

ABOVE THIS LINE FOR DIVISION USE ONLY

NEW MEXICO OIL CONSERVATION DIVISION
- Engineering Bureau -
 1220 South St. Francis Drive, Santa Fe, NM 87505



2004 NOV 15 PM 1 06

ADMINISTRATIVE APPLICATION CHECKLIST

THIS CHECKLIST IS MANDATORY FOR ALL ADMINISTRATIVE APPLICATIONS FOR EXCEPTIONS TO DIVISION RULES AND REGULATIONS WHICH REQUIRE PROCESSING AT THE DIVISION LEVEL IN SANTA FE

Application Acronyms:

- [NSL-Non-Standard Location] [NSP-Non-Standard Proration Unit] [SD-Simultaneous Dedication]**
[DHC-Downhole Commingling] [CTB-Lease Commingling] [PLC-Pool/Lease Commingling]
[PC-Pool Commingling] [OLS - Off-Lease Storage] [OLM-Off-Lease Measurement]
[WFX-Waterflood Expansion] [PMX-Pressure Maintenance Expansion]
[SWD-Salt Water Disposal] [IPI-Injection Pressure Increase]
[EOR-Qualified Enhanced Oil Recovery Certification] [PPR-Positive Production Response]

[1] TYPE OF APPLICATION - Check Those Which Apply for [A]

- [A] Location - Spacing Unit - Simultaneous Dedication**
☐ NSL ☐ NSP ☐ SD

Check One Only for [B] or [C]

- [B] Commingling - Storage - Measurement**
☐ DHC ☐ CTB ☐ PLC ☐ PC ☐ OLS ☐ OLM

- [C] Injection - Disposal - Pressure Increase - Enhanced Oil Recovery**
☐ WFX ☐ PMX ☒ SWD ☐ IPI ☐ EOR ☐ PPR

[D] Other: Specify _____

[2] NOTIFICATION REQUIRED TO: - Check Those Which Apply, or ☐ Does Not Apply

- [A] ☐ Working, Royalty or Overriding Royalty Interest Owners**
[B] ☒ Offset Operators, Leaseholders or Surface Owner
[C] ☒ Application is One Which Requires Published Legal Notice
[D] ☒ Notification and/or Concurrent Approval by BLM or SLO
U.S. Bureau of Land Management - Commissioner of Public Lands, State Land Office
[E] ☒ For all of the above, Proof of Notification or Publication is Attached, and/or,
[F] ☐ Waivers are Attached

[3] SUBMIT ACCURATE AND COMPLETE INFORMATION REQUIRED TO PROCESS THE TYPE OF APPLICATION INDICATED ABOVE.

[4] CERTIFICATION: I hereby certify that the information submitted with this application for administrative approval is accurate and complete to the best of my knowledge. I also understand that no action will be taken on this application until the required information and notifications are submitted to the Division.

Note: Statement must be completed by an individual with managerial and/or supervisory capacity.

Dorothea Logan		Regulatory Analyst	11-09-04
Print or Type Name	Signature	Title	Date
		dlogan@t3wireless.com	
		e-mail Address	

APPLICATION FOR AUTHORIZATION TO INJECT

Platinum Exploration, Inc.

Rose Eaves #2

API # 30-025-07291

660 FSL & 660 FEL

Unit P, Sec 35, T16S, R38E

Lea County, New Mexico

ITEM I

The purpose of this application is to re-enter the Rose Eaves #2 plugged by Amerada Petroleum Corp. in 1951 and convert it to a disposal well. Drill out cement plugs to 8900'. Pump 50 sx cmt plug @ 7800' – 7900'. Tie 8-5/8" csg from 1408' to surface, and cmt 8-5/8" csg to surface. Drill out Plugs. Run 4-1/2" IPC tubing. Set injection packer at 4,750'. Displace annulus with packer fluid. Run MIT and dispose of produced water to the open hole from 4810' to 7800'.

ITEM II

Platinum Exploration Inc
550 W. Texas, Ste. 500
Midland, TX 79701
Dorothea Logan (432) 687-1664

ITEM III

See Data Sheet attached

ITEM IV

This is NOT an expansion of an existing project.

ITEM V

See map attached

ITEM VI

There are no active wells in the area of review that penetrate the proposed injection interval. There are 2 plugged and abandoned wells that penetrate the interval in the area of review. See attachment "C" - Tabulation of Wells

ITEM VII

1. Daily average injection rate is expected to be 10,000 BWPD. Maximum daily injection rate would be approximately 15,000 BWPD. Daily volume is 10,000 BW. The maximum volume is 15,000 BW.
2. The system will be closed.

3. The proposed average injection pressure is expected to be 1,000 psi and the maximum injection pressure is expected to be 1,200 psi. A step rate injection test may be run to determine maximum injection pressure. The results of the test will be submitted to NMOCD.
4. Platinum will be re-entering some plugged wells in the area and the sources of disposed water would be from the Devonian.
5. Please find attached the water analysis for a well producing from the Devonian formation. (Attachment "B")

ITEM VIII

The Knowles (Devonian) field area is located in southeastern Lea County, New Mexico, eleven miles north of Hobbs, New Mexico along the southeastern rim of the Northwestern Shelf.

The Knowles field produces from the Devonian dolomite and is a strong water-drive reservoir. Platinum proposes to inject produced Devonian water into an interval between **4810 feet to 7800 feet** in the **Rose Eaves #2 well**, an old Devonian test structurally too low to produce and was dry and abandoned in January, 1951. Although the formations open in this interval are the Grayburg, San Andres, Glorieta, and Clearfork, gamma ray and resistivity curves indicate the injected water should be taken into a clean dolomite in the **lower San Andres porosity zone** between **6150 feet and 6450 feet**, just above the Glorieta formation, and **the upper Clearfork porosity** between **6812 feet and 6860 feet**. None of these formations, including the Grayburg and Glorieta, produce in the Knowles field. The proposed water disposal well is structurally low to wells in the field. The closest San Andres production is six miles south in the Carter, South field. No commercial **Clearfork/Bone Springs or Glorieta** production is within a ten mile radius of this well. The **Grayburg** produces in the Lovington field ten miles west.

Potable water exists from surface to approximately 170 feet in the Ogallala sands in the Tertiary system. No sources of drinking water exist below the proposed injection interval.

ITEM IX

The disposal interval will be acidized in the future with 15% NEFE.

ITEM X

Logs and test data were submitted when well was originally drilled and are sufficient history data for conversion.

ITEM XI

There are fresh water wells within one mile of proposed disposal well, and a fresh water analysis is provided.

ITEM XII

The geological and engineering staff of Platinum Exploration Inc. has examined available geologic and engineering data and has found no evidence of open faults or any other hydrological connection between the disposal zone and any underground sources of drinking water.

ITEM XIII

Platinum has sent copies of this application to Amerada Hess Corporation as the operator of the 2 plugged wells in the area of review and Apache Corporation as operator of undeveloped offset interests. The landowner, Valetta Ruth Lawrence, has also been noticed.

Surface Owner

Valetta Ruth Lawrence Fingado
c/o Larry Parker
P. O. Box 2709
Hobbs, NM 88241

Operators

Amerada Hess Corporation
2207 W. Industrial Ave.
Midland, TX 79701-7799

Apache Corporation
Two Warren Place
Suite 1500
6120 South Yale
Tulsa, OK 74136-4224

APPLICATION FOR AUTHORIZATION TO INJECT

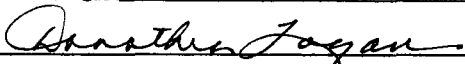
- I. PURPOSE: Secondary Recovery Pressure Maintenance X Disposal Storage
Application qualifies for administrative approval? Yes No
- II. OPERATOR: Platinum Exploration, Inc.
ADDRESS: 550 W. Texas, Suite 500 Midland, TX 79701
CONTACT PARTY: Dorothea Logan PHONE: 432-687-1664 X 123
- III. WELL DATA: Complete the data required on the reverse side of this form for each well proposed for injection.
Additional sheets may be attached if necessary.
- IV. Is this an expansion of an existing project? Yes X No
If yes, give the Division order number authorizing the project: _____
- V. Attach a map that identifies all wells and leases within two miles of any proposed injection well with a one-half mile radius circle drawn around each proposed injection well. This circle identifies the well's area of review.
- VI. Attach a tabulation of data on all wells of public record within the area of review which penetrate the proposed injection zone. Such data shall include a description of each well's type, construction, date drilled, location, depth, record of completion, and a schematic of any plugged well illustrating all plugging detail.
- VII. Attach data on the proposed operation, including:
1. Proposed average and maximum daily rate and volume of fluids to be injected;
 2. Whether the system is open or closed;
 3. Proposed average and maximum injection pressure;
 4. Sources and an appropriate analysis of injection fluid and compatibility with the receiving formation if other than reinjected produced water; and,
 5. If injection is for disposal purposes into a zone not productive of oil or gas at or within one mile of the proposed well, attach a chemical analysis of the disposal zone formation water (may be measured or inferred from existing literature, studies, nearby wells, etc.).
- *VIII. Attach appropriate geologic data on the injection zone including appropriate lithologic detail, geologic name, thickness, and depth. Give the geologic name, and depth to bottom of all underground sources of drinking water (aquifers containing waters with total dissolved solids concentrations of 10,000 mg/l or less) overlying the proposed injection zone as well as any such sources known to be immediately underlying the injection interval.
- IX. Describe the proposed stimulation program, if any.
- *X. Attach appropriate logging and test data on the well. (If well logs have been filed with the Division, they need not be resubmitted).
- *XI. Attach a chemical analysis of fresh water from two or more fresh water wells (if available and producing) within one mile of any injection or disposal well showing location of wells and dates samples were taken.
- XII. Applicants for disposal wells must make an affirmative statement that they have examined available geologic and engineering data and find no evidence of open faults or any other hydrologic connection between the disposal zone and any underground sources of drinking water.
- XIII. Applicants must complete the "Proof of Notice" section on the reverse side of this form.
- XIV. Certification: I hereby certify that the information submitted with this application is true and correct to the best of my knowledge and belief.
- NAME: Dorothea Logan TITLE: Regulatory Analyst
SIGNATURE:  DATE: 11/29/04
E-MAIL ADDRESS: dlogan@t3wireless.com
- * If the information required under Sections VI, VIII, X, and XI above has been previously submitted, it need not be resubmitted. Please show the date and circumstances of the earlier submittal: _____

III. WELL DATA

- A. The following well data must be submitted for each injection well covered by this application. The data must be both in tabular and schematic form and shall include:

- (1) Lease name; Well No.; Location by Section, Township and Range; and footage location within the section.
- (2) Each casing string used with its size, setting depth, sacks of cement used, hole size, top of cement, and how such top was determined.
- (3) A description of the tubing to be used including its size, lining material, and setting depth.
- (4) The name, model, and setting depth of the packer used or a description of any other seal system or assembly used.

Division District Offices have supplies of Well Data Sheets which may be used or which may be used as models for this purpose. Applicants for several identical wells may submit a "typical data sheet" rather than submitting the data for each well.

- B. The following must be submitted for each injection well covered by this application. All items must be addressed for the initial well. Responses for additional wells need be shown only when different. Information shown on schematics need not be repeated.

- (1) The name of the injection formation and, if applicable, the field or pool name.
- (2) The injection interval and whether it is perforated or open-hole.
- (3) State if the well was drilled for injection or, if not, the original purpose of the well.
- (4) Give the depths of any other perforated intervals and detail on the sacks of cement or bridge plugs used to seal off such perforations.
- (5) Give the depth to and the name of the next higher and next lower oil or gas zone in the area of the well, if any.

XIV. PROOF OF NOTICE

All applicants must furnish proof that a copy of the application has been furnished, by certified or registered mail, to the owner of the surface of the land on which the well is to be located and to each leasehold operator within one-half mile of the well location.

Where an application is subject to administrative approval, a proof of publication must be submitted. Such proof shall consist of a copy of the legal advertisement which was published in the county in which the well is located. The contents of such advertisement must include:

- (1) The name, address, phone number, and contact party for the applicant;
- (2) The intended purpose of the injection well; with the exact location of single wells or the Section, Township, and Range location of multiple wells;
- (3) The formation name and depth with expected maximum injection rates and pressures; and,
- (4) A notation that interested parties must file objections or requests for hearing with the Oil Conservation Division, 1220 South St. Francis Dr., Santa Fe, New Mexico 87505, within 15 days.

NO ACTION WILL BE TAKEN ON THE APPLICATION UNTIL PROPER PROOF OF NOTICE HAS BEEN SUBMITTED.

NOTICE: Surface owners or offset operators must file any objections or requests for hearing of administrative applications within 15 days from the date this application was mailed to them.

INJECTION WELL DATA SHEET

OPERATOR: Platinum Exploration, IncWELL NAME & NUMBER: Rose Heaves No. 2WELL LOCATION: 660' FSL & 660' FEL P 35 16S 38E
FOOTAGE LOCATION UNIT LETTER SECTION TOWNSHIP RANGEWELLBORE SCHEMATICWELL CONSTRUCTION DATA
Surface Casing

SEE ATTACHED "A"

Hole Size: 17-1/2" Casing Size: 13-3/8"Cemented with: 250 sx. or ft³Top of Cement: Surface Method Determined: Circ'd to SurfIntermediate CasingHole Size: 11" Casing Size: 8-5/8" @ 4810'Cemented with: 1500 sx. or ft³Top of Cement: 1500 Method Determined: Casing pulled at 1400'Production CasingHole Size: 7-7/8" Casing Size: No production csg run.Cemented with: sx. or ft³Top of Cement: Method Determined: Total Depth: Injection Interval4810' feet to 7800'(Perforated or Open Hole, indicate which)

INJECTION WELL DATA SHEETTubing Size: 4 1/2" Lining Material: IPCT Type of Packer: Arrow Set 1Packer Setting Depth: 4750'

Other T Type of Tubing/Casing Seal (if applicable): _____

Additional Data

1. Is this a new well drilled for injection? Yes ☒ No ☐

If no, for what purpose was the well originally drilled? Oil Production

Production Casing never run.

2. Name of the Injection Formation: G&G G&R San Andres/Clearfork

3. Name of Field or Pool (if applicable): Knowles

4. Has the well ever been perforated in any other zone(s)? List all such perforated intervals and give plugging detail, i.e. sacks of cement or plug(s) used. No Perfs

5. Give the name and depths of any oil or gas zones underlying or overlying the proposed injection zone in this area: Devonian @ 12,620' (non-productive in this well).

No other production in area.

Rose Eaves No. 2

660' FSL & 660' FEL
Unit P, Sec 35, T-16S, R-38E
Lea County, NM

API: 30-025-07291

Well Type: Plugged (1/51)

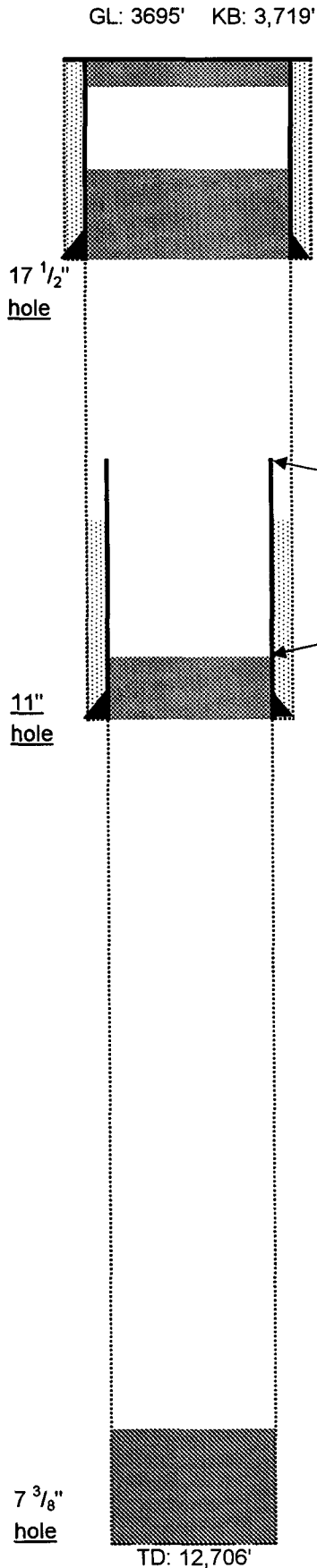

Cmt plug @ surf w/ 10 sx; (1/51)
Marker cmt'd in Surface csg.

Cmt plug @ 323' w/ 50 sx; TOC: 261'; (1/51)
13 3/8" 36# @ 323' w/ 250 sx

Circ'd cmt to surface.

Salt Section runs from 2,220' to 3,090'

8 5/8" Csg cut off @ 1,408'

Casing Cut @ 2,600' ?

Cmt plug @ 4,812' w/ 50 sx; TOC: 4,648'; (1/51)

8 5/8" 32&36# J-55 STC @ 4,810' w/ 1,500 sx
Calculated cmt to surface with 100% excess
Estimate actual cement top at 2,300'.

Cmt plug @ 12,706' w/ 35 sx; TOC: 12,577'; (1/51)

No production csg. run.

Open Hole: 4,810' - 12,706'

OIL CONSERVATION COMMISSION

SANTA FE, NEW MEXICO

Miscellaneous Reports on Wells

Submit this report in triplicate to the Oil Conservation Commission or its proper agent within ten days after the work specified is completed. It should be signed and sworn to before a notary public for reports on beginning drilling operations, results of shooting well, results of test of casing shut off, result of plugging of well, and other important operations, even though the work was witnessed by an agent of the Commission. Reports on minor operations need not be signed and sworn to before a notary public. See additional instructions in the Rules and Regulations of the Commission.

Indicate nature of report by checking below.

REPORT ON BEGINNING DRILLING OPERATIONS		REPORT ON REPAIRING WELL	
REPORT ON RESULT OF SHOOTING OR CHEMICAL TREATMENT OF WELL		REPORT ON PULLING OR OTHERWISE ALTERING CASING	
REPORT ON RESULT OF TEST OF CASING SHUT-OFF		REPORT ON DEEPENING WELL	
REPORT ON RESULT OF PLUGGING OF WELL		REPORT ON SETTING CASING	X

July 17, 1950

Monument, New Mexico

Date

Place

OIL CONSERVATION COMMISSION,
SANTA FE, NEW MEXICO.
Gentlemen:

Following is a report on the work done and the results obtained under the heading noted above at the _____

Amerada Petroleum Corporation Base Hayes Well No. 2 in the _____
Company or Operator Lease

C/SE/4 SE/4 of Sec. 35, T. 16-S, R. 38-E, N. M. P. M.,
Knolls Field 10a County.

The dates of this work were as follows: July 15 & 16, 1950

Notice of intention to do the work was ~~submitted~~ submitted on Form C-102 on July 16, 1950
and approval of the proposed plan was ~~obtained~~ obtained. (Cross out incorrect words.)

DETAILED ACCOUNT OF WORK DONE AND RESULTS OBTAINED

330' - Total Depth - Red Bed. Ran 7 Jts. of 13-3/8" O.D. 36#, Range 3, Armo Spiral Weld, Slip Joint casing - Set at 323' and cemented with 200 sacks Common & 50 Sacks of Inocer Cement. Plug to 295' at 1:00 A.M., 7-16-50. Maximum pump pressure 400#. Cement circulated.

Witnessed by Don Tepper Amerada Petroleum Corporation Asst. Dist. Supt.
Name Company Title

Subscribed and sworn before me this _____

17th day of July, 1950

Notary Public

I hereby swear or affirm that the information given above is true and correct.

Name Don Tepper

Position Assistant District Superintendent

Representing Amerada Petroleum Corporation
Company or Operator

My commission expires 10-24-53

Address Drawer B, Monument, New Mexico

Remarks:

APPROVED

Don Tepper
Name

Title

OIL CONSERVATION COMMISSION

SANTA FE, NEW MEXICO

Miscellaneous Reports on Wells

JAN 20 1951

Submit this report in triplicate to the Oil Conservation Commission or its proper agent within ten days after the work specified is completed. It should be signed and sworn to before a notary public for reports on beginning drilling operations, results of shooting well, results of test of casing shut off, result of plugging of well, and other important operations, even though the work was witnessed by an agent of the Commission. Reports on minor operations need not be signed and sworn to before a notary public. See additional instructions in the Rules and Regulations of the Commission.

Indicate nature of report by checking below.

REPORT ON BEGINNING DRILLING OPERATIONS		REPORT ON REPAIRING WELL	
REPORT ON RESULT OF SHOOTING OR CHEMICAL TREATMENT OF WELL		REPORT ON PULLING OR OTHERWISE ALTERING CASING	
REPORT ON RESULT OF TEST OF CASING SHUT-OFF		REPORT ON DEEPENING WELL	
REPORT ON RESULT OF PLUGGING OF WELL	<input checked="" type="checkbox"/>		

January 26, 1951

Monument, New Mexico

Date

Place

OIL CONSERVATION COMMISSION,
SANTA FE, NEW MEXICO.
Gentlemen:

Following is a report on the work done and the results obtained under the heading noted above at the _____

Amerada Petroleum Corporation Rose Haves Well No. 2 in the _____

Company or Operator

C/SE/4 SE/4 of Sec. 35, T. 16-S, R. 38-E, N. M. P. M.,

DeeDee Field Lee County.

The dates of this work were as follows: January 25, 1951

Notice of intention to do the work was ~~submitted~~ submitted on Form C-102 on January 24, 1951

and approval of the proposed plan was ~~obtained~~ obtained. (Cross out incorrect words.)

DETAILED ACCOUNT OF WORK DONE AND RESULTS OBTAINED

12706' - Total Depth - Line. Ran Schlumberger's Electrical & Gamma Ray Surveys. Spotted 35 sacks cement from 12706' to 12577', 50 sacks cement from 4612' to 4648'. Cut 8-5/8" casing off at 1408' and recovered same. Spotted 50 sacks cement from 323' to 261' and dumped 10 sacks cement in top of 13-3/8" surface casing and set a piece of 4" Line Pipe, cemented in center of surface casing, extending 5' above surface of the ground. Heavy mud between all of the above plugs.

Witnessed by C. E. Nichols Amerada Petroleum Corporation Farm Boss

Name

Company

Title

Subscribed and sworn before me this _____

26th day of January, 1951

[Signature]

Notary Public

I hereby swear or affirm that the information given above is true and correct.

Name *[Signature]*

Position Assistant District Superintendent

Representing Amerada Petroleum Corporation

Company or Operator

My commission expires 10-11-54

Address Drawer D, Monument, New Mexico

Remarks:

RECEIVED
JAN 30 1951

[Signature]
Inspector

NEW MEXICO OIL CONSERVATION COMMISSION
SANTA FE, NEW MEXICO

MISCELLANEOUS NOTICES

Submit this notice in triplicate to the Oil Conservation Commission or its proper agent before the work specified is to begin. A copy will be returned to the sender on which will be given the approval, with any modifications considered advisable, or the rejection by the Commission or agent, of the plan submitted. The plan as approved should be followed, and work should not begin until approval is obtained. See additional instructions in the Rules and Regulations of the Commission.

Indicate nature of notice by checking below:

NOTICE OF INTENTION TO TEST CASING SHUT-OFF		NOTICE OF INTENTION TO SHOOT OR CHEMICALLY TREAT WELL	
NOTICE OF INTENTION TO CHANGE PLANS		NOTICE OF INTENTION TO PULL OR OTHERWISE ALTER CASING	
NOTICE OF INTENTION TO REPAIR WELL		NOTICE OF INTENTION TO PLUG WELL	<input checked="" type="checkbox"/>
NOTICE OF INTENTION TO DEEPEN WELL			

Monument, New Mexico January 24, 1951
Place Date

OIL CONSERVATION COMMISSION
Santa Fe, New Mexico

Gentlemen:

Following is a notice of intention to do certain work as described below at the

Amorada Petroleum Corporation Rosa Bayon Well No. 2 in C/SE/4 SE/4
Company or Operator Lease
of Sec. 35, T. 16-S, R. 36-E, N. M. P. M. Dozules Field.
Lee County.

FULL DETAILS OF PROPOSED PLAN OF WORK

FOLLOW INSTRUCTIONS IN THE RULES AND REGULATIONS OF THE COMMISSION

12706' - Total Depth - Line. Finished drilling 7-3/8" hole at 6:45 A.M., 1-22-51. No oil or gas seeps of consequence were encountered. It is our intention to plug and abandon this well, after running Schlumberger's Electrical & Gamma Ray Surveys. We propose to plug the well as follows: 35 sacks cement from T.D. to 12577', 50 sacks cement from 14812' to 14648', cut 8-5/8" casing off at approx. 2600' and recover same. 50 sacks cement from 323' to 261' and dump 10 sacks cement in top of 13-3/8" surface casing and set a piece of 4" Line Pipe, cemented in center of surface casing, extending 5' above surface of the ground. Heavy mud between all of the above cement plugs.

Approved JAN 30 1951, 19____
except at follows:

OIL CONSERVATION COMMISSION
By Roy Guhrke
Title Oil & Gas Inspector

Amorada Petroleum Corporation
Company or Operator
By [Signature]
Position Assistant District Superintendent
Send communications regarding well to
Name Amorada Petroleum Corporation
Address Drawer D, Monument, New Mexico

Rose Eaves No. 2

660' FSL & 660' FEL
 Unit P, Sec 35, T-16S, R-38E
 Lea County, NM
API: 30-025-07291

Well Type: Proposed SWD

Surface Owner: Valetta Ruth Lawrence Fingado
 c/o Larry Parker
 P.O. Box 2710
 Hobbs, New Mexico 88241

Formation Tops

Salt	2300
Seven Rivers	3200
Grayburg	4650
San Andres	5200
Glorieta	6440
Clearfork	6550
Bone Springs	7850

GL: 3695' KB: 3,719'

17 1/2"
hole

13 3/8" 36# @ 323' w/ 250 sx
 Circ'd cmt to surface.

8 5/8" Csg tied back to surface w/ csg patch @ 1408'
 and cemented back to surface

4 1/2" IPC tbg @ 4750' w/ Arrow Set I packer

11"
Hole

8 5/8" 32&36# J-55 STC @ 4810' w/ 1500 sx

Max Inj. Rate 15,000 BPD
 Max Inj. Press. 1,200 psi
 Avg. Inj. Rate 10,000 BPD
 Avg. Inj. Press. 1,000 psi
 Inj. Interval 4810' to 7800'

Cmt plug from 7800' to 7900' w/ 50sxs

Cmt plug @ 12,706' w/ 35 sx; TOC: 12,577'; (1/51)

Open Hole: 4810' - 12,706'

7 3/8"
Hole

TD: 12,706'

JMR 11/8/04

ITEM V

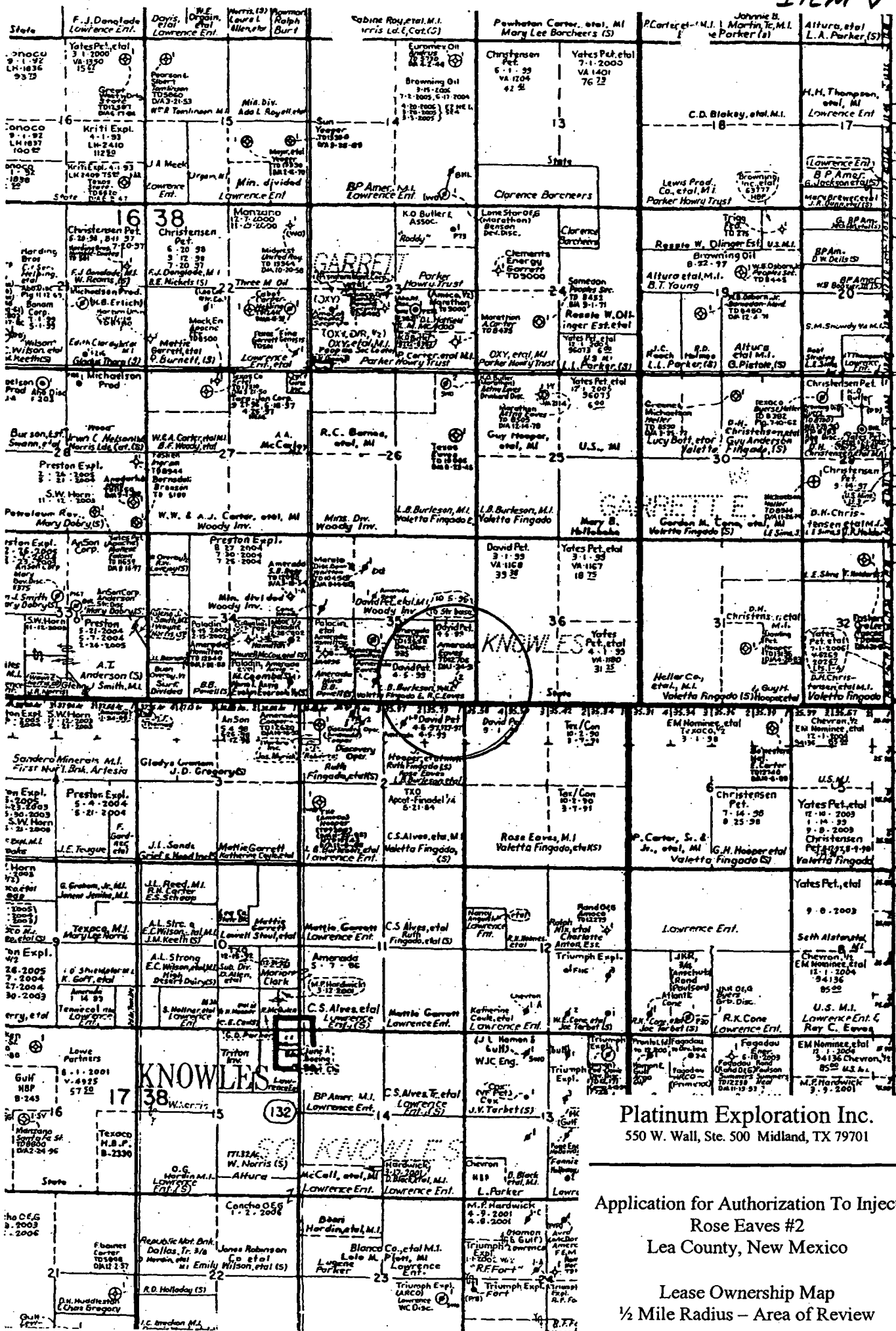

BLK. A-7

BLK. A-8

NORTH EAST LEA COUNTY NEW MEXICO

SCALE 1 IN = 4000 FT

Rose Eaves No. 1

Item VI

660' FSL & 1980' FWL

Sec 35, T-16S, R-38E

Lea County, NM

API #: 30-025-07290

Well Type: Plugged (1/70)

GL: 3,700' KB: 3,713'

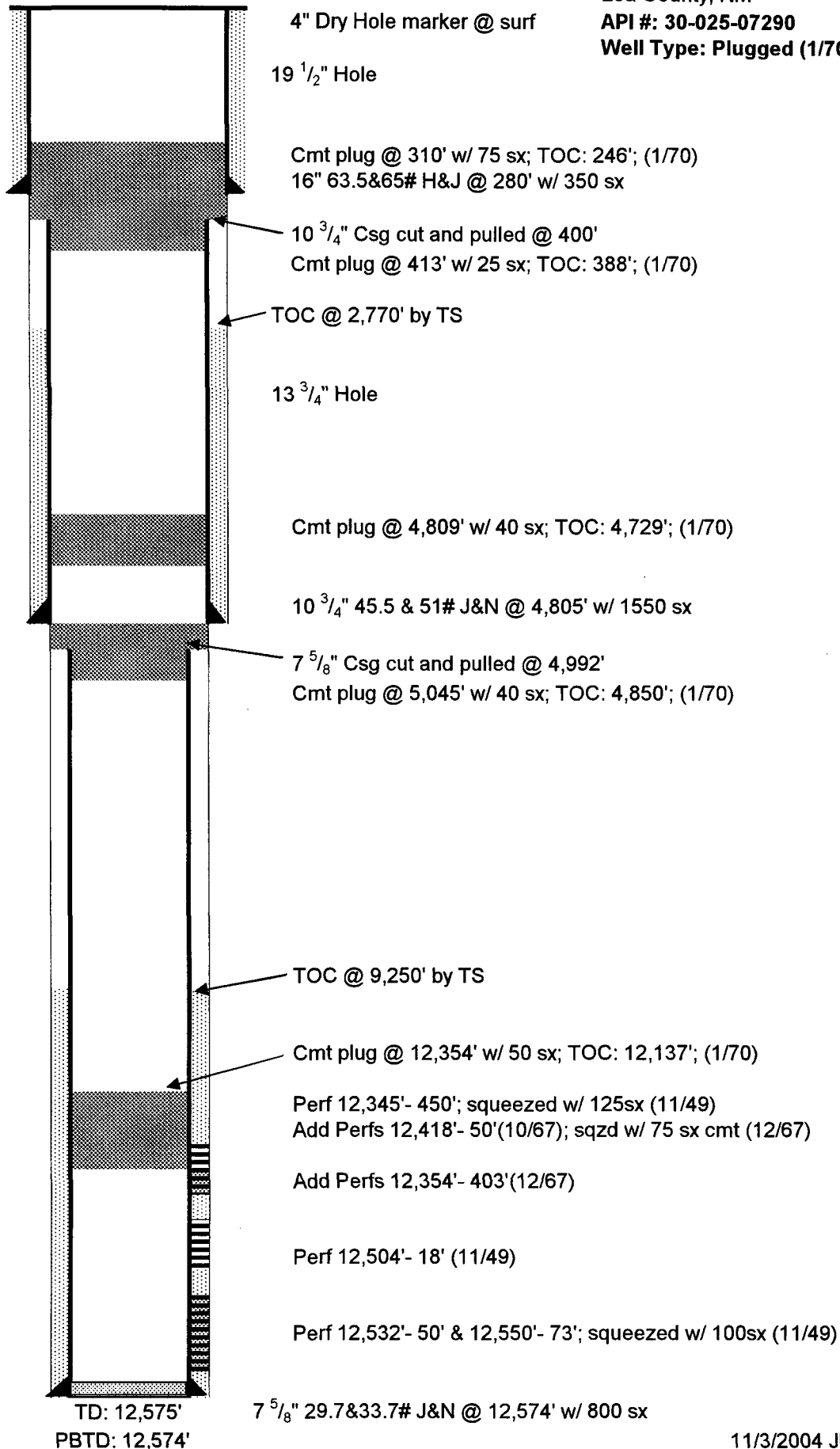

11/3/2004 JMR

OIL CONSERVATION COMMISSION

Santa Fe, New Mexico

MISCELLANEOUS REPORTS ON WELLS

Submit this report in triplicate to the Oil Conservation Commission or its proper agent within ten days after the work specified is completed. It should be signed and sworn to before a notary public for reports on beginning drilling operations, results of shooting well, results of test of casing shut off, result of plugging of well, and other important operations, even though the work was witnessed by an agent of the Commission. Reports on minor operations need not be signed and sworn to before a notary public. See additional instructions in the Rules and Regulations of the Commission.

Indicate nature of report by checking below.

REPORT ON BEGINNING DRILLING OPERATIONS		REPORT ON REPAIRING WELL	
REPORT ON RESULT OF SHOOTING OR CHEMICAL TREATMENT OF WELL		REPORT ON PULLING OR OTHERWISE ALTERING CASING	
REPORT ON RESULT OF TEST OF CASING SHUT-OFF	X	REPORT ON DEEPENING WELL	
REPORT ON RESULT OF PLUGGING OF WELL			

November 5, 1949

Monument, New Mexico

Date

Place

OIL CONSERVATION COMMISSION,
SANTA FE, NEW MEXICO

Gentlemen:

Following is a report on the work done and the results obtained under the heading noted above at the Amerada Petroleum Corporation Rose Raves Well No. 1 in the

Company or Operator SE/4 SW/4 of Sec. 35, T. 16-S, R. 38-E, N. M. P. M.,
Knowles Field, Lea County.

The dates of this work were as follows: November 4, 1949

Notice of intention to do the work was ~~submitted~~ submitted on Form C-102 on October 30, 1949
and approval of the proposed plan was ~~obtained~~ obtained. (Cross out incorrect words.)

DETAILED ACCOUNT OF WORK DONE AND RESULTS OBTAINED

12,575' - Total Depth - Line. 12,574' Drilled Out Depth. Run temperature Survey - Top of cement on outside of 7-5/8" casing 9250', actual fill 9245', ratio of actual to calculated fill 76%. Connected 7-5/8" casing, ran 6-5/8" bit & 2-3/8" O.D. HUE tubing and tested 7-5/8" casing & well head connections with 1500# for 1/2 hour - no pressure drop. Drilled cement to 12,574', circulated hole clean and tested 7-5/8" casing with 1500# for 1/2 hour - no pressure drop. Proceeded with completion operations.

Witnessed by G. R. Nichols Amerada Petroleum Corporation Farm Boss
Name Company Title

Subscribed and sworn before me this

7th day of November 1949

Notary Public

I hereby swear or affirm that the information given above is true and correct.

Name W. W. L. L. L.Position Assistant District SuperintendentRepresenting Amerada Petroleum Corporation
Company or OperatorMy commission expires 10-24-53Address Drawer D, Monument, New Mexico

Remarks:

Name

Title

OIL CONSERVATION COMMISSION

Santa Fe, New Mexico

MISCELLANEOUS REPORTS ON WELLS

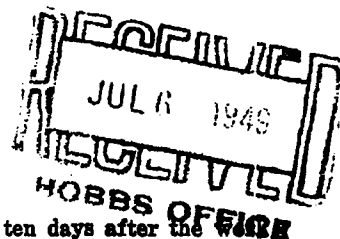

Submit this report in triplicate to the Oil Conservation Commission or its proper agent within ten days after the specified is completed. It should be signed and sworn to before a notary public for reports on beginning drilling operations, results of shooting well, results of test of casing shut off, result of plugging of well, and other important operations, even though the work was witnessed by an agent of the Commission. Reports on minor operations need not be signed and sworn to before a notary public. See additional instructions in the Rules and Regulations of the Commission.

Indicate nature of report by checking below.

REPORT ON BEGINNING DRILLING OPERATIONS		REPORT ON REPAIRING WELL	
REPORT ON RESULT OF SHOOTING OR CHEMICAL TREATMENT OF WELL		REPORT ON PULLING OR OTHERWISE ALTERING CASING	
REPORT ON RESULT OF TEST OF CASING SHUT-OFF	X	REPORT ON DEEPENING WELL	
REPORT ON RESULT OF PLUGGING OF WELL			

July 1, 1949

Monument, New Mexico

Date

Place

OIL CONSERVATION COMMISSION,
SANTA FE, NEW MEXICO
Gentlemen:

Following is a report on the work done and the results obtained under the heading noted above at the Amerada Petroleum Corporation Rose Haves Well No. 1 in the SE 1/4 Sec. 35 of Sec. 35, T. 16S, R. 38E, N. M. P. M., Knowles Field, Lee County.

The dates of this work were as follows: June 30, 1949

Notice of intention to do the work was (~~submitted~~) submitted on Form C-102 on June 27, 1949 and approval of the proposed plan was (~~submitted~~) obtained. (Cross out incorrect words.)

DETAILED ACCOUNT OF WORK DONE AND RESULTS OBTAINED

4806' Total Depth, Lime. Ran Temperature Survey and found top of cement at 2770' ON 10 3/4" CSG
Actual Fill 2034', Ratio of Actual to calculated fill 49.1%. Nippled up and picked up drill pipe and found top of cement at 4694' and tested casing with 1500# for 30 minutes was O.K. Drilled out cement plug and tested with 1500# for 30 minutes was O.K. Started drilling 8-3/4" hole at 12:30 P.M. 6-30-49.

Witnessed by C.E. Nichols Amerada Petroleum Corporation Farm Boss
Name Company Title

Subscribed and sworn before me this

1st. day of July 1949

Will Hail Taylor
Notary Public

I hereby swear or affirm that the information given above is true and correct.

Name Don J. J. J.

Position Asst. Dist. Supt.

Representing Amerada Petroleum Corporation
Company or Operator

My commission expires NOVEMBER 1, 1950

Address Drawer D, Monument, New Mexico

Remarks:

APPROVED
JUL 5 1949
Date

Roy G. G. G.
Name
Inspector
Title

DUPLICATE

OIL CONSERVATION COMMISSION

Santa Fe, New Mexico

MISCELLANEOUS REPORTS ON WELLS

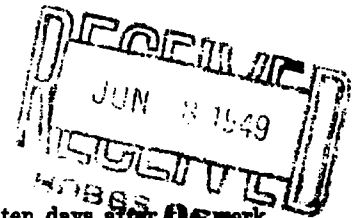

Submit this report in triplicate to the Oil Conservation Commission or its proper agent within ten days after ~~work~~ specified is completed. It should be signed and sworn to before a notary public for reports on beginning drilling operations, results of shooting well, results of test of casing shut off, result of plugging of well, and other important operations, even though the work was witnessed by an agent of the Commission. Reports on minor operations need not be signed and sworn to before a notary public. See additional instructions in the Rules and Regulations of the Commission.

Indicate nature of report by checking below.

REPORT ON BEGINNING DRILLING OPERATIONS		REPORT ON REPAIRING WELL	
REPORT ON RESULT OF SHOOTING OR CHEMICAL TREATMENT OF WELL		REPORT ON PULLING OR OTHERWISE ALTERING CASING	
REPORT ON RESULT OF TEST OF CASING SHUT-OFF		REPORT ON DEEPENING WELL	
REPORT ON RESULT OF PLUGGING OF WELL		Report on Setting Casing	X

May 31, 1949

Monument, New Mexico

Date

Place

OIL CONSERVATION COMMISSION,
SANTA FE, NEW MEXICO

Gentlemen:

Following is a report on the work done and the results obtained under the heading noted above at the

Amerada Petroleum Corporation Rose Hayes Well No. 1 in the
Company or Operator Lease

Sec. 35 of Sec. 35, T. 16S, R. 38E, N. M. P. M.,
Knowles Field, Lea County.

The dates of this work were as follows: May 30, 1949

Notice of intention to do the work was (~~was not~~) submitted on Form C-102 on May 30, 1949

and approval of the proposed plan was (~~was not~~) obtained. (Cross out incorrect words.)

DETAILED ACCOUNT OF WORK DONE AND RESULTS OBTAINED

289' Total Depth, Red Bed. Rigged up & ran 7 joints of 16" OD, 63.5#, Kaneweld, BEPE, R-2, Csg. (New) 226.29' & 1 joint of 16" OD, 65#, 8VT, R-2, National Tube Csg. (New) 34.43'. Total of 8 joints 260.72' & Set at 280' & cemented with 105 sacks Lone Star Reg. Bulk, 195 sacks Trinity Reg. Bulk, & 50 Sacks Incor cement, & plug stopped at 260' at 11:00 P.M. 5-30-49 and cement circulated.

Witnessed by K.V. Stephenson Amerada Petroleum Corporation Foreman
Name Company Title

Subscribed and sworn before me this

31st day of May 1949

Willie Baird Taylor

Notary Public

I hereby swear or affirm that the information given above is true and correct.

Name Willie Baird Taylor

Position Asst. Dist. Supt.

Representing Amerada Petroleum Corporation
Company or Operator

My commission expires

Address Drawer D, Monument, New Mexico

Remarks:

APPROVED

Date Jun 8 1949

Willie Baird Taylor
Name
Inspector
Title

NO. OF COPIES RECEIVED	
DISTRIBUTION	
SANTA FE	
FILE	
U.S.G.S.	
LAND OFFICE	
OPERATOR	

NEW MEXICO OIL CONSERVATION COMMISSION

Form C-103
Supersedes Old
C-102 and C-103
Effective 1-1-65

5a. Indicate Type of Lease:
State <input type="checkbox"/> Fee <input checked="" type="checkbox"/>

5. State Oil & Gas Lease No.

SUNDRY NOTICES AND REPORTS ON WELLS

(DO NOT USE THIS FORM FOR PROPOSALS TO DRILL OR TO DEEPEN OR PLUG BACK TO A DIFFERENT RESERVOIR.
USE "APPLICATION FOR PERMIT" (FORM C-101) FOR SUCH PROPOSALS.)

1. OIL WELL <input checked="" type="checkbox"/> GAS WELL <input type="checkbox"/> OTHER <input type="checkbox"/>	7. Unit Agreement Name
2. Name of Operator Amerada Hess Corporation	8. Farm or Lease Name Rose Eaves
3. Address of Operator P. O. Box 1920, Hobbs, New Mexico 88231	9. Well No. #1
4. Location of Well UNIT LETTER N 660' FEET FROM THE South LINE AND 1980' FEET FROM THE West LINE, SECTION 35 TOWNSHIP 16S RANGE 38E N.M.P.M.	10. Field and Pool, or Wilcox Knowles-Devonian
15. Elevation (Show whether DF, RT, GR, etc.) 3712' DF	12. County Lea

Check Appropriate Box To Indicate Nature of Notice, Report or Other Data

NOTICE OF INTENTION TO:

SUBSEQUENT REPORT OF:

PERFORM REMEDIAL WORK <input type="checkbox"/>	PLUG AND ABANDON <input checked="" type="checkbox"/>	REMEDIAL WORK <input type="checkbox"/>	ALTERING CASING <input type="checkbox"/>
TEMPORARILY ABANDON <input type="checkbox"/>	CHANGE PLANS <input type="checkbox"/>	COMMENCE DRILLING OPNS. <input type="checkbox"/>	PLUG AND ABANDONMENT <input type="checkbox"/>
PULL OR ALTER CASING <input type="checkbox"/>	OTHER <input type="checkbox"/>	CASING TEST AND CEMENT JOB <input type="checkbox"/>	

17. Describe Proposed or Completed Operations (Clearly state all pertinent details, and give pertinent dates, including estimated date of starting any proposed work) SEE RULE 1103.

Pull rods, pump and tubing. Spot 35 sx cement plug fr. 12,209' to 12,354' in 7-5/8" casing.
Shoot 7-5/8" casing and spot 40 sx cement plug in and out of 7-5/8" casing stub. Spot 40
sx cement plug fr. 4750-4850', 10-3/4" casing @ 4804'. Cut and pull 10-3/4" OD casing,
If salt section exposed spot 25 sx cement plug top and bottom. Spot 75 sx cement plug
in and out of 13-3/8" casing 246-310'. Spot 10 sx plug at surface w/dry-hole marker.

*Need 25sx plugs at following Formations
tops if exposed:
Tubb - 8070'
Glorieta - 6425'*

18. I hereby certify that the information above is true and complete to the best of my knowledge and belief.

SIGNED **G. O. Webb** *G. O. Webb* TITLE **District Superintendent** DATE **12-29-69**

APPROVED BY *[Signature]* TITLE DATE

CONDITIONS OF APPROVAL, IF ANY:

Rose Eaves "A" No. 1

660' FNL & 1980' FEL

Unit B, Sec 2, T-17S, R-38E

API #: 30-025-07296

DF: 3724' KB: 3,725'

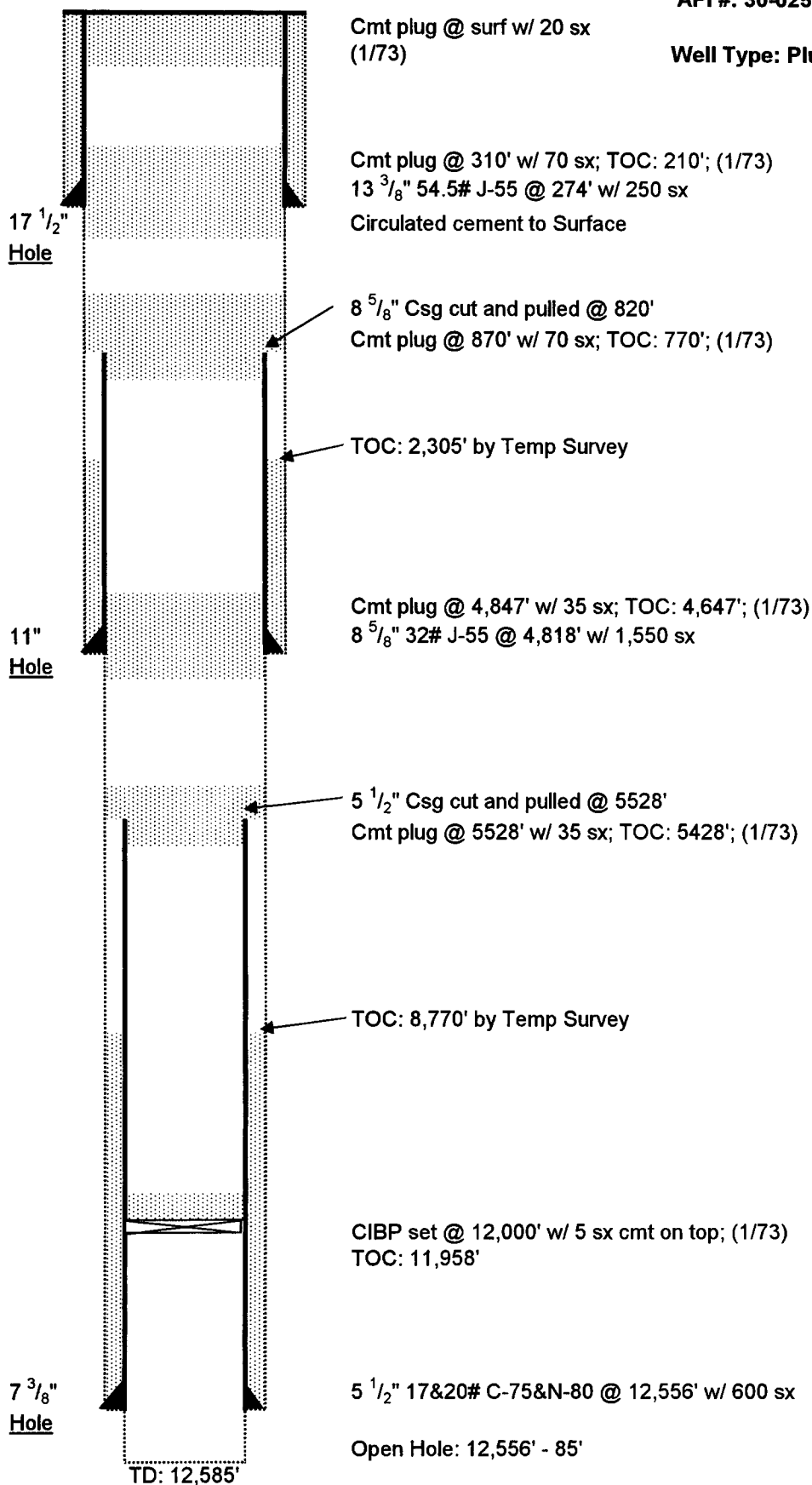
Well Type: Plugged (1/73)

Plugging Activity

NO. OF COPIES RECEIVED	
DISTRIBUTION	
SANTA FE	
FILE	
U.S.G.S.	
LAND OFFICE	
OPERATOR	

NEW MEXICO OIL CONSERVATION COMMISSION

Form C-103
Supersedes Old
C-102 and C-103
Effective 1-1-65

SUNDRY NOTICES AND REPORTS ON WELLS <small>(DO NOT USE THIS FORM FOR PROPOSALS TO DRILL OR TO DEEPEN OR PLUG BACK TO A DIFFERENT RESERVOIR. USE "APPLICATION FOR PERMIT --" (FORM C-101) FOR SUCH PROPOSALS.)</small>		5a. Indicate Type of Lease State <input type="checkbox"/> Patent Fee <input type="checkbox"/>
1. <input type="checkbox"/> OIL WELL <input type="checkbox"/> GAS WELL <input type="checkbox"/> OTHER- Plug and Abandonment		5. State Oil & Gas Lease No.
2. Name of Operator Amerada Hess Corporation		7. Unit Agreement Name
3. Address of Operator 1209 South Main, Lovington, New Mexico		8. Farm or Lease Name Rose Eaves "A"
4. Location of Well UNIT LETTER B 660' FEET FROM THE North LINE AND 1980' FEET FROM East THE 2 LINE, SECTION 17-S TOWNSHIP 38-E RANGE 38-E NMPM.		9. Well No. #1
15. Elevation (Show whether DF, RT, GR, etc.) 3724' DF		10. Field and Pool, or Wildcat Knewles Devonian
12. County Lea		

Check Appropriate Box To Indicate Nature of Notice, Report or Other Data
NOTICE OF INTENTION TO: SUBSEQUENT REPORT OF:

PERFORM REMEDIAL WORK <input type="checkbox"/>	PLUG AND ABANDON <input type="checkbox"/>	REMEDIAL WORK <input type="checkbox"/>	ALTERING CASING <input type="checkbox"/>
TEMPORARILY ABANDON <input type="checkbox"/>	CHANGE PLANS <input type="checkbox"/>	COMMENCE DRILLING OPNS. <input type="checkbox"/>	PLUG AND ABANDONMENT <input checked="" type="checkbox"/>
PULL OR ALTER CASING <input type="checkbox"/>	OTHER <input type="checkbox"/>	CASING TEST AND CEMENT JOB <input type="checkbox"/>	

17. Describe Proposed or Completed Operations (Clearly state all pertinent details, and give pertinent dates, including estimated date of starting any proposed work) SEE RULE 1103.

Rose Eaves "A" #1 - Run Cast Iron Plug to 12,000' with 5 sk. Cement on top of Plug, top of Cement @ 11,958'. Loaded Hole with 10# Brine Mud and cut 5-1/2" csg. @ 5528' and spotted 35 sk. plug 5528' - 5428', and spotted 35 sk. plug 4847' - 4647'. Cut 8-5/8" Csg. @ 820' and spotted 70 sk. plug @ 870' - 770', and 70 sk. plug 310' - 210', and 20 sk. plug 0' - 24' and install dry hole marker.
The above work was done on 12-26-72 and completed on 1-5-73

18. I hereby certify that the information above is true and complete to the best of my knowledge and belief.

SIGNED [Signature] TITLE **Area Superintendent** DATE **1-9-73**
APPROVED BY [Signature] TITLE _____ DATE _____

- PLUGGING ACTIVITY -

NO. OF COPIES RECEIVED	
DISTRIBUTION	
SANTA FE	
FILE	
U.S.G.S.	
LAND OFFICE	
OPERATOR	

NEW MEXICO OIL CONSERVATION COMMISSION

Form C-103
Supersedes Old
C-102 and C-103
Effective 1-1-65

MAR 20 1970

SUNDRY NOTICES AND REPORTS ON WELLS

(DO NOT USE THIS FORM FOR PROPOSALS TO DRILL OR TO DEEPEN OR PLUG BACK TO A DIFFERENT RESERVOIR. USE "APPLICATION FOR PERMIT -" (FORM C-101) FOR SUCH PROPOSALS.)

1. OIL WELL <input checked="" type="checkbox"/> GAS WELL <input type="checkbox"/> OTHER- <input type="checkbox"/>	5a. Indicate Type of Lease State <input type="checkbox"/> Fee <input checked="" type="checkbox"/>
2. Name of Operator Anerada Hess Corporation	5. State Oil & Gas Lease No.
3. Address of Operator P.O. Box 591, Midland, Texas 79701	7. Unit Agreement Name
4. Location of Well UNIT LETTER N 660' FEET FROM THE South LINE AND 1980' FEET FROM THE West LINE, SECTION 35 TOWNSHIP 16 S RANGE 38 E NMPM.	8. Farm or Lease Name Rose Eaves
	9. Well No. 1
	10. Field and Pool, or Wildcat Knowles Devonian
15. Elevation (Show whether DF, RT, GR, etc.) 3712' DF	12. County Lea

16. Check Appropriate Box To Indicate Nature of Notice, Report or Other Data	
NOTICE OF INTENTION TO:	SUBSEQUENT REPORT OF:
PERFORM REMEDIAL WORK <input type="checkbox"/>	REMEDIAL WORK <input type="checkbox"/>
TEMPORARILY ABANDON <input type="checkbox"/>	COMMENCE DRILLING OPNS. <input type="checkbox"/>
PULL OR ALTER CASING <input type="checkbox"/>	CASING TEST AND CEMENT JOBS <input type="checkbox"/>
OTHER <input type="checkbox"/>	OTHER <input type="checkbox"/>
PLUG AND ABANDON <input type="checkbox"/>	ALTERING CASING <input type="checkbox"/>
CHANGE PLANS <input type="checkbox"/>	PLUG AND ABANDONMENT <input checked="" type="checkbox"/>

17. Describe Proposed or Completed Operations (Clearly state all pertinent details, and give pertinent dates, including estimated date of starting any proposed work) SEE RULE 1703.

Spotted 50 sacks cement from 12,354' to 12,137'. Shot 7-5/8" Casing @ 4977', recovered 125 jts for 4992'. Set 40 sack plug 5045' to 4850' and 40 sack plug from 4809' to 4729'. Shot 10-3/4" Casing @ 396'. Recovered 9 jts. 12-3/4" for 400'. Set 25 sack plug from 413' to 388' and 75 sack plug from 310' to 246' - Well plugged and abandoned effective 1-27-70. Cemented 4" dry hole marked at surface on 3-3-70.

18. I hereby certify that the information above is true and complete to the best of my knowledge and belief.

SIGNED <u>[Signature]</u>	TITLE Area Operations Manager Anerada Division	DATE 3-23-70
APPROVED BY <u>[Signature]</u>	TITLE Geologist	DATE JUL 15 1970
CONDITIONS OF APPROVAL, IF ANY:		

CMT. TOPS AND METHODS
OIL CONSERVATION COMMISSION

Santa Fe, New Mexico

MISCELLANEOUS REPORTS ON WELLS

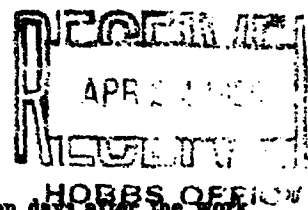

Submit this report in triplicate to the Oil Conservation Commission or its proper agent within ten days after the work specified is completed. It should be signed and sworn to before a notary public for reports on beginning drilling operations, results of shooting well, results of test of casing shut off, result of plugging of well, and other important operations, even though the work was witnessed by an agent of the Commission. Reports on minor operations need not be signed and sworn to before a notary public. See additional instructions in the Rules and Regulations of the Commission.

Indicate nature of report by checking below.

REPORT ON BEGINNING DRILLING OPERATIONS		REPORT ON REPAIRING WELL	
REPORT ON RESULT OF SHOOTING OR CHEMICAL TREATMENT OF WELL		REPORT ON PULLING OR OTHERWISE ALTERING CASING	
REPORT ON RESULT OF TEST OF CASING SHUT-OFF	X	REPORT ON DEEPENING WELL	
REPORT ON RESULT OF PLUGGING OF WELL			

April 19, 1950

Monument, New Mexico

Date

Place

OIL CONSERVATION COMMISSION,
 SANTA FE, NEW MEXICO
 Gentlemen:

Following is a report on the work done and the results obtained under the heading noted above at the _____

Amerada Petroleum Corporation **Rose Hayes "A"** Well No. **1** in the _____
 Company or Operator Lease
C/W/4 NE/4 of Sec. **2**, T. **17-S**, R. **38-E**, N. M. P. M.,
Dozules Field, **Lee** County.

The dates of this work were as follows: **April 16, 17 & 18, 1950**

Notice of intention to do the work was ~~submitted~~ submitted on Form C-102 on **April 15,** 19**50**
 and approval of the proposed plan was ~~submitted~~ obtained. (Cross out incorrect words.)

DETAILED ACCOUNT OF WORK DONE AND RESULTS OBTAINED

12,585' - Total Depth - Line - Run Temperature Survey - Top of cement on outside of 5-1/2" casing 8770', actual fill 3796', calculated fill 4950', ratio of actual to calculated fill 76.5%. W.O.C. 48 hours. Connected 5-1/2" casing, run bit & 2-3/8" O.D. HUE Tubing and tested 5-1/2" casing & connections W/ 1250# for 1/2 hour - no pressure drop. Drilled cement from 12456' to 12585', circulated hole clean & tested with 1250# for 1/2 hour - no pressure drop. Continued completion operations.

Witnessed by **G. E. Nichols** **Amerada Petroleum Corporation** **Para Ross**
 Name Company Title

Subscribed and sworn before me this _____

19th day of **April** 19**50**

Notary Public

I hereby swear or affirm that the information given above is true and correct.

Name **D. W. Topp**

Position **Assistant District Superintendent**

Representing **Amerada Petroleum Corporation**

Company or Operator

My commission expires **10-24-53**

Address **Drawer D, Monument, New Mexico**

Remarks:

APPROVED

APR 20 1950

Ray. Yarbrough
 Name
 Title

OIL CONSERVATION COMMISSION

Santa Fe, New Mexico

MISCELLANEOUS REPORTS ON WELLS

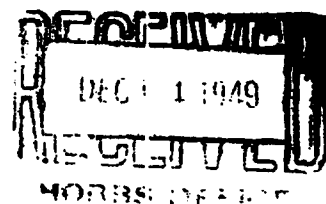

Submit this report in triplicate to the Oil Conservation Commission or its proper agent within ten days after the work specified is completed. It should be signed and sworn to before a notary public for reports on beginning drilling operations, results of shooting well, results of test of casing shut off, result of plugging of well, and other important operations, even though the work was witnessed by an agent of the Commission. Reports on minor operations need not be signed and sworn to before a notary public. See additional instructions in the Rules and Regulations of the Commission.

Indicate nature of report by checking below.

REPORT ON BEGINNING DRILLING OPERATIONS		REPORT ON REPAIRING WELL	
REPORT ON RESULT OF SHOOTING OR CHEMICAL TREATMENT OF WELL		REPORT ON PULLING OR OTHERWISE ALTERING CASING	
REPORT ON RESULT OF TEST OF CASING SHUT-OFF	X	REPORT ON DEEPENING WELL	
REPORT ON RESULT OF PLUGGING OF WELL			

December 3, 1949

Monument, New Mexico

Date

Place

OIL CONSERVATION COMMISSION,
SANTA FE, NEW MEXICO
Gentlemen:

Following is a report on the work done and the results obtained under the heading noted above at the _____

Amerada Petroleum Corporation Rosa Kavan "A" Well No. 1 in the _____
Company or Operator Lease
G/NW/4 NE/4 of Sec. 2, T. 17-S, R. 36-E, N. M. P. M.,
Known Field, Lee County.

The dates of this work were as follows: December 3, 1949

Notice of intention to do the work was ~~(insert)~~ submitted on Form C-102 on November 30, 1949
and approval of the proposed plan was ~~(insert)~~ obtained. (Cross out incorrect words.)

DETAILED ACCOUNT OF WORK DONE AND RESULTS OBTAINED

4818' - Total Depth - Anhydrite & Lime. Ran Temperature Survey - Found top of cement 2305' behind 8-5/8" Csg. Actual fill 2513' - Ratio of actual to calculated fill 35.2%. Ran Bit & Found top of cement plug at 4732' - Tested csg. with 1200# for 1/2 hour - satisfactory. Drilled out cement plug and tested csg. with 1200# for 1/2 hour - satisfactory. Started drilling 7-7/8" hole at 4:00 P.M. 12-3-49.

Witnessed by C.E. Nichols Amerada Petroleum Corporation Perm Boss
Name Company Title

Subscribed and sworn before me this
3rd day of December 1949

[Signature]
Notary Public

I hereby swear or affirm that the information given above is true and correct.

Name [Signature]

Position Assistant District Superintendent

Representing Amerada Petroleum Corporation
Company or Operator

My commission expires 10-24-53

Address Drawer B, Monument, New Mexico

Remarks:

APPROVED

Date 12-14-1949

[Signature]
Name
OIL & GAS INSPECTOR
Title

DUPLICATE

OIL CONSERVATION COMMISSION

Santa Fe, New Mexico

MISCELLANEOUS REPORTS ON WELLS

Submit this report in triplicate to the Oil Conservation Commission or its proper agent within ten days after the work specified is completed. It should be signed and sworn to before a notary public for reports on beginning drilling operations, results of shooting well, results of test of casing shut off, result of plugging of well, and other important operations, even though the work was witnessed by an agent of the Commission. Reports on minor operations need not be signed and sworn to before a notary public. See additional instructions in the Rules and Regulations of the Commission.

Indicate nature of report by checking below.

REPORT ON BEGINNING DRILLING OPERATIONS		REPORT ON REPAIRING WELL	
REPORT ON RESULT OF SHOOTING OR CHEMICAL TREATMENT OF WELL		REPORT ON PULLING OR OTHERWISE ALTERING CASING	
REPORT ON RESULT OF TEST OF CASING SHUT-OFF		REPORT ON DEEPENING WELL	
REPORT ON RESULT OF PLUGGING OF WELL		REPORT ON SETTING CASING	X

November 18, 1949

Monument, New Mexico

Date

Place

OIL CONSERVATION COMMISSION,
SANTA FE, NEW MEXICO
Gentlemen:

Following is a report on the work done and the results obtained under the heading noted above at the _____
Amerada Petroleum Corporation **Rose Haves "A"** Well No. **1** in the

C/NW/4 NE/4 Company or Operator **2** Lease **17-S**, R. **34-E**, N. M. P. M.,
Knowles Field, **La** County.

The dates of this work were as follows: **November 17, 1949**

Notice of intention to do the work was (~~submitted~~) submitted on Form C-102 on **November 17,** 19 **49**
and approval of the proposed plan was (~~submitted~~) obtained. (Cross out incorrect words.)

DETAILED ACCOUNT OF WORK DONE AND RESULTS OBTAINED

279' - Total Depth - Red Bed. Ran 6 Jts. of 13-3/8" O.D., 54.5#, 8-Bd. Thd., Grade J-55, Range 3, S. S. New Casing and set at 274' and cemented with 200 sacks of El Toro Common & 50 sacks Line Star Incon Cement. Plug to 254' at 8:30 P.M., 11-17-49. Maximum pump pressure 400#. Cement circulated.

Witnessed by **C. E. Nichols** **Amerada Petroleum Corporation** **Farm Boss**
Name Company Title

Subscribed and sworn before me this
18th day of **November** 19 **49**

[Signature]
Notary Public

I hereby swear or affirm that the information given above is true and correct.

Name *[Signature]*

Position **Assistant District Superintendent**

Representing **Amerada Petroleum Corporation**
Company or Operator

My commission expires **10/24/53**

Address **Drawer D, Monument, New Mexico**

Remarks:

[Signature]
Name
Title

XIV

AFFIDAVIT OF PUBLICATION

State of New Mexico,
County of Lea.

NOV 04 2004

I, KATHI BEARDEN

Publisher

of the Hobbs News-Sun, a
newspaper published at
Hobbs, New Mexico, do solemnly
swear that the clipping attached
hereto was published once a
week in the regular and entire
issue of said paper, and not a
supplement thereof for a period.

of 1

 weeks.

Beginning with the issue dated

October 31 2004

and ending with the issue dated

October 31 2004

Kathi Bearden

Publisher

Sworn and subscribed to before

me this 31st day of

October 2004

Donna Stowers
Notary Public.

My Commission expires
November 27, 2004
(Seal)

LEGAL NOTICE
October 31, 2004

Platinum Exploration, Inc. 550 W. Texas, Suite 500, Midland, TX 79701 is filing form C108 (Application for Authorization to Inject) with the New Mexico Oil Conservation Division seeking administrative approval for a salt water disposal well. The proposed well, Rose Eaves #2 is located 660' FSL & 660' FEL of Sec. 35, T168, R38E of Lea County, New Mexico. Produced Devonian water will be disposed into the Grayburg, San Andres, Glorieta and Clearfork formations at a depth of 4810' - 7800' with a maximum pressure of 1,200 psi and a maximum rate of 15,000 BWP. Any interested party who has an objection to this application must give notice to the Oil Conservation Division, 1220 South Saint Francis Street, Santa Fe, New Mexico 87505, within fifteen (15) days of this notice. Additional information can be obtained by contacting Dorothea Logan at (432)687-1664.
#21065

This newspaper is duly qualified to publish legal notices or advertisements within the meaning of Section 3, Chapter 167, Laws of 1937, and payment of fees for said publication has been made.

67100868000 02573130
Platinum Exploration, Inc.,
550 W. Texas, Suite 200
MIDLAND, TX 79701

REEF
 CHEMICAL

DEVONIAN WATER

Unit P, Sec 12, T17S, R38E
660 FSL, 660 FEL
30-025-07299Company: Platinum Exploration
Number: 5386
Source: Wellhead
Salesman: Skeet RaybonLocation:
Attention:
Date Sampled: August 9, 2004
Date of Analysis: August 9, 2004

Cone #1

ANALYSIS

mg/L

EQ. WT.

MEQ/L

ANALYSIS	mg/L	EQ. WT.	MEQ/L
1. pH	6.73		
2. Specific Gravity 60/60 f.	1.028		
3. Hydrogen Sulfide	70 PPM		
4. Carbon Dioxide	0.0 PPM		
5. Dissolved Oxygen	Not Determined		
6. Hydroxyl (OH-)	0 /	17.0 =	0.00
7. Carbonate (CO3=)	0 /	30.0 =	0.00
8. Bicarbonate (HCO3-)	611 /	61.1 =	10.00
9. Chloride (Cl-)	20,995 /	35.5 =	591.41
10. Sulfate (SO4=)	2,262 /	48.8 =	46.35
11. Calcium (CA++)	2,806 /	20.1 =	139.60
12. Magnesium (Mg++)	4,620 /	12.2 =	378.69
13. Sodium (Na+)	2,978 /	23.0 =	129.47
14. Barium (Ba++)	5.00		
15. Total Iron (Fe)	1.50		
16. Dissolved Solids	34,272		
17. Filterable Solids	0.00		
18. Total Solids	34,272		
19. Total Hardness As CaCO3	26,023		
20. Suspended Oil	0.0000		
21. Volume Filtered (ml)	0		
22. Resistivity @ 75 F. (calculated)	0.2120 /cm.		

23. CAC03 Saturation Index

@80 F.	0.1667
@100 F.	0.5067
@120 F.	0.7567
@140 F.	1.1067
@160 F.	1.4267

24. CASO4 Supersaturation Ratio

@70F	0.9478
@90F	0.9433
@110F	0.9457
@130F	0.9539
@150F	0.9751

Ratio Greater than 1 indicates Scale

PROBABLE MINERAL COMPOSITION				
COMPOUND	EQ. WT.	X	MEQ/L	= mg/L
Ca(HCO3)2	81.04		10.00	810
CaSO4	68.07		46.35	3,155
CaCl2	55.50		83.25	4,620
Mg(HCO3)2	73.17		0.00	0
MgSO4	60.19		0.00	0
MgCL2	47.62		378.69	18,033
NaHCO3	84.00		0.00	0
NaSO4	71.03		0.00	0
NaCl	58.46		129.47	7,569

Chemist

Item VII
Closest Compatible Water

FACSIMILE TRANSMISSION

From: Martin Water Laboratories, Inc.
709 W. Indiana
P.O. Box 98
Midland, TX 79702

Date: 10/28/04

Please deliver the following pages to:

Name: Chuck Finley PLATINUM EXPLORATION

These pages are being transmitted from: Greg

Total number of pages including this cover letter: 1

If you do not receive all the pages, please call: NO GRAYBURG + GLOLIETA 13 15 MC. SW.

Office numbers (432) 683-4521 or 683-4524

Fax number (432) 682-8819

Message: Formal report will be mailed.

San Andres - Carter Field

Dev. - S. Knowles

Total Hardness	- 3700 mg/L	5700 mg/L
Calcium	- 1100 "	1960 "
Sulfate	- 2910 "	1546 "
Chloride	- 7102 "	21,306 "
H ₂ S	- 716 "	68 "

SERVICES

Consultation & analytical services in the detection, evaluation & control of water problems involved in primary & secondary recovery of oil, agriculture, domestic, process, & general plant use.

Injection water: Specialists in water quality control surveillance of injection systems

Corrosion & Scale: Special studies for the detection, evaluation, & control in water syst

Water Origin: Evaluate sources of subsurface waters by chemical characteristics.
Extensive computer cataloged records for comparison purposes.

Petroleum: ASTM distillation and hydrogen sulfide.

Ecology: Analytical studies & consultation on agricultural, domestic, process, & other industrial waters.

Permian Treating Chemicals

WATER ANALYSIS REPORT

SAMPLE

Oil Co.: Platinum Exploration
 LeBee: See 35
 Well No.: N/A
 Location: Pre-h Water
 Attention:

Date Sampled: 03-September-2004 Date
 Analyzed: 07-September-2004 Lab 17)
 N/A
 Sep07Q4.002-1
 SJJ&LSPerson:

ANALYSIS

File Name: F:\ANAL YSES\Sep0704,002

1. Ph
 2. Specific Gravity 60/60 F. J.
 CAC03 Saturation Index

7.720
 1.003

(g) 80f
 City 140F

0.586
 1.286

- Disolved Gases
 4. Hydrogen Sulfide 5.
 Carbon Dioxide 6.
 Dissolved Oxygen

MG/L.
 Nor Percent
 Not Determined
 Not Determined

iq; Wt. 11 MEQ/L -

CATIONS

7. Calcium 8. (Ca++)
 Magnesium 9. (Mg++)
 Sodium (Na+) (Calculated)
 10. Barium (Ba++)

130 120.1 = 6.47
 36 12.2 = 2.95
 38J 123.0 = 16.7
 Below 10

ANIONS

11. Hydroxyl (OH+)
 12. Carbonate ((CO3=))
 13. Bicarbonate (HCO3.)
 14. Sulfate (SO4=)
 15. Chloride (Cl-)
 16. Total Dissolved Solids
 17. Total Hardness (Fe)
 18. Total Hardness as CaCO3
 19. Residual Chlorine 75 F. (Calculated)

0 117.0 = 0.00
 0 130.0 = 0.00
 144 161.1 = 3.99
 110 144.4 = 2.15
 700 135.5 = 19.7
 1,60' 160.0 = 72
 7 118.2 = 0.36

475

LOGARITHMIC WATER PATTERN

4.170 Ohm' meter

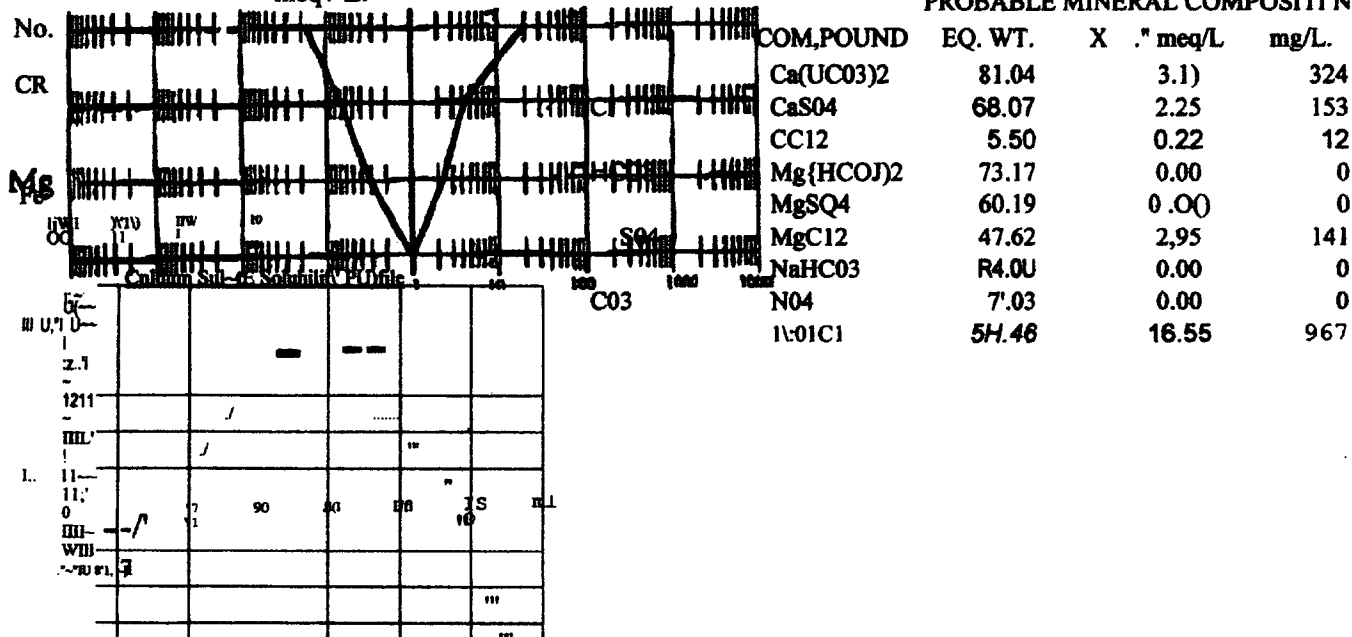
PROBABLE MINERAL COMPOSITION

PLATINUM EXPLORATION INC.
550 WEST TEXAS AVENUE, SUITE 500
MIDLAND, TEXAS 79701
OFFICE (432) 687-1664 • FAX (432) 687-2853

November 8, 2004

Amerada Hess Corporation
2207 W. Industrial Avenue
Midland, TX 79701-7799

RE: Notification to re-enter for Conversion to Saltwater Disposal
Rose Eaves #2, API #30-025-07291, Sec 35, T-16S, R-38E
Lea County, New Mexico

Gentlemen,

Platinum Exploration, Inc. 550 W. Texas, Suite 500, Midland, TX 79701 is filing form C108 (Application for Authorization to Inject) with the New Mexico Oil Conservation Division seeking administrative approval for a salt water disposal well. The proposed well, Rose Eaves #2 is located 660' FSL & 660' FEL of Sec. 35, T16S, R38E of Lea County, New Mexico. Produced Devonian water will be disposed into the Grayburg, San Andres, Glorieta and Clearfork formations at a depth of 4810' – 7800' with a maximum pressure of 1,200 psi and a maximum rate of 15,000 BWPD. Any interested party who has an objection to this application must give notice to the Oil Conservation Division, 1220 South Saint Francis Street, Santa Fe, New Mexico 87505, within fifteen (15) days of this notice. Additional information can be obtained by contacting Dorothea Logan at (432) 687-1664.

Sincerely,



Dorothea Logan
Regulatory Analyst
Platinum Exploration, Inc.

PLATINUM EXPLORATION INC.
550 WEST TEXAS AVENUE, SUITE 500
MIDLAND, TEXAS 79701
OFFICE (432) 687-1664 • FAX (432) 687-2853

November 8, 2004

Apache Corporation
Two Warren Place
Suite 1500
6120 South Yale
Tulsa, OK 74136-4224

RE: Notification to re-enter for Conversion to Saltwater Disposal
Rose Eaves #2, API #30-025-07291, Sec 35, T-16S, R-38E
Lea County, New Mexico

Dear Sir/Madam,

Platinum Exploration, Inc. 550 W. Texas, Suite 500, Midland, TX 79701 is filing form C108 (Application for Authorization to Inject) with the New Mexico Oil Conservation Division seeking administrative approval for a salt water disposal well. The proposed well, Rose Eaves #2 is located 660' FSL & 660' FEL of Sec. 35, T16S, R38E of Lea County, New Mexico. Produced Devonian water will be disposed into the Grayburg, San Andres, Glorieta and Clearfork formations at a depth of 4810' – 7800' with a maximum pressure of 1,200 psi and a maximum rate of 15,000 BWPD. Any interested party who has an objection to this application must give notice to the Oil Conservation Division, 1220 South Saint Francis Street, Santa Fe, New Mexico 87505, within fifteen (15) days of this notice. Additional information can be obtained by contacting Dorothea Logan at (432) 687-1664.

Sincerely,



Dorothea Logan
Regulatory Analyst
Platinum Exploration, Inc.

PLATINUM EXPLORATION INC.
550 WEST TEXAS AVENUE, SUITE 500
MIDLAND, TEXAS 79701
OFFICE (432) 687-1664 • FAX (432) 687-2853

November 8, 2004

Valetta Ruth Lawrence Fingado
c/o Larry Parker
P. O. Box 2710
Hobbs, NM 88241

RE: Notification to re-enter for Conversion to Saltwater Disposal
Rose Eaves #2, API #30-025-07291, Sec 35, T-16S, R-38E
Lea County, New Mexico

Dear Madam,

Platinum Exploration, Inc. 550 W. Texas, Suite 500, Midland, TX 79701 is filing form C108 (Application for Authorization to Inject) with the New Mexico Oil Conservation Division seeking administrative approval for a salt water disposal well. The proposed well, Rose Eaves #2 is located 660' FSL & 660' FEL of Sec. 35, T16S, R38E of Lea County, New Mexico. Produced Devonian water will be disposed into the Grayburg, San Andres, Glorieta and Clearfork formations at a depth of 4810' – 7800' with a maximum pressure of 1,200 psi and a maximum rate of 15,000 BWPD. Any interested party who has an objection to this application must give notice to the Oil Conservation Division, 1220 South Saint Francis Street, Santa Fe, New Mexico 87505, within fifteen (15) days of this notice. Additional information can be obtained by contacting Dorothea Logan at (432) 687-1664.

Sincerely,

Dorothea Logan
Regulatory Analyst
Platinum Exploration, Inc.

7004 0750 0000 6937 0024

U.S. Postal Service™	
CERTIFIED MAIL™ RECEIPT	
(Domestic Mail Only; No Insurance Coverage Provided)	
For delivery information visit our website at www.usps.com	
OFFICIAL USE	
Postage	\$.37
Certified Fee	2.30
Return Receipt Fee (Endorsement Required)	1.75
Restricted Delivery Fee (Endorsement Required)	
Total Postage & Fees	\$ 4.42
Postmark Here	
Sent To Valetta Ruth Lawrence Fingado Street, Apt. No., or PO Box No. /o Larry Parker City, State, ZIP+4® P. O. Box 2709 Hobbs, NM 88241	
PS Form 3800, Instructions	

7004 0750 0000 6937 0062

U.S. Postal Service™	
CERTIFIED MAIL™ RECEIPT	
(Domestic Mail Only; No Insurance Coverage Provided)	
For delivery information visit our website at www.usps.com	
OFFICIAL USE	
Postage	\$.37
Certified Fee	2.30
Return Receipt Fee (Endorsement Required)	1.75
Restricted Delivery Fee (Endorsement Required)	
Total Postage & Fees	\$ 4.42
Postmark Here	
Sent To Amerada Hess Corporation Street, Apt. No., or PO Box No. 2207 W. Industrial Ave. City, State, ZIP+4® Midland, TX 79701-7799	
PS Form 3800, Instructions	

7004 0750 0000 6937 0079

U.S. Postal Service™	
CERTIFIED MAIL™ RECEIPT	
(Domestic Mail Only; No Insurance Coverage Provided)	
For delivery information visit our website at www.usps.com	
OFFICIAL USE	
Postage	\$.37
Certified Fee	2.30
Return Receipt Fee (Endorsement Required)	1.75
Restricted Delivery Fee (Endorsement Required)	
Total Postage & Fees	\$ 4.42
Postmark Here	
Sent To Apache Corporation Street, Apt. No., or PO Box No. Two Warren Place City, State, ZIP+4® Suite 1500 6120 South Yale Tulsa, OK 74136-4224	
PS Form 3800, Instructions	