

NSP 1/31/00

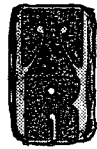

TITAN RESOURCES I, INC.

January 6, 2000

Mr. Michael Stogner
New Mexico Oil Conservation Division
2040 South Pacheco
Santa Fe, New Mexico 87505

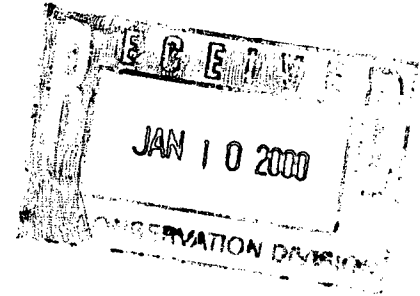

RE: Brunson Argo 17
Bliebry (formerly Tubb)
Section 10, T-22S, R-37E
Lea County, New Mexico

Dear Mr. Stogner:

Please consider this our request for administrative approval for a non-standard location of the subject well in the Bliebry Field, to be made effective January, 1998.

Attached please find a list of all offset operators including complete postal address for each, and corresponding cards certifying receipt of notification of this application by each offset operator.

Also attached are forms C101 and C102 for the referenced request.

Thank you for your prompt consideration.

Sincerely,

Laura Clepper
Regulatory Analyst

/lc

attachments

District I
PO Box 1980, Hobbs, NM 88241-1980

District II
811 South First, Artesia, NM 88210

District III
1000 Rio Brazos Rd., Aztec, NM 87410

District IV
2040 South Pacheco, Santa Fe, NM 87505

State of New Mexico
Energy, Minerals & Natural Resources Department

OIL CONSERVATION DIVISION
2040 South Pacheco
Santa Fe, NM 87505

Form C-101
Revised October 18, 1994
Instructions on back
Submit to Appropriate District Office
State Lease - 6 Copies
Fee Lease - 5 Copies

☐ AMENDED REPORT

APPLICATION FOR PERMIT TO DRILL, RE-ENTER, DEEPEN, PLUGBACK, OR ADD A ZONE

¹ Operator Name and Address TITAN RESOURCES I, INC. 500 W. TEXAS, STE 500 MIDLAND, TEXAS 79701		² GRID Number 150661
		³ API Number 30 - 02510178
⁴ Property Code 020000	⁵ Property Name BRUNSON-ARGO	⁶ Well No. 17

Surface Location

UL or lot no.	Section	Township	Range	Lot Idn	Feet from the	North/South line	Feet from the	East/West Line	County
D	10	22S	37E		589	NORTH	731	WEST	LEA

Proposed Bottom Hole Location If Different From Surface

UL or lot no.	Section	Township	Range	Lot Idn	Feet from the	North/South line	Feet from the	East/West Line	County
⁹ Proposed Pool 1 72480 BLINEBRY OIL AND GAS					¹⁰ Proposed Pool 2				

¹¹ Work Type Code P	¹² Well Type Code G	¹³ Cable/Rotary	¹⁴ Lease Type Code P	¹⁵ Ground Level Elevation 3425
¹⁶ Multiple No	¹⁷ Proposed Depth 5830	¹⁸ Formation BLINEBRY	¹⁹ Contractor NA	²⁰ Spud Date

Proposed Casing and Cement Program

Hole Size	Casing Size	Casing weight/foot	Setting Depth	Sacks of Cement	Estimated TOC
17 1/4	13 3/8	48	312	300	SURFACE
11	8 5/8	32	2860	1500	555' (TEMP SURVEY)
7 7/8	5 1/2	17	6575	800	3115' (TEMP SURVEY)

²²Describe the proposed program. If this application is to DEEPEN or PLUG BACK give the data on the present productive zone and proposed new productive zone. Describe the blowout prevention program, if any. Use additional sheets if necessary.

PRESENT PRODUCING ZONE: TUBB; PERFS @ 5868'-6209'

PROPOSED NEW ZONE: BLINEBRY - 5456'-5776'

1. SET CIBP AT 5830' AND CAP W/ 30' CLASS "C" CMT
2. PERFORATE BLINEBRY 5456'-5776'
3. ACIDIZE & FRAC AS NECESSARY
4. PUT ON PUMP

BOP EQUIPMENT: DUAL RAM, 3000 PSI WP.

NOTE: ACRAGE SIMULTANEOUSLY DEDICATED TO WELLS NO. 6, 17 AND 18.

²³I hereby certify that the information given above is true and complete to the best of my knowledge and belief.

Signature:

Laura Clepper

Printed name: Laura Clepper

Title: Regulatory Analyst

Date: 12-06-99

Phone: 915/498-8662

OIL CONSERVATION DIVISION

Approved By:

Title:

Approval Date:

Expiration Date:

Conditions of Approval:
Attached: ☐

District I
PO Box 1980, Hobbs, NM 88241-1980

District II
811 South First, Artesia, NM 88210

District III
1000 Rio Brazos Rd., Aztec, NM 87410

District IV
2040 South Pacheco, Santa Fe, NM 87505

State of New Mexico
Energy, Minerals & Natural Resources Department

OIL CONSERVATION DIVISION
2040 South Pacheco
Santa Fe, NM 87505

Form C-102
Revised October 18, 1994

Instructions on back
Submit to Appropriate District Office
State Lease - 4 Copies
Fee Lease - 3 Copies

☐ AMENDED REPORT

WELL LOCATION AND ACREAGE DEDICATION PLAT

¹ API Number NA	² Pool Code 72480	³ Pool Name BLINEBRY OIL AND GAS
⁴ Property Code 020000	⁵ Property Name BRUNSON-ARGO	⁶ Well Number 6
⁷ GRID No. 150661	⁸ Operator Name TITAN RESOURCES I, INC.	⁹ Elevation 3464

¹⁰Surface Location

UL or lot no. E	Section 10	Township 22S	Range 37E	Lot Idn	Feet from the 1980	North/South line NORTH	Feet from the 660	East/West Line WEST	County LEA
--------------------	---------------	-----------------	--------------	---------	-----------------------	---------------------------	----------------------	------------------------	---------------

¹¹Bottom Hole Location If Different From Surface

UL or lot no.	Section	Township	Range	Lot Idn	Feet from the	North/South line	Feet from the	East/West Line	County
¹² Dedicated Acres 160.00	¹³ Joint or Infill N	¹⁴ Consolidation Code	¹⁵ Order No.						

NO ALLOWABLE WILL BE ASSIGNED TO THIS COMPLETION UNTIL ALL INTERESTS HAVE BEEN CONSOLIDATED
OR A NON-STANDARD UNIT HAS BEEN APPROVED BY THE DIVISION

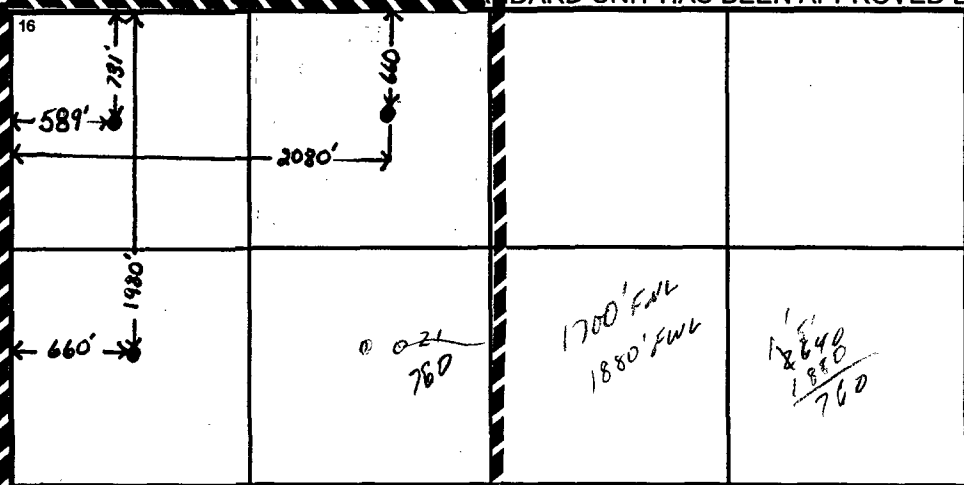
¹⁶ 	<p>¹⁷ OPERATOR CERTIFICATION</p> <p>I hereby certify that the information contained herein is true and complete to the best of my knowledge and belief</p> <p><i>Laura Clepper</i> Signature Laura Clepper Printed Name Regulatory Analyst Title 12-6-99 Date</p>
---	--

NOTE: 160 AC SIMULTANEOUSLY
DEDICATED TO WELLS NO. 6, 17, 18

<p>¹⁸SURVEYOR CERTIFICATION</p> <p>I hereby certify that the well location shown on this plat was plotted from field notes of actual surveys made by me or under my supervision, and that the same is true and correct to the best of my belief.</p> <p>Date of Survey</p> <p>Signature and Seal of Professional Surveyer:</p> <p>Certificate Number</p>

District I
PO Box 1980, Hobbs, NM 88241-1980

District II
811 South First, Artesia, NM 88210

District III
1000 Rio Brazos Rd., Aztec, NM 87410

District IV
2040 South Pacheco, Santa Fe, NM 87505

State of New Mexico
Energy, Minerals & Natural Resources Department

OIL CONSERVATION DIVISION
2040 South Pacheco
Santa Fe, NM 87505

Form C-102
Revised October 18, 1994
Instructions on back
Submit to Appropriate District Office
State Lease - 4 Copies
Fee Lease - 3 Copies

☐ AMENDED REPORT

WELL LOCATION AND ACREAGE DEDICATION PLAT

1 API Number 30-025-10179	2 Pool Code 72480	3 Pool Name BLINEBRY OIL AND GAS
4 Property Code 020000	5 Property Name BRUNSON-ARGO	6 Well Number 18
7 OGRID No. 150661	8 Operator Name TITAN RESOURCES I, INC.	9 Elevation 3427

10 Surface Location

UL or lot no. C	Section 10	Township 22S	Range 37E	Lot Idn	Feet from the 660	North/South line NORTH	Feet from the 2080	East/West Line WEST	County LEA
--------------------	---------------	-----------------	--------------	---------	----------------------	---------------------------	-----------------------	------------------------	---------------

11 Bottom Hole Location If Different From Surface

UL or lot no.	Section	Township	Range	Lot Idn	Feet from the	North/South line	Feet from the	East/West Line	County
12 Dedicated Acres 160.00	13 Joint or Infill N	14 Consolidation Code	15 Order No.						

NO ALLOWABLE WILL BE ASSIGNED TO THIS COMPLETION UNTIL ALL INTERESTS HAVE BEEN CONSOLIDATED
OR A NON-STANDARD UNIT HAS BEEN APPROVED BY THE DIVISION

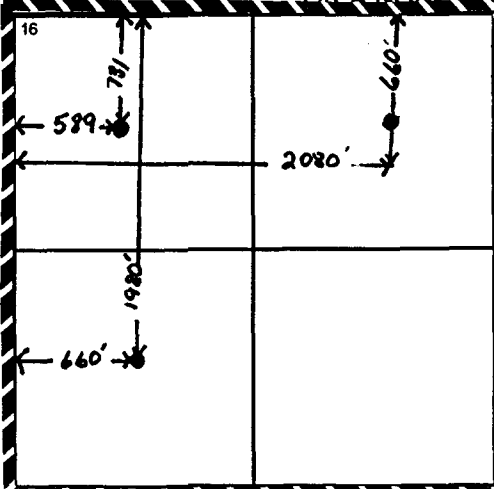
16		17 OPERATOR CERTIFICATION I hereby certify that the information contained herein is true and complete to the best of my knowledge and belief Signature <u>Laura Clepper</u> Printed Name <u>Laura Clepper</u> Title <u>Regulatory Analyst</u> Date <u>12-6-99</u>
	NOTE: 160 AC SIMULTANEOUSLY DEDICATED TO WELLS 6, 17, 18	18 SURVEYOR CERTIFICATION I hereby certify that the well location shown on this plat was plotted from field notes of actual surveys made by me or under my supervision, and that the same is true and correct to the best of my belief. Date of Survey Signature and Seal of Professional Surveyer: Certificate Number

District I
PO Box 1980, Hobbs, NM 88241-1980

District II
811 South First, Artesia, NM 88210

District III
1000 Rio Brazos Rd., Aztec, NM 87410

District IV
2040 South Pacheco, Santa Fe, NM 87505

State of New Mexico
Energy, Minerals & Natural Resources Department

OIL CONSERVATION DIVISION
2040 South Pacheco
Santa Fe, NM 87505

Form C-102
Revised October 18, 1994
Instructions on back
Submit to Appropriate District Office
State Lease - 4 Copies
Fee Lease - 3 Copies

☐ AMENDED REPORT

WELL LOCATION AND ACREAGE DEDICATION PLAT

1 API Number 30-025-10178	2 Pool Code 72480	3 Pool Name BLINEBRY OIL AND GAS
4 Property Code 020000	5 Property Name BRUNSON-ARGO	6 Well Number 17
7 OGRID No. 150661	8 Operator Name TITAN RESOURCES I, INC.	9 Elevation 3425

10 Surface Location

UL or lot no. D	Section 10	Township 22S	Range 37E	Lot Idn	Feet from the 589	North/South line NORTH	Feet from the 731	East/West Line WEST	County LEA
--------------------	---------------	-----------------	--------------	---------	----------------------	---------------------------	----------------------	------------------------	---------------

11 Bottom Hole Location If Different From Surface

UL or lot no.	Section	Township	Range	Lot Idn	Feet from the	North/South line	Feet from the	East/West Line	County
12 Dedicated Acres 160.00	13 Joint or Infill N	14 Consolidation Code	15 Order No.						

NO ALLOWABLE WILL BE ASSIGNED TO THIS COMPLETION UNTIL ALL INTERESTS HAVE BEEN CONSOLIDATED
OR A NON STANDARD UNIT HAS BEEN APPROVED BY THE DIVISION

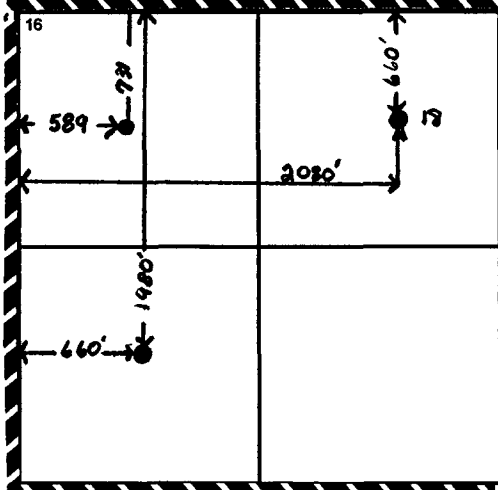

17 OPERATOR CERTIFICATION

I hereby certify that the information contained herein is true and complete to the best of my knowledge and belief

Laura Clepper
Signature
Laura Clepper
Printed Name
Regulatory Analyst
Title
12-6-99
Date

18 SURVEYOR CERTIFICATION

I hereby certify that the well location shown on this plat was plotted from field notes of actual surveys made by me or under my supervision, and that the same is true and correct to the best of my belief.

Date of Survey
Signature and Seal of Professional Surveyer:

Certificate Number

NOTE: 160 AC SIMULTANEOUSLY
DEDICATED TO WELLS No 6, 17 & 18

Is your RETURN ADDRESS completed on the reverse side?

SENDER:

- Complete items 1 and/or 2 for additional services.
- Complete items 3, 4a, and 4b.
- Print your name and address on the reverse of this form so that we can return this card to you.
- Attach this form to the front of the mailpiece, or on the back if space does not permit.
- Write "Return Receipt Requested" on the mailpiece below the article number.
- The Return Receipt will show to whom the article was delivered and the date delivered.

I also wish to receive the following services (for an extra fee):

- 1. ☐ Addressee's Address
- 2. ☐ Restricted Delivery

Consult postmaster for fee.

3. Article Addressed to:

ANADARKO PETROLEUM CORP.
P. O. BOX 2497
MIDLAND, TEXAS 79702-2497

4a. Article Number

Z 208 695 034

4b. Service Type

- ☐ Registered ☒ Certified
- ☐ Express Mail ☐ Insured
- ☐ Return Receipt for Merchandise ☐ COD

7. Date of Delivery

DEC 13 1999

5. Received By: (Print Name)

8. Addressee's Address (Only if requested and fee is paid)

6. Signature: (Addressee or Agent)

[Signature]

PS Form 3811, December 1994

102595-98-B-0229

Domestic Return Receipt

Thank you for using Return Receipt Service.

Is your RETURN ADDRESS completed on the reverse side?

SENDER:

- Complete items 1 and/or 2 for additional services.
- Complete items 3, 4a, and 4b.
- Print your name and address on the reverse of this form so that we can return this card to you.
- Attach this form to the front of the mailpiece, or on the back if space does not permit.
- Write "Return Receipt Requested" on the mailpiece below the article number.
- The Return Receipt will show to whom the article was delivered and the date delivered.

I also wish to receive the following services (for an extra fee):

- 1. ☐ Addressee's Address
- 2. ☐ Restricted Delivery

Consult postmaster for fee.

3. Article Addressed to:

APACHE CORP.
ONE POST OAK CENTRAL
2000 POST OAK BLVD., STE 100
HOUSTON, TEXAS 77056-4400

4a. Article Number

Z 208 695 035

4b. Service Type

- ☐ Registered ☒ Certified
- ☐ Express Mail ☐ Insured
- ☐ Return Receipt for Merchandise ☐ COD

7. Date of Delivery

12/13/99

5. Received By: (Print Name)

8. Addressee's Address (Only if requested and fee is paid)

6. Signature: (Addressee or Agent)

[Signature]

PS Form 3811, December 1994

102595-98-B-0229

Domestic Return Receipt

Thank you for using Return Receipt Service.

Is your RETURN ADDRESS completed on the reverse side?

SENDER:

- Complete items 1 and/or 2 for additional services.
- Complete items 3, 4a, and 4b.
- Print your name and address on the reverse of this form so that we can return this card to you.
- Attach this form to the front of the mailpiece, or on the back if space does not permit.
- Write "Return Receipt Requested" on the mailpiece below the article number.
- The Return Receipt will show to whom the article was delivered and the date delivered.

I also wish to receive the following services (for an extra fee):

- 1. ☐ Addressee's Address
- 2. ☐ Restricted Delivery

Consult postmaster for fee.

3. Article Addressed to:

ARCH PETROLEUM INC.
P. O. BOX 10340
MIDLAND, TEXAS 79702-7340

4a. Article Number

Z 208 695 036

4b. Service Type

- ☐ Registered ☒ Certified
- ☐ Express Mail ☐ Insured
- ☐ Return Receipt for Merchandise ☐ COD

7. Date of Delivery

DEC 13 1999

5. Received By: (Print Name)

8. Addressee's Address (Only if requested and fee is paid)

6. Signature: (Addressee or Agent)

[Signature]

PS Form 3811, December 1994

102595-98-B-0229

Domestic Return Receipt

Thank you for using Return Receipt Service.

Is your RETURN ADDRESS completed on the reverse side?

SENDER:

- Complete items 1 and/or 2 for additional services.
- Complete items 3, 4a, and 4b.
- Print your name and address on the reverse of this form so that we can return this card to you.
- Attach this form to the front of the mailpiece, or on the back if space does not permit.
- Write "Return Receipt Requested" on the mailpiece below the article number.
- The Return Receipt will show to whom the article was delivered and the date delivered.

I also wish to receive the following services (for an extra fee):

- 1. ☐ Addressee's Address
- 2. ☐ Restricted Delivery

Consult postmaster for fee.

3. Article Addressed to:

BEC CORP.
P. O. BOX 1392
MIDLAND, TEXAS 79702-1392

4a. Article Number

E 208 695 037

4b. Service Type

- ☐ Registered ☒ Certified
- ☐ Express Mail ☐ Insured
- ☐ Return Receipt for Merchandise ☐ COD

7. Date of Delivery

8. Addressee's Address (Only if requested and fee is paid)

5. Received By: (Print Name)

6. Signature: (Addressee or Agent)

X Norma Rute

PS Form 3811, December 1994

102595-98-B-0229

Domestic Return Receipt

Thank you for using Return Receipt Service.

Is your RETURN ADDRESS completed on the reverse side?

SENDER:

- Complete items 1 and/or 2 for additional services.
- Complete items 3, 4a, and 4b.
- Print your name and address on the reverse of this form so that we can return this card to you.
- Attach this form to the front of the mailpiece, or on the back if space does not permit.
- Write "Return Receipt Requested" on the mailpiece below the article number.
- The Return Receipt will show to whom the article was delivered and the date delivered.

I also wish to receive the following services (for an extra fee):

- 1. ☐ Addressee's Address
- 2. ☐ Restricted Delivery

Consult postmaster for fee.

3. Article Addressed to:

CHEVRON U S A INC.
P. O. BOX J SECTION 975R
CONCORD, CALIFORNIA 94524

4a. Article Number

E 208 695 038

4b. Service Type

- ☐ Registered ☒ Certified
- ☐ Express Mail ☐ Insured
- ☐ Return Receipt for Merchandise ☐ COD

7. Date of Delivery

5. Received By: (Print Name)

6. Signature: (Addressee or Agent)

X [Signature]

PS Form 3811, December 1994

102595-98-B-0229

Domestic Return Receipt

Thank you for using Return Receipt Service.

Is your RETURN ADDRESS completed on the reverse side?

SENDER:

- Complete items 1 and/or 2 for additional services.
- Complete items 3, 4a, and 4b.
- Print your name and address on the reverse of this form so that we can return this card to you.
- Attach this form to the front of the mailpiece, or on the back if space does not permit.
- Write "Return Receipt Requested" on the mailpiece below the article number.
- The Return Receipt will show to whom the article was delivered and the date delivered.

I also wish to receive the following services (for an extra fee):

- 1. ☐ Addressee's Address
- 2. ☐ Restricted Delivery

Consult postmaster for fee.

3. Article Addressed to:

COLLINS & WARE INC.
508 W. WALL, STE. 1200
MIDLAND, TEXAS 79701

4a. Article Number

E 208 695 039

4b. Service Type

- ☐ Registered ☒ Certified
- ☐ Express Mail ☐ Insured
- ☐ Return Receipt for Merchandise ☐ COD

7. Date of Delivery

12-13-99

5. Received By: (Print Name)

6. Signature: (Addressee or Agent)

X [Signature]

PS Form 3811, December 1994

102595-98-B-0229

Domestic Return Receipt

Thank you for using Return Receipt Service.

Is your RETURN ADDRESS completed on the reverse side?

SENDER:

- Complete items 1 and/or 2 for additional services.
- Complete items 3, 4a, and 4b.
- Print your name and address on the reverse of this form so that we can return this card to you.
- Attach this form to the front of the mailpiece, or on the back if space does not permit.
- Write "Return Receipt Requested" on the mailpiece below the article number.
- The Return Receipt will show to whom the article was delivered and the date delivered.

I also wish to receive the following services (for an extra fee):

- 1. ☐ Addressee's Address
- 2. ☐ Restricted Delivery

Consult postmaster for fee.

3. Article Addressed to:

CONOCO, INC.
10 DESTA DRIVE WEST
MIDLAND, TEXAS 79705

4a. Article Number

Z 208 695 040

4b. Service Type

- ☐ Registered ☒ Certified
- ☐ Express Mail ☐ Insured
- ☐ Return Receipt for Merchandise ☐ COD

7. Date of Delivery

12/13

5. Received By: (Print Name)

Shanna Williams

8. Addressee's Address (Only if requested and fee is paid)

6. Signature: (Addressee or Agent)

X

PS Form 3811, December 1994

102595-98-B-0229

Domestic Return Receipt

Thank you for using Return Receipt Service.

SENDER: COMPLETE THIS SECTION

- Complete items 1, 2, and 3. Also complete item 4 if Restricted Delivery is desired.
- Print your name and address on the reverse so that we can return the card to you.
- Attach this card to the back of the mailpiece, or on the front if space permits.

1. Article Addressed to:

CROSS TIMBERS OPERATING CO.
3000 N. GARFIELD, STE. 175
MIDLAND, TEXAS 79705

COMPLETE THIS SECTION ON DELIVERY

A. Received by (Please Print Clearly)

B. Date of Delivery

12-13-99

C. Signature

X Bennie Henderson

- ☐ Agent
- ☐ Addressee

D. Is delivery address different from item 1?

☐ Yes

If YES, enter delivery address below:

☐ No

3. Service Type

- ☒ Certified Mail ☐ Express Mail
- ☐ Registered ☐ Return Receipt for Merchandise
- ☐ Insured Mail ☐ C.O.D.

4. Restricted Delivery? (Extra Fee)

☐ Yes

2. Article Number (Copy from service label)

Z 208 695 041

PS Form 3811, July 1999

Domestic Return Receipt

102595-99-M-1789

SENDER: COMPLETE THIS SECTION

- Complete items 1, 2, and 3. Also complete item 4 if Restricted Delivery is desired.
- Print your name and address on the reverse so that we can return the card to you.
- Attach this card to the back of the mailpiece, or on the front if space permits.

1. Article Addressed to:

DYNEGY MIDSTREAM SERVICES LTD. PT
6 DESTA DR., STE. 3300
MIDLAND, TEXAS 79705

COMPLETE THIS SECTION ON DELIVERY

A. Received by (Please Print Clearly)

B. Date of Delivery

12/13

C. Signature

X J. H. Leeson

- ☐ Agent
- ☐ Addressee

D. Is delivery address different from item 1?

☐ Yes

If YES, enter delivery address below:

☐ No

3. Service Type

- ☒ Certified Mail ☐ Express Mail
- ☐ Registered ☐ Return Receipt for Merchandise
- ☐ Insured Mail ☐ C.O.D.

4. Restricted Delivery? (Extra Fee)

☐ Yes

2. Article Number (Copy from service label)

Z 208 695 042

PS Form 3811, July 1999

Domestic Return Receipt

102595-99-M-1789

SENDER: COMPLETE THIS SECTION

- Complete items 1, 2, and 3. Also complete item 4 if Restricted Delivery is desired.
- Print your name and address on the reverse so that we can return the card to you.
- Attach this card to the back of the mailpiece, or on the front if space permits.

1. Article Addressed to:

EXXON CORP.
P. O. BOX 4496
HOUSTON, TEXAS 77210-4496

COMPLETE THIS SECTION ON DELIVERY

A. Received by (Please Print Clearly) B. Date of Delivery

C. Signature

X

GEE

DEC 18 1999

☐ Agent
☐ Addressee

D. Is delivery address different from item 1? ☐ Yes
 If YES, enter delivery address below: ☐ No

3. Service Type

☒ Certified Mail ☐ Express Mail
☐ Registered ☐ Return Receipt for Merchandise
☐ Insured Mail ☐ C.O.D.

4. Restricted Delivery? (Extra Fee) ☐ Yes

2. Article Number (Copy from service label)

Z 208 695 043

PS Form 3811, July 1999

Domestic Return Receipt

102595-99-M-1789

SENDER: COMPLETE THIS SECTION

- Complete items 1, 2, and 3. Also complete item 4 if Restricted Delivery is desired.
- Print your name and address on the reverse so that we can return the card to you.
- Attach this card to the back of the mailpiece, or on the front if space permits.

1. Article Addressed to:

JOHN H. HENDERSON
P. O. BOX 2040
MIDLAND, TEXAS 79702-0040

COMPLETE THIS SECTION ON DELIVERY

A. Received by (Please Print Clearly) B. Date of Delivery

C. Signature

X

J. H. Henderson

☐ Agent
☐ Addressee

D. Is delivery address different from item 1? ☐ Yes
 If YES, enter delivery address below: ☐ No

3. Service Type

☒ Certified Mail ☐ Express Mail
☐ Registered ☐ Return Receipt for Merchandise
☐ Insured Mail ☐ C.O.D.

4. Restricted Delivery? (Extra Fee) ☐ Yes

2. Article Number (Copy from service label)

Z 208 695 044

PS Form 3811, July 1999

Domestic Return Receipt

102595-99-M-1789

SENDER: COMPLETE THIS SECTION

- Complete items 1, 2, and 3. Also complete item 4 if Restricted Delivery is desired.
- Print your name and address on the reverse so that we can return the card to you.
- Attach this card to the back of the mailpiece, or on the front if space permits.

1. Article Addressed to:

LOUIS DREYFUS NATURAL GAS CORP.
14000 QUAIL SPRINGS PKWY, SUITE 600
OKLAHOMA CITY, OKLAHOMA 73134-2600

COMPLETE THIS SECTION ON DELIVERY

A. Received by (Please Print Clearly) B. Date of Delivery

C. Signature

X

J. Pearson

☒ Agent
☐ Addressee

D. Is delivery address different from item 1? ☐ Yes
 If YES, enter delivery address below: ☐ No

3. Service Type

☒ Certified Mail ☐ Express Mail
☐ Registered ☐ Return Receipt for Merchandise
☐ Insured Mail ☐ C.O.D.

4. Restricted Delivery? (Extra Fee) ☐ Yes

2. Article Number (Copy from service label)

Z 208 695 045

PS Form 3811, July 1999

Domestic Return Receipt

102595-99-M-1789

SENDER: COMPLETE THIS SECTION

- Complete items 1, 2, and 3. Also complete item 4 if Restricted Delivery is desired.
- Print your name and address on the reverse so that we can return the card to you.
- Attach this card to the back of the mailpiece, or on the front if space permits.

1. Article Addressed to:

MARATHON OIL CO.
P. O. BOX 552
MIDLAND, TEXAS 79702

2. Article Number (Copy from service label)

Z 208 695 046

PS Form 3811, July 1999

Domestic Return Receipt

102595-99-M-1789

COMPLETE THIS SECTION ON DELIVERY

A. Received by (Please Print Clearly)

B. Date of Delivery

DEC 13 1999

C. Signature

x Rudy L...

☐ Agent☐ Addressee

D. Is delivery address different from item 1?

☐ Yes

If YES, enter delivery address below:

☐ No

3. Service Type

☒ Certified Mail☐ Express Mail☐ Registered☐ Return Receipt for Merchandise☐ Insured Mail☐ C.O.D.

4. Restricted Delivery? (Extra Fee)

☐ Yes

SENDER: COMPLETE THIS SECTION

- Complete items 1, 2, and 3. Also complete item 4 if Restricted Delivery is desired.
- Print your name and address on the reverse so that we can return the card to you.
- Attach this card to the back of the mailpiece, or on the front if space permits.

1. Article Addressed to:

OXY USA INC.
P. O. BOX 50250
MIDLAND, TEXAS 79710

2. Article Number (Copy from service label)

Z 208 695 047

PS Form 3811, July 1999

Domestic Return Receipt

102595-99-M-1789

COMPLETE THIS SECTION ON DELIVERY

A. Received by (Please Print Clearly)

B. Date of Delivery

DEC 13 1999

C. Signature

x Annie L...

☐ Agent☐ Addressee

D. Is delivery address different from item 1?

☐ Yes

If YES, enter delivery address below:

☐ No

3. Service Type

☒ Certified Mail☐ Express Mail☐ Registered☐ Return Receipt for Merchandise☐ Insured Mail☐ C.O.D.

4. Restricted Delivery? (Extra Fee)

☐ Yes

SENDER: COMPLETE THIS SECTION

- Complete items 1, 2, and 3. Also complete item 4 if Restricted Delivery is desired.
- Print your name and address on the reverse so that we can return the card to you.
- Attach this card to the back of the mailpiece, or on the front if space permits.

1. Article Addressed to:

RICE OPERATING CO.
122 W. TAYLOR
HOBBS, NEW MEXICO 88240

2. Article Number (Copy from service label)

Z 208 695 048

PS Form 3811, July 1999

Domestic Return Receipt

102595-99-M-1789

COMPLETE THIS SECTION ON DELIVERY

A. Received by (Please Print Clearly)

B. Date of Delivery

12/13/99

C. Signature

x Begie Sak

☐ Agent☐ Addressee

D. Is delivery address different from item 1?

☐ Yes

If YES, enter delivery address below:

☐ No

3. Service Type

☒ Certified Mail☐ Express Mail☐ Registered☐ Return Receipt for Merchandise☐ Insured Mail☐ C.O.D.

4. Restricted Delivery? (Extra Fee)

☐ Yes

SENDER: COMPLETE THIS SECTION

- Complete items 1, 2, and 3. Also complete item 4 if Restricted Delivery is desired.
- Print your name and address on the reverse so that we can return the card to you.
- Attach this card to the back of the mailpiece, or on the front if space permits.

1. Article Addressed to:

ROBERT L. PARKER TRUST
8 EAST THIRD STREET
TULSA, OKLAHOMA 74103

2. Article Number (Copy from service label)

Z 208 695 049

PS Form 3811, July 1999

Domestic Return Receipt

102595-99-M-1789

COMPLETE THIS SECTION ON DELIVERY

A. Received by (Please Print Clearly)

B. Date of Delivery

12/13/99

C. Signature

X

Heagy Book

☐ Agent☐ Addressee

D. Is delivery address different from item 1?

☐ Yes

If YES, enter delivery address below:

☐ No

3. Service Type

☒ Certified Mail☐ Express Mail☐ Registered☐ Return Receipt for Merchandise☐ Insured Mail☐ C.O.D.

4. Restricted Delivery? (Extra Fee)

☐ Yes

SENDER: COMPLETE THIS SECTION

- Complete items 1, 2, and 3. Also complete item 4 if Restricted Delivery is desired.
- Print your name and address on the reverse so that we can return the card to you.
- Attach this card to the back of the mailpiece, or on the front if space permits.

1. Article Addressed to:

SOUTHWEST ROYALTIES INC.
P. O. BOX 11390
MIDLAND, TEXAS 79702

2. Article Number (Copy from service label)

Z 208 695 050

PS Form 3811, July 1999

Domestic Return Receipt

102595-99-M-1789

COMPLETE THIS SECTION ON DELIVERY

A. Received by (Please Print Clearly)

B. Date of Delivery

12/14/99

C. Signature

X

D. J. Smith

☐ Agent☐ Addressee

D. Is delivery address different from item 1?

☐ Yes

If YES, enter delivery address below:

☐ No

3. Service Type

☒ Certified Mail☐ Express Mail☐ Registered☐ Return Receipt for Merchandise☐ Insured Mail☐ C.O.D.

4. Restricted Delivery? (Extra Fee)

☐ Yes

SENDER: COMPLETE THIS SECTION

- Complete items 1, 2, and 3. Also complete item 4 if Restricted Delivery is desired.
- Print your name and address on the reverse so that we can return the card to you.
- Attach this card to the back of the mailpiece, or on the front if space permits.

1. Article Addressed to:

TEXACO EXPLORATION & PRODUCTION
205 EAST BENDER
HOBBS, NEW MEXICO 88240

2. Article Number (Copy from service label)

Z 208 695 051

PS Form 3811, July 1999

Domestic Return Receipt

102595-99-M-1789

COMPLETE THIS SECTION ON DELIVERY

A. Received by (Please Print Clearly)

B. Date of Delivery

12-13-99

C. Signature

X

John Ayer

☐ Agent☐ Addressee

D. Is delivery address different from item 1?

☐ Yes

If YES, enter delivery address below:

☐ No

3. Service Type

☒ Certified Mail☐ Express Mail☐ Registered☐ Return Receipt for Merchandise☐ Insured Mail☐ C.O.D.

4. Restricted Delivery? (Extra Fee)

☐ Yes

SENDER: COMPLETE THIS SECTION

- Complete items 1, 2, and 3. Also complete item 4 if Restricted Delivery is desired.
- Print your name and address on the reverse so that we can return the card to you.
- Attach this card to the back of the mailpiece, or on the front if space permits.

1. Article Addressed to:

WISER OIL CO.
8115 PRESTON RD., STE. 400
DALLAS, TEXAS 75225

COMPLETE THIS SECTION ON DELIVERY

A. Received by (Please Print Clearly)

B. Date of Delivery
12-14-99

C. Signature

Debra Bridger☐ Agent
☐ AddresseeD. Is delivery address different from item 1?
If YES, enter delivery address below:☐ Yes
☐ No

3. Service Type

☒ Certified Mail ☐ Express Mail
☐ Registered ☐ Return Receipt for Merchandise
☐ Insured Mail ☐ C.O.D.

4. Restricted Delivery? (Extra Fee)

☐ Yes

2. Article Number (Copy from service label)

Z 208 695 052

PS Form 3811, July 1999

Domestic Return Receipt

102595-99-M-1789

SENDER: COMPLETE THIS SECTION

- Complete items 1, 2, and 3. Also complete item 4 if Restricted Delivery is desired.
- Print your name and address on the reverse so that we can return the card to you.
- Attach this card to the back of the mailpiece, or on the front if space permits.

1. Article Addressed to:

ZIA ENERGY INC.
P. O. BOX 2510
HOBBS, NEW MEXICO 88241-2510

COMPLETE THIS SECTION ON DELIVERY

A. Received by (Please Print Clearly)

B. Date of Delivery

12-14-99

C. Signature

x *Maisha Webb*☐ Agent
☐ AddresseeD. Is delivery address different from item 1?
If YES, enter delivery address below:☐ Yes
☐ No

3. Service Type

☒ Certified Mail ☐ Express Mail
☐ Registered ☐ Return Receipt for Merchandise
☐ Insured Mail ☐ C.O.D.

4. Restricted Delivery? (Extra Fee)

☐ Yes

2. Article Number (Copy from service label)

Z 208 695 053

PS Form 3811, July 1999

Domestic Return Receipt

102595-99-M-1789

ANADARKO PETROLEUM CORP.
P. O. BOX 2497
MIDLAND, TEXAS 79702-2497

APACHE CORP.
ONE POST OAK CENTRAL
2000 POST OAK BLVD., STE 100
HOUSTON, TEXAS 77056-4400

ARCH PETROLEUM INC.
P. O. BOX 10340
MIDLAND, TEXAS 79702-7340

BEC CORP.
P. O. BOX 1392
MIDLAND, TEXAS 79702-1392

CHEVRON U S A INC.
P. O. BOX J SECTION 975R
CONCORD, CALIFORNIA 94524

COLLINS & WARE INC.
508 W. WALL, STE. 1200
MIDLAND, TEXAS 79701

CONOCO, INC.
10 DESTA DRIVE WEST
MIDLAND, TEXAS 79705

CROSS TIMBERS OPERATING CO.
3000 N. GARFIELD, STE. 175
MIDLAND, TEXAS 79705

DYNEGY MIDSTREAM SERVICES LTD. PT
6 DESTA DR., STE. 3300
MIDLAND, TEXAS 79705

EXXON CORP.
P. O. BOX 4496
HOUSTON, TEXAS 77210-4496

JOHN H. HENDRIX CORP.
P. O. BOX 3040
MIDLAND, TEXAS 79702-3040

LOUIS DREYFUS NATURAL GAS CORP.
14000 QUAIL SPRINGS PKWY, SUITE 600
OKLAHOMA CITY, OKLAHOMA 73134-2600

MARATHON OIL CO.
P. O. BOX 552
MIDLAND, TEXAS 79702

OXY USA INC.
P. O. BOX 50250
MIDLAND, TEXAS 79710

RICE OPERATING CO.
122 W. TAYLOR
HOBBS, NEW MEXICO 88240

ROBERT L. PARKER TRUST
8 EAST THIRD STREET
TULSA, OKLAHOMA 74103

SOUTHWEST ROYALTIES INC.
P. O. BOX 11390
MIDLAND, TEXAS 79702

TEXACO EXPLORATION & PRODUCTION
205 EAST BENDER
HOBBS, NEW MEXICO 88240

WISER OIL CO.
8115 PRESTON RD., STE. 400
DALLAS, TEXAS 75225

ZIA ENERGY INC.
P. O. BOX 2510
HOBBS, NEW MEXICO 88241-2510