

(SUBMIT IN TRIPLICATE)

UNITED STATES
DEPARTMENT OF THE INTERIOR
GEOLOGICAL SURVEY

Land Office New Mexico
Lease No. 03380
Unit Flarence

SUNDRY NOTICES AND REPORTS ON WELLS

NOTICE OF INTENTION TO DRILL.....	<input checked="" type="checkbox"/>	SUBSEQUENT REPORT OF WATER SHUT-OFF.....	
NOTICE OF INTENTION TO CHANGE PLANS.....		SUBSEQUENT REPORT OF SHOOTING OR ACIDIZING.....	
NOTICE OF INTENTION TO TEST WATER SHUT-OFF.....		SUBSEQUENT REPORT OF ALTERING CASING.....	
NOTICE OF INTENTION TO RE-DRILL OR REPAIR WELL.....		SUBSEQUENT REPORT OF RE-DRILLING OR REPAIR.....	
NOTICE OF INTENTION TO SHOOT OR ACIDIZE.....		SUBSEQUENT REPORT OF ABANDONMENT.....	
NOTICE OF INTENTION TO PULL OR ALTER CASING.....		SUPPLEMENTARY WELL HISTORY.....	
NOTICE OF INTENTION TO ABANDON WELL.....			

(INDICATE ABOVE BY CHECK MARK NATURE OF REPORT, NOTICE, OR OTHER DATA)

Well No. 7-D is located 900 ft. from S line and 1850 ft. from E line of sec. 19
SE Section 19 27S 6W 104N
 (1/4 Sec. and Sec. No.) (Twp.) (Range) (Meridian)
So. Blanco P.C. San Juan New Mexico
 (Field) (County or Subdivision) (State or Territory)

The elevation of the derrick floor above sea level is 6097 ft.

DETAILS OF WORK

(State names of and expected depths to objective sands; show sizes, weights, and lengths of proposed casings; indicate mudding jobs, cementing points, and all other important proposed work)

It is intended to drill a well thru the Pictured Cliff formation using rotary tools and to perforate and water fracture possible producing zones. Estimated Total Depth 2170'.

Casing Program:

9 5/8" at 120' with 125 sacks regular cement circulated to surface.
5 1/2" at 2170' with 75 sacks regular cement, 75 sacks Pozmix.

The SE/4 of Section 19 is dedicated to this well.
 (SE/4) 03380.

I understand that this plan of work must receive approval in writing by the Geological Survey before operations may be commenced.

Company El Paso Natural Gas Company

Address Box 997

Farmington, New Mexico

By J. W. Boyle

Title Petroleum Engineer

NEW MEXICO
OIL CONSERVATION COMMISSION

WELL LOCATION AND OR GAS PRODUCTION PLAT

MAY 4, 1956

EL PASO NATURAL GAS COMPANY

FLORANCE "D"

NM 03380

7

19

27-N

8-W

900

SOUTH

1850

EAST

SAN JUAN

6087

PICTURED CLIFF

SO. BLANCO

160
(1882 PLAT)

Note: All measurements must be taken after being figured on section.

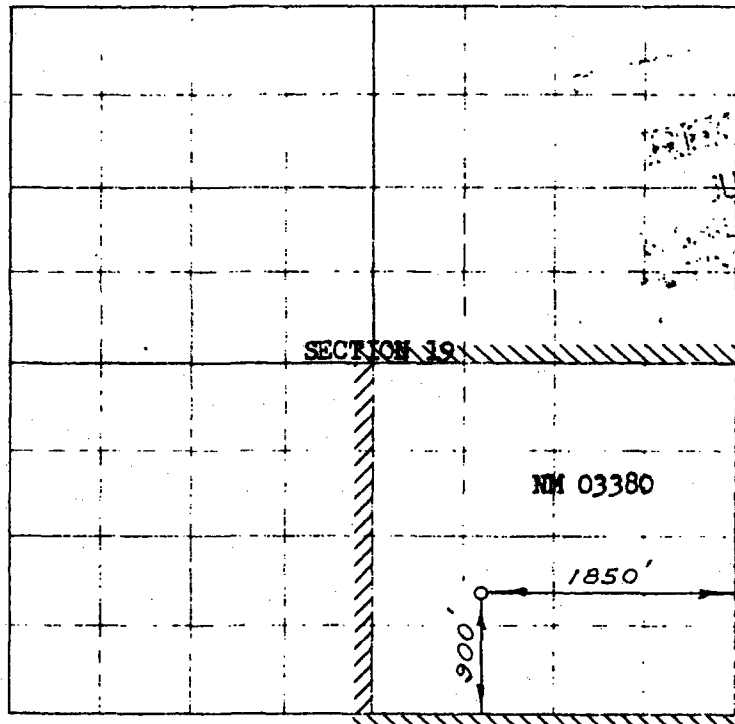

Scale: 1 inch equals 1 mile

NOTE

This section of
form is to be used
for gas wells only

I hereby certify that the above plat was prepared from
field notes of actual surveys made by me or under my
supervision and that the same are true and correct to the
best of my knowledge and belief.

Date Surveyed MAY 2, 1956

B. C. Walker
Registered Professional Engineer and ~~Land~~ Land Surveyor

1. Is this well a Dedic. Comp.

Yes No **X**

2. If the answer to Question 1

is yes, are there any other nearby
completed wells within the
dedicated acreage.

Yes No

Name W. Boyd

Position Petroleum Engineer

representing El Paso Natural Gas Co.

Address Box 997, Farmington, N.M.

(Seal)

Farmington, New Mexico

U. S. LAND OFFICE New Mexico

SERIAL NUMBER 03380

LEASE OR PERMIT TO PROSPECT

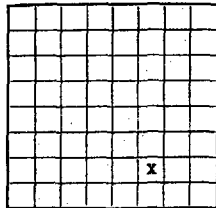

LOCATE WELL CORRECTLY

 UNITED STATES
 DEPARTMENT OF THE INTERIOR
 GEOLOGICAL SURVEY

RECEIVED

JUL 26 1956

U. S. GEOLOGICAL SURVEY
FARMINGTON, NEW MEXICO

LOG OF OIL OR GAS WELL

Company El Paso Natural Gas Company Address Box 997, Farmington, New Mexico
 Lessor or Tract Fluorance Field So. Blanco P.C. State New Mexico
 Well No. 7-D Sec. 19 T. 27N R. 8W Meridian NMPM County San Juan
 Location 900 ft. N. of S Line and 1850 ft. W. of E Line of Section 19 Elevation 6997'
 The information given herewith is a complete and correct record of the well and all work done thereon
 so far as can be determined from all available records.

Date July 24, 1956Signed W. F. Court
Title Petroleum Engineer

The summary on this page is for the condition of the well at above date.

Commenced drilling June 6, 1956 Finished drilling June 10, 1956

OIL OR GAS SANDS OR ZONES

(Denote gas by G)

No. 1, from 2102 to 2170 (G) No. 4, from _____ to _____
 No. 2, from _____ to _____ No. 5, from _____ to _____
 No. 3, from _____ to _____ No. 6, from _____ to _____

IMPORTANT WATER SANDS

No. 1, from _____ to _____ No. 3, from _____ to _____
 No. 2, from _____ to _____ No. 4, from _____ to _____

CASING RECORD

Size casing	Weight per foot	Threads per foot	Make	Spigot	Kind of shoe	Cut and pulled from	Perforated	Purpose
							From	To
9 5/8"	25.44	P. E.	S. V.	122'	None			Surface
5 1/2"	15.50	P. E.	S. V.	122'	None			Surface
1 3/4"	3.20	P. E.	S. V.	122'	None			Surface

MUDDING AND CEMENTING RECORD

Size casing	Where set	Number sacks of cement	Method used	Mud gravity	Amount of mud used
9 5/8"	135'	100	Circulated		
5 1/2"	2205'	150	Single Stage		

PLUGS AND ADAPTERS

Heaving plug—Material _____ Length _____ Depth set _____
 Adapters—Material _____ Size _____

SHOOTING RECORD

Size	Shall used	Explosive used	Quantity	Date	Depth shot	Depth cleaned out
			See Well History			

TOOLS USED

Rotary tools were used from _____ feet to _____ feet, and from _____ feet to _____ feet
 Cable tools were used from _____ feet to _____ feet, and from _____ feet to _____ feet

DATES

_____ 6-24-56 _____, 19____ Put to producing _____, 19____

The production for the first 24 hours was _____ barrels of fluid of which _____ % was oil; _____ % emulsion; _____ % water; and _____ % sediment. Gravity, °Bé. _____

If gas well, cu. ft. per 24 hours 1,008,000 A. D. E. 1022 M. D. 1022 per 1,000 cu. ft. of gas

Rock pressure, lbs. per sq. in. 782

EMPLOYEES

_____, Driller _____, Driller
 _____, Driller _____, Driller

FORMATION RECORD

FROM	TO	TOTAL FEET	FORMATION
0	1130	1130	Ten to 15 cr-grn ss interbedded w/gray sh.
1130	1260	130	Ojo Alamo ss. White cr-grn s.
1260	1872	612	Kirtland form. Gray sh interbedded w/tight gray fine-grn ss.
1872	2102	230	Fruitland form. Gray carb sh, scattered coals and gray, tight, fine-grn ss.
2102	2170	68	Pictured Cliffs form. Gray, fine-grn, tight, varicolored soft ss.
2170	2205	35	Levis formation. Gray to white dense sh v/silty to shaly ss breaks.

1	2	3	4	5	6	7	8	9	10	11	12	13	14	15	16	17	18	19	20	21	22	23	24	25	26	27	28	29	30	31	32	33	34	35	36	37	38	39	40	41	42	43	44	45	46	47	48	49	50	51	52	53	54	55	56	57	58	59	60	61	62	63	64	65	66	67	68	69	70	71	72	73	74	75	76	77	78	79	80	81	82	83	84	85	86	87	88	89	90	91	92	93	94	95	96	97	98	99	100
---	---	---	---	---	---	---	---	---	----	----	----	----	----	----	----	----	----	----	----	----	----	----	----	----	----	----	----	----	----	----	----	----	----	----	----	----	----	----	----	----	----	----	----	----	----	----	----	----	----	----	----	----	----	----	----	----	----	----	----	----	----	----	----	----	----	----	----	----	----	----	----	----	----	----	----	----	----	----	----	----	----	----	----	----	----	----	----	----	----	----	----	----	----	----	----	----	----	----	-----

[illegible]

HISTORY OF OIL OR GAS WELL.

<p>RECORD</p> <p>SOFT REEL</p> <p>REEL</p> <p>REVERSE</p>	<p>RECORD</p> <p>SOFT REEL</p> <p>REEL</p> <p>REVERSE</p>	<p>RECORD</p> <p>SOFT REEL</p> <p>REEL</p> <p>REVERSE</p>	<p>RECORD</p> <p>SOFT REEL</p> <p>REEL</p> <p>REVERSE</p>
---	---	---	---

INFORMATION RECORD—Continued

Form 9-331a
APPROVED
JUN 25 1956
JERRY W. LONG
ACTING DISTRICT ENGINEER

(SUBMIT IN TRIPLICATE)
UNITED STATES
DEPARTMENT OF THE INTERIOR
GEOLOGICAL SURVEY

Land Office New Mexico
Lease No. 03980
Unit Florence

SUNDRY NOTICES AND REPORTS ON WELLS

NOTICE OF INTENTION TO DRILL	SUBSEQUENT REPORT OF WATER SHUT-OFF	<input checked="" type="checkbox"/>
NOTICE OF INTENTION TO CHANGE PLANS	SUBSEQUENT REPORT OF SHOOTING OR ACIDIZING	<input type="checkbox"/>
NOTICE OF INTENTION TO TEST WATER SHUT-OFF	SUBSEQUENT REPORT OF ALTERING CASING	<input type="checkbox"/>
NOTICE OF INTENTION TO RE-DRILL OR REPAIR WELL	SUBSEQUENT REPORT OF RE-DRILLING OR REPAIR	<input type="checkbox"/>
NOTICE OF INTENTION TO SHOOT OR ACIDIZE	SUBSEQUENT REPORT OF ABANDONMENT	<input type="checkbox"/>
NOTICE OF INTENTION TO PULL OR ALTER CASING	SUPPLEMENTARY WELL HISTORY	<input type="checkbox"/>
NOTICE OF INTENTION TO ABANDON WELL		<input type="checkbox"/>

(INDICATE ABOVE BY CHECK MARK NATURE OF REPORT, NOTICE, OR OTHER DATA)

June 11, 1956

Well No. 7-D is located 300 ft. from S line and 1850 ft. from E line of sec. 19
SE Section 19 27N 3E 106W
(1/4 Sec. and Sec. No.) (Twp.) (Range) (Meridian)
So. Blanco P.C. San Juan New Mexico
(Field) (County or Subdivision) (State or Territory)

The elevation of the derrick floor above sea level is 6097 ft.

DETAILS OF WORK

(State names of and expected depths to objective sands; show sizes, weights, and lengths of proposed casings; indicate mudding jobs, cementing points, and all other important proposed work)

6-11-56. Total Depth 2205'.
Run 70 joints 5 1/2", 15.30#, J-55 casing (2195') set at 2205' with 75 sacks regular cement, 75 sacks Pozzix, 25 Gal. 75# Flocculs.
Hold 1000# for 30 minutes.
Top of cement by temperature survey at 1500'.

I understand that this plan of work must receive approval in writing by the Geological Survey before operations may be commenced.

Company El Paso Natural Gas Company

Address Box 297

Farrington, New Mexico

By

S. Schuler
Title Petroleum Engineer

NEW MEXICO OIL CONSERVATION COMMISSION
Santa Fe, New Mexico

(Form C-104)
(Revised 7/1/52)

REQUEST FOR (OIL) - (GAS) ALLOWABLE

New Well
Recompletion

This form shall be submitted by the operator before an initial allowable will be assigned to any completed Oil or Gas well. Form C-104 is to be submitted in QUADRUPLICATE to the same District Office to which Form C-101 was sent. The allowable will be assigned effective 7:00 A.M. on date of completion or recompletion, provided this form is filed during calendar month of completion or recompletion. The completion date shall be that date in the case of an oil well when oil is delivered into the stock tanks. Gas must be reported on 15.025 psia at 60° Fahrenheit.

Farmington, N.M.

July 23, 1956

(Place)

(Date)

WE ARE HEREBY REQUESTING AN ALLOWABLE FOR A WELL KNOWN AS:

El Paso Natural Gas Co.

Florance

Well No. 7-D

in SW

1/4 SE

1/4

(Company or Operator)

(Lease)

0

Sec. 19

T. 27N

R. 8W

So. Blanco P.C.

Pool

Unit Letter

San Juan

County. Date Spudded 6-6-56

Date Completed 6-24-56

Please indicate location:

D	C	B	A
E	F	G	H
L	K	J	I
M	N	O X	P

900'S, 1850'E

Casing and Cementing Record

Size Feet Sax

9 5/8"	122'	100
5 1/2"	2195'	150
1 1/4"	2097'	---

Elevation 6087' Total Depth 2205' ~~Top C.O.~~ 2165'

Top oil/gas pay 2102' (Perf.) Name of Prod. Form. Pictured Cliff

Casing Perforations: 2102-2116, 2138-2152. or

Depth to Casing shoe of Prod. String 2205

Natural Prod. Test..... BOPD

based on..... bbls. Oil in..... Hrs..... Mins.

Test after acid or shot..... BOPD

Based on..... bbls. Oil in..... Hrs..... Mins.

Gas Well Potential AGF - 1022 MCF/D, Ch. Volume - 1008 MCF/D.

Size choke in inches.....

Date first oil run to tanks or gas to Transmission system: W/O Pipeline

Transporter taking Oil or Gas: El Paso Natural Gas Company

Remarks:.....

I hereby certify that the information given above is true and complete to the best of my knowledge.

Approved..... JUL 25 1956, 19.....

OIL CONSERVATION COMMISSION

By: Emory C. Currier

Title Oil and Gas Inspector Dist. #3.

El Paso Natural Gas Company

(Company or Operator)

By: E. J. Coel

(Signature)

Title

Petroleum Engineer

Send Communications regarding

Name

E. J. Coel

Address

Box 997, Farmington, N.M.

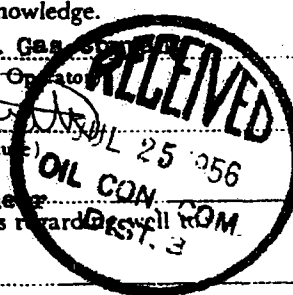

NEW MEXICO OIL CONSERVATION COMMISSION
SANTA FE, NEW MEXICO

Form C-110
Revised 7/1/55

(File the original and 4 copies with the appropriate district office)

CERTIFICATE OF COMPLIANCE AND AUTHORIZATION
TO TRANSPORT OIL AND NATURAL GAS

Company or Operator El Paso Natural Gas Company Lease Florance

Well No. 7-D Unit Letter 0 S19 T 27N R 8W Pool So. Blanco P.C.

County San Juan Kind of Lease (State, Fed. or Patented) Federal

If well produces oil or condensate, give location of tanks: Unit S T R

Authorized Transporter of Oil or Condensate El Paso Natural Gas Products Co.

Address _____
(Give address to which approved copy of this form is to be sent)

Authorized Transporter of Gas El Paso Natural Gas Co.

Address Box 997, Farmington, N.M.
(Give address to which approved copy of this form is to be sent)

If Gas is not being sold, give reasons and also explain its present disposition:

Reasons for Filing: (Please check proper box) New Well (X)

Change in Transporter of (Check One): Oil () Dry Gas () C'head () Condensate ()

Change in Ownership () Other ()

Remarks: _____
(Give explanation below)

The undersigned certifies that the Rules and Regulations of the Oil Conservation Commission have been complied with.

Executed this the 23 day of July 19 56

Approved JUL 25 1956 19

By [Signature]

Title Petroleum Engineer

Company El Paso Natural Gas Co.

Address Box 997, Farmington, N.M.

OIL CONSERVATION COMMISSION

By [Signature]

Title Oil and Gas Inspector Dist. #3.

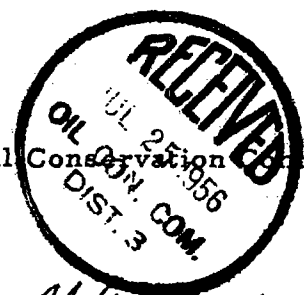

Form G-30a
(7-1-50)

APPROVED

JUL 16 1956

JERRY W. LONG
Acting District Engineer

(SUBMIT IN TRIPLICATE)

UNITED STATES
DEPARTMENT OF THE INTERIOR
GEOLOGICAL SURVEY

Budget Bureau No. 42-R358.4.
Approval expires 12-31-60.

Land Office New Mexico
Lease No. 0330
Unit Florence

SUNDRY NOTICES AND REPORTS ON WELLS

NOTICE OF INTENTION TO DRILL	SUBSEQUENT REPORT OF WATER SHUT-OFF
NOTICE OF INTENTION TO CHANGE PLANS	SUBSEQUENT REPORT OF SHOOTING OR ACIDIZING
NOTICE OF INTENTION TO TEST WATER SHUT-OFF	SUBSEQUENT REPORT OF ALTERING CASING
NOTICE OF INTENTION TO RE-DRILL OR REPAIR WELL	SUBSEQUENT REPORT OF RE-DRILLING OR REPAIR
NOTICE OF INTENTION TO SHOOT OR ACIDIZE	SUBSEQUENT REPORT OF ABANDONMENT
NOTICE OF INTENTION TO PULL OR ALTER CASING	SUPPLEMENTARY WELL HISTORY
NOTICE OF INTENTION TO ABANDON WELL	

(INDICATE ABOVE BY CHECK MARK NATURE OF REPORT, NOTICE, OR OTHER DATA)

June 22, 1956

Well No. 7-D is located 200 ft. from N line and 1850 ft. from E line of sec. 19
Section 19 27N S 18W
 (1/4 Sec. and Sec. No.) (Twp.) (Range) (Meridian)
St. Blaize P.C. San Juan New Mexico
 (Field) (County or Subdivision) (State or Territory)

The elevation of the derrick floor above sea level is 6077 ft.

DETAILS OF WORK

(State names of and expected depths to objective sands; show sizes, weights, and lengths of proposed casings; indicate mudding jobs, cementing points, and all other important proposed work)

Open date 6-5-56.
 on 6-7-56. Total Dept. 135'.
 ran 3 joints 9 5/8", 22.45, brace spiral weld casing (122')
 with 100 sacks regular cement circulated to surface.
 held 500' 30 minutes.

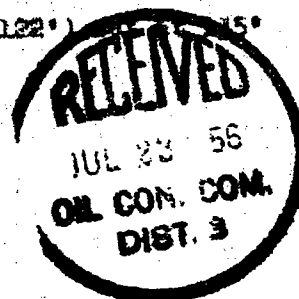

I understand that this plan of work must receive approval in writing by the Geological Survey before operations may be commenced.

Company El Paso Natural Gas Company
 Address Box 391
Farmington, New Mexico
 By John R. Cook
 Title Petroleum Engineer

STATE OF NEW MEXICO
ENERGY AND MINERALS DEPARTMENT

NO. OF COPIES RECEIVED	
DISTRIBUTION	
SANTA FE	
FILE	
U.S.G.S.	
LAND OFFICE	
TRANSPORTER	OIL
OPERATOR	GAS
PRORATION OFFICE	

OIL CONSERVATION DIVISION
P.O. BOX 2088
SANTA FE, NEW MEXICO 87501

Form C-104
Revised 10-01-78
Format 06-01-83
Page 1

REQUEST FOR ALLOWABLE
AND
AUTHORIZATION TO TRANSPORT OIL AND NATURAL GAS

RECEIVED
SEP 06 1985

OIL CON. DIV.
DIST. 3

Operator Tenneco Oil Company	
Address P. O. Box 3249, Englewood, CO 80155	
Reason(s) for filing (Check proper box)	Other (Please explain)
<input type="checkbox"/> New Well <input type="checkbox"/> Recompletion <input checked="" type="checkbox"/> Change in Ownership	Change in Transporter of: <input type="checkbox"/> Oil <input type="checkbox"/> Casinghead Gas <input type="checkbox"/> Dry Gas <input checked="" type="checkbox"/> Condensate
Well Name	

If change of ownership give name and address of previous owner **El Paso Natural Gas, P.O. Box 4990, Farmington, NM 87499**

II. DESCRIPTION OF WELL AND LEASE

Lease Name Florance D LS	Well No. 7	Pool Name, Including Formation So. Blanco-PC	Kind of Lease State, Federal or Fee USA NM	Lease No. 03380
Location				
Unit Letter O	900	Feet From The S	Line and 1850	Feet From The E
Line of Section 19	Township 27N	Range 8W	NMPM, San Juan County	

III. DESIGNATION OF TRANSPORTER OF OIL AND NATURAL GAS

Name of Authorized Transporter of Oil <input type="checkbox"/> or Condensate <input checked="" type="checkbox"/> Conoco Inc. Surface Transportation	Address (Give address to which approved copy of this form is to be sent) P. O. Box 460, Hobbs, NM 88240
Name of Authorized Transporter of Casinghead Gas <input type="checkbox"/> or Dry Gas <input checked="" type="checkbox"/> El Paso Natural Gas	Address (Give address to which approved copy of this form is to be sent) P. O. Box 4990, Farmington, NM 87499
If well produces oil or liquids, give location of tanks.	Unit O
Sec. 19	Twp. 27N
Rge. 8W	Is gas actually connected? Yes
When	

If this production is commingled with that from any other lease or pool, give commingling order number

NOTE: Complete Parts IV and V on reverse side if necessary.

VI. CERTIFICATE OF COMPLIANCE

I hereby certify that the rules and regulations of the Oil Conservation Division have been complied with and that the information given is true and complete to the best of my knowledge and belief.

Scott McKinnis
(Signature)
Sr. Regulatory Analyst

(Title)
SEP 1 1985
(Date)

OIL CONSERVATION DIVISION

APPROVED **SEP 06 1985**
BY *Frank J. Quigley*
TITLE **SUPERVISOR DISTRICT 3**

This form is to be filed in compliance with RULE 1104.

If this is a request for allowable for a newly drilled or deepened well, this form must be accompanied by a tabulation of the deviation tests taken on the well in accordance with RULE 111.

All sections of this form must be filled out completely for allowable on new and recompleted wells.

Fill out only Section I, II, III, and VI for changes of owner, well name and or number, or transporter, or other such change of condition.

Separate Forms C-104 must be filed for each pool in multiply completed wells.

Submit 5 Copies
Appropriate District Office
DISTRICT I
P.O. Box 1980, Hobbs, NM 88240

DISTRICT II
P.O. Drawer DD, Artesia, NM 88210

DISTRICT III
1000 Rio Brazos Rd., Aztec, NM 87410

State of New Mexico
Energy, Minerals and Natural Resources Department

OIL CONSERVATION DIVISION

P.O. Box 2088
Santa Fe, New Mexico 87504-2088

Form C-104
Revised 1-1-89
See Instructions
at Bottom of Page

REQUEST FOR ALLOWABLE AND AUTHORIZATION
TO TRANSPORT OIL AND NATURAL GAS

Operator Amoco Production Company		Well API No. 3004506313
Address 1670 Broadway, P. O. Box 800, Denver, Colorado 80201		
Reason(s) for Filing (Check proper box) <input type="checkbox"/> Other (Please explain)		
New Well <input type="checkbox"/>	Change in Transporter of:	
Recompletion <input type="checkbox"/>	Oil <input type="checkbox"/> Dry Gas <input type="checkbox"/>	
Change in Operator <input checked="" type="checkbox"/>	Casinghead Gas <input type="checkbox"/> Condensate <input type="checkbox"/>	
If change of operator give name and address of previous operator Tenneco Oil E & P, 6162 S. Willow, Englewood, Colorado 80155		

II. DESCRIPTION OF WELL AND LEASE

Lease Name FLORANCE D LS	Well No. 7	Pool Name, including Formation BLANCO SOUTH (PICT CLIFFS)	FEDERAL	Lease No. NM003380
Location Unit Letter O 990 900 Feet From The FSL Line and 1850 Feet From The FEL Line Section 19 Township 27N Range 8W, NMPM, SAN JUAN County				

III. DESIGNATION OF TRANSPORTER OF OIL AND NATURAL GAS

Name of Authorized Transporter of Oil <input type="checkbox"/> or Condensate <input checked="" type="checkbox"/>	Address (Give address to which approved copy of this form is to be sent)					
Name of Authorized Transporter of Casinghead Gas <input type="checkbox"/> or Dry Gas <input checked="" type="checkbox"/>	Address (Give address to which approved copy of this form is to be sent)					
EL PASO NATURAL GAS COMPANY	P. O. BOX 1492, EL PASO, TX 79978					
If well produces oil or liquids, give location of tanks.	Unit	Soc.	Twp.	Rge.	Is gas actually connected?	When?

If this production is commingled with that from any other lease or pool, give commingling order number:

IV. COMPLETION DATA

Designate Type of Completion - (X)	Oil Well	Gas Well	New Well	Workover	Deepen	Plug Back	Same Res'v	Mif Res'v
Date Spudded	Date Compl. Ready to Prod.		Total Depth		P.B.T.D.			
Elevations (DF, RKB, RT, GR, etc)	Name of Producing Formation		Top Oil/Gas Pay		Tubing Depth			
Perforations				Depth Casing Shoe				
HOLE SIZE		TUBING, CASING AND CEMENTING RECORD		DEPTH SET		SACKS CEMENT		
		CASING & TUBING SIZE						

V. TEST DATA AND REQUEST FOR ALLOWABLE

OIL WELL (Test must be after recovery of total volume of load oil and must be equal to or exceed top allowable for this depth or be for full 24 hours.)

Date First New Oil Run To Tank	Date of Test	Producing Method (Flow, pump, gas lift, etc.)	
Length of Test	Tubing Pressure	Casing Pressure	Choke Size
Actual Prod. During Test	Oil - Bbls.	Water - Bbls.	Gas - MCF

GAS WELL

Actual Prod. Test - MCF/D	Length of Test	Bbls. Condensate/MMCF	Gravity of Condensate
Testing Method (pilot, back pr.)	Tubing Pressure (Shut-in)	Casing Pressure (Shut-in)	Choke Size

VI. OPERATOR CERTIFICATE OF COMPLIANCE

I hereby certify that the rules and regulations of the Oil Conservation Division have been complied with and that the information given above is true and complete to the best of my knowledge and belief.

J. L. Hampton
Signature

J. L. Hampton Sr. Staff Admin. Suprv.
Printed Name Title
January 16, 1989 303-830-5025
Date Telephone No.

OIL CONSERVATION DIVISION

Date Approved MAY 08 1989

By *[Signature]*
SUPERVISION DISTRICT # 3
Title

INSTRUCTIONS: This form is to be filed in compliance with Rule 1104

- 1) Request for allowable for newly drilled or deepened well must be accompanied by tabulation of deviation tests taken in accordance with Rule 111.
- 2) All sections of this form must be filled out for allowable on new and recompleted wells.
- 3) Fill out only Sections I, II, III, and VI for changes of operator, well name or number, transporter, or other such changes.
- 4) Separate Form C-104 must be filed for each pool in multiply completed wells.

Submit 5 Copies
Appropriate District Office
DISTRICT I
P.O. Box 1980, Hobbs, NM 88240

DISTRICT II
P.O. Drawer DD, Artesia, NM 88210

DISTRICT III
1000 Rio Brazos Rd., Aztec, NM 87410

State of New Mexico
Energy, Minerals and Natural Resources Department

OIL CONSERVATION DIVISION
P.O. Box 2088
Santa Fe, New Mexico 87504-2088

Form C-104
Revised 1-1-89
See Instructions
at Bottom of Page

REQUEST FOR ALLOWABLE AND AUTHORIZATION
TO TRANSPORT OIL AND NATURAL GAS

Operator AMOCO PRODUCTION COMPANY		Well APN No. 3004506313
Address P.O. BOX 800, DENVER, COLORADO 80201		
Reason(s) for Filing (Check proper box) <input type="checkbox"/> Other (Please explain)		
New Well <input type="checkbox"/>	Change in Transporter of: Oil <input type="checkbox"/> Dry Gas <input type="checkbox"/>	
Recompletion <input type="checkbox"/>	Casinghead Gas <input type="checkbox"/> Condensate <input checked="" type="checkbox"/>	
Change in Operator <input type="checkbox"/>		
If change of operator give name and address of previous operator		

II. DESCRIPTION OF WELL AND LEASE

Lease Name FLORANCE D LS	Well No. 7	Pool Name, Including Formation BLANCO SOUTH (PICT CLIFFS)	Kind of Lease FEDERAL	Lease No. NM003380
Location Unit Letter O : 900 Feet From The FSL Line and 1850 Feet From The FEI Line Section 19 Township 27N Range 8W NMPM SAN JUAN County				

III. DESIGNATION OF TRANSPORTER OF OIL AND NATURAL GAS

Name of Authorized Transporter of Oil <input type="checkbox"/> or Condensate <input type="checkbox"/> NERIDIAN OIL INC.	Address (Give address to which approved copy of this form is to be sent) 3535 EAST 30TH STREET, FARMINGTON, NM 87401	
Name of Authorized Transporter of Casinghead Gas <input type="checkbox"/> or Dry Gas <input type="checkbox"/> EL PASO NATURAL GAS COMPANY	Address (Give address to which approved copy of this form is to be sent) P.O. BOX 1492, EL PASO, TX 79978	
If well produces oil or liquids, give location of tanks.	Unit	Sec.
	Twp.	Rge.
		Is gas actually connected? <input type="checkbox"/> When?

If this production is commingled with that from any other lease or pool, give commingling order number:

IV. COMPLETION DATA

Designate Type of Completion - (X)	Oil Well	Gas Well	New Well	Workover	Deepen	Plug Back	Same Res'v	Diff Res'v
Date Spudded	Date Compl. Ready to Prod.		Total Depth		P.B.T.D.			
Elevations (DF, RKB, RT, GR, etc.)	Name of Producing Formation		Top Oil/Gas Pay		Tubing Depth			
Perforations			Depth Casing Shoe					
TUBING, CASING AND CEMENTING RECORD								
HOLE SIZE	CASING & TUBING SIZE		DEPTH SET		SACKS CEMENT			

V. TEST DATA AND REQUEST FOR ALLOWABLE

OIL WELL (Test must be after recovery of total volume of load oil and must be equal to or exceed top allowable for this depth or be for full 24 hours.)

Date First New Oil Run To Tank	Date of Test	Producing Method (Flow, pump, gas lift, etc.)	
Length of Test	Tubing Pressure	Choke Size	
Actual Prod. During Test	Oil - Bbls.	Well - Bbls.	Gas - MCF

GAS WELL

Actual Prod. Test - MCF/D	Length of Test	Bbls. Condensate/MCF	Gravity of Condensate
Testing Method (pilot, back pr.)	Tubing Pressure (Shut-in)	Casing Pressure (Shut-in)	Choke Size

VI. OPERATOR CERTIFICATE OF COMPLIANCE

I hereby certify that the rules and regulations of the Oil Conservation Division have been complied with and that the information given above is true and complete to the best of my knowledge and belief.

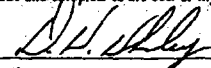
Signature
Doug W. Whaley, Staff Admin. Supervisor
Printed Name
February 8, 1991
Date
303-830-4280
Telephone No.

OIL CONSERVATION DIVISION

FEB 25 1991

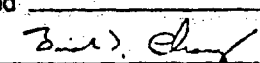
Date Approved _____
By 
SUPERVISOR DISTRICT 13
Title _____

INSTRUCTIONS: This form is to be filed in compliance with Rule 1104

- 1) Request for allowable for newly drilled or deepened well must be accompanied by tabulation of deviation tests taken in accordance with Rule 111.
- 2) All sections of this form must be filled out for allowable on new and recompleted wells.
- 3) Fill out only Sections I, II, III, and VI for changes of operator, well name or number, transporter, or other such changes.
- 4) Separate Form C-104 must be filed for each pool in multiply completed wells.

District I
PO Box 1980, Hobbs, NM 88241-1980

District II
#11 South First, Artesia, NM 88210

District III
1000 RioBrazos Rd., Aztec, NM 87410

District IV
2040 South Pacheco, Santa Fe, NM 87505

State of New Mexico
Energy, Minerals and Natural Resources Department
OIL CONSERVATION DIVISION
2040 South Pacheco
Santa Fe, NM 87505

Form C-104
Revised October 18, 1994
Instructions on back
Submit to Appropriate District Office
5 Copies

☐ AMENDED REPORT

I. REQUEST FOR ALLOWABLE AND AUTHORIZATION TO TRANSPORT

¹ Operator name and Address CROSS TIMBERS OPERATING COMPANY 6001 Highway 64 Farmington, NM 87401		² OGRID Number 167087
		³ Reason for Filing Code Change of Operator, 12/1/97
⁴ API Number 30-045-06313	⁵ Pool Name S BLANCO PICTURED CLIFFS	⁶ Pool Code 72439
⁷ Property Code	⁸ Property Name FLORANCE D LS	⁹ Well Number 7

II. ¹⁰ Surface Location

UL or lot no. 0	Section 19	Township 27N	Range 08W	Lot/Idn	Feet from the 900	North/South Line S	Feet from the 1850	East/West line E	County SJ
--------------------	---------------	-----------------	--------------	---------	----------------------	-----------------------	-----------------------	---------------------	--------------

¹¹ Bottom Hole Location

UL or lot no.	Section	Township	Range	Lot/Idn	Feet from the	North/South Line	Feet from the	East/West line	County
¹² Loe Code F	¹³ Producing Method Code	¹⁴ Gas Connection Date	¹⁵ C-129 Permit Number	¹⁶ C-129 Effective Date	¹⁷ C-129 Expiration Date				

III. Oil and Gas Transporters

¹⁸ Transporter OGRID	¹⁹ Transporter Name and Address	²⁰ POD	²¹ O/G	²² POD ULSTR Location and Description

RECEIVED
DEC 19 1997

IV. Produced Water

²³ POD	²⁴ POD ULSTR Location and Description

OIL CON. DIV.
DIST. 3

V. Well Completion Data

²⁵ Spud Date	²⁶ Ready Date	²⁷ TD	²⁸ FBTD	²⁹ Perforation	³⁰ DHC,DC,MC
³¹ Hole Size	³² Casing and Tubing Size	³³ Depth Set	³⁴ Sacks Cement		

VI. Well Test Data

³⁵ Date New Oil	³⁶ Gas Delivery Date	³⁷ Test Date	³⁸ Test Length	³⁹ Tbg. Pressure	⁴⁰ Csg. Pressure
⁴¹ Choke Size	⁴² Oil	⁴³ Water	⁴⁴ Gas	⁴⁵ AOF	⁴⁶ Test Method

⁴⁷ I hereby certify that the rules of the Oil Conservation Division have been complied with and that the information given above is true and complete to the best of my knowledge and belief.

Signature:

Printed Name: *Vaughan D. Vannerberg, II*

Title: *Sr. Vice President-Land*

Date: *December 1, 1997*

Phone: *(505) 632-5200*

OIL CONSERVATION DIVISIO

Approved by: *Frank T. Chavez*

Title: *Supervisor District #3*

Approval Date:

⁴⁸ If this is a change of operator fill in the OGRID number and name of the previous operator

Amoco Production Company OGRID# 000778

Gail Jefferson
Printed Name

Senior Administrative Staff Assistant
Title

12/01/97
Date

Previous Operator Signature

UNITED STATES
DEPARTMENT OF THE INTERIOR
BUREAU OF LAND MANAGEMENT

FORM APPROVED
Budget Bureau No. 1004-0135
Expires November 30, 2000

SUNDRY NOTICES AND REPORTS ON WELLS

Do not use this form for proposals to drill or to re-enter an
abandoned well. Use Form 3160-3 (APD) for such proposals.

SUBMIT IN TRIPLICATE - Other instructions on reverse side

1. Type of Well
☐ Oil Well ☒ Gas Well ☐ Other

2. Name of Operator
XTO Energy Inc.

3a. Address 3b. Phone No. (include area code)
2700 Farmington Ave., Bldg. K. Ste 1 Farmington, NM 8740505-324-1090

4. Location of Well (Footage, Sec., T., R., M., or Survey Description)
900' FSL & 1850' FEL, UNIT 0, SEC 19, T27N, R8W

5. Lease Serial No.

NMNM03380

6. If Indian, Allottee or Tribe Name

7. If Unit or CA/Agreement, Name and/or No

8. Well Name and No.

FLORANCE D LS #7

9. API Well No.

30-045-06313

10. Field and Pool, or Exploratory Area

BLANCO PICTURED CLIFFS

11. County or Parish, State

SAN JUAN NM

12. CHECK APPROPRIATE BOX(ES) TO INDICATE NATURE OF NOTICE, REPORT, OR OTHER DATA

TYPE OF SUBMISSION

- ☒ Notice of Intent
☐ Subsequent Report
☐ Final Abandonment Notice

TYPE OF ACTION

- | | | | |
|---|---|--|--|
| <input type="checkbox"/> Acidize | <input type="checkbox"/> Deepen | <input type="checkbox"/> Production (Start/Resume) | <input type="checkbox"/> Water Shut-Off |
| <input type="checkbox"/> Alter Casing | <input type="checkbox"/> Fracture Treat | <input type="checkbox"/> Reclamation | <input type="checkbox"/> Well Integrity |
| <input type="checkbox"/> Casing Repair | <input type="checkbox"/> New Construction | <input type="checkbox"/> Recomplete | <input checked="" type="checkbox"/> Other <u>SURFACE</u> |
| <input type="checkbox"/> Change Plans | <input type="checkbox"/> Plug and Abandon | <input type="checkbox"/> Temporarily Abandon | <u>COMMINGLE</u> |
| <input type="checkbox"/> Convert to Injection | <input type="checkbox"/> Plug Back | <input type="checkbox"/> Water Disposal | |

13. Describe Proposed or Completed Operation (clearly state all pertinent details, including estimated starting date of any proposed work and approximated duration thereof. If the proposal is to deepen directionally or recomplete horizontally, give subsurface locations and measured and true vertical depths of all pertinent markers and zones. Attach the Bond under which the work will be performed or provide the Bond No. on file with BLM/BIA. Required subsequent reports shall be filed within 30 days following completion of the involved operations. If the operation results in a multiple completion or recompletion in a new interval, a Form 3160-4 shall be filed once testing has been completed. Final Abandonment Notices shall be filed only after all requirements, including reclamation, have been completed, and the operator has determined that the final site is ready for final inspection.)

XTO Energy Inc. proposes to surface commingle this well per the attached documents.

14. I hereby certify that the foregoing is true and correct
Name (Printed/Typed)

DARRIN STEED

Title

OPERATIONS ENGINEER

Date 12/14/01

THIS SPACE FOR FEDERAL OR STATE OFFICE USE

Approved by

/s/ Jim Lovato

Title

Date JAN - 2 2002

Office

Conditions of approval, if any, are attached. Approval of this notice does not warrant or certify that the applicant holds legal or equitable title to those rights in the subject lease which would entitle the applicant to conduct operations thereon.

Title 18 U.S.C. Section 1001, makes it a crime for any person knowingly and willfully to make to any department or agency of the United States any false, fictitious or fraudulent statements or representations as to any matter within its jurisdiction.

(Instructions on reverse)

NMOC

**** ORIGINAL ** ORIGINAL ** ORIGINAL ** ORIGINAL ** ORIGINAL ** ORIGINAL ** ORIGINAL ****

Additional data for EC transaction #11806 that would not fit on the form

Wells/Facilities, continued

Agreement	Lease	Well/Fac Name, Number	API Number	Location
	NMNM03380	FLORANCE DLS 7	30-045-06313	Sec 19 T27N R08W SWSE 900FSL 1850FEL
	NMNM03380	FLORANCE 67	30-045-11822	Sec 19 T27N R08W SWSE 1135FSL 1850FEL
	NMNM03380	FLORANCE 69R	30-045-30629	Sec 19 T27N R08W SWSE 935FSL 1845FEL

[Handwritten signature]

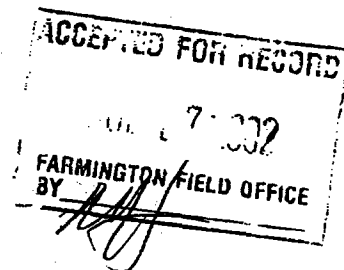

NMOCD

UNITED STATES
DEPARTMENT OF THE INTERIOR
BUREAU OF LAND MANAGEMENTFORM APPROVED
OMB NO. 1004-0135
Expires: November 30, 2000**SUNDRY NOTICES AND REPORTS ON WELLS**
*Do not use this form for proposals to drill or to re-enter an abandoned well. Use form 3160-3 (APD) for such proposals.***SUBMIT IN TRIPLICATE - Other instructions on reverse side.**

1. Type of Well <input type="checkbox"/> Oil Well <input checked="" type="checkbox"/> Gas Well <input type="checkbox"/> Other		5. Lease Serial No. NMNM03380
2. Name of Operator XTO ENERGY INC		6. If Indian, Allottee or Tribe Name
Contact: HOLLY PERKINS E-Mail: Regulatory@xtoenergy.com		7. If Unit or CA/Agreement, Name and/or No.
3a. Address 2700 FARMINGTON AVE., BLDG K, SUITE 1 FARMINGTON, NM 87401	3b. Phone No. (include area code) Ph: 505.324.1090 Ext: 4020 Fx: 505.564.6700	8. Well Name and No. FLORENCE D LS 7
4. Location of Well (Footage, Sec., T., R., M., or Survey Description) Sec 19 T27N R8W SWSE 0990FSL 1850FEL 36.55512 N Lat, 107.71977 W Lon		9. API Well No. 30-045-06313-00-S1
		10. Field and Pool, or Exploratory BLANCO P.C. SOUTH
		11. County or Parish, and State SAN JUAN COUNTY, NM

12. CHECK APPROPRIATE BOX(ES) TO INDICATE NATURE OF NOTICE, REPORT, OR OTHER DATA

TYPE OF SUBMISSION	TYPE OF ACTION			
<input checked="" type="checkbox"/> Notice of Intent	<input type="checkbox"/> Acidize	<input type="checkbox"/> Deepen	<input type="checkbox"/> Production (Start/Resume)	<input type="checkbox"/> Water Shut-Off
<input type="checkbox"/> Subsequent Report	<input type="checkbox"/> Alter Casing	<input type="checkbox"/> Fracture Treat	<input type="checkbox"/> Reclamation	<input type="checkbox"/> Well Integrity
<input type="checkbox"/> Final Abandonment Notice	<input type="checkbox"/> Casing Repair	<input type="checkbox"/> New Construction	<input type="checkbox"/> Recomplete	<input type="checkbox"/> Other
	<input type="checkbox"/> Change Plans	<input checked="" type="checkbox"/> Plug and Abandon	<input type="checkbox"/> Temporarily Abandon	
	<input type="checkbox"/> Convert to Injection	<input type="checkbox"/> Plug Back	<input type="checkbox"/> Water Disposal	

13. Describe Proposed or Completed Operation (clearly state all pertinent details, including estimated starting date of any proposed work and approximate duration thereof. If the proposal is to deepen directionally or recompleat horizontally, give subsurface locations and measured and true vertical depths of all pertinent markers and zones. Attach the Bond under which the work will be performed or provide the Bond No. on file with BLM/BIA. Required subsequent reports shall be filed within 30 days following completion of the involved operations. If the operation results in a multiple completion or recompleat in a new interval, a Form 3160-4 shall be filed once testing has been completed. Final Abandonment Notices shall be filed only after all requirements, including reclamation, have been completed, and the operator has determined that the site is ready for final inspection.)

XTO Energy Inc. proposes to plug and abandon this well per attached procedure. Attached is the proposed P&A wellbore diagram.



14. I hereby certify that the foregoing is true and correct. Electronic Submission #31165 verified by the BLM Well Information System For XTO ENERGY INC., sent to the Farmington Committed to AFMSS for processing by STEVE MASON on 05/26/2004 (04SXM1607SE)	
Name (Printed/Typed) HOLLY PERKINS	Title REGULATORY SPECIALIST
Signature (Electronic Submission)	Date 05/26/2004

THIS SPACE FOR FEDERAL OR STATE OFFICE USE

Approved By	Title <i>RS</i>	JUN 03 2004
Conditions of approval, if any, are attached. Approval of this notice does not warrant or certify that the applicant holds legal or equitable title to those rights in the subject lease which would entitle the applicant to conduct operations thereon.	Office <i>FFO</i>	

Title 18 U.S.C. Section 1001 and Title 43 U.S.C. Section 1212, make it a crime for any person knowingly and willfully to make to any department or agency of the United States any false, fictitious or fraudulent statements or representations as to any matter within its jurisdiction.

**** BLM REVISED ** BLM REVISED ** BLM REVISED ** BLM REVISED ** BLM REVISED ******NMOCD**

FLORANCE D #7
SEC 19, T 27 N, R 08 W
SAN JUAN COUNTY, NEW MEXICO
PLUG AND ABANDON WELL

Formation:	Pictured Cliffs
Surface csg:	9-5/8", 25.4# csg @ 135'. Cmt'd w/100 sx cmt & 3% CaCl ₂ . Circ cmt to surf.
Production csg:	5-1/2", 15.5# J-55 csg @ 2,205'. Cmt'd w/75 sx reg cmt, 75 sx Pozmix w/2% gal & 1/2#/# Floccs. Did not circ cmt. TOC @ 1,500' by TS.
Tbg:	99 jts 1-1/4", 2.3# 3rd tbg. EDT @ 2,097'
Perfs:	2,102'-2,116' & 2,138'-2,152' w/4 JSPP.
Current Status:	SI

1. Notify BLM and NMOCD of plugging operations.
2. MRO PU. MIS joints 1-1/4" tubing. Check and record tubing, casing and bradenhead pressures.
3. Blow well down and kill well with fresh water.
4. NB WH. NU and pressure test BOP.
5. TOH with 1-1/4" tubing. Inspect tubing. RIH with 5-1/2" gauge ring on sand line.
6. PU and TIH with 5-1/2" cement retainer. Set retainer at 2,052'. Pressure test tubing to 1,000 psig. Load casing with water and circulate wellbore clean. Pressure test casing to 500 psig. If casing does not test, then spot or tag subsequent plugs as directed by BLM.
7. Spot a 39 sx type III cement plug inside the casing from 2,052'-1,725' to cover the Fruitland Coal formation and the top of the Pictured Cliffs formation.
8. TOH with tubing.
9. Perforate 3 squeeze holes at 1,316'. Attempt to establish rate into squeeze holes if the casing pressure tested. PU and TIH with 5-1/2" cement retainer. Set at 1,260'. Establish rate into squeeze holes. Mix and pump 145 sx Type III cement, squeeze 85 sx outside the casing and leave 28 sx inside casing to cover the Kirtland and Ojo Alamo formation tops. (1376-1079)
10. TOH and lay down tubing.
11. Perforate 3 squeeze holes at 185'. Establish circulation out bradenhead. Mix and pump approximately 75 sx Type III cement down the 5-1/2" casing to circulate good cement out bradenhead. Shut-in well and WOC.
12. Cut off wellhead and install P&A marker. Cement marker with 10 sx cement. RDMO PU.

Fiorance D.L.S. #7

Proposed P&A

Blanco Pictured Cliffs / API 230-243-08313

900' FEL to 1800' FEL, Section 16, T.27N. R.2E.W., San Juan County, NM

Today's Date: 8/17/94
Spud: 6/6/94
Completed: 7/24/98
Elevation: 8037' GL
6096' OF

Ojo Alamo @ 1136'
L.P.

Kilband @ 1280'
1314

Prudhoe @ 1775'
1834

Pictured Cliffs @ 2100'

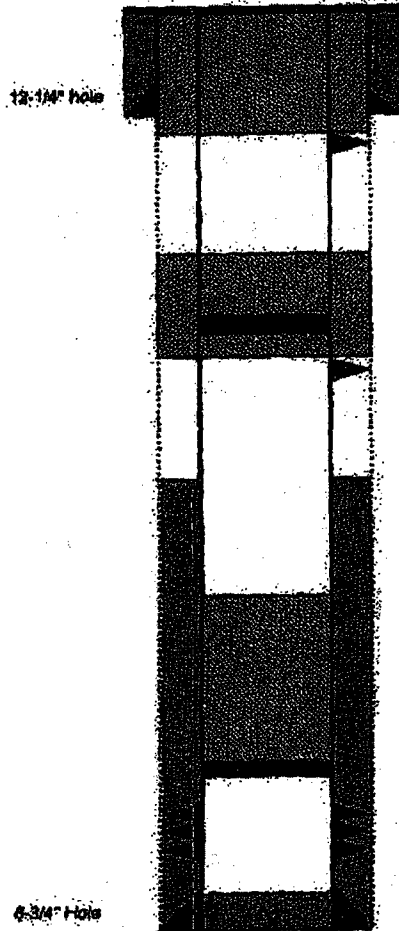

6-3/4" Hole

TD 2200'
CO 2152'

$$\begin{aligned} 195 / 1.32(7.413) &= 19 \text{ SKS} \\ 50 / 1.32(3.9519) &= 10 \text{ SKS} \\ 135 / 1.32(3.5) &= 29 \text{ SKS} \\ \hline &58 \text{ SKS} \end{aligned}$$

0.458" 25.4# Casing set @ 135'
Cement with 100 sks (Circulated in Surface)

Perforate @ 180' Plug #1: 185' - Surface
Type III cement, 75 sks

$$1576 - 1079 =$$

Plug #2: 1079' - 1088'
Type III cement, 135 sks
25 sks outside casing
and 35 inside.

Cert Retainer @ 1280'

$$\begin{aligned} \text{Perforate @ 1325'} & \left(\frac{1376 - 1079}{1276 - 1079} \right) \times 50 / 1.32(7.413) = 35 \text{ SKS} \\ & (1276 - 1079) 2 / 1.32(3.9519) = 114 \text{ SKS} \end{aligned}$$

TGC @ 1500' (T9)

Plug #3: 1725' - 1728'
Type III cement, 30 sks

$$(2052 - 1725) + 50 / 1.32(7.413) = 38 \text{ SKS}$$

Set CR @ 2052'

Pictured Cliffs Perforations:
2182' - 2152'

5-1/2" 15.5# J-55 Casing set @ 2205'
Cement with 150 sks

Submit 3 Copies To Appropriate District Office
District I
1625 N. French Dr., Hobbs, NM 88240
District II
1301 W. Grand Ave., Artesia, NM 88210
District III
1000 Rio Brazos Rd., Aztec, NM 87410
District IV
1220 S. St. Francis Dr., Santa Fe, NM 87505

State of New Mexico
Energy, Minerals and Natural Resources

Form C-103
May 27, 2004

OIL CONSERVATION DIVISION
1220 South St. Francis Dr.
Santa Fe, NM 87505

SUNDRY NOTICES AND REPORTS ON WELLS (DO NOT USE THIS FORM FOR PROPOSALS TO DRILL OR TO DEEPEN OR PLUG BACK TO A DIFFERENT RESERVOIR. USE "APPLICATION FOR PERMIT" (FORM C-101) FOR SUCH PROPOSALS.)		WELL API NO. 30-045-06313-00-S1
1. Type of Well: Oil Well <input type="checkbox"/> Gas Well <input checked="" type="checkbox"/> Other <input type="checkbox"/>		5. Indicate Type of Lease STATE <input type="checkbox"/> FEE <input type="checkbox"/>
2. Name of Operator XTO Energy Inc.		6. State Oil & Gas Lease No. NMNM 03380
3. Address of Operator 2700 Farmington Ave., Bldg K, Santa Fe, NM 87401		7. Lease Name or Unit Agreement Name Florence D. L3
4. Well Location Unit Letter 940 feet from the South line and 1850 feet from the East line Section 19 Township 27N Range 8W NMPM County Santa Fe		8. Well Number 47
11. Elevation (Show whether DR, RKB, RT, GR, etc.) 6096' DF, 6087' GR		9. OGRID Number
Pit or Below-grade Tank Application <input checked="" type="checkbox"/> or Closure <input type="checkbox"/>		10. Pool name or Wildcat Blanco P.C. South
Pit type Underground Depth to Groundwater 275' Distance from nearest fresh water well 21000' Distance from nearest surface water 21000'		
Pit Liner Thickness: 12 mil Below-Grade Tank: Volume bbls; Construction Material		

12. Check Appropriate Box to Indicate Nature of Notice, Report or Other Data

NOTICE OF INTENTION TO:		SUBSEQUENT REPORT OF:	
PERFORM REMEDIAL WORK <input type="checkbox"/>	PLUG AND ABANDON <input type="checkbox"/>	REMEDIAL WORK <input type="checkbox"/>	ALTERING CASING <input type="checkbox"/>
TEMPORARILY ABANDON <input type="checkbox"/>	CHANGE PLANS <input type="checkbox"/>	COMMENCE DRILLING OPNS. <input type="checkbox"/>	P AND A <input type="checkbox"/>
PULL OR ALTER CASING <input type="checkbox"/>	MULTIPLE COMPL. <input type="checkbox"/>	CASING/CEMENT JOB <input type="checkbox"/>	
OTHER: <input checked="" type="checkbox"/>		OTHER: <input type="checkbox"/>	

13. Describe proposed or completed operations. (Clearly state all pertinent details, and give pertinent dates, including estimated date of starting any proposed work). SEE RULE 1103. For Multiple Completions: Attach wellbore diagram of proposed completion or recompletion.

Big earthen pit to hold cement waste water from plug & abandonment operations as per the Interior Pit & Below-Grade Tank Guidelines Section II, Subsection B, Drilling & Work over pits

I hereby certify that the information above is true and complete to the best of my knowledge and belief. I further certify that any pit or below-grade tank has been/will be constructed or closed according to NMOC guidelines ☒, a general permit ☐ or an (attached) alternative OCD-approved plan ☐.

SIGNATURE *Wally C. Perkins* TITLE *Regulatory Compliance Sect* DATE *7-14-04*

Type or print name
For State Use Only

E-mail address:

Telephone No.

APPROVED BY: *Charles L.*
Conditions of Approval (if any):

TITLE *Deputy O&G Inspector* DATE *7-16-04*

Rec 7-14

UNITED STATES
DEPARTMENT OF THE INTERIOR
BUREAU OF LAND MANAGEMENTFORM APPROVED
OMB NO. 1004-0135
Expires: November 30, 2000**SUNDRY NOTICES AND REPORTS ON WELLS**
Do not use this form for proposals to drill or to re-enter an
abandoned well. Use form 3160-3 (APD) for such proposals.

SUBMIT IN TRIPLICATE - Other instructions on reverse side.

1. Type of Well <input type="checkbox"/> Oil Well <input checked="" type="checkbox"/> Gas Well <input type="checkbox"/> Other		5. Lease Serial No. NMNM03380	
2. Name of Operator XTO ENERGY INC		6. If Indian, Allottee or Tribe Name	
3a. Address 2700 FARMINGTON AVE., BLDG K, SUITE 1 FARMINGTON, NM 87401		7. If Unit or CA/Agreement, Name and/or No.	
3b. Phone No. (include area code) Ph: 505.324.1080 Ext: 4020 Fx: 505.584.6700		8. Well Name and No. FLORENCE D LS 7	
4. Location of Well (Footage, Sec., T., R., M., or Survey Description) Sec 19 T27N R8W SWSE 0990FSL 1850FEL 36.55512 N Lat, 107.71977 W Lon		9. API Well No. 30-045-06313-00-S1	
		10. Field and Pool, or Exploratory BLANCO P.C. SOUTH	
		11. County or Parish, and State SAN JUAN COUNTY, NM	

12. CHECK APPROPRIATE BOX(ES) TO INDICATE NATURE OF NOTICE, REPORT, OR OTHER DATA

TYPE OF SUBMISSION	TYPE OF ACTION			
<input type="checkbox"/> Notice of Intent	<input type="checkbox"/> Acidize	<input type="checkbox"/> Deepen	<input type="checkbox"/> Production (Start/Resume)	<input type="checkbox"/> Water Shut-Off
<input checked="" type="checkbox"/> Subsequent Report	<input type="checkbox"/> Alter Casing	<input type="checkbox"/> Fracture Treat	<input type="checkbox"/> Reclamation	<input type="checkbox"/> Well Integrity
<input type="checkbox"/> Final Abandonment Notice	<input type="checkbox"/> Casing Repair	<input type="checkbox"/> New Construction	<input type="checkbox"/> Recomplete	<input type="checkbox"/> Other
	<input type="checkbox"/> Change Plans	<input checked="" type="checkbox"/> Plug and Abandon	<input type="checkbox"/> Temporarily Abandon	
	<input type="checkbox"/> Convert to Injection	<input type="checkbox"/> Plug Back	<input type="checkbox"/> Water Disposal	

13. Describe Proposed or Completed Operation (clearly state all pertinent details, including estimated starting date of any proposed work and approximate duration thereof. If the proposal is to deepen directionally or recomplete horizontally, give subsurface locations and measured and true vertical depths of all pertinent markers and zones. Attach the Bond under which the work will be performed or provide the Bond No. on file with BLM/BIA. Required subsequent reports shall be filed within 30 days following completion of the involved operations. If the operation results in a multiple completion or recompletion in a new interval, a Form 3160-4 shall be filed once testing has been completed. Final Abandonment Notices shall be filed only after all requirements, including reclamation, have been completed, and the operator has determined that the site is ready for final inspection.)

XTO Energy Inc. plugged and abandoned this well in the following manner:

MIRU rig. TOH w/tbg. TIH w/bit, csg scraper & tbg. Circ wellbore w/50 BFW. Spotted plug #1: 44 sx Class C cmt fr/1055' - 1621'. Plug #1 OK'd by Matt Warren w/BLM. Circ out BH vlv. TOH w/tbg. Perf'd 3 sqz holes @ 1376'. TIH w/cmt retainer & tbg; set retainer @ 1348'. Press up to 1500 psig; lost 500 psig in 3 min. Stung out of retainer. Ppd plug #2: 10 sx Class C cmt fr/1348' - 1248'. Perf'd 3 sqz holes @ 1179'. TIH w/cmt retainer & tbg; set retainer @ 1129'. Press up to 1000 psig; lost 500 psig in 3 min. Stung out of retainer. Ppd plug #3: 15 sx Class C cmt fr/1134' - 986'. TIH w/pkr; set @ 192' & 513'. Press tstd csg @ ea stop to 500 psig; held OK. TOH w/pkr & tbg. RIH w/CIBP; set @ 200'. Perf'd 3 sqz holes @ 188'. Est circ out BH vlv w/5 BFW. Ppd plug #4: 67 sx Class C cmt fr/185' - surf. ND BOP. Cut off WH & installed P&A marker.

14. I hereby certify that the foregoing is true and correct. Electronic Submission #34560 verified by the BLM Well Information System For XTO ENERGY INC, sent to the Farmington Committed to AFMSS for processing by STEVE MASON on 08/13/2004 (04SXM1607SE)	
Name (Printed/Typed) HOLLY PERKINS	Title REGULATORY COMPLIANCE TECH
Signature (Electronic Submission)	Date 08/13/2004

THIS SPACE FOR FEDERAL OR STATE OFFICE USE

Approved By ACCEPTED	STEPHEN MASON Title PETROLEUM ENGINEER	Date 08/13/2004
Conditions of approval, if any, are attached. Approval of this notice does not warrant or certify that the applicant holds legal or equitable title to those rights in the subject lease which would entitle the applicant to conduct operations thereon.		
Office Farmington		

Title 18 U.S.C. Section 1001 and Title 43 U.S.C. Section 1212, make it a crime for any person knowingly and willfully to make to any department or agency of the United States any false, fictitious or fraudulent statements or representations as to any matter within its jurisdiction.

** BLM REVISED ** BLM REVISED ** BLM REVISED ** BLM REVISED ** BLM REVISED **

NMOCD

[HOME](#) | [PETROLEUM DATA](#) | [NEWS](#) | [MARKETPLACE](#) | [SOFTWARE](#) | [SPONSORS](#) | [LINKS](#) | [CONTACT](#)

[PTTC](#)
[PRRC](#)
[NM-TECH](#)
[NMBGMR](#)



[NYMEX LS Crude](#) \$53.15
[Navajo WTXI](#) \$50.25
[Henry Hub](#) \$6.72

Updated 3/4/2005

[GENERAL](#) | [COUNTY](#) | [OPERATOR](#) | [POOL](#) | [LOCATION](#) | [OCD LOG & WELL FILES](#)

View Production Data

In Internet Explorer, right click and select "Save Target As..."
In Netscape, right click and select "Save Link As..."

Download: [HTTP](#)

Well: FLORANCE D LS **No.:** 007
Operator: XTO ENERGY, INC. [[NM SLO data](#)]
API: 3004506313 **Township:** 27.0N **Range:** 08W
Section: 19 **Unit:** O
Land Type: F **County:** San Juan
Pools associated:

- [BLANCO P. C. SOUTH \(PRORATED GAS\)](#) **Total Acreage:** Unknown **Completion:** Unknown
- [Show All](#)

Year: 1977

Pool Name: BLANCO P. C. SOUTH (PRORATED GAS)

Month	Oil(BBLS)	Gas(MCF)	Water(BBLS)	Days Produced	Accum. Oil(BBLS)	Accum. Gas(MCF)
January	0	1015	0	32	0	1015
February	0	735	0	24	0	1750
March	0	1001	0	32	0	2751
April	0	993	0	32	0	3744
May	0	982	0	32	0	4726
June	0	713	0	24	0	5439
July	0	1007	0	31	0	6446
August	0	991	0	32	0	7437
September	0	959	0	32	0	8396
October	0	991	0	31	0	9387
November	0	930	0	29	0	10317

December	0	938	0	31	0	11255
Total	0	11255	0	362		

Year: 1978

Pool Name: BLANCO P. C. SOUTH (PRORATED GAS)

Month	Oil(BBLS)	Gas(MCF)	Water(BBLS)	Days Produced	Accum. Oil(BBLS)	Accum. Gas(MCF)
January	0	962	0	31	0	12217
February	0	886	0	28	0	13103
March	0	954	0	31	0	14057
April	0	927	0	30	0	14984
May	0	970	0	31	0	15954
June	0	926	0	30	0	16880
July	0	935	0	31	0	17815
August	0	977	0	31	0	18792
September	0	954	0	30	0	19746
October	0	1026	0	31	0	20772
November	0	1018	0	30	0	21790
December	0	1072	0	31	0	22862
Total	0	11607	0	365		

Year: 1979

Pool Name: BLANCO P. C. SOUTH (PRORATED GAS)

Month	Oil(BBLS)	Gas(MCF)	Water(BBLS)	Days Produced	Accum. Oil(BBLS)	Accum. Gas(MCF)
January	0	1035	0	30	0	23897
February	0	904	0	28	0	24801
March	0	1023	0	31	0	25824
April	0	932	0	30	0	26756
May	0	954	0	31	0	27710
June	0	941	0	30	0	28651
July	0	891	0	31	0	29542
August	0	896	0	31	0	30438
September	0	940	0	30	0	31378
October	0	971	0	31	0	32349
November	0	965	0	30	0	33314
December	0	969	0	31	0	34283
Total	0	11421	0	364		

Year: 1980

Pool Name: BLANCO P. C. SOUTH (PRORATED GAS)

Month	Oil(BBLS)	Gas(MCF)	Water(BBLS)	Days Produced	Accum. Oil(BBLS)	Accum. Gas(MCF)
January						

	0	968	0	31	0	35251
February	0	891	0	29	0	36142
March	0	937	0	31	0	37079
April	0	908	0	30	0	37987
May	0	912	0	31	0	38899
June	0	837	0	30	0	39736
July	0	631	0	31	0	40367
August	0	756	0	31	0	41123
September	0	806	0	30	0	41929
October	0	941	0	31	0	42870
November	0	1075	0	30	0	43945
December	0	1082	0	31	0	45027
Total	0	10744	0	366		

Year: 1981

Pool Name: BLANCO P. C. SOUTH (PRORATED GAS)

Month	Oil(BBLS)	Gas(MCF)	Water(BBLS)	Days Produced	Accum. Oil(BBLS)	Accum. Gas(MCF)
January	0	1063	0	31	0	46090
February	0	932	0	28	0	47022
March	0	1040	0	31	0	48062
April	0	966	0	30	0	49028
May	0	930	0	31	0	49958
June	0	944	0	30	0	50902
July	0	932	0	31	0	51834
August	0	828	0	31	0	52662
September	0	768	0	30	0	53430
October	0	985	0	31	0	54415
November	0	1089	0	30	0	55504
December	0	1056	0	31	0	56560
Total	0	11533	0	365		

Year: 1982

Pool Name: BLANCO P. C. SOUTH (PRORATED GAS)

Month	Oil(BBLS)	Gas(MCF)	Water(BBLS)	Days Produced	Accum. Oil(BBLS)	Accum. Gas(MCF)
January	0	1055	0	31	0	57615
February	0	934	0	28	0	58549
March	0	994	0	31	0	59543
April	0	703	0	30	0	60246
May	0	1003	0	31	0	61249
June	0	1041	0	30	0	62290

July	0	690	0	31	0	62980
August	0	1010	0	31	0	63990
September	0	1125	0	30	0	65115
October	0	827	0	22	0	65942
November	0	0	0	0	0	65942
December	0	606	0	11	0	66548
Total	0	9988	0	306		

Year: 1983

Pool Name: BLANCO P. C. SOUTH (PRORATED GAS)

Month	Oil(BBLS)	Gas(MCF)	Water(BBLS)	Days Produced	Accum. Oil(BBLS)	Accum. Gas(MCF)
January	0	1211	0	31	0	67759
February	0	631	0	20	0	68390
March	0	0	0	0	0	68390
April	0	214	0	2	0	68604
May	0	1547	0	31	0	70151
June	0	1119	0	30	0	71270
July	0	1077	0	31	0	72347
August	0	1062	0	31	0	73409
September	0	904	0	24	0	74313
October	0	1085	0	30	0	75398
November	0	1123	0	30	0	76521
December	0	1027	0	31	0	77548
Total	0	11000	0	291		

Year: 1984

Pool Name: BLANCO P. C. SOUTH (PRORATED GAS)

Month	Oil(BBLS)	Gas(MCF)	Water(BBLS)	Days Produced	Accum. Oil(BBLS)	Accum. Gas(MCF)
January	0	1053	0	31	0	78601
February	0	1040	0	29	0	79641
March	0	968	0	23	0	80609
April	0	1018	0	30	0	81627
May	0	1049	0	31	0	82676
June	0	0	0	0	0	82676
July	0	295	0	4	0	82971
August	0	1154	0	22	0	84125
September	0	985	0	25	0	85110
October	0	1214	0	31	0	86324
November	0	1119	0	30	0	87443
December	0	1121	0	31	0	88564

Total 0 11016 0 287

Year: 1985

Pool Name: BLANCO P. C. SOUTH (PRORATED GAS)

Month	Oil(BBLS)	Gas(MCF)	Water(BBLS)	Days Produced	Accum. Oil(BBLS)	Accum. Gas(MCF)
January	0	1058	0	31	0	89622
February	0	967	0	28	0	90589
March	0	993	0	31	0	91582
April	0	924	0	30	0	92506
May	0	982	0	31	0	93488
June	0	547	0	14	0	94035
July	0	963	0	27	0	94998
August	0	1114	0	31	0	96112
September	0	890	0	99	0	97002
October	0	801	0	99	0	97803
November	0	830	0	99	0	98633
December	0	978	0	99	0	99611
Total	0	11047	0	223		

Year: 1986

Pool Name: BLANCO P. C. SOUTH (PRORATED GAS)

Month	Oil(BBLS)	Gas(MCF)	Water(BBLS)	Days Produced	Accum. Oil(BBLS)	Accum. Gas(MCF)
January	0	1027	0	99	0	100638
February	0	822	0	99	0	101460
March	0	944	0	99	0	102404
April	0	409	0	99	0	102813
May	0	0	0	99	0	102813
June	0	0	0	99	0	102813
July	0	0	0	99	0	102813
August	0	0	0	99	0	102813
September	0	0	0	99	0	102813
October	0	0	0	99	0	102813
November	0	0	0	99	0	102813
December	0	1112	0	99	0	103925
Total	0	4314	0	0		

Year: 1987

Pool Name: BLANCO P. C. SOUTH (PRORATED GAS)

Month	Oil(BBLS)	Gas(MCF)	Water(BBLS)	Days Produced	Accum. Oil(BBLS)	Accum. Gas(MCF)
January	0	870	0	99	0	104795
February						

	0	314	0	3	0	105109
March	0	0	0	0	0	105109
April	0	0	0	0	0	105109
May	0	0	0	0	0	105109
June	0	0	0	0	0	105109
July	0	0	0	0	0	105109
August	0	0	0	0	0	105109
September	0	0	0	0	0	105109
October	0	1457	0	19	0	106566
November	0	1462	0	30	0	108028
December	0	1276	0	31	0	109304
Total	0	5379	0	83		

Year: 1988

Pool Name: BLANCO P. C. SOUTH (PRORATED GAS)

Month	Oil(BBLS)	Gas(MCF)	Water(BBLS)	Days Produced	Accum. Oil(BBLS)	Accum. Gas(MCF)
January	0	1296	0	31	0	110600
February	0	1101	0	29	0	111701
March	0	1147	0	30	0	112848
April	0	741	0	22	0	113589
May	0	1055	0	30	0	114644
June	0	933	0	29	0	115577
July	0	646	0	18	0	116223
August	0	831	0	23	0	117054
September	0	903	0	30	0	117957
October	0	914	0	31	0	118871
November	0	40	0	1	0	118911
December	0	0	0	0	0	118911
Total	0	9607	0	274		

Year: 1989

Pool Name: BLANCO P. C. SOUTH (PRORATED GAS)

Month	Oil(BBLS)	Gas(MCF)	Water(BBLS)	Days Produced	Accum. Oil(BBLS)	Accum. Gas(MCF)
January	0	1253	0	28	0	120164
February	0	1055	0	28	0	121219
March	0	43	0	1	0	121262
April	0	1053	0	22	0	122315
May	0	878	0	24	0	123193
June	0	658	0	26	0	123851
July	0	783	0	31	0	124634

August	0	784	0	28	0	125418
September	0	778	0	26	0	126196
October	0	872	0	31	0	127068
November	0	848	0	30	0	127916
December	0	902	0	31	0	128818
Total	0	9907	0	306		

Year: 1990

Pool Name: BLANCO P. C. SOUTH (PRORATED GAS)

Month	Oil(BBLS)	Gas(MCF)	Water(BBLS)	Days Produced	Accum. Oil(BBLS)	Accum. Gas(MCF)
January	0	942	0	31	0	129760
February	0	837	0	28	0	130597
March	0	993	0	31	0	131590
April	0	881	0	30	0	132471
May	0	570	0	28	0	133041
June	0	0	0	0	0	133041
July	0	772	0	23	0	133813
August	0	688	0	29	0	134501
September	0	707	0	30	0	135208
October	0	763	0	31	0	135971
November	0	690	0	29	0	136661
December	0	12	0	31	0	136673
Total	0	7855	0	321		

Year: 1991

Pool Name: BLANCO P. C. SOUTH (PRORATED GAS)

Month	Oil(BBLS)	Gas(MCF)	Water(BBLS)	Days Produced	Accum. Oil(BBLS)	Accum. Gas(MCF)
January	0	415	0	31	0	137088
February	0	835	0	26	0	137923
March	0	759	0	31	0	138682
April	0	709	0	30	0	139391
May	0	714	0	31	0	140105
June	0	565	0	29	0	140670
July	0	443	0	26	0	141113
August	0	0	0	20	0	141113
September	0	0	0	2	0	141113
October	0	0	0	0	0	141113
November	0	0	0	9	0	141113
December	0	678	0	15	0	141791
Total	0	5118	0	250		

Year: 1992

Pool Name: BLANCO P. C. SOUTH (PRORATED GAS)

Month	Oil(BBLS)	Gas(MCF)	Water(BBLS)	Days Produced	Accum. Oil(BBLS)	Accum. Gas(MCF)
January	0	877	0	28	0	142668
February	0	18	0	1	0	142686
March	0	0	0	1	0	142686
April	0	1361	0	30	0	144047
May	0	1065	0	27	0	145112
June	0	918	0	30	0	146030
July	0	932	0	29	0	146962
August	0	851	0	26	0	147813
September	0	670	0	23	0	148483
October	0	841	0	31	0	149324
November	0	714	0	30	0	150038
December	0	1069	0	31	0	151107
Total	0	9316	0	287		

Year: 1993

Pool Name: BLANCO P. C. SOUTH (PRORATED GAS)

Month	Oil(BBLS)	Gas(MCF)	Water(BBLS)	Days Produced	Accum. Oil(BBLS)	Accum. Gas(MCF)
January	0	1007	0	31	0	152114
February	0	907	0	26	0	153021
March	0	602	0	31	0	153623
April	0	687	0	30	0	154310
May	0	779	0	31	0	155089
June	0	694	0	30	0	155783
July	0	720	0	31	0	156503
August	0	552	0	31	0	157055
September	0	564	0	30	0	157619
October	0	950	0	31	0	158569
November	0	908	0	30	0	159477
December	0	1068	0	31	0	160545
Total	0	9438	0	363		

Year: 1994

Pool Name: BLANCO P. C. SOUTH (PRORATED GAS)

Month	Oil(BBLS)	Gas(MCF)	Water(BBLS)	Days Produced	Accum. Oil(BBLS)	Accum. Gas(MCF)
January	0	556	0	31	0	161101
February	0	492	0	28	0	161593
March	0	505	0	31	0	162098
April						

	0	412	0	30	0	162510
May	0	434	0	31	0	162944
June	0	337	0	30	0	163281
July	0	420	0	31	0	163701
August	0	460	0	31	0	164161
September	0	356	0	30	0	164517
October	0	905	0	31	0	165422
November	0	867	0	30	0	166289
December	0	911	0	31	0	167200
Total	0	6655	0	365		

Year: 1995

Pool Name: BLANCO P. C. SOUTH (PRORATED GAS)

Month	Oil(BBLS)	Gas(MCF)	Water(BBLS)	Days Produced	Accum. Oil(BBLS)	Accum. Gas(MCF)
January	0	791	0	31	0	167991
February	0	775	0	28	0	168766
March	0	858	0	31	0	169624
April	0	812	0	30	0	170436
May	0	755	0	31	0	171191
June	0	860	0	30	0	172051
July	0	888	0	31	0	172939
August	0	854	0	31	0	173793
September	0	670	0	30	0	174463
October	0	828	0	31	0	175291
November	0	841	0	30	0	176132
December	0	710	0	31	0	176842
Total	0	9642	0	365		

Year: 1996

Pool Name: BLANCO P. C. SOUTH (PRORATED GAS)

Month	Oil(BBLS)	Gas(MCF)	Water(BBLS)	Days Produced	Accum. Oil(BBLS)	Accum. Gas(MCF)
January	0	934	0	31	0	177776
February	0	802	0	29	0	178578
March	0	890	0	31	0	179468
April	0	831	0	30	0	180299
May	0	813	0	31	0	181112
June	0	796	0	30	0	181908
July	0	739	0	31	0	182647
August	0	794	0	31	0	183441
September	0	638	0	24	0	184079

October	0	909	0	31	0	184988
November	0	900	0	30	0	185888
December	0	901	0	31	0	186789
Total	0	9947	0	360		

Year: 1997

Pool Name: BLANCO P. C. SOUTH (PRORATED GAS)

Month	Oil(BBLS)	Gas(MCF)	Water(BBLS)	Days Produced	Accum. Oil(BBLS)	Accum. Gas(MCF)
January	0	835	0	31	0	187624
February	0	765	0	28	0	188389
March	0	823	0	31	0	189212
April	0	718	0	30	0	189930
May	0	853	0	31	0	190783
June	0	633	0	27	0	191416
July	0	0	0	23	0	191416
August	0	1075	0	26	0	192491
September	0	1023	0	30	0	193514
October	0	1048	0	31	0	194562
November	0	960	0	30	0	195522
December	0	997	0	31	0	196519
Total	0	9730	0	349		

Year: 1998

Pool Name: BLANCO P. C. SOUTH (PRORATED GAS)

Month	Oil(BBLS)	Gas(MCF)	Water(BBLS)	Days Produced	Accum. Oil(BBLS)	Accum. Gas(MCF)
January	0	966	0	31	0	197485
February	0	709	0	28	0	198194
March	0	870	0	31	0	199064
April	0	824	0	30	0	199888
May	0	804	0	31	0	200692
June	0	724	0	30	0	201416
July	0	694	0	31	0	202110
August	0	399	0	31	0	202509
September	0	603	0	30	0	203112
October	0	507	0	31	0	203619
November	0	702	0	30	0	204321
December	0	798	0	31	0	205119
Total	0	8600	0	365		

Year: 1999

Pool Name: BLANCO P. C. SOUTH (PRORATED GAS)

Month	Oil(BBLS)	Gas(MCF)	Water(BBLS)	Days Produced	Accum. Oil(BBLS)	Accum. Gas(MCF)
January	0	850	0	31	0	205969
February	0	651	0	28	0	206620
March	0	637	0	31	0	207257
April	0	561	0	30	0	207818
May	0	551	0	31	0	208369
June	0	454	0	30	0	208823
July	0	298	0	31	0	209121
August	0	557	0	31	0	209678
September	0	452	0	30	0	210130
October	0	4	0	1	0	210134
November	0	0	0	30	0	210134
December	0	0	0	31	0	210134
Total	0	5015	0	335		

Year: 2000

Pool Name: BLANCO P. C. SOUTH (PRORATED GAS)

Month	Oil(BBLS)	Gas(MCF)	Water(BBLS)	Days Produced	Accum. Oil(BBLS)	Accum. Gas(MCF)
January	0	906	0	20	0	211040
February	0	867	0	29	0	211907
March	0	516	0	26	0	212423
April	0	0	0	0	0	212423
May	0	0	0	0	0	212423
June	0	0	0	0	0	212423
July	0	0	0	0	0	212423
August	0	0	0	0	0	212423
September	0	0	0	0	0	212423
October	0	139	0	31	0	212562
November	0	0	0	0	0	212562
December	0	0	0	0	0	212562
Total	0	2428	0	106		

Year: 2001

Pool Name: BLANCO P. C. SOUTH (PRORATED GAS)

Month	Oil(BBLS)	Gas(MCF)	Water(BBLS)	Days Produced	Accum. Oil(BBLS)	Accum. Gas(MCF)
January	0	0	0	0	0	212562
February	0	0	0	0	0	212562
March	0	0	0	0	0	212562
April	0	0	0	0	0	212562
May	0	0	0	0	0	212562
June	0	0	0	0	0	212562

July	0	0	0	0	0	212562
August	0	0	0	0	0	212562
September	0	0	0	0	0	212562
October	0	0	0	0	0	212562
November	0	0	0	0	0	212562
December	0	0	0	0	0	212562
Total	0	0	0	0		

Year: 2002

Pool Name: BLANCO P. C. SOUTH (PRORATED GAS)

Month	Oil(BBLS)	Gas(MCF)	Water(BBLS)	Days Produced	Accum. Oil(BBLS)	Accum. Gas(MCF)
January	0	0	0	0	0	212562
February	0	0	0	0	0	212562
March	0	0	0	0	0	212562
April	0	0	0	0	0	212562
May	0	0	0	0	0	212562
June	0	0	0	0	0	212562
July	0	0	0	0	0	212562
August	0	0	0	0	0	212562
September	0	0	50	0	0	212562
October	0	0	0	0	0	212562
November	0	0	0	0	0	212562
December	0	0	0	0	0	212562
Total	0	0	50	0		

Year: 2003

Pool Name: BLANCO P. C. SOUTH (PRORATED GAS)

Month	Oil(BBLS)	Gas(MCF)	Water(BBLS)	Days Produced	Accum. Oil(BBLS)	Accum. Gas(MCF)
January	0	0	0	0	0	212562
February	0	0	0	0	0	212562
March	0	0	0	0	0	212562
April	0	0	0	0	0	212562
May	0	0	0	0	0	212562
June	0	0	0	0	0	212562
July	0	0	0	0	0	212562
August	0	0	0	0	0	212562
September	0	0	0	0	0	212562
October	0	0	0	0	0	212562
November	0	0	0	0	0	212562
December	0	0	0	0	0	212562

Total	0	0	0	0
-------	---	---	---	---

Year: 2004

Pool Name: BLANCO P. C. SOUTH (PRORATED GAS)

Month	Oil(BBLS)	Gas(MCF)	Water(BBLS)	Days Produced	Accum. Oil(BBLS)	Accum. Gas(MCF)
January	0	0	0	0	0	212562
February	0	0	0	0	0	212562
March	0	0	0	0	0	212562
April	0	0	0	0	0	212562
May	0	0	0	0	0	212562
June	0	0	0	0	0	212562
July	0	0	0	0	0	212562
August	0	0	0	0	0	212562
September	0	0	0	0	0	212562
October	0	0	0	0	0	212562
November	0	0	0	0	0	212562
December	0	0	0	0	0	212562
Total	0	0	0	0		

Page last updated 07/22/2004. Webmaster gotech_prrc@yahoo.com