

DATE 5/19/03	SUSPENSE NA	ENGINEER DC	LOGGED IN MN	TYPE DHC	APP NO AKR0314031323
---------------------	--------------------	--------------------	---------------------	-----------------	-----------------------------

ABOVE THIS LINE FOR DIVISION USE ONLY

NEW MEXICO OIL CONSERVATION DIVISION
- Engineering Bureau -
1220 South St. Francis Drive, Santa Fe, NM 87505



319

ADMINISTRATIVE APPLICATION CHECKLIST

THIS CHECKLIST IS MANDATORY FOR ALL ADMINISTRATIVE APPLICATIONS FOR EXCEPTIONS TO DIVISION RULES AND REGULATIONS WHICH REQUIRE PROCESSING AT THE DIVISION LEVEL IN SANTA FE

Application Acronyms:

[NSL-Non-Standard Location] [NSP-Non-Standard Proration Unit] [SD-Simultaneous Dedication]
[DHC-Downhole Commingling] [CTB-Lease Commingling] [PLC-Pool/Lease Commingling]
[PC-Pool Commingling] [OLS - Off-Lease Storage] [OLM-Off-Lease Measurement]
[WFX-Waterflood Expansion] [PMX-Pressure Maintenance Expansion]
[SWD-Salt Water Disposal] [IPI-Injection Pressure Increase]
[EOR-Qualified Enhanced Oil Recovery Certification] [PPR-Positive Production Response]

- [1] **TYPE OF APPLICATION** - Check Those Which Apply for [A]
 [A] Location - Spacing Unit - Simultaneous Dedication
☐ NSL ☐ NSP ☐ SD
 Check One Only for [B] or [C]
 [B] Commingling - Storage - Measurement
☒ DHC ☐ CTB ☐ PLC ☐ PC ☐ OLS ☐ OLM
 [C] Injection - Disposal - Pressure Increase - Enhanced Oil Recovery
☐ WFX ☐ PMX ☐ SWD ☐ IPI ☐ EOR ☐ PPR
 [D] Other: Specify _____

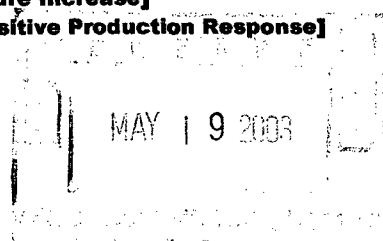

- [2] **NOTIFICATION REQUIRED TO:** - Check Those Which Apply, or Does Not Apply
 [A] ☐ Working, Royalty or Overriding Royalty Interest Owners
 [B] ☐ Offset Operators, Leaseholders or Surface Owner
 [C] ☐ Application is One Which Requires Published Legal Notice
 [D] ☐ Notification and/or Concurrent Approval by BLM or SLO
 U.S. Bureau of Land Management - Commissioner of Public Lands, State Land Office
 [E] ☐ For all of the above, Proof of Notification or Publication is Attached, and/or,
 [F] ☐ Waivers are Attached

- [3] **SUBMIT ACCURATE AND COMPLETE INFORMATION REQUIRED TO PROCESS THE TYPE OF APPLICATION INDICATED ABOVE.**

- [4] **CERTIFICATION:** I hereby certify that the information submitted with this application for administrative approval is **accurate** and **complete** to the best of my knowledge. I also understand that **no action** will be taken on this application until the required information and notifications are submitted to the Division.

Note: Statement must be completed by an individual with managerial and/or supervisory capacity.

James M. Hill
Print or Type Name

Signature

Operations Engineer
Title

5/15/03
Date

c-mail Address

District I
1625 N. French Drive, Hobbs, NM 88240

District II
811 South First Street, Artesia, NM 88210

District III
1000 Rio Brazos Road, Aztec, NM 87410

District IV
2040 South Pacheco, Santa Fe, NM 87505

State of New Mexico
Energy, Minerals and Natural Resources Department

Form C-107A
Revised May 15, 2000

OIL CONSERVATION DIVISION

2040 South Pacheco
Santa Fe, New Mexico 87505

APPLICATION TYPE

☒ Single Well
☐ Establish Pre-Approved Pools
EXISTING WELLBORE
☒ Yes ☐ No

APPLICATION FOR DOWNHOLE COMMINGLING

Yates Petroleum Corporation 105 South Fourth Street Artesia, New Mexico 88210
Operator Address

Louise AYL 1 I 25 21S 26E Eddy
Lease Well No. Unit Letter-Section-Township-Range County

OGRID No. 025575 Property Code API No. 30-015-31625 Lease Type: Federal State ☒ Fee

DATA ELEMENT	UPPER ZONE	INTERMEDIATE ZONE	LOWER ZONE
Pool Name	Wildcat Strawn <i>Und. Northeast Hggs</i>	Wildcat Atoka <i>Und. Pioneer Bluff Atoka</i>	<i>Und.</i> Burton Flat Morrow
Pool Code	<i>Vally Strawn 78075</i>		<i>73280</i>
Top and Bottom of Pay Section (Perforated or Open-Hole Interval)	10054-10184'	10484-10490' 10722-10858'	11342-11414' 11444-11470'
Method of Production (Flowing or Artificial Lift)	Flowing		Flowing
Bottomhole Pressure (Note: Pressure data will not be required if the bottom perforation in the lower zone is within 150% of the depth of the top perforation in the upper zone)	N/A		N/A
Oil Gravity or Gas BTU (Degree API or Gas BTU)			
Producing, Shut-In or New Zone	New Zone	New Zone	New Zone
Date and Oil/Gas/Water Rates of Last Production. (Note: For new zones with no production history, applicant shall be required to attach production estimates and supporting data.)	Date: Rates: Not Yet Completed. A fixed percentage allocation formula based on actual production rates will be submitted for approval after testing	Date: Rates: Not Yet Completed. A fixed percentage allocation formula based on actual production rates will be submitted for approval after testing	Date: Rates: Not Yet Completed. A fixed percentage allocation formula based on actual production rates will be submitted for approval after testing
Fixed Allocation Percentage (Note: If allocation is based upon something other than current or past production, supporting data or explanation will be required.)	Oil Gas %	Oil Gas %	Oil Gas %

ADDITIONAL DATA

Are all working, royalty and overriding royalty interests identical in all commingled zones? Yes ☒ No ☐
If not, have all working, royalty and overriding royalty interest owners been notified by certified mail? Yes ☐ No ☐

Are all produced fluids from all commingled zones compatible with each other? Yes ☒ No ☐

Will commingling decrease the value of production? Yes ☐ No ☒

If this well is on, or communitized with, state or federal lands, has either the Commissioner of Public Lands or the United States Bureau of Land Management been notified in writing of this application? Yes ☐ No ☐

NMOCD Reference Case No. applicable to this well: _____

Attachments:
C-102 for each zone to be commingled showing its spacing unit and acreage dedication.
Production curve for each zone for at least one year. (If not available, attach explanation.)
For zones with no production history, estimated production rates and supporting data.
Data to support allocation method or formula.
Notification list of working, royalty and overriding royalty interests for uncommon interest cases.
Any additional statements, data or documents required to support commingling.

PRE-APPROVED POOLS

If application is to establish Pre-Approved Pools, the following additional information will be required:
List of other orders approving downhole commingling within the proposed Pre-Approved Pools
List of all operators within the proposed Pre-Approved Pools
Proof that all operators within the proposed Pre-Approved Pools were provided notice of this application.
Bottomhole pressure data.

I hereby certify that the information above is true and complete to the best of my knowledge and belief.

SIGNATURE *James M. Hill* TITLE Operations Engineer DATE May 14, 2003
TYPE OR PRINT NAME James M. Hill TELEPHONE NO. (505)-748-4129

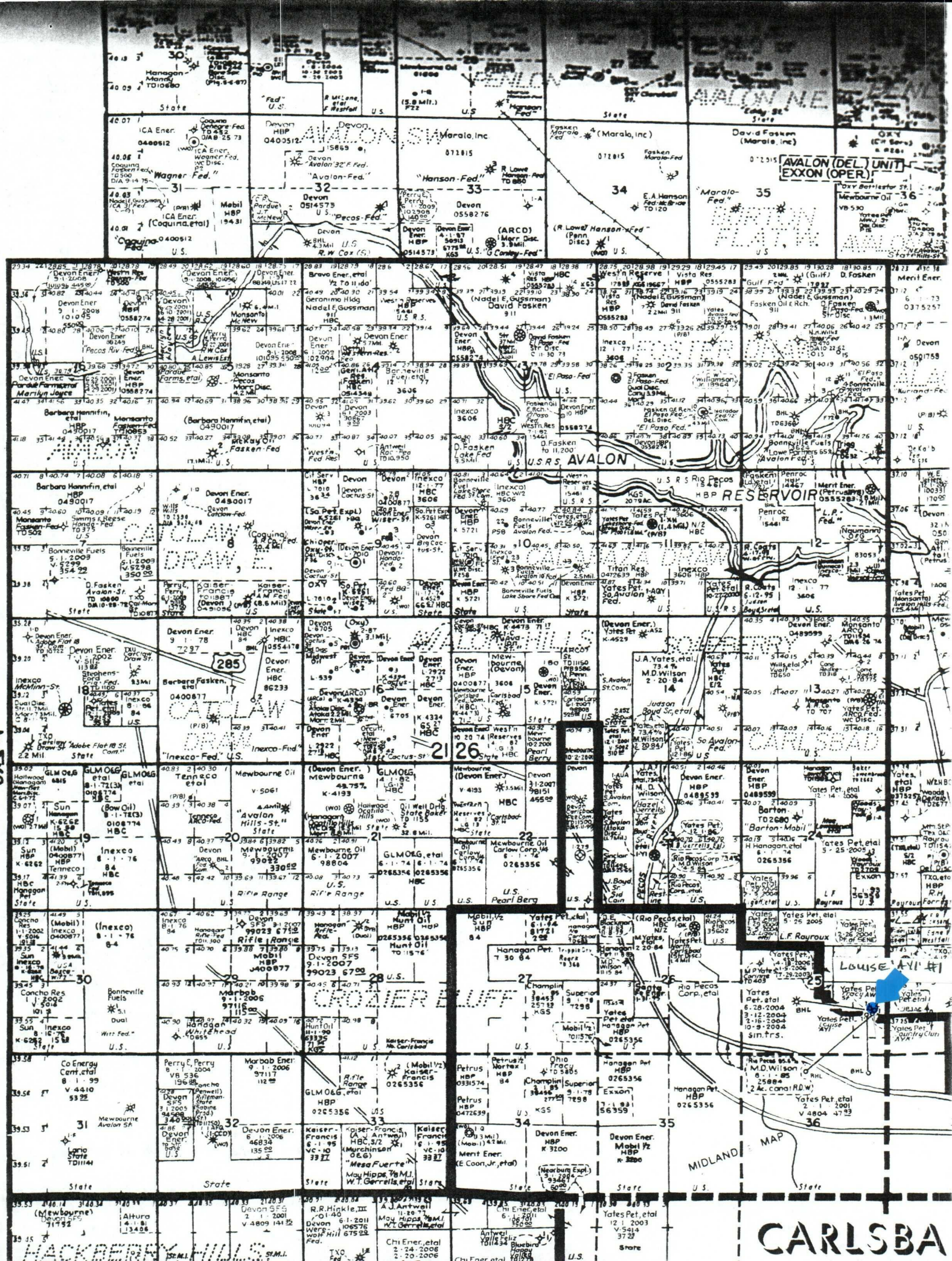

MARTIN YATES, III
1912 - 1985
FRANK W. YATES
1936 - 1986



105 SOUTH FOURTH STREET
ARTESIA, NEW MEXICO 88210-2118
TELEPHONE (505) 748-1471

S. P. YATES
CHAIRMAN OF THE BOARD
JOHN A. YATES
PRESIDENT
PEYTON YATES
EXECUTIVE VICE PRESIDENT
RANDY G. PATTERSON
SECRETARY
DENNIS G. KINSEY
TREASURER

May 14, 2003

David Catanach
State of New Mexico
OIL CONSERVATION DIVISION
1220 South Saint Francis Drive
Santa Fe, NM 87505

Dear Mr. Catanach,

Yates Petroleum Corporation hereby seeks administrative approval to downhole commingle the production from the Burton Flat Morrow the Wildcat Atoka and the Wildcat Strawn pools in our Louise AYI #1 located in Unit I of Section 25, Township 21 South, Range 26 East, Eddy County.

If you have any questions or need additional information, please call me at (505) 748-4129

Sincerely,

James M. Hill
Operations Engineer

JMH/cm

Enclosures

MARTIN YATES, III
1912 - 1985
FRANK W. YATES
1936 - 1986



105 SOUTH FOURTH STREET
ARTESIA, NEW MEXICO 88210-2118
TELEPHONE (505) 748-1471

S. P. YATES
CHAIRMAN OF THE BOARD
JOHN A. YATES
PRESIDENT
PEYTON YATES
EXECUTIVE VICE PRESIDENT
RANDY G. PATTERSON
SECRETARY
DENNIS G. KINSEY
TREASURER

May 14, 2003

Tim Gum
State of New Mexico
OIL CONSERVATION DIVISION
811 S. First Street
Artesia, NM 88210

Dear Mr. Gum,

Yates Petroleum Corporation hereby seeks administrative approval to downhole commingle the production from the Burton Flat Morrow the Wildcat Atoka and the Wildcat Strawn pools in our Louise AYI #1 located in Unit I of Section 25, Township 21 South, Range 26 East, Eddy County.

If you have any questions or need additional information, please call me at (505) 748-4129.

Thank you.

Sincerely,

A handwritten signature in black ink, appearing to read 'James M. Hill', written in a cursive style.

James M. Hill
Operations Engineer

JMH/cm

Enclosures

MARTIN YATES, III
1912 - 1985
FRANK W. YATES
1936 - 1986



105 SOUTH FOURTH STREET
ARTESIA, NEW MEXICO 88210-2118
TELEPHONE (505) 748-1471

S. P. YATES
CHAIRMAN OF THE BOARD
JOHN A. YATES
PRESIDENT
PEYTON YATES
EXECUTIVE VICE PRESIDENT
RANDY G. PATTERSON
SECRETARY
DENNIS G. KINSEY
TREASURER

May 14, 2003

Armando Lopez
Bureau of Land Management
2909 2nd Street
Roswell, New Mexico 88201

Dear Mr. Lopez

Yates Petroleum Corporation hereby seeks administrative approval to downhole commingle the production from the Burton Flat Morrow the Wildcat Atoka and the Wildcat Strawn pools in our Louise AYI #1 located in Unit I of Section 25, Township 21 South, Range 26 East, Eddy County.

If you have any questions please feel free to contact me at (505) 748-4129.

Sincerely

James M. Hill
Operations Engineer

JMH/cm

Enclosure

District I
1625 N. French Dr., Hobbs, NM 88240

State of New Mexico
Energy, Minerals & Natural Resources Department

Form C-102
Revised August 15, 2000

District II
811 South First, Artesia, NM 88210

OIL CONSERVATION DIVISION
1220 South St. Francis Dr.
Santa Fe, NM 87505

Submit to Appropriate District Office
State Lease - 4 Copies
Fee Lease - 3 Copies

District III
1000 Rio Brazos Rd., Aztec, NM 87410

District IV
1220 S. St. Francis Dr., Santa Fe, NM 87505

☐ AMENDED REPORT

WELL LOCATION AND ACREAGE DEDICATION PLAT

¹ API Number 30-015-31625	³ Pool Name Wildcat Strawn	
⁴ Property Code	⁵ Property Name Louise "AYI" (Fee)	⁶ Well Number 1
⁷ OGRID No. 025575	⁸ Operator Name Yates Petroleum Corporation	⁹ Elevation 3127'

¹⁰ Surface Location

UL or lot no.	Section	Township	Range	Lot Idn	Feet from the	North/South line	Feet from the	East/West line	County
I	25	21S	26E		1859	South	660	East	Eddy

¹¹ Bottom Hole Location If Different From Surface

UL or lot no.	Section	Township	Range	Lot Idn	Feet from the	North/South line	Feet from the	East/West line	County
---------------	---------	----------	-------	---------	---------------	------------------	---------------	----------------	--------

¹² Dedicated Acres 320	¹³ Joint or Infill	¹⁴ Consolidation Code	¹⁵ Order No.
---	-------------------------------	----------------------------------	-------------------------

NO ALLOWABLE WILL BE ASSIGNED TO THIS COMPLETION UNTIL ALL INTERESTS HAVE BEEN CONSOLIDATED OR A NON-STANDARD UNIT HAS BEEN APPROVED BY THE DIVISION

			17 OPERATOR CERTIFICATION <i>I hereby certify that the information contained herein is true and complete to the best of my knowledge and belief.</i>  Signature Cherry Matchus Printed Name Engineering Technician Title 5/14/03 Date
			18 SURVEYOR CERTIFICATION <i>I hereby certify that the well location shown on this plat was plotted from field notes of actual surveys made by me or under my supervision, and that the same is true and correct to the best of my belief.</i>
		FEE	Date of Survey Signature and Seal of Professional Surveyor:
			Certificate Number

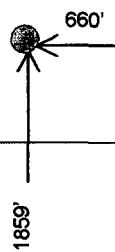

The Wildcat Strawn is a new zone and production curves are not available.

District I
1625 N. French Dr., Hobbs, NM 88240

State of New Mexico
Energy, Minerals & Natural Resources Department

Form C-102
Revised August 15, 2000

District II
811 South First, Artesia, NM 88210

OIL CONSERVATION DIVISION
1220 South St. Francis Dr.
Santa Fe, NM 87505

Submit to Appropriate District Office

State Lease - 4 Copies

Fee Lease - 3 Copies

District III
1000 Rio Brazos Rd., Aztec, NM 87410

District IV
1220 S. St. Francis Dr., Santa Fe, NM 87505

☐ AMENDED REPORT

WELL LOCATION AND ACREAGE DEDICATION PLAT

¹ API Number 30-015-31625	² Pool Code	³ Pool Name Wildcat Atoka
⁴ Property Code	⁵ Property Name Louise "AYI" (Fee)	⁶ Well Number 1
⁷ OGRID No. 025575	⁸ Operator Name Yates Petroleum Corporation	⁹ Elevation 3127'

¹⁰ Surface Location

UL or lot no.	Section	Township	Range	Lot Idn	Feet from the	North/South line	Feet from the	East/West line	County
I	25	21S	26E		1859	South	660	East	Eddy

¹¹ Bottom Hole Location If Different From Surface

UL or lot no.	Section	Township	Range	Lot Idn	Feet from the	North/South line	Feet from the	East/West line	County

¹² Dedicated Acres 320	¹³ Joint or Infill	¹⁴ Consolidation Code	¹⁵ Order No.
---	-------------------------------	----------------------------------	-------------------------

NO ALLOWABLE WILL BE ASSIGNED TO THIS COMPLETION UNTIL ALL INTERESTS HAVE BEEN CONSOLIDATED OR A NON-STANDARD UNIT HAS BEEN APPROVED BY THE DIVISION

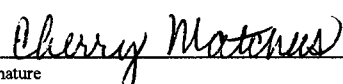
				¹⁷ OPERATOR CERTIFICATION <i>I hereby certify that the information contained herein is true and complete to the best of my knowledge and belief.</i>  Signature Cherry Matchus Printed Name Engineering Technician Title 5/14/03 Date
		FEE		¹⁸ SURVEYOR CERTIFICATION <i>I hereby certify that the well location shown on this plat was plotted from field notes of actual surveys made by me or under my supervision, and that the same is true and correct to the best of my belief.</i> Date of Survey Signature and Seal of Professional Surveyor: Certificate Number



The Wildcat Atoka is a new zone and production curves are not available.

District I

1625 N. French Dr., Hobbs, NM 88240

District II

811 South First, Artesia, NM 88210

District III

1000 Rio Brazos Rd., Aztec, NM 87410

District IV

1220 S. St. Francis Dr., Santa Fe, NM 87505

State of New Mexico
Energy, Minerals & Natural Resources Department

Form C-102

Revised August 15, 2000

OIL CONSERVATION DIVISION

1220 South St. Francis Dr.
Santa Fe, NM 87505

Submit to Appropriate District Office

State Lease - 4 Copies

Fee Lease - 3 Copies

☐ AMENDED REPORT

WELL LOCATION AND ACREAGE DEDICATION PLAT

¹ API Number 30-015-31625	² Pool Code	³ Pool Name Burton Flat Morrow
⁴ Property Code	⁵ Property Name Louise "AYI" (Fee)	⁶ Well Number 1
⁷ OGRID No. 025575	⁸ Operator Name Yates Petroleum Corporation	⁹ Elevation 3127'

¹⁰ Surface Location

UL or lot no.	Section	Township	Range	Lot Idn	Feet from the	North/South line	Feet from the	East/West line	County
I	25	21S	26E		1859	South	660	East	Eddy

¹¹ Bottom Hole Location If Different From Surface

UL or lot no.	Section	Township	Range	Lot Idn	Feet from the	North/South line	Feet from the	East/West line	County

¹² Dedicated Acres 320	¹³ Joint or Infill	¹⁴ Consolidation Code	¹⁵ Order No.
---	-------------------------------	----------------------------------	-------------------------

NO ALLOWABLE WILL BE ASSIGNED TO THIS COMPLETION UNTIL ALL INTERESTS HAVE BEEN CONSOLIDATED OR A
NON-STANDARD UNIT HAS BEEN APPROVED BY THE DIVISION

	FEE	¹⁷ OPERATOR CERTIFICATION I hereby certify that the information contained herein is true and complete to the best of my knowledge and belief. Signature Cherry Matchus Printed Name Engineering Technician Title 5/14/03 Date
		¹⁸ SURVEYOR CERTIFICATION I hereby certify that the well location shown on this plat was plotted from field notes of actual surveys made by me or under my supervision, and that the same is true and correct to the best of my belief.
		Date of Survey Signature and Seal of Professional Surveyor: Certificate Number

The Burton Flat Morrow is a new zone and production curves are not available.