

DATE IN: 5.25.11	SUSPENSE	ENGINEER: RE	LOGGED IN: 5.25.11	TYPE: CTB	APP NO: 1114546203
------------------	----------	--------------	--------------------	-----------	--------------------

ABOVE THIS LINE FOR DIVISION USE ONLY

# NEW MEXICO OIL CONSERVATION DIVISION

- Engineering Bureau -

1220 South St. Francis Drive, Santa Fe, NM 87505



Mewbourne  
14744  
Red Wells 21 Fed/Gm #44  
30-025-40156

## ADMINISTRATIVE APPLICATION CHECKLIST

THIS CHECKLIST IS MANDATORY FOR ALL ADMINISTRATIVE APPLICATIONS FOR EXCEPTIONS TO DIVISION RULES AND REGULATIONS WHICH REQUIRE PROCESSING AT THE DIVISION LEVEL IN SANTA FE

### Application Acronyms:

[NSL-Non-Standard Location] [NSP-Non-Standard Proration Unit] [SD-Simultaneous Dedication]  
[DHC-Downhole Commingling] [CTB-Lease Commingling] [PLC-Pool/Lease Commingling]  
[PC-Pool Commingling] [OLS - Off-Lease Storage] [OLM-Off-Lease Measurement]  
[WFX-Waterflood Expansion] [PMX-Pressure Maintenance Expansion]  
[SWD-Salt Water Disposal] [IPI-Injection Pressure Increase]  
[EOR-Qualified Enhanced Oil Recovery Certification] [PPR-Positive Production Response]

### [1] TYPE OF APPLICATION - Check Those Which Apply for [A]

[A] Location - Spacing Unit - Simultaneous Dedication  
☐ NSL ☐ NSP ☐ SD

Check One Only for [B] or [C]

[B] Commingling - Storage - Measurement  
☐ DHC ☒ CTB ☐ PLC ☐ PC ☐ OLS ☐ OLM

[C] Injection - Disposal - Pressure Increase - Enhanced Oil Recovery  
☐ WFX ☐ PMX ☐ SWD ☐ IPI ☐ EOR ☐ PPR

[D] Other: Specify \_\_\_\_\_

Lea, Fed

### [2] NOTIFICATION REQUIRED TO: - Check Those Which Apply, or ☐ Does Not Apply

[A] ☒ Working, Royalty or Overriding Royalty Interest Owners  
[B] ☐ Offset Operators, Leaseholders or Surface Owner  
[C] ☐ Application is One Which Requires Published Legal Notice  
[D] ☒ Notification and/or Concurrent Approval by BLM or SLO  
U.S. Bureau of Land Management - Commissioner of Public Lands, State Land Office  
[E] ☒ For all of the above, Proof of Notification or Publication is Attached, and/or,  
[F] ☐ Waivers are Attached

### [3] SUBMIT ACCURATE AND COMPLETE INFORMATION REQUIRED TO PROCESS THE TYPE OF APPLICATION INDICATED ABOVE.

[4] **CERTIFICATION:** I hereby certify that the information submitted with this application for administrative approval is **accurate** and **complete** to the best of my knowledge. I also understand that **no action** will be taken on this application until the required information and notifications are submitted to the Division.

Note: Statement must be completed by an individual with managerial and/or supervisory capacity.

Robin Terrell  
Print or Type Name

Signature

SR Production Engineer 04/11/11  
Title Date

rterrell@mewbourne.com  
e-mail Address

MEWBOURNE OIL COMPANY  
PO BOX 5270  
HOBBS, NM 88240  
575-393-5905 FAX 575-397-6252

OLD  
RECEIVED OCD  
2011 MAY 25 A 9:52

April 15, 2011

Engineering Bureau  
New Mexico Oil Conservation Division  
1220 S. St. Francis Drive  
Santa Fe, NM 87505

Bureau Of Land Management  
Attn: Duncan Whitlock  
620 E Green Street  
Carlsbad, NM 88220

RE: Surface Commingle of Federal Leases

To: Whom It May Concern

Mewbourne Oil Co is requesting permission to surface commingle the following wells.

Red Hills West "21" Fed Com # 1H located at 330' FNL & 950' FEL, Sec 21, R26S, T32E, Lea Co.

✓ (API # 30-025- ) with our existing tank battery on our Red Hills West "22" Fed Com # 1H

✓ (API # 30-025-39901) located at 380' FNL & 380' FWL, Sec 22, R26S, T32E, Leo Co.

These wells will have different overriding royalty and working interest but the same federal lease numbers

Please find the following enclosed:

- Sundry Notice of intent
- Copy of Form C107B submitted to NMOCD
- Site diagram of production facility with pictures
- Spreadsheet showing leases production & fluid characteristics
- Explanation of testing procedure
- Explanation of why commingle is needed (economics & footprint)
- Form C-102 for leases
- Map showing entire section and corresponding leases
- Administrative Application Checklist
- Letter Head statement on how com will not lower value of reserves
- Letter Head Statement on how all parties have been notified
- List of all involved parties

Copy of letter that was sent certified mail to all involved parties informing them of proposed surface commingle.

Mewbourne Oil Company would appreciate this commingle request being processed as soon as possible. If you need further information, please call me at (575) 390-4816.

Thank you,

A handwritten signature in black ink, appearing to read 'Robin Terrell', with a stylized, cursive script.

Robin Terrell  
SR Production Engineer

UNITED STATES  
DEPARTMENT OF THE INTERIOR  
BUREAU OF LAND MANAGEMENT

**SUNDRY NOTICES AND REPORTS ON WELLS**  
*Do not use this form for proposals to drill or to re-enter an abandoned well. Use Form 3160-3 (APD) for such proposals.*

FORM APPROVED  
OMB No. 1004-0135  
Expires: January 31, 2004

5. Lease Serial No.
NM-27507
6. If Indian, Allottee or Tribe Name
7. If Unit or CA/Agreement, Name and/or No.
8. Well Name and No.
Red Hills West 21 Fed Com #1H
9. API Well No.
10. Field and Pool, or Exploratory Area
Wildcat Bone Springs
11. County or Parish, State
Lea County, NM

<b>SUBMIT IN TRIPLICATE - Other Instructions on reverse side</b>	
1. Type of Well <input checked="" type="checkbox"/> Oil Well <input type="checkbox"/> Gas Well <input type="checkbox"/> Other	
2. Name of Operator Mewbourne Oil Company   14744	
3a. Address PO Box 5270   Hobbs, NM 88241	3b. Phone No. (include area code) 575-393-5905
4. Location of Well (Footage, Sec., T, R., M., or Survey Description)  330' FNL & 950' FEL, Sec 21-T26S-R32E   Unit Letter A	

12. CHECK APPROPRIATE BOX(ES) TO INDICATE NATURE OF NOTICE, REPORT, OR OTHER DATA

TYPE OF SUBMISSION	TYPE OF ACTION			
<input checked="" type="checkbox"/> Notice of Intent	<input type="checkbox"/> Acidize	<input type="checkbox"/> Deepen	<input type="checkbox"/> Production (Start/Resume)	<input type="checkbox"/> Water Shut-Off
<input type="checkbox"/> Subsequent Report	<input type="checkbox"/> Alter Casing	<input type="checkbox"/> Fracture Treat	<input type="checkbox"/> Reclamation	<input type="checkbox"/> Well Integrity
<input type="checkbox"/> Final Abandonment Notice	<input type="checkbox"/> Casing Repair	<input type="checkbox"/> New Construction	<input type="checkbox"/> Recomplete	<input checked="" type="checkbox"/> Other <u>Surface Commingle</u>
	<input type="checkbox"/> Change Plans	<input type="checkbox"/> Plug and Abandon	<input type="checkbox"/> Temporarily Abandon	<u>production</u>
	<input type="checkbox"/> Convert to Injection	<input type="checkbox"/> Plug Back	<input type="checkbox"/> Water Disposal	

3. Describe Proposed or Completed Operation (clearly state all pertinent details, including estimated starting date of any proposed work and approximate duration thereof. If the proposal is to deepen directionally or recompleate horizontally, give subsurface locations and measured and true vertical depths of all pertinent markers and zones. Attach the Bond under which the work will be performed or provide the Bond No. on file with BLM/BIA. Required subsequent reports shall be filed within 30 days following completion of the involved operations. If the operation results in a multiple completion or recompleation in a new interval, a Form 3160-4 shall be filed once testing has been completed. Final Abandonment Notices shall be filed only after all requirements, including reclamation, have been completed, and the operator has determined that the site is ready for final inspection.)

Mewbourne requests permission to surface commingle production from the above captioned well into our existing tank battery on our Red Hills West 22 Fed Com #1H (API 30-025-39901). Consider with following attachments.

14. I hereby certify that the foregoing is true and correct	
Name (Printed/Typed) Jackie Lathan	Title   Hobbs Regulatory
Signature 	Date   04/14/11

THIS SPACE FOR FEDERAL OR STATE OFFICE USE

Approved by (Signature)  Conditions of approval, if any, are attached. Approval of this notice does not warrant or certify that the applicant holds legal or equitable title to those rights in the subject lease which would entitle the applicant to conduct operations thereon.	Name (Printed/Typed)	Title
	Office	Date

Title 18 U.S.C. Section 1001 and Title 43 U.S.C. Section 1212, make it a crime for any person knowingly and willfully to make to any department or agency of the United States any false, fictitious or fraudulent statements or representations as to any matter within its jurisdiction.

(Continued on next page)

District I  
1625 N. French Drive, Hobbs, NM 88240  
District II  
1301 W Grand Ave, Artesia, NM 88210  
District III  
1000 Rio Brazos Road, Aztec, NM 87410  
District IV  
1220 S St Francis Dr, Santa Fe, NM  
87505

State of New Mexico  
Energy, Minerals and Natural Resources Department

Form C-107-B  
Revised June 10, 2003

**OIL CONSERVATION DIVISION**

1220 S. St Francis Drive  
Santa Fe, New Mexico 87505

Submit the original  
application to the Santa Fe  
office with one copy to the  
appropriate District Office.

**APPLICATION FOR SURFACE COMMINGLING (DIVERSE OWNERSHIP)**

OPERATOR NAME: Mewbourne Oil Company

OPERATOR ADDRESS: PO Box 5270, Hobbs, NM 88241

APPLICATION TYPE:

☐ Pool Commingling ☒ Lease Commingling ☐ Pool and Lease Commingling ☐ Off-Lease Storage and Measurement (Only if not Surface Commingled)

LEASE TYPE: ☐ Fee ☐ State ☒ Federal

Is this an Amendment to existing Order? ☐ Yes ☒ No If "Yes", please include the appropriate Order No. \_\_\_\_\_

Have the Bureau of Land Management (BLM) and State Land office (SLO) been notified in writing of the proposed commingling ☒ Yes ☐ No  
Fee surface & minerals

**(A) POOL COMMINGLING**  
Please attach sheets with the following information

(1) Pool Names and Codes	Gravities / BTU of Non-Commingled Production	Calculated Gravities / BTU of Commingled Production		Calculated Value of Commingled Production	Volumes

(2) Are any wells producing at top allowables? ☐ Yes ☐ No

(3) Has all interest owners been notified by certified mail of the proposed commingling? ☐ Yes ☐ No.

(4) Measurement type: ☐ Metering ☐ Other (Specify)

(5) Will commingling decrease the value of production? ☐ Yes ☐ No If "yes", describe why commingling should be approved

**(B) LEASE COMMINGLING**  
Please attach sheets with the following information

(1) Pool Name and Code. Wildcat Bone Spring 97838

(2) Is all production from same source of supply? ☒ Yes ☐ No

(3) Has all interest owners been notified by certified mail of the proposed commingling? ☒ Yes ☐ No

(4) Measurement type: ☒ Metering ☐ Other (Specify)

**(C) POOL and LEASE COMMINGLING**  
Please attach sheets with the following information

(1) Complete Sections A and E

**(D) OFF-LEASE STORAGE and MEASUREMENT**  
Please attached sheets with the following information

(1) Is all production from same source of supply? ☒ Yes ☐ No

(2) Include proof of notice to all interest owners.

**(E) ADDITIONAL INFORMATION (for all application types)**  
Please attach sheets with the following information

(1) A schematic diagram of facility, including legal location.

(2) A plat with lease boundaries showing all well and facility locations. Include lease numbers if Federal or State lands are involved.

(3) Lease Names, Lease and Well Numbers, and API Numbers.

I hereby certify that the information above is true and complete to the best of my knowledge and belief.

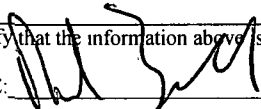
SIGNATURE:  TITLE: SR Production Engineer DATE: 04/11/11

TYPE OR PRINT NAME Robin Terrell TELEPHONE NO 575-393-5905

E-MAIL ADDRESS: rterrell@mewbourne.com

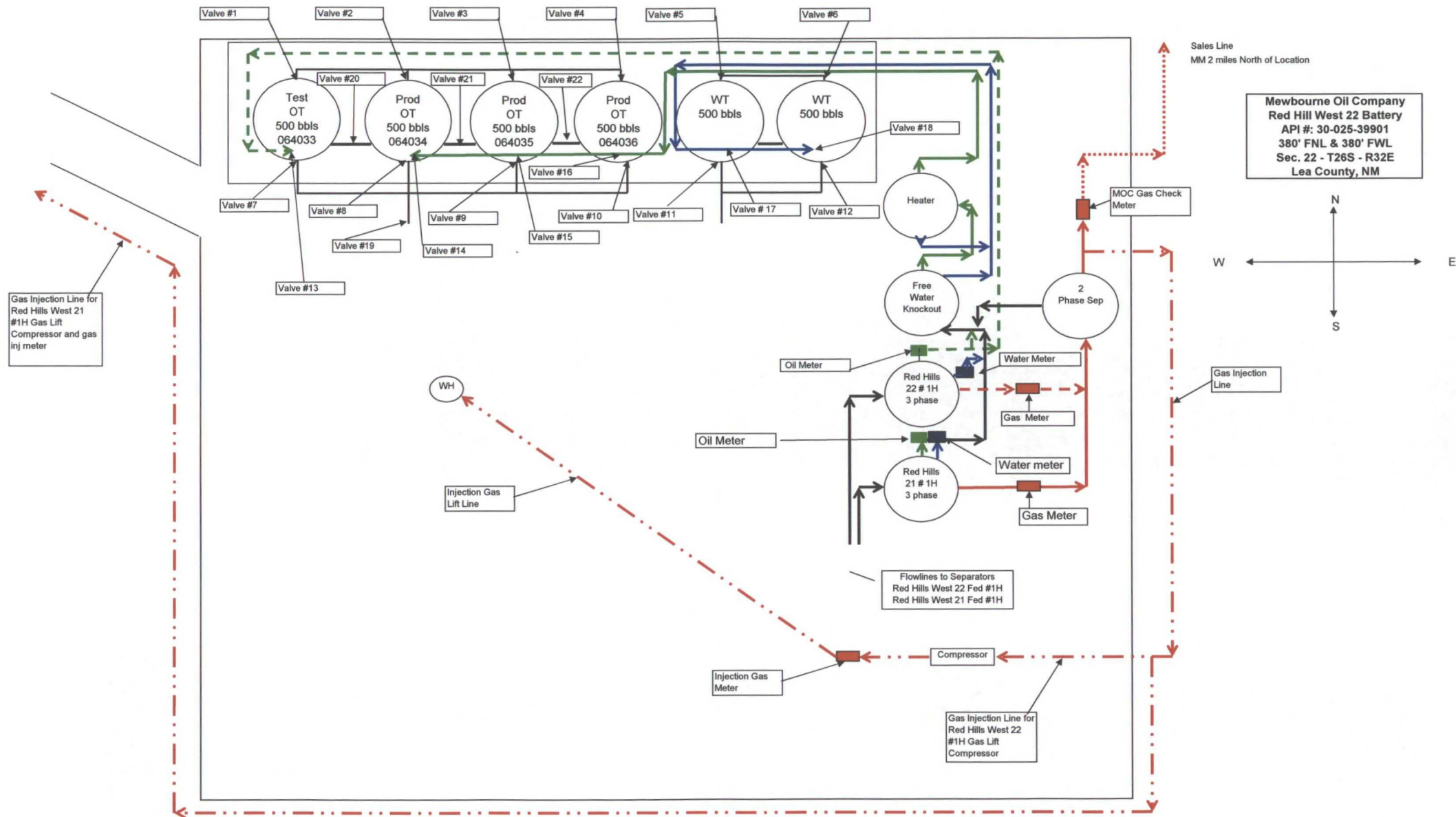

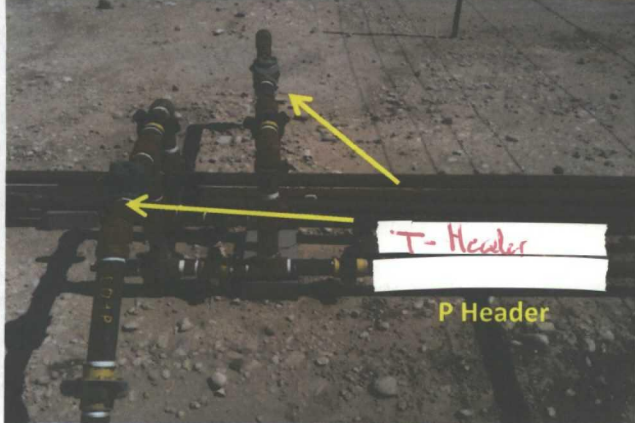
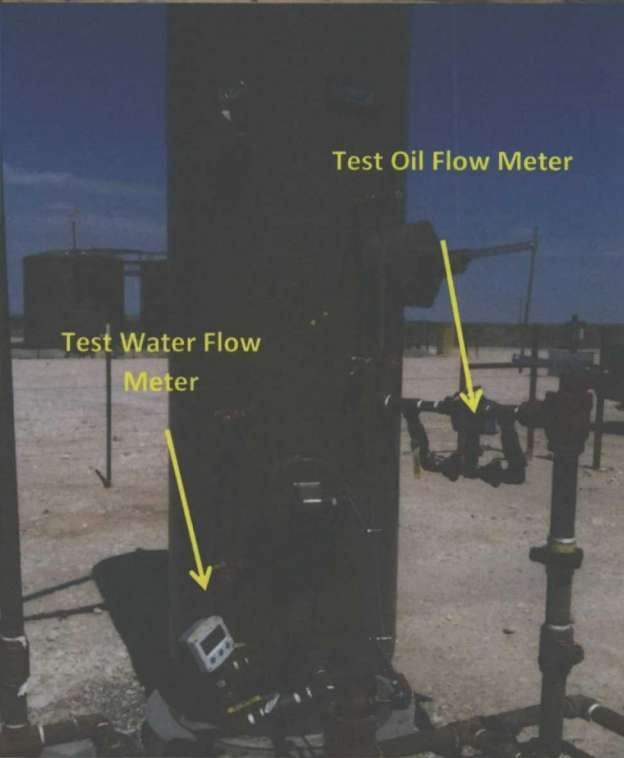
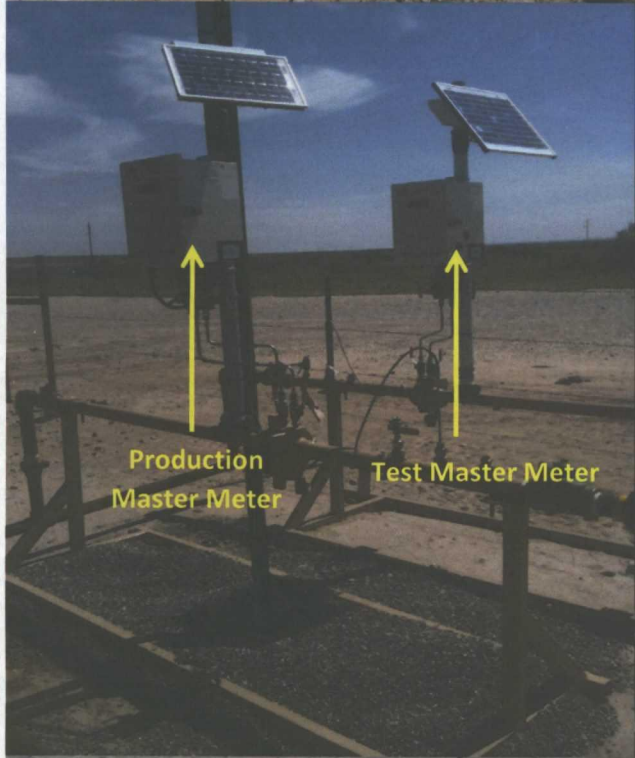
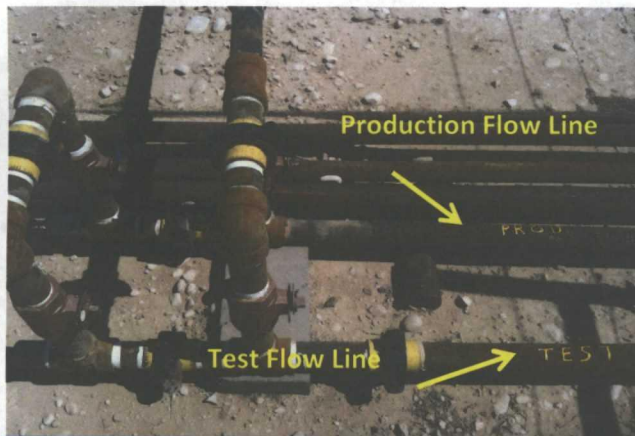



Well Name	API #	Location	Formation	BOPD	BWPD	MCFPD	Oil gravity	BTU
Red Hills West "22" Fed Com # 1H	30-025-3880	NWNW 22-26S-32E	Bone Springs	300	300	1100	48.1	1145
Red Hills West "21" Fed Com # 1H	30-025-	NENE 21-26S-32E	Bone Springs	Not Drilled yet will get info to BLM after completion				



# **MEWBOURNE OIL COMPANY**

## **Metering Procedure**

Each well will have its own 3 phase separator. Since each well will have its own 3 phase separator all wells will be metered separately daily.

The 3 phase separator will be equipped with meters on all 3 phases. The gas phase will have a Total Flow EFM 6213. The water phase will have a turbine meter. The oil phase will have a turbine meter. The oil meter will be checked monthly to ensure turbine meter accuracy. The process by which the oil meter will be checked is by proving it to an isolated tank and calibrating it to that test.

The allocation process would be the same as if the wells were on well test. The only difference is all wells or leases in the common battery would have well test everyday. At the end of month each well would be allocated a percentage of battery oil, water, and gas based on its individual metered numbers.

**Mewbourne Oil Company**  
**PO Box 5270**  
**Hobbs, NM 88240**  
**(505) 393-5905**

April 15, 2011  
Bureau Of Land Management  
Attn: Duncan Whitlock  
620 East Green Street  
Carlsbad, NM 88220

RE: Explanation for requesting surface commingle

Duncan

Mewbourne Oil Company has requested permission to surface commingle production from out Red Hills West "21" Fed Com # 1H well (API unknown yet) with our Red Hills West "22" Fed Com # 1H well (API # 30-025-39901). The proposal to surface commingle these wells and hopefully in the future others in this area comes from economics and footprint. MOC has built a large tank battery on the Red Hills West 22 Fed Com # 1H well. This battery had constructed cost of \$325,000. These wells have high initial production rates that require large, high pressure, and expensive equipment that is only needed in the first 1-3 months of the well. It makes great economic sense to build the large battery to accommodate future wells. Another reason for surface commingling is the footprint of large batteries and facilities. If MOC were granted permission to surface commingle wells it would allow for pads on wells going to a common battery to reclaimed further.

Any questions on this matter I may be reached at (575) 390-4816 cell, (575) 393-5905 office, [rterrell@mewbounre.com](mailto:rterrell@mewbounre.com) email.

Thank you,

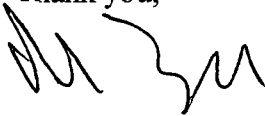

Robin Terrell  
Mewbourne Oil Co  
Sr. Production Engineer

DISTRICT I  
1625 M. French Dr., Hobbs, NM 88240

DISTRICT II  
1501 W. Grand Avenue, Artesia, NM 88210

DISTRICT III  
1000 Rio Brazos Rd., Aztec, NM 87410

DISTRICT IV  
1220 S. St. Francis Dr., Santa Fe, NM 87505

State of New Mexico  
Energy, Minerals and Natural Resources Department

Form C-102  
Revised October 15, 2009

Submit one copy to appropriate  
District Office

OIL CONSERVATION DIVISION  
1220 South St. Francis Dr.  
Santa Fe, New Mexico 87505

WELL LOCATION AND ACREAGE DEDICATION PLAT

☐ AMENDED REPORT

API Number <b>30-025-39901</b>	Pool Code	Pool Name <b>Wildcat Bone Springs</b>
Property Code	Property Name <b>RED HILLS WEST "22" FEDERAL COM</b>	Well Number <b>1H</b>
OGRID No. <b>14744</b>	Operator Name <b>MEWBOURNE OIL COMPANY</b>	Elevation <b>3148'</b>

Surface Location

UL or lot No. <b>D</b>	Section <b>22</b>	Township <b>26 S</b>	Range <b>32 E</b>	Lot Idn	Feet from the <b>380</b>	North/South line <b>NORTH</b>	Feet from the <b>380</b>	East/West line <b>WEST</b>	County <b>LEA</b>
---------------------------	----------------------	-------------------------	----------------------	---------	-----------------------------	----------------------------------	-----------------------------	-------------------------------	----------------------

Bottom Hole Location If Different From Surface

UL or lot No. <b>P</b>	Section <b>22</b>	Township <b>26 S</b>	Range <b>32 E</b>	Lot Idn	Feet from the <b>330</b>	North/South line <b>South</b>	Feet from the <b>380</b>	East/West line <b>West</b>	County <b>Lea</b>
---------------------------	----------------------	-------------------------	----------------------	---------	-----------------------------	----------------------------------	-----------------------------	-------------------------------	----------------------

Dedicated Acres <b>160</b>	Joint or Infill	Consolidation Code	Order No.
-------------------------------	-----------------	--------------------	-----------

NO ALLOWABLE WILL BE ASSIGNED TO THIS COMPLETION UNTIL ALL INTERESTS HAVE BEEN CONSOLIDATED  
OR A NON-STANDARD UNIT HAS BEEN APPROVED BY THE DIVISION

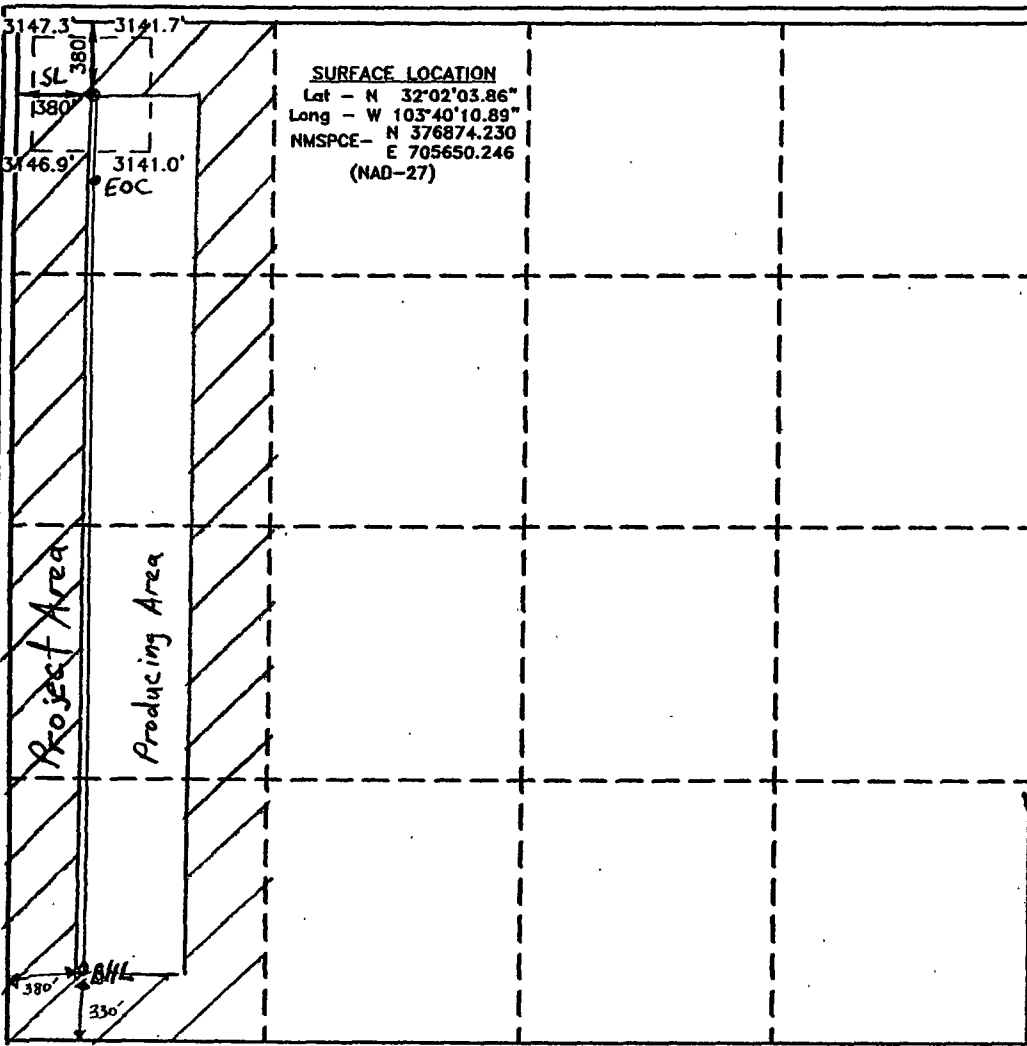
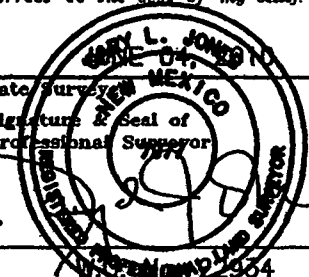
	<p><b>SURFACE LOCATION</b> Lat - N 32°02'03.86" Long - W 103°40'10.89" NMSPC- N 376874.230 E 705650.246 (NAD-27)</p>	<p><b>OPERATOR CERTIFICATION</b></p> <p>I hereby certify that the information contained herein is true and complete to the best of my knowledge and belief, and that this organization either owns a working interest or unleased mineral interest in the land including the proposed bottom hole location or has a right to drill this well at this location pursuant to a contract with an owner of such a mineral or working interest, or to a voluntary pooling agreement or a compulsory pooling order heretofore entered by the division.</p> <p><i>Jackie Lathan</i> 6/30/10 Signature Date</p> <p><b>Jackie Lathan</b> Printed Name</p> <p><b>SURVEYOR CERTIFICATION</b></p> <p>I hereby certify that the well location shown on this plat was plotted from field notes of actual surveys made by me or under my supervision, and that the same is true and correct to the best of my belief.</p> <p></p> <p>Date Surveyed Signature &amp; Seal of Professional Surveyor</p> <p>Certificate No. Gary L. Jones 7977</p> <p><b>Basin Surveys</b></p>
--	--	---

DISTRICT I  
1625 N. French Dr., Hobbs, NM 88240

DISTRICT II  
1301 W. Grand Avenue, Artesia, NM 88210

DISTRICT III  
1000 Rio Brazos Rd., Aztec, NM 87410

DISTRICT IV  
1220 S. St. Francis Dr., Santa Fe, NM 87505

State of New Mexico  
Energy, Minerals and Natural Resources Department

Form C-102  
Revised July 16, 2010

Submit one copy to appropriate  
District Office

OIL CONSERVATION DIVISION

1220 South St. Francis Dr.  
Santa Fe, New Mexico 87505

WELL LOCATION AND ACREAGE DEDICATION PLAT

☐ AMENDED REPORT

API Number	Pool Code	Pool Name
Property Code	Property Name RED HILLS WEST "21" FEDERAL COM	Well Number 2H
OGRID No. 14744	Operator Name MEWBOURNE OIL COMPANY	Elevation 3162'

Surface Location

UL or lot No. A	Section 21	Township 26 S	Range 32 E	Lot Idn	Feet from the 330	North/South line NORTH	Feet from the 950	East/West line EAST	County LEA
--------------------	---------------	------------------	---------------	---------	----------------------	---------------------------	----------------------	------------------------	---------------

Bottom Hole Location If Different From Surface

UL or lot No.	Section	Township	Range	Lot Idn	Feet from the	North/South line	Feet from the	East/West line	County
---------------	---------	----------	-------	---------	---------------	------------------	---------------	----------------	--------

Dedicated Acres	Joint or Infill	Consolidation Code	Order No.
-----------------	-----------------	--------------------	-----------

NO ALLOWABLE WILL BE ASSIGNED TO THIS COMPLETION UNTIL ALL INTERESTS HAVE BEEN CONSOLIDATED  
OR A NON-STANDARD UNIT HAS BEEN APPROVED BY THE DIVISION

<p><b>SURFACE LOCATION</b> Lat - N 32°02'04.33" Long - W 103°40'26.34" NMSPC- N 376913.779 E 704320.134 (NAD-27)</p>				<p>3172.8' 3164.2' 330' 950' 3147.6' 3154.8'</p>		<p><b>OPERATOR CERTIFICATION</b> I hereby certify that the information contained herein is true and complete to the best of my knowledge and belief, and that this organization either owns a working interest or unleased mineral interest in the land including the proposed bottom hole location or has a right to drill this well at this location pursuant to a contract with an owner of such a mineral or working interest, or to a voluntary pooling agreement or a compulsory pooling order heretofore entered by the division.</p> <p><u>Jackie Lathan</u> 4/11/11 Signature Date <u>Jackie Lathan</u> Printed Name _____ Email Address</p>	
						<p><b>SURVEYOR CERTIFICATION</b> I hereby certify that the well location shown on this plat was plotted from field notes of actual surveys made by me or under my supervision, and that the same is true and correct to the best of my belief.</p> <p><b>GARY L. JONES</b> DECEMBER 09, 2010 Date Surveyed Signature &amp; Seal of Professional Surveyor W.L. No. 23879 Certificate No. Gary L. Jones 7977 BASIN SURVEYS 23879</p>	

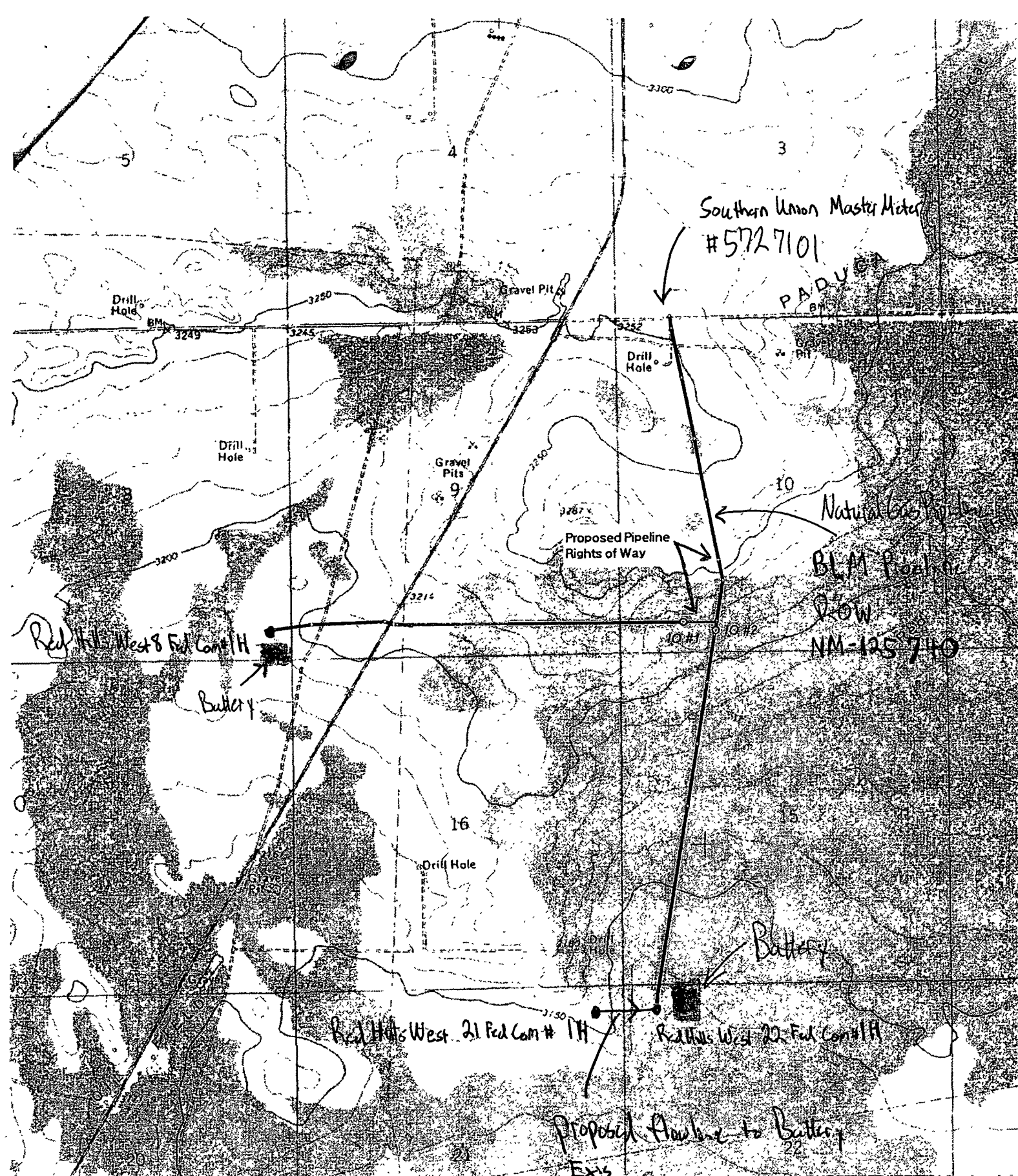
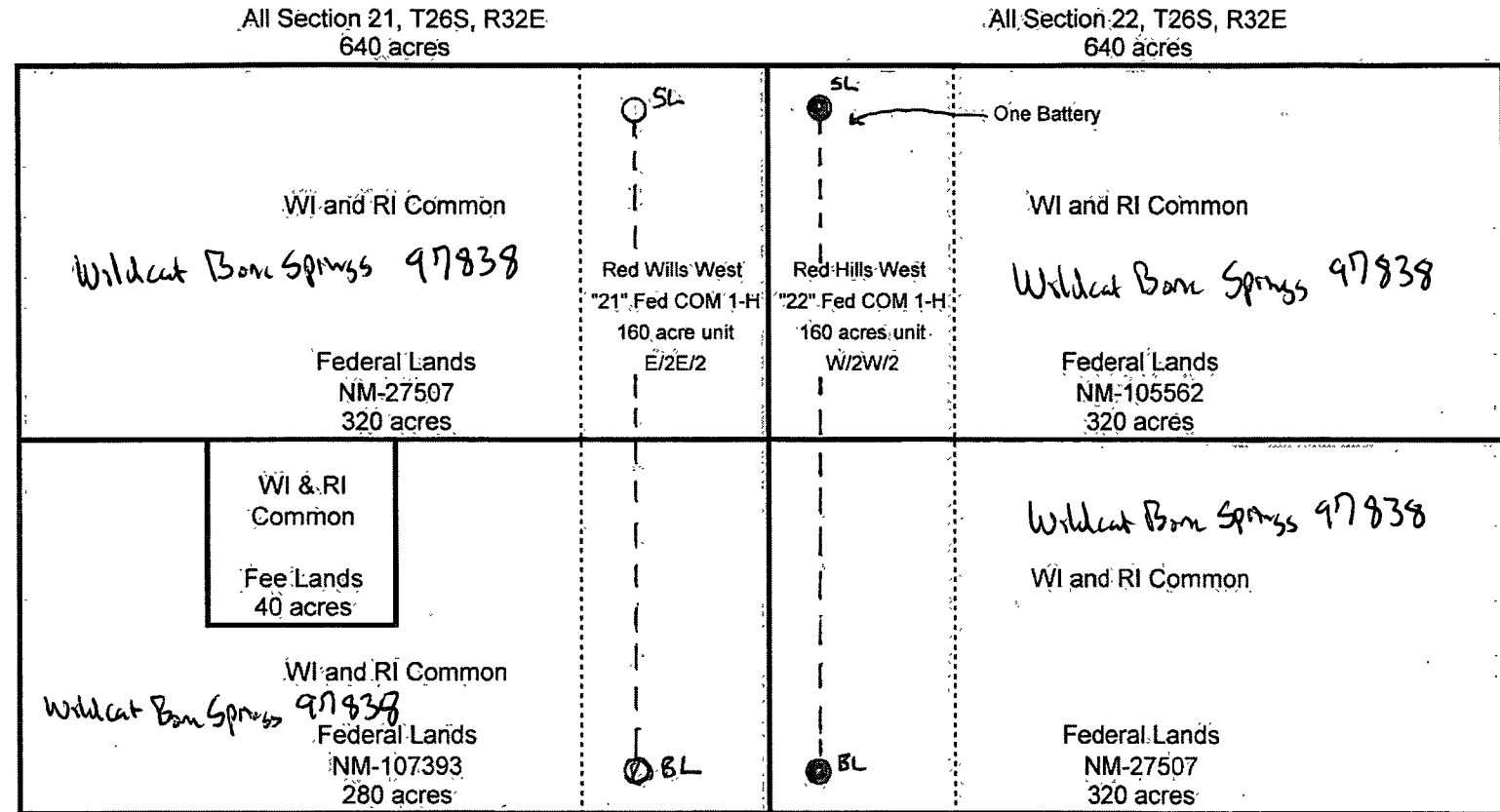

Figure 1: Survey Area  
 Mewbourne Oil Company  
 Red Hills West "8" Federal COM Number 1H and Red Hills West "22" Federal Number 1H  
 Proposed Pipeline Rights of Way, Sections 3, 8, 9, 10, 15 and 22, T.26S, R.32E  
 USGS Paduca Breaks, NM, TX (1973) 7.5 topo map  
 Lea County, New Mexico  
 Scale 1:24,000



Surface Commingling Application  
 Red Hills West "21" Fed COM #1-H (E/2E/2 Section 21) & Red Hills West "22" Fed COM #1-H (W/2W/2 Section 22)





**Mewbourne Oil Company**  
**PO Box 5270**  
**Hobbs, NM 88240**  
**(505) 393-5905**

April 15, 2011  
Bureau Of Land Management  
Attn: Duncan Whitlock  
620 East Green Street  
Carlsbad, NM 88220

RE: Statement describing how surface commingle will not reduce value or royalty.

Duncan

2H ?  
Mewbourne Oil Company has requested permission to surface commingle production from our Red Hills West "21" Fed Com # 1H well (API unknown yet) with our Red Hills West "22" Fed Com # 1H well (API # 30-025-39901). This will not reduce the value of reserves or interest to any parties involved. Both wells will be producing from the same source of supply so oil and gas gravities will be very similar. These wells are producing 160 acres each. Wells are both N/S horizontals in the Wildcat Bone Spring Pool.

Any questions on this matter I may be reached at (575) 390-4816 cell, (575) 393-5905 office, [rterrell@mewbounre.com](mailto:rterrell@mewbounre.com) email.

Thank you,



Robin Terrell  
Mewbourne Oil Co  
Sr. Production Engineer



**Mewbourne Oil Company**  
**PO Box 5270**  
**Hobbs, NM 88240**  
**(505) 393-5905**

April 15, 2011  
Bureau Of Land Management  
Attn: Duncan Whitlock  
620 East Green Street  
Carlsbad, NM 88220

RE: Informed all parties statement

Duncan

Mewbourne Oil Company has requested permission to surface commingle production from out Red Hills West "21" Fed Com # 1H well (API unknown yet) with our Red Hills West "22" Fed Com # 1H well (API # 30-025-39901). MOC has sent certified letters just like the one Carlsbad BLM received notifying them of MOC's proposal to surface commingle these wells. I have attached the contact list and a copy of these letters.

Any questions on this matter I may be reached at (575) 390-4816 cell, (575) 393-5905 office, [rterrell@mewbounre.com](mailto:rterrell@mewbounre.com) email.

Thank you,

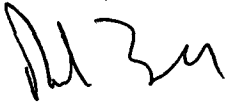

Robin Terrell  
Mewbourne Oil Co  
Sr. Production Engineer

**Parties To Be Noticed For Commingling Application  
Red Hills West "21" Fed COM #1-H & Red Hills West "22" Fed COM #1-H**

**Working Interest Owners**

Great Western Drilling Ltd.  
Attn: Mr. Carter Muire  
P.O. Box 1659  
Midland, Texas 79702

Kaiser-Francis Anadarko, L.L.C.  
P.O. Box 21468  
Tulsa, Oklahoma 74121-1468  
Attn: Mr. Wayne A. Fields

Manzano Energy Partners L.L.C.  
P.O. Box 2107  
Roswell, New Mexico 88202  
Attn: Mr. Ken Barbe, Jr.

McCombs Energy, Ltd.  
5599 San Felipe, Suite 1200  
Houston, Texas 77056  
Attn: Mr. Ricky Haikin

PetroVen, Inc.  
5930 West Parker Road, Suite 800  
Plano, Texas 75093  
Attn: Mr. David Cherry

Tamaroa Development, LLC  
P.O. Box 866937  
Plano, Texas 75086  
Attn: Mr. Bill Bahlburg

RSC Resources, L.P.  
6824 Island Drive  
Midland, Texas 79707  
Attn: Mr. Randy Cate

**Lease Royalty Owners**

Bureau of Land Management  
Carlsbad Field Office  
620 E. Greene Street  
Carlsbad, NM 88220-6292  
Attn: Mr. Wesley W. Ingram

**Overriding Royalty Interest Owners**

ConocoPhillips Company  
Attn: Mr. Tom J. Scarbrough  
600 N. Dairy Ashford Street  
3WL-14066  
Houston, Texas 77079-1100

WHID, Inc.  
P.O. Box 6675  
Lubbock, TX 79493  
Attn: Mrs. Leota Davis

Hopp & Davis, Ltd.  
2702 58th St.  
Lubbock, TX 79413

Peregrine Production, LLC  
P.O. Box 1844  
Midland, Texas 79702  
Attn: Mr. Kirk E. Smith

The Blanco Company  
110 2<sup>nd</sup> Street SW, Suite 612  
Albuquerque, New Mexico 87102

## MEWBOURNE OIL COMPANY

500 W. TEXAS, SUITE 1020  
MIDLAND, TEXAS 79701

(432) 682-3715  
FAX (432) 685-4170

April 7, 2011

Certified Mail-Return Receipt No. 0147

Great Western Drilling Ltd.,  
Attn: Mr. Carter Muire  
P.O. Box 1659  
Midland, Texas 79702

Re: Application for Surface Commingling  
Red Hills West "21" Fed COM #1-H Well  
E/2E/2 Section 21, T-26-S, R-32-E  
Red Hills West "22" Fed COM #1-H Well  
W/2W/2 Section 22, T-26-S, R-32-E  
Lea County, New Mexico  
**Red Hills West Prospect**

Gentlemen:

Mewbourne Oil Company (Mewbourne) is preparing to file an application with the New Mexico Oil Conservation Division (NMOCD) seeking authorization to surface commingle production from the Red Hills West "21" Fed COM #1-H well located in the E/2E/2 of Section 21, T-26-S, R-32-E with production from the Red Hills West "22" Fed COM #1-H well located in the W/2W/2 of Section 22, T-26-S, R-32-E. All production from both wells will be run through and sold from the Red Hills West "22" Tank Battery located in the NW/4NW/4 of said Section 22. A new three phase separation vessel will be installed at the Red Hills West "22" Tank Battery to facilitate accurate measurement and allocation of production to each well.

If you object to this application, you must notify the NMOCD in writing no later than 20 days from the date the NMOCD receives Mewbourne's surface commingling application.

Feel free to contact me if you have any questions or would like to discuss this in greater detail. I can be reached by phone at (432) 682-3715 or via email at [ssmith@mewbourne.com](mailto:ssmith@mewbourne.com).

Sincerely,

MEWBOURNE OIL COMPANY

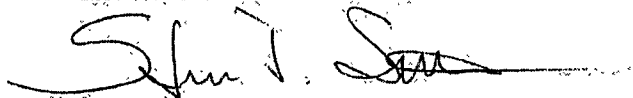

Steven J. Smith  
Senior Landman

## MEWBOURNE OIL COMPANY

500 W. TEXAS, SUITE 1020  
MIDLAND, TEXAS 79701

(432) 682-3715  
FAX (432) 685-4170

April 7, 2011

Certified Mail-Return Receipt No. 0161

Kaiser-Francis Anadarko, L.L.C.  
P. O. Box 21468  
Tulsa, Oklahoma 74121-1468  
Attn: Mr. Wayne A. Fields

Re: Application for Surface Commingling  
Red Hills West "21" Fed COM #1-H Well  
E/2E/2 Section 21, T-26-S, R-32-E  
Red Hills West "22" Fed COM #1-H Well  
W/2W/2 Section 22, T-26-S, R-32-E  
Lea County, New Mexico  
Red Hills West Prospect

Dear Mr. Caté:

Mewbourne Oil Company (Mewbourne) is preparing to file an application with the New Mexico Oil Conservation Division (NMOCD) seeking authorization to surface commingle production from the Red Hills West "21" Fed COM #1-H well located in the E/2E/2 of Section 21, T-26-S, R-32-E with production from the Red Hills West "22" Fed COM #1-H well located in the W/2W/2 of Section 22, T-26-S, R-32-E. All production from both wells will be run through and sold from the Red Hills West "22" Tank Battery located in the NW/4NW/4 of said Section 22. A new three phase separation vessel will be installed at the Red Hills West "22" Tank Battery to facilitate accurate measurement and allocation of production to each well.

If you object to this application, you must notify the NMOCD in writing no later than 20 days from the date the NMOCD receives Mewbourne's surface commingling application.

Feel free to contact me if you have any questions or would like to discuss this in greater detail. I can be reached by phone at (432) 682-3715 or via email at [ssmith@mewbourne.com](mailto:ssmith@mewbourne.com).

Sincerely,

MEWBOURNE OIL COMPANY

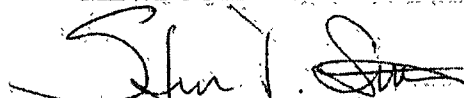

Steven J. Smith  
Senior Landman

## MEWBOURNE OIL COMPANY

500 W. TEXAS, SUITE 1020  
MIDLAND, TEXAS 79701

(432) 682-3715  
FAX (432) 685-4170

April 7, 2011

Certified Mail-Return Receipt No. 0178

Manzano Energy Partners L.L.C.  
P. O. Box 2107  
Roswell, New Mexico 88202  
Attn: Mr. Ken Barbe, Jr.

Re: Application for Surface Commingling  
Red Hills West "21" Fed COM #1-H Well  
E/2E/2 Section 21, T-26-S, R-32-E  
Red Hills West "22" Fed COM #1-H Well  
W/2W/2 Section 22, T-26-S, R-32-E  
Lea County, New Mexico  
Red Hills West Prospect

Gentlemen:

Mewbourne Oil Company (Mewbourne) is preparing to file an application with the New Mexico Oil Conservation Division (NMOCD) seeking authorization to surface commingle production from the Red Hills West "21" Fed COM #1-H well located in the E/2E/2 of Section 21, T-26-S, R-32-E with production from the Red Hills West "22" Fed COM #1-H well located in the W/2W/2 of Section 22, T-26-S, R-32-E. All production from both wells will be run through and sold from the Red Hills West "22" Tank Battery located in the NW/4NW/4 of said Section 22. A new three phase separation vessel will be installed at the Red Hills West "22" Tank Battery to facilitate accurate measurement and allocation of production to each well.

If you object to this application, you must notify the NMOCD in writing no later than 20 days from the date the NMOCD receives Mewbourne's surface commingling application.

Feel free to contact me if you have any questions or would like to discuss this in greater detail. I can be reached by phone at (432) 682-3715 or via email at [ssmith@mewbourne.com](mailto:ssmith@mewbourne.com).

Sincerely,

MEWBOURNE OIL COMPANY

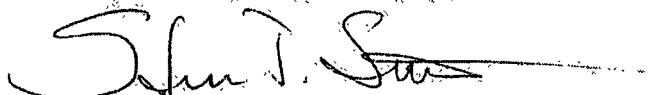

Steven J. Smith  
Senior Landman

## MEWBOURNE OIL COMPANY

500 W. TEXAS, SUITE 1020  
MIDLAND, TEXAS 79701

(432) 682-3715  
FAX (432) 685-4170

April 7, 2011

Certified Mail-Return Receipt No. 0185

McCombs Energy, Ltd.  
5599 San Felipe, Suite 1200  
Houston, Texas 77056  
Attn: Mr. Ricky Haikin

Re: Application for Surface Commingling  
Red Hills West "21" Fed COM #1-H Well  
E/2E/2 Section 21, T-26-S, R-32-E  
Red Hills West "22" Fed COM #1-H Well  
W/2W/2 Section 22, T-26-S, R-32-E  
Lea County, New Mexico  
Red Hills West Prospect

Gentlemen:

Mewbourne Oil Company (Mewbourne) is preparing to file an application with the New Mexico Oil Conservation Division (NMOCD) seeking authorization to surface commingle production from the Red Hills West "21" Fed COM #1-H well located in the E/2E/2 of Section 21, T-26-S, R-32-E with production from the Red Hills West "22" Fed COM #1-H well located in the W/2W/2 of Section 22, T-26-S, R-32-E. All production from both wells will be run through and sold from the Red Hills West "22" Tank Battery located in the NW/4NW/4 of said Section 22. A new three phase separation vessel will be installed at the Red Hills West "22" Tank Battery to facilitate accurate measurement and allocation of production to each well.

If you object to this application, you must notify the NMOCD in writing no later than 20 days from the date the NMOCD receives Mewbourne's surface commingling application.

Feel free to contact me if you have any questions or would like to discuss this in greater detail. I can be reached by phone at (432) 682-3715 or via email at [ssmith@mewbourne.com](mailto:ssmith@mewbourne.com).

Sincerely,

MEWBOURNE OIL COMPANY

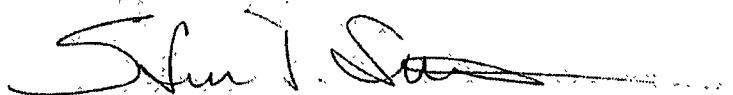

Steven J. Smith  
Senior Landman

## MEWBOURNE OIL COMPANY

500 W. TEXAS, SUITE 1020  
MIDLAND, TEXAS 79701

(432) 682-3715  
FAX (432) 685-4170

April 7, 2011

Certified Mail-Return Receipt No. 0208

PetroVen, Inc.  
5930 West Parker Road, Suite 800  
Plano, Texas 75093  
Attn: Mr. David Cherry

Re: Application for Surface Commingling  
Red Hills West "21" Fed COM #1-H Well  
E/2E/2, Section 21, T-26-S, R-32-E  
Red Hills West "22" Fed COM #1-H Well  
W/2W/2 Section 22, T-26-S, R-32-E  
Lea County, New Mexico  
Red Hills West Prospect

Gentlemen:

Mewbourne Oil Company (Mewbourne) is preparing to file an application with the New Mexico Oil Conservation Division (NMOCD) seeking authorization to surface commingle production from the Red Hills West "21" Fed COM #1-H well located in the E/2E/2 of Section 21, T-26-S, R-32-E with production from the Red Hills West "22" Fed COM #1-H well located in the W/2W/2 of Section 22, T-26-S, R-32-E. All production from both wells will be run through and sold from the Red Hills West "22" Tank Battery located in the NW/4NW/4 of said Section 22. A new three phase separation vessel will be installed at the Red Hills West "22" Tank Battery to facilitate accurate measurement and allocation of production to each well.

If you object to this application, you must notify the NMOCD in writing no later than 20 days from the date the NMOCD receives Mewbourne's surface commingling application.

Feel free to contact me if you have any questions or would like to discuss this in greater detail. I can be reached by phone at (432) 682-3715 or via email at [ssmith@mewbourne.com](mailto:ssmith@mewbourne.com).

Sincerely,

MEWBOURNE OIL COMPANY

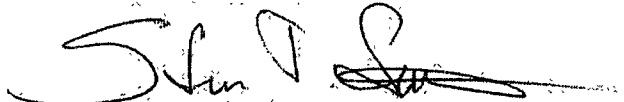
  
Steven J. Smith  
Senior Landman



## MEWBOURNE OIL COMPANY

500 W. TEXAS, SUITE 1020  
MIDLAND, TEXAS 79701

(432) 682-3715  
FAX (432) 685-4170

April 7, 2011

Certified Mail-Return Receipt No. 0239

WHID, Inc.  
P.O. Box 6675  
Lubbock, TX 79493  
Attn: Mrs. Leota Davis

Re: Application for Surface Commingling  
Red Hills West "21" Fed COM #1-H Well  
E/2E/2 Section 21, T-26-S, R-32-E,  
Red Hills West "22" Fed COM #1-H Well  
W/2W/2 Section 22, T-26-S, R-32-E  
Lea County, New Mexico  
**Red Hills West Prospect**

Ladies and Gentlemen:

Mewbourne Oil Company (Mewbourne) is preparing to file an application with the New Mexico Oil Conservation Division (NMOCD) seeking authorization to surface commingle production from the Red Hills West "21" Fed COM #1-H well located in the E/2E/2 of Section 21, T-26-S, R-32-E with production from the Red Hills West "22" Fed COM #1-H well located in the W/2W/2 of Section 22, T-26-S, R-32-E. All production from both wells will be run through and sold from the Red Hills West "22" Tank Battery located in the NW/4NW/4 of said Section 22. A new three phase separation vessel will be installed at the Red Hills West "22" Tank Battery to facilitate accurate measurement and allocation of production to each well.

If you object to this application, you must notify the NMOCD in writing no later than 20 days from the date the NMOCD receives Mewbourne's surface commingling application.

Feel free to contact me if you have any questions or would like to discuss this in greater detail. I can be reached by phone at (432) 682-3715 or via email at [ssmith@mewbourne.com](mailto:ssmith@mewbourne.com).

Sincerely,

MEWBOURNE OIL COMPANY



Steven J. Smith  
Senior Landman

## **MEWBOURNE OIL COMPANY**

500 W. TEXAS, SUITE 1020  
MIDLAND, TEXAS 79701

(432) 682-3715  
FAX (432) 685-4170

April 7, 2011

Certified Mail-Return Receipt No. 0123

Bureau of Land Management  
Carlsbad Field Office  
620 E. Greene Street  
Carlsbad, NM 88220-6292  
Attn: Mr. Wesley W. Ingram

Re: Application for Surface Commingling  
Red Hills West "21" Fed COM #1-H Well  
E/2E/2 Section 21, T-26-S, R-32-E  
Red Hills West "22" Fed COM #1-H Well  
W/2W/2 Section 22, T-26-S, R-32-E  
Lea County, New Mexico  
Red Hills West Prospect

Gentlemen:

Mewbourne Oil Company (Mewbourne) is preparing to file an application with the New Mexico Oil Conservation Division (NMOCD) seeking authorization to surface commingle production from the Red Hills West "21" Fed COM #1-H well located in the E/2E/2 of Section 21, T-26-S, R-32-E with production from the Red Hills West "22" Fed COM #1-H well located in the W/2W/2 of Section 22, T-26-S, R-32-E. All production from both wells will be run through and sold from the Red Hills West "22" Tank Battery located in the NW/4NW/4 of said Section 22. A new three phase separation vessel will be installed at the Red Hills West "22" Tank Battery to facilitate accurate measurement and allocation of production to each well.

If you object to this application, you must notify the NMOCD in writing no later than 20 days from the date the NMOCD receives Mewbourne's surface commingling application.

Feel free to contact me if you have any questions or would like to discuss this in greater detail. I can be reached by phone at (432) 682-3715 or via email at [ssmith@mewbourne.com](mailto:ssmith@mewbourne.com).

Sincerely,

**MEWBOURNE OIL COMPANY**

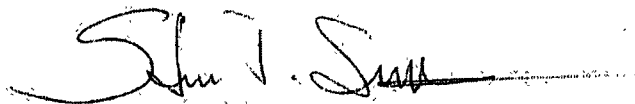

Steven J. Smith  
Senior Landman

## **MEWBOURNE OIL COMPANY**

500 W. TEXAS, SUITE 1020  
MIDLAND, TEXAS 79701

(432) 682-3715  
FAX (432) 685-4170

April 7, 2011

Certified Mail-Return Receipt No. 0130

ConocoPhillips Company  
Attn: Mr. Tom J. Scarbrough  
600 N. Dairy Ashford Street  
3WL-14066  
Houston, Texas 77079-1100

Re: Application for Surface Commingling  
Red Hills West "21" Fed COM #1-H Well  
E/2E/2 Section 21, T-26-S, R-32-E  
Red Hills West "22" Fed COM #1-H Well  
W/2W/2 Section 22, T-26-S, R-32-E  
Lea County, New Mexico  
Red Hills West Prospect

Gentlemen:

Mewbourne Oil Company (Mewbourne) is preparing to file an application with the New Mexico Oil Conservation Division (NMOCD) seeking authorization to surface commingle production from the Red Hills West "21" Fed COM #1-H well located in the E/2E/2 of Section 21, T-26-S, R-32-E with production from the Red Hills West "22" Fed COM #1-H well located in the W/2W/2 of Section 22, T-26-S, R-32-E. All production from both wells will be run through and sold from the Red Hills West "22" Tank Battery located in the NW/4NW/4 of said Section 22. A new three phase separation vessel will be installed at the Red Hills West "22" Tank Battery to facilitate accurate measurement and allocation of production to each well.

If you object to this application, you must notify the NMOCD in writing no later than 20 days from the date the NMOCD receives Mewbourne's surface commingling application.

Feel free to contact me if you have any questions or would like to discuss this in greater detail. I can be reached by phone at (432) 682-3715 or via email at [ssmith@mewbourne.com](mailto:ssmith@mewbourne.com).

Sincerely,

**MEWBOURNE OIL COMPANY**



Steven J. Smith  
Senior Landman

## MEWBOURNE OIL COMPANY

500 W. TEXAS, SUITE 1020  
MIDLAND, TEXAS 79701

(432) 682-3715  
FAX (432) 685-4170

April 7, 2011

Certified Mail-Return Receipt No. 0116

The Blanco Company  
1102<sup>nd</sup> Street SW, Suite 612  
Albuquerque, New Mexico 87102

Re: Application for Surface Commingling  
Red Hills West "21" Fed COM #1-H Well  
E/2E/2 Section 21, T-26-S, R-32-E  
Red Hills West "22" Fed COM #1-H Well  
W/2W/2 Section 22, T-26-S, R-32-E  
Lea County, New Mexico  
**Red Hills West Prospect**

Gentlemen:

Mewbourne Oil Company (Mewbourne) is preparing to file an application with the New Mexico Oil Conservation Division (NMOCD) seeking authorization to surface commingle production from the Red Hills West "21" Fed COM #1-H well located in the E/2E/2 of Section 21, T-26-S, R-32-E with production from the Red Hills West "22" Fed COM #1-H well located in the W/2W/2 of Section 22, T-26-S, R-32-E. All production from both wells will be run through and sold from the Red Hills West "22" Tank Battery located in the NW/4NW/4 of said Section 22. A new three phase separation vessel will be installed at the Red Hills West "22" Tank Battery to facilitate accurate measurement and allocation of production to each well.

If you object to this application, you must notify the NMOCD in writing no later than 20 days from the date the NMOCD receives Mewbourne's surface commingling application.

Feel free to contact me if you have any questions or would like to discuss this in greater detail. I can be reached by phone at (432) 682-3715 or via email at [ssmith@mewbourne.com](mailto:ssmith@mewbourne.com).

Sincerely,

MEWBOURNE OIL COMPANY

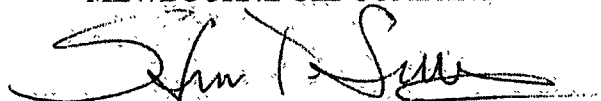

Steven J. Smith  
Senior Landman

## MEWBOURNE OIL COMPANY

500 W. TEXAS, SUITE 1020  
MIDLAND, TEXAS 79701

(432) 682-3715  
FAX (432) 685-4170

April 7, 2011

Certified Mail-Return Receipt No. 0154

Hopp & Davis, Ltd.  
2702 58th St.  
Lubbock, TX 79413

Re: Application for Surface Commingling  
Red Hills West "21" Fed COM #1-H Well  
E/2E/2 Section 21, T-26-S, R-32-E  
Red Hills West "22" Fed COM #1-H Well  
W/2W/2 Section 22, T-26-S, R-32-E  
Lea County, New Mexico  
Red Hills West Prospect

Ladies and Gentlemen:

Mewbourne Oil Company (Mewbourne) is preparing to file an application with the New Mexico Oil Conservation Division (NMOCD) seeking authorization to surface commingle production from the Red Hills West "21" Fed COM #1-H well located in the E/2E/2 of Section 21, T-26-S, R-32-E with production from the Red Hills West "22" Fed COM #1-H well located in the W/2W/2 of Section 22, T-26-S, R-32-E. All production from both wells will be run through and sold from the Red Hills West "22" Tank Battery located in the NW/4NW/4 of said Section 22. A new three phase separation vessel will be installed at the Red Hills West "22" Tank Battery to facilitate accurate measurement and allocation of production to each well.

If you object to this application, you must notify the NMOCD in writing no later than 20 days from the date the NMOCD receives Mewbourne's surface commingling application.

Feel free to contact me if you have any questions or would like to discuss this in greater detail. I can be reached by phone at (432) 682-3715 or via email at [ssmith@mewbourne.com](mailto:ssmith@mewbourne.com).

Sincerely,

MEWBOURNE OIL COMPANY

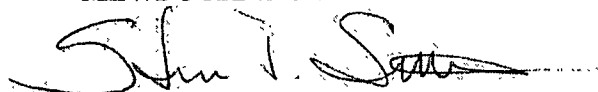

Steven J. Smith  
Senior Landman

## MEWBOURNE OIL COMPANY

500 W. TEXAS, SUITE 1020  
MIDLAND, TEXAS 79701

(432) 682-3715  
FAX (432) 685-4170

April 7, 2011

Certified Mail-Return Receipt No. 0192

Peregrine Production, LLC.  
P. O. Box 1844  
Midland, Texas 79702  
Attn: Mr. Kirk E. Smith

Re: Application for Surface Commingling  
Red Hills West "21" Fed COM #1-H Well  
E/2E/2 Section 21, T-26-S, R-32-E  
Red Hills West "22" Fed COM #1-H Well  
W/2W/2 Section 22, T-26-S, R-32-E  
Lea County, New Mexico  
Red Hills West Prospect

Dear Mr. Smith:

Mewbourne Oil Company (Mewbourne) is preparing to file an application with the New Mexico Oil Conservation Division (NMOCD) seeking authorization to surface commingle production from the Red Hills West "21" Fed COM #1-H well located in the E/2E/2 of Section 21, T-26-S, R-32-E with production from the Red Hills West "22" Fed COM #1-H well located in the W/2W/2 of Section 22, T-26-S, R-32-E. All production from both wells will be run through and sold from the Red Hills West "22" Tank Battery located in the NW/4NW/4 of said Section 22. A new three phase separation vessel will be installed at the Red Hills West "22" Tank Battery to facilitate accurate measurement and allocation of production to each well.

If you object to this application, you must notify the NMOCD in writing no later than 20 days from the date the NMOCD receives Mewbourne's surface commingling application.

Feel free to contact me if you have any questions or would like to discuss this in greater detail. I can be reached by phone at (432) 682-3715 or via email at [ssmith@mewbourne.com](mailto:ssmith@mewbourne.com).

Sincerely,

MEWBOURNE OIL COMPANY



Steven J. Smith  
Senior Landman

## MEWBOURNE OIL COMPANY

500 W. TEXAS, SUITE 1020  
MIDLAND, TEXAS 79701

(432) 682-3715  
FAX (432) 685-4170

April 7, 2011

Certified Mail-Return Receipt No. 0215

RSC Resources, L.P.  
6824 Island Drive  
Midland, Texas 79707  
Attn: Mr. Randy Cate

Re: Application for Surface Commingling  
Red Hills West "21" Fed COM #1-H Well  
E/2E/2 Section 21, T-26-S, R-32-E  
Red Hills West "22" Fed COM #1-H Well  
W/2W/2 Section 22, T-26-S, R-32-E  
Lea County, New Mexico  
**Red Hills West Prospect**

Dear Mr. Cate:

Mewbourne Oil Company (Mewbourne) is preparing to file an application with the New Mexico Oil Conservation Division (NMOCD) seeking authorization to surface commingle production from the Red Hills West "21" Fed COM #1-H well located in the E/2E/2 of Section 21, T-26-S, R-32-E with production from the Red Hills West "22" Fed COM #1-H well located in the W/2W/2 of Section 22, T-26-S, R-32-E. All production from both wells will be run through and sold from the Red Hills West "22" Tank Battery located in the NW/4NW/4 of said Section 22. A new three phase separation vessel will be installed at the Red Hills West "22" Tank Battery to facilitate accurate measurement and allocation of production to each well.

If you object to this application, you must notify the NMOCD in writing no later than 20 days from the date the NMOCD receives Mewbourne's surface commingling application.

Feel free to contact me if you have any questions or would like to discuss this in greater detail. I can be reached by phone at (432) 682-3715 or via email at [ssmith@mewbourne.com](mailto:ssmith@mewbourne.com).

Sincerely,

MEWBOURNE OIL COMPANY

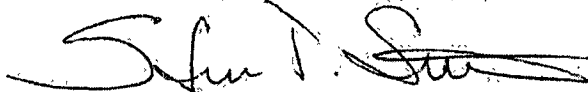

Steven J. Smith  
Senior Landman



## MEWBOURNE OIL COMPANY

500 W. TEXAS, SUITE 1020  
MIDLAND, TEXAS 79701

(432) 682-3715  
FAX (432) 685-4170

April 7, 2011

Certified Mail-Return Receipt No. 0222

Tamaroa Development, LLC  
P.O. Box 866937  
Plano, Texas 75086  
Attn: Mr. Bill Bahlburg

Re: Application for Surface Commingling  
Red Hills West "21" Fed COM #1-H Well  
E/2E/2 Section 21, T-26-S, R-32-E  
Red Hills West "22" Fed COM #1-H Well  
W/2W/2 Section 22, T-26-S, R-32-E  
Lea County, New Mexico  
**Red Hills West Prospect**

Gentlemen:

Mewbourne Oil Company (Mewbourne) is preparing to file an application with the New Mexico Oil Conservation Division (NMOCD) seeking authorization to surface commingle production from the Red Hills West "21" Fed COM #1-H well located in the E/2E/2 of Section 21, T-26-S, R-32-E with production from the Red Hills West "22" Fed COM #1-H well located in the W/2W/2 of Section 22, T-26-S, R-32-E. All production from both wells will be run through and sold from the Red Hills West "22" Tank Battery located in the NW/4NW/4 of said Section 22. A new three phase separation vessel will be installed at the Red Hills West "22" Tank Battery to facilitate accurate measurement and allocation of production to each well.

If you object to this application, you must notify the NMOCD in writing no later than 20 days from the date the NMOCD receives Mewbourne's surface commingling application.

Feel free to contact me if you have any questions or would like to discuss this in greater detail. I can be reached by phone at (432) 682-3715 or via email at [ssmith@mewbourne.com](mailto:ssmith@mewbourne.com).

Sincerely,

MEWBOURNE OIL COMPANY

  
Steven J. Smith  
Senior Landman