

ABOVE THIS LINE FOR DIVISION USE ONLY

**NEW MEXICO OIL CONSERVATION DIVISION**  
**- Engineering Bureau -**  
 1220 South St. Francis Drive, Santa Fe, NM 87505



PLC-385

**ADMINISTRATIVE APPLICATION CHECKLIST**

THIS CHECKLIST IS MANDATORY FOR ALL ADMINISTRATIVE APPLICATIONS FOR EXCEPTIONS TO DIVISION RULES AND REGULATIONS WHICH REQUIRE PROCESSING AT THE DIVISION LEVEL IN SANTA FE

**Application Acronyms:**

[NSL-Non-Standard Location] [NSP-Non-Standard Proration Unit] [SD-Simultaneous Dedication]  
 [DHC-Downhole Commingling] [CTB-Lease Commingling] [PLC-Pool/Lease Commingling]  
 [PC-Pool Commingling] [OLS - Off-Lease Storage] [OLM-Off-Lease Measurement]  
 [WFX-Waterflood Expansion] [PMX-Pressure Maintenance Expansion]  
 [SWD-Salt Water Disposal] [IPI-Injection Pressure Increase]  
 [EOR-Qualified Enhanced Oil Recovery Certification] [PPR-Positive Production Response]

[1] **TYPE OF APPLICATION** - Check Those Which Apply for [A]

- [A] Location - Spacing Unit - Simultaneous Dedication  
☐ NSL ☐ NSP ☐ SD

Check One Only for [B] or [C]

- [B] Commingling - Storage - Measurement  
☐ DHC ☐ CTB ☒ PLC ☐ PC ☐ OLS ☐ OLM
- [C] Injection - Disposal - Pressure Increase - Enhanced Oil Recovery  
☐ WFX ☐ PMX ☐ SWD ☐ IPI ☐ EOR ☐ PPR

- [D] Other: Specify \_\_\_\_\_

[2] **NOTIFICATION REQUIRED TO:** - Check Those Which Apply, or ☐ Does Not Apply

- [A] ☒ Working, Royalty or Overriding Royalty Interest Owners
- [B] ☐ Offset Operators, Leaseholders or Surface Owner
- [C] ☐ Application is One Which Requires Published Legal Notice
- [D] ☒ Notification and/or Concurrent Approval by BLM or SLO  
U.S. Bureau of Land Management - Commissioner of Public Lands, State Land Office
- [E] ☒ For all of the above, Proof of Notification or Publication is Attached, and/or,
- [F] ☐ Waivers are Attached

[3] **SUBMIT ACCURATE AND COMPLETE INFORMATION REQUIRED TO PROCESS THE TYPE OF APPLICATION INDICATED ABOVE.**

[4] **CERTIFICATION:** I hereby certify that the information submitted with this application for administrative approval is **accurate** and **complete** to the best of my knowledge. I also understand that **no action** will be taken on this application until the required information and notifications are submitted to the Division.

Note: Statement must be completed by an individual with managerial and/or supervisory capacity.

Jennifer Duarte \_\_\_\_\_ Regulatory Specialist 9/19/13  
 Print or Type Name Signature Title Date  
 \_\_\_\_\_ jennifer.duarte@oxy.com  
 e-mail Address

OXY USA

25 wells

① 'Goodnight 26' wells

⑤ 'Goodnight 27' wells

2013 SEP 20 P 12:54

RECEIVED OCD

① 'Goodnight 35' wells

② 'Cypress 33' wells

④ 'Cypress 28' wells

⑧ 'Cypress 34' wells



District I  
1625 N. French Drive, Hobbs, NM 88240  
District II  
811 S. First St., Artesia, NM 88210  
District III  
1000 Rio Brazos Road, Aztec, NM 87410  
District IV  
1220 S. St Francis Dr, Santa Fe, NM  
87505

State of New Mexico  
Energy, Minerals and Natural Resources Department

Form C-107-B  
Revised August 1, 2011

**OIL CONSERVATION DIVISION**  
1220 S. St Francis Drive  
Santa Fe, New Mexico 87505

Submit the original  
application to the Santa Fe  
office with one copy to the  
appropriate District Office.

**APPLICATION FOR SURFACE COMMINGLING (DIVERSE OWNERSHIP)**

OPERATOR NAME: OXY USA INC 16696  
OPERATOR ADDRESS: 5 GREENWAY PLAZA, SUITE 110; HOUSTON, TX 77046  
APPLICATION TYPE:

☐ Pool Commingling ☐ Lease Commingling ☒ Pool and Lease Commingling ☐ Off-Lease Storage and Measurement (Only if not Surface Commingled)

LEASE TYPE: ☐ Fee ☐ State ☒ Federal

Is this an Amendment to existing Order? ☐ Yes ☒ No If "Yes", please include the appropriate Order No. \_\_\_\_\_  
Have the Bureau of Land Management (BLM) and State Land office (SLO) been notified in writing of the proposed commingling  
☒ Yes ☐ No

**(A) POOL COMMINGLING**  
Please attach sheets with the following information

(1) Pool Names and Codes	Gravities / BTU of Non-Commingled Production	Calculated Gravities / BTU of Commingled Production		Calculated Value of Commingled Production	Volumes
See Attached list					

- (2) Are any wells producing at top allowables? ☐ Yes ☐ No  
(3) Has all interest owners been notified by certified mail of the proposed commingling? ☒ Yes ☐ No.  
(4) Measurement type: ☐ Metering ☒ Other (Specify)  
(5) Will commingling decrease the value of production? ☐ Yes ☒ No If "yes", describe why commingling should be approved

**(B) LEASE COMMINGLING**  
Please attach sheets with the following information

- (1) Pool Name and Code.  
(2) Is all production from same source of supply? ☒ Yes ☐ No  
(3) Has all interest owners been notified by certified mail of the proposed commingling? ☒ Yes ☐ No  
(4) Measurement type: ☐ Metering ☒ Other (Specify)

**(C) POOL and LEASE COMMINGLING**  
Please attach sheets with the following information

- (1) Complete Sections A and E.

**(D) OFF-LEASE STORAGE and MEASUREMENT**  
Please attached sheets with the following information

- (1) Is all production from same source of supply? ☒ Yes ☐ No  
(2) Include proof of notice to all interest owners.

**(E) ADDITIONAL INFORMATION (for all application types)**  
Please attach sheets with the following information

- (1) A schematic diagram of facility, including legal location.  
(2) A plat with lease boundaries showing all well and facility locations. Include lease numbers if Federal or State lands are involved.  
(3) Lease Names, Lease and Well Numbers, and API Numbers.

I hereby certify that the information above is true and complete to the best of my knowledge and belief.

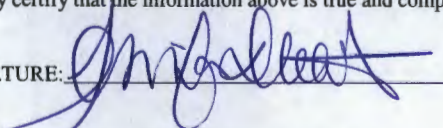
SIGNATURE:  TITLE: REGULATORY SPECIALIST DATE: 09/19/2013  
TYPE OR PRINT NAME: JENNIFER DUARTE TELEPHONE NO.: 713-513-6640 E-MAIL ADDRESS: jennifer\_duarte@oxy.com



UNITED STATES  
DEPARTMENT OF THE INTERIOR  
BUREAU OF LAND MANAGEMENT

FORM APPROVED  
OMB NO. 1004-0135  
Expires: July 31, 2010

**SUNDRY NOTICES AND REPORTS ON WELLS**  
*Do not use this form for proposals to drill or to re-enter an abandoned well. Use form 3160-3 (APD) for such proposals.*

5. Lease Serial No.  
NMNM103603

6. If Indian, Allottee or Tribe Name

**SUBMIT IN TRIPLICATE - Other instructions on reverse side.**

7. If Unit or CA/Agreement, Name and/or No.

1. Type of Well

☒ Oil Well ☐ Gas Well ☐ Other

8. Well Name and No.  
VARIOUS MULTIPLE

2. Name of Operator  
OXY USA INC

Contact: JENNIFER A DUARTE  
E-Mail: JENNIFER\_DUARTE@OXY.COM

9. API Well No.

3a. Address  
PO BOX 4294  
HOUSTON, TX 77210

3b. Phone No. (include area code)  
Ph: 713-513-6640

10. Field and Pool, or Exploratory  
VARIOUS

4. Location of Well (Footage, Sec., T., R., M., or Survey Description)

11. County or Parish, and State  
EDDY COUNTY, NM

**12. CHECK APPROPRIATE BOX(ES) TO INDICATE NATURE OF NOTICE, REPORT, OR OTHER DATA**

TYPE OF SUBMISSION	TYPE OF ACTION			
<input checked="" type="checkbox"/> Notice of Intent	<input type="checkbox"/> Acidize	<input type="checkbox"/> Deepen	<input type="checkbox"/> Production (Start/Resume)	<input type="checkbox"/> Water Shut-Off
<input type="checkbox"/> Subsequent Report	<input type="checkbox"/> Alter Casing	<input type="checkbox"/> Fracture Treat	<input type="checkbox"/> Reclamation	<input type="checkbox"/> Well Integrity
<input type="checkbox"/> Final Abandonment Notice	<input type="checkbox"/> Casing Repair	<input type="checkbox"/> New Construction	<input type="checkbox"/> Recomplete	<input checked="" type="checkbox"/> Other
	<input type="checkbox"/> Change Plans	<input type="checkbox"/> Plug and Abandon	<input type="checkbox"/> Temporarily Abandon	Surface Commingling
	<input type="checkbox"/> Convert to Injection	<input type="checkbox"/> Plug Back	<input type="checkbox"/> Water Disposal	

13. Describe Proposed or Completed Operation (clearly state all pertinent details, including estimated starting date of any proposed work and approximate duration thereof. If the proposal is to deepen directionally or recomplete horizontally, give subsurface locations and measured and true vertical depths of all pertinent markers and zones. Attach the Bond under which the work will be performed or provide the Bond No. on file with BLM/BIA. Required subsequent reports shall be filed within 30 days following completion of the involved operations. If the operation results in a multiple completion or recompletion in a new interval, a Form 3160-4 shall be filed once testing has been completed. Final Abandonment Notices shall be filed only after all requirements, including reclamation, have been completed, and the operator has determined that the site is ready for final inspection.)

**APPLICATION FOR CENTRAL TANK BATTERY, LEASE COMMINGLE,  
OFF LEASE MEASUREMENT, SALES & STORAGE**

**I. Well List**

Please see attached list for all wells Oxy USA Inc. is requesting the BLM for surface commingling.

Well information contained in the attachment:

- Well name and number
- API number
- Central facility name
- Location to include ? , ? , Section, Township, and Range
- State (NM) Pool Name (formation) and Pool Code

14. I hereby certify that the foregoing is true and correct.

**Electronic Submission #220622 verified by the BLM Well Information System  
For OXY USA INC, sent to the Carlsbad**

Name (Printed/Typed) JENNIFER A DUARTE

Title REGULATORY SPECIALIST

Signature (Electronic Submission)

Date 09/19/2013

**THIS SPACE FOR FEDERAL OR STATE OFFICE USE**

Approved By \_\_\_\_\_

Title \_\_\_\_\_

Date \_\_\_\_\_

Conditions of approval, if any, are attached. Approval of this notice does not warrant or certify that the applicant holds legal or equitable title to those rights in the subject lease which would entitle the applicant to conduct operations thereon.

Office \_\_\_\_\_

Title 18 U.S.C. Section 1001 and Title 43 U.S.C. Section 1212, make it a crime for any person knowingly and willfully to make to any department or agency of the United States any false, fictitious or fraudulent statements or representations as to any matter within its jurisdiction.

**\*\* OPERATOR-SUBMITTED \*\* OPERATOR-SUBMITTED \*\* OPERATOR-SUBMITTED \*\***



## **Additional data for EC transaction #220622 that would not fit on the form**

### **32. Additional remarks, continued**

- Currently daily average from each contributing well (BOPD and MCFPD)
- Current oil gravity at 60 degrees Fahrenheit
- Current dry gas BTU

### **II. Proposed Method of Measurement / Allocation**

#### **Oil/Water/Gas Metering:**

Oil, water, and gas volumes from each well producing to its particular facility, Cypress 33-1 Battery / Cypress 34-1 Battery / Goodnight 27-1 Battery, will be allocated on a daily basis based on the most recent test using a test separator with a test meters for oil, water, and gas. Please see attachment for detailed list of which wells go to which facilities. Facility name is based on the well located on the facility location. Well tests for each well will be conducted at a minimum of one time per month for a minimum of 24 hours.

#### **Cypress 33-1 Battery**

- Oil Test Meter # 65802
- Gas Test Meter # 20037408

#### **Cypress 34-1 Battery**

- Oil Test Meter # 61325
- Gas Test Meter # 113259218

#### **Goodnight 27-1 Battery**

- Oil Test Meter # 10267
- Gas Test Meter # 04450188

#### **Measurement Points:**

All oil production will be sold from the Cypress 33-1 Battery via a LACT unit. Oil production from the Cypress 34-1 Battery and Goodnight 27-1 Battery are sent to the Cypress 33-1 Battery via an oil transfer pump. Gas production at each facility location will be sent through a volume transfer meter at the facility location. Facility name is based on the well located on the facility location. All gas production will be then sent to DCP for further processing.

#### **Cypress 33-1 Battery**

- Gas Transfer Meter # 57211
- Oil Sales LACT # NM19848

#### **Cypress 34-1 Battery**

- Gas Transfer Meter # 57325

#### **Goodnight 27-1 Battery**

- Gas Transfer Meter # 57324

### **III. Current Facility Diagrams**

Please see attached diagrams for the Cypress 33-1 Battery, Cypress 34-1 Battery, and Goodnight 27-1 Battery. The flow of produced fluids and valve positions during production and sales phases are shown in the diagram. Facility name is based on the well located on the facility location.

The commingling of production is in the interest of conservation and waste and will result in the most effective economic means of producing the reserves in place from the affected wells and will not result in reduced royalty or improper measurement of production. The proposed commingling will reduce operating expenses as well as reduce the surface facility footprint and overall emissions. OXY USA WTP LP understands the requested approval will not constitute the granting of any right-of-way or construction rights not granted by the lease instrument. These applications will be submitted separately for approval per NMOCD and BLM regulations.

The working interest, royalty interest and overriding royalty interest owners have been notified of this proposal by certified mail (see attached).

Signed: \_\_\_\_\_

Printed Name: Jennifer Duarte

Title: Regulatory Specialist

Date: 08/20/2013



# **APPLICATION FOR CENTRAL TANK BATTERY, LEASE COMMINGLE, OFF LEASE MEASUREMENT, SALES & STORAGE**

## **I. Well List**

Please see attached list for all wells Oxy USA Inc. is requesting the BLM for surface commingling. Well information contained in the attachment:

- Well name and number
- API number
- Central facility name
- Location to include ¼ , ¼ , Section, Township, and Range
- State (NM) Pool Name (formation) and Pool Code
- Currently daily average from each contributing well (BOPD and MCFPD)
- Current oil gravity at 60 degrees Fahrenheit
- Current dry gas BTU

## **II. Proposed Method of Measurement / Allocation**

### **Oil/Water/Gas Metering:**

Oil, water, and gas volumes from each well producing to its particular facility, Cypress 33-1 Battery / Cypress 34-1 Battery / Goodnight 27-1 Battery, will be allocated on a daily basis based on the most recent test using a test separator with a test meters for oil, water, and gas. Please see attachment for detailed list of which wells go to which facilities. Facility name is based on the well located on the facility location. Well tests for each well will be conducted at a minimum of one time per month for a minimum of 24 hours.

#### **Cypress 33-1 Battery**

- Oil Test Meter # 65802
- Gas Test Meter # 20037408

#### **Cypress 34-1 Battery**

- Oil Test Meter # 61325
- Gas Test Meter # 113259218

#### **Goodnight 27-1 Battery**

- Oil Test Meter # 10267
- Gas Test Meter # 04450188

### **Measurement Points:**

All oil production will be sold from the Cypress 33-1 Battery via a LACT unit. Oil production from the Cypress 34-1 Battery and Goodnight 27-1 Battery are sent to the Cypress 33-1 Battery via an oil transfer pump. Gas production at each facility location will be sent through a volume transfer meter at the facility location. Facility name is based on the well located on the facility location. All gas production will be then sent to DCP for further processing.

#### **Cypress 33-1 Battery**

- Gas Transfer Meter # 57211
- Oil Sales LACT # NM19848

#### **Cypress 34-1 Battery**

- Gas Transfer Meter # 57325

#### **Goodnight 27-1 Battery**

- Gas Transfer Meter # 57324

## **III. Current Facility Diagrams**

Please see attached diagrams for the Cypress 33-1 Battery, Cypress 34-1 Battery, and Goodnight 27-1 Battery. The flow of produced fluids and valve positions during production and sales phases are shown in the diagram. Facility name is based on the well located on the facility location.

The commingling of production is in the interest of conservation and waste and will result in the most effective economic means of producing the reserves in place from the affected wells and will not result in reduced royalty or improper measurement of production. The proposed commingling will reduce operating expenses as well as reduce the surface facility footprint and overall emissions. OXY

USA WTP LP understands the requested approval will not constitute the granting of any right-of-way or construction rights not granted by the lease instrument. These applications will be submitted separately for approval per NMOCD and BLM regulations.

The working interest, royalty interest and overriding royalty interest owners have been notified of this proposal by certified mail (see attached).

Signed: 

Printed Name: Jennifer Duarte

Title: Regulatory Specialist

Date: 08/20/2013



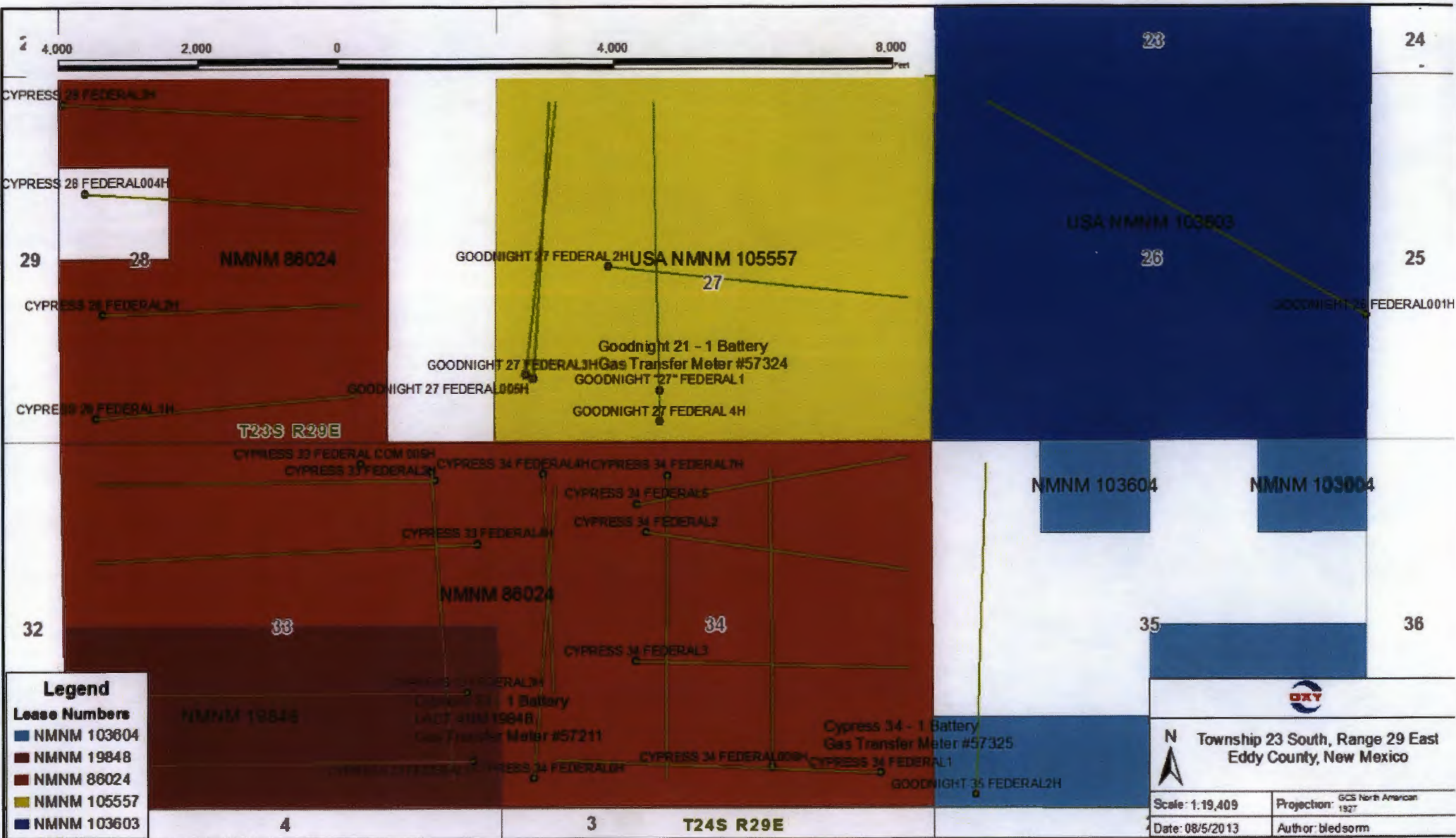



**DEPARTMENT OF THE INTERIOR  
BUREAU OF LAND MANAGEMENT  
CASE RECORDATION  
(MASS) Serial Register Page**

Run Time: 02:34 PM

Page 1 of 2

Run Date: 09/19/2013

01 12-22-1987;101STAT1330;30USC181 ET SE

Total Acres

Serial Number

Case Type 312021: O&G LSE COMP PD -1987

1,280.000

NMNM-- - 103603

Commodity 459: OIL & GAS L

Case Disposition: AUTHORIZED

Serial Number: NMNM-- - 103603

Name & Address			Int Rel	% Interest
CHESAPEAKE EXPLORATION LP	PO BOX 18496	OKLAHOMA CITY OK 731540496	OPERATING RIGHTS	0.0000000
CHEVRON USA INC	1400 SMITH ST	HOUSTON TX 770027327	OPERATING RIGHTS	0.0000000
ECHO PROD INC	PO BOX 1210	GRAHAM TX 76450	LESSEE	100.0000000
LATIGO PETROLEUM INC	15 W 6TH ST #1100	TULSA OK 74119	OPERATING RIGHTS	0.0000000
OXY USA INC	5 GREENWAY PLZ #110	HOUSTON TX 770460521	OPERATING RIGHTS	0.0000000
TALUS INC	PO BOX 1210	GRAHAM TX 76450	OPERATING RIGHTS	0.0000000
THE ALLAR CO	PO BOX 1567	GRAHAM TX 76450	OPERATING RIGHTS	0.0000000
TWIN MONTANA INC	PO BOX 1210	GRAHAM TX 76450	OPERATING RIGHTS	0.0000000

Serial Number: NMNM-- - 103603

Mer Twp	Rng	Sec	STyp	SNr Suff	Subdivision	District/Field Office	County	Mgmt Agency
23 0230S	0290E	023	ALL		ENTIRE SECTION	CARLSBAD FIELD OFFICE	EDDY	BUREAU OF LAND MGMT
23 0230S	0290E	026	ALL		ENTIRE SECTION	CARLSBAD FIELD OFFICE	EDDY	BUREAU OF LAND MGMT

Serial Number: NMNM-- - 103603

Act Date	Code	Action	Action Remark	Pending Office
10/19/1999	387	CASE ESTABLISHED	9910069	
10/20/1999	191	SALE HELD		
10/20/1999	267	BID RECEIVED	\$198400.00;	
10/20/1999	392	MONIES RECEIVED	\$2560.00;	
10/28/1999	392	MONIES RECEIVED	\$195840.00;	
11/22/1999	237	LEASE ISSUED		
11/22/1999	974	AUTOMATED RECORD VERIF	LBO	
12/01/1999	496	FUND CODE	05;145003	
12/01/1999	530	RLTY RATE - 12 1/2%		
12/01/1999	868	EFFECTIVE DATE		
01/18/2000	899	TRF OF ORR FILED		
02/04/2000	084	RENTAL RECEIVED BY ONRR	\$1920;11/MULTIPLE	
03/02/2000	932	TRF OPER RGTS FILED	ECHO/KUKUI	
05/19/2000	933	TRF OPER RGTS APPROVED	EFF 04/01/2000	
05/19/2000	974	AUTOMATED RECORD VERIF	ANN	
10/10/2000	084	RENTAL RECEIVED BY ONRR	\$1920;21/413	
01/15/2002	963	CASE MICROFILMED		
04/30/2003	817	MERGER RECOGNIZED	KUKUI INC/ANIMAS ENE	
06/27/2003	932	TRF OPER RGTS FILED	ANIMAS/SAGA;	
08/01/2003	933	TRF OPER RGTS APPROVED	EFF 07/01/03;	
08/01/2003	974	AUTOMATED RECORD VERIF	MV	
09/15/2003	932	TRF OPER RGTS FILED	ANIMAS ENE/SAGA PETRO	
10/30/2003	933	TRF OPER RGTS APPROVED	EFF 10/01/03;	
10/30/2003	974	AUTOMATED RECORD VERIF	JLV	
07/12/2004	932	TRF OPER RGTS FILED	SAGA PETRO/LATIGO1	
08/20/2004	933	TRF OPER RGTS APPROVED	EFF 08/01/04;	
08/20/2004	974	AUTOMATED RECORD VERIF	MV	
12/08/2006	932	TRF OPER RGTS FILED	LATIGO PE/CHEVRON M;1	
02/14/2007	933	TRF OPER RGTS APPROVED	EFF 01/01/07;	
02/14/2007	974	AUTOMATED RECORD VERIF	MV	

NO WARRANTY IS MADE BY BLM FOR USE OF THE DATA FOR PURPOSES NOT INTENDED BY BLM



**DEPARTMENT OF THE INTERIOR  
BUREAU OF LAND MANAGEMENT  
CASE RECORDATION  
(MASS) Serial Register Page**

Run Time: 02:36 PM

Page 1 of 2

Run Date: 09/19/2013

01 12-22-1987;101STAT1330;30USC181 ET SE

Total Acres  
640.000

Serial Number  
NMNM-- - 105557

Case Type 312021: O&G LSE COMP PD -1987

Commodity 459: OIL & GAS L

Case Disposition: AUTHORIZED

Serial Number: NMNM-- - 105557

Name & Address	Int Rel	% Interest
ANIMAS ENERGY LLC	OPERATING RIGHTS	0.0000000
CHEVRON MIDCONTINENT LP	OPERATING RIGHTS	0.0000000
CHEVRON USA INC	OPERATING RIGHTS	0.0000000
ECHO PROD INC	LESSEE	100.0000000
LATIGO PETROLEUM INC	OPERATING RIGHTS	0.0000000
OXY USA INC	OPERATING RIGHTS	0.0000000
OXY USA WTP LP	OPERATING RIGHTS	0.0000000
TALUS INC	OPERATING RIGHTS	0.0000000
THE ALLAR CO	OPERATING RIGHTS	0.0000000
TWIN MONTANA INC	OPERATING RIGHTS	0.0000000

Serial Number: NMNM-- - 105557

Mer Twp Rng Sec	STyp	SNr Suff	Subdivision	District/Field Office	County	Mgmt Agency
23 0230S 0290E 027	ALIQ		ALL;	CARLSBAD FIELD OFFICE	EDDY	BUREAU OF LAND MGMT

Serial Number: NMNM-- - 105557

Act Date	Code	Action	Action Remark	Pending Office
10/17/2000	387	CASE ESTABLISHED	200010035	
10/18/2000	191	SALE HELD		
10/18/2000	267	BID RECEIVED	\$121600.00;	
10/18/2000	392	MONIES RECEIVED	\$121600.00;	
11/07/2000	237	LEASE ISSUED		
11/07/2000	974	AUTOMATED RECORD VERIF	GSB	
12/01/2000	496	FUND CODE	05;145003	
12/01/2000	530	RLTY RATE - 12 1/2%		
12/01/2000	868	EFFECTIVE DATE		
12/05/2000	084	RENTAL RECEIVED BY ONRR	\$960.00;11/MULTIPLE	
01/19/2001	899	TRF OF ORR FILED		
03/19/2001	932	TRF OPER RGTS FILED	ECHO/KUKUI	
04/24/2001	933	TRF OPER RGTS APPROVED	EFF 04/01/01;	
04/24/2001	974	AUTOMATED RECORD VERIF	LR	
01/17/2002	963	CASE MICROFILMED		
04/30/2003	817	MERGER RECOGNIZED	KUKUI INC/ANIMAS ENE	
06/27/2003	932	TRF OPER RGTS FILED	ANIMAS/SAGA;	
07/29/2003	933	TRF OPER RGTS APPROVED	EFF 07/01/03;	
07/29/2003	974	AUTOMATED RECORD VERIF	MV	
08/15/2003	932	TRF OPER RGTS FILED	ALLAR CO/CHESAPEAKE	
08/15/2003	932	TRF OPER RGTS FILED	TALUS INC/CHESAPEAKE	
08/15/2003	932	TRF OPER RGTS FILED	TWIN MONTANA/CHESAPEA	
09/23/2003	933	TRF OPER RGTS APPROVED	01EFF 09/01/03;	
09/23/2003	933	TRF OPER RGTS APPROVED	02EFF 09/01/03;	
09/23/2003	933	TRF OPER RGTS APPROVED	03EFF 09/01/03;	
09/23/2003	974	AUTOMATED RECORD VERIF	LR	
07/12/2004	932	TRF OPER RGTS FILED	SAGA PETRO/LATIGO	
08/20/2004	933	TRF OPER RGTS APPROVED	EFF 08/01/04;	
08/20/2004	974	AUTOMATED RECORD VERIF	MV	



**DEPARTMENT OF THE INTERIOR  
BUREAU OF LAND MANAGEMENT  
CASE RECORDATION  
(MASS) Serial Register Page**

Run Time: 02:40 PM

Page 1 of 2

Run Date: 09/19/2013

01 02-25-1920;041STAT0437;30USC181ETSEQ

Total Acres

Serial Number

Case Type 311211: O&G LSE SIMO PUBLIC LAND

960.000

NMNM-- - 019848

Commodity 459: OIL & GAS L

Case Disposition: AUTHORIZED

Serial Number: NMNM-- - 019848

Name & Address			Int Rel	% Interest
BIRD CREEK RESOURCES INC	1412 S BOSTON #550	TULSA OK 74119	OPERATING RIGHTS	0.0000000
EXXONMOBIL OIL CORP	PO BOX 4358	HOUSTON TX 772104358	LESSEE	100.0000000
EXXONMOBIL OIL CORP	PO BOX 4358	HOUSTON TX 772104358	OPERATING RIGHTS	0.0000000
OXY USA INC	5 GREENWAY PLZ #110	HOUSTON TX 770460521	OPERATING RIGHTS	0.0000000
OXY USA INC	PO BOX 27570	HOUSTON TX 772277570	OPERATING RIGHTS	0.0000000

Serial Number: NMNM-- - 019848

Mer Twp	Rng	Sec	STyp	SNr Suff	Subdivision	District/Field Office	County	Mgmt Agency
23	0230S	0290E 029	ALIQ		ALL;	CARLSBAD FIELD OFFICE	EDDY	BUREAU OF LAND MGMT
23	0230S	0290E 033	ALIQ		S2;	CARLSBAD FIELD OFFICE	EDDY	BUREAU OF LAND MGMT

Relinquished/Withdrawn Lands

Serial Number: NMNM-- - 019848

23	0230S	0290E 720	FF		SWSE,SEGR;	CARLSBAD FIELD OFFICE	EDDY	BUREAU OF LAND MGMT
23	0230S	0290E 733	FF		N2,SEGR;	CARLSBAD FIELD OFFICE	EDDY	BUREAU OF LAND MGMT
23	0230S	0290E 734	FF		ALL,SEGR;	CARLSBAD FIELD OFFICE	EDDY	BUREAU OF LAND MGMT
23	0230S	0290E 735	FF		N2NW,SWNW,SEGR;	CARLSBAD FIELD OFFICE	EDDY	BUREAU OF LAND MGMT
23	0230S	0290E 728	FF		W2E2,W2,SEGR;	CARLSBAD FIELD OFFICE	EDDY	BUREAU OF LAND MGMT

Serial Number: NMNM-- - 019848

Act Date	Code	Action	Action Remark	Pending Office
10/22/1973	387	CASE ESTABLISHED	SPAR52;	
10/23/1973	888	DRAWING HELD		
04/24/1974	237	LEASE ISSUED		
05/01/1974	496	FUND CODE	05;145003	
05/01/1974	530	RLTY RATE - 12 1/2%		
05/01/1974	868	EFFECTIVE DATE		
12/01/1975	232	LEASE COMMITTED TO UNIT	NMNM70967X;LAGUNA GRA	
12/01/1975	700	LEASE SEGREGATED	INTO NMNM27728;	
03/27/1976	500	GEOGRAPHIC NAME	UNDEFINED FLD;	
03/27/1976	510	KMA CLASSIFIED		
06/15/1976	315	RENTAL RATE DET/ADJ	\$2.00;	
07/20/1976	102	NOTICE SENT-PROD STATUS		
09/13/1976	512	KMA EXPANDED		
01/16/1981	512	KMA EXPANDED		
01/16/1981	650	HELD BY PROD - ACTUAL	LAGUNA GRANDE UNIT	
03/27/1981	253	ELIM BY CONTRAC(PARTIAL)	NMNM70967X;LAGUNA GRA	
09/26/1987	974	AUTOMATED RECORD VERIF	GG/LR	
10/20/1988	963	CASE MICROFILMED	CNUM,102,942	
06/27/1990	700	LEASE SEGREGATED	INTO NMNM86024;	
06/03/1991	899	TRF OF ORR FILED	(1)	
06/03/1991	899	TRF OF ORR FILED	(2)	
09/10/1991	932	TRF OPER RGTS FILED	TRIPOD/BIRD CREEK	
01/13/1992	933	TRF OPER RGTS APPROVED	EFF 10/01/91;	
01/13/1992	974	AUTOMATED RECORD VERIF	AR/CG	
07/13/1992	899	TRF OF ORR FILED		
12/02/1992	974	AUTOMATED RECORD VERIF	CM/JS	
04/29/1993	111	RENTAL RECEIVED	\$1040.00;41/000000180	



**DEPARTMENT OF THE INTERIOR  
BUREAU OF LAND MANAGEMENT  
CASE RECORDATION  
(MASS) Serial Register Page**

Run Time: 02:42 PM

Page 1 of 2

Run Date: 09/19/2013

01 02-25-1920;041STAT0437;30USC181ETSEQ

Total Acres  
1,440.000

Serial Number  
NMNM-- - 086024

Case Type 311211: O&G LSE SIMO PUBLIC LAND

Commodity 459: OIL & GAS L

Case Disposition: AUTHORIZED

Serial Number: NMNM-- - 086024

Name & Address			Int Rel	% Interest
EXXONMOBIL OIL CORP	PO BOX 4358	HOUSTON TX 772104358	OPERATING RIGHTS	0.0000000
EXXONMOBIL OIL CORP	PO BOX 4358	HOUSTON TX 772104358	LESSEE	100.0000000
OXY USA INC	5 GREENWAY PLZ #110	HOUSTON TX 770460521	OPERATING RIGHTS	0.0000000
OXY USA INC	PO BOX 27570	HOUSTON TX 772277570	OPERATING RIGHTS	0.0000000
PENWELL ENERGY INC	600 N MARIENFELD #1100	MIDLAND TX 79701	OPERATING RIGHTS	0.0000000

Serial Number: NMNM-- - 086024

Mer Twp	Rng	Sec	STyp	SNr Suff	Subdivision	District/Field Office	County	Mgmt Agency
23 0230S	0290E	028	ALIQ		W2E2,W2;	CARLSBAD FIELD OFFICE	EDDY	BUREAU OF LAND MGMT
23 0230S	0290E	033	ALIQ		N2;	CARLSBAD FIELD OFFICE	EDDY	BUREAU OF LAND MGMT
23 0230S	0290E	034	ALIQ		ALL;	CARLSBAD FIELD OFFICE	EDDY	BUREAU OF LAND MGMT

Serial Number: NMNM-- - 086024

Act Date	Code	Action	Action Remark	Pending Office
10/22/1973	387	CASE ESTABLISHED	SPAR52;	
05/01/1974	496	FUND CODE	05;145003	
05/01/1974	530	RLTY RATE - 12 1/2%		
05/01/1974	868	EFFECTIVE DATE		
03/27/1976	500	GEOGRAPHIC NAME	UDEFINED FLD;	
03/27/1976	510	KMA CLASSIFIED		
06/15/1976	315	RENTAL RATE DET/ADJ	\$2.00;	
09/13/1976	512	KMA EXPANDED		
06/27/1990	209	CASE CREATED BY SEGR	OUT OF NMNM19848;	
06/27/1990	232	LEASE COMMITTED TO UNIT	NMNM82520X;LAGUNA SAL	
06/27/1990	647	MEMO OF LAST PROD-ALLOC	NMNM19848;	
06/27/1990	648	EXT BY PROD ON ASSOC LSE	NMNM19848;	
02/26/1991	653	HELD BY LOC IN PROD UNIT	NMNM82520X;	
12/02/1992	974	AUTOMATED RECORD VERIF	CM/JS	
12/21/1992	963	CASE MICROFILMED	CNUM 569,689 JMV	
12/29/1992	111	RENTAL RECEIVED	\$1440.00;11/710305	
04/16/1993	111	RENTAL RECEIVED	\$1440.00;21/179895	
04/19/1994	111	RENTAL RECEIVED	\$1440.00;21/185920	
08/01/1994	235	EXTENDED	THRU 08/01/96;	
08/01/1994	336	UNIT AGRMT TERMINATED	NMNM82520X;LAGUNA SAL	
04/24/1995	084	RENTAL RECEIVED BY ONRR	\$1440.00;21/000000500	
04/24/1996	084	RENTAL RECEIVED BY ONRR	\$1440.00;21/000000503	
10/24/1996	974	AUTOMATED RECORD VERIF	GAG;	
04/21/1997	084	RENTAL RECEIVED BY ONRR	\$2880.00;21/000000506	
05/29/1997	932	TRF OPER RGTS FILED	EXXON/PENWELL ENE	
07/08/1997	933	TRF OPER RGTS APPROVED	EFF 06/01/97;	
07/08/1997	974	AUTOMATED RECORD VERIF	MV/MV	
01/15/1998	575	APD FILED		
02/23/1998	576	APD APPROVED	#1 COCHITI "28" FED	
04/17/1998	084	RENTAL RECEIVED BY ONRR	\$2880.00;21/000000508	
10/29/1998	650	HELD BY PROD - ACTUAL		



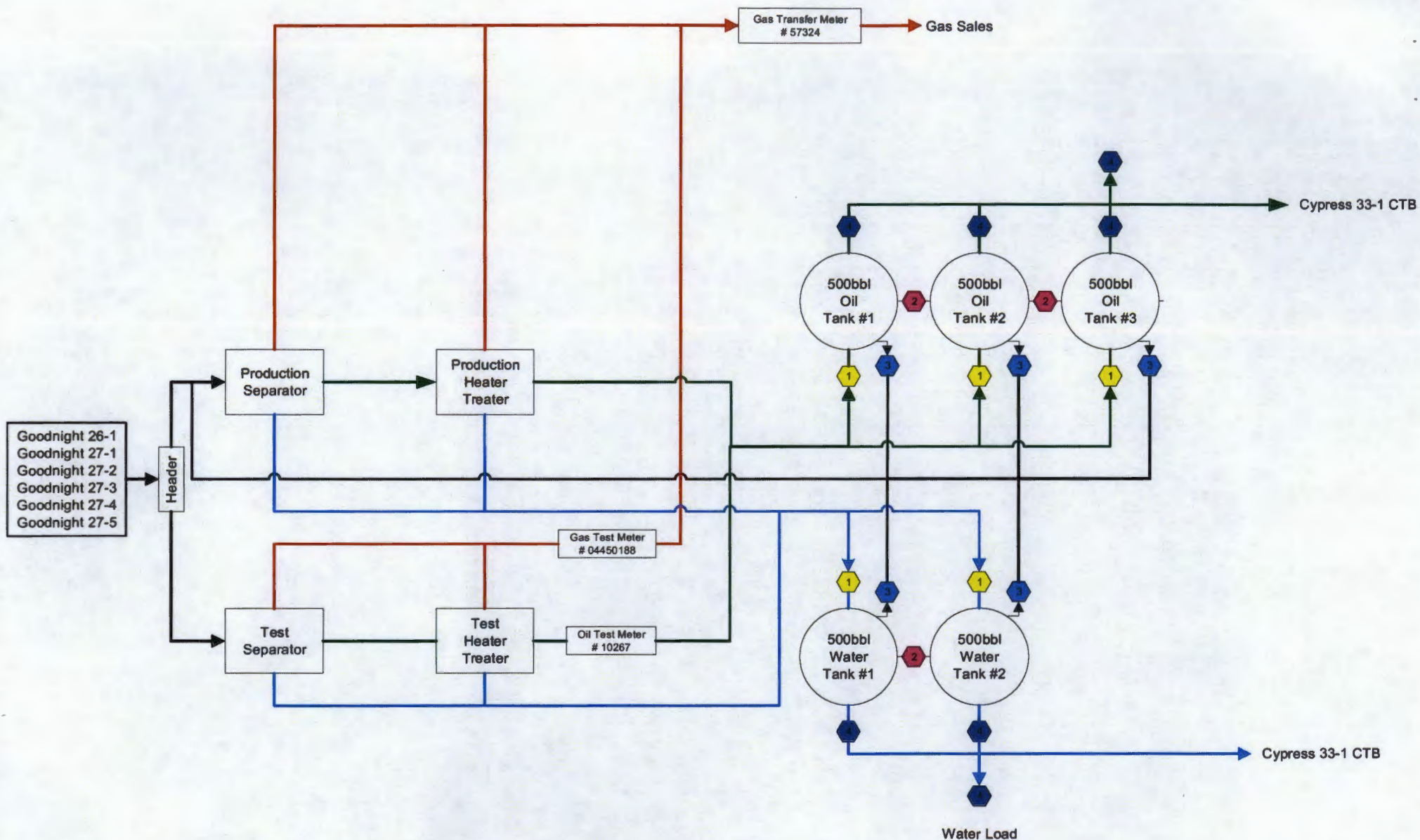

OXY

Facility Name: Goodnight 27-1 CTB  
Lease Serial #: NMNM 105557  
Located at: Section 27, T23S R29E  
Eddy County, NM

This lease is subject to the security plan for the Carlsbad Operation. The plan is located at: 1502 W Commerce Dr, Carlsbad, NM 88220

#### I. Production Phase:

- 1) Valve #1 – All Tanks – Open
- 2) Valve #2 – All Tanks – Open
- 3) Valve #3 – Oil Tanks – Open
- 4) Valve #3 – Water Tanks – Closed
- 5) Valve #4 – Oil Tanks – Open to Cypress 33-1 CTB, Closed to Oil Load
- 6) Valve #4 – Water Tanks – Open to Cypress 33-1 CTB, Closed to Water Load

#### II. Transfer to CTB Phase:

- 1) Oil Tank for transfer to CTB will have Valve #4 Open, except for oil load Valve #4
- 2) Water Tank for transfer to CTB will have Valve #4 Open, except for water load Valve #4



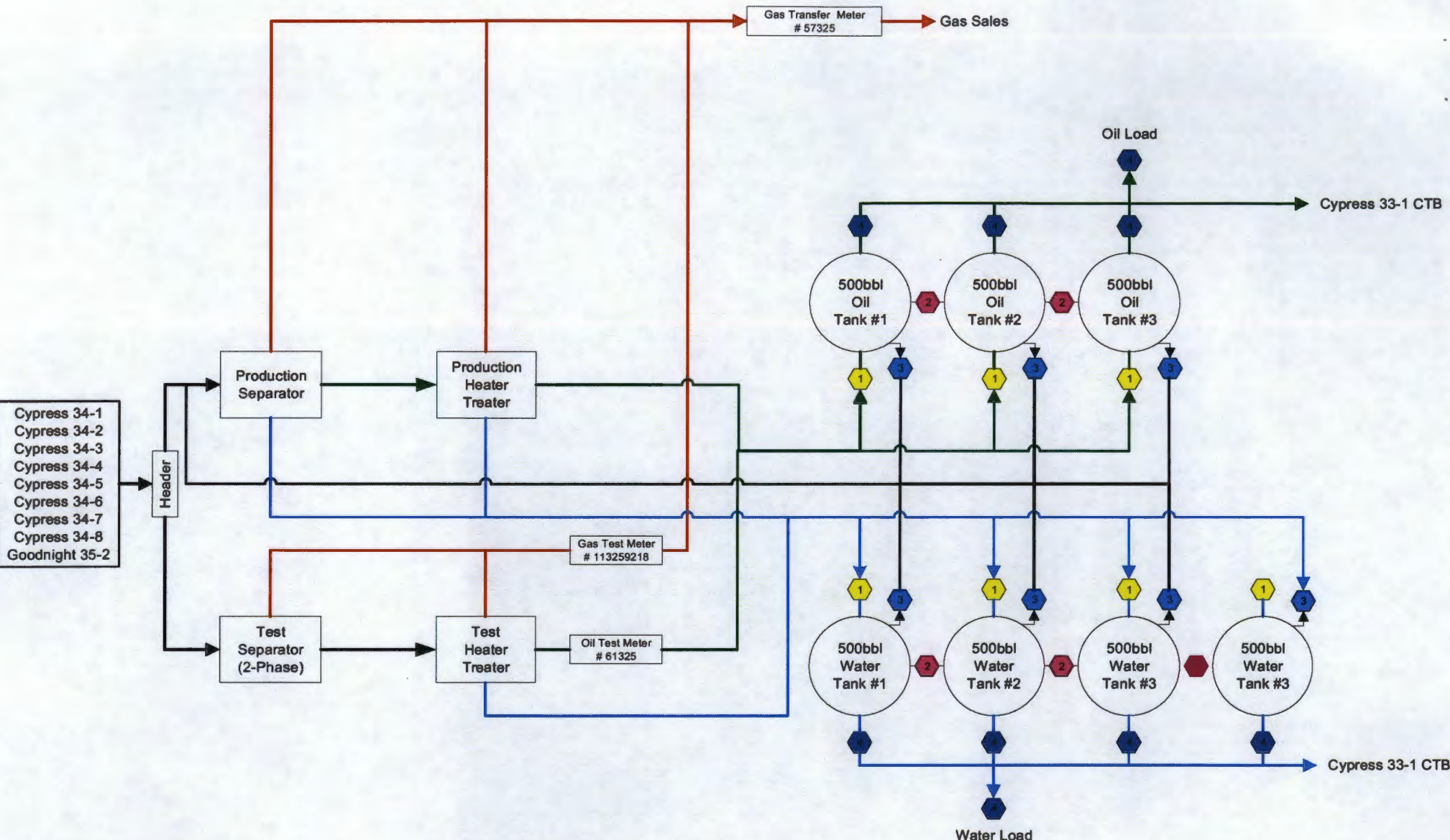

OXY  
 Facility Name: Cypress 34-1 CTB  
 Lease Serial #: NMNM 86024  
 Located at: Section 34, T23S R29E  
 Eddy County, NM

This lease is subject to the security plan for the Carlsbad Operation. The plan is located at: 1502 W Commerce Dr, Carlsbad, NM 88220

**I. Production Phase:**

- 1) Valve #1 – All Tanks – Open
- 2) Valve #2 – All Tanks – Open
- 3) Valve #3 – Oil Tanks – Open
- 4) Valve #3 – Water Tanks – Closed
- 5) Valve #4 – Oil Tanks – Open to Cypress 33-1 CTB, Closed to Oil Load
- 6) Valve #4 – Water Tanks – Open to Cypress 33-1 CTB, Closed to Water Load

**II. Transfer to CTB Phase:**

- 1) Oil Tank for transfer to CTB will have Valve #4 Open, except for oil load Valve #4
- 2) Water Tank for transfer to CTB will have Valve #4 Open, except for water load Valve #4



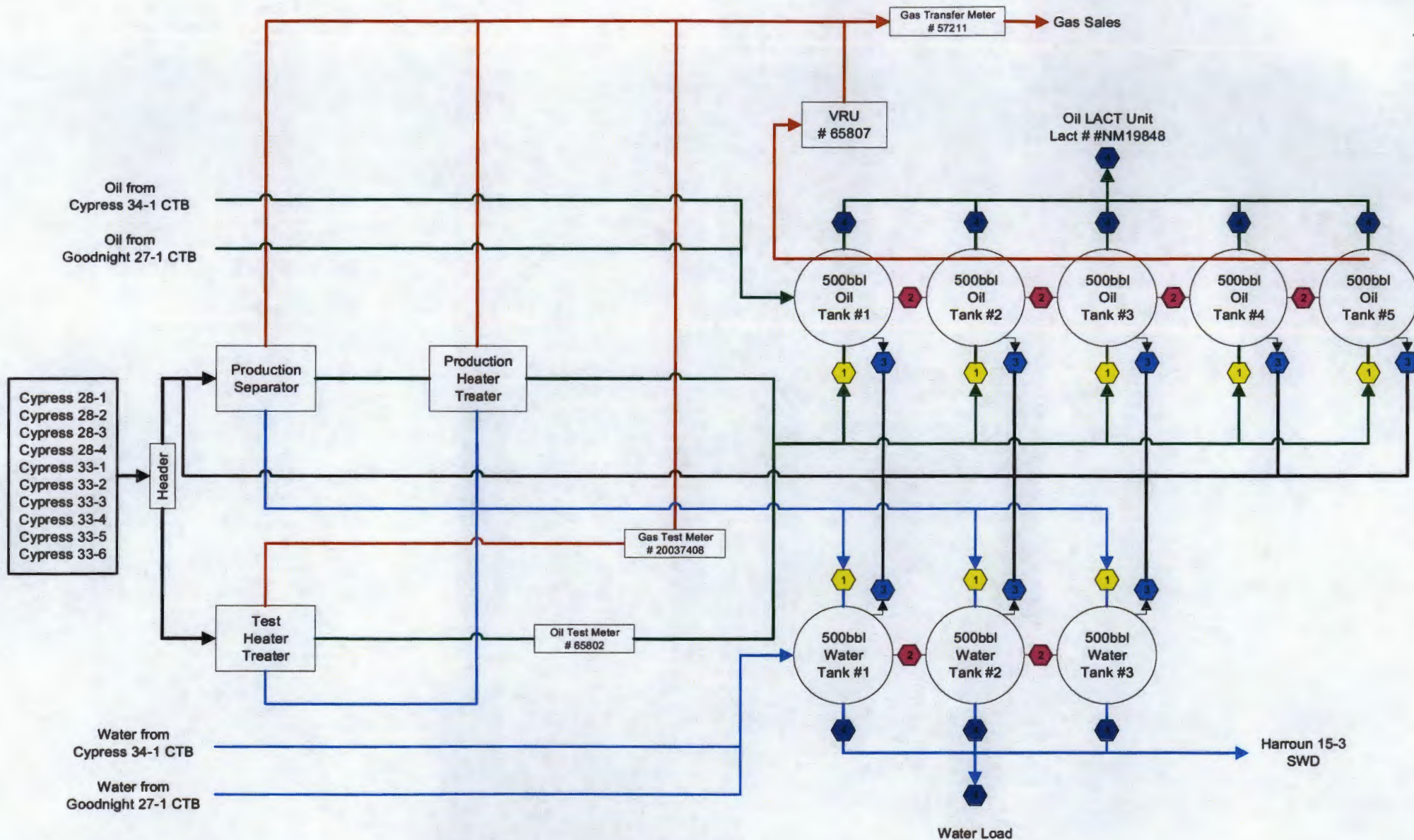

#### OXY

Facility Name: Cypress 33-1 CTB  
Lease Serial #: NMNM 19848  
Located at: Section 33, T23S R29E  
Eddy County, NM

This lease is subject to the security plan for the Carlsbad Operation. The plan is located at: 1502 W Commerce Dr, Carlsbad, NM 88220

#### I. Production Phase:

- 1) Valve #1 – All Tanks – Open
- 2) Valve #2 – All Tanks – Open
- 3) Valve #3 – Oil Tanks – Open
- 4) Valve #3 – Water Tanks – Closed
- 5) Valve #4 – Oil Tanks – Closed
- 6) Valve #4 – Water Tanks – Closed to Water Load, Open to SWD

#### II. Sales Phase:

- 1) Oil Tank for sales will have Valve #4 Open, all other valves (1,2, and 3) will be Closed



GOODNIGHT 27 FEDERAL 002H

Goodnight 27-1 Battery

GOODNIGHT 27 FEDERAL 005H GOODNIGHT 27 FEDERAL 001

GOODNIGHT 27 FEDERAL 004H

GOODNIGHT 26 FEDERAL 001

















OXY USA WTP Limited Partnership / OXY USA INC /  
OCCIDENTIAL PERMIAN LP  
A subsidiary of Occidental Petroleum Corporation

5 Greenway Plaza, Suite 110, Houston, Texas 77046  
P.O. Box 4294, Houston, Texas 77210-4294  
Direct: 713.513.6640 Cell: 832.740.3716  
Jennifer\_duarte@oxy.com

September 19, 2013

**CERTIFIED MAIL**  
**RETURN RECEIPT REQUESTED**

Interest Owners

Re: Request for a CTB & Commingle  
CTB Location: Sec 33-T 23S-R 29E – Cypress 33-1 CTB  
Pool: Laguna Salado; Bone Spring South(96857); Cedar Canyon; Bone Spring (11520); Harroun  
Ranch; Delaware, NE (96857); Nash Draw; Delaware, SW (97148)  
Eddy County, New Mexico

To Whom It May Concern:

This is to advise you that OXY USA WTP LP is filing an application with the New Mexico Oil Conservation Division ("NMOCD") seeking approval for a Central Tanks Battery & Off-lease Gas Measurement, Sales, & Storage for the above mentioned wells.

A copy of our application submitted to the Division is attached.

Any objection or requests that a hearing should be held regarding this application must be submitted to the New Mexico Oil Conservation Division Santa Fe Office within 20 Days from the date of this letter.

Please contact me should you have any questions or need anything further.

Thank you in advance for your time.

Very Truly Yours,

OXY USA WTP Limited Partnership / OXY USA INC / OCCIDENTIAL PERMIAN LP  
Jennifer Duarte  
Regulatory Specialist

Enclosure



<b><u>Working Interest Name</u></b>	<b><u>Address #1</u></b>	<b><u>Certified Number</u></b>
ARCADIA RESOURCES LP	PO Box 18756 Oklahoma City, OK 73154	70131090000009726317
CHESAPEAKE EXPLORATION LP	PO Box 203892 Dallas, TX 75320-3892	70131090000009726300
CHEVRON MIDCONTINENT LP	PO Box 730365 Dallas, TX 75373-0365	70131090000009726294
CHEVRON U S A INC	PO Box 730436 Dallas, TX 75373-0436	70131090000009726287
EXXON MOBIL CORP	PO Box 951027 Dallas, TX 75395	70131090000009726270
KENNETH C HAGGART	PO Box 1210 Graham, TX 76450	70131090000009726263
TALUS INC.	PO Box 1210 Graham, TX 76450	70131090000009726256
THE ALLAR COMPANY	PO Box 1567 Graham, TX 76450	70131090000009726249
TWIN MONTANA, INC	PO Box 1210 Graham, TX 76450	70131090000009726232