

ABOVE THIS LINE FOR DIVISION USE ONLY

NEW MEXICO OIL CONSERVATION DIVISION  
- Engineering Bureau -  
1220 South St. Francis Drive, Santa Fe, NM 87505



RECEIVED  
OCT 10 2014

**ADMINISTRATIVE APPLICATION CHECKLIST**

THIS CHECKLIST IS MANDATORY FOR ALL ADMINISTRATIVE APPLICATIONS FOR EXCEPTIONS TO DIVISION RULES AND REGULATIONS WHICH REQUIRE PROCESSING AT THE DIVISION LEVEL IN SANTA FE

**Application Acronyms:**

- [NSL-Non-Standard Location] [NSP-Non-Standard Proration Unit] [SD-Simultaneous Dedication]
- [DHC-Downhole Commingling] [CTB-Lease Commingling] [PLC-Pool/Lease Commingling]
- [PC-Pool Commingling] [OLS - Off-Lease Storage] [OLM-Off-Lease Measurement]
- [WFX-Waterflood Expansion] [PMX-Pressure Maintenance Expansion]
- [SWD-Salt Water Disposal] [IPI-Injection Pressure Increase]
- [EOR-Qualified Enhanced Oil Recovery Certification] [PPR-Positive Production Response]

- [1] TYPE OF APPLICATION - Check Those Which Apply for [A]
- [A] Location - Spacing Unit - Simultaneous Dedication  
 NSL  NSP  SD
- Check One Only for [B] or [C]
- [B] Commingling - Storage - Measurement  
 DHC  CTB  PLC  PC  OLS  OLM
- [C] Injection - Disposal - Pressure Increase - Enhanced Oil Recovery  
 WFX  PMX  SWD  IPI  EOR  PPR
- [D] Other: Specify \_\_\_\_\_

CTB-664-A  
 - Yates Petroleum  
 Corp  
 25575  
 Pool  
 - Livingston  
 Ridge, Delaware  
 39360

- [2] NOTIFICATION REQUIRED TO: - Check Those Which Apply, or Does Not Apply
- [A]  Working, Royalty or Overriding Royalty Interest Owners
- [B]  Offset Operators, Leaseholders or Surface Owner
- [C]  Application is One Which Requires Published Legal Notice
- [D]  Notification and/or Concurrent Approval by BLM or SLO  
U.S. Bureau of Land Management - Commissioner of Public Lands, State Land Office
- [E]  For all of the above, Proof of Notification or Publication is Attached, and/or,
- [F]  Waivers are Attached

Wells  
 - Attachment A

[3] SUBMIT ACCURATE AND COMPLETE INFORMATION REQUIRED TO PROCESS THE TYPE OF APPLICATION INDICATED ABOVE.

[4] CERTIFICATION: I hereby certify that the information submitted with this application for administrative approval is **accurate** and **complete** to the best of my knowledge. I also understand that **no action** will be taken on this application until the required information and notifications are submitted to the Division.

Note: Statement must be completed by an individual with managerial and/or supervisory capacity.

Miriam Morales \_\_\_\_\_  
 Print or Type Name Signature

Production Analyst \_\_\_\_\_  
 Title Date

mmorales@yatespetroleum.com  
 e-mail Address

District I  
1625 N. French Drive, Hobbs, NM 88240  
District II  
1301 W. Grand Ave, Artesia, NM 88210  
District III  
1000 Rio Brazos Road, Aztec, NM 87410  
District IV  
1220 S. St Francis Dr, Santa Fe, NM  
87505

State of New Mexico  
Energy, Minerals and Natural Resources Department

Form C-107-B  
Revised June 10, 2003

**OIL CONSERVATION DIVISION**  
1220 S. St Francis Drive  
Santa Fe, New Mexico 87505

Submit the original application to the Santa Fe office with one copy to the appropriate District Office.

**APPLICATION FOR SURFACE COMMINGLING (DIVERSE OWNERSHIP)**

OPERATOR NAME: Yates Petroleum Corporation  
OPERATOR ADDRESS: 105 South Fourth St. Artesia, NM 88210  
APPLICATION TYPE:

Pool Commingling  Lease Commingling  Pool and Lease Commingling  Off-Lease Storage and Measurement (Only if not Surface Commingled)

LEASE TYPE:  Fee  State  Federal

Is this an Amendment to existing Order?  Yes  No If "Yes", please include the appropriate Order No. CTB-664  
Have the Bureau of Land Management (BLM) and State Land office (SLO) been notified in writing of the proposed commingling  
 Yes  No

**(A) POOL COMMINGLING**  
Please attach sheets with the following information

(1) Pool Names and Codes	Gravities / BTU of Non-Commingled Production	Calculated Gravities / BTU of Commingled Production		Calculated Value of Commingled Production	Volumes

- (2) Are any wells producing at top allowables?  Yes  No  
 (3) Has all interest owners been notified by certified mail of the proposed commingling?  Yes  No.  
 (4) Measurement type:  Metering  Other (Specify)  
 (5) Will commingling decrease the value of production?  Yes  No If "yes", describe why commingling should be approved

**(B) LEASE COMMINGLING**  
Please attach sheets with the following information

- (1) Pool Name and Code. Livingston Ridge; Delaware 39360  
 (2) Is all production from same source of supply?  Yes  No  
 (3) Has all interest owners been notified by certified mail of the proposed commingling?  Yes  No  
 (4) Measurement type:  Metering  Other (Specify)

**(C) POOL and LEASE COMMINGLING**  
Please attach sheets with the following information

- (1) Complete Sections A and E.

**(D) OFF-LEASE STORAGE and MEASUREMENT**  
Please attached sheets with the following information

- (1) Is all production from same source of supply?  Yes  No  
 (2) Include proof of notice to all interest owners.

**(E) ADDITIONAL INFORMATION (for all application types)**  
Please attach sheets with the following information

- (1) A schematic diagram of facility, including legal location.  
 (2) A plat with lease boundaries showing all well and facility locations. Include lease numbers if Federal or State lands are involved.  
 (3) Lease Names, Lease and Well Numbers, and API Numbers.

I hereby certify that the information above is true and complete to the best of my knowledge and belief.

SIGNATURE: *Miriam Morales* TITLE: Production Analyst DATE: 7/8/14  
 TYPE OR PRINT NAME Miriam Morales TELEPHONE NO.: (575) 748-1471  
 E-MAIL ADDRESS: mmorales@yatespetroleum.com

UNITED STATES  
DEPARTMENT OF THE INTERIOR  
BUREAU OF LAND MANAGEMENT

FORM APPROVED  
OMB NO. 1004-0135  
Expires: July 31, 2010

**SUNDRY NOTICES AND REPORTS ON WELLS**  
*Do not use this form for proposals to drill or to re-enter an abandoned well. Use form 3160-3 (APD) for such proposals.*

5. Lease Serial No.  
NMNM65417

6. If Indian, Allottee or Tribe Name

**SUBMIT IN TRIPLICATE - Other instructions on reverse side.**

7. If Unit or CA/Agreement, Name and/or No.

1. Type of Well  
 Oil Well  Gas Well  Other

8. Well Name and No.  
MARTHA AIK FEDERAL 8H

2. Name of Operator Contact: MIRIAM MORALES  
YATES PETROLEUM CORPORATION -Mail: mmorales@yatespetroleum.com

9. API Well No.  
30-015-39733

3a. Address 105 S FOURTH  
ARTESIA, NM 88210

3b. Phone No. (include area code)  
Ph: 575-748-4200

10. Field and Pool, or Exploratory  
LIVINGSTON RIDGE;DELAWARE

4. Location of Well (Footage, Sec., T., R., M., or Survey Description)  
Sec 11 T22S R31E NENE 430FNL 200FEL

11. County or Parish, and State  
EDDY COUNTY, NM

**12. CHECK APPROPRIATE BOX(ES) TO INDICATE NATURE OF NOTICE, REPORT, OR OTHER DATA**

TYPE OF SUBMISSION	TYPE OF ACTION			
<input checked="" type="checkbox"/> Notice of Intent	<input type="checkbox"/> Acidize	<input type="checkbox"/> Deepen	<input type="checkbox"/> Production (Start/Resume)	<input type="checkbox"/> Water Shut-Off
<input type="checkbox"/> Subsequent Report	<input type="checkbox"/> Alter Casing	<input type="checkbox"/> Fracture Treat	<input type="checkbox"/> Reclamation	<input type="checkbox"/> Well Integrity
<input type="checkbox"/> Final Abandonment Notice	<input type="checkbox"/> Casing Repair	<input type="checkbox"/> New Construction	<input type="checkbox"/> Recomplete	<input checked="" type="checkbox"/> Other Surface Commingling
	<input type="checkbox"/> Change Plans	<input type="checkbox"/> Plug and Abandon	<input type="checkbox"/> Temporarily Abandon	
	<input type="checkbox"/> Convert to Injection	<input type="checkbox"/> Plug Back	<input type="checkbox"/> Water Disposal	

13. Describe Proposed or Completed Operation (clearly state all pertinent details, including estimated starting date of any proposed work and approximate duration thereof. If the proposal is to deepen directionally or recomplete horizontally, give subsurface locations and measured and true vertical depths of all pertinent markers and zones. Attach the Bond under which the work will be performed or provide the Bond No. on file with BLM/BIA. Required subsequent reports shall be filed within 30 days following completion of the involved operations. If the operation results in a multiple completion or recompletion in a new interval, a Form 3160-4 shall be filed once testing has been completed. Final Abandonment Notices shall be filed only after all requirements, including reclamation, have been completed, and the operator has determined that the site is ready for final inspection.)

Filing of application due to diversified ownership (WI/OR. All wells on same lease-BLM notification only.

Yates Petroleum respectfully requests approval to amend CTB-665 by adding the Martha AIK Federal #7H and Martha AIK Federal #8H.

Yates will like to commingle production for the Martha #1-11H, 13H and 14H.

The commingle production will be measured and sold at the Martha battery located at SESE, Sec. 11-T22S-R31E.

The ownership is diversified. All owners will be notified (see attach).

14. I hereby certify that the foregoing is true and correct.

**Electronic Submission #251948 verified by the BLM Well Information System  
For YATES PETROLEUM CORPORATION, sent to the Carlsbad**

Name (Printed/Typed) MIRIAM MORALES Title PRODUCTION ANALYST

Signature (Electronic Submission) Date 07/08/2014

**THIS SPACE FOR FEDERAL OR STATE OFFICE USE**

Approved By \_\_\_\_\_ Title \_\_\_\_\_ Date \_\_\_\_\_

Conditions of approval, if any, are attached. Approval of this notice does not warrant or certify that the applicant holds legal or equitable title to those rights in the subject lease which would entitle the applicant to conduct operations thereon.

Office

Title 18 U.S.C. Section 1001 and Title 43 U.S.C. Section 1212, make it a crime for any person knowingly and willfully to make to any department or agency of the United States any false, fictitious or fraudulent statements or representations as to any matter within its jurisdiction.

**\*\* OPERATOR-SUBMITTED \*\* OPERATOR-SUBMITTED \*\* OPERATOR-SUBMITTED \*\***

**Additional data for EC transaction #251948 that would not fit on the form**

**32. Additional remarks, continued**

Please see site facility diagram and all other documentation attach.

Royalty values will not be affected by this commingle.

## **Continuation of Martha AIK Federal #8H Surface/Lease Commingle**

### **Oil Measurement**

All of the wells with the exception of #1, 2, & 3, which utilize a single well test separator (common ownership), will be equipped with continuous meter separators for oil production prior to oil being commingled for sales at the Martha AIK Federal #1. Total sales/production will be allocated back to each individual well using the metered (daily well tests) volumes and periodic tests. Metered volumes will be compared to total battery volumes daily and monthly for accuracy. Any vapor recovery gas shall be included in this application.

### **Gas Measurement**

All of the wells with the exception of #1, 2, and 3 which utilize a single well test separator (common ownership) will be equipped with allocation meters for gas prior to commingle. The BLM point of measurement for this commingled production is at the Agave CDP meter # 4028 located on the Martha Battery.

NOTE- wells #1-3 each periodically produce separately through the test separator for allocation purposes.

The purpose of the Surface/lease Commingle of production is in the interest of conservation, the reduction of environmental impact area, and overall emissions. It will not result in reduced royalty or improper measurement of production. Without approval for utilizing existing batteries on adjacent leases, it will become necessary to build separate facilities for each well.

NEW MEXICO OIL CONSERVATION COMMISSION  
WELL LOCATION AND ACREAGE DEDICATION PLAT

Form C-102  
Supersedes C-128  
Effective 1-1-65

All distances must be from the outer boundaries of the Section.

Operator <b>YATES PETROLEUM CORPORATION</b>		Lease <b>Martha AIK Federal</b>			Well No. <b>1</b>
Unit Letter <b>P</b>	Section <b>11</b>	Township <b>22 South</b>	Range <b>31 East</b>	County <b>Eddy County, N.M.</b>	
Actual Footage Location of Well: <b>330</b> feet from the <b>South</b> line and <b>430</b> feet from the <b>East</b> line					
Ground Level Elev. <b>3566.</b>	Producing Formation <b>DELAWARE</b>	Pool <b>UNOGS. LIVINGSTON ROCK DELAWARE</b>	Dedicated Acreage: <b>40</b> Acres		

- Outline the acreage dedicated to the subject well by colored pencil or hachure marks on the plat below.
- If more than one lease is dedicated to the well, outline each and identify the ownership thereof (both as to working interest and royalty).
- If more than one lease of different ownership is dedicated to the well, have the interests of all owners been consolidated by communitization, unitization, force-pooling, etc.?

Yes  No If answer is "yes," type of consolidation \_\_\_\_\_

If answer is "no," list the owners and tract descriptions which have actually been consolidated. (Use reverse side of this form if necessary.) \_\_\_\_\_

No allowable will be assigned to the well until all interests have been consolidated (by communitization, unitization, forced-pooling, or otherwise) or until a non-standard unit, eliminating such interests, has been approved by the Commission.

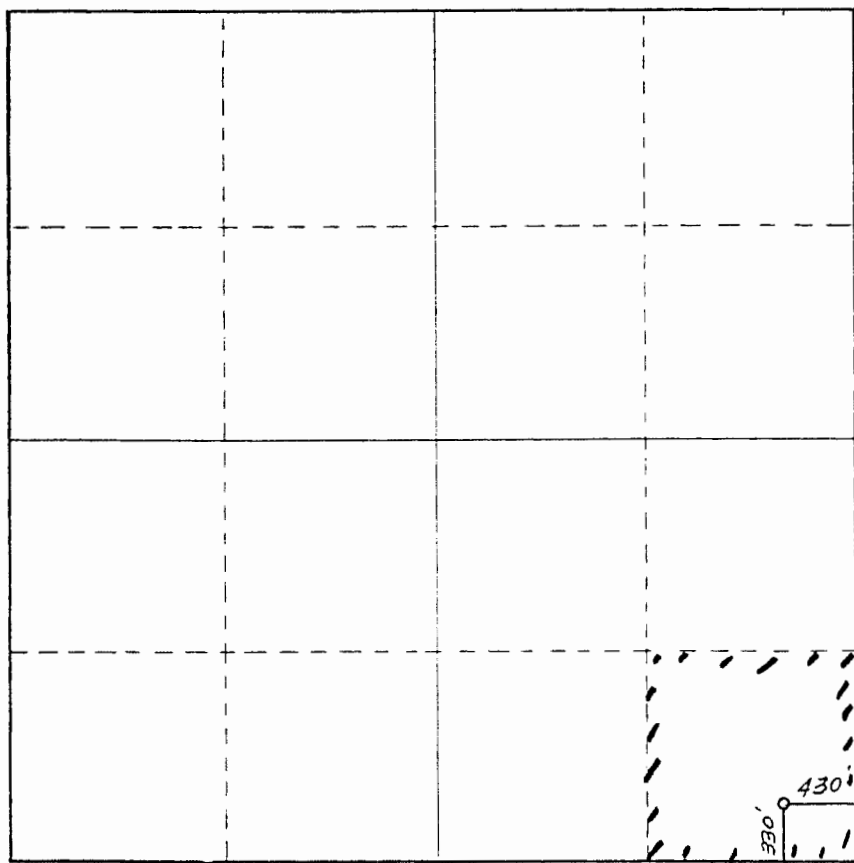

CERTIFICATION

I hereby certify that the information contained herein is true and complete to the best of my knowledge and belief.

*Clifton R. May*  
Name

Clifton R. May

Position  
Permit Agent

Company  
Yates Petroleum Corporation

Date  
11-9-90

I hereby certify that the well location shown on this plat was plotted from field notes of actual surveys made by me or under my supervision, and that the same is true and correct to the best of my knowledge and belief.

Date Surveyed  
November 2, 1990

Registered Professional Engineer and/or Land Surveyor

*Dan R. Reddy*  
Certificate No.

NM PE&PS NO. 5412

MEXICO OIL CONSERVATION COMMISSION  
WELL LOCATION AND ACREAGE DEDICATION PLAT

Form C-102  
Supersedes C-128  
Effective 1-1-65

All distances must be from the outer boundaries of the Section

Operator <b>YATES PETROLEUM CORPORATION</b>		Lease <b>Martha AIK Federal</b>		Well No. <b>2</b>
Unit Letter <b>I</b>	Section <b>11</b>	Township <b>22 South</b>	Range <b>31 East</b>	County <b>Eddy County, N.M.</b>
Actual Footage Location of Well: <b>1980</b> feet from the <b>South</b> line and <b>330</b> feet from the <b>East</b> line				
Ground Level Elev. <b>3580.</b>	Producing Formation <b>Delaware</b>	Pool <b>Under Livingston Ridge Delaware</b>	Dedicated Acreage: <b>40</b> Acres	

1. Outline the acreage dedicated to the subject well by colored pencil or hachure marks on the plat below.
2. If more than one lease is dedicated to the well, outline each and identify the ownership thereof (both as to working interest and royalty).
3. If more than one lease of different ownership is dedicated to the well, have the interests of all owners been consolidated by communitization, unitization, force-pooling, etc?

Yes  No If answer is "yes," type of consolidation \_\_\_\_\_

If answer is "no," list the owners and tract descriptions which have actually been consolidated. (Use reverse side of this form if necessary.) \_\_\_\_\_

No allowable will be assigned to the well until all interests have been consolidated (by communitization, unitization, forced-pooling, or otherwise) or until a non-standard unit, eliminating such interests, has been approved by the Commission.

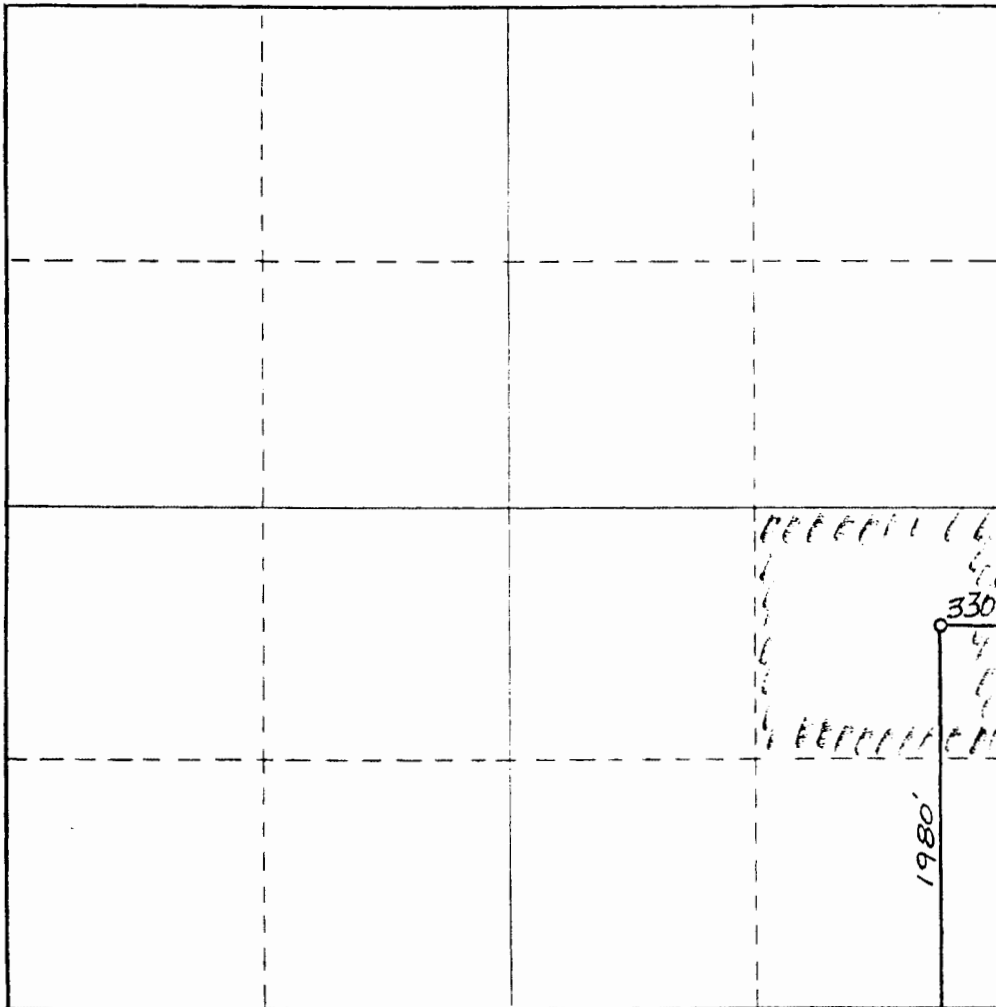

CERTIFICATION

I hereby certify that the information contained herein is true and complete to the best of my knowledge and belief.

*Ken Beardmore*

Name  
**KEN BEARDMORE**

Position  
**LANDMAN**

Company  
**Yates Pet. Corp.**

Date  
**1-28-91**

I hereby certify that the well location shown on this plat was plotted from field notes of actual surveys made by me or under my supervision, and that the same is true and correct to the best of my knowledge and belief.

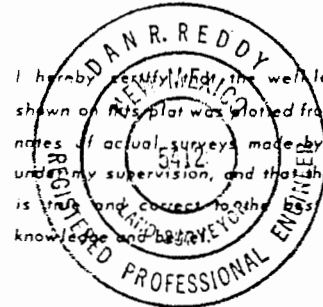

Date Surveyed  
**January 24, 1991**

Registered Professional Engineer and/or Land Surveyor

*Dan R. Reddy*

Certificate No.  
**NM PE&PS NO. 5412**

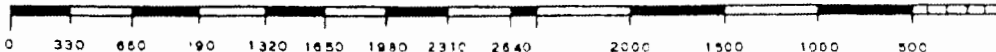

MEXICO OIL CONSERVATION COMMISSION  
WELL LOCATION AND ACREAGE DEDICATION PLAT

Form C-102  
Supersedes C-128  
Effective 1-1-65

All distances must be from the outer boundaries of the Section.

Operator <b>YATES PETROLEUM CORPORATION</b>		Lease <b>Martha AIK Federal</b>		Well No. <b>3</b>
Unit Letter <b>0</b>	Section <b>11</b>	Township <b>22 South</b>	Range <b>31 East</b>	County <b>Eddy County, N.M.</b>
Actual Footage Location of Well: <b>660</b> feet from the <b>South</b> line and <b>1650</b> feet from the <b>East</b> line				
Ground Level Elev. <b>3560.</b>	Producing Formation <b>DELAWARE</b>	Pool <b>Yates - Livestock Rippe Delaware</b>	Dedicated Acreage: <b>40</b> Acres	

- Outline the acreage dedicated to the subject well by colored pencil or hachure marks on the plat below.
- If more than one lease is dedicated to the well, outline each and identify the ownership thereof (both as to working interest and royalty).
- If more than one lease of different ownership is dedicated to the well, have the interests of all owners been consolidated by communitization, unitization, force-pooling, etc?

Yes  No If answer is "yes!" type of consolidation \_\_\_\_\_

If answer is "no," list the owners and tract descriptions which have actually been consolidated. (Use reverse side of this form if necessary.) \_\_\_\_\_

No allowable will be assigned to the well until all interests have been consolidated (by communitization, unitization, forced-pooling, or otherwise) or until a non-standard unit, eliminating such interests, has been approved by the Commission.

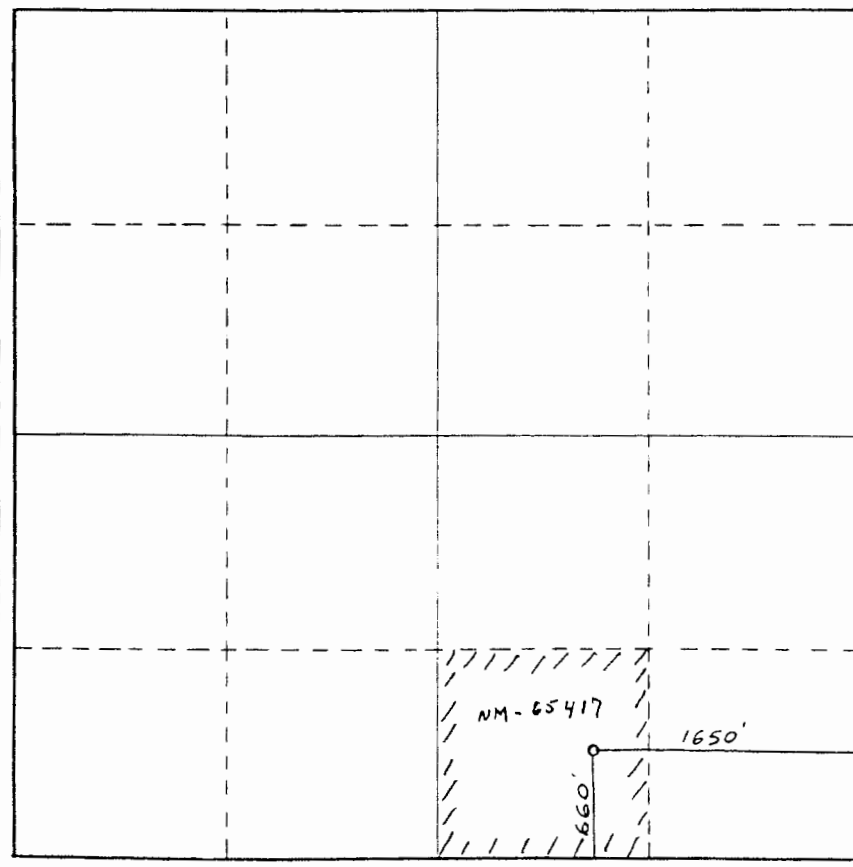

CERTIFICATION

I hereby certify that the information contained herein is true and complete to the best of my knowledge and belief.

**Clifton R. May**

Name  
Clifton R. May

Position  
Permit Agent

Company  
Yates Petroleum Corporation

Date  
3-13-91

I hereby certify that the well location shown on this plat was plotted from field notes of actual surveys made by me or under my supervision, and that the same is true and correct to the best of my knowledge and belief.

Date Surveyed  
March 7, 1991

Registered Professional Engineer and/or Land Surveyor

**Dan R. Reddy**

Certificate No.  
NM PE&PS NO. 5412



NEW MEXICO OIL CONSERVATION COMMISSION  
WELL LOCATION AND ACREAGE DEDICATION PLAT

Form C-102  
Supersedes C-128  
Effective 1-1-65

All distances must be from the outer boundaries of the Section

Operator <b>YATES PETROLEUM CORPORATION</b>		Lease <b>Martha Aik Federal</b>		Well No. <b>4</b>
Unit Letter <b>J</b>	Section <b>11</b>	Township <b>22 South</b>	Range <b>31 East</b>	County <b>Eddy County, N.M.</b>
Actual Footage Location of Well: <b>1980</b> feet from the <b>South</b> line and <b>1650</b> feet from the <b>East</b> line				
Ground Level Elev. <b>3580.</b>	Producing Formation <b>DELAWARE</b>	Pool <b>UNDE. LIVINGSTON RIDGE DELAWARE</b>	Dedicated Acreage: <b>40</b> Acres	

1. Outline the acreage dedicated to the subject well by colored pencil or hachure marks on the plat below.
2. If more than one lease is dedicated to the well, outline each and identify the ownership thereof (both as to working interest and royalty).
3. If more than one lease of different ownership is dedicated to the well, have the interests of all owners been consolidated by communitization, unitization, force-pooling, etc?  
 Yes  No If answer is "yes," type of consolidation \_\_\_\_\_

If answer is "no," list the owners and tract descriptions which have actually been consolidated. (Use reverse side of this form if necessary.) \_\_\_\_\_

No allowable will be assigned to the well until all interests have been consolidated (by communitization, unitization, forced-pooling, or otherwise) or until a non-standard unit, eliminating such interests, has been approved by the Commission.

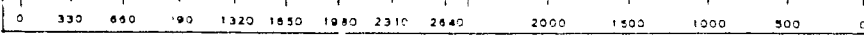
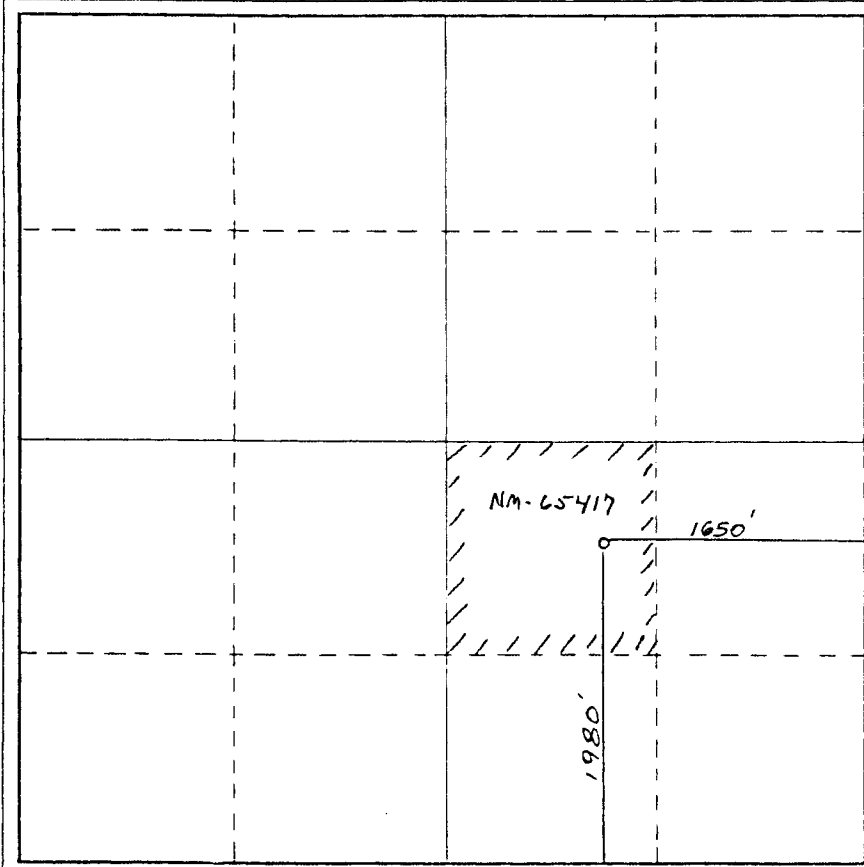

**CERTIFICATION**

I hereby certify that the information contained herein is true and complete to the best of my knowledge and belief.

*Clifton R. May*  
Name  
**Clifton R. May**  
Position  
**Permit Agent**  
Company  
**Yates Petroleum Corporation**  
Date  
**3-13-91**

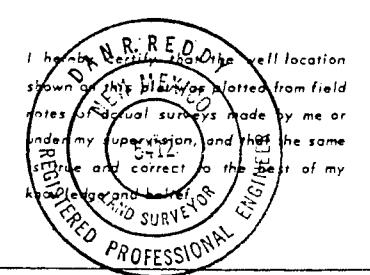

Date Surveyed  
**March 7, 1991**  
Registered Professional Engineer and/or Land Surveyor  
*Jan R. Reddy*  
Certificate No.  
**NM PE&PS NO. 5412**

Submit to Appropriate  
District Office  
State Leases - 4 copies  
Fee Leases - 3 copies

State of New Mexico  
Energy, Minerals and Natural Resources Dept.

Form C-102  
Revised 1-1-89

**OIL CONSERVATION DIVISION**  
P.O. Box 2088  
Santa Fe, New Mexico 87504-2088

DISTRICT I  
P.O. Box 1980, Hobbs, NM 88240

DISTRICT II  
P.O. Drawer DD, Artesia, NM 88210

DISTRICT III  
1000 Rio Roscos Rd., Aztec, NM 87410

**WELL LOCATION AND ACREAGE DEDICATION PLAT**  
All Distances must be from the outer boundaries of the section

Operator <b>YATES PETROLEUM CORPORATION</b>			Lease <b>MARTHA "AIK" FEDERAL</b>		Well No. <b>5</b>
Unit Letter <b>H</b>	Section <b>11</b>	Township <b>22 SOUTH</b>	Range <b>31 EAST</b>	County <b>EDDY</b>	NE/PM
Actual Footage Location of Well: <b>1980</b> feet from the <b>NORTH</b> line and <b>330</b> feet from the <b>EAST</b> line					
Ground level Elev. <b>3558</b>	Producing Formation <b>DELAWARE</b>		Pool <b>UNDES. LIVINGSTON RIDGE DELAWARE</b>		Dedicated Acreage: <b>40</b> Acres

- Outline the acreage dedicated to the subject well by colored pencil or leadline marks on the plat below.
- If more than one lease is dedicated to the well, outline each and identify the ownership thereof (both as to working interest and royalty).
- If more than one lease of different ownership is dedicated to the well, have the interest of all owners been consolidated by communitization, unitization, force-pooling, etc.?  
 Yes     No    If answer is "yes" type of consolidation \_\_\_\_\_  
 If answer is "no" list the owners and tract descriptions which have actually been consolidated. (Use reverse side of this form if necessary.)  
 No allowable will be assigned to the well until all interests have been consolidated (by communitization, unitization, forced-pooling, or otherwise) or until a non-standard unit, eliminating such interest, has been approved by the Division.

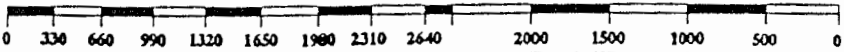
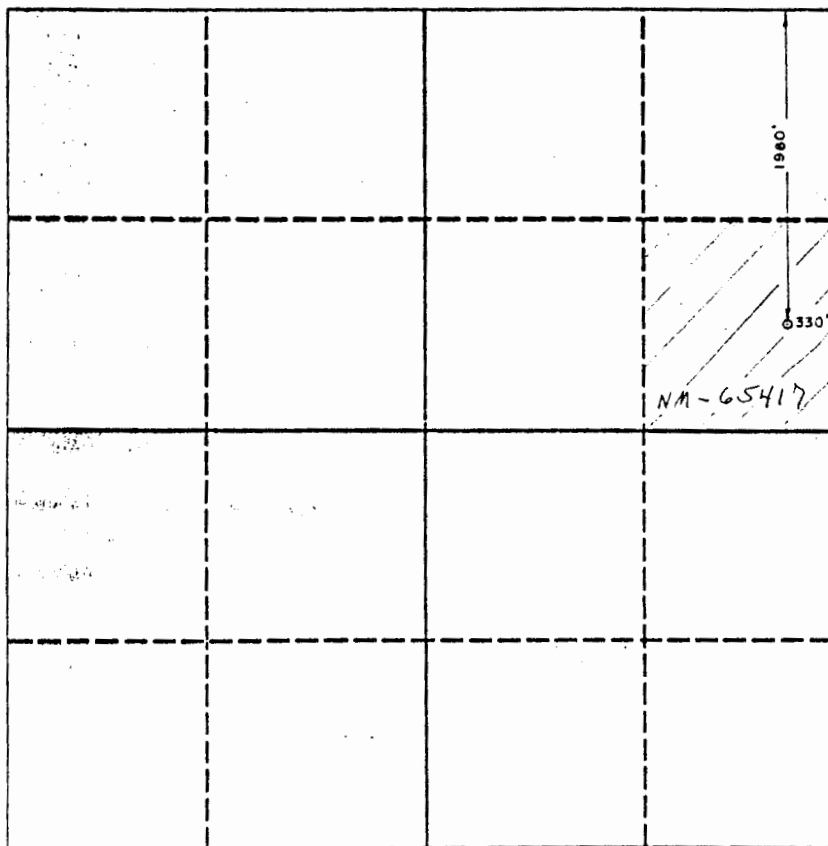

**OPERATOR CERTIFICATION**

I hereby certify that the information contained herein is true and complete to the best of my knowledge and belief.

Signature  
*Clifton R. May*

Printed Name  
Clifton R. May

Position  
Permit Agent

Company  
Yates Petroleum Corp.

Date  
4-4-91

**SURVEYOR CERTIFICATION**

I hereby certify that the well location shown on this plat was plotted from field notes of actual surveys made by me or under my supervision, and that the same is true and correct to the best of my knowledge and belief.

Date Surveyed  
4/15/91

Signature & Seal of Professional Surveyor  
*Henschel*

Certificate No. 3640

Submit to Appropriate District Office  
 State Lease - 4 copies  
 Fee Lease - 3 copies

State of New Mexico  
 Dept. of Minerals and Natural Resources Department

Form C-102  
 Revised 1-1-89

**OIL CONSERVATION DIVISION**  
 P.O. Box 2088  
 Santa Fe, New Mexico 87504-2088

**DISTRICT I**  
 P.O. Box 1980, Hobbs, NM 88240

**DISTRICT II**  
 P.O. Drawer DD, Artesia, NM 88210

**DISTRICT III**  
 1000 Rio Brazos Rd., Aztec, NM 87410

**WELL LOCATION AND ACREAGE DEDICATION PLAT**  
 All Distances must be from the outer boundaries of the section

Operator <b>YATES PETROLEUM CORPORATION</b>		Lease <b>MARTHA "AIK" FEDERAL</b>		Well No. <b>6</b>	
Unit Letter <b>A</b>	Section <b>11</b>	Township <b>22 SOUTH</b>	Range <b>31 EAST</b>	County <b>NMPM EDDY</b>	
Actual Footage Location of Well: <b>660</b> feet from the <b>NORTH</b> line and <b>330</b> feet from the <b>EAST</b> line					
Ground level Elev. <b>3594</b>	Producing Formation <b>DELAWARE</b>		Pool <b>UNION LIVINGSTON RIDGE DELAWARE</b>	Dedicated Acreage: <b>40</b> Acres	

- Outline the acreage dedicated to the subject well by colored pencil or hachure marks on the plat below.
- If more than one lease is dedicated to the well, outline each and identify the ownership thereof (both as to working interest and royalty).
- If more than one lease of different ownership is dedicated to the well, have the interest of all owners been consolidated by communitization, unitization, force-pooling, etc.?
 

Yes     No    If answer is "yes" type of consolidation \_\_\_\_\_

If answer is "no" list the owners and tract descriptions which have actually been consolidated. (Use reverse side of this form if necessary.) \_\_\_\_\_

No allowable will be assigned to the well until all interests have been consolidated (by communitization, unitization, forced-pooling, or otherwise) or until a non-standard unit, eliminating such interest, has been approved by the Division.

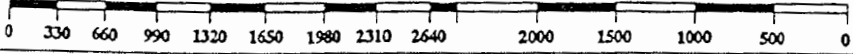
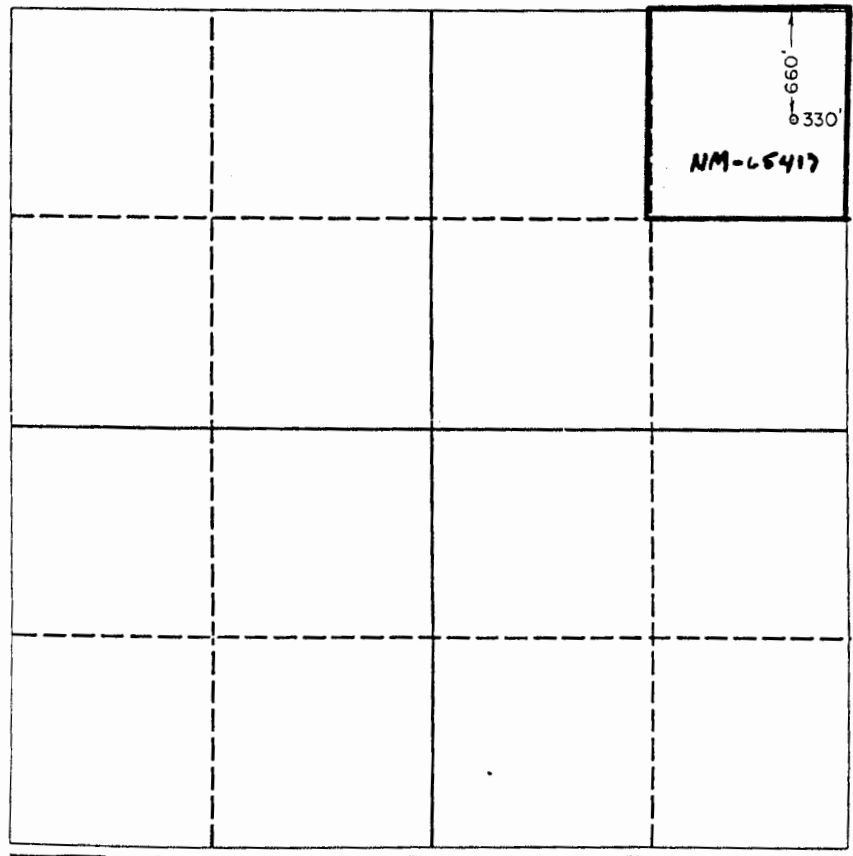

**OPERATOR CERTIFICATION**  
 I hereby certify that the information contained herein is true and complete to the best of my knowledge and belief.

Signature: *Clifton R. May*  
 Printed Name: Clifton R. May  
 Position: Permit Agent  
 Company: YATES PETROLEUM CORPORATION  
 Date: January 15, 1992

**SURVEYOR CERTIFICATION**  
 I hereby certify that the well location shown on this plat was plotted from field notes of actual surveys made by me or under my supervision, and that the same is true and correct to the best of my knowledge and belief.

Date Surveyed: 1/14/92  
 Signature & Seal of Professional Surveyor: *[Signature]*  
 Certificate No. 3640

District I  
1625 N. French Dr., Hobbs, NM 88240  
Phone: (575) 393-6161 Fax: (575) 393-0720  
District II  
811 S. First St., Artesia, NM 88210  
Phone: (575) 748-1283 Fax: (575) 748-9720  
District III  
1000 Rio Brazos Road, Aztec, NM 87410  
Phone: (505) 334-6178 Fax: (505) 334-6170  
District IV  
1220 S. St. Francis Dr., Santa Fe, NM 87505  
Phone: (505) 476-3460 Fax: (505) 476-3462

State of New Mexico  
Energy, Minerals & Natural Resources Department  
OIL CONSERVATION DIVISION  
1220 South St. Francis Dr.  
Santa Fe, NM 87505

**RECEIVED**  
FEB 21 2014  
NMOC D ARTESIA

Form C-102  
Revised August 1, 2011  
Submit one copy to appropriate  
District Office  
AMENDED REPORT

**WELL LOCATION AND ACREAGE DEDICATION PLAT**

<sup>1</sup> API Number 30-015-40051	<sup>2</sup> Pool Code 39360	<sup>3</sup> Pool Name Livingston Ridge, Delaware
<sup>4</sup> Property Code 12538	<sup>5</sup> Property Name Martha AIK Federal	<sup>6</sup> Well Number 7H
<sup>7</sup> OGRID No. 025575	<sup>8</sup> Operator Name Yates Petroleum Corporation	<sup>9</sup> Elevation 3,550' GR

**Surface Location**

UL or lot no.	Section	Township	Range	Lot Idn	Feet from the	North/South line	Feet from the	East/West line	County
H	11	22S	31E		1750	North	200	East	Eddy

**Bottom Hole Location If Different From Surface**

UL or lot no.	Section	Township	Range	Lot Idn	Feet from the	North/South line	Feet from the	East/West line	County
E	11	22S	31E		1751	North	330	West	Eddy
<sup>12</sup> Dedicated Acres 160	<sup>13</sup> Joint or Infill	<sup>14</sup> Consolidation Code	<sup>15</sup> Order No.						

No allowable will be assigned to this completion until all interests have been consolidated or a non-standard unit has been approved by the division.

	330' BL	1751'			1750'	200'	SL		
<p><b>OPERATOR CERTIFICATION</b> I hereby certify that the information contained herein is true and complete to the best of my knowledge and belief, and that this organization either owns a working interest or unleased mineral interest in the land including the proposed bottom hole location or has a right to drill this well at this location pursuant to a contract with an owner of such a mineral or working interest, or to a voluntary pooling agreement or a compulsory pooling order heretofore entered by the division.</p> <p>Signature: <u>Laura Watts</u> Date: <u>2/20/2014</u>          Printed Name: <u>Laura Watts</u>          E-mail Address: <u>laura@yatespetroleum.com</u></p>									
<p><b>SURVEYOR CERTIFICATION</b> I hereby certify that the well location shown on this plat was plotted from field notes of actual surveys made by me or under my supervision, and that the same is true and correct to the best of my belief.</p> <p>Date of Survey: _____          Signature and Seal of Professional Surveyor: _____          Certificate Number: _____</p>									

30-015-39733

DISTRICT I  
1625 N. French Dr., Hobbs, NM 88240

DISTRICT II  
1301 W. Grand Avenue, Artesia, NM 86210

DISTRICT III  
1000 Rio Brazos Rd., Aztec, NM 87410

DISTRICT IV  
1220 S. St. Francis Dr., Santa Fe, NM 87505

State of New Mexico  
Energy, Minerals and Natural Resources Department

Form C-102  
Revised July 16, 2010

Submit one copy to appropriate  
District Office

**OIL CONSERVATION DIVISION**  
1220 South St. Francis Dr.  
Santa Fe, New Mexico 87505

WELL LOCATION AND ACREAGE DEDICATION PLAT

AMENDED REPORT

API Number <b>30-015-39733</b>	Pool Code <b>39360</b>	Pool Name <b>Livingston Ridge; Delaware</b>
Property Code <b>12538</b>	Property Name <b>MARTHA "AIK" FEDERAL</b>	Well Number <b>8H</b>
OGRID No. <b>025575</b>	Operator Name <b>YATES PETROLEUM CORP.</b>	Elevation <b>3546'</b>

Surface Location

UL or lot No.	Section	Township	Range	Lot Idn	Feet from the	North/South line	Feet from the	East/West line	County
A	11	22 S	31 E		430	NORTH	200	EAST	EDDY

Bottom Hole Location If Different From Surface

UL or lot No.	Section	Township	Range	Lot Idn	Feet from the	North/South line	Feet from the	East/West line	County
C	11	22 S	31 E		500	NORTH	1650	WEST	EDDY

Dedicated Acres <b>120</b>	Joint or Infill	Consolidation Code	Order No.
-------------------------------	-----------------	--------------------	-----------

NO ALLOWABLE WILL BE ASSIGNED TO THIS COMPLETION UNTIL ALL INTERESTS HAVE BEEN CONSOLIDATED OR A NON-STANDARD UNIT HAS BEEN APPROVED BY THE DIVISION

**PROPOSED BOTTOM HOLE LOCATION**  
 Lot - N 32°24'42.94"  
 Long - W 103°45'06.86"  
 NMSPC - N 514078.415  
 E 720781.540  
 (NAD-83)

**SURFACE LOCATION**  
 Lot - N 32°24'43.70"  
 Long - W 103°44'26.64"  
 NMSPC - N 514174.142  
 E 724211.307  
 (NAD-83)

Penetration Point  
443' FNL  
677' FEL

Production Zone

**OPERATOR CERTIFICATION**

I hereby certify that the information contained herein is true and complete to the best of my knowledge and belief, and that this organization either owns a working interest or unleased mineral interest in the land including the proposed bottom hole location or has a right to drill this well at this location pursuant to a contract with an owner of such a mineral or working interest, or to a voluntary pooling agreement or a compulsory pooling order heretofore entered by the division.

*[Signature]* 4/4/11  
Signature Date

*Alexander A. Lopez*  
Printed Name

*armando1@yatespetrol.com*  
Email Address

---

**SURVEYOR CERTIFICATION**

I hereby certify that the well location shown on this plat was plotted from field notes of actual surveys made by me or under my supervision, and that the same is true and correct to the best of my belief.

*[Signature]*  
Date Surveyed

*[Seal]*  
Signature & Seal of Professional Surveyor

Certificate No. Gary L. Jones 7977

BASIN SURVEYS 23907

**RECEIVED**  
NOV 29 2011  
NMOCD ARTESIA

District I  
1625 N. French Dr., Hobbs, NM 88240  
Phone: (575) 391-6161 Fax: (575) 393-0720  
District II  
811 S. First St., Artesia, NM 88210  
Phone: (575) 748-1283 Fax: (575) 748-9720  
District III  
1000 Rio Brazos Road, Aztec, NM 87410  
Phone: (505) 334-6178 Fax: (505) 334-6170  
District IV  
1220 S. St. Francis Dr., Santa Fe, NM 87505  
Phone: (505) 476-3460 Fax: (505) 476-3462

State of New Mexico  
Energy, Minerals & Natural Resources Department  
OIL CONSERVATION DIVISION  
1220 South St. Francis Dr.  
Santa Fe, NM 87505

**RECEIVED**  
APR 25 2013  
MOC ARTESIA

Form C-102  
Revised August 1, 2011  
Submit one copy to appropriate  
District Office  
 AMENDED REPORT

WELL LOCATION AND ACREAGE DEDICATION PLAT

<sup>1</sup> API Number 30-015-37512		<sup>2</sup> Pool Code 39360		<sup>3</sup> Pool Name Livingston Ridge; Delaware	
<sup>4</sup> Property Code 12538		<sup>5</sup> Property Name Martha AIK Federal			<sup>6</sup> Well Number 9H
<sup>7</sup> OGRID No. 025575		<sup>8</sup> Operator Name Yates Petroleum Corporation			<sup>9</sup> Elevation 3563'GR

<sup>10</sup> Surface Location

UL or lot no.	Section	Township	Range	Lot Idn	Feet from the	North/South line	Feet from the	East/West line	County
P	11	22S	31E		430	South	200	East	Eddy

<sup>11</sup> Bottom Hole Location If Different From Surface

UL or lot no.	Section	Township	Range	Lot Idn	Feet from the	North/South line	Feet from the	East/West line	County
N	11	22S	31E		435	South	1650	West	Eddy

<sup>12</sup> Dedicated Acres 120	<sup>13</sup> Joint or Infill	<sup>14</sup> Consolidation Code	<sup>15</sup> Order No.
--------------------------------------	-------------------------------	----------------------------------	-------------------------

No allowable will be assigned to this completion until all interests have been consolidated or a non-standard unit has been approved by the division.

					<b><sup>17</sup> OPERATOR CERTIFICATION</b> I hereby certify that the information contained herein is true and complete to the best of my knowledge and belief, and that this organization either owns a working interest or unleased mineral interest in the land including the proposed bottom hole location or has a right to drill this well at this location pursuant to a contract with an owner of such a mineral or working interest, or to a voluntary pooling agreement or a compulsory pooling order heretofore entered by the division.  Signature: <u>Tina Huerta</u> Date: April 24, 2013  Printed Name: Tina Huerta  E-mail Address: <u>tinah@yatespetroleum.com</u>
					<b><sup>18</sup> SURVEYOR CERTIFICATION</b> I hereby certify that the well location shown on this plat was plotted from field notes of actual surveys made by me or under my supervision, and that the same is true and correct to the best of my belief.  Date of Survey: _____ Signature and Seal of Professional Surveyor: _____  Certificate Number: _____

District I  
1625 N. French Dr., Hobbs, NM 88240  
Phone: (575) 393-6161 Fax: (575) 393-0720  
District II  
811 S. First St., Artesia, NM 88210  
Phone: (575) 748-1283 Fax: (575) 748-9720  
District III  
1000 Rio Brazos Road, Aztec, NM 87410  
Phone: (505) 334-6178 Fax: (505) 334-6170  
District IV  
1220 S. St. Francis Dr., Santa Fe, NM 87505  
Phone: (505) 476-3460 Fax: (505) 476-3462

State of New Mexico  
**RECEIVED**  
Energy, Minerals & Natural Resources Department  
FEB 20 2013  
CONSERVATION DIVISION  
1220 South St. Francis Dr.  
Santa Fe, NM 87505  
NMOCD ARTESIA

Form C-102  
Revised August 1, 2011  
Submit one copy to appropriate  
District Office

AMENDED REPORT

**WELL LOCATION AND ACREAGE DEDICATION PLAT**

<sup>1</sup> API Number 30-015-37509		<sup>2</sup> Pool Code 39360		<sup>3</sup> Pool Name Livingston Ridge; Delaware	
<sup>4</sup> Property Code 12538		<sup>5</sup> Property Name Martha AIK Federal			<sup>6</sup> Well Number 10H
<sup>7</sup> OGRID No. 025575		<sup>8</sup> Operator Name Yates Petroleum Corporation			<sup>9</sup> Elevation 3584'GR

<sup>10</sup> Surface Location									
UL or lot no.	Section	Township	Range	Lot Idn	Feet from the	North/South line	Feet from the	East/West line	County
I	11	22S	31E		1780	South	178	East	Eddy

<sup>11</sup> Bottom Hole Location If Different From Surface									
UL or lot no.	Section	Township	Range	Lot Idn	Feet from the	North/South line	Feet from the	East/West line	County
L	11	22S	31E		1900	South	360	West	Eddy

<sup>12</sup> Dedicated Acres 160	<sup>13</sup> Joint or Infill	<sup>14</sup> Consolidation Code	<sup>15</sup> Order No.
--------------------------------------	-------------------------------	----------------------------------	-------------------------

No allowable will be assigned to this completion until all interests have been consolidated or a non-standard unit has been approved by the division.

<div style="border: 1px solid black; padding: 5px;"> <p><sup>16</sup></p> </div>	<p><b><sup>17</sup> OPERATOR CERTIFICATION</b></p> <p><i>I hereby certify that the information contained herein is true and complete to the best of my knowledge and belief, and that this organization either owns a working interest or unleased mineral interest in the land including the proposed bottom hole location or has a right to drill this well at this location pursuant to a contract with an owner of such a mineral or working interest, or to a voluntary pooling agreement, or a compulsory pooling order heretofore entered by the division.</i></p> <p style="text-align: right;">February 15, 2013</p> <p><i>Tina Huerta</i> Signature</p> <p>Tina Huerta Printed Name</p> <p>tinah@yatespetroleum.com E-mail Address</p> <hr/> <p><b><sup>18</sup> SURVEYOR CERTIFICATION</b></p> <p><i>I hereby certify that the well location shown on this plat was plotted from field notes of actual surveys made by me or under my supervision, and that the same is true and correct to the best of my belief.</i></p> <p style="text-align: center;"><i>on file</i></p> <p>Date of Survey</p> <p>Signature and Seal of Professional Surveyor:</p> <hr/> <p>Certificate Number</p>
--	---

District I  
1625 N. French Dr., Hobbs, NM 88240  
Phone: (575) 393-6161 Fax: (575) 393-0720  
District II  
811 S. First St., Artesia, NM 88210  
Phone: (575) 748-1283 Fax: (575) 748-9720  
District III  
1000 Rio Brazos Road, Aztec, NM 87410  
Phone: (505) 334-6178 Fax: (505) 334-6170  
District IV  
1220 S. St. Francis Dr., Santa Fe, NM 87505  
Phone: (505) 476-3460 Fax: (505) 476-3462

**RECEIVED**  
FEB 28 2013  
NMOCD ARTESIA

State of New Mexico  
Energy, Minerals & Natural Resources Department  
OIL CONSERVATION DIVISION  
1220 South St. Francis Dr.  
Santa Fe, NM 87505

Form C-102  
Revised August 1, 2011  
Submit one copy to appropriate  
District Office

AMENDED REPORT

*As Drilled*

WELL LOCATION AND ACREAGE DEDICATION PLAT

<sup>1</sup> API Number 30-015-37510		<sup>2</sup> Pool Code 39360		<sup>3</sup> Pool Name Livingston Ridge; Delaware	
<sup>4</sup> Property Code 12538		<sup>5</sup> Property Name Martha AIK Federal			<sup>6</sup> Well Number 11H
<sup>7</sup> OGRID No. 025575		<sup>8</sup> Operator Name Yates Petroleum Corporation			<sup>9</sup> Elevation 3584'GL

<sup>10</sup> Surface Location

UL or lot no.	Section	Township	Range	Lot Idn	Feet from the	North/South line	Feet from the	East/West line	County
I	11	22S	31E		1780	South	200	East	Eddy

<sup>11</sup> Bottom Hole Location If Different From Surface

UL or lot no.	Section	Township	Range	Lot Idn	Feet from the	North/South line	Feet from the	East/West line	County
L	11	22S	31E		1774	South	378	West	Eddy

<sup>12</sup> Dedicated Acres 160	<sup>13</sup> Joint or Infill	<sup>14</sup> Consolidation Code	<sup>15</sup> Order No.
--------------------------------------	-------------------------------	----------------------------------	-------------------------

No allowable will be assigned to this completion until all interests have been consolidated or a non-standard unit has been approved by the division.

<p><sup>16</sup></p>	<p><b><sup>17</sup> OPERATOR CERTIFICATION</b> I hereby certify that the information contained herein is true and complete to the best of my knowledge and belief, and that this organization either owns a working interest or unleased mineral interest in the land including the proposed bottom hole location or has a right to drill this well at this location pursuant to a contract with an owner of such a mineral or working interest, or to a voluntary pooling agreement or a compulsory pooling order heretofore entered by the division.</p> <p><i>Tina Huerta</i> February 8, 2013 Signature Date</p> <p>Tina Huerta Printed Name</p> <p>tinah@yatespetroleum.com E-mail Address</p>
	<p><b><sup>18</sup> SURVEYOR CERTIFICATION</b> I hereby certify that the well location shown on this plat was plotted from field notes of actual surveys made by me or under my supervision, and that the same is true and correct to the best of my belief.</p> <p>Date of Survey</p> <p>Signature and Seal of Professional Surveyor:</p> <p>Certificate Number</p>



640

**District I**  
1625 N. French Dr., Hobbs, NM 88240

**District II**  
1301 W. Grand Avenue, Artesia, NM 88210

**District III**  
1000 Rio Brazos Rd., Aztec, NM 87410

**District IV**  
1220 S. St. Francis Dr., Santa Fe, NM 87505

State of New Mexico  
Energy, Minerals & Natural Resources Department  
**OIL CONSERVATION DIVISION**  
1220 South St. Francis Dr.  
Santa Fe, NM 87505

Form C-102  
Revised July 16, 2010  
Submit one copy to appropriate  
District Office

AMENDED REPORT

**WELL LOCATION AND ACREAGE DEDICATION PLAT**

<sup>1</sup> API Number 30-015-37511	<sup>2</sup> Pool Code 39360	<sup>3</sup> Pool Name Livingston Ridge; Delaware
<sup>4</sup> Property Code 12538	<sup>5</sup> Property Name Martha AIK Federal	
<sup>7</sup> OGRID No. 025575	<sup>8</sup> Operator Name Yates Petroleum Corporation	<sup>6</sup> Well Number 13H  <sup>9</sup> Elevation 3549'GR

<sup>10</sup> Surface Location

UL or lot no.	Section	Township	Range	Lot Idn	Feet from the	North/South line	Feet from the	East/West line	County
H	11	22S	31E		1650	North	330	East	Eddy

<sup>11</sup> Bottom Hole Location If Different From Surface

UL or lot no.	Section	Township	Range	Lot Idn	Feet from the	North/South line	Feet from the	East/West line	County
E	11	22S	31E		1671	North	4915	East	Eddy

<sup>12</sup> Dedicated Acres 160	<sup>13</sup> Joint or Infill	<sup>14</sup> Consolidation Code	<sup>15</sup> Order No.
--------------------------------------	-------------------------------	----------------------------------	-------------------------

No allowable will be assigned to this completion until all interests have been consolidated or a non-standard unit has been approved by the division.

<p>16</p> <p>1671'N</p> <p>4915'E</p>	<p><b>RECEIVED</b> DEC 22 2010 NMOCD ARTESIA</p>		<p>1650'N</p> <p>330'E</p>	<p><sup>17</sup> OPERATOR CERTIFICATION</p> <p><i>I hereby certify that the information contained herein is true and complete to the best of my knowledge and belief, and that this organization either owns a working interest or unleased mineral interest in the land including the proposed bottom hole location or has a right to drill this well at this location pursuant to a contract with an owner of such a mineral or working interest, or to a voluntary pooling agreement or a compulsory pooling order heretofore entered by the division.</i></p> <p><i>Tina Huerta</i> December 20, 2010 Signature Date</p> <p>Tina Huerta Printed Name</p> <p>tinah@yatespetroleum.com E-mail Address</p>	
	<p><sup>18</sup> SURVEYOR CERTIFICATION</p> <p><i>I hereby certify that the well location shown on this plat was plotted from field notes of actual surveys made by me or under my supervision, and that the same is true and correct to the best of my belief.</i></p>				
	<p>Date of Survey</p> <p>Signature and Seal of Professional Surveyor:</p> <p>Certificate Number</p>				

OK 2/24/11 CS

District I  
1625 N. French Dr., Hobbs, NM 88240  
Phone: (575) 393-6161 Fax: (575) 393-0720  
District II  
811 S. First St., Artesia, NM 88210  
Phone: (575) 748-1283 Fax: (575) 748-9720  
District III  
1000 Rio Brazos Road, Aztec, NM 87410  
Phone: (505) 334-6178 Fax: (505) 334-6170  
District IV  
1220 S. St. Francis Dr., Santa Fe, NM 87505  
Phone: (505) 476-3460 Fax: (505) 476-3462

State of New Mexico  
Energy, Minerals & Natural Resources Department  
OIL CONSERVATION DIVISION  
1220 South St. Francis Dr.  
Santa Fe, NM 87505

Form C-102  
Revised August 1, 2011  
Submit one copy to appropriate  
District Office

AMENDED REPORT

WELL LOCATION AND ACREAGE DEDICATION PLAT

<sup>1</sup> API Number 30-015-37556		<sup>2</sup> Pool Code 39360		<sup>3</sup> Pool Name Livingston Ridge; Delaware	
<sup>4</sup> Property Code 12538		<sup>5</sup> Property Name Martha AIK Federal			<sup>6</sup> Well Number 14H
<sup>7</sup> OGRID No. 025575		<sup>8</sup> Operator Name Yates Petroleum Corporation			<sup>9</sup> Elevation 3570'GR

<sup>10</sup> Surface Location

UL or lot no.	Section	Township	Range	Lot Idn	Feet from the	North/South line	Feet from the	East/West line	County
P	11	22S	31E		430	South	178	East	Eddy

<sup>11</sup> Bottom Hole Location If Different From Surface

UL or lot no.	Section	Township	Range	Lot Idn	Feet from the	North/South line	Feet from the	East/West line	County
N	11	22S	31E		626	South	1657	West	Eddy

<sup>12</sup> Dedicated Acres 120	<sup>13</sup> Joint or Infill	<sup>14</sup> Consolidation Code	<sup>15</sup> Order No.
--------------------------------------	-------------------------------	----------------------------------	-------------------------

No allowable will be assigned to this completion until all interests have been consolidated or a non-standard unit has been approved by the division.

					<div style="border: 2px solid black; padding: 5px; display: inline-block;"> <p><b>RECEIVED</b> APR 18 2013 NMOCD ARTESIA</p> </div>	<p><b><sup>17</sup> OPERATOR CERTIFICATION</b> I hereby certify that the information contained herein is true and complete to the best of my knowledge and belief, and that this organization either owns a working interest or released mineral interest in the land including the proposed bottom hole location or has a right to drill this well at this location pursuant to a contract with an owner of such a mineral or working interest, or to a voluntary pooling agreement or a compulsory pooling order heretofore entered by the division.</p> <p style="text-align: right;"><i>Tina Huerta</i> April 17, 2013 Signature Date</p> <p>Tina Huerta Printed Name</p> <p>tinah@yatespetroleum.com E-mail Address</p>
					<p><b><sup>18</sup> SURVEYOR CERTIFICATION</b> I hereby certify that the well location shown on this plat was plotted from field notes of actual surveys made by me or under my supervision, and that the same is true and correct to the best of my belief.</p> <p>Date of Survey _____ Signature and Seal of Professional Surveyor: _____</p>	
					Certificate Number _____	



105 South 4<sup>th</sup> Street \* Artesia, NM 88210  
(575)-748-1471

-Joe Palma Foreman  
-January, 2014

# Martha AIK Battery

330' FSL & 430' FEL \* Sec11 – T22S R31E \* Unit P  
Eddy County, NM  
API- 3001526549

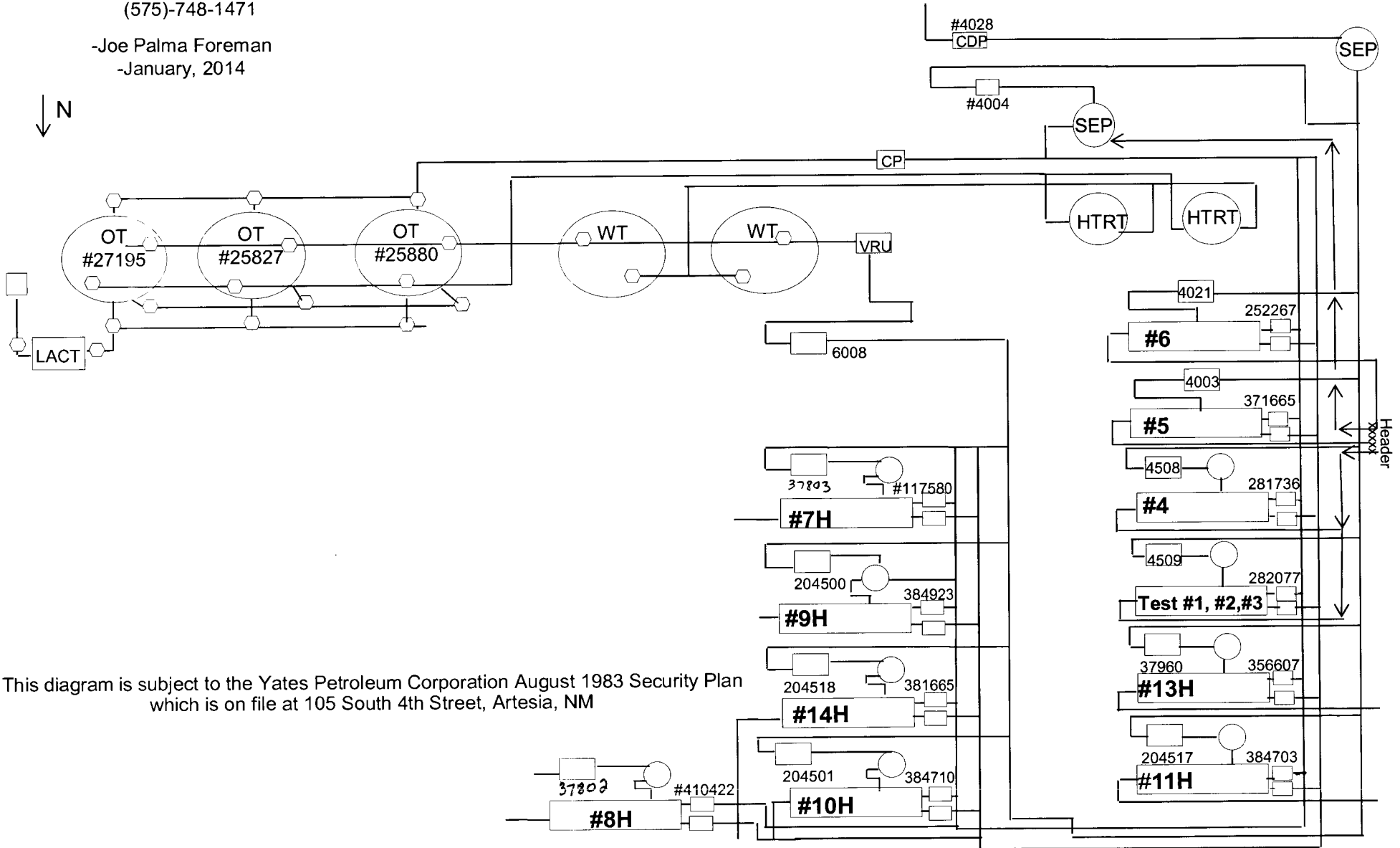

This diagram is subject to the Yates Petroleum Corporation August 1983 Security Plan which is on file at 105 South 4th Street, Artesia, NM

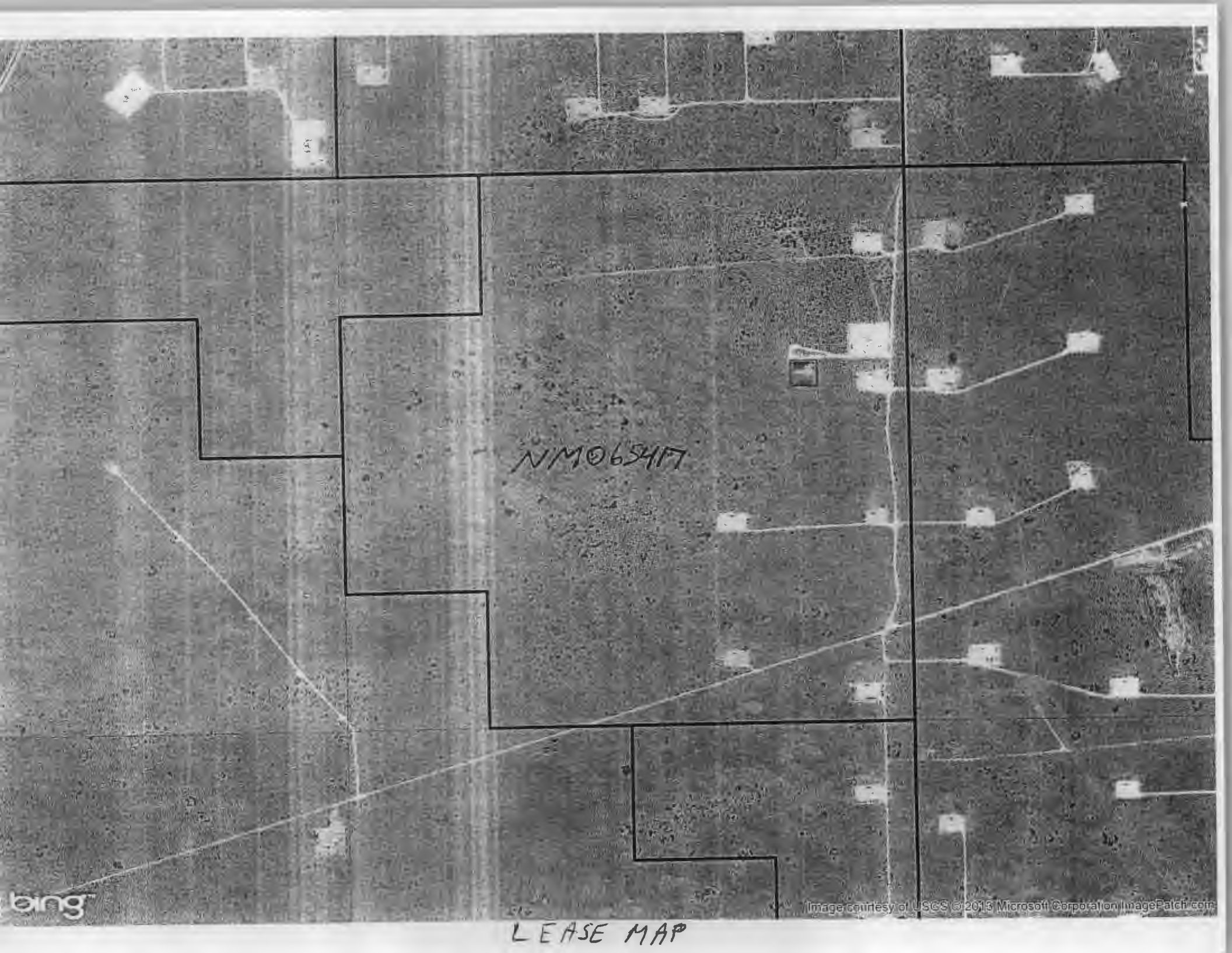

NM065417

bing

Image courtesy of USGS © 2013 Microsoft Corporation on ImagePatch.com

LEASE MAP



185 SOUTH FOURTH (575) 748-1471  
ARTESIA, NEW MEXICO 88210



### LEGEND

- GPS ROADS
- GAS WELL PROPOSED
- OIL WELL PROPOSED
- GAS WELL
- OIL WELL
- FLOW LINE YATES

DRAWN BY: JAH
DATE DRAWN: 05-03-13
COUNTY:
STATE: NEW MEXICO
SHEET NUMBER: 1 OF 1
SCALE: 1" = 1/8 Mile

TITLE:

THIS MAP HAS BEEN CAREFULLY COMPILED AND PRINTED BY YATES PETROLEUM CORPORATION FROM AVAILABLE INFORMATION. YATES PETROLEUM CORPORATION DOES NOT GUARANTEE THE ACCURACY OF THIS MAP OR INFORMATION DELINEATED THEREON.

NOR DOES YATES PETROLEUM CORPORATION ASSUME RESPONSIBILITY FOR ANY RELIANCE THEREON. RECIPIENT AGREES NOT TO COPY, DISTRIBUTE OR DIGITIZE THIS MAP WITHOUT EXPRESS CONSENT FROM YATES PETROLEUM CORPORATION OR ITS AFFILIATES.

BHL  
⊙  
BHL

MARTHA

MARTHA #8H

MARTHA #6

#12H

MARTHA

#13H

MARTHA

#7H

MARTHA

#5

2 7/8 STEEL

1 1

MARTHA

#4

MARTHA

#2

MARTHA

#11

MARTHA

#10H

POLY

MARTHA

#3

MARTHA

#9H

MARTHA

BAFT

MARTHA

#14

MARTIN YATES, III  
1912-1985

FRANK W. YATES  
1936-1986

S.P. YATES  
1914-2008



105 SOUTH FOURTH STREET  
ARTESIA, NEW MEXICO 88210-2118

TELEPHONE (575) 748-1471

JOHN A. YATES  
CHAIRMAN OF THE BOARD

JOHN A. YATES JR.  
PRESIDENT

JAMES S. BROWN  
CHIEF OPERATING OFFICER

JOHN D. PERINI  
CHIEF FINANCIAL OFFICER

JORGE S. MENDOZA  
CHIEF ADMINISTRATIVE OFFICER

RE: Amend Surface Lease Commingle  
Martha AIK Federal #7H & 8H  
Eddy County, New Mexico

Dear Interest Owner,

Yates Petroleum is notifying you of an addition to CTB-664, which will be the Martha AIK Federal #7H & 8H. The battery is located at the Martha AIK Federal #1.

Ownership is diversified.

**Oil Measurement**

All of the wells with the exception of #1, 2, & 3, which utilize a single well test separator (common ownership), will be equipped with continuous meter separators for oil production prior to oil being commingled for sales at the Martha AIK Federal #1. Total sales/production will be allocated back to each individual well using the metered (daily well tests) volumes and periodic tests. Metered volumes will be compared to total battery volumes daily and monthly for accuracy.

**Gas Measurement**

All of the wells with the exception of #1, 2, and 3 which utilize a single well test separator (common ownership) will be equipped with allocation meters, for gas, prior to commingle. The BLM point of measurement for this commingled production is at the Agave CDP meter # 4028 located on the Martha Battery.

NOTE- wells #1-3 each periodically produce separately through the test separator for allocation purposes.

The purpose of the Surface/lease Commingle of production is in the interest of conservation, economic feasibility, the reduction of environmental impact area, and overall emissions. It will not result in reduced royalty or improper measurement of production. Without approval for utilizing existing batteries on adjacent leases, it will become necessary to build separate facilities for each well.

If you should have any questions, please give me a call at (575) 748-4200 (direct line).

Sincerely,

Miriam Morales  
Production Analyst

I hereby approve this application

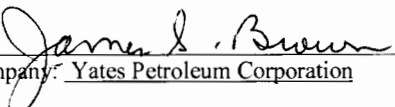
  
Company: Yates Petroleum Corporation

MARTIN YATES, III  
1912-1985

FRANK W. YATES  
1936-1986

S.P. YATES  
1914-2008



105 SOUTH FOURTH STREET  
ARTESIA, NEW MEXICO 88210-2118

TELEPHONE (575) 748-1471

JOHN A. YATES  
CHAIRMAN OF THE BOARD

JOHN A. YATES JR.  
PRESIDENT

JAMES S. BROWN  
CHIEF OPERATING OFFICER

JOHN D. PERINI  
CHIEF FINANCIAL OFFICER

JORGE S. MENDOZA  
CHIEF ADMINISTRATIVE OFFICER

RE: Amend Surface Lease Commingle  
Martha AIK Federal #7H & 8H  
Eddy County, New Mexico

Dear Interest Owner,

Yates Petroleum is notifying you of an addition to CTB-664, which will be the Martha AIK Federal #7H & 8H. The battery is located at the Martha AIK Federal #1.

Ownership is diversified.

**Oil Measurement**

All of the wells with the exception of #1, 2, & 3, which utilize a single well test separator (common ownership), will be equipped with continuous meter separators for oil production prior to oil being commingled for sales at the Martha AIK Federal #1. Total sales/production will be allocated back to each individual well using the metered (daily well tests) volumes and periodic tests. Metered volumes will be compared to total battery volumes daily and monthly for accuracy.

**Gas Measurement**

All of the wells with the exception of #1, 2, and 3 which utilize a single well test separator (common ownership) will be equipped with allocation meters, for gas, prior to commingle. The BLM point of measurement for this commingled production is at the Agave CDP meter # 4028 located on the Martha Battery.

NOTE- wells #1-3 each periodically produce separately through the test separator for allocation purposes.

The purpose of the Surface/lease Commingle of production is in the interest of conservation, economic feasibility, the reduction of environmental impact area, and overall emissions. It will not result in reduced royalty or improper measurement of production. Without approval for utilizing existing batteries on adjacent leases, it will become necessary to build separate facilities for each well.

If you should have any questions, please give me a call at (575) 748-4200 (direct line).

Sincerely,

Miriam Morales  
Production Analyst

I hereby approve this application

  
Company: MYCO Industries, Inc.

MARTIN YATES, III  
1912-1985  
FRANK W. YATES  
1936-1986  
S.P. YATES  
1914-2008



105 SOUTH FOURTH STREET  
ARTESIA, NEW MEXICO 88210-2118  
TELEPHONE (575) 748-1471

JOHN A. YATES  
CHAIRMAN OF THE BOARD  
JOHN A. YATES JR.  
PRESIDENT  
JAMES S. BROWN  
CHIEF OPERATING OFFICER  
JOHN D. PERINI  
CHIEF FINANCIAL OFFICER  
JORGE S. MENDOZA  
CHIEF ADMINISTRATIVE OFFICER

RE: Amend Surface Lease Commingle  
Martha AIK Federal #7H & 8H  
Eddy County, New Mexico

Dear Interest Owner,

Yates Petroleum is notifying you of an addition to CTB-664, which will be the Martha AIK Federal #7H & 8H. The battery is located at the Martha AIK Federal #1.

Ownership is diversified.

**Oil Measurement**

All of the wells with the exception of #1, 2, & 3, which utilize a single well test separator (common ownership), will be equipped with continuous meter separators for oil production prior to oil being commingled for sales at the Martha AIK Federal #1. Total sales/production will be allocated back to each individual well using the metered (daily well tests) volumes and periodic tests. Metered volumes will be compared to total battery volumes daily and monthly for accuracy.

**Gas Measurement**

All of the wells with the exception of #1, 2, and 3 which utilize a single well test separator (common ownership) will be equipped with allocation meters, for gas, prior to commingle. The BLM point of measurement for this commingled production is at the Agave CDP meter # 4028 located on the Martha Battery.

NOTE- wells #1-3 each periodically produce separately through the test separator for allocation purposes.

The purpose of the Surface/lease Commingle of production is in the interest of conservation, economic feasibility, the reduction of environmental impact area, and overall emissions. It will not result in reduced royalty or improper measurement of production. Without approval for utilizing existing batteries on adjacent leases, it will become necessary to build separate facilities for each well.

If you should have any questions, please give me a call at (575) 748-4200 (direct line).

Sincerely,

Miriam Morales  
Production Analyst

I hereby approve this application

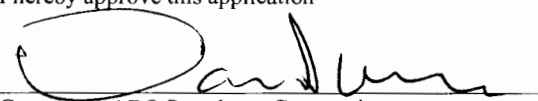
  
Company: ABO Petroleum Corporation



MARTIN YATES, III  
1912-1985

FRANK W. YATES  
1936-1986

S. P. YATES  
1914-2008



105 SOUTH FOURTH STREET  
ARTESIA, NEW MEXICO 88210-2118

TELEPHONE (575) 748-1471

JOHN A. YATES  
CHAIRMAN OF THE BOARD

JOHN A. YATES JR.  
PRESIDENT

JAMES S. BROWN  
CHIEF OPERATING OFFICER

JOHN D. PERINI  
CHIEF FINANCIAL OFFICER

JORGE S. MENDOZA  
CHIEF ADMINISTRATIVE OFFICER

July 8, 2014

RE: Amend Surface Lease Commingle  
Martha AIK Federal #7 & 8  
Eddy County, New Mexico

Dear Interest Owner,

Yates Petroleum is requesting approval from the Bureau of Land Management and the Oil Conservation Division to amend CTB-664 by adding the Martha AIK Federal #7H & Martha AIK Federal #8H.

The commingle production will be measured and sold at Martha battery located at the Martha AIK Federal #1. The ownership is diversified by percentage.

**Oil Measurement**

All of the wells with the exception of #1, 2, & 3, which utilize a single well test separator (common ownership), will be equipped with continuous meter separators for oil production prior to oil being commingled for sales at the Martha AIK Federal #1. Total sales/production will be allocated back to each individual well using the metered (daily well tests) volumes and periodic tests. Metered volumes will be compared to total battery volumes daily and monthly for accuracy.

**Gas Measurement**

All of the wells with the exception of #1, 2, and 3 which utilize a single well test separator (common ownership) will be equipped with allocation meters, for gas, prior to commingle. The BLM point of measurement for this commingled production is at the Agave CDP meter # 4028 located on the Martha Battery.

NOTE- wells #1-3 each periodically produce separately through the test separator for allocation purposes.

The purpose of the Surface/lease Commingle of production is in the interest of conservation, economic feasibility, the reduction of environmental impact area, and overall emissions. It will not result in reduced royalty or improper measurement of production. Without approval for utilizing existing batteries on adjacent leases, it will become necessary to build separate facilities for each well. This will greatly increase costs and shorten the economic life of each well.

Any objection must be filed in writing with the Oil Conservation Division in Santa Fe within 20 days from the date the division receives the application. Application will be sent in conjunction with notification to owners.

If you should have any questions, please give me a call at (575) 748-4200 (direct line).

Sincerely,

A handwritten signature in cursive script, appearing to read 'Miriam Morales'.

Miriam Morales  
Production Analyst

**CERTIFIED MAIL™**



YATES BUILDING - 105 SOUTH FOURTH STREET  
ARTESIA, NEW MEXICO 88210

ADDRESS SERVICE REQUESTED

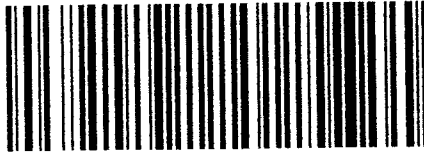

7013 2250 0000 5201 2099  
7013 2250 0000 5201 2099

U.S. Postal Service™ <b>CERTIFIED MAIL™ RECEIPT</b> (Domestic Mail Only: No Insurance Coverage Provided)	
For delivery information visit our website at <a href="http://www.usps.com">www.usps.com</a>	
Certified Fee Postage \$	Return Receipt Fee (Endorsement Required) Restricted Delivery Fee (Endorsement Required) Total Postage & Fees \$
Sent To Street, Apt. No., or PO Box No. City, State, ZIP+4	Postmark Here
PS Form 3800, August 2006 See Reverse for Instructions	

*North 841803 of B-104 7/18/14  
Kimmer pad.*

OXY Y-1 COMPANY  
P O BOX 841803  
DALLAS TX 75284-1803

PLACE STICKER AT TOP OF ENVELOPE TO THE RIGHT OF THE RETURN ADDRESS, FOLD AT DOTTED LINE

SENDER: COMPLETE THIS SECTION		COMPLETE THIS SECTION ON DELIVERY	
1. Article Addressed to:  OXY Y-1 COMPANY P O BOX 841803 DALLAS TX 75284-1803		A. Signature <input checked="" type="checkbox"/> Agent <input checked="" type="checkbox"/> Addressee B. Received by (Printed Name) C. Date of Delivery	
2. Article Number (Transfer from sender) 7013 2250 0000 5201 2099		D. Is delivery address different from item 1? <input type="checkbox"/> Yes If YES, enter delivery address below: <input type="checkbox"/> No	
3. Service Type <input checked="" type="checkbox"/> Certified Mail® <input type="checkbox"/> Priority Mail Express™ <input type="checkbox"/> Registered <input type="checkbox"/> Return Receipt for Merchandise <input type="checkbox"/> Insured Mail <input type="checkbox"/> Collect on Delivery		4. Restricted Delivery? (Extra Fee) <input type="checkbox"/> Yes	

mail receipt delivery address mail is RANI please item 1000 For the return ditto sent to rk or post office Sav August

MPSD821

Inquire/Update Production History

7/15/14  
11:04:27

Property . . . . . 038695 001      MARTHA AIK FEDERAL #1  
Production Date Range . . . . 12 2013 to 07 2014

Type options, press Enter.  
2=Edit 4=Delete 5=Display

O	P	Prod	Well	API	Reg	Dys	-----Oil-----		-----Gas-----		-Water-
T	Mo/Year	Name	Cpl	Prd	Produced	Sold	Produced	Sold	Produced	Sold	Prod
_	5	2014	MARTHA AIK FEDE	S1	31	288	292	557	513	981	
_	4	2014	MARTHA AIK FEDE	S1	30	390	387	664	664	1637	
_	3	2014	MARTHA AIK FEDE	S1	27	356	348	339	339	1434	
_	2	2014	MARTHA AIK FEDE	S1	15	146	140	94	94	556	
_	1	2014	MARTHA AIK FEDE	S1							
_	12	2013	MARTHA AIK FEDE	S1			1				

F3=Exit    F6=Add    F10=Totals    F11=Expand/Compress    F12=Previous    F15=Print

MPSD821

Inquire/Update Production History

7/15/14  
11:04:40

Property . . . . . 038695 002      MARTHA AIK FEDERAL #2  
Production Date Range . . . . 12 2013 to 07 2014

Type options, press Enter.  
2=Edit 4>Delete 5=Display

O	P	Prod	Well	API	Reg	Dys	-----Oil-----		-----Gas-----		-Water-
T	Mo/Year	Name	Cpl	Prd	Produced	Sold	Produced	Sold	Produced	Sold	Prod
[ ]	5	2014	MARTHA AIK FEDE	S1	31	262	265	568	524	951	
[ ]	4	2014	MARTHA AIK FEDE	S1	30	358	349	633	633	1592	
[ ]	3	2014	MARTHA AIK FEDE	S1	20	165	163	310	310	1296	
[ ]	2	2014	MARTHA AIK FEDE	S1	11	93	89	93	93	1051	
[ ]	1	2014	MARTHA AIK FEDE	S1							
[ ]	12	2013	MARTHA AIK FEDE	S1							

F3=Exit F6=Add F10=Totals F11=Expand/Compress F12=Previous F15=Print

MPSD821

Inquire/Update Production History

7/15/14

11:04:47

Property . . . . . 038695 003 MARTHA AIK FEDERAL #3

YPC

Production Date Range . . . . 12 2013 to 07 2014

Type options, press Enter.

2=Edit 4=Delete 5=Display

O	P	Prod	Well	API	Reg	Dys	-----Oil-----		-----Gas-----		-Water-
T	Mo/Year	Name	Cpl	Prd	Produced	Sold	Produced	Sold	Produced	Sold	Prod
[	5	2014	MARTHA AIK FEDE	S1	31	420	420	569	525	1275	
[	4	2014	MARTHA AIK FEDE	S1	30	442	429	600	600	1774	
[	3	2014	MARTHA AIK FEDE	S1	10	163	163	171	171	552	
[	2	2014	MARTHA AIK FEDE	S1	13	136	130	83	83	492	
[	1	2014	MARTHA AIK FEDE	S1							
[	12	2013	MARTHA AIK FEDE	S1			1				

F3=Exit F6=Add F10=Totals F11=Expand/Compress F12=Previous F15=Print

MPSD821

Inquire/Update Production History

7/15/14  
11:04:55  
YPC

Property . . . . . 038695 004      MARTHA AIK FEDERAL #4  
Production Date Range . . . . . 12 2013 to 07 2014

Type options, press Enter.  
2=Edit 4=Delete 5=Display

O	P	Prod	Well	API	Reg	-----Oil-----		-----Gas-----		-Water-
T	Mo/Year	Name	Cpl	Dys	Prd	Produced	Sold	Produced	Sold	Prod
[	5	2014	MARTHA AIK FEDE	S1	31	536	539	548	504	1212
[	4	2014	MARTHA AIK FEDE	S1	30	640	622	658	658	1540
[	3	2014	MARTHA AIK FEDE	S1	12	224	220	209	209	277
[	2	2014	MARTHA AIK FEDE	S1	11	112	107	107	107	972
[	1	2014	MARTHA AIK FEDE	S1			1			
[	12	2013	MARTHA AIK FEDE	S1			8			

F3=Exit    F6=Add    F10=Totals    F11=Expand/Compress    F12=Previous    F15=Print

MPSD821

Inquire/Update Production History

7/15/14  
11:05:01

Property . . . . . 038695 005      MARTHA AIK FEDERAL #5  
Production Date Range . . . . 12 2013 to 07 2014

Type options, press Enter.  
2=Edit 4=Delete 5=Display

O	P	Prod	Well	API	Reg	Dys	-----Oil-----		-----Gas-----		-Water-
T	Mo/Year	Name	Cpl	Prd	Produced	Sold	Produced	Sold	Produced	Sold	Prod
[	5	2014	MARTHA AIK FEDE	S1	30	132	127	561	517	1811	
[	4	2014	MARTHA AIK FEDE	S1	5	20	19	60	60	258	
[	3	2014	MARTHA AIK FEDE	S1			5				
[	2	2014	MARTHA AIK FEDE	S1	13	105	100	100	100	755	
[	1	2014	MARTHA AIK FEDE	S1							
[	12	2013	MARTHA AIK FEDE	S1							

F3=Exit    F6=Add    F10=Totals    F11=Expand/Compress    F12=Previous    F15=Print

MPSD821

Inquire/Update Production History

7/15/14  
11:05:10

Property . . . . . 038695 006      MARTHA AIK FEDERAL #6  
Production Date Range . . . . 12 2013 to 07 2014

Type options, press Enter.  
2=Edit 4=Delete 5=Display

O	P	Prod	Well	API	Reg	-----Oil-----		-----Gas-----		-Water-
T	Mo/Year	Name	Cpl	Dys	Prd	Produced	Sold	Produced	Sold	Prod
┌	5	2014	MARTHA AIK FEDE	S1	31	138	133	572	528	1904
┌	4	2014	MARTHA AIK FEDE	S1	5	20	19	60	60	261
┌	3	2014	MARTHA AIK FEDE	S1			4			
┌	2	2014	MARTHA AIK FEDE	S1	13	96	92	101	101	482
┌	1	2014	MARTHA AIK FEDE	S1						
┌	12	2013	MARTHA AIK FEDE	S1						

F3=Exit    F6=Add    F10=Totals    F11=Expand/Compress    F12=Previous    F15=Print



MPSD821

Inquire/Update Production History

7/15/14  
11:05:18

Property . . . . . 038695 007      MARTHA AIK FEDERAL #7H  
Production Date Range . . . . 12 2013 to 07 2014

Type options, press Enter.  
2=Edit 4=Delete 5=Display

O	P	Prod	Well	API	Reg	-----Oil-----		-----Gas-----		-Water-
T	Mo/Year	Name	Cpl	Prd	Dys	Produced	Sold	Produced	Sold	Prod
[	5	2014	MARTHA AIK FEDE	S01	14	471	452	352	352	3367
[	4	2014	MARTHA AIK FEDE	S01			33			
[	3	2014	MARTHA AIK FEDE	S01	23	865	857	1256	1256	9167
[	2	2014	MARTHA AIK FEDE	S01	20	586	560	11	11	8912

F3=Exit    F6=Add    F10=Totals    F11=Expand/Compress    F12=Previous    F15=Print

MPSD821

Inquire/Update Production History

7/15/14  
11:05:32

Property . . . . . 038695 008      MARTHA AIK FEDERAL #8H  
Production Date Range . . . . 12 2013 to 07 2014

Type options, press Enter.

2=Edit 4=Delete 5=Display

O	P	Prod	Well	API	Reg	-----Oil-----		-----Gas-----		-Water-
T	Mo/Year	Name	Cpl	Prd	Dys	Produced	Sold	Produced	Sold	Prod
┌	5	2014	MARTHA AIK FEDE	S01	31	2773	2780	10683	10683	35750
┌	4	2014	MARTHA AIK FEDE	S01	30	3058	3082	9369	9369	33088
┌	3	2014	MARTHA AIK FEDE	S01	31	3910	3932	10266	10266	36593
┌	2	2014	MARTHA AIK FEDE	S01	28	3922	3917	9889	9889	33306
┌	1	2014	MARTHA AIK FEDE	S01	31	5692	5518	7516	7516	38458

F3=Exit F6=Add F10=Totals F11=Expand/Compress F12=Previous F15=Print

MPSD821

Inquire/Update Production History

7/15/14  
11:05:42

Property . . . . . 038695 009      MARTHA AIK FEDERAL #9H  
Production Date Range . . . . 12 2013 to 07 2014

Type options, press Enter.  
2=Edit 4=Delete 5=Display

O	P	Prod	Well	API	Reg	-----Oil-----		-----Gas-----		-Water-
T	Mo/Year	Name	Cpl	Prd	Produced	Sold	Produced	Sold	Prod	
[	5	2014	MARTHA AIK FEDE	S01	31	1443	1441	4297	4297	16540
[	4	2014	MARTHA AIK FEDE	S01	30	1445	1448	3728	3728	14978
[	3	2014	MARTHA AIK FEDE	S01	31	1667	1649	4506	4506	17602
[	2	2014	MARTHA AIK FEDE	S01	17	1038	1058	2777	2777	10169
[	1	2014	MARTHA AIK FEDE	S01	31	2068	2156	4922	4922	18864
[	12	2013	MARTHA AIK FEDE	S01	28	2284	2244	3447	3447	15564

F3=Exit    F6=Add    F10=Totals    F11=Expand/Compress    F12=Previous    F15=Print

MPSD821

Inquire/Update Production History

7/15/14  
11:05:48

Property . . . . . 038695 010      MARTHA AIK FEDERAL #10H  
Production Date Range . . . . 12 2013 to 07 2014

Type options, press Enter.

2=Edit 4=Delete 5=Display

O	P	Prod	Well	API	Reg	Dys	-----Oil-----		-----Gas-----		-Water-
T	Mo/Year		Name	Cpl	Prd	Produced	Sold	Produced	Sold	Prod	
[	5	2014	MARTHA AIK FEDE	S01	31	2787	2785	6008	6008	20394	
[	4	2014	MARTHA AIK FEDE	S01	30	2868	2874	5304	5304	17392	
[	3	2014	MARTHA AIK FEDE	S01	31	3271	3255	6853	6853	23409	
[	2	2014	MARTHA AIK FEDE	S01	26	2513	2503	6181	6181	21514	
[	1	2014	MARTHA AIK FEDE	S01	31	3250	3311	4641	4641	21731	
[	12	2013	MARTHA AIK FEDE	S01	30	2366	2386	5632	5632	18329	

F3=Exit F6=Add F10=Totals F11=Expand/Compress F12=Previous F15=Print

MPSD821

Inquire/Update Production History

7/15/14  
11:05:54

Property . . . . . 038695 011      MARTHA AIK FEDERAL #11H  
Production Date Range . . . . 12 2013 to 07 2014

Type options, press Enter.  
2=Edit 4=Delete 5=Display

O	P	Prod	Well	API	Dys	Reg	-----Oil-----		-----Gas-----		-Water-
T	Mo/Year	Name	Cpl	Prd	Produced	Sold	Produced	Sold	Produced	Sold	Prod
┌	5	2014	MARTHA AIK FEDE	S01	31	4889	4888	7939	7939	15399	
┌	4	2014	MARTHA AIK FEDE	S01	30	5108	5164	7531	7531	15921	
┌	3	2014	MARTHA AIK FEDE	S01	31	6929	6941	10111	10111	17934	
┌	2	2014	MARTHA AIK FEDE	S01	28	6439	6364	5411	5411	21956	
┌	1	2014	MARTHA AIK FEDE	S01	31	6892	6864	6626	6626	20989	
┌	12	2013	MARTHA AIK FEDE	S01	31	2759	2720	1706	1706	30569	

F3=Exit   F6=Add   F10=Totals   F11=Expand/Compress   F12=Previous   F15=Print

MPSD821

Inquire/Update Production History

7/15/14  
11:06:03

Property . . . . . 038695 013      MARTHA AIK FEDERAL #13H  
Production Date Range . . . . 12 2013 to 07 2014

Type options, press Enter.  
2=Edit 4=Delete 5=Display

O	P	Prod	Well	API	Reg	-----Oil-----		-----Gas-----		-Water-
T	Mo/Year		Name	Cpl	Dys Prd	Produced	Sold	Produced	Sold	Prod
[	5	2014	MARTHA AIK FEDE	S01	31		1	44		
[	4	2014	MARTHA AIK FEDE	S01			12			
[	3	2014	MARTHA AIK FEDE	S01	18	315	315	286	286	8145
[	2	2014	MARTHA AIK FEDE	S01	12	284	296	141	141	9262
[	1	2014	MARTHA AIK FEDE	S01	28	775	804	1844	1844	14518
[	12	2013	MARTHA AIK FEDE	S01	26	775	788	1898	1898	9633

F3=Exit F6=Add F10=Totals F11=Expand/Compress F12=Previous F15=Print

MPSD821

Inquire/Update Production History

7/15/14  
11:06:09

Property . . . . . 038695 014      MARTHA AIK FEDERAL #14H  
Production Date Range . . . . 12 2013 to 07 2014

Type options, press Enter.  
2=Edit 4=Delete 5=Display

O	P	Prod	Well	API	Reg	-----Oil-----		-----Gas-----		-Water-
T	Mo/Year	Name	Cpl	Prd	Dys	Produced	Sold	Produced	Sold	Prod
[	5	2014	MARTHA AIK FEDE	S01	31	866	854	290	290	6750
[	4	2014	MARTHA AIK FEDE	S01	30	629	612	178	178	6803
[	3	2014	MARTHA AIK FEDE	S01	31	272	263	98	98	7587
[	2	2014	MARTHA AIK FEDE	S01	16		20	470	470	3668
[	1	2014	MARTHA AIK FEDE	S01	23	613	665	595	595	4632
[	12	2013	MARTHA AIK FEDE	S01	27	1051	1052	925	925	5560

F3=Exit    F6=Add    F10=Totals    F11=Expand/Compress    F12=Previous    F15=Print

State of New Mexico  
Energy, Minerals and Natural Resources Department

**Susana Martinez**  
Governor

**John Bemis**  
Cabinet Secretary

**Brett F. Woods, Ph.D.**  
Deputy Cabinet Secretary

**Jami Bailey**  
Division Director  
Oil Conservation Division



Administrative Order CTB-664  
Application No. pDKB1235556454

December 20, 2012

Yates Petroleum Corporation  
105 South Fourth Street  
Artesia, NM 88210

Attention: Miriam Morales:

Yates Petroleum Corporation ("Yates") is hereby authorized to surface commingle oil and gas production from the Livingston Ridge; Delaware Pool (39360), and from the following federal leases and wells:

Martha AIK Federal Well No. 1 (API 30-015-26549), Section 11, T-22-S, R-31-E  
Martha AIK Federal Well No. 2 (API 30-015-26650), Section 11, T-22-S, R-31-E  
Martha AIK Federal Well No. 3 (API 30-015-26723), Section 11, T-22-S, R-31-E  
Martha AIK Federal Well No. 4 (API 30-015-26724), Section 11, T-22-S, R-31-E  
Martha AIK Federal Well No. 5 (API 30-015-26908), Section 11, T-22-S, R-31-E  
Martha AIK Federal Well No. 6 (API 30-015-26960), Section 11, T-22-S, R-31-E  
Martha AIK Federal Well No. 9H (API 30-015-37512), Section 11, T-22-S, R-31-E  
Martha AIK Federal Well No. 10H (API 30-015-37509), Section 11, T-22-S, R-31-E  
Martha AIK Federal Well No. 11H (API 30-015-37510), Section 11, T-22-S, R-31-E  
Martha AIK Federal Well No. 13H (API 30-015-37511), Section 11, T-22-S, R-31-E  
Martha AIK Federal Well No. 14H (API 30-015-37556), Section 11, T-22-S, R-31-E

**All in NMPM, Eddy County, New Mexico.**

The commingled oil and gas production from the wells detailed above shall be measured and sold at the Central Tank Battery (CTB), located at the Martha AIK Federal Well No. 1 in Section 11 Township 22 South, Range 31 East, NMPM, Eddy County, New Mexico.

The oil and gas production from each well shall be continuously measured with allocation meters before commingling with production from other wells; provided that production from the Martha AIK Federal Wells Nos. 1, 2 and 3, which have identical ownership, shall pass through a single separator, and be allocated back to individual wells based on well tests. The allocation meters shall be calibrated monthly.



December 20, 2012

Page 2

NOTE: This installation shall be installed and operated in accordance with the applicable Division Rules and Regulations. It is the responsibility of the producer to notify the transporter of this commingling authority.

FURTHER: The operator shall notify the Artesia District office of the Division prior to implementation of the commingling operations.

**This approval is subject to like approval from the United States Bureau of Land Management (BLM) before commencing the commingling operations.**

DONE at Santa Fe, New Mexico, on December 20, 2012.

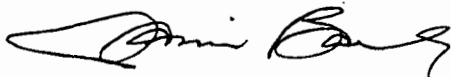

Jami Bailey  
Division Director

JB/re

cc: Oil Conservation Division – Artesia  
State Land Office – Oil, Gas, and Minerals Division