

RECEIVED: 11/13/2017	REVIEWER: MAM	TYPE: PLC	APP NO: DMAM1731759469
-------------------------	------------------	--------------	---------------------------

ABOVE THIS TABLE FOR OCD DIVISION USE ONLY

NEW MEXICO OIL CONSERVATION DIVISION
 - Geological & Engineering Bureau -
 1220 South St. Francis Drive, Santa Fe, NM 87505



ADMINISTRATIVE APPLICATION CHECKLIST

THIS CHECKLIST IS MANDATORY FOR ALL ADMINISTRATIVE APPLICATIONS FOR EXCEPTIONS TO DIVISION RULES AND REGULATIONS WHICH REQUIRE PROCESSING AT THE DIVISION LEVEL IN SANTA FE

Applicant: OXY USA WTP LP	OGRID Number: 192463
Well Name: JAMES BUCHANAN 33 STATE NO 1	API: 30-015-29890
Pool: TRAVIS; UPPER PENN	Pool Code: 59860

SUBMIT ACCURATE AND COMPLETE INFORMATION REQUIRED TO PROCESS THE TYPE OF APPLICATION INDICATED BELOW

1) **TYPE OF APPLICATION:** Check those which apply for [A]

A. Location - Spacing Unit - Simultaneous Dedication

☐ NSL ☐ NSP (PROJECT AREA) ☐ NSP (PRORATION UNIT) ☐ SD

B. Check one only for [I] or [II]

[I] Commingling - Storage - Measurement

☐ DHC ☐ CTB ☒ PLC ☐ PC ☐ OLS ☐ OLM

[II] Injection - Disposal - Pressure Increase - Enhanced Oil Recovery

☐ WFX ☐ PMX ☐ SWD ☐ IPI ☐ EOR ☐ PPR

2) **NOTIFICATION REQUIRED TO:** Check those which apply.

A. ☐ Offset operators or lease holders

B. ☒ Royalty, overriding royalty owners, revenue owners

C. ☐ Application requires published notice

D. ☒ Notification and/or concurrent approval by SLO

E. ☐ Notification and/or concurrent approval by BLM

F. ☐ Surface owner

G. ☒ For all of the above, proof of notification or publication is attached, and/or,

H. ☐ No notice required

FOR OCD ONLY

☐ Notice Complete

☐ Application Content Complete

3) **CERTIFICATION:** I hereby certify that the information submitted with this application for administrative approval is **accurate** and **complete** to the best of my knowledge. I also understand that **no action** will be taken on this application until the required information and notifications are submitted to the Division.

Note: Statement must be completed by an individual with managerial and/or supervisory capacity.

SANDRA MUSALLAM

Print or Type Name

Sandra Musallam

Signature

11/10/2017

Date

713-366-5106

Phone Number

SANDRA_MUSALLAM@OXY.COM

e-mail Address

APPLICATION FOR POOL AND LEASE COMMINGLING, OFF-LEASE MEASUREMENT, SALES AND STORAGE

Commingling proposal for James Buchanan 33 State No. 1 Battery

OXY USA WTP LP requests approval to amend surface commingling permit CTB-467 for the James Buchanan 33 State No. 1 battery. Off-lease measurement, sales and storage is also requested for Pagan State No. 1, Pagan State No. 2 and Edward Mitchusson 4 State No. 1.

The oil production from all of the facilities and wells listed below will flow to the James Buchanan 33 State No. 1 battery (Lat 32.7024422, Long -104.1745224) where it will be stored, measured and trucked to sales. Production will then be allocated to each well based on well test and the amount of hours the well was operating in a given month.

Gas production from the Edward Mitchusson 4 State No. 1, Pagan State No. 1 and No. 2 wells will be separated and measured through Oxy check meters at their respective batteries, as described below.

All water will be trucked to disposal.

A detailed process description by facility can be found below. The oil and gas meters will be calibrated on a regular basis per API and NMOCD specifications.

STATE LEASE X0647405

POOL: TRAVIS; UPPER PENN (59860)

Well Name	API	Location	Oil (BPD)	Gravity	Gas (MSCFD)	BTU/cf	Water (BPD)
James Buchanan 33 State No 1	30-015-29890	I-33-18S-28E	1	42.6	5	1300	0
James Buchanan 33 State No 2	30-015-30322	A-33-18S-28E	0	42.6	2	1300	0

STATE LEASE LG29855

POOL: ILLINOIS CAMP; BONE SPRING (96632)

Well Name	API	Location	Oil (BPD)	Gravity	Gas (MSCFD)	BTU/cf	Water (BPD)
Pagan State No 1*	30-015-30316	D-26-18S-28E	83	40.4	260	1240	110

* Estimated production values after recompletion

STATE LEASE LG29855

POOL: TRAVIS; UPPER PENN (59860)

Well Name	API	Location	Oil (BPD)	Gravity	Gas (MSCFD)	BTU/cf	Water (BPD)
Pagan State No 2	30-015-30367	L-26-18S-28E	0	42.6	8	1328	0

STATE LEASE X0648150

POOL: TRAVIS WOLFCAMP (96833)

Well Name	API	Location	Oil (BPD)	Gravity	Gas (MSCFD)	BTU/cf	Water (BPD)
Edward Mitchusson 4 State No 1	30-015-30165	K-04-19S-28E	1	42.6	7	1291	0

James Buchanan 33 State No. 1 and No. 2 production is separated, measured and stored at the James Buchanan 33 State No. 1 battery. The battery is equipped with a three-phase test separator and three-phase production separator. The test separator is equipped with turbine meters for oil and water measurement, and an orifice meter for gas measurement. Oil production is sent through the separators then to storage tanks at the battery before being measured and trucked to sales. Gas production is sent from the three-phase separators to a gas sales meter. Water production is sent from the three-phase separators to water tanks at the battery, then trucked to disposal.

Edward Mitchusson 4 State No. 1 production flows to a three-phase separator located at its well pad (Lat 32.687767, Long -104.1829071). The separator is equipped with turbine meters for oil and water measurement, and an orifice meter for gas measurement. Oil and water are recombined downstream of the separator turbine meters and sent to the James Buchanan 33 State battery production separator. Gas from Edward Mitchusson 4 State No. 1 is measured through the orifice meter on the production separator at its well pad, then sent to sales.

Pagan State No. 1 and No. 2 production flows to a three-phase separator located at the Pagan State No. 1 well pad (Lat 32.7239876, Long -104.1533508). The separator is equipped with turbine meters for oil and water measurement, and an orifice meter for gas measurement. Oil is sent from the separator at Pagan State No. 1 well pad to the oil storage tanks located at the James Buchanan 33 State battery. Gas is measured through the orifice meter on the production separator at Pagan State No. 1 well pad, then sent to sales. Water is sent to disposal.

Additional Application Components:

The flow of production is shown in detail on the enclosed facility diagrams. Also enclosed is a map detailing the lease boundaries, well and battery locations.

The working interest, royalty interest and overriding royalty interest owners have been notified of this proposal by certified mail (see attached).

Pursuant to Statewide rule 19.15.12.10(C)(4)(g) OXY USA WTP LP requests the option to include additional pools or leases within the defined parameters set forth in the order for future additions.

Commingling this production is the most effective means of producing the reserves. OXY USA WTP LP understands the requested approval will not constitute the granting of any right-of-way or construction rights not granted by the lease instrument. These applications will be submitted separately for approval per NMOC regulations.

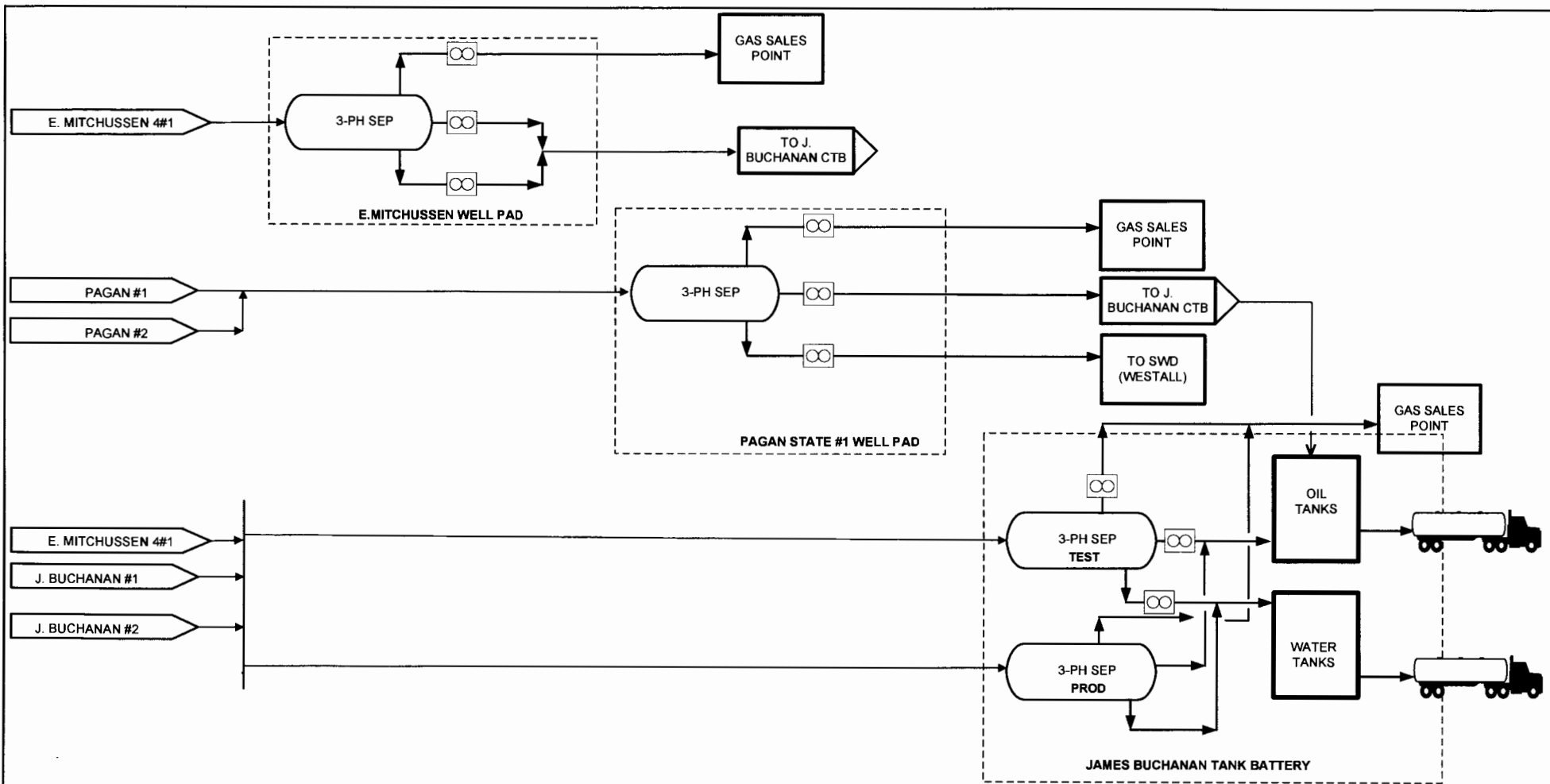

REVISION BLOCK						ENGINEERING RECORD		<p>PROCESS FLOW DIAGRAM JAMES BUCHANAN BATTERY</p> <p>EDDY COUNTY, NEW MEXICO</p>
NO.	DATE	DESCRIPTION	BY	CHK	APP	BY	DATE	
1	9/6/17		LDS			DRN:		
						DES:		
						CHK:		
						APP:		
						AFE:		

James Buchanan CTB

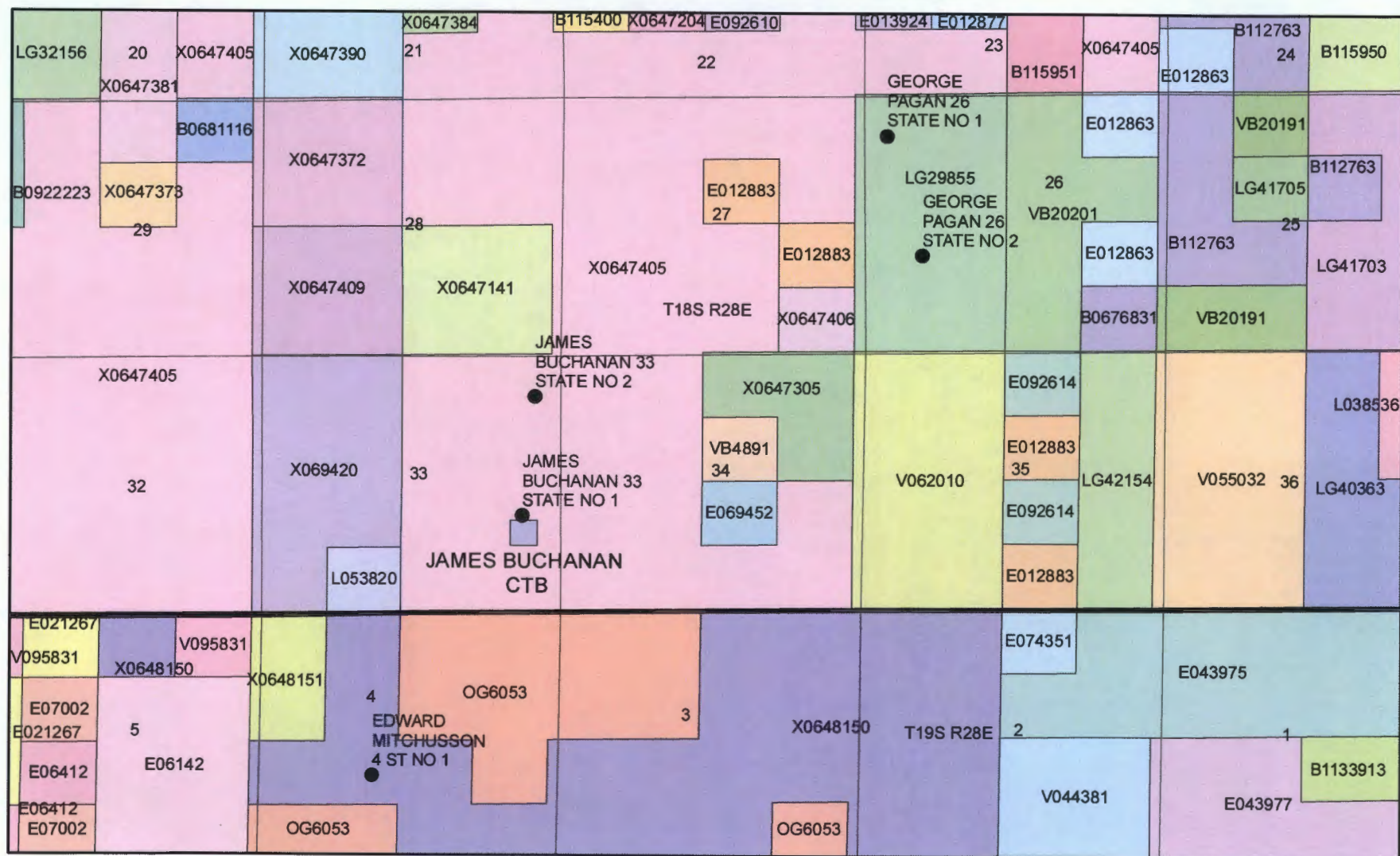

Legend

- Wells

James Buchanan CTB

James Buchanan 33 Production Data

James Buchanan 33 State No. 1 (30-015-29890)

Month	Oil (bbls)	Gas (MCF)	Water (bbls)
Mar-2017	4	13	0
Apr-2017	0	0	0
May-2017	0	19	0
Jun-2017	0	27	0
Jul-2017	0	23	0
Aug-2017	0	0	0

Pagan State 26 Production Data

Pagan 26 State No. 2 (30-015-30367)

Month	Oil (bbls)	Gas (MCF)	Water (bbls)
Mar-2017	0	36	0
Apr-2017	0	24	0
May-2017	0	42	0
Jun-2017	0	117	0
Jul-2017	0	144	0
Aug-2017	0	101	0

James Buchanan 33 State No. 2 (30-015-30322)

Month	Oil (bbls)	Gas (MCF)	Water (bbls)
Mar-2017	0	1	0
Apr-2017	0	0	0
May-2017	0	4	0
Jun-2017	0	0	0
Jul-2017	0	0	0
Aug-2017	0	0	0

E Mitchussen 4 Production Data

E. Mitchussen 4 State No. 1 (30-015-30165)

Month	Oil (bbls)	Gas (MCF)	Water (bbls)
Mar-2017	36	94	0
Apr-2017	0	0	0
May-2017	0	0	0
Jun-2017	0	185	0
Jul-2017	0	35	0
Aug-2017	0	66	0



**OXY USA WTP Limited Partnership / OXY USA INC /
OCCIDENTAL PERMIAN LTD**
A subsidiary of Occidental Petroleum Corporation

5 Greenway Plaza, Suite 110, Houston, Texas 77046
P.O. Box 4294, Houston, Texas 77210-4294
Direct: 713.366.5106
Sandra_Musallam@oxy.com

November 10, 2017

CERTIFIED MAIL
RETURN RECEIPT REQUESTED

Re: Application for Pool and Lease Commingling and Off-lease Measurement, Sales, & Storage for
the James Buchanan 33 State No. 1, Pagan State No. 1 and Edward Mitchusson 4 State No. 1
Batteries
Eddy County, New Mexico

To Whom It May Concern:

This is to advise you that OXY USA WTP LP is filing an application for pool and surface commingling at the James Buchanan 33 State No. 1 Battery. A copy of the application submitted to the Division is attached.

Any objections or requests for a hearing regarding this application must be submitted to the New Mexico Oil Conservation Division Santa Fe Office within 20 Days from the date of this letter.

Pursuant to Statewide rule 19.15.12.10(C)(4)(g) OXY USA INC requests the option to include additional pools or leases within the defined parameters set forth in the order for future additions.

For questions regarding this application, please contact Sandra Musallam at (713) 366-5106.

Respectfully,

OXY USA WTP LP
Sandra Musallam
Regulatory Engineer – Compliance Lead
Sandra_Musallam@oxy.com

NAME	ADDRESS	CITY	ST	ZIP	TRACKING
ANDERSEN MALONE LLC	PO BOX 87	ROS WELL	NM	88202-0087	7017 1450 0002 2915 3928
ANNE S JOHNSON	14511 W SELMA	WICHITA	KS	67227	7017 1450 0002 2915 3911
BEAN FAMILY LTD CO	PO BOX 1738	ROS WELL	NM	88202-1738	7017 1450 0002 2915 3904
BEVERIDGE COMPANY	SUITE 235, 4305 N GARFIELD	MIDLAND	TX	79705	7017 1450 0002 2915 3898
CHARLES F MALONE LVG TRST	2701 CHRYSLER DR	ROS WELL	NM	88201-5207	7017 1450 0002 2915 3881
CHERYL WHITE DERRICK	6006 BALCONES CT APT 20	EL PASO	TX	79912-3340	7017 1450 0002 2915 3874
COILLE LTD PARTNERSHIP LP	1508 WILMINGTON AVE	RICHMOND	VA	23227	7017 1450 0002 2915 3867
CONSTANCE WHITE	7007 LAWLER RIDGE	HOUSTON	TX	77055-7012	7017 1450 0002 2915 3850
DML REV TRUST, DAN LEONARD	PO BOX 3422	MIDLAND	TX	79702	7017 1450 0002 2915 3843
DOROTHY H PETERSON	56 BRIVERSIDE DR	ROS WELL	NM	88201-0915	7017 1450 0002 2915 3836
ELIZABETH EATON	5870 S CURTICE ST	LITTLETON	CO	80120-1909	7017 1450 0002 2915 3829
ELIZABETH WHITE KANALY	1022 POTOMAC	HOUSTON	TX	77057	7017 1450 0002 2915 3812
EOG RESOURCES INC	PO BOX 840321	DALLAS	TX	75284	7017 1450 0002 2915 3805
EOG Y RESOURCES INC	105 SOUTH FOURTH ST	ARTESIA	NM	88210	7017 1450 0002 2915 3799
FAULCONER 1996 LLP	PO BOX 8150	TYLER	TX	75711-8150	7017 1450 0002 2915 3782
GILBERT J EATON	48 ARIZONA STATE DRIVE	NEWARK	DE	19713-1144	7017 1450 0002 2915 3775
GRETCHEN S WHITE	700 NORTH KENTUCKY	ROS WELL	NM	88201-4822	7017 1450 0002 2915 3768
HANACO LLC	PO BOX 750	BIG HORN	WY	82833	7017 1450 0002 2915 3751
HANAGAN INVESTMENTS LLC	PO BOX 1737	ROS WELL	NM	88202-1737	7017 1450 0002 2915 3744
HARVARD PETROLEUM CORP	PO BOX 936	ROS WELL	NM	88202-0936	7017 1450 0002 2915 3737
J PHELPS WHITE III	8883 SW 94TH LANE #F	OCALA	FL	34481	7017 1450 0002 2915 3720
J PHELPS WHITE IV	PO BOX 1433	ROS WELL	NM	88202-1433	7017 1450 0002 2915 3713
JAMES GEBEL	PO BOX 162	ROS WELL	NM	88202	7017 1450 0002 2915 3690
JOSEPH J KELLY	PO BOX 310	ROS WELL	NM	88202-0310	7017 1450 0002 2915 3706
LAURA LYNN MCCAMPBELL	6023 WEYMOUTH DRIVE	DALLAS	TX	75252	7017 1450 0002 2915 3683
LINDA E SCHWARZ	324 W RAMONA AVE	COLORADO SPRINGS	CO	80905	7017 1450 0002 2915 3676
LISA L DURBAN	PO BOX 3194	BOULDER	CO	80307	7017 1450 0002 2915 3669
LRW CORP	BOX 168	MIDLAND	TX	79702	7017 1450 0002 2915 3652
MARIAN LEONE SPEARS	PO BOX 293384	KERRVILLE	TX	78029	7017 1450 0002 2915 5007
MARY ANN TWITTY	26989 SEA VISTA DR	MALIBU	CA	90265-4432	7017 1450 0002 2915 4031
NEW MEXICO WESTERN MINERALS INC	PO BOX 1738	ROS WELL	NM	88202-1738	7017 1450 0002 2915 4024
NONDARCY OIL AND GAS INC	PO BOX 1116	ROS WELL	NM	88202	7017 1450 0002 2915 4017
PAMELA ANNE EVANS	7625 PARKVIEW CIRCLE	AUSTIN	TX	78731	7017 1450 0002 2915 4000
READ & STEVENS INC	PO BOX 1518	ROS WELL	NM	88201	7017 1450 0002 2915 3997
ROBERT K LEONARD	PO BOX 294928	KERRVILLE	TX	78029	7017 1450 0002 2915 3980
ROY G SR & OPAL BARTON REV TRUST	1919 N TURNER ST	HOBBS	NM	88240-2712	7017 1450 0002 2915 3973
SPLASH EXPLORATION LP	PO BOX 1973	ROS WELL	NM	88202	7017 1450 0002 2915 3966
STATE OF NEW MEXICO COMMISSIONER OF	PO BOX 1148	SANTA FE	NM	87504-1148	7017 1450 0002 2915 3959
THEODORE P WHITE	PO BOX 533	ROS WELL	NM	88202-0533	7017 1450 0002 2915 3942
ZIA ENTERPRISES DBA ZIA ROYALTY LLC	PO BOX 2160	HOBBS	NM	88241	7017 1450 0002 2915 3935
ZPZ DELAWARE I LLC	PO BOX 840133	DALLAS	TX	75284-0133	7017 1450 0002 2915 3645

DISTRICT I

P.O. Box 1980, Hobbs, NM 88241-1980

State of New Mexico

Energy, Minerals and Natural Resources Department

Form C-102

Revised February 10, 1994
 Submit to Appropriate District Office
 State Lease - 4 Copies
 Fee Lease - 3 Copies

DISTRICT II

P.O. Drawer 88, Artesia, NM 88211-0719

DISTRICT III

1000 Rio Brazos Rd., Aztec, NM 87410

OIL CONSERVATION DIVISION

P.O. Box 2088

Santa Fe, New Mexico 87504-2088

DISTRICT IV

P.O. Box 8088, Santa Fe, NM 87504-8088

☐ AMENDED REPORT

WELL LOCATION AND ACREAGE DEDICATION PLAT

API Number 30-015-29890	Pool Code	Pool Name Travis - Upper Pennsylvanian
Property Code 21712	Property Name JAMES BUCHANAN "33" STATE	Well Number 1
OGRID No. 14021	Operator Name MARATHON OIL COMPANY	Elevation 3545

Surface Location

UL or lot No.	Section	Township	Range	Lot Idn	Feet from the	North/South line	Feet from the	East/West line	County
1	33	18 S	28 E		2000	SOUTH	660	EAST	EDDY

Bottom Hole Location If Different From Surface

UL or lot No.	Section	Township	Range	Lot Idn	Feet from the	North/South line	Feet from the	East/West line	County
Dedicated Acres	Joint or Infill	Consolidation Code	Order No.						
80-E/2, SE/4									

NO ALLOWABLE WILL BE ASSIGNED TO THIS COMPLETION UNTIL ALL INTERESTS HAVE BEEN CONSOLIDATED
 OR A NON-STANDARD UNIT HAS BEEN APPROVED BY THE DIVISION

	OPERATOR CERTIFICATION I hereby certify the the information contained herein is true and complete to the best of my knowledge and belief. Signature R. J. Longmire Printed Name Drilling Superintendent Title 3/5/99 Date
	SURVEYOR CERTIFICATION I hereby certify that the well location shown on this plat was plotted from field notes of actual surveys made by me or under my supervision, and that the same is true and correct to the best of my belief. JUNE 12, 1997 Date Surveyed Signature of Surpl Professional Surveyor W.O. Num. 97-115 0971 Certificate No. RONALD K. EDSON, 3239 GARY G. EDSON, 12841

District I
1625 N. French Dr., Hobbs, NM 88240
Phone: (575) 393-6161 Fax: (575) 393-0720
District II
811 S. First St., Artesia, NM 88210
Phone: (575) 748-1283 Fax: (575) 748-9720
District III
1000 Rio Brazos Road, Aztec, NM 87410
Phone: (505) 334-6178 Fax: (505) 334-6170
District IV
1220 S. St. Francis Dr., Santa Fe, NM 87505
Phone: (505) 476-3460 Fax: (505) 476-3462

State of New Mexico
Energy, Minerals & Natural Resources Department
OIL CONSERVATION DIVISION
1220 South St. Francis Dr.
Santa Fe, NM 87505

Form C-102
Revised August 1, 2011
Submit one copy to appropriate
District Office

☒ AMENDED REPORT

WELL LOCATION AND ACREAGE DEDICATION PLAT

¹ API Number 30-05-30316		² Pool Code 96632		³ Pool Name Illinois Camp Bare Springs East	
⁴ Property Code		⁵ Property Name Pagan State			⁶ Well Number 1
⁷ OGRID No. 192463		⁸ Operator Name OXY USA WTP LP			⁹ Elevation 3520'
¹⁰ Surface Location					
UL or lot no. D	Section 26	Township 18S	Range 28E	Lot Idn	Feet from the 800
				North/South line North	Feet from the 660
				East/West line West	County Eddy
¹¹ Bottom Hole Location If Different From Surface					
UL or lot no.	Section	Township	Range	Lot Idn	Feet from the
					North/South line
					Feet from the
					East/West line
					County
¹² Dedicated Acres 40		¹³ Joint or Infill N		¹⁴ Consolidation Code	
¹⁵ Order No.					

No allowable will be assigned to this completion until all interests have been consolidated or a non-standard unit has been approved by the division.

	¹⁷ OPERATOR CERTIFICATION			
	I hereby certify that the information contained herein is true and complete in the best of my knowledge and belief, and that this organization either owns a working interest or unleased mineral interest in the land including the proposed bottom hole location or has a right to drill this well at this location pursuant to a contract with an owner of such a mineral or working interest, or to a voluntary pooling agreement or a compulsory pooling order heretofore entered by the division.			
	Signature <i>David Stewart</i>		Date 11/9/17	
	Printed Name David Stewart		SR. Reg. Act.	
E-mail Address david_stewart@oxy.com				
¹⁸ SURVEYOR CERTIFICATION				
I hereby certify that the well location shown on this plat was plotted from field notes of actual surveys made by me or under my supervision, and that the same is true and correct to the best of my belief.				
Date of Survey				
Signature and Seal of Professional Surveyor:				
Certificate Number				

DISTRICT I
P.O. Box 1088, Hobbs, NM 88241-1088

DISTRICT II
P.O. Drawer 38, Artesia, NM 88211-0718

DISTRICT III
1000 Rio Blanco Rd., Artesia, NM 87410

DISTRICT IV
P.O. Box 3088, Santa Fe, NM 87504-3088

State of New Mexico
Energy, Minerals and Natural Resources Department

Form C-102
Revised February 16, 1994
Submit to Appropriate District Office
State Lease - 4 Copies
Fee Lease - 3 Copies

OIL CONSERVATION DIVISION

P.O. Box 2088
Santa Fe, New Mexico 87504-2088

☐ AMENDED REPORT

WELL LOCATION AND ACREAGE DEDICATION PLAT

API Number	Pool Code 59860	Pool Name Travis, Upper Pennsylvanian
Property Code 21712	Property Name JANIE'S BUCHANAN "33" STATE	Well Number 2
OGED No. 14021	Operator Name MARATHON OIL COMPANY	Elevation 3537

Surface Location

UL or Lot No.	Section	Township	Range	Lot 1/4	Feet from the	North/South line	Feet from the	East/West line	County
A	33	18 S	28 E		830	NORTH	447	EAST	EDDY

Bottom Hole Location If Different From Surface

UL or Lot No.	Section	Township	Range	Lot 1/4	Feet from the	North/South line	Feet from the	East/West line	County
Dedicated Acres	Joint or Infill	Consolidation Code	Order No.						
80 - N/2 NE/4									

NO ALLOWABLE WILL BE ASSIGNED TO THIS COMPLETION UNTIL ALL INTERESTS HAVE BEEN CONSOLIDATED
OR A NON-STANDARD UNIT HAS BEEN APPROVED BY THE DIVISION

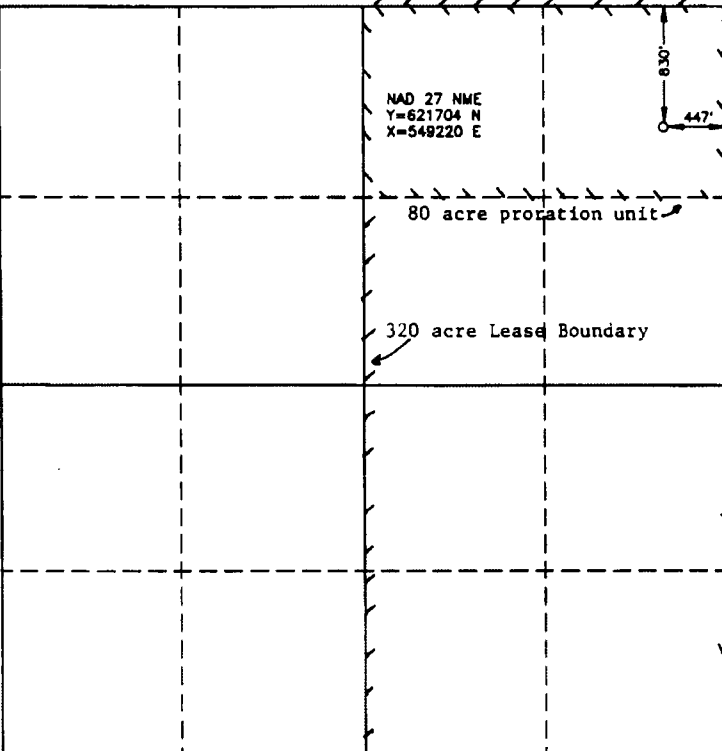
	OPERATOR CERTIFICATION I hereby certify that the information contained herein is true and complete to the best of my knowledge and belief. Signature: <i>D. P. Nordt</i> Printed Name: D. P. Nordt Title: Drilling Superintendent Date: 6/30/98
	SURVEYOR CERTIFICATION I hereby certify that the well location shown on this plat was plotted from field notes of actual surveys made by me or under my supervision, and that the same is true and correct to the best of my belief. JUNE 25, 1998 Data Supplied: JLP Signature & Seal of Professional Surveyor: <i>Harold E. Eidson</i> W.O. Num 98-NE-0959 Certificate No. HAROLD E. EIDSON, 3238 GARY E. EIDSON, 12841 JOHN McDONALD, 12185

DISTRICT I
P.O. Box 1988, Hobbs, NM 88241-1988

DISTRICT II
P.O. Drawer DD, Artesia, NM 88211-0719

DISTRICT III
1000 Rio Hrazon Rd., Aztec, NM 87410

DISTRICT IV
P.O. BOX 2088, SANTA FE, N.M. 87504 2088

State of New Mexico
Energy, Minerals and Natural Resources Department

Form C-102
Revised February 10, 1994
Submit to Appropriate District Office
State Lease - 4 Copies
Fee Lease - 3 Copies

OIL CONSERVATION DIVISION

P.O. Box 2088
Santa Fe, New Mexico 87504-2088

☐ AMENDED REPORT

WELL LOCATION AND ACREAGE DEDICATION PLAT

API Number 30-015-30367	Pool Code 59860	Pool Name Travis - Upper Penn
Property Code 23457	Property Name PAGAN STATE	Well Number 2
OGRID No. 14021	Operator Name MARATHON COMPANY	Elevation 3514

Surface Location

UL or lot No.	Section	Township	Range	Lot Idn	Feet from the	North/South line	Feet from the	East/West line	County
	26	18-S	28-E			North	990	West	Eddy

Bottom Hole Location If Different From Surface

UL or lot No.	Section	Township	Range	Lot Idn	Feet from the	North/South line	Feet from the	East/West line	County
F	26	18-S	28-E		1700	North	2260	West	Eddy
Dedicated Acres 160	Joint or Infill	Consolidation Code	Order No.						

NO ALLOWABLE WILL BE ASSIGNED TO THIS COMPLETION UNTIL ALL INTERESTS HAVE BEEN CONSOLIDATED
OR A NON-STANDARD UNIT HAS BEEN APPROVED BY THE DIVISION

	<p>320 acre lease</p> <p>BHL</p> <p>990'</p> <p>KOP</p> <p>160 acre proration unit</p>	<p>OPERATOR CERTIFICATION</p> <p>I hereby certify the the information contained herein is true and complete to the best of my knowledge and belief</p> <p><i>R. J. Longmire</i> Signature</p> <p>R. J. Longmire Printed Name</p> <p>Drilling Superintendent Title</p> <p>12/11/98 Date</p> <p>SURVEYOR CERTIFICATION</p> <p>I hereby certify that the well location shown on this plat was plotted from field notes of actual surveys made by me or under my supervision, and that the same is true and correct to the best of my belief.</p> <p>Date Surveyed Signature & Seal of Professional Surveyor Professional Surveyor 3239 8-03-98</p> <p>Certificate No. RONALD J. EIDSON 3239 CARY EIDSON 2641 MACON McDONALD 2185</p>
--	--	---

District I
PO Box 1980, Hobbs, NM 88241-1980
District II
811 S. 1st Street, Artesia, NM 88210-2834
District III
1000 Rio Brazos Rd., Aztec, NM 87410
District IV
2040 South Pacheco, Santa Fe, NM 87505

State of New Mexico
Energy, Minerals & Natural Resources Department

OIL CONSERVATION DIVISION
2040 South Pacheco
Santa Fe, NM 87505

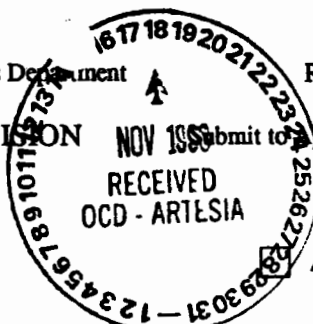

Form C-102
Revised October 18, 1994
Instructions on back
Submit to appropriate District Office
State Lease - 4 Copies
Fee Lease - 3 Copies

AMENDED REPORT

WELL LOCATION AND ACREAGE DEDICATION PLAT

¹ API Number 30-015-30165		² Pool Code 96833		³ Pool Name Travis Wolfcamp	
⁴ Property Code 23145		⁵ Property Name Edward Mitchusson 4 State			⁶ Well Number 1
⁷ OGRID No. 014021		⁸ Operator Name Marathon Oil Company			⁹ Elevation 3549' GL

¹⁰ Surface Location									
UL or lot no. K	Section 4	Township 19S	Range 28E	Lot. Idn	Feet from the 1980'	North/South Line South	Feet from the 1980'	East/West line West	County Eddy

¹¹ Bottom Hole Location If Different From Surface									
UL or lot no.	Section	Township	Range	Lot. Idn	Feet from the	North/South Line	Feet from the	East/West line	County
¹² Dedicated Acres 40									
¹³ Joint or Infill									
¹⁴ Consolidation Code									
¹⁵ Order No.									

NO ALLOWABLE WILL BE ASSIGNED TO THIS COMPLETION UNTIL ALL INTERESTS HAVE BEEN CONSOLIDATED
OR A NON-STANDARD UNIT HAS BEEN APPROVED BY THE DIVISION

				¹⁷ OPERATOR CERTIFICATION I hereby certify that the information contained herein is true and complete to the best of my knowledge and belief.	
				Signature <i>Bryan L. Williams</i> Printed Name Bryan L. Williams Title Production Engineer Date 11/12/98	
				¹⁸ SURVEYOR CERTIFICATION I hereby certify that the well location shown on this plat was plotted from field notes of actual surveys made by me or under my supervision, and that the same is true and correct to the best of my belief.	
				Date of Survey SEE ORIGINAL Signature and Seal of Professional Surveyer: Certificate Number	



**NEW MEXICO ENERGY, MINERALS
& NATURAL RESOURCES DEPARTMENT**

OIL CONSERVATION DIVISION
2040 South Pacheco Street
Santa Fe, New Mexico 87505
(505) 827-7131

**AMENDED COMMINGLING ORDER CTB-467
(3rd Amendment)**

Marathon Oil Company
P.O. Box 2409
Hobbs, New Mexico 88241-2409

Attn: Mr. Bryan L. Williams

The above named company is hereby authorized to commingle Travis Upper Penn (59860) Pool production from the following leases:

Lease:	David Crockett '27' State Lease
Description:	W/2 of Section 27, Township 18 South, and;
Lease:	James Buchanan '33' State Lease
Description:	E/2 of Section 33, Township 18 South, and;
Lease:	Henry Courtman '4' State Lease
Description:	N/2 of Section 4, Township 19 South,
Lease:	Samuel Burns '34' State Lease
Description:	N/2 of Section 34, Township 18 South,
Lease:	W.B. Travis '15' State Lease
Description:	E/2 of Section 15, Township 18 South, and;
Lease:	James Garvin '22' State Lease
Description:	S/2 of Section 22, Township 18 South, and;
Lease:	George Pagan '26' State Lease
Description:	W/2 of Section 26, Township 18 South, and;
Lease:	J. Guerrero '34' State Lease
Description:	S/2 of Section 34, Township 18 South, and;
Lease:	Edward Mitchusson '4' State Lease
Description:	S/2 of Section 4, Township 19 South, and;

all located in Range 28 East, NMPM, Eddy County, New Mexico.

Production shall be allocated to each lease by separately metering the production from each prior to commingling.

NOTE: This installation shall be installed and operated in accordance with the applicable provisions of Rule 303 of the Division Rules and Regulations and the Division "Manual for the Installation and Operation of Commingling Facilities." It is the responsibility of the producer to notify the transporter of this commingling authority.

Amended Division Order CTB-467

Marathon Oil Company

August 3, 1998

Page 2

REMARKS: The commingled production shall be stored in the Buchanan No.1 tank battery facility located in Unit Letter 'I', Section 33, Township 18 South, Range 28 East, NMPM, Eddy County, New Mexico.

FURTHER: The operator shall notify the Artesia district office of the Division prior to implementation of the commingling process.

PROVIDING: Validation of this authority shall be accomplished by like approval from the New Mexico Commissioner of Public Lands.

DONE at Santa Fe, New Mexico, on this 3rd day of August, 1998.

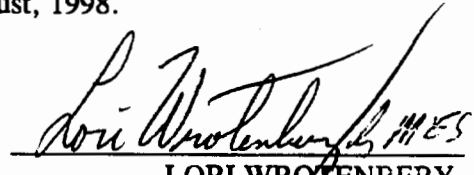
LORI WROTENBERY,
Division Director

LW/MWA/kv

cc: Oil Conservation Division - Artesia
State Land Office - Oil & Gas Division



NEW MEXICO ENERGY, MINERALS
& NATURAL RESOURCES DEPARTMENT

OIL CONSERVATION DIVISION
2040 South Pacheco Street
Santa Fe, New Mexico 87505
(505) 827-7131

October 30, 1998

Marathon Oil Company
P.O. Box 2409
Hobbs, New Mexico 88241-2409

Attention: Mr. Andrew Schwandt

*Edward Mitchusson '4' State No. 1
API No. 30-015-30165
1980 FS and WL
Unit K, Section 4, Township 19 South, Range 28 East, NMPM,
Eddy County, New Mexico.
~~Mitchusson~~ Wolfcamp (96833 - Oil) and
Travis-Upper Penn (59860 - Oil) Pools*

Dear Mr. Schwandt:

Reference is made to your recent request to temporarily surface commingle the Mitchusson-Wolfcamp and Travis-Upper Penn Pool production from Marathon's Edward Mitchusson '4' State No. 1 pending the outcome of the application for an amendment to Order CTB-467. My staff has reviewed your request and the same is hereby approved for a period of 60 days, concluding on December 30, 1998.

Production shall be allocated by separately metering the production from each well prior to commingling.

REMARKS: The commingled production shall be stored in the Buchanan No.1 tank battery facility located in Unit Letter 'I', Section 33, Township 18 South, Range 28 East, NMPM, Eddy County, New Mexico.

Sincerely,

Lori Wrotenbery
Lori Wrotenbery
Director

LW/MWA

cc: Oil Conservation Division -- Artesia

October 29, 1998

Mr. Mark Ashley
State of New Mexico
Oil Conservation Division
P.O. Box 2088
Santa Fe, NM 87504-2088

Re: Verification of verbal approval for exemption to Rule 309-A
Surface Lease Commingling

Edward Mitchusson '4' ST. NO. 1
1980' FSL and 1980' FWL
Section 4, T-19-S, R-28-E
Travis Field
Eddy Co., NM.
Travis - Wolfcamp

Mr. Mark Ashley:

This letter is to verify that Greg Muse of Marathon Oil Co. received verbal approval from you on 10-29-98, for the temporary exemption to Rule 309-A. The temporary exemption is for the surface commingling of the Mitchusson Wolfcamp (96833) with the Travis Upper Penn (59860), which is currently surface comingled per Order No. CTB-467. This is understood to be a temporary approval until further review at the public hearing scheduled on the docket for November 19, 1998. The common battery is at the James Buchanan '33' St. No. 1 location. All produced fluids are metered before being comingled, pursuant to all applicable provisions.

If you have any questions or comments, please advise.

Sincerely,

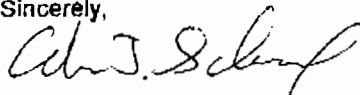

Andrew J. Schwandt
Production Engineer
(505) 393-7106 x216

Post-it® Fax Note	7671	Date	10-29	# of Pages	1
To	Mark Ashley	From	Andy Schwandt		
Co./Dept.	OCD	Co.	Marathon		
Phone #		Phone #	505-393-7106 x216		
Fax #	505-827-1389	Fax #	393-2472		