

| | | | |
|-------------------------------|------------------------|---------------------|----------------------------------|
| RECEIVED: 4/25/2018 | REVIEWER: LR | TYPE: NSL | APP NO: DMAM1811558525 |
|-------------------------------|------------------------|---------------------|----------------------------------|

ABOVE THIS TABLE FOR OCD DIVISION USE ONLY

NEW MEXICO OIL CONSERVATION DIVISION
 - Geological & Engineering Bureau -
 1220 South St. Francis Drive, Santa Fe, NM 87505

**ADMINISTRATIVE APPLICATION CHECKLIST**

THIS CHECKLIST IS MANDATORY FOR ALL ADMINISTRATIVE APPLICATIONS FOR EXCEPTIONS TO DIVISION RULES AND
 REGULATIONS WHICH REQUIRE PROCESSING AT THE DIVISION LEVEL IN SANTA FE

Applicant: Devon Energy Production Company, L.P.**OGRID Number:** 6137**Well Name:** Mean Green 23-35 Fed Com 4H**API:** 30-025-44598**Pool:** WC-025 G-08 S263412K; BONE SPRING**Pool Code:** 96672

**SUBMIT ACCURATE AND COMPLETE INFORMATION REQUIRED TO PROCESS THE TYPE OF APPLICATION
 INDICATED BELOW**

NSL-7702**1) TYPE OF APPLICATION:** Check those which apply for [A]

A. Location - Spacing Unit - Simultaneous Dedication

☒ NSL☐ NSP (PROJECT AREA)☐ NSP (PRORATION UNIT)☐ SD

B. Check one only for [I] or [II]

[I] Commingling - Storage - Measurement

☐ DHC☐ CTB☐ PLC☐ PC☐ OLS☐ OLM

[II] Injection - Disposal - Pressure Increase - Enhanced Oil Recovery

☐ WFX☐ PMX☐ SWD☐ IPI☐ EOR☐ PPR**2) NOTIFICATION REQUIRED TO:** Check those which apply.A. ☐ Offset operators or lease holdersB. ☐ Royalty, overriding royalty owners, revenue ownersC. ☐ Application requires published noticeD. ☐ Notification and/or concurrent approval by SLOE. ☐ Notification and/or concurrent approval by BLMF. ☐ Surface ownerG. ☐ For all of the above, proof of notification or publication is attached, and/or,H. ☒ No notice required**FOR OCD ONLY**☐

Notice Complete

☐Application
Content
Complete

3) CERTIFICATION: I hereby certify that the information submitted with this application for administrative approval is **accurate** and **complete** to the best of my knowledge. I also understand that **no action** will be taken on this application until the required information and notifications are submitted to the Division.

Note: Statement must be completed by an individual with managerial and/or supervisory capacity.

Jeff Ramsdell

Print or Type Name

Signature

Date

4/24/2018

405-552-8099

Phone Number

Jeff.Ramsdell@dmn.com

e-mail Address



Devon Energy Production Company, L.P.
333 West Sheridan Avenue
Oklahoma City, OK 73102

405 235 3611 Phone
www.devonenergy.com

April 24, 2018

VIA FED EX OVERNIGHT MAIL

New Mexico Oil Conservation Division
Attn: Mr. Leonard Lowe
1220 South St. Francis Drive
Santa Fe, NM 87505

**Re: Application for a Non-Standard Location
Mean Green 23-35 Fed Com 4H
E/2SE/4 Section 23; E/2E/2 Section 26; Lot 1 & NE/4 Section 35
T26S-R34E
Lea County, New Mexico**

Dear Mr. Lowe,

Devon Energy Production Company, L.P. ("Devon") respectfully requests administrative approval of an unorthodox well location for the Mean Green 23-35 Fed Com 4H to be completed in the WC-025 G-08 S263412K; BONE SPRING Pool (96672), API Number 30-025-44598. As shown on the enclosed C-102, the permitted surface location is 2,449' FSL and 920' FEL of Section 23-T26S-R34E, with a permitted bottom hole location 200' FSL and 1,133' FEL of Section 35-T26S-R34E. The projected FTP (first take point) is expected to be approximately 2,310' FSL and 1,133' FEL of Section 23-T26S-R34E, and projected LTP (last take point) is expected to be approximately 330' FSL and 1,133' FEL of Section 35-T26S-R34E. The completed interval for this well will be unorthodox because it is closer than 330 feet to the northwestern, western and southwestern boundaries of the project area. The reason for permitting this well at an unorthodox location is to maximize recovery by using Devon's preferred well spacing for horizontal wells.

Please be advised the parties named on "list of affected parties" own 100% of the leasehold in Sections 23, 26 and 35-26S-34E; therefore, notice is not required. All parties listed have been sent a courtesy copy of this application. In addition, notification is not required to the offsetting operator/leaseholder to the southwest (Tract 4) due to the acreage being located in Texas.

Enclosed for your review are the following:

- Form C-102 for the Mean Green 23-35 Fed Com 4H
- Land plat showing the project area for the Mean Green 23-35 Fed Com 4H lateral
- List of affected parties
- Administrative Application Checklist

If you have any questions concerning this application, please do not hesitate to contact me at (405) 228-8756 or email me at Melissa.Miller@devon.com.

Very truly yours,

Devon Energy Production Company, L.P.

Melissa Miller
Senior Landman

DISTRICT I
1625 N. FRENCH DR., HOBBS, NM 88240
Phone: (575) 393-6161 Fax: (575) 393-0720

DISTRICT II
811 S. FIRST ST., ARTESIA, NM 88210
Phone: (575) 748-1283 Fax: (575) 748-0720

DISTRICT III
1000 RIO BRAZOS RD., AZTEC, NM 87410
Phone: (505) 334-6178 Fax: (505) 334-6170

DISTRICT IV
1220 S. ST. FRANCIS DR., SANTA FE, NM 87505
Phone: (505) 478-3460 Fax: (505) 478-3482

State of New Mexico
Energy, Minerals & Natural Resources Department
OIL CONSERVATION DIVISION
1220 SOUTH ST. FRANCIS DR.
Santa Fe, New Mexico 87505

Form C-102
Revised August 1, 2011
Submit one copy to appropriate
District Office

☐ AMENDED REPORT

WELL LOCATION AND ACREAGE DEDICATION PLAT

| | | |
|-------------------|---|----------------------|
| API Number | Pool Code | Pool Name |
| Property Code | Property Name MEAN GREEN 23-35 FED COM | Well Number 4H |
| OGRID No. 6137 | Operator Name DEVON ENERGY PRODUCTION COMPANY, L.P. | Elevation 3194.1' |

Surface Location

| UL or lot No. | Section | Township | Range | Lot Idn | Feet from the | North/South line | Feet from the | East/West line | County |
|---------------|---------|----------|-------|---------|---------------|------------------|---------------|----------------|--------|
| I | 23 | 26-S | 34-E | | 2449 | SOUTH | 920 | EAST | LEA |

Bottom Hole Location If Different From Surface

| UL or lot No. | Section | Township | Range | Lot Idn | Feet from the | North/South line | Feet from the | East/West line | County |
|---------------|---------|----------|-------|---------|---------------|------------------|---------------|----------------|--------|
| H | 35 | 26-S | 34-E | | 200 | SOUTH | 1026 | EAST | LEA |

| Dedicated Acres | Joint or Infill | Consolidation Code | Order No. |
|-----------------|-----------------|--------------------|-----------|
| | | | |

NO ALLOWABLE WILL BE ASSIGNED TO THIS COMPLETION UNTIL ALL INTERESTS HAVE BEEN CONSOLIDATED
OR A NON-STANDARD UNIT HAS BEEN APPROVED BY THE DIVISION

Note: All bearings recited herein are based on the New Mexico State Plane Coordinate System, NAD 83, New Mexico East Zone 3001, US Survey Feet, all distances are grid.

OPERATOR CERTIFICATION

I hereby certify that the information herein is true and complete to the best of my knowledge and belief, and that this organization either owns a working interest or unleased mineral interest in the land including the proposed bottom hole location or has a right to drill this well at this location pursuant to a contract with an owner of such mineral or working interest, or to a voluntary pooling agreement or a compulsory pooling order heretofore entered by the division.

Signature _____ Date _____

Printed Name _____

E-mail Address _____

SURVEYOR CERTIFICATION

I hereby certify that the well location shown on this plat was plotted from field notes of actual surveys made by me or under my supervision, and that the same is true and correct to the best of my belief.

Signature & Seal of Professional Surveyor

06/05/17

Certificate No. 22404 B.L. LAMAN
W.C. # _____ DRAWN BY: CM

MEAN GREEN 23-35 FED COM 4H UNORTHODOX LOCATION NOTICE TRACT PLAT

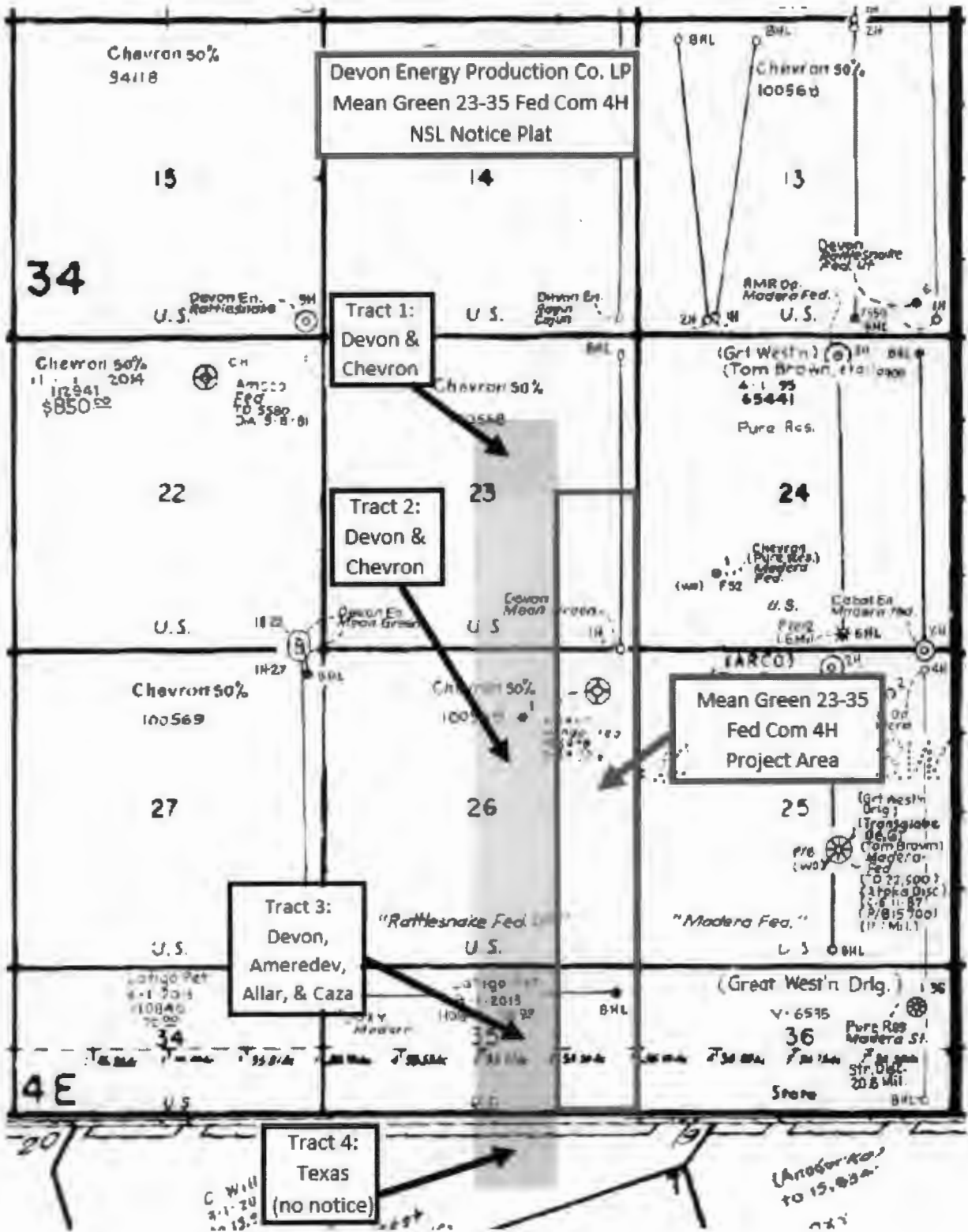



Devon Energy Production Company, L.P.
333 West Sheridan Avenue
Oklahoma City, OK 73102

405 228 8756 Phone
www.devonenergy.com

April 24, 2018

VIA FED EX OVERNIGHT MAIL

New Mexico Oil Conservation Division
1220 South St. Francis Drive
Santa Fe, NM 87505
Attn: Mr. Leonard Lowe

Re: Application for a Non-Standard Location
Mean Green 23-35 Fed Com 4H
E/2SE/4 Section 23; E/2E/2 Section 26; Lot 1 & NE/4 Section 35
T26S-R34E
Lea County, New Mexico

Mr. Lowe:

Devon Energy Production Company, L.P. ("Devon") respectfully requests administrative approval of an unorthodox well location for the Mean Green 23-35 Fed Com 4H well to be completed in the WC-025 G-08 S263412K; BONE SPRING Pool (96672) .

Devon desires to develop Sections 23, 26, and 35-T26S-R34E in a manner which will protect correlative rights and prevent waste. Devon's objective is to prudently produce reserves in such a manner that may not otherwise be recovered. The non-standard location allows Devon to optimize well spacing for horizontal development thereby minimizing the risk of leaving reserves behind.

If anything further is needed contact me at (405) 228-4413 or Chris.Cope@dvn.com.

Sincerely,

DEVON ENERGY PRODUCTION COMPANY, L.P.

A handwritten signature in black ink, appearing to read "Chris Cope". The signature is fluid and cursive, with the first and last names being more prominent.

Chris Cope
Reservoir Engineer

List of Affected Parties
MEAN GREEN 23-35 FED COM 4H

| Affected Offset Operators | Certified Mail Tracking # | Date Sent |
|--|-----------------------------|-----------|
| <u>Tract 1 and 2</u> Operator: Devon | | |
| cc: Chevron U.S.A. Inc. Attn: Kristen Hunter 1400 Smith Street Houston, TX 77002 | 9414 8149 0152 7181 4616 11 | 4/24/2018 |
| <u>Tract 3</u> Operator: Devon | | |
| cc: The Allar Company Attn: Jack Graham P.O. Box 1567 Graham, TX 76450 | 9414 8149 0152 7181 4616 28 | 4/24/2018 |
| Ameredev New Mexico, LLC Attn: Brandon Forteza 5707 Southwest Parkway Building 1, Suite 275 Austin, TX 78735 | 9414 8149 0152 7181 4616 73 | 4/24/2018 |
| Caza Petroleum, LLC Attn: Jay Brown 16945 Northchase Drive Suite 1430 Houston, Texas 77060 | 9414 8149 0152 7181 4617 03 | 4/24/2018 |

Tract 4: Section 25, Blk C24, A-701, Texas (notice not required)



Devon Energy Production Company LP
333 West Sheridan Avenue
Oklahoma City, OK 73102

405 235 3611 Phone
www.devonenergy.com

April 24, 2018

The Allar Company
Attn: Jack Graham
P.O. Box 1567
Graham, TX 76450

RE: Non-Standard Location Application
Lea County, NM

Dear Mr. Graham:

As a courtesy, Devon Energy Production Company, L.P. ("Devon") is providing notification of our submittal of an unorthodox well location application for the following two wells:

Mean Green 23-35 Fed Com 1H
E/2SE/4 Section 23; E/2E/2 Section 26; Lot 1 & NE/4 Section 35
T26S-R34E
Lea County, New Mexico

Mean Green 23-35 Fed Com 4H
E/2SE/4 Section 23; E/2E/2 Section 26; Lot 1 & NE/4 Section 35
T26S-R34E
Lea County, New Mexico

Enclosed is a copy of Devon's application packet to the New Mexico Oil Conservation Division. Should you have any questions, please contact me at (405) 228-8756 or email me at Melissa.Miller@dvn.com.

Sincerely,

Devon Energy Production Company, L.P.

A handwritten signature in cursive script that reads "Melissa Miller".

Melissa Miller
Senior Landman



Devon Energy Production Company LP
333 West Sheridan Avenue
Oklahoma City, OK 73102

405 235 3611 Phone
www.devonenergy.com

April 24, 2018

Ameredev New Mexico, LLC
Attn: Brandon Forteza
5707 Southwest Parkway
Building 1, Suite 275
Austin, TX 78735

RE: Non-Standard Location Application
Lea County, NM

Dear Mr. Forteza:

As a courtesy, Devon Energy Production Company, L.P. ("Devon") is providing notification of our submittal of an unorthodox well location application for the following two wells:

Mean Green 23-35 Fed Com 1H
E/2SE/4 Section 23; E/2E/2 Section 26; Lot 1 & NE/4 Section 35
T26S-R34E
Lea County, New Mexico

Mean Green 23-35 Fed Com 4H
E/2SE/4 Section 23; E/2E/2 Section 26; Lot 1 & NE/4 Section 35
T26S-R34E
Lea County, New Mexico

Enclosed is a copy of Devon's application packet to the New Mexico Oil Conservation Division. Should you have any questions, please contact me at (405) 228-8756 or email me at Melissa.Miller@dvn.com.

Sincerely,

Devon Energy Production Company, L.P.

A handwritten signature in cursive script that reads "Melissa Miller".

Melissa Miller
Senior Landman



Devon Energy Production Company LP
333 West Sheridan Avenue
Oklahoma City, OK 73102

405 235 3611 Phone
www.devonenergy.com

April 24, 2018

Caza Petroleum, LLC
Attn: Jay Brown
16945 Northchase Drive
Suite 1430
Houston, Texas 77060

RE: Non-Standard Location Application
Lea County, NM

Dear Mr. Brown:

As a courtesy, Devon Energy Production Company, L.P. ("Devon") is providing notification of our submittal of an unorthodox well location application for the following two wells:

Mean Green 23-35 Fed Com 1H
E/2SE/4 Section 23; E/2E/2 Section 26; Lot 1 & NE/4 Section 35
T26S-R34E
Lea County, New Mexico

Mean Green 23-35 Fed Com 4H
E/2SE/4 Section 23; E/2E/2 Section 26; Lot 1 & NE/4 Section 35
T26S-R34E
Lea County, New Mexico

Enclosed is a copy of Devon's application packet to the New Mexico Oil Conservation Division. Should you have any questions, please contact me at (405) 228-8756 or email me at Melissa.Miller@dvn.com.

Sincerely,

Devon Energy Production Company, L.P.

A handwritten signature in cursive script that reads "Melissa Miller".

Melissa Miller
Senior Landman



Devon Energy Production Company LP
333 West Sheridan Avenue
Oklahoma City, OK 73102

405 235 3611 Phone
www.devonenergy.com

April 24, 2018

Emailed: kristen.hunter@chevron.com

Chevron U.S.A. Inc.
Attn: Kristen Hunter
1400 Smith Street
Houston, Texas 77002

RE: Non-Standard Location Application
Lea County, NM

Dear Ms. Hunter:

As a courtesy, Devon Energy Production Company, L.P. ("Devon") is providing notification of our submittal of an unorthodox well location application for the following two wells:

Mean Green 23-35 Fed Com 1H
E/2SE/4 Section 23; E/2E/2 Section 26; Lot 1 & NE/4 Section 35
T26S-R34E
Lea County, New Mexico

Mean Green 23-35 Fed Com 4H
E/2SE/4 Section 23; E/2E/2 Section 26; Lot 1 & NE/4 Section 35
T26S-R34E
Lea County, New Mexico

Enclosed is a copy of Devon's application packet to the New Mexico Oil Conservation Division. Should you have any questions, please contact me at (405) 228-8756 or email me at Melissa.Miller@dvn.com.

Sincerely,

Devon Energy Production Company, L.P.

A handwritten signature in black ink that reads "Melissa Miller". The signature is written in a cursive, flowing style.

Melissa Miller
Senior Landman

McMillan, Michael, EMNRD

From: Miller, Melissa <Melissa.Miller@dvn.com>
Sent: Tuesday, May 1, 2018 6:23 AM
To: McMillan, Michael, EMNRD
Subject: RE: [EXTERNAL] Mean Green 23 35 Fed Com Well No. 1H

Good Morning,

Ownership in the 4H project area is identical to ownership in the offsetting affected tracts.

Thank you!

From: McMillan, Michael, EMNRD [mailto:Michael.McMillan@state.nm.us]
Sent: Monday, April 30, 2018 4:41 PM
To: Miller, Melissa <Melissa.Miller@dvn.com>
Subject: RE: [EXTERNAL] Mean Green 23 35 Fed Com Well No. 1H

How about the NSL application for the 4H?
Mike

From: Miller, Melissa <Melissa.Miller@dvn.com>
Sent: Monday, April 30, 2018 7:29 AM
To: McMillan, Michael, EMNRD <Michael.McMillan@state.nm.us>
Subject: RE: [EXTERNAL] Mean Green 23 35 Fed Com Well No. 1H

Good Morning Mike,

Ownership in the project area is identical to ownership in the offsetting affected tracts. I apologize for not including that information in the cover letter.

Please let me know if you need any additional information!

Thanks!

From: McMillan, Michael, EMNRD [mailto:Michael.McMillan@state.nm.us]
Sent: Friday, April 27, 2018 4:37 PM
To: Miller, Melissa <Melissa.Miller@dvn.com>
Subject: [EXTERNAL] Mean Green 23 35 Fed Com Well No. 1H

Melissa:

I am working on the NSL application for the Mean Green 23 35 Fed Com Well No. 1H in Lea County. I need clarification on your letter-you state that all of the affected parties have working interest in the three sections of the project area; however, you did not state that ownership is identical in the project area and affected tracts. If the ownership is not identical, then Devon will have to wait 20 days before approval.

Thank You

Devon Energy Prod. Co. L.P. WELL: Mean Green 23-35 Fed Com. No. 4 H NSL-_____

API: 025- 44598

POOL: Wildcat; B.S. [96672]

S.L.: 2449' FSL & 920' FEL "I" SEC 23

P₁: 2310' FSL & 1133' FEL SEC 23

P₂: 330' FSL & 1133' FEL SEC 35

B.L.: 200' FSL & 1133' FEL SEC 35

| | | | |
|--|--|--|--|
| D (D) Federal ¹ Federal ² (25) 40 | C (C) Federal ¹ Federal ² (25) 40 | B (B) Federal ¹ Federal ² (25) 40 | A (A) Federal ¹ Federal ² (25) 40 |
|--|--|--|--|

| | | | |
|--|--|--|--|
| E (E) Federal ¹ Federal ² (25) 40 | F (F) Federal ¹ Federal ² (25) 40 | G (G) Federal ¹ Federal ² (25) 40 | H (H) Federal ¹ Federal ² (25) 40 |
|--|--|--|--|

| | | | |
|--|--|--|--|
| L (L) Federal ¹ Federal ² (25) 40 | K (K) Federal ¹ Federal ² (25) 40 | J (J) Federal ¹ Federal ² (25) 40 | I (I) Federal ¹ Federal ² (25) 40 |
|--|--|--|--|

| | | | |
|--|--|--|--|
| M (M) Federal ¹ Federal ² (25) 40 | N (N) Federal ¹ Federal ² (25) 40 | O (O) Federal ¹ Federal ² (25) 40 | P (P) Federal ¹ Federal ² (25) 40 |
|--|--|--|--|

Section : 23-26S-34E

| | | | |
|--|--|--|--|
| D (D) Federal ¹ Federal ² (25) 40 | C (C) Federal ¹ Federal ² (25) 40 | B (B) Federal ¹ Federal ² (25) 40 | A (A) Federal ¹ Federal ² (25) 40 |
|--|--|--|--|

| | | | |
|--|--|--|--|
| E (E) Federal ¹ Federal ² (25) 40 | F (F) Federal ¹ Federal ² (25) 40 | G (G) Federal ¹ Federal ² (25) 40 | H (H) Federal ¹ Federal ² (25) 40 |
|--|--|--|--|

| | | | |
|--|--|--|--|
| L (L) Federal ¹ Federal ² (25) 40 | K (K) Federal ¹ Federal ² (25) 40 | J (J) Federal ¹ Federal ² (25) 40 | I (I) Federal ¹ Federal ² (25) 40 |
|--|--|--|--|

| | | | |
|--|--|--|--|
| M (M) Federal ¹ Federal ² (25) 40 | N (N) Federal ¹ Federal ² (25) 40 | O (O) Federal ¹ Federal ² (25) 40 | P (P) Federal ¹ Federal ² (25) 40 |
|--|--|--|--|

Section : 26-26S-34E

| | | | |
|--|--|--|--|
| D (D) Federal ¹ Federal ² (25) 40 | C (C) Federal ¹ Federal ² (25) 40 | B (B) Federal ¹ Federal ² (25) 40 | A (A) Federal ¹ Federal ² (25) 40 |
|--|--|--|--|

| | | | |
|--|---|---|--|
| E (4) Federal ¹ Federal ² (25) 35.7 | F (3) Federal ¹ Federal ² (25) 35.53 | G (2) Federal ¹ Federal ² (25) 35.37 | H (1) Federal ¹ Federal ² (25) 35.2 |
|--|---|---|--|

Section : 35-26S-34E

