

ABOVE THIS LINE FOR DIVISION USE ONLY

NEW MEXICO OIL CONSERVATION DIVISION
 - Engineering Bureau -
 1220 South St. Francis Drive, Santa Fe, NM 87505



ADMINISTRATIVE APPLICATION CHECKLIST

THIS CHECKLIST IS MANDATORY FOR ALL ADMINISTRATIVE APPLICATIONS FOR EXCEPTIONS TO DIVISION RULES AND REGULATIONS WHICH REQUIRE PROCESSING AT THE DIVISION LEVEL IN SANTA FE

Application Acronyms:

- [NSL-Non-Standard Location] [NSP-Non-Standard Proration Unit] [SD-Simultaneous Dedication]
 [DHC-Downhole Commingling] [CTB-Lease Commingling] [PLC-Pool/Lease Commingling]
 [PC-Pool Commingling] [OLS - Off-Lease Storage] [OLM-Off-Lease Measurement]
 [WFX-Waterflood Expansion] [PMX-Pressure Maintenance Expansion]
 [SWD-Salt Water Disposal] [IPI-Injection Pressure Increase]
 [EOR-Qualified Enhanced Oil Recovery Certification] [PPR-Positive Production Response]

- [1] **TYPE OF APPLICATION** - Check Those Which Apply for [A]
- [A] Location - Spacing Unit - Simultaneous Dedication
 NSL NSP SD
- Check One Only for [B] or [C]
- [B] Commingling - Storage - Measurement
 DHC CTB PLC PC OLS OLM
- [C] Injection - Disposal - Pressure Increase - Enhanced Oil Recovery
 WFX PMX SWD IPI EOR PPR
- [D] Other: Specify _____
- [2] **NOTIFICATION REQUIRED TO:** - Check Those Which Apply, or Does Not Apply
- [A] Working, Royalty or Overriding Royalty Interest Owners
- [B] Offset Operators, Leaseholders or Surface Owner
- [C] Application is One Which Requires Published Legal Notice
- [D] Notification and/or Concurrent Approval by BLM or SLO
U.S. Bureau of Land Management - Commissioner of Public Lands, State Land Office
- [E] For all of the above, Proof of Notification or Publication is Attached, and/or,
- [F] Waivers are Attached
- [3] **SUBMIT ACCURATE AND COMPLETE INFORMATION REQUIRED TO PROCESS THE TYPE OF APPLICATION INDICATED ABOVE.**

SWD
 - Solaris Water
 Midstream, LLC
 371643
 Well
 - Current PLY
 State SWD #1
 30-015 ~~partly~~
 44626
 POU
 - SWD's Devonian-
 Silurian
 97869

Note: Statement must be completed by an individual with managerial and/or supervisory capacity.

Ben Stone

 Print or Type Name

 Signature

Agent for Solaris Water Midstream, LLC 1/11/18

 Title
 ben@sosconsulting.us

 e-mail Address



January 10, 2018

New Mexico Oil Conservation Division
1220 South St. Francis Drive
Santa Fe, New Mexico 87505

Attn: Acting Director

Re: Application of Solaris Water Midstream, LLC to permit for salt water disposal in the proposed Corral Fly State SWD Well No.1, to be located in Section 6, Township 25 South, Range 30 East, NMPM, Eddy County, New Mexico.

Dear Sir or Madam,

Please find enclosed form C-108 Application for Authority to Inject, supporting the above-referenced request to permit for disposal, the Corral Fly SWD No.1. Solaris recently permitted this proposed SWD at a location approximately one mile west of this new proposal. New communications with potential clients and other stakeholders determined the well and facility would be better positioned at this new location.

Solaris Water Midstream seeks to optimize efficiency, both economically and operationally, of its operations and to offer additional disposal options for operators in southeast New Mexico. Approval of this application is consistent with that goal as well as the NMOCD's mission of preventing waste and protection of correlative rights.

Published legal notice will run on January 11, 2018 in the Artesia Daily Press and all offset operators and other interested parties have been notified individually. The legal notice affidavit will be forwarded when received. This application also includes revisions of a wellbore schematic, area of review maps, leaseholder plats and other required information for a complete Form C-108. The well is located on state land and minerals; a copy of this application has been submitted to the State Land Office, Oil and Gas Division.

I respectfully request that the approval of this salt water disposal well proceed swiftly and if you or your staff requires additional information or has any questions, please do not hesitate to call or email me.

Best regards,

A handwritten signature in black ink, appearing to read 'Ben Stone', is written over a white background.

Ben Stone, Partner
SOS Consulting, LLC
Agent for Solaris Water Midstream, LLC

Cc: Application attachment and file

APPLICATION FOR AUTHORIZATION TO INJECT

- I. PURPOSE: **Salt Water Disposal** and the application **QUALIFIES** for administrative approval.
- II. OPERATOR: **Solaris Water Midstream, LLC**
ADDRESS: **701 Tradewinds Blvd., Suite C, Midland, TX 79706**

CONTACT PARTY: **Agent: SOS Consulting, LLC – Ben Stone (903) 488-9850**
- III. WELL DATA: **All well data and applicable wellbore diagrams are ATTACHED.**
- IV. **This is not an expansion of an existing project.**
- V. **A map is attached** that identifies all wells and leases within two miles of any proposed injection well with a one-half mile radius circle drawn around each proposed injection well. This circle identifies the well's area of review.
- *VI. A tabulation is attached of data on all wells of public record within the area of review which penetrate the proposed injection zone. **There are NO (0) Wells in the subject AOR which Penetrate the proposed Devonian interval.** The data includes a description of each well's type, construction, date drilled, location, depth, and a schematic of any plugged well illustrating all plugging detail. **NO P&A Wells penetrate.**
- VII. **The following data is ATTACHED** on the proposed operation, including:
1. Proposed average and maximum daily rate and volume of fluids to be injected;
 2. Whether the system is open or closed;
 3. Proposed average and maximum injection pressure;
 4. Sources and an appropriate analysis of injection fluid and compatibility with the receiving formation if other than reinjected produced water; and,
 5. If injection is for disposal purposes into a zone not productive of oil or gas at or within one mile of the proposed well, attach a chemical analysis of the disposal zone formation water (may be measured or inferred from existing literature, studies, nearby wells, etc.).
- *VIII. **Appropriate geologic data on the injection zone is ATTACHED** including appropriate lithologic detail, geologic name, thickness, and depth. Give the geologic name, and depth to bottom of all underground sources of drinking water (aquifers containing waters with total dissolved solids concentrations of 10,000 mg/l or less) overlying the proposed injection zone as well as any such sources known to be immediately underlying the injection interval.
- IX. **Stimulation program – a conventional acid job may be performed to clean and open the formation.**
- *X. Attach appropriate logging and test data on the well. (If well logs have been filed with the Division, they need not be resubmitted). **Well Logs will be filed with OCD.**
- *XI. **There is 1 (one) water well POD within one mile of the proposed salt water disposal well. Records show it is P&Ad.**
- XII. **An affirmative statement is ATTACHED that available geologic and engineering data has been examined and no evidence was found** of open faults or any other hydrologic connection between the disposal zone and any underground sources of drinking water.
- XIII. **"Proof of Notice" section on the next page of this form has been completed and ATTACHED. There are 9 offset lessees and/or operators within ½ mile and State minerals - all have been noticed. Well location is State.**
- XIV. Certification: I hereby certify that the information submitted with this application is true and correct to the best of my knowledge and belief.

NAME: **Ben Stone** TITLE: **SOS Consulting, LLC agent for Solaris Water Midstream, LLC**

SIGNATURE:  DATE: **1/10/2018**

E-MAIL ADDRESS: **ben@sosconsulting.us**

- * If the information required under Sections VI, VIII, X, and XI above has been previously submitted, it need not be resubmitted. Please show the date and circumstances of the earlier submittal:

DISTRIBUTION: Original and one copy to Santa Fe with one copy to the appropriate District Office

FORM C-108 – APPLICATION FOR AUTHORIZATION TO INJECT (cont.)

III. WELL DATA – *The following information and data is included (See ATTACHED Wellbore Schematic):*

A. The following well data must be submitted for each injection well covered by this application. The data must be both in tabular and schematic form and shall include:

- (1) Lease name; Well No., Location by Section, Township and Range; and footage location within the section.
- (2) Each casing string used with its size, setting depth, sacks of cement used, hole size, top of cement, and how such top was determined.
- (3) A description of the tubing to be used including its size, lining material, and setting depth.
- (4) The name, model, and setting depth of the packer used or a description of any other seal system or assembly used.

Division District Offices have supplies of Well Data Sheets which may be used or which may be used as models for this purpose. Applicants for several identical wells may submit a "typical data sheet" rather than submitting the data for each well.

B. The following must be submitted for each injection well covered by this application. All items must be addressed for the initial well. Responses for additional wells need be shown only when different. Information shown on schematics need not be repeated.

- (1) The name of the injection formation and, if applicable, the field or pool name.
- (2) The injection interval and whether it is perforated or open-hole.
- (3) State if the well was drilled for injection or, if not, the original purpose of the well.
- (4) Give the depths of any other perforated intervals and detail on the sacks of cement or bridge plugs used to seal off such perforations.
- (5) Give the depth to and the name of the next higher and next lower oil or gas zone in the area of the well, if any.

XIV. PROOF OF NOTICE *pursuant to the following criteria is ATTACHED.*

All applicants must furnish proof that a copy of the application has been furnished, by certified or registered mail, to the owner of the surface of the land on which the well is to be located and to each leasehold operator within one-half mile of the well location.

Where an application is subject to administrative approval, a proof of publication must be submitted. Such proof shall consist of a copy of the legal advertisement which was published in the county in which the well is located. The contents of such advertisement must include:

- (1) The name, address, phone number, and contact party for the applicant;
- (2) The intended purpose of the injection well; with the exact location of single wells or the Section, Township, and Range location of multiple wells;
- (3) The formation name and depth with expected maximum injection rates and pressures; and,
- (4) A notation that interested parties must file objections or requests for hearing with the Oil Conservation Division, 1220 South St. Francis Dr., Santa Fe, New Mexico 87505, within 15 days.

NO ACTION WILL BE TAKEN ON THE APPLICATION UNTIL PROPER PROOF OF NOTICE HAS BEEN SUBMITTED.

NOTICE: Surface owners or offset operators must file any objections or requests for hearing of administrative applications within 15 days from the date this application was mailed to them.



WELL SCHEMATIC - PROPOSED

Corral Fly SWD Well No.1

API 30-015-xxxxx
 760° FSL & 215° FWL, SEC. 6-T25S-R30E
 EDDY COUNTY, NEW MEXICO

SWD; Devonian-Silurian (97869)
 Spud Date: 3/01/2018
 SWD Config Dt: 4/01/2018

Annulus Monitored
 or open to atmosphere

Injection Pressure Regulated and Volumes Reported
 3100 psi Max. Surface (0.2 psi per foot)

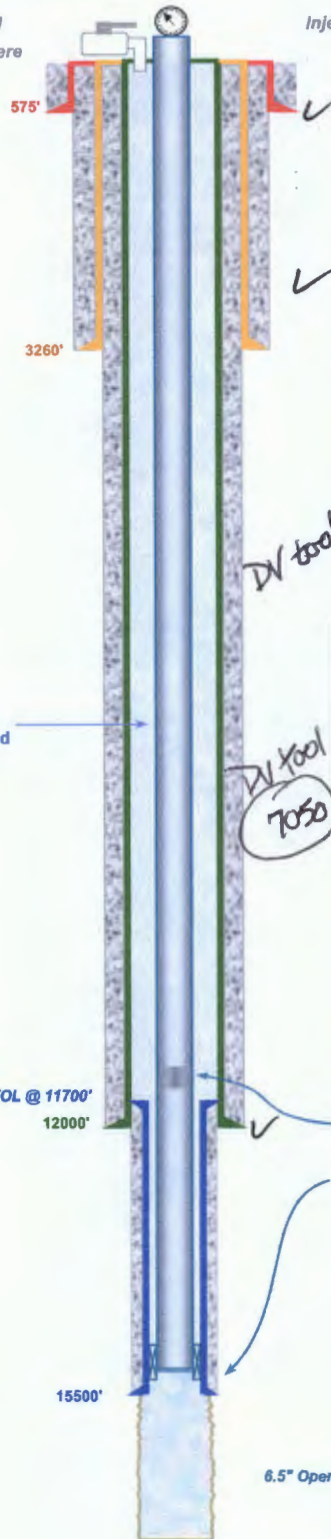
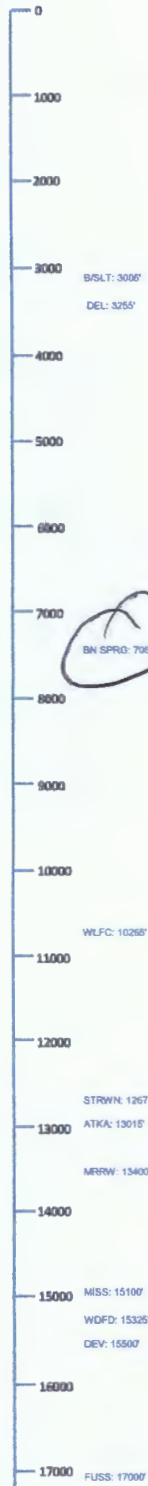

Surface Casing

20.0", 94.0# K-55 Csg. (26.0" Hole) @ 575'
 900 sx - Circulated to Surface

Intermediate Casing

13.375", 68.0# Csg. (17.5" Hole) @ 3260'
 1300 sx - Circulated to Surface

Solaris Water Midstream, LLC

Drill and set casing as designed w/ all strings cemented to surface.
 Install 7.625" liner @ ~15,550 w/ 300 sx to TOL.
 Drill 6.5" openhole to approx. 16,700' TD w/ mudlog for interval/
 formation verification. Acidize formation;
 run 5.5" (5.0" FJ inside liner) injection TBG on PKR set at 15,400'.+
 Conduct OCD witnessed MIT.
 Well ready for injection upon completion of surface facilities.

2nd Intermediate Casing

9.625", 53.5# P-110 Csg. (12.25" Hole) @ 12,000'
 2300 sx - Staged; Circulate to Surface
 (DV @ 3310' / 7050')

Split String Tubing Transition ~11,640'

5.5" to liner w/ 5.0" Flush Joint inside liner
 IPC Tubing set in PKR ~15,400'
 (Within 100' of Uppermost Disposal Interval)

Prod/LNR Casing

7.625", 39.0# P-110 Csg (8.5" Hole) 11,900' to 16,700'
 450 sxs CIs H - TOC @ Top of LNR

6.5" Openhole Interval: 15,500' to 17,200'



Drawn by: Ben Stone, 1/08/2018

Corral Fly State SWD No.1 - Area of Review / 2 Miles

(Attachment to NMOCD Form C-108 - Item V)

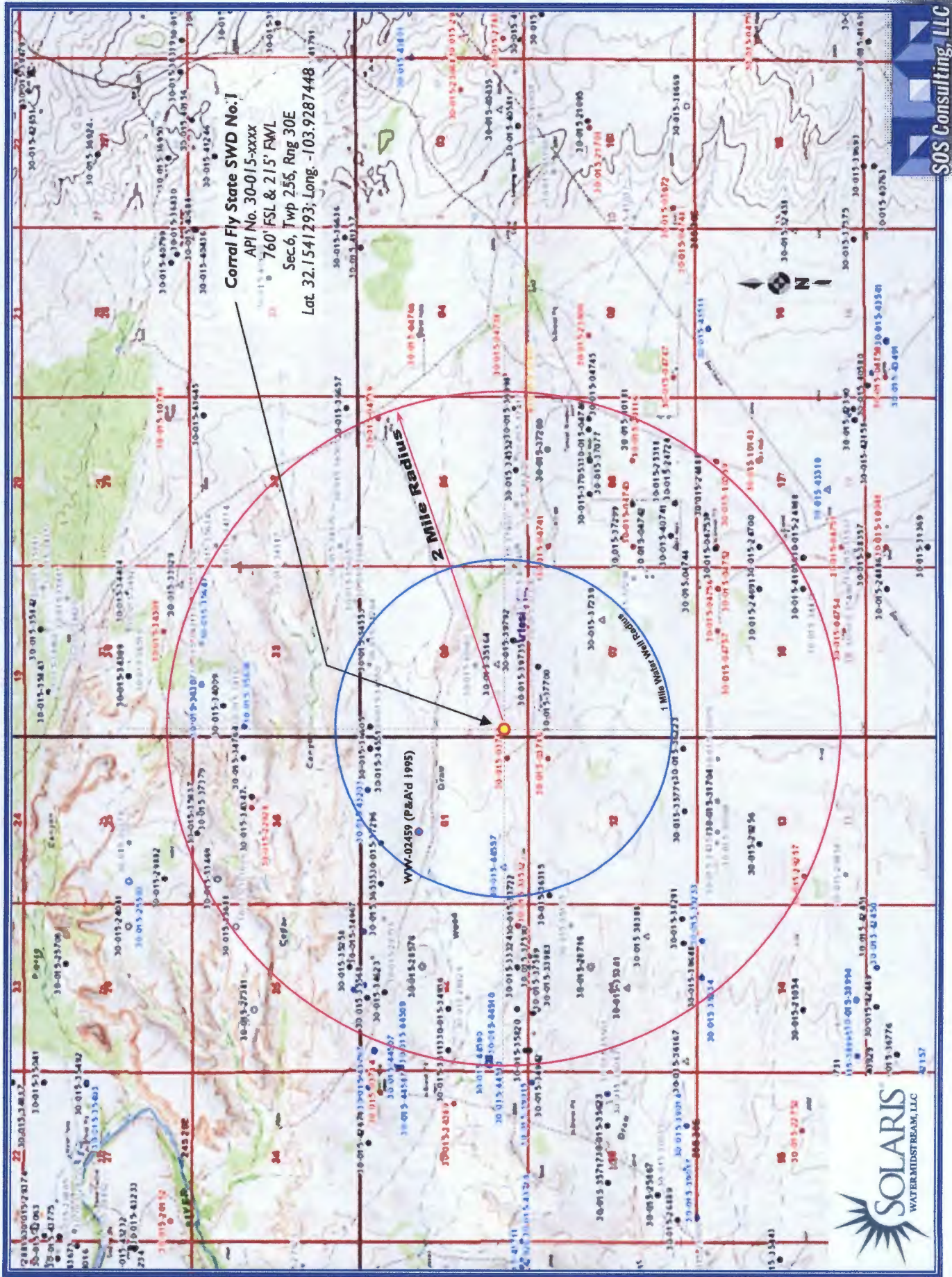

Corral Fly State SWD Well No.1 - Area of Review / Overview Map

(Attachment to NMOCD Form C-108, Application for Authority to Inject.)

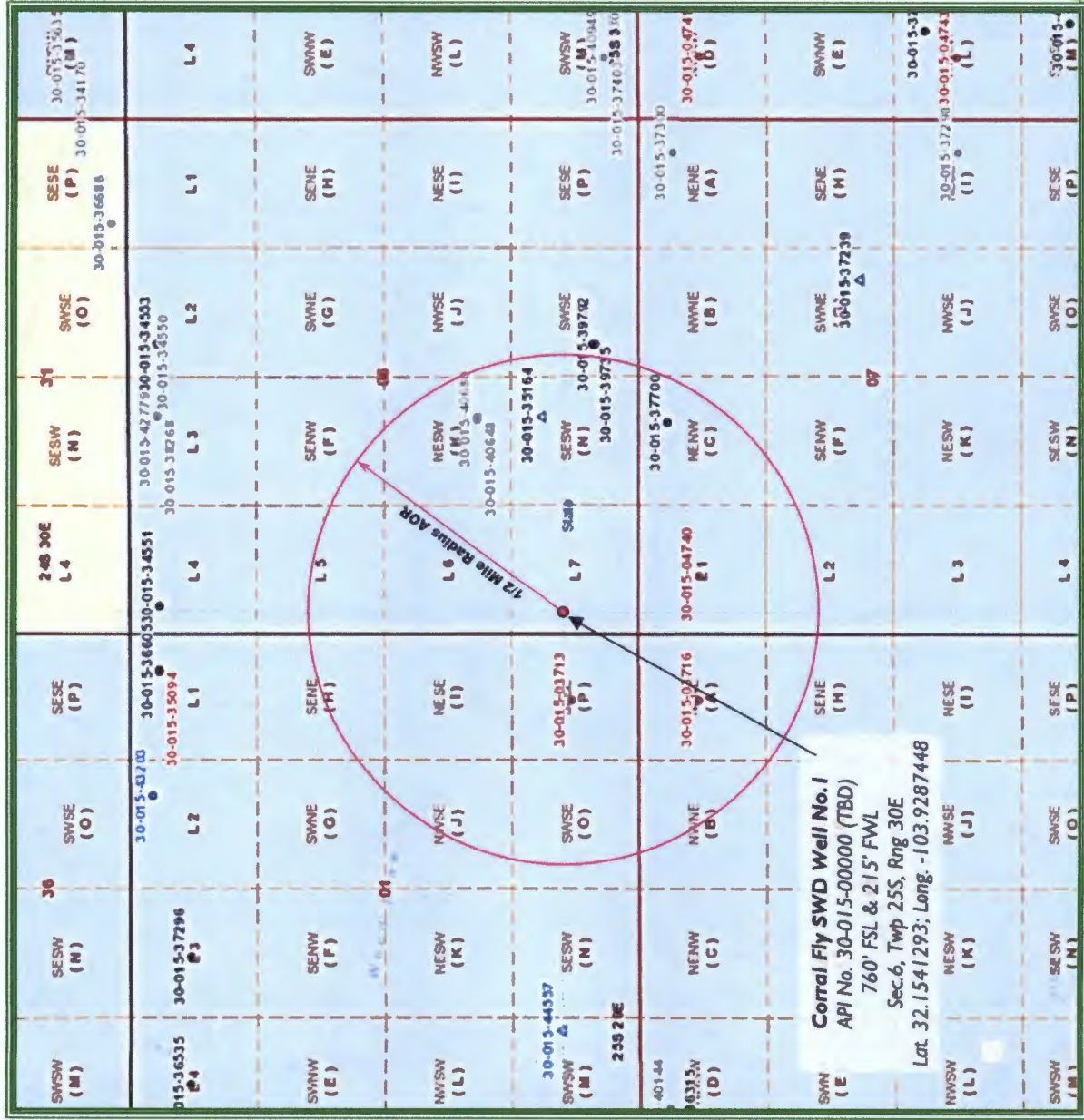

10.0 miles Southeast of Malaga, NM



Eddy County, New Mexico



C-108 - Item VI

Area of Review Well Data

**THERE ARE NO WELLS WHICH PENETRATE THE
PROPOSED DEVONIAN FORMATION IN THE
ONE-HALF MILE AREA of REVIEW**

C-108 ITEM X – LOGS and AVAILABLE TEST DATA

**A Standard Suite of Logs will be run after
drilling the well and submitted to the Division.**

C-108 ITEM VII – PROPOSED OPERATION

Corral Fly SWD No.1

Commercial SWD Facility

Upon approval of all permits for SWD, operations would begin within 30 days. Completion of the well operations will take approximately 6-8 weeks. Facility construction including installation of the tank battery, berms, plumbing and other and associated equipment would be occurring during the same interval but at a different location from the well. In any event, it is not expected for the construction phase of the project to last more than 60 days, depending on availability of contractors and equipment.

Configure for Salt Water Disposal

Prior to commencing any work, an NOI sundry(ies) will be submitted to configure the well for SWD and will detail the completion workover including all work otherwise described above, any change to the procedure noted herein and to perform mechanical integrity pressure test per OCD test procedures. (Notify NMOCD 24 hours prior.) The casing/tubing annulus will be monitored for communication with injection fluid or loss of casing integrity.

Operational Summary

The SWD facility will not be fenced so that trucks may access for load disposal 24/7.

The well and injection equipment will be a closed system and equipped with pressure limiting devices and volume meters. The annulus, loaded with an inert, anti-corrosion packer fluid, will be monitored for pressure.

The tanks will be equipped with telemetry devices and visual alarms to alert the operator and customers of full tanks or an overflow situation.

Anticipated daily maximum volume is 30,000 bpd and an average of 20,000 bpd at a maximum surface injection pressure of 3100 psi (.2 psi/ft gradient – maximum pressure will be adjusted if the top of interval is modified after well logs are run).

Potential releases will be contained and cleaned up immediately. The operator shall repair or otherwise correct the situation within 48 hours before resuming operations. OCD will be notified within 24 hours of any release greater than 5 bbls. If required, remediation will start as soon as practicable. Operator shall comply with 19.15.29 NMAC and 19.15.30 NMAC, as necessary and appropriate.

C-108 ITEM VII – PRODUCED WATER ANALYSES

Item VII.4 – Water Analysis of Source Zone Water

Delaware
Bone Spring
Wolfcamp
Morrow

Item VII.5 – Water Analysis of Disposal Zone Water

Devonian

Water Analyses follow this page.

C-108 Item VII.5 - Produced Water Data
Solaris Water Midstream, LLC - Corral Fly SWD Well No.1

SOURCE ZONE

BONE SPRING

API No	3002502429	Lab ID	
Well Name	LEA UNIT 005	Sample ID	4916
		Sample No	
Location	ULSTR 12 20 S 34 E 1980 S 1980 E	Lat / Long	32.58504 -103.51106
		County	Lea

Operator (when sampled)

	Field	LEA	Unit J
Sample Date			

Sample Source	DST	Depth (if known)
Water Typ		

ph		alkalinity_as_caco3_mgL	
ph_temp_F		hardness_as_caco3_mgL	
specificgravity		hardness_mgL	
specificgravity_temp_F		resistivity_ohm_cm	
tds_mgL	202606	resistivity_ohm_cm_temp_	
tds_mgL_180C		conductivity	
chloride_mgL	118100	conductivity_temp_F	
sodium_mgL		carbonate_mgL	
calcium_mgL		bicarbonate_mgL	5196
iron_mgL		sulfate_mgL	992
barium_mgL		hydroxide_mgL	
magnesium_mgL		h2s_mgL	
potassium_mgL		co2_mgL	
strontium_mgL		o2_mgL	
manganese_mgL		anionremarks	

Remarks

(Produced water data courtesy of NMT Octane NM WAIDS database.)



C-108 Item VII.5 - Produced Water Data
Solaris Water Midstream, LLC - Corral Fly SWD Well No.1

SOURCE ZONE

WOLFCAMP

API No	3001520138	Lab ID	
Well Name	MAHUN STATE 001	Sample ID	5688
		Sample No	
Location	ULSTR 16 22 S 22 E 1800 N 1980 W	Lat / Long	32.39340 -104.70979
		County	Eddy

Operator (when sampled)

	Field	ROCKY ARROYO	Unit	F
Sample Date		5/17/1968	Analysis Date	

Sample Sourc	DST	Depth (if known)	
Water Typ			

ph	8.6	alkalinity_as_caco3_mgL	
ph_temp_F		hardness_as_caco3_mgL	
specificgravity		hardness_mgL	
specificgravity_temp_F		resistivity_ohm_cm	
tds_mgL	35495	resistivity_ohm_cm_temp_	
tds_mgL_180C		conductivity	
chloride_mgL	19000	conductivity_temp_F	
sodium_mgL		carbonate_mgL	
calcium_mgL		bicarbonate_mgL	830
iron_mgL		sulfate_mgL	2500
barium_mgL		hydroxide_mgL	
magnesium_mgL		h2s_mgL	
potassium_mgL		co2_mgL	
strontium_mgL		o2_mgL	
manganese_mgL		anionremarks	

Remarks

(Produced water data courtesy of NMT Octane NM WAIDS database.)



C-108 Item VII.5 - Produced Water Data
Solaris Water Midstream, LLC - Corral Fly SWD Well No.1

SOURCE ZONE

MORROW

API No	3002520756	Lab ID	
Well Name	CUSTER MOUNTAIN UNIT 001	Sample ID	2434
		Sample No	
Location	ULSTR 09 24 S 35 E	Lat / Long	32.22999 -103.37431
	1980 S 1980 W	County	Lea
Operator (when sampled)			
	Field CINTA ROJA	Unit	K
Sample Date		Analysis Date	
	Sample Source DST	Depth (if known)	
	Water Type		
ph		alkalinity_as_caco3_mgL	
ph_temp_F		hardness_as_caco3_mgL	
specificgravity		hardness_mgL	
specificgravity_temp_F		resistivity_ohm_cm	
tds_mgL	282741	resistivity_ohm_cm_temp_	
tds_mgL_180C		conductivity	
chloride_mgL	176800	conductivity_temp_F	
sodium_mgL		carbonate_mgL	
calcium_mgL		bicarbonate_mgL	161
iron_mgL		sulfate_mgL	650
barium_mgL		hydroxide_mgL	
magnesium_mgL		h2s_mgL	
potassium_mgL		co2_mgL	
strontium_mgL		o2_mgL	
manganese_mgL		anionremarks	
Remarks			

(Produced water data courtesy of NMT Octane NM WAIDS database.)



**C-108 Item VII.5 - Produced Water Data
Solaris Water Midstream, LLC - Corral Fly SWD Well No.1**

DISPOSAL ZONE

DEVONIAN

API No.	3002508483	Lab ID	
Well Name	BELL LAKE UNIT 006	Sample ID	5733
		Sample No	
Location	ULSTR 06 23 S 34 E 660 S 1980 E	Lat / Long	32.32821 -103.50663
		County	Lea

Operator (when sampled)

Field	BELL LAKE NORTH	Unit	O
Sample Date		Analysis Date	

Sample Source	HEATER/TREATER	Depth (if known)	
Water Type			

ph	7	alkalinity_as_caco3_mgL	
ph_temp_F		hardness_as_caco3_mgL	
specificgravity		hardness_mgL	
specificgravity_temp_F		resistivity_ohm_cm	
tds_mgL	71078	resistivity_ohm_cm_temp_	
tds_mgL_180C		conductivity	
chloride_mgL	42200	conductivity_temp_F	
sodium_mgL		carbonate_mgL	
calcium_mgL		bicarbonate_mgL	500
iron_mgL		sulfate_mgL	1000
barium_mgL		hydroxide_mgL	
magnesium_mgL		h2s_mgL	
potassium_mgL		co2_mgL	
strontium_mgL		o2_mgL	
manganese_mgL		anionremarks	

Remarks

(Produced water data courtesy of NMT Octane NM WAIDS database.)



**C-108 Item VII.5 - Produced Water Data
Solaris Water Midstream, LLC - Corral Fly SWD No.1**

DISPOSAL ZONE

DEVONIAN

API No.	3002521082	Lab ID	
Well Name	ANTELOPE RIDGE UNIT 003	Sample ID	5720
		Sample No	
Location	ULSTR 34 23 S 34 E 1980 S 1650 W	Lat / Long	32.25922 -103.46068
		County	Lea
Operator (when sampled)			
	Field	ANTELOPE RIDGE	Unit K
Sample Date	11/14/1967	Analysis Date	
	Sample Source	UNKNOWN	Depth (if known)
	Water Type		
ph	6.9	alkalinity_as_caco3_mgL	
ph_temp_F		hardness_as_caco3_mgL	
specificgravity		hardness_mgL	
specificgravity_temp_F		resistivity_ohm_cm	
tds_mgL	80187	resistivity_ohm_cm_temp_	
tds_mgL_180C		conductivity	
chloride_mgL	47900	conductivity_temp_F	
sodium_mgL		carbonate_mgL	
calcium_mgL		bicarbonate_mgL	476
iron_mgL		sulfate_mgL	900
barium_mgL		hydroxide_mgL	
magnesium_mgL		h2s_mgL	
potassium_mgL		co2_mgL	
strontium_mgL		o2_mgL	
manganese_mgL		anionremarks	
Remarks			

(Produced water data courtesy of NMT Octane NM WAIDS database.)



C-108 – Item VIII

Geologic Information

The Devonian and Silurian (including Fusselman) consist of carbonates including light colored dolomite and chert intervals interspersed with some tight limestone intervals. Several thick sections of porous dolomite capable of taking water are present within the subject formations in the area. Depth control data was inferred from deep wells in the vicinity. If the base of Devonian and top of Silurian and/or Ordovician rocks come in as expected the well will only be drilled deep enough for adequate logging rathole.

At a proposed depth of 17,200' BGL (Below Ground Level) the well will TD approximately 1,700 feet below the estimated top of the Devonian. Mud logging through the interval will ensure the target interval remains in Devonian and Silurian. Once Devonian is determined, the casing shoe depth will be set at an approximate maximum upper depth of 15,475' BGL. Injection will occur through the resulting openhole interval. If the base of Silurian and top of Ordovician rocks come in as expected the well will only be drilled deep enough for adequate logging rathole; estimated total depth approximately 17,200'.

The Devonian is overlain by the Woodford Shale and Mississippian Lime. The lower Silurian (Fusselman) rock is underlain by the Ordovician; Simpson, McKee and Ellenburger.

Fresh water in the area is generally available from valley and basin fill of the Carlsbad-Pecos segment of the lower Pecos Valley complex of Quaternary alluvial sand and gravel deposits. State Engineer's records show water wells in the area with an average depth of groundwater at 364 feet.

There are no water wells located within one mile of the proposed SWD. One POD was picked up but records indicate the well is P&Ad.

C-108 ITEM XI – WATER WELLS IN AOR

NO WATER WELLS WITHIN ONE MILE OF PROPOSED SWD WELL.



New Mexico Office of the State Engineer Active & Inactive Points of Diversion (with Ownership Information)

No PODs found.

PLSS Search:

Section(s): 6, 7 Township: 25S Range: 30E

WR File Nbr	Sub basin	Use	Diversion	Owner	County	POD Number	Code Grant	Source	q q q 6416 4 Sec Twp Rng	X	Y
000450	C	PRO	0	SANTA FE ENERGY RESOURCES INC	ED	000450	Well is plugged.	4 4 1 02 25S 29E	598422	3558663*	

Record Count: 1

PLSS Search:

Section(s): 1, 2 Township: 25S Range: 29E

Sorted by: File Number

*UTM location was derived from PLSS - see Help

The data is furnished by the NMOSE/ISC and is accepted by the recipient with the expressed understanding that the OSE/ISC make no warranties, expressed or implied, concerning the accuracy, completeness, reliability, usability, or suitability for any particular purpose of the data.

wellname	api	section	township	range	unit	formation	samplesource	ph	tds_mgL
CONTINENTAL FED #002		3001510172	20 25S	30E	L	DELAWARE	UNKNOWN		157068
R & B FED FED A #001		3001504752	17 25S	30E	D	DELAWARE	WELLHEAD	7	146809
HOPP FED #001		3001504738	4 25S	30E	M	DELAWARE	SWAB		146106
HOPP FED #001		3001504738	4 25S	30E	M	DELAWARE	WELLHEAD		180137
R AND B FEDERAL #001Y		3001504753	17 25S	30E	D	DELAWARE	WELLHEAD		146130
BENNETT FEDERAL #001		3001524071	30 25S	30E	O	DELAWARE		6.85	100240
BENNETT FEDERAL #001		3001524071	30 25S	30E	O	DELAWARE	WELLHEAD	6	103300
CONTINENTAL FEDERAL #001		3001510048	20 25S	30E	D	DELAWARE	DST		311052
CONTINENTAL FEDERAL #001		3001510048	20 25S	30E	D	DELAWARE	DST		170607
CONTINENTAL FEDERAL #001		3001510048	20 25S	30E	D	DELAWARE	DST		193989
SUPERIOR STATE #002		3001510181	8 25S	30E	I	DELAWARE	SWAB		155173
SUPERIOR STATE #002		3001510181	8 25S	30E	I	DELAWARE	UNKNOWN		150830

C-108 ITEM XI – WATER WELLS IN AOR

Depth to Ground Water



New Mexico Office of the State Engineer Water Column/Average Depth to Water

(A CLW##### in the POD suffix indicates the POD has been replaced & no longer serves a water right file.)

(R=POD has been replaced,
O=orphaned,

C=the file is

closed) (quarters are 1=NW 2=NE 3=SW 4=SE)

(quarters are smallest to largest) (NAD83 UTM in meters)

(In feet)

POD Number	POD Sub-Code	basin	County	Q Q Q			Sec	Tws	Rng	X	Y	Depth Well	Depth Water	Water Column
				64	16	4								
C 01379	C	ED	4	4	3	10	25S	30E	606571	3556355*	400			
C 03716 POD1	CUB	ED	4	2	2	02	25S	30E	609069	3559211	600	425	175	
C 03781 POD1	CUB	ED	3	3	3	13	25S	30E	609306	3554761	720	325	395	
C 03782 POD1	CUB	ED	4	3	3	28	25S	30E	604526	3551444	805	277	528	
C 03891 POD1	CUB	ED	4	4	2	01	25S	30E	610608	3558890	635	429	206	

Average Depth to Water: **364 feet**

Minimum Depth: **277 feet**

Maximum Depth: **429 feet**

Record Count: 5

PLSS Search:

Township: 25S

Range: 30E

C-108 - Item XI

Groundwater Basins - Water Column / Depth to Groundwater

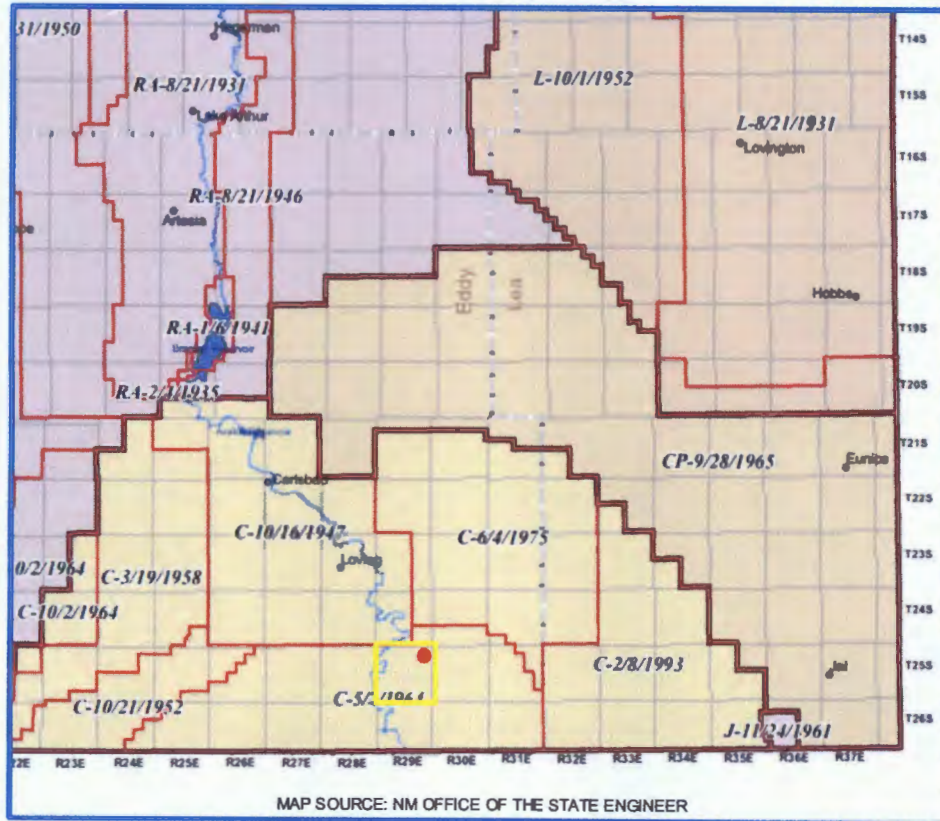

The subject well is located within the Carlsbad Basin.

Fresh water in the area is generally available from the ~~Santa Rosa~~ or Cenozoic alluvial deposits of the Carlsbad Basin. State Engineer's records show water wells in 24S-31E with an average depth to water at 182 feet.

There is 1 (one) water well located within one mile of the proposed SWD.

absent from township / Rustler at ~578' BGS

Well ID	Depth to Water
0-6/25S/30E 30-015-39735	622'
D-12/25S/29E 30-016-36315	690' (W)
L-8/25S/30E 30-015-37299	563' (S)



C-108 ITEM XII – GEOLOGIC AFFIRMATION

We have examined available geologic and engineering data and have found no evidence of open faults or other hydrologic connection between the disposal interval and any underground sources of drinking water.

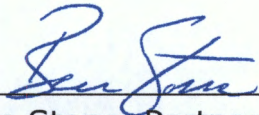

Ben Stone, Partner
SOS Consulting, LLC

Project: Solaris Water Midstream, LLC
Corral Fly State SWD No.1
Reviewed 1/10/2018

C-108 ITEM XIII – PROOF OF NOTIFICATION

IDENTIFICATION AND NOTIFICATION OF INTERESTED PARTIES

Exhibits for Section

Leasehold Plat

List of Interested Parties

Notification Letter to Interested Parties

Proof of Certified Mailing

Published Legal Notice

Corral Fly State SWD Well No.1 - Leasehold Plat

(Attachment to NMOCD Form C-108, Application for Authority to Inject.)

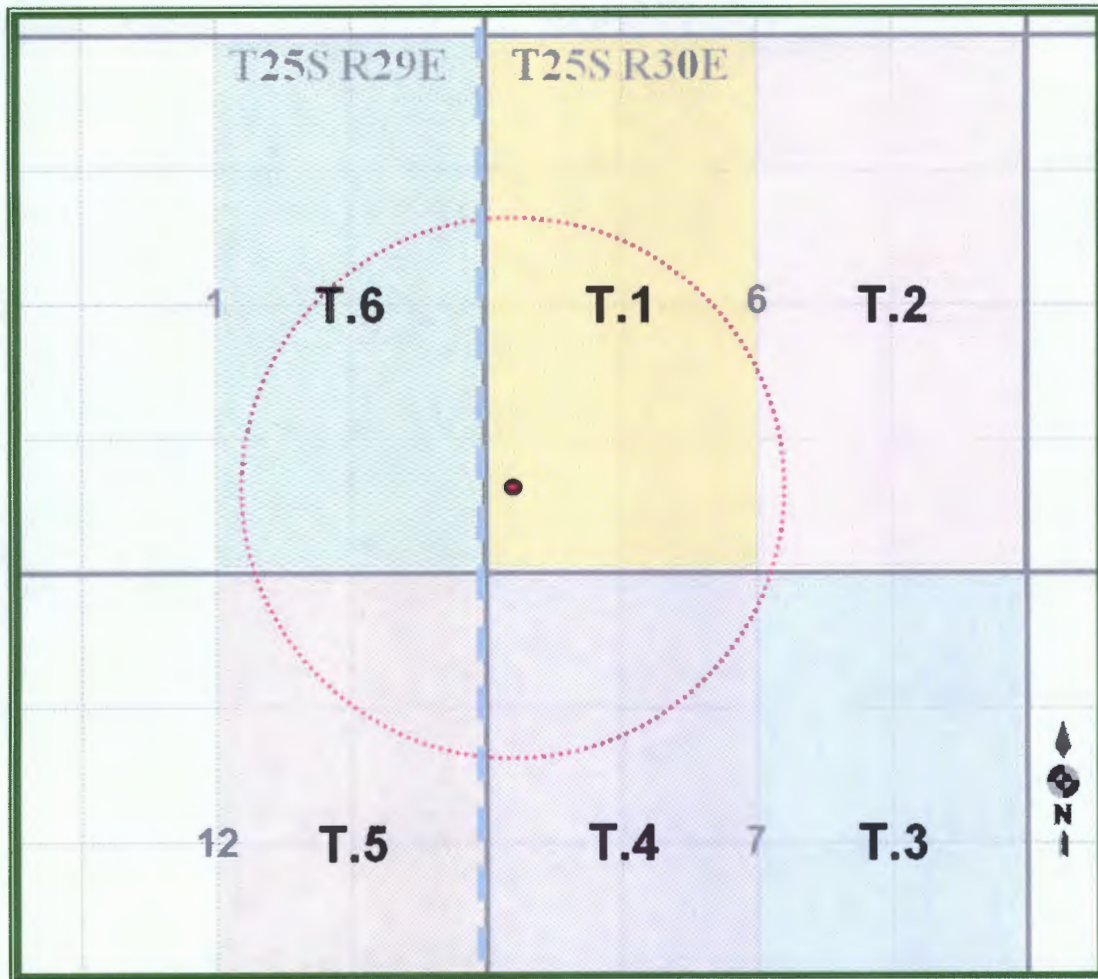

LEGEND

- T.1 – VO-6711 – EOG 'Y' Resources, Inc.
- T.2 – VO-6099 – EOG 'Y' Resources, Inc.
- T.3 – VO-7066 – COG Operating, LLC
- T.4 – VO-8025 – XTO Energy, Inc.
- T.5 – VB-1105 – Chevron USA, Inc.
- T.6 – VA-2975 – Mewbourne Oil Company

(All State of NM Leases.)

**C-108 ITEM XIII – PROOF OF NOTIFICATION
INTERESTED PARTIES LIST**

SURFACE OWNER

- 1 STATE OF NEW MEXICO (Notified via USPS Certified Mail)
Oil, Gas and Minerals Division
310 Old Santa Fe Trail
Santa Fe, NM 87504
Certified: 7015 3010 0001 3789 7824

OFFSET MINERALS LESSEES and OPERATORS (All Notified via USPS Certified Mail)

State Lease VO-6711 & VO-6099 (T.1 & T.2 on Leasehold Plat)

Lessee & Operator

- 2 EOG 'Y' RESOURCES, INC.
105 S. 4th Street
Artesia, NM 88210
Certified: 7015 3010 0001 3789 7763

- 3 **State Lease VO-7066 (T.3 on Leasehold Plat)**

Lessee & Operator

COG OPERATING, LLC
2208 W. Main Street
Artesia, New Mexico 88210-3720
7015 3010 0001 3789 7770

State Lease VO-8025 (T.4 on Leasehold Plat)

Lessee & Operator

- 4 XTO ENERGY, INC.
P.O. Box 6501
Englewood, CO 80155
Certified: 7015 3010 0001 3789 7787

State Lease VB-1105 (T.5 on Leasehold Plat)

Lessee & Operator

- 5 CHEVRON USA, INC.
Attn: Linda McMurray, Permitting Team
6301 Deauville Blvd.
Midland, TX 79706
Certified: 7015 3010 0001 3789 7800

State Lease VA-2975 (T.6 on Leasehold Plat)

Lessee

- 6 MEWBOURNE OIL COMPANY
P.O. Box 2070
Hobbs, NM 88240
Certified: 7015 3010 0001 3789 7794

Operators

- 7 OXY USA WTP, LIMITED PARTNERSHIP
6001 Deauville Blvd.
Midland, TX 79706
Certified: 7015 3010 0001 3789 7817

C-108 ITEM XIII – PROOF OF NOTIFICATION
INTERESTED PARTIES LIST (cont.)

State Lease VA-3633 (T.6 on Leasehold Plat – cont.)

Operators (cont.)

EOG 'Y' RESOURCES, INC.

105 S. 4th Street

Artesia, NM 88210

REGULATORY

NEW MEXICO OIL CONSERVATION DIVISION (FedEx'ed original and copy)

1220 S. St. Francis Dr.

Santa Fe, NM 87505

NEW MEXICO OIL CONSERVATION DIVISION (FedEx'ed copy)

811 S. First St.

Artesia, NM 88210

January 10, 2018

NOTIFICATION TO INTERESTED PARTIES
via U.S. Certified Mail – Return Receipt Requested

To Whom It May Concern:

Solaris Water Midstream, LLC, Midland, Texas, has made application to the New Mexico Oil Conservation Division to drill and complete for salt water disposal the Corral Fly SWD Well No.1. The proposed commercial operation will be for produced water disposal from area operators. As indicated in the notice below, the well is located in Section 6, Township 25 South, Range 30 East in Eddy County, New Mexico.

The published notice states that the interval will be from 15,500 feet to 17,200 feet into the Devonian, Silurian and Fusselman formations.

Following is the notice published in the Artesia Daily Press, Artesia, New Mexico on or about January 12, 2018.

LEGAL NOTICE

Solaris Water Midstream, LLC, 701 Tradewinds Blvd., Suite C, Midland, TX 79706, is filing Form C-108 (Application for Authority to Inject) with the New Mexico Oil Conservation Division seeking administrative approval for a salt water disposal well. The proposed well, the Corral Fly State SWD No.1, is located 760' FSL and 215' FWL, Section 6, Township 25 South, Range 30 East, Eddy County, New Mexico. Produced water from area production will be commercially disposed into the Devonian, Silurian and Fusselman formations at a depth of 15,500' to 17,200' at a maximum surface pressure of 3100 psi and a rate limited only by such pressure. The proposed SWD well is located approximately 10.0 miles southeast of Malaga, NM.

Interested parties wishing to object to the proposed application must file with the New Mexico Oil Conservation Division, 1220 St. Francis Dr., Santa Fe, NM 87505, (505)476-3460 within 15 days of the date of this notice. Additional information may be obtained from the applicant's agent, SOS Consulting, LLC, (903)488-9850 or, email info@sosconsulting.us.

You have been identified as a party who may be interested as an offset lessee or operator.

You are entitled to a full copy of the application. A full copy in PDF format is posted on the SOS Consulting **ShareFile** site and is available for immediate download.

Use the URL link: <https://sosconsulting.sharefile.com/d-s642c43e85814805a>
(Please Note: The ShareFile service is powered by Citrix Systems and is completely secure.*)

The link to this file will be active for 30 days from the date of this letter. Your company can access and download the file a maximum of five (5) times. (One copy may be downloaded and shared as needed among your company.)

Alternatively, you may call SOS Consulting, LLC at 903-488-9850, or email info@sosconsulting.us, and the same PDF file copy will be expedited to you via email.

Please use the subject "**Corral Fly Jan 2018 PDF Copy Request**".

Thank you for your attention in this matter.

Best regards,



Ben Stone, SOS Consulting, LLC
Agent for Solaris Water Midstream, LLC

Cc: Application File

SOS Consulting is committed to providing superior quality work using technology to assist clients and affected parties in obtaining the documentation required. SOS will continue to utilize methods which are less energy and resource intensive including, the reduction of paper copies.

We hope you'll partner with us and appreciate these efforts.

* You will be asked for your email, name and company.
This will not be used by anyone except keeping track of the file downloads.
You will not be solicited by SOS or anyone else. Data is stored on Citrix Systems servers only.



C-108 - Item XIV

Proof of Notice (Certified Mail Receipts)

7015 3010 0001 3789 7824

U.S. Postal Service™
CERTIFIED MAIL® RECEIPT
Domestic Mail Only

For delivery information, visit our website at www.usps.com

OFFICIAL USE

Certified Mail Fee	\$	 <p>Postmark Here</p>
Extra Services & Fees (check box, add fee as appropriate)		
<input type="checkbox"/> Return Receipt (hardcopy)	\$	
<input type="checkbox"/> Return Receipt (electronic)	\$	
<input type="checkbox"/> Certified Mail Restricted Delivery	\$	
<input type="checkbox"/> Adult Signature Required	\$	
Postage	\$	
Total Postage and Fees	\$ 6.59	
Sent To		
Street and A		
City, State, ZIP		

PS Form 3800, October 2011

5922 682E 1000 010E 5102

U.S. Postal Service™
CERTIFIED MAIL® RECEIPT
Domestic Mail Only

For delivery information, visit our website at www.usps.com

OFFICIAL USE

Certified Mail Fee	\$	 <p>Postmark Here</p>
Extra Services & Fees (check box, add fee as appropriate)		
<input type="checkbox"/> Return Receipt (hardcopy)	\$	
<input type="checkbox"/> Return Receipt (electronic)	\$	
<input type="checkbox"/> Certified Mail Restricted Delivery	\$	
<input type="checkbox"/> Adult Signature Required	\$	
Postage	\$	
Total Postage and Fees	\$ 6.59	
Sent To		
Street and A		
City, State, ZIP		

PS Form 3800, October 2011

7015 3010 0001 3789 7770

U.S. Postal Service™
CERTIFIED MAIL® RECEIPT
Domestic Mail Only

For delivery information, visit our website at www.usps.com

OFFICIAL USE

Certified Mail Fee	\$	 <p>Postmark Here</p>
Extra Services & Fees (check box, add fee as appropriate)		
<input type="checkbox"/> Return Receipt (hardcopy)	\$	
<input type="checkbox"/> Return Receipt (electronic)	\$	
<input type="checkbox"/> Certified Mail Restricted Delivery	\$	
<input type="checkbox"/> Adult Signature Required	\$	
Postage	\$	
Total Postage and Fees	\$ 6.59	
Sent To		
Street and A		
City, State, ZIP		

PS Form 3800, October 2011

5922 682E 1000 010E 5102

U.S. Postal Service™
CERTIFIED MAIL® RECEIPT
Domestic Mail Only

For delivery information, visit our website at www.usps.com

OFFICIAL USE

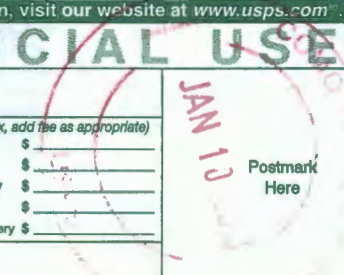
Certified Mail Fee	\$	 <p>Postmark Here</p>
Extra Services & Fees (check box, add fee as appropriate)		
<input type="checkbox"/> Return Receipt (hardcopy)	\$	
<input type="checkbox"/> Return Receipt (electronic)	\$	
<input type="checkbox"/> Certified Mail Restricted Delivery	\$	
<input type="checkbox"/> Adult Signature Required	\$	
Postage	\$	
Total Postage and Fees	\$ 6.59	
Sent To		
Street and A		
City, State, ZIP		

PS Form 3800, October 2011

C-108 - Item XIV

Proof of Notice (Certified Mail Receipts - cont.)

7015 3010 0001 3789 7800

U.S. Postal Service™
CERTIFIED MAIL® RECEIPT
Domestic Mail Only

For delivery information, visit our website at www.usps.com

OFFICIAL USE

Certified Mail Fee \$	 Postmark Here
Extra Services & Fees (check box, add fee as appropriate)	
<input type="checkbox"/> Return Receipt (hardcopy) \$	
<input type="checkbox"/> Return Receipt (electronic) \$	
<input type="checkbox"/> Certified Mail Restricted Delivery \$	
<input type="checkbox"/> Adult Signature Required \$	
<input type="checkbox"/> Adult Signature Restricted Delivery \$	
Postage \$	
Total Postage and Fees \$ <u>6.59</u>	
Sent To	
Street and Apt. CHEVRON USA, INC.	
City, State, ZIP Attn: Linda McMurray, Permitting Team	
6301 Deauville Blvd.	
Midland, TX 79706	

PS Form 38

7015 3010 0001 3789 7794

U.S. Postal Service™
CERTIFIED MAIL® RECEIPT
Domestic Mail Only

For delivery information, visit our website at www.usps.com

OFFICIAL USE

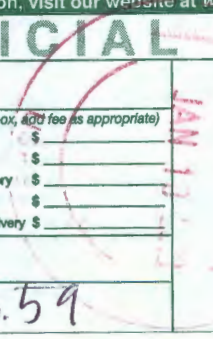
Certified Mail Fee \$	 Postmark Here
Extra Services & Fees (check box, add fee as appropriate)	
<input type="checkbox"/> Return Receipt (hardcopy) \$	
<input type="checkbox"/> Return Receipt (electronic) \$	
<input type="checkbox"/> Certified Mail Restricted Delivery \$	
<input type="checkbox"/> Adult Signature Required \$	
<input type="checkbox"/> Adult Signature Restricted Delivery \$	
Postage \$	
Total Postage and Fees \$ <u>6.59</u>	
Sent To	
Street and Apt. MEWBOURNE OIL COMPANY	
City, State, ZIP 701 S Cecil Street	
Hobbs, NM 88240	

PS Form 38

7015 3010 0001 3789 7817

U.S. Postal Service™
CERTIFIED MAIL® RECEIPT
Domestic Mail Only

For delivery information, visit our website at www.usps.com

OFFICIAL USE

Certified Mail Fee \$	 Postmark Here
Extra Services & Fees (check box, add fee as appropriate)	
<input type="checkbox"/> Return Receipt (hardcopy) \$	
<input type="checkbox"/> Return Receipt (electronic) \$	
<input type="checkbox"/> Certified Mail Restricted Delivery \$	
<input type="checkbox"/> Adult Signature Required \$	
<input type="checkbox"/> Adult Signature Restricted Delivery \$	
Postage \$	
Total Postage and Fees \$ <u>6.59</u>	
Sent To	
Street and Apt. OXY USA, INC.	
City, State, ZIP 6001 Deauville Blvd.	
Midland, TX 79706	

PS Form 38

C-108 - Item XIV

Proof of Notice – Legal Notice
Newspaper of General Circulation

Legal Notice

Solaris Water Midstream, LLC, 701 Tradewinds Blvd., Suite C, Midland, TX 79706, is filing Form C-108 (Application for Authority to Inject) with the New Mexico Oil Conservation Division seeking administrative approval for a salt water disposal well. The proposed well, the Corral Fly State SWD No.1, is located 760' FSL and 215' FWL, Section 6, Township 25 South, Range 30 East, Eddy County, New Mexico. Produced water from area production will be commercially disposed into the Devonian, Silurian and Fusselman formations at a depth of 15,500' to 17,200' at a maximum surface pressure of 3100 psi and a rate limited only by such pressure. The proposed SWD well is located approximately 10.0 miles southeast of Malaga, NM.

Interested parties wishing to object to the proposed application must file with the New Mexico Oil Conservation Division, 1220 St. Francis Dr., Santa Fe, NM 87505, (505)476-3460 within 15 days of the date of this notice. Additional information may be obtained from the applicant's agent, SOS Consulting, LLC, (903)488-9850 or, email info@sosconsulting.us.

Published in the Artesia Daily Press, Artesia, N.M., Jan. 11, 2018 Legal No. 24530.

The above is the "Proof Copy" sent from the Artesia Daily Press.
The affidavit of publication will be forwarded as soon as it is received.

Affidavit of Publication

No. 24530

State of New Mexico

County of Eddy:

Danny Scott

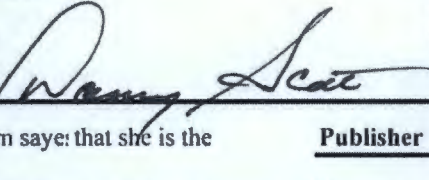

being duly sworn say: that she is the Publisher

of the Artesia Daily Press, a daily newspaper of General circulation, published in English at Artesia, said county and state, and that the hereto attached

Legal Ad

was published in a regular and entire issue of the said Artesia Daily Press, a daily newspaper duly qualified for that purpose within the meaning of Chapter 167 of the 1937 Session Laws of the state of New Mexico for 1 Consecutive weeks/day on the same

day as follows:

First Publication	January 11, 2018
Second Publication	
Third Publication	
Fourth Publication	
Fifth Publication	
Sixth Publication	
Seventh Publication	

Subscribed and sworn before me this 11th day of January 2018



OFFICIAL SEAL
Latisha Romine
NOTARY PUBLIC-STATE OF NEW MEXICO

My commission expires: 5/12/2019

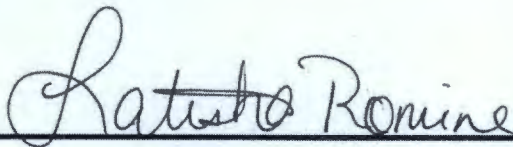

Latisha Romine

Notary Public, Eddy County, New Mexico

Copy of Publication:

Legal Notice

Solaris Water Midstream, LLC, 701 Tradewinds Blvd., Suite C, Midland, TX 79706, is filing Form C-108 (Application for Authority to Inject) with the New Mexico Oil Conservation Division seeking administrative approval for a salt water disposal well. The proposed well, the Corral Fly State SWD No.1, is located 760' FSL and 215' FWL, Section 6, Township 25 South, Range 30 East, Eddy County, New Mexico. Produced water from area production will be commercially disposed into the Devonian, Silurian and Fusselman formations at a depth of 15,500' to 17,200' at a maximum surface pressure of 3100 psi and a rate limited only by such pressure. The proposed SWD well is located approximately 10.0 miles southeast of Malaga, NM.

Interested parties wishing to object to the proposed application must file with the New Mexico Oil Conservation Division, 1220 St. Francis Dr., Santa Fe, NM 87505, (505)476-3460 within 15 days of the date of this notice. Additional information may be obtained from the applicant's agent, SOS Consulting, LLC, (903)488-9850 or, email info@sosconsulting.us.

Published in the Artesia Daily Press, Artesia, N.M., Jan. 11, 2018 Legal No. 24530.

Affidavit of Publication

No. 24530

State of New Mexico

County of Eddy:

Danny Scott

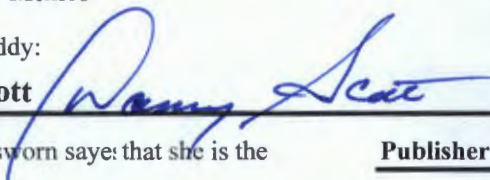

being duly sworn says that she is the **Publisher**

of the Artesia Daily Press, a daily newspaper of General circulation, published in English at Artesia, said county and state, and that the hereto attached

Legal Ad

was published in a regular and entire issue of the said Artesia Daily Press, a daily newspaper duly qualified for that purpose within the meaning of Chapter 167 of the 1937 Session Laws of the state of New Mexico for 1 Consecutive weeks/day on the same

day as follows:

First Publication January 11, 2018

Second Publication _____

Third Publication _____

Fourth Publication _____

Fifth Publication _____

Sixth Publication _____

Seventh Publication _____

Subscribed and sworn before me this

11th day of January 2018



OFFICIAL SEAL
Latisha Romine
NOTARY PUBLIC-STATE OF NEW MEXICO

My commission expires: 5/12/2019

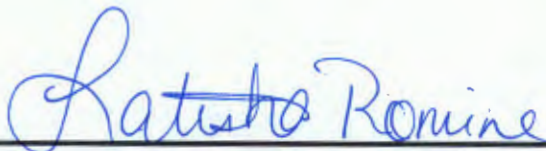

Latisha Romine

Notary Public, Eddy County, New Mexico

Copy of Publication:

Legal Notice

Solaris Water Midstream, LLC, 701 Tradewinds Blvd., Suite C, Midland, TX 79706, is filing Form C-108 (Application for Authority to Inject) with the New Mexico Oil Conservation Division seeking administrative approval for a salt water disposal well. The proposed well, the Corral Fly State SWD No.1, is located 760' FSL and 215' FWL, Section 6, Township 25 South, Range 30 East, Eddy County, New Mexico. Produced water from area production will be commercially disposed into the Devonian, Silurian and Fusselman formations at a depth of 15,500' to 17,200' at a maximum surface pressure of 3100 psi and a rate limited only by such pressure. The proposed SWD well is located approximately 10.0 miles southeast of Malaga, NM.

Interested parties wishing to object to the proposed application must file with the New Mexico Oil Conservation Division, 1220 St. Francis Dr., Santa Fe, NM 87505, (505)476-3460 within 15 days of the date of this notice. Additional information may be obtained from the applicant's agent, SOS Consulting, LLC, (903)488-9850 or, email info@sosconsulting.us.

Published in the Artesia Daily Press, Artesia, N.M., Jan. 11, 2018 Legal No. 24530.

2018 JAN 25 P 3: 13

RECEIVED OCD



FORM C-108 Technical Review Summary [Prepared by reviewer and included with application; V16.2]

DATE RECORD: First Rec: 1/16/18 Admin Complete: 1/16/18 or Suspended: [Devonian data base development] Add. Request/Reply: _____

ORDER TYPE: WFX / PMX (SWD) Number: 1727 Order Date: 05/01/2018 Legacy Permits/Orders: (SWD-1706)

Well No. 1 Well Name(s): Corral Fly State SWD

API: 30-0 15-44626 Spud Date: TBD/applicant has requested expedited response New or Old (EPA): New (UIC Class II Primacy 03/07/1982)

Footages 760' FSL / 215' FWL Lot - or Unit M Sec 6 Tsp 25S Rge 30E County Eddy

General Location: Big Sinks area / off Buck Jackson / Rock Lake Pool: SWD; Devonian-Silurian Pool No.: 97869

BLM 100K Map: Jal Operator: Solaris Water Midstream LLC OGRID: 371643 Contact: Ben Stone; SOS Consulting

COMPLIANCE RULE 5.9: Total Wells: 6 Inactive: 0 Fincl Assur: Yes Compl. Order? No IS 5.9 OK? Yes Date: 05/01/2018

WELL FILE REVIEWED Current Status: APD filed; spud date soon

WELL DIAGRAMS: NEW: Proposed or RE-ENTER: Before Conv. After Conv. Logs in Imaging: NA

Planned Rehab Work to Well: NA

Well Construction Details		Sizes (in) Borehole / Pipe	Setting Depths (ft)	Cement Sz or Cf	Cement Top and Determination Method
Planned <input checked="" type="checkbox"/> or Existing <input type="checkbox"/>	Surface	26 / 20	0 to 575	900	Cir. to surface
Planned <input type="checkbox"/> or Existing <input checked="" type="checkbox"/>	Interm/Prod	12 1/2 / 13 3/8	0 to 3260	1300	Cir. to surface
Planned <input type="checkbox"/> or Existing <input checked="" type="checkbox"/>	Interm/Prod	12 1/4 / 9 5/8	0 to 1200	2300	Cir to surface / Not provided
Planned <input type="checkbox"/> or Existing <input checked="" type="checkbox"/>	Prod/Liner	8 1/2 / 7 5/8	11700 to 15500	450	Not provided
Planned <input type="checkbox"/> or Existing <input type="checkbox"/>	Liner	-	-	-	-
Planned <input checked="" type="checkbox"/> or Existing <input checked="" type="checkbox"/>	OH/PERF	6.5	15500 to 17200	Inj Length 1700'	

Injection Lithostratigraphic Units:				Completion/Operation Details:				
Adjacent Unit:	Litho.	Struc.	Por.	Depths (ft)	Injection or Confining Units	Tops	Drilled TD	PBTD
Adjacent Unit:	Litho.	Struc.	Por.		Mississippian	15100	NEW TD	17200
Confining Unit:	Litho.	Struc.	Por.	15500	Woodford	15325	NEW PBTD	
Proposed Inj Interval TOP:				15500	Devonian	15500	NEW Open Hole	<input checked="" type="checkbox"/>
Proposed Inj Interval BOTTOM:				17200	Fossilman	17000	Tubing Size	4" or 5" Inter Coated? <input checked="" type="checkbox"/>
Confining Unit:	Litho.	Struc.	Por.		Montoya	NP	Proposed Packer Depth	15400 ft
Adjacent Unit:	Litho.	Struc.	Por.		Simpson	NP	Min. Packer Depth	15400 (100-ft limit)
							Proposed Max. Surface Press.	3100 psi
							Admin. Inj. Press.	3100 (0.2 psi per ft)

AOR: Hydrologic and Geologic Information

POTASH: R-111-P NA (South) Noticed? NA BLM Sec Ord NA WIPP Noticed? NA Salt/Salado T. ~900' B: ~3300' NW: Cliff House fm NA

FRESH WATER: Aquifer Paduca - ~580' (DTW) Max Depth [± 600'] HYDRO AFFIRM STATEMENT By Qualified Person

NMOSE Basin: Cretaceous CAPITAN REEF: thru adj NA No. GW Wells in 1-Mile Radius? NA FW Analysis? NA

Disposal Fluid: Formation Source(s) Morrow/Permian Analysis? Yes On Lease Operator Only or Commercial

Disposal Interval: Inject Rate (Avg/Max BWPD): 20000/30000 Protectable Waters? Low Prob. Source: Analysis System: Closed or Open

HC Potential: Producing Interval? NA Formerly Producing? NA Method: Logs/DST/P&A/Other Request log 2-Mi Radius Pool Map

AOR Wells: 1/2-M Radius Map and Well List? Yes No. Penetrating Wells: 0 [AOR Horizontals: _____ AOR SWDs: _____]

Penetrating Wells: No. Active Wells 0 Num Repairs? _____ on which well(s)? _____ Diagrams? _____

Penetrating Wells: No. P&A Wells 0 Num Repairs? _____ on which well(s)? _____ Diagrams? _____

NOTICE: Newspaper Date 01/11/2018 Mineral Owner NMSLO Surface Owner NMSLO N. Date 01/10/2018

RULE 26.7(A): Identified Tracts? Yes Affected Persons: COG / XTO / EOG Y / Chevron / Marbame / OXY / NMSLO N. Date 1/10/18

Order Conditions: Issues: Interm casing #2 & Liner - cement placement not determined / HC potential

Additional COAs: CBL on Liner & 9 5/8 cto shoe of 13 5/8 casing; mudlog + picks; Montoya limit

**Pending Application for High-Volume Devonian Disposal Well
C-108 Application for Corral Fly State SWD No. 1 – Solaris Water Midstream LLC**

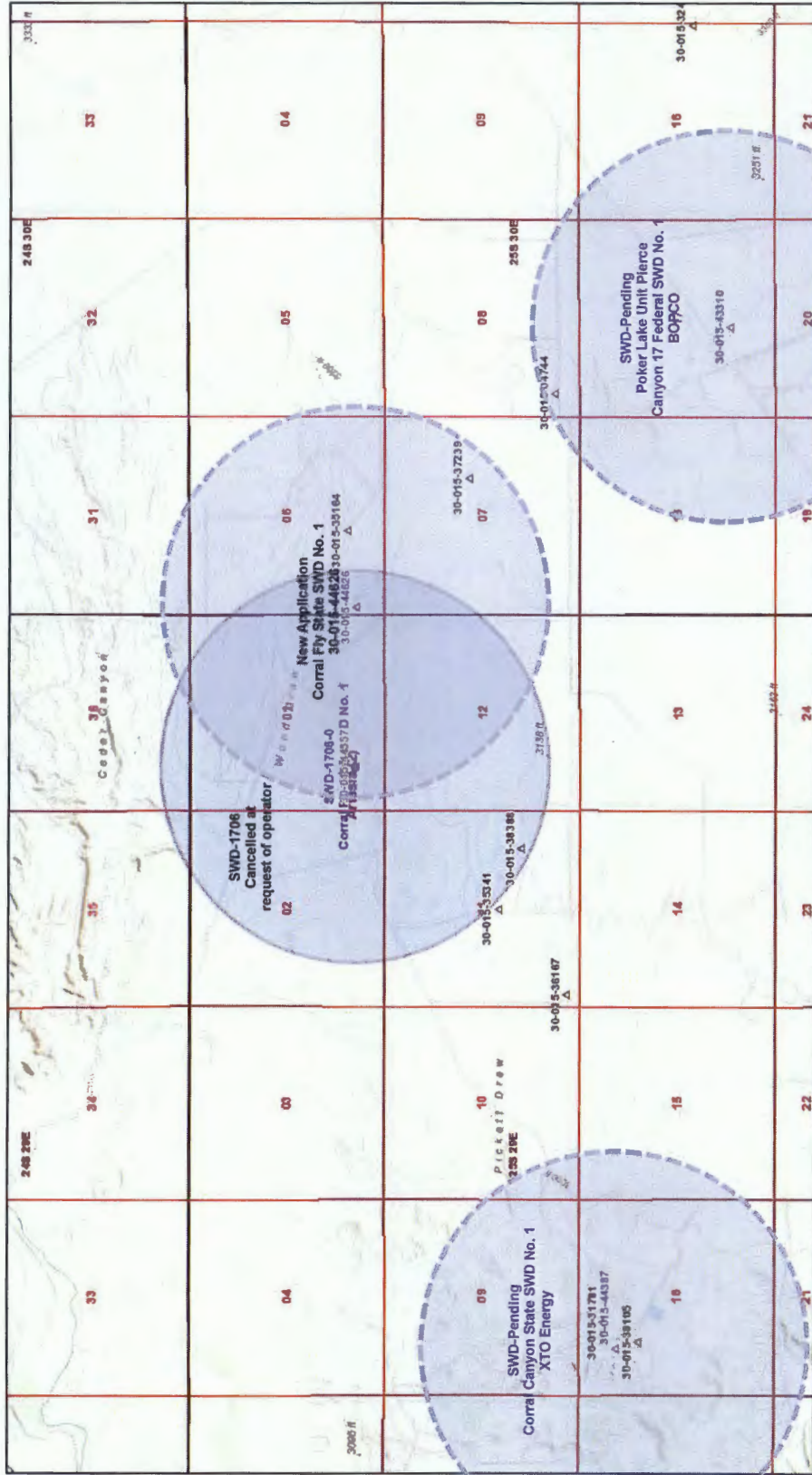

Corral Fly State SWD No. 1; Solaris Water Midstream LLC

API 30-015-44626; Application No. pMAM1801655181; replacement for SWD-1706

Proposed interval: 15,500' to 17,200'

Closest Devonian Wells with Large-Volume Potential: Corral Canyon State SWD No. 1 (30-015-44387) and PLU Pierce Canyon 17 Fed SWD No. 1 (30-015-43310)

Remaining SWD locations are for shallower disposal intervals (mostly Delaware Mountain Group).

Section : 06-25S-30E

Type: Normal

Total Acres: 642.68

County: Eddy (15)

D (4) State 1 State 2 (15) 40.17	C (3) State 1 State 2 (15) 40.3	B (2) State 1 State 2 (15) 40.5	A (1) State 1 State 2 (15) 40.7
E (5) State 1 State 2 (15) 40.2	F (F) State 1 State 2 (15) 40	G (G) State 1 State 2 (15) 40	H (H) State 1 State 2 (15) 40
L (6) State 1 State 2 (15) 40.34	K (K) State 1 State 2 (15) 40	J (J) State 1 State 2 (15) 40	I (I) State 1 State 2 (15) 40
M (7) State 1 State 2 (15) 40.47	N (N) State 1 State 2 (15) 40	O (O) State 1 State 2 (15) 40	P (P) State 1 State 2 (15) 40