

RECEIVED: 03/12/2019	REVIEWER: MAM	TYPE: NSP	APP NO: pMAM1907145838
-------------------------	------------------	--------------	---------------------------

ABOVE THIS TABLE FOR OCD DIVISION USE ONLY

**NEW MEXICO OIL CONSERVATION DIVISION**  
 - Geological & Engineering Bureau -  
 1220 South St. Francis Drive, Santa Fe, NM 87505



**ADMINISTRATIVE APPLICATION CHECKLIST**

THIS CHECKLIST IS MANDATORY FOR ALL ADMINISTRATIVE APPLICATIONS FOR EXCEPTIONS TO DIVISION RULES AND  
 REGULATIONS WHICH REQUIRE PROCESSING AT THE DIVISION LEVEL IN SANTA FE

Applicant: HILCORP ENERGY COMPANYOGRID Number: 372171Well Name: SAN JUAN 32-7 UNIT #249HAPI: 3004535886Pool: BASIN FRUITLAND COALPool Code: 71629

**SUBMIT ACCURATE AND COMPLETE INFORMATION REQUIRED TO PROCESS THE TYPE OF APPLICATION  
 INDICATED BELOW**

1) **TYPE OF APPLICATION:** Check those which apply for [A]

A. Location – Spacing Unit – Simultaneous Dedication

☐ NSL☐ NSP (PROJECT AREA)☒ NSP (PRORATION UNIT)☐ SD

NSP-2120

B. Check one only for [ I ] or [ II ]

[ I ] Commingling – Storage – Measurement

☐ DHC☐ CTB☐ PLC☐ PC☐ OLS☐ OLM

[ II ] Injection – Disposal – Pressure Increase – Enhanced Oil Recovery

☐ WFX☐ PMX☐ SWD☐ IPI☐ EOR☐ PPR2) **NOTIFICATION REQUIRED TO:** Check those which apply.A. ☒ Offset operators or lease holdersB. ☐ Royalty, overriding royalty owners, revenue ownersC. ☐ Application requires published noticeD. ☒ Notification and/or concurrent approval by SLOE. ☒ Notification and/or concurrent approval by BLMF. ☐ Surface ownerG. ☒ For all of the above, proof of notification or publication is attached, and/or,H. ☐ No notice required**FOR OCD ONLY**☐

Notice Complete

☐Application  
Content  
Complete

3) **CERTIFICATION:** I hereby certify that the information submitted with this application for administrative approval is **accurate** and **complete** to the best of my knowledge. I also understand that **no action** will be taken on this application until the required information and notifications are submitted to the Division.

**Note: Statement must be completed by an individual with managerial and/or supervisory capacity.**

Robert Carlson

Print or Type Name

Signature

March 11, 2019

Date

(832) 839-4596

Phone Number

rcarlson@hilcorp.com

e-mail Address





March 11, 2019  
Sent Overnight UPS

New Mexico Oil Conservation Division  
1220 South St. Francis Drive  
Santa Fe, NM 87505

VIA Email: Leonard.Lowe@state.nm.us

Re: Application for Non-Standard Horizontal Spacing Unit  
**Well (Formation):** San Juan 32-7 Unit #249H (Fruitland Coal)  
**API:** 3004535886  
**SHL:** Unit L (NW/SW), 2654' FSL & 421' FWL, Section 9, T32N-R7W  
**FTP:** Unit L (NW/SW), 1553' FSL & 481' FWL, Section 9, T32N-R7W  
**BHL:** Unit E (SW/NW), 2412' FNL & 355' FWL, Section 16, T32N-R7W  
**Horizontal Spacing Unit:** W/2 W/2 Section 9, E/2 E/2 Section 8, NW/4 Section 16,  
T32N, R7W, San Juan County, New Mexico

Dear Mr. Lowe:

Hilcorp Energy Company ("Hilcorp") requests approval of a non-standard horizontal spacing unit ("HSU) for the subject horizontal well pursuant to Paragraph (5) of Subsection B of 19.15.16.15 NMAC.

Paragraph (3) of Subsection B of 19.15.16.15 NMAC, states:

"The horizontal spacing unit shall comprise one or more contiguous tracts that the horizontal gas well's completed interval penetrates, each of which consists of a governmental quarter section or equivalent".

In these circumstances, dedicating a standard quarter section or equivalent to this well is not possible due to the segregating effect the federal unit boundary shared by the San Juan 32-7 Unit and Allison Unit has on Section 9, T32N, R7W. This can be seen on the enclosed map which references one of the equivalent quarter sections in the SW/4 of Section 9 bordered in pink.

Due to this, Hilcorp has formed the following non-standard HSU situated in Township 32 North, Range 7 West which can be seen on the attached map bordered in red:

- Lot 4, NW/4 SW/4, Lot 14 (collectively "W/2 W/2") of Section 9
- Lot 1, NE/4 SE/4, Lot 5 (collectively "E/2 E/2") of Section 8

- NW/4 of Section 16

Approval of this non-standard HSU is necessary to maximize recovery of oil and gas reserves and appropriately limits the acreage dedicated to this well to the Federal Unit in which it is located.

To support this request, the following has been attached:

- 1) Map identifying HSU in relation to Federal Units involved
- 2) List of affected persons

In accordance with Paragraph (4) of Subsection B of 19.15.15.11, Hilcorp has sent a copy of this application/plat, via certified mail, return receipt requested, to all affected persons as of the date reflected on the application. Hilcorp is the Operator of the subject HSU and all adjoining spacing units. Therefore, affected persons are the working interest owners in the San Juan 32-7 Unit and Allison Unit.

The subject HSU does contain federal and state leases. In accordance with Paragraph (4) of Subsection B of 19.15.15.11, a copy of the C-102 was made available to the BLM upon submission of the APD; which the BLM has recently approved. Further, as of the date of this application, a copy of this letter and C-102 have been sent to the State Land Office.

If you have any questions or concerns regarding this matter, please do not hesitate to contact me at the email or number provided below.

Regards,

Hilcorp Energy Company



Robert T. Carlson

Landman

(832) 839-4596

[rcarlson@hilcorp.com](mailto:rcarlson@hilcorp.com)



# Fruitland Coal HSU Reference Map

San Juan 32-7 Unit #249H

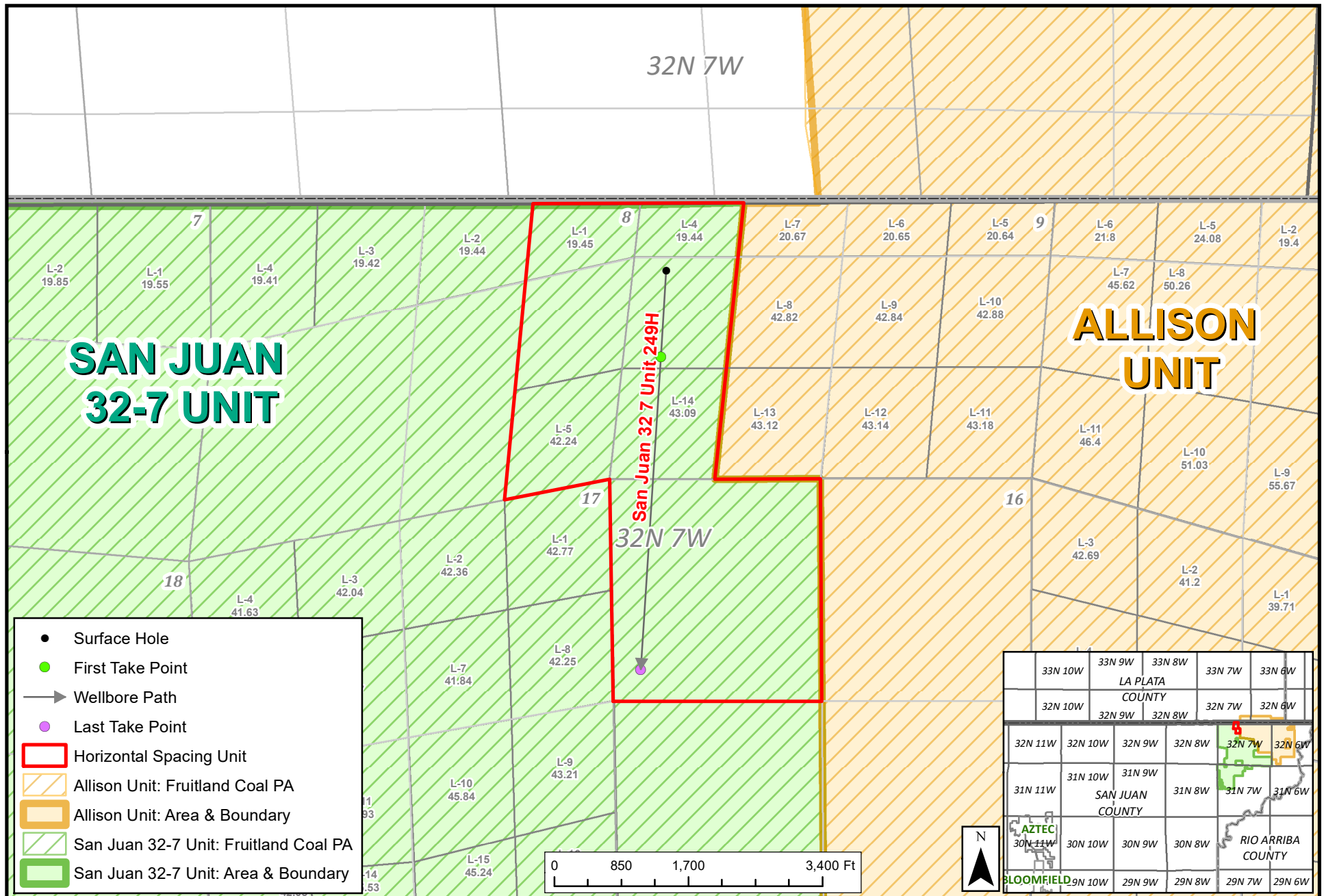

- Surface Hole
- First Take Point
- Wellbore Path
- Last Take Point
- Horizontal Spacing Unit
- Allison Unit: Fruitland Coal PA
- Allison Unit: Area & Boundary
- San Juan 32-7 Unit: Fruitland Coal PA
- San Juan 32-7 Unit: Area & Boundary

0 850 1,700 3,400 Ft

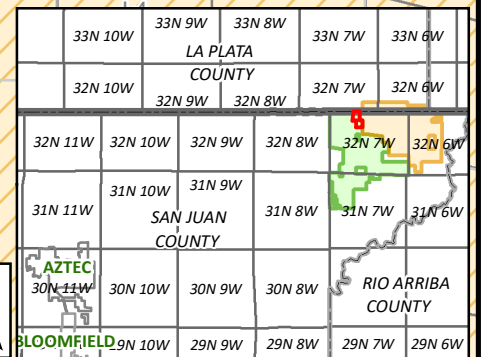

Scale 1:20,000

## U.S. DEPARTMENT OF THE INTERIOR

## BUREAU OF LAND MANAGEMENT

## General Land Office Records

BLM

[Search Documents](#)[Reference Center](#)[Support](#)[Shopping Cart](#)[Search Documents](#) | [Results List](#) | [LSR Details](#)

DM ID: 38537 Document Type: Oil and Gas State: New Mexico Posted Date: 2/1/2019

## Land Status Record Details

## Related Documents

Township / Range:	032.0N - 007.0W
Meridian:	New Mexico Pm
State, Office:	New Mexico State Office
Pages:	1

Sheet: 1

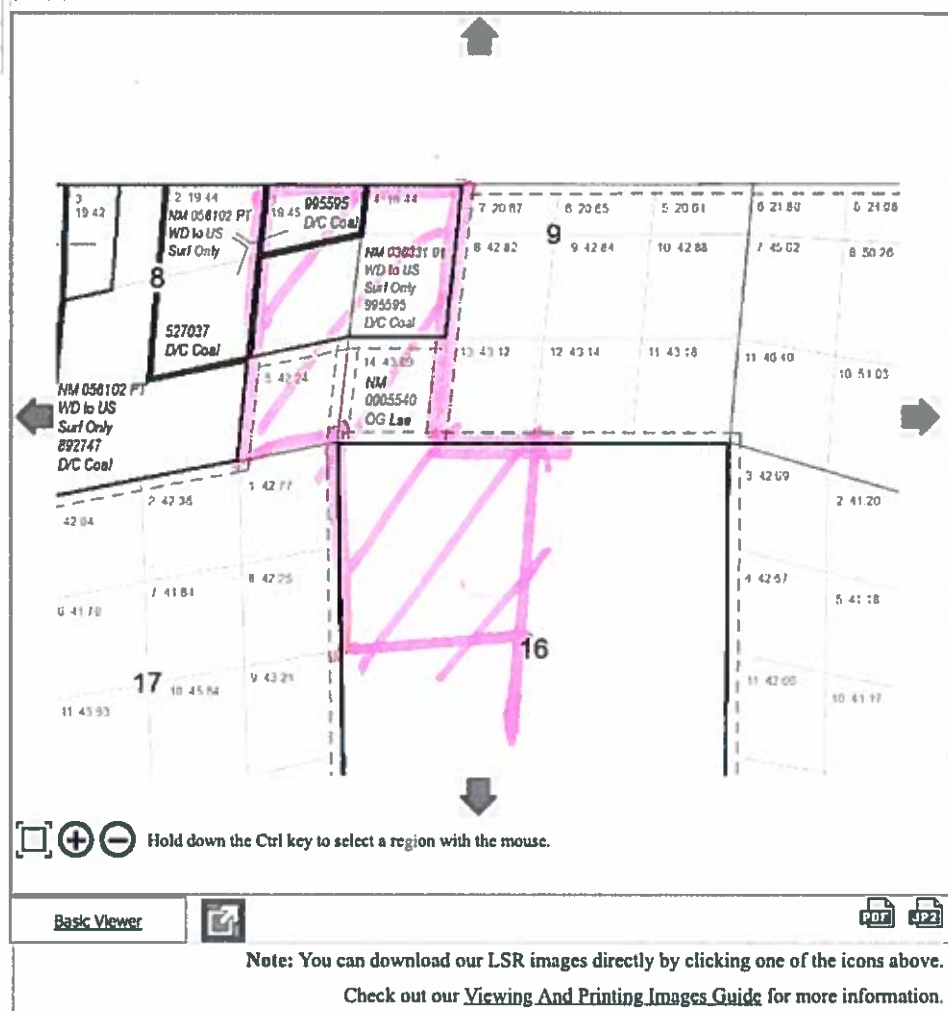



March 11, 2019  
Sent Overnight UPS

OWNER NAME  
ADDRESS  
SUITE  
CITY, ST ZIP

Re: Application for Non-Standard Horizontal Spacing Unit  
**Well (Formation):** San Juan 32-7 Unit #249H (Fruitland Coal)  
**API:** 3004535886  
**SHL:** Unit L (NW/SW), 2654' FSL & 421' FWL, Section 9, T32N-R7W  
**FTP:** Unit L (NW/SW), 1553' FSL & 481' FWL, Section 9, T32N-R7W  
**BHL:** Unit E (SW/NW), 2412' FNL & 355' FWL, Section 16, T32N-R7W  
**Horizontal Spacing Unit:** W/2 W/2 Section 9, E/2 E/2 Section 8, NW/4 Section 16,  
T32N, R7W, San Juan County, New Mexico

**OWNER NAME:**

Hilcorp Energy Company ("Hilcorp"), as Operator, has filed an Application for Non-Standard Horizontal Spacing Unit ("Application") with the New Mexico Oil & Conservation Division ("NMOCD") for the San Juan 32-7 Unit 249H; a horizontal Fruitland Coal well located within the boundary of the San Juan 32-7 Federal Unit.

Paragraph (3) of Subsection B of 19.15.16.15 New Mexico Administrative Code ("NMAC") requires horizontal spacing units be comprised of one or more contiguous tracts consisting of a governmental quarter section or equivalent. As outlined in the enclosed Application and map, **Hilcorp is unable to dedicate a standard quarter section from Section 9, T32N, R7W since all but the W/2 W/2 is located within the Allison Unit.**

Pursuant to Paragraph (3) of Subsection B of 19.15.15.11 NMAC (as amended), Hilcorp is required to provide notification to you, a working interest owner in either 1) the adjoining Allison Unit Fruitland Coal Participating Area, situated in the E/2 W/2 Section 9 of Township 32 North, Range 7 West or 2) the adjoining spacing units situated in the San Juan 32-7 Unit Fruitland Coal Participating Area. If you have an objection to this Application, you must file such in writing with the NMOCD within 20 days from the date of this notice; **however, no action is required on your part if you do not object to this Application.**

If you have any questions or concerns regarding this matter, please do not hesitate to contact me at the email or number provided in the footer below.

Sincerely,

A handwritten signature in blue ink, appearing to read 'Rob Carlson'.

Rob Carlson  
Landman

Certified Number	Sender	Recipient	Date Mailed	Delivery Status
92148969009997901771152070	Dani Papetti	, A E KNITTER, 4323 S LENOX, MILWAUKEE, WI, 53207-5239 Code: SAN JUAN 32-7 249H FC HSU	3/8/2019	Arrived at USPS Regional Origin Facility March 11, 2019 <b>Signature Pending</b>
92148969009997901771152087	Dani Papetti	, ACACIA BUSH, 1017 CHEROKEE RANCH RD, HOLLY HILL, FL, 32117-3125 Code: SAN JUAN 32-7 249H FC HSU	3/8/2019	Arrived at USPS Regional Origin Facility March 11, 2019 <b>Signature Pending</b>
92148969009997901771152094	Dani Papetti	, ACCORD DU LAC PARTNERSHIP LLP, PO BOX 676281, RANCHO SANTA FE, CA, 92067-6281 Code: SAN JUAN 32-7 249H FC HSU	3/8/2019	Arrived at USPS Regional Origin Facility March 11, 2019 <b>Signature Pending</b>
92148969009997901771152100	Dani Papetti	, ADELANTE OIL and GAS LLC, PO BOX 2471, DURANGO, CO, 81302 Code: SAN JUAN 32-7 249H FC HSU	3/8/2019	Arrived at USPS Regional Origin Facility March 11, 2019 <b>Signature Pending</b>
92148969009997901771152117	Dani Papetti	, ALDA LOUISE MILES CURTIS, 403 N WASHINGTON, CORTEZ, CO, 81321 Code: SAN JUAN 32-7 249H FC HSU	3/8/2019	Arrived at USPS Regional Origin Facility March 11, 2019 <b>Signature Pending</b>
92148969009997901771152124	Dani Papetti	, ALEX A MEYER, 2358 RIVERSIDE AVE, JACKSONVILLE, FL, 32204 Code: SAN JUAN 32-7 249H FC HSU	3/8/2019	Arrived at USPS Regional Origin Facility March 11, 2019 <b>Signature Pending</b>
92148969009997901771152131	Dani Papetti	, ALLISON ANDREW COMBINATION TRUST, ALLISON ANDREW, TRUSTEE 1955 VENEZIA, NEW BRAUNFELS, TX, 78132 Code: SAN JUAN 32-7 249H FC HSU	3/8/2019	Arrived at USPS Regional Origin Facility March 11, 2019 <b>Signature Pending</b>
92148969009997901771152148	Dani Papetti	, ALLISON D MEEKER, 752 MEADOWOOD DR, ASPEN, CO, 81611 Code: SAN JUAN 32-7 249H FC HSU	3/8/2019	Arrived at USPS Regional Origin Facility March 11, 2019 <b>Signature Pending</b>
92148969009997901771152155	Dani Papetti	, ALLISON L KROEGER, 3408 MONTE MORO RD, KINGMAN, AZ, 86401 Code: SAN JUAN 32-7 249H FC HSU	3/8/2019	Arrived at USPS Regional Origin Facility March 11, 2019 <b>Signature Pending</b>
92148969009997901771152162	Dani Papetti	, ALVIN DEWEY BAKER JR, PO BOX 12992, EL PASO, TX, 79913-0992 Code: SAN JUAN 32-7 249H FC HSU	3/8/2019	Arrived at USPS Regional Origin Facility March 11, 2019 <b>Signature Pending</b>
92148969009997901771152179	Dani Papetti	, AMANDA MAE TAFOYA, 1304 N FAIRVIEW ST, FARMINGTON, NM, 87401 Code: SAN JUAN 32-7 249H FC HSU	3/8/2019	Departed USPS Regional Origin Facility March 11, 2019 <b>Signature Pending</b>
92148969009997901771152186	Dani Papetti	, AMELIA C KELLY, 1181 HEMLOCK AVE SW, NORTH BEND, WA, 98045 Code: SAN JUAN 32-7 249H FC HSU	3/8/2019	Arrived at USPS Regional Origin Facility March 11, 2019 <b>Signature Pending</b>
92148969009997901771152193	Dani Papetti	, ANABEL FORD, 727 E ANAPAMU ST, SANTA BARBARA, CA, 93103 Code: SAN JUAN 32-7 249H FC HSU	3/8/2019	Arrived at USPS Regional Origin Facility March 11, 2019 <b>Signature Pending</b>
92148969009997901771152209	Dani Papetti	, ANDREW B KELLY JR, 650 GLENDALOUGH CT, ALPHARETTA, GA, 30004 Code: SAN JUAN 32-7 249H FC HSU	3/8/2019	Arrived at USPS Regional Origin Facility March 11, 2019 <b>Signature Pending</b>
92148969009997901771152216	Dani Papetti	, ANGALENE FINLAY, 11605 BLUE RIBBON RD SE, ALBUQUERQUE, NM, 87123 Code: SAN JUAN 32-7 249H FC HSU	3/8/2019	Arrived at USPS Regional Origin Facility March 11, 2019 <b>Signature Pending</b>
92148969009997901771152223	Dani Papetti	, ANITA MCDONALD, 1301 SUNNY HILL CT., BETTENDORF, IA, 52722 Code: SAN JUAN 32-7 249H FC HSU	3/8/2019	Arrived at USPS Regional Origin Facility March 11, 2019 <b>Signature Pending</b>
92148969009997901771152230	Dani Papetti	, ANN E MOHAGERI, 1222 228TH PL SW, BOTHELL, WA, 98021 Code: SAN JUAN 32-7 249H FC HSU	3/8/2019	Arrived at USPS Regional Origin Facility March 11, 2019 <b>Signature Pending</b>
92148969009997901771152247	Dani Papetti	, ANN STEVENS, 7713 AMERICAN HERITAGE NE, ALBUQUERQUE, NM, 87109 Code: SAN JUAN 32-7 249H FC HSU	3/8/2019	Arrived at USPS Regional Origin Facility March 11, 2019 <b>Signature Pending</b>
92148969009997901771152254	Dani Papetti	, ANNA MAY VOLLBRECHT, 6058 E PINE ST, LODI, CA, 95240-0816 Code: SAN JUAN 32-7 249H FC HSU	3/8/2019	Arrived at USPS Regional Origin Facility March 11, 2019 <b>Signature Pending</b>



92148969009997901771152261	Dani Papetti	, ANNA PAULINE SWEARINGEN, 442 ROCK RD, JAMESTOWN, KS, 66948 Code: SAN JUAN 32-7 249H FC HSU	3/8/2019	Arrived at USPS Regional Origin Facility March 11, 2019 <b>Signature Pending</b>
92148969009997901771152278	Dani Papetti	, ANNE C S FINNEY REVOC TRUST, 4 3 2002 ANNE C S FINNEY TRUSTEE PO BOX 2471, DURANGO, CO, 81302 Code: SAN JUAN 32-7 249H FC HSU	3/8/2019	Arrived at USPS Regional Origin Facility March 11, 2019 <b>Signature Pending</b>
92148969009997901771152285	Dani Papetti	, ARCHIE DON YOUNG, 8922 CO RD 321, IGNACIO, CO, 81137 Code: SAN JUAN 32-7 249H FC HSU	3/8/2019	Arrived at USPS Regional Origin Facility March 11, 2019 <b>Signature Pending</b>
92148969009997901771152292	Dani Papetti	, ARLENE LOLA CAIRE, 7000 NW 17TH ST, PLANTATION, FL, 33313-5264 Code: SAN JUAN 32-7 249H FC HSU	3/8/2019	Arrived at USPS Regional Origin Facility March 11, 2019 <b>Signature Pending</b>
92148969009997901771152308	Dani Papetti	, ARLENE M REA, 1911 CR 309A, IGNACIO, CO, 81137 Code: SAN JUAN 32-7 249H FC HSU	3/8/2019	Arrived at USPS Regional Origin Facility March 11, 2019 <b>Signature Pending</b>
92148969009997901771152315	Dani Papetti	, ARTHUR C SCHROEDER, 4971 PASEO DALI, IRVINE, CA, 92612-3321 Code: SAN JUAN 32-7 249H FC HSU	3/8/2019	Arrived at USPS Regional Origin Facility March 11, 2019 <b>Signature Pending</b>
92148969009997901771152322	Dani Papetti	, ARTHUR E SHOTTS, PO BOX 506, WEATHERFORD, OK, 73096-0506 Code: SAN JUAN 32-7 249H FC HSU	3/8/2019	Arrived at USPS Regional Origin Facility March 11, 2019 <b>Signature Pending</b>
92148969009997901771152339	Dani Papetti	, ARTHUR J MACHACEK, 1229 BIRCH ST, BUHL, ID, 83316 Code: SAN JUAN 32-7 249H FC HSU	3/8/2019	Arrived at USPS Regional Origin Facility March 11, 2019 <b>Signature Pending</b>
92148969009997901771152346	Dani Papetti	, ATKO PARTNERS LTD, 260 IH 45 S, HUNTSVILLE, TX, 77340 Code: SAN JUAN 32-7 249H FC HSU	3/8/2019	Arrived at USPS Regional Facility March 11, 2019 <b>Signature Pending</b>
92148969009997901771152353	Dani Papetti	, ATLANTIC PARTNERS, PO BOX 3759, MIDLAND, TX, 79702 Code: SAN JUAN 32-7 249H FC HSU	3/8/2019	Arrived at USPS Regional Origin Facility March 11, 2019 <b>Signature Pending</b>
92148969009997901771152360	Dani Papetti	, AUGUSTA L SCHROEDER, 4971 PASEO DALI, IRVINE, CA, 92603 Code: SAN JUAN 32-7 249H FC HSU	3/8/2019	Arrived at USPS Regional Origin Facility March 11, 2019 <b>Signature Pending</b>
92148969009997901771152377	Dani Papetti	, AVA D TRUJILLO, 1568 CNTY RD 327, IGNACIO, CO, 81137-9618 Code: SAN JUAN 32-7 249H FC HSU	3/8/2019	Arrived at USPS Regional Origin Facility March 11, 2019 <b>Signature Pending</b>
92148969009997901771152384	Dani Papetti	, B2 ENERGY LLC, PO BOX 630825, HIGHLANDS RANCH, CO, 80163 Code: SAN JUAN 32-7 249H FC HSU	3/8/2019	Arrived at USPS Regional Origin Facility March 11, 2019 <b>Signature Pending</b>
92148969009997901771152391	Dani Papetti	, BADON HILL INC, 6300 RIDGLEA PLACE SUITE 950, FORT WORTH, TX, 76116-5704 Code: SAN JUAN 32-7 249H FC HSU	3/8/2019	Arrived at USPS Regional Origin Facility March 11, 2019 <b>Signature Pending</b>
92148969009997901771152407	Dani Papetti	, BALANCING OWNER, MISSING ADDRESS, , , 77208-1229 Code: SAN JUAN 32-7 249H FC HSU	3/8/2019	Pre-Shipment Info Sent to USPS, USPS Awaiting Item March 8, 2019 <b>Signature Pending</b>
92148969009997901771152414	Dani Papetti	, BAR KR INVESTMENTS LLLP, PO BOX 2964, DURANGO, CO, 81302 Code: SAN JUAN 32-7 249H FC HSU	3/8/2019	Arrived at USPS Regional Origin Facility March 11, 2019 <b>Signature Pending</b>
92148969009997901771152421	Dani Papetti	, BARBARA ABEYTA, 4771 MT ST HELENS DR, SAN DIEGO, CA, 92117 Code: SAN JUAN 32-7 249H FC HSU	3/8/2019	Arrived at USPS Regional Origin Facility March 11, 2019 <b>Signature Pending</b>
92148969009997901771152438	Dani Papetti	, BARBARA G SMITH, PO BOX 375, REEDSPORT, OR, 97467 Code: SAN JUAN 32-7 249H FC HSU	3/8/2019	Arrived at USPS Regional Origin Facility March 11, 2019 <b>Signature Pending</b>
92148969009997901771152445	Dani Papetti	, BARBARA GRAHAM, 3570 REVERE CT EAST, WELLINGTON, CO, 80549 Code: SAN JUAN 32-7 249H FC HSU	3/8/2019	Arrived at USPS Regional Origin Facility March 11, 2019 <b>Signature Pending</b>
92148969009997901771152452	Dani Papetti	, BARBARA J SWEARINGEN TR AUG 13 1999, BARBARA J SWEARINGEN and 2535 STONEPOST	3/8/2019	Arrived at USPS Regional Origin Facility

		LN, SALINA, KS, 67401 Code: SAN JUAN 32-7 249H FC HSU		March 11, 2019 <b>Signature Pending</b>
92148969009997901771152469	Dani Papetti	, BARBARA PEACE, 10400 2ND ST, ALBUQUERQUE, NM, 87114 Code: SAN JUAN 32-7 249H FC HSU	3/8/2019	Arrived at USPS Regional Origin Facility March 11, 2019 <b>Signature Pending</b>
92148969009997901771152476	Dani Papetti	, BAYARD WALKER OIL TRUST, JOHN A THIEKE and DAVIS S CROCKETT JR CO-TRSTEES LAKESIDE SQUARE 12, DALLAS, TX, 75251-2249 Code: SAN JUAN 32-7 249H FC HSU	3/8/2019	Departed USPS Regional Origin Facility March 11, 2019 <b>Signature Pending</b>
92148969009997901771152483	Dani Papetti	, BECKY WILKINS, 6951 GREENSVIEW VILLAGE, CANAL WINCHESTER, OH, 43110 Code: SAN JUAN 32-7 249H FC HSU	3/8/2019	Arrived at USPS Regional Origin Facility March 11, 2019 <b>Signature Pending</b>
92148969009997901771152490	Dani Papetti	, BELMONT SISTERS LP, BANK OF AMERICA NA AGENT PO BOX 840738, DALLAS, TX, 75284-0738 Code: SAN JUAN 32-7 249H FC HSU	3/8/2019	Arrived at USPS Regional Origin Facility March 11, 2019 <b>Signature Pending</b>
92148969009997901771152506	Dani Papetti	, BERNICE SNYDER, 5543 1/2 HAROLD WAY, HOLLYWOOD, CA, 90028-6763 Code: SAN JUAN 32-7 249H FC HSU	3/8/2019	Arrived at USPS Regional Origin Facility March 11, 2019 <b>Signature Pending</b>
92148969009997901771152513	Dani Papetti	, BESSIE CUNNINGHAM, C/O MAXINE WYNN 505 N DIVISION #55, CHARLESTON, IL, 61920-1030 Code: SAN JUAN 32-7 249H FC HSU	3/8/2019	Arrived at USPS Regional Origin Facility March 11, 2019 <b>Signature Pending</b>
92148969009997901771152520	Dani Papetti	, BESSIE LAVOLD, 1113 CONSTITUTION, PUEBLO, CO, 81001-2104 Code: SAN JUAN 32-7 249H FC HSU	3/8/2019	Pre-Shipment Info Sent to USPS, USPS Awaiting Item March 8, 2019 <b>Signature Pending</b>
92148969009997901771152537	Dani Papetti	, BETSY J BRUEMLEVE, 229 LINCOLN DR, CELINA, OH, 45822 Code: SAN JUAN 32-7 249H FC HSU	3/8/2019	Arrived at USPS Regional Origin Facility March 11, 2019 <b>Signature Pending</b>
92148969009997901771152544	Dani Papetti	, BETTY A PENNINGTON, 48255 E 88TH AVE, BENNETT, CO, 80102 Code: SAN JUAN 32-7 249H FC HSU	3/8/2019	Arrived at USPS Regional Origin Facility March 11, 2019 <b>Signature Pending</b>
92148969009997901771152551	Dani Papetti	, BETTY J FAVERINO, 1004 CIMMARON ST, AZTEC, NM, 87410-1655 Code: SAN JUAN 32-7 249H FC HSU	3/8/2019	Arrived at USPS Regional Origin Facility March 11, 2019 <b>Signature Pending</b>
92148969009997901771152568	Dani Papetti	, BETTY T JOHNSTON MARITAL TRUST, BETTY T JOHNSTON, TOM N AUNE, PATRICIA E AUNE, CO-TRUSTEES 17347 VI, HOUSTON, TX, 77040 Code: SAN JUAN 32-7 249H FC HSU	3/8/2019	Arrived at USPS Regional Facility March 11, 2019 <b>Signature Pending</b>
92148969009997901771152575	Dani Papetti	, BEVERLY J JONES, 825 N EDITH, CORTEZ, CO, 81321 Code: SAN JUAN 32-7 249H FC HSU	3/8/2019	Arrived at USPS Regional Origin Facility March 11, 2019 <b>Signature Pending</b>
92148969009997901771152582	Dani Papetti	, BEVERLY LEWIS, 915 JERLYNN AVE, DES MOINES, IA, 50313 Code: SAN JUAN 32-7 249H FC HSU	3/8/2019	Arrived at USPS Regional Origin Facility March 11, 2019 <b>Signature Pending</b>
92148969009997901771152599	Dani Papetti	, BILLIE JEAN FAVERINO, 2170 THYME DR, CORONA, CA, 92879 Code: SAN JUAN 32-7 249H FC HSU	3/8/2019	Arrived at USPS Regional Origin Facility March 11, 2019 <b>Signature Pending</b>
92148969009997901771152605	Dani Papetti	, BLACK STONE MINERALS CO LP, P O BOX 301267, DALLAS, TX, 75303-1267 Code: SAN JUAN 32-7 249H FC HSU	3/8/2019	Arrived at USPS Regional Facility March 11, 2019 <b>Signature Pending</b>
92148969009997901771152612	Dani Papetti	, BLOSSOM P MCBRIER 2011 REV TRUST, BLOSSOM P MCBRIER TRUSTEE 6721 BRIER HILL RD, FAIRVIEW, PA, 16415 Code: SAN JUAN 32-7 249H FC HSU	3/8/2019	Arrived at USPS Regional Origin Facility March 11, 2019 <b>Signature Pending</b>
92148969009997901771152629	Dani Papetti	, BONE SPRINGS LLC, 402 GAMMON PL STE 200, MADISON, WI, 53719 Code: SAN JUAN 32-7 249H FC HSU	3/8/2019	Arrived at USPS Regional Origin Facility March 11, 2019 <b>Signature Pending</b>
92148969009997901771152636	Dani Papetti	, BRAD HENKLE, 1233 N FLORES ST #203, WEST HOLLYWOOD, CA, 90069 Code: SAN JUAN 32-7 249H FC HSU	3/8/2019	Arrived at USPS Regional Origin Facility March 11, 2019 <b>Signature Pending</b>
92148969009997901771152643	Dani Papetti	, BRADLEY STEPHEN CLARK, 2062 E 1130N, DEMOTTE, IN, 46310 Code: SAN JUAN 32-7 249H FC HSU	3/8/2019	Arrived at USPS Regional Origin Facility March 11, 2019 <b>Signature Pending</b>

92148969009997901771152650	Dani Papetti	, BRIDGET AGNES GUAGLIARDI, TOURLESTRANE BALLYMOTE, CO SLIGO, IE, 77208-1229 Code: SAN JUAN 32-7 249H FC HSU	3/8/2019	Departed USPS Regional Facility March 11, 2019 <b>Signature Pending</b>
92148969009997901771152667	Dani Papetti	, BROWNE FAMILY REVOC TRUST 8-7-2013, MARSHALL BROWNE and SHARON BROWNE CO TRUSTEES 3473 KIMBERLY RD, CAMERON PARK, CA, 95682 Code: SAN JUAN 32-7 249H FC HSU	3/8/2019	Arrived at USPS Regional Origin Facility March 11, 2019 <b>Signature Pending</b>
92148969009997901771152674	Dani Papetti	, C ANN C LLC, 1237 N CHACO AVE, FARMINGTON, NM, 87401-7003 Code: SAN JUAN 32-7 249H FC HSU	3/8/2019	Arrived at USPS Regional Origin Facility March 11, 2019 <b>Signature Pending</b>
92148969009997901771152681	Dani Papetti	, CARL SELF, PO BOX 237, HERALD, CA, 95638 Code: SAN JUAN 32-7 249H FC HSU	3/8/2019	Arrived at USPS Regional Origin Facility March 11, 2019 <b>Signature Pending</b>
92148969009997901771152698	Dani Papetti	, CARNEGIE ENERGY LLC, 4925 GREENVILLE AVE SUITE 200, DALLAS, TX, 75206 Code: SAN JUAN 32-7 249H FC HSU	3/8/2019	Arrived at USPS Regional Origin Facility March 11, 2019 <b>Signature Pending</b>
92148969009997901771152704	Dani Papetti	, CAROL CONRY HALL, 17827 OAK CLUSTER CT, CYPRESS, TX, 77429-1561 Code: SAN JUAN 32-7 249H FC HSU	3/8/2019	Arrived at USPS Regional Facility March 11, 2019 <b>Signature Pending</b>
92148969009997901771152711	Dani Papetti	, CAROLYN NIELSEN SEDBERRY REV TR, CAROLYN NIELSEN SEDBERRY TTEE JOHN B SEDBERRY POA FOR TTEE PO BOX 12, FARMINGTON, NM, 87499-1258 Code: SAN JUAN 32-7 249H FC HSU	3/8/2019	Arrived at USPS Regional Origin Facility March 11, 2019 <b>Signature Pending</b>
92148969009997901771152728	Dani Papetti	, CATAMOUNT ENERGY PARTNERS LLC, 1801 BROADWAY #1000, DENVER, CO, 80202 Code: SAN JUAN 32-7 249H FC HSU	3/8/2019	Arrived at USPS Regional Origin Facility March 11, 2019 <b>Signature Pending</b>
92148969009997901771152735	Dani Papetti	, CECILIA E FORD, 618 CHAPMAN ST, MADISON, WI, 53711 Code: SAN JUAN 32-7 249H FC HSU	3/8/2019	Departed USPS Regional Origin Facility March 11, 2019 <b>Signature Pending</b>
92148969009997901771152742	Dani Papetti	, CEEFAM LLC, PO BOX 1258, FARMINGTON, NM, 87499 Code: SAN JUAN 32-7 249H FC HSU	3/8/2019	Arrived at USPS Regional Origin Facility March 11, 2019 <b>Signature Pending</b>
92148969009997901771152759	Dani Papetti	, CELESTINO R LOPEZ, PO BOX 90, IGNACIO, CO, 81137-0090 Code: SAN JUAN 32-7 249H FC HSU	3/8/2019	Arrived at USPS Regional Origin Facility March 11, 2019 <b>Signature Pending</b>
92148969009997901771152766	Dani Papetti	, CHARLES and ANN HATHOOT LLC, 606 N SEPULVEDA BLVD, MANHATTAN BEACH, CA, 90266 Code: SAN JUAN 32-7 249H FC HSU	3/8/2019	Arrived at USPS Regional Origin Facility March 11, 2019 <b>Signature Pending</b>
92148969009997901771152773	Dani Papetti	, CHARLES R CLARK, 18301 N 24 20TH ST, MARSHALL, IL, 62441 Code: SAN JUAN 32-7 249H FC HSU	3/8/2019	Arrived at USPS Regional Origin Facility March 11, 2019 <b>Signature Pending</b>
92148969009997901771152780	Dani Papetti	, CHARLES R GOULDING, PO BOX 1034, BLACK CANYON CITY, AZ, 85324-1034 Code: SAN JUAN 32-7 249H FC HSU	3/8/2019	Arrived at USPS Regional Origin Facility March 11, 2019 <b>Signature Pending</b>
92148969009997901771152797	Dani Papetti	, CHARLES R WEDDLE, PO BOX 241, KAMIAH, ID, 83536 Code: SAN JUAN 32-7 249H FC HSU	3/8/2019	Arrived at USPS Regional Origin Facility March 11, 2019 <b>Signature Pending</b>
92148969009997901771152803	Dani Papetti	, CHARLES W GAY, PO BOX 291445, KERRVILLE, TX, 78029-1445 Code: SAN JUAN 32-7 249H FC HSU	3/8/2019	Arrived at USPS Regional Origin Facility March 11, 2019 <b>Signature Pending</b>
92148969009997901771152810	Dani Papetti	, CHARLES W SMITH, 10559 NORTON ST, HOUSTON, TX, 77043-2014 Code: SAN JUAN 32-7 249H FC HSU	3/8/2019	Arrived at USPS Regional Facility March 11, 2019 <b>Signature Pending</b>
92148969009997901771152827	Dani Papetti	, CHARLIE D SELF FMLY TR, CHARLIE DON SELF TRUSTEE 225 CR 4020, IGNACIO, CO, 81137-9401 Code: SAN JUAN 32-7 249H FC HSU	3/8/2019	Arrived at USPS Regional Origin Facility March 11, 2019 <b>Signature Pending</b>
92148969009997901771152834	Dani Papetti	, CHARLOTTE E WELLS and, KAIULANI L BUMPUS JT 900 BROKEN FEATHER TRAIL #219, PFLUGERVILLE, TX, 78660 Code: SAN JUAN 32-7 249H FC HSU	3/8/2019	Arrived at USPS Regional Origin Facility March 11, 2019 <b>Signature Pending</b>
92148969009997901771152841	Dani Papetti	, CHERI H PERIMAN, and ROY LYNN DONAN JT 2306 HERMOSA AVE, DURANGO, CO, 81301	3/8/2019	Arrived at USPS Regional Origin Facility March 11, 2019

		Code: SAN JUAN 32-7 249H FC HSU		<b>Signature Pending</b>
92148969009997901771152858	Dani Papetti	, CHEROKEE LEGACY MINERALS LTD, PO BOX 3217, ALBANY, TX, 76430 Code: SAN JUAN 32-7 249H FC HSU	3/8/2019	Arrived at USPS Regional Origin Facility March 11, 2019 <b>Signature Pending</b>
92148969009997901771152865	Dani Papetti	, CHERYL DUFF COMBINATION TRUST, CHERLY ANDREW DUFF TTEE 5105 TANGLE LN, HOUSTON, TX, 77056 Code: SAN JUAN 32-7 249H FC HSU	3/8/2019	Arrived at USPS Regional Facility March 11, 2019 <b>Signature Pending</b>
92148969009997901771152872	Dani Papetti	, CHERYL HAFFER, 1809 GEKELER LN #157, LA GRANDE, OR, 97850 Code: SAN JUAN 32-7 249H FC HSU	3/8/2019	Departed USPS Regional Origin Facility March 11, 2019 <b>Signature Pending</b>
92148969009997901771152889	Dani Papetti	, CHIEFTAIN ROYALTY COMPANY, PO BOX 18441, OKLAHOMA CITY, OK, 73154 Code: SAN JUAN 32-7 249H FC HSU	3/8/2019	Arrived at USPS Regional Origin Facility March 11, 2019 <b>Signature Pending</b>
92148969009997901771152896	Dani Papetti	, CHRISTOPHER FAVERINO, 640 PIONEER AVE, AZTEC, NM, 87410 Code: SAN JUAN 32-7 249H FC HSU	3/8/2019	Arrived at USPS Regional Origin Facility March 11, 2019 <b>Signature Pending</b>
92148969009997901771152902	Dani Papetti	, CHRISTOPHER RAY HUNT, 3827 HERBERT ST, SAN DIEGO, CA, 92103 Code: SAN JUAN 32-7 249H FC HSU	3/8/2019	Departed USPS Regional Origin Facility March 11, 2019 <b>Signature Pending</b>
92148969009997901771152919	Dani Papetti	, CLAUDIA MARCIA LUNDELL GILMER, 1102 S AUSTIN AVE, GEORGETOWN, TX, 78626 Code: SAN JUAN 32-7 249H FC HSU	3/8/2019	Arrived at USPS Regional Origin Facility March 11, 2019 <b>Signature Pending</b>
92148969009997901771152926	Dani Papetti	, CLAY JOHNSON, 1603 N BIG SPRING, MIDLAND, TX, 79701 Code: SAN JUAN 32-7 249H FC HSU	3/8/2019	Arrived at USPS Regional Origin Facility March 11, 2019 <b>Signature Pending</b>
92148969009997901771152933	Dani Papetti	, CLEAR FORK MINERALS LLC, 6300 RIDGLEA PLACE SUITE 950, FORT WORTH, TX, 76116-5407 Code: SAN JUAN 32-7 249H FC HSU	3/8/2019	Arrived at USPS Regional Origin Facility March 11, 2019 <b>Signature Pending</b>
92148969009997901771152940	Dani Papetti	, CLEAR FORK ROYALTY 3 LP, 6300 RIDGLEA PLACE SUITE 950, FORT WORTH, TX, 76116-5407 Code: SAN JUAN 32-7 249H FC HSU	3/8/2019	Arrived at USPS Regional Origin Facility March 11, 2019 <b>Signature Pending</b>
92148969009997901771152957	Dani Papetti	, CLEAR FORK ROYALTY II LP, 6300 RIDGLEA PLACE SUITE 950, FORT WORTH, TX, 76116-5407 Code: SAN JUAN 32-7 249H FC HSU	3/8/2019	Arrived at USPS Regional Origin Facility March 11, 2019 <b>Signature Pending</b>
92148969009997901771152964	Dani Papetti	, CLEO GARCIA ESTATE, C/O ROBERT S LOPEZ PO BOX 143, IGNACIO, CO, 81137 Code: SAN JUAN 32-7 249H FC HSU	3/8/2019	Arrived at USPS Regional Origin Facility March 11, 2019 <b>Signature Pending</b>
92148969009997901771152971	Dani Papetti	, COCHRAN FAMILY TRUST JULY 24 2008, RUSSELL T COCHRAN and BARBARA STERNS COCHRAN TRUSTEES 18941 CEDAR VA, SANTA CLARITA, CA, 91321 Code: SAN JUAN 32-7 249H FC HSU	3/8/2019	Arrived at USPS Regional Origin Facility March 11, 2019 <b>Signature Pending</b>
92148969009997901771152988	Dani Papetti	, COLLEEN A COKER, 44807 N 12TH ST, NEW RIVER, AZ, 85087 Code: SAN JUAN 32-7 249H FC HSU	3/8/2019	Arrived at USPS Regional Origin Facility March 11, 2019 <b>Signature Pending</b>
92148969009997901771152995	Dani Papetti	, CONNIE L PEEVEY, PO BOX 128, AZTEC, NM, 87410 Code: SAN JUAN 32-7 249H FC HSU	3/8/2019	Arrived at USPS Regional Origin Facility March 11, 2019 <b>Signature Pending</b>
92148969009997901771153008	Dani Papetti	, CONSTANCE Z HUFF, 175 BLUEJAY WAY, SANTA ROSA, CA, 95409 Code: SAN JUAN 32-7 249H FC HSU	3/8/2019	Departed USPS Regional Origin Facility March 11, 2019 <b>Signature Pending</b>
92148969009997901771153015	Dani Papetti	, COREY HENKLE, 1210 3RD ST, MANHATTAN BEACH, CA, 90266 Code: SAN JUAN 32-7 249H FC HSU	3/8/2019	Departed USPS Regional Origin Facility March 11, 2019 <b>Signature Pending</b>
92148969009997901771153022	Dani Papetti	, CORRINE LAWRENCE BERKE, 5 FOUNTAIN GROVE CIR, NAPA, CA, 94558-2400 Code: SAN JUAN 32-7 249H FC HSU	3/8/2019	Departed USPS Regional Origin Facility March 11, 2019 <b>Signature Pending</b>
92148969009997901771153039	Dani Papetti	, CRAIG COLLINS and, SHERYL COLLINS 3209 SW BELLE AVE, TOPEKA, KS, 66614-4027 Code: SAN JUAN 32-7 249H FC HSU	3/8/2019	Arrived at USPS Regional Origin Facility March 11, 2019

				Signature Pending
92148969009997901771153046	Dani Papetti	, CURTIS JOHN GOODKNIGHT, 1520 KENDALL DR, BOULDER, CO, 80305 Code: SAN JUAN 32-7 249H FC HSU	3/8/2019	Arrived at USPS Regional Origin Facility March 11, 2019 Signature Pending
92148969009997901771153053	Dani Papetti	, CYRENE INMAN, BANK OF AMERICA NA PO BOX 840738, DALLAS, TX, 75284-0738 Code: SAN JUAN 32-7 249H FC HSU	3/8/2019	Arrived at USPS Regional Origin Facility March 11, 2019 Signature Pending
92148969009997901771153060	Dani Papetti	, DALE A and MARY ANN YOUNG REVOCABLE, LVG TR DTD SEPT 29 1989 4014 15TH ST LN, GREELEY, CO, 80634-2760 Code: SAN JUAN 32-7 249H FC HSU	3/8/2019	Arrived at USPS Regional Origin Facility March 11, 2019 Signature Pending
92148969009997901771153077	Dani Papetti	, DALE I MULLEN, and LINDA MULLEN JT 35 LARKSPUR PL, PARACHUTE, CO, 81635 Code: SAN JUAN 32-7 249H FC HSU	3/8/2019	Arrived at USPS Regional Origin Facility March 11, 2019 Signature Pending
92148969009997901771153084	Dani Papetti	, DALE RICHARDSON, 5824 E 15TH TER, KANSAS CITY, MO, 64126-2452 Code: SAN JUAN 32-7 249H FC HSU	3/8/2019	Arrived at USPS Regional Origin Facility March 11, 2019 Signature Pending
92148969009997901771153091	Dani Papetti	, DANIEL C PIRTLE ESTATE, JERRY GOTTLIEB PERSONAL REP 2475 ENTERPRISE RD STE 100, CLEARWATER, FL, 33763-1733 Code: SAN JUAN 32-7 249H FC HSU	3/8/2019	Arrived at USPS Regional Origin Facility March 11, 2019 Signature Pending
92148969009997901771153107	Dani Papetti	, DARLENE PEARSON, 1107 OAKMONT, HAYS, KS, 67601-1823 Code: SAN JUAN 32-7 249H FC HSU	3/8/2019	Arrived at USPS Regional Origin Facility March 11, 2019 Signature Pending
92148969009997901771153114	Dani Papetti	, DARRELL L WEDDLE, 135 FORT MISERY RD, KAMIAH, ID, 83536 Code: SAN JUAN 32-7 249H FC HSU	3/8/2019	Arrived at USPS Regional Origin Facility March 11, 2019 Signature Pending
92148969009997901771153121	Dani Papetti	, DAVID A BARRY, 211 MARSH ST, BELMONT, MA, 02478 Code: SAN JUAN 32-7 249H FC HSU	3/8/2019	Arrived at USPS Regional Origin Facility March 11, 2019 Signature Pending
92148969009997901771153138	Dani Papetti	, DAVID A JENNINGS, BILLY EDWARDS AIF PO BOX 117, ABILENE, TX, 79604 Code: SAN JUAN 32-7 249H FC HSU	3/8/2019	Arrived at USPS Regional Origin Facility March 11, 2019 Signature Pending
92148969009997901771153145	Dani Papetti	, DAVID B BROWN, 5216 BLUE CYPRESS LN, LEAGUE CITY, TX, 77573 Code: SAN JUAN 32-7 249H FC HSU	3/8/2019	Arrived at USPS Regional Facility March 11, 2019 Signature Pending
92148969009997901771153152	Dani Papetti	, DAVID B CLARK, 1934 GEFFS AVE, FINDLAY, OH, 45840 Code: SAN JUAN 32-7 249H FC HSU	3/8/2019	Arrived at USPS Regional Origin Facility March 11, 2019 Signature Pending
92148969009997901771153169	Dani Papetti	, DAVID B WHITEHILL, DBA WHITEHILL FAMILY ROYALTY CO LLC 1 E 22ND ST, TULSA, OK, 74114 Code: SAN JUAN 32-7 249H FC HSU	3/8/2019	Arrived at USPS Regional Origin Facility March 11, 2019 Signature Pending
92148969009997901771153176	Dani Papetti	, DAVID HERRERA, 1209 FEARNOW AVE, PUEBLO, CO, 81101 Code: SAN JUAN 32-7 249H FC HSU	3/8/2019	Arrived at USPS Regional Origin Facility March 11, 2019 Signature Pending
92148969009997901771153183	Dani Papetti	, DAVID J MARTINEZ DECD, PO BOX 937, RANCHO SANTA FE, CA, 92067-0937 Code: SAN JUAN 32-7 249H FC HSU	3/8/2019	Arrived at USPS Regional Origin Facility March 11, 2019 Signature Pending
92148969009997901771153190	Dani Papetti	, DAVID KEITH ROBERTS, SOLE and SEPARATE PROPERTY PO BOX 2203, RUIDOSO, NM, 88355 Code: SAN JUAN 32-7 249H FC HSU	3/8/2019	Arrived at USPS Regional Origin Facility March 11, 2019 Signature Pending
92148969009997901771153206	Dani Papetti	, DAVID PIERCE and MAXINE PIERCE REV TR, DAVID PIERCE and MAXINE PIERCE TTEES PO BOX 4140, FARMINGTON, NM, 87499-4140 Code: SAN JUAN 32-7 249H FC HSU	3/8/2019	Arrived at USPS Regional Origin Facility March 11, 2019 Signature Pending
92148969009997901771153213	Dani Papetti	, DAVID ROYCE CHAMBERS, 314 MANTZ AVE, AUDUBON, IA, 50025 Code: SAN JUAN 32-7 249H FC HSU	3/8/2019	Arrived at USPS Regional Origin Facility March 11, 2019 Signature Pending
92148969009997901771153220	Dani Papetti	, DAVIES FAMILY TRUST DTD 11-21-91, OPAL C DAVIES TRTEE 7222 S ATLANTA AVE, TULSA, OK, 74136 Code: SAN JUAN 32-7 249H FC HSU	3/8/2019	Arrived at USPS Regional Origin Facility March 11, 2019 Signature Pending
		, DEAN CLARK, 515 SCOTT AVE, FINDLAY, OH,		Arrived at USPS Regional Origin



92148969009997901771153237	Dani Papetti	45840 Code: SAN JUAN 32-7 249H FC HSU	3/8/2019	Facility March 11, 2019 <b>Signature Pending</b>
92148969009997901771153244	Dani Papetti	, DEBBIE QUALEY, 900 PANTHER DR, RENO, NV, 89506 Code: SAN JUAN 32-7 249H FC HSU	3/8/2019	Arrived at USPS Regional Origin Facility March 11, 2019 <b>Signature Pending</b>
92148969009997901771153251	Dani Papetti	, DEBORAH ANN GOODKNIGHT HANLEY, 9278 KULLENBROOKE DR, KALAMAZOO, MI, 49009 Code: SAN JUAN 32-7 249H FC HSU	3/8/2019	Arrived at USPS Regional Origin Facility March 11, 2019 <b>Signature Pending</b>
92148969009997901771153268	Dani Papetti	, DEBRA LEE DUPRAY, 12040 EAST JEFSUMARK CIR, TUCSON, AZ, 85749 Code: SAN JUAN 32-7 249H FC HSU	3/8/2019	Arrived at USPS Regional Origin Facility March 11, 2019 <b>Signature Pending</b>
92148969009997901771153275	Dani Papetti	, DELORES CAMILOTTO, N 5559 GLACIER CT, FOND DU LAC, WI, 54937 Code: SAN JUAN 32-7 249H FC HSU	3/8/2019	Arrived at USPS Regional Origin Facility March 11, 2019 <b>Signature Pending</b>
92148969009997901771153282	Dani Papetti	, DELORES MAE WENTZ, 48 MOONSTONE DR, FRANKLIN, NC, 28734 Code: SAN JUAN 32-7 249H FC HSU	3/8/2019	Arrived at USPS Regional Origin Facility March 11, 2019 <b>Signature Pending</b>
92148969009997901771153299	Dani Papetti	, DENNIS CROSS and KAREN CROSS JTWROS, 4885 POLE PLANT DR, COLORADO SPRINGS, CO, 80918 Code: SAN JUAN 32-7 249H FC HSU	3/8/2019	Arrived at USPS Regional Origin Facility March 11, 2019 <b>Signature Pending</b>
92148969009997901771153305	Dani Papetti	, DENNIS M CROSS, 4885 POLE PLANT DR, COLORADO SPRINGS, CO, 80918 Code: SAN JUAN 32-7 249H FC HSU	3/8/2019	Arrived at USPS Regional Origin Facility March 11, 2019 <b>Signature Pending</b>
92148969009997901771153312	Dani Papetti	, DENNIS S KROEGER, PO BOX 1114, PAYSON, AZ, 85547 Code: SAN JUAN 32-7 249H FC HSU	3/8/2019	Arrived at USPS Regional Origin Facility March 11, 2019 <b>Signature Pending</b>
92148969009997901771153329	Dani Papetti	, DEWEY T SMOUSE and, PATRICIA SMOUSE JTROS 339 E GRAND AVE, MANCOS, CO, 81328 Code: SAN JUAN 32-7 249H FC HSU	3/8/2019	Arrived at USPS Regional Origin Facility March 11, 2019 <b>Signature Pending</b>
92148969009997901771153336	Dani Papetti	, DIANE H SMITH, PO BOX 58, ASPEN, CO, 81612-0058 Code: SAN JUAN 32-7 249H FC HSU	3/8/2019	Arrived at USPS Regional Origin Facility March 11, 2019 <b>Signature Pending</b>
92148969009997901771153343	Dani Papetti	, DIANE HENKLE, 1210 3RD ST, MANHATTAN BEACH, CA, 90266 Code: SAN JUAN 32-7 249H FC HSU	3/8/2019	Arrived at USPS Regional Origin Facility March 11, 2019 <b>Signature Pending</b>
92148969009997901771153350	Dani Papetti	, DICK HOLLAND, PO BOX 2926, MIDLAND, TX, 79702-2926 Code: SAN JUAN 32-7 249H FC HSU	3/8/2019	Arrived at USPS Regional Origin Facility March 11, 2019 <b>Signature Pending</b>
92148969009997901771153367	Dani Papetti	, DIOCESE OF JOLIET, 16555 WEBER RD, CREST HILL, IL, 60403 Code: SAN JUAN 32-7 249H FC HSU	3/8/2019	Arrived at USPS Regional Origin Facility March 11, 2019 <b>Signature Pending</b>
92148969009997901771153374	Dani Papetti	, DIRK VANHORN REEMTSMA, 556 CRESTWOOD DR, OCEANSIDE, CA, 92058 Code: SAN JUAN 32-7 249H FC HSU	3/8/2019	Arrived at USPS Regional Origin Facility March 11, 2019 <b>Signature Pending</b>
92148969009997901771153381	Dani Papetti	, DONALD L UNDERWOOD CREDIT SHELTER, TR MAUREEN UNDERWOOD HAAVIND TTEE 3033 S OAK WAY, LAKEWOOD, CO, 80227 Code: SAN JUAN 32-7 249H FC HSU	3/8/2019	Arrived at USPS Regional Origin Facility March 11, 2019 <b>Signature Pending</b>
92148969009997901771153398	Dani Papetti	, DONALD PRESTON REA, 9135 HWY 172, IGNACIO, CO, 81137 Code: SAN JUAN 32-7 249H FC HSU	3/8/2019	Arrived at USPS Regional Origin Facility March 11, 2019 <b>Signature Pending</b>
92148969009997901771153404	Dani Papetti	, DONALD RICHARD FINNEY, PO BOX 1006, PARIS, IL, 61944 Code: SAN JUAN 32-7 249H FC HSU	3/8/2019	Arrived at USPS Regional Origin Facility March 11, 2019 <b>Signature Pending</b>
92148969009997901771153411	Dani Papetti	, DONIA LEDFORD, 9700 S 4055 RD, TALALA, OK, 74080 Code: SAN JUAN 32-7 249H FC HSU	3/8/2019	Arrived at USPS Regional Origin Facility March 11, 2019 <b>Signature Pending</b>
92148969009997901771153428	Dani Papetti	, DONNA DIANE BANZHOF, GENERAL DELIVERY, EL CAJON, CA, 77208-1229 Code: SAN JUAN 32-7 249H FC HSU	3/8/2019	Arrived at USPS Regional Facility March 11, 2019 <b>Signature Pending</b>

92148969009997901771153435	Dani Papetti	, DONNA M YOUNG, PO BOX 421, IGNACIO, CO, 81137 Code: SAN JUAN 32-7 249H FC HSU	3/8/2019	Arrived at USPS Regional Origin Facility March 11, 2019 <b>Signature Pending</b>
92148969009997901771153442	Dani Papetti	, DONNA PHILLIPS, PO BOX 1058, SEMINOLE, OK, 74818-1058 Code: SAN JUAN 32-7 249H FC HSU	3/8/2019	Arrived at USPS Regional Origin Facility March 11, 2019 <b>Signature Pending</b>
92148969009997901771153459	Dani Papetti	, DORA JANE PIERSON, THOMAS E MASON POA 3500-D LAREDO LN, FORT COLLINS, CO, 80526- 4227 Code: SAN JUAN 32-7 249H FC HSU	3/8/2019	Arrived at USPS Regional Origin Facility March 11, 2019 <b>Signature Pending</b>
92148969009997901771153466	Dani Papetti	, DOROTHY HERRERA PACHECO, 1209 FEARNOW AVE, PUEBLO, CO, 81101 Code: SAN JUAN 32-7 249H FC HSU	3/8/2019	Arrived at USPS Regional Origin Facility March 11, 2019 <b>Signature Pending</b>
92148969009997901771153473	Dani Papetti	, DOROTHY M TAYLOR, 3260 BARNWELL TRCE, POWDER SPRINGS, GA, 30127-5043 Code: SAN JUAN 32-7 249H FC HSU	3/8/2019	Arrived at USPS Regional Origin Facility March 11, 2019 <b>Signature Pending</b>
92148969009997901771153480	Dani Papetti	, DOUGLAS CAMERON MCLEOD, 600 GRANT ST STE 850, DENVER, CO, 80203 Code: SAN JUAN 32-7 249H FC HSU	3/8/2019	Arrived at USPS Regional Origin Facility March 11, 2019 <b>Signature Pending</b>
92148969009997901771153497	Dani Papetti	, DOUGLAS EUGENE CHANDLER, 1355 42ND ST, SACRAMENTO, CA, 95819 Code: SAN JUAN 32-7 249H FC HSU	3/8/2019	Arrived at USPS Regional Origin Facility March 11, 2019 <b>Signature Pending</b>
92148969009997901771153503	Dani Papetti	, DOUGLAS ROBERT MCLEOD REVOC TRUST, DOUGLAS ROBERT MCLEOD TRUSTEE 10334 SW 51ST LN, GAINESVILLE, FL, 32608 Code: SAN JUAN 32-7 249H FC HSU	3/8/2019	Arrived at USPS Regional Origin Facility March 11, 2019 <b>Signature Pending</b>
92148969009997901771153510	Dani Papetti	, DUDLEY BENNETT, US TREASURY IRS LEVY ACCT 2003-2007 NON-EMPLOYEE XXX XX 2505 918 2ND, SEATTLE, WA, 98174-1009 Code: SAN JUAN 32-7 249H FC HSU	3/8/2019	Arrived at USPS Regional Origin Facility March 11, 2019 <b>Signature Pending</b>
92148969009997901771153527	Dani Papetti	, DUQUE SURVIVORS TRUST UA, 6 7 1968 RESTATED FEB 3 1998 5 FIRST AMERICAN WAY 4TH FL, SANTA ANA, CA, 92707 Code: SAN JUAN 32-7 249H FC HSU	3/8/2019	Arrived at USPS Regional Origin Facility March 11, 2019 <b>Signature Pending</b>
92148969009997901771153534	Dani Papetti	, EARL BEN SELF, PO BOX 802, MARION, MS, 39342- 0802 Code: SAN JUAN 32-7 249H FC HSU	3/8/2019	Arrived at USPS Regional Origin Facility March 11, 2019 <b>Signature Pending</b>
92148969009997901771153541	Dani Papetti	, EARNEST J LITTLE and, PAMELA LITTLE 1287 W RIVER RD, PLAINS, MT, 59859 Code: SAN JUAN 32-7 249H FC HSU	3/8/2019	Arrived at USPS Regional Origin Facility March 11, 2019 <b>Signature Pending</b>
92148969009997901771153558	Dani Papetti	, EAST RIVER ENERGY LLC, PO BOX 4454, TULSA, OK, 74159 Code: SAN JUAN 32-7 249H FC HSU	3/8/2019	Arrived at USPS Regional Origin Facility March 11, 2019 <b>Signature Pending</b>
92148969009997901771153565	Dani Papetti	, EDWARD B DUNN, 481 SPOON CT, GRAND JUNCTION, CO, 81507-7702 Code: SAN JUAN 32-7 249H FC HSU	3/8/2019	Arrived at USPS Regional Origin Facility March 11, 2019 <b>Signature Pending</b>
92148969009997901771153572	Dani Papetti	, EDWARD E DAVIES, 2918 E 101ST PL, TULSA, OK, 74137-5641 Code: SAN JUAN 32-7 249H FC HSU	3/8/2019	Arrived at USPS Regional Origin Facility March 11, 2019 <b>Signature Pending</b>
92148969009997901771153589	Dani Papetti	, EDWARD L BINKLEY III, PO BOX 33317, SANTA FE, NM, 87594 Code: SAN JUAN 32-7 249H FC HSU	3/8/2019	Arrived at USPS Regional Origin Facility March 11, 2019 <b>Signature Pending</b>
92148969009997901771153596	Dani Papetti	, EDWARD S and JANE ELLEN BINKLEY REVOC, TRUST 12/8/2005 EDWARD BINKLEY and JANE BINKLEY TTES 1 W EDITH AVE A, LOS ALTOS, CA, 94022 Code: SAN JUAN 32-7 249H FC HSU	3/8/2019	Arrived at USPS Regional Origin Facility March 11, 2019 <b>Signature Pending</b>
92148969009997901771153602	Dani Papetti	, ELAINE W FISKE FAMILY LTD PRTRNSHP, 12377 MERIT DR STE 777, DALLAS, TX, 75251 Code: SAN JUAN 32-7 249H FC HSU	3/8/2019	Arrived at USPS Regional Origin Facility March 11, 2019 <b>Signature Pending</b>
92148969009997901771153619	Dani Papetti	, ELEANOR LORRAINE STEVENS, 915 SADDLE DR #376, HELENA, MT, 59601 Code: SAN JUAN 32-7 249H FC HSU	3/8/2019	Arrived at USPS Regional Origin Facility March 11, 2019 <b>Signature Pending</b>

92148969009997901771153626	Dani Papetti	, ELINOR RUTH BROWN, 350 DELAWARE ST, STERLING, CO, 80751 Code: SAN JUAN 32-7 249H FC HSU	3/8/2019	Arrived at USPS Regional Origin Facility March 11, 2019 <b>Signature Pending</b>
92148969009997901771153633	Dani Papetti	, ELISA BETH DENNING, 2166 CHELSEA DR, LOVELAND, CO, 80538 Code: SAN JUAN 32-7 249H FC HSU	3/8/2019	Arrived at USPS Regional Origin Facility March 11, 2019 <b>Signature Pending</b>
92148969009997901771153640	Dani Papetti	, ELIZABETH NGUYEN, 1324 BERNARDO CT NE, ALBUQUERQUE, NM, 87113 Code: SAN JUAN 32-7 249H FC HSU	3/8/2019	Arrived at USPS Regional Origin Facility March 11, 2019 <b>Signature Pending</b>
92148969009997901771153657	Dani Papetti	, ELIZABETH TURNER CALLOWAY, ROBERT WILBURN GUARDIAN PO BOX 191767, DALLAS, TX, 75219-8506 Code: SAN JUAN 32-7 249H FC HSU	3/8/2019	Arrived at USPS Regional Origin Facility March 11, 2019 <b>Signature Pending</b>
92148969009997901771153664	Dani Papetti	, ELLEN LEDVINA GARLAND, 2850 E 33RD ST, TULSA, OK, 74105 Code: SAN JUAN 32-7 249H FC HSU	3/8/2019	Arrived at USPS Regional Origin Facility March 11, 2019 <b>Signature Pending</b>
92148969009997901771153671	Dani Papetti	, ELLIOTT INDUSTRIES, PO BOX 1328, SANTA FE, NM, 87504 Code: SAN JUAN 32-7 249H FC HSU	3/8/2019	Pre-Shipment Info Sent to USPS, USPS Awaiting Item March 8, 2019 <b>Signature Pending</b>
92148969009997901771153688	Dani Papetti	, ELLIOTT-HALL COMPANY, PO BOX 1231, OGDEN, UT, 84402 Code: SAN JUAN 32-7 249H FC HSU	3/8/2019	Arrived at USPS Regional Origin Facility March 11, 2019 <b>Signature Pending</b>
92148969009997901771153695	Dani Papetti	, ELLIS BANK and TRUST CO, PO BOX 1718, SARASOTA, FL, 34230-1718 Code: SAN JUAN 32-7 249H FC HSU	3/8/2019	Arrived at USPS Regional Origin Facility March 11, 2019 <b>Signature Pending</b>
92148969009997901771153701	Dani Papetti	, ELSR LP, 8080 N CENTRAL EXPY STE 1420, DALLAS, TX, 75206-1844 Code: SAN JUAN 32-7 249H FC HSU	3/8/2019	Arrived at USPS Regional Origin Facility March 11, 2019 <b>Signature Pending</b>
92148969009997901771153718	Dani Papetti	, EMILY C TERMAAT, 406 HILLCREST DR, DURANGO, CO, 81301 Code: SAN JUAN 32-7 249H FC HSU	3/8/2019	Arrived at USPS Regional Origin Facility March 11, 2019 <b>Signature Pending</b>
92148969009997901771153725	Dani Papetti	, EMMA CLOW, 220 NE 7TH, HERMISTON, OR, 97838-1908 Code: SAN JUAN 32-7 249H FC HSU	3/8/2019	Arrived at USPS Regional Origin Facility March 11, 2019 <b>Signature Pending</b>
92148969009997901771153732	Dani Papetti	, ENDURING RESOURCES IV LLC, 1050 17TH STREET SUITE 2500, DENVER, CO, 80265 Code: SAN JUAN 32-7 249H FC HSU	3/8/2019	Arrived at USPS Regional Origin Facility March 11, 2019 <b>Signature Pending</b>
92148969009997901771153749	Dani Papetti	, EULA MAY JOHNSTON TRUST 661, BANK OF AMERICA N A PO BOX 840738, DALLAS, TX, 75284- 0738 Code: SAN JUAN 32-7 249H FC HSU	3/8/2019	Arrived at USPS Regional Origin Facility March 11, 2019 <b>Signature Pending</b>
92148969009997901771153756	Dani Papetti	, EVALYN SWEARINGEN ESTATE, KRISTI JONES EXECUTOR 1362 N 80TH RD, CONCORDIA, KS, 66901 Code: SAN JUAN 32-7 249H FC HSU	3/8/2019	Arrived at USPS Regional Origin Facility March 11, 2019 <b>Signature Pending</b>
92148969009997901771153763	Dani Papetti	, EVAN W JONES-TOSCANO, PO BOX 2758, BIG BEAR CITY, CA, 92314 Code: SAN JUAN 32-7 249H FC HSU	3/8/2019	Arrived at USPS Regional Origin Facility March 11, 2019 <b>Signature Pending</b>
92148969009997901771153770	Dani Papetti	, EVELYN H BENNETT, 48350 CRESTVIEW DR, PALM DESERT, CA, 92260 Code: SAN JUAN 32-7 249H FC HSU	3/8/2019	Arrived at USPS Regional Origin Facility March 11, 2019 <b>Signature Pending</b>
92148969009997901771153787	Dani Papetti	, EVERETT E WIGGINS JR, 2414 BENT PINE CT, SPRING HILL, FL, 34606 Code: SAN JUAN 32-7 249H FC HSU	3/8/2019	Arrived at USPS Regional Origin Facility March 11, 2019 <b>Signature Pending</b>
92148969009997901771153794	Dani Papetti	, FLORA JANE HOPKINS REVOC INTERVIVOS, TR LOMA JANE WEBBER SUCC TTEE 24476 CHAMALEA, MISSION VIEJO, CA, 92691 Code: SAN JUAN 32-7 249H FC HSU	3/8/2019	Arrived at USPS Regional Origin Facility March 11, 2019 <b>Signature Pending</b>
92148969009997901771153800	Dani Papetti	, FLOWER STREAM PARTNERS, 11207 UVALDE COVE, AUSTIN, TX, 78739 Code: SAN JUAN 32-7 249H FC HSU	3/8/2019	Arrived at USPS Regional Origin Facility March 11, 2019 <b>Signature Pending</b>
92148969009997901771153817		, FOUR RIVERS RESOURCES LLC, 2602 MCKINNEY		Arrived at USPS Regional Origin Facility

	Dani Papetti	AVE STE 400, DALLAS, TX, 75204 Code: SAN JUAN 32-7 249H FC HSU	3/8/2019	March 11, 2019 <b>Signature Pending</b>
92148969009997901771153824	Dani Papetti	, FRANCIS MARTIN and ROSELYN MARTIN TR, FRANK KEVIN MARTIN and BRAWNA L MARTIN HENDERSON TTES 558 CASTLE P, CASTLE ROCK, CO, 80108 Code: SAN JUAN 32-7 249H FC HSU	3/8/2019	Arrived at USPS Regional Origin Facility March 11, 2019 <b>Signature Pending</b>
92148969009997901771153831	Dani Papetti	, FRANK ALAN GOODKNIGHT, PO BOX 882, NIWOT, CO, 80544 Code: SAN JUAN 32-7 249H FC HSU	3/8/2019	Arrived at USPS Regional Origin Facility March 11, 2019 <b>Signature Pending</b>
92148969009997901771153848	Dani Papetti	, FRANK GILBERT MARTINEZ, 102 N 30TH DR, PHOENIX, AZ, 85009 Code: SAN JUAN 32-7 249H FC HSU	3/8/2019	Arrived at USPS Regional Origin Facility March 11, 2019 <b>Signature Pending</b>
92148969009997901771153855	Dani Papetti	, FRANK M RUPP JR, 9901 TREE TOP DR, ORLAND PARK, IL, 60462 Code: SAN JUAN 32-7 249H FC HSU	3/8/2019	Arrived at USPS Regional Origin Facility March 11, 2019 <b>Signature Pending</b>
92148969009997901771153862	Dani Papetti	, FREDERICK EUGENE TURNER, 4925 GREENVILLE AVE #852, DALLAS, TX, 75206 Code: SAN JUAN 32-7 249H FC HSU	3/8/2019	Arrived at USPS Regional Origin Facility March 11, 2019 <b>Signature Pending</b>
92148969009997901771153879	Dani Papetti	, FREDRICK CHARLES JULIAN, and CAROLE E JULIAN LIFE ESTATE 500 N W PARK LN, COLUMBIA, MO, 65201-7035 Code: SAN JUAN 32-7 249H FC HSU	3/8/2019	Arrived at USPS Regional Origin Facility March 11, 2019 <b>Signature Pending</b>
92148969009997901771153886	Dani Papetti	, GARRET A DAVIES, PO BOX 936, EDWARDS, CO, 81632 Code: SAN JUAN 32-7 249H FC HSU	3/8/2019	Arrived at USPS Regional Origin Facility March 11, 2019 <b>Signature Pending</b>
92148969009997901771153893	Dani Papetti	, GEORGE B BROOME, HC 74 BOX 62, PECOS, NM, 87552 Code: SAN JUAN 32-7 249H FC HSU	3/8/2019	Arrived at USPS Regional Origin Facility March 11, 2019 <b>Signature Pending</b>
92148969009997901771153909	Dani Papetti	, GEORGE L PALMER, PO BOX D A, HAGATNA GUAM, GU, 96932-7507 Code: SAN JUAN 32-7 249H FC HSU	3/8/2019	Arrived at USPS Regional Origin Facility March 11, 2019 <b>Signature Pending</b>
92148969009997901771153916	Dani Papetti	, GEORGE RICHARDSON, 4288 AMERICAN LEGION RD, ABBEVILLE, GA, 31001 Code: SAN JUAN 32-7 249H FC HSU	3/8/2019	Arrived at USPS Regional Origin Facility March 11, 2019 <b>Signature Pending</b>
92148969009997901771153923	Dani Papetti	, GEORGE W UMBACH, PO BOX 929, MANCHESTER, TN, 37349 Code: SAN JUAN 32-7 249H FC HSU	3/8/2019	Arrived at USPS Regional Origin Facility March 11, 2019 <b>Signature Pending</b>
92148969009997901771153930	Dani Papetti	, GEORGIA DITTMAR, 28 CR 231, DURANGO, CO, 81303-6845 Code: SAN JUAN 32-7 249H FC HSU	3/8/2019	Arrived at USPS Regional Origin Facility March 11, 2019 <b>Signature Pending</b>
92148969009997901771153947	Dani Papetti	, GINA HOUCK, 5785 CROOKED STICK WAY, SPARKS, NV, 89436 Code: SAN JUAN 32-7 249H FC HSU	3/8/2019	Arrived at USPS Regional Origin Facility March 11, 2019 <b>Signature Pending</b>
92148969009997901771153954	Dani Papetti	, GLEN EDWARD HAFER, PO BOX 803, LEWISTOWN, IA, 83501 Code: SAN JUAN 32-7 249H FC HSU	3/8/2019	Arrived at USPS Regional Origin Facility March 11, 2019 <b>Signature Pending</b>
92148969009997901771153961	Dani Papetti	, GLENDA POTTER, 3650 CR 23, RIDGWAY, CO, 81432 Code: SAN JUAN 32-7 249H FC HSU	3/8/2019	Arrived at USPS Regional Origin Facility March 11, 2019 <b>Signature Pending</b>
92148969009997901771153978	Dani Papetti	, GLORIA WHITE, 1501 PENNSYLVANIA ST, MONTROSE, CO, 81401-4151 Code: SAN JUAN 32-7 249H FC HSU	3/8/2019	Arrived at USPS Regional Origin Facility March 11, 2019 <b>Signature Pending</b>
92148969009997901771153985	Dani Papetti	, GRANT SWEARINGEN, 209 S ASHLEY PARK, WICHITA, KS, 67209 Code: SAN JUAN 32-7 249H FC HSU	3/8/2019	Arrived at USPS Regional Origin Facility March 11, 2019 <b>Signature Pending</b>
92148969009997901771153992	Dani Papetti	, GRAYFORE PARTNERS LP, PO BOX 98670, LUBBOCK, TX, 79499-8670 Code: SAN JUAN 32-7 249H FC HSU	3/8/2019	Arrived at USPS Regional Origin Facility March 11, 2019 <b>Signature Pending</b>
92148969009997901771154005	Dani Papetti	, GREGORY DALE HARKINS, DEBORAH ANN HARKINS POA 1111 PROVIDENCE CT, ELON, NC,	3/8/2019	Arrived at USPS Regional Origin Facility

		27244 Code: SAN JUAN 32-7 249H FC HSU		March 11, 2019 <b>Signature Pending</b>
92148969009997901771154012	Dani Papetti	, GREGORY E ULVESTED REVOCABLE TRUST, 4411 CHERRYWOOD DR, MIDLAND, TX, 79707-2622 Code: SAN JUAN 32-7 249H FC HSU	3/8/2019	Arrived at USPS Regional Origin Facility March 11, 2019 <b>Signature Pending</b>
92148969009997901771154029	Dani Papetti	, GROVER FAMILY LP, PO BOX 3666, MIDLAND, TX, 79702-3666 Code: SAN JUAN 32-7 249H FC HSU	3/8/2019	Arrived at USPS Regional Origin Facility March 11, 2019 <b>Signature Pending</b>
92148969009997901771154036	Dani Papetti	, HAIL FREEDONIA LLC, 3457 RINGSBY CT #208, DENVER, CO, 80216 Code: SAN JUAN 32-7 249H FC HSU	3/8/2019	Arrived at USPS Regional Origin Facility March 11, 2019 <b>Signature Pending</b>
92148969009997901771154043	Dani Papetti	, HARDGRAVE REV LIV TRUST, MEREDITH HARDGRAVE 6012 EAST 114TH ST, TULSA, OK, 74137 Code: SAN JUAN 32-7 249H FC HSU	3/8/2019	Arrived at USPS Regional Origin Facility March 11, 2019 <b>Signature Pending</b>
92148969009997901771154050	Dani Papetti	, HAROLD E PALMER, 508 SUTTON ST, AZTEC, NM, 87410-2334 Code: SAN JUAN 32-7 249H FC HSU	3/8/2019	Arrived at USPS Regional Origin Facility March 11, 2019 <b>Signature Pending</b>
92148969009997901771154067	Dani Papetti	, HAROLD F PAYNE III, 6075 GABRIELLE CAROL CT, LAS VEGAS, NV, 89149 Code: SAN JUAN 32-7 249H FC HSU	3/8/2019	Arrived at USPS Regional Origin Facility March 11, 2019 <b>Signature Pending</b>
92148969009997901771154074	Dani Papetti	, HARRIE L PERRY JR, and MAXINE J PERRY TRTEES U/D/T DD 11-14-89 F/B/O KAIULANI L BUMPUS , DE RIDDER, LA, 70634-0396 Code: SAN JUAN 32-7 249H FC HSU	3/8/2019	Arrived at USPS Regional Origin Facility March 11, 2019 <b>Signature Pending</b>
92148969009997901771154081	Dani Papetti	, HARRY JAMES RICHARDSON, 13363 E ASBURY DR, AURORA, CO, 80014 Code: SAN JUAN 32-7 249H FC HSU	3/8/2019	Arrived at USPS Regional Origin Facility March 11, 2019 <b>Signature Pending</b>
92148969009997901771154098	Dani Papetti	, HAYMAKER HOLDING COMPANY LLC, PO BOX 205415, DALLAS, TX, 75320-5415 Code: SAN JUAN 32-7 249H FC HSU	3/8/2019	Arrived at USPS Regional Facility March 11, 2019 <b>Signature Pending</b>
92148969009997901771154104	Dani Papetti	, HDBC INVESTMENTS LTD, A TEXAS LTD PTRSHP PO BOX 12766, DALLAS, TX, 75225 Code: SAN JUAN 32-7 249H FC HSU	3/8/2019	Arrived at USPS Regional Origin Facility March 11, 2019 <b>Signature Pending</b>
92148969009997901771154111	Dani Papetti	, HEATHER FROST, PO BOX 1917, AZTEC, NM, 87410 Code: SAN JUAN 32-7 249H FC HSU	3/8/2019	Arrived at USPS Regional Origin Facility March 11, 2019 <b>Signature Pending</b>
92148969009997901771154128	Dani Papetti	, HELEN CAIRE, 1103 GRAVITE N/W, ALBUQUERQUE, NM, 87102 Code: SAN JUAN 32-7 249H FC HSU	3/8/2019	Arrived at USPS Regional Origin Facility March 11, 2019 <b>Signature Pending</b>
92148969009997901771154135	Dani Papetti	, HELEN ELIZABETH DENISON HAYS, 1710 MAY LN, CORTEZ, CO, 81321 Code: SAN JUAN 32-7 249H FC HSU	3/8/2019	Arrived at USPS Regional Origin Facility March 11, 2019 <b>Signature Pending</b>
92148969009997901771154142	Dani Papetti	, HELEN L MARCOTTE, 1000 SCHIPPLE DR, SALINA, KS, 67401 Code: SAN JUAN 32-7 249H FC HSU	3/8/2019	Arrived at USPS Regional Origin Facility March 11, 2019 <b>Signature Pending</b>
92148969009997901771154159	Dani Papetti	, HELEN RICE SCHLICHT, 1527 RED BUD LN, MCALLISTER, OK, 74501-7051 Code: SAN JUAN 32-7 249H FC HSU	3/8/2019	Arrived at USPS Regional Origin Facility March 11, 2019 <b>Signature Pending</b>
92148969009997901771154166	Dani Papetti	, HENRIETTA ABEYTA, 2571 W 6075 S, ROY, UT, 84067-3225 Code: SAN JUAN 32-7 249H FC HSU	3/8/2019	Arrived at USPS Regional Origin Facility March 11, 2019 <b>Signature Pending</b>
92148969009997901771154173	Dani Papetti	, HERBERT C PHILLIPS FAMILY TRUST, NICK PHILLIPS TRUSTEE C/O HABENICHT NOVAK and BIRCKBICHLER 287 PITTS, BUTLER, PA, 16002 Code: SAN JUAN 32-7 249H FC HSU	3/8/2019	Arrived at USPS Regional Origin Facility March 11, 2019 <b>Signature Pending</b>
92148969009997901771154180	Dani Papetti	, HILARY WHITING SMITH, 707 NW HILL ST, BEND, OR, 97701 Code: SAN JUAN 32-7 249H FC HSU	3/8/2019	Arrived at USPS Regional Origin Facility March 11, 2019 <b>Signature Pending</b>
92148969009997901771154197	Dani Papetti	, Hilcorp San Juan, LP, 1111 TRAVIS, HOUSTON, TX, 77002 Code: SAN JUAN 32-7 249H FC HSU	3/8/2019	Pre-Shipment Info Sent to USPS, USPS Awaiting Item March 8, 2019 <b>Signature Pending</b>



92148969009997901771154203	Dani Papetti	, HOPE ROYALTIES LLC, PO BOX 1326, ARTESIA, NM, 88211 Code: SAN JUAN 32-7 249H FC HSU	3/8/2019	Arrived at USPS Regional Origin Facility March 11, 2019 <b>Signature Pending</b>
92148969009997901771154210	Dani Papetti	, HOWARD E REX, PO BOX 1012, CONGRESS, AZ, 85332-1012 Code: SAN JUAN 32-7 249H FC HSU	3/8/2019	Arrived at USPS Regional Origin Facility March 11, 2019 <b>Signature Pending</b>
92148969009997901771154227	Dani Papetti	, HPJ OIL LLC, 1611 S UTICA #163, TULSA, OK, 74104-4909 Code: SAN JUAN 32-7 249H FC HSU	3/8/2019	Arrived at USPS Regional Origin Facility March 11, 2019 <b>Signature Pending</b>
92148969009997901771154234	Dani Papetti	, ICON PETROLEUM INC, 1411 W ILLINOIS AVE, MIDLAND, TX, 79701 Code: SAN JUAN 32-7 249H FC HSU	3/8/2019	Arrived at USPS Regional Origin Facility March 11, 2019 <b>Signature Pending</b>
92148969009997901771154241	Dani Papetti	, IMINERALS LLC, 5 INVERNESS DR E, ENGLEWOOD, CO, 80112 Code: SAN JUAN 32-7 249H FC HSU	3/8/2019	Arrived at USPS Regional Origin Facility March 11, 2019 <b>Signature Pending</b>
92148969009997901771154258	Dani Papetti	, INA GILBERT WALTER, PO BOX 1688, YUCCA VALLEY, CA, 92286-1688 Code: SAN JUAN 32-7 249H FC HSU	3/8/2019	Arrived at USPS Regional Origin Facility March 11, 2019 <b>Signature Pending</b>
92148969009997901771154265	Dani Papetti	, J A CORNWELL, 3621 33 AVE S #607, SEATTLE, WA, 98144-2931 Code: SAN JUAN 32-7 249H FC HSU	3/8/2019	Arrived at USPS Regional Origin Facility March 11, 2019 <b>Signature Pending</b>
92148969009997901771154272	Dani Papetti	, J B TOUCHSTONE INVESTMENTS LLC, 600 COVINGTON PL, PASADENA, CA, 91105 Code: SAN JUAN 32-7 249H FC HSU	3/8/2019	Arrived at USPS Regional Origin Facility March 11, 2019 <b>Signature Pending</b>
92148969009997901771154289	Dani Papetti	, J GLENN TURNER JR, 4809 COLE AVE SUITE 212, DALLAS, TX, 75205 Code: SAN JUAN 32-7 249H FC HSU	3/8/2019	Arrived at USPS Regional Origin Facility March 11, 2019 <b>Signature Pending</b>
92148969009997901771154296	Dani Papetti	, J ROBERT TRUJILLO, 1 RD 3955, FARMINGTON, NM, 87401 Code: SAN JUAN 32-7 249H FC HSU	3/8/2019	Arrived at USPS Regional Origin Facility March 11, 2019 <b>Signature Pending</b>
92148969009997901771154302	Dani Papetti	, JandM RAYMOND LTD, RAYMOND and SONS I LLC GEN PARTNER PO BOX 291445, KERRVILLE, TX, 78029-1445 Code: SAN JUAN 32-7 249H FC HSU	3/8/2019	Arrived at USPS Regional Origin Facility March 11, 2019 <b>Signature Pending</b>
92148969009997901771154319	Dani Papetti	, JACK E SCIESZINSKI, 810 D AVE E, ALBIA, IA, 52531 Code: SAN JUAN 32-7 249H FC HSU	3/8/2019	Pre-Shipment Info Sent to USPS, USPS Awaiting Item March 8, 2019 <b>Signature Pending</b>
92148969009997901771154326	Dani Papetti	, JACK M MACKEY, NO 51, CR 4012, IGNACIO, CO, 81137 Code: SAN JUAN 32-7 249H FC HSU	3/8/2019	Pre-Shipment Info Sent to USPS, USPS Awaiting Item March 8, 2019 <b>Signature Pending</b>
92148969009997901771154333	Dani Papetti	, JACK W CLARK, 18325 N WEAVER RD, MARSHALL, IL, 62441 Code: SAN JUAN 32-7 249H FC HSU	3/8/2019	Arrived at USPS Regional Origin Facility March 11, 2019 <b>Signature Pending</b>
92148969009997901771154340	Dani Papetti	, JAMES A BROWN, and JUDITH A BROWN JTS PO BOX 928, ELK CITY, OK, 73648-0928 Code: SAN JUAN 32-7 249H FC HSU	3/8/2019	Arrived at USPS Regional Origin Facility March 11, 2019 <b>Signature Pending</b>
92148969009997901771154357	Dani Papetti	, JAMES A CHAVEZ, 7205 BELLROSE CT NE, ALBUQUERQUE, NM, 87110 Code: SAN JUAN 32-7 249H FC HSU	3/8/2019	Arrived at USPS Regional Origin Facility March 11, 2019 <b>Signature Pending</b>
92148969009997901771154364	Dani Papetti	, JAMES A MACKEY, and STACY A MACKEY 58 VANDIVER RD, SEDAN, NM, 88436 Code: SAN JUAN 32-7 249H FC HSU	3/8/2019	Arrived at USPS Regional Origin Facility March 11, 2019 <b>Signature Pending</b>
92148969009997901771154371	Dani Papetti	, JAMES A WISEMAN, 5906 ROCKFORD DR, GROVETOWN, GA, 30813 Code: SAN JUAN 32-7 249H FC HSU	3/8/2019	Arrived at USPS Regional Origin Facility March 11, 2019 <b>Signature Pending</b>
92148969009997901771154388	Dani Papetti	, JAMES B FULLERTON and BARBARA, and BARBARA A FULLERTON JTWROS 621 17TH ST, DENVER, CO, 80293 Code: SAN JUAN 32-7 249H FC HSU	3/8/2019	Arrived at USPS Regional Origin Facility March 11, 2019 <b>Signature Pending</b>
92148969009997901771154395		, JAMES CHRISTIAN BRIGGS, 25 CR 5251,		Arrived at USPS Regional Origin Facility

	Dani Papetti	BLOOMFIELD, NM, 87413 Code: SAN JUAN 32-7 249H FC HSU	3/8/2019	March 11, 2019 <b>Signature Pending</b>
92148969009997901771154401	Dani Papetti	, JAMES D PAWLICKI, PERS REP JEAN SNAJDER ESTATE 611 N BOBBY JONES DR, PAYSON, AZ, 85541-3404 Code: SAN JUAN 32-7 249H FC HSU	3/8/2019	Arrived at USPS Regional Origin Facility March 11, 2019 <b>Signature Pending</b>
92148969009997901771154418	Dani Papetti	, JAMES H ESSMAN, PO BOX 302, MIDLAND, TX, 79702 Code: SAN JUAN 32-7 249H FC HSU	3/8/2019	Arrived at USPS Regional Origin Facility March 11, 2019 <b>Signature Pending</b>
92148969009997901771154425	Dani Papetti	, JAMES J RUBOW, DBA PASSPORT ENERGY LLC 2763 VIA CAVALLERO DEL SUR, SANTA FE, NM, 87505 Code: SAN JUAN 32-7 249H FC HSU	3/8/2019	Arrived at USPS Regional Origin Facility March 11, 2019 <b>Signature Pending</b>
92148969009997901771154432	Dani Papetti	, JAMES LEWIS ROBERTS, SOLE and SEPARATE PROPERTY 307 W MULBERRY AVE, SAN ANTONIO, TX, 78212 Code: SAN JUAN 32-7 249H FC HSU	3/8/2019	Arrived at USPS Regional Origin Facility March 11, 2019 <b>Signature Pending</b>
92148969009997901771154449	Dani Papetti	, JAMES R J STRICKLER, and MARIE R STRICKLER JT 2204 N SANTIAGO AVE, FARMINGTON, NM, 87401 Code: SAN JUAN 32-7 249H FC HSU	3/8/2019	Arrived at USPS Regional Origin Facility March 11, 2019 <b>Signature Pending</b>
92148969009997901771154456	Dani Papetti	, JAMES R LEETON JR, PO BOX 10561, MIDLAND, TX, 79702 Code: SAN JUAN 32-7 249H FC HSU	3/8/2019	Arrived at USPS Regional Origin Facility March 11, 2019 <b>Signature Pending</b>
92148969009997901771154463	Dani Papetti	, JAMES R PAYNE, and JEAN PAYNE 614 PASEO DEL BOSQUE N W, ALBUQUERQUE, NM, 87114- 2277 Code: SAN JUAN 32-7 249H FC HSU	3/8/2019	Arrived at USPS Regional Origin Facility March 11, 2019 <b>Signature Pending</b>
92148969009997901771154470	Dani Papetti	, JAMES RUSSELL AUSTIN, 43881 NORMANDY LN, LANCASTER, CA, 93536 Code: SAN JUAN 32-7 249H FC HSU	3/8/2019	Arrived at USPS Regional Origin Facility March 11, 2019 <b>Signature Pending</b>
92148969009997901771154487	Dani Papetti	, JAMES S KIRK and JANICE R KIRK REVOC, LVG TRUST JAMES KIRK and JANICE KIRK TTEES 1968 RIVERWOOD TRS DR, FLORISSANT, MO, 63031 Code: SAN JUAN 32-7 249H FC HSU	3/8/2019	Arrived at USPS Regional Origin Facility March 11, 2019 <b>Signature Pending</b>
92148969009997901771154494	Dani Papetti	, JANE STALEY, and J B STALEY JTWROS PO BOX 273, PALACIOS, TX, 77465 Code: SAN JUAN 32-7 249H FC HSU	3/8/2019	Arrived at USPS Regional Facility March 11, 2019 <b>Signature Pending</b>
92148969009997901771154500	Dani Papetti	, JANET E JONES, 31566 RAILRD CANYON RD, CANYON LAKE, CA, 92587 Code: SAN JUAN 32-7 249H FC HSU	3/8/2019	Arrived at USPS Regional Origin Facility March 11, 2019 <b>Signature Pending</b>
92148969009997901771154517	Dani Papetti	, JANETTE SUSAN CLARK, 9118 BRANCH VIEW DR, INDIANAPOLIS, IN, 46234 Code: SAN JUAN 32-7 249H FC HSU	3/8/2019	Arrived at USPS Regional Origin Facility March 11, 2019 <b>Signature Pending</b>
92148969009997901771154524	Dani Papetti	, JANICE CHULICK, 13040 RIDGE VIEW DR, SUTTER CREEK, CA, 95685-9639 Code: SAN JUAN 32-7 249H FC HSU	3/8/2019	Arrived at USPS Regional Origin Facility March 11, 2019 <b>Signature Pending</b>
92148969009997901771154531	Dani Papetti	, JANICE P CAMPBELL, AUSTEN S CAMPBELL POA PO BOX 2033, MIDLAND, TX, 79702-1714 Code: SAN JUAN 32-7 249H FC HSU	3/8/2019	Arrived at USPS Regional Origin Facility March 11, 2019 <b>Signature Pending</b>
92148969009997901771154548	Dani Papetti	, JANNA E SCHAEFER, 10 TOWN PLAZA # 314, DURANGO, CO, 81301 Code: SAN JUAN 32-7 249H FC HSU	3/8/2019	Arrived at USPS Regional Origin Facility March 11, 2019 <b>Signature Pending</b>
92148969009997901771154555	Dani Papetti	, JAYE MELINDA JONES-DAVES, PO BOX 297, CORTEZ, CO, 81321 Code: SAN JUAN 32-7 249H FC HSU	3/8/2019	Arrived at USPS Regional Origin Facility March 11, 2019 <b>Signature Pending</b>
92148969009997901771154562	Dani Papetti	, JAYNE MARIE GOULDING, 5061 RESERVOIR RD, GREENWOOD, CA, 95635 Code: SAN JUAN 32-7 249H FC HSU	3/8/2019	Arrived at USPS Regional Origin Facility March 11, 2019 <b>Signature Pending</b>
92148969009997901771154579	Dani Papetti	, JEAN M MCCOY, 24 SCHMITT ST, CLAREMONT, NH, 03743-4811 Code: SAN JUAN 32-7 249H FC HSU	3/8/2019	Arrived at USPS Regional Origin Facility March 11, 2019 <b>Signature Pending</b>
92148969009997901771154586	Dani Papetti	, JEANETTE MICHELS, 1252 N 50TH RD, JAMESTOWN, KS, 66948-9547 Code: SAN JUAN 32-7 249H FC HSU	3/8/2019	Arrived at USPS Regional Origin Facility March 11, 2019 <b>Signature Pending</b>

92148969009997901771154593	Dani Papetti	, JEANETTE R PIAZZA, PO BOX 786, TONTITOWN, AR, 72770 Code: SAN JUAN 32-7 249H FC HSU	3/8/2019	Arrived at USPS Regional Origin Facility March 11, 2019 <b>Signature Pending</b>
92148969009997901771154609	Dani Papetti	, JEANNIE R FAVERINO, 3262 CR 334, IGNACIO, CO, 81137-9607 Code: SAN JUAN 32-7 249H FC HSU	3/8/2019	Arrived at USPS Regional Origin Facility March 11, 2019 <b>Signature Pending</b>
92148969009997901771154616	Dani Papetti	, JEFF DUNCAN, 2321 EAST 15TH ST, FARMINGTON, NM, 87401 Code: SAN JUAN 32-7 249H FC HSU	3/8/2019	Arrived at USPS Regional Origin Facility March 11, 2019 <b>Signature Pending</b>
92148969009997901771154623	Dani Papetti	, JEFF HARTNESS, 2122 BELMONT DR, REIDSVILLE, NC, 27320 Code: SAN JUAN 32-7 249H FC HSU	3/8/2019	Arrived at USPS Regional Origin Facility March 11, 2019 <b>Signature Pending</b>
92148969009997901771154630	Dani Papetti	, JEFFREY ALLEN CONRY, 11505 NATRONA CV, AUSTIN, TX, 78759 Code: SAN JUAN 32-7 249H FC HSU	3/8/2019	Arrived at USPS Regional Origin Facility March 11, 2019 <b>Signature Pending</b>
92148969009997901771154647	Dani Papetti	, JEFFREY SCOTT REA, 11108 HWY 172, IGNACIO, CO, 81137 Code: SAN JUAN 32-7 249H FC HSU	3/8/2019	Arrived at USPS Regional Origin Facility March 11, 2019 <b>Signature Pending</b>
92148969009997901771154654	Dani Papetti	, JENNIFER CARLAINE PURCELL, 705 WINGSTON DR, SAINT JOSEPH, IL, 61873 Code: SAN JUAN 32-7 249H FC HSU	3/8/2019	Arrived at USPS Regional Origin Facility March 11, 2019 <b>Signature Pending</b>
92148969009997901771154661	Dani Papetti	, JESMA HOPPER, 2926 COLUMBINE, WICHITA, KS, 67204-5323 Code: SAN JUAN 32-7 249H FC HSU	3/8/2019	Arrived at USPS Regional Origin Facility March 11, 2019 <b>Signature Pending</b>
92148969009997901771154678	Dani Papetti	, JIMMIE LEE COLLIER, 1113 SHADY OAKS CIR, MCKINNEY, TX, 75070-5213 Code: SAN JUAN 32-7 249H FC HSU	3/8/2019	Arrived at USPS Regional Origin Facility March 11, 2019 <b>Signature Pending</b>
92148969009997901771154685	Dani Papetti	, JIMMY WAYNE CLARK, 9982 E OLIVE LN, ROCKVILLE, IN, 47872 Code: SAN JUAN 32-7 249H FC HSU	3/8/2019	Arrived at USPS Regional Origin Facility March 11, 2019 <b>Signature Pending</b>
92148969009997901771154692	Dani Papetti	, JOA INVESTMENTS LLC, 1123 E PHIPPS CT, HIGHLANDS RANCH, CO, 80126 Code: SAN JUAN 32-7 249H FC HSU	3/8/2019	Arrived at USPS Regional Origin Facility March 11, 2019 <b>Signature Pending</b>
92148969009997901771154708	Dani Papetti	, JOAN CONRY HAUPTMAN, 5824 OGDEN CT, BETHESDA, MD, 20816 Code: SAN JUAN 32-7 249H FC HSU	3/8/2019	Arrived at USPS Regional Origin Facility March 11, 2019 <b>Signature Pending</b>
92148969009997901771154715	Dani Papetti	, JOAN E NEWELL, 116 DEBORAH DR, WARNER ROBINS, GA, 31093 Code: SAN JUAN 32-7 249H FC HSU	3/8/2019	Arrived at USPS Regional Origin Facility March 11, 2019 <b>Signature Pending</b>
92148969009997901771154722	Dani Papetti	, JOAN NETHERCUTT, 1605 W SAINT KATERI DR, PHOENIX, AZ, 85041-5832 Code: SAN JUAN 32-7 249H FC HSU	3/8/2019	Arrived at USPS Regional Origin Facility March 11, 2019 <b>Signature Pending</b>
92148969009997901771154739	Dani Papetti	, JOANN BRIGGS, DBA JRB INVESTMENTS LLC 6729 ACADEMY RD NE STE D, ALBUQUERQUE, NM, 87109 Code: SAN JUAN 32-7 249H FC HSU	3/8/2019	Arrived at USPS Regional Origin Facility March 11, 2019 <b>Signature Pending</b>
92148969009997901771154746	Dani Papetti	, JOANNA FINLAY, PO BOX 3968, DURANGO, CO, 81302 Code: SAN JUAN 32-7 249H FC HSU	3/8/2019	Arrived at USPS Regional Origin Facility March 11, 2019 <b>Signature Pending</b>
92148969009997901771154753	Dani Papetti	, JOE DAVID HARGIS, and MARGARET WEBB HARGIS 1749 WESTRIDGE DR, HURST, TX, 76054 Code: SAN JUAN 32-7 249H FC HSU	3/8/2019	Arrived at USPS Regional Origin Facility March 11, 2019 <b>Signature Pending</b>
92148969009997901771154760	Dani Papetti	, JOEL Q CRAIG, 14908 HWY 550 S, DURANGO, CO, 81303 Code: SAN JUAN 32-7 249H FC HSU	3/8/2019	Arrived at USPS Regional Origin Facility March 11, 2019 <b>Signature Pending</b>
92148969009997901771154777	Dani Papetti	, JOHN A BROWN, 15626 ASH ST, HESPERIA, CA, 92345-4209 Code: SAN JUAN 32-7 249H FC HSU	3/8/2019	Arrived at USPS Regional Origin Facility March 11, 2019 <b>Signature Pending</b>
92148969009997901771154784		, JOHN B PIERCE, PO BOX 5025, GREENEHAVEN,		Arrived at USPS Regional Origin Facility

	Dani Papetti	AZ, 86040 Code: SAN JUAN 32-7 249H FC HSU	3/8/2019	March 11, 2019 <b>Signature Pending</b>
92148969009997901771154791	Dani Papetti	, JOHN CHARLES MAJOR TRUST, ROBERT ALBERT MAJOR and REBECCA ANN RITHER COTRUSTEES 18326 BLUEWATE, HUMBLE, TX, 77346 Code: SAN JUAN 32-7 249H FC HSU	3/8/2019	Arrived at USPS Regional Facility March 11, 2019 <b>Signature Pending</b>
92148969009997901771154807	Dani Papetti	, JOHN LEE TURNER, 525 GILMER ST #108, SULPHUR SPRINGS, TX, 75482 Code: SAN JUAN 32-7 249H FC HSU	3/8/2019	Arrived at USPS Regional Origin Facility March 11, 2019 <b>Signature Pending</b>
92148969009997901771154814	Dani Papetti	, JOHN P MARTINEZ, 69 VILLA DR, PUEBLO, CO, 81001 Code: SAN JUAN 32-7 249H FC HSU	3/8/2019	Arrived at USPS Regional Origin Facility March 11, 2019 <b>Signature Pending</b>
92148969009997901771154821	Dani Papetti	, JOHN W VOGEL TRUST 9-3-01, HARRY A WARREN TRUSTEE 28 RIVERSIDE DR, RED BANK, NJ, 07701 Code: SAN JUAN 32-7 249H FC HSU	3/8/2019	Arrived at USPS Regional Origin Facility March 11, 2019 <b>Signature Pending</b>
92148969009997901771154838	Dani Papetti	, JOHN WILLIAM MCDONALD, 1301 SUNNY HILL CT, BETTENDORF, IA, 52722-2315 Code: SAN JUAN 32-7 249H FC HSU	3/8/2019	Arrived at USPS Regional Origin Facility March 11, 2019 <b>Signature Pending</b>
92148969009997901771154845	Dani Papetti	, JOLENE M JONES TAYLOR, PO BOX 2504, BIG BEAR CITY, CA, 92314 Code: SAN JUAN 32-7 249H FC HSU	3/8/2019	Arrived at USPS Regional Origin Facility March 11, 2019 <b>Signature Pending</b>
92148969009997901771154852	Dani Papetti	, JON TUBBS, PO BOX 13417, SOUTH LAKE TAHOE, CA, 96150 Code: SAN JUAN 32-7 249H FC HSU	3/8/2019	Arrived at USPS Regional Origin Facility March 11, 2019 <b>Signature Pending</b>
92148969009997901771154869	Dani Papetti	, JOSE FERNANDO TRUJILLO, 5733 N GIBRALTER WAY, AURORA, CO, 80019 Code: SAN JUAN 32-7 249H FC HSU	3/8/2019	Arrived at USPS Regional Origin Facility March 11, 2019 <b>Signature Pending</b>
92148969009997901771154876	Dani Papetti	, JOSE MARGARITO TRUJILLO, 1568 CR 327, IGNACIO, CO, 81137-9618 Code: SAN JUAN 32-7 249H FC HSU	3/8/2019	Arrived at USPS Regional Origin Facility March 11, 2019 <b>Signature Pending</b>
92148969009997901771154883	Dani Papetti	, JOSEPH E and TWILA M GOODDING LVG, TRUST MELISSA A RAMSTED TTEE 1009 CRESTVIEW CIR, FARMINGTON, NM, 87401 Code: SAN JUAN 32-7 249H FC HSU	3/8/2019	Arrived at USPS Regional Origin Facility March 11, 2019 <b>Signature Pending</b>
92148969009997901771154890	Dani Papetti	, JOSEPH G GUAGLIARDI JR, MOUNTAIN VLG EST, MACUNGIE, PA, 18062-9801 Code: SAN JUAN 32-7 249H FC HSU	3/8/2019	Departed USPS Regional Origin Facility March 11, 2019 <b>Signature Pending</b>
92148969009997901771154906	Dani Papetti	, JOSEPH L ARCHULETA, 485 CR 326, IGNACIO, CO, 81137 Code: SAN JUAN 32-7 249H FC HSU	3/8/2019	Departed USPS Regional Origin Facility March 11, 2019 <b>Signature Pending</b>
92148969009997901771154913	Dani Papetti	, JOSEPH L MARTIN, PO BOX 245, LA MESA, NM, 88044 Code: SAN JUAN 32-7 249H FC HSU	3/8/2019	Arrived at USPS Regional Origin Facility March 11, 2019 <b>Signature Pending</b>
92148969009997901771154920	Dani Papetti	, JOSEPH L WERTNTZ, 53 TWIN PEAKS RD SE, ALBUQUERQUE, NM, 87123 Code: SAN JUAN 32-7 249H FC HSU	3/8/2019	Arrived at USPS Regional Origin Facility March 11, 2019 <b>Signature Pending</b>
92148969009997901771154937	Dani Papetti	, JOSEPH RAY HUNT, PO BOX 20202, CARSON CITY, NV, 89721 Code: SAN JUAN 32-7 249H FC HSU	3/8/2019	Arrived at USPS Regional Origin Facility March 11, 2019 <b>Signature Pending</b>
92148969009997901771154944	Dani Papetti	, JOSEPHINE A MORRILL, 436 COLUMBIA CT, BOULDER CITY, NV, 89005 Code: SAN JUAN 32-7 249H FC HSU	3/8/2019	Arrived at USPS Regional Origin Facility March 11, 2019 <b>Signature Pending</b>
92148969009997901771154951	Dani Papetti	, JOY SMITH, KAUFMAN PETERSON and DISHLER PC 9939 STATE HWY 12, LA VETA, CO, 81055 Code: SAN JUAN 32-7 249H FC HSU	3/8/2019	Arrived at USPS Regional Origin Facility March 11, 2019 <b>Signature Pending</b>
92148969009997901771154968	Dani Papetti	, JOYCE ANN SASSE, 2500 LONGVIEW DR, COLUMBIA, MO, 65203 Code: SAN JUAN 32-7 249H FC HSU	3/8/2019	Arrived at USPS Regional Origin Facility March 11, 2019 <b>Signature Pending</b>
92148969009997901771154975	Dani Papetti	, JPT FAMILY JV 1, PO BOX 99084, FORT WORTH, TX, 76199-0084 Code: SAN JUAN 32-7 249H FC HSU	3/8/2019	Arrived at USPS Regional Origin Facility March 11, 2019

				<b>Signature Pending</b>
92148969009997901771154982	Dani Papetti	, JUAN P ARCHULETA, 609 ANTELOPE TRL, TEMPLE, TX, 76504 Code: SAN JUAN 32-7 249H FC HSU	3/8/2019	Arrived at USPS Regional Origin Facility March 11, 2019 <b>Signature Pending</b>
92148969009997901771154999	Dani Papetti	, JUANITA SCHATZ, 2110 WALKING TRAIL, STILLWATER, OK, 74074 Code: SAN JUAN 32-7 249H FC HSU	3/8/2019	Arrived at USPS Regional Origin Facility March 11, 2019 <b>Signature Pending</b>
92148969009997901771155002	Dani Papetti	, JUDITH A LISTER REVOCABLE TRUST, 8208 FOREST HEIGHTS, AUSTIN, TX, 78749 Code: SAN JUAN 32-7 249H FC HSU	3/8/2019	Arrived at USPS Regional Origin Facility March 11, 2019 <b>Signature Pending</b>
92148969009997901771155019	Dani Papetti	, JUDITH F RICE, 87 BEAVER LAKE DR UNIT 5063, ELIJAY, GA, 30540 Code: SAN JUAN 32-7 249H FC HSU	3/8/2019	Departed USPS Regional Origin Facility March 11, 2019 <b>Signature Pending</b>
92148969009997901771155026	Dani Papetti	, JUDITH K BAKER, 812 1ST ST APT 26, KAMIAH, ID, 83536 Code: SAN JUAN 32-7 249H FC HSU	3/8/2019	Departed USPS Regional Origin Facility March 11, 2019 <b>Signature Pending</b>
92148969009997901771155033	Dani Papetti	, JULIE J MARTIN, PO BOX 10911, SOUTHPORT, NC, 28461-1342 Code: SAN JUAN 32-7 249H FC HSU	3/8/2019	Arrived at USPS Regional Origin Facility March 11, 2019 <b>Signature Pending</b>
92148969009997901771155040	Dani Papetti	, JULIE J MARTIN, PO BOX 10911, SOUTHPORT, NC, 28461-0911 Code: SAN JUAN 32-7 249H FC HSU	3/8/2019	Arrived at USPS Regional Origin Facility March 11, 2019 <b>Signature Pending</b>
92148969009997901771155057	Dani Papetti	, JUNE BROWN ESTATE, HOMER E BROWN IND EXEC 5711 MEADOWCREEK LN, HOUSTON, TX, 77017-6809 Code: SAN JUAN 32-7 249H FC HSU	3/8/2019	Arrived at USPS Regional Facility March 11, 2019 <b>Signature Pending</b>
92148969009997901771155064	Dani Papetti	, JUNE H VALELLA, 17313 SE INDIAN HILL DR, TEQUESTA, FL, 33469 Code: SAN JUAN 32-7 249H FC HSU	3/8/2019	Arrived at USPS Regional Origin Facility March 11, 2019 <b>Signature Pending</b>
92148969009997901771155071	Dani Papetti	, JUSTIN L TOWNSLEY JR, 3120 PAWTUCKET RD, NORTHBROOK, IL, 60062-4357 Code: SAN JUAN 32-7 249H FC HSU	3/8/2019	Arrived at USPS Regional Origin Facility March 11, 2019 <b>Signature Pending</b>
92148969009997901771155088	Dani Papetti	, JUSTIN NINE, and SARA NINE 4414 10TH ST, LUBBOCK, TX, 79416 Code: SAN JUAN 32-7 249H FC HSU	3/8/2019	Arrived at USPS Regional Origin Facility March 11, 2019 <b>Signature Pending</b>
92148969009997901771155095	Dani Papetti	, KAREN H CRIDLIN, PO BOX 703, JONESVILLE, VA, 24263 Code: SAN JUAN 32-7 249H FC HSU	3/8/2019	Arrived at USPS Regional Origin Facility March 11, 2019 <b>Signature Pending</b>
92148969009997901771155101	Dani Papetti	, KAREN LAWRENCE COMBINATION TRUST, KAREN ANDREW LAWRENCE TTEE 1416 CAPITARE, NEW BRAUNFELS, TX, 78132 Code: SAN JUAN 32-7 249H FC HSU	3/8/2019	Arrived at USPS Regional Origin Facility March 11, 2019 <b>Signature Pending</b>
92148969009997901771155118	Dani Papetti	, KAREN SELF HIGASHINO, 4112 FASSETT CT, ELK GROVE, CA, 95758-6404 Code: SAN JUAN 32-7 249H FC HSU	3/8/2019	Arrived at USPS Regional Origin Facility March 11, 2019 <b>Signature Pending</b>
92148969009997901771155125	Dani Papetti	, KATHERINE L WENIG, 5721 SE 30TH CT, DES MOINES, IA, 50320 Code: SAN JUAN 32-7 249H FC HSU	3/8/2019	Departed USPS Regional Origin Facility March 11, 2019 <b>Signature Pending</b>
92148969009997901771155132	Dani Papetti	, KATHLEEN HERD COMBINATION TRUST, KATHLEEN ANDREW HERD TRUSTEE 717 CAMELOT LN, HOUSTON, TX, 77024 Code: SAN JUAN 32-7 249H FC HSU	3/8/2019	Arrived at USPS Regional Facility March 11, 2019 <b>Signature Pending</b>
92148969009997901771155149	Dani Papetti	, KATHLEEN L GELBACH ESTATE, 129 SO 96TH ST, TACOMA, WA, 98444 Code: SAN JUAN 32-7 249H FC HSU	3/8/2019	Arrived at USPS Regional Origin Facility March 11, 2019 <b>Signature Pending</b>
92148969009997901771155156	Dani Papetti	, KAY DIANE BOWLES TRUST NOV 29 2007, KAY DIANE BOWLES TRUSTEE 6209 BROOKSIDE DR, CHEVY CHASE, MD, 20815 Code: SAN JUAN 32-7 249H FC HSU	3/8/2019	Arrived at USPS Regional Origin Facility March 11, 2019 <b>Signature Pending</b>
92148969009997901771155163	Dani Papetti	, KELLY H BAXTER ESTATE, ASHLEY BAXTER, EXECUTOR P O BOX 1649, AUSTIN, TX, 78767-1649 Code: SAN JUAN 32-7 249H FC HSU	3/8/2019	Departed USPS Regional Origin Facility March 11, 2019 <b>Signature Pending</b>



92148969009997901771155170	Dani Papetti	, KEN TEMPLE, and CAROLYN TEMPLE JT 2721 MESA AVE, DURANGO, CO, 81301 Code: SAN JUAN 32-7 249H FC HSU	3/8/2019	Arrived at USPS Regional Origin Facility March 11, 2019 <b>Signature Pending</b>
92148969009997901771155187	Dani Papetti	, KENEBREW MINERALS LP, PO BOX 917, IDALOU, TX, 79329 Code: SAN JUAN 32-7 249H FC HSU	3/8/2019	Arrived at USPS Regional Origin Facility March 11, 2019 <b>Signature Pending</b>
92148969009997901771155194	Dani Papetti	, KENNEDY MINERALS LTD, 500 W TEXAS AVE SUITE 655, MIDLAND, TX, 79701 Code: SAN JUAN 32-7 249H FC HSU	3/8/2019	Arrived at USPS Regional Origin Facility March 11, 2019 <b>Signature Pending</b>
92148969009997901771155200	Dani Papetti	, KENNETH A MANNING, 725 HELMS WAY, CONWAY, SC, 29526 Code: SAN JUAN 32-7 249H FC HSU	3/8/2019	Arrived at USPS Regional Origin Facility March 11, 2019 <b>Signature Pending</b>
92148969009997901771155217	Dani Papetti	, KENNETH ROBERT SCHMIDT, 6819 OAK LAWN WY, FAIR OAKS, CA, 95628 Code: SAN JUAN 32-7 249H FC HSU	3/8/2019	Arrived at USPS Regional Origin Facility March 11, 2019 <b>Signature Pending</b>
92148969009997901771155224	Dani Papetti	, KENNETH W BROWN, 7677 JAYHAWK DR, RIVERSIDE, CA, 92509 Code: SAN JUAN 32-7 249H FC HSU	3/8/2019	Arrived at USPS Regional Origin Facility March 11, 2019 <b>Signature Pending</b>
92148969009997901771155231	Dani Papetti	, KEVIN K LEONARD, PO BOX 50688, MIDLAND, TX, 79710 Code: SAN JUAN 32-7 249H FC HSU	3/8/2019	Arrived at USPS Regional Origin Facility March 11, 2019 <b>Signature Pending</b>
92148969009997901771155248	Dani Papetti	, KIMBERLIE DIANE ADAMS, 101 LINCOLNSHIRE, CHRISMAN, IL, 61924 Code: SAN JUAN 32-7 249H FC HSU	3/8/2019	Arrived at USPS Regional Origin Facility March 11, 2019 <b>Signature Pending</b>
92148969009997901771155255	Dani Papetti	, KRIS TUBBS, PO BOX 10284, SOUTH LAKE TAHOE, CA, 96158 Code: SAN JUAN 32-7 249H FC HSU	3/8/2019	Arrived at USPS Regional Origin Facility March 11, 2019 <b>Signature Pending</b>
92148969009997901771155262	Dani Papetti	, KRISTIN DAWN BAKER ASHTON, PO BOX 371, EAST HELENA, MT, 59635 Code: SAN JUAN 32-7 249H FC HSU	3/8/2019	Arrived at USPS Regional Origin Facility March 11, 2019 <b>Signature Pending</b>
92148969009997901771155279	Dani Papetti	, LAFA LLC, PO BOX 1750, DURANGO, CO, 81302-1750 Code: SAN JUAN 32-7 249H FC HSU	3/8/2019	Arrived at USPS Regional Origin Facility March 11, 2019 <b>Signature Pending</b>
92148969009997901771155286	Dani Papetti	, LANA WOODFILL, 21 RD 2980, AZTEC, NM, 87410 Code: SAN JUAN 32-7 249H FC HSU	3/8/2019	Arrived at USPS Regional Origin Facility March 11, 2019 <b>Signature Pending</b>
92148969009997901771155293	Dani Papetti	, LANCE REEMTSMA, 2601 GRANT ST, BERKELEY, CA, 94703 Code: SAN JUAN 32-7 249H FC HSU	3/8/2019	Arrived at USPS Regional Origin Facility March 11, 2019 <b>Signature Pending</b>
92148969009997901771155309	Dani Papetti	, LAREA DELL CRAIG, 14900 HWY 550 S, DURANGO, CO, 81303 Code: SAN JUAN 32-7 249H FC HSU	3/8/2019	Arrived at USPS Regional Origin Facility March 11, 2019 <b>Signature Pending</b>
92148969009997901771155316	Dani Papetti	, LARRY D SEIBEL, PO BOX 368, IGNACIO, CO, 81137-0368 Code: SAN JUAN 32-7 249H FC HSU	3/8/2019	Arrived at USPS Regional Origin Facility March 11, 2019 <b>Signature Pending</b>
92148969009997901771155323	Dani Papetti	, LARRY J CLARK, 25540 E HWY 40, DENNISON, IL, 62423 Code: SAN JUAN 32-7 249H FC HSU	3/8/2019	Arrived at USPS Regional Origin Facility March 11, 2019 <b>Signature Pending</b>
92148969009997901771155330	Dani Papetti	, LAURA ANN GILES, 2816 ESMERELDA DR, BULLHEAD CITY, AZ, 86429 Code: SAN JUAN 32-7 249H FC HSU	3/8/2019	Arrived at USPS Regional Origin Facility March 11, 2019 <b>Signature Pending</b>
92148969009997901771155347	Dani Papetti	, LAURA DICHTER, 203 JACKSON ST, DENVER, CO, 80206 Code: SAN JUAN 32-7 249H FC HSU	3/8/2019	Arrived at USPS Regional Origin Facility March 11, 2019 <b>Signature Pending</b>
92148969009997901771155354	Dani Papetti	, LENA M COCHRAN, 24377 NEWHALL AVE, NEWHALL, CA, 91321-2742 Code: SAN JUAN 32-7 249H FC HSU	3/8/2019	Departed USPS Regional Origin Facility March 11, 2019 <b>Signature Pending</b>
92148969009997901771155361		, LEROY SELF, #238 RD 4020, IGNACIO, CO, 81137		Arrived at USPS Regional Origin Facility

	Dani Papetti	Code: SAN JUAN 32-7 249H FC HSU	3/8/2019	March 11, 2019 <b>Signature Pending</b>
92148969009997901771155378	Dani Papetti	, LESLIE TATUM, PO BOX 7392, N KANSAS CITY, MO, 64116-0092 Code: SAN JUAN 32-7 249H FC HSU	3/8/2019	Arrived at USPS Regional Origin Facility March 11, 2019 <b>Signature Pending</b>
92148969009997901771155385	Dani Papetti	, LILLIAN SNAVELY, PO BOX 687, SHASTA LAKE, CA, 96019 Code: SAN JUAN 32-7 249H FC HSU	3/8/2019	Arrived at USPS Regional Origin Facility March 11, 2019 <b>Signature Pending</b>
92148969009997901771155392	Dani Papetti	, LINDA BARRY, 471 11TH ST, CRAMERTON, NC, 28032 Code: SAN JUAN 32-7 249H FC HSU	3/8/2019	Arrived at USPS Regional Origin Facility March 11, 2019 <b>Signature Pending</b>
92148969009997901771155408	Dani Papetti	, LINDA HARTNESS JAMES, 126 MIDDLE RD, WOOLWICH, ME, 04579-9701 Code: SAN JUAN 32-7 249H FC HSU	3/8/2019	Arrived at USPS Regional Origin Facility March 11, 2019 <b>Signature Pending</b>
92148969009997901771155415	Dani Papetti	, LINDA JEANNE LUNDELL LINDSEY, PO BOX 631565, NACOGDOCHES, TX, 75963 Code: SAN JUAN 32-7 249H FC HSU	3/8/2019	Arrived at USPS Regional Facility March 11, 2019 <b>Signature Pending</b>
92148969009997901771155422	Dani Papetti	, LINDA L BRIGGS, 16273 W CNTY RD 66, CRESCENT, OK, 73028 Code: SAN JUAN 32-7 249H FC HSU	3/8/2019	Arrived at USPS Regional Origin Facility March 11, 2019 <b>Signature Pending</b>
92148969009997901771155439	Dani Papetti	, LINDA L COLLINS REVOCABLE TRUST, LINDA L COLLINS TRTEE 2509 CLIFFWOOD DR, LAKE HAVASU CITY, AZ, 86403 Code: SAN JUAN 32-7 249H FC HSU	3/8/2019	Arrived at USPS Regional Origin Facility March 11, 2019 <b>Signature Pending</b>
92148969009997901771155446	Dani Papetti	, LINDA SUE RICHARDSON, 13363 E ASBURY DR, AURORA, CO, 80014 Code: SAN JUAN 32-7 249H FC HSU	3/8/2019	Arrived at USPS Regional Origin Facility March 11, 2019 <b>Signature Pending</b>
92148969009997901771155453	Dani Papetti	, LLOYD DAVID and EMMA LYDIA OLGUIN LVG, TRUST LLOYD DAVID OLGUIN TRUSTEE 24 CR 3008, AZTEC, NM, 87410 Code: SAN JUAN 32-7 249H FC HSU	3/8/2019	Arrived at USPS Regional Origin Facility March 11, 2019 <b>Signature Pending</b>
92148969009997901771155460	Dani Papetti	, LOIS A STANSELL, 17345 HWY 50, LAS ANIMAS, CO, 81054 Code: SAN JUAN 32-7 249H FC HSU	3/8/2019	Arrived at USPS Regional Origin Facility March 11, 2019 <b>Signature Pending</b>
92148969009997901771155477	Dani Papetti	, LOIS M LUNDBLADE, 527 EAST CLACKAMAS CIR, WOODBURN, OR, 97071-4409 Code: SAN JUAN 32-7 249H FC HSU	3/8/2019	Arrived at USPS Regional Origin Facility March 11, 2019 <b>Signature Pending</b>
92148969009997901771155484	Dani Papetti	, LOIS RICE, JANICE CHULICK P/O/A 13040 RIDGEVIEW DR, SUTTER CREEK, CA, 95685-9639 Code: SAN JUAN 32-7 249H FC HSU	3/8/2019	Arrived at USPS Regional Origin Facility March 11, 2019 <b>Signature Pending</b>
92148969009997901771155491	Dani Papetti	, LORRAYN GAY HACKER, PO BOX 291445, KERRVILLE, TX, 78029-1445 Code: SAN JUAN 32-7 249H FC HSU	3/8/2019	Arrived at USPS Regional Origin Facility March 11, 2019 <b>Signature Pending</b>
92148969009997901771155507	Dani Papetti	, LOUIS T FAVERINO LLC, PO BOX 8, BLOOMFIELD, NM, 87413 Code: SAN JUAN 32-7 249H FC HSU	3/8/2019	Arrived at USPS Regional Origin Facility March 11, 2019 <b>Signature Pending</b>
92148969009997901771155514	Dani Papetti	, LT BENEFIT TR FBA STEPHEN J FORD, STEPHEN FORD TRUSTEE PO BOX 3722, CAMARILLO, CA, 93011 Code: SAN JUAN 32-7 249H FC HSU	3/8/2019	Arrived at USPS Regional Origin Facility March 11, 2019 <b>Signature Pending</b>
92148969009997901771155521	Dani Papetti	, LUCILE W HAYS FAMILY LTD, PARTNERSHIP 12377 MERIT DR STE 777, DALLAS, TX, 75251 Code: SAN JUAN 32-7 249H FC HSU	3/8/2019	Departed USPS Regional Origin Facility March 11, 2019 <b>Signature Pending</b>
92148969009997901771155538	Dani Papetti	, LUCILLE E GRIM REVOC TRUST, MYRNA L FORD TRUSTEE 3900 CR 250, DURANGO, CO, 81301-8617 Code: SAN JUAN 32-7 249H FC HSU	3/8/2019	Arrived at USPS Regional Origin Facility March 11, 2019 <b>Signature Pending</b>
92148969009997901771155545	Dani Papetti	, LUTHERAN CHURCH MISSOURI SYNOD, FOUNDATION ATTN SARA FUELLING/MATTHEWS 1333 S KIRKWOOD RD, SAINT LOUIS, MO, 63122- 7226 Code: SAN JUAN 32-7 249H FC HSU	3/8/2019	Arrived at USPS Regional Origin Facility March 11, 2019 <b>Signature Pending</b>
92148969009997901771155552	Dani Papetti	, M FRANCES TROXEL, 201 W DURFEE ST, GRANTSVILLE, UT, 84029 Code: SAN JUAN 32-7 249H FC HSU	3/8/2019	Departed USPS Regional Origin Facility March 11, 2019

				Signature Pending
92148969009997901771155569	Dani Papetti	, M J FLORANCE TRUST, NTB SUCCESSOR TRUSTEE PO BOX 226270, DALLAS, TX, 75222-6270 Code: SAN JUAN 32-7 249H FC HSU	3/8/2019	Arrived at USPS Regional Origin Facility March 11, 2019 Signature Pending
92148969009997901771155576	Dani Papetti	, MADELINE DOWLING, 5348 W 137TH PL, CRESTWOOD, IL, 60445 Code: SAN JUAN 32-7 249H FC HSU	3/8/2019	Arrived at USPS Regional Origin Facility March 11, 2019 Signature Pending
92148969009997901771155583	Dani Papetti	, MADELINE MADARANG, 705 BURTON ST, ROCKY MOUNT, NC, 27803-1904 Code: SAN JUAN 32-7 249H FC HSU	3/8/2019	Arrived at USPS Regional Origin Facility March 11, 2019 Signature Pending
92148969009997901771155590	Dani Papetti	, MADISON CAPITAL ENERGY INCOME FUND, I LP 402 GAMMON PL SUITE 320, MADISON, WI, 53719 Code: SAN JUAN 32-7 249H FC HSU	3/8/2019	Arrived at USPS Regional Origin Facility March 11, 2019 Signature Pending
92148969009997901771155606	Dani Papetti	, MADISON ROYALTY MANAGEMENT LLC, FBO GH TRUSTS 402 GAMMON PL STE 200, MADISON, WI, 53719 Code: SAN JUAN 32-7 249H FC HSU	3/8/2019	Arrived at USPS Regional Origin Facility March 11, 2019 Signature Pending
92148969009997901771155613	Dani Papetti	, MADONNA K HEALY, and MICHAEL C HEALY 4127 CR 6920, WEST PLAINS, MO, 65775 Code: SAN JUAN 32-7 249H FC HSU	3/8/2019	Arrived at USPS Regional Origin Facility March 11, 2019 Signature Pending
92148969009997901771155620	Dani Papetti	, MANHATTAN CHRISTIAN, COLLEGE 1415 ANDERSON AVE, MANHATTAN, KS, 66502-4030 Code: SAN JUAN 32-7 249H FC HSU	3/8/2019	Arrived at USPS Regional Origin Facility March 11, 2019 Signature Pending
92148969009997901771155637	Dani Papetti	, MAP 92 96 MGD, PO BOX 268984, OKLAHOMA CITY, OK, 73126-8984 Code: SAN JUAN 32-7 249H FC HSU	3/8/2019	Arrived at USPS Regional Origin Facility March 11, 2019 Signature Pending
92148969009997901771155644	Dani Papetti	, MAP HOLDINGS, PO BOX 268947, OKLAHOMA CITY, OK, 73126-8947 Code: SAN JUAN 32-7 249H FC HSU	3/8/2019	Arrived at USPS Regional Origin Facility March 11, 2019 Signature Pending
92148969009997901771155651	Dani Papetti	, MAP KandW OK, PO BOX 269031, OKLAHOMA CITY, OK, 73126-9031 Code: SAN JUAN 32-7 249H FC HSU	3/8/2019	Arrived at USPS Regional Origin Facility March 11, 2019 Signature Pending
92148969009997901771155668	Dani Papetti	, MAP MRP, PO BOX 269031, OKLAHOMA CITY, OK, 73126-9031 Code: SAN JUAN 32-7 249H FC HSU	3/8/2019	Arrived at USPS Regional Origin Facility March 11, 2019 Signature Pending
92148969009997901771155675	Dani Papetti	, MARC LILLEY, and LISA LILLEY 2135 SEDONA HILLS PKWY, LAS CRUCES, NM, 88011 Code: SAN JUAN 32-7 249H FC HSU	3/8/2019	Arrived at USPS Regional Origin Facility March 11, 2019 Signature Pending
92148969009997901771155682	Dani Papetti	, MARCELLA RUPEL RESIDUARY TRUST, ROBERT W RUPEL TRUSTEE 62 W COOLRIDGE AVE, CHARLESTON, IL, 61912 Code: SAN JUAN 32-7 249H FC HSU	3/8/2019	Arrived at USPS Regional Origin Facility March 11, 2019 Signature Pending
92148969009997901771155699	Dani Papetti	, MARCIA L BERGER EDUCATIONAL FNDN, PETROLEUM ASSET MGMT LLC AGENT PO BOX 745, HOBBS, NM, 88241 Code: SAN JUAN 32-7 249H FC HSU	3/8/2019	Arrived at USPS Regional Origin Facility March 11, 2019 Signature Pending
92148969009997901771155705	Dani Papetti	, MARGARET JUNE CLARK LIFE TENANT, MARTHA GENE LAMBERT REMAINDERMAN 7160 S 400 E, MARKLEVILLE, IN, 46056 Code: SAN JUAN 32-7 249H FC HSU	3/8/2019	Arrived at USPS Regional Origin Facility March 11, 2019 Signature Pending
92148969009997901771155712	Dani Papetti	, MARGARET MEHL, 702 NE CAMBRIDGE DR, LEES SUMMIT, MO, 64086-5420 Code: SAN JUAN 32-7 249H FC HSU	3/8/2019	Arrived at USPS Regional Origin Facility March 11, 2019 Signature Pending
92148969009997901771155729	Dani Papetti	, MARGUERITTE ATKINSON, and EVALEE MILLER ACCOUNT C/O STATE COMPTROLLER UNCLAIMED PROPERTY S, SACRAMENTO, CA, 94250 Code: SAN JUAN 32-7 249H FC HSU	3/8/2019	Departed USPS Regional Origin Facility March 11, 2019 Signature Pending
92148969009997901771155736	Dani Papetti	, MARIA ALACANTA ALBO, TONY MARTIN ALBO and CONNIE MARIE ALBO SANCHEZ POA 429 E 4TH AVE, DURANGO, CO, 81301 Code: SAN JUAN 32-7 249H FC HSU	3/8/2019	Departed USPS Regional Origin Facility March 11, 2019 Signature Pending
92148969009997901771155743	Dani Papetti	, MARIA ALACANTA ALBO, PO BOX 214, DURANGO, CO, 81302-0214 Code: SAN JUAN 32-7 249H FC HSU	3/8/2019	Arrived at USPS Regional Origin Facility March 11, 2019 Signature Pending

92148969009997901771155750	Dani Papetti	, MARIA ELENA TRUJILLO, BOX 928, IGNACIO, CO, 81137-0928 Code: SAN JUAN 32-7 249H FC HSU	3/8/2019	Arrived at USPS Regional Origin Facility March 11, 2019 <b>Signature Pending</b>
92148969009997901771155767	Dani Papetti	, MARIA ELIZA TRUJILLO, PO BOX 1218, IGNACIO, CO, 81137-1218 Code: SAN JUAN 32-7 249H FC HSU	3/8/2019	Arrived at USPS Regional Origin Facility March 11, 2019 <b>Signature Pending</b>
92148969009997901771155774	Dani Papetti	, MARIA LUCIA STEWART, PO BOX 848, BAYFIELD, CO, 81122-0848 Code: SAN JUAN 32-7 249H FC HSU	3/8/2019	Arrived at USPS Regional Origin Facility March 11, 2019 <b>Signature Pending</b>
92148969009997901771155781	Dani Papetti	, MARIE A LAGERSTROM, 7950 HWY 151, IGNACIO, CO, 81137 Code: SAN JUAN 32-7 249H FC HSU	3/8/2019	Arrived at USPS Regional Origin Facility March 11, 2019 <b>Signature Pending</b>
92148969009997901771155798	Dani Papetti	, MARIE DOREEN GALLEGOS, 613 OSO RIDGE RD, GRANTS, NM, 87020 Code: SAN JUAN 32-7 249H FC HSU	3/8/2019	Arrived at USPS Regional Origin Facility March 11, 2019 <b>Signature Pending</b>
92148969009997901771155804	Dani Papetti	, MARIE J SALEGO, FRANK G MARTINEZ POA 102 W 30TH DR, PHOENIX, AZ, 85009 Code: SAN JUAN 32-7 249H FC HSU	3/8/2019	Arrived at USPS Regional Origin Facility March 11, 2019 <b>Signature Pending</b>
92148969009997901771155811	Dani Papetti	, MARIE M MCCAULEY, JEAN M MCCOY GUARDIAN 24 SCHMIDT ST, CLAREMONT, NH, 03743-4811 Code: SAN JUAN 32-7 249H FC HSU	3/8/2019	Arrived at USPS Regional Origin Facility March 11, 2019 <b>Signature Pending</b>
92148969009997901771155828	Dani Papetti	, MARIE RICE, 13040 RIDGE VIEW DR, SUTTER CREEK, CA, 95685-9639 Code: SAN JUAN 32-7 249H FC HSU	3/8/2019	Departed USPS Regional Origin Facility March 11, 2019 <b>Signature Pending</b>
92148969009997901771155835	Dani Papetti	, MARION A PIRTLE, 7001 142ND AVE N, LARGO, FL, 33771-4747 Code: SAN JUAN 32-7 249H FC HSU	3/8/2019	Arrived at USPS Regional Origin Facility March 11, 2019 <b>Signature Pending</b>
92148969009997901771155842	Dani Papetti	, MARJORIE L WILKINS, PO BOX 1034, KAMIAH, ID, 83536 Code: SAN JUAN 32-7 249H FC HSU	3/8/2019	Departed USPS Regional Origin Facility March 11, 2019 <b>Signature Pending</b>
92148969009997901771155859	Dani Papetti	, MARJORIE YVONNE REA, 333 E CINNAMON DR. APT 5, LEMOORE, CA, 93245 Code: SAN JUAN 32-7 249H FC HSU	3/8/2019	Departed USPS Regional Origin Facility March 11, 2019 <b>Signature Pending</b>
92148969009997901771155866	Dani Papetti	, MARK CHAVEZ, 9624 SAN RAFAEL NE, ALBUQUERQUE, NM, 87109 Code: SAN JUAN 32-7 249H FC HSU	3/8/2019	Arrived at USPS Regional Origin Facility March 11, 2019 <b>Signature Pending</b>
92148969009997901771155873	Dani Papetti	, MARK MCCLELLAN, and PAULA S MCCLELLAN PO DRAWER 730, ROSWELL, NM, 88202-0730 Code: SAN JUAN 32-7 249H FC HSU	3/8/2019	Arrived at USPS Regional Origin Facility March 11, 2019 <b>Signature Pending</b>
92148969009997901771155880	Dani Papetti	, MARVEL DIANE STANLEY, 93 LIGHTHOUSE LN, MONETA, VA, 24121 Code: SAN JUAN 32-7 249H FC HSU	3/8/2019	Arrived at USPS Regional Origin Facility March 11, 2019 <b>Signature Pending</b>
92148969009997901771155897	Dani Papetti	, MARY AGNES CHRISTENSEN, PO BOX 1813, ARBOLES, CO, 81121-1813 Code: SAN JUAN 32-7 249H FC HSU	3/8/2019	Arrived at USPS Regional Origin Facility March 11, 2019 <b>Signature Pending</b>
92148969009997901771155903	Dani Papetti	, MARY ANN BOYD, 1912 S 31ST ST, TERRE HAUTE, IN, 47803 Code: SAN JUAN 32-7 249H FC HSU	3/8/2019	Arrived at USPS Regional Origin Facility March 11, 2019 <b>Signature Pending</b>
92148969009997901771155910	Dani Papetti	, MARY ANN HAUG, 1200 HUMBOLDT #905, DENVER, CO, 80218-2461 Code: SAN JUAN 32-7 249H FC HSU	3/8/2019	Arrived at USPS Regional Origin Facility March 11, 2019 <b>Signature Pending</b>
92148969009997901771155927	Dani Papetti	, MARY B LOPEZ, 335 CR 328, IGNACIO, CO, 81137-9626 Code: SAN JUAN 32-7 249H FC HSU	3/8/2019	Arrived at USPS Regional Origin Facility March 11, 2019 <b>Signature Pending</b>
92148969009997901771155934	Dani Papetti	, MARY F ROBERTS, C/O D KEITH ROBERTS AGENT PO BOX 2203, RUIDOSO, NM, 88355 Code: SAN JUAN 32-7 249H FC HSU	3/8/2019	Arrived at USPS Regional Origin Facility March 11, 2019 <b>Signature Pending</b>
92148969009997901771155941		, MARY HARRIS, 1100 W 15TH ST #5, OTTAWA, KS,		Arrived at USPS Regional Origin Facility

	Dani Papetti	66067 Code: SAN JUAN 32-7 249H FC HSU	3/8/2019	March 11, 2019 <b>Signature Pending</b>
92148969009997901771155958	Dani Papetti	, MARY ILIFF, PO BOX 2188, LANCASTER, CA, 93539 Code: SAN JUAN 32-7 249H FC HSU	3/8/2019	Departed USPS Regional Origin Facility March 11, 2019 <b>Signature Pending</b>
92148969009997901771155965	Dani Papetti	, MARY L HERROLD REVOC TR, DTD 1/7/92 8677 E 104TH PL S, TULSA, OK, 74133 Code: SAN JUAN 32-7 249H FC HSU	3/8/2019	Arrived at USPS Regional Origin Facility March 11, 2019 <b>Signature Pending</b>
92148969009997901771155972	Dani Papetti	, MARY LOU LUNDBLADE, 511 W NESS ST, VALLEY CENTER, KS, 67147-4920 Code: SAN JUAN 32-7 249H FC HSU	3/8/2019	Departed USPS Regional Origin Facility March 11, 2019 <b>Signature Pending</b>
92148969009997901771155989	Dani Papetti	, MAXINE C ANDERSON, GREGORY D HARMON CONSERVATOR PO BOX 988, IGNACIO, CO, 81137 Code: SAN JUAN 32-7 249H FC HSU	3/8/2019	Arrived at USPS Regional Origin Facility March 11, 2019 <b>Signature Pending</b>
92148969009997901771155996	Dani Papetti	, MCCARTY FAMILY TRUST, WILLIAM R MCCARTY and RONALD GENE MCCARTY COTR PO BOX 840738, DALLAS, TX, 75284-0738 Code: SAN JUAN 32-7 249H FC HSU	3/8/2019	Arrived at USPS Regional Origin Facility March 11, 2019 <b>Signature Pending</b>
92148969009997901771156009	Dani Papetti	, MCELVAIN OIL COMPANY, DAVID P MCELVAIN PO BOX 801888, DALLAS, TX, 75380-1888 Code: SAN JUAN 32-7 249H FC HSU	3/8/2019	Arrived at USPS Regional Facility March 11, 2019 <b>Signature Pending</b>
92148969009997901771156016	Dani Papetti	, MEAGHER OILandGAS PROPERTIES INC, PO BOX 4782, ENGLEWOOD, CO, 80155-4782 Code: SAN JUAN 32-7 249H FC HSU	3/8/2019	Arrived at USPS Regional Origin Facility March 11, 2019 <b>Signature Pending</b>
92148969009997901771156023	Dani Papetti	, MEKUSUKEY OIL COMPANY LLC, PO BOX 816, WEWOKA, OK, 74884-0816 Code: SAN JUAN 32-7 249H FC HSU	3/8/2019	Arrived at USPS Regional Origin Facility March 11, 2019 <b>Signature Pending</b>
92148969009997901771156030	Dani Papetti	, MERLE RICE, PO BOX 194, LOCKEFORD, CA, 95237-0194 Code: SAN JUAN 32-7 249H FC HSU	3/8/2019	Arrived at USPS Regional Origin Facility March 11, 2019 <b>Signature Pending</b>
92148969009997901771156047	Dani Papetti	, MERNA GILBERT LIFE ESTATE, STEVEN GILBERT REMAINDERMAN 1423 WABASH AVE, PUEBLO, CO, 81004 Code: SAN JUAN 32-7 249H FC HSU	3/8/2019	Arrived at USPS Regional Origin Facility March 11, 2019 <b>Signature Pending</b>
92148969009997901771156054	Dani Papetti	, MERRION OIL and GAS CORP, 610 REILLY AVE, FARMINGTON, NM, 87401-2634 Code: SAN JUAN 32-7 249H FC HSU	3/8/2019	Arrived at USPS Regional Origin Facility March 11, 2019 <b>Signature Pending</b>
92148969009997901771156061	Dani Papetti	, MICHAEL C ABRAHAM, PO BOX 25123, ALBUQUERQUE, NM, 87125-0123 Code: SAN JUAN 32-7 249H FC HSU	3/8/2019	Arrived at USPS Regional Origin Facility March 11, 2019 <b>Signature Pending</b>
92148969009997901771156078	Dani Papetti	, MICHAEL CONRY, 3212 E COUNTY RD 136, MIDLAND, TX, 79706 Code: SAN JUAN 32-7 249H FC HSU	3/8/2019	Arrived at USPS Regional Origin Facility March 11, 2019 <b>Signature Pending</b>
92148969009997901771156085	Dani Papetti	, MICHAEL CUNNINGHAM, DBA CUTTER RESOURCES LLC PO BOX 1000, TATUM, NM, 88267 Code: SAN JUAN 32-7 249H FC HSU	3/8/2019	Arrived at USPS Regional Origin Facility March 11, 2019 <b>Signature Pending</b>
92148969009997901771156092	Dani Papetti	, MICHAEL ROBERT MCLAUGHLIN, 90 SKI RD, LIBBY, MT, 59923-2832 Code: SAN JUAN 32-7 249H FC HSU	3/8/2019	Departed USPS Regional Origin Facility March 11, 2019 <b>Signature Pending</b>
92148969009997901771156108	Dani Papetti	, MICHAEL SCIESZINSKI, 125 PARKVIEW DR, ALBIA, IA, 52531 Code: SAN JUAN 32-7 249H FC HSU	3/8/2019	Arrived at USPS Regional Origin Facility March 11, 2019 <b>Signature Pending</b>
92148969009997901771156115	Dani Papetti	, MICKIE MARIE BUCKANS, PO BOX 613, PENN VALLEY, CA, 95946 Code: SAN JUAN 32-7 249H FC HSU	3/8/2019	Departed USPS Regional Origin Facility March 11, 2019 <b>Signature Pending</b>
92148969009997901771156122	Dani Papetti	, MIKE FULLER, 3163 MASCARENAS DR, AZTEC, NM, 87410 Code: SAN JUAN 32-7 249H FC HSU	3/8/2019	Arrived at USPS Regional Origin Facility March 11, 2019 <b>Signature Pending</b>
92148969009997901771156139	Dani Papetti	, MILDRED C MAITLEN, PO BOX 365, WATERFLOW, NM, 87421-0365 Code: SAN JUAN 32-7 249H FC HSU	3/8/2019	Arrived at USPS Regional Origin Facility March 11, 2019 <b>Signature Pending</b>

92148969009997901771156146	Dani Papetti	, MILDRED C MAITLEN LIFE TENANT, PO BOX 365, WATERFLOW, NM, 87421 Code: SAN JUAN 32-7 249H FC HSU	3/8/2019	Arrived at USPS Regional Origin Facility March 11, 2019 <b>Signature Pending</b>
92148969009997901771156153	Dani Papetti	, MITCHELL ROYALTY LP, 17878 W 77TH ST N, HASKELL, OK, 74436 Code: SAN JUAN 32-7 249H FC HSU	3/8/2019	Arrived at USPS Regional Origin Facility March 11, 2019 <b>Signature Pending</b>
92148969009997901771156160	Dani Papetti	, ML PETERSON LLC, 410 APPLE ST, CRAIG, CO, 81625 Code: SAN JUAN 32-7 249H FC HSU	3/8/2019	Departed USPS Regional Origin Facility March 11, 2019 <b>Signature Pending</b>
92148969009997901771156177	Dani Papetti	, MOLLIE FRANCES SMOUSE, PO BOX 93, FRUITLAND, NM, 87416-0093 Code: SAN JUAN 32-7 249H FC HSU	3/8/2019	Arrived at USPS Regional Origin Facility March 11, 2019 <b>Signature Pending</b>
92148969009997901771156184	Dani Papetti	, MULLIGAN LP, 1202 RICHARDSON DR STE 115, RICHARDSON, TX, 75080-4611 Code: SAN JUAN 32-7 249H FC HSU	3/8/2019	Arrived at USPS Regional Origin Facility March 11, 2019 <b>Signature Pending</b>
92148969009997901771156191	Dani Papetti	, MYRNA L FORD LVG TRUST MAR 14 2000, MYRNA L FORD TRUSTEE 3900 CR 250, DURANGO, CO, 81301 Code: SAN JUAN 32-7 249H FC HSU	3/8/2019	Arrived at USPS Regional Origin Facility March 11, 2019 <b>Signature Pending</b>
92148969009997901771156207	Dani Papetti	, NEAL SELF, 9363 LUFKIN WAY, ELK GROVE, CA, 95758-4540 Code: SAN JUAN 32-7 249H FC HSU	3/8/2019	Arrived at USPS Regional Origin Facility March 11, 2019 <b>Signature Pending</b>
92148969009997901771156214	Dani Papetti	, NEVIL SHANE CISELL, 4350 S HUALAPAI APT 1245, LAS VEGAS, NV, 89147 Code: SAN JUAN 32-7 249H FC HSU	3/8/2019	Arrived at USPS Regional Origin Facility March 11, 2019 <b>Signature Pending</b>
92148969009997901771156221	Dani Papetti	, NICK J MARTINEZ JR, 579 S HIGHLAND DR, PALM SPRINGS, CA, 92264-1054 Code: SAN JUAN 32-7 249H FC HSU	3/8/2019	Arrived at USPS Regional Origin Facility March 11, 2019 <b>Signature Pending</b>
92148969009997901771156238	Dani Papetti	, NICKOLA A RUBOW, DBA OSAGE LLC 131 CALLE DON JOSE, SANTA FE, NM, 87501 Code: SAN JUAN 32-7 249H FC HSU	3/8/2019	Arrived at USPS Regional Origin Facility March 11, 2019 <b>Signature Pending</b>
92148969009997901771156245	Dani Papetti	, NIGH REV TR AGREEMENT DTD 8 3 1989, BRETT D NIGH TRUSTEE 824 SURREY HILL LN, GREENWOOD, IN, 46142 Code: SAN JUAN 32-7 249H FC HSU	3/8/2019	Departed USPS Regional Origin Facility March 11, 2019 <b>Signature Pending</b>
92148969009997901771156252	Dani Papetti	, NINETY SIX CORPORATION, 500 W TEXAS SUITE 655, MIDLAND, TX, 79701 Code: SAN JUAN 32-7 249H FC HSU	3/8/2019	Arrived at USPS Regional Origin Facility March 11, 2019 <b>Signature Pending</b>
92148969009997901771156269	Dani Papetti	, NORMA GUPTON, 1902 MOODY CT, ARLINGTON, TX, 76012 Code: SAN JUAN 32-7 249H FC HSU	3/8/2019	Arrived at USPS Regional Origin Facility March 11, 2019 <b>Signature Pending</b>
92148969009997901771156276	Dani Papetti	, NOROMA ENERGY LLC, PO BOX 5443, AUSTIN, TX, 78763 Code: SAN JUAN 32-7 249H FC HSU	3/8/2019	Arrived at USPS Regional Origin Facility March 11, 2019 <b>Signature Pending</b>
92148969009997901771156283	Dani Papetti	, NORTHLAND COLLEGE, TRUSTEES 1411 ELLIS AVE, ASHLAND, WI, 54806-3925 Code: SAN JUAN 32-7 249H FC HSU	3/8/2019	Arrived at USPS Regional Origin Facility March 11, 2019 <b>Signature Pending</b>
92148969009997901771156290	Dani Papetti	, NORWEST BANK COLORADO NA, BOX 869, IGNACIO, CO, 81137 Code: SAN JUAN 32-7 249H FC HSU	3/8/2019	Arrived at USPS Regional Origin Facility March 11, 2019 <b>Signature Pending</b>
92148969009997901771156306	Dani Papetti	, O R HALL ROYALTY LLC, PO BOX 1231, OGDEN, UT, 84402 Code: SAN JUAN 32-7 249H FC HSU	3/8/2019	Arrived at USPS Regional Origin Facility March 11, 2019 <b>Signature Pending</b>
92148969009997901771156313	Dani Papetti	, OFFICE OF NATURAL RESOURCES REVENUE, LAKEWOOD ACCTG CENT ONSHORE P O BOX 25627, DENVER, CO, 80225-0627 Code: SAN JUAN 32-7 249H FC HSU	3/8/2019	Arrived at USPS Regional Origin Facility March 11, 2019 <b>Signature Pending</b>
92148969009997901771156320	Dani Papetti	, OLIVE K AMON, 7996 CR 510, BAYFIELD, CO, 81122 Code: SAN JUAN 32-7 249H FC HSU	3/8/2019	Arrived at USPS Regional Origin Facility March 11, 2019 <b>Signature Pending</b>
92148969009997901771156337		, OLIVE OIL and GAS LLC, 621 N ROBINSON SUITE		Arrived at USPS Regional Origin Facility



	Dani Papetti	100, OKLAHOMA CITY, OK, 73102 Code: SAN JUAN 32-7 249H FC HSU	3/8/2019	March 11, 2019 <b>Signature Pending</b>
92148969009997901771156344	Dani Papetti	, OSPREY RESOURCES INC, P O BOX 56449, HOUSTON, TX, 77256-6449 Code: SAN JUAN 32-7 249H FC HSU	3/8/2019	Arrived at USPS Regional Facility March 11, 2019 <b>Signature Pending</b>
92148969009997901771156351	Dani Papetti	, OZARK CHRISTIAN COLLEGE, 1111 N MAIN ST, JOPLIN, MO, 64801-1188 Code: SAN JUAN 32-7 249H FC HSU	3/8/2019	Arrived at USPS Regional Origin Facility March 11, 2019 <b>Signature Pending</b>
92148969009997901771156368	Dani Papetti	, PALMER FAMILY TRUST, DORIS E PALMER TRUSTEE 1013 FAIRWEATHER DR, SACRAMENTO, CA, 95833 Code: SAN JUAN 32-7 249H FC HSU	3/8/2019	Departed USPS Regional Origin Facility March 11, 2019 <b>Signature Pending</b>
92148969009997901771156375	Dani Papetti	, PARCELL REVOCABLE TRUST, 5/9/91 CHARLES L PARCELL and ALICE C PARCELL TRUSTEES 5460 S INDIGO , GOLD CANYON, AZ, 85118-5082 Code: SAN JUAN 32-7 249H FC HSU	3/8/2019	Departed USPS Regional Origin Facility March 11, 2019 <b>Signature Pending</b>
92148969009997901771156382	Dani Papetti	, PATRICIA A CLARK LIVING TRUST, PATRICIA A CLARK TRUSTEE PO BOX 699, FRUITA, CO, 81521 Code: SAN JUAN 32-7 249H FC HSU	3/8/2019	Arrived at USPS Regional Origin Facility March 11, 2019 <b>Signature Pending</b>
92148969009997901771156399	Dani Papetti	, PATRICIA HANNAM, 73 PARKVIEW CIR, ALBIA, IA, 52531 Code: SAN JUAN 32-7 249H FC HSU	3/8/2019	Arrived at USPS Regional Origin Facility March 11, 2019 <b>Signature Pending</b>
92148969009997901771156405	Dani Papetti	, PATRICIA J REA REV TRUST 9 25 2008, PATRICIA J REA and LAURA PARGIN TTEES 1623 CR 309A, IGNACIO, CO, 81137 Code: SAN JUAN 32-7 249H FC HSU	3/8/2019	Arrived at USPS Regional Origin Facility March 11, 2019 <b>Signature Pending</b>
92148969009997901771156412	Dani Papetti	, PATRICIA LEDVINA HIMES, 1396 E 25TH ST, TULSA, OK, 74114 Code: SAN JUAN 32-7 249H FC HSU	3/8/2019	Arrived at USPS Regional Origin Facility March 11, 2019 <b>Signature Pending</b>
92148969009997901771156429	Dani Papetti	, PATRICIA P COLE TR UTD 5/25/93, PATRICIA P COLE and JOHN PATTERSON TRUSTEES 211 MARIN AVE, MILL VALLEY, CA, 94941 Code: SAN JUAN 32-7 249H FC HSU	3/8/2019	Arrived at USPS Regional Origin Facility March 11, 2019 <b>Signature Pending</b>
92148969009997901771156436	Dani Papetti	, PATRICIO TRUJILLO, PO BOX 2303, BLOOMFIELD, NM, 87413-2303 Code: SAN JUAN 32-7 249H FC HSU	3/8/2019	Arrived at USPS Regional Origin Facility March 11, 2019 <b>Signature Pending</b>
92148969009997901771156443	Dani Papetti	, PATTERSON FAMILY BENEFICIARIES LLC, 211 MARIN AVE, MILL VALLEY, CA, 94941 Code: SAN JUAN 32-7 249H FC HSU	3/8/2019	Arrived at USPS Regional Origin Facility March 11, 2019 <b>Signature Pending</b>
92148969009997901771156450	Dani Papetti	, PAUL DAVIS LTD, PO BOX 871, MIDLAND, TX, 79702 Code: SAN JUAN 32-7 249H FC HSU	3/8/2019	Arrived at USPS Regional Origin Facility March 11, 2019 <b>Signature Pending</b>
92148969009997901771156467	Dani Papetti	, PAUL E CLARK, 4320 BAILEY RD, SAINT JOE, TX, 76265 Code: SAN JUAN 32-7 249H FC HSU	3/8/2019	Arrived at USPS Regional Origin Facility March 11, 2019 <b>Signature Pending</b>
92148969009997901771156474	Dani Papetti	, PAUL F and MARIE MARTIN TRUST 7-6-06, PAUL F MARTIN TRUSTEE 606 E DIAMOND ST, FARMINGTON, NM, 87401 Code: SAN JUAN 32-7 249H FC HSU	3/8/2019	Arrived at USPS Regional Origin Facility March 11, 2019 <b>Signature Pending</b>
92148969009997901771156481	Dani Papetti	, PAUL J SNODGRASS, 104 BRIARHAVEN RD, CARL JUNCTION, MO, 64834-9237 Code: SAN JUAN 32-7 249H FC HSU	3/8/2019	Arrived at USPS Regional Origin Facility March 11, 2019 <b>Signature Pending</b>
92148969009997901771156498	Dani Papetti	, PAULINE REA HAER DURHAM, 431 JOHNSON AVE APT 207, OROFINO, ID, 83544 Code: SAN JUAN 32-7 249H FC HSU	3/8/2019	Arrived at USPS Regional Origin Facility March 11, 2019 <b>Signature Pending</b>
92148969009997901771156504	Dani Papetti	, PEDEN FAMILY TR DTD JULY 20 2006, JONATHAN JADA PEDEN and ARLENE ELAINE PEDEN TRUSTEES 4681 DIANE AVE, SAN DIEGO, CA, 92117-2903 Code: SAN JUAN 32-7 249H FC HSU	3/8/2019	Arrived at USPS Regional Origin Facility March 11, 2019 <b>Signature Pending</b>
92148969009997901771156511	Dani Papetti	, PEGGIE SUE LAWSON, 6156 JAYS WAY, MILTON, FL, 32570 Code: SAN JUAN 32-7 249H FC HSU	3/8/2019	Arrived at USPS Regional Origin Facility March 11, 2019 <b>Signature Pending</b>
92148969009997901771156528	Dani Papetti	, PENNIES FROM HEAVEN LLC, BANK OF AMERICA AGENT PO BOX 840738, DALLAS, TX, 75284-0738 Code: SAN JUAN 32-7 249H FC HSU	3/8/2019	Arrived at USPS Regional Origin Facility March 11, 2019

				Signature Pending
92148969009997901771156535	Dani Papetti	, PERRY G WIGGINS, 3140 SAW MILL LN, SPRING HILL, FL, 34606-7031 Code: SAN JUAN 32-7 249H FC HSU	3/8/2019	Arrived at USPS Regional Origin Facility March 11, 2019 Signature Pending
92148969009997901771156542	Dani Papetti	, PINON RESOURCES INC, 203 JACKSON ST, DENVER, CO, 80206 Code: SAN JUAN 32-7 249H FC HSU	3/8/2019	Arrived at USPS Regional Origin Facility March 11, 2019 Signature Pending
92148969009997901771156559	Dani Papetti	, PRIMITIVE PETROLEUM INC, 4514 ROBIN LANE, MIDLAND, TX, 79707 Code: SAN JUAN 32-7 249H FC HSU	3/8/2019	Arrived at USPS Regional Origin Facility March 11, 2019 Signature Pending
92148969009997901771156566	Dani Papetti	, PRINCESS PROPERTIES LLC, 1213 W THIRD ST, ROSWELL, NM, 88201 Code: SAN JUAN 32-7 249H FC HSU	3/8/2019	Arrived at USPS Regional Origin Facility March 11, 2019 Signature Pending
92148969009997901771156573	Dani Papetti	, R B NIELSEN TRUST SEPT 8 2010, KARIN DALE NIELSEN TRUSTEE 1200 DANBURY DR, MANSFIELD, TX, 76063 Code: SAN JUAN 32-7 249H FC HSU	3/8/2019	Arrived at USPS Regional Origin Facility March 11, 2019 Signature Pending
92148969009997901771156580	Dani Papetti	, R F FORT, and JUANELL FORT RANDALL R FORT POA PO BOX 65043, LUBBOCK, TX, 79464-5043 Code: SAN JUAN 32-7 249H FC HSU	3/8/2019	Arrived at USPS Regional Origin Facility March 11, 2019 Signature Pending
92148969009997901771156597	Dani Papetti	, RACHEL GEORGE FLOWERS, 861 NE 207TH AVE, WILLISTON, FL, 32696-7353 Code: SAN JUAN 32-7 249H FC HSU	3/8/2019	Arrived at USPS Regional Origin Facility March 11, 2019 Signature Pending
92148969009997901771156603	Dani Papetti	, RALPH E REA III, 14 CAMINO SECO, SILVER CITY, NM, 88061-8804 Code: SAN JUAN 32-7 249H FC HSU	3/8/2019	Arrived at USPS Regional Origin Facility March 11, 2019 Signature Pending
92148969009997901771156610	Dani Papetti	, RALPH PEDEN, 2704 MEADOW GREEN, BEDFORD, TX, 76021 Code: SAN JUAN 32-7 249H FC HSU	3/8/2019	Arrived at USPS Regional Origin Facility March 11, 2019 Signature Pending
92148969009997901771156627	Dani Papetti	, RAMONCITA Y ARCHULETA, 379 CR 326, IGNACIO, CO, 81137 Code: SAN JUAN 32-7 249H FC HSU	3/8/2019	Arrived at USPS Regional Origin Facility March 11, 2019 Signature Pending
92148969009997901771156634	Dani Papetti	, RANDOLPH BRIGGS, DBA RHB ENTERPRISES LLC 6729 ACADEMY RD NE STE D, ALBUQUERQUE, NM, 87109 Code: SAN JUAN 32-7 249H FC HSU	3/8/2019	Arrived at USPS Regional Origin Facility March 11, 2019 Signature Pending
92148969009997901771156641	Dani Papetti	, RAVAE MAE SMOUSE WELLS, 46 CALLE ESPERANGA, TIJERAS, NM, 87059 Code: SAN JUAN 32-7 249H FC HSU	3/8/2019	Arrived at USPS Regional Origin Facility March 11, 2019 Signature Pending
92148969009997901771156658	Dani Papetti	, REGENT OIL and GAS COMPANY LP, PO BOX 25204, DALLAS, TX, 75225 Code: SAN JUAN 32-7 249H FC HSU	3/8/2019	Arrived at USPS Regional Origin Facility March 11, 2019 Signature Pending
92148969009997901771156665	Dani Papetti	, REGGIE L CLARK, 1086 KELLY CREEK WAY, MOODY, AL, 35004 Code: SAN JUAN 32-7 249H FC HSU	3/8/2019	Arrived at USPS Regional Origin Facility March 11, 2019 Signature Pending
92148969009997901771156672	Dani Papetti	, REX C REA, 7793 BRENTWOOD CT, ARVADA, CO, 80005-4414 Code: SAN JUAN 32-7 249H FC HSU	3/8/2019	Arrived at USPS Regional Origin Facility March 11, 2019 Signature Pending
92148969009997901771156689	Dani Papetti	, RICHARD ALLEN SWEARINGEN, 3444 N E HAPPY HOLLOW RD, TOPEKA, KS, 66617 Code: SAN JUAN 32-7 249H FC HSU	3/8/2019	Arrived at USPS Regional Origin Facility March 11, 2019 Signature Pending
92148969009997901771156696	Dani Papetti	, RICHARD ROE REED, 709 NGATE DR, SAINT JOSEPH, IL, 61873 Code: SAN JUAN 32-7 249H FC HSU	3/8/2019	Departed USPS Regional Origin Facility March 11, 2019 Signature Pending
92148969009997901771156702	Dani Papetti	, ROBERT BRUCE HAFER, 601 N D ST, GRANGEVILLE, ID, 83530-1133 Code: SAN JUAN 32-7 249H FC HSU	3/8/2019	Arrived at USPS Regional Origin Facility March 11, 2019 Signature Pending
92148969009997901771156719	Dani Papetti	, ROBERT DEAN RICHARDSON, 13363 E ASBURY DR, AURORA, CO, 80014 Code: SAN JUAN 32-7 249H FC HSU	3/8/2019	Arrived at USPS Regional Origin Facility March 11, 2019 Signature Pending

92148969009997901771156726	Dani Papetti	, ROBERT E BEAMON III, 2603 AUGUSTA DR STE 1050, HOUSTON, TX, 77057-5797 Code: SAN JUAN 32-7 249H FC HSU	3/8/2019	Arrived at USPS Regional Facility March 11, 2019 <b>Signature Pending</b>
92148969009997901771156733	Dani Papetti	, ROBERT E JONES, PO BOX 815, DURANGO, CO, 81302 Code: SAN JUAN 32-7 249H FC HSU	3/8/2019	Arrived at USPS Regional Origin Facility March 11, 2019 <b>Signature Pending</b>
92148969009997901771156740	Dani Papetti	, ROBERT J ARNOLD, P O BOX 552, STILLWATER, OK, 74076 Code: SAN JUAN 32-7 249H FC HSU	3/8/2019	Arrived at USPS Regional Origin Facility March 11, 2019 <b>Signature Pending</b>
92148969009997901771156757	Dani Papetti	, ROBERT M and GAYLE FAVERINO, LIVING TRUST DTD 9/29/98 19 RD 4998, BLOOMFIELD, NM, 87413 Code: SAN JUAN 32-7 249H FC HSU	3/8/2019	Arrived at USPS Regional Origin Facility March 11, 2019 <b>Signature Pending</b>
92148969009997901771156764	Dani Papetti	, ROBERT UMBACH CANCER FOUNDATION, ZIA DATA SEARCH CORP AGENT PO BOX 2188, ROSWELL, NM, 88202-2188 Code: SAN JUAN 32-7 249H FC HSU	3/8/2019	Arrived at USPS Regional Origin Facility March 11, 2019 <b>Signature Pending</b>
92148969009997901771156771	Dani Papetti	, ROBERT WALTER LUNDELL, 2450 FONDREN STE 304, HOUSTON, TX, 77063-2318 Code: SAN JUAN 32-7 249H FC HSU	3/8/2019	Arrived at USPS Regional Facility March 11, 2019 <b>Signature Pending</b>
92148969009997901771156788	Dani Papetti	, ROBERTA K CHATFIELD, 11420 S VIEWPOINTE WAY, YUMA, AZ, 85367 Code: SAN JUAN 32-7 249H FC HSU	3/8/2019	Arrived at USPS Regional Origin Facility March 11, 2019 <b>Signature Pending</b>
92148969009997901771156795	Dani Papetti	, ROGERS GIBBARD TRUST, ORVILLE C ROGERS SUSAN EVELAND and ELAINE GIBBARD HOWE TTEES PO BOX , SULPHUR, OK, 73086-0624 Code: SAN JUAN 32-7 249H FC HSU	3/8/2019	Arrived at USPS Regional Origin Facility March 11, 2019 <b>Signature Pending</b>
92148969009997901771156801	Dani Papetti	, ROLAND MOHRMANN, PO BOX 324, SUTTER CREEK, CA, 95685-0324 Code: SAN JUAN 32-7 249H FC HSU	3/8/2019	Arrived at USPS Regional Origin Facility March 11, 2019 <b>Signature Pending</b>
92148969009997901771156818	Dani Papetti	, RONALD HECTOR, 261 COLUMBUS AVE, NORTH BABYLON, NY, 11703 Code: SAN JUAN 32-7 249H FC HSU	3/8/2019	Arrived at USPS Regional Origin Facility March 11, 2019 <b>Signature Pending</b>
92148969009997901771156825	Dani Papetti	, RONALD J WILSON, and LINDA L WILSON JT WROS 2509 CLIFFWOOD DR, LAKE HAVASU CITY, AZ, 86403 Code: SAN JUAN 32-7 249H FC HSU	3/8/2019	Arrived at USPS Regional Origin Facility March 11, 2019 <b>Signature Pending</b>
92148969009997901771156832	Dani Papetti	, RONALD J WILSON, 4218 E WAGON WHEEL DR, LAKE HAVASU CITY, AZ, 86404 Code: SAN JUAN 32-7 249H FC HSU	3/8/2019	Arrived at USPS Regional Origin Facility March 11, 2019 <b>Signature Pending</b>
92148969009997901771156849	Dani Papetti	, RONALD PEACE, PO BOX 695, HOLDENVILLE, OK, 74848 Code: SAN JUAN 32-7 249H FC HSU	3/8/2019	Arrived at USPS Regional Origin Facility March 11, 2019 <b>Signature Pending</b>
92148969009997901771156856	Dani Papetti	, RONALD ROGERS, 19955 INDIAN SUMMER LN, MONUMENT, CO, 80132 Code: SAN JUAN 32-7 249H FC HSU	3/8/2019	Arrived at USPS Regional Origin Facility March 11, 2019 <b>Signature Pending</b>
92148969009997901771156863	Dani Papetti	, RONALD WAYNE REED, 7721 KELLY HILL RD, SOUTHPORT, FL, 32409 Code: SAN JUAN 32-7 249H FC HSU	3/8/2019	Arrived at USPS Regional Origin Facility March 11, 2019 <b>Signature Pending</b>
92148969009997901771156870	Dani Papetti	, ROSE SMITH TRUSTEE, SMITH FAMILY TRUST PO BOX 2294, PAGOSA SPRINGS, CO, 81147-2294 Code: SAN JUAN 32-7 249H FC HSU	3/8/2019	Arrived at USPS Regional Origin Facility March 11, 2019 <b>Signature Pending</b>
92148969009997901771156887	Dani Papetti	, ROY G BARTON JR and CLAUDIA R BARTON, JTWROS 1919 TURNER ST, HOBBS, NM, 88240-2712 Code: SAN JUAN 32-7 249H FC HSU	3/8/2019	Arrived at USPS Regional Origin Facility March 11, 2019 <b>Signature Pending</b>
92148969009997901771156894	Dani Papetti	, RUBY J OLGUIN, 3004 ESTRELLA BRILLANTE NW, ALBUQUERQUE, NM, 87120 Code: SAN JUAN 32-7 249H FC HSU	3/8/2019	Arrived at USPS Regional Origin Facility March 11, 2019 <b>Signature Pending</b>
92148969009997901771156900	Dani Papetti	, RYAN M HAGGERTY, 12900 PRESTON ROAD STE 1115, DALLAS, TX, 75230 Code: SAN JUAN 32-7 249H FC HSU	3/8/2019	Arrived at USPS Regional Origin Facility March 11, 2019 <b>Signature Pending</b>
92148969009997901771156917	Dani Papetti	, S W and DOROTHY C HORSTMAN TRUST, 3005 SAVANNAHS TRL, MERRITT ISLAND, FL, 32953 Code: SAN JUAN 32-7 249H FC HSU	3/8/2019	Arrived at USPS Regional Origin Facility March 11, 2019 <b>Signature Pending</b>

92148969009997901771156924	Dani Papetti	, SABINE ROYALTY TRUST, SIMMONS BANK ESCROW AGENT and TRSTEE PO BOX 678600, DALLAS, TX, 75267-8600 Code: SAN JUAN 32-7 249H FC HSU	3/8/2019	Arrived at USPS Regional Origin Facility March 11, 2019 <b>Signature Pending</b>
92148969009997901771156931	Dani Papetti	, SABINO R ARCHULETA, 349 CR 326, IGNACIO, CO, 81137 Code: SAN JUAN 32-7 249H FC HSU	3/8/2019	Arrived at USPS Regional Origin Facility March 11, 2019 <b>Signature Pending</b>
92148969009997901771156948	Dani Papetti	, SALOMON V ARCHULETA ESTATE, TONY ARCHULETA PERSONAL REP PO BOX 458, DURANGO, CO, 81302 Code: SAN JUAN 32-7 249H FC HSU	3/8/2019	Arrived at USPS Regional Origin Facility March 11, 2019 <b>Signature Pending</b>
92148969009997901771156955	Dani Papetti	, SAMUEL H WAALEN ESTATE, ELEANOR WAALEN EXECUTRIX 44 CERRETTA ST #7, STAMFORD, CT, 06907 Code: SAN JUAN 32-7 249H FC HSU	3/8/2019	Departed USPS Regional Origin Facility March 11, 2019 <b>Signature Pending</b>
92148969009997901771156962	Dani Papetti	, SAMUEL SMOUSE and FRAN SMOUSE, PO BOX 93, FRUITLAND, NM, 87416 Code: SAN JUAN 32-7 249H FC HSU	3/8/2019	Departed USPS Regional Origin Facility March 11, 2019 <b>Signature Pending</b>
92148969009997901771156979	Dani Papetti	, SAMUEL THOMAS SMOUSE, PO BOX 93, FRUITLAND, NM, 87416-0093 Code: SAN JUAN 32-7 249H FC HSU	3/8/2019	Arrived at USPS Regional Origin Facility March 11, 2019 <b>Signature Pending</b>
92148969009997901771156986	Dani Papetti	, SANDRA J CAMPBELL, 6638 C BETHESDA PT, COLORADO SPRINGS, CO, 80918 Code: SAN JUAN 32-7 249H FC HSU	3/8/2019	Arrived at USPS Regional Origin Facility March 11, 2019 <b>Signature Pending</b>
92148969009997901771156993	Dani Papetti	, SARA K RYER, 6231 GIBSON BLVD SE, ALBUQUERQUE, NM, 87108-4970 Code: SAN JUAN 32-7 249H FC HSU	3/8/2019	Arrived at USPS Regional Origin Facility March 11, 2019 <b>Signature Pending</b>
92148969009997901771157006	Dani Papetti	, SHANE ALDO JONES, 1793 GLENWOOD LN, HIGHLANDS RANCH, CO, 80126 Code: SAN JUAN 32-7 249H FC HSU	3/8/2019	Arrived at USPS Regional Origin Facility March 11, 2019 <b>Signature Pending</b>
92148969009997901771157013	Dani Papetti	, SHARLEEN DIANE HALL ODELL, 20518 RD 21, LEWIS, CO, 81327 Code: SAN JUAN 32-7 249H FC HSU	3/8/2019	Arrived at USPS Regional Origin Facility March 11, 2019 <b>Signature Pending</b>
92148969009997901771157020	Dani Papetti	, SHARLENE MURPHY, 616 N BURGESS ST, HOLDENVILLE, OK, 74848 Code: SAN JUAN 32-7 249H FC HSU	3/8/2019	Arrived at USPS Regional Origin Facility March 11, 2019 <b>Signature Pending</b>
92148969009997901771157037	Dani Papetti	, SHARON DALE CLARK, 508 PITMAN RD, RICHMOND, TX, 77469 Code: SAN JUAN 32-7 249H FC HSU	3/8/2019	Arrived at USPS Regional Facility March 11, 2019 <b>Signature Pending</b>
92148969009997901771157044	Dani Papetti	, SHARON HANSEN, 1822 SAN TROVASO WAY, VENICE, FL, 34285 Code: SAN JUAN 32-7 249H FC HSU	3/8/2019	Arrived at USPS Regional Origin Facility March 11, 2019 <b>Signature Pending</b>
92148969009997901771157051	Dani Papetti	, SHARON K FENTON, 3447 SE 35TH ST, TOPEKA, KS, 66605-3102 Code: SAN JUAN 32-7 249H FC HSU	3/8/2019	Arrived at USPS Regional Origin Facility March 11, 2019 <b>Signature Pending</b>
92148969009997901771157068	Dani Papetti	, SHARON SMALL GIOTES, 43415 NICHOLSON DR, PORT ORFORD, OR, 97465 Code: SAN JUAN 32-7 249H FC HSU	3/8/2019	Departed USPS Regional Origin Facility March 11, 2019 <b>Signature Pending</b>
92148969009997901771157075	Dani Papetti	, SHASTA SHY PALMER, 3560 COLIMA RD, ATASCADERO, CA, 93422 Code: SAN JUAN 32-7 249H FC HSU	3/8/2019	Departed USPS Regional Origin Facility March 11, 2019 <b>Signature Pending</b>
92148969009997901771157082	Dani Papetti	, SHAWN GRANADOS, 175 ELMWOOD ST, FILLMORE, CA, 93015 Code: SAN JUAN 32-7 249H FC HSU	3/8/2019	Departed USPS Regional Origin Facility March 11, 2019 <b>Signature Pending</b>
92148969009997901771157099	Dani Papetti	, SHERIE MONTOYA, 1085 TASMAN DR #440, SUNNYVALE, CA, 94089 Code: SAN JUAN 32-7 249H FC HSU	3/8/2019	Departed USPS Regional Origin Facility March 11, 2019 <b>Signature Pending</b>
92148969009997901771157105	Dani Papetti	, SHERYL SWEARINGEN JOHNSON COLLINS, 3242 NW 43RD ST, TOPEKA, KS, 66618-2647 Code: SAN JUAN 32-7 249H FC HSU	3/8/2019	Arrived at USPS Regional Origin Facility March 11, 2019 <b>Signature Pending</b>
92148969009997901771157112	Dani Papetti	, SHIRLEY MARIE MILES DAVIS, 8323 6075 RD, OLATHE, CO, 81425	3/8/2019	Departed USPS Regional Origin Facility

		Code: SAN JUAN 32-7 249H FC HSU		March 11, 2019 <b>Signature Pending</b>
92148969009997901771157129	Dani Papetti	, SHIRLEY SUTHERLIN, 410 CR 4020, IGNACIO, CO, 81137 Code: SAN JUAN 32-7 249H FC HSU	3/8/2019	Arrived at USPS Regional Origin Facility March 11, 2019 <b>Signature Pending</b>
92148969009997901771157136	Dani Papetti	, SHON MITCHELL JONES, 3692 E MORNING STAR LN, GILBERT, AZ, 85298 Code: SAN JUAN 32-7 249H FC HSU	3/8/2019	Arrived at USPS Regional Origin Facility March 11, 2019 <b>Signature Pending</b>
92148969009997901771157143	Dani Papetti	, SHRINERS HOSPITALS FOR CHILDRE, C/O NORTHERN TRUST BK OF TEXAS PO BOX 226270, DALLAS, TX, 75222-6270 Code: SAN JUAN 32-7 249H FC HSU	3/8/2019	Arrived at USPS Regional Origin Facility March 11, 2019 <b>Signature Pending</b>
92148969009997901771157150	Dani Papetti	, SONJA LOPEZ, 2299 SUMMERFIELD RD, COOKEVILLE, TN, 38506 Code: SAN JUAN 32-7 249H FC HSU	3/8/2019	Arrived at USPS Regional Origin Facility March 11, 2019 <b>Signature Pending</b>
92148969009997901771157167	Dani Papetti	, SOUTHERN UTE INDIAN TRIBE, PO BOX 973496, DALLAS, TX, 75397-3496 Code: SAN JUAN 32-7 249H FC HSU	3/8/2019	Arrived at USPS Regional Facility March 11, 2019 <b>Signature Pending</b>
92148969009997901771157174	Dani Papetti	, SOUTHERN UTE INDIAN TRIBE, PO BOX 973375, DALLAS, TX, 75397-3375 Code: SAN JUAN 32-7 249H FC HSU	3/8/2019	Arrived at USPS Regional Facility March 11, 2019 <b>Signature Pending</b>
92148969009997901771157181	Dani Papetti	, SOUTHLAND ROYALTY COMPANY LLC, C/O OILDEX MAIL 5316 W US HWY 290 SERVICE RD SUITE 400, AUSTIN, TX, 78735 Code: SAN JUAN 32-7 249H FC HSU	3/8/2019	Arrived at USPS Regional Origin Facility March 11, 2019 <b>Signature Pending</b>
92148969009997901771157198	Dani Papetti	, STANFORD UNIVERSITY, LELAND STANFORD UNIVERSITY C/O BANK OF AMERICA, N.A. P O BOX 84, DALLAS, TX, 75284 Code: SAN JUAN 32-7 249H FC HSU	3/8/2019	Arrived at USPS Regional Origin Facility March 11, 2019 <b>Signature Pending</b>
92148969009997901771157204	Dani Papetti	, STANICO ENERGY CORPORATION, PO BOX 32467, OKLAHOMA CITY, OK, 73123 Code: SAN JUAN 32-7 249H FC HSU	3/8/2019	Arrived at USPS Regional Origin Facility March 11, 2019 <b>Signature Pending</b>
92148969009997901771157211	Dani Papetti	, STANLEY PENCOSKE, and GENEVIEVE PENCOSKE JT C/O DELORES PINKOS 405 E KINNEY ST, NEWARK, NJ, 07105-2503 Code: SAN JUAN 32-7 249H FC HSU	3/8/2019	Arrived at USPS Regional Origin Facility March 11, 2019 <b>Signature Pending</b>
92148969009997901771157228	Dani Papetti	, STANLEY POLLOCK T/U/W, FBO JESSE POLLOCK-FOOTE MERCHANTS BANK NA and LESLIE FOOTE CO TTEES , WINONA, MN, 55987 Code: SAN JUAN 32-7 249H FC HSU	3/8/2019	Departed USPS Regional Origin Facility March 11, 2019 <b>Signature Pending</b>
92148969009997901771157235	Dani Papetti	, STANLEY POLLOCK T/U/W, FBO LESLIE FOOTE MERCHANTS BANK NA and LESLIE FOOTE CO TTEES PO BOX , WINONA, MN, 55987 Code: SAN JUAN 32-7 249H FC HSU	3/8/2019	Departed USPS Regional Origin Facility March 11, 2019 <b>Signature Pending</b>
92148969009997901771157242	Dani Papetti	, STANLEY POLLOCK T/U/W, FBO WELLS POLLOCK MERCHANTS BANK NA and LESLIE FOOTE CO TTEES PO BOX, WINONA, MN, 55987 Code: SAN JUAN 32-7 249H FC HSU	3/8/2019	Departed USPS Regional Origin Facility March 11, 2019 <b>Signature Pending</b>
92148969009997901771157259	Dani Papetti	, STATE OF NEW MEXICO, COMMISSIONER OF PUBLIC LANDS PO BOX 1148, SANTA FE, NM, 87501 Code: SAN JUAN 32-7 249H FC HSU	3/8/2019	Arrived at USPS Regional Origin Facility March 11, 2019 <b>Signature Pending</b>
92148969009997901771157266	Dani Papetti	, STELLA AGUIRRE, 1709 COMANCHE RD, PUEBLO, CO, 81001 Code: SAN JUAN 32-7 249H FC HSU	3/8/2019	Arrived at USPS Regional Origin Facility March 11, 2019 <b>Signature Pending</b>
92148969009997901771157273	Dani Papetti	, STEPHEN HENKLE, 964 S 225 E, SALEM, UT, 84653-9586 Code: SAN JUAN 32-7 249H FC HSU	3/8/2019	Departed USPS Regional Origin Facility March 11, 2019 <b>Signature Pending</b>
92148969009997901771157280	Dani Papetti	, STEVEN GILBERT, 6 CLOVE HITCH CT, HILTON HEAD ISLAND, SC, 29926 Code: SAN JUAN 32-7 249H FC HSU	3/8/2019	Departed USPS Regional Origin Facility March 11, 2019 <b>Signature Pending</b>
92148969009997901771157297	Dani Papetti	, STEVEN J ABRAHAM, PO BOX 25123, ALBUQUERQUE, NM, 87125-0123 Code: SAN JUAN 32-7 249H FC HSU	3/8/2019	Arrived at USPS Regional Origin Facility March 11, 2019 <b>Signature Pending</b>
92148969009997901771157303	Dani Papetti	, SURVIVORS TRUST OF THE PAYNE, FAMILY TRUST VIRGINIA E PAYNE TRUSTEE PO BOX 1142, BAYFIELD, CO, 81122 Code: SAN JUAN 32-7 249H FC HSU	3/8/2019	Arrived at USPS Regional Origin Facility March 11, 2019 <b>Signature Pending</b>
		, SUSAN A ESTEP, 3804 CEMETERY HILL RD,		Arrived at USPS Regional Origin

92148969009997901771157310	Dani Papetti	CARROLLTON, TX, 75007-2606 Code: SAN JUAN 32-7 249H FC HSU	3/8/2019	Facility March 11, 2019 <b>Signature Pending</b>
92148969009997901771157327	Dani Papetti	, SUSAN CONRY MEYER, PO BOX 1396, GRANTHAM, NH, 03753 Code: SAN JUAN 32-7 249H FC HSU	3/8/2019	Departed USPS Regional Origin Facility March 11, 2019 <b>Signature Pending</b>
92148969009997901771157334	Dani Papetti	, SUSAN CORRIGAN, 3433 OSCEOLA ST, DENVER, CO, 80212 Code: SAN JUAN 32-7 249H FC HSU	3/8/2019	Arrived at USPS Regional Origin Facility March 11, 2019 <b>Signature Pending</b>
92148969009997901771157341	Dani Papetti	, SUSAN KENNEDY, 73 CHEYENNE TR, SPARTA, NJ, 07871 Code: SAN JUAN 32-7 249H FC HSU	3/8/2019	Departed USPS Regional Origin Facility March 11, 2019 <b>Signature Pending</b>
92148969009997901771157358	Dani Papetti	, SUSAN M HINKLE, 70 RIVERSIDE DR, ROSWELL, NM, 88201 Code: SAN JUAN 32-7 249H FC HSU	3/8/2019	Departed USPS Regional Origin Facility March 11, 2019 <b>Signature Pending</b>
92148969009997901771157365	Dani Papetti	, SUSAN NELSON, DBA NELSON MINERALS LLC 4901 CRESTWOOD DR, FARMINGTON, NM, 87402 Code: SAN JUAN 32-7 249H FC HSU	3/8/2019	Arrived at USPS Regional Origin Facility March 11, 2019 <b>Signature Pending</b>
92148969009997901771157372	Dani Papetti	, SUSANNA PHILLIPS KELLY MARITAL TR, TRUST PO BOX 1865, BOZEMAN, MT, 59771-1865 Code: SAN JUAN 32-7 249H FC HSU	3/8/2019	Departed USPS Regional Origin Facility March 11, 2019 <b>Signature Pending</b>
92148969009997901771157389	Dani Papetti	, SUZANNE PAYNE, PO BOX 2063, DURANGO, CO, 81302 Code: SAN JUAN 32-7 249H FC HSU	3/8/2019	Arrived at USPS Regional Origin Facility March 11, 2019 <b>Signature Pending</b>
92148969009997901771157396	Dani Papetti	, T C MORAN AND CO, 141 S LAFAYETTE ST, DENVER, CO, 80209 Code: SAN JUAN 32-7 249H FC HSU	3/8/2019	Arrived at USPS Regional Origin Facility March 11, 2019 <b>Signature Pending</b>
92148969009997901771157402	Dani Papetti	, T H MCELVAIN OIL and GAS LLLP, 511 16TH STREET SUITE 700, DENVER, CO, 80202 Code: SAN JUAN 32-7 249H FC HSU	3/8/2019	Arrived at USPS Regional Origin Facility March 11, 2019 <b>Signature Pending</b>
92148969009997901771157419	Dani Papetti	, T H MCELVAIN OIL and GAS PROP INC, 1050 17TH ST SUITE 2500, DENVER, CO, 80265-1801 Code: SAN JUAN 32-7 249H FC HSU	3/8/2019	Arrived at USPS Regional Origin Facility March 11, 2019 <b>Signature Pending</b>
92148969009997901771157426	Dani Papetti	, TandC MINERALS LLC, 2245 W 190TH ST, TORRANCE, CA, 90504 Code: SAN JUAN 32-7 249H FC HSU	3/8/2019	Departed USPS Regional Origin Facility March 11, 2019 <b>Signature Pending</b>
92148969009997901771157433	Dani Papetti	, TAB R SMITH, 4612 LOCUST, BELLAIRE, TX, 77401 Code: SAN JUAN 32-7 249H FC HSU	3/8/2019	Arrived at USPS Regional Facility March 11, 2019 <b>Signature Pending</b>
92148969009997901771157440	Dani Papetti	, TAHANA R HOO, 266 ALTA VISTA AVE, ROSEVILLE, CA, 95678 Code: SAN JUAN 32-7 249H FC HSU	3/8/2019	Departed USPS Regional Origin Facility March 11, 2019 <b>Signature Pending</b>
92148969009997901771157457	Dani Papetti	, TAMACAM LLC, JAMES M RAYMOND AFENT and AIF PO BOX 291445, KERRVILLE, TX, 78029 Code: SAN JUAN 32-7 249H FC HSU	3/8/2019	Arrived at USPS Regional Origin Facility March 11, 2019 <b>Signature Pending</b>
92148969009997901771157464	Dani Papetti	, TAMARA SHIRLEY SHOCK, 21201 KIOWA COVE, LAGO VISTA, TX, 78645 Code: SAN JUAN 32-7 249H FC HSU	3/8/2019	Arrived at USPS Regional Origin Facility March 11, 2019 <b>Signature Pending</b>
92148969009997901771157471	Dani Papetti	, TAMBERLIE R BURNS, 409 PIATT AVE, MATTOON, IL, 61938 Code: SAN JUAN 32-7 249H FC HSU	3/8/2019	Arrived at USPS Regional Origin Facility March 11, 2019 <b>Signature Pending</b>
92148969009997901771157488	Dani Papetti	, TARAH NICOLE BAILEY, 7302 ROZENA DR, LONGMONT, CO, 80503 Code: SAN JUAN 32-7 249H FC HSU	3/8/2019	Arrived at USPS Regional Origin Facility March 11, 2019 <b>Signature Pending</b>
92148969009997901771157495	Dani Papetti	, TASHA RUCKER, 54127 KIMDALE DR, WHITE WATER, CA, 92282 Code: SAN JUAN 32-7 249H FC HSU	3/8/2019	Arrived at USPS Regional Origin Facility March 11, 2019 <b>Signature Pending</b>
92148969009997901771157501	Dani Papetti	, TERRY A WHITE, and CARLA K WHITE JT 1302 W 3RD ST, CHANUTE, KS, 66720 Code: SAN JUAN 32-7 249H FC HSU	3/8/2019	Arrived at USPS Regional Origin Facility March 11, 2019 <b>Signature Pending</b>

92148969009997901771157518	Dani Papetti	, TEXAS ROYALTIES, PO BOX 3579, MIDLAND, TX, 79702-3579 Code: SAN JUAN 32-7 249H FC HSU	3/8/2019	Arrived at USPS Regional Origin Facility March 11, 2019 <b>Signature Pending</b>
92148969009997901771157525	Dani Papetti	, THE DEWOODY LIVING TRUST, JOSEPH P and KIMBERLY A DEWOODY AS CO-TTES PO BOX 47128, FORT WORTH, TX, 76147 Code: SAN JUAN 32-7 249H FC HSU	3/8/2019	Arrived at USPS Regional Origin Facility March 11, 2019 <b>Signature Pending</b>
92148969009997901771157532	Dani Papetti	, THE SUTHERLIN FAMILY TRUST, 410 CR 4020, IGNACIO, CO, 81137 Code: SAN JUAN 32-7 249H FC HSU	3/8/2019	Arrived at USPS Regional Origin Facility March 11, 2019 <b>Signature Pending</b>
92148969009997901771157549	Dani Papetti	, THE TATUM LIVING TRUST, LESLIE C TATUM TTEE C/O BANK OF AMERICA NA AGENT PO BOX 840738, DALLAS, TX, 75284-0738 Code: SAN JUAN 32-7 249H FC HSU	3/8/2019	Arrived at USPS Regional Origin Facility March 11, 2019 <b>Signature Pending</b>
92148969009997901771157556	Dani Papetti	, THE TAURUS CORPORATION, C/O ROBERT B PAYNE, JR. P O BOX 1477, LITTLE ELM, TX, 75068 Code: SAN JUAN 32-7 249H FC HSU	3/8/2019	Arrived at USPS Regional Origin Facility March 11, 2019 <b>Signature Pending</b>
92148969009997901771157563	Dani Papetti	, THOMAS B WIGGINS, 885 N SCOTT DR, GREENWOOD, IN, 46142 Code: SAN JUAN 32-7 249H FC HSU	3/8/2019	Arrived at USPS Regional Origin Facility March 11, 2019 <b>Signature Pending</b>
92148969009997901771157570	Dani Papetti	, THOMAS BRADLEY LAWS, 5026 N MORNINGGALE WAY, BOISE, ID, 83713-1452 Code: SAN JUAN 32-7 249H FC HSU	3/8/2019	Departed USPS Regional Origin Facility March 11, 2019 <b>Signature Pending</b>
92148969009997901771157587	Dani Papetti	, THOMAS H CONNELLY ESTATE, MARY F CONNELLY, PERSONAL REPR 475 17TH STREET #980, DENVER, CO, 80202 Code: SAN JUAN 32-7 249H FC HSU	3/8/2019	Arrived at USPS Regional Origin Facility March 11, 2019 <b>Signature Pending</b>
92148969009997901771157594	Dani Papetti	, THOMAS R GOULDING, 8112 208TH PL SW, EDMONDS, WA, 98026 Code: SAN JUAN 32-7 249H FC HSU	3/8/2019	Arrived at USPS Regional Origin Facility March 11, 2019 <b>Signature Pending</b>
92148969009997901771157600	Dani Papetti	, THOMAS STANLEY SENTER JR, 3212 STREVEL WAY, SACRAMENTO, CA, 95825 Code: SAN JUAN 32-7 249H FC HSU	3/8/2019	Arrived at USPS Regional Origin Facility March 11, 2019 <b>Signature Pending</b>
92148969009997901771157617	Dani Papetti	, TIFFANY GUNTHER, 6717 HUMMINGBIRD CT, OWASSO, OK, 74055-5040 Code: SAN JUAN 32-7 249H FC HSU	3/8/2019	Arrived at USPS Regional Origin Facility March 11, 2019 <b>Signature Pending</b>
92148969009997901771157624	Dani Papetti	, TIM LILLEY, and TASHINA LILLEY 4873 RAINTREE CIRCLE, PARKER, CO, 80134 Code: SAN JUAN 32-7 249H FC HSU	3/8/2019	Arrived at USPS Regional Origin Facility March 11, 2019 <b>Signature Pending</b>
92148969009997901771157631	Dani Papetti	, TOM BARGER and MARY CATHREN HARRIS, REV TRUST TOM BARGER and MARY CATHREN HARRIS TTEES 1417 PINNACLE VIE, ALBUQUERQUE, NM, 87112-6558 Code: SAN JUAN 32-7 249H FC HSU	3/8/2019	Arrived at USPS Regional Origin Facility March 11, 2019 <b>Signature Pending</b>
92148969009997901771157648	Dani Papetti	, TOMMY D MILLER, 958 PAUL ST, GREENSBURG, PA, 15601 Code: SAN JUAN 32-7 249H FC HSU	3/8/2019	Arrived at USPS Regional Origin Facility March 11, 2019 <b>Signature Pending</b>
92148969009997901771157655	Dani Papetti	, UNITED BANK OF IGNACIO, BOX 869, IGNACIO, CO, 81137-0869 Code: SAN JUAN 32-7 249H FC HSU	3/8/2019	Arrived at USPS Regional Origin Facility March 11, 2019 <b>Signature Pending</b>
92148969009997901771157662	Dani Papetti	, V A JOHNSTON LTD, PO BOX 303247, AUSTIN, TX, 78703 Code: SAN JUAN 32-7 249H FC HSU	3/8/2019	Arrived at USPS Regional Origin Facility March 11, 2019 <b>Signature Pending</b>
92148969009997901771157679	Dani Papetti	, VALERIE RUDIBAUGH, 989 TURPIN LAKE RD, POOLVILLE, TX, 76487 Code: SAN JUAN 32-7 249H FC HSU	3/8/2019	Arrived at USPS Regional Origin Facility March 11, 2019 <b>Signature Pending</b>
92148969009997901771157686	Dani Papetti	, VAUGHAN-MCELVAIN ENERGY INC, PO BOX 970, KENNETT SQUARE, PA, 19348 Code: SAN JUAN 32-7 249H FC HSU	3/8/2019	Departed USPS Regional Origin Facility March 11, 2019 <b>Signature Pending</b>
92148969009997901771157693	Dani Papetti	, VICTOR L WIGGINS, 1850 S 30TH ST, TERRE HAUTE, IN, 47803 Code: SAN JUAN 32-7 249H FC HSU	3/8/2019	Arrived at USPS Regional Origin Facility March 11, 2019 <b>Signature Pending</b>



92148969009997901771157709	Dani Papetti	, VICTORIANO LEROY TRUJILLO, 307 4TH ST, DURANGO, CO, 81301 Code: SAN JUAN 32-7 249H FC HSU	3/8/2019	Arrived at USPS Regional Origin Facility March 11, 2019 <b>Signature Pending</b>
92148969009997901771157716	Dani Papetti	, VINCENT E PAYNE, TTEE V B PAYNE FAMILY TR 11 21 2008 13 LA QUINTA, SANDIA PARK, NM, 87047 Code: SAN JUAN 32-7 249H FC HSU	3/8/2019	Arrived at USPS Regional Origin Facility March 11, 2019 <b>Signature Pending</b>
92148969009997901771157723	Dani Papetti	, VIRGINIA F SNODGRASS, PO BOX 786, TONTITOWN, AR, 72770 Code: SAN JUAN 32-7 249H FC HSU	3/8/2019	Arrived at USPS Regional Origin Facility March 11, 2019 <b>Signature Pending</b>
92148969009997901771157730	Dani Papetti	, VIRGINIA O HATFIELD NM 2005, LVG TRUST JAMES E HATFIELD TRUSTEE 2994 BUTTONWOOD DR, CARROLLTON, TX, 75006 Code: SAN JUAN 32-7 249H FC HSU	3/8/2019	Arrived at USPS Regional Origin Facility March 11, 2019 <b>Signature Pending</b>
92148969009997901771157747	Dani Papetti	, VIRGINIA QUINNETT, 1352 E HIGHLAND AVE, PHOENIX, AZ, 85014 Code: SAN JUAN 32-7 249H FC HSU	3/8/2019	Arrived at USPS Regional Origin Facility March 11, 2019 <b>Signature Pending</b>
92148969009997901771157754	Dani Papetti	, VIRGINIA REDFORD, 1413 WARWICK ST, GARLAND, TX, 75044 Code: SAN JUAN 32-7 249H FC HSU	3/8/2019	Arrived at USPS Regional Origin Facility March 11, 2019 <b>Signature Pending</b>
92148969009997901771157761	Dani Papetti	, VIVA V COLLIER ESTATE, DE ANN DEES PERSONAL REPRESENTATIVE PO BOX 449, FLETCHER, OK, 73541 Code: SAN JUAN 32-7 249H FC HSU	3/8/2019	Arrived at USPS Regional Origin Facility March 11, 2019 <b>Signature Pending</b>
92148969009997901771157778	Dani Papetti	, W D EWING JR, 2443 FILLMORE ST, SAN FRANCISCO, CA, 94115-1814 Code: SAN JUAN 32-7 249H FC HSU	3/8/2019	Departed USPS Regional Origin Facility March 11, 2019 <b>Signature Pending</b>
92148969009997901771157785	Dani Papetti	, WAL RESOURCES LLC, PO BOX 52848, TULSA, OK, 74152 Code: SAN JUAN 32-7 249H FC HSU	3/8/2019	Arrived at USPS Regional Origin Facility March 11, 2019 <b>Signature Pending</b>
92148969009997901771157792	Dani Papetti	, WATT LIVING TRUST 1 16 2009, JAMES WATT and CAROL WATT TTEES 128 DYRELL WAY, FOLSOM, CA, 95630 Code: SAN JUAN 32-7 249H FC HSU	3/8/2019	Departed USPS Regional Origin Facility March 11, 2019 <b>Signature Pending</b>
92148969009997901771157808	Dani Papetti	, WAYNE TROWBRIDGE, 14695 N RIVERSIDE RD, CABLE, WI, 54821 Code: SAN JUAN 32-7 249H FC HSU	3/8/2019	Arrived at USPS Regional Origin Facility March 11, 2019 <b>Signature Pending</b>
92148969009997901771157815	Dani Papetti	, WENDY L COX, and DENNIS COX JT 184 BEAVER CREEK DR, BAYFIELD, CO, 81122 Code: SAN JUAN 32-7 249H FC HSU	3/8/2019	Arrived at USPS Regional Origin Facility March 11, 2019 <b>Signature Pending</b>
92148969009997901771157822	Dani Papetti	, WESLEY W MULLEN, 3121 N AJO GILA BEND HWY, AJO, AZ, 85321 Code: SAN JUAN 32-7 249H FC HSU	3/8/2019	Arrived at USPS Regional Origin Facility March 11, 2019 <b>Signature Pending</b>
92148969009997901771157839	Dani Papetti	, WESTERN ROYALTIES, PO BOX 60364, COLORADO SPRINGS, CO, 80960 Code: SAN JUAN 32-7 249H FC HSU	3/8/2019	Arrived at USPS Regional Origin Facility March 11, 2019 <b>Signature Pending</b>
92148969009997901771157846	Dani Papetti	, WHITNEY BENNETT, 4420 NE 105TH AVE, PORTLAND, OR, 97220 Code: SAN JUAN 32-7 249H FC HSU	3/8/2019	Departed USPS Regional Origin Facility March 11, 2019 <b>Signature Pending</b>
92148969009997901771157853	Dani Papetti	, WILDA L SMITH, TANA FELDMAN P/O/A 19762 E 1160 RD, ELK CITY, OK, 73644 Code: SAN JUAN 32-7 249H FC HSU	3/8/2019	Arrived at USPS Regional Origin Facility March 11, 2019 <b>Signature Pending</b>
92148969009997901771157860	Dani Papetti	, WILLIAM BRIGGS, DBA WCB INVESTMENTS LLC 6729 ACADEMY RD NE STE D, ALBUQUERQUE, NM, 87109 Code: SAN JUAN 32-7 249H FC HSU	3/8/2019	Arrived at USPS Regional Origin Facility March 11, 2019 <b>Signature Pending</b>
92148969009997901771157877	Dani Papetti	, WILLIAM D ARNOLD, 2519 N ROCK ROAD COURT, WICHITA, KS, 67226 Code: SAN JUAN 32-7 249H FC HSU	3/8/2019	Arrived at USPS Regional Origin Facility March 11, 2019 <b>Signature Pending</b>
92148969009997901771157884	Dani Papetti	, WILLIAM E and DELORES K BARTRAM REV, TR WILLIAM and DELORES BARTRAM TTEES PO BOX 1335, STILLWATER, OK, 74076 Code: SAN JUAN 32-7 249H FC HSU	3/8/2019	Arrived at USPS Regional Origin Facility March 11, 2019 <b>Signature Pending</b>
		, WILLIAM GOULD SMITH and DELNA J SMITH, REV LVG TR WILLIAM G and DELNA J SMITH TTEES		Arrived at USPS Regional Origin

92148969009997901771157891	Dani Papetti	PAUL LAWRENCE POA 288 B, FORDLAND, MO, 65652 Code: SAN JUAN 32-7 249H FC HSU	3/8/2019	Facility March 11, 2019 <b>Signature Pending</b>
92148969009997901771157907	Dani Papetti	, WILLIAM J BRIGGS, 54 CARLA WAY, BROOMFIELD, CO, 80020 Code: SAN JUAN 32-7 249H FC HSU	3/8/2019	Arrived at USPS Regional Origin Facility March 11, 2019 <b>Signature Pending</b>
92148969009997901771157914	Dani Papetti	, WILLIAM L STACK, PO BOX 2753, KANSAS CITY, MO, 77208-1229 Code: SAN JUAN 32-7 249H FC HSU	3/8/2019	Departed USPS Regional Facility March 11, 2019 <b>Signature Pending</b>
92148969009997901771157921	Dani Papetti	, WILLIAM MAHLON ROBERTS, SOLE and SEPARATE PROPERTY 2614 OAK HILLS TRL, SAN ANGELO, TX, 76904 Code: SAN JUAN 32-7 249H FC HSU	3/8/2019	Arrived at USPS Regional Origin Facility March 11, 2019 <b>Signature Pending</b>
92148969009997901771157938	Dani Papetti	, WILLIAM MOHRMANN, 1864 S HWY #49, SAN ANDRES, CA, 95249-9638 Code: SAN JUAN 32-7 249H FC HSU	3/8/2019	Departed USPS Regional Origin Facility March 11, 2019 <b>Signature Pending</b>
92148969009997901771157945	Dani Papetti	, WILLIAM P WERNTZ TEST TRUST, JOSEPH L WERNTZ TRUSTEE 53 TWIN PEAKS RD SE, ALBUQUERQUE, NM, 87123 Code: SAN JUAN 32-7 249H FC HSU	3/8/2019	Arrived at USPS Regional Origin Facility March 11, 2019 <b>Signature Pending</b>
92148969009997901771157952	Dani Papetti	, WILLIAM W BRAMLETT and JULIANNE, BRAMLETT PO BOX 132255, THE WOODLANDS, TX, 77393-2255 Code: SAN JUAN 32-7 249H FC HSU	3/8/2019	Arrived at USPS Regional Facility March 11, 2019 <b>Signature Pending</b>
92148969009997901771157969	Dani Papetti	, WILLIE LOU COTTERELL ESTATE, DEBBIE QUALEY SUCCESSOR PERS REP 900 PANTHER DR, RENO, NV, 89506 Code: SAN JUAN 32-7 249H FC HSU	3/8/2019	Arrived at USPS Regional Origin Facility March 11, 2019 <b>Signature Pending</b>
92148969009997901771157976	Dani Papetti	, WPX ENERGY INC, DBA WPX ENERGY PRODUCTION LLC ATTN: LAND DEPT. MD 25 PO BOX 3102, TULSA, OK, 74101 Code: SAN JUAN 32-7 249H FC HSU	3/8/2019	Arrived at USPS Regional Origin Facility March 11, 2019 <b>Signature Pending</b>
92148969009997901771157983	Dani Papetti	, WWR ENTERPRISES INC, C/O PETROLEUM ASSET MANAGEMENT LLC PO BOX 745, HOBBS, NM, 88241 Code: SAN JUAN 32-7 249H FC HSU	3/8/2019	Arrived at USPS Regional Origin Facility March 11, 2019 <b>Signature Pending</b>
92148969009997901771157990	Dani Papetti	, SOUTHLAND ROYALTY COMPANY LLC, 400 WEST 7TH STREET, FORT WORTH, TX, 76102 Code: SAN JUAN 32-7 249H FC HSU	3/8/2019	Arrived at USPS Regional Origin Facility March 11, 2019 <b>Signature Pending</b>
92148969009997901771158003	Dani Papetti	, LOGOS RESOURCES II LLC, 2010 AFTON PL, FARMINGTON, NM, 87401 Code: SAN JUAN 32-7 249H FC HSU	3/8/2019	Arrived at USPS Regional Origin Facility March 11, 2019 <b>Signature Pending</b>
92148969009997901771158010	Dani Papetti	, SAN JUAN BASIN PARTNERSHIP, PO BOX 1155, MEDARD, TX, 76859 Code: SAN JUAN 32-7 249H FC HSU	3/8/2019	Arrived at USPS Regional Origin Facility March 11, 2019 <b>Signature Pending</b>