

Initial Application Part I

Received: 07/17/2019

This application is placed in file for record. It MAY or MAY NOT have been reviewed to be determined Administratively Complete

RECEIVED: 07/17/2019	REVIEWER: MAM	TYPE: CTB	APP NO: pMAM1919853992
-----------------------------	----------------------	------------------	-------------------------------

ABOVE THIS TABLE FOR OCD DIVISION USE ONLY

NEW MEXICO OIL CONSERVATION DIVISION
 - Geological & Engineering Bureau -
 1220 South St. Francis Drive, Santa Fe, NM 87505



ADMINISTRATIVE APPLICATION CHECKLIST

THIS CHECKLIST IS MANDATORY FOR ALL ADMINISTRATIVE APPLICATIONS FOR EXCEPTIONS TO DIVISION RULES AND REGULATIONS WHICH REQUIRE PROCESSING AT THE DIVISION LEVEL IN SANTA FE

Applicant: SPUR ENERGY PARTNERS, LLC **OGRID Number:** 328947
Well Name: LAKEWOOD FEDERAL #1 **API:** 30-015-24231
Pool: N SEVEN RIVERS; GLORIETA-YESO **Pool Code:** 97565

SUBMIT ACCURATE AND COMPLETE INFORMATION REQUIRED TO PROCESS THE TYPE OF APPLICATION INDICATED BELOW

1) TYPE OF APPLICATION: Check those which apply for [A]

A. Location – Spacing Unit – Simultaneous Dedication

☐ NSL ☐ NSP (PROJECT AREA) ☐ NSP (PRORATION UNIT) ☐ SD

B. Check one only for [I] or [II]

[I] Commingling – Storage – Measurement

☐ DHC ☒ CTB ☐ PLC ☐ PC ☐ OLS ☐ OLM

[II] Injection – Disposal – Pressure Increase – Enhanced Oil Recovery

☐ WFX ☐ PMX ☐ SWD ☐ IPI ☐ EOR ☐ PPR

CTB-905

2) NOTIFICATION REQUIRED TO: Check those which apply.

- A. ☐ Offset operators or lease holders
 B. ☒ Royalty, overriding royalty owners, revenue owners
 C. ☐ Application requires published notice
 D. ☐ Notification and/or concurrent approval by SLO
 E. ☒ Notification and/or concurrent approval by BLM
 F. ☐ Surface owner
 G. ☐ For all of the above, proof of notification or publication is attached, and/or,
 H. ☐ No notice required

FOR OCD ONLY

- ☐ Notice Complete
☐ Application Content Complete

3) CERTIFICATION: I hereby certify that the information submitted with this application for administrative approval is **accurate** and **complete** to the best of my knowledge. I also understand that **no action** will be taken on this application until the required information and notifications are submitted to the Division.

Note: Statement must be completed by an individual with managerial and/or supervisory capacity.

Cory Walk

Print or Type Name

Signature

Cory Walk

7/12/2019

Date

505-466-8120

Phone Number

cory@permitswest.com

e-mail Address

District I
1625 N. French Drive, Hobbs, NM 88240
District II
811 S. First St., Artesia, NM 88210
District III
1000 Rio Brazos Road, Aztec, NM 87410
District IV
1220 S. St Francis Dr, Santa Fe, NM
87505

State of New Mexico
Energy, Minerals and Natural Resources Department

Form C-107-B
Revised August 1, 2011

OIL CONSERVATION DIVISION
1220 S. St Francis Drive
Santa Fe, New Mexico 87505

Submit the original
application to the Santa Fe
office with one copy to the
appropriate District Office.

APPLICATION FOR SURFACE COMMINGLING (DIVERSE OWNERSHIP)

OPERATOR NAME: SPUR ENERGY PARTNERS, LLC
OPERATOR ADDRESS: 920 MEMORIAL CITY WAY SUITE 1000 HOUSTON TX 77024
APPLICATION TYPE:

☐ Pool Commingling ☒ Lease Commingling ☐ Pool and Lease Commingling ☐ Off-Lease Storage and Measurement (Only if not Surface Commingled)

LEASE TYPE: ☐ Fee ☐ State ☒ Federal

Is this an Amendment to existing Order? ☐ Yes ☒ No If "Yes", please include the appropriate Order No. _____
Have the Bureau of Land Management (BLM) and State Land office (SLO) been notified in writing of the proposed commingling
☒ Yes ☐ No

(A) POOL COMMINGLING
Please attach sheets with the following information

(1) Pool Names and Codes	Gravities / BTU of Non-Commingled Production	Calculated Gravities / BTU of Commingled Production		Calculated Value of Commingled Production	Volumes

- (2) Are any wells producing at top allowables? ☐ Yes ☐ No
(3) Has all interest owners been notified by certified mail of the proposed commingling? ☐ Yes ☐ No.
(4) Measurement type: ☐ Metering ☐ Other (Specify)
(5) Will commingling decrease the value of production? ☐ Yes ☐ No If "yes", describe why commingling should be approved

(B) LEASE COMMINGLING
Please attach sheets with the following information

- (1) Pool Name and Code. N SEVEN RIVERS; GLORIETA-YESO
(2) Is all production from same source of supply? ☒ Yes ☐ No
(3) Has all interest owners been notified by certified mail of the proposed commingling? ☒ Yes ☐ No
(4) Measurement type: ☒ Metering ☐ Other (Specify)

(C) POOL and LEASE COMMINGLING
Please attach sheets with the following information

- (1) Complete Sections A and E.

(D) OFF-LEASE STORAGE and MEASUREMENT
Please attached sheets with the following information

- (1) Is all production from same source of supply? ☐ Yes ☐ No
(2) Include proof of notice to all interest owners.

(E) ADDITIONAL INFORMATION (for all application types)
Please attach sheets with the following information

- (1) A schematic diagram of facility, including legal location.
(2) A plat with lease boundaries showing all well and facility locations. Include lease numbers if Federal or State lands are involved.
(3) Lease Names, Lease and Well Numbers, and API Numbers.

I hereby certify that the information above is true and complete to the best of my knowledge and belief.

SIGNATURE: Cory Walk TITLE: Agent DATE: July 12, 2019

TYPE OR PRINT NAME Cory Walk TELEPHONE NO.: (505) 466-8120

E-MAIL ADDRESS: cory@permitswest.com

APPLICATION FOR SURFACE COMMINGLING, OFFLEASE MEASUREMENT, AND OFFLEASE ROYALTY FREE BENEFICIAL USE AT A COMMON CENTRAL TANK BATTERY

Percussion Petroleum, LLC is requesting approval to Surface Commingle the production from the following wells at a common central tank battery located on the Huber 3 Federal 3 Facility and #03H well location:

NM Lse #	Completion	API#	Pool Code	BLM Royalty Rate
NMNM14758	Huber 3 Federal 03H	3001538163	97565	12.5%
	Huber 3 Federal 04H	3001539022		
	Huber 3 Federal 05H	3001539177		
	Huber 3 Federal 06H	3001539765		
	Huber 3 Federal 07H	3001544706		
	Huber 3 Federal 08H	3001544707		
NMNM31200	Lakewood Federal 1	3001524231	97565	12.5% Sch B Competitive

The Huber 3 Federal 03H, 04H, 05H, 06H, 07H and 08H will require Surface Commingling for gas sales.

The Huber 3 Federal 03H, 04H, 07H and 08H will require Surface Commingling for oil storage and sales.

The Lakewood Federal 1 will require Surface Commingling, Offlease Measurement, storage and sales of oil and gas as well as Offlease Royalty Free Beneficial Use.

Please see the attached Process Description, Lease Plat, Flow Diagram, Allocation Methodology, and Site Facility Diagram.

OVERVIEW

The Lakewood Federal 1 well API# 3001524231 NMNM31200 is currently an idle well with an approved Shut-In Status. Percussion Petroleum, LLC is proposing to re-activate the well due to nearby drilling activity in the area in an attempt to establish economic productivity. There currently are no production facilities or sales connection for this well's production if the well can be restored to a producing condition. To minimize the required capital investment and maximize the opportunity to establish economic production from this well, is it proposed that this well's production be commingled with the production at the nearby Huber 3 Federal Facility. All of the wells are producing from the same formation N Seven Rivers – Glorieta Pool Code 97565.

The Huber 3 Federal Lease NMNM14758 currently has two (2) active tank battery facilities handling the production for six(6) wells. The Huber 3 Federal 3 Facility NMNM14758 currently handles the full wellstream production from four(4) Federal wells:

Huber 3 Federal 03H API#3001538163
Huber 3 Federal 04H API#3001539022
Huber 3 Federal 07H API#3001544706
Huber 3 Federal 08H API#3001544707

The Huber 3 Federal 3 Facility also handles the gas production from the Huber 3 Federal 5 Facility associated with two(2) Federal wells:

Huber 3 Federal 05H API#3001539177
Huber 3 Federal 06H API#3001539765

The attached Lease Plat shows the physical relationship of the wells, facilities, flowlines, and interconnections associated with the Lakewood Federal and Huber 3 Federal leases.

PROCESS DESCRIPTION AND ALLOCATION METHODOLOGY

The full wellstream production from the Lakewood Federal 1 well will flow to the Huber 3 Federal 3 Facility along with the full wellstream production from the Huber 3 Federal 03H, 04H, 07H, and 08H wells and only the gas production from the Huber 3 Federal 5 Facility after separation from the Huber Federal 05H and 06H wells. The Lakewood Federal 1 well produces from the NMNM31200 lease that currently has a Schedule B 12.5% royalty burden. All the Huber 3 Federal wells produce from the NMNM14758 lease that has a 12.5% royalty burden.

The full wellstream production from the Lakewood Federal 1 and Huber 3 Federal 03H, 04H, 07H, and 08H wells will be processed at the Huber 3 Federal 3 Facility through a well header system consisting of three(3) horizontal free-water knockouts all equipped with oil, gas, and water meters and a dedicated test separator that is also equipped with oil, gas, and water meters. The commingled oil production will flow to two(2) heater treaters that will further remove any residual water or sediments to allow the oil to become a saleable product. There is separate oil and water storage for all commingled liquids. The oil, gas, and water production will be proratedly allocated to each individual well based on metered well test rates.

The attached Flow Diagram will provide information on the flow, measurement, storage, and disposition of oil, gas, and water production from all wells.

The attached Oil, Gas, and Water Production Volume Allocation Example will provide information on the proposed well test allocation methodology for all wells.

The attached Lease Use Volume Allocation Example will provide information on the proposed well test allocation methodology for fuel gas for all wells.

GAS

The Lakewood Federal 1 and the Huber 3 Federal 03H and 04H wells will produce to a header system that will allow the wells to be separated through a horizontal free-water knockout and dedicated test separator all equipped with oil, gas, and water meters. The Huber 07H and 08H will each produce to a dedicated horizontal free-water knockout that are both equipped with oil, gas, and water meters. The gas production from the Huber 3 Federal 5 Facility 05H and 06H wells are both individually metered prior to leaving the facility and being commingled with the gas produced at the Huber 3 Federal 3 Facility after separation and measurement. The commingled production from all wells will then flow through a gas engine compressor to facilitate gas sales at a common Facility Measurement Point to DCP through sales meter #724979. All of the gas production and sales will be proratedly based on metered welltests for each individual well that will be updated monthly or more frequently to reflect any change in an individual well's productivity.

COMMINGLED LIQUIDS

Water Production - As noted above, the Lakewood Federal 1 and Huber 3 Federal 03H, 04H, 07H, and 08H wells will be processed at the Huber 3 Federal 3 Facility through a well header system that allows the production to be separated, metered, and tested for each individual well. All separated liquids are collected on location and stored in sealed tanks. After separation and metering, the produced water is stored in four(4) separate produced water tanks that is either metered and pumped or is transported via truck to Percussion Petroleums' Dagger Draw Saltwater Disposal System for injection into one of four permitted disposal wells. The total produced water will be allocated back to each producing well on a

prorated basis using metered welltests for each individual well that will be updated monthly or more frequently to reflect any change in an individual well's productivity.

Oil Production - After separation and metering, the produced oil from each well is then commingled and is directed to one of two heater treaters to obtain a saleable oil product that is then stored in common oil stock tanks. The commingled oil will then be sold from the sealed and strapped oil storage tanks via truck or thru a truck-LACT unit. There are two(2) Oil Facility Measurement Points (FMP) associated with this facility. FMP#1 is a truck-LACT unit and FMP#2 is a common oil load line for gauged, oil truck sales for the commingled oil. The oil sold through either Oil FMP#1 or FMP#2 will be allocated back to each producing well on a prorated basis using metered welltests for each individual well that will be updated monthly or more frequently to reflect any change in an individual well's productivity.

FUEL GAS

The Huber 3 Federal 3 Facility currently has two(2) active heater treaters downstream of the initial production separation point operating to treat the produced oil to obtain a saleable oil product. The estimated fuel gas usage for each heater treater is 10 Mcfd and the gas engine compressor is 25 Mcfd based on the engineering formulas provided on Pg 2 of the Site Facility Diagram. The amount of Lease Use will be allocated back to each producing well on a prorated basis using each individual well's oil well test rate or gas well test rate as appropriate. Offlease Royalty-Free Beneficial Lease Use for the allocated fuel assigned to the Lakewood Federal 1 well is requested.

TEMPORARY OPERATING PROCEDURES

Percussion Petroleum recognizes that the Lakewood Federal 1 NMNM31200 lease has a Step-Scale, Schedule B Competitive Royalty Burden that is subject to change per the producing capability of the well. To insure the proper Federal Royalty is paid for any production recovered from the Lakewood Federal 1 as a result of re-operating this well and commingling it with the Huber 3 Federal lease, Percussion Petroleum will monitor the allocated production from the well on a 3 month, quarterly basis for a period of 12 months after initial production is re-established in the well. If the average production from the well over the most recent 3 month, quarterly period exceeds 50 BOPD and/or 5000 MCFD (calculated separately), a re-evaluation will occur at that time to determine how the ongoing production from the Lakewood Federal 1 will be managed. Percussion Petroleum agrees to communicate the well tests, monthly production, and calculated 3 month quarterly average oil and gas production rates to the BLM Carlsbad Field Office on a quarterly basis via Sundry Notice – Subsequent Report after production is re-established. Percussion also agrees to conduct frequent welltests on the Lakewood Federal 1 as part of an effort to accurately monitor the well's performance during the 12 month temporary evaluation timeperiod.

LEASE and WELL PLAT

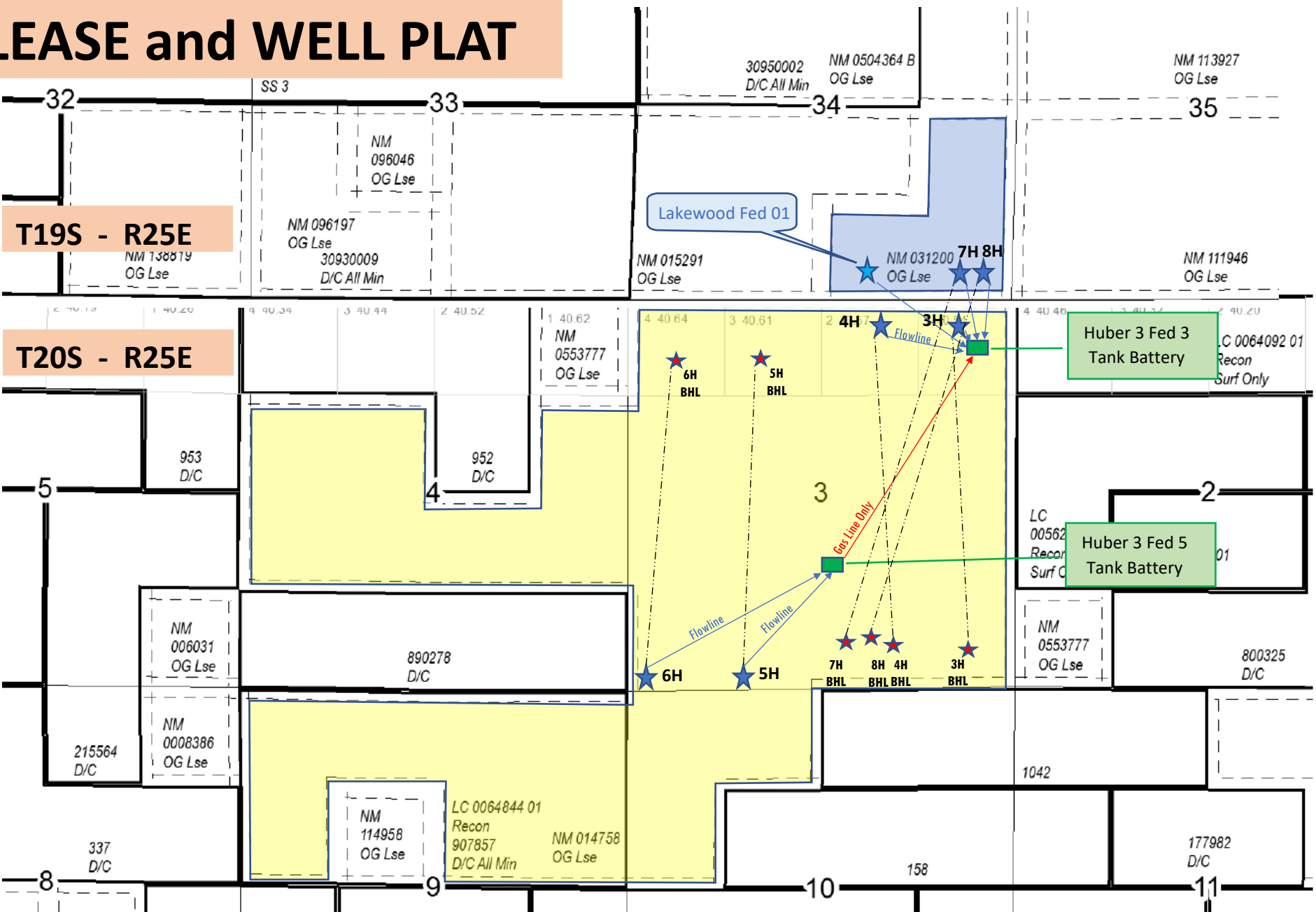

Huber3 Federal 5 Tank Battery

Huber 3 Federal 5H API# 3001539177

Huber 3 Federal 6H API# 3001539765

Huber 3 Federal 3 Tank Battery

- FLOW DIAGRAM -

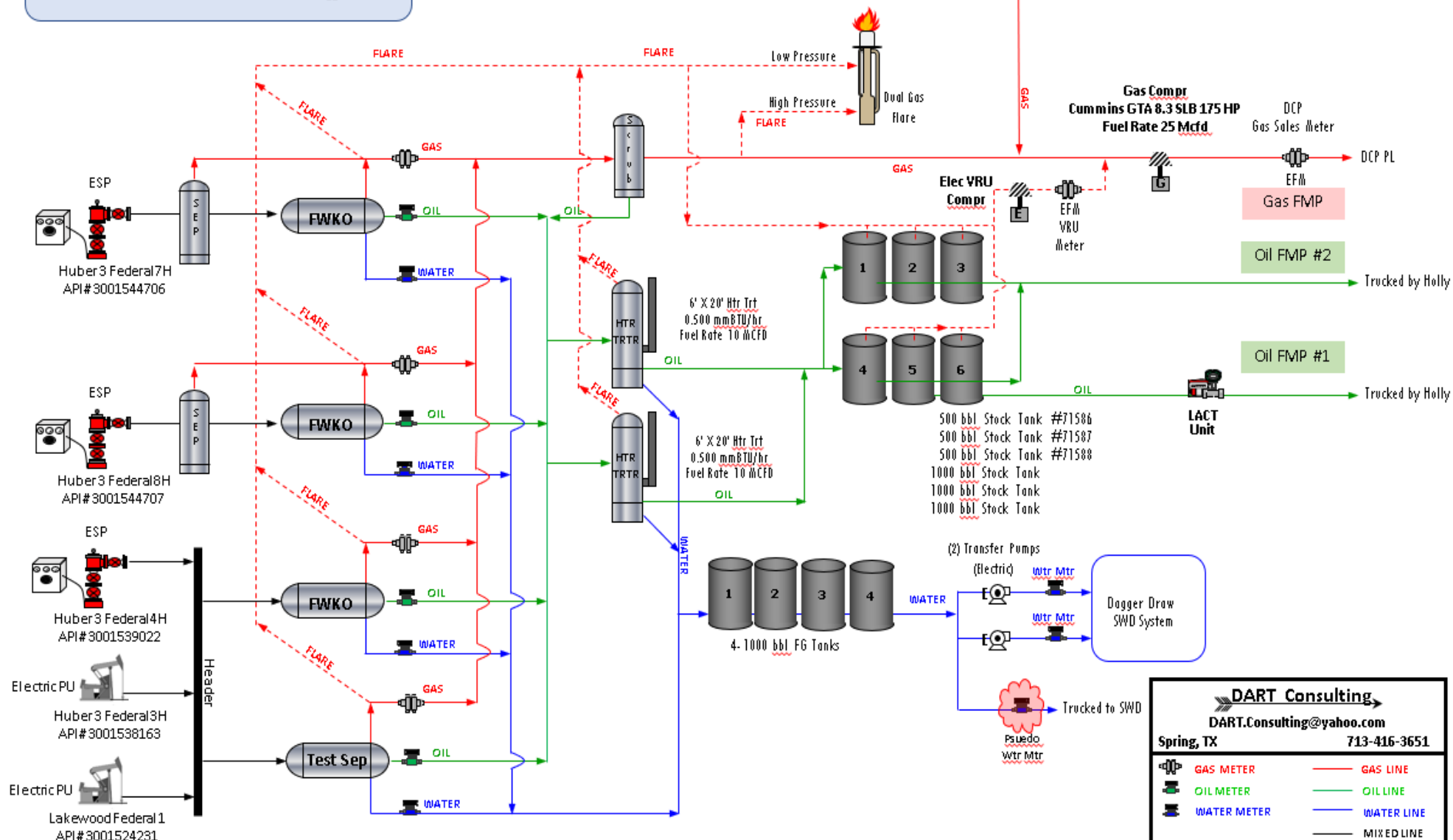

OIL, GAS, and WATER PRODUCTION VOLUME ALLOCATION - EXAMPLE
COMMINGLED PRODUCTION

	OIL Production (Bbls)	GAS Production (Mcf)	WATER Production (Bbls)
TOTAL	800	1000	2000

Facility	Well	Oil Well Test (BPD)	Gas Well Test (MCFD)	Water Well Test (BPD)	OIL		GAS		WATER	
					Oil Volume Allocation Factor	Allocated Oil Volume (Bbls)	Gas Volume Allocation Factor	Allocated Gas Volume (Bbls)	Water Volume Allocation Factor	Allocated Water Volume (Bbls)
Huber 3 Federal 3	Huber 3 Federal 3H	25.0	25.0	50.0	0.030	24.24	0.028	27.78	0.02439	48.78
	Huber 3 Federal 4H	50.0	50.0	100.0	0.061	48.48	0.056	55.56	0.04878	97.56
	Huber 3 Federal 7H	350.0	350.0	900.0	0.424	339.39	0.389	388.89	0.43902	878.05
	Huber 3 Federal 8H	350.0	350.0	900.0	0.424	339.39	0.389	388.89	0.43902	878.05
	Lakewood Federal 1	50.0	50.0	100.0	0.061	48.48	0.056	55.56	0.04878	97.56
Huber 3 Federal 5	Huber 3 Federal 5H	n/a	25.0	n/a	n/a	n/a	0.028	27.78	n/a	n/a
	Huber 3 Federal 6H	n/a	50.0	n/a	n/a	n/a	0.056	55.56	n/a	n/a
TOTAL		825.0	900.0	2,050.0	1.000	800.00	1.000	1,000.00	1.00000	2,000.00

Commingled Production Volume Allocations will be performed on a prorated basis using Oil, Gas, and Water well test rates

$$\text{Commingled Oil Volume Allocation} = \left(\frac{\text{Individual Well Oil Test Rate}}{\sum \text{All Well Oil Test Rates}} \right) \times \text{Total Commingled Oil Production Volume}$$

$$\text{Commingled Gas Volume Allocation} = \left(\frac{\text{Individual Well Gas Test Rate}}{\sum \text{All Well Gas Test Rates}} \right) \times \text{Total Commingled Gas Production Volume}$$

$$\text{Commingled Water Volume Allocation} = \left(\frac{\text{Individual Well Water Test Rate}}{\sum \text{All Well Water Test Rates}} \right) \times \text{Total Commingled Water Production Volume}$$

LEASE USE VOLUME ALLOCATION - EXAMPLE

REQUEST FOR OFF-LEASE BENEFICIAL USE OF FUEL GAS

Inventory of Common, Off-Lease Equipment Handling Commingled Oil Production

		Estimated Fuel Consumption	
Heater Treater #1	0.500 mmBTU Firetube Rating	10.0 Mcfd	13.54 mmBTU/D
Heater Treater #2	0.500 mmBTU Firetube Rating	10.0 Mcfd	13.54 mmBTU/D
TOTAL		20.0	27.08

OFF-LEASE BENEFICIAL USE EXAMPLE ALLOCATION

Facility	Well	Oil Well Test (BPD)	Fuel Volume		Fuel Quality	
			Oil Volume Allocation Factor	Allocated Lease Use Volume MCFD	Well Gas Sales BTU Factor	Allocated Lease Use mmBTU/D
Huber 3 Federal 3	Huber 3 Federal 3H	25.0	0.030	0.61	1.35400	0.82
	Huber 3 Federal 4H	50.0	0.061	1.21		1.64
	Huber 3 Federal 7H	350.0	0.424	8.48		11.49
	Huber 3 Federal 8H	350.0	0.424	8.48		11.49
	Lakewood Federal 1	50.0	0.061	1.21		1.64
Huber 3 Federal 5	Huber 3 Federal 5H	n/a	n/a	n/a	n/a	n/a
	Huber 3 Federal 6H	n/a	n/a	n/a	n/a	n/a
		825.0	1.000	20.00		27.08

Beneficial Use Fuel Volume Allocations will be performed on a prorated basis using the Oil Well Test Rate of each well

$$\text{Beneficial Use Fuel Volume Allocation} = \left(\frac{\text{Individual Well Oil Test Rate}}{\sum \text{All Well Oil Test Rates}} \right) \times \sum \text{All Common Equipment Fuel Usage Volume}$$

Beneficial Use Fuel Quality Allocations will be performed using a common Heating Value BTU Factor obtained at the POM sales meter distributed volumetrically to each well.

$$\text{Heating Value Allocation} = \text{Individual Well BTU Factor} \times \text{Beneficial Use Fuel Volume Allocation for Each Well}$$

Allocations will be adjusted according to BTU value and based on the BTU determination frequency as required by 43 CFR 3175

Off-Lease Royalty Free Beneficial Use of Fuel Gas for common equipment, fuel consumption is requested for the Lakewood Federal 1 handling commingled liquids

UNITED STATES
DEPARTMENT OF THE INTERIOR
BUREAU OF LAND MANAGEMENT

FORM APPROVED
OMB No. 1004-0137
Expires: January 31, 2018

SUNDRY NOTICES AND REPORTS ON WELLS
Do not use this form for proposals to drill or to re-enter an abandoned well. Use Form 3160-3 (APD) for such proposals.

SUBMIT IN TRIPLICATE - Other instructions on page 2

1. Type of Well

☒ Oil Well ☐ Gas Well ☐ Other

2. Name of Operator **SPUR ENERGY PARTNERS, LLC**

3a. Address **920 MEMORIAL CITY WAY SUITE 1000
HOUSTON, TX 77024**

3b. Phone No. (include area code)
(832) 930-8502

4. Location of Well (Footage, Sec., T., R., M., or Survey Description)
660 FSL & 1993 FEL, SECTION 34, T19S, R25E

5. Lease Serial No. **NMNM031200**

6. If Indian, Allottee or Tribe Name

7. If Unit of CA/Agreement, Name and/or No.

8. Well Name and No. **LAKEWOOD FEDERAL #1**

9. API Well No. **30-015-24231**

10. Field and Pool or Exploratory Area
N SEVEN RIVERS; GLORIETA-YESO

11. Country or Parish, State
Eddy County, NM

12. CHECK THE APPROPRIATE BOX(ES) TO INDICATE NATURE OF NOTICE, REPORT OR OTHER DATA

TYPE OF SUBMISSION	TYPE OF ACTION			
<input checked="" type="checkbox"/> Notice of Intent	<input type="checkbox"/> Acidize	<input type="checkbox"/> Deepen	<input type="checkbox"/> Production (Start/Resume)	<input type="checkbox"/> Water Shut-Off
<input type="checkbox"/> Subsequent Report	<input type="checkbox"/> Alter Casing	<input type="checkbox"/> Hydraulic Fracturing	<input type="checkbox"/> Reclamation	<input type="checkbox"/> Well Integrity
<input type="checkbox"/> Final Abandonment Notice	<input type="checkbox"/> Casing Repair	<input type="checkbox"/> New Construction	<input type="checkbox"/> Recomplete	<input checked="" type="checkbox"/> Other
	<input type="checkbox"/> Change Plans	<input type="checkbox"/> Plug and Abandon	<input type="checkbox"/> Temporarily Abandon	
	<input type="checkbox"/> Convert to Injection	<input type="checkbox"/> Plug Back	<input type="checkbox"/> Water Disposal	

13. Describe Proposed or Completed Operation: Clearly state all pertinent details, including estimated starting date of any proposed work and approximate duration thereof. If the proposal is to deepen directionally or recompleat horizontally, give subsurface locations and measured and true vertical depths of all pertinent markers and zones. Attach the Bond under which the work will be perfonned or provide the Bond No. on file with BLM/BIA. Required subsequent reports must be filed within 30 days following completion of the involved operations. If the operation results in a multiple completion or recompleat in a new interval, a Form 3160-4 must be filed once testing has been completed. Final Abandonment Notices must be filed only after all requirements, including reclamation, have been completed and the operator has detennined that the site is ready for final inspection.)

Spur Energy Partners LLC would like to request off-lease storage and measurement of both oil and gas at Huber 3 Federal 3 Facility. In addition, Spur Energy Partners LLC would like to request oil and gas surface commingling at Huber 3 Federal 3 Facility. Please see the list below of wells coming into this facility:

Huber 3 Federal 03H (30-015-38163)	L1, Sec. 3, T20S, R25E
Huber 3 Federal 04H (30-015-39022)	L2, Sec. 3, T20S, R25E
Huber 3 Federal 05H (30-015-39177)	SESW, Sec. 3, T20S, R25E
Huber 3 Federal 06H (30-015-39765)	SWSW, Sec. 3, T20S, R25E
Huber 3 Federal 07H (30-015-44706)	SESE, Sec. 34, T19S, R25E
Huber 3 Federal 08H (30-015-44707)	SESE, Sec. 34, T19S, R25E
Lakewood Federal 1 (30-015-24231)	SWSE, Sec. 34, T19S, R25E

See attached detailed commingling information, diagram, and map.

14. I hereby certify that the foregoing is true and correct. Name (Printed/Typed)

Cory Walk

Consultant

Title

Signature

Cory Walk

Date

05/31/2019

THE SPACE FOR FEDERAL OR STATE OFFICE USE

Approved by

Title

Date

Conditions of approval, if any, are attached. Approval of this notice does not warrant or certify that the applicant holds legal or equitable title to those rights in the subject lease which would entitle the applicant to conduct operations thereon.

Office

Title 18 U.S.C Section 1001 and Title 43 U.S.C Section 1212, make it a crime for any person knowingly and willfully to make to any department or agency of the United States any false, fictitious or fraudulent statements or representations as to any matter within its jurisdiction.

7018 1830 0000 6978 6318

U.S. Postal Service™ CERTIFIED MAIL® RECEIPT Domestic Mail Only

For delivery information, visit our website at www.usps.com®.

OFFICIAL USE

Certified Mail Fee

\$

Extra Services & Fees (check box, add fee as appropriate)

- ☐ Return Receipt (hardcopy) \$
- ☐ Return Receipt (electronic) \$
- ☐ Certified Mail Restricted Delivery \$
- ☐ Adult Signature Required \$
- ☐ Adult Signature Restricted Delivery \$

Postage

\$

Total Postage and Fees

\$

Sent To

Street and Apt. No., or PO Box No.

City, State, ZIP+4®

PS Form 3800, April 2015 PSN 7530-02-000-9047

See Reverse for Instructions

ST DEVOTE LLC

PO BOX 823085

DALLAS TX 75382

Percuss Lakewood Fed 1 Co-Mingle

PECOS NM

MAY 31 2019

Postmark Here

87552-9998

7018 1830 0000 6978 6325

U.S. Postal Service™ CERTIFIED MAIL® RECEIPT Domestic Mail Only

For delivery information, visit our website at www.usps.com®.

OFFICIAL USE

Certified Mail Fee

\$

Extra Services & Fees (check box, add fee as appropriate)

- ☐ Return Receipt (hardcopy) \$
- ☐ Return Receipt (electronic) \$
- ☐ Certified Mail Restricted Delivery \$
- ☐ Adult Signature Required \$
- ☐ Adult Signature Restricted Delivery \$

Postage

\$

Total Postage and Fees

\$

Sent To

Street and Apt. No., or PO Box No.

City, State, ZIP+4®

PS Form 3800, April 2015 PSN 7530-02-000-9047

See Reverse for Instructions

XTO HOLDINGS LLC

810 HOUSTON ST

FORT WORTH TX 76102

Percuss Lakewood Fed 1 Co-Mingle

PECOS NM

MAY 31 2019

Postmark Here

87552-9998

7018 1830 0000 6978 6288

U.S. Postal Service™ CERTIFIED MAIL® RECEIPT Domestic Mail Only

For delivery information, visit our website at www.usps.com®.

OFFICIAL USE

Certified Mail Fee

\$

Extra Services & Fees (check box, add fee as appropriate)

- ☐ Return Receipt (hardcopy) \$
- ☐ Return Receipt (electronic) \$
- ☐ Certified Mail Restricted Delivery \$
- ☐ Adult Signature Required \$
- ☐ Adult Signature Restricted Delivery \$

Postage

\$

Total Postage and Fees

\$

Sent To

Street and Apt. No., or PO Box No.

City, State, ZIP+4®

PS Form 3800, April 2015 PSN 7530-02-000-9047

See Reverse for Instructions

REISCHMAN ANNA A

1320 W FOURTH ST

ROSWELL NM 88201

Percuss Lakewood Fed 1 Co-Mingle

PECOS NM

MAY 31 2019

Postmark Here

87552-9998

7018 1830 0000 6978 6301

U.S. Postal Service™ CERTIFIED MAIL® RECEIPT Domestic Mail Only

For delivery information, visit our website at www.usps.com®.

OFFICIAL USE

Certified Mail Fee

\$

Extra Services & Fees (check box, add fee as appropriate)

- ☐ Return Receipt (hardcopy) \$
- ☐ Return Receipt (electronic) \$
- ☐ Certified Mail Restricted Delivery \$
- ☐ Adult Signature Required \$
- ☐ Adult Signature Restricted Delivery \$

Postage

\$

Total Postage and Fees

\$

Sent To

Street and Apt. No., or PO Box No.

City, State, ZIP+4®

PS Form 3800, April 2015 PSN 7530-02-000-9047

See Reverse for Instructions

ROSEWOOD RESOURCES CORP

2101 CEDAR SPRINGS RD STE 1600

DALLAS TX 75201

Percuss Lakewood Fed 1 Co-Mingle

PECOS NM

MAY 31 2019

Postmark Here

87552-9998

7018 1830 0000 6978 6240

U.S. Postal Service™ CERTIFIED MAIL® RECEIPT Domestic Mail Only

For delivery information, visit our website at www.usps.com®.

OFFICIAL USE

Certified Mail Fee

\$

Extra Services & Fees (check box, add fee as appropriate)

- ☐ Return Receipt (hardcopy) \$
- ☐ Return Receipt (electronic) \$
- ☐ Certified Mail Restricted Delivery \$
- ☐ Adult Signature Required \$
- ☐ Adult Signature Restricted Delivery \$

Postage

\$

Total Postage and Fees

\$

Sent To

Street and Apt. No., or PO Box No.

City, State, ZIP+4®

PS Form 3800, April 2015 PSN 7530-02-000-9047

See Reverse for Instructions

NEARBURG GRETCHEN B

1608 LAKEWAY BLVD

AUSTIN TX 78734

Percuss Lakewood Fed 1 Co-Mingle

PECOS NM

MAY 31 2019

Postmark Here

87552-9998

7018 1830 0000 6978 6295

U.S. Postal Service™ CERTIFIED MAIL® RECEIPT Domestic Mail Only

For delivery information, visit our website at www.usps.com®.

OFFICIAL USE

Certified Mail Fee

\$

Extra Services & Fees (check box, add fee as appropriate)

- ☐ Return Receipt (hardcopy) \$
- ☐ Return Receipt (electronic) \$
- ☐ Certified Mail Restricted Delivery \$
- ☐ Adult Signature Required \$
- ☐ Adult Signature Restricted Delivery \$

Postage

\$

Total Postage and Fees

\$

Sent To

Street and Apt. No., or PO Box No.

City, State, ZIP+4®

PS Form 3800, April 2015 PSN 7530-02-000-9047

See Reverse for Instructions

ROEMER LAMAR B

1675 BROADWAY #2750

DENVER CO 80202

Percuss Lakewood Fed 1 Co-Mingle

PECOS NM

MAY 31 2019

Postmark Here

87552-9998

7018 1830 0000 6978 6264

U.S. Postal Service™ CERTIFIED MAIL® RECEIPT Domestic Mail Only

For delivery information, visit our website at www.usps.com®.

OFFICIAL USE

Certified Mail Fee

\$

Extra Services & Fees (check box, add fee as appropriate)

☐ Return Receipt (hardcopy) \$☐ Return Receipt (electronic) \$☐ Certified Mail Restricted Delivery \$☐ Adult Signature Required \$☐ Adult Signature Restricted Delivery \$

Postage

\$

Total Postage and Fees

\$

Sent To

Street and Apt. No., or PO Box No.

City, State, ZIP+4®

PS Form 3800, April 2015 PSN 7530-02-000-9047

See Reverse for Instructions



7018 1830 0000 6978 6271

U.S. Postal Service™ CERTIFIED MAIL® RECEIPT Domestic Mail Only

For delivery information, visit our website at www.usps.com®.

OFFICIAL USE

Certified Mail Fee

\$

Extra Services & Fees (check box, add fee as appropriate)

☐ Return Receipt (hardcopy) \$☐ Return Receipt (electronic) \$☐ Certified Mail Restricted Delivery \$☐ Adult Signature Required \$☐ Adult Signature Restricted Delivery \$

Postage

\$

Total Postage and Fees

\$

Sent To

Street and Apt. No., or PO Box No.

City, State, ZIP+4®

PS Form 3800, April 2015 PSN 7530-02-000-9047



PHILLIPS JOHN D
PO BOX 11
ALBUQUERQUE NM 87103
Percuss Lakewood Fed 1 Co-Mingle

See Reverse for Instructions

7018 1830 0000 6978 6226

U.S. Postal Service™ CERTIFIED MAIL® RECEIPT Domestic Mail Only

For delivery information, visit our website at www.usps.com®.

OFFICIAL USE

Certified Mail Fee

\$

Extra Services & Fees (check box, add fee as appropriate)

☐ Return Receipt (hardcopy) \$☐ Return Receipt (electronic) \$☐ Certified Mail Restricted Delivery \$☐ Adult Signature Required \$☐ Adult Signature Restricted Delivery \$

Postage

\$

Total Postage and Fees

\$

Sent To

Street and Apt. No., or PO Box No.

City, State, ZIP+4®

PS Form 3800, April 2015 PSN 7530-02-000-9047



NEARBURG EXPL CO LLC
PO BOX 823085
DALLAS TX 75382
Percuss Lakewood Fed 1 Co-Mingle

See Reverse for Instructions

7018 1830 0000 6978 6257

U.S. Postal Service™ CERTIFIED MAIL® RECEIPT Domestic Mail Only

For delivery information, visit our website at www.usps.com®.

OFFICIAL USE

Certified Mail Fee

\$

Extra Services & Fees (check box, add fee as appropriate)

☐ Return Receipt (hardcopy) \$☐ Return Receipt (electronic) \$☐ Certified Mail Restricted Delivery \$☐ Adult Signature Required \$☐ Adult Signature Restricted Delivery \$

Postage

\$

Total Postage and Fees

\$

Sent To

Street and Apt. No., or PO Box No.

City, State, ZIP+4®

PS Form 3800, April 2015 PSN 7530-02-000-9047



NY LIFE OG OPER PROD
700 LOUISIANA #2100
HOUSTON TX 77002
Percuss Lakewood Fed 1 Co-Mingle

See Reverse for Instructions

7018 1830 0000 6978 6219

U.S. Postal Service™ CERTIFIED MAIL® RECEIPT Domestic Mail Only

For delivery information, visit our website at www.usps.com®.

OFFICIAL USE

Certified Mail Fee

\$

Extra Services & Fees (check box, add fee as appropriate)

☐ Return Receipt (hardcopy) \$☐ Return Receipt (electronic) \$☐ Certified Mail Restricted Delivery \$☐ Adult Signature Required \$☐ Adult Signature Restricted Delivery \$

Postage

\$

Total Postage and Fees

\$

Sent To

Street and Apt. No., or PO Box No.

City, State, ZIP+4®

PS Form 3800, April 2015 PSN 7530-02-000-9047



NEARBURG EUGENE E
1608 LAKEWAY BLVD
AUSTIN TX 78734
Percuss Lakewood Fed 1 Co-Mingle

See Reverse for Instructions

7018 1830 0000 6978 6233

U.S. Postal Service™ CERTIFIED MAIL® RECEIPT Domestic Mail Only

For delivery information, visit our website at www.usps.com®.

OFFICIAL USE

Certified Mail Fee

\$

Extra Services & Fees (check box, add fee as appropriate)

☐ Return Receipt (hardcopy) \$☐ Return Receipt (electronic) \$☐ Certified Mail Restricted Delivery \$☐ Adult Signature Required \$☐ Adult Signature Restricted Delivery \$

Postage

\$

Total Postage and Fees

\$

Sent To

Street and Apt. No., or PO Box No.

City, State, ZIP+4®

PS Form 3800, April 2015 PSN 7530-02-000-9047

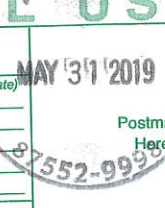

NEARBURG EXPL CO LLC
3300 N A ST #120
MIDLAND TX 79705
Percuss Lakewood Fed 1 Co-Mingle

See Reverse for Instructions

7018 1830 0000 6978 6196

U.S. Postal Service™ CERTIFIED MAIL® RECEIPT

Domestic Mail Only

For delivery information, visit our website at www.usps.com®.

OFFICIAL USE

Certified Mail Fee

Extra Services & Fees (check box, add fee as appropriate)

- ☐ Return Receipt (hardcopy) \$
☐ Return Receipt (electronic) \$
☐ Certified Mail Restricted Delivery \$
☐ Adult Signature Required \$
☐ Adult Signature Restricted Delivery \$

Postage

Total Postage and Fees
 \$
 \$
 \$

Sent To

Street and Apt. No., or PO Box No.
 City, State, ZIP+4®

PS Form 3800, April 2015 PSN 7530-02-000-9047

See Reverse for Instructions

MAY 31 2019

Postmark
Here

87552-9998

NADEL & GUSSMAN CAPITAN LLC
 15 E 5TH ST STE 3200
 TULSA OK 74103
 Percuss Lakewood Fed 1 Co-Mingle

7018 1830 0000 6978 6202

U.S. Postal Service™ CERTIFIED MAIL® RECEIPT

Domestic Mail Only

For delivery information, visit our website at www.usps.com®.

OFFICIAL USE

Certified Mail Fee

Extra Services & Fees (check box, add fee as appropriate)

- ☐ Return Receipt (hardcopy) \$
☐ Return Receipt (electronic) \$
☐ Certified Mail Restricted Delivery \$
☐ Adult Signature Required \$
☐ Adult Signature Restricted Delivery \$

Postage

Total Postage and Fees
 \$
 \$
 \$

Sent To

Street and Apt. No., or PO Box No.
 City, State, ZIP+4®

PS Form 3800, April 2015 PSN 7530-02-000-9047

See Reverse for Instructions

MAY 31 2019

Postmark
Here

87552-9998

NEARBURG CHARLES E
 PO BOX 823085
 DALLAS TX 75382
 Percuss Lakewood Fed 1 Co-Mingle

7018 1830 0000 6978 6189

U.S. Postal Service™ CERTIFIED MAIL® RECEIPT

Domestic Mail Only

For delivery information, visit our website at www.usps.com®.

OFFICIAL USE

Certified Mail Fee

Extra Services & Fees (check box, add fee as appropriate)

- ☐ Return Receipt (hardcopy) \$
☐ Return Receipt (electronic) \$
☐ Certified Mail Restricted Delivery \$
☐ Adult Signature Required \$
☐ Adult Signature Restricted Delivery \$

Postage

Total Postage and Fees
 \$
 \$
 \$

Sent To

Street and Apt. No., or PO Box No.
 City, State, ZIP+4®

PS Form 3800, April 2015 PSN 7530-02-000-9047

See Reverse for Instructions

MAY 31 2019

Postmark
Here

87552-9998

MRC DELAWARE RESOURCES LLC
 5400 LYNDON B JOHNSON FWY
 DALLAS TX 75240
 Percuss Lakewood Fed 1 Co-Mingle

7018 1830 0000 6978 6172

U.S. Postal Service™ CERTIFIED MAIL® RECEIPT

Domestic Mail Only

For delivery information, visit our website at www.usps.com®.

OFFICIAL USE

Certified Mail Fee

Extra Services & Fees (check box, add fee as appropriate)

- ☐ Return Receipt (hardcopy) \$
☐ Return Receipt (electronic) \$
☐ Certified Mail Restricted Delivery \$
☐ Adult Signature Required \$
☐ Adult Signature Restricted Delivery \$

Postage

Total Postage and Fees
 \$
 \$
 \$

Sent To

Street and Apt. No., or PO Box No.
 City, State, ZIP+4®

PS Form 3800, April 2015 PSN 7530-02-000-9047

See Reverse for Instructions

MAY 31 2019

Postmark
Here

87552-9998

MEWBORNE OIL CO
 PO Box 7698
 TYLER TX 75711
 Percuss Lakewood Fed 1 Co-Mingle

7018 1830 0000 6978 6332

U.S. Postal Service™ CERTIFIED MAIL® RECEIPT

Domestic Mail Only

For delivery information, visit our website at www.usps.com®.

OFFICIAL USE

Certified Mail Fee

Extra Services & Fees (check box, add fee as appropriate)

- ☐ Return Receipt (hardcopy) \$
☐ Return Receipt (electronic) \$
☐ Certified Mail Restricted Delivery \$
☐ Adult Signature Required \$
☐ Adult Signature Restricted Delivery \$

Postage

Total Postage and Fees
 \$
 \$
 \$

Sent To

Street and Apt. No., or PO Box No.
 City, State, ZIP+4®

PS Form 3800, April 2015 PSN 7530-02-000-9047

See Reverse for Instructions

MAY 31 2019

Postmark
Here

87552-9998

MARY JANE OMAN TRUST
 11508 STRAIT LN
 DALLAS TX 75229
 Percuss Lakewood Fed 1 Co-Mingle

7018 1830 0000 6978 6165

U.S. Postal Service™ CERTIFIED MAIL® RECEIPT

Domestic Mail Only

For delivery information, visit our website at www.usps.com®.

OFFICIAL USE

Certified Mail Fee

Extra Services & Fees (check box, add fee as appropriate)

- ☐ Return Receipt (hardcopy) \$
☐ Return Receipt (electronic) \$
☐ Certified Mail Restricted Delivery \$
☐ Adult Signature Required \$
☐ Adult Signature Restricted Delivery \$

Postage

Total Postage and Fees
 \$
 \$
 \$

Sent To

Street and Apt. No., or PO Box No.
 City, State, ZIP+4®

PS Form 3800, April 2015 PSN 7530-02-000-9047

See Reverse for Instructions

MAY 31 2019

Postmark
Here

87552-9998

MCCOMBS ENERGY LTD
 5599 SAN FELIPE ST # 1220
 HOUSTON TX 77056
 Percuss Lakewood Fed 1 Co-Mingle

7018 1830 0000 6978 6141

U.S. Postal Service™ CERTIFIED MAIL® RECEIPT

Domestic Mail Only

For delivery information, visit our website at www.usps.com®.

OFFICIAL USE

Certified Mail Fee

\$

Extra Services & Fees (check box, add fee as appropriate)

- ☐ Return Receipt (hardcopy) \$
- ☐ Return Receipt (electronic) \$
- ☐ Certified Mail Restricted Delivery \$
- ☐ Adult Signature Required \$
- ☐ Adult Signature Restricted Delivery \$

Postage

\$

Total Postage and Fees

\$

Sent To

Street and Apt. No., or PO Box No.

City, State, ZIP+4®

PS Form 3800, April 2015 PSN 7530-02-000-9047

See Reverse for Instructions

MAY 31 2019

Postmark
Here

7552-9998

LDH HOLDINGS LLC
PO BOX 183
NEW VERNON NJ 07976

Percuss Lakewood Fed 1 Co-Mingle

7018 1830 0000 6978 6134

U.S. Postal Service™ CERTIFIED MAIL® RECEIPT

Domestic Mail Only

For delivery information, visit our website at www.usps.com®.

OFFICIAL USE

Certified Mail Fee

\$

Extra Services & Fees (check box, add fee as appropriate)

- ☐ Return Receipt (hardcopy) \$
- ☐ Return Receipt (electronic) \$
- ☐ Certified Mail Restricted Delivery \$
- ☐ Adult Signature Required \$
- ☐ Adult Signature Restricted Delivery \$

Postage

\$

Total Postage and Fees

\$

Sent To

Street and Apt. No., or PO Box No.

City, State, ZIP+4®

PS Form 3800, April 2015 PSN 7530-02-000-9047

See Reverse for Instructions

MAY 31 2019

Postmark
Here

7552-9998

HOLSUM INC
BOX 2527
ROSWELL NM 88202

Percuss Lakewood Fed 1 Co-Mingle

7018 1830 0000 6978 6127

U.S. Postal Service™ CERTIFIED MAIL® RECEIPT

Domestic Mail Only

For delivery information, visit our website at www.usps.com®.

OFFICIAL USE

Certified Mail Fee

\$

Extra Services & Fees (check box, add fee as appropriate)

- ☐ Return Receipt (hardcopy) \$
- ☐ Return Receipt (electronic) \$
- ☐ Certified Mail Restricted Delivery \$
- ☐ Adult Signature Required \$
- ☐ Adult Signature Restricted Delivery \$

Postage

\$

Total Postage and Fees

\$

Sent To

Street and Apt. No., or PO Box No.

City, State, ZIP+4®

PS Form 3800, April 2015 PSN 7530-02-000-9047

See Reverse for Instructions

MAY 31 2019

Postmark
Here

7552-9998

HIDEAWAY PARTNERSHIP
25 HANOVER RD BLDG B
FLORHAM PARK NJ 7932

Percuss Lakewood Fed 1 Co-Mingle

7018 1830 0000 6978 6158

U.S. Postal Service™ CERTIFIED MAIL® RECEIPT

Domestic Mail Only

For delivery information, visit our website at www.usps.com®.

OFFICIAL USE

Certified Mail Fee

\$

Extra Services & Fees (check box, add fee as appropriate)

- ☐ Return Receipt (hardcopy) \$
- ☐ Return Receipt (electronic) \$
- ☐ Certified Mail Restricted Delivery \$
- ☐ Adult Signature Required \$
- ☐ Adult Signature Restricted Delivery \$

Postage

\$

Total Postage and Fees

\$

Sent To

Street and Apt. No., or PO Box No.

City, State, ZIP+4®

PS Form 3800, April 2015 PSN 7530-02-000-9047

See Reverse for Instructions

MAY 31 2019

Postmark
Here

7552-9998

LJS RESOURCES LLC
33 EAGLE NEST RD
MORRISTOWN NJ 07960

Percuss Lakewood Fed 1 Co-Mingle

7018 1830 0000 6978 6103

U.S. Postal Service™ CERTIFIED MAIL® RECEIPT

Domestic Mail Only

For delivery information, visit our website at www.usps.com®.

OFFICIAL USE

Certified Mail Fee

\$

Extra Services & Fees (check box, add fee as appropriate)

- ☐ Return Receipt (hardcopy) \$
- ☐ Return Receipt (electronic) \$
- ☐ Certified Mail Restricted Delivery \$
- ☐ Adult Signature Required \$
- ☐ Adult Signature Restricted Delivery \$

Postage

\$

Total Postage and Fees

\$

Sent To

Street and Apt. No., or PO Box No.

City, State, ZIP+4®

PS Form 3800, April 2015 PSN 7530-02-000-9047

See Reverse for Instructions

MAY 31 2019

Postmark
Here

7552-9998

CURRY FLORENCE
1800 GLENARM PL STE 200
DENVER CO 80202

Percuss Lakewood Fed 1 Co-Mingle

7018 1830 0000 6978 6110

U.S. Postal Service™ CERTIFIED MAIL® RECEIPT

Domestic Mail Only

For delivery information, visit our website at www.usps.com®.

OFFICIAL USE

Certified Mail Fee

\$

Extra Services & Fees (check box, add fee as appropriate)

- ☐ Return Receipt (hardcopy) \$
- ☐ Return Receipt (electronic) \$
- ☐ Certified Mail Restricted Delivery \$
- ☐ Adult Signature Required \$
- ☐ Adult Signature Restricted Delivery \$

Postage

\$

Total Postage and Fees

\$

Sent To

Street and Apt. No., or PO Box No.

City, State, ZIP+4®

PS Form 3800, April 2015 PSN 7530-02-000-9047

See Reverse for Instructions

MAY 31 2019

Postmark
Here

7552-9998

HEYCO DEVELOPMENT CORP
PO BOX 1933
ROSWELL NM 88201

Percuss Lakewood Fed 1 Co-Mingle

7018 1830 0000 6978 6059

U.S. Postal Service™
CERTIFIED MAIL® RECEIPT
Domestic Mail Only

For delivery information, visit our website at www.usps.com®.

OFFICIAL USE

Certified Mail Fee \$
Extra Services & Fees (check box, add fee as appropriate)
☐ Return Receipt (hardcopy) \$
☐ Return Receipt (electronic) \$
☐ Certified Mail Restricted Delivery \$
☐ Adult Signature Required \$
☐ Adult Signature Restricted Delivery \$

Postage \$
Total Postage and Fees \$
Sent To
Street and Apt. No., or PO Box No.
City, State, ZIP+4®

PS Form 3800, April 2015 PSN 7530-02-000-9047 See Reverse for Instructions

7018 1830 0000 6978 6042

U.S. Postal Service™
CERTIFIED MAIL® RECEIPT
Domestic Mail Only

For delivery information, visit our website at www.usps.com®.

OFFICIAL USE

Certified Mail Fee \$
Extra Services & Fees (check box, add fee as appropriate)
☐ Return Receipt (hardcopy) \$
☐ Return Receipt (electronic) \$
☐ Certified Mail Restricted Delivery \$
☐ Adult Signature Required \$
☐ Adult Signature Restricted Delivery \$

Postage \$
Total Postage and Fees \$
Sent To
Street and Apt. No., or PO Box No.
City, State, ZIP+4®

PS Form 3800, April 2015 PSN 7530-02-000-9047 See Reverse for Instructions

7018 1830 0000 6978 6073

U.S. Postal Service™
CERTIFIED MAIL® RECEIPT
Domestic Mail Only

For delivery information, visit our website at www.usps.com®.

OFFICIAL USE

Certified Mail Fee \$
Extra Services & Fees (check box, add fee as appropriate)
☐ Return Receipt (hardcopy) \$
☐ Return Receipt (electronic) \$
☐ Certified Mail Restricted Delivery \$
☐ Adult Signature Required \$
☐ Adult Signature Restricted Delivery \$

Postage \$
Total Postage and Fees \$
Sent To
Street and Apt. No., or PO Box No.
City, State, ZIP+4®

PS Form 3800, April 2015 PSN 7530-02-000-9047 See Reverse for Instructions

7018 1830 0000 6978 6066

U.S. Postal Service™
CERTIFIED MAIL® RECEIPT
Domestic Mail Only

For delivery information, visit our website at www.usps.com®.

OFFICIAL USE

Certified Mail Fee \$
Extra Services & Fees (check box, add fee as appropriate)
☐ Return Receipt (hardcopy) \$
☐ Return Receipt (electronic) \$
☐ Certified Mail Restricted Delivery \$
☐ Adult Signature Required \$
☐ Adult Signature Restricted Delivery \$

Postage \$
Total Postage and Fees \$
Sent To
Street and Apt. No., or PO Box No.
City, State, ZIP+4®

PS Form 3800, April 2015 PSN 7530-02-000-9047 See Reverse for Instructions

7018 1830 0000 6978 6080

U.S. Postal Service™
CERTIFIED MAIL® RECEIPT
Domestic Mail Only

For delivery information, visit our website at www.usps.com®.

OFFICIAL USE

Certified Mail Fee \$
Extra Services & Fees (check box, add fee as appropriate)
☐ Return Receipt (hardcopy) \$
☐ Return Receipt (electronic) \$
☐ Certified Mail Restricted Delivery \$
☐ Adult Signature Required \$
☐ Adult Signature Restricted Delivery \$

Postage \$
Total Postage and Fees \$
Sent To
Street and Apt. No., or PO Box No.
City, State, ZIP+4®

PS Form 3800, April 2015 PSN 7530-02-000-9047 See Reverse for Instructions

7018 1830 0000 6978 6097

U.S. Postal Service™
CERTIFIED MAIL® RECEIPT
Domestic Mail Only

For delivery information, visit our website at www.usps.com®.

OFFICIAL USE

Certified Mail Fee \$
Extra Services & Fees (check box, add fee as appropriate)
☐ Return Receipt (hardcopy) \$
☐ Return Receipt (electronic) \$
☐ Certified Mail Restricted Delivery \$
☐ Adult Signature Required \$
☐ Adult Signature Restricted Delivery \$

Postage \$
Total Postage and Fees \$
Sent To
Street and Apt. No., or PO Box No.
City, State, ZIP+4®

PS Form 3800, April 2015 PSN 7530-02-000-9047 See Reverse for Instructions