

Application

Part III

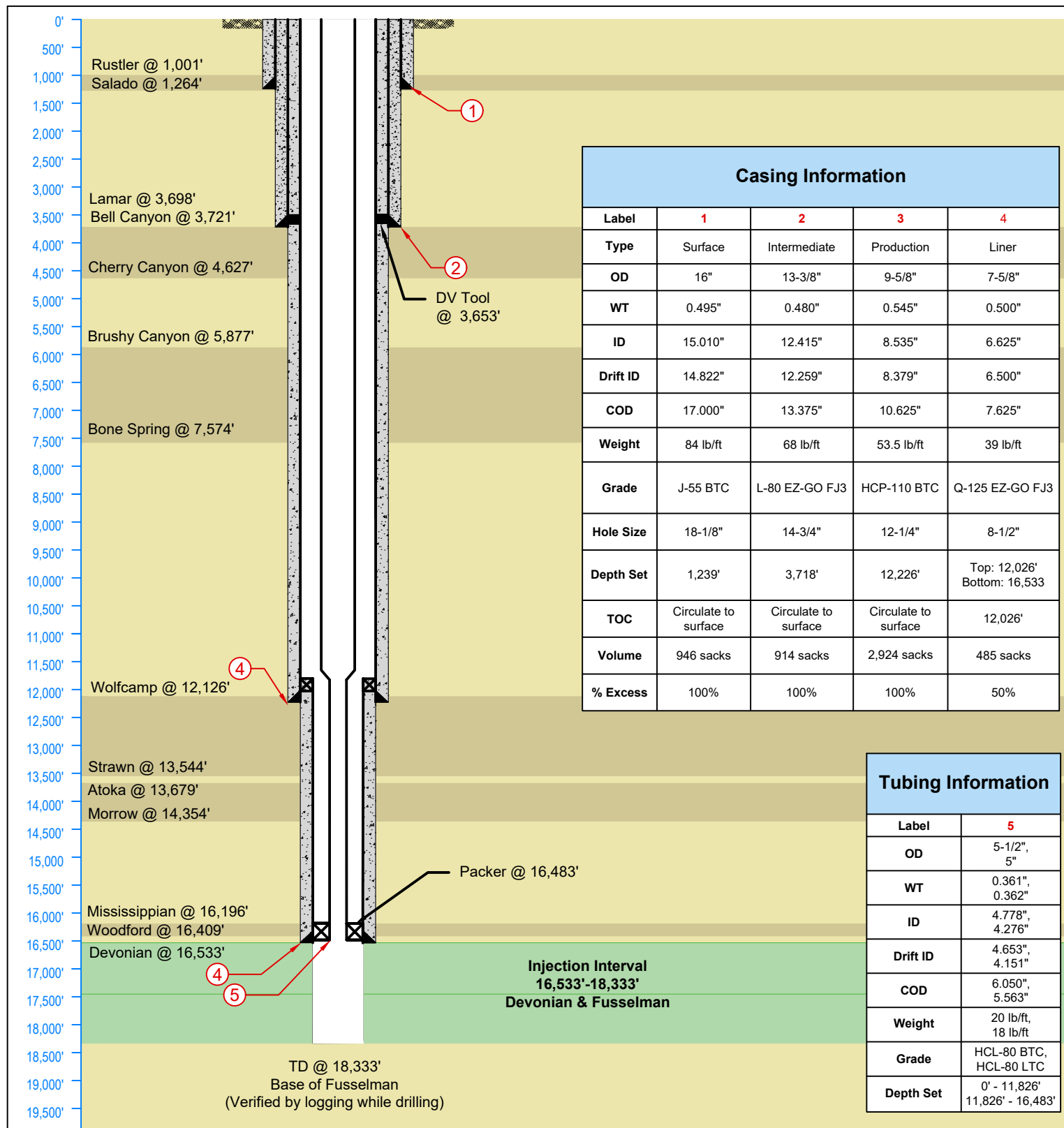

<div>LONQUIST & CO. LLC</div> <div><div>PETROLEUM ENGINEERS</div><div>ENERGY ADVISORS</div></div> <div><div>HOUSTON CALGARY</div><div>AUSTIN WICHITA DENVER</div></div>	Solaris Water Midstream, LLC		Trivette Fed SWD No. 1	
	Country: USA		State/Province: New Mexico	County/Parish: Eddy
	Location:		Site: 990' FNL & 215' FWL	Survey: S23-T26S-R30E
	API No: NA		Field: Silurian-Devonian (Code: 97869)	Well Type/Status: SWD
	Texas License F-9147		Project No: 1917	Date: 7/24/2019
12912 Hill Country Blvd. Ste F-200 Austin, Texas 78738 Tel: 512.732.9812 Fax: 512.732.9816	NMOCD District No: 2		Approved:	
	Drawn: TFM		Reviewed:	
	Rev No: 1		Notes:	

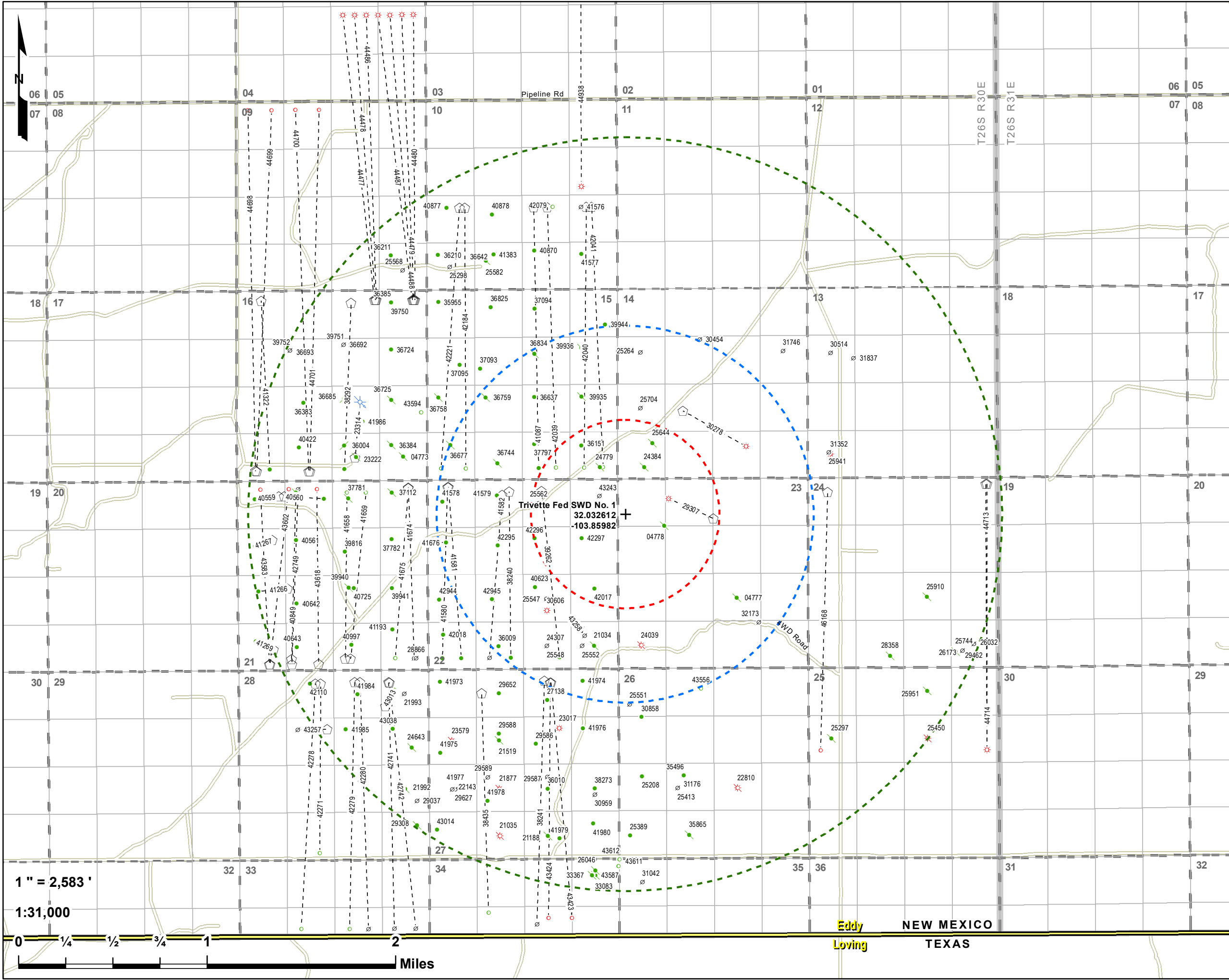

Trivette Fed SWD No. 1
2 Mile Area of Review
Solaris Water Midstream
Eddy County, NM

PCS: NAD 1983 SPCS NM-E FIPS 3001 (US Ft.)

Drawn by: SJL Date: 7/18/2019 Approved by: SLP

LONQUIST & CO. LLC

PETROLEUM
ENGINEERS

ENERGY
ADVISORS

AUSTIN • HOUSTON • CALGARY • WICHITA
DENVER • COLLEGE STATION • BATON ROUGE • EDMONTON

- + Trivette Fed SWD No. 1
- 1/2 Mile Radius
- 1 Mile Radius
- 2 Mile Radius
- QQ-Section (NM-PLSS 2nd Div.)
- Section (NM-PLSS 1st Div.)
- Township/Range (NM-PLSS)
- Counties
- States
- Laterals

API (30-015-...) SHL Status - Type (Count)

- Horizontal Surface Location (59)
- Active - Oil (66)
- Active - Gas (3)
- Permitted - Oil (7)
- Plugged (Not Released) - Oil (2)
- Plugged (Site Released) - Oil (36)
- Plugged (Site Released) - Gas (6)
- Canceled Location (34)

API (30-015-...) BHL Status - Type (Count)

- Active - Oil (14)
- Active - Gas (12)
- Permitted - Oil (12)
- Permitted - Gas (10)
- Plugged (Site Released) - Oil (1)
- Plugged (Site Released) - Salt Water Disposal (1)
- Canceled Location (9)

*Well Data Source: NM-OCD, DrillingInfo (2019)



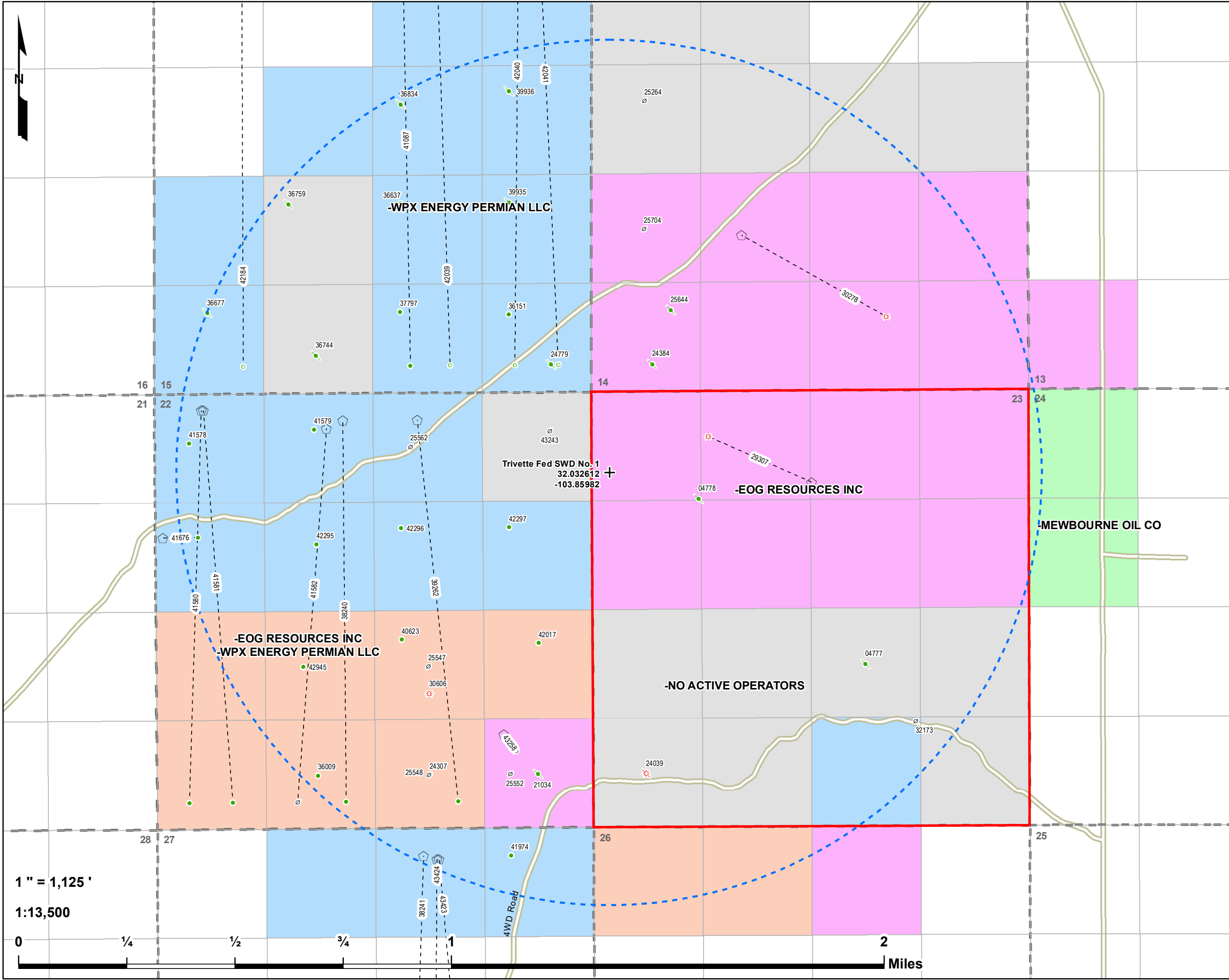

Trivette Fed SWD No. 1
1 Mile Offset Operators
Solaris Water Midstream
Eddy County, NM

PCS: NAD 1983 SPCS NM-E FIPS 3001 (US Ft.)

Drawn by: SJL | Date: 7/19/2019 | Approved by: SLP

LONQUIST & CO. LLC

PETROLEUM
ENGINEERS

ENERGY
ADVISORS

AUSTIN • HOUSTON • CALGARY • WICHITA
DENVER • COLLEGE STATION • BATON ROUGE • EDMONTON

- + Trivette Fed SWD No. 1
- 1 Mile Radius
- QQ-Section (NM-PLSS 2nd Div.)
- Section (NM-PLSS 1st Div.)
- Township/Range (T26S R30E)
- Surface Owner (BLM)
- Laterals

API (30-015-...) SHL Status - Type (Count)

- Horizontal Surface Location (17)
- Active - Oil (14)
- Active - Gas (1)
- Plugged (Site Released) - Oil (12)
- Plugged (Site Released) - Gas (1)
- Canceled Location (8)

API (30-015-...) BHL Status - Type (Count)

- Active - Oil (6)
- Active - Gas (2)
- Permitted - Oil (4)
- Permitted - Gas (2)
- Canceled Location (3)

Operators

- EOG RESOURCES INC
- EOG RESOURCES INC; WPX ENERGY PERMIAN LLC
- MEWBOURNE OIL CO
- WPX ENERGY PERMIAN LLC
- NO ACTIVE OPERATORS

*Well Data Source: NM-OCD, DrillingInfo (2019)



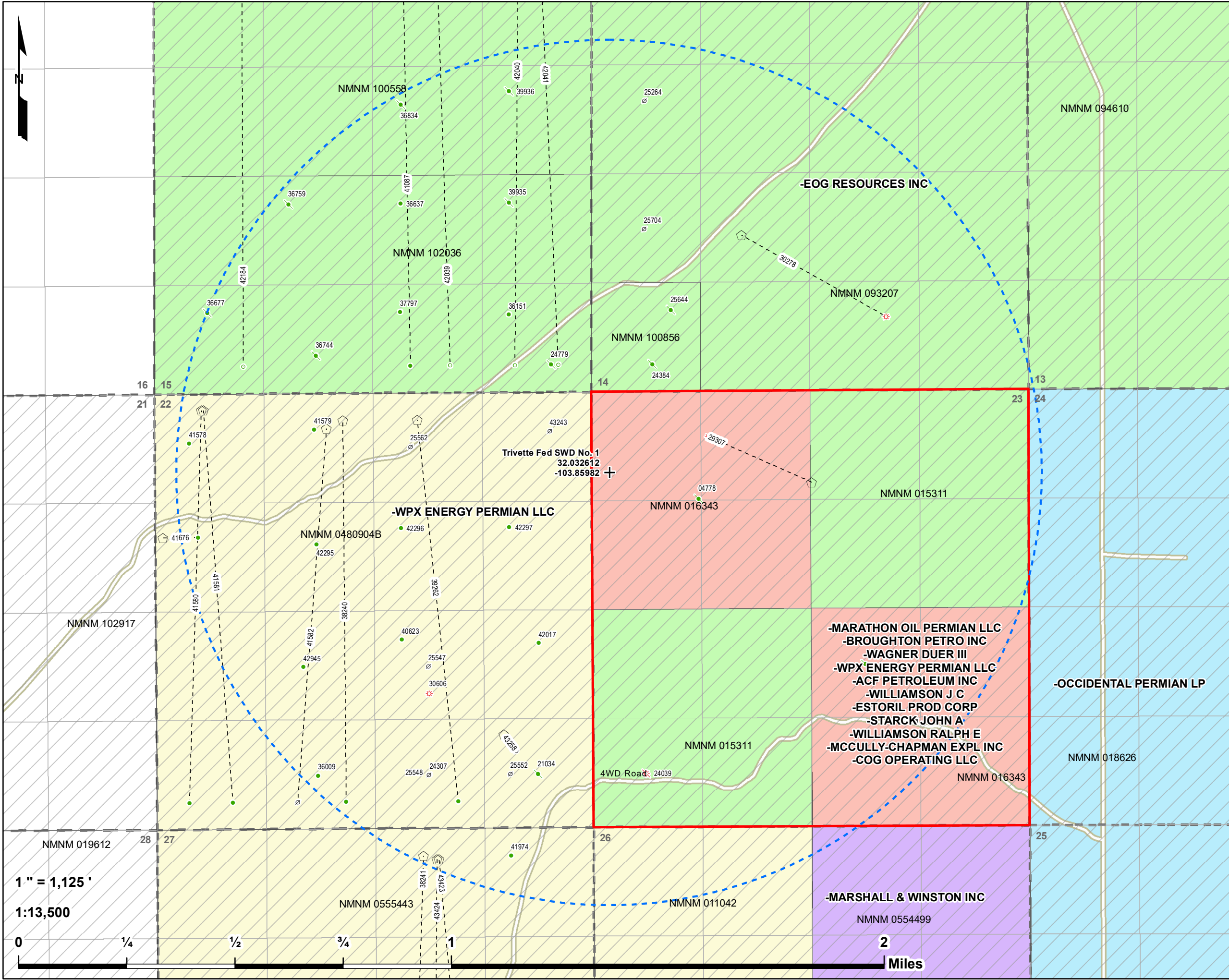

Trivette Fed SWD No. 1
1 Mile Offset Lessees
Solaris Water Midstream
Eddy County, NM

PCS: NAD 1983 SPCS NM-E FIPS 3001 (US Ft.)

Drawn by: SJL Date: 7/19/2019 Approved by: SLP

LONQUIST & CO. LLC

PETROLEUM ENGINEERS ENERGY ADVISORS

AUSTIN • HOUSTON CALGARY • WICHITA
DENVER • COLLEGE STATION BATON ROUGE • EDMONTON

- + Trivette Fed SWD No. 1
 - 1 Mile Radius
 - QQ-Section (NM-PLSS 2nd Div.)
 - Section (NM-PLSS 1st Div.)
 - Township/Range (T26S R30E)
 - Surface Owner (BLM)
 - NM - BLM (O&G Leases)
 - Laterals
- API (30-015-...) SHL Status - Type (Count)**
- Horizontal Surface Location (17)
 - Active - Oil (14)
 - Active - Gas (1)
 - Plugged (Site Released) - Oil (12)
 - Plugged (Site Released) - Gas (1)
 - Canceled Location (8)
- API (30-015-...) BHL Status - Type (Count)**
- Active - Oil (6)
 - Active - Gas (2)
 - Permitted - Oil (4)
 - Permitted - Gas (2)
 - Canceled Location (3)
- Lessees**
- EOG RESOURCES INC
 - MARATHON OIL PERMIAN LLC; -BROUGHTON PETRO INC; -WAGNER DUER III; -WPX ENERGY PERMIAN LLC; -ACF PETROLEUM INC; -WILLIAMSON J C; -ESTORIL PROD CORP; -STARCK JOHN A; -WILLIAMSON RALPH E; -MCCULLY-CHAPMAN EXPL INC; -COG OPERATING LLC
 - MARSHALL & WINSTON INC
 - OCCIDENTAL PERMIAN LP
 - WPX ENERGY PERMIAN LLC

*Well Data Source: NM-OCD, DrillingInfo (2019)



Trivette Fed SWD No. 1
1 Mile Area of Review List

API (30-015-...)	WELL NAME	WELL TYPE	STATUS	OPERATOR	TVD (FT.)	LATITUDE (NAD83 DD)	LONGITUDE (NAD83 DD)	SPUD DATE	FIELD
04777	KING #001	O	P	BARNETT OIL DEV	NR	32.0261421000	-103.849769600	NR	NR
04778	MCCALISTER #001	O	P	LOCKHART & CO	NR	32.03170390	-103.85630040	NR	NR
21034	MCCARVER-FEDERAL #001	O	P	WILLIAMSON UNDERWOOD	265	32.02250290	-103.86267090	12/6/1973	WILDCAT
24039	EL PASO 23 FEDERAL #001	G	P	EOG RESOURCES INC	12820	32.0225067000	-103.858406100	1/24/1982	[84330] ROSS DRAW, WOLFCAMP (G) (ABOLISH)
24307	ROSS DRAW UNIT #011	O	A	WPX Energy Permian, LLC	6896	32.02249910	-103.86692810	10/15/1985	[52795] ROSS DRAW, DELAWARE, EAST
24384	SUN EX FEDERAL UNIT #002	O	P	J C WILLIAMSON	6226	32.03623580	-103.85810850	1/19/1983	[52797] ROSS DRAW, DELAWARE, NORTH
24779	SUN EX FEDERAL #003P	O	P	WPX Energy Permian, LLC	6885	32.0362318307	-103.862079429	2/27/1984	[52797] ROSS DRAW, DELAWARE, NORTH
25264	SUN EX FEDERAL UNIT #005	O	C	J C WILLIAMSON	0	32.0450725078	-103.858367463	-	
25547	ROSS DRAW UNIT #017	O	C	J C WILLIAMSON	0	32.02613028	-103.86696845	-	
25548	ROSS DRAW UNIT #018	O	C	J C WILLIAMSON	0	32.02250165	-103.86695967	-	
25552	ROSS DRAW UNIT #022	O	C	J C WILLIAMSON	0	32.0225062395	-103.863749576	-	
25562	ROSS DRAW UNIT #021	O	C	J C WILLIAMSON	0	32.03349883	-103.86763495	-	
25644	SUN EX FEDERAL UNIT #002	O	P	J C WILLIAMSON	6250	32.0380516000	-103.857360800	12/13/1986	[52797] ROSS DRAW, DELAWARE, NORTH
25704	SUN EX FEDERAL UNIT #004	O	C	J C WILLIAMSON	0	32.04077456	-103.85839518	-	
29307	EL PASO 23 FEDERAL #002	G	A	EOG RESOURCES INC	13415	32.0322609000	-103.851852400	12/9/1997	[84330] ROSS DRAW, WOLFCAMP (G) (ABOLISH); [98220] PURPLE SAGE, WOLFCAMP (GAS)
30278	EL PASO 14 FEDERAL #001	G	A	EOG RESOURCES INC	12258	32.0405579000	-103.854568500	7/31/1998	[84330] ROSS DRAW, WOLFCAMP (G) (ABOLISH); [98220] PURPLE SAGE, WOLFCAMP (GAS)
30606	ROSS DRAW UNIT #021	G	A	EOG RESOURCES INC	12820	32.0252190000	-103.866935700	4/17/1999	[84330] ROSS DRAW, WOLFCAMP (G) (ABOLISH); [98220] PURPLE SAGE, WOLFCAMP (GAS)
32173	EL PASO 23 FEDERAL #003	G	C	EOG RESOURCES INC	0	32.02422293	-103.84779332	-	
36009	ROSS DRAW UNIT #029	O	A	WPX Energy Permian, LLC	5955	32.02249150	-103.87132260	1/12/2008	[52790] ROSS DRAW, DELAWARE
36151	RDX 15 #002	O	A	WPX Energy Permian, LLC	8470	32.0379295000	-103.863746600	3/19/2008	[8090] BRUSHY DRAW, DELAWARE, EAST; [52797] ROSS DRAW, DELAWARE, NORTH
36637	RDX 15 #003	O	A	WPX Energy Permian, LLC	7619	32.04166030	-103.86798860	12/11/2011	[52797] ROSS DRAW, DELAWARE, NORTH; [96403] WILDCAT, BONE SPRING
36677	RDX 15 #006	O	P	WPX Energy Permian, LLC	7330	32.03801350	-103.87561040	9/11/2009	[8090] BRUSHY DRAW, DELAWARE, EAST
36744	RDX 15 #005	O	P	WPX Energy Permian, LLC	7367	32.0365677000	-103.871353100	2/23/2011	[52790] ROSS DRAW, DELAWARE; [52797] ROSS DRAW, DELAWARE, NORTH
36759	RDX 15 #007	O	P	WPX Energy Permian, LLC	7376	32.04165270	-103.87240600	1/7/2011	[8090] BRUSHY DRAW, DELAWARE, EAST; [96403] WILDCAT, BONE SPRING
36834	RDX 15 #013	O	P	WPX Energy Permian, LLC	7610	32.0449867000	-103.867965700	4/4/2012	[8090] BRUSHY DRAW, DELAWARE, EAST; [96403] WILDCAT, BONE SPRING
37797	RDX 15 #004	O	A	WPX Energy Permian, LLC	7325	32.03803250	-103.86801150	7/27/2010	[52797] ROSS DRAW, DELAWARE, NORTH
38240	ROSS DRAW UNIT #075H	O	A	WPX Energy Permian, LLC	8400	32.03439710	-103.87029270	10/30/2010	[84300] ROSS DRAW, BONE SPRINGS (GAS); [97863] WILDCAT G-03 S263016K, BONE SPRING
38241	RDU 27 FEDERAL #001H	O	C	WPX Energy Permian, LLC	0	32.0197754000	-103.867187500	-	[84300] ROSS DRAW, BONE SPRINGS (GAS)
39262	ROSS DRAW UNIT #076H	O	A	WPX Energy Permian, LLC	7696	32.03440480	-103.86736300	8/9/2011	[97863] WILDCAT G-03 S263016K, BONE SPRING
39935	RDX 15 #014	O	P	WPX Energy Permian, LLC	7640	32.04166790	-103.86372380	5/21/2012	[52797] ROSS DRAW, DELAWARE, NORTH
39936	RDX 15 #015	O	P	WPX Energy Permian, LLC	7657	32.0454102000	-103.863700900	6/13/2012	[52797] ROSS DRAW, DELAWARE, NORTH
40623	ROSS DRAW UNIT #033	O	A	WPX Energy Permian, LLC	7525	32.02703480	-103.86800380	10/27/2014	[52795] ROSS DRAW, DELAWARE, EAST
41087	RDX FED COM 10 #005H	O	A	WPX Energy Permian, LLC	13347	32.05628970	-103.86795810	3/15/2013	[13354] CORRAL CANYON, BONE SPRING, SOUTH
41578	ROSS DRAW UNIT #034	O	A	WPX Energy Permian, LLC	7500	32.03364180	-103.87634280	9/17/2013	[8090] BRUSHY DRAW, DELAWARE, EAST
41579	ROSS DRAW UNIT #035	O	A	WPX Energy Permian, LLC	7538	32.03409190	-103.87142180	1/5/2014	[8090] BRUSHY DRAW, DELAWARE, EAST
41580	ROSS DRAW UNIT #044H	O	A	WPX Energy Permian, LLC	7705	32.03474430	-103.87586210	9/28/2013	[97863] WILDCAT G-03 S263016K, BONE SPRING
41581	ROSS DRAW UNIT #047H	O	A	WPX Energy Permian, LLC	8096	32.03475190	-103.87577820	10/22/2013	[97863] WILDCAT G-03 S263016K, BONE SPRING
41582	ROSS DRAW UNIT #048H	O	C	WPX Energy Permian, LLC	0	32.0341225000	-103.870933500	-	[97863] WILDCAT G-03 S263016K, BONE SPRING
41676	ROSS DRAW UNIT #037	O	A	WPX Energy Permian, LLC	7512	32.03047940	-103.87739560	12/19/2013	[97863] WILDCAT G-03 S263016K, BONE SPRING
41974	ROSS DRAW UNIT #053	O	A	WPX Energy Permian, LLC	7549	32.01977920	-103.86373140	3/18/2014	[52795] ROSS DRAW, DELAWARE, EAST
42017	ROSS DRAW UNIT #043	O	A	WPX Energy Permian, LLC	7550	32.0269012000	-103.862617500	11/26/2014	[52795] ROSS DRAW, DELAWARE, EAST
42039	RDX FED COM 10 #011H	O	N	WPX Energy Permian, LLC	0	32.05628970	-103.86672970	-	[97863] WILDCAT G-03 S263016K, BONE SPRING
42040	RDX FED COM 10 #013H	O	N	WPX Energy Permian, LLC	0	32.05630110	-103.86321260	-	[97863] WILDCAT G-03 S263016K, BONE SPRING
42041	RDX FED COM 10 #014H	O	N	WPX Energy Permian, LLC	0	32.05630110	-103.86272430	-	[97863] WILDCAT G-03 S263016K, BONE SPRING
42184	RDX FED COM 10 #010H	O	N	WPX Energy Permian, LLC	0	32.0562706000	-103.874198900	-	[97863] WILDCAT G-03 S263016K, BONE SPRING
42295	ROSS DRAW UNIT #038	O	A	WPX Energy Permian, LLC	7408	32.03024290	-103.87134550	6/4/2014	[52795] ROSS DRAW, DELAWARE, EAST
42296	ROSS DRAW UNIT #039	O	A	WPX Energy Permian, LLC	7506	32.03077320	-103.86801910	6/21/2014	[52795] ROSS DRAW, DELAWARE, EAST
42297	ROSS DRAW UNIT #040	O	A	WPX Energy Permian, LLC	7588	32.03078080	-103.86375430	11/11/2014	[52795] ROSS DRAW, DELAWARE, EAST
42945	ROSS DRAW UNIT #042	O	A	WPX Energy Permian, LLC	7520	32.0261233080	-103.871885100	3/8/2015	[52795] ROSS DRAW, DELAWARE, EAST
43243	ROSS DRAW UNIT #036	O	C	WPX Energy Permian, LLC	0	32.0340075000	-103.862153400	-	[52795] ROSS DRAW, DELAWARE, EAST
43258	ROSS DRAW UNIT #046	O	C	WPX Energy Permian, LLC	0	32.02737104	-103.86353170	-	[52795] ROSS DRAW, DELAWARE, EAST
43423	ROSS DRAW UNIT #068H	G	N	WPX Energy Permian, LLC	0	32.01966530	-103.86657060	-	[84330] ROSS DRAW, WOLFCAMP (G) (ABOLISH); [98220] PURPLE SAGE, WOLFCAMP (GAS)
43424	ROSS DRAW UNIT #067H	G	N	WPX Energy Permian, LLC	0	32.01966500	-103.86665620	-	[84330] ROSS DRAW, WOLFCAMP (G) (ABOLISH); [98220] PURPLE SAGE, WOLFCAMP (GAS)

Trivette Fed SWD No. 1
1 Mile Offset Operators and Lessees List

S/T/R	QQ UNIT LETTER(S)	OPERATOR	MINERAL LESSEE	MINERAL OWNER	SURFACE OWNER	ADDRESS 1	ADDRESS 2
15/26S/30E	A,B,F,G,H,I,J,L,M,O,P	WPX ENERGY PERMIAN LLC	-	-	-	3500 ONE WILLIAMS CENTER	TULSA, OK 74172
	K,N	-	EOG RESOURCES INC	-	-	PO BOX 4362	HOUSTON, TX 77210
			<u>Operating Rights on BLM Lease NMNM 102036:</u>				
			WPX ENERGY PERMIAN LLC	-	-	3500 ONE WILLIAMS CENTER	TULSA, OK 74172
14/26S/30E	I,J,K,L,M,N,O,P	EOG RESOURCES INC	-	-	-	PO BOX 2267	MIDLAND, TX 79702
	C,D,E,F,G,H	-	EOG RESOURCES INC	-	-	PO BOX 4362	HOUSTON, TX 77210
13/26S/30E	M	EOG RESOURCES INC	-	-	-	PO BOX 2267	MIDLAND, TX 79702
24/26S/30E	D,E	MEWBOURNE OIL CO	-	-	-	PO BOX 5270	HOBBS, NM 88241
23/26S/30E	A,B,C,D,E,F,G,H	EOG RESOURCES INC	-	-	-	PO BOX 2267	MIDLAND, TX 79702
	O	WPX ENERGY PERMIAN LLC	-	-	-	3500 ONE WILLIAMS CENTER	TULSA, OK 74172
	K,L,M,N	-	EOG RESOURCES INC	-	-	PO BOX 4362	HOUSTON, TX 77210
	I,J,P	-	MARATHON OIL PERMIAN LLC	-	-	5555 SAN FELIPE ST	HOUSTON, TX 77056
			BROUGHTON PETRO INC	-	-	13 TOWNHOUSE CT	BELLAIRE, TX 77401
			WAGNER DUER III	-	-	301 COMMERCE ST #2930	FORT WORTH, TX 76102
			WPX ENERGY PERMIAN LLC	-	-	3500 ONE WILLIAMS CENTER	TULSA, OK 74172
			ACF PETROLEUM INC	-	-	400 W TEXAS AVE	MIDLAND, TX 79701
			WILLIAMSON J C	-	-	PO BOX 16	MIDLAND, TX 79702
			ESTORIL PROD CORP	-	-	400 W TEXAS AVE	MIDLAND, TX 79701
			STARCK JOHN A	-	-	PO BOX 10886	MIDLAND, TX 79702
			WILLIAMSON RALPH E	-	-	BOX 994	MIDLAND, TX 79702
			MCCULLY-CHAPMAN EXPL INC	-	-	PO BOX 421	SEALY, TX 77474
			COG OPERATING LLC	-	-	600 W ILLINOIS AVE	MIDLAND, TX 79701
			<u>Operating Rights on BLM Lease NMNM 016343:</u>				
			EOG RESOURCES INC	-	-	PO BOX 4362	HOUSTON, TX 77210
			KERRY PETROLEUM CO	-	-	500 W TEXAS #1450	MIDLAND, TX 79701
			TRAINER C W	-	-	PO BOX 3788	MIDLAND, TX 79702
			WIGGINS CHARLES R	-	-	BOX 10862	MIDLAND, TX 79702
			WILLIAMS LOIS G	-	-	PO BOX 16	MIDLAND, TX 79701
			MARSHALL & WINSTON INC	-	-	PO BOX 50880	MIDLAND, TX 79710
			DOMINION OK TX EXPL & PROD INC	-	-	14000 QUAIL SPGS PKY #600	OKLAHOMA CITY, OK 73134
			COSTILLA ENERGY	-	-	PO BOX 10369	MIDLAND, TX 79702
			BURLINGTON RES OIL & GAS CO LP	-	-	PO BOX 51810	MIDLAND, TX 79710
22/26S/30E	B,C,D,E,F,G,H	WPX ENERGY PERMIAN LLC	-	-	-	3500 ONE WILLIAMS CENTER	TULSA, OK 74172
	I,J,K,L,M,N,O	WPX ENERGY PERMIAN LLC	-	-	-	3500 ONE WILLIAMS CENTER	TULSA, OK 74172
		EOG RESOURCES INC	-	-	-	PO BOX 2267	MIDLAND, TX 79702
	P	EOG RESOURCES INC	-	-	-	PO BOX 2267	MIDLAND, TX 79702
	A	-	WPX ENERGY PERMIAN LLC	-	-	3500 ONE WILLIAMS CENTER	TULSA, OK 74172
			<u>Operating Rights on BLM Lease NMNM 0480904B:</u>				
			WILLIAMSON J C	-	-	PO BOX 16	MIDLAND, TX 79702
			EOG RESOURCES INC	-	-	PO BOX 4362	HOUSTON, TX 77210
			WILLIAMSON CHARLOTTE	-	-	BOX 50410	AUSTIN, TX 78763
			WILLIAMSON RALPH E	-	-	BOX 994	MIDLAND, TX 79702
			DOMINION OK TX EXPL & PROD INC	-	-	14000 QUAIL SPGS PKY #600	OKLAHOMA CITY, OK 73134
			COSTILLA ENERGY	-	-	PO BOX 10369	MIDLAND, TX 79702
			ICA ENERGY INC	-	-	PO BOX 233	ODESSA, TX 79760
			K P ACQUISITION CORP	-	-	2040 MURRAY HOLLADAY	SALT LAKE CITY, UT 84117
27/26S/30E	A,B,C	WPX ENERGY PERMIAN LLC	-	-	-	3500 ONE WILLIAMS CENTER	TULSA, OK 74172
26/26S/30E	B	EOG RESOURCES INC	-	-	-	PO BOX 2267	MIDLAND, TX 79702
	C,D	EOG RESOURCES INC	-	-	-	PO BOX 2267	MIDLAND, TX 79702
		WPX ENERGY PERMIAN LLC	-	-	-	3500 ONE WILLIAMS CENTER	TULSA, OK 74172
Surface Location	-	-	-	-	BUREAU OF LAND MANAGEMENT	301 DINOSAUR TRAIL	SANTA FE, NM 87508

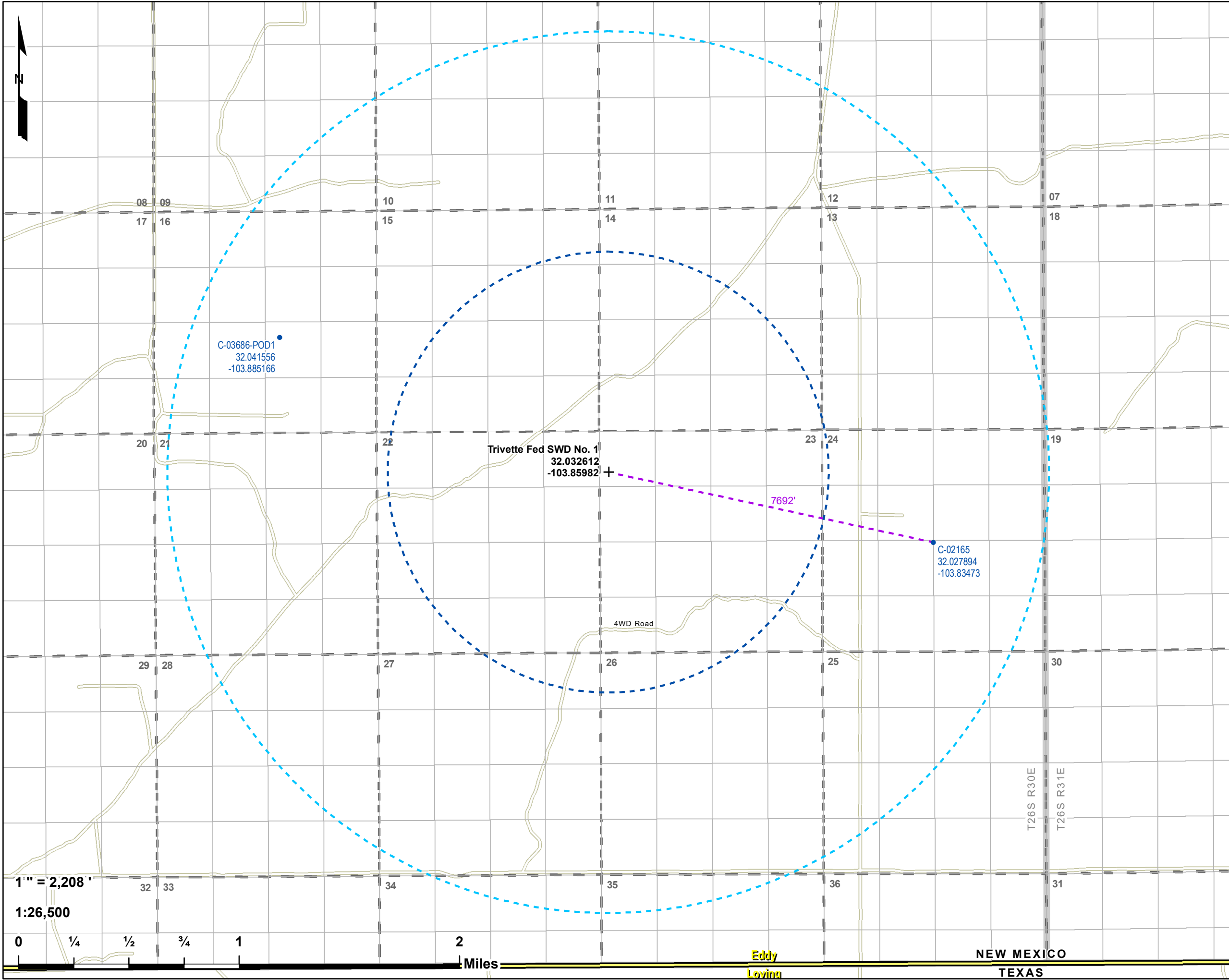

Trivette Fed SWD No. 1
2 Mile Offset Water Wells
Solaris Water Midstream
Eddy County, NM

PCS: NAD 1983 SPCS NM-E FIPS 3001 (US Ft.)

Drawn by: SJL | Date: 7/19/2019 | Approved by: SLP

LONQUIST & CO. LLC

PETROLEUM
ENGINEERS

ENERGY
ADVISORS

AUSTIN • HOUSTON | CALGARY • WICHITA
DENVER • COLLEGE STATION | BATON ROUGE • EDMONTON

+ Trivette Fed SWD No. 1

• Water Wells (2)

- - - Distance Call

- - - 1 Mile Radius

- - - 2 Mile Radius

□ QQ-Section (NM-PLSS 2nd Div.)

- - - Section (NM-PLSS 1st Div.)

▬ Township/Range (NM-PLSS)

▭ Counties

▭ States

*Well Data Source: NM-OCD, DrillingInfo (2019)



Trivette Fed SWD No. 1 Offsetting Produced Water Analysis																			
Well Name	API	Section	Township	Range	Unit	County	Field	Formation	ph	tds_mgL	sodium_mgL	calcium_mgL	iron_mgL	magnesium_mgL	manganese_mgL	chloride_mgL	bicarbonate_mgL	sulfate_mgL	co2_mgL
USA #001	3001504776	20	26S	30E	E	EDDY		DELAWARE		159967						97900	137	1100	
E D WHITE FEDERAL NCT 1 #003	3001505886	26	26S	31E	D	EDDY	MASON NORTH	DELAWARE		21212						132100	195	425	
NORTH EL MAR UNIT #022	3002508278	25	26S	32E	J	LEA	EL MAR	DELAWARE		244815						153500	88	220	
HOPI FEDERAL #001	3001529367	1	25S	28E	F	EDDY	WILLOW LAKE	DELAWARE	6.2	301207	109024	25348.9	34.713	2749.51	221998	74.4534	84.987		
HOPI FEDERAL #002	3001530754	1	25S	28E	C	EDDY		DELAWARE	5.9	289700	104602	23783.6	45.334	2914.5	212544	49.5095	508.218		
NORTH EL MAR UNIT #028	3002508296	26	26S	32E	L	LEA	EL MAR	DELAWARE		249479						156000	976	373	
NORTH EL MAR UNIT #045	3002508308	35	26S	32E	A	LEA	EL MAR	DELAWARE		255115						160000	85	310	
CONTINENTAL FED #002	3001510172	20	25S	30E	L	EDDY	CORRAL CANYON	DELAWARE		157068						97030	68	510	
R & B FED FED A #001	3001504752	17	25S	30E	D	EDDY	CORRAL CANYON	DELAWARE	7	146809						89710	24	346	
BENNETT FEDERAL #001	3001524071	30	25S	30E	D	EDDY	CORRAL CANYON SOUTH	DELAWARE	6	103300	53495	3120	10	3080		97000	100		
HOPP FED #001	3001504738	4	25S	30E	M	EDDY		DELAWARE		180137						110500	232	1199	
R AND B FEDERAL #001Y	3001504753	17	25S	30E	D	EDDY	CORRAL CANYON	DELAWARE		146130						89700	24	346	
CONTINENTAL FEDERAL #001	3001510048	20	25S	30E	D	EDDY	CORRAL CANYON	DELAWARE		193989						119700	82	1446	
SUPERIOR STATE #002	3001510181	8	25S	30E	J	EDDY	CORRAL CANYON	DELAWARE		150830									
COTTON DRAW UNIT #161H	3001538433	2	25S	31E	D	EDDY		DELAWARE-BRUSHY CANYON	6.5	257515.5	74122.9	16699.4	79.5	2736.1		160663.2		359.4	400
COTTON DRAW 13 FEDERAL #001H	3001540385	13	25S	31E	M	EDDY		DELAWARE-BRUSHY CANYON	6.7	239818.3	72792.6	12750.4	110.8	2141.6		149091.1		595.6	400
COTTON DRAW UNIT #172H	3001542426	1	25S	31E	D	EDDY		DELAWARE-BRUSHY CANYON	6.3	245565.5	71987.8	15105.6	76.4	2475.6		153168.3		545.1	400
COTTON DRAW UNIT #173H	3001542515	1	25S	31E	P	EDDY		DELAWARE-BRUSHY CANYON	6.5	240893.6	69999.9	13540.5	54	2248.5		152475.6		600.8	300
COTTON DRAW 10 FEDERAL.COM #002H	3001539230	10	25S	31E	A	EDDY		DELAWARE-BRUSHY CANYON	7.4	254959.9	79764.6		35	2265	2.5	156140	48.8	351	20
COTTON DRAW UNIT #153H	3001538535	3	25S	31E	B	EDDY		DELAWARE-BRUSHY CANYON	6.7	271580.1	82640	18493	103	3404	5	163110	219.6	286	30
COTTON DRAW 11 FEDERAL #002H	3001539375	11	25S	31E	C	EDDY		DELAWARE-BRUSHY CANYON	6.3	249141.5	73945	14492	45	2514	2.5	155100	122	0	250
COTTON DRAW UNIT #162H	3001539730	11	25S	31E	M	EDDY		DELAWARE-BRUSHY CANYON	6.2	247108.5	74025	13425	76	2423	4.5	154200	122	0	300
SNAPPING 2 STATE #013H	3001542113	2	26S	31E	N	EDDY		BONE SPRING 3RD SAND	6.8	91289.1	28721.3	3440.7	16.3	437.4		56957.4		327.9	150
SNAPPING 10 FEDERAL #005H	3001540994	10	26S	31E	P	EDDY		BONE SPRING 2ND SAND	6.6	138376	44458.5	6280.8	29.7	781.3	0	84470	122	618	20
SNAPPING 10 FEDERAL #003H	3001539866	10	26S	31E	N	EDDY		BONE SPRING 2ND SAND	6.5	152439.2	48495.7	6731.3	29.1	801.4	1.06	94055	244	0	100
ODIE 4 STATE #001H	3001541311	4	25S	28E	M	EDDY		BONE SPRING 2ND SAND	6.2	190675.4	57102	10650	45	1414	1.3	119078	93.1	17	252
NERMAL 4 STATE #001H	3001541239	4	25S	28E	C	EDDY		BONE SPRING 2ND SAND	7.4	208311.9	67903	12598	31	1592	1.5	123723	61	1.7	260
POOKY 4 STATE #001H	3001541241	4	25S	28E	A	EDDY		BONE SPRING 2ND SAND	7	204576.5	63037.2	12091.9	28.2	1510.7	1.6	125493	48.8	0	0
COTTON DRAW UNIT #219H	3001541363	2	25S	31E	P	EDDY		BONE SPRING 2ND SAND	6.4	154900.7	46690.1	7728.7	132	945.5	1.78	97130.8	183	0	200
COTTON DRAW UNIT #220H	3001541364	2	25S	31E	P	EDDY		BONE SPRING 2ND SAND	6.2	151722	47168.6	7450	48.1	989.6	1.1	93392.1	122	1116.7	200
COTTON DRAW 10 FEDERAL.COM #003H	3001542126	10	25S	31E	A	EDDY		BONE SPRING 2ND SAND	6.2	166762.2	50511.3	8741.5	34.9	1113.3	1.09	104123.2	122	0	150
COTTON DRAW 10 FEDERAL.COM #003H	3001542126	10	25S	31E	A	EDDY		BONE SPRING 2ND SAND	6.2	166972	50511.3	8741.5	34.9	1113.3	1.1	104123.2	122	698.3	150
COTTON DRAW 10 FEDERAL.COM #004H	3001542127	10	25S	31E	A	EDDY		BONE SPRING 2ND SAND	6	157444	48594.2	8080.1	33.4	1039.4	1	97266	122	767.5	150
COTTON DRAW 15 FED.COM #002H	3001540748	15	25S	31E	B	EDDY		BONE SPRING 2ND SAND	6.9	158206.7	48491.4	7898.9	47.9	982.5	1.19	98665.6	122	0	200
COTTON DRAW UNIT #202H	3001541437	2	25S	31E	M	EDDY		BONE SPRING 2ND SAND	6.9	149970.4	47221.1	7739.3	48.6	945.9	1.39	91736.6	188	0	200
COTTON DRAW 14 FED.COM #001H	3001542091	14	25S	31E	D	EDDY		BONE SPRING 2ND SAND	6.4	155557.8	47632.8	7833.6	31.4	950.8	0	96870.5	122	0	200
COTTON DRAW 14 FED.COM #002H	3001542092	14	25S	31E	D	EDDY		BONE SPRING 2ND SAND	6.2	154868.7	48183	8015.7	36	979.9	1.07	95447.5	122	0	200
COTTON DRAW 10 FEDERAL.COM #003H	3001542126	10	25S	31E	A	EDDY		BONE SPRING 2ND SAND	6.8	156876.4	47995.3	8167.1	46.9	1037.2	1.26	97409	152	0	200
COTTON DRAW 10 FEDERAL.COM #004H	3001542127	10	25S	31E	A	EDDY		BONE SPRING 2ND SAND	6.5	158125.7	48703.1	8121.1	37.1	1022.8	1.06	98100	122	0	200
COTTON DRAW UNIT #216H	3001542317	3	25S	31E	D	EDDY		BONE SPRING 2ND SAND	6.5	151149.4	46958.4	7753.9	38.7	968.6	0	93214.4	122	0	200
COTTON DRAW UNIT #217H	3001542318	3	25S	31E	D	EDDY		BONE SPRING 2ND SAND	6.5	150344.4	46535.7	7533.5	36	943.7	0	93134.6	122	0	200
COTTON DRAW 14 FEDERAL #003H	3001542504	14	25S	31E	A	EDDY		BONE SPRING 2ND SAND	6.8	149342.5	46864.9	7735.5	34.3	953.9	1.08	91392.5	244	0	200
COTTON DRAW 14 FEDERAL #004H	3001542505	14	25S	31E	A	EDDY		BONE SPRING 2ND SAND	6.8	148867.1	46832	7781.8	31.8	940.8	1.03	91091.9	144	0	200
COTTON DRAW UNIT #222H	3001542513	1	25S	31E	N	EDDY		BONE SPRING 2ND SAND	7.1	145420.8	45961.8	7771.4	35	973.4	1.29	88433.1	144	0	200
COTTON DRAW UNIT #221H	3001542514	1	25S	31E	N	EDDY		BONE SPRING 2ND SAND	7.1	145160.9	44866.9	7892.4	36	972.6	1.25	89011.8	244	0	200
SNAPPING 2 STATE #014H	3001542688	2	26S	31E	P	EDDY		WOLFCAMP	7.3	81366.4	26319.4	2687.4	26.1	326.7		50281.2		399.7	100
SIGNAL ST #002	3001502520	28	25S	28E	N	EDDY		MORROW		102849									
GOVERNMENT 134 #001	3001500076	12	26S	24E	H	EDDY	WASHINGTON RANCH	MORROW		2009						40	73	1320	
SNAPPING 10 FEDERAL #001H	3001537899	10	26S	31E	B	EDDY		AVALON UPPER	6.5	199638.8	68948.2	7560.4	111.2	1522.8	2.19	118195	732	0	500
SNAPPING 11 FEDERAL #001H	3001538193	11	26S	31E	N	EDDY		AVALON UPPER	6.1	225189.8	77010.7	8743.8	636.1	1649.2	6.75	134075	366	0	300
SNAPPING 2 STATE #003H	3001539036	2	26S	31E	M	EDDY		AVALON UPPER	6.1	223019	76001.7	10437.8	209.9	1922.4	4.5	131072	366	632	1100
SNAPPING 2 STATE #006H	3001539162	2	26S	31E	D	EDDY		AVALON UPPER	6.5	179788.5	71575.7	617.4	21.8	109.6	0	101374	3660	0	500
COOTER 16 STATE #001H	3001537625	16	25S	29E	N	EDDY		AVALON UPPER	7	208453.6	79520.3	498	28	162	0.4	121800	3208.4	1994	990
COOTER 16 STATE #002H	3001537626	16	25S	29E	M	EDDY		AVALON UPPER	7	219573.8	84179.4	370	22	141	0.4	129012	3178.6	1497	980
COOTER 16 STATE #003H	3001537627	16	25S	29E	D	EDDY		AVALON UPPER	7	201311	77136.2	343	34	108	0.6	117265	3342.8	2127	990
COOTER 16 STATE #004H	3001537628	16	25S	29E	N	EDDY		AVALON UPPER	7	190430.5	71870.7	929	110	237	1.5	111478	3224.6	1389	1140
COOTER 16 STATE.COM #005H	3001537875	16	25S	29E	D	EDDY		AVALON UPPER	7	187758.9	71165.6	758	20	178	0.3	109624	3212.4	1623	970
COOTER 16 STATE.COM #007H	3001537877	16	25S	29E	P	EDDY		AVALON UPPER	7	200382.3	76518.3	605	91	154	1.5	118991	1464	1277	700
COOTER 16 STATE.COM #008H	3001537878	16	25S	29E	P	EDDY		AVALON UPPER	6.8	207677.5	79391.5	595	99	147	1.5	123161	1708	1342	800
SLIDER 8 FEDERAL #001H	3001538242	8	25S	29E	J	EDDY		AVALON UPPER	6.9	190364	72196.4	814	60	289	1	113348	707.6	1578	500
SLIDER 8 FEDERAL #003H	3001538272	8	25S	29E	J	EDDY		AVALON UPPER	7.2	150471.8	55164.4	2053	37	445	0.5	89777	610	1249	500
COOTER 16 STATE.COM #006H	3001537876	16	25S	29E	D	EDDY		AVALON UPPER	7	193732.3	74027.8	513	104	118	1	113441	1830	2665	700
COTTON DRAW UNIT #135H	3001538533	2	25S	31E	N	EDDY		AVALON MIDDLE	7.1	204607.1	68549.6	7663	25	1369	1.5	123033	976	1434	60
COTTON DRAW UNIT #136H	3001538534	2	25S	31E	N	EDDY		AVALON LOWER	7.1	176370.9	63443.9	3351	36	615	0.8	104946	1537.2	1188	40
COTTON DRAW UNIT #137H	3001538556	2	25S	31E	N	EDDY		AVALON MIDDLE	7.3	230564.8	73317.3	11591	44	1987	2.5	140233	610	781	40
COTTON DRAW UNIT #135H	3001538533	2	25S	31E	N	EDDY		AVALON MIDDLE	6.5	221504.1	71676	11845	49	2039	2.5	131876	707.6	1106	50
SOFTSHELL 22 FEDERAL #001	3001539727	22	25S	31E	B	EDDY		AVALON UPPER	6.8	160733	52106	1481	68	289	0.9	102300	2342.4	1012	60
COTTON DRAW UNIT #134H	3001538293	2	25S	31E	M	EDDY		AVALON LOWER	6.66	1738									

GEOLOGIC AFFIRMATION

I have examined available geologic and engineering data and have found no evidence of open faults or other hydrologic connection between the disposal interval and underground sources of drinking water.



Parker Jessee
Geologist

Project: Solaris Water Midstream, LLC
Trivette Fed #1

CARLSBAD
CURRENT-ARGUS

AFFIDAVIT OF PUBLICATION

Ad No.
0001292250

LONQUIST & CO
1001 MCKINNEY, SUITE 1650
HOUSTON TX 77002

I, a legal clerk of the **Carlsbad Current-Argus**,
a newspaper published daily at the City of
Carlsbad, in said county of Eddy, state of New
Mexico and of general paid circulation in said
county; that the same is a duly qualified
newspaper under the laws of the State wherein
legal notices and advertisements may be
published; that the printed notice attached
hereto was published in the regular and entire
edition of said newspaper and not in supplement
thereof on the date as follows, to wit:

07/25/19



Legal Clerk

Subscribed and sworn before me this
26th of July 2019.



State of WI, County of Brown
NOTARY PUBLIC

5.15.23

My Commission Expires

Legal Notice

Solaris Water Midstream, LLC, 907 Tradewinds Blvd., Suite B, Midland, TX 79706, is filling Form C-108 (Application for Authorization to Inject) with the New Mexico Oil Conservation Division for administrative approval for its salt water disposal well Trivette Fed SWD No. 1. The proposed well will be located 990' FNL & 215' FWL in Section 23, Township 26S, Range 30E in Eddy County, New Mexico. Disposal water will be sourced from area production, and will be injected into the Devonian-Silurian formation (determined by offset log analysis) through an open hole completion between a maximum applied for top of 16,533 feet to a maximum depth of 18,333 feet. The maximum surface injection pressure will not exceed 3,307 psi with a maximum rate of 40,000 BWPD. Interested parties opposing the action must file objections or requests for hearing with the Oil Conservation Division, 1220 South St. Francis Drive, Santa Fe, New Mexico 87505, within 15 days. Additional information can be obtained from the applicant's agent, Lonquist & Co., LLC, at (512) 600-1777.
July 25, 2019

NANCY HEYRMAN
Notary Public
State of Wisconsin

DETERMINATION AND NOTICE OF AFFECTED PARTIES – NEW MEXICO

If an operator or mineral lessee has legal acreage or leases within one mile of the proposed salt water disposal well, their contact information is collected for notification purposes. Legal acreage of offset operators is gathered from the New Mexico Oil Conservation District's Permitting website. Minerals leased from the federal government are determined by referencing the Bureau of Land Management's Land and Mineral System Reports database. Minerals leased from the state government are determined by referencing the New Mexico State Land Office's Data Access database. Contact information for the affected parties is then extracted from the reports that were filed with the appropriate regulatory agency. Should any private minerals that are not public information fall within the one-mile radius, a title search was performed to discover the current lessee of those minerals or identifying the mineral owner of the acreage.

Notices were sent for the Trivette Fed SWD No. 1 application by mailing them a copy of Form C-108 on 7/25/2019. The individual tracking numbers are attached in the following pages of this application. Receipt of each application will be monitored and presented to the Oil Conservation Division upon request.



Tyler Moehlman
Petroleum Engineer

Project: Solaris Water Midstream, LLC
 Trivette Fed SWD No. 1

LONQUIST & CO. LLC

AUSTIN
HOUSTON

PETROLEUM
ENGINEERS

ENERGY
ADVISORS

WICHITA
CALGARY

www.lonquist.com

July 25, 2019

ACF PETROLEUM INC
400 W TEXAS AVE
MIDLAND, TX 79701

Subject: Trivette Fed SWD No. 1 Authorization to Inject

To Whom It May Concern:

Attached for your review is Form C-108, Application for Authorization to Inject, and its supplemental documents prepared for Solaris Water Midstream LLC's Trivette Fed SWD No. 1 well. Section XIV of Form C-108 requires that the surface land owner on which the well is located and each leasehold operator within a one-half mile radius of the proposed well location be furnished with the application. The notice of application has been extended to a one-mile radius.

According to the New Mexico Oil Conservation Division, surface owners or offset operators must file any objections or requests for hearing of administrative applications within 15 days from the date in which this application was mailed to them.

Any questions should be directed towards Solaris Water Midstream LLC's agent, Lonquist & Co., LLC.

Regards,



Ramona K. Hovey
Sr. Petroleum Engineer
Lonquist & Co., LLC

(512) 600-1777
ramona@lonquist.com

LONQUIST & CO. LLC

AUSTIN
HOUSTON

PETROLEUM
ENGINEERS

ENERGY
ADVISORS

WICHITA
CALGARY

www.lonquist.com

July 25, 2019

BROUGHTON PETRO INC
13 TOWNHOUSE CT
BELLAIRE, TX 77401

Subject: Trivette Fed SWD No. 1 Authorization to Inject

To Whom It May Concern:

Attached for your review is Form C-108, Application for Authorization to Inject, and its supplemental documents prepared for Solaris Water Midstream LLC's Trivette Fed SWD No. 1 well. Section XIV of Form C-108 requires that the surface land owner on which the well is located and each leasehold operator within a one-half mile radius of the proposed well location be furnished with the application. The notice of application has been extended to a one-mile radius.

According to the New Mexico Oil Conservation Division, surface owners or offset operators must file any objections or requests for hearing of administrative applications within 15 days from the date in which this application was mailed to them.

Any questions should be directed towards Solaris Water Midstream LLC's agent, Lonquist & Co., LLC.

Regards,



Ramona K. Hovey
Sr. Petroleum Engineer
Lonquist & Co., LLC

(512) 600-1777
ramona@lonquist.com

LONQUIST & CO. LLC

AUSTIN
HOUSTON

PETROLEUM
ENGINEERS

ENERGY
ADVISORS

WICHITA
CALGARY

www.lonquist.com

July 25, 2019

BURLINGTON RES OIL & GAS CO LP
PO BOX 51810
MIDLAND, TX 79710

Subject: Trivette Fed SWD No. 1 Authorization to Inject

To Whom It May Concern:

Attached for your review is Form C-108, Application for Authorization to Inject, and its supplemental documents prepared for Solaris Water Midstream LLC's Trivette Fed SWD No. 1 well. Section XIV of Form C-108 requires that the surface land owner on which the well is located and each leasehold operator within a one-half mile radius of the proposed well location be furnished with the application. The notice of application has been extended to a one-mile radius.

According to the New Mexico Oil Conservation Division, surface owners or offset operators must file any objections or requests for hearing of administrative applications within 15 days from the date in which this application was mailed to them.

Any questions should be directed towards Solaris Water Midstream LLC's agent, Lonquist & Co., LLC.

Regards,



Ramona K. Hovey
Sr. Petroleum Engineer
Lonquist & Co., LLC

(512) 600-1777
ramona@lonquist.com

July 25, 2019

BUREAU OF LAND MANAGEMENT
301 DINOSAUR TRAIL
SANTA FE, NM 87508

Subject: Trivette Fed SWD No. 1 Authorization to Inject

To Whom It May Concern:

Attached for your review is Form C-108, Application for Authorization to Inject, and its supplemental documents prepared for Solaris Water Midstream LLC's Trivette Fed SWD No. 1 well. Section XIV of Form C-108 requires that the surface land owner on which the well is located and each leasehold operator within a one-half mile radius of the proposed well location be furnished with the application. The notice of application has been extended to a one-mile radius.

According to the New Mexico Oil Conservation Division, surface owners or offset operators must file any objections or requests for hearing of administrative applications within 15 days from the date in which this application was mailed to them.

Any questions should be directed towards Solaris Water Midstream LLC's agent, Lonquist & Co., LLC.

Regards,



Ramona K. Hovey
Sr. Petroleum Engineer
Lonquist & Co., LLC

(512) 600-1777
ramona@lonquist.com

LONQUIST & CO. LLC

AUSTIN
HOUSTON

PETROLEUM
ENGINEERS

ENERGY
ADVISORS

WICHITA
CALGARY

www.lonquist.com

July 25, 2019

C W TRAINER
P.O. BOX 3788
MIDLAND, TX 79702

Subject: Trivette Fed SWD No. 1 Authorization to Inject

To Whom It May Concern:

Attached for your review is Form C-108, Application for Authorization to Inject, and its supplemental documents prepared for Solaris Water Midstream LLC's Trivette Fed SWD No. 1 well. Section XIV of Form C-108 requires that the surface land owner on which the well is located and each leasehold operator within a one-half mile radius of the proposed well location be furnished with the application. The notice of application has been extended to a one-mile radius.

According to the New Mexico Oil Conservation Division, surface owners or offset operators must file any objections or requests for hearing of administrative applications within 15 days from the date in which this application was mailed to them.

Any questions should be directed towards Solaris Water Midstream LLC's agent, Lonquist & Co., LLC.

Regards,



Ramona K. Hovey
Sr. Petroleum Engineer
Lonquist & Co., LLC

(512) 600-1777
ramona@lonquist.com

LONQUIST & CO. LLC

AUSTIN
HOUSTON

PETROLEUM
ENGINEERS

ENERGY
ADVISORS

WICHITA
CALGARY

www.lonquist.com

July 25, 2019

CHARLES R WIGGINS
BOX 10862
MIDLAND, TX 79702

Subject: Trivette Fed SWD No. 1 Authorization to Inject

To Whom It May Concern:

Attached for your review is Form C-108, Application for Authorization to Inject, and its supplemental documents prepared for Solaris Water Midstream LLC's Trivette Fed SWD No. 1 well. Section XIV of Form C-108 requires that the surface land owner on which the well is located and each leasehold operator within a one-half mile radius of the proposed well location be furnished with the application. The notice of application has been extended to a one-mile radius.

According to the New Mexico Oil Conservation Division, surface owners or offset operators must file any objections or requests for hearing of administrative applications within 15 days from the date in which this application was mailed to them.

Any questions should be directed towards Solaris Water Midstream LLC's agent, Lonquist & Co., LLC.

Regards,



Ramona K. Hovey
Sr. Petroleum Engineer
Lonquist & Co., LLC

(512) 600-1777
ramona@lonquist.com

July 25, 2019

CHARLOTTE WILLIAMSON
BOX 50410
AUSTIN, TX 78763

Subject: Trivette Fed SWD No. 1 Authorization to Inject

To Whom It May Concern:

Attached for your review is Form C-108, Application for Authorization to Inject, and its supplemental documents prepared for Solaris Water Midstream LLC's Trivette Fed SWD No. 1 well. Section XIV of Form C-108 requires that the surface land owner on which the well is located and each leasehold operator within a one-half mile radius of the proposed well location be furnished with the application. The notice of application has been extended to a one-mile radius.

According to the New Mexico Oil Conservation Division, surface owners or offset operators must file any objections or requests for hearing of administrative applications within 15 days from the date in which this application was mailed to them.

Any questions should be directed towards Solaris Water Midstream LLC's agent, Lonquist & Co., LLC.

Regards,



Ramona K. Hovey
Sr. Petroleum Engineer
Lonquist & Co., LLC

(512) 600-1777
ramona@lonquist.com

LONQUIST & CO. LLC

AUSTIN
HOUSTON

PETROLEUM
ENGINEERS

ENERGY
ADVISORS

WICHITA
CALGARY

www.lonquist.com

July 25, 2019

COG OPERATING LLC
600 W ILLINOIS AVE
MIDLAND, TX 79701

Subject: Trivette Fed SWD No. 1 Authorization to Inject

To Whom It May Concern:

Attached for your review is Form C-108, Application for Authorization to Inject, and its supplemental documents prepared for Solaris Water Midstream LLC's Trivette Fed SWD No. 1 well. Section XIV of Form C-108 requires that the surface land owner on which the well is located and each leasehold operator within a one-half mile radius of the proposed well location be furnished with the application. The notice of application has been extended to a one-mile radius.

According to the New Mexico Oil Conservation Division, surface owners or offset operators must file any objections or requests for hearing of administrative applications within 15 days from the date in which this application was mailed to them.

Any questions should be directed towards Solaris Water Midstream LLC's agent, Lonquist & Co., LLC.

Regards,



Ramona K. Hovey
Sr. Petroleum Engineer
Lonquist & Co., LLC

(512) 600-1777
ramona@lonquist.com

LONQUIST & CO. LLC

AUSTIN
HOUSTON

PETROLEUM
ENGINEERS

ENERGY
ADVISORS

WICHITA
CALGARY

www.lonquist.com

July 25, 2019

COSTILLA ENERGY
P.O. BOX 10369
MIDLAND, TX 79702

Subject: Trivette Fed SWD No. 1 Authorization to Inject

To Whom It May Concern:

Attached for your review is Form C-108, Application for Authorization to Inject, and its supplemental documents prepared for Solaris Water Midstream LLC's Trivette Fed SWD No. 1 well. Section XIV of Form C-108 requires that the surface land owner on which the well is located and each leasehold operator within a one-half mile radius of the proposed well location be furnished with the application. The notice of application has been extended to a one-mile radius.

According to the New Mexico Oil Conservation Division, surface owners or offset operators must file any objections or requests for hearing of administrative applications within 15 days from the date in which this application was mailed to them.

Any questions should be directed towards Solaris Water Midstream LLC's agent, Lonquist & Co., LLC.

Regards,



Ramona K. Hovey
Sr. Petroleum Engineer
Lonquist & Co., LLC

(512) 600-1777
ramona@lonquist.com

LONQUIST & CO. LLC

AUSTIN
HOUSTON

PETROLEUM
ENGINEERS

ENERGY
ADVISORS

WICHITA
CALGARY

www.lonquist.com

July 25, 2019

DOMINION OK TX EXPL & PROD INC
14000 QUAIL SPRINGS PKWY #600
OKLAHOMA CITY, OK 73124

Subject: Trivette Fed SWD No. 1 Authorization to Inject

To Whom It May Concern:

Attached for your review is Form C-108, Application for Authorization to Inject, and its supplemental documents prepared for Solaris Water Midstream LLC's Trivette Fed SWD No. 1 well. Section XIV of Form C-108 requires that the surface land owner on which the well is located and each leasehold operator within a one-half mile radius of the proposed well location be furnished with the application. The notice of application has been extended to a one-mile radius.

According to the New Mexico Oil Conservation Division, surface owners or offset operators must file any objections or requests for hearing of administrative applications within 15 days from the date in which this application was mailed to them.

Any questions should be directed towards Solaris Water Midstream LLC's agent, Lonquist & Co., LLC.

Regards,



Ramona K. Hovey
Sr. Petroleum Engineer
Lonquist & Co., LLC

(512) 600-1777
ramona@lonquist.com

LONQUIST & CO. LLC

AUSTIN
HOUSTON

PETROLEUM
ENGINEERS

ENERGY
ADVISORS

WICHITA
CALGARY

www.lonquist.com

July 25, 2019

DUER WAGNER III
301 COMMERCE ST 3400
FORT WORTH, TX 76102

Subject: Trivette Fed SWD No. 1 Authorization to Inject

To Whom It May Concern:

Attached for your review is Form C-108, Application for Authorization to Inject, and its supplemental documents prepared for Solaris Water Midstream LLC's Trivette Fed SWD No. 1 well. Section XIV of Form C-108 requires that the surface land owner on which the well is located and each leasehold operator within a one-half mile radius of the proposed well location be furnished with the application. The notice of application has been extended to a one-mile radius.

According to the New Mexico Oil Conservation Division, surface owners or offset operators must file any objections or requests for hearing of administrative applications within 15 days from the date in which this application was mailed to them.

Any questions should be directed towards Solaris Water Midstream LLC's agent, Lonquist & Co., LLC.

Regards,



Ramona K. Hovey
Sr. Petroleum Engineer
Lonquist & Co., LLC

(512) 600-1777
ramona@lonquist.com

LONQUIST & CO. LLC

AUSTIN
HOUSTON

PETROLEUM
ENGINEERS

ENERGY
ADVISORS

WICHITA
CALGARY

www.lonquist.com

July 25, 2019

EOG RESOURCES INC
PO BOX 4362
HOUSTON, TX 77210

Subject: Trivette Fed SWD No. 1 Authorization to Inject

To Whom It May Concern:

Attached for your review is Form C-108, Application for Authorization to Inject, and its supplemental documents prepared for Solaris Water Midstream LLC's Trivette Fed SWD No. 1 well. Section XIV of Form C-108 requires that the surface land owner on which the well is located and each leasehold operator within a one-half mile radius of the proposed well location be furnished with the application. The notice of application has been extended to a one-mile radius.

According to the New Mexico Oil Conservation Division, surface owners or offset operators must file any objections or requests for hearing of administrative applications within 15 days from the date in which this application was mailed to them.

Any questions should be directed towards Solaris Water Midstream LLC's agent, Lonquist & Co., LLC.

Regards,



Ramona K. Hovey
Sr. Petroleum Engineer
Lonquist & Co., LLC

(512) 600-1777
ramona@lonquist.com

LONQUIST & CO. LLC

AUSTIN
HOUSTON

PETROLEUM
ENGINEERS

ENERGY
ADVISORS

WICHITA
CALGARY

www.lonquist.com

July 25, 2019

EOG RESOURCES INC
PO BOX 2267
MIDLAND, TX 79702

Subject: Trivette Fed SWD No. 1 Authorization to Inject

To Whom It May Concern:

Attached for your review is Form C-108, Application for Authorization to Inject, and its supplemental documents prepared for Solaris Water Midstream LLC's Trivette Fed SWD No. 1 well. Section XIV of Form C-108 requires that the surface land owner on which the well is located and each leasehold operator within a one-half mile radius of the proposed well location be furnished with the application. The notice of application has been extended to a one-mile radius.

According to the New Mexico Oil Conservation Division, surface owners or offset operators must file any objections or requests for hearing of administrative applications within 15 days from the date in which this application was mailed to them.

Any questions should be directed towards Solaris Water Midstream LLC's agent, Lonquist & Co., LLC.

Regards,



Ramona K. Hovey
Sr. Petroleum Engineer
Lonquist & Co., LLC

(512) 600-1777

ramona@lonquist.com

LONQUIST & CO. LLC

AUSTIN
HOUSTON

PETROLEUM
ENGINEERS

ENERGY
ADVISORS

WICHITA
CALGARY

www.lonquist.com

July 25, 2019

ESTORIL PROD CORP
400 W TEXAS AVE
MIDLAND, TX 79701

Subject: Trivette Fed SWD No. 1 Authorization to Inject

To Whom It May Concern:

Attached for your review is Form C-108, Application for Authorization to Inject, and its supplemental documents prepared for Solaris Water Midstream LLC's Trivette Fed SWD No. 1 well. Section XIV of Form C-108 requires that the surface land owner on which the well is located and each leasehold operator within a one-half mile radius of the proposed well location be furnished with the application. The notice of application has been extended to a one-mile radius.

According to the New Mexico Oil Conservation Division, surface owners or offset operators must file any objections or requests for hearing of administrative applications within 15 days from the date in which this application was mailed to them.

Any questions should be directed towards Solaris Water Midstream LLC's agent, Lonquist & Co., LLC.

Regards,



Ramona K. Hovey
Sr. Petroleum Engineer
Lonquist & Co., LLC

(512) 600-1777

ramona@lonquist.com

LONQUIST & CO. LLC

AUSTIN
HOUSTON

PETROLEUM
ENGINEERS

ENERGY
ADVISORS

WICHITA
CALGARY

www.lonquist.com

July 25, 2019

ICA ENERGY INC
PO BOX 223
ODESSA, TX 79760

Subject: Trivette Fed SWD No. 1 Authorization to Inject

To Whom It May Concern:

Attached for your review is Form C-108, Application for Authorization to Inject, and its supplemental documents prepared for Solaris Water Midstream LLC's Trivette Fed SWD No. 1 well. Section XIV of Form C-108 requires that the surface land owner on which the well is located and each leasehold operator within a one-half mile radius of the proposed well location be furnished with the application. The notice of application has been extended to a one-mile radius.

According to the New Mexico Oil Conservation Division, surface owners or offset operators must file any objections or requests for hearing of administrative applications within 15 days from the date in which this application was mailed to them.

Any questions should be directed towards Solaris Water Midstream LLC's agent, Lonquist & Co., LLC.

Regards,



Ramona K. Hovey
Sr. Petroleum Engineer
Lonquist & Co., LLC

(512) 600-1777
ramona@lonquist.com

LONQUIST & CO. LLC

AUSTIN
HOUSTON

PETROLEUM
ENGINEERS

ENERGY
ADVISORS

WICHITA
CALGARY

www.lonquist.com

July 25, 2019

J C WILLIAMSON
PO BOX 16
MIDLAND, TX 79702

Subject: Trivette Fed SWD No. 1 Authorization to Inject

To Whom It May Concern:

Attached for your review is Form C-108, Application for Authorization to Inject, and its supplemental documents prepared for Solaris Water Midstream LLC's Trivette Fed SWD No. 1 well. Section XIV of Form C-108 requires that the surface land owner on which the well is located and each leasehold operator within a one-half mile radius of the proposed well location be furnished with the application. The notice of application has been extended to a one-mile radius.

According to the New Mexico Oil Conservation Division, surface owners or offset operators must file any objections or requests for hearing of administrative applications within 15 days from the date in which this application was mailed to them.

Any questions should be directed towards Solaris Water Midstream LLC's agent, Lonquist & Co., LLC.

Regards,



Ramona K. Hovey
Sr. Petroleum Engineer
Lonquist & Co., LLC

(512) 600-1777
ramona@lonquist.com

LONQUIST & CO. LLC

AUSTIN
HOUSTON

PETROLEUM
ENGINEERS

ENERGY
ADVISORS

WICHITA
CALGARY

www.lonquist.com

July 25, 2019

JOHN A STARCK
PO BOX 10886
MIDLAND, TX 79702

Subject: Trivette Fed SWD No. 1 Authorization to Inject

To Whom It May Concern:

Attached for your review is Form C-108, Application for Authorization to Inject, and its supplemental documents prepared for Solaris Water Midstream LLC's Trivette Fed SWD No. 1 well. Section XIV of Form C-108 requires that the surface land owner on which the well is located and each leasehold operator within a one-half mile radius of the proposed well location be furnished with the application. The notice of application has been extended to a one-mile radius.

According to the New Mexico Oil Conservation Division, surface owners or offset operators must file any objections or requests for hearing of administrative applications within 15 days from the date in which this application was mailed to them.

Any questions should be directed towards Solaris Water Midstream LLC's agent, Lonquist & Co., LLC.

Regards,



Ramona K. Hovey
Sr. Petroleum Engineer
Lonquist & Co., LLC

(512) 600-1777
ramona@lonquist.com

July 25, 2019

K P ACQUISITION CORP
2040 MURRAY HOLLADAY
SALT LAKE CITY, UT 84117

Subject: Trivette Fed SWD No. 1 Authorization to Inject

To Whom It May Concern:

Attached for your review is Form C-108, Application for Authorization to Inject, and its supplemental documents prepared for Solaris Water Midstream LLC's Trivette Fed SWD No. 1 well. Section XIV of Form C-108 requires that the surface land owner on which the well is located and each leasehold operator within a one-half mile radius of the proposed well location be furnished with the application. The notice of application has been extended to a one-mile radius.

According to the New Mexico Oil Conservation Division, surface owners or offset operators must file any objections or requests for hearing of administrative applications within 15 days from the date in which this application was mailed to them.

Any questions should be directed towards Solaris Water Midstream LLC's agent, Lonquist & Co., LLC.

Regards,



Ramona K. Hovey
Sr. Petroleum Engineer
Lonquist & Co., LLC

(512) 600-1777
ramona@lonquist.com

LONQUIST & CO. LLC

AUSTIN
HOUSTON

PETROLEUM
ENGINEERS

ENERGY
ADVISORS

WICHITA
CALGARY

www.lonquist.com

July 25, 2019

KERRY PETROLEUM CO
500 W TEXAS #1450
MIDLAND, TX 79701

Subject: Trivette Fed SWD No. 1 Authorization to Inject

To Whom It May Concern:

Attached for your review is Form C-108, Application for Authorization to Inject, and its supplemental documents prepared for Solaris Water Midstream LLC's Trivette Fed SWD No. 1 well. Section XIV of Form C-108 requires that the surface land owner on which the well is located and each leasehold operator within a one-half mile radius of the proposed well location be furnished with the application. The notice of application has been extended to a one-mile radius.

According to the New Mexico Oil Conservation Division, surface owners or offset operators must file any objections or requests for hearing of administrative applications within 15 days from the date in which this application was mailed to them.

Any questions should be directed towards Solaris Water Midstream LLC's agent, Lonquist & Co., LLC.

Regards,



Ramona K. Hovey
Sr. Petroleum Engineer
Lonquist & Co., LLC

(512) 600-1777
ramona@lonquist.com

LONQUIST & CO. LLC

AUSTIN
HOUSTON

PETROLEUM
ENGINEERS

ENERGY
ADVISORS

WICHITA
CALGARY

www.lonquist.com

July 25, 2019

LOIS G WILLIAMSON
PO BOX 16
MIDLAND, TX 797020016

Subject: Trivette Fed SWD No. 1 Authorization to Inject

To Whom It May Concern:

Attached for your review is Form C-108, Application for Authorization to Inject, and its supplemental documents prepared for Solaris Water Midstream LLC's Trivette Fed SWD No. 1 well. Section XIV of Form C-108 requires that the surface land owner on which the well is located and each leasehold operator within a one-half mile radius of the proposed well location be furnished with the application. The notice of application has been extended to a one-mile radius.

According to the New Mexico Oil Conservation Division, surface owners or offset operators must file any objections or requests for hearing of administrative applications within 15 days from the date in which this application was mailed to them.

Any questions should be directed towards Solaris Water Midstream LLC's agent, Lonquist & Co., LLC.

Regards,



Ramona K. Hovey
Sr. Petroleum Engineer
Lonquist & Co., LLC

(512) 600-1777
ramona@lonquist.com

LONQUIST & CO. LLC

AUSTIN
HOUSTON

PETROLEUM
ENGINEERS

ENERGY
ADVISORS

WICHITA
CALGARY

www.lonquist.com

July 25, 2019

MARATHON OIL PERMIAN LLC
5555 SAN FELIPE ST
HOUSTON, TX 77056

Subject: Trivette Fed SWD No. 1 Authorization to Inject

To Whom It May Concern:

Attached for your review is Form C-108, Application for Authorization to Inject, and its supplemental documents prepared for Solaris Water Midstream LLC's Trivette Fed SWD No. 1 well. Section XIV of Form C-108 requires that the surface land owner on which the well is located and each leasehold operator within a one-half mile radius of the proposed well location be furnished with the application. The notice of application has been extended to a one-mile radius.

According to the New Mexico Oil Conservation Division, surface owners or offset operators must file any objections or requests for hearing of administrative applications within 15 days from the date in which this application was mailed to them.

Any questions should be directed towards Solaris Water Midstream LLC's agent, Lonquist & Co., LLC.

Regards,



Ramona K. Hovey
Sr. Petroleum Engineer
Lonquist & Co., LLC

(512) 600-1777
ramona@lonquist.com

LONQUIST & CO. LLC

AUSTIN
HOUSTON

PETROLEUM
ENGINEERS

ENERGY
ADVISORS

WICHITA
CALGARY

www.lonquist.com

July 25, 2019

MARSHALL & WINSTON INC
PO BOX 50880
MIDLAND, TX 79710

Subject: Trivette Fed SWD No. 1 Authorization to Inject

To Whom It May Concern:

Attached for your review is Form C-108, Application for Authorization to Inject, and its supplemental documents prepared for Solaris Water Midstream LLC's Trivette Fed SWD No. 1 well. Section XIV of Form C-108 requires that the surface land owner on which the well is located and each leasehold operator within a one-half mile radius of the proposed well location be furnished with the application. The notice of application has been extended to a one-mile radius.

According to the New Mexico Oil Conservation Division, surface owners or offset operators must file any objections or requests for hearing of administrative applications within 15 days from the date in which this application was mailed to them.

Any questions should be directed towards Solaris Water Midstream LLC's agent, Lonquist & Co., LLC.

Regards,



Ramona K. Hovey
Sr. Petroleum Engineer
Lonquist & Co., LLC

(512) 600-1777
ramona@lonquist.com

LONQUIST & CO. LLC

AUSTIN
HOUSTON

PETROLEUM
ENGINEERS

ENERGY
ADVISORS

WICHITA
CALGARY

www.lonquist.com

July 25, 2019

MCCULLY-CHAPMAN EXPL INC
PO BOX 421
SEALY, TX 77474

Subject: Trivette Fed SWD No. 1 Authorization to Inject

To Whom It May Concern:

Attached for your review is Form C-108, Application for Authorization to Inject, and its supplemental documents prepared for Solaris Water Midstream LLC's Trivette Fed SWD No. 1 well. Section XIV of Form C-108 requires that the surface land owner on which the well is located and each leasehold operator within a one-half mile radius of the proposed well location be furnished with the application. The notice of application has been extended to a one-mile radius.

According to the New Mexico Oil Conservation Division, surface owners or offset operators must file any objections or requests for hearing of administrative applications within 15 days from the date in which this application was mailed to them.

Any questions should be directed towards Solaris Water Midstream LLC's agent, Lonquist & Co., LLC.

Regards,



Ramona K. Hovey
Sr. Petroleum Engineer
Lonquist & Co., LLC

(512) 600-1777
ramona@lonquist.com

LONQUIST & CO. LLC

AUSTIN
HOUSTON

PETROLEUM
ENGINEERS

ENERGY
ADVISORS

WICHITA
CALGARY

www.lonquist.com

July 25, 2019

MEWBOURNE OIL CO
PO BOX 5270
HOBBS, NM 88241

Subject: Trivette Fed SWD No. 1 Authorization to Inject

To Whom It May Concern:

Attached for your review is Form C-108, Application for Authorization to Inject, and its supplemental documents prepared for Solaris Water Midstream LLC's Trivette Fed SWD No. 1 well. Section XIV of Form C-108 requires that the surface land owner on which the well is located and each leasehold operator within a one-half mile radius of the proposed well location be furnished with the application. The notice of application has been extended to a one-mile radius.

According to the New Mexico Oil Conservation Division, surface owners or offset operators must file any objections or requests for hearing of administrative applications within 15 days from the date in which this application was mailed to them.

Any questions should be directed towards Solaris Water Midstream LLC's agent, Lonquist & Co., LLC.

Regards,



Ramona K. Hovey
Sr. Petroleum Engineer
Lonquist & Co., LLC

(512) 600-1777
ramona@lonquist.com

July 25, 2019

OIL CONSERVATION DIVISION DISTRICT II
811 S. First St.
Artesia NM, 88210

Subject: Trivette Fed SWD No. 1 Authorization to Inject

To Whom It May Concern:

Attached for your review is Form C-108, Application for Authorization to Inject, and its supplemental documents prepared for Solaris Water Midstream LLC's Trivette Fed SWD No. 1 well. Section XIV of Form C-108 requires that the surface land owner on which the well is located and each leasehold operator within a one-half mile radius of the proposed well location be furnished with the application. The notice of application has been extended to a one-mile radius.

According to the New Mexico Oil Conservation Division, surface owners or offset operators must file any objections or requests for hearing of administrative applications within 15 days from the date in which this application was mailed to them.

Any questions should be directed towards Solaris Water Midstream LLC's agent, Lonquist & Co., LLC.

Regards,



Ramona K. Hovey
Sr. Petroleum Engineer
Lonquist & Co., LLC

(512) 600-1777
ramona@lonquist.com

July 25, 2019

RALPH E WILLIAMSON
BOX 994
MIDLAND TX 79702

Subject: Trivette Fed SWD No. 1 Authorization to Inject

To Whom It May Concern:

Attached for your review is Form C-108, Application for Authorization to Inject, and its supplemental documents prepared for Solaris Water Midstream LLC's Trivette Fed SWD No. 1 well. Section XIV of Form C-108 requires that the surface land owner on which the well is located and each leasehold operator within a one-half mile radius of the proposed well location be furnished with the application. The notice of application has been extended to a one-mile radius.

According to the New Mexico Oil Conservation Division, surface owners or offset operators must file any objections or requests for hearing of administrative applications within 15 days from the date in which this application was mailed to them.

Any questions should be directed towards Solaris Water Midstream LLC's agent, Lonquist & Co., LLC.

Regards,



Ramona K. Hovey
Sr. Petroleum Engineer
Lonquist & Co., LLC

(512) 600-1777
ramona@lonquist.com

July 25, 2019

WPX ENERGY PERMIAN LLC
3500 ONE WILLIAMS CTR
TULSA, OK 741720135

Subject: Trivette Fed SWD No. 1 Authorization to Inject

To Whom It May Concern:

Attached for your review is Form C-108, Application for Authorization to Inject, and its supplemental documents prepared for Solaris Water Midstream LLC's Trivette Fed SWD No. 1 well. Section XIV of Form C-108 requires that the surface land owner on which the well is located and each leasehold operator within a one-half mile radius of the proposed well location be furnished with the application. The notice of application has been extended to a one-mile radius.

According to the New Mexico Oil Conservation Division, surface owners or offset operators must file any objections or requests for hearing of administrative applications within 15 days from the date in which this application was mailed to them.

Any questions should be directed towards Solaris Water Midstream LLC's agent, Lonquist & Co., LLC.

Regards,



Ramona K. Hovey
Sr. Petroleum Engineer
Lonquist & Co., LLC

(512) 600-1777
ramona@lonquist.com

Chris Weyand
Lonquist & CO LLC
1001 McKinney Street
Ste 1650
Houston, TX 77002

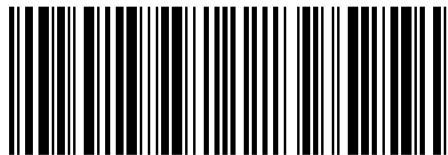

9314 8699 0430 0061 5793 27

RETURN RECEIPT (ELECTRONIC)



Total Postage: \$6.55

ACF Petroleum Inc
400 W Texas Ave
Midland, TX 79701

Reference Number: 2007 - Trivette Fed SWD No. 1

Chris Weyand
Lonquist & CO LLC
1001 McKinney Street
Ste 1650
Houston, TX 77002

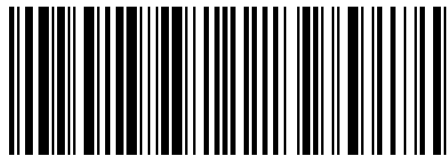

9314 8699 0430 0061 5793 34

RETURN RECEIPT (ELECTRONIC)



Total Postage: \$6.55

Broughton Petro Inc
13 Townhouse CT
Bellaire, TX 77401

Reference Number: 2007 - Trivette Fed SWD No. 1

Chris Weyand
Lonquist & CO LLC
1001 McKinney Street
Ste 1650
Houston, TX 77002

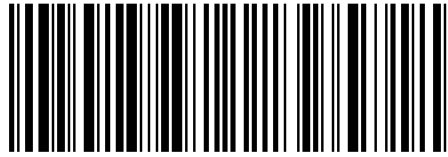

9314 8699 0430 0061 5793 41

RETURN RECEIPT (ELECTRONIC)



Total Postage: \$6.55

Bureau of Land Management
301 Dinosaur Trail
Santa Fe, NM 87508

Reference Number: 2007 - Trivette Fed SWD No. 1

Chris Weyand
Lonquist & CO LLC
1001 McKinney Street
Ste 1650
Houston, TX 77002

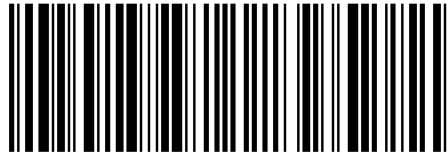

9314 8699 0430 0061 5793 58

RETURN RECEIPT (ELECTRONIC)

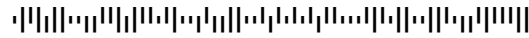

Total Postage: \$6.55

Burlington Res Oil & Gas Co LP
PO Box 51810
Midland, TX 79710

Reference Number: 2007 - Trivette Fed SWD No. 1

Chris Weyand
Lonquist & CO LLC
1001 McKinney Street
Ste 1650
Houston, TX 77002

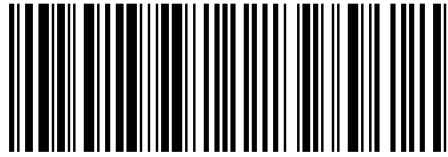

9314 8699 0430 0061 5793 65

RETURN RECEIPT (ELECTRONIC)



Total Postage: \$6.55

C W Trainer
PO Box 3788
Midland, TX 79702

Reference Number: 2007 - Trivette Fed SWD No. 1

Chris Weyand
Lonquist & CO LLC
1001 McKinney Street
Ste 1650
Houston, TX 77002

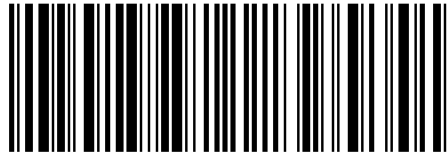

9314 8699 0430 0061 5793 72

RETURN RECEIPT (ELECTRONIC)



Total Postage: \$6.55

Charles R Wiggins
Box 10862
Midland, TX 79702

Reference Number: 2007 - Trivette Fed SWD No. 1

Chris Weyand
Lonquist & CO LLC
1001 McKinney Street
Ste 1650
Houston, TX 77002

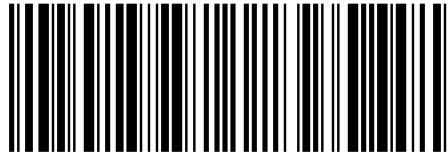

9314 8699 0430 0061 5793 89

RETURN RECEIPT (ELECTRONIC)



Total Postage: \$6.55

Charlotte Williamson
Box 50410
Austin , TX 78763

Reference Number: 2007 - Trivette Fed SWD No. 1

Chris Weyand
Lonquist & CO LLC
1001 McKinney Street
Ste 1650
Houston, TX 77002

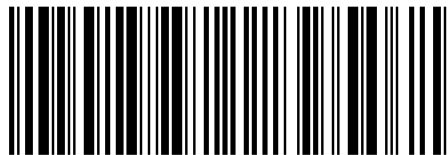

9314 8699 0430 0061 5793 96

RETURN RECEIPT (ELECTRONIC)



Total Postage: \$6.55

COG Operating LLC
600 W Illinois Ave
Midland , TX 79701

Reference Number: 2007 - Trivette Fed SWD No. 1

Chris Weyand
Lonquist & CO LLC
1001 McKinney Street
Ste 1650
Houston, TX 77002

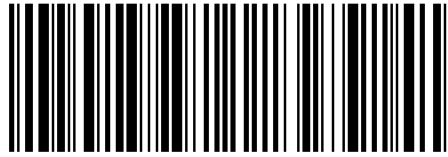

9314 8699 0430 0061 5794 02

RETURN RECEIPT (ELECTRONIC)



Total Postage: \$6.55

Costilla Energy
PO Box 10369
Midland, TX 79702

Reference Number: 2007 - Trivette Fed SWD No. 1

Chris Weyand
Lonquist & CO LLC
1001 McKinney Street
Ste 1650
Houston, TX 77002

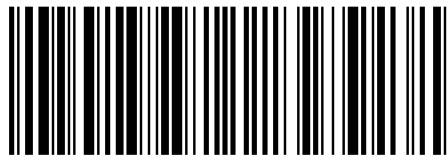

9314 8699 0430 0061 5794 19

RETURN RECEIPT (ELECTRONIC)



Total Postage: \$6.55

Dominion OK TX Expl & Prod Inc
1400 Quail Springs Pkwy #600
Oklahoma City, OK 73134

Reference Number: 2007 - Trivette Fed SWD No. 1

Chris Weyand
Lonquist & CO LLC
1001 McKinney Street
Ste 1650
Houston, TX 77002

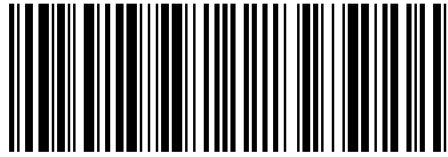

9314 8699 0430 0061 5794 26

RETURN RECEIPT (ELECTRONIC)



Total Postage: \$6.55

Duer Wagner III
301 Commerce St #2930
Fort Worth, TX 76102

Reference Number: 2007 - Trivette Fed SWD No. 1

Chris Weyand
Lonquist & CO LLC
1001 McKinney Street
Ste 1650
Houston, TX 77002

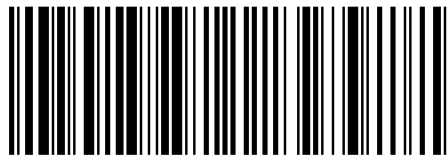

9314 8699 0430 0061 5794 33

RETURN RECEIPT (ELECTRONIC)



Total Postage: \$6.55

EOG Resources Inc
PO Box 4362
Houston, TX 77210

Reference Number: 2007 - Trivette Fed SWD No. 1

Chris Weyand
Lonquist & CO LLC
1001 McKinney Street
Ste 1650
Houston, TX 77002

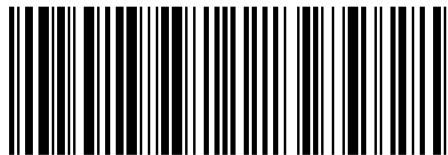

9314 8699 0430 0061 5794 40

RETURN RECEIPT (ELECTRONIC)



Total Postage: \$6.55

EOG Resources Inc
PO Box 2267
Midland, TX 79702

Reference Number: 2007 - Trivette Fed SWD No. 1

Chris Weyand
Lonquist & CO LLC
1001 McKinney Street
Ste 1650
Houston, TX 77002

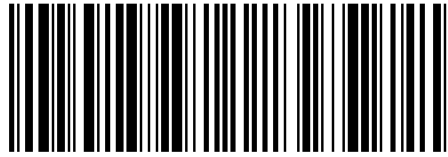

9314 8699 0430 0061 5794 57

RETURN RECEIPT (ELECTRONIC)



Total Postage: \$6.55

Estoril Prod Corp
400 W Texas Ave
Midland, TX 79701

Reference Number: 2007 - Trivette Fed SWD No. 1

Chris Weyand
Lonquist & CO LLC
1001 McKinney Street
Ste 1650
Houston, TX 77002

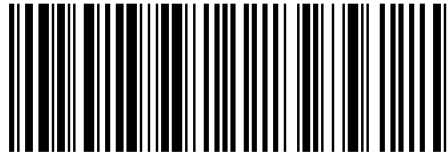

9314 8699 0430 0061 5794 64

RETURN RECEIPT (ELECTRONIC)



Total Postage: \$6.55

ICA Energy Inc
PO Box 223
Odessa, TX 79760

Reference Number: 2007 - Trivette Fed SWD No. 1

Chris Weyand
Lonquist & CO LLC
1001 McKinney Street
Ste 1650
Houston, TX 77002

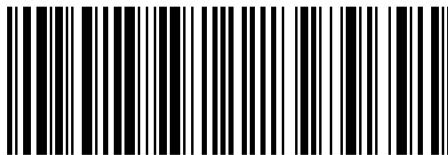

9314 8699 0430 0061 5794 71

RETURN RECEIPT (ELECTRONIC)



Total Postage: \$6.55

J C Williamson
PO Box 16
Midland, TX 79702

Reference Number: 2007 - Trivette Fed SWD No. 1

Chris Weyand
Lonquist & CO LLC
1001 McKinney Street
Ste 1650
Houston, TX 77002

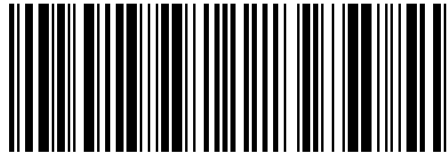

9314 8699 0430 0061 5794 88

RETURN RECEIPT (ELECTRONIC)



Total Postage: \$6.55

John A Starck
PO Box 10886
Midland, TX 79702

Reference Number: 2007 - Trivette Fed SWD No. 1

Chris Weyand
Lonquist & CO LLC
1001 McKinney Street
Ste 1650
Houston, TX 77002

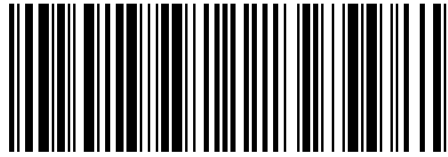

9314 8699 0430 0061 5794 95

RETURN RECEIPT (ELECTRONIC)



Total Postage: \$6.55

K P Acquisition Corp
2040 Murray Holladay
Salt Lake City, UT 84117

Reference Number: 2007 - Trivette Fed SWD No. 1

Chris Weyand
Lonquist & CO LLC
1001 McKinney Street
Ste 1650
Houston, TX 77002

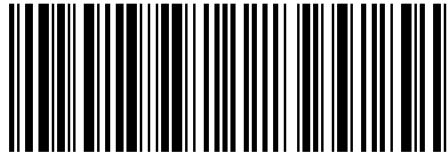

9314 8699 0430 0061 5795 01

RETURN RECEIPT (ELECTRONIC)



Total Postage: \$6.55

Kerry Petroleum Co
500 W Texas #1450
Midland , TX 79701

Reference Number: 2007 - Trivette Fed SWD No. 1

Chris Weyand
Lonquist & CO LLC
1001 McKinney Street
Ste 1650
Houston, TX 77002

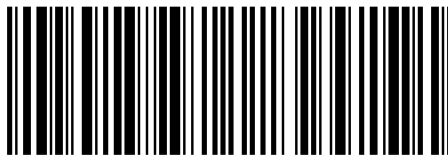

9314 8699 0430 0061 5795 18

RETURN RECEIPT (ELECTRONIC)



Total Postage: \$6.55

Lois G Williams
PO Box 16
Midland , TX 79702

Reference Number: 2007 - Trivette Fed SWD No. 1

Chris Weyand
Lonquist & CO LLC
1001 McKinney Street
Ste 1650
Houston, TX 77002

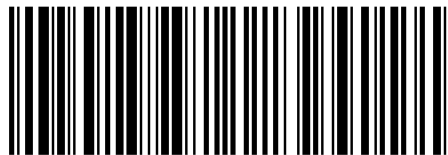

9314 8699 0430 0061 5795 25

RETURN RECEIPT (ELECTRONIC)



Total Postage: \$6.55

Marathon Oil Permian LLC
5555 San Felipe St
Houston , TX 77056

Reference Number: 2007 - Trivette Fed SWD No. 1

Chris Weyand
Lonquist & CO LLC
1001 McKinney Street
Ste 1650
Houston, TX 77002

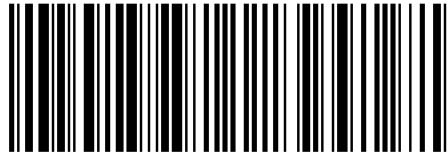

9314 8699 0430 0061 5795 32

RETURN RECEIPT (ELECTRONIC)



Total Postage: \$6.55

Marshall & Winston Inc
PO Box 50880
Midland , TX 79710

Reference Number: 2007 - Trivette Fed SWD No. 1

Chris Weyand
Lonquist & CO LLC
1001 McKinney Street
Ste 1650
Houston, TX 77002

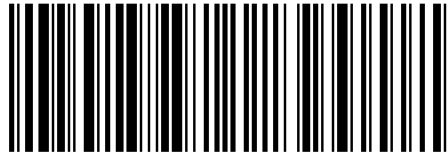

9314 8699 0430 0061 5795 49

RETURN RECEIPT (ELECTRONIC)



Total Postage: \$6.55

McCully-Chapman Expl Inc
PO Box 421
Sealy, TX 77474

Reference Number: 2007 - Trivette Fed SWD No. 1

Chris Weyand
Lonquist & CO LLC
1001 McKinney Street
Ste 1650
Houston, TX 77002

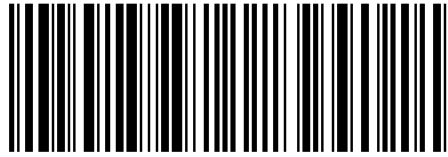

9314 8699 0430 0061 5795 56

RETURN RECEIPT (ELECTRONIC)



Total Postage: \$6.55

Mewbourne Oil Co
PO Box 5270
Hobbs, NM 88241

Reference Number: 2007 - Trivette Fed SWD No. 1

Chris Weyand
Lonquist & CO LLC
1001 McKinney Street
Ste 1650
Houston, TX 77002

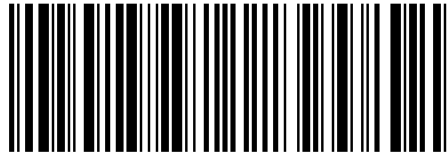

9314 8699 0430 0061 5795 63

RETURN RECEIPT (ELECTRONIC)

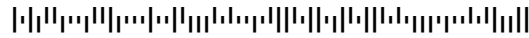

Total Postage: \$6.55

Oil Conservation Division District II
811 S. First St.
Artesia, NM 88210

Reference Number: 2007 - Trivette Fed SWD No. 1

Chris Weyand
Lonquist & CO LLC
1001 McKinney Street
Ste 1650
Houston, TX 77002

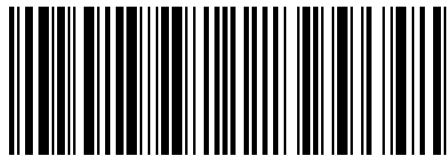

9314 8699 0430 0061 5795 70

RETURN RECEIPT (ELECTRONIC)



Total Postage: \$6.55

Oil Conservation Division District IV
1220 S St Francis Dr
Santa Fe, NM 87505

Reference Number: 2007 - Trivette Fed SWD No. 1

Chris Weyand
Lonquist & CO LLC
1001 McKinney Street
Ste 1650
Houston, TX 77002

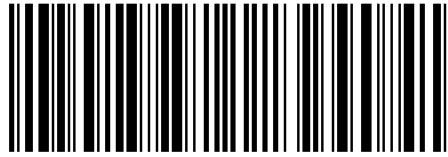

9314 8699 0430 0061 5795 87

RETURN RECEIPT (ELECTRONIC)



Total Postage: \$6.55

Ralph E Williamson
Box 994
Midland , TX 79702

Reference Number: 2007 - Trivette Fed SWD No. 1

Chris Weyand
Lonquist & CO LLC
1001 McKinney Street
Ste 1650
Houston, TX 77002

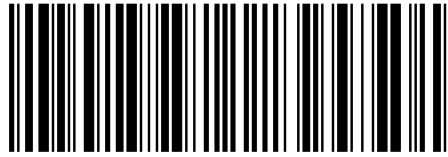

9314 8699 0430 0061 5795 94

RETURN RECEIPT (ELECTRONIC)



Total Postage: \$6.55

WPX Energy Permian LLC
3500 One Williams Center
Tulsa, OK 74172

Reference Number: 2007 - Trivette Fed SWD No. 1

APPLICATION FOR AUTHORIZATION TO INJECT

- I. PURPOSE: _____ Secondary Recovery _____ Pressure Maintenance _____ X Disposal _____ Storage
Application qualifies for administrative approval? _____ X Yes _____ No
- II. OPERATOR: Solaris Water Midstream, LLC
ADDRESS: 701 Tradewinds Blvd., Suite C, Midland, TX 79706
CONTACT PARTY: Whitney McKee PHONE: 432-203-9020
- III. WELL DATA: Complete the data required on the reverse side of this form for each well proposed for injection.
Additional sheets may be attached if necessary.
- IV. Is this an expansion of an existing project? _____ Yes _____ X No
If yes, give the Division order number authorizing the project: _____
- V. Attach a map that identifies all wells and leases within two miles of any proposed injection well with a one-half mile radius circle drawn around each proposed injection well. This circle identifies the well's area of review.
- VI. Attach a tabulation of data on all wells of public record within the area of review which penetrate the proposed injection zone. Such data shall include a description of each well's type, construction, date drilled, location, depth, record of completion, and a schematic of any plugged well illustrating all plugging detail.
- VII. Attach data on the proposed operation, including:
1. Proposed average and maximum daily rate and volume of fluids to be injected;
 2. Whether the system is open or closed;
 3. Proposed average and maximum injection pressure;
 4. Sources and an appropriate analysis of injection fluid and compatibility with the receiving formation if other than reinjected produced water; and,
 5. If injection is for disposal purposes into a zone not productive of oil or gas at or within one mile of the proposed well, attach a chemical analysis of the disposal zone formation water (may be measured or inferred from existing literature, studies, nearby wells, etc.).
- *VIII. Attach appropriate geologic data on the injection zone including appropriate lithologic detail, geologic name, thickness, and depth. Give the geologic name, and depth to bottom of all underground sources of drinking water (aquifers containing waters with total dissolved solids concentrations of 10,000 mg/l or less) overlying the proposed injection zone as well as any such sources known to be immediately underlying the injection interval.
- IX. Describe the proposed stimulation program, if any.
- *X. Attach appropriate logging and test data on the well. (If well logs have been filed with the Division, they need not be resubmitted).
- *XI. Attach a chemical analysis of fresh water from two or more fresh water wells (if available and producing) within one mile of any injection or disposal well showing location of wells and dates samples were taken.
- XII. Applicants for disposal wells must make an affirmative statement that they have examined available geologic and engineering data and find no evidence of open faults or any other hydrologic connection between the disposal zone and any underground sources of drinking water.
- XIII. Applicants must complete the "Proof of Notice" section on the reverse side of this form.
- XIV. Certification: I hereby certify that the information submitted with this application is true and correct to the best of my knowledge and belief.
- NAME: Ramona Hovey TITLE: Consulting Engineer – Agent for Solaris Water Midstream
SIGNATURE:  DATE: 7/25/2019
E-MAIL ADDRESS: ramona@lonquist.com
- * If the information required under Sections VI, VIII, X, and XI above has been previously submitted, it need not be resubmitted. Please show the date and circumstances of the earlier submittal:

III. WELL DATA

A. The following well data must be submitted for each injection well covered by this application. The data must be both in tabular and schematic form and shall include:

- (1) Lease name; Well No.; Location by Section, Township and Range; and footage location within the section.
- (2) Each casing string used with its size, setting depth, sacks of cement used, hole size, top of cement, and how such top was determined.
- (3) A description of the tubing to be used including its size, lining material, and setting depth.
- (4) The name, model, and setting depth of the packer used or a description of any other seal system or assembly used.

Division District Offices have supplies of Well Data Sheets which may be used or which may be used as models for this purpose. Applicants for several identical wells may submit a "typical data sheet" rather than submitting the data for each well.

B. The following must be submitted for each injection well covered by this application. All items must be addressed for the initial well. Responses for additional wells need be shown only when different. Information shown on schematics need not be repeated.

- (1) The name of the injection formation and, if applicable, the field or pool name.
- (2) The injection interval and whether it is perforated or open-hole.
- (3) State if the well was drilled for injection or, if not, the original purpose of the well.
- (4) Give the depths of any other perforated intervals and detail on the sacks of cement or bridge plugs used to seal off such perforations.
- (5) Give the depth to and the name of the next higher and next lower oil or gas zone in the area of the well, if any.

XIV. PROOF OF NOTICE

All applicants must furnish proof that a copy of the application has been furnished, by certified or registered mail, to the owner of the surface of the land on which the well is to be located and to each leasehold operator within one-half mile of the well location.

Where an application is subject to administrative approval, a proof of publication must be submitted. Such proof shall consist of a copy of the legal advertisement which was published in the county in which the well is located. The contents of such advertisement must include:

- (1) The name, address, phone number, and contact party for the applicant;
- (2) The intended purpose of the injection well; with the exact location of single wells or the Section, Township, and Range location of multiple wells;
- (3) The formation name and depth with expected maximum injection rates and pressures; and,
- (4) A notation that interested parties must file objections or requests for hearing with the Oil Conservation Division, 1220 South St. Francis Dr., Santa Fe, New Mexico 87505, within 15 days.

NO ACTION WILL BE TAKEN ON THE APPLICATION UNTIL PROPER PROOF OF NOTICE HAS BEEN SUBMITTED.

NOTICE: Surface owners or offset operators must file any objections or requests for hearing of administrative applications within 15 days from the date this application was mailed to them.

INJECTION WELL DATA SHEET

OPERATOR: Solaris Water Midstream, LLCWELL NAME & NUMBER: Trivette Fed SWD No. 1WELL LOCATION: 990' FNL 215' FWL
FOOTAGE LOCATIOND
UNIT LETTER23
SECTION26S
TOWNSHIP30E
RANGEWELLBORE SCHEMATICWELL CONSTRUCTION DATASurface CasingHole Size: 18.125"Casing Size: 16.00"Cemented with: 946 sx.**or** _____ ft³Top of Cement: surfaceMethod Determined: circulationIntermediate CasingHole Size: 14.750"Casing Size: 13.375"Cemented with: 914 sx.**or** _____ ft³Top of Cement: surfaceMethod Determined: circulationProduction CasingHole Size: 12.250"Casing Size: 9.625"Cemented with: 2924 sx.**or** _____ ft³Top of Cement: surfaceMethod Determined: circulationLinerHole Size: 8.500"Casing Size: 7.625"Cemented with: 485 sx.**or** _____ ft³Top of Cement: 12,026'Method Determined: calculationTotal Depth: 18,333'Injection Interval16,533 feet to 18,333 feet

(Open Hole)

INJECTION WELL DATA SHEET

Tubing Size: 5.5", 20 lb/ft, HCL-80, BTC from 0' – 11,826' and 5", 18 lb/ft, HCL-80, LTC from 11,826' – 16,483'

Lining Material: Duoline

Type of Packer: Nickel Plated Double Grip Retrievable Packer or Equivalent

Packer Setting Depth: 16,483'

Other Type of Tubing/Casing Seal (if applicable): _____

Additional Data

1. Is this a new well drilled for injection? X Yes No

If no, for what purpose was the well originally drilled?

2. Name of the Injection Formation: Devonian, Fusselman

3. Name of Field or Pool (if applicable): SWD; Devonian-Silurian 97869

4. Has the well ever been perforated in any other zone(s)? List all such perforated intervals and give plugging detail, i.e. sacks of cement or plug(s) used.

No, new drill.

5. Give the name and depths of any oil or gas zones underlying or overlying the proposed injection zone in this area:

Bell Canyon: 3,721'

Atoka: 13,679'

Cherry Canyon: 4,627'

Morrow: 14,354'

Brushy Canyon: 5,877'

Bone Spring: 7,574'

Wolfcamp: 12,126'

Strawn: 13,544'

DISTRICT I
1625 N. French Dr., Hobbs, NM 88240
Phone (575) 393-6161 Fax: (575) 393-0720

DISTRICT II
811 S. First St., Artesia, NM 88210
Phone (575) 748-1283 Fax: (575) 748-9720

DISTRICT III
1000 Rio Brazos Rd., Aztec, NM 87410
Phone (505) 334-6176 Fax: (505) 334-6170

DISTRICT IV
1220 S. St. Francis Dr., Santa Fe, NM 87505
Phone (505) 476-3460 Fax: (505) 476-3462

State of New Mexico
Energy, Minerals and Natural Resources Department

Form C-102
Revised August 1, 2011

Submit one copy to appropriate
District Office

OIL CONSERVATION DIVISION

1220 South St. Francis Dr.
Santa Fe, New Mexico 87505

WELL LOCATION AND ACREAGE DEDICATION PLAT

☐ AMENDED REPORT

API Number	Pool Code 97869	Pool Name Devonian-Silurian
Property Code	Property Name TRIVETTE FED SWD	Well Number 1
OGRID No. 371643	Operator Name SOLARIS WATER MIDSTREAM	Elevation 3096'

Surface Location

UL or lot No. D	Section 23	Township 26 S	Range 30 E	Lot Idn	Feet from the 990	North/South line NORTH	Feet from the 215	East/West line WEST	County EDDY
--------------------	---------------	------------------	---------------	---------	----------------------	---------------------------	----------------------	------------------------	----------------

Bottom Hole Location If Different From Surface

UL or lot No.	Section	Township	Range	Lot Idn	Feet from the	North/South line	Feet from the	East/West line	County
---------------	---------	----------	-------	---------	---------------	------------------	---------------	----------------	--------

Dedicated Acres	Joint or Infill	Consolidation Code	Order No.
-----------------	-----------------	--------------------	-----------

NO ALLOWABLE WILL BE ASSIGNED TO THIS COMPLETION UNTIL ALL INTERESTS HAVE BEEN CONSOLIDATED
OR A NON-STANDARD UNIT HAS BEEN APPROVED BY THE DIVISION

N:376912.7
E:687845.3
(NAD 83)

N:376947.8
E:693181.1
(NAD 83)

SURFACE LOCATION
Lat - N 32.032612°
Long - W 103.859820°
NMSPEC - N 375924.3
E 688069.8
(NAD-83)

OPERATOR CERTIFICATION

I hereby certify that the information contained herein is true and complete to the best of my knowledge and belief, and that this organization either owns a working interest or unleased mineral interest in the land including the proposed bottom hole location or has a right to drill this well at this location pursuant to a contract with an owner of such a mineral or working interest, or to a voluntary pooling agreement or a compulsory pooling order heretofore entered by the division.

Ramona K. Hovey 7/15/19
Signature Date

RAMONA K. HOVEY
Printed Name

ramona@longquist.com
Email Address

SURVEYOR CERTIFICATION

I hereby certify that the well location shown on this plat was plotted from field notes of actual surveys made by me or under my supervision, and that the same is true and correct to the best of my belief.

JUNE 22, 2019
Date Surveyed
Signature & Seal of Professional Surveyor

[Signature]
Certificate No. *7977*
Surveyor's Name *Curry L. Jones*

0' 500' 1000' 1500' 2000'
SCALE: 1" = 1000'
WO Num.: 34645

District I1625 N. French Dr., Hobbs, NM 88240
Phone: (575) 393-6161 Fax: (575) 393-0720**District II**811 S. First St., Artesia, NM 88210
Phone: (575) 748-1283 Fax: (575) 748-9720**District III**1000 Rio Brazos Road, Aztec, NM 87410
Phone: (505) 334-6178 Fax: (505) 334-6170**District IV**1220 S. St. Francis Dr., Santa Fe, NM 87505
Phone: (505) 476-3460 Fax: (505) 476-3462**State of New Mexico**Form C-101
Revised July 18, 2013**Energy Minerals and Natural Resources****Oil Conservation Division**☐ AMENDED REPORT**1220 South St. Francis Dr.****Santa Fe, NM 87505****APPLICATION FOR PERMIT TO DRILL, RE-ENTER, DEEPEN, PLUGBACK, OR ADD A ZONE**

1. Operator Name and Address SOLARIS WATER MIDSTREAM, LLC 701 TRADEWINDS BLVD., SUITE C MIDLAND, TX 79706		2. OGRID Number 371643
		3. API Number TBD
4. Property Code	5. Property Name TRIVETTE FED SWD	6. Well No. 1

7. Surface Location

UL - Lot	Section	Township	Range	Lot Idn	Feet from	N/S Line	Feet From	E/W Line	County
D	23	26 S	30 E		990	N	215	W	EDDY

8. Proposed Bottom Hole Location

UL - Lot	Section	Township	Range	Lot Idn	Feet from	N/S Line	Feet From	E/W Line	County
-	-	-	-	-	-	-	-	-	-

9. Pool Information

Pool Name SWD: Devonian-Silurian	Pool Code 97869
-------------------------------------	--------------------

Additional Well Information

11. Work Type N	12. Well Type SWD	13. Cable/Rotary R	14. Lease Type Private	15. Ground Level Elevation 3096'
16. Multiple N	17. Proposed Depth 18,333'	18. Formation Devonian-Silurian	19. Contractor TBD	20. Spud Date ASAP
Depth to Ground water 226'		Distance from nearest fresh water well 1.5 miles		Distance to nearest surface water >1 mile

☒ We will be using a closed-loop system in lieu of lined pits**21. Proposed Casing and Cement Program**

Type	Hole Size	Casing Size	Casing Weight/ft	Setting Depth	Sacks of Cement	Estimated TOC
Surface	18.125"	16"	84 lb/ft	1,239'	946	Surface
Intermediate	14.75"	13.375"	68 lb/ft	3,718'	914	Surface
Production	12.25"	9.625"	53.5 lb/ft	12,226'	2924	Surface
Liner	8.5"	7.625"	39 lb/ft	12,026' - 16,533'	485	12,026'
Tubing		5.5" & 5"	20 lb/ft & 18 lb/ft	0' - 11,826' & 11,826' - 16,483'	N/A	

Casing/Cement Program: Additional Comments

See attached schematic.

22. Proposed Blowout Prevention Program

Type	Working Pressure	Test Pressure	Manufacturer
Double Hydraulic/Blinds, Pipe	8,000 psi	10,000 psi	TBD - Schaffer/Cameron

23. I hereby certify that the information given above is true and complete to the best of my knowledge and belief.

I further certify that I have complied with 19.15.14.9 (A) NMAC ☐ and/or 19.15.14.9 (B) NMAC ☒, if applicable.

Signature:

Printed name: Ramona Hovey

Title: Consulting Engineer

E-mail Address: ramona@lonquist.com

Date: July 25, 2019

Phone: 512-600-1777

OIL CONSERVATION DIVISION

Approved By:

Title:

Approved Date:

Expiration Date:

Conditions of Approval Attached

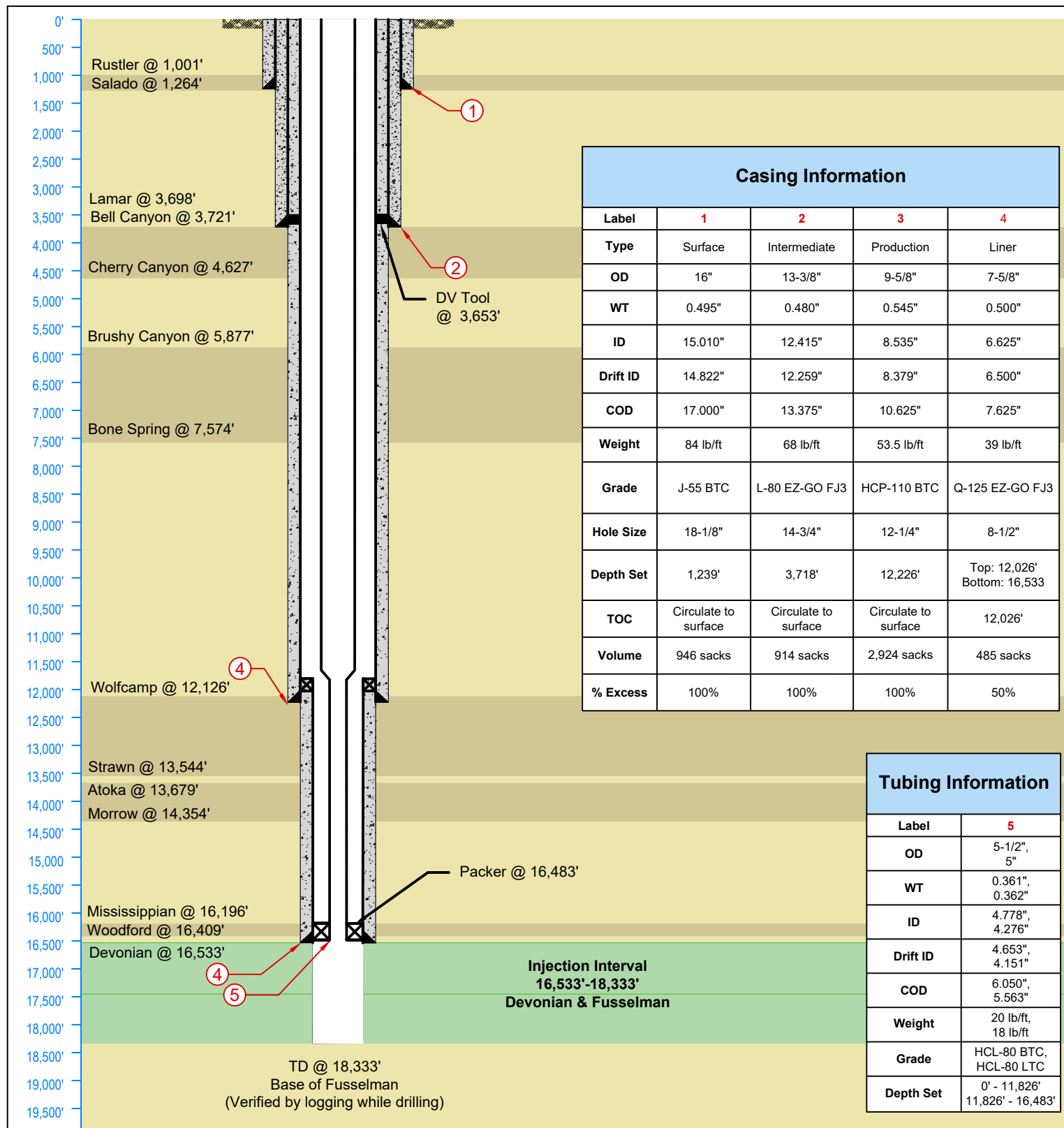

<div>LONQUIST & CO. LLC</div> <div><div>PETROLEUM ENGINEERS</div><div>ENERGY ADVISORS</div></div> <div><div>HOUSTON CALGARY</div><div>AUSTIN WICHITA DENVER</div></div>	Solaris Water Midstream, LLC		Trivette Fed SWD No. 1	
	Country: USA		State/Province: New Mexico	County/Parish: Eddy
	Location:		Site: 990' FNL & 215' FWL	Survey: S23-T26S-R30E
	API No: NA		Field: Silurian-Devonian (Code: 97869)	Well Type/Status: SWD
	Texas License F-9147		Project No: 1917	Date: 7/24/2019
12912 Hill Country Blvd. Ste F-200 Austin, Texas 78738 Tel: 512.732.9812 Fax: 512.732.9816	NMOCD District No: 2		Approved:	
	Drawn: TFM		Reviewed:	
	Rev No: 1		Notes:	

DETERMINATION AND NOTICE OF AFFECTED PARTIES – NEW MEXICO

If an operator or mineral lessee has legal acreage or leases within one mile of the proposed salt water disposal well, their contact information is collected for notification purposes. Legal acreage of offset operators is gathered from the New Mexico Oil Conservation District's Permitting website. Minerals leased from the federal government are determined by referencing the Bureau of Land Management's Land and Mineral System Reports database. Minerals leased from the state government are determined by referencing the New Mexico State Land Office's Data Access database. Contact information for the affected parties is then extracted from the reports that were filed with the appropriate regulatory agency. Should any private minerals that are not public information fall within the one-mile radius, a title search was performed to discover the current lessee of those minerals or identifying the mineral owner of the acreage.

Notices were sent for the Trivette Fed SWD No. 1 application by mailing them a copy of Form C-108 on 7/25/2019. The individual tracking numbers are attached in the following pages of this application. Receipt of each application will be monitored and presented to the Oil Conservation Division upon request.



Tyler Moehlman
Petroleum Engineer

Project: Solaris Water Midstream, LLC
 Trivette Fed SWD No. 1

GEOLOGIC AFFIRMATION

I have examined available geologic and engineering data and have found no evidence of open faults or other hydrologic connection between the disposal interval and underground sources of drinking water.



Parker Jessee
Geologist

Project: Solaris Water Midstream, LLC
 Trivette Fed #1



Solaris Water Midstream, LLC

Trivette Fed SWD No. 1

FORM C-108 Supplemental Information

III. Well Data

A. Wellbore Information

1.

Well information	
Lease Name	Trivette Fed SWD
Well No.	1
Location	S-23 T-26S R-30E
Footage Location	990' FNL & 215' FWL

2.

a. Wellbore Description

Casing Information				
Type	Surface	Intermediate	Production	Liner
OD	16"	13.375"	9.625"	7.625"
WT	0.495"	0.480"	0.545"	0.500"
ID	15.010"	12.415"	8.535"	6.625"
Drift ID	14.822"	12.259"	8.379"	6.500"
COD	17.000"	13.375"	10.625"	7.625"
Weight	84 lb/ft	68 lb/ft	53.5 lb/ft	39 lb/ft
Grade	J-55 BTC	L-80, EZ-GO FJ3	HCP-110 BTC	Q-125 EZ-GO FJ3
Hole Size	18.125"	14.75"	12.25"	8.5"
Depth Set	1378'	3,718'	12,226'	12,026' – 16,533'

b. Cementing Program

Cement Information				
Casing String	Surface	Intermediate	Production	Liner
Lead Cement	HALCEM™	HALCEM™	NEOCEM™ IL2	NEOCEM™
Lead Cement Volume (sacks)	635	628	Stage 1: 1725 Stage 2: 342	-
Lead Cement Density (ft3/sack)	1.664	1.664	Stage 1: 2.731 Stage 2: 2.732	-
Tail Cement	HALCEM™	HALCEM™	NEOCEM™/HALCEM™	VERSACEM™
Tail Cement Volume (sacks)	311	286	Stage 1: 623 Stage 2: 233	485
Tail Cement Density (ft3/sack)	1.332	1.332	Stage 1: 1.056 Stage 2: 1.336	1.223
Cement Excess	100%	100%	100%, 0%	50%
Total Sacks	946	914	2,924	485
TOC	Surface	Surface	Surface	8,300'
Method	Circulate to Surface	Circulate to Surface	Circulate to Surface	Logged

3. Tubing Description

Tubing Information	
OD	5.5"
	5.0"
WT	0.361"
	0.362"
ID	4.778"
	4.276"
Drift ID	4.653"
	4.151"
COD	6.050"
	5.563"
Weight	20 lb/ft
	18 lb/ft
Grade	HCL-80 BTC
	HCL-80 LTC
Depth Set	0' – 11,826'
	11,826' – 16,483'

Tubing will be lined with Duoline.

4. Packer Description

Nickel Plated Double Grip Retrievable Packer or Equivalent

B. Completion Information

1. Injection Formation: Devonian, Fusselman
2. Gross Injection Interval: 16,533'-18,333'

Completion Type: Open Hole

3. Drilled for injection.
4. See the attached wellbore schematic.
5. Oil and Gas Bearing Zones within area of well:

Formation	Depth
Bell Canyon	3,721'
Cherry Canyon	4,627'
Brushy Canyon	5,877'
Bone Spring	7,574'
Wolfcamp	12,126'
Strawn	13,544'
Atoka	13,679'
Morrow	14,354'

VI. Area of Review

No wells within the area of review penetrate the proposed injection zone.

VII. Proposed Operation Data

1. Proposed Daily Rate of Fluids to be Injected:

Average Volume: 30,000 BPD
Maximum Volume: 40,000 BPD

2. Closed System
3. Anticipated Injection Pressure:

Average Injection Pressure: 2,480 PSI (surface pressure)
Maximum Injection Pressure: 3,307 PSI (surface pressure)

4. The injection fluid is to be locally produced water. It is expected that the source water will predominantly be from the Avalon, Bone Spring, and Delaware formations. Attached are produced water sample analyses taken from the closest wells that feature samples from the Avalon, Bone Spring, Delaware, Morrow, and Wolfcamp.
5. The disposal interval is non-productive. No water samples are available from the surrounding area.

VIII. Geological Data

Devonian Formation Lithology:

The Devonian formation is a dolomitic ramp carbonate that occurs below the Woodford shale and above the Fusselman formation. Strata found in the Devonian formation include two major groups, the Wristen Buildups and the Thirtyone Deepwater Chert, with the Wristen being more abundant. The Wristen Groups is composed of mixed limestone and dolomites with mudstone to grainstone and boundstone textures. Porosity in the Wristen group is a result of both primary and secondary development. Present are moldic, vugular, karstic (including collapse breccia) features that allow for higher porosities and permeabilities. The Thirtyone Formation contains two end-member reservoir facies, skeletal packstones/grainstones and spiculitic chert, with most of the porosity and permeability found in the coarsely crystalline cherty dolomite. These particular characteristics allow for this formation to be a tremendous Salt Water Disposal horizon.

Fusselman Formation Lithology:

The Silurian/Ordovician Fusselman Formation is stratigraphically below the Wristen Group and is above and separated from the Montoya Formation by the Sylvan Shale. The Sylvan Shale is the lower confining layer for the proposed Trivette Fed SWD No. 1 well. Fusselman facies include a laminated skeletal wackestone in the upper part and a buildup complex in the lower part composed of ooid and bryozoan grainstones. These grainstones can also be potentially prolific zones for disposal.

A. Injection Zone: Devonian-Silurian Formation

Formation	Depth
Rustler	1,001'
Salado (Top of Salt)	1,264'
Lamar	3,698'
Bell Canyon	3,721'
Cherry Canyon	4,627'
Brushy Canyon	5,877'
Bone Spring	7,574'
Wolfcamp	12,126'
Strawn	13,544'
Atoka	13,679'
Morrow	14,354'
Mississippian Lime	16,196'
Woodford	16,409'
Devonian	16,533'

B. Underground Sources of Drinking Water

No water wells exist within a one-mile radius of the proposed well. Water wells outside a one-mile radius in the surrounding area have an average depth of 635 feet and an average water depth of 226 feet generally producing from the Carlsbad Basin. The upper Rustler may also be another USDW and will be isolated from the Salado by setting 16" surface casing at 1,239 feet.

IX. Proposed Stimulation Program

50,000 gallon acid job

X. Logging and Test Data on the Well

There are no logs or test data on the well. During the process of drilling and completion resistivity, gamma ray, and density logs will be run.

XI. Chemical Analysis of Fresh Water Wells

Because there are no water wells that exist within a one-mile radius of the proposed well, chemical analysis of fresh water wells were not retrieved for the proposed well.