

# Initial Application Part I

Received: 08/23/2019

*This application is placed in file for record. It MAY or MAY NOT have been reviewed to be determined Administratively Complete*

RECEIVED: 08/23/2019	REVIEWER:	TYPE: SWD	APP NO: pMAM1923556526
----------------------	-----------	-----------	------------------------

ABOVE THIS TABLE FOR OCD DIVISION USE ONLY

**NEW MEXICO OIL CONSERVATION DIVISION**  
 - Geological & Engineering Bureau -  
 1220 South St. Francis Drive, Santa Fe, NM 87505

**ADMINISTRATIVE APPLICATION CHECKLIST**

THIS CHECKLIST IS MANDATORY FOR ALL ADMINISTRATIVE APPLICATIONS FOR EXCEPTIONS TO DIVISION RULES AND  
 REGULATIONS WHICH REQUIRE PROCESSING AT THE DIVISION LEVEL IN SANTA FE

**Applicant:** DJR Operating, LLC **OGRID Number:** 371838  
**Well Name:** North Alamito WDW #1 **API:** \_\_\_\_\_  
**Pool:** SWD;Entrada **Pool Code:** 96436

**SUBMIT ACCURATE AND COMPLETE INFORMATION REQUIRED TO PROCESS THE TYPE OF APPLICATION  
 INDICATED BELOW**

**1) TYPE OF APPLICATION:** Check those which apply for [A]**SWD-2255**

A. Location – Spacing Unit – Simultaneous Dedication

☐ NSL      ☐ NSP (PROJECT AREA)      ☐ NSP (PRORATION UNIT)      ☐ SD

B. Check one only for [I] or [II]

[I] Commingling – Storage – Measurement

☐ DHC    ☐ CTB    ☐ PLC    ☐ PC    ☐ OLS    ☐ OLM

[II] Injection – Disposal – Pressure Increase – Enhanced Oil Recovery

☐ WFX    ☐ PMX    ☒ SWD    ☐ IPI    ☐ EOR    ☐ PPR
**2) NOTIFICATION REQUIRED TO:** Check those which apply.

- A. ☒ Offset operators or lease holders  
 B. ☐ Royalty, overriding royalty owners, revenue owners  
 C. ☐ Application requires published notice  
 D. ☐ Notification and/or concurrent approval by SLO  
 E. ☐ Notification and/or concurrent approval by BLM  
 F. ☒ Surface owner  
 G. ☒ For all of the above, proof of notification or publication is attached, and/or,  
 H. ☐ No notice required

**FOR OCD ONLY**

- ☐ Notice Complete  
☐ Application  
 Content  
 Complete

- 3) CERTIFICATION:** I hereby certify that the information submitted with this application for administrative approval is **accurate** and **complete** to the best of my knowledge. I also understand that **no action** will be taken on this application until the required information and notifications are submitted to the Division.

**Note: Statement must be completed by an individual with managerial and/or supervisory capacity.**

**Ningning Li**

Print or Type Name

Signature

8/15/2019

Date

303-407-7390

Phone Number

nli@djrlc.com

e-mail Address



August 15, 2019

Mr. Will Jones  
New Mexico Oil Conservation Division – Engineering Bureau  
1200 South St. Francis St.  
Santa Fe, NM 87505

Re: Application for North Alamito WDW #1, San Juan Co., NM

Dear Mr. Jones:

Enclosed is DJR Operating, LLC's application for disposal of produced water in the North Alamito WDW #1. In fulfilling the requirements of the application, the following materials are provided herein.

1. Form C-108, Application for Authorization to Inject
2. Tabular and schematic data on proposed injection well
3. Two-mile radius map identifying all wells with a one-half mile radius drawn around the proposed injection well
4. Data sheet of all wells within 2-miles of proposed injection well, highlighting those wells inside one-half mile radius of the proposed injection well
5. Lease and surface owner maps identifying all lessees and surface owners within a two-mile radius with one-half mile radius drawn around the proposed injection well
6. Operations plan for proposed injection well
7. Water analysis of produced water to be disposed in injection well
8. Required geologic, stimulation, logging, test and fresh water data from nearby wells
9. Signed statement of geologic and engineering data
10. Proof of notice in the form of notification letters sent to offsetting operators and surface owners and a copy of the Affidavit of Publication of the notice as it appeared in the Farmington Daily Times.

If you have questions or require additional information, please contact me.

Sincerely,

A handwritten signature in black ink, appearing to read 'Ningning Li', with a small flourish at the end.

Ningning Li  
Completions Manager

Attachments



**APPLICATION FOR AUTHORIZATION TO INJECT**

- I. PURPOSE: \_\_\_\_\_ Secondary Recovery \_\_\_\_\_ Pressure Maintenance \_\_\_\_\_ XX \_\_\_\_\_ Disposal \_\_\_\_\_ Storage  
Application qualifies for administrative approval? \_\_\_\_\_ Yes \_\_\_\_\_ No
- II. OPERATOR: DJR Operating, LLC  
ADDRESS: 1600 Broadway, Suite 1960, Denver, CO 80202  
CONTACT PARTY: Ningning Li PHONE: 303-407-7390
- III. WELL DATA: Complete the data required on the reverse side of this form for each well proposed for injection.  
Additional sheets may be attached if necessary.
- IV. Is this an expansion of an existing project? \_\_\_\_\_ Yes \_\_\_\_\_ XX \_\_\_\_\_ No  
If yes, give the Division order number authorizing the project: \_\_\_\_\_
- V. Attach a map that identifies all wells and leases within two miles of any proposed injection well with a one-half mile radius circle drawn around each proposed injection well. This circle identifies the well's area of review.
- VI. Attach a tabulation of data on all wells of public record within the area of review which penetrate the proposed injection zone. Such data shall include a description of each well's type, construction, date drilled, location, depth, record of completion, and a schematic of any plugged well illustrating all plugging detail.
- VII. Attach data on the proposed operation, including:
1. Proposed average and maximum daily rate and volume of fluids to be injected;
  2. Whether the system is open or closed;
  3. Proposed average and maximum injection pressure;
  4. Sources and an appropriate analysis of injection fluid and compatibility with the receiving formation if other than reinjected produced water; and,
  5. If injection is for disposal purposes into a zone not productive of oil or gas at or within one mile of the proposed well, attach a chemical analysis of the disposal zone formation water (may be measured or inferred from existing literature, studies, nearby wells, etc.).
- \*VIII. Attach appropriate geologic data on the injection zone including appropriate lithologic detail, geologic name, thickness, and depth. Give the geologic name, and depth to bottom of all underground sources of drinking water (aquifers containing waters with total dissolved solids concentrations of 10,000 mg/l or less) overlying the proposed injection zone as well as any such sources known to be immediately underlying the injection interval.
- IX. Describe the proposed stimulation program, if any.
- \*X. Attach appropriate logging and test data on the well. (If well logs have been filed with the Division, they need not be resubmitted).
- \*XI. Attach a chemical analysis of fresh water from two or more fresh water wells (if available and producing) within one mile of any injection or disposal well showing location of wells and dates samples were taken.
- XII. Applicants for disposal wells must make an affirmative statement that they have examined available geologic and engineering data and find no evidence of open faults or any other hydrologic connection between the disposal zone and any underground sources of drinking water.
- XIII. Applicants must complete the "Proof of Notice" section on the reverse side of this form.
- XIV. Certification: I hereby certify that the information submitted with this application is true and correct to the best of my knowledge and belief.
- NAME: Ningning Li TITLE: Engineer  
SIGNATURE:  DATE: 8/15/2019  
E-MAIL ADDRESS: nli@djrlc.com
- \* If the information required under Sections VI, VIII, X, and XI above has been previously submitted, it need not be resubmitted. Please show the date and circumstances of the earlier submittal: \_\_\_\_\_

### III. WELL DATA

A. The following well data must be submitted for each injection well covered by this application. The data must be both in tabular and schematic form and shall include:

- (1) Lease name; Well No.; Location by Section, Township and Range; and footage location within the section.
- (2) Each casing string used with its size, setting depth, sacks of cement used, hole size, top of cement, and how such top was determined.
- (3) A description of the tubing to be used including its size, lining material, and setting depth.
- (4) The name, model, and setting depth of the packer used or a description of any other seal system or assembly used.

Division District Offices have supplies of Well Data Sheets which may be used or which may be used as models for this purpose. Applicants for several identical wells may submit a "typical data sheet" rather than submitting the data for each well.

B. The following must be submitted for each injection well covered by this application. All items must be addressed for the initial well. Responses for additional wells need be shown only when different. Information shown on schematics need not be repeated.

- (1) The name of the injection formation and, if applicable, the field or pool name.
- (2) The injection interval and whether it is perforated or open-hole.
- (3) State if the well was drilled for injection or, if not, the original purpose of the well.
- (4) Give the depths of any other perforated intervals and detail on the sacks of cement or bridge plugs used to seal off such perforations.
- (5) Give the depth to and the name of the next higher and next lower oil or gas zone in the area of the well, if any.

### XIV. PROOF OF NOTICE

All applicants must furnish proof that a copy of the application has been furnished, by certified or registered mail, to the owner of the surface of the land on which the well is to be located and to each leasehold operator within one-half mile of the well location.

Where an application is subject to administrative approval, a proof of publication must be submitted. Such proof shall consist of a copy of the legal advertisement which was published in the county in which the well is located. The contents of such advertisement must include:

- (1) The name, address, phone number, and contact party for the applicant;
- (2) The intended purpose of the injection well; with the exact location of single wells or the Section, Township, and Range location of multiple wells;
- (3) The formation name and depth with expected maximum injection rates and pressures; and,
- (4) A notation that interested parties must file objections or requests for hearing with the Oil Conservation Division, 1220 South St. Francis Dr., Santa Fe, New Mexico 87505, within 15 days.

NO ACTION WILL BE TAKEN ON THE APPLICATION UNTIL PROPER PROOF OF NOTICE HAS BEEN SUBMITTED.

---

NOTICE: Surface owners or offset operators must file any objections or requests for hearing of administrative applications within 15 days from the date this application was mailed to them.

Application for Authorization to Inject

DJR Operating, LLC

**North Alamito WDW #1**

General Information

DJR Operating, LLC is hereby making an application for administrative approval to dispose of produced water by underground injection. The proposed disposal site is the North Alamito Unit WDW #1 well located 908' FNL & 1176' FEL in Section 1, Township 22 North, Range 8 West, San Juan County, New Mexico. Produced water will be injected into the Entrada Sandstone between 6875' and 7070'. The maximum injection pressure will be 1300-psi and the maximum injection rate will be 6000 barrels of water daily.

The well is a new drill for the purpose of salt water disposal. The well is in the process of being permitted and is awaiting SWD application approval to commence drilling. Upon approval of this application, an injection test will be conducted. If adequate rates are not found, it may be necessary to stimulate the proposed injection zone or perforate additional zones in the well.

Any change to the plans contained herein will be approved by the New Mexico Oil Conservation Division prior to implementation.



Application for Authorization to Inject

DJR Operating, LLC

**North Alamito WDW #1**

Part III. Well Data

A. Tabular Information

1. Name: North Alamito WDW #1

Location: 908' FNL & 1176' FEL  
Sec. 1, T22N, R8W  
San Juan County, NM

2. Surface Casing:

9-5/8 in, 36 lb, J-55 set at 500 ft, ST&C coupling, Cemented with 253 sx (352 cu ft). Circulate cement to surface, Hole size – 12-1/4 in.

Production Casing:

7 in, 26 lb, N-80 (7070 ft) set at 7070 ft., LT&C coupling, Cement in two stages with stage tool (DV) at 3795 ft using 739 cu ft (626 cu ft 1<sup>st</sup> stage and 113 cu ft in 1<sup>st</sup> tail) in first stage and 739 (626 2<sup>nd</sup> stage and 113 in 2<sup>nd</sup> tail) cubic ft in second stage. Hole size – 8-3/4 in.

Injection Tubing:

3-1/2 in J-55 EUE 9.3 lb/ft Internally Coated Tubing set at 6885 ft.

Packer:

7 in by 3 1/2 in AS1-X packer 10K nickel coated, will be set in tension at 6825 ft or 50 ft above the upper most perforation.

B. Additional Information

1. Injection Interval: Entrada Sandstone
2. The injection interval (Entrada 6875' – 7070') will be perforated.
3. The well (North Alamito WDW #1) will be drilled for the purpose of injection into the Entrada Sandstone.
4. Only the injection interval is to be perforated.
5. Fruitland Coal / Pictured Cliffs Sandstone-Approx. 1025' – 1459', Gallup-Approx. 4515'-5624' and Dakota Sandstone-Approx. 5775'.

**Injection Well Data Sheet**  
**Operator: DJR Operating LLC**  
**Well Name and Number: North Alamito WDW No. 1**

	<b>WELL NAME:</b> North Alamito Unit WDW #1 <b>API NO:</b> <b>TVD:</b> 7050'	<b>STATE:</b> New Mexico <b>COUNTY:</b> San Juan	<b>LOCATION:</b> 908' FNL & 1176' FEL ULA Sec 1 T22N R8W <b>TARGET FORMATION:</b> Entrada				
	<b>CASING DATA and OTHER TOOLS</b>						
		OD	WT/FT	GRADE	THREAD	TOP	EOC
	Srf Csg	9.625"	36.00 lb/ft	J-55	STC	0'	500'
Prod Liner	7.00"	26.00 lb/ft	L-80	LT&C	0'	7070'	
DV Tool					3795'		
Packer	7" by 3 1/2"						
	AS 1-X 10K Nickel coated						
<b>Geology</b>			<b>Cement</b>				
Formation	Tops	Subsea	TVD	MD	O/G/W	Pressure	
Ojo Alamo	6110		725	725	W	normal	
Kirtland	6070		765	765	W	normal	
Fruitland	5810		1025	1025	G/W	sub-normal	
Pictured Cliffs	5555		1280	1280	G/W	sub-normal	
Lewis	5375		1460	1460	G/W	normal	
Chacra	4800		2035	2035	G/W	normal	
Cliff House	4105		2730	2730	G/W	sub-normal	
Menefee	4070		2765	2765	G/W	normal	
Point Lookout	3160		3675	3675	G/W	normal	
Mancos	2990		3845	3845	O/G	normal	
Gallup	2320		4515	4515	O/G	normal	
Greenhorn	1210		5625	5625	O/G/W	normal	
Dakota	1060		5775	5775	O/G/W	normal	
Todilto	20		6815	6815	G/W	normal	
Entrada	-40		6875	6875	W	normal	
Total Depth	-235		7070	7070			
<b>Tubing and Packer</b>							
Size	Tubing Depth	Packer Depth					
3.500"	6855'	6825'					
			SX	WT.			
Surface	Tail only		253	14.6 ppg	125% Excess over gauge		
Production							
1st Stage	Lead		314	12.5 ppg	50% Excess over gauge		
1st Stage	Tail		82	14.6 ppg			
2nd Stage	Lead		373	12.5 ppg			
2nd Stage	Tail		82	14.6 ppg			
Total			851				



### INJECTION WELL DATA SHEET

**Tubing Size:**

**Surface Casing:**

9-5/8 in, 36 lb, J-55 set at 500 ft, ST&C coupling, Cemented with 253 sx (352 cu ft). Circulate cement to surface, Hole size – 12-1/4 in.

**Production Casing:**

7 in, 26 lb, N-80 (7070 ft) set at 7070 ft., LT&C coupling, Cement in two stages with stage tool (DV) at 3795 ft using 739 cu ft (626 cu ft 1<sup>st</sup> stage and 113 cu ft in 1<sup>st</sup> tail) in first stage and 739 (626 2<sup>nd</sup> stage and 113 in 2<sup>nd</sup> tail) cubic ft in second stage. Hole size – 8-3/4 in.

**Injection Tubing:**

3-1/2 in J-55 EUE 9.3 lb/ft Internally Coated Tubing

**Type of Packer:**

7 in by 3 1/2 in AS1-X packer 10K nickel coated,

**Packer Setting Depth:**

Set in tension at 6825 ft or 50 ft above the upper most perforation.

Other Type of Tubing/Casing Seal (If applicable): -NA-

### Additional Data

1. Is this a new well drilled for injection:   X   Yes    No  
If no, for what purpose was the well originally drilled?
2. Name of Injection Formation: Entrada Sandstone
3. Name of Field or Pool (If applicable): NA
4. Has the well ever been perforated in other zone(s)   No  
List all such Perforated intervals and give plugging detail, i.e. Sacks of cement or plug(s) used:  
NA
5. Give the name and depths of any oil or gas zones underlying or overlying the proposed injection zone in this area: Fruitland Formation-1025', Picture Cliffs-1280', Mancos Shale-3845', Gallup Sandstone-4515', Dakota Sandstone-5775'

8W | 7W

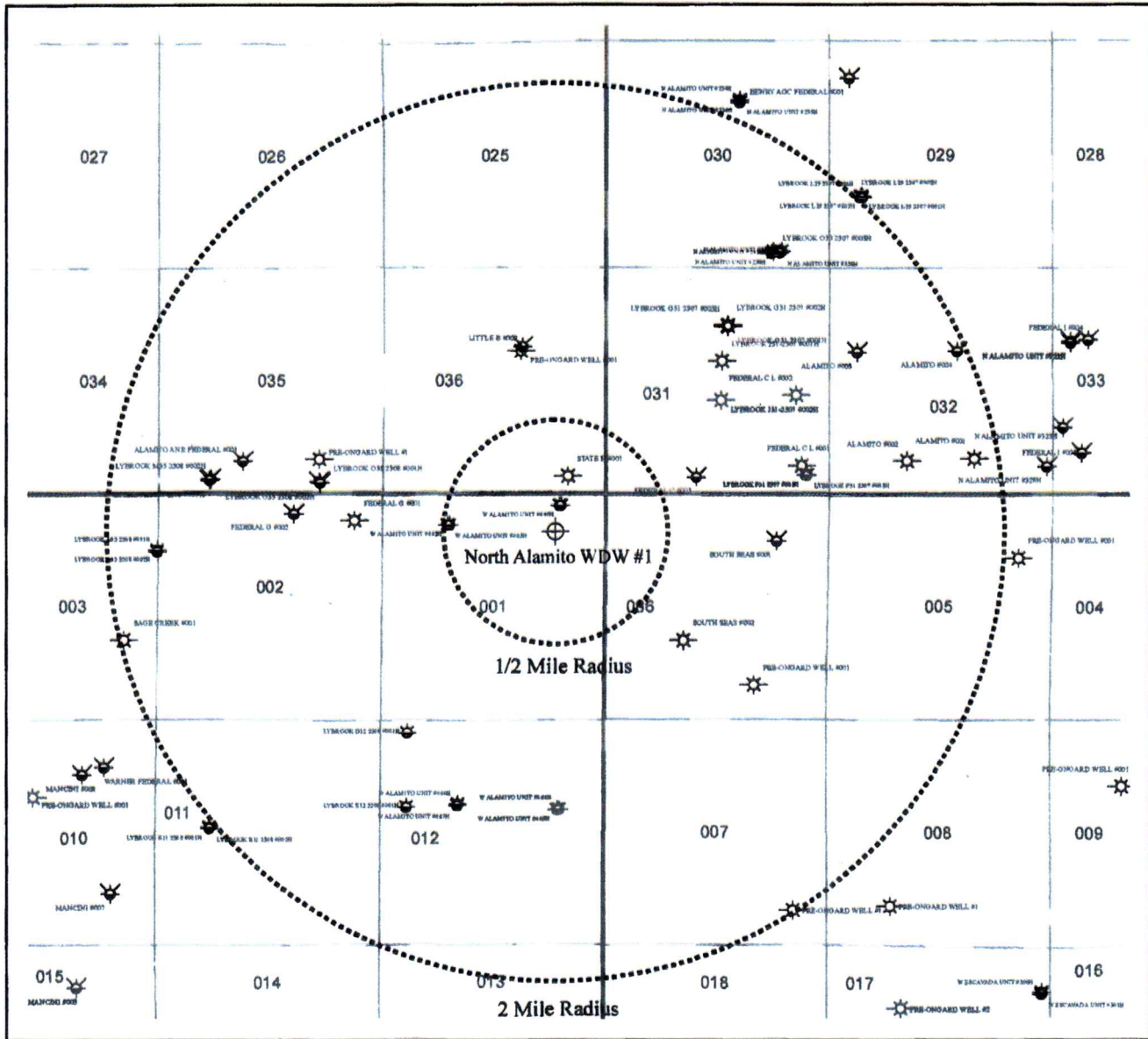

## 2 Mile Radius Map - Legend



1/2 Mile Radius

2 Mile Radius



Suspended, Cancelled, Plugged



New, Active



North Alamo Unit WDW

 DJR Operating, LLC

Township 22 North, Range 7 West  
 Township 23 North, Range 7 West  
 Sandoval County, NM  
 Township 22 North, Range 8 West  
 Township 23 North, Range 8 West  
 San Juan County, NM

8W | 7W

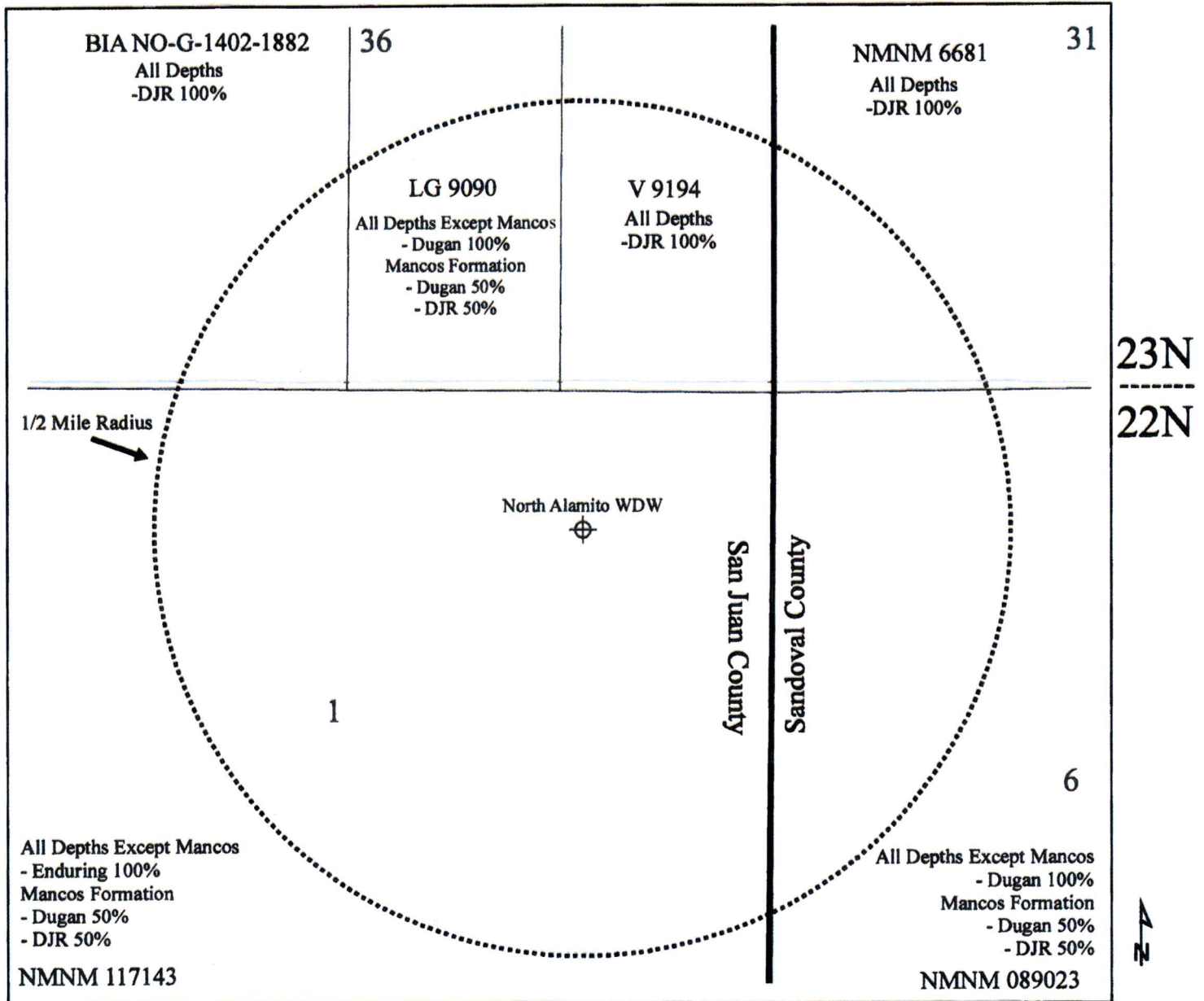

C-108 Application to Inject  
 North Alamito Unit WDW #1  
 Part V. b.  
 Lease Ownership Map

Township 22 North, Range 7 West  
Township 23 North, Range 7 West  
Sandoval County, NM  
Township 22 North, Range 8 West  
Township 23 North, Range 8 West  
San Juan County, NM

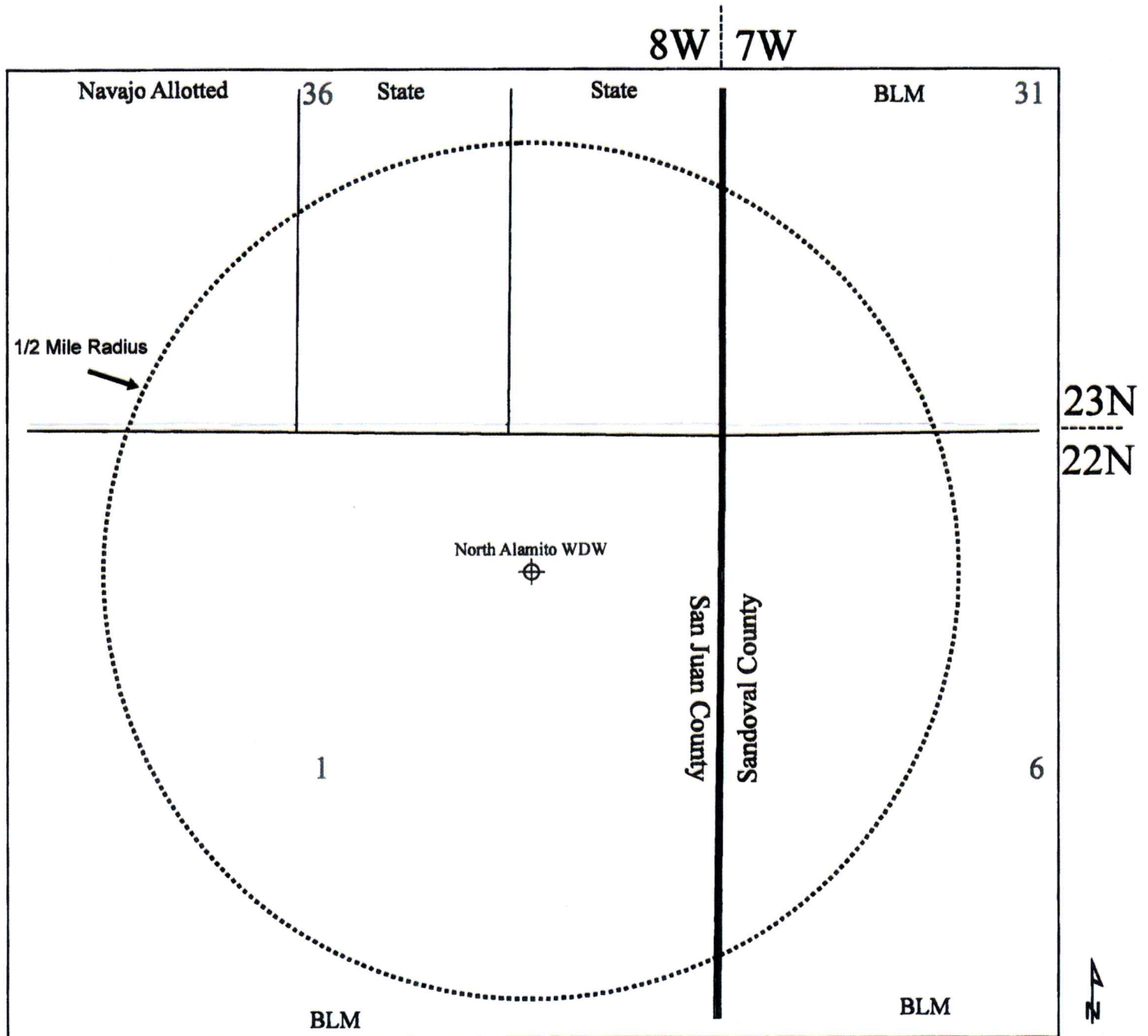

C-108 Application to Inject  
North Alamo Unit WDW #1  
Part V. c.  
Surface Ownership Map

 DJR Operating, LLC



Application for Authorization to Inject

DJR Operating, LLC

**North Alamito WDW #1**

Part VI. Data on Offset Wells

There are no wells within the ½ mile area of review which penetrate the proposed injection zone. There are also no plugged wells in the ½ mile radius of the proposed injection well.

## North Alamito WDW #1 - Data Sheet of All Wells Within 2 Miles

API	Well Name	Well Number	Type	Mineral Owner	Surface Owner	Status	Sec	Township	Range	OCD Unit Letter	Last Production	Spud Date	Plugged On	Current Operator
30-043-21229	LYBROOK P31 2307	#001H	Gas	Federal		New	31	23N	07W	P	1/1800			[371838] DJR OPERATING, LLC
30-043-21228	LYBROOK P31 2307	#003H	Gas	Federal		New	31	23N	07W	P	1/1800			[371838] DJR OPERATING, LLC
30-043-21217	LYBROOK G31 2307	#001H	Gas	Federal	Navajo	Plugged, Site Released	31	23N	07W	G	1/1800		12/9/2015	[282327] ENCANA OIL & GAS (USA) INC.
30-043-21216	LYBROOK G31 2307	#002H	Gas	Federal		Plugged, Site Released	31	23N	07W	G	1/1800		12/9/2015	[282327] ENCANA OIL & GAS (USA) INC.
30-043-21218	LYBROOK G31 2307	#003H	Gas	Federal		Plugged, Site Released	31	23N	07W	G	1/1800		12/9/2015	[282327] ENCANA OIL & GAS (USA) INC.
30-043-21214	LYBROOK J31-2307	#001H	Gas	Federal	Navajo	Plugged, Site Released	31	23N	07W	J	1/1800		12/9/2015	[282327] ENCANA OIL & GAS (USA) INC.
30-043-21215	LYBROOK J31-2307	#002H	Oil	Federal	Navajo	Plugged, Site Released	31	23N	07W	J	1/1800		12/9/2015	[282327] ENCANA OIL & GAS (USA) INC.
30-043-20826	FEDERAL C	#003	Oil	Federal		Active	31	23N	07W	N		May-19	7/12/1988	[372834] EPIC ENERGY, L.L.C.
30-043-05164	FEDERAL C L	#001	Oil	Federal		Plugged, Site Released	31	23N	07W	P		Apr-04	7/26/1978	11/17/2004 [23846] QEP ENERGY COMPANY
30-043-20081	FEDERAL C L	#002	Oil	Federal		Plugged, Site Released	31	23N	07W	I		Feb-95	7/26/1978	5/10/2002 [23846] QEP ENERGY COMPANY
30-043-21235	N ALAMITO UNIT	#234H	Oil	Federal	Indian	New	30	23N	07W	G	1/1800			[371838] DJR OPERATING, LLC
30-043-21236	N ALAMITO UNIT	#235H	Oil	Federal	Indian	New	30	23N	07W	G	1/1800			[371838] DJR OPERATING, LLC
30-043-21237	N ALAMITO UNIT	#236H	Oil	Federal	Indian	New	30	23N	07W	G	1/1800			[371838] DJR OPERATING, LLC
30-043-21211	N ALAMITO UNIT	#238H	Oil	Federal	Indian	New	30	23N	07W	O	1/1800			[371838] DJR OPERATING, LLC
30-043-21210	N ALAMITO UNIT	#239H	Oil	Federal	Indian	New	30	23N	07W	O	1/1800			[371838] DJR OPERATING, LLC
30-043-21267	N ALAMITO UNIT	#240H	Oil	Federal	Indian	New	30	23N	07W	P	1/1800			[371838] DJR OPERATING, LLC
30-043-21268	N ALAMITO UNIT	#241H	Oil	Federal	Indian	New	30	23N	07W	O	1/1800			[371838] DJR OPERATING, LLC
30-043-21198	N ALAMITO UNIT	#328H	Oil	State		Active	32	23N	07W	P		Jun-19	9/3/2014	[371838] DJR OPERATING, LLC
30-043-20814	ALAMITO	#003	Oil	State		Active	32	23N	07W	E		May-19	8/21/1987	[372834] EPIC ENERGY, L.L.C.
30-043-20815	ALAMITO	#004	Oil	State		Active	32	23N	07W	G		May-19	8/28/1987	[372834] EPIC ENERGY, L.L.C.
30-043-20807	ALAMITO	#001	Gas	State		Plugged, Site Released	32	23N	07W	O		Aug-89	8/16/1986	2/21/1996 [23846] QEP ENERGY COMPANY
30-043-20816	ALAMITO	#002	Oil	State		Plugged, Site Released	32	23N	07W	N		Feb-05	8/14/1987	5/12/2011 [23846] QEP ENERGY COMPANY
30-045-35713	W ALAMITO UNIT	#460H	Oil	Federal	Indian	New	1	22N	08W	A	1/1800			[372286] ENDURING RESOURCES, LLC
30-045-35714	W ALAMITO UNIT	#461H	Oil	Federal	Indian	New	1	22N	08W	A	1/1800			[372286] ENDURING RESOURCES, LLC
30-045-35716	W ALAMITO UNIT	#462H	Oil	Federal	Indian	New	1	22N	08W	C	1/1800			[372286] ENDURING RESOURCES, LLC
30-045-35715	W ALAMITO UNIT	#463H	Oil	Federal	Indian	New	1	22N	08W	C	1/1800			[372286] ENDURING RESOURCES, LLC
30-045-26912	FEDERAL G	#002	Oil	Federal		Active	2	22N	08W	B		May-19	7/5/1988	[372834] EPIC ENERGY, L.L.C.
30-045-05067	FEDERAL G	#001	Oil	Federal		Plugged, Site Released	2	22N	08W	A		Jun-09	7/24/1978	6/24/2009 [23846] QEP ENERGY COMPANY
30-045-35669	LYBROOK A03 2208	#001H	Gas	Federal	Indian	New	3	22N	08W	A	1/1800			[371838] DJR OPERATING, LLC
30-045-35668	LYBROOK A03 2208	#002H	Gas	Federal	Indian	New	3	22N	08W	A	1/1800			[371838] DJR OPERATING, LLC
30-045-26757	SAGE CREEK	#001	Oil	Federal		Plugged, Site Released	3	22N	08W	I		Feb-03	10/8/1986	6/8/2009 [6515] DUGAN PRODUCTION CORP
30-045-34429	SATCHMO COM	#001	Gas	Federal		Active	3	22N	08W	N		May-19	12/12/2007	[6515] DUGAN PRODUCTION CORP
30-045-35670	LYBROOK D12 2208	#001H	Gas	Federal	Indian	New	12	22N	08W	D	1/1800			[371838] DJR OPERATING, LLC
30-045-35664	LYBROOK E12 2208	#001H	Gas	Federal		New	12	22N	08W	E	1/1800			[371838] DJR OPERATING, LLC
30-045-35717	W ALAMITO UNIT	#464H	Oil	Federal	Indian	New	12	22N	08W	H	1/1800			[372286] ENDURING RESOURCES, LLC
30-045-35718	W ALAMITO UNIT	#465H	Oil	Federal	Indian	New	12	22N	08W	H	1/1800			[372286] ENDURING RESOURCES, LLC
30-045-35719	W ALAMITO UNIT	#466H	Oil	Federal	Indian	New	12	22N	08W	F	1/1800			[372286] ENDURING RESOURCES, LLC
30-045-35720	W ALAMITO UNIT	#467H	Oil	Federal	Indian	New	12	22N	08W	F	1/1800			[372286] ENDURING RESOURCES, LLC
30-045-35526	LYBROOK M35 2308	#001H	Oil	Federal		Active	35	23N	08W	M		19-Jun	9/25/2014	[371838] DJR OPERATING, LLC
30-045-35527	LYBROOK M35 2308	#002H	Oil	Federal		Active	35	23N	08W	N		19-Jun	10/6/2014	[371838] DJR OPERATING, LLC
30-045-35525	LYBROOK O35 2308	#001H	Oil	Federal	Indian	Active	35	23N	08W	O		19-Jun	10/27/2014	[371838] DJR OPERATING, LLC
30-045-35524	LYBROOK O35 2308	#002H	Oil	Federal		Active	35	23N	08W	O		19-Jun	10/15/2014	[371838] DJR OPERATING, LLC
30-045-28989	ALAMITO ANR FEDER.	#001	Oil	Federal		Active	35	23N	08W	N		19-May	10/2/1993	[6515] DUGAN PRODUCTION CORP
30-045-28333	LITTLE B	#002	Gas	State		Active	36	23N	08W	G		19-May	11/23/1990	[6515] DUGAN PRODUCTION CORP
30-045-28665	STATE K	#001	Oil	State		Plugged, Site Released	36	23N	08W	P		9-May	5/23/1992	6/29/2009 [282327] ENCANA OIL & GAS (USA) INC.
30-045-27855	PRE-ONGARD WELL	#001	Gas	State		Plugged, Site Released	36	23N	08W	G	1/1800			12/31/1901 [214263] PRE-ONGARD WELL OPERATOR
30-043-20897	SOUTH SEAS	#001	Gas	Federal		Active	6	22N	07W	A		19-May	7/30/1993	[6515] DUGAN PRODUCTION CORP
30-043-20914	SOUTH SEAS	#002	Gas	Federal		Plugged, Site Released	6	22N	07W	K		10-Oct	4/29/1994	3/6/2012 [6515] DUGAN PRODUCTION CORP
30-043-20361	PRE-ONGARD WELL	#001	Oil	Federal		Plugged, Site Released	6	22N	07W	O	1/1800			8/25/1979 [214263] PRE-ONGARD WELL OPERATOR

\* Wells in bold type are located within the 1/2 Mile Area of Review