

SWD Initial Application

Received: 09/23/19

RECEIVED: 9/23/19	REVIEWER:	TYPE: SWD	APP NO: pLEL1926953359
--------------------------	-----------	------------------	-------------------------------

ABOVE THIS TABLE FOR OCD DIVISION USE ONLY

NEW MEXICO OIL CONSERVATION DIVISION
 - Geological & Engineering Bureau -
 1220 South St. Francis Drive, Santa Fe, NM 87505



ADMINISTRATIVE APPLICATION CHECKLIST

THIS CHECKLIST IS MANDATORY FOR ALL ADMINISTRATIVE APPLICATIONS FOR EXCEPTIONS TO DIVISION RULES AND REGULATIONS WHICH REQUIRE PROCESSING AT THE DIVISION LEVEL IN SANTA FE

Applicant: Select Energy Services **OGRID Number:** 289068
Well Name: Jerrah 1 Federal SWD #2 **API:** _____
Pool: SWD; DEVONIAN - SILURIAN **Pool Code:** 97869

SUBMIT ACCURATE AND COMPLETE INFORMATION REQUIRED TO PROCESS THE TYPE OF APPLICATION INDICATED BELOW

- 1) **TYPE OF APPLICATION:** Check those which apply for [A]
- A. Location – Spacing Unit – Simultaneous Dedication
☐ NSL ☐ NSP (PROJECT AREA) ☐ NSP (PRORATION UNIT) ☐ SD
- B. Check one only for [I] or [II]
- [I] Commingling – Storage – Measurement
☐ DHC ☐ CTB ☐ PLC ☐ PC ☐ OLS ☐ OLM
- [II] Injection – Disposal – Pressure Increase – Enhanced Oil Recovery
☐ WFX ☐ PMX ☒ SWD ☐ IPI ☐ EOR ☐ PPR
- 2) **NOTIFICATION REQUIRED TO:** Check those which apply.
- A. ☒ Offset operators or lease holders
 B. ☐ Royalty, overriding royalty owners, revenue owners
 C. ☒ Application requires published notice
 D. ☒ Notification and/or concurrent approval by SLO
 E. ☒ Notification and/or concurrent approval by BLM
 F. ☒ Surface owner
 G. ☒ For all of the above, proof of notification or publication is attached, and/or,
 H. ☐ No notice required

FOR OCD ONLY

- ☐ Notice Complete
☐ Application Content Complete

- 3) **CERTIFICATION:** I hereby certify that the information submitted with this application for administrative approval is **accurate** and **complete** to the best of my knowledge. I also understand that **no action** will be taken on this application until the required information and notifications are submitted to the Division.

Note: Statement must be completed by an individual with managerial and/or supervisory capacity.

Nate Alleman

Print or Type Name

Nathan Alleman

Signature

09/23/2019

Date

918-382-7581

Phone Number

nalleman@all-llc.com

e-mail Address



September 23, 2019

Oil Conservation Division
1220 South St. Francis Dr.
Santa Fe, New Mexico 87505

Subject: Select Energy Services – Jerrah 1 Federal SWD #2
Application for Authorization to Inject

To Whom It May Concern,

On behalf of Select Energy Services (Select), ALL Consulting, LLC (ALL) is submitting the enclosed Application for Authorization to Inject for the Jerrah 1 Federal SWD #2, a proposed salt water disposal well, in Lea County, NM.

Should you have any questions regarding the enclosed application, please contact Nate Alleman at (918) 382-7581 or nalleman@all-llc.com.

Sincerely,
ALL Consulting

A handwritten signature in black ink that reads "Nathan Alleman".

Nate Alleman
Sr. Regulatory Specialist

APPLICATION FOR AUTHORIZATION TO INJECT

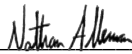
- I. PURPOSE: _____ Secondary Recovery _____ Pressure Maintenance X Disposal
_____ Storage Application qualifies for administrative approval? X Yes _____ No
- II. OPERATOR: Select Energy Services
ADDRESS: 1820 N I-35, Gainesville, TX 76240
CONTACT PARTY RJ Metzler PHONE: (940)-665-7000
- III. WELL DATA: Complete the data required on the reverse side of this form for each well proposed for injection.
Additional sheets may be attached if necessary.
- IV. Is this an expansion of an existing project? _____ Yes X No
If yes, give the Division order number authorizing the project: _____
- V. Attach a map that identifies all wells and leases within two miles of any proposed injection well with a one-half mile radius circle drawn around each proposed injection well. This circle identifies the well's area of review.
- VI. Attach a tabulation of data on all wells of public record within the area of review which penetrate the proposed injection zone. Such data shall include a description of each well's type, construction, date drilled, location, depth, record of completion, and a schematic of any plugged well illustrating all plugging detail.
- VII. Attach data on the proposed operation, including:
1. Proposed average and maximum daily rate and volume of fluids to be injected;
 2. Whether the system is open or closed;
 3. Proposed average and maximum injection pressure;
 4. Sources and an appropriate analysis of injection fluid and compatibility with the receiving formation if other than reinjected produced water; and,
 5. If injection is for disposal purposes into a zone not productive of oil or gas at or within one mile of the proposed well, attach a chemical analysis of the disposal zone formation water (may be measured or inferred from existing literature, studies, nearby wells, etc.).
- *VIII. Attach appropriate geologic data on the injection zone including appropriate lithologic detail, geologic name, thickness, and depth. Give the geologic name, and depth to bottom of all underground sources of drinking water (aquifers containing waters with total dissolved solids concentrations of 10,000 mg/l or less) overlying the proposed injection zone as well as any such sources known to be immediately underlying the injection interval.
- IX. Describe the proposed stimulation program, if any.
- *X. Attach appropriate logging and test data on the well. (If well logs have been filed with the Division, they need not be resubmitted).
- *XI. Attach a chemical analysis of fresh water from two or more fresh water wells (if available and producing) within one mile of any injection or disposal well showing location of wells and dates samples were taken.
- XII. Applicants for disposal wells must make an affirmative statement that they have examined available geologic and engineering data and find no evidence of open faults or any other hydrologic connection between the disposal zone and any underground sources of drinking water.
- XIII. Applicants must complete the "Proof of Notice" section on the reverse side of this form.
- XIV. Certification: I hereby certify that the information submitted with this application is true and correct to the best of my knowledge and belief.
NAME: Nate Alleman TITLE: Regulatory Specialist - ALL Consulting
- SIGNATURE:  DATE: 09/23/2019
- E-MAIL ADDRESS: nalleman@all-llc.com
- * If the information required under Sections VI, VIII, X, and XI above has been previously submitted, it need not be resubmitted. Please show the date and circumstances of the earlier submittal: _____

III. WELL DATA

A. The following well data must be submitted for each injection well covered by this application. The data must be both in tabular and schematic form and shall include:

- (1) Lease name; Well No.; Location by Section, Township and Range; and footage location within the section.
- (2) Each casing string used with its size, setting depth, sacks of cement used, hole size, top of cement, and how such top was determined.
- (3) A description of the tubing to be used including its size, lining material, and setting depth.
- (4) The name, model, and setting depth of the packer used or a description of any other seal system or assembly used.

Division District Offices have supplies of Well Data Sheets which may be used or which may be used as models for this purpose. Applicants for several identical wells may submit a "typical data sheet" rather than submitting the data for each well.

B. The following must be submitted for each injection well covered by this application. All items must be addressed for the initial well. Responses for additional wells need be shown only when different. Information shown on schematics need not be repeated.

- (1) The name of the injection formation and, if applicable, the field or pool name.
- (2) The injection interval and whether it is perforated or open-hole.
- (3) State if the well was drilled for injection or, if not, the original purpose of the well.
- (4) Give the depths of any other perforated intervals and detail on the sacks of cement or bridge plugs used to seal off such perforations.
- (5) Give the depth to and the name of the next higher and next lower oil or gas zone in the area of the well, if any.

XIV. PROOF OF NOTICE

All applicants must furnish proof that a copy of the application has been furnished, by certified or registered mail, to the owner of the surface of the land on which the well is to be located and to each leasehold operator within one-half mile of the well location.

Where an application is subject to administrative approval, a proof of publication must be submitted. Such proof shall consist of a copy of the legal advertisement which was published in the county in which the well is located. The contents of such advertisement must include:

- (1) The name, address, phone number, and contact party for the applicant;
- (2) The intended purpose of the injection well; with the exact location of single wells or the Section, Township, and Range location of multiple wells;
- (3) The formation name and depth with expected maximum injection rates and pressures; and,
- (4) A notation that interested parties must file objections or requests for hearing with the Oil Conservation Division, 1220 South St. Francis Dr., Santa Fe, New Mexico 87505, within 15 days.

NO ACTION WILL BE TAKEN ON THE APPLICATION UNTIL PROPER PROOF OF NOTICE HAS BEEN SUBMITTED.

NOTICE: Surface owners or offset operators must file any objections or requests for hearing of administrative applications within 15 days from the date this application was mailed to them.

Application for Authorization to Inject
Well Name: Jerrah 1 Federal SWD #2

III – Well Data *(The Wellbore Diagram is included as Attachment 1)*

A.

(1) General Well Information:

Operator: Select Energy Services (OGRID No. 289068)
Lease Name & Well Number: Jerrah 1 Federal SWD #2
Location Footage Calls: 1,002' FNL & 1,287' FWL
Legal Location: Unit Letter D, S17 T22S R32E
Ground Elevation: 3,776'
Proposed Injection Interval: 16,235' – 17,505'
County: Lea

(2) Casing Information:

Type	Hole Size	Casing Size	Casing Weight	Setting Depth	Sacks of Cement	Estimated TOC	Method Determined
Surface	24"	20"	133.0 lb/ft	835'	845	Surface	Circulation
Intermediate 1	14-3/4"	13-3/8"	68.0 lb/ft	4,850'	1,085	Surface	Circulation
Intermediate 2	12-1/4"	9-5/8"	53.5 lb/ft	13,320'	5,220	Surface	Circulation
Liner	8-1/2"	7-5/8"	39.0 lb/ft	16,235'	255	13,120'	CBL

(3) Tubing Information:

5.5" (composite weight string) fiberglass-coated tubing with setting depth of 16,215'

(4) Packer Information: Baker SC-2 or equivalent packer set at 16,215'

B.

(1) Injection Formation Name: Devonian and Silurian-Fusselman formations

Pool Name: SWD; DEVONIAN - SILURIAN

Pool Code: 97869

(2) Injection Interval: Open-hole between 16,235' – 17,505'

(3) Drilling Purpose: New Drill for Salt Water Disposal

(4) Other Perforated Intervals: No other perforated intervals exist.

(5) Overlying Oil and Gas Zones: Below are the approximate formation tops for known oil and gas producing zones in the area.

- Delaware (4,850')
- Bone Springs (8,725')
- Wolfcamp (11,760')
- Atoka (13,625')
- Morrow (14,105')

Underlying Oil and Gas Zones: No underlying oil and gas zones exist.

V – Well and Lease Maps

The following maps are included in **Attachment 2**:

- 2-mile Oil & Gas Well Map
- 2-mile Lease Map
- 1.5-mile Deep SWD Map (Devonian/Silurian SWDs)
- 1-mile Well Detail List
- Potash Lease Map

VI – AOR Well List

There are no wells within the 1-mile AOR that penetrate the proposed injection zone.

A list of the wells within the 1-mile AOR is included in **Attachment 2**.

VII – Proposed Operation

- (1) **Proposed Maximum Injection Rate:** 30,000 bpd
Proposed Average Injection Rate: 15,000 bpd
- (2) A **closed system** will be used.
- (3) **Proposed Maximum Injection Pressure:** 3,247 psi (surface)
Proposed Average Injection Pressure: approximately 1,500 – 2,000 psi (surface)
- (4) **Source Water Analysis:** It is expected that the injectate will consist of produced water from production wells completed in the Wolfcamp and Bone Springs formations. Analysis of water from these formations is included in **Attachment 3**.
- (5) **Injection Formation Water Analysis:** The proposed SWD will be injecting water into the Devonian and Silurian-Fusselman formations which is a non-productive zone known to be compatible with formation water from the Wolfcamp and Bone Springs formations. Water analyses from the Devonian-Silurian formation in the area are included in **Attachment 4**.

VIII – Geologic Description

The proposed injection interval includes the Devonian and Silurian-Fusselman formations from 16,235' – 17,505' feet. These formations consist of carbonates including light colored dolomite and chert intervals interspersed with some tight limestone intervals. Several thick sections of porous dolomite capable of taking water are present within the subject formations in the area.

The freshwater formation is the Rustler at a depth of approximately 810 feet. Water well depths in the area range from approximately 55 – 560 feet below ground surface.

IX – Proposed Stimulation Program

A small cleanup acid job may be used to remove mud and drill cuttings from the formation. However, no other formation stimulation is currently planned.

X – Logging and Test Data

Logs will be submitted to the Division upon completion of the well.

XI – Fresh Groundwater Samples

Based on a review of data from the New Mexico Office of the State Engineer, no groundwater wells are located within 1-mile of the proposed SWD location; therefore, no groundwater samples were collected in association with this application.

A water well map of the area is included in **Attachment 5**.

XII – No Hydrologic Connection Statement

No faulting is present in the area that would provide a hydrologic connection between the injection interval and overlying USDWs. Additionally, the casing program has been designed to ensure there will be no hydrologic connection between the injection interval and overlying USDWs. A letter from a knowledgeable and qualified expert stating that there is a low risk of seismic activity from the proposed injection activities is included in **Attachment 6**.

XIII – Proof of Notice

A Public Notice was filed with the Hobbs News-Sun newspaper and an affidavit is included in **Attachment 7**.

A copy of the application was mailed to the OCD District Office, landowner, and leasehold operators within 1-mile of the proposed SWD location. A list of the recipients, as well as delivery confirmations, are included in **Attachment 7**.

DISTRICT I
1625 N. French Dr., Hobbs, NM 88240
Phone: (575) 393-6161 Fax: (575) 393-0720

DISTRICT II
811 S. First St., Artesia, NM 88210
Phone: (575) 748-1283 Fax: (575) 748-9720

DISTRICT III
1000 Rio Brazos Rd., Aztec, NM 87410
Phone: (505) 334-6178 Fax: (505) 334-6170

DISTRICT IV
1220 S. St. Francis Dr., Santa Fe, NM 87505
Phone: (505) 476-3460 Fax: (505) 476-3462

State of New Mexico
Energy, Minerals & Natural Resources Department
OIL CONSERVATION DIVISION
1220 South St. Francis Dr.
Santa Fe, New Mexico 87505

Form C-102
Revised August 1, 2011

Submit one copy to appropriate
District Office

☐ AMENDED REPORT

WELL LOCATION AND ACREAGE DEDICATION PLAT

API Number	Pool Code 97869	Pool Name SWD; DEVONIAN - SILURIAN
Property Code	Property Name JERRAH 1 FEDERAL SWD	Well Number 2
OGRID No. 289068	Operator Name SELECT ENERGY SERVICES, LLC	Elevation 3775.95'

Surface Location

UL or lot no. D	Section 17	Township 22 S	Range 32 E	Lot Idn	Feet from the 1002	North/South line NORTH	Feet from the 1287	East/West line WEST	County LEA
---------------------------	----------------------	-------------------------	----------------------	---------	------------------------------	----------------------------------	------------------------------	-------------------------------	----------------------

Bottom Hole Location If Different From Surface

UL or lot no.	Section	Township	Range	Lot Idn	Feet from the	North/South line	Feet from the	East/West line	County
Dedicated Acres		Joint or Infill	Consolidated Code		Order No.				

No allowable will be assigned to this completion until all interests have been consolidated or a non-standard unit has been approved by the division.

NW COR SEC 17 NMSP-E (NAD 27) Y = 509343.48' N X = 693968.03' E	1002'	JERRAH 1 FEDERAL SWD 2 SHL NMSP-E (NAD 83) Y = 508414.22' N X = 736444.09' E LAT. = 32.396114° LONG. = -103.701206°	N 1/4 COR SEC 17 NMSP-E (NAD 27) Y = 509369.35' N X = 696608.08' E	
W 1/4 COR SEC 17 NMSP-E (NAD 27) Y = 506702.44' N X = 693986.15' E		NMSP-E (NAD 27) Y = 508353.68' N X = 695261.79' E LAT. = 32.395991°N LONG. = -103.700717°W		

OPERATOR CERTIFICATION

I hereby certify that the information contained herein is true and complete to the best of my knowledge and belief, and that this organization either owns a working interest or unleased mineral interest in the land including the proposed bottom hole location or has a right to drill this well at this location pursuant to a contract with an owner of such a mineral or working interest, or to voluntary pooling agreement or a compulsory pooling order heretofore entered by the division.

Signature _____ Date _____

Print Name _____

E-mail Address _____

SURVEYORS CERTIFICATION

I hereby certify that the well location shown on this plat was plotted from field notes of actual surveys made by me or under my supervision, and that the same is true and correct to the best of my belief.

AUGUST 15, 2019
Date of Survey

Signature and Seal of Professional Surveyor

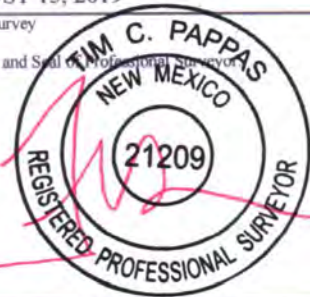

Job No.: SEL.190001
TIM C. PAPPAS, NM P.L.S.
NO.21209

September 23, 2019

Mr. Phillip Goetze
NM EMNRD – Oil Conservation Division
1220 South St. Francis Drive
Santa Fe, NM 87505

Subject: Select Energy - Jerrah 1 Federal SWD #2 Footage Calls

Dear Mr. Goetze:

The purpose of this letter is to inform the Oil Conservation Division (OCD) that the footage calls shown in this C-108 Application for Authorization to Inject for Select Energy's Jerrah 1 Federal SWD #2 and the enclosed C-102 (i.e. 1002 FNL and 1287 FWL) differ slightly from the footage calls that were included in the Legal Notice published in the Hobbs News-Sun (i.e. 1,000 FNL and 1,282 FWL).

The correct footage calls that were used throughout the Application and provided on the C-102 indicate a location that is approximately 5.4 feet southwest of the location stated in the Legal Notice. This slight change in location does not materially affect the location shown in the Legal Notice, does not move the surface hole location out of its stated Quarter Quarter Section and does change any of Affected Persons.

Accordingly, proper notice has been provided to all affected parties.

Please let us know if you have any questions or if any further action is required for this application.

Sincerely,
ALL Consulting



Nathan Alleman
Sr. Regulatory Specialist

Enclosures

Attachments

Attachment 1: Wellbore Diagram

Attachment 2: Area of Review Information:

- 2-mile Oil & Gas Well Map
- 2-mile Lease Map
- 1.5-mile Deep SWD Map (Devonian/Silurian SWDs)
- 1-mile Well Detail List
- Potash Lease Map

Attachment 3: Source Water Analyses

Attachment 4: Injection Formation Water Analyses

Attachment 5: Water Well Map and Well Data

Attachment 6: Induced Seismicity Assessment Letter

Attachment 7: Public Notice Affidavit and Notice of Application Confirmations

Attachment 1

Wellbore Diagram

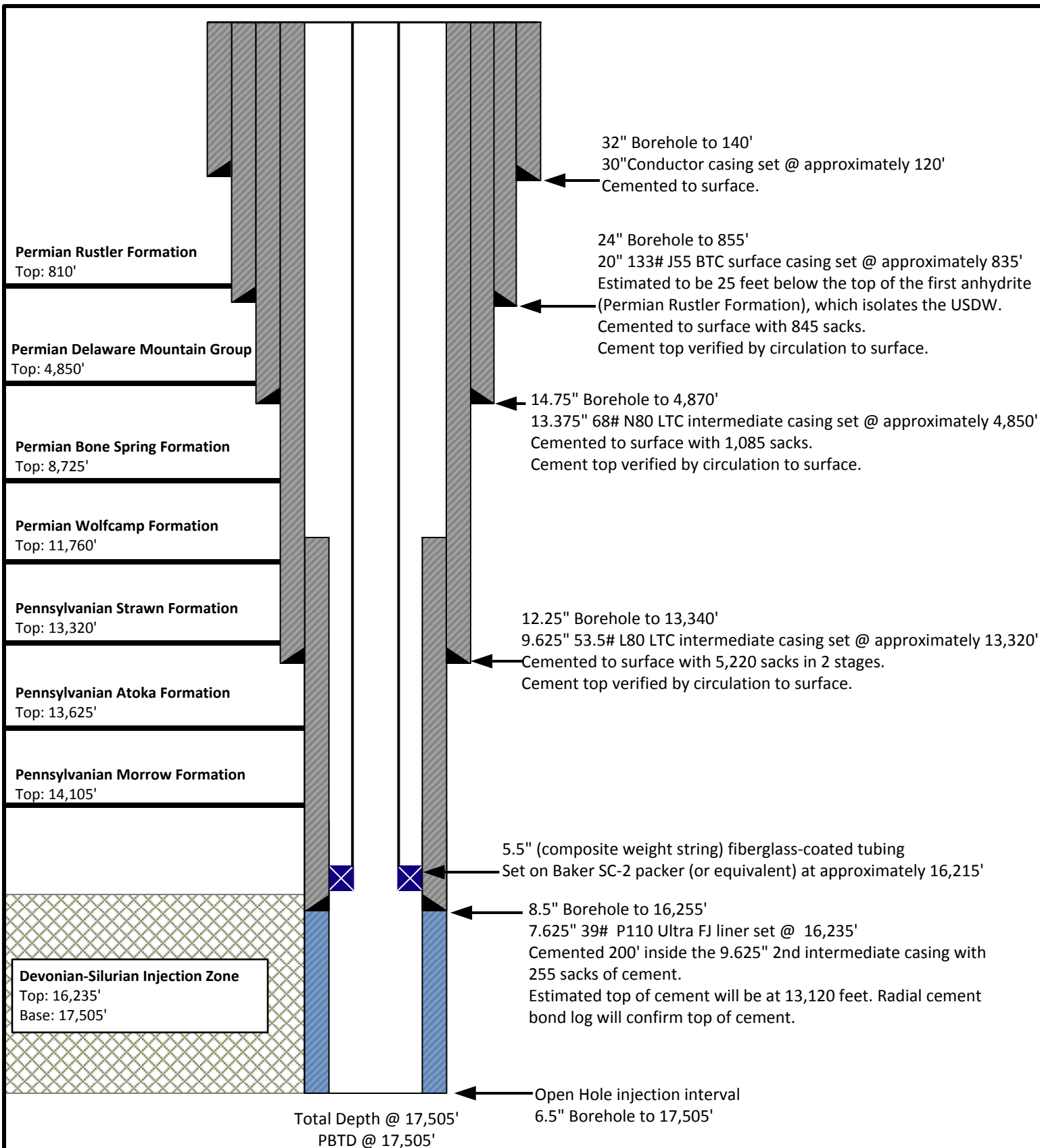

Note: Listed depths and cement volumes are approximates based on available information. All cement calculations use yield of 1.18 cubic foot per sack and include 25% excess.

NOT TO SCALE

Prepared by:

ALLCONSULTING

Drawn by: Joshua Ticknor

Project Manager:
Dan Arthur

Date: 9/12/2019

Select Energy Services
Jerrah 1 Federal SWD #2
Section 17, Twp 22S, Rng 32E
1002' FNL & 1287' FWL
Lea County, NM

A-3 and AL-2 LOK-SET Retrievable Casing Packers

Product Family No. H64630 and H64628

APPLICATION

The A-3™ LOK-SET™ packer combines advantages of a retrievable packer with the features of a permanent packer. An ability to lock down tubing forces makes the A-3 suitable for a broad range of applications, including production, injection, zone isolation, and remedial operations. The AL-2™ LOK-SET packer is similar to the A-3, and has a larger bore.

Advantages

- Holds pressure from above and below, without relying on set-down weight, tubing tension, or hydraulic hold down
- Provides tubing anchoring with tension applied, suitable for pumping wells or injection, controlling tubing forces related to change fluid temperatures
- Opposed, non-transferring, dovetail slips prevent packer movement associated with changing differential pressures, while allowing the landing of the tubing in tension, neutral or compression
- Right-hand tubing rotation controls setting and releasing
- Packing element compression locks in by ratcheting action of lock segments, which restricts rotation to one direction

Accessories

To provide a simple and reliable injection system for retrieving an injection string without having to unseat the packer:

L-10 or L-316 on-off sealing connectors, Product Family Nos. H68420 and H68422. Baker Hughes blanking plug can be used in the seating nipple profile of the on-off sealing connector to provide a means of plugging the lower zone while the tubing is being pulled.

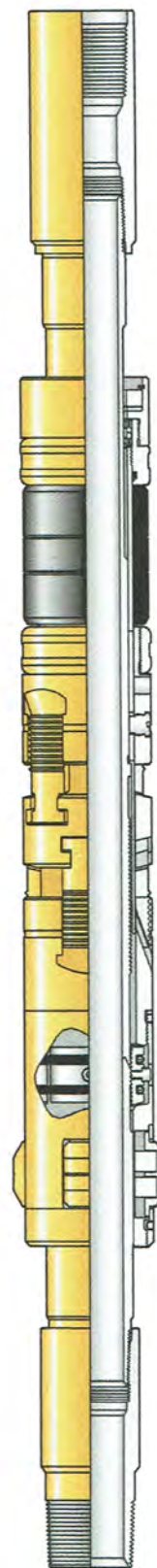

A-3 LOK-SET
Retrievable Casing Packer
Product Family No. H64630

SPECIFICATION GUIDES

A-3™ LOK-SET Retrievable Casing Packer, Product Family No. H64630

Casing			Packer				
OD		Weight *	Size	Nom ID		Max Gage Ring OD	
in.	mm	lb/ft		in.	mm	in.	mm
4	101.6	9.5–12.9	41A2	1.500	38.1	3.244	82.4
4-1/2	144.3	21.6–23.6	41A2	1.500	38.1	3.244	82.4
4	101.6	9.5	41A4	1.500	38.1	3.423	112.4
4-1/2	114.3	18.8	41A4	1.500	38.1	3.423	112.4
		13.5–17.7	41B			3.578	90.9
		11.6–13.5	43A2	1.978	50.2	3.786	96.2
		9.5–10.5	43A4			3.786	96.2
5	127.0	15–18	43B	1.978	50.2	4.140	105.2
		11.5–15	43C			4.265	108.3
5-1/2	139.7	26	43C	1.978	50.2	4.265	108.3
		20–23	45A2			4.515	114.7
		15.5–20	45A4			4.656	118.3
		13–15.5	45B			4.796	121.8
6	152.4	26	45B	1.978	50.2	4.796	121.8
		20–23	45C			5.078	129.0
		15–18	45D			5.171	131.3
6-5/8	168.3	34	45E	1.978	50.2	5.421	137.7
		24–32	45F			5.499	139.7
		24	47A2	2.441	62.0	5.671	144.0
		17–24	45G	1.978	50.2	5.796	147.2
7	177.8	17–20	47A4	2.441	62.0	5.827	148.0
		38	47A2	2.441	62.0	5.671	144.0
		32–35	47A4			5.827	148.0
		26–29	47B2			5.983	152.0
7-5/8	193.7	23–26	47B4			6.093	154.8
		17–20	47C2			6.281	159.5
		33.7–39	47C4	2.441	62.0	6.468	164.3
		24–29.7	47D2			6.687	169.9
8-5/8	219.1	20–24	47D4			6.827	173.4
		44–49	49A2	3.500	88.9	7.327	186.1
		32–40	49A4			7.546	191.7
		20–28	49B			7.796	198.0
9-5/8	244.5	47–53.5	51A2	3.500	88.9	8.234	209.1
		40–47	51A4			8.452	214.7
		29.3–36	51B			8.608	218.6

AL-2™ Large Bore LOK-SET Retrievable Casing Packer Product Family No. H64628

Casing			Packer					
OD		Weight *	Size	Nom ID		Max Gage Ring OD		Max Diameter of Compressed Drag Block
in.	mm	lb/ft		in.	mm	in.	mm	in.
5-1/2	139.7	20	45A2 x 2-3/8	2.375	60.3	4.562	115.9	4.592
		15.5–17	45A4 x 2-3/8			4.656	118.3	4.750
		13	45B x 2-3/8			4.796	121.8	4.902
6	152.4	26	45B x 2-3/8	2.375	60.3	4.796	121.8	4.902

- When selecting a packer for a casing weight common to two weight ranges (same OD), choose the packer size shown for the lighter of the two weight ranges. Example: for 7-in. (177.8 mm) OD 26 lb/ft casing use packer size 47B4. Under certain circumstances the other packer size may be run, such as when running in mixed casing strings.

Repair kits, including such items as packing elements, seal rings, etc., are available for redressing Baker Retrievable Packers. Contact your Baker Hughes representative. Use only Baker Hughes repair parts.

Attachment 2

Area of Review Information:

- 2-mile Oil & Gas Well Map
- 2-mile Lease Map
- 1.5-mile Deep SWD Map (Devonian/Silurian SWDs)
- 1-mile Well Detail List
- Potash Lease Map

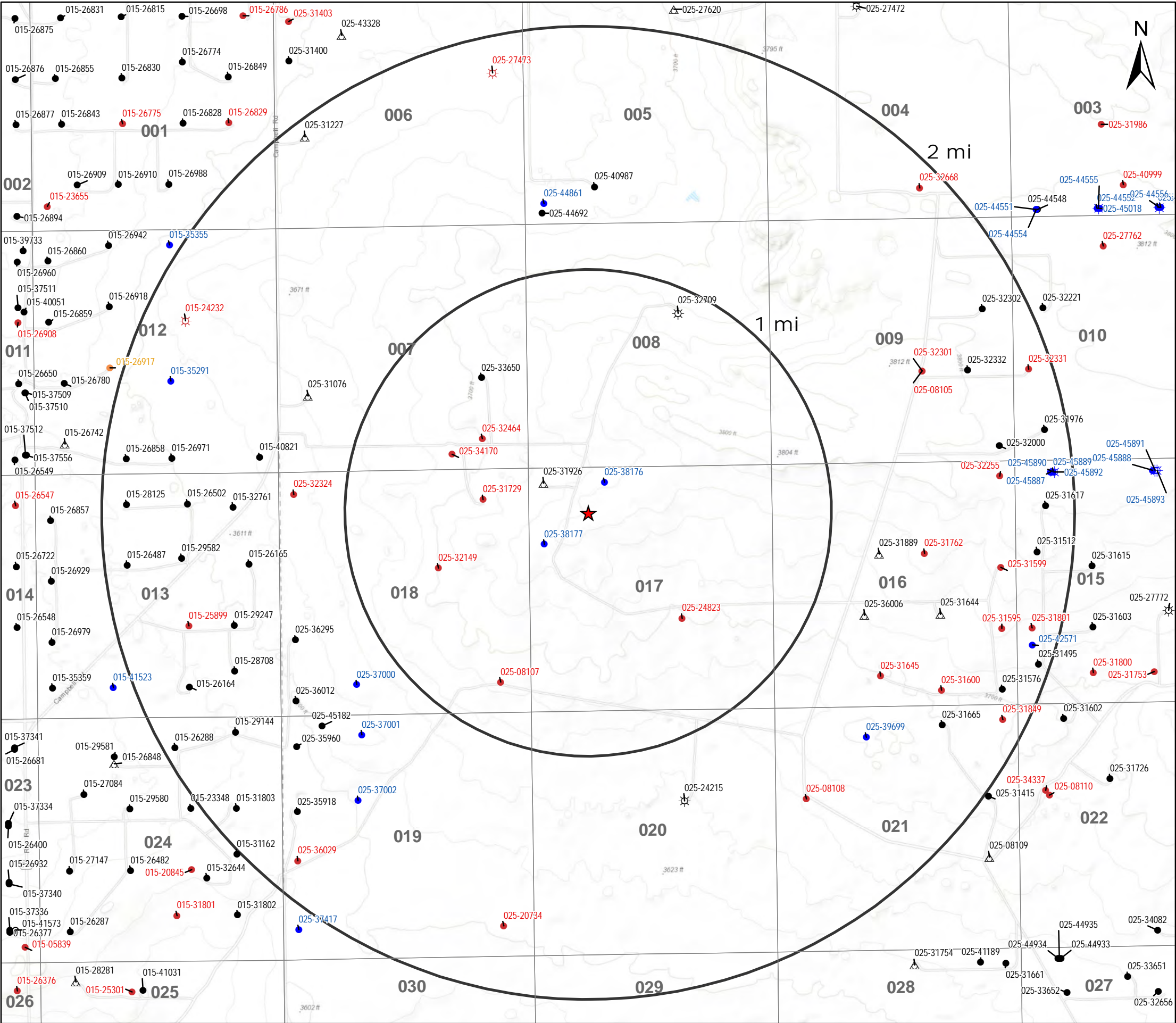

Legend

- ★ Proposed SWD
- ☼ Gas, Active (4)
- ☼ Gas, New (5)
- ☼ Gas, Plugged (2)
- Oil, Active (106)
- Oil, New (22)
- Oil, Plugged (42)
- Oil, Temporarily Abandoned (1)
- △ Salt Water Injection, Active (13)

O&G Wells Area of Review		
JERRAH 1 FEDERAL SWD #2		
Lea County, New Mexico		
Proj Mgr: Dan Arthur	August 31, 2019	Mapped by: Ben Bockelmann
Prepared by: 		

Service Layer Credits: Sources: Esri, HERE, Garmin, Intermap, increment P Corp., GEBCO, USGS, FAO, NPS, NRCAN, GeoBase, IGN, Kadaster NL, Ordnance Survey, Esri Japan, METI, Esri China (Hong Kong), (c) OpenStreetMap contributors, and the GIS User Community

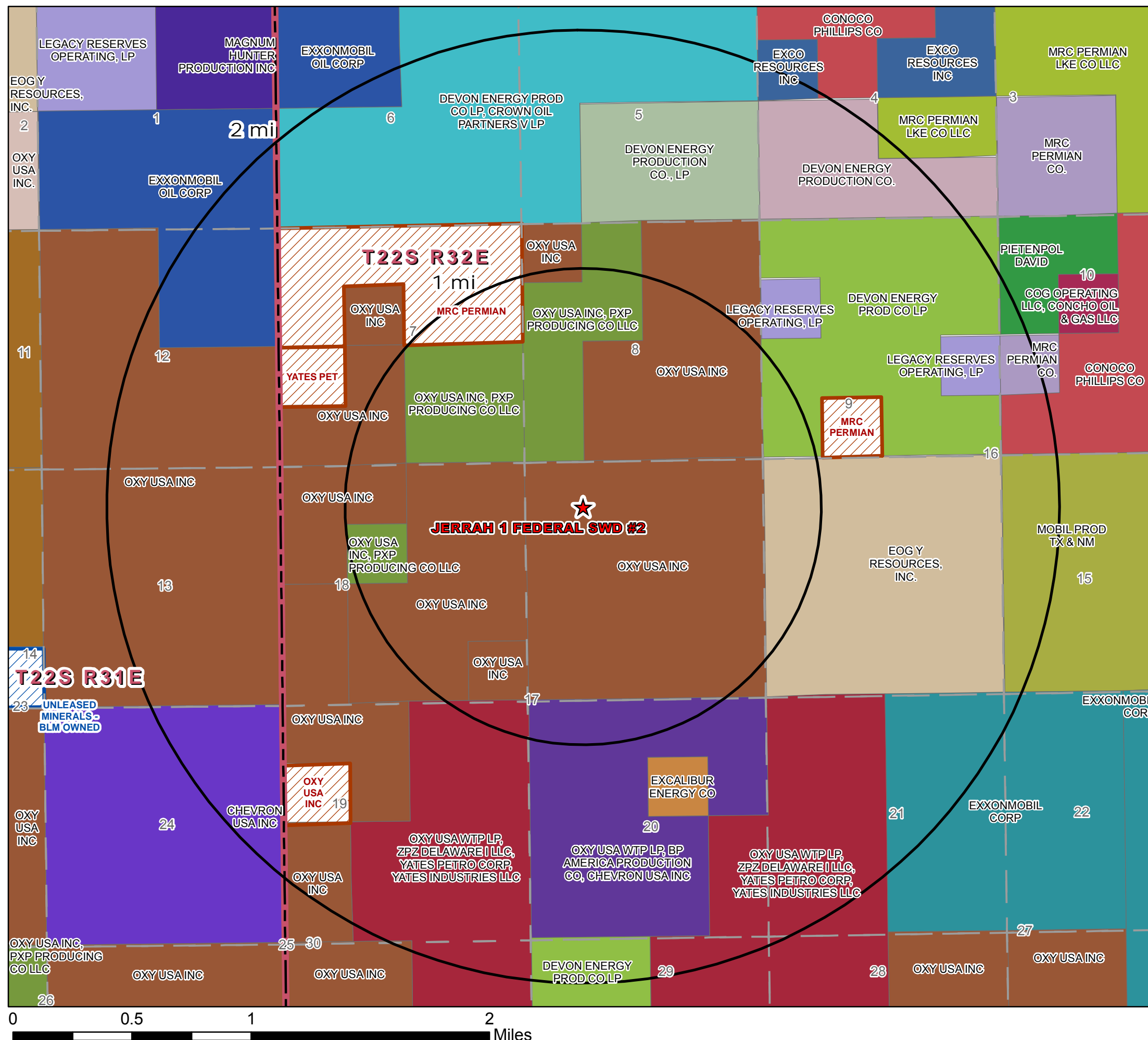

Legend

- ★ Proposed SWD
- ▨ Private Mineral Leases
- ▨ Unleased Minerals - BLM Owned

BLM Mineral Leases

- CHEVRON USA INC
- COG OPERATING LLC, CONCHO OIL & GAS LLC
- CONOCO PHILLIPS CO
- DEVON ENERGY PROD CO LP
- DEVON ENERGY PROD CO LP, CROWN OIL PARTNERS V LP
- EOG A RESOURCES INC, EOG M RESOURCES INC, OXY Y-1 COMPANY, EOG Y RESOURCES INC
- EXCALIBUR ENERGY CO
- EXCO RESOURCES INC
- EXXONMOBIL CORP
- EXXONMOBIL OIL CORP
- MAGNUM HUNTER PRODUCTION INC
- MOBIL PROD TX & NM
- MRC PERMIAN LKE CO LLC
- OXY USA INC
- OXY USA INC, PXP PRODUCING CO LLC
- OXY USA WTP LP, BP AMERICA PRODUCTION CO, CHEVRON USA INC
- OXY USA WTP LP, ZPZ DELAWARE I LLC, YATES PETRO CORP, YATES INDUSTRIES LLC
- PIETENPOL DAVID

NMSLO Mineral Leases

- DEVON ENERGY PRODUCTION CO.
- DEVON ENERGY PRODUCTION CO., LP
- EOG Y RESOURCES, INC.
- LEGACY RESERVES OPERATING, LP
- MRC PERMIAN CO.
- OXY USA INC.

Prepared for:
SELECT
ENERGY SERVICES



Mineral Lease Area of Review

JERRAH 1 FEDERAL SWD #2 Lea County, New Mexico

Proj Mgr:
Dan Arthur

September 18, 2019

Mapped by:
Ben Bockelmann

Prepared by:

ALLCONSULTING

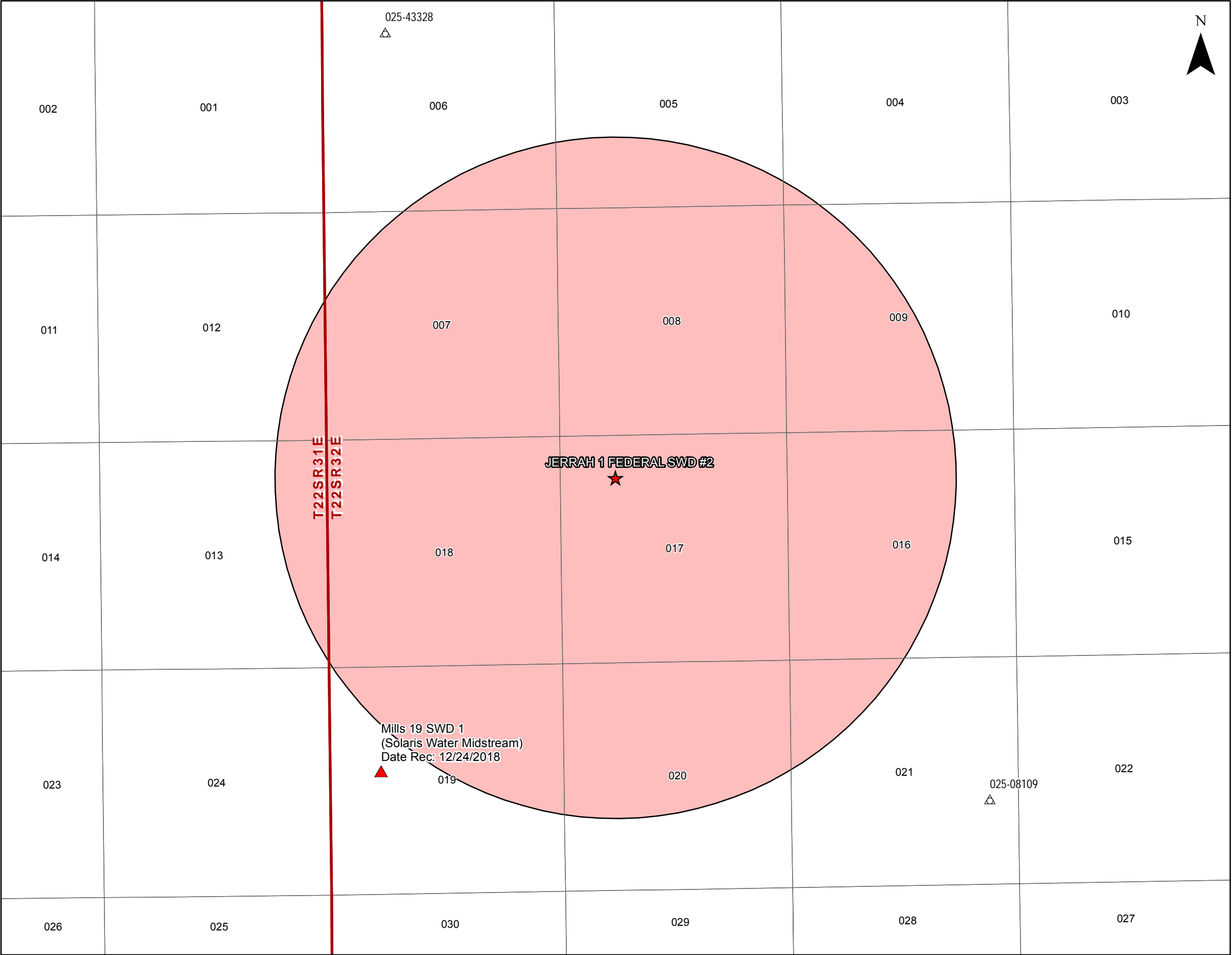

Prepared for:

Select Energy
JERRAH 1 FEDERAL SWD #2
& 1.5-mile Radius Review
Lea County, NM

- Legend**
- ★ Select Energy - Proposed SWD
 - ▲ Pending Deep SWDs (1)
 - Select Energy SWD - 1.5-mile Radius
- NMOCD Deep Devonian/Silurian SWDs**
- △ Salt Water Injection, Active (2)

Note: All **Pending Deep SWDs** were plotted using Footage calls from Sec, Twn, & Rng lines. Locations should be considered approximate.

Prepared by:

ALLCONSULTING

AOR Tabulation for Jerrah 1 Federal SWD #2 (Top of Injection Interval: 16,235')

Well Name	API#	Well Type	Operator	Spud Date	Location (Sec., Tn., Rng.)	Total Vertical Depth (feet)	Penetrate Inj. Zone?
EAST LIVINGSTON RIDGE UNIT #001	30-025-31729	Plugged	OXY USA INC	9/29/1992	A-18-22S-32E	Plugged (8780)	No
EAST LIVINGSTON RIDGE UNIT #006	30-025-32464	Plugged	OXY USA INC	12/9/1995	P-07-22S-32E	Plugged (7400)	No
FEDERAL 8 COM #001	30-025-32709	G	OXY USA INC	4/5/1995	G-08-22S-32E	15100	No
EAST LIVINGSTON RIDGE UNIT #012	30-025-33650	O	OXY USA INC	10/22/1996	I-07-22S-32E	7364	No
EAST LIVINGSTON RIDGE UNIT #005	30-025-34170	Plugged	OXY USA INC	12/12/1997	O-07-22S-32E	Plugged (7350)	No
EAST LIVINGSTON RIDGE UNIT #003	30-025-32149	Plugged	POGO PRODUCING CO	8/24/1992	G-18-22S-32E	Plugged (8782)	No
CLEARY FEDERAL SWD #002	30-025-31926	S	EOG RESOURCES INC	12/13/2004	D-17-22S-32E	8740	No
CLEARY AKC FEDERAL #003	30-025-38176	O	EOG RESOURCES INC	Not Drilled	C-17-22S-32E	Proposed (8900)	No
CLEARY AKC FEDERAL #004	30-025-38177	O	EOG RESOURCES INC	Not Drilled	E-17-22S-32E	Proposed (8900)	No
CLEARY AKC FEDERAL #001	30-025-24823	Plugged	EOG Y RESOURCES, INC.	12/17/1991	J-17-22S-32E	Plugged (14800)	No
PRE-ONGARD WELL #001	30-025-08107	Plugged	PRE-ONGARD WELL OPERATOR (Josh H. Trigg)	4/27/1951	P-18-22S-32E	Plugged (4896)	No

Notes: No wells within the 1-mile AOR penetrate the injection interval.

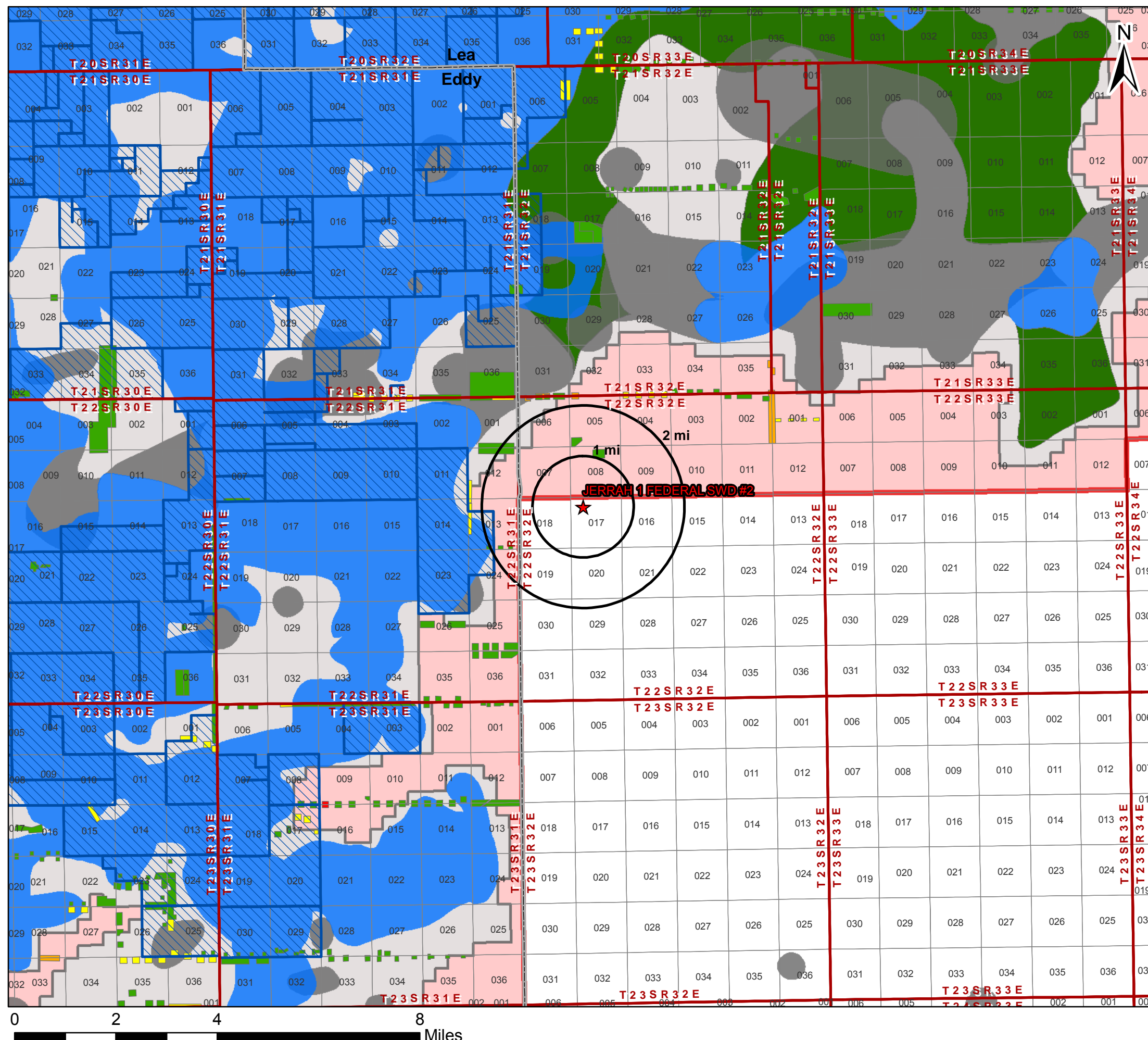

Legend

- ★ Proposed SWD
- Potash Leases
- Ore Type - Measured
- Ore Type - Indicated
- Ore Type - Inferred
- KPLA
- SOPA
- Drill Islands
- Status
 - Approved
 - Denied
 - Nominated
 - Withdrawn

Potash Leases Area of Review		
JERRAH 1 FEDERAL SWD #2 Lea County, New Mexico		
Proj Mgr: Dan Arthur	September 18, 2019	Mapped by: Ben Bockelmann
Prepared by: ALL CONSULTING		

Attachment 3

Source Water Analyses

PRODUCED WATER FROM BONE SPRING, DELAWARE, DEVONIAN, WOLFCAMP

API	SECTION	TOWNSHIP	RANGE	FORMATION	tds mgL	chloride mgL	bicarbonate mgL	sulfate mgL
3002502424	11	20S	34E	BONE SPRING	29436	16720	634	1142
3002502427	12	20S	34E	BONE SPRING	15429			
3002502427	12	20S	34E	BONE SPRING	180701	108300	1016	670
3002502429	12	20S	34E	BONE SPRING	202606	118100	5196	992
3002502429	12	20S	34E	BONE SPRING	121800			
3002502431	12	20S	34E	BONE SPRING	147229	89640	108	1038
3002531696	2	20S	34E	DELAWARE	152064	102148	404	691
3002532105	2	20S	34E	DELAWARE	296822	215237	143	294
3002532466	2	20S	34E	DELAWARE	340838	245270	229	147
3002502427	12	20S	34E	DELAWARE	214787	132700	208	1816
3002502431	12	20S	34E	DEVONIAN	33414	18570	227	1961
3002502432	13	20S	34E	DEVONIAN	45778	26440	1145	729
3002501912	16	16S	34E	WOLFCAMP	164004	102500	4204	1249
3002501922	20	16S	34E	WOLFCAMP	104541	64290	280	541
3002501922	20	16S	34E	WOLFCAMP	104033	64080	268	515
3002501922	20	16S	34E	WOLFCAMP	105175	65570	207	192
3002501925	21	16S	34E	WOLFCAMP	86355	51800	610	665
3002501928	21	16S	34E	WOLFCAMP	119102	73300	227	454
3002501928	21	16S	34E	WOLFCAMP	35422	19170	979	1949
3002501930	22	16S	34E	WOLFCAMP	30015	14800	750	3300
3002501931	22	16S	34E	WOLFCAMP	87680	53000	301	681
3002501933	28	16S	34E	WOLFCAMP	59960	35100	515	1500
3002501933	28	16S	34E	WOLFCAMP	60309	35350	586	1297
3002501940	30	16S	34E	WOLFCAMP	82422	49890	361	787
3002501944	30	16S	34E	WOLFCAMP	83960	51410	418	641
3002502022	27	16S	34E	WOLFCAMP	85457	51020	544	1201
3001542895	2	23S	31E	WOLFCAMP	119472	73173		1036

Attachment 4

Injection Formation Water Analyses

Injection Formation Water Analysis									
------------------------------------	--	--	--	--	--	--	--	--	--

Select Energy Services - Devonian , Fusselman & Silurian formations

Wellname	API	Latitude	Longitude	Section	Township	Range	Unit	ftgns	ftgew	County	State	company	Field	Formation	Depth	tds_mgL	chloride_mgL	bicarbonate_mgL	sulfate_mgL
FARNSWORTH FEDERAL #006	3002511950	32.0777245	-103.162468	4	26S	37E	A	660N	990E	LEA	NM		CROSBY	DEVONIAN		31,931	20,450	302	591
ARNOTT RAMSAY NCT-B #003	3002511863	32.0922279	-103.1784439	32	25S	37E	A	660N	660E	LEA	NM		CROSBY	DEVONIAN	8797		100,382	476	
STATE NJ A #001	3002511398	32.1647491	-103.1273346	2	25S	37E	A	663N	660E	LEA	NM		JUSTIS NORTH	DEVONIAN		105,350	59,300	660	4,950
COPPER #001	3002511818	32.0994835	-103.1656723	28	25S	37E	J	1980S	1981E	LEA	NM		CROSBY	DEVONIAN		27,506	15,270	1,089	1,079
ARNOTT RAMSAY NCT-B #003	3002511863	32.0922279	-103.1784439	32	25S	37E	A	660N	660E	LEA	NM		CROSBY	DEVONIAN		158,761			
BELL LAKE UNIT #006	3002508483	32.3282585	-103.507103	6	23S	34E	O	660S	1980E	LEA	NM		BELL LAKE NORTH	DEVONIAN		71,078	42,200	500	1,000
CLINE FEDERAL #001	3002510717	32.3025551	-103.1358261	14	23S	37E	K	1980S	1980W	LEA	NM		CLINE	DEVONIAN		118,979	71,280	462	2,593
E C HILL B FEDERAL #001	3002510945	32.2658463	-103.1443634	34	23S	37E	A	810N	660E	LEA	NM		TEAGUE	DEVONIAN		112,959	67,390	288	2,765
E C HILL D FEDERAL #001	3002510947	32.2622147	-103.1443634	34	23S	37E	H	2131N	660E	LEA	NM		TEAGUE	DEVONIAN		35,639			
E C HILL D FEDERAL #004	3002510950	32.2653503	-103.1443634	34	23S	37E	A	990N	660E	LEA	NM		TEAGUE	DEVONIAN		236,252	147,000	129	781
ANTELOPE RIDGE UNIT #003	3002521082	32.2593155	-103.4610748	34	23S	34E	K	1980S	1650W	LEA	NM		ANTELOPE RIDGE	DEVONIAN		80,187	47,900	476	900
REMUDA BASIN UNIT #001	3001503691	32.2886238	-103.9360428	24	23S	29E	J	1980S	1980E	EDDY	NM		REMUDA	DEVONIAN		64,582	37,500	610	1,700
REMUDA BASIN UNIT #001	3001503691	32.2886238	-103.9360428	24	23S	29E	J	1980S	1980E	EDDY	NM		REMUDA	DEVONIAN		56,922	29,000	1,740	4,980
STATE B COM #001	3002509716	32.1794052	-103.2212524	36	24S	36E	C	600N	1880W	LEA	NM		CUSTER	DEVONIAN		176,234	107,400	128	1,004
WHITE CITY PENN GAS COM UNIT 1 #001	3001500408	32.1937523	-104.3088455	29	24S	26E	A	660N	660E	EDDY	NM			DEVONIAN			10,120	653	1,336
BIG EDDY UT #001	3001502475	32.4421539	-104.042305	36	21S	28E	C	660N	1980W	EDDY	NM			DEVONIAN		16,223	7,000	1,030	2,290
BIG EDDY UT #001	3001502475	32.4421539	-104.042305	36	21S	28E	C	660N	1980W	EDDY	NM			DEVONIAN		19,941	10,700	640	1,130

Source: <http://gotech.nmt.edu/gotech/Water/producedwater.aspx>

Attachment 5

Water Well Map and Well Data

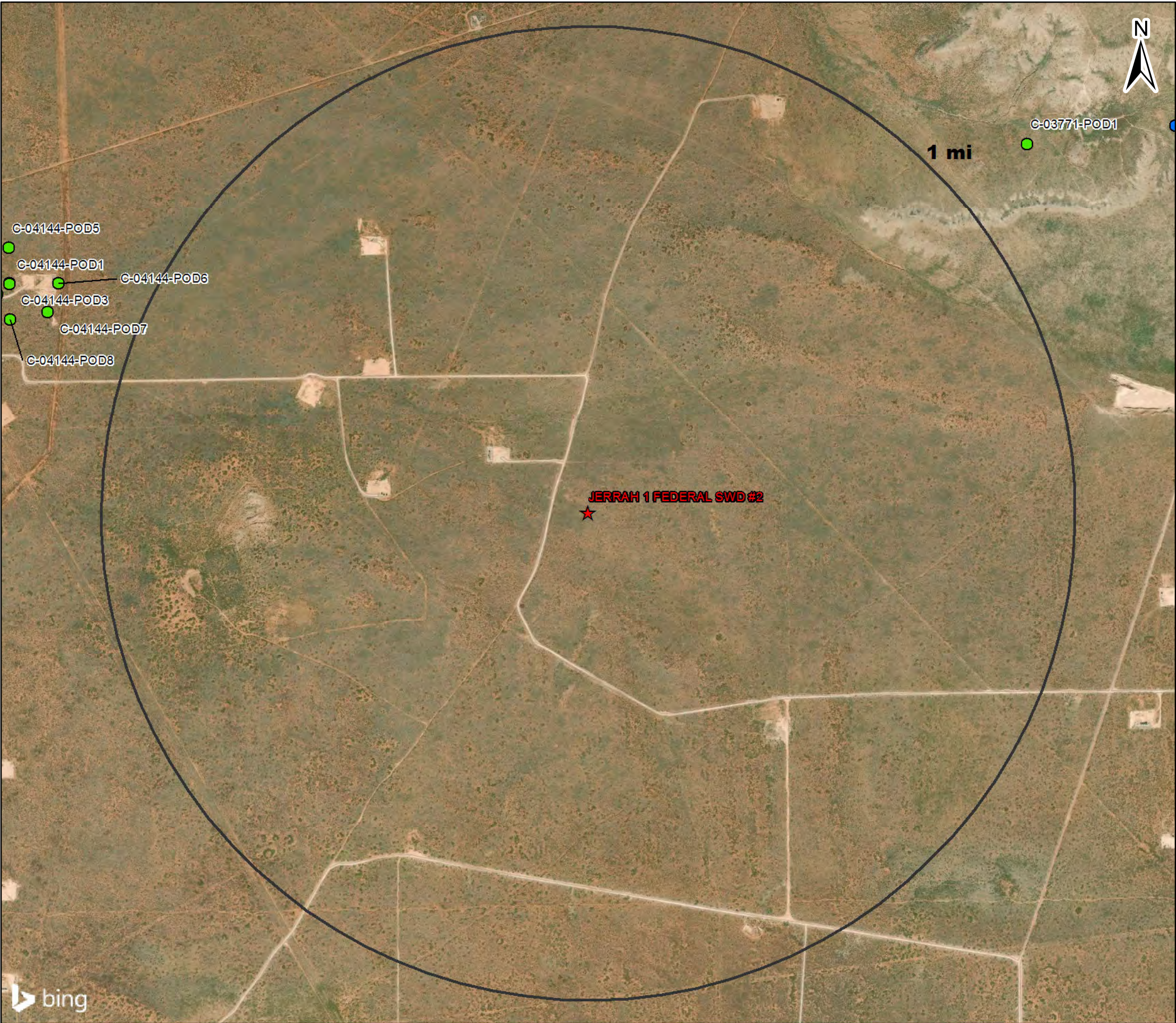

Legend

★ Proposed SWD

NMOSE PODs

Status

- Active (2)
- Pending (7)
- Change Location of Well (0)
- Capped (0)
- Plugged (0)
- Incomplete (0)
- Unknown (0)

Water Wells Area of Review

JERRAH 1 FEDERAL SWD #2
Lea County, New Mexico

Proj Mgr:
Dan Arthur

September 18, 2019

Mapped by:
Ben Bockelmann

Prepared by:



Water Well Sampling Rationale						
Select Energy Services - Jerrah 1 Federal SWD #2						
SWD	Water Wells	Owner	Available Contact Information	Use	Sampling Required	Notes

Note: No water wells are present within 1 mile of the proposed SWD location.

Attachment 6

Induced Seismicity Assessment Letter

September 18, 2019

Mr. Phillip Goetze, P.G.
NM EMNRD – Oil Conservation Division
1220 South St. Francis Drive
Santa Fe, NM 87505

Subject: Induced Seismicity Potential Statement for the Jerrah 1 Federal SWD #2

Dear Mr. Goetze,

This letter provides information regarding the seismic potential associated with injection operations associated with Select Energy Services, LLC (Select), proposed Jerrah 1 Federal SWD #2, hereinafter referred to as the “Subject Well.”

As outlined herein, based on my experience as an expert on the issue of induced seismicity, it is my opinion that the potential for the proposed injection well to cause injection-induced seismicity is expected to be minimal, at best. This conclusion is based on (1) the lack of historic seismic activity and faulting in the area, (2) the low fault slip potential (FSP) of Precambrian faults in the area, (3) the presence of confining layers, and (4) the overall vertical distance between the proposed injection zone and basement rock.

The Subject Well, is located 1,002 FNL & 1,287 FWL of Section 17, in T22-S and R32-E of Lea County, New Mexico. Historically, the Eddy and Lea Counties area has experienced very limited recorded seismic activity (per the U.S. Geological Survey [USGS] earthquake catalog database). There has been one known seismic events located within a 25-mile radius of the proposed Subject Well. The closest recorded seismic event was a M2.9 that occurred on December 4th, 1984, and was located approximately 12.3 miles southeast of the Subject Well (See Exhibit 1). The closest Class IID well injecting into the same formations (Devonian-Silurian) of the Subject Well is approximately 2.2 miles to the northwest (See Exhibit 1).

Select does not own either 2D or 3D seismic reflection data in the area of the Subject Well. Fault data from USGS indicates that the closest known fault is approximately 11 miles east of the Subject Well (See Exhibit 1).

In a recent paper written by Snee and Zoback (2018) entitled “State of Stress in the Permian Basin, Texas and New Mexico: Implications for Induced Seismicity,” the authors found that large groups of mostly north-south striking Precambrian basement faults, predominantly located along the Central Basin Platform, the western Delaware Basin, and large parts of the Northwest Shelf (which includes Eddy and Lea counties, New Mexico) have low FSP at the modeled fluid-pressure

perturbation. The map in Exhibit 2 depicts the low probability risk of FSP for the Delaware Basin and Northwest Shelf areas (Snee and Zoback 2018).

Geologic analysis indicates that the proposed Devonian-Silurian injection zone is overlain by approximately 200 to 400 feet of Woodford Shale, which is the upper confining zone and will serve as a barrier for upward injection fluid migration. Additionally, the Simpson Group that lies directly below the Montoya Formation will act as a lower confining zone to prohibit fluids from migrating downward into the underlying Ellenburger Formation and Precambrian basement rock. See the stratigraphic column for the Delaware Basin included in Exhibit 3.

In the Eddy and Lea Counties area of New Mexico, the Simpson Group is comprised of a series of Middle to Upper Ordovician carbonates, several sandstones, and sandy shales that range from approximately 350 to 650 feet thick (Jones 2008). This group of rocks is capped by the limestones of the Bromide Formation, which is approximately 200 feet thick in this area (Jones 2008). The closest deep well drilled into the Precambrian basement was completed by the Skelly Oil Company in 1975. This well is located in Section 17, Range 36E, Township 25S of Lea County (API No.30-025-25046) and encountered 602 feet of Ellenburger Formation before reaching the top of the Precambrian granite at a depth of 18,920 feet. Based on the estimated thickness of the Simpson Group and Ellenburger Formation in this area, the Precambrian basement should be approximately 1,000 to 1,200 feet below the bottom of the proposed injection zones in the Subject Well.

Conclusion

As an expert on the issue of induced seismicity, it is my opinion that the potential for the proposed injection well to cause injection-induced seismicity is expected to be minimal, at best. This conclusion is based on (1) the lack of historic seismic activity and faulting in the area, (2) the low FSP of Precambrian faults in the area, (3) the presence of confining layers, and (4) the overall vertical distance between the proposed injection zone and basement rock.

Sincerely,
ALL Consulting

A handwritten signature in black ink, appearing to read "J. Daniel Arthur", is written over a light blue rectangular background.

J. Daniel Arthur, P.E., SPEC
President and Chief Engineer

Enclosures
References
Exhibits

References

Ball, Mahlon M. 1995. "Permian Basin Province (044)." In *National Assessment of United States Oil and Gas Resources—Results, Methodology, and Supporting Data*. U.S. Geological Survey. <https://certmapper.cr.usgs.gov/data/noga95/prov44/text/prov44.pdf> (accessed June 18, 2018).

Green, G.N., and G.E. Jones. 1997. "The Digital Geologic Map of New Mexico in ARC/INFO Format." U.S. Geological Survey Open-File Report 97-0052. <https://mrdata.usgs.gov/geology/state/state.php?state=NM> (accessed June 14, 2018).

Jones, Rebecca H. 2008. "The Middle-Upper Ordovician Simpson Group of the Permian Basin: Deposition, Diagenesis, and Reservoir Development." http://www.beg.utexas.edu/resprog/permianbasin/PBGSP_members/writ_synth/Simpson.pdf (accessed June 19, 2018).

Snee, Jens-Erik Lund, and Mark D. Zoback. 2018. "State of Stress in the Permian Basin, Texas and New Mexico: Implications for Induced Seismicity." *The Leading Edge* 37, no. 2 (February 2018): 127-34.

U.S. Geological Survey (USGS). No date. Earthquakes Hazard Program: Earthquake Catalog. <https://earthquake.usgs.gov/earthquakes/search/> (accessed June 14, 2018).

Exhibits



Exhibit 1. Map Showing the Distances from Known and Inferred Faults, Seismic Event, and Closest Deep Injection Well

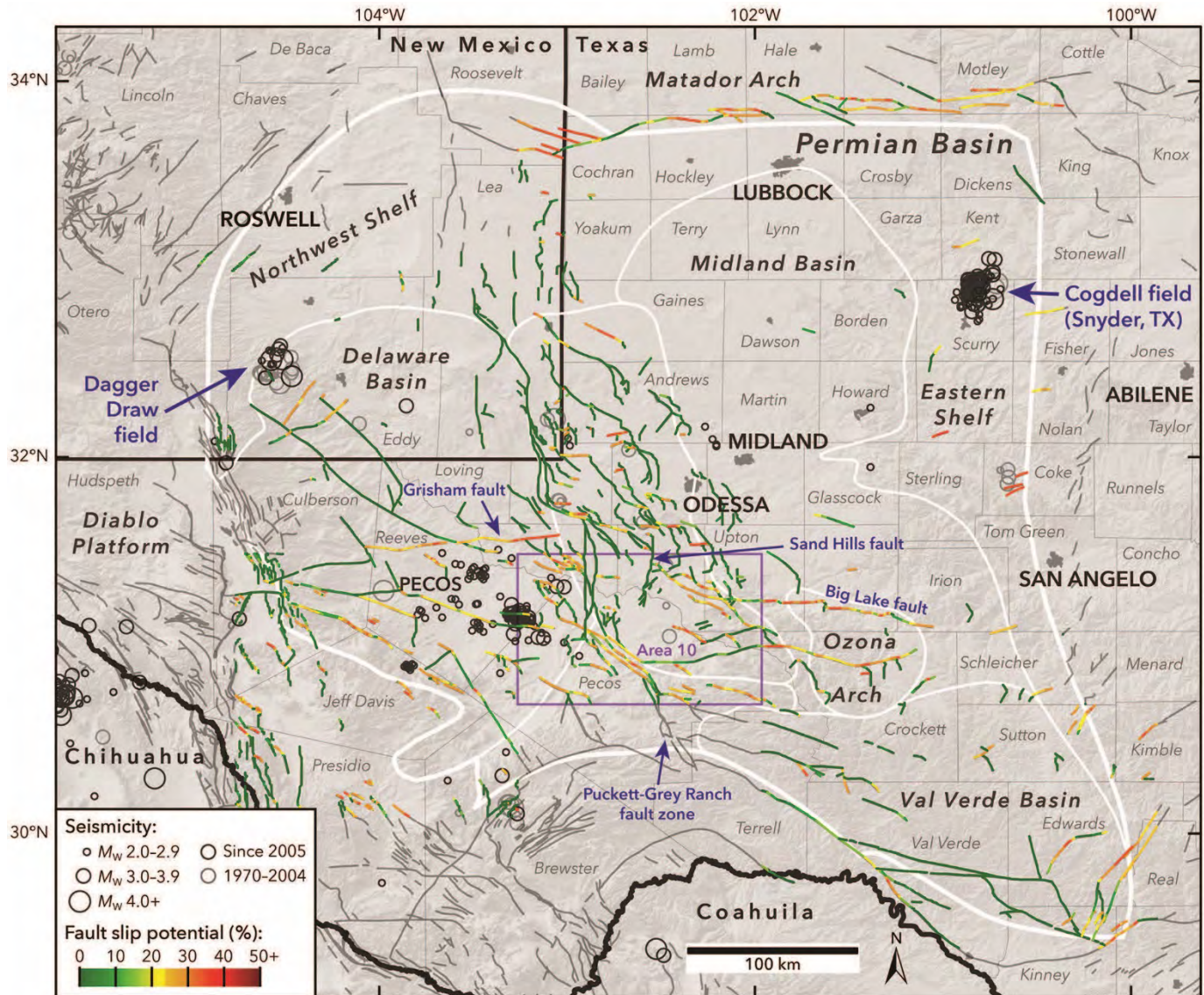

Exhibit 2. Results of the Snee and Zoback (2018) Probabilistic FSP Analysis Across the Permian Basin

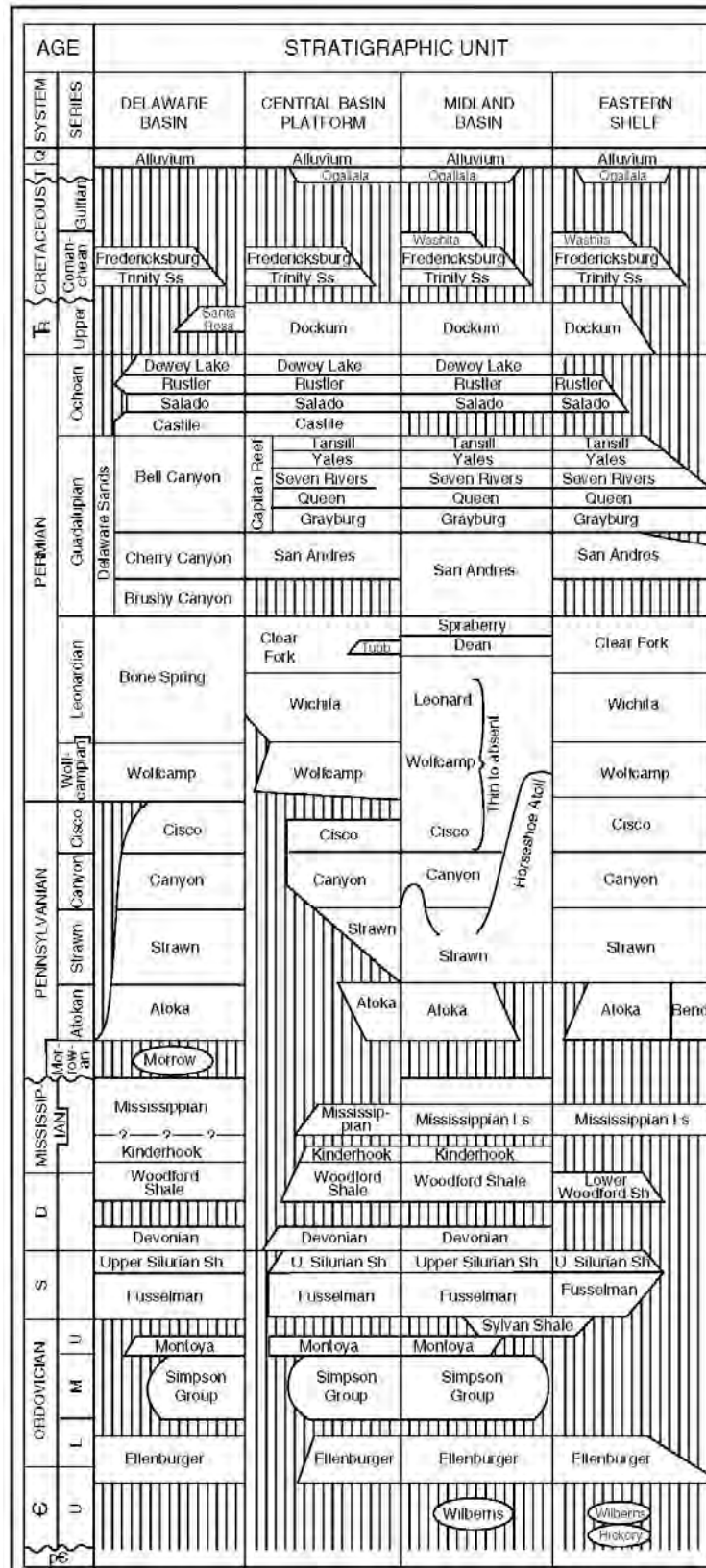

Exhibit 3. Delaware Basin Stratigraphic Chart (Ball 1995)

Attachment 7

Public Notice Affidavit and Notice of Application Confirmations

Affidavit of Publication

STATE OF NEW MEXICO
COUNTY OF LEA

I, Daniel Russell, Publisher of the Hobbs News-Sun, a newspaper published at Hobbs, New Mexico, solemnly swear that the clipping attached hereto was published in the regular and entire issue of said newspaper, and not a supplement thereof for a period of 1 issue(s).

Beginning with the issue dated
September 06, 2019
and ending with the issue dated
September 06, 2019.



Publisher

Sworn and subscribed to before me this
6th day of September 2019.

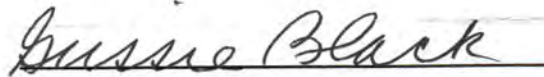
Business Manager

My commission expires
January 29, 2023

(Seal)

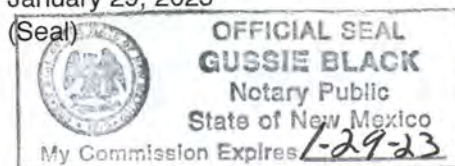

This newspaper is duly qualified to publish legal notices or advertisements within the meaning of Section 3, Chapter 167, Laws of 1937 and payment of fees for said

LEGAL	LEGAL
LEGAL NOTICE SEPTEMBER 6, 2019	
APPLICATION FOR AUTHORIZATION TO INJECT	
NOTICE IS HEREBY GIVEN: That Select Energy Services, 1820 N I-35, Gainesville, TX 76240, is requesting that the New Mexico Oil Conservation Division administratively approve the APPLICATION FOR AUTHORIZATION TO INJECT as follows:	
PURPOSE: The intended purpose of the injection well is to dispose of salt water produced from permitted oil and gas wells.	
WELL NAME AND LOCATION: Jerrah 1 Federal SWD #2 Located 24.3 miles northeast of Loving, NM NW 1/4 NW 1/4, Section 17, Township 22S, Range 32E 1,000' FNL & 1,282' FWL Lea County, NM	
NAME AND DEPTH OF DISPOSAL ZONE: Devonian - Silurian (16,235 - 17,505')	
EXPECTED MAXIMUM INJECTION RATE: 30,000 Bbls/day	
EXPECTED MAXIMUM INJECTION PRESSURE: 3,247 psi (surface)	
Objections or requests for hearing must be filed with the New Mexico Oil Conservation Division within fifteen (15) days. Any objection or request for hearing should be mailed to the Oil Conservation Division, 1220 South St. Francis Dr., Santa Fe, New Mexico 87505.	
Additional information may be obtained by contacting Nate Alleman at 918-382-7581. #34670	

67115320

00233083

DANIEL ARTHUR
ALL CONSULTING
1718 S. CHEYENNE AVE.
TULSA, OK 74119

Jerrah 1 Federal SWD #2 - Notice of Application Recipients				
Entity	Address	City	State	Zip Code
Land & Mineral Owner				
New Mexico BLM	620 Greene St.	Carlsbad	NM	88220
OCD District				
NMOCD District 1	1625 N. French Drive	Hobbs	NM	88240
Leasehold Operators				
BP America Production Company (BP AMERICA PRODUCTION CO)	501 Westlake Park Blvd.	Houston	TX	77079
Chevron USA Inc. (CHEVRON USA INC)	6301 Deauville Blvd	Midland	TX	79706
Commision of Public Lands - State Land Office	310 Old Santa Fe Trail	Santa Fe	NM	87501
Devon Energy Production Company, LP (DEVON ENERGY PROD CO LP)	333 W. Sheridan Ave.	Oklahoma City	OK	73102
EOG Resources, Inc. (EOG RESOURCES INC)	104 S. 4th Street	Artesia	NM	88210
EOG Y Resources, Inc. (EOG Y RESOURCES INC)	104 S. 4th Street	Artesia	NM	88210
MRC Permian Company (MRC PERMIAN)	5400 LBL Freeway, Suite 1500	Dallas	TX	75240
OXY USA Inc. (OXY USA INC)	P.O. Box 27570	Houston	TX	77227-7570
OXY USA Limited Partnership (OXY USA WTP LP)	5 Greenway Plaza, Suite 110	Houston	TX	77210
PXP Producing Company, LLC (PXP PRODUCING CO LLC)	P.O. Box 2504	Houston	TX	77252
Yates Industries, LLC (YATES INDUSTRIES LLC)	P.O. Box 1091	Artesia	NM	88211
Yates Petroleum Corporation (YATES PET) (YATES PETRO CORP)	105 South Fourth Street	Artesia	NM	88210
ZPZ Delaware I, LLC (ZPZ DELAWARE I LLC)	2000 Post Oak Blvd., Suite 100	Houston	TX	77056
Notes: The table above shows the Entities who were identified as parties of interest requiring notification on either the 1-mile well detail list (Attachment 2) or on the 2-mile Mineral Lease Map (Attachment 2). The names listed above in parenthesis, are the abbreviated entity names used on either the 1-mile well detail list (Attachment 2) or on the 2-mile Mineral Lease Map (Attachment 2).				

Place label at top of the center of the envelope and fold at dotted line.

ALL Consulting
1718 S. Cheyenne Ave.
Tulsa, OK 74119

\$5.600
US POSTAGE
FIRST-CLASS
FROM 74119
SEP 16 2019
stamps.com



Place label at top of the center of the envelope and fold at dotted line.

CERTIFIED MAIL™



9414 8118 9956 1570 0929 37

BP America Production Company
501 Westlake Park Blvd.
Houston TX 77079-2604

ALL Consulting
1718 S. Cheyenne Ave.
Tulsa, OK 74119

\$5.600
US POSTAGE
FIRST-CLASS
FROM 74119
SEP 16 2019
stamps.com



Place label at top of the center of the envelope and fold at dotted line.

CERTIFIED MAIL™

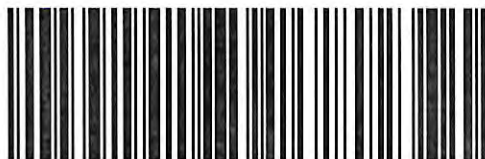

9414 8118 9956 1570 0926 61

Chevron USA Inc.
6301 Deauville
Midland TX 79706-2964

ALL Consulting
1718 S. Cheyenne Ave.
Tulsa, OK 74119

\$5.600
US POSTAGE
FIRST-CLASS
FROM 74119
SEP 16 2019
stamps.com



Place label at top of the center of the envelope and fold at dotted line.

CERTIFIED MAIL™



9414 8118 9956 1570 0926 23

Devon Energy Production Company, LP
333 W. Sheridan Ave.
Oklahoma City OK 73102-5010

ALL Consulting
1718 S. Cheyenne Ave.
Tulsa, OK 74119

\$5.600
US POSTAGE
FIRST-CLASS
FROM 74119
SEP 16 2019
stamps.com



Place label at top of the center of the envelope and fold at dotted line.

CERTIFIED MAIL®

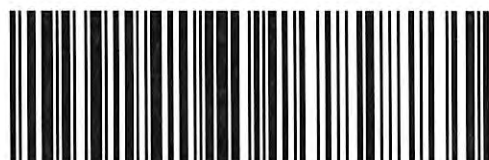

9414 8118 9956 1570 0921 04

EOG Resources, Inc.
104 S. 4th Street
Artesia NM 88210-2123

ALL Consulting
1718 S. Cheyenne Ave.
Tulsa, OK 74119

\$5.600
US POSTAGE
FIRST-CLASS
FROM 74119
SEP 16 2019
stamps.com



Place label at top of the center of the envelope and fold at dotted line.

CERTIFIED MAIL®

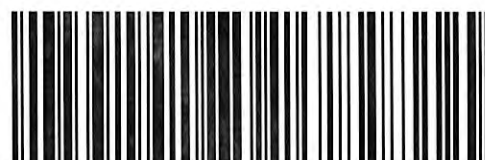

9414 8118 9956 1570 0921 35

EOG Y Resources, Inc.
104 S. 4th Street
Artesia NM 88210-2123

ALL Consulting
1718 S. Cheyenne Ave.
Tulsa, OK 74119

\$5.600
US POSTAGE
FIRST-CLASS
FROM 74119
SEP 16 2019
stamps.com



Place label at top of the center of the envelope and fold at dotted line.

CERTIFIED MAIL®

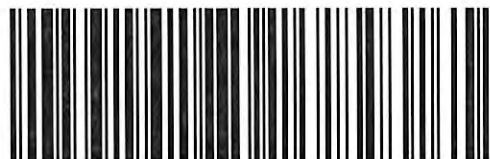

9414 8118 9956 1570 0921 73

MRC Permian Company
5400 LBJ Freeway, Suite 1500
Dallas TX 75240-1017

ALL Consulting
1718 S. Cheyenne Ave.
Tulsa, OK 74119

\$5.600
US POSTAGE
FIRST-CLASS
FROM 74119
SEP 16 2019
stamps.com



Place label at top of the center of the envelope and fold at dotted line.

CERTIFIED MAIL®



9414 8118 9956 1570 0923 64

New Mexico BLM
620 E Greene St.
Carlsbad NM 88220-6292

ALL Consulting
1718 S. Cheyenne Ave.
Tulsa, OK 74119

\$5.600
US POSTAGE
FIRST-CLASS
FROM 74119
SEP 16 2019
stamps.com



Place label at top of the center of the envelope and fold at dotted line.

CERTIFIED MAIL®

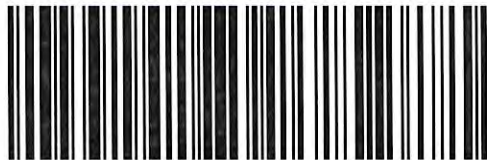

9414 8118 9956 1570 0923 40

NMOCD District 1
1625 N. French Drive
Hobbs NM 88240-9273

ALL Consulting
1718 S. Cheyenne Ave.
Tulsa, OK 74119

\$5.600
US POSTAGE
FIRST-CLASS
FROM 74119
SEP 16 2019
stamps.com



Place label at top of the center of the envelope and fold at dotted line.

CERTIFIED MAIL®

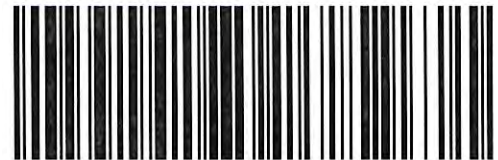

9414 8118 9956 1570 0923 71

OXY USA Inc.
P.O. Box 27570
Houston TX 77227-7570

ALL Consulting
1718 S. Cheyenne Ave.
Tulsa, OK 74119

\$5.600
US POSTAGE
FIRST-CLASS
FROM 74119
SEP 16 2019
stamps.com



Place label at top of the center of the envelope and fold at dotted line.

CERTIFIED MAIL®

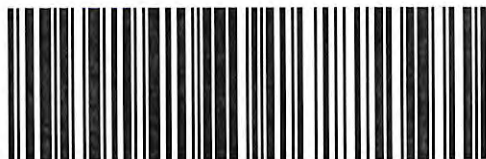

9414 8118 9956 1570 0920 50

OXY USA Limited Partnership
5 Greenway Plaza, Suite 110
Houston TX 77046-0521

ALL Consulting
1718 S. Cheyenne Ave.
Tulsa, OK 74119

\$5.600
US POSTAGE
FIRST-CLASS
FROM 74119
SEP 16 2019
stamps.com



Place label at top of the center of the envelope and fold at dotted line.

CERTIFIED MAIL®



9414 8118 9956 1570 0920 05

PXP Producing Company, LLC
P.O. Box 2504
Houston TX 77252-2504

ALL Consulting
1718 S. Cheyenne Ave.
Tulsa, OK 74119

\$5.600
US POSTAGE
FIRST-CLASS
FROM 74119
SEP 16 2019
stamps.com



Place label at top of the center of the envelope and fold at dotted line.

CERTIFIED MAIL®



9414 8118 9956 1570 0924 56

Commission of Public Lands
State Land Office
310 Old Santa Fe Trail
Santa Fe NM 87501-2708

ALL Consulting
1718 S. Cheyenne Ave.
Tulsa, OK 74119

\$5.600
US POSTAGE
FIRST-CLASS
FROM 74119
SEP 16 2019
stamps.com



Place label at top of the center of the envelope and fold at dotted line.

CERTIFIED MAIL®

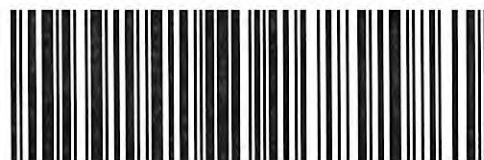

9414 8118 9956 1570 0924 87

Yates Industries, LLC
P.O. Box 1091
Artesia NM 88211-1091

ALL Consulting
1718 S. Cheyenne Ave.
Tulsa, OK 74119

\$5.600
US POSTAGE
FIRST-CLASS
FROM 74119
SEP 16 2019
stamps.com



Place label at top of the center of the envelope and fold at dotted line.

CERTIFIED MAIL®



9414 8118 9956 1570 0925 62

Yates Petroleum Corporation
105 South Fourth Street
Artesia NM 88210-2177

ALL Consulting
1718 S. Cheyenne Ave.
Tulsa, OK 74119

\$5.600
US POSTAGE
FIRST-CLASS
FROM 74119
SEP 16 2019
stamps.com



Place label at top of the center of the envelope and fold at dotted line.

CERTIFIED MAIL®



9414 8118 9956 1570 0925 31

ZIP Delaware I, LLC
2000 Post Oak Blvd., Suite 100
Houston TX 77056-4497