

Application

Received: 10/16/2019

This application is placed in file for record. It MAY or MAY NOT have been reviewed to be determined Administratively Complete

JA9BL-191016-C-107B 618

Revised March 23, 2017

RECEIVED: 10/16/19	REVIEWER: DM	TYPE: PLC	APP NO: pDM1929652817
--------------------	--------------	-----------	-----------------------

ABOVE THIS TABLE FOR OCD DIVISION USE ONLY

NEW MEXICO OIL CONSERVATION DIVISION
 - Geological & Engineering Bureau -
 1220 South St. Francis Drive, Santa Fe, NM 87505

**ADMINISTRATIVE APPLICATION CHECKLIST**

THIS CHECKLIST IS MANDATORY FOR ALL ADMINISTRATIVE APPLICATIONS FOR EXCEPTIONS TO DIVISION RULES AND
 REGULATIONS WHICH REQUIRE PROCESSING AT THE DIVISION LEVEL IN SANTA FE

Applicant: Matador Production Company	OGRID Number: 228937
Well Name: Heyco State #001H, #121H, #122H	API: 30-015-21078, -44083, 44099
Pool: WC-015 G-04 S203032P; Bone Spring & Golden Lane; Strawn (Gas)	Pool Code: 98008 & 77600

**SUBMIT ACCURATE AND COMPLETE INFORMATION REQUIRED TO PROCESS THE TYPE OF APPLICATION
 INDICATED BELOW**

1) **TYPE OF APPLICATION:** Check those which apply for [A]

A. Location – Spacing Unit – Simultaneous Dedication

☐ NSL ☐ NSP (PROJECT AREA) ☐ NSP (PRORATION UNIT) ☐ SD

B. Check one only for [I] or [II]

[I] Commingling – Storage – Measurement

☐ DHC ☐ CTB ☒ PLC ☐ PC ☐ OLS ☐ OLM

[II] Injection – Disposal – Pressure Increase – Enhanced Oil Recovery

☐ WFX ☐ PMX ☐ SWD ☐ IPI ☐ EOR ☐ PPR
2) **NOTIFICATION REQUIRED TO:** Check those which apply.

- A. ☒ Offset operators or lease holders
 B. ☒ Royalty, overriding royalty owners, revenue owners
 C. ☐ Application requires published notice
 D. ☒ Notification and/or concurrent approval by SLO
 E. ☐ Notification and/or concurrent approval by BLM
 F. ☐ Surface owner
 G. ☒ For all of the above, proof of notification or publication is attached, and/or,
 H. ☐ No notice required

FOR OCD ONLY

☐ Notice Complete
☐ Application
 Content
 Complete

- 3) **CERTIFICATION:** I hereby certify that the information submitted with this application for administrative approval is **accurate** and **complete** to the best of my knowledge. I also understand that **no action** will be taken on this application until the required information and notifications are submitted to the Division.

Note: Statement must be completed by an individual with managerial and/or supervisory capacity.

Kaitlyn A. Luck

Print or Type Name

Signature

10/16/19

Date

505-954-7286

Phone Number

kaluck@hollandhart.com

e-mail Address



Kaitlyn A. Luck
Phone (505) 954-7286
Fax (505) 819-5579
kaluck@hollandhart.com

October 16, 2019

VIA ONLINE FILING

Adrienne Sandoval
Director, Oil Conservation Division
New Mexico Department of Energy,
Minerals and Natural Resources
1220 South Saint Francis Drive
Santa Fe, New Mexico 87505

Re: Application of Matador Production Company to authorize pool commingling, off-lease storage, off lease measurement, and off-lease marketing at the Heyco State Tank Battery located in the NW/4 NW/4 (Unit D) of Section 32, Township 20 South, Range 30 East, NMPM, Eddy County, New Mexico.

Dear Ms. Sandoval:

Pursuant to 19.15.12.7 NMAC, individual spacing units are considered separate “leases” for surface commingling purposes. Accordingly, Matador Production Company (OGRID No. 228937) seeks administrative approval for pool commingling, off-lease storage, off-lease measurement, and off-lease marketing at the Heyco State Tank Battery of production from the WC-015 G-04 S203032P; Bone Spring (98008); and the Golden Lane; Strawn (Gas) (77600) pools from *all existing and future wells drilled in the following “leases”*:

(a) The 320-acre, more or less, spacing unit in the Golden Lane; Strawn (Gas) (77600) underlying the W/2 of Section 32. The spacing unit is currently dedicated to the **Heyco State #001H well** (API No. 30-015-21078);

(b) The 160-acre, more or less, spacing unit in the WC-015 G-04 S203032P; Bone Spring (98008) underlying the W/2 W/2 of Section 32. The spacing unit is currently dedicated to the **Heyco State #121H well** (API No. 30-015-44083);

(c) The 160-acre, more or less, spacing unit in the WC-015 G-04 S203032P; Bone Spring (98008) underlying the E/2 W/2 of Section 32. The spacing unit is currently dedicated to the **Heyco State #122H well** (API No. 30-015-44099); and

(d) Pursuant to 19.15.12.10.C(4)(g), *future spacing units connected to this central tank battery* with notice provided only to the interest owners within these future “leases.”

Oil and gas production from these “leases” will be commingled and sold at the Heyco State Tank Battery located in the NW/4 NW/4 (Unit D) of Section 32. Prior to commingling, gas production

from each “lease” will be separately metered using individual test separators with calibrated orifice meters that are manufactured to AGA specifications. Oil production from each “lease” will also be separately metered using turbine meters.

Exhibit 1 is a land plat showing Matador’s current development plan, flow lines, and central tank battery (“production facility”) in the subject area. The plat identifies the wellbores, the existing spacing units, and the common surface facilities located in the NW/4 NW/4 (Unit D) of Section 32.

Exhibit 2 is a C-102 for each of the wells currently permitted or drilled within the existing spacing units, together with existing production reports for the producing wells.

Exhibit 3 is a completed Application for Surface Commingling (Diverse Ownership) Form C-107-B, that includes a statement from Benjamin D. Peterson, P.E., Senior Production Engineer with Matador, identifying the facilities and the measurement devices to be utilized, a detailed schematic of the surface facilities (attachment A to the statement) and a referenced gas sample (attachment B to the statement).

Exhibit 4 is a list of the interest owners (including any owners of royalty or overriding royalty interests) affected by this application, an example of the letters sent by certified mail advising the interest owners that any objections must be filed in writing with the Division within 20 days from the date the Division receives this application, and proof of mailing. A courtesy copy of this application has been provided to the New Mexico State Land Office since state lands are involved.

Thank you for your attention to this matter, and please feel free to call if you have any questions or require additional information.

Sincerely,

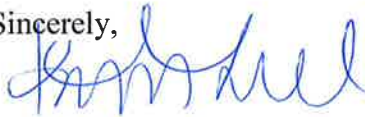

Kaitlyn A. Luck

**ATTORNEY FOR MATADOR PRODUCTION
COMPANY**



Kaitlyn A. Luck
Phone (505) 954-7286
Fax (505) 819-5579
kaluck@hollandhart.com

October 16, 2019

CERTIFIED MAIL
RETURN RECEIPT REQUESTED

TO: ALL AFFECTED PARTIES

Re: Application of Matador Production Company to authorize pool commingling, off-lease storage, off lease measurement, and off-lease marketing at the Heyco State Tank Battery located in the NW/4 NW/4 (Unit D) of Section 32, Township 20 South, Range 30 East, NMPM, Eddy County, New Mexico.

Ladies and Gentlemen:

Enclosed is a copy of the above-referenced application, which was filed with the New Mexico Oil Conservation Division on this date. Any objection to this application must be filed in writing within twenty days from this date at the Division's Santa Fe office located at 1220 South St. Francis Drive, Santa Fe, New Mexico, 87505. If no objection is received within this twenty-day period, this application may be approved administratively by the Division.

If you have any questions about this application, please contact the following:

Brian Fancher
Matador Production Company
972-371-5242
bfancher@matadorresources.com

Sincerely,

A handwritten signature in blue ink, appearing to read "Kaitlyn Luck", written over a light blue circular stamp.

Kaitlyn A. Luck
ATTORNEY FOR
MATADOR PRODUCTION COMPANY

Heyco State Land Plat

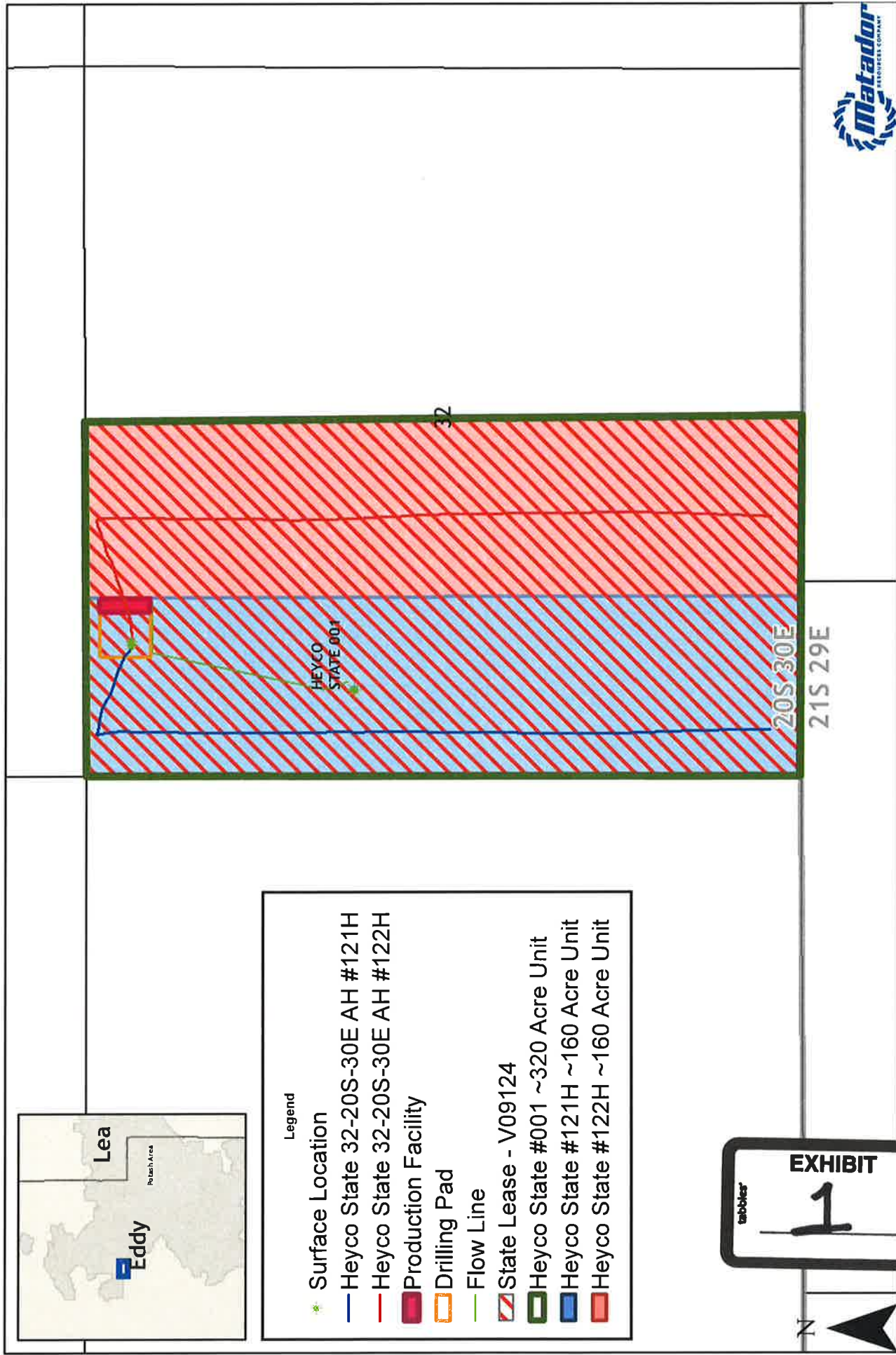

Southeast New Mexico

NEW MEXICO OIL CONSERVATION COMMISSION
WELL LOCATION AND ACREAGE DEDICATION PLAT

Form O-10,
Supersedes O-12B
Effective 1-1-73

All distances must be from the outer boundaries of the Section

Harvey E. Yates Company, Inc.		K-4278 Yates State		Yates State #1	
E	32	20S	30E	Eddy	
Section Title Location of Well:					
1980	feet from the North	660	feet from the West		
3322	Producing Formation Strawn	Undesignated	Dedicated Acreage:	320	Acres

1. Outline the acreage dedicated to the subject well by colored pencil or hatchure marks on the plat below.
2. If more than one lease is dedicated to the well, outline each and identify the ownership thereof (both as to working interest and royalty).
3. If more than one lease of different ownership is dedicated to the well, have the interests of all owners been consolidated by communitization, unitization, force-pooling, etc?

☐ Yes ☐ No If answer is "yes," type of consolidation _____

If answer is "no," list the owners and tract descriptions which have actually been consolidated. (Use reverse side of this form if necessary.) _____

No allowable will be assigned to the well until all interests have been consolidated (by communitization, unitization, forced-pooling, or otherwise) or until a non-standard unit, eliminating such interests, has been approved by the Commission.

CERTIFICATION

I hereby certify that the information contained herein is true and complete to the best of my knowledge and belief.

Vice President

Company
Harvey E. Yates Company, Inc.

Date
August 9, 1974

I hereby certify that the well location shown on this plat was plotted from field notes of actual surveys made by me or under my supervision, and that the same is true and correct to the best of my knowledge and belief.

Date Surveyed

Registered Professional Engineer
and/or Land Surveyor

Certificate No.

EXHIBIT

2

tabbies

Production Summary Report API: 30-015-21078 HEYCO STATE #001 Printed On: Thursday, September 12 2019														
Year	Pool	Month	Production					Days P/I	Injection					Pressure
			Oil(BBLS)	Gas(MCF)	Water(BBLS)	Water(BBLS)	Co2(MCF)	Gas(MCF)	Water(BBLS)	Co2(MCF)	Gas(MCF)	Other	Pressure	
1992 Cum	[77600] GOLDEN LANE;STRAWN (GAS)	Dec	83045	1998453	58611	99	0	0	0	0	0	0	0	0
1993	[77600] GOLDEN LANE;STRAWN (GAS)	Dec	72	3181	0	12	0	0	0	0	0	0	0	0
1994	[77600] GOLDEN LANE;STRAWN (GAS)	Jan	139	9876	0	31	0	0	0	0	0	0	0	0
1994	[77600] GOLDEN LANE;STRAWN (GAS)	Feb	123	7591	264	28	0	0	0	0	0	0	0	0
1994	[77600] GOLDEN LANE;STRAWN (GAS)	Mar	174	5860	248	31	0	0	0	0	0	0	0	0
1994	[77600] GOLDEN LANE;STRAWN (GAS)	Apr	11	3937	443	30	0	0	0	0	0	0	0	0
1994	[77600] GOLDEN LANE;STRAWN (GAS)	May	33	2671	199	31	0	0	0	0	0	0	0	0
1994	[77600] GOLDEN LANE;STRAWN (GAS)	Jun	39	2517	0	30	0	0	0	0	0	0	0	0
1994	[77600] GOLDEN LANE;STRAWN (GAS)	Jul	30	2107	345	0	0	0	0	0	0	0	0	0
1994	[77600] GOLDEN LANE;STRAWN (GAS)	Aug	110	1902	274	24	0	0	0	0	0	0	0	0
1994	[77600] GOLDEN LANE;STRAWN (GAS)	Sep	28	1025	119	11	0	0	0	0	0	0	0	0
1994	[77600] GOLDEN LANE;STRAWN (GAS)	Oct	30	1925	0	17	0	0	0	0	0	0	0	0
1994	[77600] GOLDEN LANE;STRAWN (GAS)	Nov	6	1123	256	30	0	0	0	0	0	0	0	0
1994	[77600] GOLDEN LANE;STRAWN (GAS)	Dec	0	249	0	12	0	0	0	0	0	0	0	0
1995	[77600] GOLDEN LANE;STRAWN (GAS)	Jan	0	98	0	26	0	0	0	0	0	0	0	0
1995	[77600] GOLDEN LANE;STRAWN (GAS)	Feb	0	86	0	25	0	0	0	0	0	0	0	0
1995	[77600] GOLDEN LANE;STRAWN (GAS)	Mar	8	433	0	18	0	0	0	0	0	0	0	0
1995	[77600] GOLDEN LANE;STRAWN (GAS)	Apr	19	1460	0	21	0	0	0	0	0	0	0	0
1995	[77600] GOLDEN LANE;STRAWN (GAS)	May	25	1303	44	18	0	0	0	0	0	0	0	0
1995	[77600] GOLDEN LANE;STRAWN (GAS)	Jun	17	589	0	26	0	0	0	0	0	0	0	0
1995	[77600] GOLDEN LANE;STRAWN (GAS)	Jul	96	1914	310	31	0	0	0	0	0	0	0	0
1995	[77600] GOLDEN LANE;STRAWN (GAS)	Aug	103	946	0	24	0	0	0	0	0	0	0	0
1995	[77600] GOLDEN LANE;STRAWN (GAS)	Sep	83	1236	198	30	0	0	0	0	0	0	0	0
1995	[77600] GOLDEN LANE;STRAWN (GAS)	Oct	0	1419	232	31	0	0	0	0	0	0	0	0
1995	[77600] GOLDEN LANE;STRAWN (GAS)	Nov	0	1292	122	30	0	0	0	0	0	0	0	0
1995	[77600] GOLDEN LANE;STRAWN (GAS)	Dec	50	1231	145	31	0	0	0	0	0	0	0	0

1996	[77600]	GOLDEN LANE;STRAWN (GAS)	Jan	2	1211	97	31	0	0	0	0	0	0	0	0
1996	[77600]	GOLDEN LANE;STRAWN (GAS)	Feb	22	773	230	29	0	0	0	0	0	0	0	0
1996	[77600]	GOLDEN LANE;STRAWN (GAS)	Mar	58	1360	299	31	0	0	0	0	0	0	0	0
1996	[77600]	GOLDEN LANE;STRAWN (GAS)	Apr	72	1306	194	30	0	0	0	0	0	0	0	0
1996	[77600]	GOLDEN LANE;STRAWN (GAS)	May	42	1261	246	31	0	0	0	0	0	0	0	0
1996	[77600]	GOLDEN LANE;STRAWN (GAS)	Jun	28	1185	0	28	0	0	0	0	0	0	0	0
1996	[77600]	GOLDEN LANE;STRAWN (GAS)	Jul	97	1035	189	28	0	0	0	0	0	0	0	0
1996	[77600]	GOLDEN LANE;STRAWN (GAS)	Aug	2	1073	183	26	0	0	0	0	0	0	0	0
1996	[77600]	GOLDEN LANE;STRAWN (GAS)	Sep	50	1473	197	30	0	0	0	0	0	0	0	0
1996	[77600]	GOLDEN LANE;STRAWN (GAS)	Oct	30	1277	154	29	0	0	0	0	0	0	0	0
1996	[77600]	GOLDEN LANE;STRAWN (GAS)	Nov	6	1259	122	30	0	0	0	0	0	0	0	0
1996	[77600]	GOLDEN LANE;STRAWN (GAS)	Dec	2	1452	0	31	0	0	0	0	0	0	0	0
1997	[77600]	GOLDEN LANE;STRAWN (GAS)	Jan	6	1367	136	29	0	0	0	0	0	0	0	0
1997	[77600]	GOLDEN LANE;STRAWN (GAS)	Feb	91	1297	216	28	0	0	0	0	0	0	0	0
1997	[77600]	GOLDEN LANE;STRAWN (GAS)	Mar	36	1604	304	31	0	0	0	0	0	0	0	0
1997	[77600]	GOLDEN LANE;STRAWN (GAS)	Apr	140	1455	361	30	0	0	0	0	0	0	0	0
1997	[77600]	GOLDEN LANE;STRAWN (GAS)	May	23	1488	331	31	0	0	0	0	0	0	0	0
1997	[77600]	GOLDEN LANE;STRAWN (GAS)	Jun	80	1554	300	30	0	0	0	0	0	0	0	0
1997	[77600]	GOLDEN LANE;STRAWN (GAS)	Jul	22	1684	378	31	0	0	0	0	0	0	0	0
1997	[77600]	GOLDEN LANE;STRAWN (GAS)	Aug	19	1625	316	31	0	0	0	0	0	0	0	0
1997	[77600]	GOLDEN LANE;STRAWN (GAS)	Sep	11	1685	268	30	0	0	0	0	0	0	0	0
1997	[77600]	GOLDEN LANE;STRAWN (GAS)	Oct	13	1543	108	31	0	0	0	0	0	0	0	0
1997	[77600]	GOLDEN LANE;STRAWN (GAS)	Nov	3	1416	0	30	0	0	0	0	0	0	0	0
1997	[77600]	GOLDEN LANE;STRAWN (GAS)	Dec	0	1439	0	31	0	0	0	0	0	0	0	0
1998	[77600]	GOLDEN LANE;STRAWN (GAS)	Jan	33	1709	173	31	0	0	0	0	0	0	0	0
1998	[77600]	GOLDEN LANE;STRAWN (GAS)	Feb	3	1599	288	28	0	0	0	0	0	0	0	0
1998	[77600]	GOLDEN LANE;STRAWN (GAS)	Mar	0	1377	345	31	0	0	0	0	0	0	0	0
1998	[77600]	GOLDEN LANE;STRAWN (GAS)	Apr	11	1748	322	30	0	0	0	0	0	0	0	0
1998	[77600]	GOLDEN LANE;STRAWN (GAS)	May	33	1678	295	31	0	0	0	0	0	0	0	0
1998	[77600]	GOLDEN LANE;STRAWN (GAS)	Jun	33	1487	276	30	0	0	0	0	0	0	0	0
1998	[77600]	GOLDEN LANE;STRAWN (GAS)	Jul	39	1741	336	31	0	0	0	0	0	0	0	0
1998	[77600]	GOLDEN LANE;STRAWN (GAS)	Aug	39	1783	363	31	0	0	0	0	0	0	0	0

1998	[77600]	GOLDEN LANE;STRAWN (GAS)	Sep	30	1718	334	30	0	0	0	0	0	0	0
1998	[77600]	GOLDEN LANE;STRAWN (GAS)	Oct	49	1853	312	31	0	0	0	0	0	0	0
1998	[77600]	GOLDEN LANE;STRAWN (GAS)	Nov	42	1699	310	30	0	0	0	0	0	0	0
1998	[77600]	GOLDEN LANE;STRAWN (GAS)	Dec	41	1805	407	31	0	0	0	0	0	0	0
1999	[77600]	GOLDEN LANE;STRAWN (GAS)	Jan	35	1765	336	31	0	0	0	0	0	0	0
1999	[77600]	GOLDEN LANE;STRAWN (GAS)	Feb	39	1743	283	28	0	0	0	0	0	0	0
1999	[77600]	GOLDEN LANE;STRAWN (GAS)	Mar	44	1801	366	31	0	0	0	0	0	0	0
1999	[77600]	GOLDEN LANE;STRAWN (GAS)	Apr	44	1885	324	30	0	0	0	0	0	0	0
1999	[77600]	GOLDEN LANE;STRAWN (GAS)	May	44	1968	344	31	0	0	0	0	0	0	0
1999	[77600]	GOLDEN LANE;STRAWN (GAS)	Jun	36	1990	333	1	0	0	0	0	0	0	0
1999	[77600]	GOLDEN LANE;STRAWN (GAS)	Jul	42	2016	295	31	0	0	0	0	0	0	0
1999	[77600]	GOLDEN LANE;STRAWN (GAS)	Aug	38	1986	321	31	0	0	0	0	0	0	0
1999	[77600]	GOLDEN LANE;STRAWN (GAS)	Sep	36	2032	306	30	0	0	0	0	0	0	0
1999	[77600]	GOLDEN LANE;STRAWN (GAS)	Oct	31	1963	274	31	0	0	0	0	0	0	0
1999	[77600]	GOLDEN LANE;STRAWN (GAS)	Nov	31	1911	284	30	0	0	0	0	0	0	0
1999	[77600]	GOLDEN LANE;STRAWN (GAS)	Dec	30	2146	403	31	0	0	0	0	0	0	0
2000	[77600]	GOLDEN LANE;STRAWN (GAS)	Jan	30	2207	246	31	0	0	0	0	0	0	0
2000	[77600]	GOLDEN LANE;STRAWN (GAS)	Feb	31	2193	263	29	0	0	0	0	0	0	0
2000	[77600]	GOLDEN LANE;STRAWN (GAS)	Mar	25	2332	307	31	0	0	0	0	0	0	0
2000	[77600]	GOLDEN LANE;STRAWN (GAS)	Apr	24	2442	264	27	0	0	0	0	0	0	0
2000	[77600]	GOLDEN LANE;STRAWN (GAS)	May	11	2474	239	31	0	0	0	0	0	0	0
2000	[77600]	GOLDEN LANE;STRAWN (GAS)	Jun	31	2318	281	30	0	0	0	0	0	0	0
2000	[77600]	GOLDEN LANE;STRAWN (GAS)	Jul	3	2671	204	31	0	0	0	0	0	0	0
2000	[77600]	GOLDEN LANE;STRAWN (GAS)	Aug	14	2677	210	31	0	0	0	0	0	0	0
2000	[77600]	GOLDEN LANE;STRAWN (GAS)	Sep	14	2836	214	30	0	0	0	0	0	0	0
2000	[77600]	GOLDEN LANE;STRAWN (GAS)	Oct	5	2988	70	31	0	0	0	0	0	0	0
2000	[77600]	GOLDEN LANE;STRAWN (GAS)	Nov	6	2927	117	30	0	0	0	0	0	0	0
2000	[77600]	GOLDEN LANE;STRAWN (GAS)	Dec	11	2524	206	31	0	0	0	0	0	0	0
2001	[77600]	GOLDEN LANE;STRAWN (GAS)	Jan	16	2634	144	31	0	0	0	0	0	0	0
2001	[77600]	GOLDEN LANE;STRAWN (GAS)	Feb	6	2668	175	28	0	0	0	0	0	0	0
2001	[77600]	GOLDEN LANE;STRAWN (GAS)	Mar	36	2716	293	31	0	0	0	0	0	0	0
2001	[77600]	GOLDEN LANE;STRAWN (GAS)	Apr	25	2204	230	30	0	0	0	0	0	0	0

2001	[77600]	GOLDEN LANE;STRAWN (GAS)	May	8	2255	194	31	0	0	0	0	0	0	0	0
2001	[77600]	GOLDEN LANE;STRAWN (GAS)	Jun	3	1805	250	30	0	0	0	0	0	0	0	0
2001	[77600]	GOLDEN LANE;STRAWN (GAS)	Jul	0	2381	143	31	0	0	0	0	0	0	0	0
2001	[77600]	GOLDEN LANE;STRAWN (GAS)	Aug	10	2584	245	29	0	0	0	0	0	0	0	0
2001	[77600]	GOLDEN LANE;STRAWN (GAS)	Sep	2	2409	270	29	0	0	0	0	0	0	0	0
2001	[77600]	GOLDEN LANE;STRAWN (GAS)	Oct	8	2883	320	31	0	0	0	0	0	0	0	0
2001	[77600]	GOLDEN LANE;STRAWN (GAS)	Nov	33	2720	355	30	0	0	0	0	0	0	0	0
2001	[77600]	GOLDEN LANE;STRAWN (GAS)	Dec	31	2792	317	31	0	0	0	0	0	0	0	0
2002	[77600]	GOLDEN LANE;STRAWN (GAS)	Jan	16	2780	1291	31	0	0	0	0	0	0	0	0
2002	[77600]	GOLDEN LANE;STRAWN (GAS)	Feb	14	2481	332	28	0	0	0	0	0	0	0	0
2002	[77600]	GOLDEN LANE;STRAWN (GAS)	Mar	8	2465	283	28	0	0	0	0	0	0	0	0
2002	[77600]	GOLDEN LANE;STRAWN (GAS)	Apr	6	2692	354	30	0	0	0	0	0	0	0	0
2002	[77600]	GOLDEN LANE;STRAWN (GAS)	May	0	2723	265	31	0	0	0	0	0	0	0	0
2002	[77600]	GOLDEN LANE;STRAWN (GAS)	Jun	0	2897	368	30	0	0	0	0	0	0	0	0
2002	[77600]	GOLDEN LANE;STRAWN (GAS)	Jul	8	3000	252	31	0	0	0	0	0	0	0	0
2002	[77600]	GOLDEN LANE;STRAWN (GAS)	Aug	5	2896	321	31	0	0	0	0	0	0	0	0
2002	[77600]	GOLDEN LANE;STRAWN (GAS)	Sep	67	2858	275	30	0	0	0	0	0	0	0	0
2002	[77600]	GOLDEN LANE;STRAWN (GAS)	Oct	23	2774	259	31	0	0	0	0	0	0	0	0
2002	[77600]	GOLDEN LANE;STRAWN (GAS)	Nov	0	2813	303	30	0	0	0	0	0	0	0	0
2002	[77600]	GOLDEN LANE;STRAWN (GAS)	Dec	0	2903	297	31	0	0	0	0	0	0	0	0
2003	[77600]	GOLDEN LANE;STRAWN (GAS)	Jan	0	2908	334	31	0	0	0	0	0	0	0	0
2003	[77600]	GOLDEN LANE;STRAWN (GAS)	Feb	0	2587	229	28	0	0	0	0	0	0	0	0
2003	[77600]	GOLDEN LANE;STRAWN (GAS)	Mar	89	3043	275	31	0	0	0	0	0	0	0	0
2003	[77600]	GOLDEN LANE;STRAWN (GAS)	Apr	16	2869	276	30	0	0	0	0	0	0	0	0
2003	[77600]	GOLDEN LANE;STRAWN (GAS)	May	45	2935	287	30	0	0	0	0	0	0	0	0
2003	[77600]	GOLDEN LANE;STRAWN (GAS)	Jun	45	2935	287	30	0	0	0	0	0	0	0	0
2003	[77600]	GOLDEN LANE;STRAWN (GAS)	Jul	58	3042	293	31	0	0	0	0	0	0	0	0
2003	[77600]	GOLDEN LANE;STRAWN (GAS)	Aug	46	3008	279	31	0	0	0	0	0	0	0	0
2003	[77600]	GOLDEN LANE;STRAWN (GAS)	Sep	40	2903	257	30	0	0	0	0	0	0	0	0
2003	[77600]	GOLDEN LANE;STRAWN (GAS)	Oct	18	2925	323	31	0	0	0	0	0	0	0	0
2003	[77600]	GOLDEN LANE;STRAWN (GAS)	Nov	1	2868	223	30	0	0	0	0	0	0	0	0
2003	[77600]	GOLDEN LANE;STRAWN (GAS)	Dec	0	2984	214	31	0	0	0	0	0	0	0	0

2004	[77600]	GOLDEN LANE;STRAWN (GAS)	Jan	72	2984	237	31	0	0	0	0	0	0	0
2004	[77600]	GOLDEN LANE;STRAWN (GAS)	Feb	0	2718	175	29	0	0	0	0	0	0	0
2004	[77600]	GOLDEN LANE;STRAWN (GAS)	Mar	88	3024	234	31	0	0	0	0	0	0	0
2004	[77600]	GOLDEN LANE;STRAWN (GAS)	Apr	46	2952	259	30	0	0	0	0	0	0	0
2004	[77600]	GOLDEN LANE;STRAWN (GAS)	May	52	2924	235	31	0	0	0	0	0	0	0
2004	[77600]	GOLDEN LANE;STRAWN (GAS)	Jun	57	2889	257	30	0	0	0	0	0	0	0
2004	[77600]	GOLDEN LANE;STRAWN (GAS)	Jul	48	2923	212	31	0	0	0	0	0	0	0
2004	[77600]	GOLDEN LANE;STRAWN (GAS)	Aug	22	2943	257	31	0	0	0	0	0	0	0
2004	[77600]	GOLDEN LANE;STRAWN (GAS)	Sep	29	2820	255	30	0	0	0	0	0	0	0
2004	[77600]	GOLDEN LANE;STRAWN (GAS)	Oct	39	2405	206	27	0	0	0	0	0	0	0
2004	[77600]	GOLDEN LANE;STRAWN (GAS)	Nov	61	1276	46	10	0	0	0	0	0	0	0
2004	[77600]	GOLDEN LANE;STRAWN (GAS)	Dec	7	2515	81	31	0	0	0	0	0	0	0
2005	[77600]	GOLDEN LANE;STRAWN (GAS)	Jan	41	3198	184	31	0	0	0	0	0	0	0
2005	[77600]	GOLDEN LANE;STRAWN (GAS)	Feb	26	543	247	28	0	0	0	0	0	0	0
2005	[77600]	GOLDEN LANE;STRAWN (GAS)	Mar	48	3333	222	31	0	0	0	0	0	0	0
2005	[77600]	GOLDEN LANE;STRAWN (GAS)	Apr	7	3327	89	30	0	0	0	0	0	0	0
2005	[77600]	GOLDEN LANE;STRAWN (GAS)	May	0	3508	30	31	0	0	0	0	0	0	0
2005	[77600]	GOLDEN LANE;STRAWN (GAS)	Jun	1	3270	53	30	0	0	0	0	0	0	0
2005	[77600]	GOLDEN LANE;STRAWN (GAS)	Jul	3	2938	171	31	0	0	0	0	0	0	0
2005	[77600]	GOLDEN LANE;STRAWN (GAS)	Aug	18	3469	109	31	0	0	0	0	0	0	0
2005	[77600]	GOLDEN LANE;STRAWN (GAS)	Sep	5	2749	8	23	0	0	0	0	0	0	0
2005	[77600]	GOLDEN LANE;STRAWN (GAS)	Oct	0	3618	0	31	0	0	0	0	0	0	0
2005	[77600]	GOLDEN LANE;STRAWN (GAS)	Nov	0	3205	0	30	0	0	0	0	0	0	0
2005	[77600]	GOLDEN LANE;STRAWN (GAS)	Dec	0	3053	34	31	0	0	0	0	0	0	0
2006	[77600]	GOLDEN LANE;STRAWN (GAS)	Jan	4	3407	8	31	0	0	0	0	0	0	0
2006	[77600]	GOLDEN LANE;STRAWN (GAS)	Feb	1	3051	8	28	0	0	0	0	0	0	0
2006	[77600]	GOLDEN LANE;STRAWN (GAS)	Mar	0	3407	13	31	0	0	0	0	0	0	0
2006	[77600]	GOLDEN LANE;STRAWN (GAS)	Apr	0	3079	53	30	0	0	0	0	0	0	0
2006	[77600]	GOLDEN LANE;STRAWN (GAS)	May	0	3078	191	31	0	0	0	0	0	0	0
2006	[77600]	GOLDEN LANE;STRAWN (GAS)	Jun	0	2911	144	30	0	0	0	0	0	0	0
2006	[77600]	GOLDEN LANE;STRAWN (GAS)	Jul	0	3159	171	31	0	0	0	0	0	0	0
2006	[77600]	GOLDEN LANE;STRAWN (GAS)	Aug	0	2987	157	31	0	0	0	0	0	0	0

2006	[77600]	GOLDEN LANE;STRAWN (GAS)	Sep	0	2824	103	30	0	0	0	0	0	0	0
2006	[77600]	GOLDEN LANE;STRAWN (GAS)	Oct	0	2855	264	31	0	0	0	0	0	0	0
2006	[77600]	GOLDEN LANE;STRAWN (GAS)	Nov	0	2927	99	30	0	0	0	0	0	0	0
2006	[77600]	GOLDEN LANE;STRAWN (GAS)	Dec	0	3129	75	31	0	0	0	0	0	0	0
2007	[77600]	GOLDEN LANE;STRAWN (GAS)	Jan	0	2910	120	31	0	0	0	0	0	0	0
2007	[77600]	GOLDEN LANE;STRAWN (GAS)	Feb	0	2662	136	28	0	0	0	0	0	0	0
2007	[77600]	GOLDEN LANE;STRAWN (GAS)	Mar	0	2969	174	31	0	0	0	0	0	0	0
2007	[77600]	GOLDEN LANE;STRAWN (GAS)	Apr	0	2855	192	30	0	0	0	0	0	0	0
2007	[77600]	GOLDEN LANE;STRAWN (GAS)	May	0	2960	210	31	0	0	0	0	0	0	0
2007	[77600]	GOLDEN LANE;STRAWN (GAS)	Jun	9	2979	119	30	0	0	0	0	0	0	0
2007	[77600]	GOLDEN LANE;STRAWN (GAS)	Jul	4	3106	162	31	0	0	0	0	0	0	0
2007	[77600]	GOLDEN LANE;STRAWN (GAS)	Aug	0	3170	106	31	0	0	0	0	0	0	0
2007	[77600]	GOLDEN LANE;STRAWN (GAS)	Sep	0	2960	53	30	0	0	0	0	0	0	0
2007	[77600]	GOLDEN LANE;STRAWN (GAS)	Oct	0	3191	38	31	0	0	0	0	0	0	0
2007	[77600]	GOLDEN LANE;STRAWN (GAS)	Nov	0	2842	32	30	0	0	0	0	0	0	0
2007	[77600]	GOLDEN LANE;STRAWN (GAS)	Dec	0	2909	290	31	0	0	0	0	0	0	0
2008	[77600]	GOLDEN LANE;STRAWN (GAS)	Jan	0	2923	59	31	0	0	0	0	0	0	0
2008	[77600]	GOLDEN LANE;STRAWN (GAS)	Feb	0	2677	95	29	0	0	0	0	0	0	0
2008	[77600]	GOLDEN LANE;STRAWN (GAS)	Mar	0	3091	91	31	0	0	0	0	0	0	0
2008	[77600]	GOLDEN LANE;STRAWN (GAS)	Apr	0	2708	65	30	0	0	0	0	0	0	0
2008	[77600]	GOLDEN LANE;STRAWN (GAS)	May	0	2859	28	22	0	0	0	0	0	0	0
2008	[77600]	GOLDEN LANE;STRAWN (GAS)	Jun	0	2950	122	30	0	0	0	0	0	0	0
2008	[77600]	GOLDEN LANE;STRAWN (GAS)	Jul	0	3012	185	22	0	0	0	0	0	0	0
2008	[77600]	GOLDEN LANE;STRAWN (GAS)	Aug	0	3024	187	31	0	0	0	0	0	0	0
2008	[77600]	GOLDEN LANE;STRAWN (GAS)	Sep	0	2291	185	23	0	0	0	0	0	0	0
2008	[77600]	GOLDEN LANE;STRAWN (GAS)	Oct	0	3067	152	31	0	0	0	0	0	0	0
2008	[77600]	GOLDEN LANE;STRAWN (GAS)	Nov	0	3082	125	30	0	0	0	0	0	0	0
2008	[77600]	GOLDEN LANE;STRAWN (GAS)	Dec	0	2721	62	30	0	0	0	0	0	0	0
2009	[77600]	GOLDEN LANE;STRAWN (GAS)	Jan	0	3016	77	31	0	0	0	0	0	0	0
2009	[77600]	GOLDEN LANE;STRAWN (GAS)	Feb	0	2722	124	28	0	0	0	0	0	0	0
2009	[77600]	GOLDEN LANE;STRAWN (GAS)	Mar	0	2974	152	31	0	0	0	0	0	0	0
2009	[77600]	GOLDEN LANE;STRAWN (GAS)	Apr	0	2976	150	30	0	0	0	0	0	0	0

2009	[77600]	GOLDEN LANE;STRAWN (GAS)	May	0	3038	155	31	0	0	0	0	0	0	0
2009	[77600]	GOLDEN LANE;STRAWN (GAS)	Jun	0	2871	150	30	0	0	0	0	0	0	0
2009	[77600]	GOLDEN LANE;STRAWN (GAS)	Jul	0	3091	197	31	0	0	0	0	0	0	0
2009	[77600]	GOLDEN LANE;STRAWN (GAS)	Aug	0	3071	182	31	0	0	0	0	0	0	0
2009	[77600]	GOLDEN LANE;STRAWN (GAS)	Sep	0	3034	157	30	0	0	0	0	0	0	0
2009	[77600]	GOLDEN LANE;STRAWN (GAS)	Oct	0	3088	155	31	0	0	0	0	0	0	0
2009	[77600]	GOLDEN LANE;STRAWN (GAS)	Nov	0	2996	180	30	0	0	0	0	0	0	0
2009	[77600]	GOLDEN LANE;STRAWN (GAS)	Dec	0	3172	277	31	0	0	0	0	0	0	0
2010	[77600]	GOLDEN LANE;STRAWN (GAS)	Jan	0	3027	101	31	0	0	0	0	0	0	0
2010	[77600]	GOLDEN LANE;STRAWN (GAS)	Feb	0	2703	78	28	0	0	0	0	0	0	0
2010	[77600]	GOLDEN LANE;STRAWN (GAS)	Mar	0	2933	157	31	0	0	0	0	0	0	0
2010	[77600]	GOLDEN LANE;STRAWN (GAS)	Apr	0	2767	238	30	0	0	0	0	0	0	0
2010	[77600]	GOLDEN LANE;STRAWN (GAS)	May	0	3150	238	31	0	0	0	0	0	0	0
2010	[77600]	GOLDEN LANE;STRAWN (GAS)	Jun	0	2973	184	30	0	0	0	0	0	0	0
2010	[77600]	GOLDEN LANE;STRAWN (GAS)	Jul	0	3068	240	31	0	0	0	0	0	0	0
2010	[77600]	GOLDEN LANE;STRAWN (GAS)	Aug	0	3121	230	31	0	0	0	0	0	0	0
2010	[77600]	GOLDEN LANE;STRAWN (GAS)	Sep	0	3008	221	30	0	0	0	0	0	0	0
2010	[77600]	GOLDEN LANE;STRAWN (GAS)	Oct	0	3103	151	31	0	0	0	0	0	0	0
2010	[77600]	GOLDEN LANE;STRAWN (GAS)	Nov	0	3000	222	30	0	0	0	0	0	0	0
2010	[77600]	GOLDEN LANE;STRAWN (GAS)	Dec	0	2929	216	31	0	0	0	0	0	0	0
2011	[77600]	GOLDEN LANE;STRAWN (GAS)	Jan	0	2935	209	31	0	0	0	0	0	0	0
2011	[77600]	GOLDEN LANE;STRAWN (GAS)	Feb	0	2766	89	28	0	0	0	0	0	0	0
2011	[77600]	GOLDEN LANE;STRAWN (GAS)	Mar	0	3068	224	31	0	0	0	0	0	0	0
2011	[77600]	GOLDEN LANE;STRAWN (GAS)	Apr	0	2991	228	30	0	0	0	0	0	0	0
2011	[77600]	GOLDEN LANE;STRAWN (GAS)	May	0	3115	227	31	0	0	0	0	0	0	0
2011	[77600]	GOLDEN LANE;STRAWN (GAS)	Jun	0	2942	233	30	0	0	0	0	0	0	0
2011	[77600]	GOLDEN LANE;STRAWN (GAS)	Jul	0	3021	326	31	0	0	0	0	0	0	0
2011	[77600]	GOLDEN LANE;STRAWN (GAS)	Aug	0	3068	236	31	0	0	0	0	0	0	0
2011	[77600]	GOLDEN LANE;STRAWN (GAS)	Sep	0	2980	238	30	0	0	0	0	0	0	0
2011	[77600]	GOLDEN LANE;STRAWN (GAS)	Oct	0	3045	236	31	0	0	0	0	0	0	0
2011	[77600]	GOLDEN LANE;STRAWN (GAS)	Nov	0	2914	244	30	0	0	0	0	0	0	0
2011	[77600]	GOLDEN LANE;STRAWN (GAS)	Dec	0	3072	311	31	0	0	0	0	0	0	0

2012	[77600] GOLDEN LANE;STRAWN (GAS)	Jan	0	3018	332	31	0	0	0	0	0	0	0
2012	[77600] GOLDEN LANE;STRAWN (GAS)	Feb	0	2874	280	29	0	0	0	0	0	0	0
2012	[77600] GOLDEN LANE;STRAWN (GAS)	Mar	0	3116	337	31	0	0	0	0	0	0	0
2012	[77600] GOLDEN LANE;STRAWN (GAS)	Apr	173	3021	227	30	0	0	0	0	0	0	0
2012	[77600] GOLDEN LANE;STRAWN (GAS)	May	17	3120	165	31	0	0	0	0	0	0	0
2012	[77600] GOLDEN LANE;STRAWN (GAS)	Jun	27	2995	238	30	0	0	0	0	0	0	0
2012	[77600] GOLDEN LANE;STRAWN (GAS)	Jul	43	3076	87	31	0	0	0	0	0	0	0
2012	[77600] GOLDEN LANE;STRAWN (GAS)	Aug	157	3076	194	31	0	0	0	0	0	0	0
2012	[77600] GOLDEN LANE;STRAWN (GAS)	Sep	34	2872	157	30	0	0	0	0	0	0	0
2012	[77600] GOLDEN LANE;STRAWN (GAS)	Oct	0	2652	164	25	0	0	0	0	0	0	0
2012	[77600] GOLDEN LANE;STRAWN (GAS)	Nov	37	2348	110	23	0	0	0	0	0	0	0
2012	[77600] GOLDEN LANE;STRAWN (GAS)	Dec	66	3242	172	31	0	0	0	0	0	0	0
2013	[77600] GOLDEN LANE;STRAWN (GAS)	Jan	48	2650	219	26	0	0	0	0	0	0	0
2013	[77600] GOLDEN LANE;STRAWN (GAS)	Feb	34	2925	126	28	0	0	0	0	0	0	0
2013	[77600] GOLDEN LANE;STRAWN (GAS)	Mar	50	2775	150	31	0	0	0	0	0	0	0
2013	[77600] GOLDEN LANE;STRAWN (GAS)	Apr	7	861	42	12	0	0	0	0	0	0	0
2013	[77600] GOLDEN LANE;STRAWN (GAS)	May	32	3413	177	31	0	0	0	0	0	0	0
2013	[77600] GOLDEN LANE;STRAWN (GAS)	Jun	44	1896	98	27	0	0	0	0	0	0	0
2013	[77600] GOLDEN LANE;STRAWN (GAS)	Jul	54	2022	167	31	0	0	0	0	0	0	0
2013	[77600] GOLDEN LANE;STRAWN (GAS)	Aug	27	1410	103	21	0	0	0	0	0	0	0
2013	[77600] GOLDEN LANE;STRAWN (GAS)	Sep	0	132	27	6	0	0	0	0	0	0	0
2013	[77600] GOLDEN LANE;STRAWN (GAS)	Oct	39	2266	140	31	0	0	0	0	0	0	0
2013	[77600] GOLDEN LANE;STRAWN (GAS)	Nov	80	2022	182	30	0	0	0	0	0	0	0
2013	[77600] GOLDEN LANE;STRAWN (GAS)	Dec	26	1155	80	16	0	0	0	0	0	0	0
2014	[77600] GOLDEN LANE;STRAWN (GAS)	Jan	43	2272	138	31	0	0	0	0	0	0	0
2014	[77600] GOLDEN LANE;STRAWN (GAS)	Feb	27	1868	126	28	0	0	0	0	0	0	0
2014	[77600] GOLDEN LANE;STRAWN (GAS)	Mar	25	2015	46	31	0	0	0	0	0	0	0
2014	[77600] GOLDEN LANE;STRAWN (GAS)	Apr	43	1928	130	30	0	0	0	0	0	0	0
2014	[77600] GOLDEN LANE;STRAWN (GAS)	May	37	1809	139	29	0	0	0	0	0	0	0
2014	[77600] GOLDEN LANE;STRAWN (GAS)	Jun	43	1913	190	30	0	0	0	0	0	0	0
2014	[77600] GOLDEN LANE;STRAWN (GAS)	Jul	52	1930	184	31	0	0	0	0	0	0	0
2014	[77600] GOLDEN LANE;STRAWN (GAS)	Aug	68	1547	106	26	0	0	0	0	0	0	0

District I
1625 N. French Dr., Hobbs, NM 88240
Phone: (575) 393-6161 Fax: (575) 393-0720
District II
811 S. First St., Artesia, NM 88210
Phone: (575) 748-1283 Fax: (575) 748-9720
District III
1000 Rio Brazos Road, Aztec, NM 87410
Phone: (505) 334-6178 Fax: (505) 334-6170
District IV
1220 S. St. Francis Dr., Santa Fe, NM 87505
Phone: (505) 476-3460 Fax: (505) 476-3462

State of New Mexico
Energy, Minerals & Natural Resources
Department
OIL CONSERVATION DIVISION
1220 South St. Francis Dr.
Santa Fe, NM 87505

NM OIL CONSERVATION FORM C-102
ARTESIA DISTRICT Revised August 1, 2011
AUG 30 2017
mit one copy to appropriate
District Office
RECEIVED ☐ AMENDED REPORT

WELL LOCATION AND ACREAGE DEDICATION PLAT

¹ API Number 30-015-44083	² Pool Code 98008	³ Pool Name WC-015 G-04 S203032P; BONE SPRING
⁴ Property Code 314286	⁵ Property Name HEYCO STATE	
⁶ Well Number #121H		
⁷ GRID No. 228937	⁸ Operator Name MATADOR PRODUCTION COMPANY	⁹ Elevation 3333'

¹⁰Surface Location

UL or lot no.	Section	Township	Range	Lot Idn	Feet from the	North/South line	Feet from the	East/West line	County
D	32	20-S	30-E	-	326'	NORTH	1012'	WEST	EDDY

UL or lot no.	Section	Township	Range	Lot Idn	Feet from the	North/South line	Feet from the	East/West line	County
M	32	20-S	30-E	-	235'	SOUTH	366'	WEST	EDDY

¹² Dedicated Acres 160.02	¹³ Joint or Infill	¹⁴ Consolidation Code	¹⁵ Order No.
--	-------------------------------	----------------------------------	-------------------------

No allowable will be assigned to this completion until all interests have been consolidated or a non-standard unit has been approved by the division.

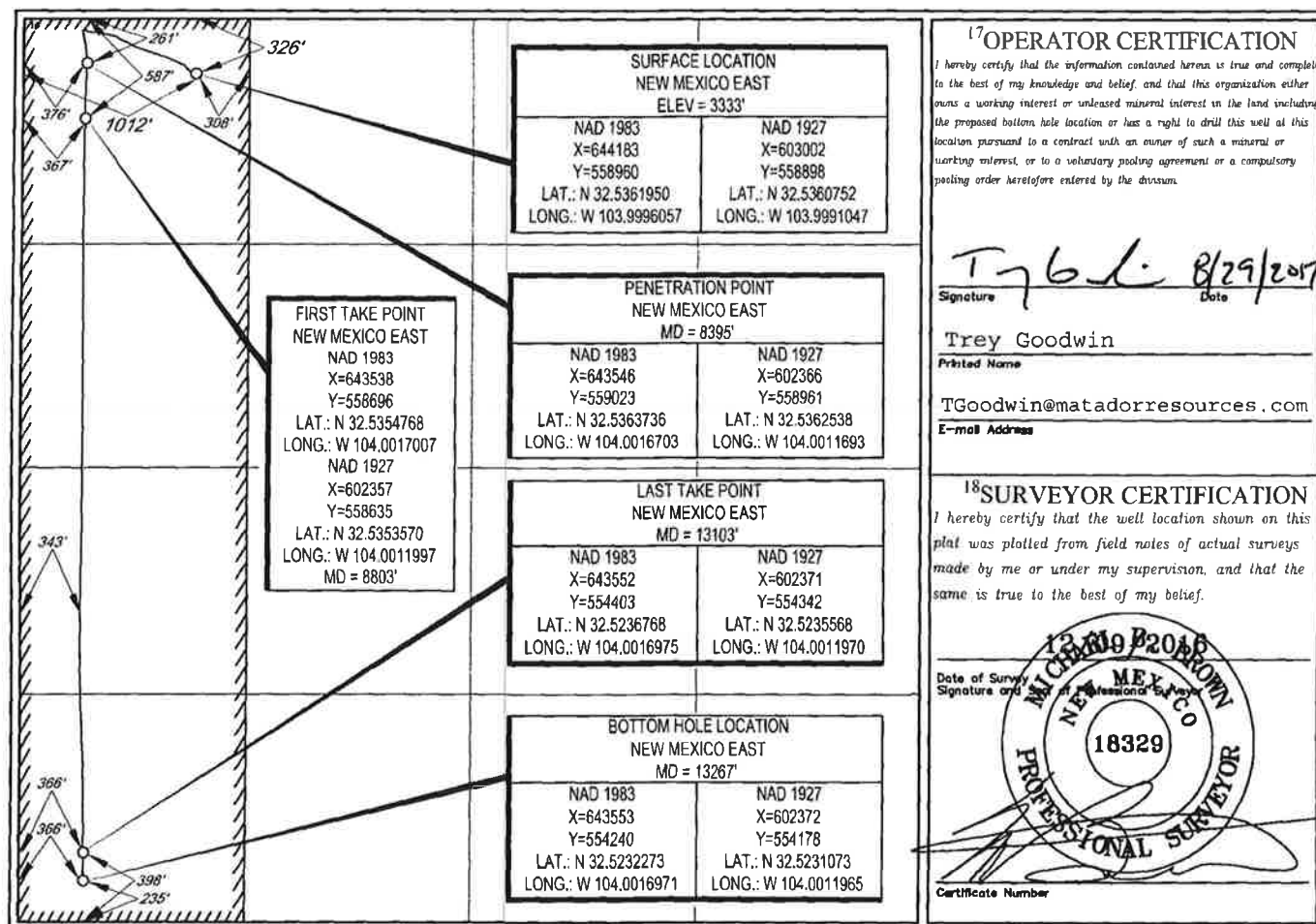

Production Summary Report API: 30-015-44083 HEYCO STATE #121H Printed On: Thursday, September 12 2019												
Year	Pool	Month	Oil(BBLS)	Gas(MCF)	Water(BBLS)	Days P/I	Injection					
							Water(BBLS)	Co2(MCF)	Gas(MCF)	Other	Pressure	
2017	[98008] WC-015 G-04 S203032P;BONE SPRING	Sep	4851	20023	36813	30		0	0	0	0	0
2017	[98008] WC-015 G-04 S203032P;BONE SPRING	Oct	4210	12933	1242	31		0	0	0	0	0
2017	[98008] WC-015 G-04 S203032P;BONE SPRING	Nov	3531	20126	30913	30		0	0	0	0	0
2017	[98008] WC-015 G-04 S203032P;BONE SPRING	Dec	2756	15336	24487	25		0	0	0	0	0
2018	[98008] WC-015 G-04 S203032P;BONE SPRING	Jan	2453	13162	20365	31		0	0	0	0	0
2018	[98008] WC-015 G-04 S203032P;BONE SPRING	Feb	1986	13737	18667	28		0	0	0	0	0
2018	[98008] WC-015 G-04 S203032P;BONE SPRING	Mar	1800	13764	20802	31		0	0	0	0	0
2018	[98008] WC-015 G-04 S203032P;BONE SPRING	Apr	1362	8111	12437	26		0	0	0	0	0
2018	[98008] WC-015 G-04 S203032P;BONE SPRING	May	1548	8127	14384	29		0	0	0	0	0
2018	[98008] WC-015 G-04 S203032P;BONE SPRING	Jun	589	1559	4860	25		0	0	0	0	0
2018	[98008] WC-015 G-04 S203032P;BONE SPRING	Jul	242	92	673	6		0	0	0	0	0
2018	[98008] WC-015 G-04 S203032P;BONE SPRING	Aug	892	338	951	10		0	0	0	0	0
2018	[98008] WC-015 G-04 S203032P;BONE SPRING	Sep	1089	1712	8288	30		0	0	0	0	0

2018	[98008] WC-015 G-04 S203032P;BONE	Oct	878	1354	5421	26	0	0	0	0	0	0
2018	[98008] WC-015 G-04 S203032P;BONE	Nov	1086	1855	7027	30	0	0	0	0	0	0
2018	[98008] WC-015 G-04 S203032P;BONE	Dec	1035	1776	7272	31	0	0	0	0	0	0
2019	[98008] WC-015 G-04 S203032P;BONE	Jan	699	1571	7312	31	0	0	0	0	0	0
2019	[98008] WC-015 G-04 S203032P;BONE	Feb	415	3334	6090	28	0	0	0	0	0	0
2019	[98008] WC-015 G-04 S203032P;BONE	Mar	955	3474	5170	30	0	0	0	0	0	0
2019	[98008] WC-015 G-04 S203032P;BONE	Apr	922	3430	5602	30	0	0	0	0	0	0
2019	[98008] WC-015 G-04 S203032P;BONE	May	746	2987	4649	18	0	0	0	0	0	0
2019	[98008] WC-015 G-04 S203032P;BONE	Jun	997	3664	5973	29	0	0	0	0	0	0

District I
1625 N. French Dr., Hobbs, NM 88240
Phone: (575) 393-6161 Fax: (575) 393-0720
District II
811 S. First St., Artesia, NM 88210
Phone: (575) 748-1283 Fax: (575) 748-9720
District III
1000 Rio Brazos Road, Aztec, NM 87410
Phone: (505) 334-6178 Fax: (505) 334-6170
District IV
1220 S. St. Francis Dr., Santa Fe, NM 87505
Phone: (505) 476-3460 Fax: (505) 476-3462

State of New Mexico
Energy, Minerals & Natural Resources
Department
OIL CONSERVATION DIVISION
1220 South St. Francis Dr.
Santa Fe, NM 87505

FORM C-102
Revised August 1, 2011
ARTESIA DISTRICT Submit one copy to appropriate District Office

RECEIVED ☐ AMENDED REPORT

WELL LOCATION AND ACREAGE DEDICATION PLAT

¹ API Number 30-015-44099		² Pool Code 98008		³ Pool Name WC-015 G-04 S203032P; BONE SPRING	
⁴ Property Code 314286		⁵ Property Name HEYCO STATE			⁶ Well Number #122H
⁷ OGRID No. 228937		⁸ Operator Name MATADOR PRODUCTION COMPANY			⁹ Elevation 3333'

¹⁰Surface Location

UL or lot no.	Section	Township	Range	Lot Idn	Feet from the	North/South line	Feet from the	East/West line	County
D	32	20-S	30-E	-	326'	NORTH	1042'	WEST	EDDY

UL or lot no.	Section	Township	Range	Lot Idn	Feet from the	North/South line	Feet from the	East/West line	County
N	32	20-S	30-E	-	221'	SOUTH	1949'	WEST	EDDY

¹² Dedicated Acres 160.03	¹³ Joint or Infill	¹⁴ Consolidation Code	¹⁵ Order No.
---	-------------------------------	----------------------------------	-------------------------

No allowable will be assigned to this completion until all interests have been consolidated or a non-standard unit has been approved by the division.

	<p>PENETRATION POINT NEW MEXICO EAST MD = 8400'</p> <table border="1"> <tr> <td>NAD 1983 X=645127 Y=559104 LAT.: N 32.5365853 LONG.: W 103.9965404</td> <td>NAD 1927 X=603946 Y=559043 LAT.: N 32.5364655 LONG.: W 103.9960395</td> </tr> </table>	NAD 1983 X=645127 Y=559104 LAT.: N 32.5365853 LONG.: W 103.9965404	NAD 1927 X=603946 Y=559043 LAT.: N 32.5364655 LONG.: W 103.9960395	<p>¹⁷OPERATOR CERTIFICATION I hereby certify that the information contained herein is true and complete to the best of my knowledge and belief, and that this organization either owns a working interest or unleased mineral interest in the land including the proposed bottom hole location or has a right to drill this well at this location pursuant to a contract with an owner of such a mineral or working interest, or to a voluntary pooling agreement or a compulsory pooling order heretofore entered by the division.</p> <p>T. Goodwin 8/29/2017 Signature Date</p> <p>Trey Goodwin Printed Name</p> <p>TGoodwin@matadorresources.com E-mail Address</p>
	NAD 1983 X=645127 Y=559104 LAT.: N 32.5365853 LONG.: W 103.9965404	NAD 1927 X=603946 Y=559043 LAT.: N 32.5364655 LONG.: W 103.9960395		
	<p>FIRST TAKE POINT NEW MEXICO EAST MD = 8823'</p> <table border="1"> <tr> <td>NAD 1983 X=645126 Y=558783 LAT.: N 32.5357009 LONG.: W 103.9965483</td> <td>NAD 1927 X=603945 Y=558721 LAT.: N 32.5355810 LONG.: W 103.9960475</td> </tr> </table>	NAD 1983 X=645126 Y=558783 LAT.: N 32.5357009 LONG.: W 103.9965483	NAD 1927 X=603945 Y=558721 LAT.: N 32.5355810 LONG.: W 103.9960475	
	NAD 1983 X=645126 Y=558783 LAT.: N 32.5357009 LONG.: W 103.9965483	NAD 1927 X=603945 Y=558721 LAT.: N 32.5355810 LONG.: W 103.9960475		
<p>LAST TAKE POINT NEW MEXICO EAST MD = 13225'</p> <table border="1"> <tr> <td>NAD 1983 X=645140 Y=554389 LAT.: N 32.5236226 LONG.: W 103.9965449</td> <td>NAD 1927 X=603960 Y=554327 LAT.: N 32.5235026 LONG.: W 103.9960444</td> </tr> </table>	NAD 1983 X=645140 Y=554389 LAT.: N 32.5236226 LONG.: W 103.9965449	NAD 1927 X=603960 Y=554327 LAT.: N 32.5235026 LONG.: W 103.9960444		
NAD 1983 X=645140 Y=554389 LAT.: N 32.5236226 LONG.: W 103.9965449	NAD 1927 X=603960 Y=554327 LAT.: N 32.5235026 LONG.: W 103.9960444			
<p>BOTTOM HOLE LOCATION NEW MEXICO EAST MD = 13385'</p> <table border="1"> <tr> <td>NAD 1983 X=645135 Y=554229 LAT.: N 32.5231851 LONG.: W 103.9965636</td> <td>NAD 1927 X=603954 Y=554168 LAT.: N 32.5230651 LONG.: W 104.9960632</td> </tr> </table>	NAD 1983 X=645135 Y=554229 LAT.: N 32.5231851 LONG.: W 103.9965636	NAD 1927 X=603954 Y=554168 LAT.: N 32.5230651 LONG.: W 104.9960632		
NAD 1983 X=645135 Y=554229 LAT.: N 32.5231851 LONG.: W 103.9965636	NAD 1927 X=603954 Y=554168 LAT.: N 32.5230651 LONG.: W 104.9960632			
<p>¹⁸SURVEYOR CERTIFICATION I hereby certify that the well location shown on this plat was plotted from field notes of actual surveys made by me or under my supervision, and that the same is true to the best of my belief.</p> <p>Date of Survey Signature of Professional Surveyor</p> <p>18329 MICHAEL B. BOHANNON PROFESSIONAL SURVEYOR</p> <p>Certificate Number</p>				

Production Summary Report API: 30-015-44099 HEYCO STATE #122H Printed On: Thursday, September 12 2019												
Year	Pool	Month	Oil(BBLS)	Gas(MCF)	Water(BBLS)	Days P/I	Water(BBLS)	Co2(MCF)	Gas(MCF)	Other	Pressure	
2017	[98008] WC-015 G-04 S203032P;BONE SPRING	Sep	6048	24622	30436	30		0	0	0	0	
2017	[98008] WC-015 G-04 S203032P;BONE SPRING	Oct	1276	3560	1242	31		0	0	0	0	
2017	[98008] WC-015 G-04 S203032P;BONE SPRING	Nov	4200	16202	22989	30		0	0	0	0	
2017	[98008] WC-015 G-04 S203032P;BONE SPRING	Dec	2690	14095	18697	31		0	0	0	0	
2018	[98008] WC-015 G-04 S203032P;BONE SPRING	Jan	2163	11713	16273	31		0	0	0	0	
2018	[98008] WC-015 G-04 S203032P;BONE SPRING	Feb	1727	8643	11863	28		0	0	0	0	
2018	[98008] WC-015 G-04 S203032P;BONE SPRING	Mar	1723	8443	13031	31		0	0	0	0	
2018	[98008] WC-015 G-04 S203032P;BONE SPRING	Apr	1153	5765	8958	27		0	0	0	0	
2018	[98008] WC-015 G-04 S203032P;BONE SPRING	May	920	1559	2900	18		0	0	0	0	
2018	[98008] WC-015 G-04 S203032P;BONE SPRING	Jun	1014	2944	3914	30		0	0	0	0	
2018	[98008] WC-015 G-04 S203032P;BONE SPRING	Jul	1005	2560	4562	31		0	0	0	0	
2018	[98008] WC-015 G-04 S203032P;BONE SPRING	Aug	816	3223	2718	31		0	0	0	0	
2018	[98008] WC-015 G-04 S203032P;BONE SPRING	Sep	972	7752	5807	23		0	0	0	0	

2018 SPRING	[98008] WC-015 G-04 S203032P;BONE	Oct	956	1547	2440	26	0	0	0	0	0	0	0
2018 SPRING	[98008] WC-015 G-04 S203032P;BONE	Nov	994	3393	2039	30	0	0	0	0	0	0	0
2018 SPRING	[98008] WC-015 G-04 S203032P;BONE	Dec	934	4290	2071	31	0	0	0	0	0	0	0
2019 SPRING	[98008] WC-015 G-04 S203032P;BONE	Jan	1188	4404	2772	31	0	0	0	0	0	0	0
2019 SPRING	[98008] WC-015 G-04 S203032P;BONE	Feb	1198	1975	2535	28	0	0	0	0	0	0	0
2019 SPRING	[98008] WC-015 G-04 S203032P;BONE	Mar	744	1866	2246	29	0	0	0	0	0	0	0
2019 SPRING	[98008] WC-015 G-04 S203032P;BONE	Apr	739	2271	2619	30	0	0	0	0	0	0	0
2019 SPRING	[98008] WC-015 G-04 S203032P;BONE	May	752	2181	2892	31	0	0	0	0	0	0	0
2019 SPRING	[98008] WC-015 G-04 S203032P;BONE	Jun	424	1463	1531	20	0	0	0	0	0	0	0

District I
1625 N. French Drive, Hobbs, NM 88240
District II
811 S. First St., Artesia, NM 88210
District III
1000 Rio Brazos Road, Aztec, NM 87410
District IV
1220 S. St Francis Dr, Santa Fe, NM
87505

State of New Mexico
Energy, Minerals and Natural Resources Department

Form C-107-B
Revised August 1, 2011

OIL CONSERVATION DIVISION
1220 S. St Francis Drive
Santa Fe, New Mexico 87505

Submit the original
application to the Santa Fe
office with one copy to the
appropriate District Office.

APPLICATION FOR SURFACE COMMINGLING (DIVERSE OWNERSHIP)

OPERATOR NAME: Matador Production Company
OPERATOR ADDRESS: 5400 LBJ Freeway Tower 1 Suite 1500 Dallas, TX 75240
APPLICATION TYPE:

☐ Pool Commingling ☐ Lease Commingling ☒ Pool and Lease Commingling ☐ Off-Lease Storage and Measurement (Only if not Surface Commingled)

LEASE TYPE: ☐ Fee ☒ State ☐ Federal

Is this an Amendment to existing Order? ☐ Yes ☒ No If "Yes", please include the appropriate Order No. _____
Have the Bureau of Land Management (BLM) and State Land office (SLO) been notified in writing of the proposed commingling
☒ Yes ☐ No

(A) POOL COMMINGLING
Please attach sheets with the following information

(1) Pool Names and Codes	Gravities / BTU of Non- Commingled Production	Calculated Gravities / BTU of Commingled Production	Calculated Value of Commingled Production	Volumes
WC-015 G-04 S203032P; Bone Spring [98008]	1,241 BTU/CF	1,235 BTU/CF	\$2.1291/mcf (Dec' 18 realized price)	200 mcf/d
Golden Lane; Strawn (Gas) [77600]	1,223 BTU/CF			100 mcf/d

- (2) Are any wells producing at top allowables? ☐ Yes ☒ No
(3) Has all interest owners been notified by certified mail of the proposed commingling? ☒ Yes ☐ No.
(4) Measurement type: ☒ Metering ☐ Other (Specify)
(5) Will commingling decrease the value of production? ☐ Yes ☒ No If "yes", describe why commingling should be approved

(B) LEASE COMMINGLING
Please attach sheets with the following information

- (1) Pool Name and Code- see above
(2) Is all production from same source of supply? ☐ Yes ☒ No
(3) Has all interest owners been notified by certified mail of the proposed commingling? ☒ Yes ☐ No
(4) Measurement type: ☒ Metering ☐ Other (Specify)

(C) POOL and LEASE COMMINGLING
Please attach sheets with the following information

- (1) Complete Sections A and E.

(D) OFF-LEASE STORAGE and MEASUREMENT
Please attached sheets with the following information

- (1) Is all production from same source of supply? ☐ Yes ☒ No
(2) Include proof of notice to all interest owners.

(E) ADDITIONAL INFORMATION (for all application types)
Please attach sheets with the following information

- (1) A schematic diagram of facility, including legal location.
(2) A plat with lease boundaries showing all well and facility locations. Include lease numbers if Federal or State lands are involved.
(3) Lease Names, Lease and Well Numbers, and API Numbers.

I hereby certify that the information above is true and complete to the best of my knowledge and belief.

SIGNATURE: Ben Peterson TITLE: Senior Production Engineer DATE: 10/14/19

TYPE OR PRINT NAME Ben Peterson TELEPHONE NO.: (972) 371-5427

E-MAIL ADDRESS: bpeterson@matadorresources.com

EXHIBIT

3

Matador Production Company

One Lincoln Centre • 5400 LBJ Freeway • Suite 1500 • Dallas, Texas 75240

Voice 972.371.5427 • Fax 972.371.5201

bpeterson@matadorresources.com

Benjamin D. Peterson
Senior Production Engineer

October 14, 2019

New Mexico Oil Conservation Division
1220 South St. Francis Drive
Santa Fe, NM 87505

Re: Application of Matador Production Company for administrative approval for off-lease measurement and approval to pool and lease commingle gas production from the spacing units comprised of the W/2 of Section 32, Township 20 South, Range 30 East, NMPM, Eddy County, New Mexico (the “Lands”)

To Whom This May Concern,

Matador Production Company (“Matador”), OGRID: 228937, requests to commingle gas production from three distinct wells located on the Lands and future production from the Lands as described herein. The wells will be metered through three-phase separators with gas orifice meters. The gas commingling will occur after individual measurement at each well. Gas exiting each well test flows into one gathering line, as depicted on **Exhibit A**, the Enterprise Products Partners L.P. line. Each well on the Lands will have its own three-phase separator with an orifice meter manufactured and assembled in accordance with American Gas Association (AGA) specifications. All primary and secondary Electronic Flow Measurement (EFM) equipment is tested and calibrated by a reputable third party measurement company in accordance with industry specifications.

The orifice meter is the preferred measurement device utilized by midstream and E&P companies in natural gas measurement. The gas samples are obtained at the time of the meter testing/calibration and the composition and heating value are determined by a laboratory in accordance with American Petroleum Institute (API) specifications to ensure accurate volume and Energy (MMBTU) determinations. See example from Fesco Laboratory attached as **Exhibit B** hereto.

The flow stream from each wellhead is demonstrated in the Process Flow Diagram (PFD) attached as **Exhibit A** hereto. The PFD shows that the water, oil, and gas leave the wellbore and flow into a wellhead three-phase separator which separates the oil, gas, and water. The oil is measured via turbine meter which is calibrated periodically by a third party measurement company for accuracy. The gas is measured on a volume and MMBTU basis by an orifice meter and supporting EFM equipment in accordance with American Petroleum Association (API) Chapter 21.1. The gas is

then sent into a gathering line where it is commingled with each of the other wells' metered gas. The gathering line gas is then metered by another orifice meter at the tank battery check to show the total volume of gas leaving the Tank Battery. This meter is tested and calibrated in accordance with industry specifications and volume and energy are determined on an hourly, daily, and monthly basis. Once the gas exits this final tank battery sales check it travels directly into a third party sales connect meter. Enterprise Products Partners L.P has its own orifice meter that measures the gas for custody transfer. These meters are also calibrated periodically to ensure the measurement accuracy.

In conclusion, all the oil and gas produced on the Lands is and will be metered at each wellhead and allocated correctly using the same measurement equipment as the pipeline sales measurement specifications accepted by API as industry standard.

Very truly yours,

MATADOR PRODUCTION COMPANY

A handwritten signature in black ink, appearing to read 'Ben Peterson', with a long horizontal flourish extending to the right.

Benjamin D. Peterson
Sr. Production Engineer

BDP/bkf
Enclosures

September 8, 2017

FESCO, Ltd.
1100 Fesco Ave. - Alice, Texas 78332

For: Matador Production Company
One Lincoln Centre
5400 LBJ Freeway, Suite 1500
Dallas, Texas 75240

Sample: Heyco State No. 121H
First Stage Separator Gas
Spot Sample @ 349 psig & 117 °F

Date Sampled: 08/18/17

Job Number: 73108.001

CHROMATOGRAPH EXTENDED ANALYSIS - GPA 2286

COMPONENT	MOL%	GPM
Hydrogen Sulfide*	< 0.001	
Nitrogen	2.609	
Carbon Dioxide	0.179	
Methane	76.465	
Ethane	12.077	3.223
Propane	5.428	1.492
Isobutane	0.640	0.209
n-Butane	1.427	0.449
2-2 Dimethylpropane	0.000	0.000
Isopentane	0.312	0.114
n-Pentane	0.315	0.114
Hexanes	0.191	0.078
Heptanes Plus	<u>0.357</u>	<u>0.132</u>
Totals	100.000	5.812

Computed Real Characteristics Of Heptanes Plus:

Specific Gravity ----- 3.177 (Air=1)
Molecular Weight ----- 91.68
Gross Heating Value ----- 4605 BTU/CF

Computed Real Characteristics Of Total Sample:

Specific Gravity ----- 0.736 (Air=1)
Compressibility (Z) ----- 0.9964
Molecular Weight ----- 21.25
Gross Heating Value
Dry Basis ----- 1241 BTU/CF
Saturated Basis ----- 1220 BTU/CF

*Hydrogen Sulfide tested on location b: Stain Tube Method (GPA 2377)
Results: 0.063 Gr/100 CF, 1.0 PPMV or 0.0001 Mol%

Base Conditions: 14.650 PSI & 60 Deg F

Sampled By: (24) J. Santos
Analyst: HB
Processor: RG
Cylinder ID: T-2139

Certified: FESCO, Ltd. - Alice, Texas

David Dannhaus 361-661-7000



CHROMATOGRAPH EXTENDED ANALYSIS - GPA 2286
TOTAL REPORT

COMPONENT	MOL %	GPM	WT %
Hydrogen Sulfide*	< 0.001		< 0.001
Nitrogen	2.609		3.440
Carbon Dioxide	0.179		0.371
Methane	76.465		57.734
Ethane	12.077	3.223	17.091
Propane	5.428	1.492	11.265
Isobutane	0.640	0.209	1.751
n-Butane	1.427	0.449	3.904
2,2 Dimethylpropane	0.000	0.000	0.000
Isopentane	0.312	0.114	1.059
n-Pentane	0.315	0.114	1.070
2,2 Dimethylbutane	0.002	0.001	0.008
Cyclopentane	0.000	0.000	0.000
2,3 Dimethylbutane	0.028	0.011	0.114
2 Methylpentane	0.062	0.026	0.251
3 Methylpentane	0.032	0.013	0.130
n-Hexane	0.067	0.027	0.272
Methylcyclopentane	0.043	0.015	0.170
Benzene	0.061	0.017	0.224
Cyclohexane	0.079	0.027	0.313
2-Methylhexane	0.008	0.004	0.038
3-Methylhexane	0.010	0.005	0.047
2,2,4 Trimethylpentane	0.000	0.000	0.000
Other C7's	0.026	0.011	0.121
n-Heptane	0.016	0.007	0.075
Methylcyclohexane	0.044	0.018	0.203
Toluene	0.029	0.010	0.126
Other C8's	0.020	0.009	0.104
n-Octane	0.005	0.003	0.027
Ethylbenzene	0.002	0.001	0.010
M & P Xylenes	0.003	0.001	0.015
O-Xylene	0.001	0.000	0.005
Other C9's	0.006	0.003	0.036
n-Nonane	0.001	0.001	0.006
Other C10's	0.002	0.001	0.013
n-Decane	0.001	0.001	0.007
Undecanes (11)	<u>0.000</u>	<u>0.000</u>	<u>0.000</u>
Totals	100.000	5.812	100.000

Computed Real Characteristics of Total Sample

Specific Gravity -----	0.736	(Air=1)
Compressibility (Z) -----	0.9964	
Molecular Weight -----	21.25	
Gross Heating Value		
Dry Basis -----	1241	BTU/CF
Saturated Basis -----	1220	BTU/CF

FESCO, Ltd.**1100 Fesco Ave. - Alice, Texas 78332****Sample:** Heyco State No. 121H

First Stage Separator Gas

Spot Sample @ 349 psig & 117 °F

Date Sampled: 08/18/17

Job Number: 73108.001

GLYCALC FORMAT

COMPONENT	MOL%	GPM	Wt %
Carbon Dioxide	0.179		0.371
Hydrogen Sulfide	< 0.001		< 0.001
Nitrogen	2.609		3.440
Methane	76.465		57.734
Ethane	12.077	3.223	17.091
Propane	5.428	1.492	11.265
Isobutane	0.640	0.209	1.751
n-Butane	1.427	0.449	3.904
Isopentane	0.312	0.114	1.059
n-Pentane	0.315	0.114	1.070
Cyclopentane	0.000	0.000	0.000
n-Hexane	0.067	0.027	0.272
Cyclohexane	0.079	0.027	0.313
Other C6's	0.124	0.051	0.503
Heptanes	0.103	0.042	0.451
Methylcyclohexane	0.044	0.018	0.203
2,2,4 Trimethylpentane	0.000	0.000	0.000
Benzene	0.061	0.017	0.224
Toluene	0.029	0.010	0.126
Ethylbenzene	0.002	0.001	0.010
Xylenes	0.004	0.002	0.020
Octanes Plus	<u>0.035</u>	<u>0.017</u>	<u>0.193</u>
Totals	100.000	5.812	100.000

Real Characteristics Of Octanes Plus:

Specific Gravity ----- 4.045 (Air=1)
Molecular Weight ----- 116.74
Gross Heating Value ----- 5973 BTU/CF

Real Characteristics Of Total Sample:

Specific Gravity ----- 0.736 (Air=1)
Compressibility (Z) ----- 0.9964
Molecular Weight ----- 21.25
Gross Heating Value
Dry Basis ----- 1241 BTU/CF
Saturated Basis ----- 1220 BTU/CF



October 16, 2019

CERTIFIED MAIL
RETURN RECEIPT REQUESTED

TO: ALL AFFECTED PARTIES

Re: Application of Matador Production Company to authorize pool commingling, off-lease storage, off lease measurement, and off-lease marketing at the Heyco State Tank Battery located in the NW/4 NW/4 (Unit D) of Section 32, Township 20 South, Range 30 East, NMPM, Eddy County, New Mexico.

Ladies and Gentlemen:

Enclosed is a copy of the above-referenced application, which was filed with the New Mexico Oil Conservation Division on this date. Any objection to this application must be filed in writing within twenty days from this date at the Division's Santa Fe office located at 1220 South St. Francis Drive, Santa Fe, New Mexico, 87505. If no objection is received within this twenty-day period, this application may be approved administratively by the Division.

If you have any questions about this application, please contact the following:

Brian Fancher
Matador Production Company
972-371-5242
bfancher@matadorresources.com

Sincerely,

Kaitlyn A. Luck
ATTORNEY FOR
MATADOR PRODUCTION COMPANY

ADDR1	ADDR2	ADDR3	ADDR4	ADDR5
Explorers Petroleum Corp	PO Box 1933	Roswell	New Mexico	88202-1933
Jalapeno Corporation	PO Box 1608	Albuquerque	New Mexico	87103-1608
Spril Inc.	PO Box 1933	Roswell	New Mexico	88202-1933
Yates Energy Corporation	PO Box 2323	Roswell	New Mexico	88202-2323
Commissioner of Public Lands	PO Box 1148	Santa Fe	New Mexico	87504-1148
Aeron A Yates Children's Trust	2843 Seccomb Street	Fort Collins	Colorado	80526
Aeron Yates	2843 Seccomb Street	Fort Collins	Colorado	80526
Carolyn Bulovas Yates	50 Orchard Pines Place	The Woodlands	Texas	77382
Cibola Land Corporation	PO Box 1608	Albuquerque	New Mexico	87103-1608
Colkelan NV Corp., C/O Reta Jones, CPA	6120 Padre Court, NE	Albuquerque	New Mexico	87111
George M Yates	PO Box 1933	Roswell	New Mexico	88202-1933
Harvey E Yates Jr.	PO Box 484	Albuquerque	New Mexico	87103-0484
Leslie Y Messa Children's Trust Attention: Aeron A				
Yates & John Frances Messa, Co-Trustees	PO Box 1887	New Caney	Texas	77357-1887
Nadel and Gussman Capitan, LLC	15 East 5th Street, Ste. 3300	Tulsa	Oklahoma	74103-4340
Nancy J. Lamb, C/O Cavin & Ingram, PA	PO Box 1216	Albuquerque	New Mexico	87103-1216
Noelle L. Lamb, C/O Cavin & Ingram, PA	PO Box 1216	Albuquerque	New Mexico	87103-1216
Penelope A. Lamb, C/O Cavin & Ingram, PA	PO Box 1216	Albuquerque	New Mexico	87103-1216
Petrovates, Inc.	PO Box 1608	Albuquerque	New Mexico	87103-1608
Sally L. Chumbley, Trustee of the Chumbley Family				
Trust, C/O Cavin & Ingram, PA	PO Box 1216	Albuquerque	New Mexico	87103-1216
Steve M Yates Children's Trust	50 Orchard Pines Place	The Woodlands	Texas	77382

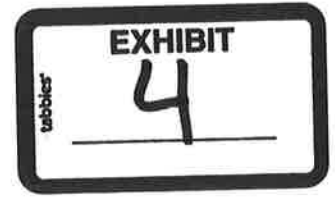



Shipment Confirmation Acceptance Notice

A. Mailer Action

Note to Mailer: The labels and volume associated to this form online, **must** match the labeled packages being presented to the USPS® employee with this form.

Matador - Heyco
CM# 83379.0001

Shipment Date: 10/16/2019

Shipped From:

Name: HOLLAND & HART LLP

Address: 110 N GUADALUPE ST # 1

City: SANTA FE

State: NM ZIP+4® 87501

Type of Mail	Volume
Priority Mail Express®	
Priority Mail®	0
First-Class Package Service®	
Returns	
International*	
Other	21
Total	21

*Start time for products with service guarantees will begin when mail arrives at the local Post Office™ and items receive individual processing and acceptance scans.

B. USPS Action

Note to RSS Clerk:

1. Home screen > Mailing/Shipping > More
2. Select Shipment Confirm
3. Scan or enter the barcode/label number from PS Form 5630
4. Confirm the volume count message by selecting Yes or No
5. Select Pay and End Visit to complete transaction

USPS EMPLOYEE: Please scan upon pickup or receipt of mail.
Leave form with customer or in customer's mail receptacle.

USPS SCAN AT ACCEPTANCE



9275 0901 1935 6200 0017 7429 09



Firm Mailing Book For Accountable Mail

Name and Address of Sender Holland & Hart LLP 110 N Guadalupe St # 1 Santa Fe NM 87501		Check type of mail or service <input type="checkbox"/> Adult Signature Required <input type="checkbox"/> Priority Mail Express <input type="checkbox"/> Adult Signature Restricted Delivery <input type="checkbox"/> Registered Mail <input checked="" type="checkbox"/> Certified Mail <input type="checkbox"/> Return Receipt for Merchandise <input type="checkbox"/> Certified Mail Restricted Delivery <input type="checkbox"/> Signature Confirmation <input type="checkbox"/> Collect on Delivery (COD) <input type="checkbox"/> Signature Confirmation Restricted Delivery <input type="checkbox"/> Insured Mail <input type="checkbox"/> Signature Confirmation Restricted Delivery <input type="checkbox"/> Priority Mail		Affix Stamp Here (If issued as an international certificate of mailing or for additional copies of this receipt). Postmark with Date of Receipt.											
USPS Tracking/Article Number	Addressee (Name, Street, City, State, & ZIP Code™)	Postage	(Extra Service) Fee	Handling Charge	Actual Value if Registered	Insured Value	Due Sender if COD	ASR Fee	ASRD Fee	RD Fee	RR Fee	SC Fee	SCRD Fee	SH Fee	
1. 9214 8901 9403 8395 5982 52	Explorers Petroleum Corp PO BOX 1933 Roswell NM 88202-1933	0.80	3.50	Handling Charge - if Registered and over \$50,000 in value							1.60				
2. 9214 8901 9403 8395 5982 69	Jalapeno Corporation PO BOX 1008 Albuquerque NM 87103-1008	0.80	3.50								1.60				
3. 9214 8901 9403 8395 5982 76	Sprint Inc PO BOX 1933 Roswell NM 88202-1933	0.80	3.50								1.60				
4. 9214 8901 9403 8395 5982 83	Yates Energy Corporation PO BOX 2323 Roswell NM 88202-2323	0.80	3.50								1.60				
5. 9214 8901 9403 8395 5982 90	Commissioner of Public Lands PO BOX 1148 Santa Fe NM 87504-1148	0.80	3.50								1.60				
6. 9214 8901 9403 8395 5983 06	Aaron A Yates Children's Trust 2643 Seccomb Street Fort Collins CO 80526	0.80	3.50								1.60				
7. 9214 8901 9403 8395 5983 13	Aaron Yates 2643 Seccomb Street Fort Collins CO 80526	0.80	3.50								1.60				
8. 9214 8901 9403 8395 5983 20	Carolyn Bulovas Yates 50 Orchard Pines Place The Woodlands TX 77382	0.80	3.50								1.60				
Total Number of Pieces Listed by Sender 21	Total Number of Pieces Received at Post Office	Postmaster, Per (Name of receiving employee)													



Firm Mailing Book For Accountable Mail

Name and Address of Sender Holland & Hart LLP 110 N Guadalupe St # 1 Santa Fe NM 87501		Check type of mail or service <input type="checkbox"/> Adult Signature Required <input type="checkbox"/> Priority Mail Express <input type="checkbox"/> Adult Signature Restricted Delivery <input type="checkbox"/> Registered Mail <input checked="" type="checkbox"/> Certified Mail <input type="checkbox"/> Return Receipt for Merchandise <input type="checkbox"/> Collect on Delivery (COD) <input type="checkbox"/> Signature Confirmation <input type="checkbox"/> Insured Mail <input type="checkbox"/> Signature Confirmation Restricted Delivery <input type="checkbox"/> Priority Mail		Affix Stamp Here (if issued as an international certificate of mailing or for additional copies of this receipt). Postmark with Date of Receipt.											
USPS Tracking/Article Number	Addressee (Name, Street, City, State, & ZIP Code™)	Postage	(Extra Service) Fee	Handling Charge	Actual Value if Registered	Insured Value	Due Sender if COD	ASR Fee	ASRD Fee	RD Fee	RR Fee	SC Fee	SCRD Fee	SH Fee	
9. 9214 8901 9403 8395 5983 37	Cibola Land Corporation PO BOX 1608 Albuquerque NM 87103-1608	0.80	3.50	Handling Charge - if Registered and over \$50,000 in value							1.60				
10. 9214 8901 9403 8395 5983 44	Cokalan NV Corp C/O Reta Jones CPA 8120 Padre Court NE Albuquerque NM 87111	0.80	3.50								1.60				
11. 9214 8901 9403 8395 5983 51	Georgia M Yates PO BOX 1933 Roswell NM 86202-1933	0.80	3.50								1.60				
12. 9214 8901 9403 8395 5983 68	Harvey E Yates Jr PO BOX 484 Albuquerque NM 87103-0484	0.80	3.50								1.60				
13. 9214 8901 9403 8395 5983 75	Leslie Y Messa Children's Trust Attention: Aaron A Yates & John Frances Messa Co-Trustees PO BOX 1887 New Caney TX 77357-1887	0.80	3.50							1.60					
14. 9214 8901 9403 8395 5983 82	Nadel and Gussman Capital LLC 15 East 5th Street Ste 3300 Tulsa OK 74103-4340	0.80	3.50							1.60					
15. 9214 8901 9403 8395 5983 99	Nancy J Lamb C/O Cavin & Ingram PA PO BOX 1216 Albuquerque NM 87103-1216	0.80	3.50							1.60					
16. 9214 8901 9403 8395 5984 05	Huella L Lamb C/O Cavin & Ingram PA PO BOX 1216 Albuquerque NM 87103-1216	0.80	3.50							1.60					
Total Number of Pieces Listed by Sender 21	Total Number of Pieces Received at Post Office	Postmaster, Per (Name of receiving employee)													



PS Form 3877, April 2015 (Page 3 of 3) Complete in Ink Privacy Notice: For more information on USPS privacy policies, visit usps.com/privacypolicy.
PSN 7530-02-000-9098