

# Initial Application Part I

Received: 11/25/2019

*This application is placed in file for record. It MAY or MAY NOT have been reviewed to be determined Administratively Complete*



November 22, 2019

Oil Conservation Division  
1220 South St. Francis Dr.  
Santa Fe, New Mexico 87505

Subject: Select Energy Services – Cersei Federal SWD #2  
Application for Authorization to Inject

To Whom It May Concern,

On behalf of Select Energy Services (Select), ALL Consulting, LLC (ALL) is submitting the enclosed Application for Authorization to Inject for the Cersei Federal SWD #2, a proposed salt water disposal well, in Eddy County, NM.

Should you have any questions regarding the enclosed application, please contact Nate Alleman at (918) 382-7581 or [nalleman@all-llc.com](mailto:nalleman@all-llc.com).

Sincerely,  
ALL Consulting

Nate Alleman  
Sr. Regulatory Specialist

DP4W7-191125-C-1080

Revised March 23, 2017

RECEIVED: 11/25/19	REVIEWER: BLL	TYPE: SWD	APP NO: pBL1933032216
--------------------	---------------	-----------	-----------------------

ABOVE THIS TABLE FOR OCD DIVISION USE ONLY

**NEW MEXICO OIL CONSERVATION DIVISION**  
 - Geological & Engineering Bureau -  
 1220 South St. Francis Drive, Santa Fe, NM 87505

**ADMINISTRATIVE APPLICATION CHECKLIST**

THIS CHECKLIST IS MANDATORY FOR ALL ADMINISTRATIVE APPLICATIONS FOR EXCEPTIONS TO DIVISION RULES AND REGULATIONS WHICH REQUIRE PROCESSING AT THE DIVISION LEVEL IN SANTA FE

Applicant: \_\_\_\_\_ OGRID Number: \_\_\_\_\_  
 Well Name: \_\_\_\_\_ API: \_\_\_\_\_  
 Pool: \_\_\_\_\_ Pool Code: \_\_\_\_\_

**SUBMIT ACCURATE AND COMPLETE INFORMATION REQUIRED TO PROCESS THE TYPE OF APPLICATION INDICATED BELOW**

1) **TYPE OF APPLICATION:** Check those which apply for [A]

A. Location - Spacing Unit - Simultaneous Dedication

☐ NSL☐ NSP (PROJECT AREA)☐ NSP (PRORATION UNIT)☐ SD

SWD-2326

B. Check one only for [ I ] or [ II ]

[ I ] Commingling - Storage - Measurement

☐ DHC☐ CTB☐ PLC☐ PC☐ OLS☐ OLM

[ II ] Injection - Disposal - Pressure Increase - Enhanced Oil Recovery

☐ WFX☐ PMX☐ SWD☐ IPI☐ EOR☐ PPR2) **NOTIFICATION REQUIRED TO:** Check those which apply.A. ☐ Offset operators or lease holdersB. ☐ Royalty, overriding royalty owners, revenue ownersC. ☐ Application requires published noticeD. ☐ Notification and/or concurrent approval by SLOE. ☐ Notification and/or concurrent approval by BLMF. ☐ Surface ownerG. ☐ For all of the above, proof of notification or publication is attached, and/or,H. ☐ No notice required**FOR OCD ONLY**☐

Notice Complete

☐Application  
Content  
Complete

3) **CERTIFICATION:** I hereby certify that the information submitted with this application for administrative approval is **accurate** and **complete** to the best of my knowledge. I also understand that **no action** will be taken on this application until the required information and notifications are submitted to the Division.

**Note:** Statement must be completed by an individual with managerial and/or supervisory capacity.

Date

Print or Type Name

Phone Number

Signature

e-mail Address

STATE OF NEW MEXICO  
ENERGY, MINERALS AND NATURAL  
RESOURCES DEPARTMENT

Oil Conservation Division  
1220 South St. Francis Dr.  
Santa Fe, New Mexico 87505

FORM C-108  
Revised June 10, 2003

**APPLICATION FOR AUTHORIZATION TO INJECT**

- I. PURPOSE: \_\_\_\_\_ Secondary Recovery \_\_\_\_\_ Pressure Maintenance   X   Disposal  
\_\_\_\_\_ Storage Application qualifies for administrative approval?   X   Yes \_\_\_\_\_ No
- II. OPERATOR: Select Energy Services  
ADDRESS: 1820 N I-35, Gainesville, TX 76240  
CONTACT PARTY RJ Metzler PHONE: (940)-665-7000
- III. WELL DATA: Complete the data required on the reverse side of this form for each well proposed for injection.  
Additional sheets may be attached if necessary.
- IV. Is this an expansion of an existing project? \_\_\_\_\_ Yes   X   No  
If yes, give the Division order number authorizing the project: \_\_\_\_\_
- V. Attach a map that identifies all wells and leases within two miles of any proposed injection well with a one-half mile radius circle drawn around each proposed injection well. This circle identifies the well's area of review.
- VI. Attach a tabulation of data on all wells of public record within the area of review which penetrate the proposed injection zone. Such data shall include a description of each well's type, construction, date drilled, location, depth, record of completion, and a schematic of any plugged well illustrating all plugging detail.
- VII. Attach data on the proposed operation, including:
1. Proposed average and maximum daily rate and volume of fluids to be injected;
  2. Whether the system is open or closed;
  3. Proposed average and maximum injection pressure;
  4. Sources and an appropriate analysis of injection fluid and compatibility with the receiving formation if other than reinjected produced water; and,
  5. If injection is for disposal purposes into a zone not productive of oil or gas at or within one mile of the proposed well, attach a chemical analysis of the disposal zone formation water (may be measured or inferred from existing literature, studies, nearby wells, etc.).
- \*VIII. Attach appropriate geologic data on the injection zone including appropriate lithologic detail, geologic name, thickness, and depth. Give the geologic name, and depth to bottom of all underground sources of drinking water (aquifers containing waters with total dissolved solids concentrations of 10,000 mg/l or less) overlying the proposed injection zone as well as any such sources known to be immediately underlying the injection interval.
- IX. Describe the proposed stimulation program, if any.
- \*X. Attach appropriate logging and test data on the well. (If well logs have been filed with the Division, they need not be resubmitted).
- \*XI. Attach a chemical analysis of fresh water from two or more fresh water wells (if available and producing) within one mile of any injection or disposal well showing location of wells and dates samples were taken.
- XII. Applicants for disposal wells must make an affirmative statement that they have examined available geologic and engineering data and find no evidence of open faults or any other hydrologic connection between the disposal zone and any underground sources of drinking water.
- XIII. Applicants must complete the "Proof of Notice" section on the reverse side of this form.
- XIV. Certification: I hereby certify that the information submitted with this application is true and correct to the best of my knowledge and belief.  
NAME: Nate Alleman TITLE: Regulatory Specialist - ALL Consulting  
SIGNATURE:  DATE: 11/22/2019  
E-MAIL ADDRESS: nalleman@all-llc.com
- \* If the information required under Sections VI, VIII, X, and XI above has been previously submitted, it need not be resubmitted. Please show the date and circumstances of the earlier submittal: \_\_\_\_\_

DISTRIBUTION: Original and one copy to Santa Fe with one copy to the appropriate District Office

Side 2

### III. WELL DATA

A. The following well data must be submitted for each injection well covered by this application. The data must be both in tabular and schematic form and shall include:

- (1) Lease name; Well No.; Location by Section, Township and Range; and footage location within the section.
- (2) Each casing string used with its size, setting depth, sacks of cement used, hole size, top of cement, and how such top was determined.
- (3) A description of the tubing to be used including its size, lining material, and setting depth.
- (4) The name, model, and setting depth of the packer used or a description of any other seal system or assembly used.

Division District Offices have supplies of Well Data Sheets which may be used or which may be used as models for this purpose. Applicants for several identical wells may submit a "typical data sheet" rather than submitting the data for each well.

B. The following must be submitted for each injection well covered by this application. All items must be addressed for the initial well. Responses for additional wells need be shown only when different. Information shown on schematics need not be repeated.

- (1) The name of the injection formation and, if applicable, the field or pool name.
- (2) The injection interval and whether it is perforated or open-hole.
- (3) State if the well was drilled for injection or, if not, the original purpose of the well.
- (4) Give the depths of any other perforated intervals and detail on the sacks of cement or bridge plugs used to seal off such perforations.
- (5) Give the depth to and the name of the next higher and next lower oil or gas zone in the area of the well, if any.

### XIV. PROOF OF NOTICE

All applicants must furnish proof that a copy of the application has been furnished, by certified or registered mail, to the owner of the surface of the land on which the well is to be located and to each leasehold operator within one-half mile of the well location.

Where an application is subject to administrative approval, a proof of publication must be submitted. Such proof shall consist of a copy of the legal advertisement which was published in the county in which the well is located. The contents of such advertisement must include:

- (1) The name, address, phone number, and contact party for the applicant;
- (2) The intended purpose of the injection well; with the exact location of single wells or the Section, Township, and Range location of multiple wells;
- (3) The formation name and depth with expected maximum injection rates and pressures; and,
- (4) A notation that interested parties must file objections or requests for hearing with the Oil Conservation Division, 1220 South St. Francis Dr., Santa Fe, New Mexico 87505, within 15 days.

NO ACTION WILL BE TAKEN ON THE APPLICATION UNTIL PROPER PROOF OF NOTICE HAS BEEN SUBMITTED.

---

NOTICE: Surface owners or offset operators must file any objections or requests for hearing of administrative applications within 15 days from the date this application was mailed to them.

Application for Authorization to Inject  
Well Name: Cersei Federal SWD #2

### III – Well Data *(The Wellbore Diagram is included as Attachment 1)*

#### A.

##### (1) General Well Information:

Operator: Select Energy Services (OGRID No. 289068)  
Lease Name & Well Number: Cersei Federal SWD #2  
Location Footage Calls: 1,741' FSL & 871' FEL  
Legal Location: Unit Letter I, S33 T24S R31E  
Ground Elevation: 3,455'  
Proposed Injection Interval: 16,360' – 17,550'  
County: Eddy

##### (2) Casing Information:

Type	Hole Size	Casing Size	Casing Weight	Setting Depth	Sacks of Cement	Estimated TOC	Method Determined
Surface	24"	20"	133.0 lb/ft	575'	600	Surface	Circulation
Intermediate 1	14-3/4"	13-3/8"	68.0 lb/ft	4,350'	970	Surface	Circulation
Intermediate 2	12-1/4"	9-5/8"	53.5 lb/ft	13,570'	4,505	Surface	Circulation
Liner	8-1/2"	7-5/8"	39.0 lb/ft	16,360'	245	13,370'	CBL

Note: A DV Tool will be set at 5,000'.

##### (3) Tubing Information:

5.5" (composite weight string) of fiberglass-coated tubing with setting depth of 16,340'

##### (4) Packer Information: Baker SC-2 or equivalent packer set at 16,340'

#### B.

##### (1) Injection Formation Name: Devonian and Silurian formations

Pool Name: SWD; DEVONIAN - SILURIAN

Pool Code: 97869

##### (2) Injection Interval: Open-hole injection between 16,360' – 17,550'

##### (3) Drilling Purpose: New Drill for Salt Water Disposal

##### (4) Other Perforated Intervals: No other perforated intervals exist.

##### (5) Overlying Oil and Gas Zones: Below are the approximate formation tops for known oil and gas producing zones in the area.

- Permian Delaware Mountain Group (4,350')
- Bone Springs (8,200')
- Wolfcamp (11,560')
- Atoka (13,755')
- Morrow (14,590')

**Underlying Oil and Gas Zones:** No underlying oil and gas zones exist.

## V – Well and Lease Maps

The following maps are included in **Attachment 2**:

- 2-mile Oil & Gas Well Map
- 2-mile Lease Map
- 2-mile Mineral Ownership Map
- 2-mile Surface Ownership Map
- 1.5-mile Deep SWD Map (Devonian/Silurian SWDs)
- 1-mile Well Detail List
- Potash Lease Map

## VI – AOR Well List

There are no wells within the 1-mile AOR that penetrate the proposed injection zone.

A list of the wells within the 1-mile AOR is included in **Attachment 2**.

## VII – Proposed Operation

- (1) **Proposed Maximum Injection Rate:** 30,000 bpd  
**Proposed Average Injection Rate:** 15,000 bpd
- (2) A closed system will be used.
- (3) **Proposed Surface Maximum Injection Pressure:** 3,272 psi (based on 0.2 psi per foot)  
**Proposed Average Surface Injection Pressure:** approximately 1,500 – 2,000 psi
- (4) **Source Water Analysis:** It is expected that the injectate will consist of produced water from production wells completed in the Wolfcamp and Bone Springs formations. Analysis of water from these formations is included in **Attachment 3**.
- (5) **Injection Formation Water Analysis:** The proposed SWD will be injecting water into the Devonian and Silurian formations which is a non-productive zone known to be compatible with formation water from the Wolfcamp and Bone Springs formations. Water analyses from the Devonian-Silurian formation in the area are included in **Attachment 4**.

## VIII – Geologic Description

The proposed injection interval includes the Devonian and Silurian formations from 16,360 – 17,550 feet. These formations consist of carbonate rocks which include light colored dolomite and chert intervals interspersed with some tight limestone intervals. Several thick sections of porous dolomite capable of accepting injected fluids are present within the subject formations in the area.

The base of the deepest Underground Source of Drinking Water (USDW) is at a depth of approximately 550 feet. Surface casing will be set at a depth of 575 feet, which is 25 feet below the top of the Rustler formation, which isolates the USDW. Geophysical log assessment was conducted to accurately determine the top of the Rustler formation, and the top and the base of the Salado formation in this area. Water well depths in the area range from approximately 325 - 450 feet below ground surface.

## **IX – Proposed Stimulation Program**

A small cleanup acid job may be used to remove mud and drill cuttings from the formation. However, no other formation stimulation is currently planned.

## **X – Logging and Test Data**

Logs will be submitted to the Division upon completion of the well.

## **XI – Fresh Groundwater Samples**

Based on a review of data from the New Mexico Office of the State Engineer, there are three groundwater well located within 1-mile of the proposed SWD location. After conversations with the BLM, landowners, and a ranch manager it was determined that only one active water well is located within 1-mile of the proposed SWD location. A groundwater sample was collected on 11-12-2019.

A water well map of the area is included in **Attachment 5**.

## **XII – No Hydrologic Connection Statement**

ALL Consulting has examined available geologic and engineering data and has found no evidence of faulting present in the area that would provide a hydrologic connection between the injection interval and overlying USDWs. Additionally, the casing and cementing program has been designed to further ensure there will be no hydrologic connection between the injection interval and overlying USDWs. A letter from a knowledgeable and qualified expert stating that there is a low risk of seismic activity from the proposed injection activities is included in **Attachment 6**.

## **XIII – Proof of Notice**

A Public Notice was filed with the Carlsbad Current Argus newspaper and an affidavit is included in **Attachment 7**.

A copy of the application was mailed to the OCD District Office, landowner, and leasehold operators within 1-mile of the proposed SWD location. A list of the recipients, as well as delivery confirmations, are included in **Attachment 7**.



# Attachments

**Attachment 1:**

- C-102
- Wellbore Diagram

**Attachment 2:** Area of Review Information:

- 2-mile Oil & Gas Well Map
- 2-mile Lease Map
- 2-mile Mineral Ownership Map
- 2-mile Surface Ownership Map
- 1.5-mile Deep SWD Map (Devonian/Silurian SWDs)
- 1-mile Well Detail List
- Potash Lease Map

**Attachment 3:** Source Water Analyses

**Attachment 4:** Injection Formation Water Analyses

**Attachment 5:** Water Well Map and Well Data

**Attachment 6:** Induced Seismicity Assessment Letter

**Attachment 7:** Public Notice Affidavit and Notice of Application Confirmations

**Attachment 1**

- C-102
- Wellbore Diagram

DISTRICT I  
1625 N. French Dr., Hobbs, NM 88240  
Phone: (575) 393-6161 Fax: (575) 393-0720

DISTRICT II  
811 S. First St., Artesia, NM 88210  
Phone: (575) 748-1283 Fax: (575) 748-9720

DISTRICT III  
1000 Rio Brazos Rd., Aztec, NM 87410  
Phone: (505) 334-6178 Fax: (505) 334-6170

DISTRICT IV  
1220 S. St. Francis Dr., Santa Fe, NM 87505  
Phone: (505) 476-3460 Fax: (505) 476-3462

State of New Mexico  
Energy, Minerals & Natural Resources Department  
**OIL CONSERVATION DIVISION**  
1220 South St. Francis Dr.  
Santa Fe, New Mexico 87505

Form C-102  
Revised August 1, 2011  
Submit one copy to appropriate  
District Office  
☐ AMENDED REPORT

**WELL LOCATION AND ACREAGE DEDICATION PLAT**

API Number	Pool Code <b>97869</b>	Pool Name <b>DEVONIAN - SILURIAN</b>
Property Code	Property Name <b>CERSEI FEDERAL SWD</b>	Well Number <b>#2</b>
OGRID No. <b>289068</b>	Operator Name <b>SELECT ENERGY SERVICES, LLC</b>	Elevation <b>3454.8'</b>

**Surface Location**

UL or lot no. <b>I</b>	Section <b>33</b>	Township <b>24 S</b>	Range <b>31 E</b>	Lot Idn	Feet from the <b>1741</b>	North/South line <b>SOUTH</b>	Feet from the <b>871</b>	East/West line <b>EAST</b>	County <b>EDDY</b>
---------------------------	----------------------	-------------------------	----------------------	---------	------------------------------	----------------------------------	-----------------------------	-------------------------------	-----------------------

**Bottom Hole Location If Different From Surface**

UL or lot no.	Section	Township	Range	Lot Idn	Feet from the	North/South line	Feet from the	East/West line	County
Dedicated Acres		Joint or Infill	Consolidated Code		Order No.				

No allowable will be assigned to this completion until all interests have been consolidated or a non-standard unit has been approved by the division.

<p style="text-align: center;">CERSEI FEDERAL SWD #2 GR. ELEV. 3454.8' NMSP-E (NAD 27) Y = 426621.11' N X = 713482.31' E LAT. = 32.171636° LONG. = -103.776971°</p> <p style="text-align: center;">E 1/4 COR SEC 33 NMSP-E (NAD 27) Y = 427466.83' N X = 714347.36' E</p> <p style="text-align: center;">S 1/4 COR SEC 33 NMSP-E (NAD 27) Y = 424879.68' N X = 711721.80' E</p> <p style="text-align: center;">SE COR SEC 33 NMSP-E (NAD 27) Y = 424879.70' N X = 714367.04' E</p>	<p><b>OPERATOR CERTIFICATION</b></p> <p><i>I hereby certify that the information contained herein is true and complete to the best of my knowledge and belief, and that this organization either owns a working interest or unleased mineral interest in the land including the proposed bottom hole location or has a right to drill this well at this location pursuant to a contract with an owner of such a mineral or working interest, or to voluntary pooling agreement or a compulsory pooling order heretofore entered by the division.</i></p> <p>Signature _____ Date _____</p> <p>Print Name _____</p> <p>E-mail Address _____</p> <p><b>SURVEYORS CERTIFICATION</b></p> <p><i>I hereby certify that the well location shown on this plat was plotted from field notes of actual surveys made by me or under my supervision, and that the same is true and correct to the best of my belief.</i></p> <p>NOVEMBER 14, 2019 Date of Survey</p> <p>Signature and Seal of Professional Surveyor</p> <div style="text-align: center;"> </div> <p>Job No.: SEL190001 TIM C. PAPPAS, NM P.L.S. NO. 21209</p>
------------------------------------------------------------------------------------------------------------------------------------------------------------------------------------------------------------------------------------------------------------------------------------------------------------------------------------------------------------------------------------------------------------------------------------------------------------------------------------------------------------------------------------------------	-------------------------------------------------------------------------------------------------------------------------------------------------------------------------------------------------------------------------------------------------------------------------------------------------------------------------------------------------------------------------------------------------------------------------------------------------------------------------------------------------------------------------------------------------------------------------------------------------------------------------------------------------------------------------------------------------------------------------------------------------------------------------------------------------------------------------------------------------------------------------------------------------------------------------------------------------------------------------------------------------------------------------------------------------------------------------------------------------------------------------------

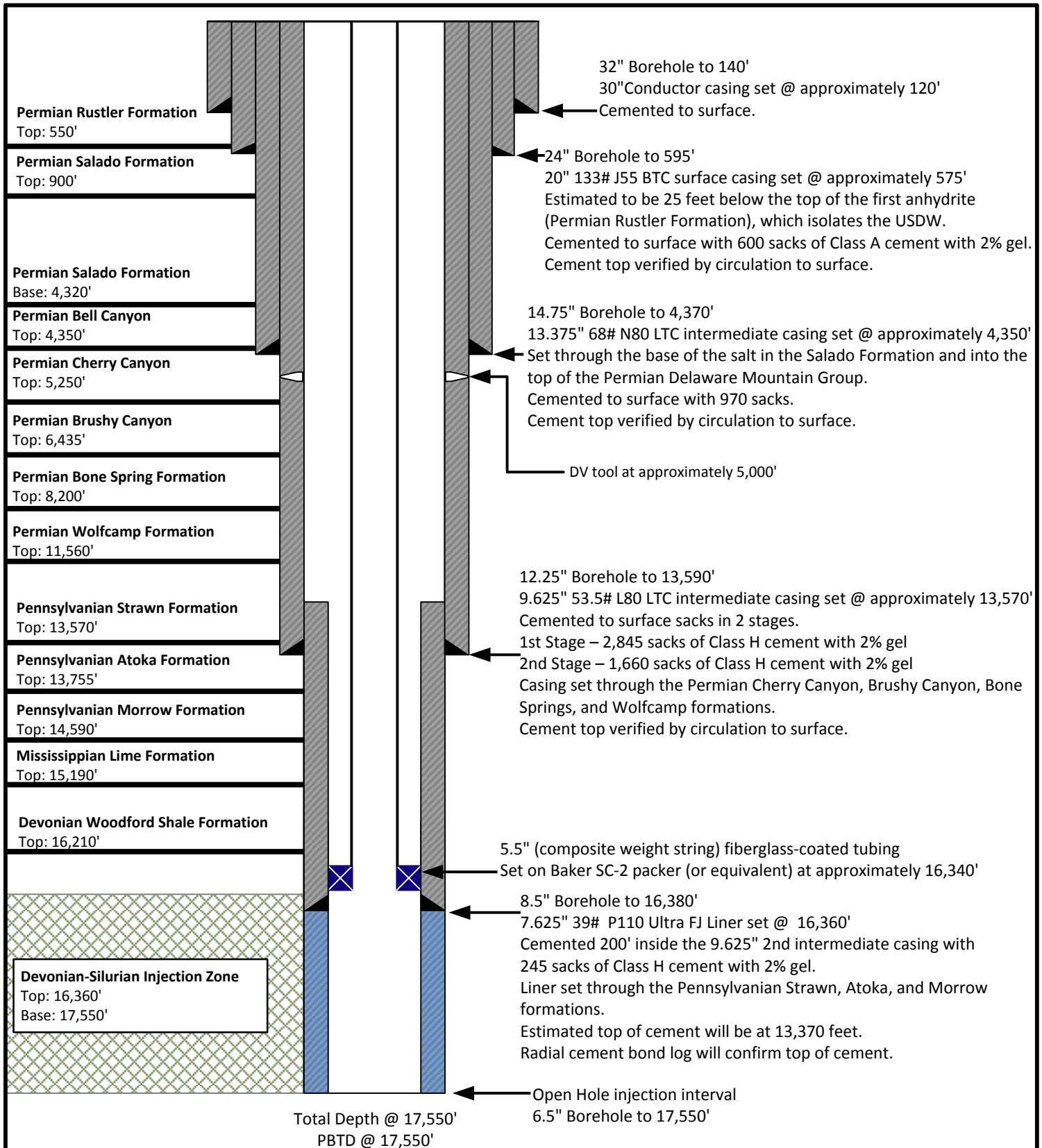

NOT TO SCALE

Note: Listed depths and cement volumes are approximates based on available information. All cement calculations use yield of 1.18 cubic foot per sack and include 25% excess.

Prepared by:

Drawn by: Joshua Ticknor

Project Manager:  
Dan Arthur

Date: 11/14/2019

**Select Energy Services**  
**Cersei Federal SWD #2**

**SC-2 Packer****1 Introduction**

The SC-2™ packer is Baker Hughes, a GE company (BHGE)' primary packer for cased hole gravel pack and frac pack applications where a high performance retrievable packer is required.

**2 Description**

The SC-2 packer is a fully retrievable, high-performance retainer production packer. Although the packer was originally designed for premium gravel pack applications, it may also be used as a standard completion packer in wells where a premium retrievable production packer is required.

The SC-2 packer is fully compatible with standard BHGE sealing accessories, including retrievable and expendable plugs.

Refer to the specifications guide in the Packer Size/Model Availability Guide, Specification Guide, and Packer/Accessory Guide for SC™ and HP™ Packers (Product Family H48861), Unit 5750 under Sand Control Tools for packer/accessory size and packer size/model availability.

**3 Application**

The SC-2 packer is primarily used in gravel pack or frac pack applications where a higher differential pressure production rating, treating pressure rating and temperature are required. The SC-2 may also be used as a production packer.

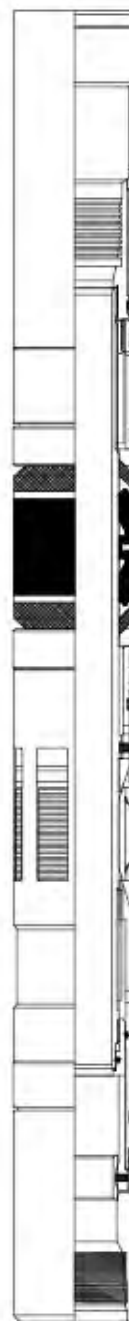

## **Attachment 2**

### Area of Review Information:

- 2-mile Oil & Gas Well Map
- 2-mile Lease Map
- 2-mile Mineral Ownership Map
- 2-mile Surface Ownership Map
- 1.5-mile Deep SWD Map (Devonian/Silurian SWDs)
- 1-mile Well Detail List
- Potash Lease Map



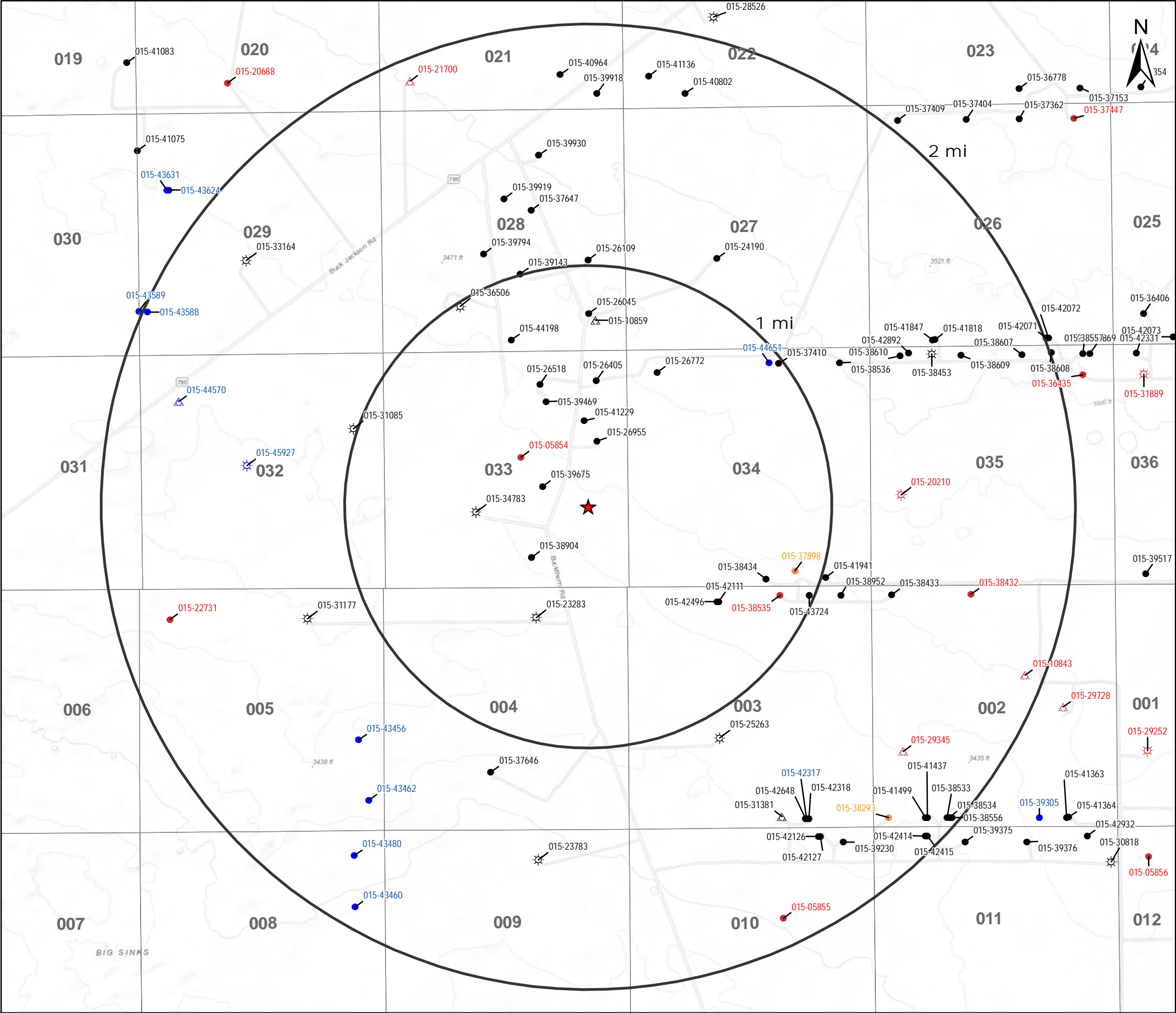

**Legend**

- ★ Proposed SWD
- ☼ Gas, Active (11)
- ⚙ Gas, New (1)
- ☼ Gas, Plugged (3)
- Oil, Active (71)
- Oil, New (11)
- Oil, Plugged (9)
- Oil, Temporarily Abandoned (2)
- △ Salt Water Injection, Active (2)
- △ Salt Water Injection, New (1)
- △ Salt Water Injection, Plugged (4)

Source Info: NMOCD O&G Wells updated 7/30/2019  
(<http://www.emnrd.state.nm.us/OCD/ocdgis.html>)

**O&G Wells Area of Review**

**CERSEI FEDERAL SWD #2**  
**Eddy County, New Mexico**

Proj Mgr:  
Dan Arthur

November 18, 2019

Mapped by:  
Ben Bockelmann

Prepared for:



Prepared by:



0 0.5 1 2 Miles

Service Layer Credits: Sources: Esri, HERE, Garmin, Intermap, increment P Corp., GEBCO, USGS, FAO, NPS, NRCAN, GeoBase, IGN, Kadaster NL, Ordnance Survey, Esri Japan, METI, Esri China (Hong Kong), (c) OpenStreetMap contributors, and the GIS User Community

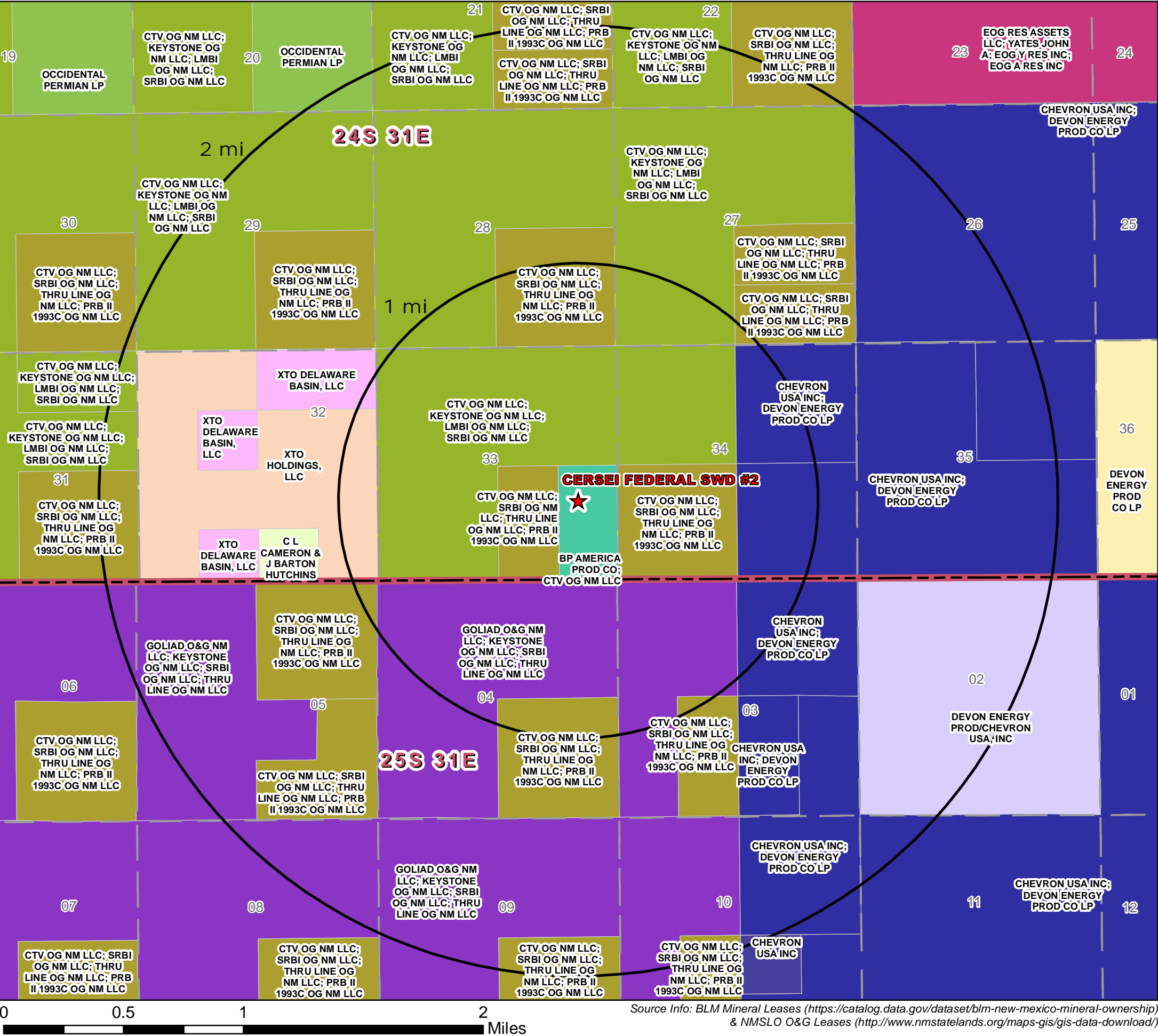

**Legend**

★ Proposed SWD

**BLM Mineral Leases**

- BP AMERICA PROD CO; CTV OG NM LLC
- CHEVRON USA INC
- CHEVRON USA INC; DEVON ENERGY PROD CO LP
- CTV OG NM LLC; KEYSTONE OG NM LLC; LMBI OG NM LLC; SRBI OG NM LLC
- CTV OG NM LLC; SRBI OG NM LLC; THRU LINE OG NM LLC; PRB II 1993C OG NM LLC
- EOG RES ASSETS LLC; YATES JOHN A; EOG Y RES INC; EOG A RES INC
- GOLIAD O&G NM LLC; KEYSTONE OG NM LLC; SRBI OG NM LLC; THRU LINE OG NM LLC
- OCCIDENTAL PERMIAN LP

**NMSLO Mineral Leases**

- C L CAMERON & J BARTON HUTCHINS
- DEVON ENERGY PROD CO LP
- DEVON ENERGY PROD/CHEVRON USA, INC
- XTO DELAWARE BASIN, LLC
- XTO HOLDINGS, LLC

N

Mineral Lease  
Area of Review

CERSEI FEDERAL SWD #2  
Eddy County, New Mexico

Proj Mgr: Dan Arthur	November 20, 2019	Mapped by: Ben Bockelmann
-------------------------	-------------------	------------------------------

Prepared for: 	Prepared by: 
-------------------	------------------



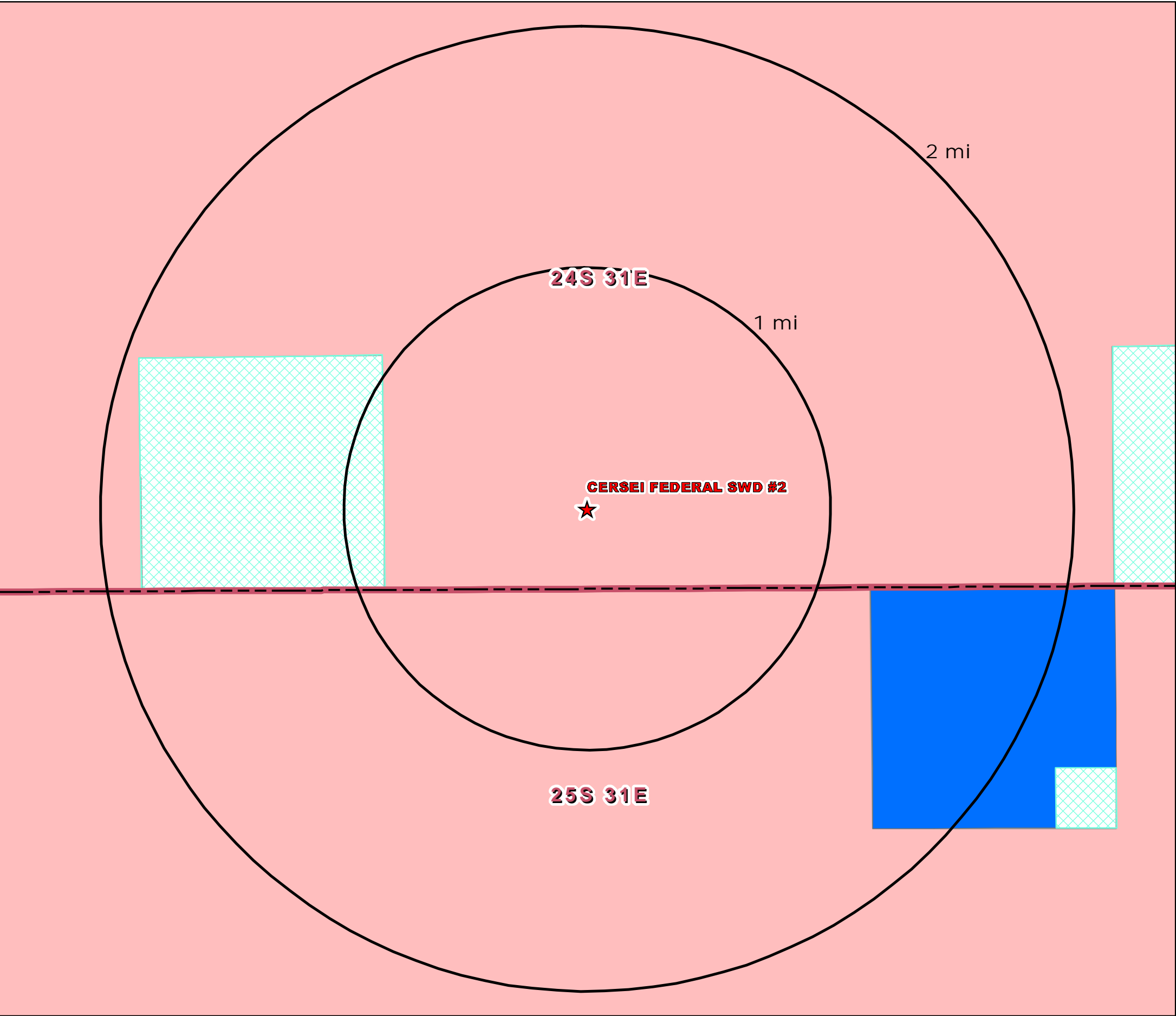

Legend

- ★ Proposed SWD
- Mineral Ownership**
  - All minerals are owned by U.S. (BLM)
  - Subsurface minerals (NMSLO)
  - Surface and Subsurface minerals (NMSLO)
  - Private minerals

Mineral Ownership Area of Review		
CERSEI FEDERAL SWD #2 Eddy County, New Mexico		
Proj Mgr: Dan Arthur	November 14, 2019	Mapped by: Ben Bockelmann
Prepared for: 		Prepared by: 



Source Info: BLM Mineral Ownership (<https://catalog.data.gov/dataset/blm-new-mexico-mineral-ownership>) & NMSLO Ownership (<http://www.nmstatelands.org/maps-gis/gis-data-download/>)

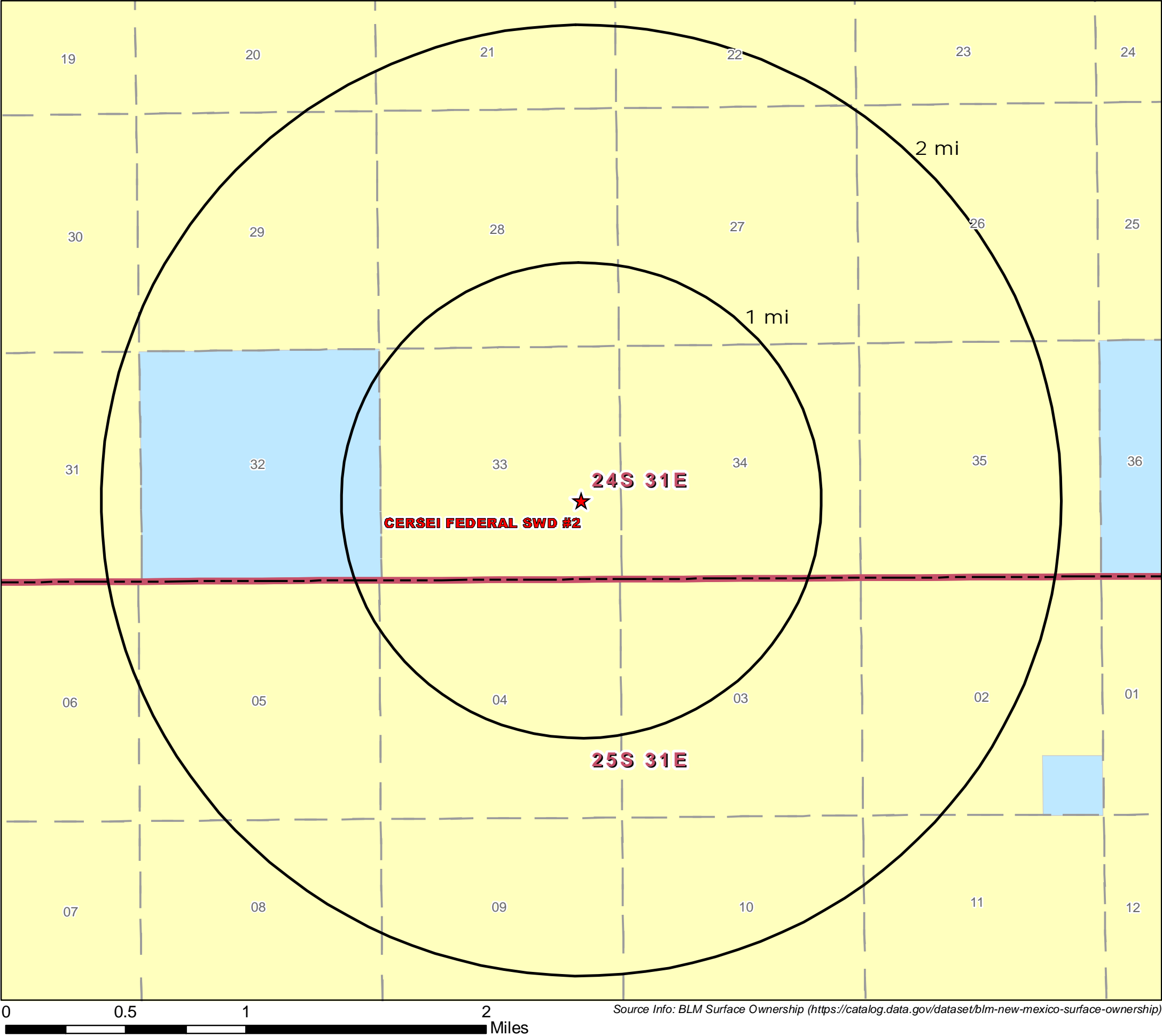

**Legend**

★ Proposed SWD

**Surface Ownership**

BLM

State



Surface Ownership  
Area of Review

CERSEI FEDERAL SWD #2  
Eddy County, New Mexico

Proj Mgr:  
Dan Arthur

November 14, 2019

Mapped by:  
Ben Bockelmann

Prepared for:  
**SELECT**  
ENERGY SERVICES

Prepared by:  
**ALL**CONSULTING

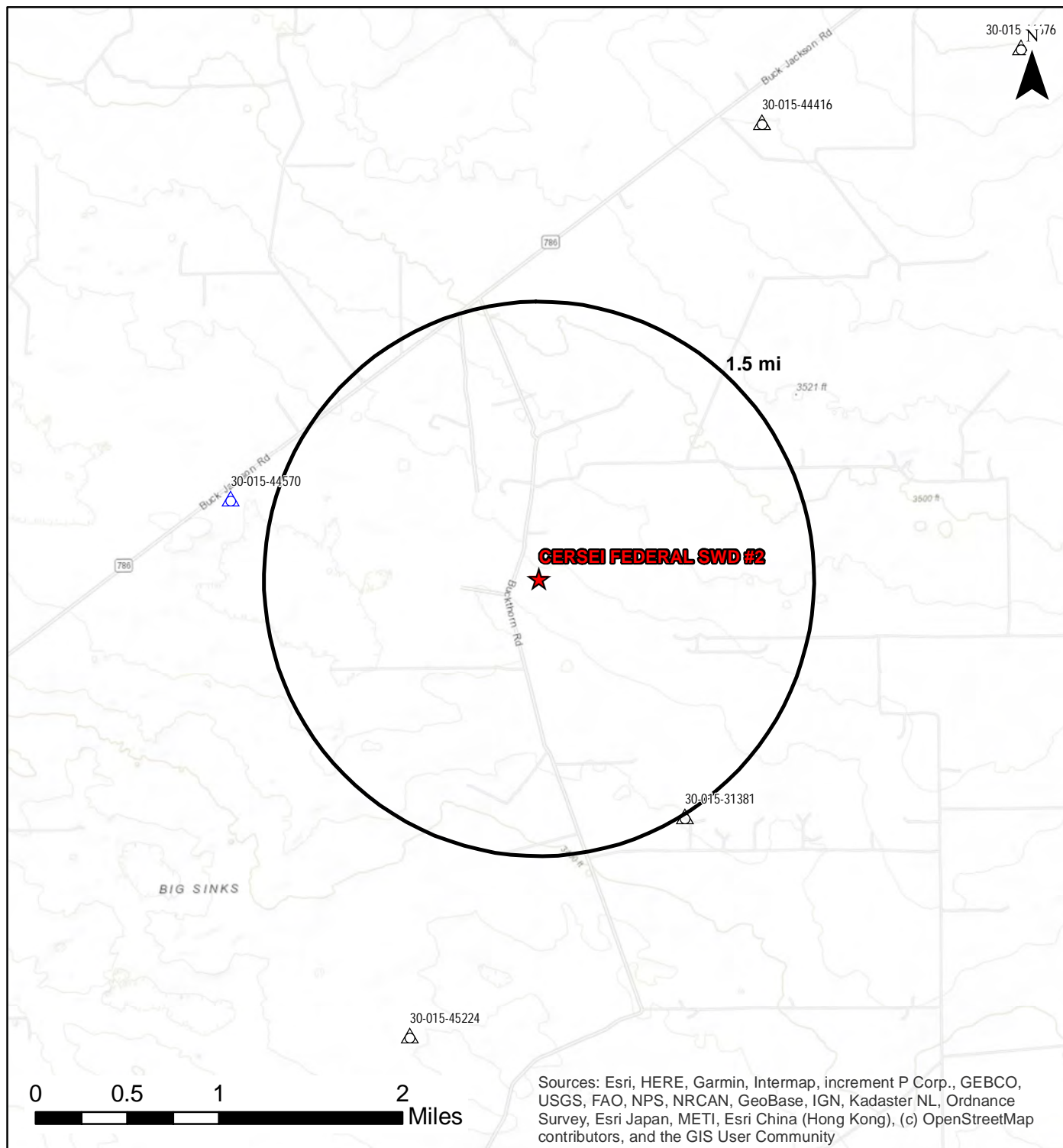

## CERSEI FEDERAL SWD #2 Deep SWDs AOR

Proj Mgr:  
Dan Arthur

Nov 20, 2019

Mapped by:  
Ben Bockelmann

Prepared for:



Prepared by:



### Legend



Proposed SWD

### Devonian/Silurian SWDs



Salt Water Injection, Active (5)



Salt Water Injection, New (1)

Source Info: NMOCD O&G Wells updated 7/30/2019  
(<http://www.emnrd.state.nm.us/OCD/ocdgis.html>)

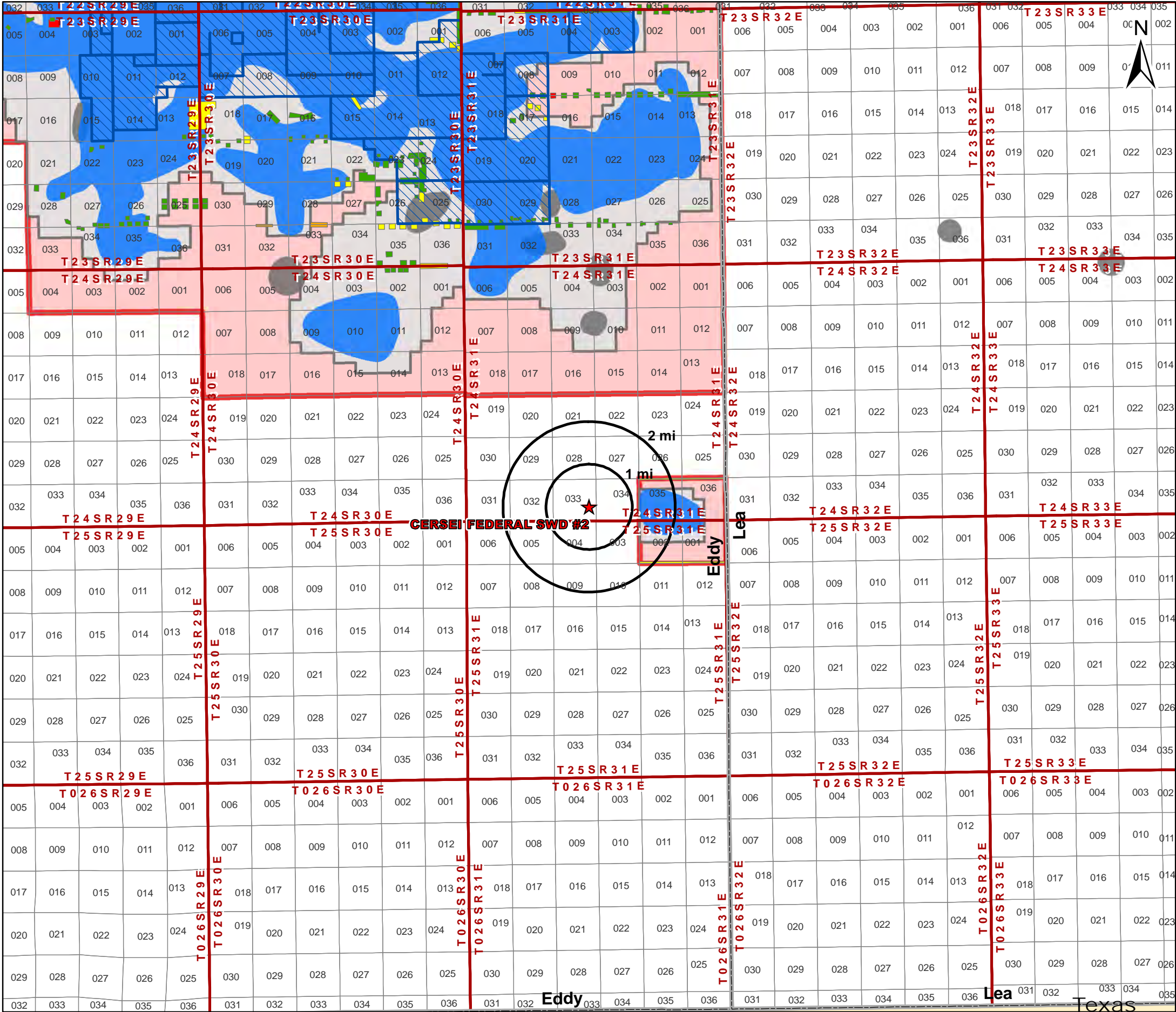

Legend

- ★ Proposed SWD
- Potash Leases
- Ore Type - Measured
- Ore Type - Indicated
- KPLA
- SOPA
- Drill Islands
- Status
  - Approved
  - Denied
  - Nominated
  - Withdrawn

Potash Leases  
Area of Review

CERSEI FEDERAL SWD #2  
Eddy County, New Mexico

Proj Mgr:  
Dan Arthur

November 20, 2019

Mapped by:  
Ben Bockelmann

Prepared for:  
 SELECT  
ENERGY SERVICES

Prepared by:  
 ALL  
CONSULTING

**Attachment 3**

Source Water Analyses



## PRODUCED WATER FROM BONE SPRING, DELAWARE, DEVONIAN, WOLFCAMP

API	SECTION	TOWNSHIP	RANGE	FORMATION	tds mgL	chloride mgL	bicarbonate mgL	sulfate mgL
3002502424	11	20S	34E	BONE SPRING	29436	16720	634	1142
3002502427	12	20S	34E	BONE SPRING	15429			
3002502427	12	20S	34E	BONE SPRING	180701	108300	1016	670
3002502429	12	20S	34E	BONE SPRING	202606	118100	5196	992
3002502429	12	20S	34E	BONE SPRING	121800			
3002502431	12	20S	34E	BONE SPRING	147229	89640	108	1038
3002531696	2	20S	34E	DELAWARE	152064	102148	404	691
3002532105	2	20S	34E	DELAWARE	296822	215237	143	294
3002532466	2	20S	34E	DELAWARE	340838	245270	229	147
3002502427	12	20S	34E	DELAWARE	214787	132700	208	1816
3002502431	12	20S	34E	DEVONIAN	33414	18570	227	1961
3002502432	13	20S	34E	DEVONIAN	45778	26440	1145	729
3002501912	16	16S	34E	WOLFCAMP	164004	102500	4204	1249
3002501922	20	16S	34E	WOLFCAMP	104541	64290	280	541
3002501922	20	16S	34E	WOLFCAMP	104033	64080	268	515
3002501922	20	16S	34E	WOLFCAMP	105175	65570	207	192
3002501925	21	16S	34E	WOLFCAMP	86355	51800	610	665
3002501928	21	16S	34E	WOLFCAMP	119102	73300	227	454
3002501928	21	16S	34E	WOLFCAMP	35422	19170	979	1949
3002501930	22	16S	34E	WOLFCAMP	30015	14800	750	3300
3002501931	22	16S	34E	WOLFCAMP	87680	53000	301	681
3002501933	28	16S	34E	WOLFCAMP	59960	35100	515	1500
3002501933	28	16S	34E	WOLFCAMP	60309	35350	586	1297
3002501940	30	16S	34E	WOLFCAMP	82422	49890	361	787
3002501944	30	16S	34E	WOLFCAMP	83960	51410	418	641
3002520222	27	16S	34E	WOLFCAMP	85457	51020	544	1201
3001542895	2	23S	31E	WOLFCAMP	119472	73173		1036

EXHIBIT F

**Attachment 4**

Injection Formation Water Analyses

Injection Formation Water Analysis																			
Select Energy Services - Devonian , Fusselman & Silurian formations																			
Wellname	API	Latitude	Longitude	Section	Township	Range	Unit	ftgns	ftgew	County	State	company	Field	Formation	Depth	tds_mgL	chloride_mgL	bicarbonate_mgL	sulfate_mgL
FARNSWORTH FEDERAL #006	3002511950	32.0777245	-103.162468	4	26S	37E	A	660N	990E	LEA	NM		CROSBY	DEVONIAN		31,931	20,450	302	591
ARNOTT RAMSAY NCT-B #003	3002511863	32.0922279	-103.1784439	32	25S	37E	A	660N	660E	LEA	NM		CROSBY	DEVONIAN	8797		100,382	476	
STATE NJ A #001	3002511398	32.1647491	-103.1273346	2	25S	37E	A	663N	660E	LEA	NM		JUSTIS NORTH	DEVONIAN		105,350	59,300	660	4,950
COPPER #001	3002511818	32.0994835	-103.1656723	28	25S	37E	J	1980S	1981E	LEA	NM		CROSBY	DEVONIAN		27,506	15,270	1,089	1,079
ARNOTT RAMSAY NCT-B #003	3002511863	32.0922279	-103.1784439	32	25S	37E	A	660N	660E	LEA	NM		CROSBY	DEVONIAN		158,761			
BELL LAKE UNIT #006	3002508483	32.3282585	-103.507103	6	23S	34E	O	660S	1980E	LEA	NM		BELL LAKE NORTH	DEVONIAN		71,078	42,200	500	1,000
CLINE FEDERAL #001	3002510717	32.3025551	-103.1358261	14	23S	37E	K	1980S	1980W	LEA	NM		CLINE	DEVONIAN		118,979	71,280	462	2,593
E C HILL B FEDERAL #001	3002510945	32.2658463	-103.1443634	34	23S	37E	A	810N	660E	LEA	NM		TEAGUE	DEVONIAN		112,959	67,390	288	2,765
E C HILL D FEDERAL #001	3002510947	32.2622147	-103.1443634	34	23S	37E	H	2131N	660E	LEA	NM		TEAGUE	DEVONIAN		35,639			
E C HILL D FEDERAL #004	3002510950	32.2653503	-103.1443634	34	23S	37E	A	990N	660E	LEA	NM		TEAGUE	DEVONIAN		236,252	147,000	129	781
ANTELOPE RIDGE UNIT #003	3002521082	32.2593155	-103.4610748	34	23S	34E	K	1980S	1650W	LEA	NM		ANTELOPE RIDGE	DEVONIAN		80,187	47,900	476	900
REMUDA BASIN UNIT #001	3001503691	32.2886238	-103.9360428	24	23S	29E	J	1980S	1980E	EDDY	NM		REMUDA	DEVONIAN		64,582	37,500	610	1,700
REMUDA BASIN UNIT #001	3001503691	32.2886238	-103.9360428	24	23S	29E	J	1980S	1980E	EDDY	NM		REMUDA	DEVONIAN		56,922	29,000	1,740	4,980
STATE B COM #001	3002509716	32.1794052	-103.2212524	36	24S	36E	C	600N	1880W	LEA	NM		CUSTER	DEVONIAN		176,234	107,400	128	1,004
WHITE CITY PENN GAS COM UNIT 1 #001	3001500408	32.1937523	-104.3088455	29	24S	26E	A	660N	660E	EDDY	NM			DEVONIAN			10,120	653	1,336
BIG EDDY UT #001	3001502475	32.4421539	-104.042305	36	21S	28E	C	660N	1980W	EDDY	NM			DEVONIAN		16,223	7,000	1,030	2,290
BIG EDDY UT #001	3001502475	32.4421539	-104.042305	36	21S	28E	C	660N	1980W	EDDY	NM			DEVONIAN		19,941	10,700	640	1,130
Source: <a href="http://gotech.nmt.edu/gotech/Water/producedwater.aspx">http://gotech.nmt.edu/gotech/Water/producedwater.aspx</a>																			



**Attachment 5**

Water Well Map and Well Data



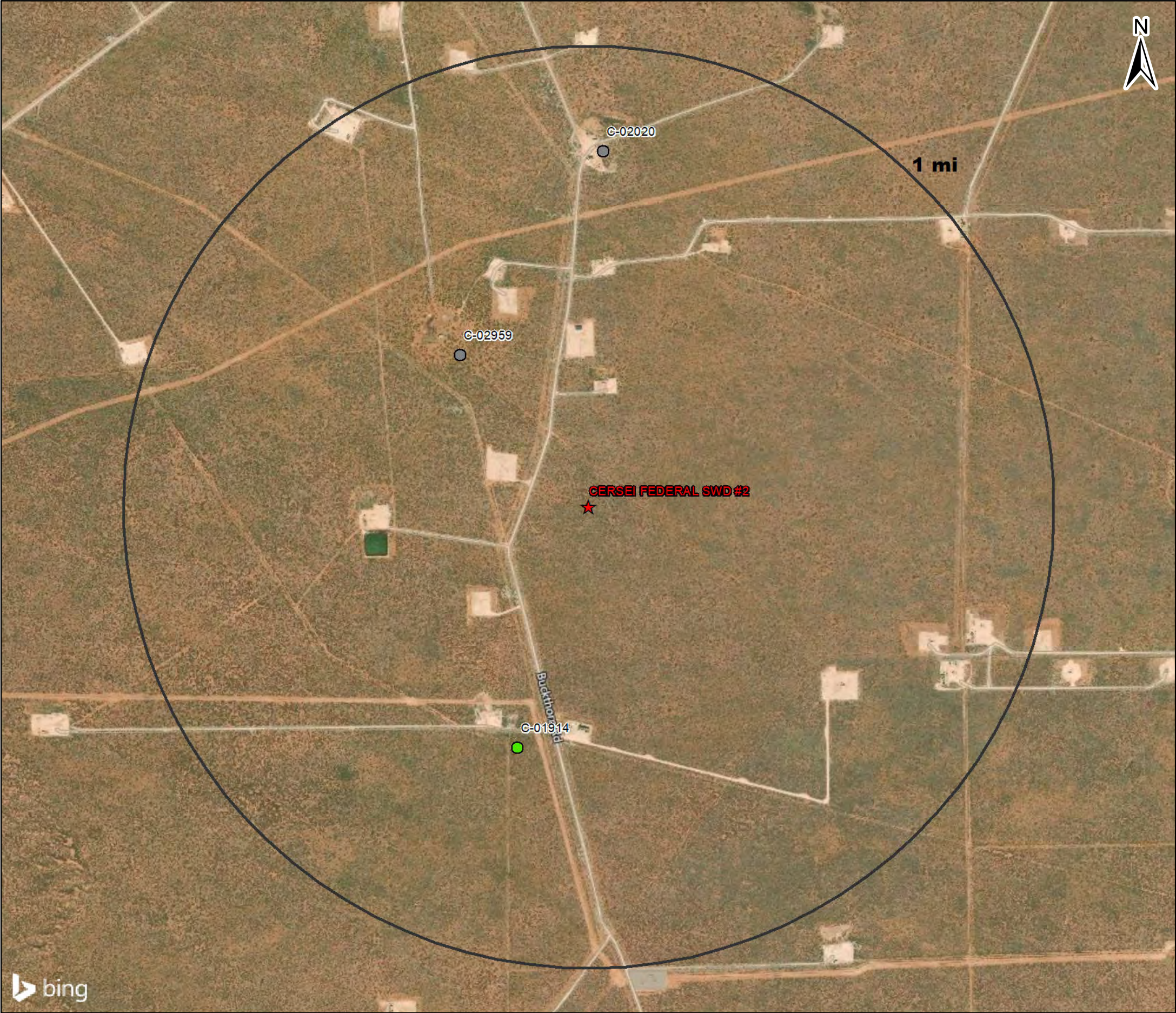

**Legend**

★ Proposed SWD

**NMOSE PODs**

**Status**

- Active (0)
- Pending (1)
- Change Location of Well (0)
- Capped (0)
- Plugged (0)
- Incomplete (0)
- Unknown (2)

Water Wells Area of Review

CERSEI FEDERAL SWD #2  
Eddy County, New Mexico

Proj Mgr: Dan Arthur	November 14, 2019	Mapped by: Ben Bockelmann
Prepared for: 		Prepared by: 



Water Well Sampling Rationale					
Cersei Federal SWD #2					
Water Wells	Owner	Available Contact Information	Use	Sampling Required	Notes
C 02020	BLM	Brad Winger 575-234-5942	Livestock Watering	No	Coordinates (32.182816, -103.776288) Legal Location (SE 1/4 SE 1/4 S28 T24S R31E) Water well was initially drilled for oil and gas exploration. Once the exploration use of the well was completed the well was turned over to the BLM. BLM range specialist Kelsey Davis informed ALL that they could not find a record of this well. An onsite visit was conducted, and no water well was observed by the sampling personel.
C 01914	Perry R. Bass	Perry R. Bass P.O. Box 2760 Midland, Texas 79702	Prospecting or Development of Natural Resources	No	Abstractors note on the well application states that no wells was drilled. Additionally there is no record of the well being drilled in the state engineers office.
C 02959	Richardson Cattle Company	Steve McCutchen (Owner): 575 706 7068 Email: Daggerdrawranchnm@gmail.com Garth Grizzle (Ranch Foreman): 575 200 7013 Jesus (Local Ranch Hand): 575 706 0384	Livestock watering	Yes	Coordinated (32.176463, -103.781613), Legal Location (S33 T24S R31E)  Met with Jesus to confirm the well location as it was located north of the mapped location from the OSE Pod location map. The well's electric water pump was plumbed directly into a water line leading to an above ground water tank, and cattle troughs. A cattle trough was sampled, as there was not a more direct Sample point to obtain a ground water sample.
Note:					

**Attachment 6**

Induced Seismicity Assessment Letter



November 20, 2019

Mr. Phillip Goetze, P.G.  
NM EMNRD – Oil Conservation Division  
1220 South St. Francis Drive  
Santa Fe, NM 87505

Subject: Induced Seismicity Potential Statement for the Cersei Federal SWD #2

Dear Mr. Goetze,

This letter provides information regarding the seismic potential associated with injection operations associated with Select Energy Services, LLC (Select), proposed Cersei Federal SWD #2, hereinafter referred to as the “Subject Well.”

As outlined herein, based on my experience as an expert on the issue of induced seismicity, it is my opinion that the potential for the proposed injection well to cause injection-induced seismicity is expected to be minimal, at best. This conclusion is based on (1) the lack of historic seismic activity and faulting in the area, (2) the low fault slip potential (FSP) of Precambrian faults in the area, (3) the presence of confining layers, and (4) the overall vertical distance between the proposed injection zone and basement rock.

The Subject Well, is located 1,741 FSL & 871 FEL of Section 33, in T24-S and R31-E of Eddy County, New Mexico. Historically, the Eddy and Lea Counties area has experienced very limited recorded seismic activity (per the U.S. Geological Survey [USGS] earthquake catalog database). There has been one known seismic events located within a 25-mile radius of the proposed Subject Well. The closest recorded seismic event was a M3.1 that occurred on March 18, 2012, and was located approximately 10.1 miles northwest of the Subject Well (See Exhibit 1). The closest Class IID well injecting into the same formations (Devonian-Silurian) of the Subject Well is approximately 1.5 miles to the southeast (See Exhibit 1).

Select does not own either 2D or 3D seismic reflection data in the area of the Subject Well. Publicly available fault data from USGS indicates that the closest known fault is approximately 13.0 miles west of the Subject Well (See Exhibit 1).

In a recent paper written by Snee and Zoback (2018) entitled “State of Stress in the Permian Basin, Texas and New Mexico: Implications for Induced Seismicity,”, the authors found that large groups of mostly north-south striking Precambrian basement faults, predominantly located along the Central Basin Platform, the western Delaware Basin, and large parts of the Northwest Shelf (which includes Eddy and Lea counties, New Mexico) have low FSP at the modeled fluid-pressure

Induced Seismicity Potential Statement for the Cersei Federal SWD #2  
November 20, 2019

perturbation. The map in Exhibit 2 depicts the low probability risk of FSP for the Delaware Basin and Northwest Shelf areas (Snee and Zoback 2018).

Geologic analysis indicates that the proposed Devonian-Silurian injection zone is overlain by approximately 200 to 400 feet of Woodford Shale, which is the upper confining zone and will serve as a barrier for upward injection fluid migration. Additionally, the Simpson Group that lies directly below the Montoya Formation will act as a lower confining zone to prohibit fluids from migrating downward into the underlying Ellenburger Formation and Precambrian basement rock. See the stratigraphic column for the Delaware Basin included in Exhibit 3.

In the Eddy and Lea Counties area of New Mexico, the Simpson Group is comprised of a series of Middle to Upper Ordovician carbonates, several sandstones, and sandy shales that range from approximately 350 to 650 feet thick (Jones 2008). This group of rocks is capped by the limestones of the Bromide Formation, which is approximately 200 feet thick in this area (Jones 2008). The closest deep well drilled into the Precambrian basement was completed by the Skelly Oil Company in 1975. This well is located in Section 17, Range 36E, Township 25S of Lea County (API No.30-025-25046) and encountered 602 feet of Ellenburger Formation before reaching the top of the Precambrian granite at a depth of 18,920 feet. Based on the estimated thickness of the Simpson Group and Ellenburger Formation in this area, the Precambrian basement should be approximately 1,000 to 1,200 feet below the bottom of the proposed injection zones in the Subject Well.

### **Conclusion**

As an expert on the issue of induced seismicity, it is my opinion that the potential for the proposed injection well to cause injection-induced seismicity is expected to be minimal, at best. This conclusion is based on (1) the lack of historic seismic activity and faulting in the area, (2) the low FSP of Precambrian faults in the area, (3) the presence of confining layers, and (4) the overall vertical distance between the proposed injection zone and basement rock.

Sincerely,  
ALL Consulting



J. Daniel Arthur, P.E., SPEC  
President and Chief Engineer

Enclosures  
References  
Exhibits

Induced Seismicity Potential Statement for the Cersei Federal SWD #2  
November 20, 2019

## **References**

Induced Seismicity Potential Statement for the Cersei Federal SWD #2  
November 20, 2019

Ball, Mahlon M. 1995. "Permian Basin Province (044)." In *National Assessment of United States Oil and Gas Resources—Results, Methodology, and Supporting Data*. U.S. Geological Survey. <https://certmapper.cr.usgs.gov/data/noga95/prov44/text/prov44.pdf> (accessed June 18, 2018).

Green, G.N., and G.E. Jones. 1997. "The Digital Geologic Map of New Mexico in ARC/INFO Format." U.S. Geological Survey Open-File Report 97-0052. <https://mrdata.usgs.gov/geology/state/state.php?state=NM> (accessed June 14, 2018).

Jones, Rebecca H. 2008. "The Middle-Upper Ordovician Simpson Group of the Permian Basin: Deposition, Diagenesis, and Reservoir Development." [http://www.beg.utexas.edu/resprog/permianbasin/PBGSP\\_members/writ\\_synth/Simpson.pdf](http://www.beg.utexas.edu/resprog/permianbasin/PBGSP_members/writ_synth/Simpson.pdf) (accessed June 19, 2018).

Snee, Jens-Erik Lund, and Mark D. Zoback. 2018. "State of Stress in the Permian Basin, Texas and New Mexico: Implications for Induced Seismicity." *The Leading Edge* 37, no. 2 (February 2018): 127-34.

U.S. Geological Survey (USGS). No date. Earthquakes Hazard Program: Earthquake Catalog. <https://earthquake.usgs.gov/earthquakes/search/> (accessed June 14, 2018).



Induced Seismicity Potential Statement for the Cersei Federal SWD #2  
November 20, 2019

## **Exhibits**

Induced Seismicity Potential Statement for the Cersei Federal SWD #2  
November 20, 2019

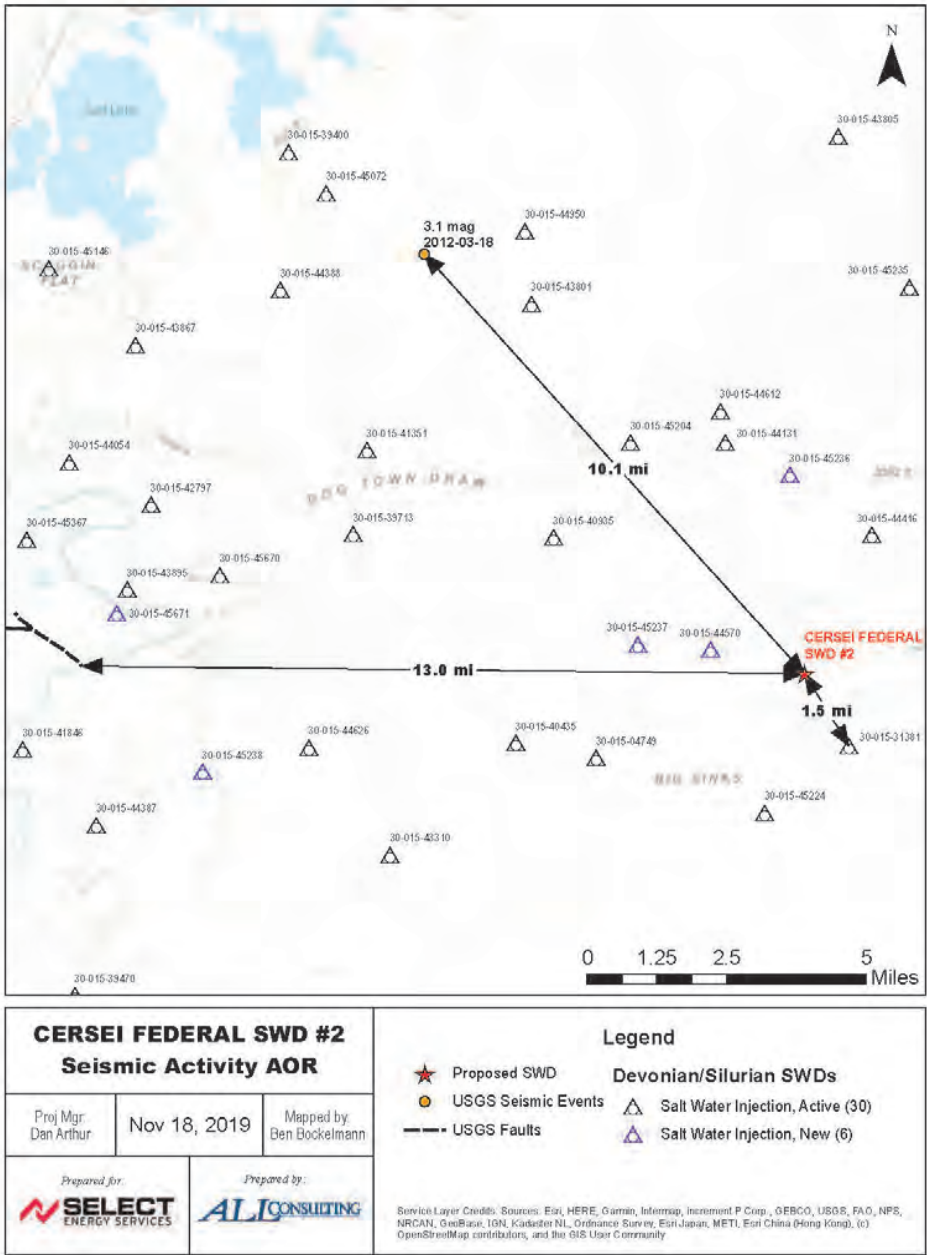

**Exhibit 1. Map Showing the Distances from Known and Inferred Faults, Seismic Event, and Closest Deep Injection Well**

Induced Seismicity Potential Statement for the Cersei Federal SWD #2  
November 20, 2019

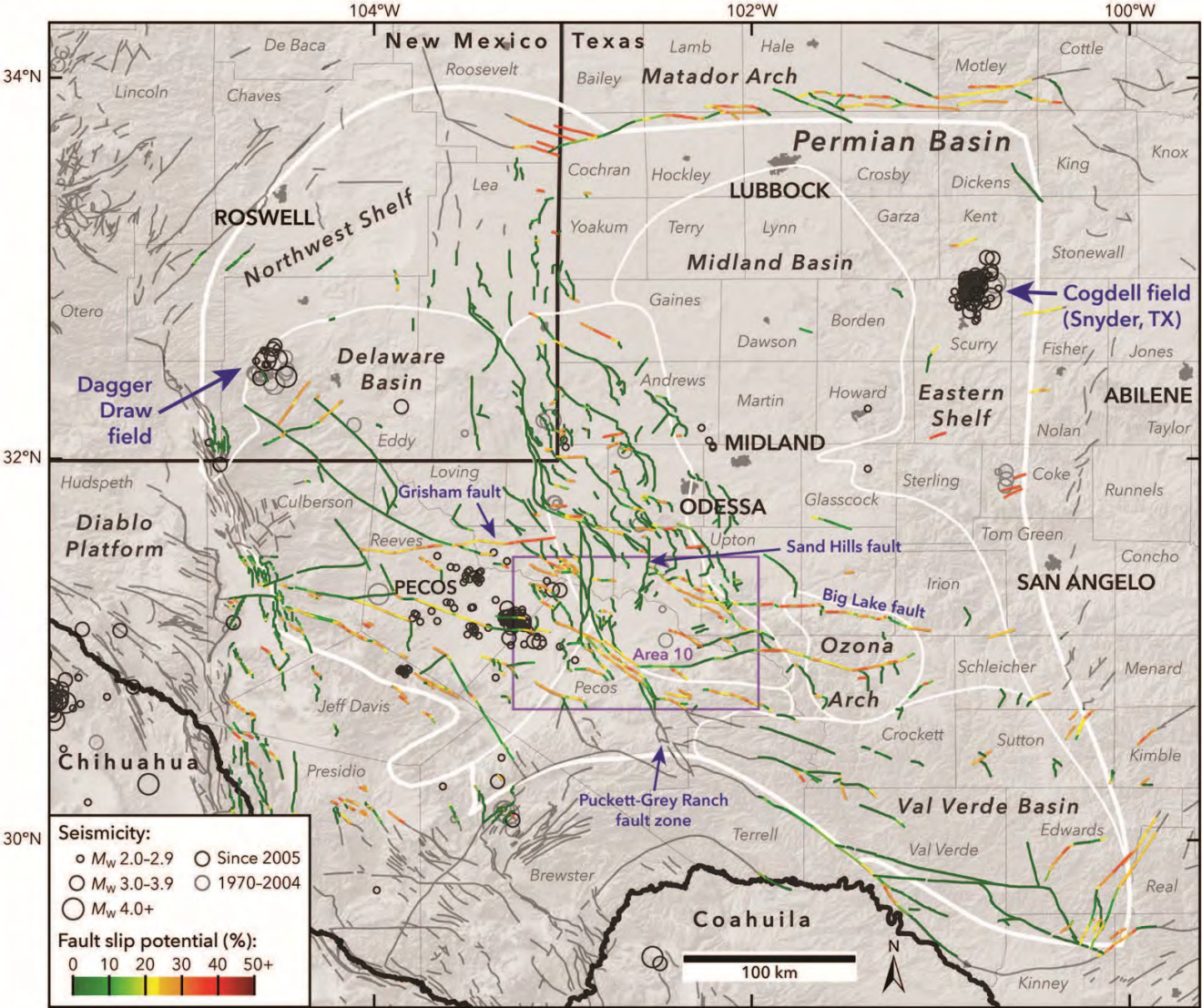

**Exhibit 2. Results of the Snee and Zoback (2018) Probabilistic FSP Analysis Across the Permian Basin**



Induced Seismicity Potential Statement for the Cersei Federal SWD #2  
November 20, 2019

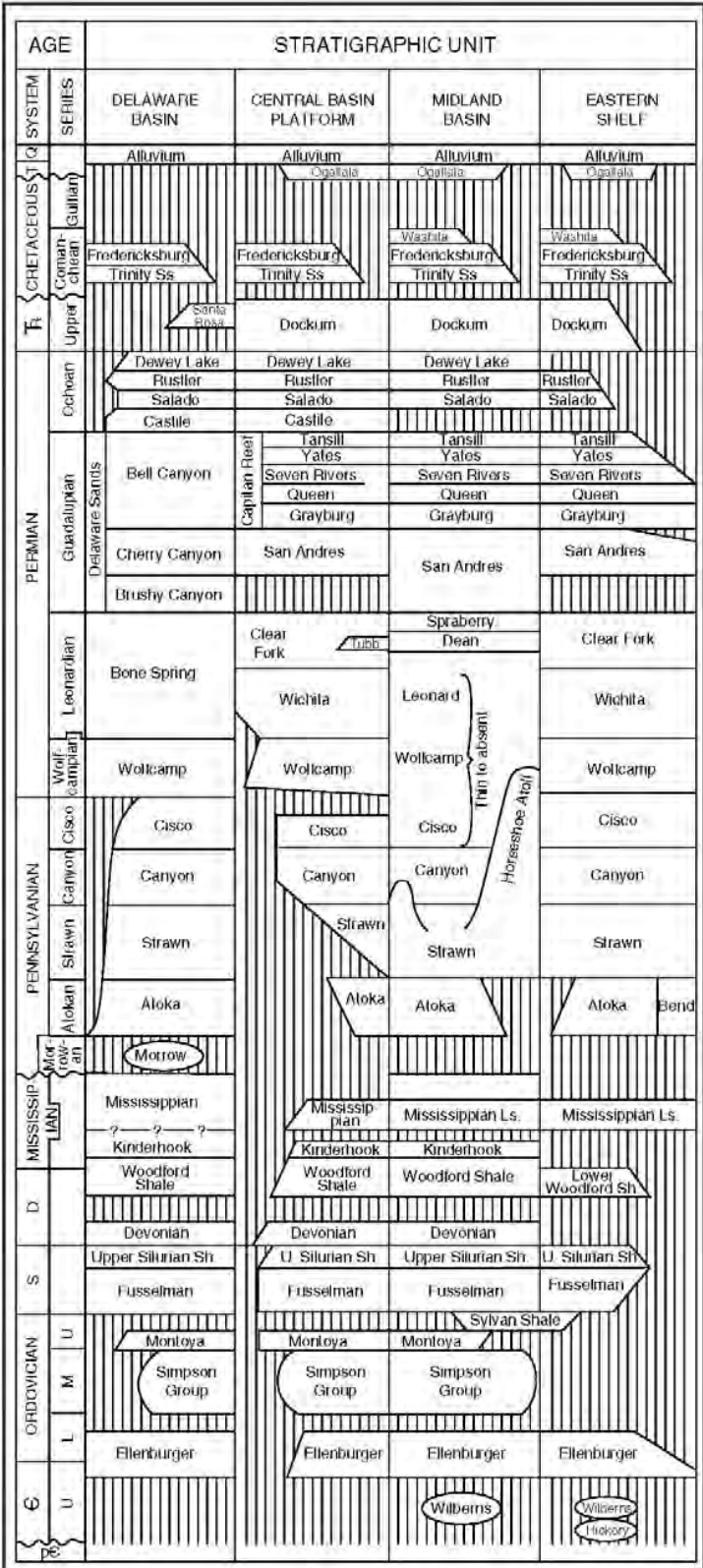

Exhibit 3. Delaware Basin Stratigraphic Chart (Ball 1995)

**Attachment 7**

Public Notice Affidavit and Notice of Application Confirmations

# Carlsbad Current Argus.

PART OF THE MIA TODAY HERALD

## Affidavit of Publication

Ad # 0003907800

**ALL CONSULTING- CARL SBAD**  
1718 SOUTH CHEYENNE AVENUE

**TULSA, OK 74119**

I, a legal clerk of the **Carlsbad Current Argus**, a newspaper published daily at the City of Carlsbad, in said county of Eddy, state of New Mexico and of general paid circulation in said county; that the same is a duly qualified newspaper under the laws of the State wherein legal notices and advertisements may be published; that the printed notice attached hereto was published in the regular and entire edition of said newspaper and not in supplement thereof on the date as follows, to wit:

**November 19, 2019**

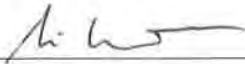

Legal Clerk

Subscribed and sworn before me this November 19, 2019:

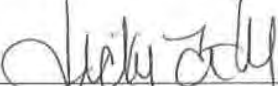

State of WI, County of Brown  
NOTARY PUBLIC

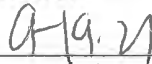

My commission expires

### APPLICATION FOR AUTHORIZATION TO INJECT

NOTICE IS HEREBY GIVEN:  
That Select Energy Services, 1820 N I-35, Gainesville, TX 76240, is requesting that the New Mexico Oil Conservation Division administrative-ly approve the APPLICATION FOR AUTHORIZATION TO INJECT as follows:

PURPOSE: The intended purpose of the injection well is to dispose of salt water produced from permitted oil and gas wells.

WELL NAME AND LOCATION: Cersei Federal SWD #2

Located 17.66 miles southeast of Malaga, NM  
NE 1/4 SE 1/4, Section 33,  
Township 24S, Range 31E  
1,741' FSL & 871' FEL  
Eddy County, NM

NAME AND DEPTH OF DISPOSAL ZONE:  
Devonian - Silurian (16,360' - 17,550')

EXPECTED MAXIMUM INJECTION RATE: 30,000 Bbls/day

EXPECTED MAXIMUM INJECTION PRESSURE: 3,272 psi (surface)

Objections or requests for hearing must be filed with the New Mexico Oil Conservation Division within fifteen (15) days. Any objection or request for hearing should be mailed to the Oil Conservation Division, 1220 South St. Francis Dr., Santa Fe, New Mexico 87505.

Additional information may be obtained by contacting Nate Alleman at 918-382-7581.

November 19, 2019

Ad # 0003907800  
PO #: Cersei Fed SWD #2  
# of Affidavits : 1



Cersei Federal SWD #2 - Notice of Application Recipients				
Entity	Address	City	State	Zip Code
Land & Mineral Owner				
New Mexico BLM	620 E. Greene St.	Carlsbad	NM	88220
OCD District				
NMOCD District 2	811 S. 1st St.	Artesia	NM	88210
Leasehold Operators				
BP America Production Company (BP AMERICA PROD CO)	501 Westlake Park Blvd.	Houston	TX	77079
Chevron USA Inc. (CHEVRON USA INC)	6301 Deauville	Midland	TX	79706
Commission of Public Lands - State Land Office	310 Old Santa Fe Trail	Santa Fe	NM	87501
CTV Oil & Gas New Mexico, LLC (CTV OG NM LLC)	201 Main Street, Ste 2700	Fort Worth	TX	76102
Devon Energy Production Company, LP (DEVON ENERGY PROD CO LP)	333 W. Sheridan Ave.	Oklahoma City	OK	73102
Goliad Oil and Gas New Mexico, LLC (GOLIAD O&G NM LLC)	211 E. 7th St.	Austin	TX	78701
Keystone Petroleum NM, LLC (KEYSTONE OG NM LLC)	222 Las Colinas Blvd. W.	Irving	TX	75039
LMBI Oil & Gas New Mexico, LLC (LMBI OG NM LLC)	201 Main Street, Ste 2700	Fort Worth	TX	76102
Maverick Operating, LLC	1001 W. Wall St.	Midland	TX	79701
PRB II 1993C Oil & Gas New Mexico, LLC (PRB II 1993C OG NM LLC)	251 Little Falls Dr.	Wilmington	DE	19808
SRBI O&G NM, LLC (SRBI OG NM LLC)	202 Main Street, Ste 3200	Fort Worth	TX	76102
Thru Line Oil & Gas New Mexico, LLC (THRU LINE OG NM LLC)	201 Main Street, Ste 2700	Fort Worth	TX	76102
XTO Energy, Inc. (XTO Delaware Basin, LLC) (XTO Holding LLC) (XTO PERMIAN OPERATING LLC.)	500 W. Illinois Ave Suite 100	Midland	TX	79701
<b>Notes:</b> The table above shows the Entities who were identified as parties of interest requiring notification on either the 1-mile well detail list (Attachment 2) or on the 2-mile Mineral Lease Map (Attachment 2). The names listed above in parenthesis, are the abbreviated entity names used on either the 1-mile well detail list (Attachment 2) or on the 2-mile Mineral Lease Map (Attachment 2).				

Place label at top of the center of the envelope and fold at dotted line.

Place label at top of the center of the envelope and fold at dotted line.

ALL Consulting  
1718 S. Cheyenne Ave.  
Tulsa, OK 74119

**\$5.600**  
US POSTAGE  
FIRST-CLASS  
FROM 74119  
NOV 20 2019  
stamps.com



062S0008663991

**CERTIFIED MAIL®**  
**CERTIFIED MAIL®**

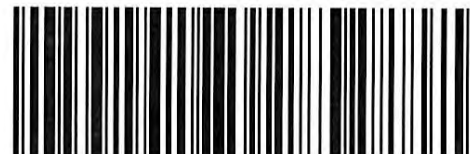

9414 8118 9956 1309 7921 07

BP America Production Company  
501 Westlake Park Blvd.  
Houston TX 77079-2604

ALL Consulting  
1718 S. Cheyenne Ave.  
Tulsa, OK 74119

**\$5.600**  
US POSTAGE  
FIRST-CLASS  
FROM 74119  
NOV 20 2019  
stamps.com



062S0008663991

Place label at top of the center of the envelope and fold at dotted line.

**CERTIFIED MAIL®**  
**CERTIFIED MAIL®**

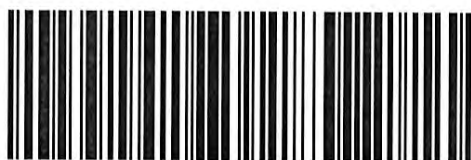

9414 8118 9956 1309 7923 29

Chevron USA Inc.  
6301 Deauville  
Midland TX 79706-2964

ALL Consulting  
1718 S. Cheyenne Ave.  
Tulsa, OK 74119

**\$5.600**  
US POSTAGE  
FIRST-CLASS  
FROM 74119  
NOV 20 2019  
stamps.com



062S0008663991

Place label at top of the center of the envelope and fold at dotted line.

**CERTIFIED MAIL®**  
**CERTIFIED MAIL®**



9414 8118 9956 1309 7920 53

CTV Oil & Gas New Mexico, LLC  
201 Main Street, Ste 2700  
Fort Worth TX 76102-3131



**Certified Mail® Labels**
 **Top of the page**
Print postage using Stamps.com Template **SDC-3610**

ALL Consulting  
1718 S. Cheyenne Ave.  
Tulsa, OK 74119

**\$5.600**  
US POSTAGE  
FIRST-CLASS  
FROM 74119  
NOV 20 2019

**stamps.com**



Place label at top of the center of the envelope and fold at dotted line.

**CERTIFIED MAIL®**  
**CERTIFIED MAIL®**



9414 8118 9956 1309 7920 08

ALL Consulting  
1718 S. Cheyenne Ave.  
Tulsa, OK 74119

**\$5.600**  
US POSTAGE  
FIRST-CLASS  
FROM 74119  
NOV 20 2019

**stamps.com**



Place label at top of the center of the envelope and fold at dotted line.

**CERTIFIED MAIL®**  
**CERTIFIED MAIL®**



9414 8118 9956 1309 7920 39

Devon Energy Production Company, LP  
333 W. Sheridan Ave.  
Oklahoma City OK 73102-5010

Goliad Oil and Gas New Mexico, LLC  
211 E. 7th St.  
Austin TX 78701-3334

ALL Consulting  
1718 S. Cheyenne Ave.  
Tulsa, OK 74119

**\$5.600**  
US POSTAGE  
FIRST-CLASS  
FROM 74119  
NOV 20 2019

**stamps.com**



Place label at top of the center of the envelope and fold at dotted line.

**CERTIFIED MAIL®**  
**CERTIFIED MAIL®**



9414 8118 9956 1309 7924 04

ALL Consulting  
1718 S. Cheyenne Ave.  
Tulsa, OK 74119

**\$5.600**  
US POSTAGE  
FIRST-CLASS  
FROM 74119  
NOV 20 2019

**stamps.com**



Place label at top of the center of the envelope and fold at dotted line.

**CERTIFIED MAIL®**  
**CERTIFIED MAIL®**



9414 8118 9956 1309 7925 58

Keystone Petroleum NM, LLC  
222 Las Colinas Blvd. W.  
Irving TX 75039-5421

LMBI Oil & Gas New Mexico, LLC  
201 Main Street, Ste 2700  
Fort Worth TX 76102-3131

**Certified Mail® Labels**
 **Top of the page**
Print postage using Stamps.com Template **SDC-3610**

ALL Consulting  
1718 S. Cheyenne Ave.  
Tulsa, OK 74119

**\$5.600**  
US POSTAGE  
FIRST-CLASS  
FROM 74119  
NOV 20 2019  
**stamps.com**



Place label at top of the center of the  
envelope and fold at dotted line.

**CERTIFIED MAIL®**



9414 8118 9956 1309 7902 57

Maverick Operating, LLC  
1001 W. Wall St.  
Midland TX 79701-6637

ALL Consulting  
1718 S. Cheyenne Ave.  
Tulsa, OK 74119

**\$5.600**  
US POSTAGE  
FIRST-CLASS  
FROM 74119  
NOV 20 2019  
**stamps.com**



Place label at top of the center of the  
envelope and fold at dotted line.

**CERTIFIED MAIL®**



9414 8118 9956 1309 7902 88

New Mexico BLM  
620 E. Greene St.  
Carlsbad NM 88220-6292

ALL Consulting  
1718 S. Cheyenne Ave.  
Tulsa, OK 74119

**\$5.600**  
US POSTAGE  
FIRST-CLASS  
FROM 74119  
NOV 20 2019  
**stamps.com**



Place label at top of the center of the  
envelope and fold at dotted line.

**CERTIFIED MAIL®**



9414 8118 9956 1309 7908 20

NMOCD District 2  
811 S. 1st St.  
Artesia NM 88210-2834

ALL Consulting  
1718 S. Cheyenne Ave.  
Tulsa, OK 74119

**\$5.600**  
US POSTAGE  
FIRST-CLASS  
FROM 74119  
NOV 20 2019  
**stamps.com**



Place label at top of the center of the  
envelope and fold at dotted line.

**CERTIFIED MAIL®**



9414 8118 9956 1309 7908 37

PRB II 1993C O&G New Mexico, LLC  
251 Little Falls Dr.  
Wilmington DE 19808-1674



**Certified Mail® Labels**
 **Top of the page**
Print postage using Stamps.com Template **SDC-3610**

ALL Consulting  
1718 S. Cheyenne Ave.  
Tulsa, OK 74119

**\$5.600**  
US POSTAGE  
FIRST-CLASS  
FROM 74119  
NOV 20 2019

**stamps.com**



Place label at top of the center of the envelope and fold at dotted line.

**CERTIFIED MAIL®**  
**CERTIFIED MAIL®**

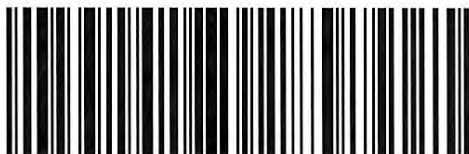

9414 8118 9956 1309 7907 45

ALL Consulting  
1718 S. Cheyenne Ave.  
Tulsa, OK 74119

**\$5.600**  
US POSTAGE  
FIRST-CLASS  
FROM 74119  
NOV 20 2019

**stamps.com**



Place label at top of the center of the envelope and fold at dotted line.

**CERTIFIED MAIL®**  
**CERTIFIED MAIL®**



9414 8118 9956 1309 7909 05

SRBI O&G NM, LLC  
201 Main Street, Ste 3200  
Fort Worth TX 76102-3134

Commission of Public Lands  
State Land Office  
310 Old Santa Fe Trail  
Santa Fe NM 87501-2708

ALL Consulting  
1718 S. Cheyenne Ave.  
Tulsa, OK 74119

**\$5.600**  
US POSTAGE  
FIRST-CLASS  
FROM 74119  
NOV 20 2019

**stamps.com**



Place label at top of the center of the envelope and fold at dotted line.

**CERTIFIED MAIL®**  
**CERTIFIED MAIL®**



9414 8118 9956 1309 7906 08

ALL Consulting  
1718 S. Cheyenne Ave.  
Tulsa, OK 74119

**\$5.600**  
US POSTAGE  
FIRST-CLASS  
FROM 74119  
NOV 20 2019

**stamps.com**



Place label at top of the center of the envelope and fold at dotted line.

**CERTIFIED MAIL®**  
**CERTIFIED MAIL®**



9414 8118 9956 1309 7906 77

Thru Line Oil & Gas New Mexico, LLC  
201 Main Street, Ste 2700  
Fort Worth TX 76102-3131

XTO Energy, Inc.  
500 W. Illinois Ave Suite 100  
Midland TX 79701-4337