

Y1M14-200102-C-107B 185

Revised March 23, 2017

RECEIVED: 1/2/20	REVIEWER:	TYPE: OLM	APP NO: pDM2000744921
------------------	-----------	-----------	-----------------------

ABOVE THIS TABLE FOR OCD DIVISION USE ONLY

NEW MEXICO OIL CONSERVATION DIVISION
 - Geological & Engineering Bureau -
 1220 South St. Francis Drive, Santa Fe, NM 87505

**ADMINISTRATIVE APPLICATION CHECKLIST**

THIS CHECKLIST IS MANDATORY FOR ALL ADMINISTRATIVE APPLICATIONS FOR EXCEPTIONS TO DIVISION RULES AND
 REGULATIONS WHICH REQUIRE PROCESSING AT THE DIVISION LEVEL IN SANTA FE

Applicant: Marathon Oil Permian LLC	OGRID Number: 372098
Well Name: Catapult 1 WA Fee 5H, WXY Fee 3H, WXY Fee 10H	API: 30-015-44691, 30-015-44692, 30-015-44690
Pool: Purple Sage; Wolfcamp (Gas)	Pool Code: 98220

**SUBMIT ACCURATE AND COMPLETE INFORMATION REQUIRED TO PROCESS THE TYPE OF APPLICATION
 INDICATED BELOW**

1) TYPE OF APPLICATION: Check those which apply for [A]

A. Location – Spacing Unit – Simultaneous Dedication

☐ NSL☐ NSP (PROJECT AREA)☐ NSP (PRORATION UNIT)☐ SD

B. Check one only for [I] or [II]

[I] Commingling – Storage – Measurement

☐ DHC☐ CTB☐ PLC☐ PC☒ OLS☒ OLM

[II] Injection – Disposal – Pressure Increase – Enhanced Oil Recovery

☐ WFX☐ PMX☐ SWD☐ IPI☐ EOR☐ PPR**2) NOTIFICATION REQUIRED TO:** Check those which apply.A. ☐ Offset operators or lease holdersB. ☒ Royalty, overriding royalty owners, revenue ownersC. ☐ Application requires published noticeD. ☒ Notification and/or concurrent approval by SLOE. ☐ Notification and/or concurrent approval by BLMF. ☐ Surface ownerG. ☒ For all of the above, proof of notification or publication is attached, and/or,H. ☐ No notice required**FOR OCD ONLY**☐ Notice Complete☐ Application
Content
Complete

3) CERTIFICATION: I hereby certify that the information submitted with this application for administrative approval is **accurate** and **complete** to the best of my knowledge. I also understand that **no action** will be taken on this application until the required information and notifications are submitted to the Division.

Note: Statement must be completed by an individual with managerial and/or supervisory capacity.

Adrian Covarrubias

Print or Type Name

Signature

12/18/2019

Date

713-296-3368

Phone Number

acovarrubias@marathonoil.com

e-mail Address

**NEW MEXICO
STATE
LAND OFFICE**

**APPLICATION FOR
COMMINGLING AND OFF-LEASE STORAGE
ON STATE TRUST LANDS**



This application form is required for all commingling applications requiring approval by the Commissioner of Public Lands.

Applicant: MARATHON OIL PERMIAN LLC
Well Name: CATAPULT 1 WA FEE 5H, WXY 3H, WXY 10H
Pool: PURPLE SAGE; WOLFCAMP (GAS)

OGRID #: 372098
API #: 30-015-44691; 44692; 44690

OPERATOR NAME: MARATHON OIL PERMIAN LLC
OPERATOR ADDRESS: 5555 SAN FELIPE ST, HOUSTON, TX 77063

APPLICATION REQUIREMENTS – SUBMIT:

1. New Mexico Oil Conservation Division (NMOCD) application packet (or equivalent information if no application is required by NMOCD),
2. Commingling application fee of \$150.

CERTIFICATION: To the best of my knowledge,

- All business leases and rights-of-way necessary for conducting the proposed operation on State Trust lands have been applied for or obtained,
- The information submitted with this application is **accurate** and **complete**, and
- No loss will accrue to the state of New Mexico as a result of the proposed operation.

I also understand that **no action** will be taken on this application until the required information and fee are submitted to the State Land Office.

Note: Statement must be completed by an individual with managerial and/or supervisory capacity.

Adrian Covarrubias

Print or Type Name



Signature

12/18/2019

Date

713-296-3368

Phone Number

acovarrubias@marathonoil.com

e-mail Address

Submit application to:
 Commissioner of Public Lands
 Attn: Commingling Manager
 PO Box 1148
 Santa Fe, NM 87504-1148

Questions?
 Contact the Commingling Manager:
 505.827.5791

Upon approval, the requesting organization will receive an acknowledgment letter from the Commissioner of Public Lands.

Submit 1 Copy To Appropriate District Office
 District I – (575) 393-6161
 1625 N. French Dr., Hobbs, NM 88240
 District II – (575) 748-1283
 811 S. First St., Artesia, NM 88210
 District III – (505) 334-6178
 1000 Rio Brazos Rd., Aztec, NM 87410
 District IV – (505) 476-3460
 1220 S. St. Francis Dr., Santa Fe, NM 87505

State of New Mexico
 Energy, Minerals and Natural Resources

OIL CONSERVATION DIVISION
 1220 South St. Francis Dr.
 Santa Fe, NM 87505

Form C-103
 Revised July 18, 2013

SUNDRY NOTICES AND REPORTS ON WELLS (DO NOT USE THIS FORM FOR PROPOSALS TO DRILL OR TO DEEPEN OR PLUG BACK TO A DIFFERENT RESERVOIR. USE "APPLICATION FOR PERMIT" (FORM C-101) FOR SUCH PROPOSALS.)		WELL API NO. Multiple
1. Type of Well: Oil Well <input type="checkbox"/> Gas Well <input type="checkbox"/> Other <input type="checkbox"/>		5. Indicate Type of Lease STATE <input type="checkbox"/> FEE <input type="checkbox"/>
2. Name of Operator Marathon Oil Permian LLC		6. State Oil & Gas Lease No.
3. Address of Operator 5555 San Felipe St., Houston, TX 77056		7. Lease Name or Unit Agreement Name Catapult 1 Fee
4. Well Location Unit Letter _____ : _____ feet from the _____ line and _____ feet from the _____ line Section 36 Township 22S Range 26E NMMPM County EDDY		8. Well Number Multiple
11. Elevation (Show whether DR, RKB, RT, GR, etc.)		9. OGRID Number 372098
		10. Pool name or Wildcat Multiple

12. Check Appropriate Box to Indicate Nature of Notice, Report or Other Data

NOTICE OF INTENTION TO:		SUBSEQUENT REPORT OF:	
PERFORM REMEDIAL WORK <input type="checkbox"/>	PLUG AND ABANDON <input type="checkbox"/>	REMEDIAL WORK <input type="checkbox"/>	ALTERING CASING <input type="checkbox"/>
TEMPORARILY ABANDON <input type="checkbox"/>	CHANGE PLANS <input type="checkbox"/>	COMMENCE DRILLING OPNS. <input type="checkbox"/>	P AND A <input type="checkbox"/>
PULL OR ALTER CASING <input type="checkbox"/>	MULTIPLE COMPL <input type="checkbox"/>	CASING/CEMENT JOB <input type="checkbox"/>	
DOWNHOLE COMMINGLE <input type="checkbox"/>			
CLOSED-LOOP SYSTEM <input type="checkbox"/>			
OTHER: Off-Lease Storage/Measurement <input checked="" type="checkbox"/>		OTHER: <input type="checkbox"/>	

13. Describe proposed or completed operations. (Clearly state all pertinent details, and give pertinent dates, including estimated date of starting any proposed work). SEE RULE 19.15.7.14 NMAC. For Multiple Completions: Attach wellbore diagram of proposed completion or recompletion.

Marathon Oil Permian LLC is requesting approval to off-lease storage and measure. The value of the oil and gas will not be affected with the approval of this request. Notices have been mailed to all working interest owners.

Wells to have off-lease storage/measurement:

Name	Location	API	Pool
Catapult 1 WA Fee 5H	O-36-22S-26E (337' FSL 1417' FEL)	30-015-44691	Purple Sage; Wolfcamp (Gas) (98220)
Catapult 1 WXY Fee 3H	O-36-22S-26E (337' FSL 1447' FEL)	30-015-44692	Purple Sage; Wolfcamp (Gas) (98220)
Catapult 1 WXY Fee 10H	O-36-22S-26E (337' FSL 1357' FEL)	30-015-44690	Purple Sage; Wolfcamp (Gas) (98220)

Spud Date:

Rig Release Date:

I hereby certify that the information above is true and complete to the best of my knowledge and belief.

SIGNATURE  TITLE Regulatory Professional DATE 12/18/2019
 Type or print name Adrian Covarrubias E-mail address: acovarrubias@marathonoil.com PHONE: 713-296-3368
For State Use Only

APPROVED BY: _____ TITLE _____ DATE _____
 Conditions of Approval (if any): _____

Marathon Oil Permian LLC is requesting approval for off-lease measurement and sales:

Lease map shows the Central Tank Battery (CTB) for Catapult 1 Fee WXY 3H, WA 5H, and WXY 10H resides off-lease from the hydrocarbons produced from the wells. Working interest owners are identical.

Oil Production

The oil production from Catapult 1 Fee WXY 3H, WA 5H, and WXY 10H will be stored and measured at the central tank battery located in UL O, Section 36, T22S-R26E. The oil production from the Airport 36 WXY State 10H (API 30-015-44912) will also be stored and measured at the central tank battery. Production from Airport 36 WXY State 10H will be stored and measured separately from the Catapult wells on site.

The Catapult Fee 5H 3H 10H & Airport 10H CTB will have a total of eight oil tanks. Six of the tanks will be for the oil storage of the Catapult wells. The three Catapult wells will have a common CDP separate from the Airport well.

Gas Production

The gas production from Catapult 1 Fee WXY 3H, WA 5H, and WXY 10H will be measured at the central tank battery located in UL O, Section 36, T22S-R26E. The three catapult wells will have a common CDP separate from the Airport well.

Oil, gas, and water volumes from each well producing to this battery will be determined by using individual metering allocation separator.

Please see the enclosed Administrative Application Checklist, C-103 Application for off-lease measurement, plats for referenced wells, site facility diagram, and maps with lease boundaries showing wells and facility locations.

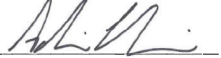
Signed: 
Printed Name: Adrian Covarrubias
Title: Regulatory Professional
Date: December 18, 2019

INTEREST OWNER LETTER



Clayton Rule, CPL

Land Supervisor

LAND - Permian

Marathon Oil Company

5555 San Felipe

Houston, TX 77056

Telephone 713.296.2186

Fax 713.296.4495

CWRULE@marathonoil.com

March 5, 2015

New Mexico Oil Conservation District

1220 South St. Francis Drive

Santa Fe, NM 87505

Re: Marathon Oil Permian LLC Application for Off-Lease Storage and Measurement
Catapult 1 Fee Wells (WA 5H, WXY 3H, WXY 10H)
Section 36, T22S-R26E
Eddy County, New Mexico

To whom it may concern:

The purpose of this letter is to certify that Marathon Oil Permian LLC owns 100% of the working interest, as to depths covering the Purple Sage; Wolfcamp (Gas) pool (98220), within the spacing unit for the above captions Catapult 1 Fee wells. As such there are no other working interest owners that require notification of our application to store and measure production off-lease.

Sincerely,

MARATHON OIL COMPANY

A handwritten signature in blue ink, appearing to read "C. Rule".

Clayton Rule, CPL

FACILITY DIAGRAMS

CATAPULT FEE 5H 3H 10H & AIRPORT 10H

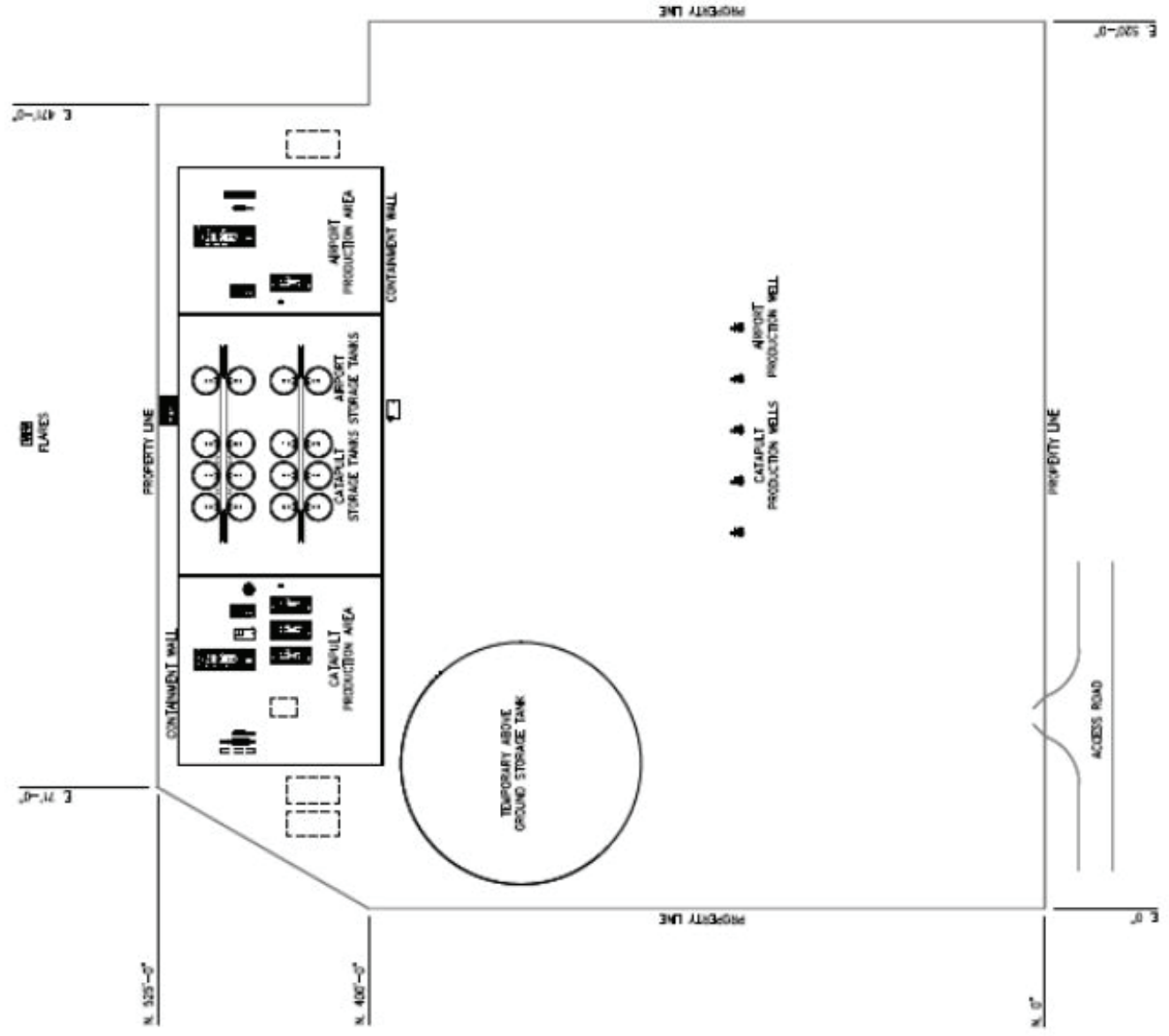

LEASE MAP

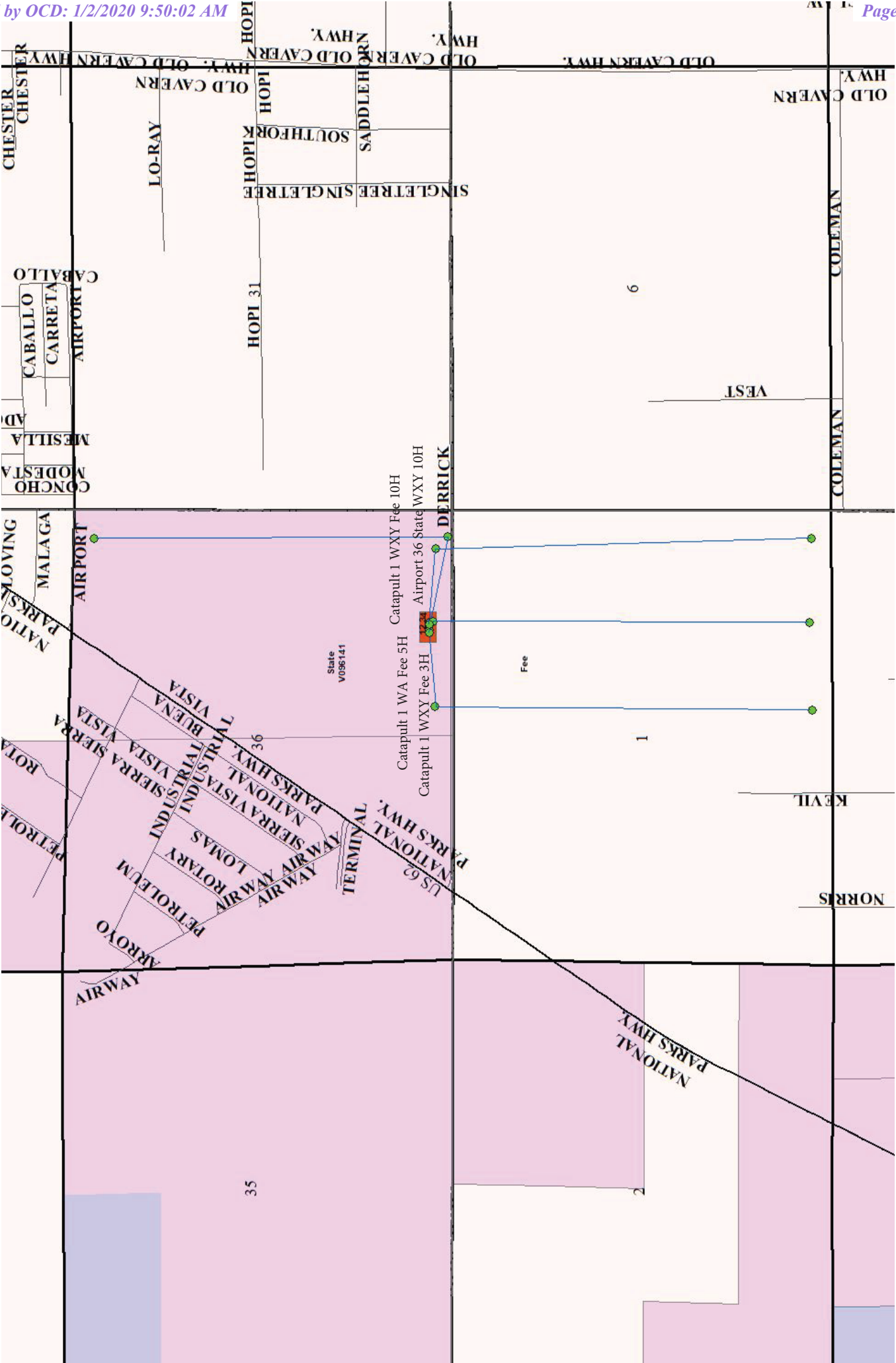

AS DRILLED PLATS

District I
1625 N. French Dr., Hobbs, NM 88240
Phone: (575) 393-6161 Fax: (575) 393-0720
District II
811 S. First St., Artesia, NM 88210
Phone: (575) 748-1283 Fax: (575) 748-9720
District III
1000 Rio Brazos Road, Aztec, NM 87410
Phone: (505) 334-6178 Fax: (505) 334-6170
District IV
1220 S. St. Francis Dr., Santa Fe, NM 87505
Phone: (505) 476-3460 Fax: (505) 476-3462

State of New Mexico
Energy, Minerals & Natural Resources Department
OIL CONSERVATION DIVISION
1220 South St. Francis Dr.
Santa Fe, NM 87505

Form C-102
Revised August 1, 2011
Submit one copy to appropriate
District Office
☐ AMENDED REPORT

WELL LOCATION AND ACREAGE DEDICATION PLAT

¹ API Number 30-015-44691	² Pool Code 98220	³ Pool Name PURPLE SAGE; WOLFCAMP (GAS)
⁴ Property Code	⁵ Property Name CATAPULT 1 WA FEE	⁶ Well Number 5H
⁷ OGRID No. 372098	⁸ Operator Name MARATHON OIL PERMIAN LLC	⁹ Elevation 3217'

¹⁰ Surface Location

UL or lot no.	Section	Township	Range	Lot Idn	Feet from the	North/South line	Feet from the	East/West line	County
0	36	T22S	R26E		337	SOUTH	1417	EAST	EDDY

¹¹ Bottom Hole Location If Different From Surface

UL or lot no.	Section	Township	Range	Lot Idn	Feet from the	North/South line	Feet from the	East/West line	County
0	1	T23S	R26E		286	SOUTH	2357	EAST	EDDY

¹² Dedicated Acres 320.08	¹³ Joint or Infill	¹⁴ Consolidation Code	¹⁵ Order No.
---	-------------------------------	----------------------------------	-------------------------

No allowable will be assigned to this completion until all interests have been consolidated or a non-standard unit has been approved by the division.

¹⁶ 		¹⁷ OPERATOR CERTIFICATION I hereby certify that the information contained herein is true and complete to the best of my knowledge and belief, and that this organization either owns a working interest or unleased mineral interest in the land including the proposed bottom hole location or has a right to drill this well at this location pursuant to a contract with an owner of such a mineral or working interest, or to a voluntary pooling agreement or a compulsory pooling order heretofore entered by the division. Signature: <i>Adrian Covarrubias</i> Date: 1/24/2019 Printed Name: Adrian Covarrubias E-mail Address:
¹⁸ SURVEYOR CERTIFICATION I hereby certify that the well location shown on this plat was plotted from field notes of actual surveys made by me or under my supervision, and that the same is true and correct to the best of my belief. Date of Survey: <i>1/24/2019</i> Signature and Seal of Professional Surveyor: <i>Adrian Covarrubias</i> Certificate Number:		

Distances/areas relative to NAD83 Combined Scale Factor: 0.99976038 Convergence: 0.05095500; NOTE: ALL DIMENSIONS IN U.S. FEET

District I
1625 N. French Dr., Hobbs, NM 88240
Phone: (575) 393-6161 Fax: (575) 393-0720

District II
811 S. First St., Artesia, NM 88210
Phone: (575) 748-1283 Fax: (575) 748-9720

District III
1000 Rio Brazos Road, Aztec, NM 87410
Phone: (505) 334-6178 Fax: (505) 334-6170

District IV
1220 S. St. Francis Dr., Santa Fe, NM 87505
Phone: (505) 476-3460 Fax: (505) 476-3462

State of New Mexico
Energy, Minerals & Natural Resources Department
OIL CONSERVATION DIVISION
1220 South St. Francis Dr.
Santa Fe, NM 87505

Form C-102
Revised August 1, 2011
Submit one copy to appropriate
District Office
☐ AMENDED REPORT

WELL LOCATION AND ACREAGE DEDICATION PLAT

¹ API Number API 30-015-44692	² Pool Code 98220	³ Pool Name PURPLE SAGE; WOLFCAMP (GAS)
⁴ Property Code	⁵ Property Name CATAPULT 1 WXY FEE	⁶ Well Number 3H
⁷ OGRID No. 372098	⁸ Operator Name MARATHON OIL PERMIAN LLC	⁹ Elevation 3217'

¹⁰ Surface Location

UL or lot no.	Section	Township	Range	Lot Idn	Feet from the	North/South line	Feet from the	East/West line	County
0	36	T22S	R26E		337	SOUTH	1447	EAST	EDDY

¹¹ Bottom Hole Location If Different From Surface

UL or lot no.	Section	Township	Range	Lot Idn	Feet from the	North/South line	Feet from the	East/West line	County
0	1	T23S	R26E		316	SOUTH	1325	EAST	EDDY

¹² Dedicated Acres 320.36	¹³ Joint or Infill	¹⁴ Consolidation Code	¹⁵ Order No.
---	-------------------------------	----------------------------------	-------------------------

No allowable will be assigned to this completion until all interests have been consolidated or a non-standard unit has been approved by the division.

<p>16 SURFACE HOLE LOCATION 337' FSL 1447' FEL, SECTION 36 NAD 83, SPCS NM EAST X:569435.11' / Y:488179.22' LAT:32.34204320N / LON:-104.24235300W NAD 27, SPCS NM EAST X:528253.43' / Y:488120.20' LAT:32.34192502N / LON:-104.24185058W</p> <p>KICK OFF POINT 8,477' MEASURED DEPTH IN FEET NAD 83, SPCS NM EAST X:569559.88' / Y:488122.22' LAT:32.34188620N / LON:-104.24194919W NAD 27, SPCS NM EAST X:528378.20' / Y:488063.19' LAT:32.34176802N / LON:-104.24144675W</p> <p>FIRST TAKE POINT 9,353' MEASURED DEPTH IN FEET NAD 83, SPCS NM EAST X:569556.46' / Y:487512.21' LAT:32.34020940N / LON:-104.24196194W NAD 27, SPCS NM EAST X:528374.77' / Y:487453.20' LAT:32.34009121N / LON:-104.24145955W</p> <p>LAST TAKE POINT 13,997' MEASURED DEPTH IN FEET NAD 83, SPCS NM EAST X:569557.23' / Y:482872.85' LAT:32.32745646N / LON:-104.24197228W NAD 27, SPCS NM EAST X:528375.44' / Y:482813.96' LAT:32.32733820N / LON:-104.24147024W</p> <p>BOTTOM HOLE LOCATION 14,011' MEASURED DEPTH IN FEET NAD 83, SPCS NM EAST X:569557.57' / Y:482858.85' LAT:32.32741798N / LON:-104.24197121W NAD 27, SPCS NM EAST X:528375.79' / Y:482799.97' LAT:32.32729972N / LON:-104.24146918W</p>	<p>SECTION 36 T-22-S SECTION 1</p> <p>SECTION 31 SECTION 6</p> <p>SECTION 6 SECTION 7</p> <p>SECTION 11 SECTION 12</p> <p>CORNER COORDINATES NAD 83, SPCS NM EAST A - X: 568227.81' / Y: 487840.96' B - X: 570881.56' / Y: 487843.47' C - X: 570883.00' / Y: 482551.56' D - X: 568203.23' / Y: 482533.94'</p> <p>CORNER COORDINATES NAD 27, SPCS NM EAST A - X: 527046.14' / Y: 487781.95' B - X: 529699.85' / Y: 487784.43' C - X: 529701.19' / Y: 482492.66' D - X: 527021.46' / Y: 482475.08'</p>	<p>17 OPERATOR CERTIFICATION I hereby certify that the information contained herein is true and complete to the best of my knowledge and belief, and that this organization either owns a working interest or unleased mineral interest in the land including the proposed bottom hole location or has a right to drill this well at this location pursuant to a contract with an owner of such a mineral or working interest, or to a voluntary pooling agreement or a compulsory pooling order heretofore entered by the division.</p> <p>Signature: <i>Adrian Covarrubias</i> Date: 1/24/2019 Printed Name: Adrian Covarrubias E-mail Address:</p> <p>18 SURVEYOR CERTIFICATION I hereby certify that the well location shown on this plat was plotted from field notes of actual surveys made by me or under my supervision, and that the same is true and correct to the best of my belief.</p> <p>Date of Survey: Signature and Seal of Professional Surveyor: Certificate Number:</p>
--	--	--

Distances/areas relative to NAD83 Combined Scale Factor: 0.99978038 Convergence: 0.05095500'; NOTE: ALL DIMENSIONS IN U.S. FEET

District I
1625 N. French Dr., Hobbs, NM 88240
Phone: (575) 393-6161 Fax: (575) 393-0720

District II
811 S. First St., Artesia, NM 88210
Phone: (505) 748-1283 Fax: (575) 748-9720

District III
1000 Rio Brazos Road, Aztec, NM 87410
Phone: (505) 334-6178 Fax: (505) 334-6170

District IV
1220 S. St. Francis Dr., Santa Fe, NM 87505
Phone: (505) 476-3460 Fax: (505) 476-3462

State of New Mexico
Energy, Minerals & Natural Resources Department
OIL CONSERVATION DIVISION
1220 South St. Francis Dr.
Santa Fe, NM 87505

Form C-102
Revised August 1, 2011
Submit one copy to appropriate
District Office
☐ AMENDED REPORT

WELL LOCATION AND ACREAGE DEDICATION PLAT

¹ API Number 30-015-44690	² Pool Code 98220	³ Pool Name PURPLE SAGE; WOLFCAMP (GAS)
⁴ Property Code	⁵ Property Name CATAPULT 1 WXY FEE	⁶ Well Number 10H
⁷ OGRID No. 372098	⁸ Operator Name MARATHON OIL PERMIAN LLC	⁹ Elevation 3217'

¹⁰ Surface Location

UL or lot no.	Section	Township	Range	Lot Idn	Feet from the	North/South line	Feet from the	East/West line	County
0	36	T22S	R26E		337	SOUTH	1357	EAST	EDDY

¹¹ Bottom Hole Location If Different From Surface

UL or lot no.	Section	Township	Range	Lot Idn	Feet from the	North/South line	Feet from the	East/West line	County
P	1	T23S	R26E		286	SOUTH	341	EAST	EDDY

¹² Dedicated Acres 320.36	¹³ Joint or Infill	¹⁴ Consolidation Code	¹⁵ Order No.
---	-------------------------------	----------------------------------	-------------------------

No allowable will be assigned to this completion until all interests have been consolidated or a non-standard unit has been approved by the division.

¹⁶		¹⁷ OPERATOR CERTIFICATION I hereby certify that the information contained herein is true and complete to the best of my knowledge and belief, and that this organization either owns a working interest or unleased mineral interest in the land including the proposed bottom hole location or has a right to drill this well at this location pursuant to a contract with an owner of such a mineral or working interest, or to a voluntary pooling agreement or a compulsory pooling order heretofore entered by the division. Signature: <i>Adrian Covarrubias</i> Date: 1/24/2019 Printed Name: Adrian Covarrubias E-mail Address:
¹⁸ SURVEYOR CERTIFICATION I hereby certify that the well location shown on this plat was plotted from field notes of actual surveys made by me or under my supervision, and that the same is true and correct to the best of my belief. Date of Survey: _____ Signature and Seal of Professional Surveyor: _____ Certificate Number: _____		

District I
1625 N. French Dr., Hobbs, NM 88240
Phone: (575) 393-6161 Fax: (575) 393-0720

District II
811 S. First St., Artesia, NM 88210
Phone: (575) 748-1283 Fax: (575) 748-9720

District III
1000 Rio Brazos Road, Aztec, NM 87410
Phone: (505) 334-6178 Fax: (505) 334-6170

District IV
1220 S. St. Francis Dr., Santa Fe, NM 87505
Phone: (505) 476-3460 Fax: (505) 476-3462

State of New Mexico
Energy, Minerals & Natural Resources Department
OIL CONSERVATION DIVISION
1220 South St. Francis Dr.
Santa Fe, NM 87505

Form C-102
Revised August 1, 2011
Submit one copy to appropriate
District Office

☐ AMENDED REPORT

WELL LOCATION AND ACREAGE DEDICATION PLAT

¹ API Number 30-015-44912	² Pool Code 98220	³ Pool Name PURPLE SAGE; WOLFCAMP (GAS)
⁴ Property Code	⁵ Property Name AIRPORT 36 WXY STATE	⁶ Well Number 10H
⁷ OGRID No. 372098	⁸ Operator Name MARATHON OIL PERMIAN LLC	⁹ Elevation 3217'

¹⁰ Surface Location

UL or lot no.	Section	Township	Range	Lot Idn	Feet from the	North/South line	Feet from the	East/West line	County
P	36	22S	26E		337	SOUTH	1327	EAST	EDDY

" Bottom Hole Location If Different From Surface

UL or lot no.	Section	Township	Range	Lot Idn	Feet from the	North/South line	Feet from the	East/West line	County
A	36	22S	26E		330	NORTH	330	EAST	EDDY

¹² Dedicated Acres	¹³ Joint or Infill	¹⁴ Consolidation Code	¹⁵ Order No.
320.00			

No allowable will be assigned to this completion until all interests have been consolidated or a non-standard unit has been approved by the division.

16		17 OPERATOR CERTIFICATION	
<p>BOTTOM HOLE LOCATION 13,714' MEASURED DEPTH IN FEET NAD 83, SPCS NM EAST X:570531.10' / Y:492860.66' LAT:32.35490916N / LON:104.23879083W NAD 27, SPCS NM EAST X:529349.49' / Y:492801.50' LAT:32.35479100N / LON:104.23828815W</p>		<p>I hereby certify that the information contained herein is true and complete to the best of my knowledge and belief, and that this organization either owns a working interest or unleased mineral interest in the land including the proposed bottom hole location or has a right to drill this well at this location pursuant to a contract with an owner of such a mineral or working interest, or to a voluntary pooling agreement or a compulsory pooling order heretofore entered by the division.</p> <p style="text-align: right;">Signature _____ Date 1/2/2020</p> <p style="text-align: right;">Adrian Covarrubias Printed Name</p> <p style="text-align: right;">E-mail Address _____</p>	
<p>SECTION 26 SECTION 25</p> <p>SECTION 35 SECTION 36</p> <p>LAST TAKE POINT 13,671' MEASURED DEPTH IN FEET NAD 83, SPCS NM EAST X:570534.28' / Y:492817.41' LAT:32.35479026N / LON:104.23878067W NAD 27, SPCS NM EAST X:529352.67' / Y:492758.24' LAT:32.35467209N / LON:104.23827799W</p> <p>FIRST TAKE POINT 9,014' MEASURED DEPTH IN FEET NAD 83, SPCS NM EAST X:570555.01' / Y:488173.16' LAT:32.34202385N / LON:104.23872682W NAD 27, SPCS NM EAST X:529373.31' / Y:488114.11' LAT:32.34190562N / LON:104.23822449W</p> <p>KICK OFF POINT 8,614' MEASURED DEPTH IN FEET NAD 83, SPCS NM EAST X:570557.51' / Y:487913.16' LAT:32.34130915N / LON:104.23871945W NAD 27, SPCS NM EAST X:529375.81' / Y:487854.12' LAT:32.34119092N / LON:104.23821715W</p> <p>SURFACE HOLE LOCATION 337' FNL 1327' FEL, SECTION 36 NAD 83, SPCS NM EAST X:569555.11' / Y:488179.22' LAT:32.34204292N / LON:104.24196450W NAD 27, SPCS NM EAST X:528373.43' / Y:488120.19' LAT:32.34192474N / LON:104.24146203W</p>		<p>SECTION 30 SECTION 31</p> <p>The diagram shows a well path starting from a Surface Hole Location (SHL) in Section 36, passing through various crossings (Crossing 1 to Crossing 4), and ending at a Bottom Hole Location (BHL) in Section 31. Key features include: - **Section 36**: Last Take Point, First Take Point, Kick Off Point. - **Section 35**: Crossings 1, 2, 3, 4. - **Section 30**: Crossings 1, 2, 3, 4. - **Section 31**: Bottom Hole Location (BHL). - **Measurements**: Measured depths are provided for each segment between points. Corner coordinates are listed for all four corners of each section. - **Labels**: SHL (Surface Hole Location), KOP (Kick Off Point), BHL (Bottom Hole Location), LAST TAKE POINT, FIRST TAKE POINT, CROSSING 1-4, NEAREST/FARTHEST MEASURED DEPTHS.</p>	
<p>SECTION 35 SECTION 36</p> <p>CORNER COORDINATES NAD 83, SPCS NM EAST A - X: 568161.72' / Y: 493200.20' B - X: 570884.53' / Y: 493139.71' C - X: 570881.56' / Y: 487843.47' D - X: 568227.81' / Y: 487840.96'</p>		<p>SECTION 2 SECTION 1</p> <p>CORNER COORDINATES NAD 27, SPCS NM EAST A - X: 526980.15' / Y: 493141.05' B - X: 529702.92' / Y: 493080.53' C - X: 529699.85' / Y: 487784.43' D - X: 527046.14' / Y: 487781.95'</p>	

18 SURVEYOR CERTIFICATION

I hereby certify that the well location shown on this plat was plotted from field notes of actual surveys made by me or under my supervision, and that the same is true and correct to the best of my belief.

Date of Survey _____ Signature and Seal of Professional Surveyor: _____

Certificate Number _____