

RECEIVED: <u>10/09/2018</u>	REVIEWER:	TYPE: <u>SWD</u>	APP NO: <u>PMAm 18288 48858</u>
--------------------------------	-----------	---------------------	------------------------------------

ABOVE THIS TABLE FOR OCD DIVISION USE ONLY

NEW MEXICO OIL CONSERVATION DIVISION
 - Geological & Engineering Bureau -
 1220 South St. Francis Drive, Santa Fe, NM 87505



ADMINISTRATIVE APPLICATION CHECKLIST

THIS CHECKLIST IS MANDATORY FOR ALL ADMINISTRATIVE APPLICATIONS FOR EXCEPTIONS TO DIVISION RULES AND REGULATIONS WHICH REQUIRE PROCESSING AT THE DIVISION LEVEL IN SANTA FE

Applicant: OWL SWD Operating, LLC **OGRID Number:** 308339
Well Name: Sholes Deep SWD #2 **API:** _____
Pool: SWD; Silurian-Devonian **Pool Code:** 97869

SUBMIT ACCURATE AND COMPLETE INFORMATION REQUIRED TO PROCESS THE TYPE OF APPLICATION INDICATED BELOW

- 1) **TYPE OF APPLICATION:** Check those which apply for [A]
 A. Location – Spacing Unit – Simultaneous Dedication
☐ NSL ☐ NSP (PROJECT AREA) ☐ NSP (PRORATION UNIT) ☐ SD
- B. Check one only for [I] or [II]
 [I] Commingling – Storage – Measurement
☐ DHC ☐ CTB ☐ PLC ☐ PC ☐ OLS ☐ OLM
 [II] Injection – Disposal – Pressure Increase – Enhanced Oil Recovery
☐ WFX ☐ PMX ☒ SWD ☐ IPI ☐ EOR ☐ PPR
- Other:**
- 2) **NOTIFICATION REQUIRED TO:** Check those which apply.
 A. ☒ Offset operators or lease holders
 B. ☒ Royalty, overriding royalty owners, revenue owners
 C. ☒ Application requires published notice
 D. ☐ Notification and/or concurrent approval by SLO
 E. ☐ Notification and/or concurrent approval by BLM
 F. ☒ Surface owner
 G. ☒ For all of the above, proof of notification or publication is attached, and/or,
 H. ☐ No notice required

FOR OCD ONLY

- ☐ Notice Complete
☐ Application Content Complete

- 3) **CERTIFICATION:** I hereby certify that the information submitted with this application for administrative approval is **accurate** and **complete** to the best of my knowledge. I also understand that **no action** will be taken on this application until the required information and notifications are submitted to the Division.

Note: Statement must be completed by an individual with managerial and/or supervisory capacity.

Ramona Hovey

Print or Type Name

Ramona K Hovey

Signature

Date

OCTOBER 5, 2018

(512) 600-1777

Phone Number

ramona@lonquist.com

e-mail Address

LONQUIST & CO. LLC

AUSTIN
HOUSTON

PETROLEUM
ENGINEERS

ENERGY
ADVISORS

WICHITA
CALGARY

www.lonquist.com

October 5, 2018

New Mexico Energy, Minerals, and Natural Resources Department
Oil Conservation Division District IV
1220 South St. Francis Drive
Santa Fe, New Mexico 87505
(505) 476-3440

RE: SHOLES DEEP SWD NO. 2 AUTHORIZATION TO INJECT

To Whom It May Concern:

Attached for your review is Form C-108, Application for Authorization to Inject, and its supplemental documents prepared for OWL SWD Operating, LLC's Sholes Deep SWD No. 2. In addition, Forms C-101 and C-102 have been included with this package. Notices have been sent to offset leaseholders and the surface owner. Proof of notice will be sent to the OCD upon receipt.

Any questions should be directed towards OWL SWD Operating, LLC's agent Lonquist & Co., LLC.

Regards,

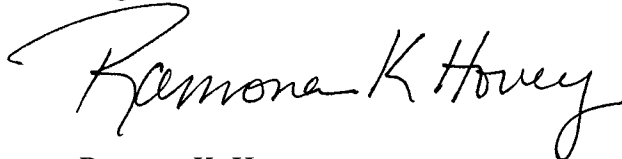

Ramona K. Hovey
Sr. Petroleum Engineer
Lonquist & Co., LLC
(512) 600-1777
ramona@lonquist.com

APPLICATION FOR AUTHORIZATION TO INJECT

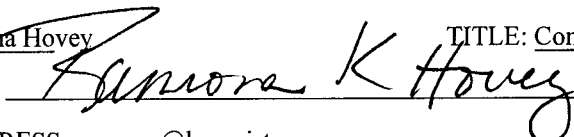
- I. PURPOSE: _____ Secondary Recovery _____ Pressure Maintenance X Disposal _____ Storage
Application qualifies for administrative approval? X Yes _____ No
- II. OPERATOR: OWL SWD Operating, LLC
ADDRESS: 8214 Westchester Drive, Suite 850, Dallas, TX 75255
CONTACT PARTY: Preston Carr PHONE: (855) 695-7937
- III. WELL DATA: Complete the data required on the reverse side of this form for each well proposed for injection.
Additional sheets may be attached if necessary.
- IV. Is this an expansion of an existing project? _____ Yes X No
If yes, give the Division order number authorizing the project: _____
- V. Attach a map that identifies all wells and leases within two miles of any proposed injection well with a one-half mile radius circle drawn around each proposed injection well. This circle identifies the well's area of review.
- VI. Attach a tabulation of data on all wells of public record within the area of review which penetrate the proposed injection zone. Such data shall include a description of each well's type, construction, date drilled, location, depth, record of completion, and a schematic of any plugged well illustrating all plugging detail.
- VII. Attach data on the proposed operation, including:
1. Proposed average and maximum daily rate and volume of fluids to be injected;
 2. Whether the system is open or closed;
 3. Proposed average and maximum injection pressure;
 4. Sources and an appropriate analysis of injection fluid and compatibility with the receiving formation if other than reinjected produced water; and,
 5. If injection is for disposal purposes into a zone not productive of oil or gas at or within one mile of the proposed well, attach a chemical analysis of the disposal zone formation water (may be measured or inferred from existing literature, studies, nearby wells, etc.).
- *VIII. Attach appropriate geologic data on the injection zone including appropriate lithologic detail, geologic name, thickness, and depth. Give the geologic name, and depth to bottom of all underground sources of drinking water (aquifers containing waters with total dissolved solids concentrations of 10,000 mg/l or less) overlying the proposed injection zone as well as any such sources known to be immediately underlying the injection interval.
- IX. Describe the proposed stimulation program, if any.
- *X. Attach appropriate logging and test data on the well. (If well logs have been filed with the Division, they need not be resubmitted).
- *XI. Attach a chemical analysis of fresh water from two or more fresh water wells (if available and producing) within one mile of any injection or disposal well showing location of wells and dates samples were taken.
- XII. Applicants for disposal wells must make an affirmative statement that they have examined available geologic and engineering data and find no evidence of open faults or any other hydrologic connection between the disposal zone and any underground sources of drinking water.
- XIII. Applicants must complete the "Proof of Notice" section on the reverse side of this form
- XIV. Certification: I hereby certify that the information submitted with this application is true and correct to the best of my knowledge and belief.
- NAME: Ramona Hovey TITLE: Consulting Engineer – Agent for OWL SWD Operating, LLC
SIGNATURE:  DATE: 10/05/2018
E-MAIL ADDRESS: ramona@lonquist.com
- XV. If the information required under Sections VI, VIII, X, and XI above has been previously submitted, it need not be resubmitted. Please show the date and circumstances of the earlier submittal: _____

III. WELL DATA

A. The following well data must be submitted for each injection well covered by this application. The data must be both in tabular and schematic form and shall include:

- (1) Lease name; Well No.; Location by Section, Township and Range; and footage location within the section.
- (2) Each casing string used with its size, setting depth, sacks of cement used, hole size, top of cement, and how such top was determined.
- (3) A description of the tubing to be used including its size, lining material, and setting depth.
- (4) The name, model, and setting depth of the packer used or a description of any other seal system or assembly used.

Division District Offices have supplies of Well Data Sheets which may be used or which may be used as models for this purpose. Applicants for several identical wells may submit a "typical data sheet" rather than submitting the data for each well.

B. The following must be submitted for each injection well covered by this application. All items must be addressed for the initial well. Responses for additional wells need be shown only when different. Information shown on schematics need not be repeated.

- (1) The name of the injection formation and, if applicable, the field or pool name.
- (2) The injection interval and whether it is perforated or open-hole.
- (3) State if the well was drilled for injection or, if not, the original purpose of the well.
- (4) Give the depths of any other perforated intervals and detail on the sacks of cement or bridge plugs used to seal off such perforations.
- (5) Give the depth to and the name of the next higher and next lower oil or gas zone in the area of the well, if any.

XIV. PROOF OF NOTICE

All applicants must furnish proof that a copy of the application has been furnished, by certified or registered mail, to the owner of the surface of the land on which the well is to be located and to each leasehold operator within one-half mile of the well location.

Where an application is subject to administrative approval, a proof of publication must be submitted. Such proof shall consist of a copy of the legal advertisement which was published in the county in which the well is located. The contents of such advertisement must include:

- (1) The name, address, phone number, and contact party for the applicant;
- (2) The intended purpose of the injection well; with the exact location of single wells or the Section, Township, and Range location of multiple wells;
- (3) The formation name and depth with expected maximum injection rates and pressures; and,
- (4) A notation that interested parties must file objections or requests for hearing with the Oil Conservation Division, 1220 South St. Francis Dr., Santa Fe, New Mexico 87505, within 15 days.

NO ACTION WILL BE TAKEN ON THE APPLICATION UNTIL PROPER PROOF OF NOTICE HAS BEEN SUBMITTED.

NOTICE: Surface owners or offset operators must file any objections or requests for hearing of administrative applications within 15 days from the date this application was mailed to them.

INJECTION WELL DATA SHEET

OPERATOR: OWL SWD Operating, LLC (OGRID 308339)

WELL NAME & NUMBER: Sholes Deep SWD No. 2

WELL LOCATION: 1,115' FSL & 1,122' FWL
FOOTAGE LOCATION

N
UNIT LETTER

29
SECTION

25 S
TOWNSHIP

37 E
RANGE

WELLBORE SCHEMATIC

WELL CONSTRUCTION DATA

Surface Casing

Hole Size: 20"

Casing Size: 16"

Cemented with: 1220 sks

or _____ ft³

Top of Cement: surface

Method Determined: circulation

Intermediate Casing

Hole Size: 14-3/4"

Casing Size: 10-3/4"

Cemented with: 1,870 sks

or _____ ft³

Top of Cement: surface

Method Determined: circulation

Production Casing

Hole Size: 9-1/2"

Casing Size: 7-5/8"

Cemented with: 990 sks

or _____ ft³

Top of Cement: surface

Method Determined: circulation

Total Depth: 10,826'

Injection Interval

9,052 feet to 10,826 feet

(Open Hole)

INJECTION WELL DATA SHEET

Tubing Size: 5.500", 17.0 lb/ft. P-110 UFJ (or equivalent), from 0' – 9,000'

Lining Material: Duoline

Type of Packer: 7-5/8" x 5-1/2" D&L Oil Tools Permapack Packer – Single Bore

Packer Setting Depth: 9,000'

Other Type of Tubing/Casing Seal (if applicable): _____

Additional Data

1. Is this a new well drilled for injection? X Yes No

If no, for what purpose was the well originally drilled?

2. Name of the Injection Formation: Silurian-Devonian

3. Name of Field or Pool (if applicable): _____

4. Has the well ever been perforated in any other zone(s)? List all such perforated intervals and give plugging detail, i.e. sacks of cement or plug(s) used.

No, new drill.

5. Give the name and depths of any oil or gas zones underlying or overlying the proposed injection zone in this area:

Formation	Depth
Tansill	2,521'
Yates	2,655'
Seven Rivers	2,920'
Queen	3,143'
Glorieta	4,395'
Tubb	5,993'
Woodford	8,508'
Devonian	9,052'
Fusselman	9,852'

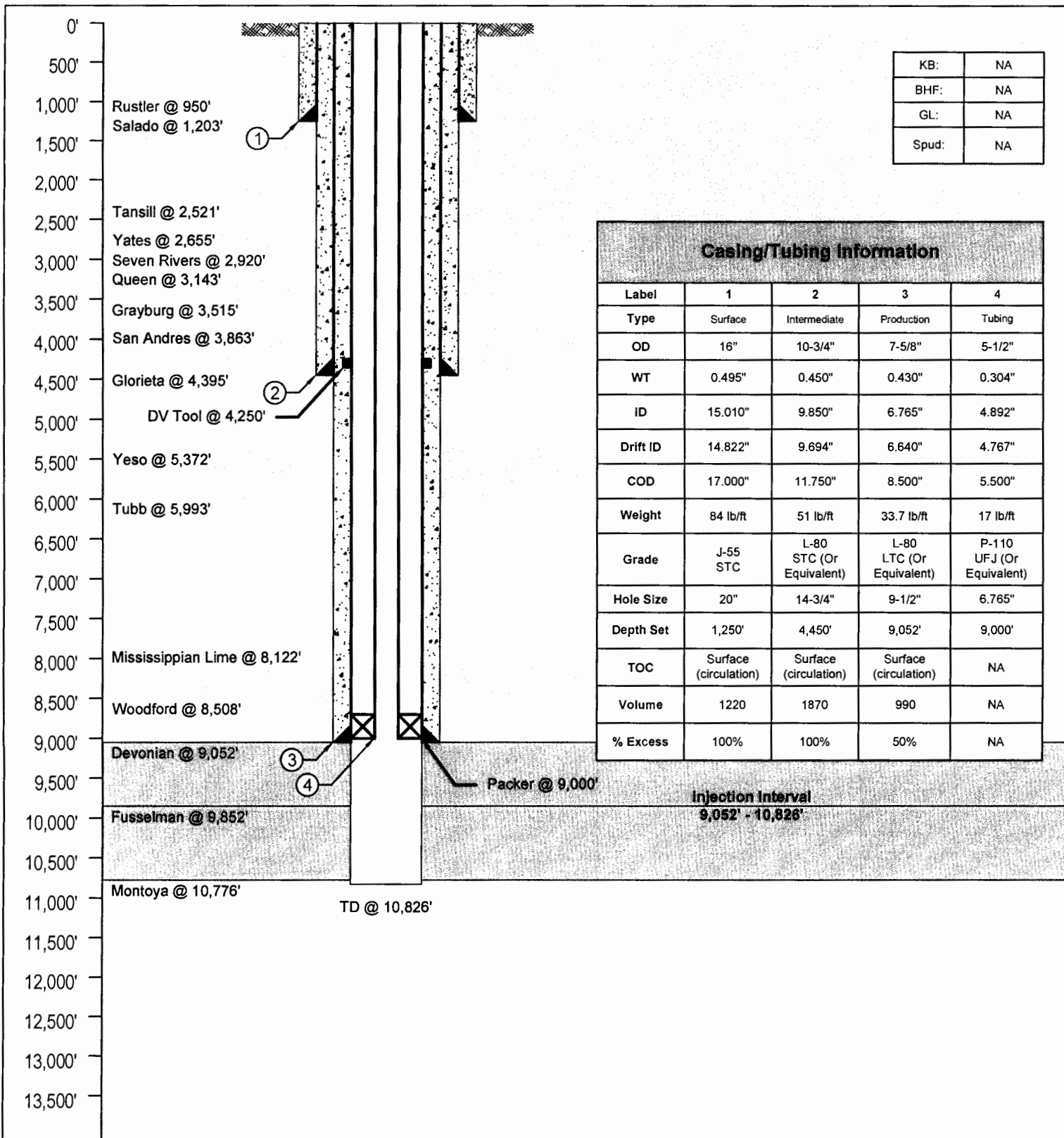

LONQUIST & CO. LLC PETROLEUM ENGINEERS ENERGY ADVISORS HOUSTON · CALGARY · AUSTIN · WICHITA · DENVER Texas License F-9147 12912 Hill Country Blvd. Ste F-200 Austin, Texas 78738 Tel: 512.732.9812 Fax: 512.732.9816	OWL		Sholes Deep SWD No. 2	
	Country: USA		State/Province: New Mexico	County/Parish: Lea
	Location:		Site:	Survey:
	API No: NA		Field:	Well Type/Status: SWD / New Drill
	RRC District No:		Project No: 1752	Date: 9/13/2018
	Drawn: WHG		Reviewed: SLP	Approved:
	Rev No: 1		Notes:	

OWL SWD Operating, LLC.

Sholes Deep SWD No. 2

FORM C-108 Supplemental Information

III. Well Data

A. Wellbore Information

1.

Well information	
Lease Name	Sholes Deep SWD
Well No.	2
Location	Unit N S-29 T-25S R-37E
Footage Location	1,115' FSL & 1,122' FWL

2.

a. Wellbore Description

Casing Information			
Type	Surface	Intermediate	Production
OD	16"	10-3/4"	7-5/8"
WT	0.495"	0.450"	0.430"
ID	15.010"	9.850"	6.765"
Drift ID	14.822"	9.694"	6.640"
COD	17.000"	11.750"	8.500"
Weight	84 lb/ft	51lb/ft	33.7 lb/ft
Grade	J-55 STC	L-80 STC (Or Equivalent)	L-80 LTC (Or Equivalent)
Hole Size	20"	14-3/4"	9-1/2"
Depth Set	1,250'	4,450'	9,052'

b. Cementing Program

Cement Information			
Casing String	Surface	Intermediate 1	Production
Lead Cement	ECONOCEM	NeoCem	Stage 1: NeoCem Stage 2: NeoCem
Lead Cement Volume	715 sks	1,275 sks	Stage 1: 370 sks Stage 2: 285 sks
Tail Cement	HALCEM	HALCEM	Stage 1: VersaCem Stage 2: HalCem
Tail Cement Volume	505 sks	595 sks	Stage 1: 235 sks Stage 2: 100 sks
Cement Excess	100%	100%	50%
TOC	Surface	Surface	Surface
Method	Circulate to Surface	Circulate to Surface	Circulate to Surface

3. Tubing Description

Tubing	
OD	5-1/2"
WT	0.304"
ID	4.892"
Drift ID	4.767"
COD	5.500"
Weight	17 lb/ft
Grade	P-110 UFJ (Or Equivalent)
Depth Set	9,000'

Tubing will be lined with Duoline.

4. Packer Description

D&L Oil Tools 7-5/8" x 5-1/2" Permapack Packer – Single Bore

B. Completion Information

1. Injection Formation: Silurian - Devonian
2. Gross Injection Interval: 9,052' – 10,826'

Completion Type: Open Hole
3. Drilled for injection.
4. See the attached wellbore schematic.
5. Oil and Gas Bearing Zones within area of well:

Formation	Depth
Tansill	2,521'
Yates	2,655'
Seven Rivers	2,920'
Queen	3,143'
Glorieta	4,395'
Tubb	5,993'
Woodford	8,508'
Devonian	9,052'
Fusselman	9,852'

VI. Area of Review

Two wells within the one-mile AOR penetrated the proposed injection zone. The ARCO SRC No. 1 (30-025-11824) was plugged in 1981. The Gutman D No. 1 (30-025-11829) was plugged in 1968. The well records and wellbore schematics for these two wells are attached.

VII. Proposed Operation Data

1. Proposed Daily Rate of Fluids to be Injection:

Average Volume: 20,000 BPD
Maximum Volume: 30,000 BPD
2. Closed System
3. Anticipated Injection Pressure:

Average Injection Pressure: 1,481 PSI (surface pressure)
Maximum Injection Pressure: 1,810 PSI (surface pressure)

4. The injection fluid is to be locally produced water. Attached are produced water sample analyses taken from the closest wells that feature samples from the Devonian and Fusselman formations.
5. As mentioned above, a Devonian produced water sample analysis is attached.

VIII. Geological Data

The Devonian formation is a dolomitic ramp carbonate that occurs below the Woodford shale and above the Fusselman formation. Strata found in the Devonian formation near Jal are two major groups, the Wristen Buildups and the Thirtyone Deepwater Chert, with the Wristen being more abundant. The Wristen Groups is composed of mixed limestone and dolomites with mudstone to grainstone and boundstone textures. Porosity in the Wristen group is a result of both primary and secondary development. Present are moldic, vugular, karstic (including collapse breccia) features that allow for higher porosities and permeabilities. The Thirtyone Formation contains two end-member reservoir facies, skeletal packstones/grainstones and spiculitic chert, with most of the porosity and permeability found in the coarsely crystalline cherty dolomite. These particular characteristics allow for this formation to be a successful Salt Water Disposal horizon.

A. Injection Zone: Devonian-Silurian Formation

Formation	Depth
Rustler	950'
Salado	1,203'
Tansill	2,521'
Yates	2,655'
Seven Rivers	2,920'
Queen	3,143'
Grayburg	3,515'
San Andres	3,863'
Glorieta	4,395'
Yeso	5,372'
Tubb	5,993'
Mississippian Lime	8,122'
Woodford	8,508'
Devonian	9,052'
Fusselman	9,852'
Montoya	10,776'

B. Underground Sources of Drinking Water

Water wells in the one-mile surrounding area for the proposed Sholes Deep SWD #2 well are at depths ranging from 100 ft to 460 ft. The Rustler may also be another USDW and will be protected through the top of the Salado Formation at 1,203' by setting surface casing at 1,250'.

IX. Proposed Stimulation Program

No proposed stimulation program.

X. Logging and Test Data on the Well

There are no existing logs or test data on the well. During the process of drilling and completion resistivity, gamma ray, and density logs will be run.

XI. Chemical Analysis of Fresh Water Wells

There are 15 fresh water wells within one mile of the well location, per the New Mexico Office of the State Engineer. A list of all the water wells, a map of these wells and their associated Water Right Summaries are attached. Fresh water samples will be obtained from two of the wells and analysis of these samples will be submitted as soon as possible.

XII. Affirmative Statement of Examination of Geologic and Engineering Data

Based on the available engineering and geologic data we find no evidence of open faults or any other hydrologic connection between the disposal zone and any underground sources of drinking water.

Sholes Deep SWD No. 2
1 Mile Area of Review List

API (30-025-...)	WELL NAME	WELL TYPE	STATUS	OPERATOR	TVD (FT.)	LATITUDE (NAD83 DD)	LONGITUDE (NAD83 DD)	DATE DRILLED
11673	PRE-ONGARD WELL #001	O	P	PRE-ONGARD WELL OPERATOR	0	32.1103554000	-103.182724000	1/1/1900
11817	SAUNDERS ESTATE #001	G	P	BURLESON PETROLEUM, INC	0	32.1031036000	-103.174194300	1/1/1900
11820	PRE-ONGARD WELL #002	O	P	PRE-ONGARD WELL OPERATOR	0	32.1003914000	-103.175254800	1/1/1900
11823	PRE-ONGARD WELL #001	O	P	PRE-ONGARD WELL OPERATOR	0	32.0958595000	-103.186965900	1/1/1900
11824	PRE-ONGARD WELL #001	G	P	PRE-ONGARD WELL OPERATOR	0	32.1030998000	-103.178451500	1/1/1900
11825	PRE-ONGARD WELL #001	G	P	PRE-ONGARD WELL OPERATOR	0	32.1060104000	-103.186348000	1/1/1900
11826	BATES #002	G	P	BETTIS BOYLE & STOVALL, INC.	99999	32.1067238000	-103.191230800	12/31/9999
11827	GUTMAN #001	G	P	BURLESON PETROLEUM, INC	3270	32.0994873000	-103.178451500	6/20/1950
11828	PRE-ONGARD WELL #001	G	P	PRE-ONGARD WELL OPERATOR	0	32.1030998000	-103.182716400	1/1/1900
11829	PRE-ONGARD WELL #001	G	P	PRE-ONGARD WELL OPERATOR	0	32.0990753000	-103.178451500	1/1/1900
11830	GUTMAN SWD #002	S	A	HERMAN L. LOEB LLC	3297	32.1003952000	-103.181648300	11/17/1950
11831	JENKINS #001	O	P	BURLESON PETROLEUM, INC	3173	32.0958595000	-103.192291300	12/4/1951
11832	PRE-ONGARD WELL #001	O	P	PRE-ONGARD WELL OPERATOR	0	32.1067276000	-103.182716400	1/1/1900
11833	PRE-ONGARD WELL #002	G	P	PRE-ONGARD WELL OPERATOR	0	32.0994873000	-103.186965900	1/1/1900
11834	JENKINS #003	G	P	BURLESON PETROLEUM, INC	0	32.0961342000	-103.186965900	1/1/1900
11835	PRE-ONGARD WELL #004	O	P	PRE-ONGARD WELL OPERATOR	0	32.0994873000	-103.190742500	1/1/1900
11836	CROSBY A #001	G	P	AMERICAN INLAND RESOURCES COMPANY LLC	99999	32.0958595000	-103.182708700	12/31/9999
11837	PRE-ONGARD WELL #001	G	P	PRE-ONGARD WELL OPERATOR	0	32.1049156000	-103.180587800	1/1/1900
11838	WINNINGHAM #007	G	P	BURLINGTON RESOURCES OIL & GAS CO	99999	32.1032562000	-103.194931000	12/31/9999
11843	PRE-ONGARD WELL #003	G	P	PRE-ONGARD WELL OPERATOR	0	32.0993500000	-103.194419900	1/1/1900
11844	WINNINGHAM #004	O	P	BURLINGTON RESOURCES OIL & GAS CO	99999	32.0958595000	-103.199752800	12/31/9999
11845	WINNINGHAM #006	O	P	BURLINGTON RESOURCES OIL & GAS CO	99999	32.0958595000	-103.195488000	12/31/9999
11850	PRE-ONGARD WELL #001	O	P	PRE-ONGARD WELL OPERATOR	0	32.0931396000	-103.203979500	1/1/1900
11853	DYER #001	O	E	FULFER OIL & CATTLE LLC	3251	32.0931396000	-103.200813300	9/11/1950
11854	DYER #002	O	A	FULFER OIL & CATTLE LLC	3440	32.0920258000	-103.196517900	7/16/1975
11855	DYER #003	G	A	FULFER OIL & CATTLE LLC	2968	32.0895081000	-103.194419900	5/10/1976
11857	M F LEGAL #002	G	P	CIMAREX ENERGY CO. OF COLORADO	3350	32.0849876000	-103.195480300	12/31/9999
11862	ARNOTT RAMSAY NCT B #002	G	P	CHEVRON U S A INC	0	32.0886002000	-103.178443900	1/1/1900
11863	ARNOTT RAMSAY NCT-B #003	O	T	ENERVEST OPERATING L.L.C.	8797	32.0922279000	-103.178443900	10/26/1956
11882	EL PASO TOM FEDERAL #009	G	P	LANEXCO INC	4000	32.0922279000	-103.174186700	12/10/1947
11883	PRE-ONGARD WELL #004	O	P	PRE-ONGARD WELL OPERATOR	0	32.0886002000	-103.174186700	1/1/1900
12552	WINNINGHAM #005	O	P	BURLINGTON RESOURCES OIL & GAS CO	3180	32.0994873000	-103.199752800	3/12/1951
26106	ARNOTT RAMSAY NCT-B #004	S	A	ENERVEST OPERATING L.L.C.	3600	32.0931358000	-103.192291300	12/31/9999
26153	PRE-ONGARD WELL #002	O	C	PRE-ONGARD WELL OPERATOR	0	32.0922265569	-103.195496899	12/31/9999
26191	PRE-ONGARD WELL #002	O	P	PRE-ONGARD WELL OPERATOR	0	32.1031036000	-103.177391100	1/1/1900
26278	ARNOTT RAMSAY NCT-B #006	O	A	ENERVEST OPERATING L.L.C.	3600	32.0849876000	-103.182708700	4/6/1979
26279	ARNOTT RAMSAY NCT-B #007	G	P	PLANTATION OPERATING LLC	3600	32.0853958000	-103.179512000	8/13/1981
26595	PRE-ONGARD WELL #001	G	P	PRE-ONGARD WELL OPERATOR	0	32.1033974000	-103.192451500	1/1/1900
26708	EL PASO TOM FEDERAL #001	G	P	LANEXCO INC	3330	32.0931358000	-103.175247200	3/21/1980
26725	EL PASO TOM FEDERAL #002	O	P	LANEXCO INC	3300	32.0895081000	-103.175247200	3/29/1980
26757	ARNOTT RAMSAY NCT-B #009	O	A	ENERVEST OPERATING L.L.C.	3450	32.0849876000	-103.186958300	4/25/1980
26962	ARNOTT RAMSAY NCT-B #010	O	A	ENERVEST OPERATING L.L.C.	3400	32.0886002000	-103.186958300	12/31/9999
26963	ARNOTT RAMSAY NCT-B #011	O	T	ENERVEST OPERATING L.L.C.	3473	32.0840797000	-103.190155000	12/31/9999
27177	CROSBY A #003	O	P	AMERICAN INLAND RESOURCES COMPANY LLC	3400	32.0958557000	-103.174186700	12/31/9999
27265	CROSBY A #004	O	P	AMERICAN INLAND RESOURCES COMPANY LLC	3419	32.0958557000	-103.178451500	12/31/9999
28508	EL PASO TOM FEDERAL #005	G	A	LANEXCO INC	3210	32.0895081000	-103.174186700	12/31/9999

Sholes Deep SWD No. 2
1 Mile Area of Review List

28637	WINNINGHAM #009	G	A	SPECIAL ENERGY CORP	3475	32.1067276000	-103.199752800	12/31/9999
-------	-----------------	---	---	---------------------	------	---------------	----------------	------------

Sholes Deep SWD No. 1
Water Wells Within 1 Mile List

POD BASIN	POD #	T	R	S	WELL DEPTH	WATER DEPTH	WELL USE	POD STATUS	STATUS	OWNER LAST NAME	OWNER FIRST NAME	LAT	LONG	EASTING	NORTHING	DATUM
CP	00774	25S	37E	29	100	60	DOM	ACT	PMT	HOLGUIN	ANTONIO	32.10486767140	-103.18907548600	670869.0	3553495.0	NAD83
CP	00434	25S	37E	29	0	0	DOM		PMT	ELY	S.C.	32.10487180200	-103.18055560700	671673.0	3553509.0	NAD83
CP	00509	25S	37E	29	300	275	DOM	ACT	PMT	DORMINEY	CHARLES	32.10579010070	-103.18169245000	671564.0	3553609.0	NAD83
CP	00487	25S	37E	29	421	250	DOM	ACT	PMT	REED	L.L.	32.10671382310	-103.18698322300	671063.0	3553703.0	NAD83
CP	00638	25S	37E	29	380	187	DOM	ACT	PMT	TRICE	DONALD R.	32.10671161630	-103.19124325600	670661.0	3553696.0	NAD83
CP	00506	25S	37E	29	425	200	DOM	ACT	PMT	TAFF	CHARLES D.	32.10487180200	-103.18055560700	671673.0	3553509.0	NAD83
CP	00557	25S	37E	20	350	42	DOM	ACT	PMT	WEBB	LUCILLE BOCK	32.10944212020	-103.19233391800	670553.0	3553997.0	NAD83
CP	00387	25S	37E	29	422	210	DOM	ACT	PMT	BALLINGER	PAUL S	32.10308994340	-103.18272085400	671472.0	3553308.0	NAD83
CP	01512	25S	37E	32	0	0	MUN		PMT	CITY OF JAL		32.09070046160	-103.17869955800	671874.7	3551940.8	NAD83
CP	01256	25S	37E	29	0	0	MUN	PEN	PMT	CITY OF JAL		32.10097215750	-103.19141681800	670655.3	3553059.4	NAD83
CP	01256	25S	37E	29	0	0	MUN	PEN	PMT	CITY OF JAL		32.09911101920	-103.18905560500	670881.6	3552856.8	NAD83
CP	01256	25S	37E	29	450	190	MUN	ACT	PMT	CITY OF JAL		32.09947197880	-103.19089750900	670707.1	3552893.9	NAD83
CP	01256	25S	37E	29	440	210	MUN	ACT	PMT	CITY OF JAL		32.09938887610	-103.18786123400	670993.8	3552889.5	NAD83
CP	01306	25S	37E	29	458	110	COM	ACT	PMT	FULFER OIL & CATTLE COMPANY		32.09595277030	-103.19186435400	670622.4	3552502.2	NAD83
CP	01308	25S	37E	30	420	210	COM	ACT	PMT	FULFER OIL & CATTLE COMPANY		32.09416988830	-103.19758081800	670086.2	3552295.5	NAD83

Lea Co., NM

Drawn by: SJL	Date: 9/14/2018	Approved by: ELR
---------------	-----------------	------------------

Drawn by: SJL	Date: 9/14/2018	Approved by: ELR
---------------	-----------------	------------------

Date: 9/14/2018	Approved by: ELR
-----------------	------------------

**PETROLEUM
ENGINEERS**

**ENERGY
ADVISORS**

AUSTIN • HOUSTON • WICHITA • DENVER • CALGARY

- | | |
|---|--|
|  | Sholes Deep SWD No. 2 |
|  | 1/2 Mile Radius |
|  | DQ-Section (NM-PLSS 2nd Div.) |
|  | Section (NM-PLSS 1st Div.) |
|  | Township/Range (NM-PLSS) |
|  | NM - BLM |
|  | NM - SLO |
|  | Fuiler Ranch Property Boundary (Surface Owner) |
|  | API (30-025-...) SHL Status-Type (Count) |
|  | Active - Oil (28) |
|  | Active - Gas (21) |
|  | Active - SWD (6) |
|  | Active - Injection (2) |
|  | Permitted - Oil (1) |
|  | Permitted - SWD (1) |
|  | Cancelled Location (4) |
|  | Approved TA - Oil (3) |
|  | Expired/TA - Oil (3) |
|  | Plugged/Not Released - Oil (1) |
|  | Plugged/Not Released - Gas (1) |
|  | Plugged/Not Released - Misc. (1) |
|  | Plugged/Site Released - Oil (85) |
|  | Plugged/Site Released - Gas (64) |
|  | Plugged/Site Released - SWD (4) |
|  | Plugged/Site Released - Injection (1) |

Losses
-BP AMERICA PRODUCTION CO

-CHEVRON USA INC

SHL Source: NM-OCD (2018)



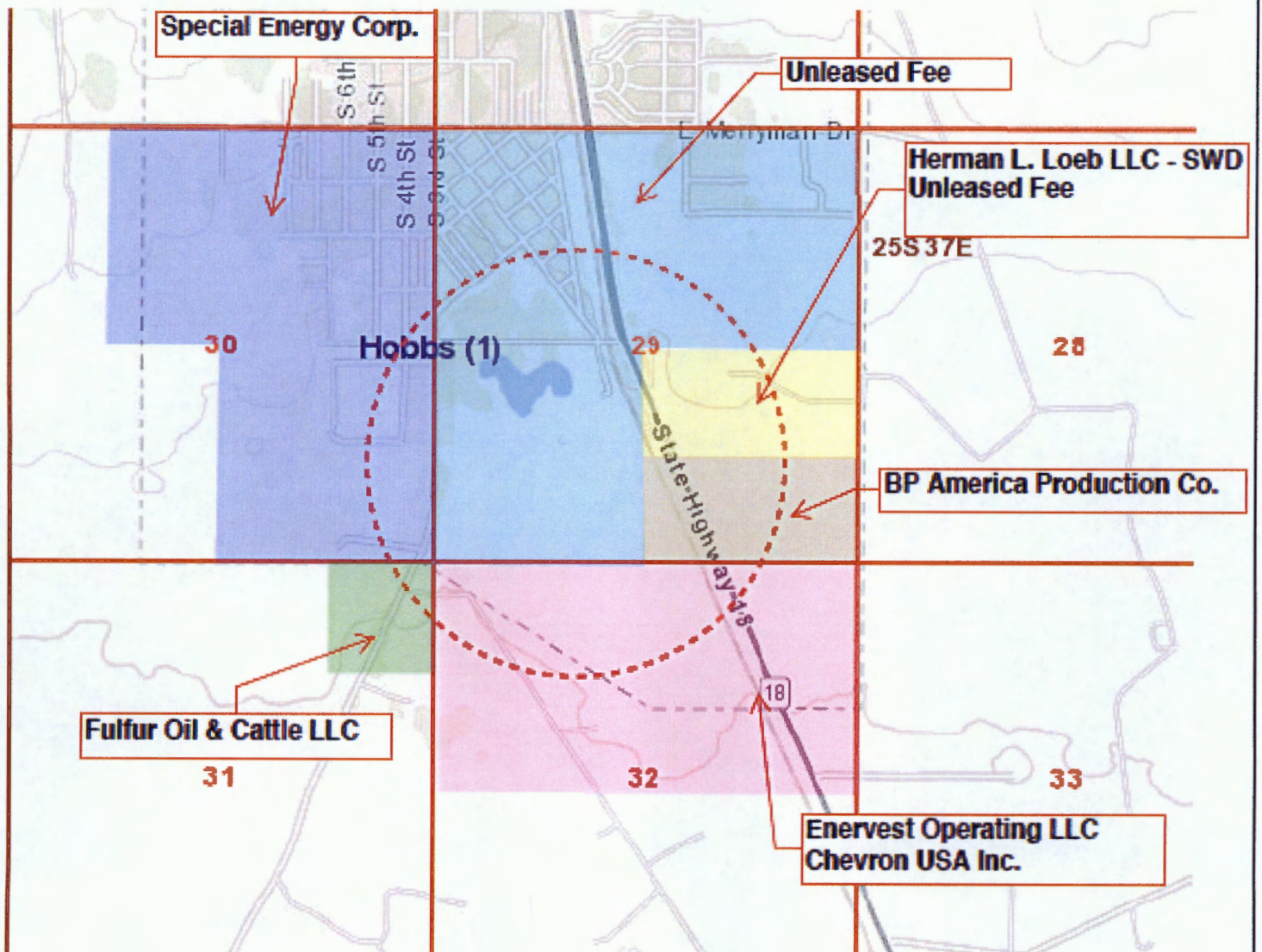

Sholes Deep SWD No. 2
1/2 Mile Offset Operators and Lessees List

S/T/R	QQ UNIT LETTER(S)	OPERATOR	MINERAL LESSEE	MINERAL OWNER	SURFACE OWNER	ADDRESS 1	ADDRESS 2
29/25S/37E	J	HERMAN L. LOEB LLC	-	-	-	600 COUNTY CLUB DRIVE	LAWRENCEVILLE, IL 62439
	O,P	-	BP AMERICA PRODUCTION CO	-	-	PO BOX 3092	HOUSTON, TX 77253
	E,F,G,H,I,K,L,M,N	-	-	PRIVATE (UNKNOWN)	-	-	-
30/25S/37E	H,I,P	-	-	PRIVATE (UNKNOWN)	-	-	-
31/25S/37E	A	FULFER OIL & CATTLE LLC	-	-	-	PO BOX 1224	JAL, NM 88252
32/25S/37E	A,D,F	ENERVEST OPERATING L.L.C.	-	-	-	2700 FARMINGTON AVE, BLDG K SUITE 1	FARMINGTON, NM 87401
	B,C,E	-	CHEVRON USA INC	-	-	6301 DEAUVILLE	MIDLAND, TX 79706
Surface Location	-	-	-	-	FULFER RANCH LLC	PO BOX 1224	JAL, NM 88252

Produced Water Analysis - Surrounding Areas
Sholes Deep SWD #2

wellname	api	latitude	longitude	section	township	range	unit	figs	figew	county	state	formation	sampledate	ph	tds_mgl	resistivity_ohm_cm	sodium_mgl	calcium_mgl	magnesium_mgl	chloride_mgl	carbonate_mgl	bicarbonate	sulfate_mgl
STATE B COM #001	3002509716	32.1794052	-103.2212524		36 24S	36E	C	600N	1880W	LEA	NM	DEVONIAN			176234					107400		128	1004
ARNOTT RAMSAY NCT-B #003	3002511863	32.0922279	-103.1784439		32 25S	37E	A	660N	660E	LEA	NM	DEVONIAN	1/2/1900 0:00					17244		100382		476	
ARNOTT RAMSAY NCT-B #003	3002511863	32.0922279	-103.1784439		32 25S	37E	A	660N	660E	LEA	NM	DEVONIAN			158761				5345				
CARLSON A #002	3002511764	32.1003838	-103.1113434		25 25S	37E	I	2310S	990E	LEA	NM	FUSSELMAN			208280					124000		510	3400
CARLSON B 25 #004	3002511784	32.096756	-103.1113434		25 25S	37E	P	990S	990E	LEA	NM	FUSSELMAN			184030				112900		68	1806	
COPPER #001	3002511818	32.0994835	-103.1656723		28 25S	37E	J	1980S	1981E	LEA	NM	DEVONIAN			27506				15270		1089	1079	
LEARCY MCBUFFINGTON #008	3002511569	32.1239548	-103.118782		13 25S	37E	N	330S	1980W	LEA	NM	FUSSELMAN	1/2/1900 0:00	7.6	67909			2603	684	38887		742	2489
SOUTH JUSTIS UNIT #016F	3002511556	32.1312065	-103.1187744		13 25S	37E	F	2310N	1980W	LEA	NM	FUSSELMAN			57675					34030		595	1211
SOUTH JUSTIS UNIT #023C	3002511760	32.1067276	-103.1184616		25 25S	37E	C	660N	2080W	LEA	NM	FUSSELMAN			63817					35870		360	3442
STATE NJ A #001	3002511398	32.1647491	-103.1273346		2 25S	37E	A	663N	660E	LEA	NM	DEVONIAN			105350					59300		660	4950
STATE Y #009	3002511777	32.1058197	-103.1113434		25 25S	37E	A	990N	990E	LEA	NM	FUSSELMAN	3/17/1961 0:00	7.3	219570					129000		960	4630
STATE Y #009	3002511777	32.1058197	-103.1113434		25 25S	37E	A	990N	990E	LEA	NM	FUSSELMAN	3/18/1961 0:00	6.8	163430					96000		290	3780
WESTATES FEDERAL #004	3002511389	32.161129	-103.1241226		1 25S	37E	E	1980N	330W	LEA	NM	FUSSELMAN	6/17/1961 0:00	6	80880					46200		340	3050
WESTATES FEDERAL #004	3002511389	32.161129	-103.1241226		1 25S	37E	E	1980N	330W	LEA	NM	FUSSELMAN			84900					48600		840	2650
WESTATES FEDERAL #004	3002511389	32.161129	-103.1241226		1 25S	37E	E	1980N	330W	LEA	NM	FUSSELMAN			72200					41000		370	2960
WESTATES FEDERAL #004	3002511389	32.161129	-103.1241226		1 25S	37E	E	1980N	330W	LEA	NM	FUSSELMAN			80900					46200		340	3050
WESTATES FEDERAL #004	3002511389	32.161129	-103.1241226		1 25S	37E	E	1980N	330W	LEA	NM	FUSSELMAN			77600					44000		550	3240
WESTATES FEDERAL #004	3002511389	32.161129	-103.1241226		1 25S	37E	E	1980N	330W	LEA	NM	FUSSELMAN			135000					77000		650	5810
WESTATES FEDERAL #004	3002511389	32.161129	-103.1241226		1 25S	37E	E	1980N	330W	LEA	NM	FUSSELMAN			114000					65000		280	5110
WESTATES FEDERAL #004	3002511389	32.161129	-103.1241226		1 25S	37E	E	1980N	330W	LEA	NM	FUSSELMAN			135000					77000		500	5320
WESTATES FEDERAL #008	3002511393	32.1621208	-103.1241226		1 25S	37E	E	1620N	330W	LEA	NM	FUSSELMAN			91058					51020		376	4783
WESTATES FEDERAL #008	3002511393	32.1621208	-103.1241226		1 25S	37E	E	1620N	330W	LEA	NM	FUSSELMAN			86847					50450		363	2544
EARNSWORTH FEDERAL #006	3002511950	32.0777245	-103.162468		4 26S	37E	A	660N	990E	LEA	NM	DEVONIAN			31931					20450		302	591

Sholes Deep SWD No. 2 Notice List					
S-T-R	Unit(s)	Notice Party Type	Notice Party	Address	Phone Number
			Oil Conservation Division District IV	1220 South St. Francis Drive, Santa Fe, NM 87505	505-476-3440
			Oil Conservation Division District I - Hobbs	1625 N. French Drive Hobbs, New Mexico 88240	575-393-6161
Surface Owner					
		SURFACE OWNER	Fulfer Ranch LLC	P.O. BOX 1224 JAL, NM 88252	505-935-9970
Notice Parties - 0.5 Mile					
S29-T25S-R37E	J	OPERATOR	HERMAN L LOEB LLC	600 COUNTY CLUB DRIVE LAWRENCEVILLE, IL 62439	
S31-T25S-R37E	A	OPERATOR	FULFER OIL & CATTLE LLC	P.O. BOX 1224 JAL, NM 88252	505-935-9970
S32-T25S-R37E	A,D,F	OPERATOR	ENERVEST OPERATING LLC	2700 FARMINGTON AVE, BLDG K SUITE 1	
S29-T25S-R37E	O, P	LESSEE	BP AMERICA PRODUCTION CO	PO BOX 3092 HOUSTON, TX 77253	
S32-T25S-R37E	B,C,E	LESSEE	CHEVRON USA INC.	6301 Deauville Midland, TX 79706	
S29-T25S-R37E	L,K,M,N	MINERAL OWNER	James T. Coppedge, SSP	P.O. Box 43 Spencer, IN 47460	
S29-T25S-R37E	L,K,M,N	MINERAL OWNER	Doralean Sanders Bean, Dora Lewis Sanders and Leland L. Fellows, Independent Trustees of The Estate of L. T. Lewis	P.O. Box 1738 Roswell, NM 88202	
S29-T25S-R37E	L,K,M,N	MINERAL OWNER	John H. Hendrix Corp.	P.O. Box 3040 Midland, TX 79702	
S29-T25S-R37E	L,K,M,N	MINERAL OWNER	Alvin Luskey et ux Sandra Luskey	4433 Dunwick Fort Worth, TX 76109	
S29-T25S-R37E	L,K,M,N	MINERAL OWNER	Metropolitan Royalty Corp.	#10 Roxbury Place Glen Rock, NJ 07452	
S29-T25S-R37E	L,K,M,N	MINERAL OWNER	John Grant Akin, Trustee under Declaration of Trust	6026 Brusy Mountain Road Moravian Falls, NC 28654	
S29-T25S-R37E	L,K,M,N	MINERAL OWNER	New Mexico Western Minerals Inc.	P.O. Box 1738 Roswell, NM 88202	
S29-T25S-R37E	L,K,M,N	MINERAL OWNER	Sallee Oconner, SSP	2206 Noble Court, SE Apt. "B" Auburn, WA 98092	
S29-T25S-R37E	L,K,M,N	MINERAL OWNER	Frank L. Johnson, SSP	HCI Box 50 Coalinga, CA 93210	
S29-T25S-R37E	L,K,M,N	MINERAL OWNER	Clarence W. Johnson, SSP	345 Overland Road West Meridian, ID 83642	
S29-T25S-R37E	L,K,M,N	MINERAL OWNER	Boyed E. Penfield, SSP	1804 Long Mead Road Silver Spring, MD 20906	
S29-T25S-R37E	L,K,M,N	MINERAL OWNER	James William Akin, Trustee of the James William Akir Trust	Los Angeles, CA 90069	
S29-T25S-R37E	L,K,M,N	MINERAL OWNER	Thomas Martin Ellison, Individually and as Trustee under the will of Thomas Williams Ellison	715 Stadium Drive San Antonio, TX 78212	
S29-T25S-R37E	L,K,M,N	MINERAL OWNER	Trinity University	P.O. Box 3499 Tulsa, OK 74101	
S29-T25S-R37E	L,K,M,N	MINERAL OWNER	BOKF, NA, as Agent for Marilyn M. Law and James B. Law Co-Trustees of the Marilyn M. Law Revocable Trust	P.O. Box 18757 Oklahoma City, OK 73154	
S29-T25S-R37E	L,K,M,N	MINERAL OWNER	James Michael Morey, Trustee of the Onez Norman Rooney Testamentary Trust	5400 N. Grand Boulevard, Suite 100 Oklahoma City, OK 73112	
S29-T25S-R37E	L,K,M,N	MINERAL OWNER	K&K Minerals, L.L.C.	P.O. Box 2227 Houston, TX 77252	
S29-T25S-R37E	L,K,M,N	MINERAL OWNER	Lyeth Oil Trust, c/o Kanaly Trust, LTA	PO Box 206 Volcano, CA 95689	
S29-T25S-R37E	L,K,M,N	MINERAL OWNER	Thomas Martin Ellison	P.O. Box 1359 Tijeras, NM 87059	
S29-T25S-R37E	L,K,M,N	MINERAL OWNER	Kenneth N. Headley, Trustee	95 Skidway Island Park Road #311 Savannah, GA 31411	
S29-T25S-R37E	L,K,M,N	MINERAL OWNER	Bernice S. Luskey, Trustee of the Luskey Living Trust M2	2929 N. Central Expressway Richardson, Texas 75080	
S29-T25S-R37E	L,K,M,N	MINERAL OWNER	James L. Falgout, Trustee of the Michael Herd Moore Irrevocable Trust	6140 East Voltaire Avenue Scottsdale, AZ 85254	
S29-T25S-R37E	L,K,M,N	MINERAL OWNER	Brent W. McWhorter or Ruth A. McWhorter, Trustees of the McWhorter Living Trust	5111 North Travis Street, Apt. 613 Sherman, TX 75092	
S29-T25S-R37E	L,K,M,N	MINERAL OWNER	Davis A. Coppedge, Trustee of the Davis A. Coppedge Revocable Trust	933 Dunleer Drive Allen, TX 75103	
S29-T25S-R37E	L,K,M,N	MINERAL OWNER	Robert R. Winningham	P.O. Box 1087 Ashland, OR 97504	
S29-T25S-R37E	L,K,M,N	MINERAL OWNER	Dan Mordhurst, Trustee of the Dan Mordhorst Revocable Trust	P.O. Box 32857 Austin, TX 78703	
S29-T25S-R37E	L,K,M,N	MINERAL OWNER	Baxto, LLC	815-A Brazos Street #491 Austin, TX 78701	
S29-T25S-R37E	L,K,M,N	MINERAL OWNER	Blairbax Energy, LLC	P.O. Box 1649 Austin, TX 78767	
S29-T25S-R37E	L,K,M,N	MINERAL OWNER	Buffy Energy, LLC		
S29-T25S-R37E	L,K,M,N	MINERAL OWNER	Berdell Lois Molett, deceased C/O Frank Molett	4473 Sacajewa Riverton, Utah 84096	

S29-T25S-R37E	L,K,M,N	MINERAL OWNER	Ann D. Allison	6703 82nd Street, Apt. 632 Lubbock, TX 79424	
S29-T25S-R37E	I,J	MINERAL OWNER	Pegro & Co., LP	45 East 89th Street, #35E New York, NY 10128	
S29-T25S-R37E	I,J	MINERAL OWNER	Thomas T. Holley, Jr.	P.O. Box 3602 Wichita Falls, TX 76301	
S29-T25S-R37E	I,J	MINERAL OWNER	Yakka II, LLC	P.O. Box 2078 Abilene, TX 79604	
S29-T25S-R37E	I,J	MINERAL OWNER	Josh Ensor	1018 N. 5th Street Abilene, TX 79601	
S29-T25S-R37E	I,J	MINERAL OWNER	Donald Gutman	8784 Petite Creek Drive Roseville, CA 95661	
S29-T25S-R37E	I,J	MINERAL OWNER	Ari B. Socolow and Joshua A. Socolow, Co- Trustees of the ARJO Trust	150 W. 79th Street New York, NY 10024	
S29-T25S-R37E	G	MINERAL OWNER	Diamond Lil Properties, LLC	P.O. Box 1818 Roswell, NM 88202	
S29-T25S-R37E	G	MINERAL OWNER	Spirit Trail, LLC	P.O. Box 1818 Roswell, NM 88202	
S29-T25S-R37E	G	MINERAL OWNER	Catherine Coll, Trustee	83 La Barbaria Trail Santa Fe, NM 87505	
S29-T25S-R37E	G	MINERAL OWNER	Max W. Coll, III	7625-2 El Centro Boulevard Las Cruces, NM 88012	
S29-T25S-R37E	G	MINERAL OWNER	Eric J. Coll	P.O. Box 1818 Roswell, NM 88202	
S29-T25S-R37E	G	MINERAL OWNER	Clarke C. Coll	P.O. Box 1818 Roswell, NM 88202	
S29-T25S-R37E	G	MINERAL OWNER	Jon F. Coll, II	7335 Walla Walla San Antonio, TX 78250	
S29-T25S-R37E	G	MINERAL OWNER	Melanie Coll DeTempe	5653 Tobias Avenue Van Nuys, CA 91411	
S29-T25S-R37E	H	MINERAL OWNER	The Wallace Family Limited Partnership	P.O. Box 2918 Midland, TX 79702	
S29-T25S-R37E	H	MINERAL OWNER	Dan W. Irwin	118 N. Grant Street Hinsdale, IL 60521	
S29-T25S-R37E	H	MINERAL OWNER	Kathleen Irwin Schuster, Trustee	3213 Pepperwood Lane Fort Collins, CO 80525	
S29-T25S-R37E	E,F	MINERAL OWNER	Ingrid Powell, Trustee of the C&I Revocable Living Trust	114 Las Brisas Drive Monterey, CA 93940	
S29-T25S-R37E	E,F	MINERAL OWNER	Edward T. Dreesen, Jr. and Kathleen Dreesen Revocable Living Trust	P.O. Box 830 Palo Cedro, CA 96073	
S29-T25S-R37E	E,F	MINERAL OWNER	Cecile Marie Dreesen	P.O. Box 1370 Poulsbo, WA 98370	
S29-T25S-R37E	E,F	MINERAL OWNER	Susan Duff	50 Sequoyah Shawnee, OK 74801	
S29-T25S-R37E	E,F	MINERAL OWNER	John V. McCarthy, II	P.O. Box 3688 Bernice, OK 74331	
S29-T25S-R37E	E,F	MINERAL OWNER	Progeny Petroleum LLC	P.O. Box 30864 Santa Barbara, CA 93130	
S29-T25S-R37E	E,F	MINERAL OWNER	Duard B. Thomas, as Personal Representative of The Estate of Warren J.	P.O. Box 1357 Ada, OK 74820	
S29-T25S-R37E	E,F	MINERAL OWNER	James R. Bates	P.O. Box 6216 Shawnee Mission, KS 66206	
S29-T25S-R37E	E,F	MINERAL OWNER	Texas State Bank, San Angelo, Successor Trustee of the Lucille Chism Bates Testamentary Trust	P.O. Box 3782 San Angelo, TX 76902	
S29-T25S-R37E	E,F	MINERAL OWNER	Bates Family Investment Company, LLC c/o The Trust Company of Oklahoma	P.O. Box 3627 Tulsa, OK 74101	
S29-T25S-R37E	E,F	MINERAL OWNER	Blaze Interests, LLC	218 N. Main Street, Suite C Midland, TX 79701	

All notices were sent out by 10/5/2018. Once all notices have been delivered, we will provide confirmation of delivery.

WATER WELL SUMMARIES

New Mexico Office of the State Engineer **Water Right Summary**



WR File Number: CP 01308

Subbasin: CP

Cross Reference: -

Primary Purpose: COM COMMERCIAL

Primary Status: PMT PERMIT

Total Acres: 0

Subfile: -

Total Diversion: 150

Cause/Case: -

Owner: FULFER OIL & CATTLE COMPANY

Contact: GREGG FULFER

Owner: ATKINS ENGINEERING ASSOC, INC.

Contact: RICHARD CIBAK

Documents on File

			Status			From/			
Trn #	Doc	File/Act	1	2	Transaction Desc.	To	Acres	Diversion	Consumptive
 get images	604532	APPRO 2016-01-21	PMT	LOG	CP 01308	T	0	150	100

Current Points of Diversion

(NAD83 UTM in meters)									
Q Q Q									
POD Number	Source	6416	4	Sec	Tws	Rng	X	Y	Other Location Desc
CP 01308 POD1	Artesian	3	4	4	30	25S 37E	670086	3552295	

Priority Summary

Priority	Status	Acres	Diversion	Pod Number	Source
03/27/2014	PMT	0	150	CP 01308 POD1	Artesian

Place of Use

[illegible]

Source

Acres	Diversion	CU	Use	Priority	Source	Description
0	150	100	COM	03/27/2014	GW	



New Mexico Office of the State Engineer

Water Right Summary



WR File Number: CP 00387 Subbasin: CP Cross Reference: -
Primary Purpose: DOM 72-12-1 DOMESTIC ONE HOUSEHOLD
Primary Status: PMT PERMIT
Total Acres: Subfile: -
Total Diversion: 3 Cause/Case: -
Owner: PAUL S BALLINGER

Documents on File

	Trn #	Doc	File/Act	Status		Transaction Desc.	From/ To	Acres	Diversion	Consumptive
				1	2					
get images	473059	72121	1968-02-08	PMT	LOG	CP 00387	T		3	
get images	473057	72121	1967-03-31	PMT	LOG	CP 00387	T		3	
get images	473042	72121	1966-09-30	PMT	LOG	CP 00387	T		3	

Current Points of Diversion

(NAD83 UTM in meters)

POD Number	Source	Q	Q	Q	Sec	Tws	Rng	X	Y	Other Location Desc
CP 00387	Shallow	3	2	29	25S	37E		671472	3553308*	

An () after northing value indicates UTM location was derived from PLSS - see Help



New Mexico Office of the State Engineer

Water Right Summary



WR File Number: CP 00434 Subbasin: CP Cross Reference: -
Primary Purpose: DOM 72-12-1 DOMESTIC ONE HOUSEHOLD
Primary Status: PMT PERMIT
Total Acres: Subfile: -
Total Diversion: 3 Cause/Case: -
Owner: S.C. ELY

Documents on File

Trn #	Doc	File/Act	Status		Transaction Desc.	From/ To	Acres	Diversion	Consumptive
			1	2					
473331	72121	1967-07-06	PMT	APR	CP 00434	T		3	

Current Points of Diversion

(NAD83 UTM in meters)

POD Number	Source	Q	Q	Q	Sec	Tws	Rng	X	Y	Other Location Desc
<u>CP 00434</u>		2	29	25S	37E			671673	3553509*	

An () after northing value indicates UTM location was derived from PLSS - see Help



New Mexico Office of the State Engineer

Water Right Summary



WR File Number: CP 00487 Subbasin: CP Cross Reference: -
Primary Purpose: DOM 72-12-1 DOMESTIC ONE HOUSEHOLD
Primary Status: PMT PERMIT
Total Acres: Subfile: -
Total Diversion: 3 Cause/Case: -
Owner: L.L. REED

Documents on File

Trn #	Doc	File/Act	Status		Transaction Desc.	From/ To	Acres	Diversion	Consumptive
			1	2					
473497	72121	1972-11-16	PMT	LOG	CP 00487	T		3	

Current Points of Diversion

(NAD83 UTM in meters)

POD Number	Source	Q	Q	Q	Sec	Tws	Rng	X	Y	Other Location Desc
CP 00487	Shallow	2	1	29	25S	37E		671063	3553703*	

An () after northing value indicates UTM location was derived from PLSS - see Help



New Mexico Office of the State Engineer

Water Right Summary



WR File Number: CP 00506 **Subbasin:** CP **Cross Reference:-**
Primary Purpose: DOM 72-12-1 DOMESTIC ONE HOUSEHOLD
Primary Status: PMT PERMIT
Total Acres: **Subfile:** -
Total Diversion: 3 **Cause/Case:** -
Owner: CHARLES D. TAFF

Documents on File

Trn #	Doc	File/Act	Status		Transaction Desc.	From/ To	Acres	Diversion	Consumptive
			1	2					
473694	72121	1972-06-30	PMT	LOG	CP 00506	T		3	

Current Points of Diversion

(NAD83 UTM in meters)

POD Number	Source	Q	Q	Q	Sec	Tws	Rng	X	Y	Other Location Desc
<u>CP 00506</u>	Shallow	2	29	25S	37E			671673	3553509*	THORNTON ADDITION, JAL, NM

An () after northing value indicates UTM location was derived from PLSS - see Help



New Mexico Office of the State Engineer

Water Right Summary



WR File Number: CP 00509 Subbasin: CP Cross Reference: -
Primary Purpose: DOM 72-12-1 DOMESTIC ONE HOUSEHOLD
Primary Status: PMT PERMIT
Total Acres: Subfile: -
Total Diversion: 3 Cause/Case: -
Owner: CHARLES DORMINEY

Documents on File

Trn #	Doc	File/Act	Status		Transaction Desc.	From/		Acres	Diversion	Consumptive
			1	2		To				
473767	72121	1972-08-24	PMT	LOG	CP 00509	T			3	

Current Points of Diversion

(NAD83 UTM in meters)

POD Number	Source	Q	Q	Q	Sec	Tws	Rng	X	Y	Other Location Desc
CP 00509	Shallow	4	1	2	29	25S	37E	671564	3553609*	

An () after northing value indicates UTM location was derived from PLSS - see Help



New Mexico Office of the State Engineer

Water Right Summary



WR File Number: CP 00557 Subbasin: CP Cross Reference: -
Primary Purpose: DOM 72-12-1 DOMESTIC ONE HOUSEHOLD
Primary Status: PMT PERMIT
Total Acres: Subfile: -
Total Diversion: 3 Cause/Case: -
Owner: LUCILLE BOCK WEBB

Documents on File

Trn #	Doc	File/Act	Status		Transaction Desc.	From/		Acres	Diversion	Consumptive
			1	2		To				
474142	72121	1976-04-29	PMT	LOG	CP 00557	T			3	

Current Points of Diversion

(NAD83 UTM in meters)

POD Number	Source	Q	Q	Q	Sec	Tws	Rng	X	Y	Other Location Desc
CP 00557	Shallow	3	3	3	20	25S	37E	670553	3553997*	ADD/LOC:417 S. 2ND ST. JAL, NM

An () after northing value indicates UTM location was derived from PLSS - see Help



New Mexico Office of the State Engineer

Water Right Summary



WR File Number: CP 00638 Subbasin: CP Cross Reference: -
Primary Purpose: DOM 72-12-1 DOMESTIC ONE HOUSEHOLD
Primary Status: PMT PERMIT
Total Acres: Subfile: -
Total Diversion: 3 Cause/Case: -
Owner: DONALD R. TRICE

Documents on File

Trn #	Doc	File/Act	Status		Transaction Desc.	From/		Acres	Diversion	Consumptive
			1	2		To				
get images	475327	72121	1981-06-24	PMT LOG	CP 00638	T			3	

Current Points of Diversion

(NAD83 UTM in meters)

POD Number	Source	Q	Q	Q	Sec	Tws	Rng	X	Y	Other Location Desc
<u>CP 00638</u>	Shallow	1	1	29	25S	37E	670661	3553696*		LOTS: 13,14,15,16,17

An () after northing value indicates UTM location was derived from PLSS - see Help



New Mexico Office of the State Engineer

Water Right Summary



WR File Number: CP 00774 Subbasin: CP Cross Reference: -
Primary Purpose: DOM 72-12-1 DOMESTIC ONE HOUSEHOLD
Primary Status: PMT PERMIT
Total Acres: Subfile: -
Total Diversion: 3 Cause/Case: -
Owner: ANTONIO HOLGUIN

Documents on File

Trn #	Doc	File/Act	Status		Transaction Desc.	From/ To	Acres	Diversion	Consumptive
			1	2					
476012	72121	1992-08-11	PMT	LOG	CP 00774	T		3	

Current Points of Diversion

(NAD83 UTM in meters)

POD Number	Source	Q	Q	Q	Sec	Tws	Rng	X	Y	Other Location Desc
CP 00774	Shallow	1	29	25S	37E			670869	3553495*	

An () after northing value indicates UTM location was derived from PLSS - see Help



New Mexico Office of the State Engineer

Water Right Summary



WR File Number: CP 01256 **Subbasin:** CP **Cross Reference:** -
Primary Purpose: MUN MUNICIPAL - CITY OR COUNTY SUPPLIED WATER
Primary Status: PMT PERMIT
Total Acres: 0 **Subfile:** -
Total Diversion: 100 **Cause/Case:** -
Agent: ATKINS ENGINEERING ASSOC, INC.
Contact: RICHARD C. CIBAK
Owner: CITY OF JAL
Contact: CURTIS SCHRADER

Documents on File

Trn #	Doc	File/Act	Status		Transaction Desc.	From/ To	Acres	Diversion	Consumptive
			1	2					
603265	APPRO	2014-06-16	PMT	LOG	CP 01256	T	0	100	100

Current Points of Diversion

POD Number	Source	Q Q Q			(NAD83 UTM in meters)		Other Location Desc
		64	16	4	X	Y	
CP 01256 POD1		1	1	3	29 25S 37E	670655 3553059	
CP 01256 POD2		3	2	3	29 25S 37E	670882 3552856	
CP 01256 POD3	Shallow	4	1	3	29 25S 37E	670707 3552893	
CP 01256 POD4	Shallow	3	2	3	29 25S 37E	670994 3552889	

Priority Summary

Priority	Status	Acres	Diversion	Pod Number	Source
10/31/2013	PMT	0	100	CP 01256 POD1	
				CP 01256 POD2	
				CP 01256 POD3	Shallow
				CP 01256 POD4	Shallow

Place of Use

Q Q Q Q				Sec	Tws	Rng	Acres	Diversion	CU	Use	Priority	Status	Other Location Desc
256	64	16	4										
3	29	25S	37E				0	100	100	MUN	10/31/2013	PMT	JAL LAKE AND ITS PARK AREA

Source

Acres	Diversion	CU	Use	Priority	Source Description
0	100	100	MUN	10/31/2013	GW



New Mexico Office of the State Engineer

Water Right Summary



WR File Number: CP 01306 **Subbasin:** CP **Cross Reference:** -
Primary Purpose: COM COMMERCIAL
Primary Status: PMT PERMIT
Total Acres: 0 **Subfile:** -
Total Diversion: 100 **Cause/Case:** -
Owner: FULFER OIL & CATTLE COMPANY
Contact: GREGG FULFER
Owner: ATKINS ENGINEERING ASSOC, INC.
Contact: RICHARD CIBAK

Documents on File

Trn #	Doc	File/Act	Status		Transaction Desc.	From/	Acres	Diversion	Consumptive
			1	2		To			
604502	APPRO	2016-01-21	PMT	LOG	CP 01306	T	0	100	100

Current Points of Diversion

POD Number	Q Q Q Q				(NAD83 UTM in meters)		Other Location Desc
	Source	64	16	4	Sec	Tws Rng	
CP 01306 POD1	Artesian	1	3	3	29	25S 37E	670622 3552502

Priority Summary

Priority	Status	Acres	Diversion	Pod Number	Source
03/27/2014	PMT	0	100	CP 01306 POD1	Artesian

Place of Use

Q Q Q Q				Acres	Diversion	CU	Use	Priority	Status	Other Location Desc
256	64	16	4							
				0	100	100	COM	03/27/2014	PMT	NO PLACE OF USE GIVEN

Source

Acres	Diversion	CU	Use	Priority	Source Description
0	100	100	COM	03/27/2014	GW



New Mexico Office of the State Engineer

Water Right Summary



WR File Number: CP 01512 **Subbasin:** CP **Cross Reference:** -
Primary Purpose: MUN MUNICIPAL - CITY OR COUNTY SUPPLIED WATER
Primary Status: PMT PERMIT
Total Acres: 0 **Subfile:** -
Total Diversion: 39.5 **Cause/Case:** -
Agent: SOUDER, MILLER AND ASSOCIATES
Contact: SCOTT A. MCKITRICK
Owner: CITY OF JAL
Contact: BOB GALLAGHER

Documents on File

Trn #	Doc	File/Act	Status			Transaction Desc.	From/ To	Acres	Diversion	Consumptive
			1	2						
613961	APPRO	2017-08-11	PMT	PAR		CP 01512	T	0	39.5	39.5

Current Points of Diversion

(NAD83 UTM in meters)										
POD Number	Source	Q	Q	Q	Sec	Tws	Rng	X	Y	Other Location Desc
CP 01512 POD1		64	16	4	32	25S	37E	671875	3551940	LISTED AS POD5 ON APPLICATION

Priority Summary

Priority	Status	Acres	Diversion	Pod Number	Source
05/14/2015	PMT	0	39.5	CP 01512 POD1	

Place of Use

Q Q Q Q				Sec	Tws	Rng	Acres	Diversion	CU	Use	Priority	Status	Other Location Desc
256	64	16	4										
01	25S	36E					0	39.5	39.5	MUN	05/14/2015	PMT	CITY OF JAL MUNICIPAL WATER SYSTEM

Source

Acres	Diversion	CU	Use	Priority	Source Description
0	39.5	39.5	MUN	05/14/2015	GW

October 03, 2018

RAMONA HOVEY

Lonquist Field Services, LLC

3345 Bee Cave Road, Suite 201

Austin, TX 78746

RE: SHOLES DEEP SWD NO 2

Enclosed are the results of analyses for samples received by the laboratory on 09/26/18 15:50.

Cardinal Laboratories is accredited through Texas NELAP under certificate number T104704398-18-11. Accreditation applies to drinking water, non-potable water and solid and chemical materials. All accredited analytes are denoted by an asterisk (*). For a complete list of accredited analytes and matrices visit the TCEQ website at www.tceq.texas.gov/field/qa/lab_accred_certif.html.

Cardinal Laboratories is accredited through the State of Colorado Department of Public Health and Environment for:

Method EPA 552.2	Total Haloacetic Acids (HAA-5)
Method EPA 524.2	Total Trihalomethanes (TTHM)
Method EPA 524.4	Regulated VOCs (V1, V2, V3)

Cardinal Laboratories is accredited through the State of New Mexico Environment Department for:

Method SM 9223-B	Total Coliform and E. coli (Colilert MMO-MUG)
Method EPA 524.2	Regulated VOCs and Total Trihalomethanes (TTHM)
Method EPA 552.2	Total Haloacetic Acids (HAA-5)

Accreditation applies to public drinking water matrices for State of Colorado and New Mexico.

This report meets NELAP requirements and is made up of a cover page, analytical results, and a copy of the original chain-of-custody. If you have any questions concerning this report, please feel free to contact me.

Sincerely,

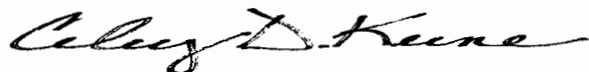

Celey D. Keene

Lab Director/Quality Manager

Analytical Results For:

Lonquist Field Services, LLC
3345 Bee Cave Road, Suite 201
Austin TX, 78746

Project: SHOLES DEEP SWD NO 2
Project Number: NONE GIVEN
Project Manager: RAMONA HOVEY
Fax To: (512) 732-9816

Reported:
03-Oct-18 16:50

Sample ID	Laboratory ID	Matrix	Date Sampled	Date Received
CP - 00487	H802725-01	Water	26-Sep-18 12:12	26-Sep-18 15:50
CP - 00509	H802725-02	Water	26-Sep-18 12:44	26-Sep-18 15:50

Cardinal Laboratories

*=Accredited Analyte

PLEASE NOTE: Liability and Damages. Cardinal's liability and client's exclusive remedy for any claim arising, whether based in contract or tort, shall be limited to the amount paid by client for analyses. All claims, including those for negligence or any other cause whatsoever shall be deemed waived unless made in writing and received by Cardinal within thirty (30) days after completion of the applicable service. In no event shall Cardinal be liable for incidental or consequential damage including, without limitation, business interruptions, loss of use, or loss of profits incurred by client, its subsidiaries, affiliates or successors arising out of or related to the performance of the services hereunder by Cardinal, regardless of whether such claim is based upon any of the above stated reasons or otherwise. Results relate only to the samples identified above. This report shall not be reproduced except in full with written approval of Cardinal Laboratories.



Celey D. Keene, Lab Director/Quality Manager

Analytical Results For:

 Lonquist Field Services, LLC
 3345 Bee Cave Road, Suite 201
 Austin TX, 78746

 Project: SHOLES DEEP SWD NO 2
 Project Number: NONE GIVEN
 Project Manager: RAMONA HOVEY
 Fax To: (512) 732-9816

 Reported:
 03-Oct-18 16:50

CP - 00487
H802725-01 (Water)

Analyte	Result	MDL	Reporting Limit	Units	Dilution	Batch	Analyst	Analyzed	Method	Notes
---------	--------	-----	-----------------	-------	----------	-------	---------	----------	--------	-------

Cardinal Laboratories
Inorganic Compounds

Alkalinity, Bicarbonate	342		5.00	mg/L	1	8091811	AC	27-Sep-18	310.1	
Alkalinity, Carbonate	<1.00		1.00	mg/L	1	8091811	AC	27-Sep-18	310.1	
Chloride*	60.0		4.00	mg/L	1	8092408	AC	27-Sep-18	4500-Cl-B	
Conductivity*	1250		1.00	uS/cm	1	8092703	AC	27-Sep-18	120.1	
pH*	7.88		0.100	pH Units	1	8092703	AC	27-Sep-18	150.1	
Resistivity	7.99			Ohms/m	1	8092703	AC	27-Sep-18	120.1	
Specific Gravity @ 60° F	1.001		0.000	[blank]	1	8092708	AC	27-Sep-18	SM 2710F	
Sulfate*	265		50.0	mg/L	5	8092705	AC	27-Sep-18	375.4	
TDS*	768		5.00	mg/L	1	8092401	AC	29-Sep-18	160.1	
Alkalinity, Total*	280		4.00	mg/L	1	8091811	AC	27-Sep-18	310.1	
Sulfide, total	<0.0100		0.0100	mg/L	1	8092709	AC	27-Sep-18	376.2	

Green Analytical Laboratories
Total Recoverable Metals by ICP (E200.7)

Barium*	<0.050		0.050	mg/L	1	B810005	AES	02-Oct-18	EPA200.7	
Calcium*	40.7		0.100	mg/L	1	B810005	AES	02-Oct-18	EPA200.7	
Iron*	0.148		0.050	mg/L	1	B810005	AES	02-Oct-18	EPA200.7	
Magnesium*	38.6		0.100	mg/L	1	B810005	AES	02-Oct-18	EPA200.7	
Potassium*	6.49		1.00	mg/L	1	B810005	AES	02-Oct-18	EPA200.7	
Sodium*	184		1.00	mg/L	1	B810005	AES	02-Oct-18	EPA200.7	

Cardinal Laboratories

*=Accredited Analyte

PLEASE NOTE: Liability and Damages. Cardinal's liability and client's exclusive remedy for any claim arising, whether based in contract or tort, shall be limited to the amount paid by client for analyses. All claims, including those for negligence or any other cause whatsoever shall be deemed waived unless made in writing and received by Cardinal within thirty (30) days after completion of the applicable service. In no event shall Cardinal be liable for incidental or consequential damage including, without limitation, business interruptions, loss of use, or loss of profits incurred by client, its subsidiaries, affiliates or successors arising out of or related to the performance of the services hereunder by Cardinal, regardless of whether such claim is based upon any of the above stated reasons or otherwise. Results relate only to the samples identified above. This report shall not be reproduced except in full with written approval of Cardinal Laboratories.



Celey D. Keene, Lab Director/Quality Manager

Analytical Results For:

 Lonquist Field Services, LLC
 3345 Bee Cave Road, Suite 201
 Austin TX, 78746

 Project: SHOLES DEEP SWD NO 2
 Project Number: NONE GIVEN
 Project Manager: RAMONA HOVEY
 Fax To: (512) 732-9816

 Reported:
 03-Oct-18 16:50

CP - 00509
H802725-02 (Water)

Analyte	Result	MDL	Reporting Limit	Units	Dilution	Batch	Analyst	Analyzed	Method	Notes
---------	--------	-----	-----------------	-------	----------	-------	---------	----------	--------	-------

Cardinal Laboratories
Inorganic Compounds

Alkalinity, Bicarbonate	312		5.00	mg/L	1	8091811	AC	27-Sep-18	310.1	
Alkalinity, Carbonate	<1.00		1.00	mg/L	1	8091811	AC	27-Sep-18	310.1	
Chloride*	176		4.00	mg/L	1	8092408	AC	27-Sep-18	4500-Cl-B	
Conductivity*	1980		1.00	uS/cm	1	8092703	AC	27-Sep-18	120.1	
pH*	7.17		0.100	pH Units	1	8092703	AC	27-Sep-18	150.1	
Resistivity	5.05			Ohms/m	1	8092703	AC	27-Sep-18	120.1	
Specific Gravity @ 60° F	0.9992		0.000	[blank]	1	8092708	AC	27-Sep-18	SM 2710F	
Sulfate*	692		125	mg/L	12.5	8092705	AC	27-Sep-18	375.4	
TDS*	1410		5.00	mg/L	1	8092401	AC	29-Sep-18	160.1	
Alkalinity, Total*	256		4.00	mg/L	1	8091811	AC	27-Sep-18	310.1	
Sulfide, total	<0.0100		0.0100	mg/L	1	8092709	AC	27-Sep-18	376.2	

Green Analytical Laboratories
Total Recoverable Metals by ICP (E200.7)

Barium*	<0.050		0.050	mg/L	1	B810005	AES	02-Oct-18	EPA200.7	
Calcium*	182		0.100	mg/L	1	B810005	AES	02-Oct-18	EPA200.7	
Iron*	0.108		0.050	mg/L	1	B810005	AES	02-Oct-18	EPA200.7	
Magnesium*	54.6		0.100	mg/L	1	B810005	AES	02-Oct-18	EPA200.7	
Potassium*	5.27		1.00	mg/L	1	B810005	AES	02-Oct-18	EPA200.7	
Sodium*	188		1.00	mg/L	1	B810005	AES	02-Oct-18	EPA200.7	

Cardinal Laboratories

*=Accredited Analyte

PLEASE NOTE: Liability and Damages. Cardinal's liability and client's exclusive remedy for any claim arising, whether based in contract or tort, shall be limited to the amount paid by client for analyses. All claims, including those for negligence or any other cause whatsoever shall be deemed waived unless made in writing and received by Cardinal within thirty (30) days after completion of the applicable service. In no event shall Cardinal be liable for incidental or consequential damage including, without limitation, business interruptions, loss of use, or loss of profits incurred by client, its subsidiaries, affiliates or successors arising out of or related to the performance of the services hereunder by Cardinal, regardless of whether such claim is based upon any of the above stated reasons or otherwise. Results relate only to the samples identified above. This report shall not be reproduced except in full with written approval of Cardinal Laboratories.



Celey D. Keene, Lab Director/Quality Manager

Analytical Results For:

Lonquist Field Services, LLC
3345 Bee Cave Road, Suite 201
Austin TX, 78746

Project: SHOLES DEEP SWD NO 2
Project Number: NONE GIVEN
Project Manager: RAMONA HOVEY
Fax To: (512) 732-9816

Reported:
03-Oct-18 16:50

Inorganic Compounds - Quality Control

Cardinal Laboratories

Analyte	Result	Reporting Limit	Units	Spike Level	Source Result	%REC	%REC Limits	RPD	RPD Limit	Notes
---------	--------	-----------------	-------	-------------	---------------	------	-------------	-----	-----------	-------

Batch 8091811 - General Prep - Wet Chem

Blank (8091811-BLK1)

Prepared: 18-Sep-18 Analyzed: 20-Sep-18

Alkalinity, Carbonate	ND	1.00	mg/L							
Alkalinity, Bicarbonate	5.00	5.00	mg/L							
Alkalinity, Total	4.00	4.00	mg/L							

LCS (8091811-BS1)

Prepared: 18-Sep-18 Analyzed: 20-Sep-18

Alkalinity, Carbonate	ND	2.50	mg/L				80-120			
Alkalinity, Bicarbonate	305	12.5	mg/L				80-120			
Alkalinity, Total	250	10.0	mg/L	250		100	80-120			

LCS Dup (8091811-BSD1)

Prepared: 18-Sep-18 Analyzed: 20-Sep-18

Alkalinity, Carbonate	ND	2.50	mg/L				80-120		20	
Alkalinity, Bicarbonate	305	12.5	mg/L				80-120	0.00	20	
Alkalinity, Total	250	10.0	mg/L	250		100	80-120	0.00	20	

Batch 8092401 - Filtration

Blank (8092401-BLK1)

Prepared: 24-Sep-18 Analyzed: 26-Sep-18

TDS	ND	5.00	mg/L							
-----	----	------	------	--	--	--	--	--	--	--

LCS (8092401-BS1)

Prepared: 24-Sep-18 Analyzed: 26-Sep-18

TDS	504		mg/L	527		95.6	80-120			
-----	-----	--	------	-----	--	------	--------	--	--	--

Duplicate (8092401-DUP1)

Source: H802685-01

Prepared: 24-Sep-18 Analyzed: 25-Sep-18

TDS	1060	5.00	mg/L		1030			2.88	20	
-----	------	------	------	--	------	--	--	------	----	--

Batch 8092408 - General Prep - Wet Chem

Blank (8092408-BLK1)

Prepared & Analyzed: 24-Sep-18

Chloride	ND	4.00	mg/L							
----------	----	------	------	--	--	--	--	--	--	--

Cardinal Laboratories

*=Accredited Analyte

PLEASE NOTE: Liability and Damages. Cardinal's liability and client's exclusive remedy for any claim arising, whether based in contract or tort, shall be limited to the amount paid by client for analyses. All claims, including those for negligence or any other cause whatsoever shall be deemed waived unless made in writing and received by Cardinal within thirty (30) days after completion of the applicable service. In no event shall Cardinal be liable for incidental or consequential damage including, without limitation, business interruptions, loss of use, or loss of profits incurred by client, its subsidiaries, affiliates or successors arising out of or related to the performance of the services hereunder by Cardinal, regardless of whether such claim is based upon any of the above stated reasons or otherwise. Results relate only to the samples identified above. This report shall not be reproduced except in full with written approval of Cardinal Laboratories.

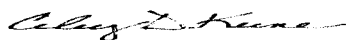

Celey D. Keene, Lab Director/Quality Manager

Analytical Results For:

 Lonquist Field Services, LLC
 3345 Bee Cave Road, Suite 201
 Austin TX, 78746

 Project: SHOLES DEEP SWD NO 2
 Project Number: NONE GIVEN
 Project Manager: RAMONA HOVEY
 Fax To: (512) 732-9816

 Reported:
 03-Oct-18 16:50

Inorganic Compounds - Quality Control
Cardinal Laboratories

Analyte	Result	Reporting Limit	Units	Spike Level	Source Result	%REC	%REC Limits	RPD	RPD Limit	Notes
---------	--------	-----------------	-------	-------------	---------------	------	-------------	-----	-----------	-------

Batch 8092408 - General Prep - Wet Chem
LCS (8092408-BS1)

Prepared & Analyzed: 24-Sep-18

Chloride	92.0	4.00	mg/L	100	92.0	80-120
----------	------	------	------	-----	------	--------

LCS Dup (8092408-BSD1)

Prepared & Analyzed: 24-Sep-18

Chloride	96.0	4.00	mg/L	100	96.0	80-120	4.26	20
----------	------	------	------	-----	------	--------	------	----

Batch 8092703 - General Prep - Wet Chem
LCS (8092703-BS1)

Prepared & Analyzed: 27-Sep-18

Conductivity	501		uS/cm	500	100	80-120
pH	7.11		pH Units	7.00	102	90-110

Duplicate (8092703-DUP1)

Source: H802725-01

Prepared & Analyzed: 27-Sep-18

pH	7.95	0.100	pH Units	7.88		0.884	20
Conductivity	1260	1.00	uS/cm	1250		0.319	20
Resistivity	7.96		Ohms/m	7.99		0.319	20

Batch 8092705 - General Prep - Wet Chem
Blank (8092705-BLK1)

Prepared & Analyzed: 27-Sep-18

Sulfate	ND	10.0	mg/L
---------	----	------	------

LCS (8092705-BS1)

Prepared & Analyzed: 27-Sep-18

Sulfate	17.5	10.0	mg/L	20.0	87.4	80-120
---------	------	------	------	------	------	--------

LCS Dup (8092705-BSD1)

Prepared & Analyzed: 27-Sep-18

Sulfate	17.7	10.0	mg/L	20.0	88.4	80-120	1.14	20
---------	------	------	------	------	------	--------	------	----

Cardinal Laboratories

*=Accredited Analyte

PLEASE NOTE: Liability and Damages. Cardinal's liability and client's exclusive remedy for any claim arising, whether based in contract or tort, shall be limited to the amount paid by client for analyses. All claims, including those for negligence or any other cause whatsoever shall be deemed waived unless made in writing and received by Cardinal within thirty (30) days after completion of the applicable service. In no event shall Cardinal be liable for incidental or consequential damage including, without limitation, business interruptions, loss of use, or loss of profits incurred by client, its subsidiaries, affiliates or successors arising out of or related to the performance of the services hereunder by Cardinal, regardless of whether such claim is based upon any of the above stated reasons or otherwise. Results relate only to the samples identified above. This report shall not be reproduced except in full with written approval of Cardinal Laboratories.



Celey D. Keene, Lab Director/Quality Manager

Analytical Results For:

Lonquist Field Services, LLC
3345 Bee Cave Road, Suite 201
Austin TX, 78746

Project: SHOLES DEEP SWD NO 2
Project Number: NONE GIVEN
Project Manager: RAMONA HOVEY
Fax To: (512) 732-9816

Reported:
03-Oct-18 16:50

Inorganic Compounds - Quality Control**Cardinal Laboratories**

Analyte	Result	Reporting Limit	Units	Spike Level	Source Result	%REC	%REC Limits	RPD	RPD Limit	Notes
---------	--------	--------------------	-------	----------------	------------------	------	----------------	-----	--------------	-------

Batch 8092708 - General Prep - Wet Chem

Duplicate (8092708-DUP1) **Source: H802725-01** Prepared & Analyzed: 27-Sep-18

Specific Gravity @ 60° F	0.9956	0.000	[blank]		1.001			0.566	20	
--------------------------	--------	-------	---------	--	-------	--	--	-------	----	--

Batch 8092709 - General Prep - Wet Chem

Blank (8092709-BLK1) Prepared & Analyzed: 27-Sep-18

Sulfide, total	ND	0.0100	mg/L							
----------------	----	--------	------	--	--	--	--	--	--	--

Duplicate (8092709-DUP1) **Source: H802725-01** Prepared & Analyzed: 27-Sep-18

Sulfide, total	0.00455	0.0100	mg/L		0.00385			16.7	20	
----------------	---------	--------	------	--	---------	--	--	------	----	--

Cardinal Laboratories

* = Accredited Analyte

PLEASE NOTE: Liability and Damages. Cardinal's liability and client's exclusive remedy for any claim arising, whether based in contract or tort, shall be limited to the amount paid by client for analyses. All claims, including those for negligence or any other cause whatsoever shall be deemed waived unless made in writing and received by Cardinal within thirty (30) days after completion of the applicable service. In no event shall Cardinal be liable for incidental or consequential damage including, without limitation, business interruptions, loss of use, or loss of profits incurred by client, its subsidiaries, affiliates or successors arising out of or related to the performance of the services hereunder by Cardinal, regardless of whether such claim is based upon any of the above stated reasons or otherwise. Results relate only to the samples identified above. This report shall not be reproduced except in full with written approval of Cardinal Laboratories.



Celey D. Keene, Lab Director/Quality Manager

Analytical Results For:

 Lonquist Field Services, LLC
 3345 Bee Cave Road, Suite 201
 Austin TX, 78746

 Project: SHOLES DEEP SWD NO 2
 Project Number: NONE GIVEN
 Project Manager: RAMONA HOVEY
 Fax To: (512) 732-9816

 Reported:
 03-Oct-18 16:50

Total Recoverable Metals by ICP (E200.7) - Quality Control
Green Analytical Laboratories

Analyte	Result	Reporting Limit	Units	Spike Level	Source Result	%REC Limits	RPD	RPD Limit	Notes
---------	--------	--------------------	-------	----------------	------------------	----------------	-----	--------------	-------

Batch B810005 - Total Rec. 200.7/200.8/200.2
Blank (B810005-BLK1)

Prepared: 01-Oct-18 Analyzed: 02-Oct-18

Magnesium	ND	0.100	mg/L						
Calcium	ND	0.100	mg/L						
Potassium	ND	1.00	mg/L						
Iron	ND	0.050	mg/L						
Barium	ND	0.050	mg/L						
Sodium	ND	1.00	mg/L						

LCS (B810005-BS1)

Prepared: 01-Oct-18 Analyzed: 02-Oct-18

Sodium	3.33	1.00	mg/L	3.24		103	85-115		
Potassium	8.51	1.00	mg/L	8.00		106	85-115		
Barium	1.99	0.050	mg/L	2.00		99.5	85-115		
Calcium	4.29	0.100	mg/L	4.00		107	85-115		
Iron	4.14	0.050	mg/L	4.00		104	85-115		
Magnesium	21.2	0.100	mg/L	20.0		106	85-115		

LCS Dup (B810005-BSD1)

Prepared: 01-Oct-18 Analyzed: 02-Oct-18

Sodium	3.29	1.00	mg/L	3.24		101	85-115	1.29	20
Potassium	8.24	1.00	mg/L	8.00		103	85-115	3.14	20
Calcium	4.24	0.100	mg/L	4.00		106	85-115	1.18	20
Iron	4.11	0.050	mg/L	4.00		103	85-115	0.733	20
Magnesium	21.3	0.100	mg/L	20.0		107	85-115	0.628	20
Barium	1.99	0.050	mg/L	2.00		99.4	85-115	0.151	20

Cardinal Laboratories

*=Accredited Analyte

PLEASE NOTE: Liability and Damages. Cardinal's liability and client's exclusive remedy for any claim arising, whether based in contract or tort, shall be limited to the amount paid by client for analyses. All claims, including those for negligence or any other cause whatsoever shall be deemed waived unless made in writing and received by Cardinal within thirty (30) days after completion of the applicable service. In no event shall Cardinal be liable for incidental or consequential damage including, without limitation, business interruptions, loss of use, or loss of profits incurred by client, its subsidiaries, affiliates or successors arising out of or related to the performance of the services hereunder by Cardinal, regardless of whether such claim is based upon any of the above stated reasons or otherwise. Results relate only to the samples identified above. This report shall not be reproduced except in full with written approval of Cardinal Laboratories.



Celey D. Keene, Lab Director/Quality Manager

Notes and Definitions

ND	Analyte NOT DETECTED at or above the reporting limit
RPD	Relative Percent Difference
**	Samples not received at proper temperature of 6°C or below.
***	Insufficient time to reach temperature.
-	Chloride by SM4500Cl-B does not require samples be received at or below 6°C Samples reported on an as received basis (wet) unless otherwise noted on report

Cardinal Laboratories

*=Accredited Analyte

PLEASE NOTE: Liability and Damages. Cardinal's liability and client's exclusive remedy for any claim arising, whether based in contract or tort, shall be limited to the amount paid by client for analyses. All claims, including those for negligence or any other cause whatsoever shall be deemed waived unless made in writing and received by Cardinal within thirty (30) days after completion of the applicable service. In no event shall Cardinal be liable for incidental or consequential damage including, without limitation, business interruptions, loss of use, or loss of profits incurred by client, its subsidiaries, affiliates or successors arising out of or related to the performance of the services hereunder by Cardinal, regardless of whether such claim is based upon any of the above stated reasons or otherwise. Results relate only to the samples identified above. This report shall not be reproduced except in full with written approval of Cardinal Laboratories.

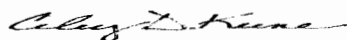

Celey D. Keene, Lab Director/Quality Manager

CHAIN-OF-CUSTODY AND ANALYSIS REQUEST

4 Cardinal secretariat vobis abbas. Place for written changes to (ETE) 202-2225

CARDINAL LABORATORIES

SCALE INDEX WATER ANALYSIS REPORT

Company :	LONQUIST FIELD SERVICES, LLC	Date Sampled : 09/26/18
Lease Name :	SHOLES DEEP SWD NO 2	Company Rep. : RAMONA HOVEY
Well Number :	CP-00487 (H802725-01)	
Location :	32.106714 -103.186983	

ANALYSIS

- | | | |
|---|--------|------------------------------------|
| 1. pH | 7.88 | |
| 2. Specific Gravity @ 60/60 F. | 1.0010 | |
| 3. CaCO ₃ Saturation Index @ 80 F. | -0.304 | |
| @ 140 F. | +0.396 | 'Calcium Carbonate Scale Possible' |

Dissolved Gasses

- | | | |
|---------------------|-------|-----|
| 4. Hydrogen Sulfide | 0.000 | PPM |
| 5. Carbon Dioxide | ND | PPM |
| 6. Dissolved Oxygen | ND | PPM |

Cations

- | | | / | Eq. Wt. | = | MEQ/L |
|---------------------|-------|---|---------|---|-------|
| 7. Calcium (Ca++) | 40.70 | / | 20.1 | = | 2.02 |
| 8. Magnesium (Mg++) | 38.60 | / | 12.2 | = | 3.16 |
| 9. Sodium (Na+) | 184 | / | 23.0 | = | 7.53 |
| 10. Barium (Ba++) | 0.000 | / | 68.7 | = | 0.00 |

Anions

- | | | | | | |
|--------------------------------------|-----|---|------|---|------|
| 11. Hydroxyl (OH-) | 0 | / | 17.0 | = | 0.00 |
| 12. Carbonate (CO ₃ =) | 0 | / | 30.0 | = | 0.00 |
| 13. Bicarbonate (HCO ₃ -) | 342 | / | 61.1 | = | 5.60 |
| 14. Sulfate (SO ₄ =) | 265 | / | 48.8 | = | 5.43 |
| 15. Chloride (Cl-) | 60 | / | 35.5 | = | 1.69 |

Other

- | | | | | | |
|---|-------|------------|------|-------------|------|
| 16. Total Iron (Fe) | 0.148 | / | 18.2 | = | 0.01 |
| 17. Total Dissolved Solids | 768 | | | | |
| 18. Total Hardness As CaCO ₃ | 261.0 | | | | |
| 19. Calcium Sulfate Solubility @ 90 F. | 1,402 | | | | |
| 20. Resistivity (Measured) | 7.990 | Ohm/Meters | @ 77 | Degrees (F) | |

Logarithmic Water Pattern

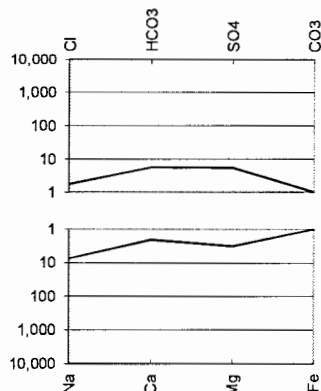

PROBABLE MINERAL COMPOSITION

COMPOUND	Eq. Wt.	X	MEQ/L	=	mg/L
Ca(HCO ₃) ₂	81.04	X	2.02	=	164
CaSO ₄	68.07	X	0.00	=	0
CaCl ₂	55.50	X	0.00	=	0
Mg(HCO ₃) ₂	73.17	X	3.16	=	232
MgSO ₄	60.19	X	2.27	=	136
MgCl ₂	47.62	X	0.00	=	0
NaHCO ₃	84.00	X	0.41	=	34
NaSO ₄	71.03	X	3.16	=	225
NaCl	58.46	X	3.96	=	231

ND = Not Determined

CARDINAL LABORATORIES

SCALE INDEX WATER ANALYSIS REPORT

Company :	LONQUIST FIELD SERVICES, LLC	Date Sampled :	09/26/18
Lease Name :	SHOLES DEEP SWD NO 2	Company Rep. :	RAMONA HOVEY
Well Number :	CP-00509 (H802725-02)		
Location :	32.106714 -103.186983		

ANALYSIS

- | | | |
|---|--------|------------------------------------|
| 1. pH | 7.17 | |
| 2. Specific Gravity @ 60/60 F. | 0.9992 | |
| 3. CaCO ₃ Saturation Index @ 80 F. | +0.307 | 'Calcium Carbonate Scale Possible' |
| @ 140 F. | +1.007 | 'Calcium Carbonate Scale Possible' |

Dissolved Gasses

- | | | |
|---------------------|-------|-----|
| 4. Hydrogen Sulfide | 0.000 | PPM |
| 5. Carbon Dioxide | ND | PPM |
| 6. Dissolved Oxygen | ND | PPM |

Cations

- | | | / | Eq. Wt. | = | MEQ/L |
|---------------------|--------|---|---------|---|-------|
| 7. Calcium (Ca++) | 182.00 | / | 20.1 | = | 9.05 |
| 8. Magnesium (Mg++) | 54.60 | / | 12.2 | = | 4.48 |
| 9. Sodium (Na+) | 188 | / | 23.0 | = | 10.71 |
| 10. Barium (Ba++) | 0.000 | / | 68.7 | = | 0.00 |

Anions

- | | | | | | |
|--------------------------------------|-----|---|------|---|-------|
| 11. Hydroxyl (OH-) | 0 | / | 17.0 | = | 0.00 |
| 12. Carbonate (CO ₃ =) | 0 | / | 30.0 | = | 0.00 |
| 13. Bicarbonate (HCO ₃ -) | 312 | / | 61.1 | = | 5.11 |
| 14. Sulfate (SO ₄ =) | 692 | / | 48.8 | = | 14.18 |
| 15. Chloride (Cl-) | 176 | / | 35.5 | = | 4.96 |

Other

- | | | | | | |
|---|-------|------------|------|-------------|------|
| 16. Total Iron (Fe) | 0.108 | / | 18.2 | = | 0.01 |
| 17. Total Dissolved Solids | 1,410 | | | | |
| 18. Total Hardness As CaCO ₃ | 679.0 | | | | |
| 19. Calcium Sulfate Solubility @ 90 F. | 1,346 | | | | |
| 20. Resistivity (Measured) | 5.050 | Ohm/Meters | @ 77 | Degrees (F) | |

Logarithmic Water Pattern

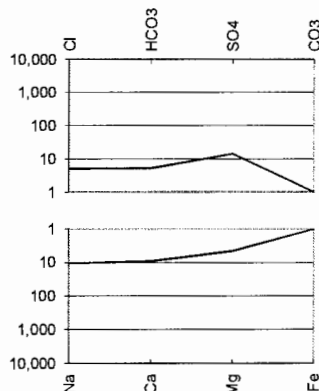

PROBABLE MINERAL COMPOSITION

COMPOUND	Eq. Wt.	X	MEQ/L	=	mg/L
Ca(HCO ₃) ₂	81.04	X	5.11	=	414
CaSO ₄	68.07	X	3.95	=	269
CaCl ₂	55.50	X	0.00	=	0
Mg(HCO ₃) ₂	73.17	X	0.00	=	0
MgSO ₄	60.19	X	4.48	=	269
MgCl ₂	47.62	X	0.00	=	0
NaHCO ₃	84.00	X	0.00	=	0
NaSO ₄	71.03	X	5.76	=	409
NaCl	58.46	X	4.96	=	290

ND = Not Determined

PLUGGED WELL DATA

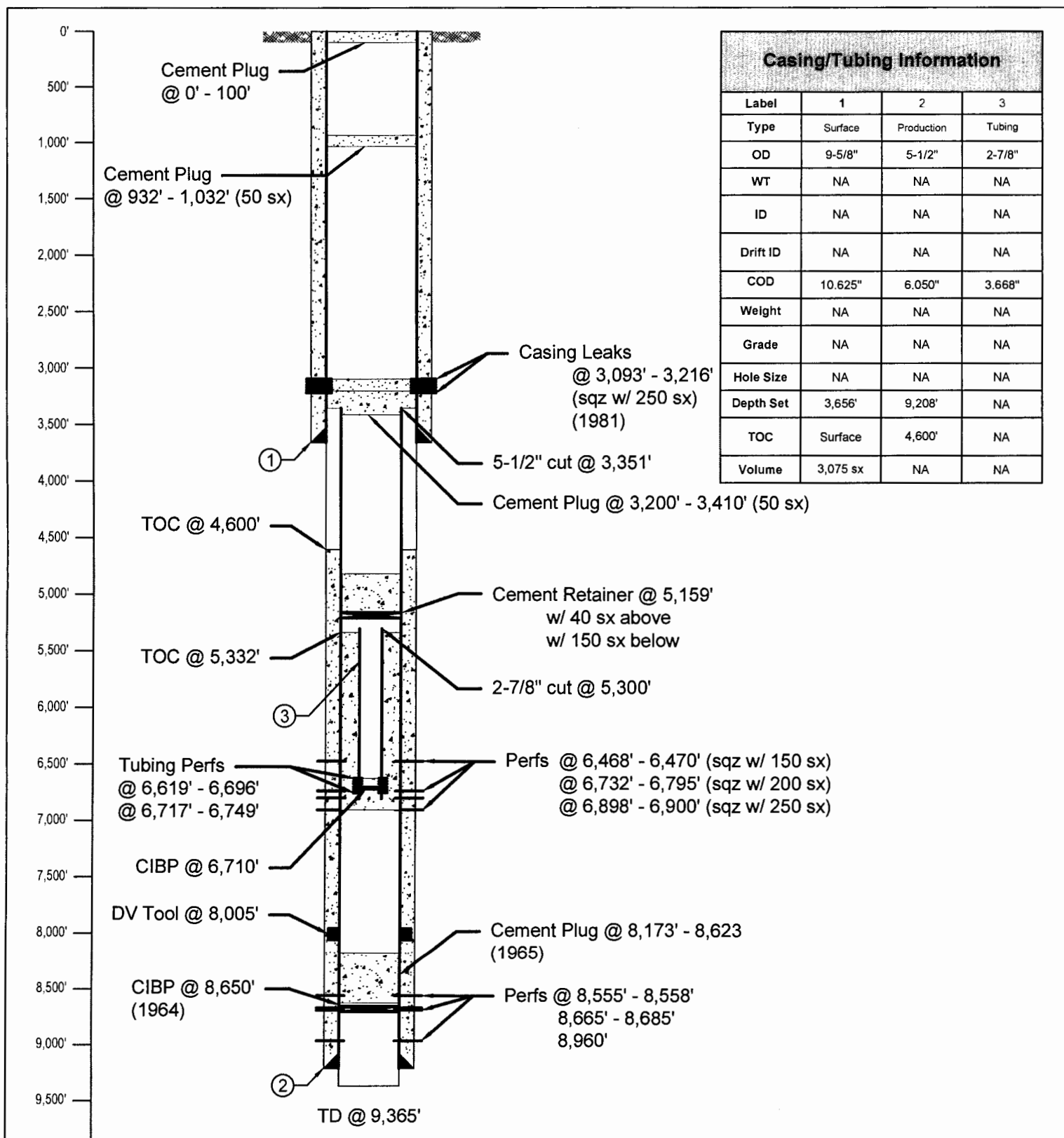

LONQUIST & CO. LLC

**PETROLEUM
ENGINEERS**

**ENERGY
ADVISORS**

HOUSTON CALGARY
AUSTIN WICHITA DENVER

Texas License F-9147

12912 Hill Country Blvd. Ste F-200
Austin, Texas 78738
Tel: 512.732.9812
Fax: 512.732.9816

ARCO Oil and Gas

Country: USA

Location:

API No: 30-025-11824

State ID No:

Drawn: WHG

Rev No: 1

ARCO SRC No. 1

State/Province: New Mexico

District:

Field:

Project No: 1752

Reviewed: RH

Notes:

County/Parish: Lea

Survey:

Well Type/Status: Gas / P&A

Date: 9/28/18

Approved: RH

STATE OF NEW MEXICO
ENERGY AND MINERALS DEPARTMENT

OIL CONSERVATION DIVISION

P. O. BOX 2088

SANTA FE, NEW MEXICO 87501

Form C-101
Revised 10-

NO. OF COPIES RECEIVED	
DISTRIBUTION	
SANTA FE	
FILE	
U.S.G.S.	
LAND OFFICE	
OPERATOR	

5a. Indicate Type of Lease
State ☐ Fee ☐
5. State Oil & Gas Lease No.

SUNDRY NOTICES AND REPORTS ON WELLS
(DO NOT USE THIS FORM FOR PROPOSALS TO DRILL OR TO DEEPEN OR PLUG BACK TO A DIFFERENT RESERVOIR. USE "APPLICATION FOR PERMIT -" (FORM C-101) FOR SUCH PROPOSALS.)

OIL WELL ☐ GAS WELL ☐ OTHER- Re-entry - Dry

Name of Operator ARCO Oil and Gas Company
Div of Atlantic Richfield Co.

Address of Operator P. O. Box 1710, Hobbs, N M 88240

Location of Well
UNIT LETTER H, 1980 FEET FROM THE North LINE AND 660 FEET FROM
THE East LINE, SECTION 29 TOWNSHIP 25S RANGE 37E NMPM.

15. Elevation (Show whether DF, RT, GR, etc.)
3029' GR

7. Unit Agreement Name
8. Farm or Lease Name
ARCO SRC
9. Well No.
1
10. Field and Pool, or Wildcat
Wildcat
Abo Reef
12. County
Lea

Check Appropriate Box To Indicate Nature of Notice, Report or Other Data
NOTICE OF INTENTION TO: SUBSEQUENT REPORT OF:

PERFORM REMEDIAL WORK <input type="checkbox"/>	PLUG AND ABANDON <input type="checkbox"/>	REMEDIAL WORK <input type="checkbox"/>	ALTERING CASING <input type="checkbox"/>
TEMPORARILY ABANDON <input type="checkbox"/>	CHANGE PLANS <input type="checkbox"/>	COMMENCE DRILLING OPNS. <input type="checkbox"/>	PLUG AND ABANDONMENT <input type="checkbox"/>
PULL OR ALTER CASING <input type="checkbox"/>	OTHER <input type="checkbox"/>	CASING TEST AND CEMENT JOBS <input type="checkbox"/>	OTHER Re-enter, perf, treat & test <input type="checkbox"/>

7. Describe Proposed or Completed Operations (Clearly state all pertinent details, and give pertinent dates, including estimated date of starting any proposed work) SEE RULE 1103.

U on 12/06/81, rem dry hole marker, install WH & BOP. DO cmt inside 9-5/8" OD csg to 2696'. rld BP @ 2696'. Drld & CO to 3327'. Press tstd 9-5/8" & 5 1/2" csg lap to 1350#, estab circ. rld cmt inside 5 1/2" csg to 3346'. Press tstd 9-5/8" csg, indicated csg leaks 3093-3216'. Set -5/8" pkr @ 3001'. Pmpd 250 sx Cl H cmt contg 2% CaCl₂, MP 750#. POH w/pkr WOC. DO cmt. Press std csg to 500# for 30 mins, OK. Drld & CO inside 5 1/2" csg to 7018'. RIH w/pkr. set @ 3375'. Press test 5 1/2" csg to 1500# for 30 mins, OK. Ran GR-CNL 2700-7018'. On 12/29/81 perf 5 1/2" csg 398-6900' & 6468-6470'. RIH w/5 1/2" pkr, set @ 6855'. Pmpd 47 bbls 10# BW, dn tbq, no returns. 1j 3 BPM @ 2500#. Final inj rate 4 BPM @ 2500#. POH w/pkr, set cmt retr @ 6851'. Sqz cmtd arfs 6898-6900' w/250 sx Cl H cmt contg 2% CaCl₂. RIH w/bit to 6600'. POH w/bit. Set pkr @ 200'. Cmt sqz perfs 6468-70' w/150 sx Cl H cmt contg 2% CaCl₂. RIH w/bit to 6881'. Perf'd 2" csg @ 6795, 99, 6802, 06, 11, 14, 17, 22, 29, 32'. RIH w/pkr to 6848', spot 150 gals 15% 3 FE acid, set pkr @ 6663, acidize perfs 6795-6832' w/1000 gal 15% NEFE acid. On 8 hrs test vbd 0 BO, 134 BL & FW, no show gas. POH w/pkr. Set cmt retr @ 6784'. Cmt sqzd perfs 6795-382' w/200 sx Cl H cmt contg 2% CaCl₂. P00 retr w/tbg 12'. Tbg stuck @ 5327'. Cmt inside -7/8" tbg @ 5382'. RI 2-7/8" tbg w/bit to 5382' TOC, drld cmt to 6743'. POH w/bit. Ran CBL 48-4748', good bond of cmt, indicated TOC @ 5332'. Press tstd tbg/csg w/1200# for 30 mins, C. Perf'd 2-7/8" tbg f/csg @ 6717, 20, 29, 32, 35, 38, 41, 44, 49' w/9 holes. Pmpd into perfs 17-6749' w/2300# MP back to 1500# @ 1.2 BPM. In 3 hrs swbd 0 BO, 7 BW, no show gas. Set CIBP 6710'. Spot 100 gal 15% NEA acid 6698-6300'. Perf'd 2-7/8" tbg f/csg @ 6619, 24, 33, 36, 43,

I hereby certify that the information above is true and complete to the best of my knowledge and belief.

WED Jerry W. Schmidt TITLE Dist. Dir. Supt. DATE 1/29/82
APPROVED BY Ronald M. [Signature] TITLE OIL & GAS INSPECTOR DATE FEB 27 1984
ADDITIONS OF APPROVAL, IF ANY:

47, 52, 65, 74, 77, 84. 8, 92, 96', load tbg w/3 bbls KCL wtr, broke perfs w/1600#. On 1/22/82 swbd perfs 6619-6688' 7 hrs, rec 0 BO, 89 BW, no show gas. Cut 2-7/8" tbg f/csg off @ 5300'. Set cmt retr @ 5159'. Pmpd 150 sx Cl H cmt thru retr, sqzd w/3500#. Spot 40 sx cmt on top of retr. TOC @ 4815' in 5½" csg. Spotted 30 bbl of 10# gel mud 4525-3200'. Spot 50 sx Cl H cmt 3410-3200' in 5½" & 9-5/8" csg. Spotted 50 sx (100') cmt plug 1032-932'. Spotted 100' cmt plug @ surf. Installed regulation dry hole marker, cleaned & levelled location for abandonment. P&A eff: 1/26/82.

FINAL REPORT.

OIL CONSERVATION DIVISION

P. O. BOX 2088

SANTA FE, NEW MEXICO 87501

WELL COMPLETION OR RECOMPLETION REPORT AND LOG

NO. OF COPIES RECEIVED	
DISTRIBUTION	
SANTA FE	
FILE	
U.S.O.S.	
LAND OFFICE	
OPERATOR	

5a. Indicate Type of Lease
State ☐ Fee ☒

5. State Oil & Gas Lease No.

7. Unit Agreement Name

8. Farm or Lease Name

ARCO SRC

9. Well No.

1

10. Field and Pool, or Wildcat

Wildcat Abo Reef

12. County

Lea

TYPE OF WELL

OIL WELL ☐

GAS WELL ☐

DRY ☒

OTHER

TYPE OF COMPLETION

NEW WELL ☐

WORK OVER ☐

DEEPEN ☐

PLUG BACK ☐

DIFF. RESVR. ☐

OTHER

Name of Operator ARCO Oil and Gas Company
Div. of Atlantic Richfield Co.

Address of Operator

P. O. Box 1710, Hobbs, N M 88240

Location of Well

H

1980

North

660

T. LETTER LOCATED FEET FROM THE LINE AND FEET FROM

East

LINE OF SEC. 29

TWP. 25S

RGE. 37E

Date Spudded

16. Date T.D. Reached

17. Date Compl. (Ready to Prod.)

18. Elevations (DF, RKB, RT, GR, etc.)

19. Elev. Casinghead

entry Commenced

12/06/81

12/24/81

Dry

3029'

Total Depth

9365'

21. Plug Back T.D.

7018'

22. If Multiple Compl., How Many

23. Intervals Drilled By

Rotary Tools

Cable Tools

0-9365

Producing Interval(s), of this completion - Top, Bottom, Name

None

25. Was Directional Made

No

Type Electric and Other Logs Run

GR-CNL, CBL & Micro Seismogram Logged Cased hole

27. Was Well Cored

No

CASING RECORD (Report all strings set in well)

CASING SIZE	WEIGHT LB./FT.	DEPTH SET	HOLE SIZE	CEMENTING RECORD	AMOUNT PULLED
3-3/8" OD	48#	512'	17 1/2"	500	None
9-5/8" OD	36#	3655'	12 1/2"	3075	None
5 1/2" OD	17 & 20#	3351-9208'	7-7/8"	800	None

LINER RECORD

SIZE	TOP	BOTTOM	SACKS CEMENT	SCREEN	SIZE	DEPTH SET	PACKER SET

Perforation Record (Interval, size and number)

32. ACID, SHOT, FRACTURE, CEMENT SQUEEZE, ETC.

DEPTH INTERVAL	AMOUNT AND KIND MATERIAL USED
6898-6900'	250 sx C1 H cmt, 2% CaCl ₂
6468-6470'	150 sx C1 H cmt, 2% CaCl ₂
6795-6732'	1000 gal 15% NEFE, 200 sx C1 cmt w/2% CaCl ₂

PRODUCTION 6619-6696' 100 gal 15% NEA, 3bbls 2% KCl

1st First Production

Dry

Production Method (Flowing, gas lift, pumping - Size and type pump)

Water, 110 sx C1 H cmt

P&A

1st of Test	Hours Tested	Choke Size	Prod'n. Per Test Period	Oil - Bbl.	Gas - MCF	Water - Bbl.	Gas - Oil Ratio
2nd Tubing Press.	Casing Pressure	Calculated 24-Hour Rate	Oil - Bbl.	Gas - MCF	Water - Bbl.	Oil Gravity - API (Corr.)	

Disposition of Gas (Sold, used for fuel, vented, etc.)

Test Witnessed By

Horace Hegwood

List of Attachments

Logs as listed in item 26 above

I hereby certify that the information shown on both sides of this form is true and complete to the best of my knowledge and belief.

SIGNED

TITLE

Dist. Drlg. Supt.

DATE

1/29/82

INSTRUCTIONS

This form is to be filed with the appropriate District Office of the Division not later than 26 days after the completion of any newly-drilled or deepened well. It shall be accompanied by one copy of all electrical and mechanical logs run in the well and a summary of all special tests conducted, including drill stem tests. All depths reported shall be measured depths. In the case of directionally drilled wells, true vertical depths shall also be reported. For multiple completions, Items 3a through 3d shall be reported for each zone. The form is to be filed in quadruplicate except on some land, where six copies are required. See Rule 1105.

INDICATE FORMATION TOPS IN CONFORMANCE WITH GEOGRAPHICAL SECTION OF STATE

Southeastern New Mexico

Northwestern New Mexico

See Orig Completion Form C-105		T. Canyon	T. Ojo Alamo	T. Penn. "B"
T. Anhy	T. Strawn	T. Kirtland-Fruitland	T. Penn. "C"	
T. Salt	T. Atoka	T. Pictured Cliffs	T. Penn. "D"	
T. Salt	T. Miss	T. Cliff House	T. Leadville	
T. Yates	T. Devonian	T. Menefee	T. Madison	
T. 7 Rivers	T. Silurian	T. Point Lookout	T. Elbert	
T. Queen	T. Montoya	T. Mancos	T. McCracken	
T. Grayburg	T. Simpson	T. Gallup	T. Ignacio (Zizic)	
T. San Andres	T. McKee	Base Greenhorn	T. Granite	
T. Glorieta	T. Ellenburger	T. Dakota		
T. Paddock	T. Gr. Wash	T. Morrison		
T. Blinberry	T. Granite	T. Todilto		
T. Tubb	T. Delaware Sand	T. Entrada		
T. Drinkard	T. Bone Springs	T. Wingate		
T. Abo		T. Chinle		
T. Wolfcamp		T. Pennian		
T. Penn.		T. Penn. "A"		
T. Cisco (Bough C)				

OIL OR GAS SANDS OR ZONES

No. 1, from.....None.....to.....	No. 4, from.....to.....
No. 2, from.....to.....	No. 5, from.....to.....
No. 3, from.....to.....	No. 6, from.....to.....

IMPORTANT WATER SANDS

Include data on rate of water inflow and elevation to which water rose in hole.

No. 1, from.....None.....to.....feet.....
No. 2, from.....to.....feet.....
No. 3, from.....to.....feet.....
No. 4, from.....to.....feet.....

FORMATION RECORD (Attach additional sheets if necessary)

From	To	Thickness in Feet	Formation	From	To	Thickness in Feet	Formation
			See Orig Completion Form C-105				

NO. OF COPIES RECEIVED	
DISTRIBUTION	
SANTA FE	
FILE	
U.S.G.S.	
LAND OFFICE	
OPERATOR	

NEW MEXICO OIL CONSERVATION COMMISSION

Form C-103
Supersedes Old
C-102 and C-103
Effective 1-1-65

SUNDRY NOTICES AND REPORTS ON WELLS

(DO NOT USE THIS FORM FOR PROPOSALS TO DRILL OR TO DEEPEN OR PLUG BACK TO A DIFFERENT RESERVOIR. USE "APPLICATION FOR PERMIT -" (FORM C-101) FOR SUCH PROPOSALS.)

1. OIL <input type="checkbox"/> GAS <input type="checkbox"/> OTHER <input checked="" type="checkbox"/> failed to produce	5a. Indicate Type of Lease State <input type="checkbox"/> Fee <input checked="" type="checkbox"/>
2. Name of Operator Burleson & Huff	5. State Oil & Gas Lease No.
3. Address of Operator Box 935, Midland, Texas 79701	7. Unit Agreement Name
4. Location of Well UNIT LETTER H , 1980 FEET FROM THE north LINE AND 660 FEET FROM THE east LINE, SECTION 29 TOWNSHIP 25-8 RANGE 37-E NMPM.	8. Farm or Lease Name Coll
	9. Well No. 1
	10. Field and Pool, or Wildcat Jalmat
15. Elevation (Show whether DF, RT, GR, etc.) 3023 D. F.	12. County Lea

16. Check Appropriate Box To Indicate Nature of Notice, Report or Other Data	
NOTICE OF INTENTION TO:	SUBSEQUENT REPORT OF:
PERFORM REMEDIAL WORK <input type="checkbox"/>	REMEDIAL WORK <input type="checkbox"/>
TEMPORARILY ABANDON <input type="checkbox"/>	COMMENCE DRILLING OPNS. <input type="checkbox"/>
PULL OR ALTER CASING <input type="checkbox"/>	CASING TEST AND CEMENT JOBS <input type="checkbox"/>
OTHER <input type="checkbox"/>	OTHER <input type="checkbox"/>
PLUG AND ABANDON <input type="checkbox"/>	ALTERING CASING <input type="checkbox"/>
CHANGE PLANS <input type="checkbox"/>	PLUG AND ABANDONMENT <input checked="" type="checkbox"/>

17. Describe Proposed or Completed Operations (Clearly state all pertinent details, and give pertinent dates, including estimated date of starting any proposed work) SEE RULE 1103.

1. Spotted 50 sax of cement over perfs from 2437-2529
2. Filled hole with mud & water
3. 10 sax cement plug in top of 9 5/8
4. Cement marker into hole, fill in cellar.

Note: Plug back depth with Halliburton 9 5/8" plug is 2540' and none of the 9 5/8" casing will be pulled.

You will be notified when the location is cleaned up for your inspection

18. I hereby certify that the information above is true and complete to the best of my knowledge and belief.		
SIGNED <i>Lee B. Burleson</i>	TITLE Partner	DATE 12-19-69
APPROVED <i>Nathan E. Oleg</i>	TITLE INSPECTOR	DATE DEC 7 1971
CONDITIONS OF APPROVAL, IF ANY:		

NO. OF COPIES RECEIVED	
DISTRIBUTION	
SANTA FE	
FILE	
U.S.G.S.	
LAND OFFICE	
OPERATOR	

NEW MEXICO OIL CONSERVATION COMMISSION

AUG 6 11 23 AM '65

Form C-103
Supersedes Old
C-102 and C-103
Effective 1-1-65

5a. Indicate Type of Lease State <input type="checkbox"/> Fee <input checked="" type="checkbox"/>	
5. State Oil & Gas Lease No.	
7. Unit Agreement Name	
8. Farm or Lease Name Coll	
9. Well No. 1	
10. Field and Pool, or Wildcat Crosby Devonian	
12. County Lea	

SUNDRY NOTICES AND REPORTS ON WELLS
(DO NOT USE THIS FORM FOR PROPOSALS TO DRILL OR TO DEEPEN OR PLUG BACK TO A DIFFERENT RESERVOIR. USE "APPLICATION FOR PERMIT -" (FORM C-101) FOR SUCH PROPOSALS.)

1. OIL WELL ☐ GAS WELL ☒ OTHER-
2. Name of Operator
Union Texas Petroleum Corporation
3. Address of Operator
Box 1859 - Midland, Texas
4. Location of Well
UNIT LETTER H, 1980 FEET FROM THE North LINE AND 660 FEET FROM
THE East LINE, SECTION 29 TOWNSHIP 25-S RANGE 37-E NMPM.
15. Elevation (Show whether DF, RT, GR, etc.)
3023 DF

Check Appropriate Box To Indicate Nature of Notice, Report or Other Data
NOTICE OF INTENTION TO: SUBSEQUENT REPORT OF:

PERFORM REMEDIAL WORK <input type="checkbox"/>	PLUG AND ABANDON <input type="checkbox"/>	REMEDIAL WORK <input type="checkbox"/>	ALTERING CASING <input type="checkbox"/>
TEMPORARILY ABANDON <input type="checkbox"/>	CHANGE PLANS <input type="checkbox"/>	COMMENCE DRILLING OPNS. <input type="checkbox"/>	PLUG AND ABANDONMENT <input checked="" type="checkbox"/>
PULL OR ALTER CASING <input type="checkbox"/>	OTHER <input type="checkbox"/>	CASING TEST AND CEMENT JOB <input type="checkbox"/>	

7. Describe Proposed or Completed Operations (Clearly state all pertinent details, and give pertinent dates, including estimated date of starting any proposed work) SEE RULE 1103.

Spotted 50 sack cement plug from 8173 to 8623'. Cut 5-1/2" casing off at 3351' and pulled same. Spotted 50 sack cement plug 3254 to 3534'. Spotted 10 sack cement plug in top of 9-5/8" casing. Welded 1/2" steel plate over 13-3/8" casing and installed well marker.

18. I hereby certify that the information above is true and complete to the best of my knowledge and belief.

SIGNED [Signature] TITLE District Clerk DATE Aug. 5, 1965

APPROVED BY [Signature] TITLE _____ DATE _____

CONDITIONS OF APPROVAL, IF ANY:

NUMBER OF COPIES RECEIVED	
DISTRIBUTION	
SANTA FE	
FILE	
U.S.G.S.	
LAND OFFICE	
TRANSPORTER	OIL
	GAS
PRODUCTION OFFICE	
OPERATOR	

NEW MEXICO OIL CONSERVATION COMMISSION

Santa Fe, New Mexico

MISCELLANEOUS NOTICES

strict Office, Oil Conservation Commission, before the work specified is to begin. A copy will be furnished to the Bureau on which will be given the approval, with any modifications considered advisable, or the rejection by the Commission or agent, of the plan submitted. The plan as approved should be followed, and work should not begin until approval is obtained. See additional instructions in the Rules and Regulations of the Commission.

Indicate Nature of Notice by Checking Below

NOTICE OF INTENTION TO CHANGE PLANS		NOTICE OF INTENTION TO TEMPORARILY ABANDON WELL		NOTICE OF INTENTION TO DRILL DEEPER	
NOTICE OF INTENTION TO PLUG WELL		NOTICE OF INTENTION TO PLUG BACK		NOTICE OF INTENTION TO SET LINER	
NOTICE OF INTENTION TO SQUEEZE		NOTICE OF INTENTION TO ACIDIZE		NOTICE OF INTENTION TO SHOOT (Nitro)	
NOTICE OF INTENTION TO GUN PERFORATE		NOTICE OF INTENTION (OTHER)	X	NOTICE OF INTENTION (OTHER)	

OIL CONSERVATION COMMISSION
SANTA FE, NEW MEXICOMidland, Texas
(Place)December 15, 1964
(Date)

Gentlemen:

Following is a Notice of Intention to do certain work as described below at the Union Texas Petroleum Corporation....

Coll Well No. 1 in H
(Company or Operator) Lease (Unit)
SE 1/4 NE 1/4 of Sec. 29, T-25-S, R. 37-E, NMPM, Crosby (Devonian) Pool
(40-acre Subdivision)
County.

FULL DETAILS OF PROPOSED PLAN OF WORK
(FOLLOW INSTRUCTIONS IN THE RULES AND REGULATIONS)

Set Baker Bridge Plug at 8650' to blank off lower perforations 8665-8685'.
Swabbed well. Would not flow. Shut well in.

Approved....., 19.....
Except as follows:

Approved
OIL CONSERVATION COMMISSION

By.....

Title.....

Union Texas Petroleum Corporation
Company or Operator

By.....

Position..... District Engineer

Send Communications regarding well to:

Name..... Union Texas Petroleum Corporation

Address..... Box 1859 - Midland, Texas

COMPANY Anderson-Prichard Oil Corporation - Box 196, Midland, Texas
(Address)

LEASE Coll WELL NO. 1 UNIT H S 29 T 25S R 37E
DATE WORK PERFORMED Oct. 20, 1955 POOL Crosby-Devonian

This is a Report of: (Check appropriate block) ☒ Results of Test of Casing Shut-off

☐ Beginning Drilling Operations

☐ Remedial Work

☐ Plugging

☐ Other _____

Detailed account of work done, nature and quantity of materials used and results obtained.

Depth 9365' - Set 5-1/2" OD 17 & 20' Casing at 9208' with DV Tool set at 8005'. Cemented first stage with 300 sacks of neat cement with 1/4" of flow seal per sack. Job completed at 2:10 A.M. Oct. 20, 1955. Circulated through DV Tool 6 hours. Cemented through DV Tool with 500 sacks of 6% Gel, 1/4" Flow seal per sack. Plug down 9:30 A.M. Oct. 20, 1955. Top cement at 2335'. Released pressure after 24 hours. Tested casing to 1200' for 30 minutes. No decrease in pressure.

FILL IN BELOW FOR REMEDIAL WORK REPORTS ONLY

Original Well Data:

DF Elev. _____ TD _____ PBD _____ Prod. Int. _____ Compl Date _____

Tbng. Dia _____ Tbng Depth _____ Oil String Dia _____ Oil String Depth _____

Perf Interval (s) _____

Open Hole Interval _____ Producing Formation (s) _____

RESULTS OF WORKOVER:

BEFORE

AFTER

Date of Test _____

Oil Production, bbls. per day _____

Gas Production, Mcf per day _____

Water Production, bbls. per day _____

Gas-Oil Ratio, cu. ft. per bbl. _____

Gas Well Potential, Mcf per day _____

Witnessed by _____

(Company)

OIL CONSERVATION COMMISSION

I hereby certify that the information given above is true and complete to the best of my knowledge.

Name C. M. [Signature]

Name C. E. [Signature]

Title _____

Position Pet. Engineer

Date _____

Company Anderson-Prichard Oil Corporation

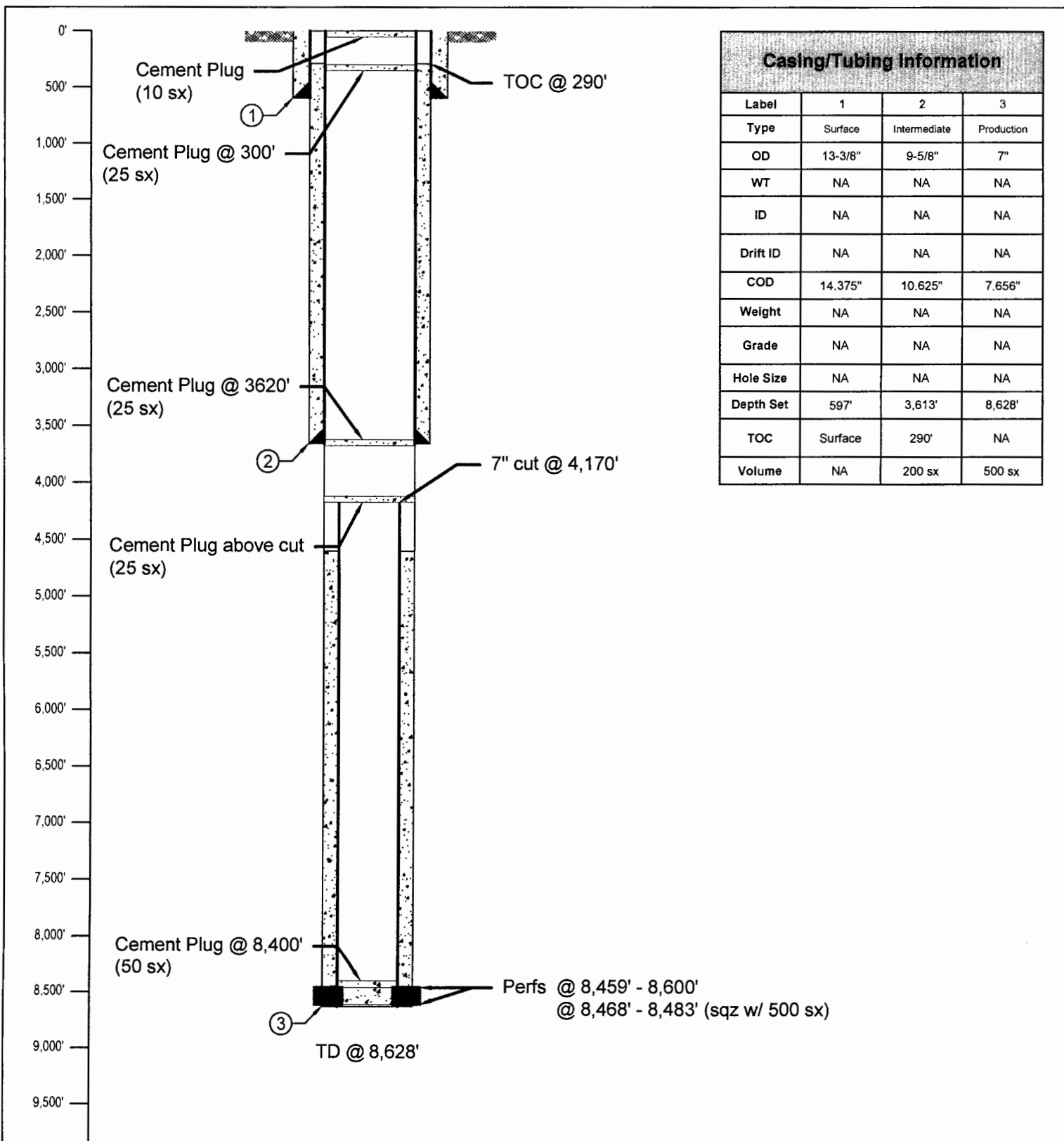

Casing/Tubing Information			
Label	1	2	3
Type	Surface	Intermediate	Production
OD	13-3/8"	9-5/8"	7"
WT	NA	NA	NA
ID	NA	NA	NA
Drift ID	NA	NA	NA
COD	14.375"	10.625"	7.656"
Weight	NA	NA	NA
Grade	NA	NA	NA
Hole Size	NA	NA	NA
Depth Set	597'	3,613'	8,628'
TOC	Surface	290'	NA
Volume	NA	200 sx	500 sx

LONQUIST & CO. LLC PETROLEUM ENGINEERS ENERGY ADVISORS HOUSTON CALGARY AUSTIN WICHITA DENVER	Texas Pacific Oil Co		Gutman D No. 1	
	Country: USA	State/Province: New Mexico		County/Parish: Lea
	Location:	District:		Survey:
	API No: 30-025-11829	Field:		Well Type/Status: P&A
Texas License F-9147	State ID No:	Project No: 1752		Date: 9/28/18
12912 Hill Country Blvd. Ste F-200 Austin, Texas 78738 Tel: 512.732.9812 Fax: 512.732.9816	Drawn: WHG	Reviewed: RH		Approved: RH
	Rev No: 1	Notes:		

NO. OF COPIES RECEIVED	
DISTRIBUTION	
SANTA FE	
FILE	
U.S.G.S.	
LAND OFFICE	
OPERATOR	

NEW MEXICO OIL CONSERVATION COMMISSION

Form C-103
Supersedes Old
C-102 and C-103
Effective 1-1-65

5a. Indicate Type of Lease	
State <input type="checkbox"/>	Fee <input checked="" type="checkbox"/>
5. State Oil & Gas Lease No.	
NMJ-581	

SUNDRY NOTICES AND REPORTS ON WELLS

(DO NOT USE THIS FORM FOR PROPOSALS TO DRILL OR TO DEEPEN OR PLUG BACK TO A DIFFERENT RESERVOIR. USE "APPLICATION FOR PERMIT -" (FORM C-101) FOR SUCH PROPOSALS.)

1. OIL WELL <input type="checkbox"/> GAS WELL <input type="checkbox"/> OTHER <input type="checkbox"/>	7. Unit Agreement Name
2. Name of Operator Texas Pacific Oil Company	8. Farm or Lease Name Gutman "D"
3. Address of Operator P. O. Box 1068, Hobbs, New Mexico	9. Well No. 1
4. Location of Well UNIT LETTER <u>I</u> , <u>1830</u> FEET FROM THE <u>south</u> LINE AND <u>660</u> FEET FROM THE <u>East</u> LINE, SECTION <u>299</u> TOWNSHIP <u>25S</u> RANGE <u>37E</u> NMPM.	10. Field and Pool, or Wildcat Crosby Devonian
15. Elevation (Show whether DI, RT, GR, etc.) 3011' GR	12. County Lea

Check Appropriate Box To Indicate Nature of Notice, Report or Other Data

NOTICE OF INTENTION TO:

PERFORM REMEDIAL WORK	<input type="checkbox"/>
TEMPORARILY ABANDON	<input type="checkbox"/>
PULL OR ALTER CASING	<input type="checkbox"/>
OTHER	<input type="checkbox"/>

PLUG AND ABANDON	<input type="checkbox"/>
CHANGE PLANS	<input type="checkbox"/>

SUBSEQUENT REPORT OF:

REMEDIAL WORK	<input type="checkbox"/>
COMMENCE DRILLING OPNS.	<input type="checkbox"/>
CASING TEST AND CEMENT JOB	<input type="checkbox"/>
OTHER	<input type="checkbox"/>
ALTERING CASING	<input type="checkbox"/>
PLUG AND ABANDONMENT	<input checked="" type="checkbox"/>

17. Describe Proposed or Completed Operations (Clearly state all pertinent details, and give pertinent dates, including estimated date of starting any proposed work) SEE RULE 1103.

1. Spotted a 50 sack cement plug at 3400'
2. Loaded hole with mud laden fluid
3. Shot and pulled 7" casing from 4170'
4. Spotted a 25 sack plug at stub of 7" casing
5. Spotted a 25 sack plug at 3620'
6. Spotted a 35 sack plug at 300'
7. Spotted a 10 sack plug in the top and erected a regulation marker

18. I hereby certify that the information above is true and complete to the best of my knowledge and belief.

SIGNED Hobbs Pipe & Supply Co TITLE Manager DATE June 28, 1968

APPROVED BY John H. H. H. H. TITLE DATE

CONDITIONS OF APPROVAL, IF ANY:

NO. OF COPIES RECEIVED	
DISTRIBUTION	
SANTA FE	
FILE	
U.S.G.S.	
LAND OFFICE	
OPERATOR	

NEW MEXICO OIL CONSERVATION COMMISSION

Form C-103
Supersedes Old
C-102 and C-103
Effective 1-1-65

110885 OF 110885
Nov 28 9 40 AM '66
HOBBS O.C.C.

5. Indicate Type of Lease	State <input checked="" type="checkbox"/> Fee <input checked="" type="checkbox"/>
5. State Oil & Gas Lease No.	

SUNDRY NOTICES AND REPORTS ON WELLS

(DO NOT USE THIS FORM FOR PROPOSALS TO DRILL OR TO DEEPEN OR PLUG BACK TO A DIFFERENT RESERVOIR. USE "APPLICATION FOR PERMIT -" (FORM C-101) FOR SUCH PROPOSALS.)

1. OIL WELL <input type="checkbox"/> GAS WELL <input checked="" type="checkbox"/> OTHER- 2. Name of Operator TEXAS PACIFIC OIL COMPANY 3. Address of Operator P.O. Box 1069 - Hobbs, New Mexico 4. Location of Well UNIT LETTER I , 1830 FEET FROM THE South LINE AND 660 FEET FROM THE East LINE, SECTION 29 TOWNSHIP 25-S RANGE 37-E NMPM.	7. Unit Agreement Name 8. Farm or Lease Name Gutman "D" 9. Well No. 1 10. Field and Pool, or Wildcat Crosby Devonian
15. Elevation (Show whether DF, RT, GR, etc.) 3011'	12. County Lea

Check Appropriate Box To Indicate Nature of Notice, Report or Other Data
NOTICE OF INTENTION TO:

PERFORM REMEDIAL WORK <input checked="" type="checkbox"/>	PLUG AND ABANDON <input type="checkbox"/>
TEMPORARILY ABANDON <input type="checkbox"/>	CHANGE PLANS <input type="checkbox"/>
PULL OR ALTER CASING <input type="checkbox"/>	OTHER <input type="checkbox"/>

SUBSEQUENT REPORT OF:

REMEDIAL WORK <input type="checkbox"/>	ALTERING CASING <input type="checkbox"/>
COMMENCE DRILLING OPMS. <input type="checkbox"/>	PLUG AND ABANDONMENT <input type="checkbox"/>
CASING TEST AND CEMENT JOBS <input type="checkbox"/>	OTHER <input type="checkbox"/>

17. Describe Proposed or Completed Operations (Clearly state all pertinent details, and give pertinent dates, including estimated date of starting any proposed work) SEE RULE 1103.

1. Rig up. Install BOP. Pull and run tubing to hydro-test.
2. Set cement retainer @ 8350'.
3. Squeeze present perfs. 8459-8600' w/500 sks., 50-50 pozmix + 2% Gel. + 1% Halad 9.
4. Pull tubing. W.O.C. 24 hrs. Drill out cement to 8550'.
5. Perf. 8468-8484' w/1 JSPP.
6. Re-run tubing. Recover load oil and place on test.

18. I hereby certify that the information above is true and complete to the best of my knowledge and belief.

SIGNED [Signature] TITLE Area Superintendent DATE 11-23-66

APPROVED BY _____ TITLE _____ DATE _____

CONDITIONS OF APPROVAL, IF ANY:

NO. OF COPIES RECEIVED		
DISTRIBUTION		
SANTA FE		
FILE		
U.S.G.S.		
LAND OFFICE		
OPERATOR		

NEW MEXICO OIL CONSERVATION COMMISSION HOBBS OFFICE

Form C-103
Supersedes Old
C-102 and C-103
Effective 1-1-65

DEC 6 1966

54. Indicate type of Lease
State ☐ Fee ☒

5. State Oil & Gas Lease No.

SUNDRY NOTICES AND REPORTS ON WELLS

(DO NOT USE THIS FORM FOR PROPOSALS TO DRILL OR TO DEEPEN OR PLUG BACK TO A DIFFERENT RESERVOIR.
USE "APPLICATION FOR PERMIT - 1" (FORM C-101) FOR SUCH PROPOSALS.)

1. OIL WELL <input type="checkbox"/> GAS WELL <input checked="" type="checkbox"/> OTHER-	7. Unit Agreement Name
2. Name of Operator TEXAS PACIFIC OIL COMPANY	8. Farm or Lease Name Gutman "D"
3. Address of Operator P.O. Box 1069 - Hobbs, New Mexico	9. Well No. 1
4. Location of Well UNIT LETTER I 1830 FEET FROM THE South LINE AND 660 FEET FROM THE East LINE, SECTION 29 TOWNSHIP 25-S RANGE 37-E NMPM.	10. Field and Pool, or Wildcat Crosby Devonian
15. Elevation (Show whether DF, RT, GR, etc.) 3011'	12. County Lea

16. Check Appropriate Box To Indicate Nature of Notice, Report or Other Data
NOTICE OF INTENTION TO: SUBSEQUENT REPORT OF:

PERFORM REMEDIAL WORK <input type="checkbox"/>	PLUG AND ABANDON <input type="checkbox"/>	REMEDIAL WORK <input checked="" type="checkbox"/>	ALTERING CASING <input type="checkbox"/>
TEMPORARILY ABANDON <input type="checkbox"/>	CHANGE PLANS <input type="checkbox"/>	COMMENCE DRILLING OPNS. <input type="checkbox"/>	PLUG AND ABANDONMENT <input type="checkbox"/>
PULL OR ALTER CASING <input type="checkbox"/>	OTHER <input type="checkbox"/>	CASING TEST AND CEMENT JOB <input type="checkbox"/>	

17. Describe Proposed or Completed Operations (Clearly state all pertinent details and give pertinent dates, including estimated date of starting any proposed work.) SEE RULE 1103.

1. Rigged up. Pulled tubing. Test tubing back in hole.
2. Set cement retainer @ 8350'.
3. Squeezed perfs. 8459-8600' w/500 sks. 50-50 pozmix + 2% gel. + 1% halad 9.
4. Pulled tbg. W.O.C. 24 hrs. Drilled out cement to 8550'.
5. Perf. 8468-8483' w/15 2" holes w/1 JSPP.
6. Ran tbg. and acidized 8468-8484' w/1500 gal. HCl acid. Set pkr. @ 8393'.
7. Swab and flow.

8. I hereby certify that the information above is true and complete to the best of my knowledge and belief.

SIGNED [Signature] TITLE Production Foreman DATE 12-6-66

APPROVED BY _____ TITLE _____ DATE _____

CONDITIONS OF APPROVAL, IF ANY:

N.

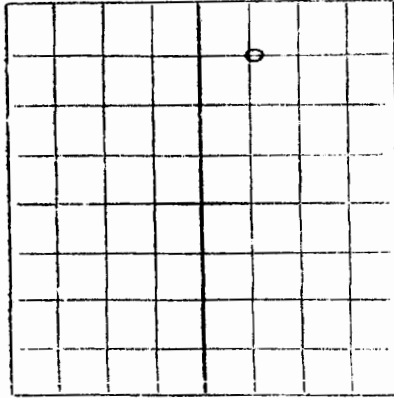

AREA 640 ACRES
LOCATE WELL CORRECTLY

NEW MEXICO OIL CONSERVATION COMMISSION

Santa Fe, New Mexico

WELL RECORD

RO-710

OO RECTANGLE

Mail to District Office, Oil Conservation Commission, to which Form C-105 was sent not later than twenty days after completion of well. Follow instructions in Rules and Regulations of the Commission. Submit in QUINCUPLICATE.

R. OLSEN (Company or Operator) Gutman (Lease)

Well No. D-1, in N/2 of Sec. 29, T. 25S, R. 37E, NMPM.

Crosby-Devonian Post Leg County.

Well is 1830 feet from South line and 660 feet from East line

of Section 29 If State Land the Oil and Gas Lease No. is

Drilling Commenced 10-8, 19 55 Drilling was Completed 12-8, 19 55

Name of Drilling Contractor R. Olsen

Address Drawer "Z" Jal, N. Mex.

Elevation above sea level at Top of Tubing Head 3011' The information given is to be kept confidential until _____, 19____

OIL SANDS OR ZONES

No. 1, from <u>8457'</u> to <u>8600'</u>	No. 4, from _____ to _____
No. 2, from _____ to _____	No. 5, from _____ to _____
No. 3, from _____ to _____	No. 6, from _____ to _____

IMPORTANT WATER SANDS

Include data on rate of water inflow and elevation to which water rose in hole.

No. 1, from _____ to _____	_____ feet.
No. 2, from _____ to _____	_____ feet.
No. 3, from <u>NON</u> to _____	_____ feet.
No. 4, from _____ to _____	_____ feet.

If drill-stem or other special tests are desired, separate tests can be run.

Rotary tools were used from 0 to 100% of the time.

Cable tools were used from 0 to 100% of the time.

521-125

OLD WELL: The production during the first 24 h is 0.1

was oil

1
 2
 3
 4
 5
 6
 7
 8
 9
 10
 11
 12
 13
 14
 15
 16
 17
 18
 19
 20
 21
 22
 23
 24
 25
 26
 27
 28
 29
 30
 31
 32
 33
 34
 35
 36
 37
 38
 39
 40
 41
 42
 43
 44
 45
 46
 47
 48
 49
 50
 51
 52
 53
 54
 55
 56
 57
 58
 59
 60
 61
 62
 63
 64
 65
 66
 67
 68
 69
 70
 71
 72
 73
 74
 75
 76
 77
 78
 79
 80
 81
 82
 83
 84
 85
 86
 87
 88
 89
 90
 91
 92
 93
 94
 95
 96
 97
 98
 99
 100
 101
 102
 103
 104
 105
 106
 107
 108
 109
 110
 111
 112
 113
 114
 115
 116
 117
 118
 119
 120
 121
 122
 123
 124
 125
 126
 127
 128
 129
 130
 131
 132
 133
 134
 135
 136
 137
 138
 139
 140
 141
 142
 143
 144
 145
 146
 147
 148
 149
 150
 151
 152
 153
 154
 155
 156
 157
 158
 159
 160
 161
 162
 163
 164
 165
 166
 167
 168
 169
 170
 171
 172
 173
 174
 175
 176
 177
 178
 179
 180
 181
 182
 183
 184
 185
 186
 187
 188
 189
 190
 191
 192
 193
 194
 195
 196
 197
 198
 199
 200
 201
 202
 203
 204
 205
 206
 207
 208
 209
 210
 211
 212
 213
 214
 215
 216
 217
 218
 219
 220
 221
 222
 223
 224
 225
 226
 227
 228
 229
 230
 231
 232
 233
 234
 235
 236
 237
 238
 239
 240
 241
 242
 243
 244
 245
 246
 247
 248
 249
 250
 251
 252
 253
 254
 255
 256
 257
 258
 259
 260
 261
 262
 263
 264
 265
 266
 267
 268
 269
 270
 271
 272
 273
 274
 275
 276
 277
 278
 279
 280
 281
 282
 283
 284
 285
 286
 287
 288
 289
 290
 291
 292
 293
 294
 295
 296
 297
 298
 299
 300
 301
 302
 303
 304
 305
 306
 307
 308
 309
 310
 311
 312
 313
 314
 315
 316
 317
 318
 319
 320
 321
 322
 323
 324
 325
 326
 327
 328
 329
 330
 331
 332
 333
 334
 335
 336
 337
 338
 339
 340
 341
 342
 343
 344
 345
 346
 347
 348
 349
 350
 351
 352
 353
 354
 355
 356
 357
 358
 359
 360
 361
 362
 363
 364
 365
 366
 367
 368
 369
 370
 371
 372
 373
 374
 375
 376
 377
 378
 379
 380
 381
 382
 383
 384
 385
 386
 387
 388
 389
 390
 391
 392
 393
 394
 395
 396
 397
 398
 399
 400
 401
 402
 403
 404
 405
 406
 407
 408
 409
 410
 411
 412
 413
 414
 415
 416
 417
 418
 419
 420
 421
 422
 423
 424
 425
 426
 427
 428
 429
 430
 431
 432
 433
 434
 435
 436
 437
 438
 439
 440
 441
 442
 443
 444
 445
 446
 447
 448
 449
 450
 451
 452
 453
 454
 455
 456
 457
 458
 459
 460
 461
 462
 463
 464
 465
 466
 467
 468
 469
 470
 471
 472
 473
 474
 475
 476
 477
 478
 479
 480
 481
 482
 483
 484
 485
 486
 487
 488
 489
 490
 491
 492
 493
 494
 495
 496
 497
 498
 499
 500
 501
 502
 503
 504
 505
 506
 507
 508
 509
 510
 511
 512
 513
 514
 515
 516
 517
 518
 519
 520
 521
 522
 523
 524
 525

100 million people in the world are still without electricity. The production during the first 24 hours of the crisis was 100 million people in the world are still without electricity.

Liquid Hydrocarbon, Chur in Presence of 2,5-D

Length of Time Shut in

PLEASE INDICATE BELOW FORMATION TYPE IN CONFORMANCE WITH GEOGRAPHICAL SECTION OF STATE:

Southeastern New York

Northwestern University

T.	Amly.	T.	Resource	8446	City, State,
T	Amly.	2337	T	Resource	8446	City, State,
T	Stb.	2500	T	Resource	8446	City, State,
B	Stb.	2765	T	Resource	8446	City, State,
T	Yates	3130	T	Resource	8446	City, State,
T	Rivers		T	Resource	8446	City, State,
T	Queen		T	Resource	8446	City, State,
T	Grayburg		T	Resource	8446	City, State,
T	San Andre		T	Resource	8446	City, State,
T	Glorieta		T	Resource	8446	City, State,
T	Drinkard		T	Resource	8446	City, State,
T	Pubbs		T	Resource	8446	City, State,
T	Abbe		T	Resource	8446	City, State,
T	Penn		T	Resource	8446	City, State,
T	Miss		T	Resource	8446	City, State,

EXHIBITION BY ORDER

From	To	Thickness, in feet	Formation	Feet to base	Thickness in feet	Formation
C	580	580	Red beds and sand			
89C	1385	505	Red salt, anhydrite			
1905	2333	948	Anhydrite and salt			

COMPANY R. OLSEN, et al Drawer "A", J-1, New Mexico

(Address)

LEASE Gutman WELL NO. B-1 UNIT I S sec.29 T 25S R 37EDATE WORK PERFORMED 12-10-55 POOL UndesignatedThis is a Report of: (Check appropriate block) ☒ Results of Test of Casing Shut-off☐ Beginning Drilling Operations☐ Remedial Work☐ Plugging☐ Other _____

Detailed account of work done, nature and quantity of materials used and results obtained.

Ran 8644' 7" casing, weight 23, and 26 and 32#. Casing set at 8628' from o'. Cemented with 500 sacks cement. Plugged down at 10:00 A.M. December 10th, 1955. At 10:00 P.M. Saturday evening ran temperature survey. Cement back to 8045'. Pressured up with 10,000#. Held for 30 minutes. No loss in pressure. T.D. is 8628'.

FILL IN BELOW FOR REMEDIAL WORK REPORTS ONLY

Original Well Data:

DF Elev. _____ TD _____ PBD _____ Prod. Int. _____ Compl Date _____

Tbng. Dia _____ Tbng Depth _____ Oil String Dia _____ Oil String Depth _____

Perf Interval (s) _____

Open Hole Interval _____ Producing Formation (s) _____

RESULTS OF WORKOVER:

BEFORE

AFTER

Date of Test _____

Oil Production, bbls. per day _____

Gas Production, Mcf per day _____

Water Production, bbls. per day _____

Gas-Oil Ratio, cu. ft. per bbl. _____

Gas Well Potential, Mcf per day _____

Witnessed by _____

(Company)

OIL CONSERVATION COMMISSION

Name _____

Title _____

Date _____

I hereby certify that the information given above is true and complete to the best of my knowledge.

Name _____

Position _____

Company R. OLSEN

NEW MEXICO OIL CONSERVATION COMMISSION

Santa Fe, New Mexico

MISCELLANEOUS REPORTS ON WELLS

Submit this report in TRIPLICATE to the District Office, Oil Conservation Commission, within 10 days after the work specified is completed. It should be signed and filed as a report on Beginning Drilling Operations, Results of test of casing shut-off, result of plugging of well, result of well repair, and other important operations, even though the work was witnessed by an agent of the Commission. See additional instructions in the Rules and Regulations of the Commission.

Indicate Nature of Report by Checking Below

REPORT ON BEGINNING DRILLING OPERATIONS		REPORT ON RESULT OF TEST OF CASING SHUT-OFF	<input checked="" type="checkbox"/>	REPORT ON REPAIRING WELL	
REPORT ON RESULT OF PLUGGING WELL		REPORT ON RECOMPLETION OPERATION		REPORT ON (Other)	

October 31, 1955

Jal, New Mexico

(Date)

(Place)

Following is a report on the work done and the results obtained under the heading noted above at the

R. OLSEN

GUTMAN

(Company or Operator)

(Lease)

Well No. D-1 in the N 1/2 SE 1/4 of Sec. 29

(Contractor)

T. 25 S, R. 37 E, NMPM, Undesignated Pool, Lea County.

The Dates of this work were as follows: October 27, 1955

Notice of intention to do the work ~~was~~ (was not) submitted on Form C-102 on _____, 19_____,
(Cross out incorrect words)

and approval of the proposed plan ~~was~~ (was not) obtained.

DETAILED ACCOUNT OF WORK DONE AND RESULTS OBTAINED

Ran 3613' of 9-5/8" casing with 1800 sacks of 4% Jell and 200 sacks of Neat Cement with 4# of salt per sack. Plug down at 4:00 P.M. 10-27-55. Cement did not circulate. Ran temperature survey. Found cement 290' from 0' point. Waited 36 hours. Well pressured up at 4 A.M. 10-29-55 with 1,000#. Held for 30 minutes. No loss in pressure.

Witnessed by Ladell Ellis R. OLSEN
(Name) (Company) (Title)

Approved: OIL CONSERVATION COMMISSION

I hereby certify that the information given above is true and complete to the best of my knowledge.

Name: R. OLSEN

Position: DRILLER

Representing: DRILLER #2, Jal, New Mexico

Address: _____

(Title)

(Date)

NEW MEXICO OIL CONSERVATION COMMISSION

Santa Fe, New Mexico

MISCELLANEOUS REPORTS ON WELLS

Submit this report in TRIPLICATE to the District Office, Oil Conservation Commission, within 10 days after the work specified is completed. It should be signed and filed as a report on Beginning Drilling Operations, Results of test of casing shut-off, result of plugging of well, result of well repair, and other important operations, even though the work was witnessed by an agent of the Commission. See additional instructions in the Rules and Regulations of the Commission.

Indicate Nature of Report by Checking Below

REPORT ON BEGINNING DRILLING OPERATIONS		REPORT ON RESULT OF TEST OF CASING SHUT-OFF	<input checked="" type="checkbox"/>	REPORT ON REPAIRING WELL	
REPORT ON RESULT OF PLUGGING WELL		REPORT ON RECOMPLETION OPERATION		REPORT ON (Other)	

October 12, 1955

(Date)

Jal, New Mexico

(Place)

Following is a report on the work done and the results obtained under the heading noted above at the

R. OLSEN

(Company or Operator)

GUTMAN

(Lease)

Well No. D-1 in the N 1/2 SE 1/4 of Sec. 29

(Contractor)

T. 25 S, R. 37 E, NMPM, Undesignated Pool, Lea County.

The Dates of this work were as follows: October 12, 1955

Notice of intention to do the work ~~(was)~~ (was not) submitted on Form C-102 on _____, 19____.

(Cross out incorrect words)

and approval of the proposed plan ~~(was)~~ (was not) obtained.

DETAILED ACCOUNT OF WORK DONE AND RESULTS OBTAINED

Ran 597' 13-3/8" casing. Cemented with 500 sacks cement. Cement circulated to surface. Plugged down 11:00 A.M. 10-12-55. Waited 24 hours. Tested with 500# pressure for 30 minutes. No leaks.

Ladell Ellis

Witnessed by _____

(Name)

R. OLSEN

(Company) (Title)

Approved:

OIL CONSERVATION COMMISSION

(Name)

I hereby certify that the information given above is true and complete to the best of my knowledge.

Name _____

Position _____

Representing R. OLSEN

Address DRAWER "Z", Jal, New Mexico

(Title)

(Date)

C-101 APPLICATION FOR PERMIT TO DRILL

District I
1625 N. French Dr., Hobbs, NM 88240
Phone: (575) 393-6161 Fax: (575) 393-0720
District II
811 S. First St., Artesia, NM 88210
Phone: (575) 748-1283 Fax: (575) 748-9720
District III
1000 Rio Brazos Road, Aztec, NM 87410
Phone: (505) 334-6178 Fax: (505) 334-6170
District IV
1220 S. St. Francis Dr., Santa Fe, NM 87505
Phone: (505) 476-3460 Fax: (505) 476-3462

State of New Mexico

Form C-101
Revised July 18, 2013

Energy Minerals and Natural Resources

Oil Conservation Division

☐ AMENDED REPORT

1220 South St. Francis Dr.

Santa Fe, NM 87505

APPLICATION FOR PERMIT TO DRILL, RE-ENTER, DEEPEN, PLUGBACK, OR ADD A ZONE

¹ Operator Name and Address OWL SWD Operating, LLC 8214 Westchester Drive, Suite 850, Dallas, TX 75255		² OGRID Number 308339
		³ API Number 30-025-
⁴ Property Code	⁵ Property Name Sholes Deep SWD	⁶ Well No. 2

⁷ Surface Location

UL - Lot	Section	Township	Range	Lot Idn	Feet from	N/S Line	Feet From	E/W Line	County
N	29	25S	37E		1,115	South	1,122	West	Lea

⁸ Proposed Bottom Hole Location

UL - Lot	Section	Township	Range	Lot Idn	Feet from	N/S Line	Feet From	E/W Line	County

⁹ Pool Information

Pool Name SWD; Silurian-Devonian	Pool Code 97869
-------------------------------------	--------------------

Additional Well Information

¹¹ Work Type N	¹² Well Type SWD	¹³ Cable/Rotary R	¹⁴ Lease Type Private	¹⁵ Ground Level Elevation 2,983'
¹⁶ Multiple N	¹⁷ Proposed Depth 10,826'	¹⁸ Formation Silurian-Devonian	¹⁹ Contractor TBD	²⁰ Spud Date ASAP
Depth to Ground water 440'	Distance from nearest fresh water well 823'	Distance to nearest surface water +1 mi		

☐ We will be using a closed-loop system in lieu of lined pits

²¹ Proposed Casing and Cement Program

Type	Hole Size	Casing Size	Casing Weight/ft	Setting Depth	Sacks of Cement	Estimated TOC
Surface	20"	16"	84 lb/ft	1,250'	1,220 sks	Surface
Intermediate	14-3/4"	10-3/4"	51 lb/ft	4,450'	1,870 sks	Surface
Production	9-1/2"	7-5/8"	33.7 lb/ft	9,052'	990 sks	Surface
Tubing	N/A	5.5"	17 lb/ft	0' - 9,000'	N/A	N/A

Casing/Cement Program: Additional Comments

See attached schematic.

²² Proposed Blowout Prevention Program

Type Double Hydraulic/ Blinds, Pipe	Working Pressure 8,000 psi	Test Pressure 10,000 psi	Manufacturer TBD (Schaffer/Cameron)
²³ I hereby certify that the information given above is true and complete to the best of my knowledge and belief. I further certify that I have complied with 19.15.14.9 (A) NMAC <input type="checkbox"/> and/or 19.15.14.9 (B) NMAC <input checked="" type="checkbox"/> , if applicable. Signature: <i>Ramona K Hovey</i>		OIL CONSERVATION DIVISION	
Printed name: Ramona Hovey		Approved By:	
Title: Consulting Engineer- Agent for OWL SWD Operating, LLC		Title:	
E-mail Address: ramona@lonquist.com		Approved Date: Expiration Date:	
Date: 10/05/2018	Phone: 512-600-1777	Conditions of Approval Attached	

C-102 WELL LOCATION PLAT

①
②

D
C
B
A

E
F
G
H

GEODETTIC DATA
NAD 83 GRID - NM EAST
SHOLE DEEP SWD # 2
Y= 400947.82 N
X= 895467.25 E
LAT= 32.097122 N
LONG= 103.189762 W

L
K
J
I

A - Y= 405088.52, X= 894267.59
B - Y= 405180.39, X= 899589.05
C - Y= 399876.26, X= 899644.65
D - Y= 399821.31, X= 894366.28

1121.96'

1114.99'

M
N
O
P

④
③

17 OPERATOR CERTIFICATION

I hereby certify that the information contained herein is true and complete to the best of my knowledge and belief, and that this organization either owns a working interest or unleased mineral interest in the land including the proposed bottom hole location or has a right to drill this well at this location pursuant to a contract with an owner of such a mineral or working interest, or to a voluntary pooling agreement or a compulsory pooling order heretofore entered by the division.

Ramona Hovey 9/27/18
Signature Date

RAMONA HOVEY 9/27/18
Printed Name Date

ramona@longquist.com
Email Address Date

18 SURVEYOR CERTIFICATION

I hereby certify that the well location shown on this plat was plotted from field notes of actual surveys made by me or under my supervision, and that the same is true and correct to the best of my belief.

Aug 31, 2018 *PREY E. HUDSON*
Date of Survey Date

Signature and Seal of Professional Surveyor:

20559

Certificate Number
20559

McMillan, Michael, EMNRD

From: Ramona Hovey <ramona@lonquist.com>
Sent: Monday, October 8, 2018 2:20 PM
To: McMillan, Michael, EMNRD; Goetze, Phillip, EMNRD
Cc: Steve Pattee
Subject: [EXT] Sholes Deep SWD #2
Attachments: AffidavitOfPublication_SholesDeepNo2.pdf

Please find the attached Affidavit of Publication for OWL SWD Operating's Sholes Deep SWD #2.

Regards,

LONQUIST & CO. LLC **Ramona Hovey** • Sr. Petroleum Engineer • Lonquist & Co., LLC • 12912 Hill Country Blvd., Suite F-200 • Bee Cave, Texas, USA 78738
PETROLEUM ENGINEERS **ENERGY ADVISORS** Direct: 512-600-1777 • Cell: 512-585-0654 • Fax: 512-732-9816 • ramona@lonquist.com • www.lonquist.com

HOUSTON CALGARY
AUSTIN WICHITA DENVER

This email and any attachments thereto may contain private, confidential and privileged material for the sole use of the intended recipient. Any review, copying, or distribution of this email (or any attachments thereto) by others is strictly prohibited. If you are not the intended recipient, please contact the sender immediately and permanently delete the original and any copies of this email and any attachments thereto.

Affidavit of Publication

STATE OF NEW MEXICO
COUNTY OF LEA

I, Daniel Russell, Publisher of the Hobbs News-Sun, a newspaper published at Hobbs, New Mexico, solemnly swear that the clipping attached hereto was published in the regular and entire issue of said newspaper, and not a supplement thereof for a period of 1 issue(s).

Beginning with the issue dated
October 02, 2018
and ending with the issue dated
October 02, 2018.

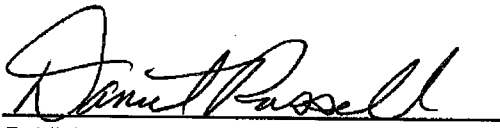

Publisher

Sworn and subscribed to before me this
2nd day of October 2018.



Business Manager

My commission expires
January 29, 2019

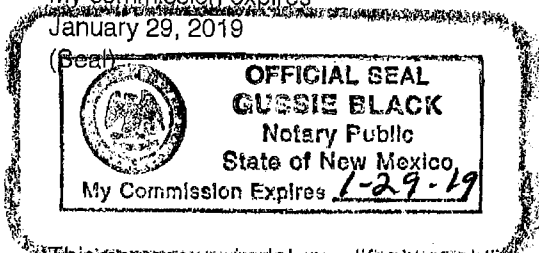

This newspaper is duly qualified to publish legal notices or advertisements within the meaning of Section 3, Chapter 167, Laws of 1937 and payment of fees for said

LEGALS

LEGAL NOTICE October 2, 2018

OWL SWD Operating, LLC, 8214 Westchester Dr., Suite 850, Dallas, Texas 75255, is filing Form C-108 (Application for Authorization to Inject) with the New Mexico Oil Conservation Division for administrative approval for its salt water disposal well Shoes Deep SWD No. 2. The proposed well will be located 1,115' FSL & 1,122' FWL in Section 29, Township 25S, Range 37E in Lea County, New Mexico. Disposal water will be sourced from area production, and will be injected into the Devonian-Silurian Formation (determined by offset log analysis) through an open hole completion between a maximum applied for top of 9,052 feet to a maximum depth of 10,826 feet. The maximum surface injection pressure will not exceed 1,810 psi with a maximum rate of 30,000 BWPD. Interested parties opposing the action must file objections or requests for hearing with the Oil Conservation Division, 1220 South St. Francis Drive, Santa Fe, New Mexico 87505, within 15 days. Additional information can be obtained from the applicant's agent, Lonquist & Co., LLC, at (512) 600-1774. #33275

67112661

00218894

LONQUIST & CO., LLC
12912 HILL COUNTRY BLVD, STE F200
AUSTIN, TX 78738