

My 4/24/2019
mm 4/26/2019

RECEIVED:	REVIEWER:	TYPE:	APP NO:
4/26/2019		SWD	PMA19119 41507

ABOVE THIS TABLE FOR OCD DIVISION USE ONLY

NEW MEXICO OIL CONSERVATION DIVISION
 - Geological & Engineering Bureau -
 1220 South St. Francis Drive, Santa Fe, NM 87505



ADMINISTRATIVE APPLICATION CHECKLIST

THIS CHECKLIST IS MANDATORY FOR ALL ADMINISTRATIVE APPLICATIONS FOR EXCEPTIONS TO DIVISION RULES AND REGULATIONS WHICH REQUIRE PROCESSING AT THE DIVISION LEVEL IN SANTA FE

Applicant: Delaware Energy, LLC	OGRID Number: 371195
Well Name: Wanderer State SWD #1	API: Pending
Pool: SWD; Devonian	Pool Code: 96101

SUBMIT ACCURATE AND COMPLETE INFORMATION REQUIRED TO PROCESS THE TYPE OF APPLICATION INDICATED BELOW

- 1) **TYPE OF APPLICATION:** Check those which apply for [A]
- A. Location - Spacing Unit - Simultaneous Dedication
 NSL NSP (PROJECT AREA) NSP (PRORATION UNIT) SD
- B. Check one only for [I] or [II]
- [I] Commingling - Storage - Measurement
 DHC CTB PLC PC OLS OLM
- [II] Injection - Disposal - Pressure Increase - Enhanced Oil Recovery
 WFX PMX SWD IPI EOR PPR

- 2) **NOTIFICATION REQUIRED TO:** Check those which apply.
- A. Offset operators or lease holders
 B. Royalty, overriding royalty owners, revenue owners
 C. Application requires published notice
 D. Notification and/or concurrent approval by SLO
 E. Notification and/or concurrent approval by BLM
 F. Surface owner
 G. For all of the above, proof of notification or publication is attached, and/or,
 H. No notice required

FOR OCD ONLY	
<input type="checkbox"/>	Notice Complete
<input type="checkbox"/>	Application Content Complete

3) **CERTIFICATION:** I hereby certify that the information submitted with this application for administrative approval is **accurate** and **complete** to the best of my knowledge. I also understand that **no action** will be taken on this application until the required information and notifications are submitted to the Division.

Note: Statement must be completed by an individual with managerial and/or supervisory capacity.

Sarah Presley

Print or Type Name

Signature

4/15/2019
Date

432-685-7005
Phone Number

s.presley@delawareenergy.com
e-mail Address

Delaware Energy, LLC
Application for Injection/SWD
Wanderer State SWD #1

UL M, Sec. 8, T-22-S, R-36-E, 905' FSL & 400' FWL, Lea Co., NM

April 15, 2019

Contents:

1. Administrative Application Checklist
2. Form C-108: Application for Authority to Inject
3. Form C-108 Additional Questions Answered
4. Form C-102 APR 26 2019 PM04:49
5. Chemical Analysis of Bone Spring Formation Water Sample
6. Chemical Analysis of Wolfcamp Formation Water Sample
7. Chemical Analysis of Delaware Formation Water Sample
8. Planned wellbore diagram for the Wanderer State SWD #1
9. ~~Tabular Data on All Wells of Public Record within the Area of Review which Penetrate the Proposed Injection Zone~~ (No applicable wells)
10. Map Identifying all Wells and Leases within Two Miles of Any Proposed Injection Well with a One Mile Radius Circle Drawn Around the Proposed Injection Well
11. Sample of Letter Sent with This Application Packet to Owner of Surface of the Land on Which the Well is to be Located and to each Leasehold Operator within One Mile of the Well Location
12. Formation Tops
13. Certified Mailers
14. Seismicity Assessment
15. Carlsbad Current-ARGUS Affidavit of publication

Delaware Energy, L.L.C.
405 N. Marienfeld, Suite 200
Midland, TX 79701
Office: (432) 685-7005

April 15, 2019

Surface Owner / Offset Operators

Re: Notification of Application for Authorization to Inject
Wanderer State SWD #1 Well

Ladies and Gentlemen:

Delaware Energy, LLC is seeking administrative approval to utilize the proposed Wanderer State SWD #1 as a commercial Salt Water Disposal well. As required by the New Mexico Oil Conservation Division Rules, we are notifying you of the following proposed salt water disposal well. This letter is a notice only. No action is required unless you have questions or objections.

<u>Well:</u>	Wanderer State SWD #1
<u>Proposed Disposal Zone:</u>	Devonian Formation (from 13,098' - 14,098')
<u>Location:</u>	905' FSL & 400' FWL, UL M, Sec. 8, T22S, R36E, Lea Co., NM
<u>Applicants Name:</u>	Delaware Energy, L.L.C.
<u>Applicants Address:</u>	405 N. Marienfeld, Suite 200, Midland, TX 79701

This application for water disposal well will be filed with the New Mexico Oil Conservation Division. If they determine the application complies with the applicable regulations, then it will be approved. The New Mexico Conservation Division address is 1220 South St. Francis Dr., Santa Fe, NM 87505. And their phone number is 505-476-3460.

Please call Sarah Presley with Delaware Energy, LLC if you have any questions at 432-685-7005.

Sincerely,

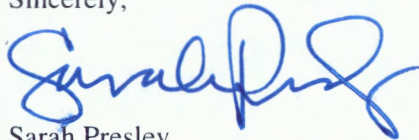

Sarah Presley

DISTRIBUTION LIST

Surface Owner:

State of New Mexico
310 Old Santa Fe Trail
Santa Fe NM 87501

Offset Operators/Leasehold Owners:

Blackbeard Operating, LLC
200 N Loraine St #300
Midland, TX 79701

Bruce A Wilbanks Co
P.O.Box 192
Sistersville, WV 26175

Cameron Oil & Gas Inc
300 W. 2nd St.
Roswell, NM 88201

ConocoPhillips Co.
PO Box 7500
Bartlesville, OK 74005-7500

Enervest Operating
1001 Fannin Street, Suite 800
Houston, TX 77002-6707

Mammoth Exploration LLC
200 N. Loraine, Ste #1100
Midland, TX 79101

Marjam Energy, LLC
8150 N. Central Expressway, Ste 1525
Dallas, TX 75206

The McDaniel Company, Inc.
12900 Preston Rd., Ste. 415
Dallas, TX 75230

Oxy USA WTP LP
6 Desta Dr. #6000
Midland, TX 79705-5505

Special Energy Corp
4815 S Perkins Rd
Stillwater, OK 74074

Special Exploration, LLC
PO Box 369
Stillwater, OK 74076-0369

Wiser Oil Co
P.O.Box 192
Sistersville, WV 26175

State of New Mexico Oil Conservation Division
District I
1625 N French Dr.
Hobbs, NM 88240

State of New Mexico Oil Conservation Division
1220 South St. Francis Dr.
Santa Fe, NM 87505

APPLICATION FOR AUTHORIZATION TO INJECT

- I. PURPOSE: _____ Secondary Recovery _____ Pressure Maintenance XXX Disposal _____ Storage
Application qualifies for administrative approval? XX Yes _____ No
- II. OPERATOR: Delaware Energy, LLC
ADDRESS: 405 North Marienfeld, Suite 250, Midland TX 79701
CONTACT PARTY: Mike McCurdy PHONE: 432-312-5251
- III. WELL DATA: Complete the data required on the reverse side of this form for each well proposed for injection.
Additional sheets may be attached if necessary.
- IV. Is this an expansion of an existing project? _____ Yes XXXX No
If yes, give the Division order number authorizing the project: _____
- V. Attach a map that identifies all wells and leases within two miles of any proposed injection well with a one-half mile radius circle drawn around each proposed injection well. This circle identifies the well's area of review.
- VI. Attach a tabulation of data on all wells of public record within the area of review which penetrate the proposed injection zone. Such data shall include a description of each well's type, construction, date drilled, location, depth, record of completion, and a schematic of any plugged well illustrating all plugging detail.
- VII. Attach data on the proposed operation, including:
1. Proposed average and maximum daily rate and volume of fluids to be injected;
 2. Whether the system is open or closed;
 3. Proposed average and maximum injection pressure;
 4. Sources and an appropriate analysis of injection fluid and compatibility with the receiving formation if other than reinjected produced water; and,
 5. If injection is for disposal purposes into a zone not productive of oil or gas at or within one mile of the proposed well, attach a chemical analysis of the disposal zone formation water (may be measured or inferred from existing literature, studies, nearby wells, etc.).
- *VIII. Attach appropriate geologic data on the injection zone including appropriate lithologic detail, geologic name, thickness, and depth. Give the geologic name, and depth to bottom of all underground sources of drinking water (aquifers containing waters with total dissolved solids concentrations of 10,000 mg/l or less) overlying the proposed injection zone as well as any such sources known to be immediately underlying the injection interval.
- IX. Describe the proposed stimulation program, if any.
- *X. Attach appropriate logging and test data on the well. (If well logs have been filed with the Division, they need not be resubmitted).
- *XI. Attach a chemical analysis of fresh water from two or more fresh water wells (if available and producing) within one mile of any injection or disposal well showing location of wells and dates samples were taken.
- XII. Applicants for disposal wells must make an affirmative statement that they have examined available geologic and engineering data and find no evidence of open faults or any other hydrologic connection between the disposal zone and any underground sources of drinking water.
- XIII. Applicants must complete the "Proof of Notice" section on the reverse side of this form.
- XIV. Certification: I hereby certify that the information submitted with this application is true and correct to the best of my knowledge and belief.
- NAME: Mike McCurdy TITLE: Vice-President
SIGNATURE:  DATE: 4/15/2019
E-MAIL ADDRESS: m.mccurdy@delawareenergy.com
- * If the information required under Sections VI, VIII, X, and XI above has been previously submitted, it need not be resubmitted. Please show the date and circumstances of the earlier submittal: _____

III. WELL DATA

A. The following well data must be submitted for each injection well covered by this application. The data must be both in tabular and schematic form and shall include:

- (1) Lease name; Well No.; Location by Section, Township and Range; and footage location within the section.
- (2) Each casing string used with its size, setting depth, sacks of cement used, hole size, top of cement, and how such top was determined.
- (3) A description of the tubing to be used including its size, lining material, and setting depth.
- (4) The name, model, and setting depth of the packer used or a description of any other seal system or assembly used.

Division District Offices have supplies of Well Data Sheets which may be used or which may be used as models for this purpose. Applicants for several identical wells may submit a "typical data sheet" rather than submitting the data for each well.

B. The following must be submitted for each injection well covered by this application. All items must be addressed for the initial well. Responses for additional wells need be shown only when different. Information shown on schematics need not be repeated.

- (1) The name of the injection formation and, if applicable, the field or pool name.
- (2) The injection interval and whether it is perforated or open-hole.
- (3) State if the well was drilled for injection or, if not, the original purpose of the well.
- (4) Give the depths of any other perforated intervals and detail on the sacks of cement or bridge plugs used to seal off such perforations.
- (5) Give the depth to and the name of the next higher and next lower oil or gas zone in the area of the well, if any.

XIV. PROOF OF NOTICE

All applicants must furnish proof that a copy of the application has been furnished, by certified or registered mail, to the owner of the surface of the land on which the well is to be located and to each leasehold operator within one-half mile of the well location.

Where an application is subject to administrative approval, a proof of publication must be submitted. Such proof shall consist of a copy of the legal advertisement which was published in the county in which the well is located. The contents of such advertisement must include:

- (1) The name, address, phone number, and contact party for the applicant;
- (2) The intended purpose of the injection well; with the exact location of single wells or the Section, Township, and Range location of multiple wells;
- (3) The formation name and depth with expected maximum injection rates and pressures; and,
- (4) A notation that interested parties must file objections or requests for hearing with the Oil Conservation Division, 1220 South St. Francis Dr., Santa Fe, New Mexico 87505, within 15 days.

NO ACTION WILL BE TAKEN ON THE APPLICATION UNTIL PROPER PROOF OF NOTICE HAS BEEN SUBMITTED.

NOTICE: Surface owners or offset operators must file any objections or requests for hearing of administrative applications within 15 days from the date this application was mailed to them.

INJECTION WELL DATA SHEET

OPERATOR: Delaware Energy, LLC

WELL NAME & NUMBER: Wanderer State SWD # 1

WELL LOCATION: 905' FSL & 400' FWL M 8 SECTION 22S TOWNSHIP 36E RANGE
FOOTAGE LOCATION UNIT LETTER

WELLBORE SCHEMATIC see attached wellbore sketch

WELL CONSTRUCTION DATA

Surface Casing

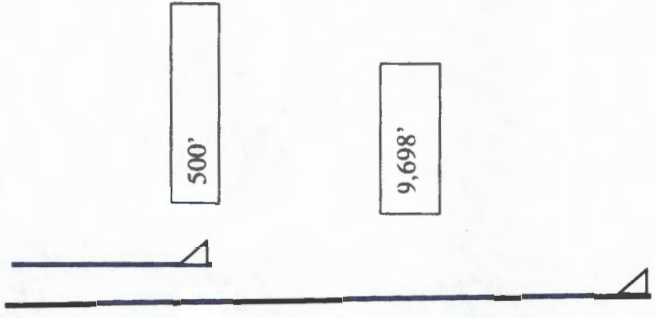

Hole Size: 17-1/2" Casing Size: 13-3/8", 54.5#
Cemented with: 500 sx. or ft³

Top of Cement: surface Method Determined: Plan to Circulate

Intermediate Casing

Hole Size: 12-1/4" Casing Size: 9-5/8", 47#, L-80
Cemented with: 2,500' sx. or ft³

Top of Cement: surface Method Determined: Plan to Circulate

Production Casing

Hole Size: 8-1/2" Casing Size: 7-5/8", 39#, P-110
Cemented with: 650 sx. or ft³

Top of Cement: Top of Liner Method Determined: Plan to Circulate to liner top

Total Depth: 13,098'

Injection Interval

13,098' feet to 14,098'
(OPEN HOLE)

INJECTION WELL DATA SHEET

Tubing Size: 5.5" BTC x 5.5" Flush Joint Lining Material: Fiber Glass

Type of Packer: Weatherford Arrow Set IX

Packer Setting Depth: 13,048'

Other Type of Tubing/Casing Seal (if applicable): none

Additional Data

- 1. Is this a new well drilled for injection? XXXXX Yes No
 If no, for what purpose was the well originally drilled? N/A

2. Name of the Injection Formation: Devonian

3. Name of Field or Pool (if applicable): SWD; Devonian

4. Has the well ever been perforated in any other zone(s)? List all such perforated intervals and give plugging detail, i.e. sacks of cement or plug(s) used. N/A

5. Give the name and depths of any oil or gas zones underlying or overlying the proposed injection zone in this area: _____

Below: none

Next Higher: Delaware 6,398' - 7,798'; Bone Springs 7,798' - 9,698'; Wolfcamp 9,698' - 9,998'; Strawn 9,998' - 10,398'; Atoka 10,398' - 10,998'; Morrow 10,998' - 12,298'

Additional Questions on C-108

VII.

1. Proposed average and maximum daily rate and volume of fluids to be injected;

Average 15,000-20,000 BWP/D, Max 25,000 BWP/D

2. Whether the system is open or closed;

Open System, Commercial SWD

3. Proposed average and maximum injection pressure;

Average 1,500-2,500 PSI, Max 2,620 PSI

4. Sources and an appropriate analysis of injection fluid and compatibility with the receiving formation if other than reinjected produced water; and,

Bone Spring, Delaware, and Wolfcamp produced water. No known incompatibility exists with these produced water types and the Devonian. Devonian formation is used as a disposal interval throughout the Delaware Basin for Wolfcamp, Bone Springs, and Delaware produced water. See attached water analysis from Bone Spring, Wolfcamp, and Delaware produced water.

5. If injection is for disposal purposes into a zone not productive of oil or gas at or within one mile of the proposed well, attach a chemical analysis of the disposal zone formation water (may be measured or inferred from existing literature, studies, nearby wells, etc.).

See attached Lea County Devonian water samples

***VIII. Attach appropriate geologic data on the injection zone including appropriate lithologic detail, geologic name, thickness, and depth. Give the geologic name, and depth to bottom of all underground sources of drinking water (aquifers containing waters with total dissolved solids concentrations of 10,000 mg/l or less) overlying the proposed injection zone as well as any such sources known to be immediately underlying the injection interval.**

The proposed disposal interval is in the Devonian formation 13,098'-14,098'. Devonian is an impermeable organic shale at the very top (12,848 ft, Woodford Shale) 100ft thick followed by permeable lime, dolomite, and small amount of shale 1000ft thick. There are no fresh water zones underlying the proposed injection zone. Usable water depth is from surface to +/- 140', the water source is older alluvium (Quaternary). All the fresh water wells in the area have an average depth to water of 177ft per State Engineer.

IX. Describe the proposed stimulation program, if any.

60,000 gallons 20% HCL acid job with packer

X. Attach appropriate logging and test data on the well

Mud log will be filed after the well has been drilled. All cased hole and open hole Logs will be filed following drilling operations.

XI. Attach a chemical analysis of fresh water from two or more fresh water wells (if available and producing) within one mile of any injection or disposal well showing location of wells and dates samples were taken.

Attached is a water sample taken from 32.447640, -103.293997

XII. Applicants for disposal wells must make an affirmative statement that they have examined available geologic and engineering data and find no evidence of open faults or any other hydrologic connection between the disposal zone and any underground sources of drinking water.

Delaware Energy, L.L.C. has reviewed and examined available geologic and engineering data in the area of interest for the Wanderer State SWD #1 and have found no evidence of faults or other hydrologic connections between Devonian disposal zone and the underground sources of drinking water. Furthermore, there exist many impermeable intervals between the injection interval and the fresh ground water from the top of the Devonian Carbonate and the base of the ground water.

Mike McCurdy **Vice President** **4/15/2019**
 _____ Title _____ Date _____

III. WELL DATA

(1) Lease name; Well No.; Location by Section, Township and Range; and footage location within the section.
 Wanderer State SWD #1, Sec. 8-T22S-R36E, 905' FSL & 400' FWL, UL M, Lea County, New Mexico

(2) Each casing string used with its size, setting depth, sacks of cement used, hole size, top of cement, and how such top was determined.

Casing Size	Setting Depth	Sacks of Cement	Hole Size	Top of Cement	Determined
13-3/8"	500'	500	17-1/2"	Surface	CIRC
9-5/8"	9,698'	2500	12-1/4"	Surface	CIRC
7-5/8"	8,498'-13,098'	650	8-1/2"	Liner Top	CIRC & CBL

(3) A description of the tubing to be used including its size, lining material, and setting depth.
 5-1/2" BTC X 5-1/2" Flush Joint, Internally Fiber Glass Coated Tubing set 50 to 100ft above open hole

(4) The name, model, and setting depth of the packer used or a description of any other seal system or assembly used.
 Weatherford Arrow Set 1X injection packer, nickel plated with on/off tool

B. The following must be submitted for each injection well covered by this application. All items must be addressed for the initial well. Responses for additional wells need be shown only when different. Information shown on schematics need not be repeated.

(1) The name of the injection formation and, if applicable, the field or pool name.
 Devonian Formation
 Pool Name: SWD (Devonian)

(2) The injection interval and whether it is perforated or open-hole.
 13,098' to 14,098' (Open hole)

(3) State if the well was drilled for injection or, if not, the original purpose of the well.
 Well is a planned new drill for SWD

(4) Give the depths of any other perforated intervals and detail on the sacks of cement or bridge plugs used to seal off such perforations.

None, well is a planned new drill

(5) Give the depth to and the name of the next higher and next lower oil or gas zone in the area of the well, if any.

Next Higher: Delaware 6,398' – 7,798'; Bone Springs 7,798' – 9,698'; Wolfcamp 9,698' – 9,998';
Strawn 9,998' – 10,398'; Atoka 10,398' – 10,998'; Morrow 10,998' – 12,298'

Next Lower: None

DISTRICT I
1825 N. French Dr., Hobbs, NM 88240
Phone (575) 393-8181 Fax: (575) 393-9720

DISTRICT II
811 S. First St., Artesia, NM 88210
Phone (575) 748-1283 Fax: (575) 748-9720

DISTRICT III
1000 Rio Brazos Rd., Artec, NM 87410
Phone (505) 354-8178 Fax: (505) 354-8179

DISTRICT IV
1220 S. St. Francis Dr., Santa Fe, NM 87505
Phone (505) 478-3480 Fax: (505) 478-3482

State of New Mexico
Energy, Minerals and Natural Resources Department

Form C-102
Revised August 1, 2011

Submit one copy to appropriate
District Office

OIL CONSERVATION DIVISION
1220 South St. Francis Dr.
Santa Fe, New Mexico 87505

WELL LOCATION AND ACREAGE DEDICATION PLAT

AMENDED REPORT

API Number	Pool Code 96101	Pool Name SWD; DEVONIAN
Property Code	Property Name WANDERER STATE SWD	Well Number 1
OGRID No. 371195	Operator Name DELAWARE ENERGY	Elevation 3598'

Surface Location

UL or lot No.	Section	Township	Range	Lot Idn	Feet from the	North/South line	Feet from the	East/West line	County
M	8	22 S	36 E		905	SOUTH	400	WEST	LEA

Bottom Hole Location If Different From Surface

UL or lot No.	Section	Township	Range	Lot Idn	Feet from the	North/South line	Feet from the	East/West line	County
Dedicated Acres		Joint or Infill		Consolidation Code		Order No.			

NO ALLOWABLE WILL BE ASSIGNED TO THIS COMPLETION UNTIL ALL INTERESTS HAVE BEEN CONSOLIDATED
OR A NON-STANDARD UNIT HAS BEEN APPROVED BY THE DIVISION

N: 515736.1 E: 861489.6 (NAD83)	N: 515789.5 E: 864095.9 (NAD83)	N: 515803.2 E: 866733.4 (NAD83)
<p>SURFACE LOCATION Lat - N 32.401638° Long - W 103.294636° NMSPC - N 511404.6 E 861917.4 (NAD-83)</p>		
400'		
905'		
N: 510498.6 E: 866803.5 (NAD83)		N: 510513.9 E: 866803.5 (NAD83)

OPERATOR CERTIFICATION

I hereby certify that the information contained herein is true and complete to the best of my knowledge and belief, and that this organization either owns a working interest or unleased mineral interest in the land including the proposed bottom hole location or has a right to drill this well at this location pursuant to a contract with an owner of such a mineral or working interest, or to a voluntary pooling agreement or a compulsory pooling order heretofore entered by the division.

Sarah Presley 4-15-19
Signature Date

Sarah Presley
Printed Name

s.presley@delawareenergy.com
Email Address

SURVEYOR CERTIFICATION

I hereby certify that the well location shown on this plat was plotted from field notes of actual surveys made by me or under my supervision, and that the same is true and correct to the best of my belief.

FEBRUARY 20 2019
Date Surveyed

Gary L. Jones
Signature & Seal of Professional Surveyor

GARY L. JONES 7977
Certificate No. 7977
BASIN SURVEYS

0' 1000' 2000' 3000' 4000'
SCALE: 1" = 2000'
WO Num.: 34326

SECTION 8, TOWNSHIP 22 SOUTH, RANGE 36 EAST, N.M.P.M.,
LEA COUNTY, NEW MEXICO.

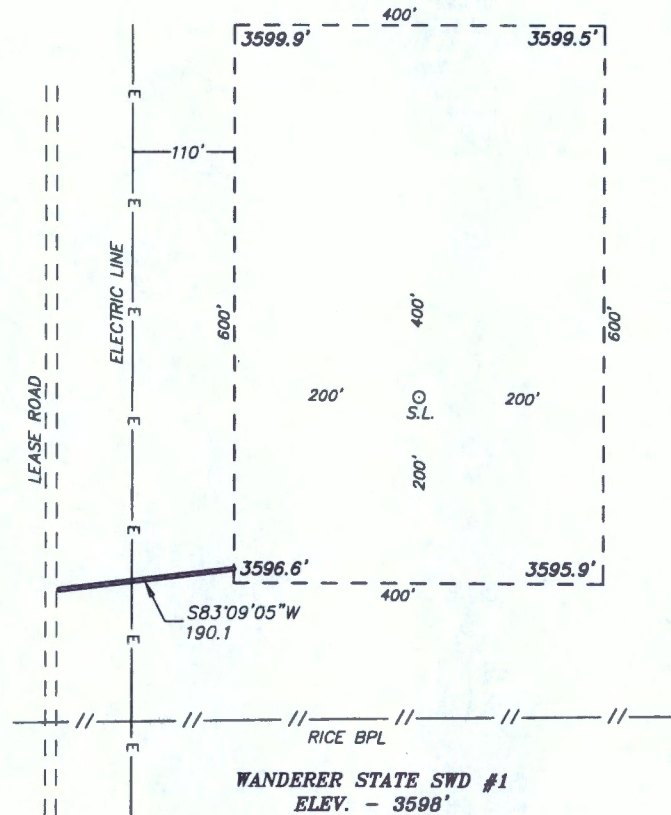

WANDERER STATE SWD #1
ELEV. - 3598'

Lat - N 32.401638°
Long - W 103.294636°
NMSPCE- N 511404.6
E 861917.4
(NAD-83)

EUNICE, NM IS ±8 MILES TO THE NORTHEAST OF LOCATION.

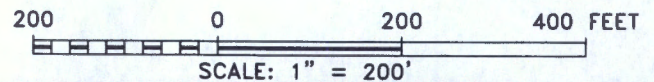

DELAWARE ENERGY

REF: WANDERER STATE SWD #1 / WELL PAD TOPO

THE WANDERER STATE SWD #1 LOCATED 905' FROM
THE SOUTH LINE AND 400' FROM THE WEST LINE OF
SECTION 8, TOWNSHIP 22 SOUTH, RANGE 36 EAST.

N.M.P.M., LEA COUNTY, NEW MEXICO.



focused on excellence in the oilfield
P.O. Box 1786
1120 N. West County Rd.
Hobbs, New Mexico 88241
(575) 393-7316 - Office
(575) 392-2206 - Fax
basinsurveys.com

**SECTION 8, TOWNSHIP 22 SOUTH, RANGE 36 EAST, N.M.P.M.,
LEA COUNTY, NEW MEXICO.**

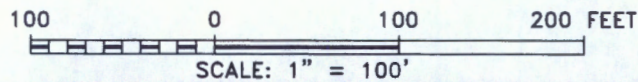
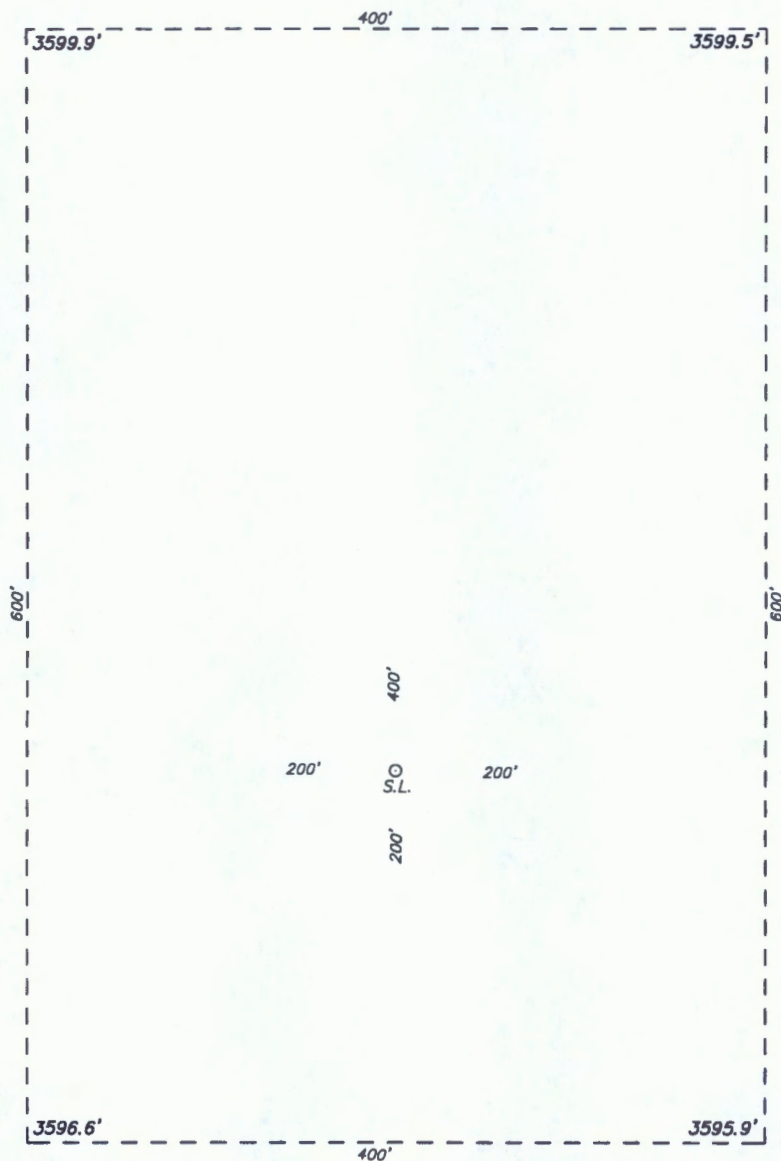

DELAWARE ENERGY

REF: WANDERER STATE SWD #1 / WELL PAD TOPO

THE WANDERER STATE SWD #1 LOCATED 905' FROM
THE SOUTH LINE AND 400' FROM THE WEST LINE OF
SECTION 8, TOWNSHIP 22 SOUTH, RANGE 36 EAST.

N.M.P.M., LEA COUNTY, NEW MEXICO.

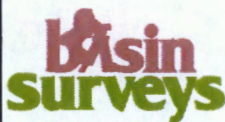

focused on excellence in the oilfield
P.O. Box 1786
1120 N. West County Rd.
Hobbs, New Mexico 88241
(575) 393-7316 - Office
(575) 392-2206 - Fax
basinsurveys.com

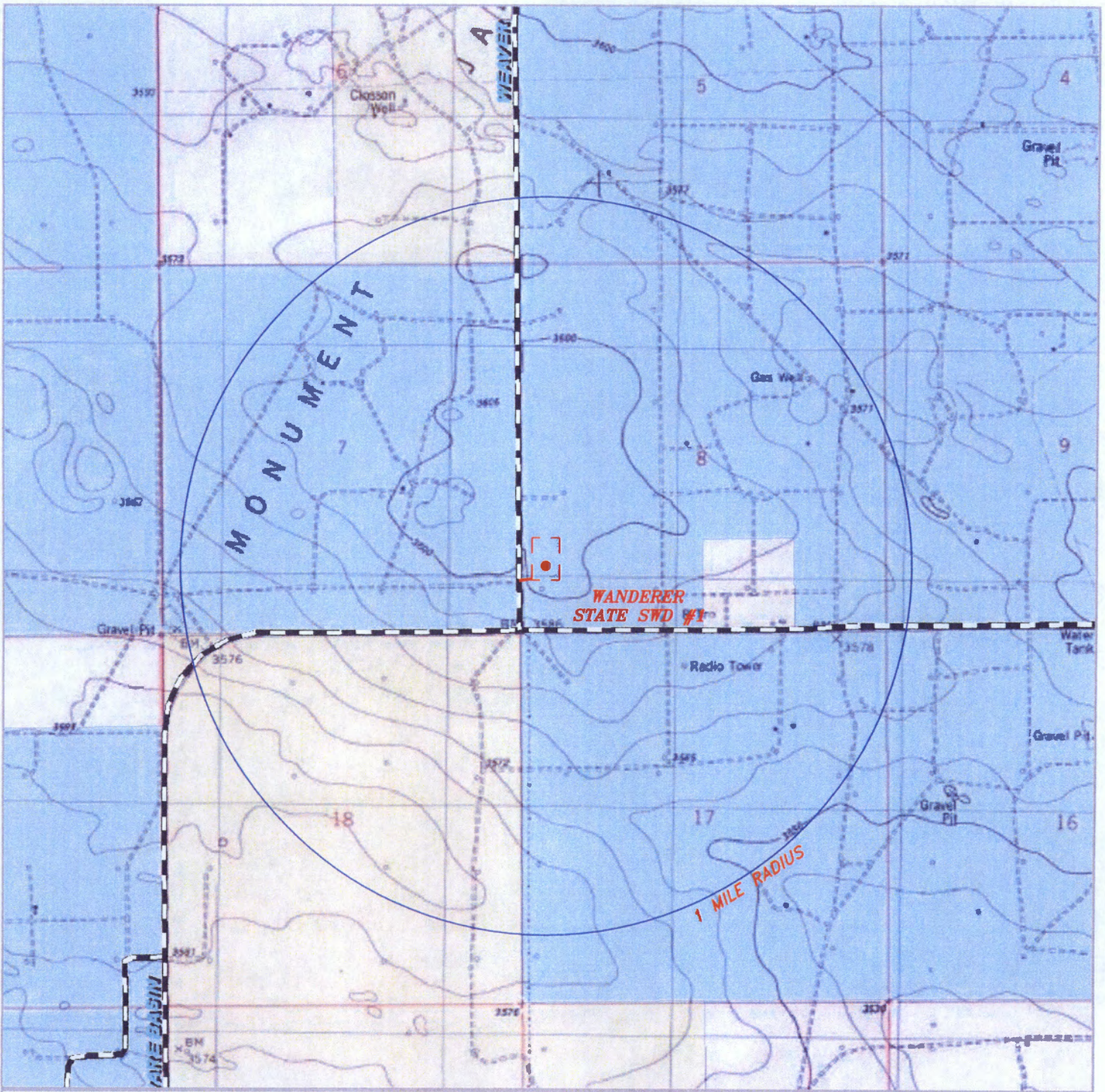

WANDERER STATE SWD #1

Located 905' FSL and 400' FWL
 Section 8, Township 22 South, Range 36 East,
 N.M.P.M., Lea County, New Mexico.



P.O. Box 1786
 1120 N. West County Rd.
 Hobbs, New Mexico 88241
 (575) 393-7316 - Office
 (575) 392-2206 - Fax
 basinsurveys.com

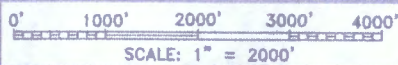

W.O. Number: JG 34326

Survey Date: 2-8-2019

YELLOW TINT - USA LAND
 BLUE TINT - STATE LAND
 NATURAL COLOR - FEE LAND



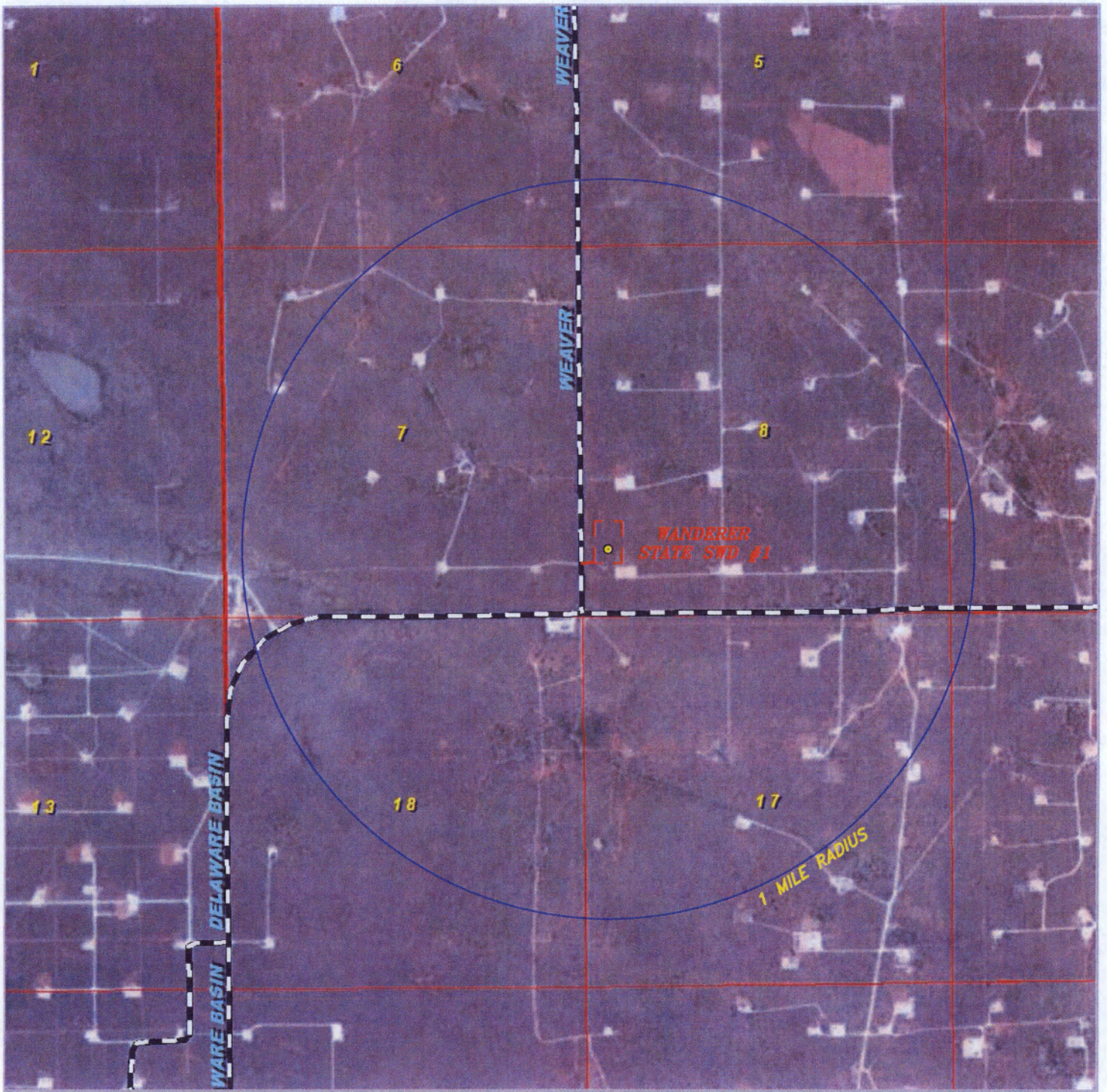

**DELAWARE
 ENERGY**



WANDERER STATE SWD #1

Located 905' FSL and 400' FWL
 Section 8, Township 22 South, Range 36 East,
 N.M.P.M., Lea County, New Mexico.

 <p>focused on excellence in the oilfield</p>	P.O. Box 1786 1120 N. West County Rd. Hobbs, New Mexico 88241 (575) 393-7316 - Office (575) 392-2206 - Fax basinsurveys.com	0' 1000' 2000' 3000' 4000' SCALE: 1" = 2000'	 <p>DELAWARE ENERGY</p>
	W.O. Number: JG 34326	Survey Date: 2-8-2019	
	YELLOW TINT - USA LAND BLUE TINT - STATE LAND NATURAL COLOR - FEE LAND		

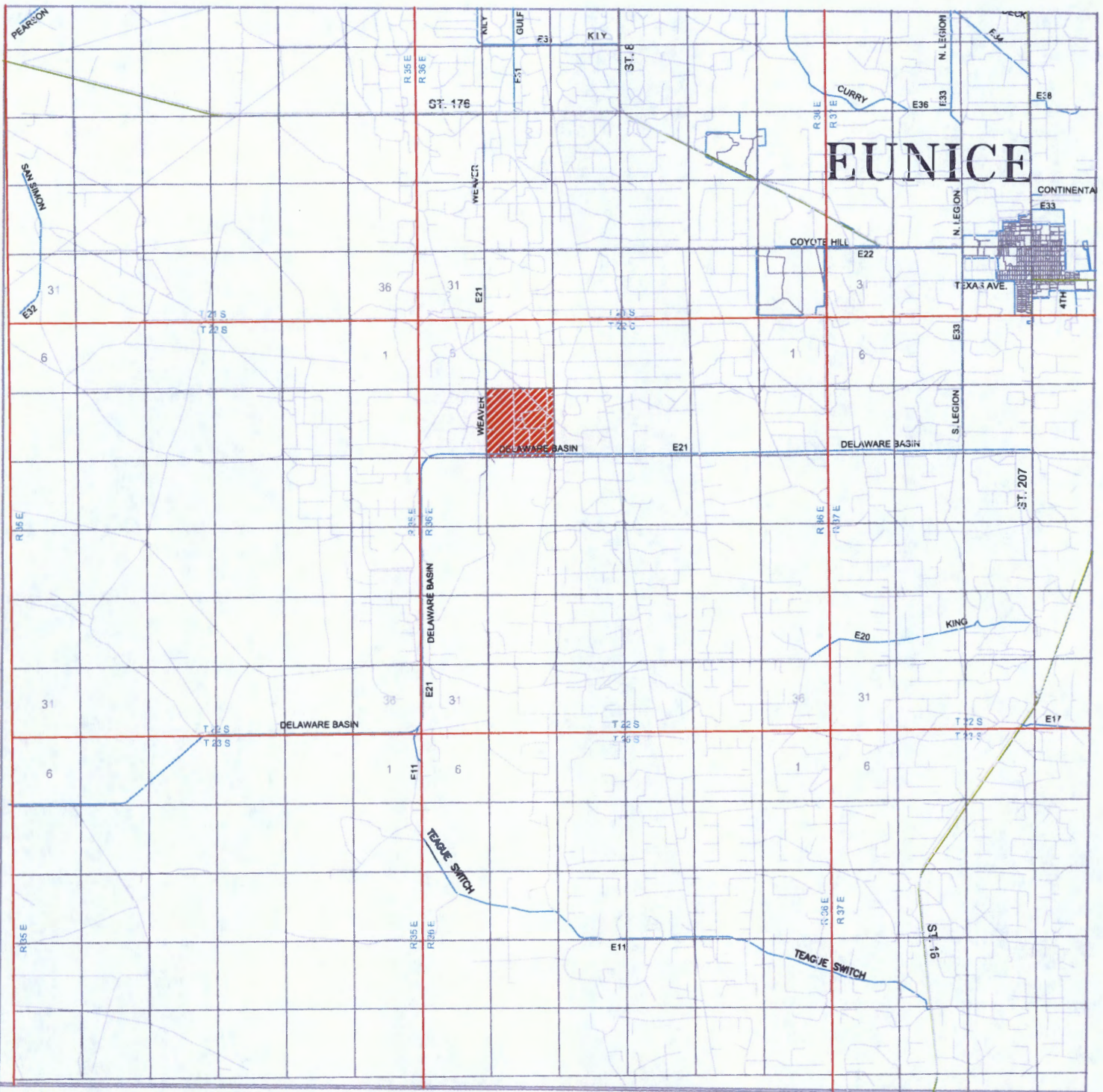

WANDERER STATE SWD #1

Located 905' FSL and 400' FWL
 Section 8, Township 22 South, Range 36 East,
 N.M.P.M., Lea County, New Mexico.



P.O. Box 1786
 1120 N. West County Rd.
 Hobbs, New Mexico 88241
 (575) 393-7316 - Office
 (575) 392-2206 - Fax
 basinsurveys.com



SCALE: 1" = 2000'

W.O. Number: JG 34326

Survey Date: 2-8-2019

YELLOW TINT - USA LAND
 BLUE TINT - STATE LAND
 NATURAL COLOR - FEE LAND



**DELAWARE
 ENERGY**

SECTION 8, TOWNSHIP 22 SOUTH, RANGE 36 EAST, N.M.P.M.,
LEA COUNTY, NEW MEXICO.

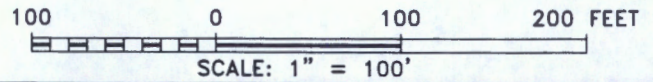
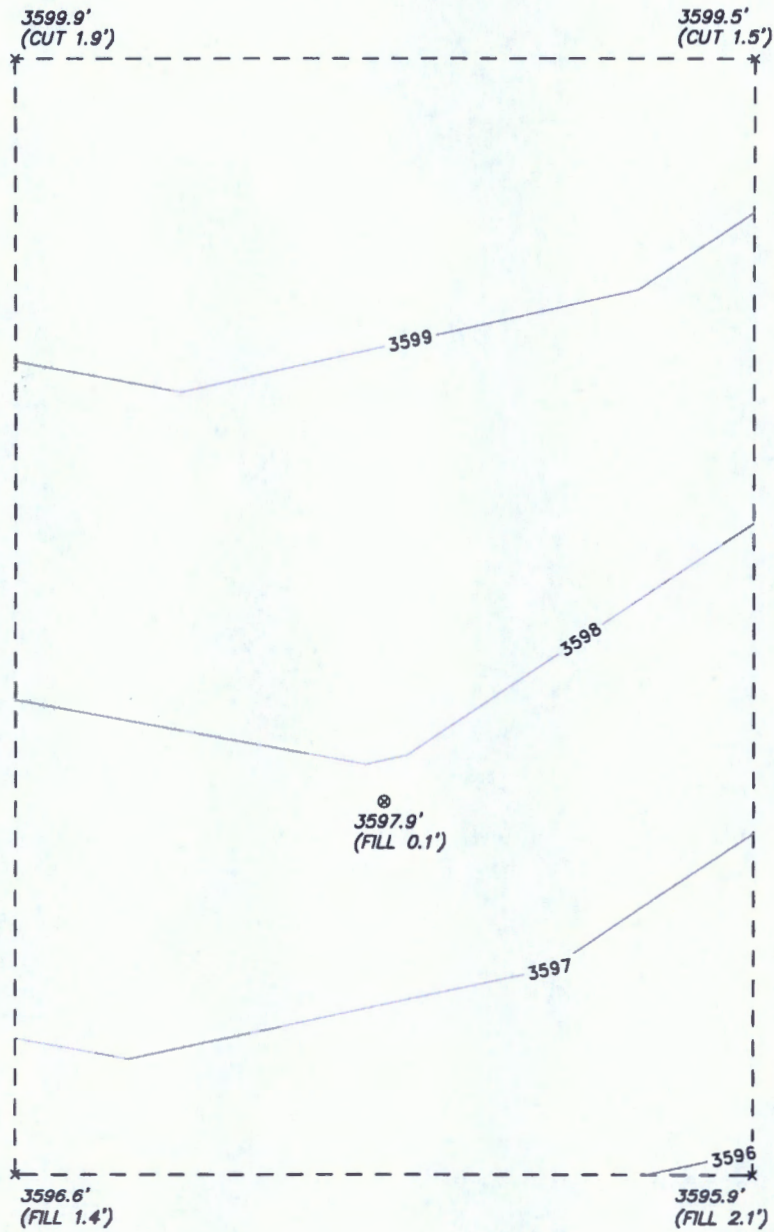

DELAWARE ENERGY

REF: WANDERER STATE SWD #1 / CUT & FILL

THE WANDERER STATE SWD #1 LOCATED 905' FROM
THE SOUTH LINE AND 400' FROM THE WEST LINE OF
SECTION 8, TOWNSHIP 22 SOUTH, RANGE 36 EAST.

N.M.P.M., LEA COUNTY, NEW MEXICO.



focused on excellence in the oilfield
P.O. Box 1786
1120 N. West County Rd.
Hobbs, New Mexico 88241
(575) 393-7316 - Office
(575) 392-2206 - Fax
basinsurveys.com

Water Analysis - Disposal Zone - DEVONIAN

NM WAIDS DATA				
S-T-R	FIELD	FORMATION	TDS	CHLRD
24-23S-29E	REMUDA	DEVONIAN	64582	37500
24-23S-29E	REMUDA	DEVONIAN	56922	29000
06-23S-34E	BELL LAKE NORTH	DEVONIAN	71078	42200
34-23S-34E	ANTELOPE RIDGE	DEVONIAN	80187	47900

Water Analysis - Source Zone - BONE SPRING



Laboratory Analysis
Endurance

Sample Date: 1/31/2014

Requested by: T. Ratliff

Jazzmaster 17 State #4H

Lea Co, NM

		Water Analysis Measurements		Cations (+)		Anions (-)	
				mg/L		mg/L	
Oxygen (mg/L)	100	Oil in Water (ppm)	NA	Barium (Ba)	0	Carbonate (CO ₃)	0
Carbon Dioxide (mg/L)	009 MB	Specific Gravity	1.150	Calcium (Ca)	18.640	Bicarbonate (HCO ₃)	16.00
Hydrogen Sulfide (mg/L)	0.0	Total Dissolved Solids (TDS)	(mg/L) _{25°C}	Magnesium (Mg)	380	Chloride (mg/L)	118.520
pH	5.7	Total Hardness (mg/L)	180.000	Sulfate (SO ₄)	34.270	Sulfide (SO ₂)	319
Temperature °F	73			Iron (Fe)	1.00		
				Manganese (Mn)	0.00		

Water Analysis - Source Zone - DELAWARE

PO BOX 11810
HOUSTON, TEXAS 77210
PH 281.276.1818 FAX 281.276.1810

Martin Water Laboratories, Inc.

PH 817.488.2222
PO BOX 171441 DALLAS, TEXAS 75217
PHONE 972.482.1121

RESULT OF WATER ANALYSIS

TO: Mr. Joe Small LABORATORY NO: 99293
P.O. Box 11810, Houston, TX 77210 SAMPLE RECEIVED: 9-18-92
 RESULTS REPORTED: 9-18-92

COMPANY: Meridian Oil Company LEASE: Digger Lake #1

FIELD OR POOL: Wildcat

SECTION: _____ BLOCK: _____ SURVEY: _____ COUNTY: Lea STATE: NM

SOURCE OF SAMPLE AND DATE TAKEN: _____

NO 1: Recovered water - taken from Digger Lake #1. 9-9-92

NO 2: _____

NO 3: _____

NO 4: _____

REMARKS: Delaware

	CHEMICAL AND PHYSICAL PROPERTIES			
	NO. 1	NO. 2	NO. 3	NO. 4
Specific Gravity at 20°C	1.1462			
pH at 20°C				
Temperature (°C)		8.26		
Temperature at 20°C	1.48			
Temperature at 25°C				
Total Hardness at 25°C	50.500			
Calcium as Ca	18.000			
Magnesium as Mg	1.336			
Sulfate as SO ₄	68.883			
Chloride as Cl	94.7			
Iron as Fe	140.618			
Manganese as Mn	90.0			
Barium as Ba				
Strontium as Sr				
Fluoride as F				
Total Solids (mg/L)	229.531			
Total Solids (mg/L)				
Carbon Dioxide (mg/L)				
Dissolved Oxygen (mg/L)				
Hydrogen Sulfide (mg/L)	0.0			
Residual Chlorine (mg/L)	0.033			
Residual Chlorine (mg/L)				
Total Dissolved Solids @ 180°C	184.361			



P.O. Box 3394, Midland, Texas 79702
 Phone (432) 684-4233 Fax (432) 684-4277

Water Analysis

Code 214059		Sample Information	
Client Information		Lease/Well: Wanderer SWD/1	
Delaware Energy County:	Lea	Sample Point:	
Rep:	Derrick Boutwell	Date Sampled:	03/14/2019
		Date Reported:	03/19/2019

Results

Cations

Ion	Concentration(mg/L)
Barium (as Ba)	0
Calcium (as Ca)	14
Iron (as Fe)	0
Sodium (as Na)	36
Magnesium (as Mg)	2

Other Measurements

Measurement	Value
pH	9.03
SG	0.999
Turbidity	34
CO ₂	
Total Dissolved Solids	316.000

Anions

Ion	Concentration(mg/L)
Chlorides (as Cl)	42
Sulfate (as SO ₄)	27
Carbonate (as CO ₃)	0
Bicarbonates (as HCO ₃)	195
Sulfide (as S ²⁻)	0

Scaling Indices

Temp(F)	CaCO ₃	CaSO ₄ *2H ₂ O	CaSO ₄	BaSO ₄
80	1.0721	0.0000	0.0000	-27.3467
120	1.3711	0.0000	0.0000	-27.5527
160	1.6892	0.0000	0.0000	-27.6571
200	1.9778	0.0000	0.0000	-27.7051
250	2.2502	0.0000	0.0000	-27.7528

Low = < 0.200, Moderate = 0.200-0.999, High = > 1.00

Comments

32.447640-103.293997.

Wanderer State SWD # 1

API # PENDING
905' FSL & 400' FWL, Sec. 8, T22S, R36E, UL "M"
LEA COUNTY, NEW MEXICO

ELEVATION:
GL: 3,598'

PROPOSED WELLBORE

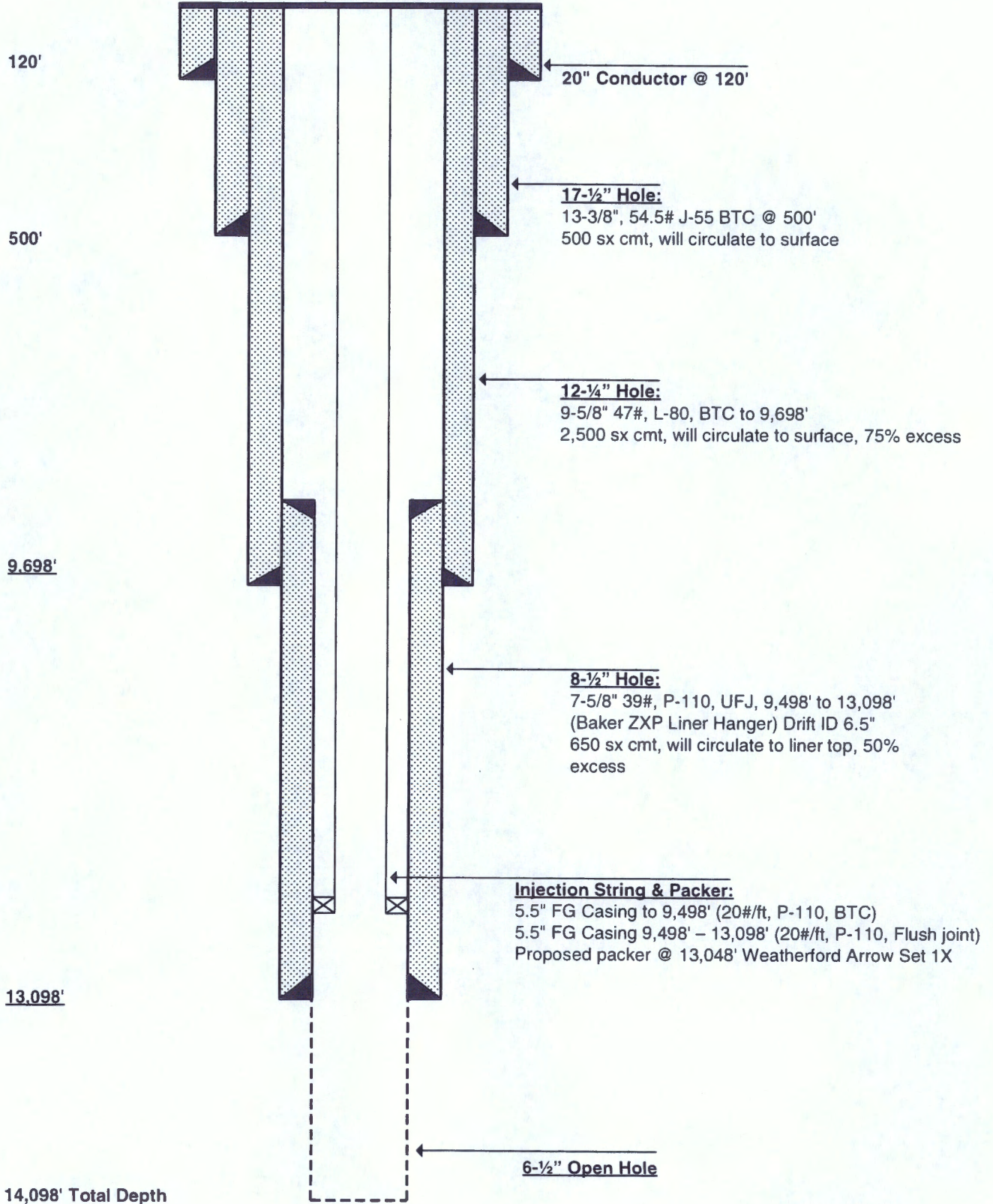

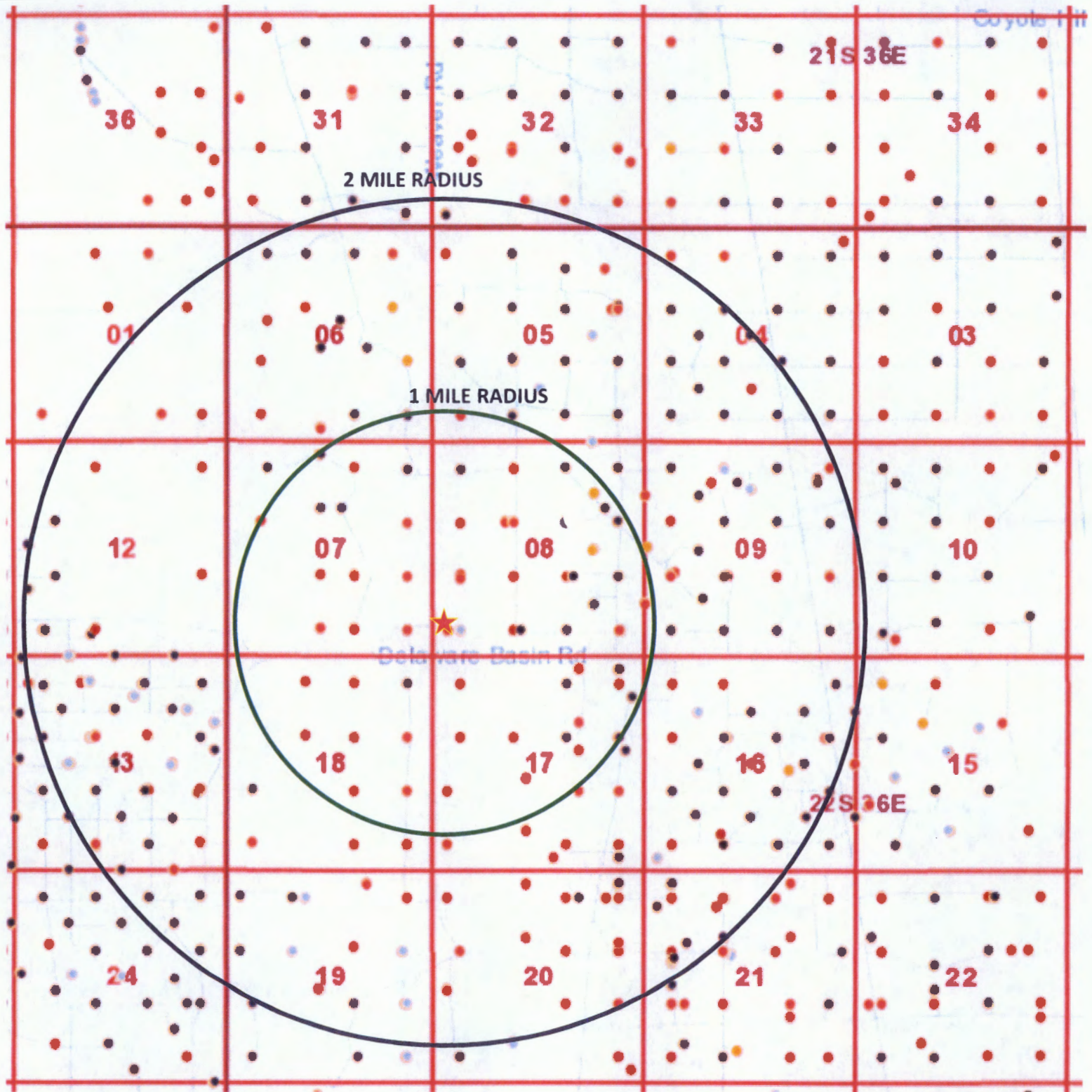

WELLS – ONE MILE RADIUS

NO WELLS PENETRATE THE DEVONIAN FORMATION IN THE AOR

SECTION 8-T22S-R36E

★ Wanderer State SWD #1
 (Proposed Location)
 Delaware Energy, LLC

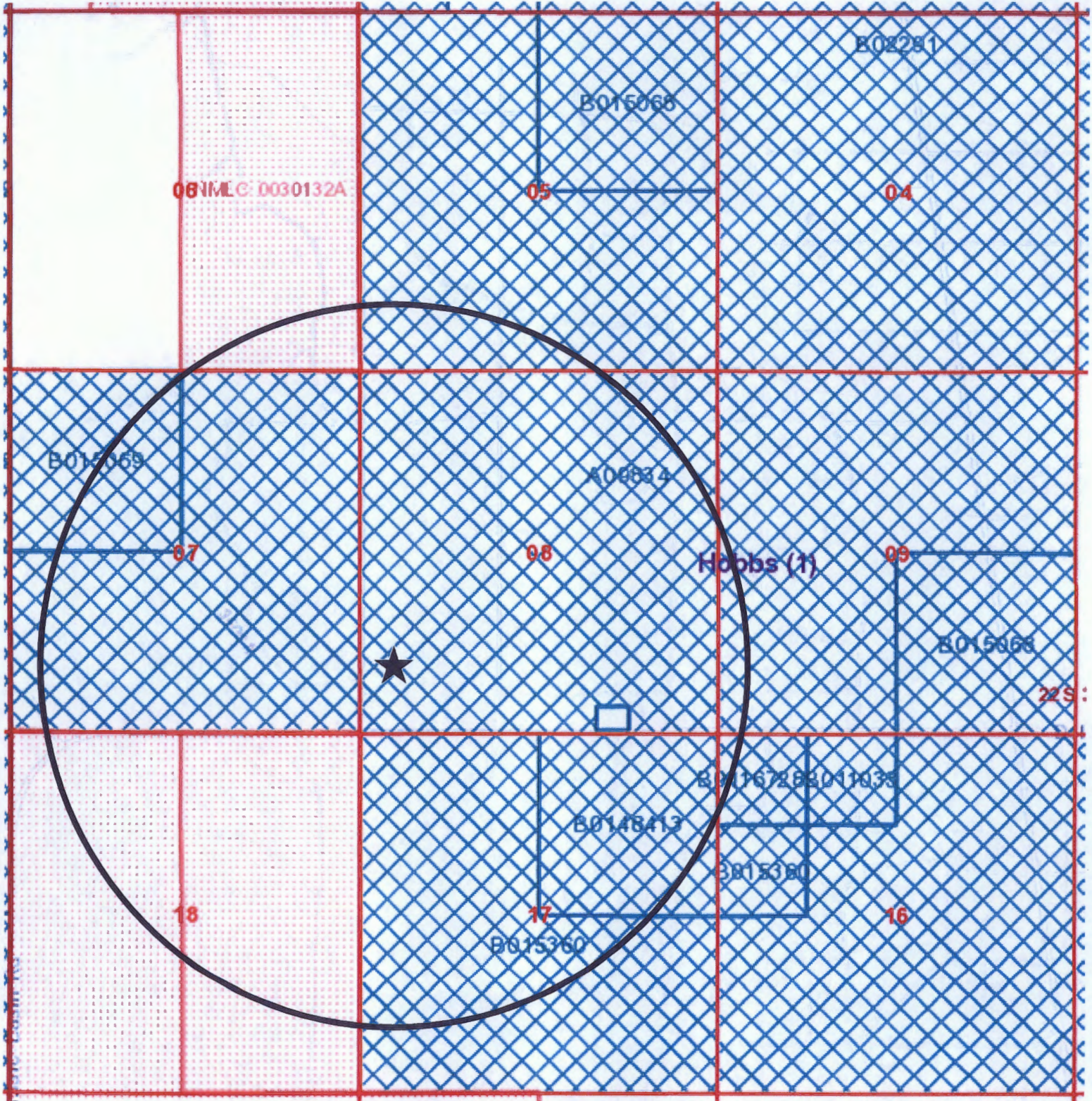

OB IMLC: D030132A

B01281

B015068

05

04

B015069

B06834

07

08

Hobbs (1)

09

B015068

22 S

18

17

B0167284011035

B0148413

B015380

16

B015360

LEASES – ONE MILE RADIUS

★ Wanderer State SWD #1
 Sec. 8-T22S-R36E
 Lea Co. NM

Wanderer State SWD #1

LEASES – ONE MILE RADIUS

Section 5, T22S-R36E

State Lease

- **Blackbeard Operating, LLC**
200 N Loraine St #300
Midland, TX 79701

Section 6, T22S-R36E

Federal Lease

- **Mammoth Exploration LLC**
200 N. Loraine, Ste #1100
Midland, TX 79101

Section 7, T22S-R36E

State Lease

- **Blackbeard Operating, LLC**
200 N Loraine St #300
Midland, TX 79701
- **Cameron Oil & Gas Inc & (Lessee)**
300 W. 2nd St.
Roswell, NM 88201

Section 8, T22S-R36E

State Lease

- **Blackbeard Operating, LLC**
200 N Loraine St #300
Midland, TX 79701

Section 9, T22S-R36E

State Lease

- **Blackbeard Operating, LLC**
200 N Loraine St #300
Midland, TX 79701

Section 16, T22S-R36E

State Lease

- **Bruce A Wilbanks Co (Lessee)**
P.O.Box 192
Sistersville, WV 26174

- **Wiser Oil Co (Lessee)**
P.O.Box 192
Sistersville, WV 26174

Section 17, T22S-R36E

- State Lease
- **Special Energy Corp**
4815 S Perkins Rd
Stillwater, OK 74074
- **Enervest Operating**
1001 Fannin Street, Suite 800
Houston, TX 77002-6707
- **ConocoPhillips Co. (Lessee)**
PO Box 7500
Bartlesville, OK 74005-7500
- **The McDaniel Company, Inc.**
12900 Preston Rd., Ste. 415
Dallas, TX 75230
- **Marjam Energy, LLC**
8150 N. Central Expressway, Ste 1525
Dallas, TX 75206
- **Special Exploration, LLC**
PO Box 369
Stillwater, OK 74076-0369

Section 18, T22S-R36E

- Federal Leases (NMNM 0030132A & NMNM 0030132B)
- **Oxy USA WTP LP & (Lessee)**
6 Desta Dr. #6000
Midland, TX 79705-5505

Wanderer State SWD #1
Location: 905' FSL & 400' FWL
Sec. 8, T-22-S, R-36-E

Estimated Pre-Drill Formation Tops

Top of Salt	1,398'
Base Salt	3,098'
Delaware Mountain Group	6,398'
Bone Spring/Abo	7,798'
Wolfcamp	9,698'
Strawn	9,998'
Atoka	10,398'
Morrow	10,998'
Barnett	11,998'
Mississippian	12,298'
Woodford	12,848'
Devonian	13,098'

Statement Regarding Seismicity and Well Location (Wanderer State SWD #1)

Historically, the area near the proposed Wanderer State SWD #1 has not seen any major seismic activity. There have been two seismic events (as per public data available on the USGS database) in the area. All events are over 10 miles from the proposed SWD location. The most recent and closest event was 10.1 miles southeast on June 2, 2001 and measured 2.6, the other event was 17.9 miles to the southwest and measured 2.9 on December 4, 1984.

Delaware Energy does not own 2D or 3D seismic data near the proposed SWD location therefore the fault interpretations are based on data obtained from the USGS New Mexico Faults Database (2005) and other published data. Based on these sources the closest fault would be approximately .46 miles northeast of the location. A recent technical paper written by Snee and Zoback, "State of Stress in the Permian Basin, Texas and New Mexico: Implications for induced seismicity", was published in the February 2018 edition of The Leading Edge. The study evaluates the strike-slip probability of known faults using FSP analysis. The study predicts that the NW-SE trending fault NE of the location (green) should have a very low probability of being critically stressed resulting in an induced seismicity event. This is due to the relationship of the strike of the fault and the regional Shmax orientation (approx. N 75 deg E) in the area. The exact position of this fault relative to the proposed location, and depth of the target formation, is unknown. Risk of contact with this fault should be evaluated and modeled prior to drilling the well. There has been no nearby seismicity associated or documented with this fault found in the public domain.

The proposed Wanderer State SWD #1 is located well away from the nearest active Devonian SWD (see map below). The closest SWD well is 2.1 miles to the NNW in the Yates formation. The Wanderer State SWD #1 is targeted for the Devonian and should not affect the Yates activity. The well should meet current OCD and Industry recommended practices.

Kevin J. Schepel
Petrophysical Advisor
kevin.schepel@att.net
214-212-6540

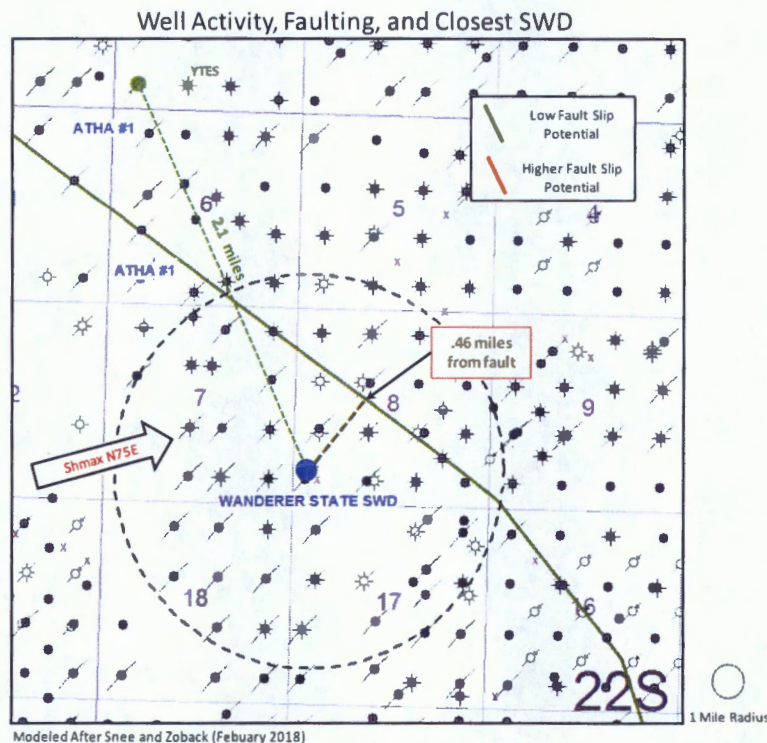

Proximity to Historic Earthquake Activity and Faults

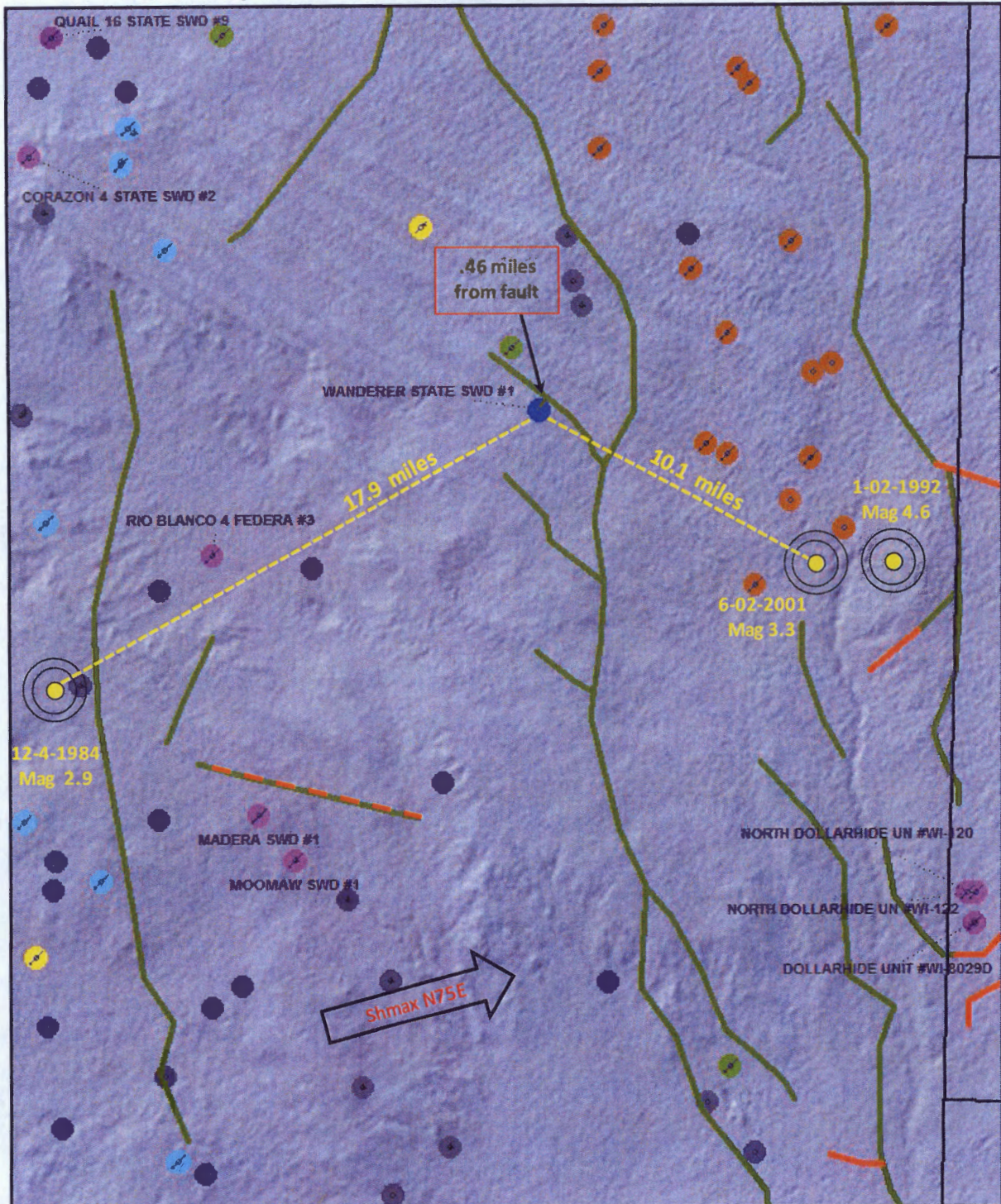

Modeled After Snee and Zoback (February 2018)

- Devonian SWD
- San Andres SWD
- Yates SWD
- Morrow SWD
- Proposed Location
- Permits
- Delaware SWD
- USGS Earthquake
- Low Fault Slip Potential
- Higher Fault Slip Potential

Data and Interpretation Disclosure - Although care has been taken to ensure that these data are up to date and accurate, this information and data is being providing as is. The data are what is believed to be the best public data available based on published documents, reports, and information available through the USGS. The user assumes all responsibility and risk for use of the data and interpretations. Users of the data agree not to misuse, add to without permission, or misrepresent the data provided in any way. In no event will the provider of this document be liable to any party for any direct, indirect, incidental, consequential, special or exemplary damages, or lost profit resulting from any use or misuse of this data. Additionally, provider is not liable for any inaccurate data. No person, entity, or user shall use the information in a manner that is in violation of any federal, state, or local law or regulation.

Affidavit of Publication

STATE OF NEW MEXICO
COUNTY OF LEA

I, Daniel Russell, Publisher of the Hobbs News-Sun, a newspaper published at Hobbs, New Mexico, solemnly swear that the clipping attached hereto was published in the regular and entire issue of said newspaper, and not a supplement thereof for a period of 1 issue(s).

Beginning with the issue dated
March 26, 2019
and ending with the issue dated
March 26, 2019.

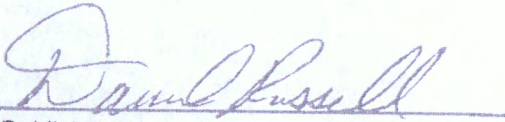

Publisher

Sworn and subscribed to before me this
26th day of March 2019.

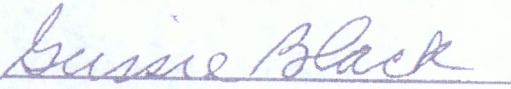

Business Manager

My commission expires
January 29, 2023

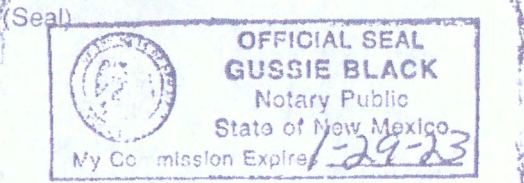

This newspaper is duly qualified to publish legal notices or advertisements within the meaning of Section 3, Chapter 167, Laws of 1937 and payment of fees for said

LEGAL NOTICE MARCH 26, 2019

Delaware Energy, L.L.C., 405 N. Marienfeld St. Suite 200, Midland, TX 79701, has filed a form C-108 (Application for Authorization to Inject) with the Oil Conservation Division seeking administrative approval to drill the Wanderer State SWD #1 as a Commercial Salt Water Disposal well.

The Wanderer State SWD #1 is located at 905' FSL and 400' FWL, Unit Letter M, Section 8, Township 22 South, Range 36 East, Lea County, New Mexico. The well will dispose of water produced from oil and gas wells into the Devonian Formation from 13,098' to 14,098' at a maximum rate of 25,000 barrels of water per day at a maximum pressure of 2,620 psi.

Interested parties must file objections or requests for hearing with the Oil Conservation Division, 1220 South St. Francis Dr. Santa Fe, New Mexico 87505, within 15 days.

Additional information can be obtained by contacting Delaware Energy, L.L.C. at (432) 685-7005. #33938

67114908

00226313

MIKE MCCURDY
DELAWARE ENERGY
405 N. MARIENFELD, STE 250
MIDLAND, TX 79701

7018 0680 0000 0582 7464

U.S. Postal Service™
CERTIFIED MAIL® RECEIPT
 Domestic Mail Only

For delivery information, visit our website at www.usps.com®.

DALLAS, TX 75206

OFFICIAL USE

Certified Mail Fee \$3.50

Extra Services & Fees (check box, add fee as appropriate)

Return Receipt (hardcopy) \$2.80

Return Receipt (electronic) \$0.00

Certified Mail Restricted Delivery \$0.00

Adult Signature Required \$0.00

Adult Signature Restricted Delivery \$0.00

Postage \$1.75

Total Postage and Fees \$8.05

Sent To
 Marjam Energy, LLC
 Street and Apt. No., or PO Box No.
 8150 N. Central Expressway, Ste 1525
 City, State, ZIP+4®
 Dallas, Tx 75206

PS Form 3800, April 2015 PSN 7530-02-000-9047 See Reverse for Instructions

Wanderer State
 DOWNTOWN STATION MIDLAND TX
 APR 17 2019
 04/17/2019

7018 0680 0000 0582 7471

U.S. Postal Service™
CERTIFIED MAIL® RECEIPT
 Domestic Mail Only

For delivery information, visit our website at www.usps.com®.

DALLAS, TX 75230

OFFICIAL USE

Certified Mail Fee \$3.50

Extra Services & Fees (check box, add fee as appropriate)

Return Receipt (hardcopy) \$2.80

Return Receipt (electronic) \$0.00

Certified Mail Restricted Delivery \$0.00

Adult Signature Required \$0.00

Adult Signature Restricted Delivery \$0.00

Postage \$1.75

Total Postage and Fees \$8.05

Sent To
 The McDaniel Company, Inc.
 Street and Apt. No., or PO Box No.
 12000 Preston Rd, Ste. 415
 City, State, ZIP+4®
 Dallas, Tx 75230

PS Form 3800, April 2015 PSN 7530-02-000-9047 See Reverse for Instructions

Wanderer State
 DOWNTOWN STATION MIDLAND TX
 APR 17 2019
 04/17/2019

7018 0680 0000 0582 7440

U.S. Postal Service™
CERTIFIED MAIL® RECEIPT
 Domestic Mail Only

For delivery information, visit our website at www.usps.com®.

HOUSTON, TX 77002

OFFICIAL USE

Certified Mail Fee \$3.50

Extra Services & Fees (check box, add fee as appropriate)

Return Receipt (hardcopy) \$2.80

Return Receipt (electronic) \$0.00

Certified Mail Restricted Delivery \$0.00

Adult Signature Required \$0.00

Adult Signature Restricted Delivery \$0.00

Postage \$1.75

Total Postage and Fees \$8.05

Sent To
 Ernest Operating
 Street and Apt. No., or PO Box No.
 1001 Fannin Street, Ste 800
 City, State, ZIP+4®
 Houston, Tx 77002

PS Form 3800, April 2015 PSN 7530-02-000-9047 See Reverse for Instructions

Wanderer State
 DOWNTOWN STATION MIDLAND TX
 APR 17 2019
 04/17/2019

7018 0680 0000 0582 7457

U.S. Postal Service™
CERTIFIED MAIL® RECEIPT
 Domestic Mail Only

For delivery information, visit our website at www.usps.com®.

MIDLAND, TX 79701

OFFICIAL USE

Certified Mail Fee \$3.50

Extra Services & Fees (check box, add fee as appropriate)

Return Receipt (hardcopy) \$2.80

Return Receipt (electronic) \$0.00

Certified Mail Restricted Delivery \$0.00

Adult Signature Required \$0.00

Adult Signature Restricted Delivery \$0.00

Postage \$1.75

Total Postage and Fees \$8.05

Sent To
 Mammoth Exploration, LLC
 Street and Apt. No., or PO Box No.
 200 N. Lorraine, Ste #1100
 City, State, ZIP+4®
 Midland Tx 79701

PS Form 3800, April 2015 PSN 7530-02-000-9047 See Reverse for Instructions

Wanderer State
 DOWNTOWN STATION MIDLAND TX
 APR 17 2019
 04/17/2019

7018 0680 0000 0582 7419

U.S. Postal Service™
CERTIFIED MAIL® RECEIPT
 Domestic Mail Only

For delivery information, visit our website at www.usps.com®.

SIXERSVILLE, WV 26175

OFFICIAL USE

Certified Mail Fee \$3.50

Extra Services & Fees (check box, add fee as appropriate)

Return Receipt (hardcopy) \$2.80

Return Receipt (electronic) \$0.00

Certified Mail Restricted Delivery \$0.00

Adult Signature Required \$0.00

Adult Signature Restricted Delivery \$0.00

Postage \$1.75

Total Postage and Fees \$8.05

Sent To
 Bruce A. Wilbanks Co.
 Street and Apt. No., or PO Box No.
 P.O. Box 192
 City, State, ZIP+4®
 Sixersville WV

PS Form 3800, April 2015 PSN 7530-02-000-9047 See Reverse for Instructions

Wanderer State
 DOWNTOWN STATION MIDLAND TX
 APR 17 2019
 04/17/2019

7018 0680 0000 0582 7426

U.S. Postal Service™
CERTIFIED MAIL® RECEIPT
 Domestic Mail Only

For delivery information, visit our website at www.usps.com®.

ROSWELL, NM 88201

OFFICIAL USE

Certified Mail Fee \$3.50

Extra Services & Fees (check box, add fee as appropriate)

Return Receipt (hardcopy) \$2.80

Return Receipt (electronic) \$0.00

Certified Mail Restricted Delivery \$0.00

Adult Signature Required \$0.00

Adult Signature Restricted Delivery \$0.00

Postage \$1.75

Total Postage and Fees \$8.05

Sent To
 Cameron Oil & Gas Inc.
 Street and Apt. No., or PO Box No.
 300 W. 2nd St.
 City, State, ZIP+4®
 Roswell, NM 88201

PS Form 3800, April 2015 PSN 7530-02-000-9047 See Reverse for Instructions

Wanderer State
 DOWNTOWN STATION MIDLAND TX
 APR 17 2019
 04/17/2019

U.S. Postal Service™
CERTIFIED MAIL® RECEIPT
 Domestic Mail Only

For delivery information, visit our website at www.usps.com®.

OFFICIAL USE
 MIDLAND TX 79701

Certified Mail Fee	\$3.50
\$	\$2.80
Extra Services & Fees (check box, add fee as appropriate)	
<input type="checkbox"/> Return Receipt (hardcopy)	\$0.00
<input type="checkbox"/> Return Receipt (electronic)	\$0.00
<input type="checkbox"/> Certified Mail Restricted Delivery	\$0.00
<input type="checkbox"/> Adult Signature Required	\$0.00
<input type="checkbox"/> Adult Signature Restricted Delivery	\$0.00
Postage	\$1.75
\$	\$8.05
Total Postage and Fees	
\$	\$8.05

Wanderer State
 DOWNTOWN STATION
 APR 17 2019
 MIDLAND TX 79701

Sent To
Conoco Phillips Co.
 Street and Apt. No., or PO Box No.
PO Box 7500
 City, State, ZIP+4®
Bartlesville, OK 74005

PS Form 3800, April 2015 PSN 7530-02-000-9047 See Reverse for Instructions

U.S. Postal Service™
CERTIFIED MAIL® RECEIPT
 Domestic Mail Only

For delivery information, visit our website at www.usps.com®.

OFFICIAL USE
 STILLWATER OK 74074

Certified Mail Fee	\$3.50
\$	\$2.80
Extra Services & Fees (check box, add fee as appropriate)	
<input type="checkbox"/> Return Receipt (hardcopy)	\$0.00
<input type="checkbox"/> Return Receipt (electronic)	\$0.00
<input type="checkbox"/> Certified Mail Restricted Delivery	\$0.00
<input type="checkbox"/> Adult Signature Required	\$0.00
<input type="checkbox"/> Adult Signature Restricted Delivery	\$0.00
Postage	\$1.75
\$	\$8.05
Total Postage and Fees	
\$	\$8.05

Wanderer State
 DOWNTOWN STATION
 APR 17 2019
 MIDLAND TX 79701

Sent To
Special Energy Corp
 Street and Apt. No., or PO Box No.
4815 S Perkins Rd.
 City, State, ZIP+4®
Stillwater, OK 74074

PS Form 3800, April 2015 PSN 7530-02-000-9047 See Reverse for Instructions

U.S. Postal Service™
CERTIFIED MAIL® RECEIPT
 Domestic Mail Only

For delivery information, visit our website at www.usps.com®.

OFFICIAL USE
 SISTERSVILLE WV 26075

Certified Mail Fee	\$3.50
\$	\$2.80
Extra Services & Fees (check box, add fee as appropriate)	
<input type="checkbox"/> Return Receipt (hardcopy)	\$0.00
<input type="checkbox"/> Return Receipt (electronic)	\$0.00
<input type="checkbox"/> Certified Mail Restricted Delivery	\$0.00
<input type="checkbox"/> Adult Signature Required	\$0.00
<input type="checkbox"/> Adult Signature Restricted Delivery	\$0.00
Postage	\$1.75
\$	\$8.05
Total Postage and Fees	
\$	\$8.05

Wanderer State
 DOWNTOWN STATION
 APR 17 2019
 MIDLAND TX 79701

Sent To
Wiser Oil Co.
 Street and Apt. No., or PO Box No.
PO Box 192
 City, State, ZIP+4®
Sistersville, WV 26075

PS Form 3800, April 2015 PSN 7530-02-000-9047 See Reverse for Instructions

U.S. Postal Service™
CERTIFIED MAIL® RECEIPT
 Domestic Mail Only

For delivery information, visit our website at www.usps.com®.

OFFICIAL USE
 MIDLAND TX 79701

Certified Mail Fee	\$3.50
\$	\$2.80
Extra Services & Fees (check box, add fee as appropriate)	
<input type="checkbox"/> Return Receipt (hardcopy)	\$0.00
<input type="checkbox"/> Return Receipt (electronic)	\$0.00
<input type="checkbox"/> Certified Mail Restricted Delivery	\$0.00
<input type="checkbox"/> Adult Signature Required	\$0.00
<input type="checkbox"/> Adult Signature Restricted Delivery	\$0.00
Postage	\$1.75
\$	\$8.05
Total Postage and Fees	
\$	\$8.05

Wanderer State
 DOWNTOWN STATION
 APR 17 2019
 MIDLAND TX 79701

Sent To
Blackbeard Operating, LLC
 Street and Apt. No., or PO Box No.
200 N Lorraine St #200
 City, State, ZIP+4®
Midland, TX 79701

PS Form 3800, April 2015 PSN 7530-02-000-9047 See Reverse for Instructions

U.S. Postal Service™
CERTIFIED MAIL® RECEIPT
 Domestic Mail Only

For delivery information, visit our website at www.usps.com®.

OFFICIAL USE
 STILLWATER OK 74074

Certified Mail Fee	\$3.50
\$	\$2.80
Extra Services & Fees (check box, add fee as appropriate)	
<input type="checkbox"/> Return Receipt (hardcopy)	\$0.00
<input type="checkbox"/> Return Receipt (electronic)	\$0.00
<input type="checkbox"/> Certified Mail Restricted Delivery	\$0.00
<input type="checkbox"/> Adult Signature Required	\$0.00
<input type="checkbox"/> Adult Signature Restricted Delivery	\$0.00
Postage	\$1.75
\$	\$8.05
Total Postage and Fees	
\$	\$8.05

Wanderer State
 DOWNTOWN STATION
 APR 17 2019
 MIDLAND TX 79701

Sent To
Special Exploration, LLC
 Street and Apt. No., or PO Box No.
P.O. Box 369
 City, State, ZIP+4®
Stillwater, OK 74074

PS Form 3800, April 2015 PSN 7530-02-000-9047 See Reverse for Instructions

U.S. Postal Service™
CERTIFIED MAIL® RECEIPT
 Domestic Mail Only

For delivery information, visit our website at www.usps.com®.

OFFICIAL USE
 MIDLAND TX 79701

Certified Mail Fee	\$3.50
\$	\$2.80
Extra Services & Fees (check box, add fee as appropriate)	
<input type="checkbox"/> Return Receipt (hardcopy)	\$0.00
<input type="checkbox"/> Return Receipt (electronic)	\$0.00
<input type="checkbox"/> Certified Mail Restricted Delivery	\$0.00
<input type="checkbox"/> Adult Signature Required	\$0.00
<input type="checkbox"/> Adult Signature Restricted Delivery	\$0.00
Postage	\$1.75
\$	\$8.05
Total Postage and Fees	
\$	\$8.05

Wanderer State
 DOWNTOWN STATION
 APR 17 2019
 MIDLAND TX 79701

Sent To
OK USA WTP LP
 Street and Apt. No., or PO Box No.
6 Deste Dr. #6000
 City, State, ZIP+4®
Midland, TX 79705

PS Form 3800, April 2015 PSN 7530-02-000-9047 See Reverse for Instructions

7433 2852 0000 0582 0680 7018
 5042 0582 0680 0000 0582 7018
 7495 0582 0680 0000 0582 7018
 7488 0582 0680 0000 0582 7018

2042 2852 0000 0582 0680 7018
 7501 2852 0000 0582 0680 7018
 7488 0582 0680 0000 0582 7018

U.S. Postal Service™
CERTIFIED MAIL® RECEIPT
 Domestic Mail Only

For delivery information, visit our website at www.usps.com®.

SANTA FE, NM 87501

OFFICIAL USE

Certified Mail Fee	\$3.50
Extra Services & Fees (check box, add fee as appropriate)	\$2.80
<input type="checkbox"/> Return Receipt (hardcopy)	\$0.00
<input type="checkbox"/> Return Receipt (electronic)	\$0.00
<input type="checkbox"/> Certified Mail Restricted Delivery	\$0.00
<input type="checkbox"/> Adult Signature Required	\$0.00
<input type="checkbox"/> Adult Signature Restricted Delivery	\$0.00

Postage \$1.75

Total Postage and Fees \$8.05

Wanderer State



Sent To
 New Mexico State Land Office

Street and Apt. No., or PO Box No.
 310 Old Santa Fe Trail

City, State, ZIP+4®
 Santa Fe, NM 87501

PS Form 3800, April 2015 PSN 7530-02-000-9047 See Reverse for Instructions

7018 0680 0000 0580 0850 5066

U.S. Postal Service™
CERTIFIED MAIL® RECEIPT
 Domestic Mail Only

For delivery information, visit our website at www.usps.com®.

HOBBS, NM 88240

OFFICIAL USE

Certified Mail Fee	\$3.50
Extra Services & Fees (check box, add fee as appropriate)	\$2.80
<input type="checkbox"/> Return Receipt (hardcopy)	\$0.00
<input type="checkbox"/> Return Receipt (electronic)	\$0.00
<input type="checkbox"/> Certified Mail Restricted Delivery	\$0.00
<input type="checkbox"/> Adult Signature Required	\$0.00
<input type="checkbox"/> Adult Signature Restricted Delivery	\$0.00

Postage \$1.75

Total Postage and Fees \$8.05

Wanderer State



Sent To
 State of New Mexico OCD District I

Street and Apt. No., or PO Box No.
 1025 N. French Dr.

City, State, ZIP+4®
 Hobbs, NM 88240

PS Form 3800, April 2015 PSN 7530-02-000-9047 See Reverse for Instructions

7018 0680 0000 0580 0850 5059

McMillan, Michael, EMNRD

From: McMillan, Michael, EMNRD
Sent: Monday, April 29, 2019 11:35 AM
To: 'Sarah Presley'
Subject: Wonderer State SWD Well No. 1

Sarah:
Your application is suspended, because you did not notify BLM

Your application is suspended until you provide notice to them.

Mike

Michael McMillan
1220 South St. Francis
Santa Fe, New Mexico
505-476-3448
Michael.mcmillan@state.nm.us

McMillan, Michael, EMNRD

From: Sarah Presley <s.presley@delawareenergy.com>
Sent: Monday, April 29, 2019 2:52 PM
To: McMillan, Michael, EMNRD
Subject: [EXT] RE: Wonderer State SWD Well No. 1
Attachments: wanderer state swd.pdf

Hey Mike,

Here is the certified receipt for the BLM.

Thanks,

SP

Regards,

Sarah Presley | Operations Manager
405 N. Marienfeld, Suite 200
Midland, TX 79701
O: (432) 685-7005
C: (432) 269-3789



From: McMillan, Michael, EMNRD <Michael.McMillan@state.nm.us>
Sent: Monday, April 29, 2019 12:35 PM
To: Sarah Presley <s.presley@delawareenergy.com>
Subject: Wonderer State SWD Well No. 1

Sarah:
Your application is suspended, because you did not notify BLM

Your application is suspended until you provide notice to them.

Mike

Michael McMillan
1220 South St. Francis
Santa Fe, New Mexico
505-476-3448
Michael.mcmillan@state.nm.us

U.S. Postal Service™
CERTIFIED MAIL® RECEIPT
 Domestic Mail Only

For delivery information, visit our website at www.usps.com

OFFICIAL USE

Certified Mail Fee \$3.50

- Extra Services & Fees (check box, add fee as appropriate)
- Return Receipt (hardcopy) \$2.80
 - Return Receipt (electronic) \$0.00
 - Certified Mail Restricted Delivery \$0.00
 - Adult Signature Required \$0.00
 - Adult Signature Restricted Delivery \$0.00

Postage \$1.75

Total Postage and Fees \$8.05

Sent To
Bureau of Land Management
 Street and Apt. No., or PO Box No.
620 E. Greene Street
 City, State, ZIP+4®
Carlsbad, NM 88220

PS Form 3800, April 2015 Edition www.usps.com See Reverse for Instructions



7018 0580 0000 0000 0890 8702