

DATE IN	SUSPENSE	ENGINEER <b>DM</b>	LOGGED IN	TYPE <b>CTB</b>	APP NO. <b>pDM2022728553</b>
---------	----------	--------------------	-----------	-----------------	------------------------------

SFOHU-200813-C-107B CTB-965

ABOVE THIS LINE FOR DIVISION USE ONLY

**NEW MEXICO OIL CONSERVATION DIVISION**  
 - Engineering Bureau -  
 1220 South St. Francis Drive, Santa Fe, NM 87505



**ADMINISTRATIVE APPLICATION CHECKLIST**

THIS CHECKLIST IS MANDATORY FOR ALL ADMINISTRATIVE APPLICATIONS FOR EXCEPTIONS TO DIVISION RULES AND REGULATIONS WHICH REQUIRE PROCESSING AT THE DIVISION LEVEL IN SANTA FE

**Application Acronyms:**

- [NSL-Non-Standard Location] [NSP-Non-Standard Proration Unit] [SD-Simultaneous Dedication]
- [DHC-Downhole Commingling] [CTB-Lease Commingling] [PLC-Pool/Lease Commingling]
- [PC-Pool Commingling] [OLS - Off-Lease Storage] [OLM-Off-Lease Measurement]
- [WFX-Waterflood Expansion] [PMX-Pressure Maintenance Expansion]
- [SWD-Salt Water Disposal] [IPI-Injection Pressure Increase]
- [EOR-Qualified Enhanced Oil Recovery Certification] [PPR-Positive Production Response]

[1] **TYPE OF APPLICATION** - Check Those Which Apply for [A]

- [A] Location - Spacing Unit - Simultaneous Dedication  
 NSL  NSP  SD

Check One Only for [B] or [C]

- [B] Commingling - Storage - Measurement  
 DHC  CTB  PLC  PC  OLS  OLM

- [C] Injection - Disposal - Pressure Increase - Enhanced Oil Recovery  
 WFX  PMX  SWD  IPI  EOR  PPR

- [D] Other: Specify \_\_\_\_\_

[2] **NOTIFICATION REQUIRED TO:** - Check Those Which Apply, or Does Not Apply

- [A]  Working, Royalty or Overriding Royalty Interest Owners
- [B]  Offset Operators, Leaseholders or Surface Owner
- [C]  Application is One Which Requires Published Legal Notice
- [D]  Notification and/or Concurrent Approval by BLM or SLO  
U.S. Bureau of Land Management - Commissioner of Public Lands, State Land Office
- [E]  For all of the above, Proof of Notification or Publication is Attached, and/or,
- [F]  Waivers are Attached

[3] **SUBMIT ACCURATE AND COMPLETE INFORMATION REQUIRED TO PROCESS THE TYPE OF APPLICATION INDICATED ABOVE.**

[4] **CERTIFICATION:** I hereby certify that the information submitted with this application for administrative approval is **accurate** and **complete** to the best of my knowledge. I also understand that **no action** will be taken on this application until the required information and notifications are submitted to the Division.

Note: Statement must be completed by an individual with managerial and/or supervisory capacity.

David Schellstede                      [Signature]                      COO                      8/10/2020  
 Print or Type Name                      Signature                      Title                      Date

david@Ftenergy.us.com  
 e-mail Address

District I  
1625 N. French Drive, Hobbs, NM 88240  
District II  
811 S. First St., Artesia, NM 88210  
District III  
1000 Rio Brazos Road, Aztec, NM 87410  
District IV  
1220 S. St Francis Dr, Santa Fe, NM  
87505

State of New Mexico  
Energy, Minerals and Natural Resources Department

Form C-107-B  
Revised August 1, 2011

**OIL CONSERVATION DIVISION**  
1220 S. St Francis Drive  
Santa Fe, New Mexico 87505

Submit the original application to the Santa Fe office with one copy to the appropriate District Office.

**APPLICATION FOR SURFACE COMMINGLING (DIVERSE OWNERSHIP)**

OPERATOR NAME: FAE II Operating, LLC  
OPERATOR ADDRESS: 11757 Katy Fwy, Ste. 1000, Houston, TX 77079  
APPLICATION TYPE:

Pool Commingling  Lease Commingling  Pool and Lease Commingling  Off-Lease Storage and Measurement (Only if not Surface Commingled)

LEASE TYPE:  Fee  State  Federal

Is this an Amendment to existing Order?  Yes  No If "Yes", please include the appropriate Order No. \_\_\_\_\_  
Have the Bureau of Land Management (BLM) and State Land office (SLO) been notified in writing of the proposed commingling  
 Yes  No

**(A) POOL COMMINGLING**  
Please attach sheets with the following information

(1) Pool Names and Codes	Gravities / BTU of Non-Commingled Production	Calculated Gravities / BTU of Commingled Production		Calculated Value of Commingled Production	Volumes

(2) Are any wells producing at top allowables?  Yes  No  
(3) Has all interest owners been notified by certified mail of the proposed commingling?  Yes  No.  
(4) Measurement type:  Metering  Other (Specify)  
(5) Will commingling decrease the value of production?  Yes  No If "yes", describe why commingling should be approved

**(B) LEASE COMMINGLING**  
Please attach sheets with the following information

(1) Pool Name and Code. 37240 LANGLIE MATTIX; 7 RVRS-Q-GRAYBURG  
(2) Is all production from same source of supply?  Yes  No  
(3) Has all interest owners been notified by certified mail of the proposed commingling?  Yes  No  
(4) Measurement type:  Metering  Other (Specify)

**(C) POOL and LEASE COMMINGLING**  
Please attach sheets with the following information

(1) Complete Sections A and E.

**(D) OFF-LEASE STORAGE and MEASUREMENT**  
Please attached sheets with the following information

(1) Is all production from same source of supply?  Yes  No  
(2) Include proof of notice to all interest owners.

**(E) ADDITIONAL INFORMATION (for all application types)**  
Please attach sheets with the following information

(1) A schematic diagram of facility, including legal location.  
(2) A plat with lease boundaries showing all well and facility locations. Include lease numbers if Federal or State lands are involved.  
(3) Lease Names, Lease and Well Numbers, and API Numbers.

I hereby certify that the information above is true and complete to the best of my knowledge and belief.  
SIGNATURE: MBates TITLE: Engineering Tech DATE: 8/10/2020  
TYPE OR PRINT NAME Marshall Bates TELEPHONE NO.: (713) 253-2885  
E-MAIL ADDRESS: Marshall@FAEnergyus.com

# faeIIoperating

August 6, 2020

**VIA ONLINE FILING**

Mr. Dean McClure  
New Mexico Energy, Minerals and Natural Resources Department  
1220 South St. Francis Drive  
Santa Fe, New Mexico 87505

**Re: Application of FAE II Operating, LLC for Administrative Approval to Surface Commingle and Sell Gas Production from the Langlie Mattix 7 Rivers Oil and Gas Pool for the Terra Carlson #1 and Terra Carlson B #1 wells at the Carlson #5 Tank Battery located in Unit H, Sec. 26, T-25S, R-37E, Lea County, New Mexico**

Dear Mr. McClure:

FAE II Operating LLC, OGRID: 329326, requests administrative approval for surface commingling of gas production for its Carlson and Terra Carlson leases located in Section 26 of Township 25S, Range 37E as shown on the map in Exhibit A. The two separate leases are also identified by outline and legend. Exhibit B offers further detail on the relevant leases and wells.

The attached battery diagrams, Exhibits C and D, are accurate schematics of the current facility and the proposed commingled facility, respectively. A new 2-inch gas flowline will be laid from each of the Terra Carlson wells and tie in to the suction side of the compressor at the Carlson #5 CTB. Each of the Terra Carlson wells will have a gas orifice (allocation) meter manufactured and assembled in accordance with American Gas Association specifications. The Carlson #5 gas production will be determined by subtracting the metered wells from the total production measured at the lease custody transfer meter.

After a review of internal records, the interest owners are not identical for the wells mentioned above. As such, we have notified all relevant parties of our intent to commingle production (see attached letter). The working, royalty, and overriding royalty interest owners as shown in Exhibit E have been notified of this application by certified mail. Copies of the certified mail receipts are attached as Exhibit F.

This proposed commingling of production is in the interest of conservation and will not result in reduced royalty or improper measurement of production. If there are further questions concerning this application, please feel free to contact the undersigned by email at [kevin@faenergyus.com](mailto:kevin@faenergyus.com) or by telephone at (832) 220-9188.

Very truly yours,



**FAE II Operating, LLC**

# faeIIoperating

## Exhibit A – Lease Boundaries Map

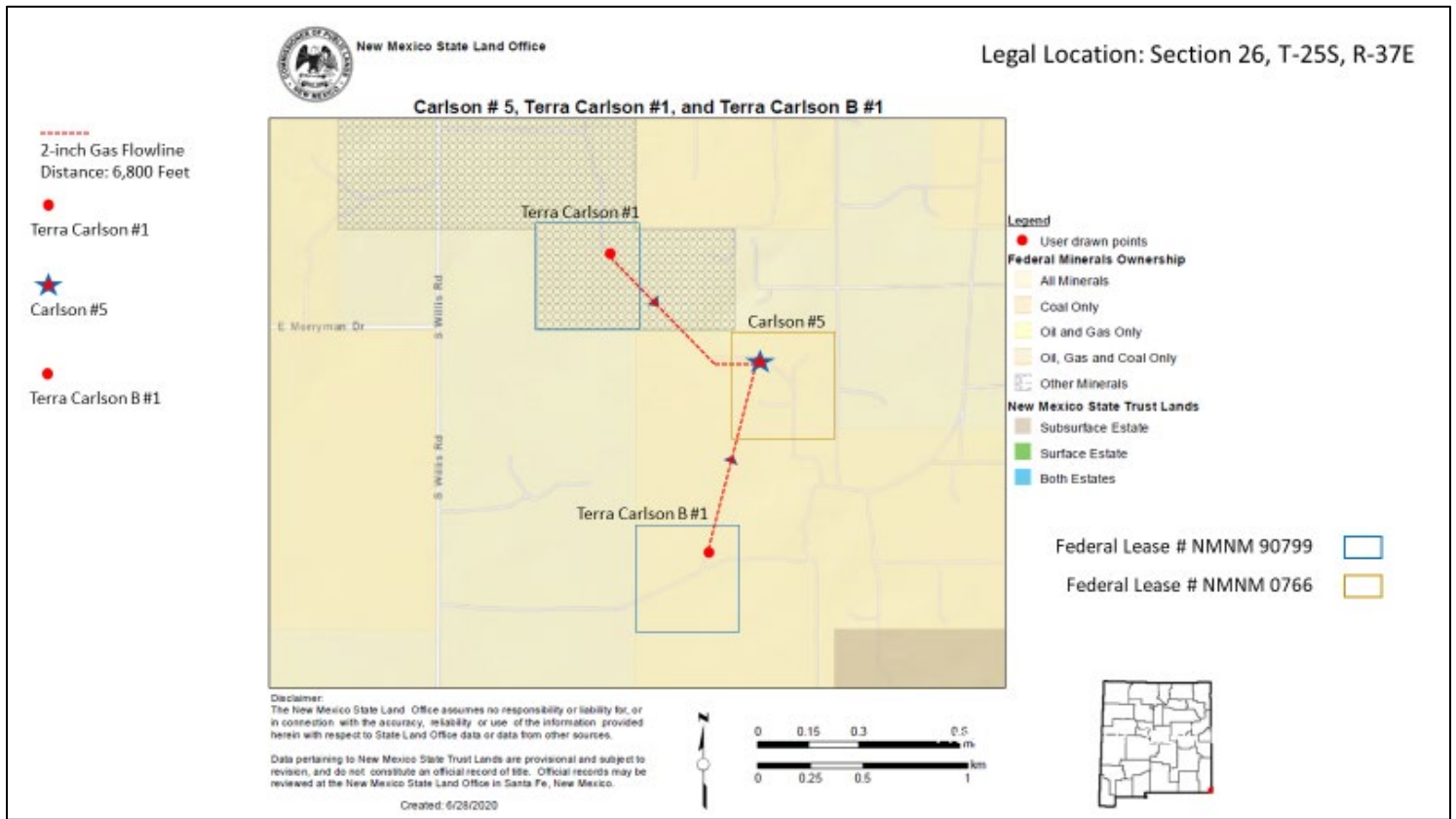

## Exhibit B – Lease and Well Information

Well Name	Federal Lease No.	API #	Pool ID
Carlson #5	NMNM 0766	30-025-29528	37240 LANGLIE MATTIX; 7 RVRS-Q-GRAYBURG
Terra Carlson #1	NMNM 90799	30-025-26950	37240 LANGLIE MATTIX; 7 RVRS-Q-GRAYBURG
Terra Carlson B #1	NMNM 90799	30-025-27192	37240 LANGLIE MATTIX; 7 RVRS-Q-GRAYBURG

# faeIIoperating

## Exhibit C – Current Facility Layout

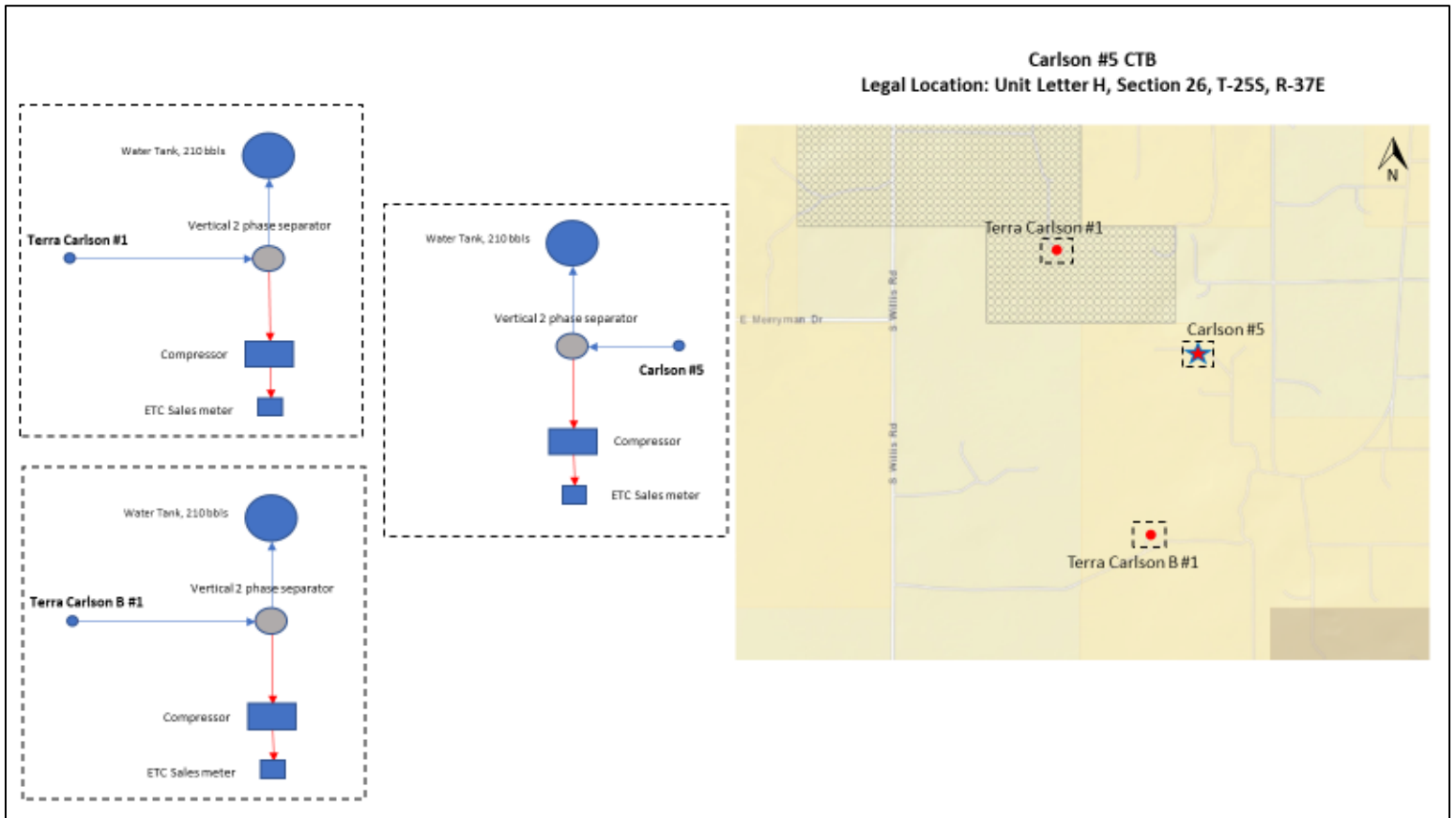

# faeIIoperating

## Exhibit D – Proposed Facility Layout

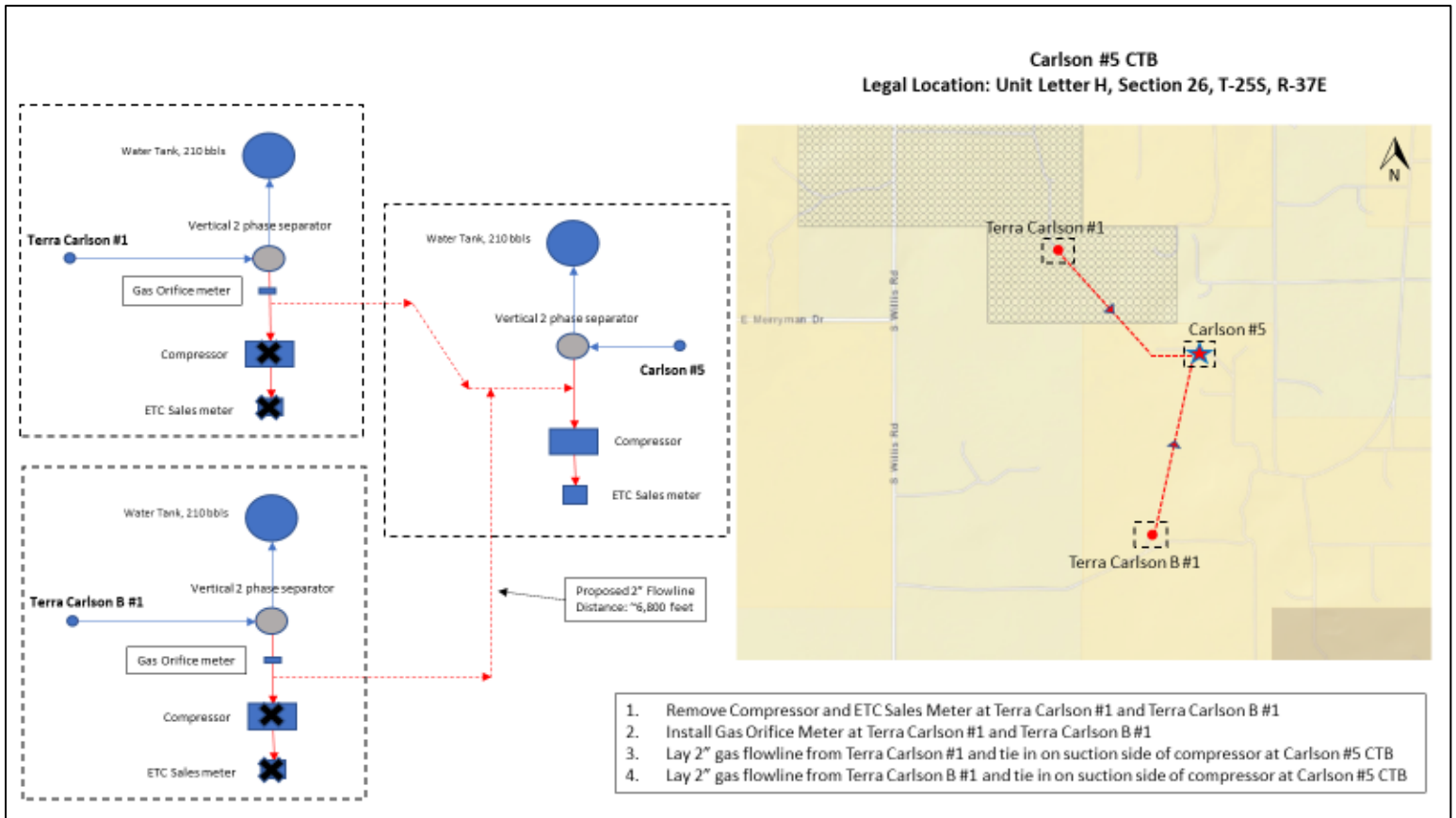

# fae II operating

## Exhibit E – Ownership Information

Well Name(s)	Ownership Type	Name	Address
Carlson #5, Terra Carlson #1, Terra Carlson B #1	Working	FAE II Operating LLC	11757 Katy Fwy Ste. 1000 Houston, TX 77079-1762
Carlson #5, Terra Carlson #1, Terra Carlson B #1	Royalty	Office of Natural Resources Revenue	PO Box 25627 Denver, CO 80225-0627
Carlson #5	Overriding Royalty	The McDaniel Company	12900 Preston Road, Suite 415 Dallas, TX 75231
Carlson #5	Overriding Royalty	Marjam Energy, LLC	10440 N. Central Express Way, Ste. 1010 Dallas, TX 75231
Carlson #5	Overriding Royalty	Milagro Resources, LP	415 West Wall Avenue, Suite 1118 Midland, TX 79701
Carlson #5	Overriding Royalty	John F. Special	PO Box 369 Stillwater, OK 74076
Carlson #5	Overriding Royalty	Larry Bond	3501 French Park Drive, Suite G Edmond, OK 73034
Carlson #5	Overriding Royalty	Jimmie Eden Jr. Trust	PO Box 17 Stillwater, OK 74074
Carlson #5	Overriding Royalty	Legat, LLC	6114 W. Canterbury Drive Stillwater, OK 74074
Terra Carlson#1, Terra Carlson B #1	Working	Michelle Holder	102 Oak Bluff Lane May, TX 76857
Terra Carlson#1, Terra Carlson B #1	Overriding Royalty	L. E. Armstrong	13 Road 6SS Cody, WY 82414-0182
Terra Carlson#1, Terra Carlson B #1	Overriding Royalty	Earl R. Bruno, Jr.	PO Drawer 590 Midland, TX 79702
Terra Carlson#1, Terra Carlson B #1	Overriding Royalty	Nancy Young Chandler	216 Pate Lane Mena, AR 71953
Terra Carlson#1, Terra Carlson B #1	Overriding Royalty	Christine Kay Connell	915 Evergreen Street Cheyenne, WY 82009
Terra Carlson#1, Terra Carlson B #1	Overriding Royalty	Barbara C. Harmer	17035 Butterfield Trail Poway, CA 92064
Terra Carlson#1, Terra Carlson B #1	Overriding Royalty	Hunt Oil Company	Lockbox 840722 Dallas, TX 75284-0722
Terra Carlson#1, Terra Carlson B #1	Overriding Royalty	Saletha K Y Isaacson	764 Eudora Street Denver, CO 80220
Terra Carlson#1, Terra Carlson B #1	Overriding Royalty	Jaco Production Company	PO Box 82515 Bakersfield, CA 93380-2515
Terra Carlson#1, Terra Carlson B #1	Overriding Royalty	Marathon Oil Company	PO Box 732312 Dallas, TX 75373-2312
Terra Carlson#1, Terra Carlson B #1	Overriding Royalty	Robert H Marshall	PO Box 1422 Midland, TX 79702
Terra Carlson#1, Terra Carlson B #1	Overriding Royalty	Mekusukey Oil Company, LLC	PO Box 816 Wewoka, OK 74884-0816
Terra Carlson#1, Terra Carlson B #1	Overriding Royalty	Betsy Phelan	403 Prairie Hill Drive Cheyenne, WY 82009
Terra Carlson#1, Terra Carlson B #1	Overriding Royalty	Walner Family Trust Cathie F. Simonieg Walner, Trustee	1812 Lakeshore Court McKinney, TX 75070
Terra Carlson#1, Terra Carlson B #1	Overriding Royalty	Windom Royalties, LLC	PO Box 660082 Dallas, TX 75266-0082

# faeIoperating

## Exhibit F – Certified Mail Receipts

U.S. Postal Service™  
**CERTIFIED MAIL® RECEIPT**  
Domestic Mail Only

For delivery information, visit our website at [www.usps.com](http://www.usps.com)®.

Frisco, TX 75033

**OFFICIAL USE**

Certified Mail Fee \$3.55  
Extra Services & Fees (check box, add fee) \$2.85  
 Return Receipt (hardcopy) \$0.00  
 Return Receipt (electronic) \$0.00  
 Certified Mail Restricted Delivery \$0.00  
 Adult Signature Required \$0.00  
 Adult Signature Restricted Delivery \$0.00

Postage \$1.20  
Total Postage and Fees \$7.60

Sent To  
The McDaniel Company  
12900 Preston Road, Ste. 415 75033  
Dallas, TX 75231 Frisco, TX

PS Form 3800, April 2015 PSN 7530-02-000-9047 See Reverse for Instructions

U.S. Postal Service™  
**CERTIFIED MAIL® RECEIPT**  
Domestic Mail Only

For delivery information, visit our website at [www.usps.com](http://www.usps.com)®.

Stillwater, OK 74076

**OFFICIAL USE**

Certified Mail Fee \$3.55  
Extra Services & Fees (check box, add fee) \$2.85  
 Return Receipt (hardcopy) \$0.00  
 Return Receipt (electronic) \$0.00  
 Certified Mail Restricted Delivery \$0.00  
 Adult Signature Required \$0.00  
 Adult Signature Restricted Delivery \$0.00

Postage \$1.20  
Total Postage and Fees \$7.60

Sent To  
John F. Special  
PO Box 369  
Stillwater, OK 74076

PS Form 3800, April 2015 PSN 7530-02-000-9047 See Reverse for Instructions

U.S. Postal Service™  
**CERTIFIED MAIL® RECEIPT**  
Domestic Mail Only

For delivery information, visit our website at [www.usps.com](http://www.usps.com)®.

Dallas, TX 75231

**OFFICIAL USE**

Certified Mail Fee \$3.55  
Extra Services & Fees (check box, add fee) \$2.85  
 Return Receipt (hardcopy) \$0.00  
 Return Receipt (electronic) \$0.00  
 Certified Mail Restricted Delivery \$0.00  
 Adult Signature Required \$0.00  
 Adult Signature Restricted Delivery \$0.00

Postage \$1.20  
Total Postage and Fees \$7.60

Sent To  
Marjam Energy, LLC  
10440 N. Central Express Way, Ste. 1010  
Dallas, TX 75231

PS Form 3800, April 2015 PSN 7530-02-000-9047 See Reverse for Instructions

U.S. Postal Service™  
**CERTIFIED MAIL® RECEIPT**  
Domestic Mail Only

For delivery information, visit our website at [www.usps.com](http://www.usps.com)®.

Midland, TX 79701

**OFFICIAL USE**

Certified Mail Fee \$3.55  
Extra Services & Fees (check box, add fee) \$2.85  
 Return Receipt (hardcopy) \$0.00  
 Return Receipt (electronic) \$0.00  
 Certified Mail Restricted Delivery \$0.00  
 Adult Signature Required \$0.00  
 Adult Signature Restricted Delivery \$0.00

Postage \$1.20  
Total Postage and Fees \$7.60

Sent To  
Milagro Resources, LP  
415 West Wall Avenue, Suite 1118  
Midland, TX 79701

PS Form 3800, April 2015 PSN 7530-02-000-9047 See Reverse for Instructions

U.S. Postal Service™  
**CERTIFIED MAIL® RECEIPT**  
Domestic Mail Only

For delivery information, visit our website at [www.usps.com](http://www.usps.com)®.

Denver, CO 80225

**OFFICIAL USE**

Certified Mail Fee \$3.55  
Extra Services & Fees (check box, add fee) \$2.85  
 Return Receipt (hardcopy) \$0.00  
 Return Receipt (electronic) \$0.00  
 Certified Mail Restricted Delivery \$0.00  
 Adult Signature Required \$0.00  
 Adult Signature Restricted Delivery \$0.00

Postage \$1.20  
Total Postage and Fees \$7.60

Sent To  
Office of Natural Resources Revenue  
PO Box 25627  
Denver, CO 80225-0627

PS Form 3800, April 2015 PSN 7530-02-000-9047 See Reverse for Instructions



# faeIoperating

7019 2970 0000 8911 5894

**U.S. Postal Service™  
CERTIFIED MAIL® RECEIPT**  
Domestic Mail Only

For delivery information, visit our website at [www.usps.com](http://www.usps.com)®.  
Mena, AR 71953

**OFFICIAL USE**

Certified Mail Fee	\$3.55
Extra Services & Fees (check box, add fee as appropriate)	\$2.85
<input type="checkbox"/> Return Receipt (hardcopy)	\$0.00
<input type="checkbox"/> Return Receipt (electronic)	\$0.00
<input type="checkbox"/> Certified Mail Restricted Delivery	\$0.00
<input type="checkbox"/> Adult Signature Required	\$0.00
<input type="checkbox"/> Adult Signature Restricted Delivery	\$0.00
Postage	\$1.20
Total Postage and Fees	\$7.60

Postmark Here  
08/10/2020

Sent To  
Nancy Young Chandler  
Street and Apt. No., or PO Box No.  
216 Pate Lane  
City, State, ZIP+4®  
Mena, AR 71953

PS Form 3800, April 2015 PSN 7530-02-000-9047 See Reverse for Instructions

7019 2970 0000 8911 5900

**U.S. Postal Service™  
CERTIFIED MAIL® RECEIPT**  
Domestic Mail Only

For delivery information, visit our website at [www.usps.com](http://www.usps.com)®.  
Midland, TX 79702

**OFFICIAL USE**

Certified Mail Fee	\$3.55
Extra Services & Fees (check box, add fee as appropriate)	\$2.85
<input type="checkbox"/> Return Receipt (hardcopy)	\$0.00
<input type="checkbox"/> Return Receipt (electronic)	\$0.00
<input type="checkbox"/> Certified Mail Restricted Delivery	\$0.00
<input type="checkbox"/> Adult Signature Required	\$0.00
<input type="checkbox"/> Adult Signature Restricted Delivery	\$0.00
Postage	\$1.20
Total Postage and Fees	\$7.60

Postmark Here  
08/10/2020

Sent To  
Earl R. Bruno, Jr.  
Street and Apt. No., or PO Box No.  
PO Drawer 590  
City, State, ZIP+4®  
Midland, TX 79702

PS Form 3800, April 2015 PSN 7530-02-000-9047 See Reverse for Instructions

7019 2970 0000 8911 5917

**U.S. Postal Service™  
CERTIFIED MAIL® RECEIPT**  
Domestic Mail Only

For delivery information, visit our website at [www.usps.com](http://www.usps.com)®.  
Cody, WY 82414

**OFFICIAL USE**

Certified Mail Fee	\$3.55
Extra Services & Fees (check box, add fee as appropriate)	\$2.85
<input type="checkbox"/> Return Receipt (hardcopy)	\$0.00
<input type="checkbox"/> Return Receipt (electronic)	\$0.00
<input type="checkbox"/> Certified Mail Restricted Delivery	\$0.00
<input type="checkbox"/> Adult Signature Required	\$0.00
<input type="checkbox"/> Adult Signature Restricted Delivery	\$0.00
Postage	\$1.20
Total Postage and Fees	\$7.60

Postmark Here  
08/10/2020

Sent To  
L. E. Armstrong  
Street and Apt. No., or PO Box No.  
13 Road 655  
City, State, ZIP+4®  
Cody, WY 82414 - 0182

PS Form 3800, April 2015 PSN 7530-02-000-9047 See Reverse for Instructions

7019 2970 0000 8911 5931

**U.S. Postal Service™  
CERTIFIED MAIL® RECEIPT**  
Domestic Mail Only

For delivery information, visit our website at [www.usps.com](http://www.usps.com)®.  
Stillwater, OK 74074

**OFFICIAL USE**

Certified Mail Fee	\$3.55
Extra Services & Fees (check box, add fee as appropriate)	\$2.85
<input type="checkbox"/> Return Receipt (hardcopy)	\$0.00
<input type="checkbox"/> Return Receipt (electronic)	\$0.00
<input type="checkbox"/> Certified Mail Restricted Delivery	\$0.00
<input type="checkbox"/> Adult Signature Required	\$0.00
<input type="checkbox"/> Adult Signature Restricted Delivery	\$0.00
Postage	\$1.20
Total Postage and Fees	\$7.60

Postmark Here  
08/10/2020

Sent To  
Leapt, LLC  
Street and Apt. No., or PO Box No.  
6114 W. Canterbury Drive  
City, State, ZIP+4®  
Stillwater, OK 74074

PS Form 3800, April 2015 PSN 7530-02-000-9047 See Reverse for Instructions

7019 2970 0000 8911 5948

**U.S. Postal Service™  
CERTIFIED MAIL® RECEIPT**  
Domestic Mail Only

For delivery information, visit our website at [www.usps.com](http://www.usps.com)®.  
Stillwater, OK 74076

**OFFICIAL USE**

Certified Mail Fee	\$3.55
Extra Services & Fees (check box, add fee as appropriate)	\$2.85
<input type="checkbox"/> Return Receipt (hardcopy)	\$0.00
<input type="checkbox"/> Return Receipt (electronic)	\$0.00
<input type="checkbox"/> Certified Mail Restricted Delivery	\$0.00
<input type="checkbox"/> Adult Signature Required	\$0.00
<input type="checkbox"/> Adult Signature Restricted Delivery	\$0.00
Postage	\$1.20
Total Postage and Fees	\$7.60

Postmark Here  
08/10/2020

Sent To  
Jimmie Eden Jr. Trust  
Street and Apt. No., or PO Box No.  
PO Box 17  
City, State, ZIP+4®  
Stillwater, OK 74074 74076

PS Form 3800, April 2015 PSN 7530-02-000-9047 See Reverse for Instructions

7019 2970 0000 8911 5955

**U.S. Postal Service™  
CERTIFIED MAIL® RECEIPT**  
Domestic Mail Only

For delivery information, visit our website at [www.usps.com](http://www.usps.com)®.  
Edmond, OK 73034

**OFFICIAL USE**

Certified Mail Fee	\$3.55
Extra Services & Fees (check box, add fee as appropriate)	\$2.85
<input type="checkbox"/> Return Receipt (hardcopy)	\$0.00
<input type="checkbox"/> Return Receipt (electronic)	\$0.00
<input type="checkbox"/> Certified Mail Restricted Delivery	\$0.00
<input type="checkbox"/> Adult Signature Required	\$0.00
<input type="checkbox"/> Adult Signature Restricted Delivery	\$0.00
Postage	\$1.20
Total Postage and Fees	\$7.60

Postmark Here  
08/10/2020

Sent To  
Larry Bond  
Street and Apt. No., or PO Box No.  
3501 French Park Drive, Suite G  
City, State, ZIP+4®  
Edmond, OK 73034

PS Form 3800, April 2015 PSN 7530-02-000-9047 See Reverse for Instructions

# faeIoperating

7019 2970 0000 8911 5849

**U.S. Postal Service™  
CERTIFIED MAIL® RECEIPT**  
Domestic Mail Only

For delivery information, visit our website at [www.usps.com](http://www.usps.com)®.  
Bakersfield, CA 93380

**OFFICIAL USE**

Certified Mail Fee	\$3.55	0042
Extra Services & Fees (check box, add fee as appropriate)	\$2.85	07
<input type="checkbox"/> Return Receipt (hardcopy)	\$0.00	
<input type="checkbox"/> Return Receipt (electronic)	\$0.00	
<input type="checkbox"/> Certified Mail Restricted Delivery	\$0.00	
<input type="checkbox"/> Adult Signature Required	\$0.00	
<input type="checkbox"/> Adult Signature Restricted Delivery	\$0.00	
Postage	\$1.20	
<b>Total Postage and Fees</b>	<b>\$7.60</b>	

Sent To  
Street and Apt. No., or PO Box No.  
Jaco Production Company  
PO Box 82515  
City, State, ZIP+4®  
Bakersfield, CA 93380 - 2515

PS Form 3800, April 2015 PSN 7530-02-000-9047 See Reverse for Instructions

7019 2970 0000 8911 5856

**U.S. Postal Service™  
CERTIFIED MAIL® RECEIPT**  
Domestic Mail Only

For delivery information, visit our website at [www.usps.com](http://www.usps.com)®.  
Denver, CO 80220

**OFFICIAL USE**

Certified Mail Fee	\$3.55	0042
Extra Services & Fees (check box, add fee as appropriate)	\$2.85	07
<input type="checkbox"/> Return Receipt (hardcopy)	\$0.00	
<input type="checkbox"/> Return Receipt (electronic)	\$0.00	
<input type="checkbox"/> Certified Mail Restricted Delivery	\$0.00	
<input type="checkbox"/> Adult Signature Required	\$0.00	
<input type="checkbox"/> Adult Signature Restricted Delivery	\$0.00	
Postage	\$1.20	
<b>Total Postage and Fees</b>	<b>\$7.60</b>	

Sent To  
Street and Apt. No., or PO Box No.  
Salettha K.Y. Isaacson  
764 Eudora Street  
City, State, ZIP+4®  
Denver, CO 80220

PS Form 3800, April 2015 PSN 7530-02-000-9047 See Reverse for Instructions

7019 2970 0000 8911 5863

**U.S. Postal Service™  
CERTIFIED MAIL® RECEIPT**  
Domestic Mail Only

For delivery information, visit our website at [www.usps.com](http://www.usps.com)®.  
Dallas, TX 75284

**OFFICIAL USE**

Certified Mail Fee	\$3.55	0042
Extra Services & Fees (check box, add fee as appropriate)	\$2.85	07
<input type="checkbox"/> Return Receipt (hardcopy)	\$0.00	
<input type="checkbox"/> Return Receipt (electronic)	\$0.00	
<input type="checkbox"/> Certified Mail Restricted Delivery	\$0.00	
<input type="checkbox"/> Adult Signature Required	\$0.00	
<input type="checkbox"/> Adult Signature Restricted Delivery	\$0.00	
Postage	\$1.20	
<b>Total Postage and Fees</b>	<b>\$7.60</b>	

Sent To  
Street and Apt. No., or PO Box No.  
Hunt Oil Company  
Lockbox 840722  
City, State, ZIP+4®  
Dallas, TX 75284 - 0722

PS Form 3800, April 2015 PSN 7530-02-000-9047 See Reverse for Instructions

7019 2970 0000 8911 5924

**U.S. Postal Service™  
CERTIFIED MAIL® RECEIPT**  
Domestic Mail Only

For delivery information, visit our website at [www.usps.com](http://www.usps.com)®.  
Dallas, TX 76857

**OFFICIAL USE**

Certified Mail Fee	\$3.55	0042
Extra Services & Fees (check box, add fee as appropriate)	\$2.85	07
<input type="checkbox"/> Return Receipt (hardcopy)	\$0.00	
<input type="checkbox"/> Return Receipt (electronic)	\$0.00	
<input type="checkbox"/> Certified Mail Restricted Delivery	\$0.00	
<input type="checkbox"/> Adult Signature Required	\$0.00	
<input type="checkbox"/> Adult Signature Restricted Delivery	\$0.00	
Postage	\$1.20	
<b>Total Postage and Fees</b>	<b>\$7.60</b>	

Sent To  
Street and Apt. No., or PO Box No.  
Michelle Holder  
102 Oak Bluff Lane  
City, State, ZIP+4®  
May, TX 76857

PS Form 3800, April 2015 PSN 7530-02-000-9047 See Reverse for Instructions

7019 2970 0000 8911 5870

**U.S. Postal Service™  
CERTIFIED MAIL® RECEIPT**  
Domestic Mail Only

For delivery information, visit our website at [www.usps.com](http://www.usps.com)®.  
Poway, CA 92064

**OFFICIAL USE**

Certified Mail Fee	\$3.55	0042
Extra Services & Fees (check box, add fee as appropriate)	\$2.85	07
<input type="checkbox"/> Return Receipt (hardcopy)	\$0.00	
<input type="checkbox"/> Return Receipt (electronic)	\$0.00	
<input type="checkbox"/> Certified Mail Restricted Delivery	\$0.00	
<input type="checkbox"/> Adult Signature Required	\$0.00	
<input type="checkbox"/> Adult Signature Restricted Delivery	\$0.00	
Postage	\$1.20	
<b>Total Postage and Fees</b>	<b>\$7.60</b>	

Sent To  
Street and Apt. No., or PO Box No.  
Barbara C. Harmer  
17035 Butterfield Trail  
City, State, ZIP+4®  
Poway, CA 92064

PS Form 3800, April 2015 PSN 7530-02-000-9047 See Reverse for Instructions

7019 2970 0000 8911 5887

**U.S. Postal Service™  
CERTIFIED MAIL® RECEIPT**  
Domestic Mail Only

For delivery information, visit our website at [www.usps.com](http://www.usps.com)®.  
Cheyenne, WY 82001

**OFFICIAL USE**

Certified Mail Fee	\$3.55	0042
Extra Services & Fees (check box, add fee as appropriate)	\$2.85	07
<input type="checkbox"/> Return Receipt (hardcopy)	\$0.00	
<input type="checkbox"/> Return Receipt (electronic)	\$0.00	
<input type="checkbox"/> Certified Mail Restricted Delivery	\$0.00	
<input type="checkbox"/> Adult Signature Required	\$0.00	
<input type="checkbox"/> Adult Signature Restricted Delivery	\$0.00	
Postage	\$1.20	
<b>Total Postage and Fees</b>	<b>\$7.60</b>	

Sent To  
Street and Apt. No., or PO Box No.  
Christine Kay Connell  
915 Evergreen Street  
City, State, ZIP+4®  
Cheyenne, WY 82001

PS Form 3800, April 2015 PSN 7530-02-000-9047 See Reverse for Instructions

# faeIoperating

7019 2970 0000 8911 5795

**U.S. Postal Service™  
CERTIFIED MAIL® RECEIPT**  
Domestic Mail Only

For delivery information, visit our website at [www.usps.com](http://www.usps.com)®.

**McKinney, TX 75072**

**OFFICIAL USE**

Certified Mail Fee	\$3.55	
Extra Services & Fees (check box, add fee as appropriate)	\$2.85	
<input type="checkbox"/> Return Receipt (hardcopy)	\$0.00	
<input type="checkbox"/> Return Receipt (electronic)	\$0.00	
<input type="checkbox"/> Certified Mail Restricted Delivery	\$0.00	
<input type="checkbox"/> Adult Signature Required	\$0.00	
<input type="checkbox"/> Adult Signature Restricted Delivery	\$0.00	
Postage	\$1.20	
Total Postage and Fees	\$7.60	

0042 07  
Postmark Here  
AUG 10 2020  
08/10/2020

Sent To  
**Walner Family Trust**  
Street and Apt. No., or PO Box No.  
**1512 Lakeshore Court**  
City, State, ZIP+4®  
**McKinney, TX 75070 75072**

PS Form 3800, April 2015 PSN 7530-02-000-9047 See Reverse for Instructions

7019 2970 0000 8911 5788

**U.S. Postal Service™  
CERTIFIED MAIL® RECEIPT**  
Domestic Mail Only

For delivery information, visit our website at [www.usps.com](http://www.usps.com)®.

**Dallas, TX 75266**

**OFFICIAL USE**

Certified Mail Fee	\$3.55	
Extra Services & Fees (check box, add fee as appropriate)	\$2.85	
<input type="checkbox"/> Return Receipt (hardcopy)	\$0.00	
<input type="checkbox"/> Return Receipt (electronic)	\$0.00	
<input type="checkbox"/> Certified Mail Restricted Delivery	\$0.00	
<input type="checkbox"/> Adult Signature Required	\$0.00	
<input type="checkbox"/> Adult Signature Restricted Delivery	\$0.00	
Postage	\$1.20	
Total Postage and Fees	\$7.60	

0042 07  
Postmark Here  
AUG 10 2020  
08/10/2020

Sent To  
**Windom Royalties, LLC**  
Street and Apt. No., or PO Box No.  
**10 Box 668082**  
City, State, ZIP+4®  
**Dallas, TX 75266-0082**

PS Form 3800, April 2015 PSN 7530-02-000-9047 See Reverse for Instructions

7019 2970 0000 8911 5801

**U.S. Postal Service™  
CERTIFIED MAIL® RECEIPT**  
Domestic Mail Only

For delivery information, visit our website at [www.usps.com](http://www.usps.com)®.

**Cheyenne, WY 82009**

**OFFICIAL USE**

Certified Mail Fee	\$3.55	
Extra Services & Fees (check box, add fee as appropriate)	\$2.85	
<input type="checkbox"/> Return Receipt (hardcopy)	\$0.00	
<input type="checkbox"/> Return Receipt (electronic)	\$0.00	
<input type="checkbox"/> Certified Mail Restricted Delivery	\$0.00	
<input type="checkbox"/> Adult Signature Required	\$0.00	
<input type="checkbox"/> Adult Signature Restricted Delivery	\$0.00	
Postage	\$1.20	
Total Postage and Fees	\$7.60	

0042 07  
Postmark Here  
AUG 10 2020  
08/10/2020

Sent To  
**Betsy Phelan**  
Street and Apt. No., or PO Box No.  
**403 Prairie Hill Drive**  
City, State, ZIP+4®  
**Cheyenne, WY 82009**

PS Form 3800, April 2015 PSN 7530-02-000-9047 See Reverse for Instructions

7019 2970 0000 8911 5818

**U.S. Postal Service™  
CERTIFIED MAIL® RECEIPT**  
Domestic Mail Only

For delivery information, visit our website at [www.usps.com](http://www.usps.com)®.

**Wenoka, OK 74884**

**OFFICIAL USE**

Certified Mail Fee	\$3.55	
Extra Services & Fees (check box, add fee as appropriate)	\$2.85	
<input type="checkbox"/> Return Receipt (hardcopy)	\$0.00	
<input type="checkbox"/> Return Receipt (electronic)	\$0.00	
<input type="checkbox"/> Certified Mail Restricted Delivery	\$0.00	
<input type="checkbox"/> Adult Signature Required	\$0.00	
<input type="checkbox"/> Adult Signature Restricted Delivery	\$0.00	
Postage	\$1.20	
Total Postage and Fees	\$7.60	

0042 07  
Postmark Here  
AUG 10 2020  
08/10/2020

Sent To  
**Mekuskey Oil Company, LLC**  
Street and Apt. No., or PO Box No.  
**PO Box 816**  
City, State, ZIP+4®  
**Wenoka, OK 74884-0816**

PS Form 3800, April 2015 PSN 7530-02-000-9047 See Reverse for Instructions

7019 2970 0000 8911 5825

**U.S. Postal Service™  
CERTIFIED MAIL® RECEIPT**  
Domestic Mail Only

For delivery information, visit our website at [www.usps.com](http://www.usps.com)®.

**Midland, TX 79702**

**OFFICIAL USE**

Certified Mail Fee	\$3.55	
Extra Services & Fees (check box, add fee as appropriate)	\$2.85	
<input type="checkbox"/> Return Receipt (hardcopy)	\$0.00	
<input type="checkbox"/> Return Receipt (electronic)	\$0.00	
<input type="checkbox"/> Certified Mail Restricted Delivery	\$0.00	
<input type="checkbox"/> Adult Signature Required	\$0.00	
<input type="checkbox"/> Adult Signature Restricted Delivery	\$0.00	
Postage	\$1.20	
Total Postage and Fees	\$7.60	

0042 07  
Postmark Here  
AUG 10 2020  
08/10/2020

Sent To  
**Robert H. Marshall**  
Street and Apt. No., or PO Box No.  
**PO Box 1422**  
City, State, ZIP+4®  
**Midland, TX 79702**

PS Form 3800, April 2015 PSN 7530-02-000-9047 See Reverse for Instructions

7019 2970 0000 8911 5832

**U.S. Postal Service™  
CERTIFIED MAIL® RECEIPT**  
Domestic Mail Only

For delivery information, visit our website at [www.usps.com](http://www.usps.com)®.

**Dallas, TX 75373**

**OFFICIAL USE**

Certified Mail Fee	\$3.55	
Extra Services & Fees (check box, add fee as appropriate)	\$2.85	
<input type="checkbox"/> Return Receipt (hardcopy)	\$0.00	
<input type="checkbox"/> Return Receipt (electronic)	\$0.00	
<input type="checkbox"/> Certified Mail Restricted Delivery	\$0.00	
<input type="checkbox"/> Adult Signature Required	\$0.00	
<input type="checkbox"/> Adult Signature Restricted Delivery	\$0.00	
Postage	\$1.20	
Total Postage and Fees	\$7.60	

0042 07  
Postmark Here  
AUG 10 2020  
08/10/2020

Sent To  
**Marathon Oil Company**  
Street and Apt. No., or PO Box No.  
**PO Box 732312**  
City, State, ZIP+4®  
**Dallas, TX 75373-2312**

PS Form 3800, April 2015 PSN 7530-02-000-9047 See Reverse for Instructions