

NSL

Initial

Application

RECEIVED: 03/01/21	REVIEWER: LRL	TYPE: NSL	APP NO: pLEL2106038826
---------------------------	----------------------	------------------	-------------------------------

ABOVE THIS TABLE FOR OCD DIVISION USE ONLY

NEW MEXICO OIL CONSERVATION DIVISION
 - Geological & Engineering Bureau -
 1220 South St. Francis Drive, Santa Fe, NM 87505



ADMINISTRATIVE APPLICATION CHECKLIST

THIS CHECKLIST IS MANDATORY FOR ALL ADMINISTRATIVE APPLICATIONS FOR EXCEPTIONS TO DIVISION RULES AND REGULATIONS WHICH REQUIRE PROCESSING AT THE DIVISION LEVEL IN SANTA FE

Applicant: Mewbourne Oil Company **OGRID Number:** 14744
Well Name: Glock 17/16 WODA Fed Com #3H **API:** 30-015-43411
Pool: Burton Flat East Wolfcamp Gas Pool **Pool Code:** 73480

SUBMIT ACCURATE AND COMPLETE INFORMATION REQUIRED TO PROCESS THE TYPE OF APPLICATION INDICATED BELOW

- 1) **TYPE OF APPLICATION:** Check those which apply for [A]
- A. Location - Spacing Unit - Simultaneous Dedication
 NSL NSP (PROJECT AREA) NSP (PRORATION UNIT) SD
- B. Check one only for [I] or [II]
- [I] Commingling - Storage - Measurement
 DHC CTB PLC PC OLS OLM
- [II] Injection - Disposal - Pressure Increase - Enhanced Oil Recovery
 WFX PMX SWD IPI EOR PPR

FOR OCD ONLY	
<input type="checkbox"/>	Notice Complete
<input type="checkbox"/>	Application Content Complete

- 2) **NOTIFICATION REQUIRED TO:** Check those which apply.
- A. Offset operators or lease holders
 B. Royalty, overriding royalty owners, revenue owners
 C. Application requires published notice
 D. Notification and/or concurrent approval by SLO
 E. Notification and/or concurrent approval by BLM
 F. Surface owner
 G. For all of the above, proof of notification or publication is attached, and/or,
 H. No notice required

3) **CERTIFICATION:** I hereby certify that the information submitted with this application for administrative approval is **accurate** and **complete** to the best of my knowledge. I also understand that **no action** will be taken on this application until the required information and notifications are submitted to the Division.

Note: Statement must be completed by an individual with managerial and/or supervisory capacity.

Lee M. Scarborough
 Print or Type Name

1/6/2021
 Date

432-682-3715
 Phone Number

lscarborough@mewbourne.com
 e-mail Address

[Signature]
 Signature

MEWBOURNE OIL COMPANY

500 West Texas, Suite 1020
Midland, Texas 79701
Phone (432) 682-3715
Fax (432) 685-4170

February 12, 2021

Via Certified Mail

New Mexico Oil Conservation Division
1220 S. St. Francis Drive
Santa Fe, New Mexico 87505
Attn: Mr. Leonard Lowe
Division Director

Re: Application of Mewbourne Oil Company for administrative approval of an unorthodox well location, Glock 17/16 W0DA Fed Com #3H
Section 16 and 17
Township 20 South, Range 29 East, NMPM
Eddy County, New Mexico

Dear Mr. Lowe:

Mewbourne Oil Company (OGRID No. 114744) seeks administrative approval of an unorthodox well location ("NSL") for its Glock 17/16 W0DA Fed Com #3H (API# 30-015-43411) to be completed within the Burton Flat; Wolfcamp, East (Gas) Pool (Pool Code 73480) underlying the N/2 of Section 16 and N/2 of Section 17, Township 20 South, Range 29 East, N.M.P.M., Eddy County, New Mexico. A C-102 for the Well is attached as Exhibit "A". This is a horizontal gas well that has been drilled as follows:

Glock 17/16 W0DA Fed Com #3H

API# 30-015-43411

Surface Location (S.L.): 824' FNL & 582' FEL (Unit A) (Section 18)

First Perf (F.P.): 1310' FNL and 100' FWL (Unit D) (Section 17)

Bottomhole Location (B.H.): 1310' FNL & 100' FEL (Unit A) (Section 16)

Last Perf (L.P.): 1310' FNL & 100' FEL (Unit A) (Section 16)

Burton Flat; Wolfcamp, East (Gas) Pool; Pool Code: 73480

Spacing Unit: N/2 of Section 16 and N/2 of Section 17, T20S, R29E, Eddy County, NM

Mewbourne Oil Company is requesting approval of a non-standard location in order to efficiently produce its interests in Section 16 and Section 17. The Glock 17/16 W0DA Fed Com #3H Well will produce from the Burton Flat; Wolfcamp, East (Gas) Pool (Pool Code 73480). There are no special pool rules for this pool, thus the setback requirements under Rule 19.15.16.15(C) of 330' apply. The completed interval for the subject well is closer than 330'

from the boundary of the spacing unit. The unorthodox location will encroach towards the W/2 of Section 15, Township 20 South, Range 29 East. A list of surrounding Wolfcamp operators is attached as Exhibit "B".

A list of the parties affected by the encroachment is attached as Exhibit "C". Each of these parties has been provided notice of this application by certified mail, return receipt requested, advising them that if they have an objection to the location of this Well, it must be filed with the New Mexico Oil Conservation Division within 20 days of this mailing notice.

Should you have any questions regarding the above, please email me at lscarborough@mewbourne.com or call me at (432) 682-3715.

Very truly yours,

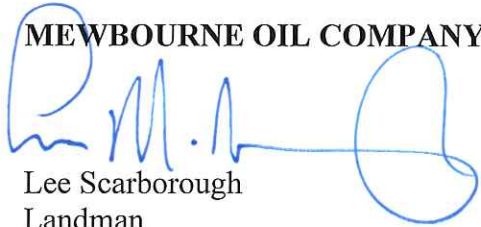
MEWBOURNE OIL COMPANY

Lee Scarborough
Landman

Enclosures

MEWBOURNE OIL COMPANY

500 West Texas, Suite 1020
Midland, Texas 79701
Phone (432) 682-3715
Fax (432) 685-4170

January 6, 2021

Via Certified Mail

Matador Production Company
Attn: Permian Land Manager
5400 LBJ Freeway, #1500
Dallas, Texas 75240

Re: Application for Unorthodox Well Location
Glock 17/16 W0DA Fed Com #3H
API# 30-015-43411
Section 17 & 16, T-20-S, R-29-E, NMPM
Eddy County, New Mexico

Gentlemen:

Enclosed is a copy of Mewbourne Oil Company's (MOC) Application for Unorthodox Well Location for the Glock 17/16 W0DA Fed Com #3H well in Sections 17 & 16, T-20-S, R-29-E, Eddy County, New Mexico. You are being sent a copy of this Application per OCD's requirements to notify the interest owners in the affected offset acreage. If you have any objection to this Application, notification should be given within 20 days of the date of this letter. The Application has been filed with the OCD as of this date.

MOC is seeking approval of the unorthodox location in order to allow for the efficient recovery of reserves, thereby preventing waste.

If you have any questions regarding this application, please contact the undersigned by telephone at 432-682-3715 or email at lscarborough@mewbourne.com.

Very truly yours,

MEWBOURNE OIL COMPANY

Lee Scarborough
Landman

Enclosures



Proof of Acceptance (Electronic)

Date: 1/8/2021

Client Name: Mewbourne Oil Company

Certified with RR(E) item number 9414836897846521103111,
addressed to Permian Land Manager

Accepted at USPS Regional Facility-January 6, 2021, 9:06 pm,
MIDLAND TX DISTRIBUTION CENTER,

The item number, time, date, city, state, and zip code is a true extract of
information provided by the United States Postal Service to
SimpleCertifiedMail.com.

Permian Land Manager
Matador Production company
5400 LBJ Freeway, #1500
Dallas, TX 75240
Reference #: Glock 17/16
Group Name: MIDLAND OFFICE

The above information is for the sole use of SimpleCertifiedMail.com
clients and represents information provided by the United States Postal
Service.

District I
1625 N. French Dr., Hobbs, NM 88240
Phone: (575) 393-6161 Fax: (575) 393-0720
District II
811 S. First St., Artesia, NM 88210
Phone: (575) 748-1283 Fax: (575) 748-9720
District III
1000 Rio Brazos Road, Aztec, NM 87410
Phone: (505) 334-6178 Fax: (505) 334-6170
District IV
1220 S. St. Francis Dr., Santa Fe, NM 87505
Phone: (505) 476-3460 Fax: (505) 476-3462

State of New Mexico
Energy, Minerals & Natural Resources Department
OIL CONSERVATION DIVISION
1220 South St. Francis Dr.
Santa Fe, NM 87505

Form C-102
Revised August 1, 2011
Submit one copy to appropriate
District Office

AMENDED REPORT

WELL LOCATION AND ACREAGE DEDICATION PLAT

1 API Number		2 Pool Code		3 Pool Name	
4 Property Code		5 Property Name GLOCK 17/16 WODA FED COM			6 Well Number 3H
7 GRID NO.		8 Operator Name MEWBOURNE OIL COMPANY			9 Elevation 3265'

10 Surface Location

UL or lot no.	Section	Township	Range	Lot Idn	Feet from the	North/South line	Feet From the	East/West line	County
A	18	20S	29E		824	NORTH	582	EAST	EDDY

11 Bottom Hole Location If Different From Surface

UL or lot no.	Section	Township	Range	Lot Idn	Feet from the	North/South line	Feet from the	East/West line	County
A	16	20S	29E		1310	NORTH	100	EAST	EDDY

12 Dedicated Acres	13 Joint or Infill	14 Consolidation Code	15 Order No.
--------------------	--------------------	-----------------------	--------------

No allowable will be assigned to this completion until all interest have been consolidated or a non-standard unit has been approved by the division.

16

GEODETIC DATA
NAD 83 GRID - NM EAST

SURFACE LOCATION
N: 574263.9 - E: 610845.2
LAT: 32.5785032° N
LONG: 104.1076783° W

BOTTOM HOLE
N: 573795.2 - E: 621902.7
LAT: 32.5771454° N
LONG: 104.0717844° W

CORNER DATA
NAD 83 GRID - NM EAST

A: FOUND 1" IRON PIPE
N: 569795.3 - E: 606355.1

B: FOUND BRASS CAP "1942"
N: 572439.7 - E: 606381.9

C: FOUND BRASS CAP "1916"
N: 575081.0 - E: 606409.4

D: FOUND BRASS CAP "1916"
N: 575085.1 - E: 608784.7

E: FOUND BRASS CAP "1916"
N: 575088.6 - E: 611425.3

F: FOUND BRASS CAP "1916"
N: 575086.5 - E: 614071.1

G: FOUND BRASS CAP "1916"
N: 575085.0 - E: 616714.9

H: FOUND BRASS CAP "1916"
N: 575095.2 - E: 619357.5

I: FOUND BRASS CAP "1916"
N: 575105.3 - E: 621999.3

J: FOUND BRASS CAP "1916"
N: 572462.9 - E: 622006.1

K: FOUND BRASS CAP "1916"
N: 569820.2 - E: 622012.4

L: FOUND BRASS CAP "1916"
N: 569809.9 - E: 619369.9

M: FOUND BRASS CAP "1916"
N: 569798.5 - E: 616727.8

N: FOUND BRASS CAP "1916"
N: 569801.9 - E: 614082.2

O: FOUND BRASS CAP "1916"
N: 569804.9 - E: 611437.8

P: FOUND BRASS CAP "1916"
N: 569800.7 - E: 608796.2

Q: FOUND BRASS CAP "1916"
N: 572443.7 - E: 616721.6

17 OPERATOR CERTIFICATION
I hereby certify that the information contained herein is true and complete to the best of my knowledge and belief, and that this organization either owns a working interest or unleased mineral interest in the land including the proposed bottom hole location or has a right to drill this well at this location pursuant to a contract with an owner of such a mineral or working interest, or to a voluntary pooling agreement or a compulsory pooling order heretofore entered by the division.

Signature _____ Date _____

Printed Name _____

E-mail Address _____

18 SURVEYOR CERTIFICATION
I hereby certify that the well location shown on this plat was plotted from field notes of actual surveys made by me or under my supervision, and that the same is true and correct to the best of my belief.

2-26-2019
Date of Survey

Signature and Seal of Professional Surveyor _____

19680
Certificate Number

District I
1625 N. French Dr., Hobbs, NM 88240
Phone: (575) 393-6161 Fax: (575) 393-0720
District II
811 S. First St., Artesia, NM 88210
Phone: (575) 748-1283 Fax: (575) 748-9720
District III
1000 Rio Brazos Road, Aztec, NM 87410
Phone: (505) 334-6178 Fax: (505) 334-6170
District IV
1220 S. St. Francis Dr., Santa Fe, NM 87505
Phone: (505) 476-3460 Fax: (505) 476-3462

State of New Mexico
Energy, Minerals & Natural Resources Department
OIL CONSERVATION DIVISION
1220 South St. Francis Dr.
Santa Fe, NM 87505

Form C-102
Revised August 1, 2011
Submit one copy to appropriate
District Office

AMENDED REPORT

WELL LOCATION AND ACREAGE DEDICATION PLAT

¹ API Number		² Pool Code		³ Pool Name	
⁴ Property Code		⁵ Property Name GLOCK 17/16 WODA FED COM			⁶ Well Number 3H
⁷ GRID NO.		⁸ Operator Name MEWBOURNE OIL COMPANY			⁹ Elevation 3265'

¹⁰ Surface Location

UL or lot no.	Section	Township	Range	Lot Idn	Feet from the	North/South line	Feet From the	East/West line	County
A	18	20S	29E		824	NORTH	582	EAST	EDDY

¹¹ Bottom Hole Location If Different From Surface

UL or lot no.	Section	Township	Range	Lot Idn	Feet from the	North/South line	Feet from the	East/West line	County
A	16	20S	29E		1310	NORTH	330	EAST	EDDY

¹² Dedicated Acres	¹³ Joint or Infill	¹⁴ Consolidation Code	¹⁵ Order No.

No allowable will be assigned to this completion until all interest have been consolidated or a non-standard unit has been approved by the division.

16

GEODETIC DATA
NAD 83 GRID - NM EAST

SURFACE LOCATION
N: 574263.9 - E: 610845.2
LAT: 32.5785032° N
LONG: 104.1076783° W

BOTTOM HOLE
N: 573794.3 - E: 621672.7
LAT: 32.5771446° N
LONG: 104.0725309° W

CORNER DATA
NAD 83 GRID - NM EAST

A: FOUND 1" IRON PIPE
N: 569795.3 - E: 606355.1

B: FOUND BRASS CAP "1942"
N: 572439.7 - E: 606381.9

C: FOUND BRASS CAP "1916"
N: 575081.0 - E: 606409.4

D: FOUND BRASS CAP "1916"
N: 575085.1 - E: 608784.7

E: FOUND BRASS CAP "1916"
N: 575088.6 - E: 611425.3

F: FOUND BRASS CAP "1916"
N: 575086.5 - E: 614071.1

G: FOUND BRASS CAP "1916"
N: 575085.0 - E: 616714.9

H: FOUND BRASS CAP "1916"
N: 575095.2 - E: 619357.5

I: FOUND BRASS CAP "1916"
N: 575105.3 - E: 621999.3

J: FOUND BRASS CAP "1916"
N: 572462.9 - E: 622006.1

K: FOUND BRASS CAP "1916"
N: 569820.2 - E: 622012.4

L: FOUND BRASS CAP "1916"
N: 569809.9 - E: 619369.9

M: FOUND BRASS CAP "1916"
N: 569798.5 - E: 616727.8

N: FOUND BRASS CAP "1916"
N: 569801.9 - E: 614082.2

O: FOUND BRASS CAP "1916"
N: 569804.9 - E: 611437.8

P: FOUND BRASS CAP "1916"
N: 569800.7 - E: 608796.2

Q: FOUND BRASS CAP "1916"
N: 572443.7 - E: 616721.6

17 OPERATOR CERTIFICATION
I hereby certify that the information contained herein is true and complete to the best of my knowledge and belief, and that this organization either owns a working interest or unleased mineral interest in the land including the proposed bottom hole location or has a right to drill this well at this location pursuant to a contract with an owner of such a mineral or working interest, or to a voluntary pooling agreement or a compulsory pooling order heretofore entered by the division.

Signature _____ Date _____

Printed Name _____

E-mail Address _____

18 SURVEYOR CERTIFICATION
I hereby certify that the well location shown on this plat was plotted from field notes of actual surveys made by me or under my supervision, and that the same is true and correct to the best of my belief.

2-26-2019
Date of Survey

Signature and Seal of Professional Surveyor _____

19680
Certificate Number

REV: 4/4/19 NAME/BHL

Job No: LS19020223

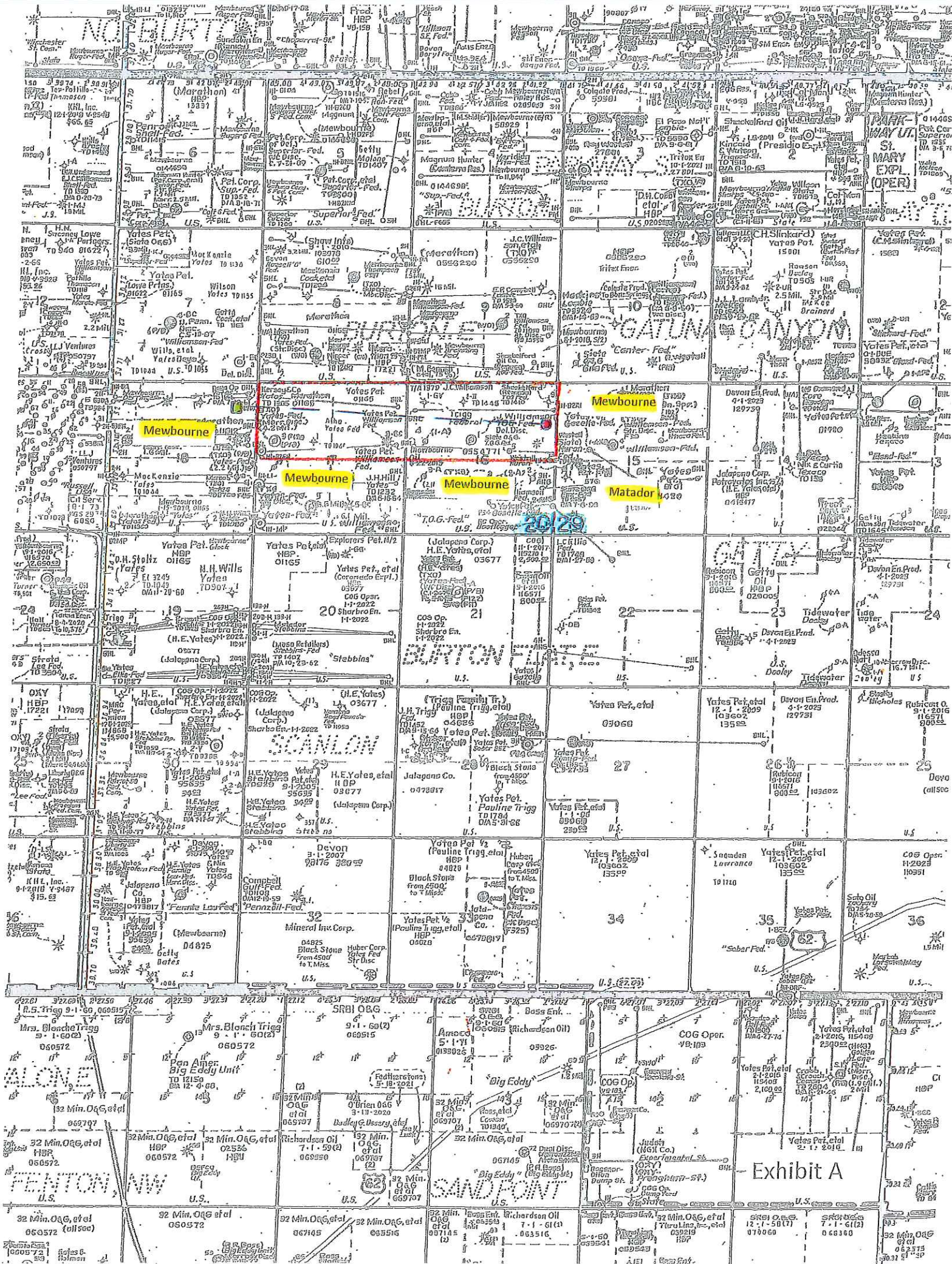

NO. 100

Mewbourne

Mewbourne

Mewbourne

Mewbourne

Matador

2029

Exhibit A

Exhibit B

List of Wolfcamp Operators

Mewbourne Oil Company

Matador Production Company

Exhibit C

List of Affected Parties

Mewbourne Oil Company

Matador Production Company