

Initial Application Part I

Received: 2/16/2022

This application is placed in file for record. It MAY or MAY NOT have been reviewed to be determined Administratively Complete

STATE OF NEW MEXICO
ENERGY, MINERALS AND NATURAL
RESOURCES DEPARTMENT

Oil Conservation Division
1220 South St. Francis Dr.
Santa Fe, New Mexico 87505

FORM C-108
Revised June 10, 2003

APPLICATION FOR AUTHORIZATION TO INJECT

- I. PURPOSE: Secondary Recovery Pressure Maintenance ☒ Disposal Storage
Application qualifies for administrative approval? ☒ Yes ☐ No
- II. OPERATOR: Sabinal Energy Operating, LLC
ADDRESS: 1780 Hughes Landing Blvd. Ste 1200 The Woodlands, TX
77380
CONTACT PARTY: Erin Mazur PHONE: 346-224-9270
- III. WELL DATA: Complete the data required on the reverse side of this form for each well proposed for injection.
Additional sheets may be attached if necessary.
- IV. Is this an expansion of an existing project? ☐ Yes ☒ No
If yes, give the Division order number authorizing the project: _____
- V. Attach a map that identifies all wells and leases within two miles of any proposed injection well with a one-half mile radius circle drawn around each proposed injection well. This circle identifies the well's area of review.
- VI. Attach a tabulation of data on all wells of public record within the area of review which penetrate the proposed injection zone. Such data shall include a description of each well's type, construction, date drilled, location, depth, record of completion, and a schematic of any plugged well illustrating all plugging detail.
- VII. Attach data on the proposed operation, including:
1. Proposed average and maximum daily rate and volume of fluids to be injected;
 2. Whether the system is open or closed;
 3. Proposed average and maximum injection pressure;
 4. Sources and an appropriate analysis of injection fluid and compatibility with the receiving formation if other than reinjected produced water; and,
 5. If injection is for disposal purposes into a zone not productive of oil or gas at or within one mile of the proposed well, attach a chemical analysis of the disposal zone formation water (may be measured or inferred from existing literature, studies, nearby wells, etc.).
- *VIII. Attach appropriate geologic data on the injection zone including appropriate lithologic detail, geologic name, thickness, and depth. Give the geologic name, and depth to bottom of all underground sources of drinking water (aquifers containing waters with total dissolved solids concentrations of 10,000 mg/l or less) overlying the proposed injection zone as well as any such sources known to be immediately underlying the injection interval.
- IX. Describe the proposed stimulation program, if any.
- *X. Attach appropriate logging and test data on the well. (If well logs have been filed with the Division, they need not be resubmitted).
- *XI. Attach a chemical analysis of fresh water from two or more fresh water wells (if available and producing) within one mile of any injection or disposal well showing location of wells and dates samples were taken.
- XII. Applicants for disposal wells must make an affirmative statement that they have examined available geologic and engineering data and find no evidence of open faults or any other hydrologic connection between the disposal zone and any underground sources of drinking water.
- XIII. Applicants must complete the "Proof of Notice" section on the reverse side of this form.
- XIV. Certification: I hereby certify that the information submitted with this application is true and correct to the best of my knowledge and belief.
- NAME: Erin Mazur TITLE: Sr. Reg Analyst
SIGNATURE: E. Mazur DATE: 2/16/22
E-MAIL ADDRESS: erinm@sabinalenergy.com
- * If the information required under Sections VI, VIII, X, and XI above has been previously submitted, it need not be resubmitted.
Please show the date and circumstances of the earlier submittal: All filed w/ original application.
Application is for return to injection after being SI
- DISTRIBUTION: Original and one copy to Santa Fe with one copy to the appropriate District Office

III. WELL DATA

A. The following well data must be submitted for each injection well covered by this application. The data must be both in tabular and schematic form and shall include:

- (1) Lease name; Well No.; Location by Section, Township and Range; and footage location within the section.
- (2) Each casing string used with its size, setting depth, sacks of cement used, hole size, top of cement, and how such top was determined.
- (3) A description of the tubing to be used including its size, lining material, and setting depth.
- (4) The name, model, and setting depth of the packer used or a description of any other seal system or assembly used.

Division District Offices have supplies of Well Data Sheets which may be used or which may be used as models for this purpose. Applicants for several identical wells may submit a "typical data sheet" rather than submitting the data for each well.

B. The following must be submitted for each injection well covered by this application. All items must be addressed for the initial well. Responses for additional wells need be shown only when different. Information shown on schematics need not be repeated.

- (1) The name of the injection formation and, if applicable, the field or pool name.
- (2) The injection interval and whether it is perforated or open-hole.
- (3) State if the well was drilled for injection or, if not, the original purpose of the well.
- (4) Give the depths of any other perforated intervals and detail on the sacks of cement or bridge plugs used to seal off such perforations.
- (5) Give the depth to and the name of the next higher and next lower oil or gas zone in the area of the well, if any.

XIV. PROOF OF NOTICE

All applicants must furnish proof that a copy of the application has been furnished, by certified or registered mail, to the owner of the surface of the land on which the well is to be located and to each leasehold operator within one-half mile of the well location.

Where an application is subject to administrative approval, a proof of publication must be submitted. Such proof shall consist of a copy of the legal advertisement which was published in the county in which the well is located. The contents of such advertisement must include:

- (1) The name, address, phone number, and contact party for the applicant;
- (2) The intended purpose of the injection well; with the exact location of single wells or the Section, Township, and Range location of multiple wells;
- (3) The formation name and depth with expected maximum injection rates and pressures; and,
- (4) A notation that interested parties must file objections or requests for hearing with the Oil Conservation Division, 1220 South St. Francis Dr., Santa Fe, New Mexico 87505, within 15 days.

NO ACTION WILL BE TAKEN ON THE APPLICATION UNTIL PROPER PROOF OF NOTICE HAS BEEN SUBMITTED.

NOTICE: Surface owners or offset operators must file any objections or requests for hearing of administrative applications within 15 days from the date this application was mailed to them.

FORM C-108

APPLICATION for AUTHORIZATION to INJECT

SABINAL ENERGY OPERATING, LLC

LAMBIRTH STATE #1

- I. This disposal well application qualifies for administrative approval.
- II. Operator: Sabinal Energy Operating, LLC
Address: 1780 Hughes Landing Blvd, Ste 1200 The Woodlands, TX 77380
Contact: Erin Mazur 346-224-9270
- III. Well data sheet is attached as Injection Well Data Sheet as **Attachment No. 1**
- IV. This is not an expansion of an existing project.
- V. A map is attached which identifies the well's Area of Review as **Attachment No. 2**
- VI. A tabulation of data from all wells within the Area of Review and other pertinent information is attached as **Attachment No. 3**. Also included are well completion records and wellbore schematics of all plugged wells. Previously submitted 9/14/93.

- VII. **Proposed Operational Data:**
 - a. The average injection rate will be 1000 BWPD and the maximum injection rate will be 2000 BWPD
 - b. The system is closed
 - c. The average injection pressure will be 200 psi and the maximum injection pressure will be 1500 psi.
 - d. The source of produced water will be the Fusselman formation (reinjecting produced water) from nearby leases. Water analysis is attached as **Attachment No. 4**.
 - e. The disposal zone is productive or oil within one mile of the disposal well.

VIII. GEOLOGIC DATA

- Previously submitted 9/14/93.
- IX. The Fusselman formation will be acidized with approximately 1500 gallons of 15% hydrochloric acid.
- X. Well logs have previously been filed with the Division.
- XI. Previously submitted 9/14/93.
- XII. All available geological and engineering data has been examined and no evidence of open faults or any other hydrological connection between the injection zone and underground drinking water was found
- XIII. I hereby certify a complete copy of this application, with a copy of the publisher's affidavit of Publication attached as **Attachment No. 5**, has been sent by certified mail on February 16, 2022.

Surface Owner:

State of New Mexico
State Land Office
PO BOX 1148
Santa Fe, New Mexico 87504-1148

Offset Operators:

Sabinal Energy Operating, LLC is the only offset

INJECTION WELL DATA SHEET

Operator: Okie Crude Company

Lease and Well: Lambirth State No. 1

Location: 1980 ft FNL and 510 ft FEL

Sec. 36, T-5-S, R-32-E

Roosevelt County

Well Schematic

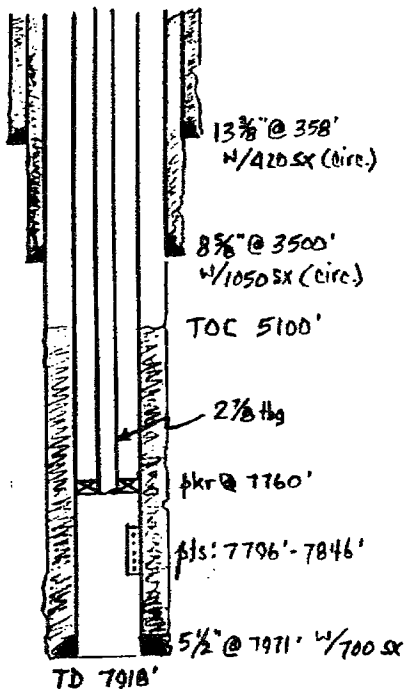

Tubular Data

Surface casing

13-3/8", 48#, H-40 set at 358 ft and cemented to surface by circulating 420 sacks in 17-1/2" hole.

Intermediate Casing

8-5/8", 24#, K-55 set at 3500 ft and cemented to surface by circulating 1050 sacks in 11" hole

Production Casing

5-1/2", 14# & 15.5#, K-55 set at 7971 ft and cemented with 700 sacks Class H cement in 7-7/8" hole. Top of cement at 5100 ft determined by temperature survey. Total depth of well is 7918 ft.

Injection Interval

Well is perforated from 7796 ft to 7846 ft

Tubing String

2-7/8" internally plastic coated set in Baker Model AD-1 tension packer at 7760 ft.

Other Data

1. Name of the Injection formation: Fusselman
2. Name of the field or Pool (if applicable): Peterson, South
3. Is this a new well drilled for injection? No, well was originally drilled as a Fusselman oilwell
4. Has the well ever been perforated in any other zone(s)? No
5. Give the depth to and name of any overlying and/or underlying oil or gas zones (pools) in this area. 7550 ft, Peterson Penn Associated, South

OKIE CRUDE COMPANY

ATTACHMENT NO. 1

FORM C-108

APPLICATION for AUTHORIZATION to INJECT

SABINAL ENERGY OPERATING, LLC

LAMBIRTH STATE #1

- I. This disposal well application qualifies for administrative approval.
- II. Operator: Sabinal Energy Operating, LLC
Address: 1780 Hughes Landing Blvd, Ste 1200 The Woodlands, TX 77380
Contact: Erin Mazur 346-224-9270
- III. Well data sheet is attached as Injection Well Data Sheet as **Attachment No. 1**
- IV. This is not an expansion of an existing project.
- V. A map is attached which identifies the well's Area of Review as **Attachment No. 2**
- VI. A tabulation of data from all wells within the Area of Review and other pertinent information is attached as **Attachment No. 3**. Also included are well completion records and wellbore schematics of all plugged wells. Previously submitted 9/14/93.

- VII. **Proposed Operational Data:**
 - a. The average injection rate will be 1000 BWPD and the maximum injection rate will be 2000 BWPD
 - b. The system is closed
 - c. The average injection pressure will be 200 psi and the maximum injection pressure will be 1500 psi.
 - d. The source of produced water will be the Fusselman formation (reinjecting produced water) from nearby leases. Water analysis is attached as **Attachment No. 4**.
 - e. The disposal zone is productive or oil within one mile of the disposal well.

VIII. GEOLOGIC DATA

- Previously submitted 9/14/93.
- IX. The Fusselman formation will be acidized with approximately 1500 gallons of 15% hydrochloric acid.
- X. Well logs have previously been filed with the Division.
- XI. Previously submitted 9/14/93.
- XII. All available geological and engineering data has been examined and no evidence of open faults or any other hydrological connection between the injection zone and underground drinking water was found
- XIII. I hereby certify a complete copy of this application, with a copy of the publisher's affidavit of Publication attached as **Attachment No. 5**, has been sent by certified mail on February 16, 2022.

Surface Owner:

State of New Mexico
State Land Office
PO BOX 1148
Santa Fe, New Mexico 87504-1148

Offset Operators:

Sabinal Energy Operating, LLC is the only offset

INJECTION WELL DATA SHEET

Operator: Okie Crude Company

Lease and Well: Lambirth State No. 1

Location: 1980 ft FNL and 510 ft FEL

Sec. 36, T-5-S, R-32-E

Roosevelt County

Well Schematic

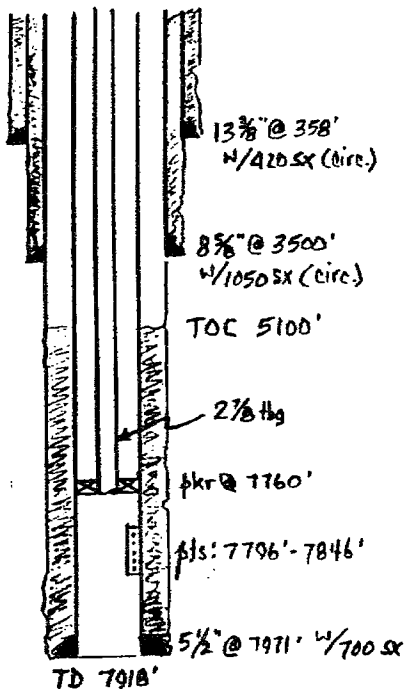

Tubular Data

Surface casing

13-3/8", 48#, H-40 set at 358 ft and cemented to surface by circulating 420 sacks in 17-1/2" hole.

Intermediate Casing

8-5/8", 24#, K-55 set at 3500 ft and cemented to surface by circulating 1050 sacks in 11" hole

Production Casing

5-1/2", 14# & 15.5#, K-55 set at 7971 ft and cemented with 700 sacks Class H cement in 7-7/8" hole. Top of cement at 5100 ft determined by temperature survey. Total depth of well is 7918 ft.

Injection Interval

Well is perforated from 7796 ft to 7846 ft

Tubing String

2-7/8" internally plastic coated set in Baker Model AD-1 tension packer at 7760 ft.

Other Data

1. Name of the Injection formation: Fusselman
2. Name of the field or Pool (if applicable): Peterson, South
3. Is this a new well drilled for injection? No, well was originally drilled as a Fusselman oilwell
4. Has the well ever been perforated in any other zone(s)? No
5. Give the depth to and name of any overlying and/or underlying oil or gas zones (pools) in this area. 7550 ft, Peterson Penn Associated, South

OKIE CRUDE COMPANY

ATTACHMENT NO. 1

NEW MEXICO OIL CONSERVATION COMMISSION
WELL LOCATION AND ACREAGE DEDICATION PLAT

Form C-102
Supersedes C-128
Effective 1-1-65

All distances must be from the outer boundaries of the Section

Operator PHILLIPS PETROLEUM Co.			Lease LAMBRITH STATE			Well No. 1
Tract Letter H	Section 36	Township 5 South	Range 32 East	County Roosevelt		
Actual Footage Location of Well: 1980 feet from the North line and 510 feet from the East line						
Ground Level Elev. 4381.7	Producing Formation Fusselman		Pool Peterson Fusselman, South		Dedicated Acreage: 80 Acres	

1. Outline the acreage dedicated to the subject well by colored pencil or hatchure marks on the plat below.
2. If more than one lease is dedicated to the well, outline each and identify the ownership thereof (both as to working interest and royalty).
3. If more than one lease of different ownership is dedicated to the well, have the interests of all owners been consolidated by communitization, unitization, force-pooling, etc?

☐ Yes ☐ No If answer is "yes," type of consolidation _____

If answer is "no," list the owners and tract descriptions which have actually been consolidated. (Use reverse side of this form if necessary.) _____

No allowable will be assigned to the well until all interests have been consolidated (by communitization, unitization, forced-pooling, or otherwise) or until a non-standard unit, eliminating such interests, has been approved by the Commission.

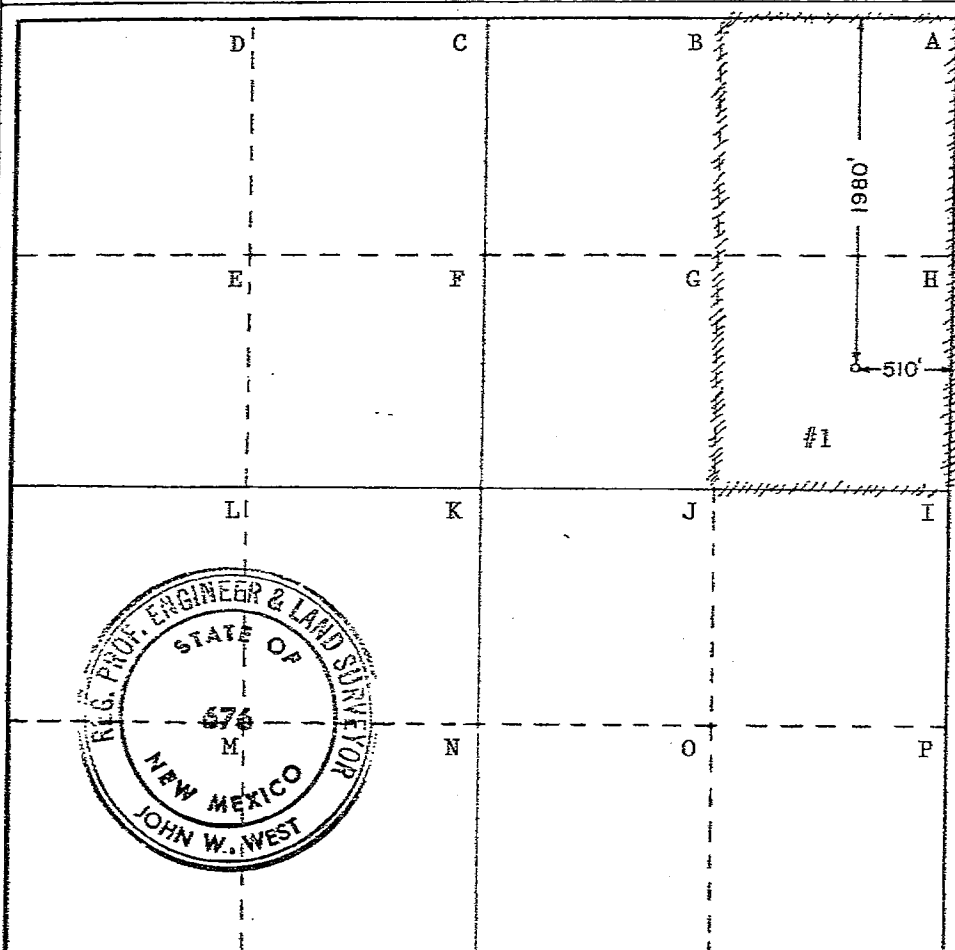

CERTIFICATION

I hereby certify that the information contained herein is true and complete to the best of my knowledge and belief.

W. J. Mueller
Name

W. J. Mueller
Position

Senior Engineering Specialist

Company

Phillips Petroleum Company

Date

October 22, 1979

I hereby certify that the well location shown on this plat was plotted from field notes of actual surveys made by me or under my supervision, and that the same is true and correct to the best of my knowledge and belief.

Date Surveyed

October 17, 1979

Registered Professional Engineer and/or Land Surveyor

John W. West
Signature

Certificate No. John W. West

676

Ronald J. Eidson

3239

0 330 540 90 1320 1680 1980 2310 2640 2000 1500 1000 500

CALCULATIONS AND DESIGN DATA		PREPARED BY RFC
SUBJECT	DATE 9-7-93	SHEET 1 OF 3
Wellbore schematics showing all plugging detail		

Lambirth No. 6
P&A'd 4/83

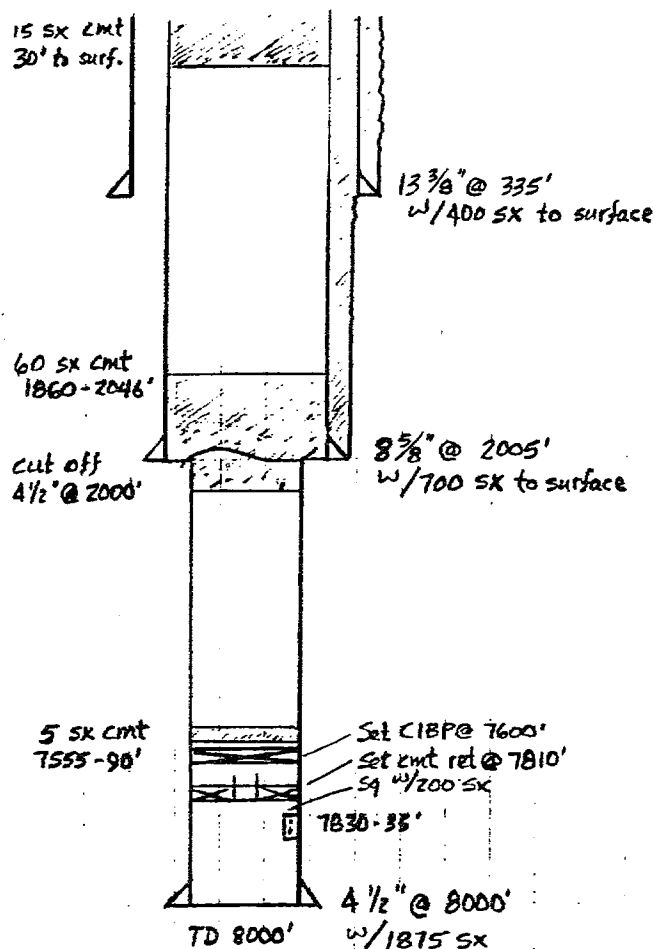

P&A work performed 4-9-83 to 4-16-83

Lambirth No. 9
P&A'd 5/92

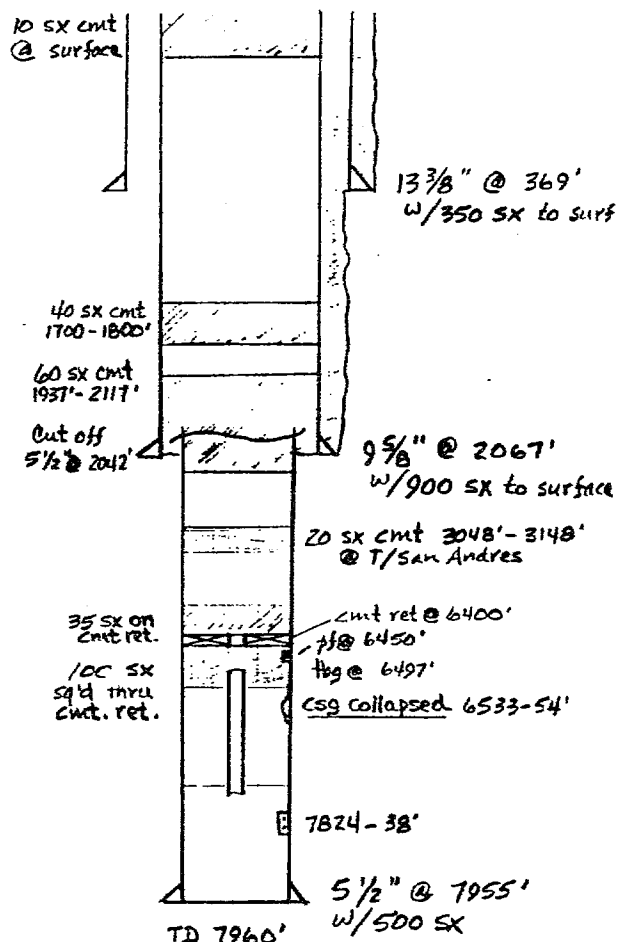

P&A work performed 5-11-92 to 5-13-92

PLUGGING DETAIL

ATTACHMENT NO. 3

PAGE 29 OF 31

CALCULATIONS AND DESIGN DATA		PREPARED BY RFC
SUBJECT		DATE 9-7-93
Wellbore schematics showing all plugging detail		SHEET 2 OF 3

Lambirth No. 10
P&A'd 5-92

Goldston A No. 2
P&A'd 7-73

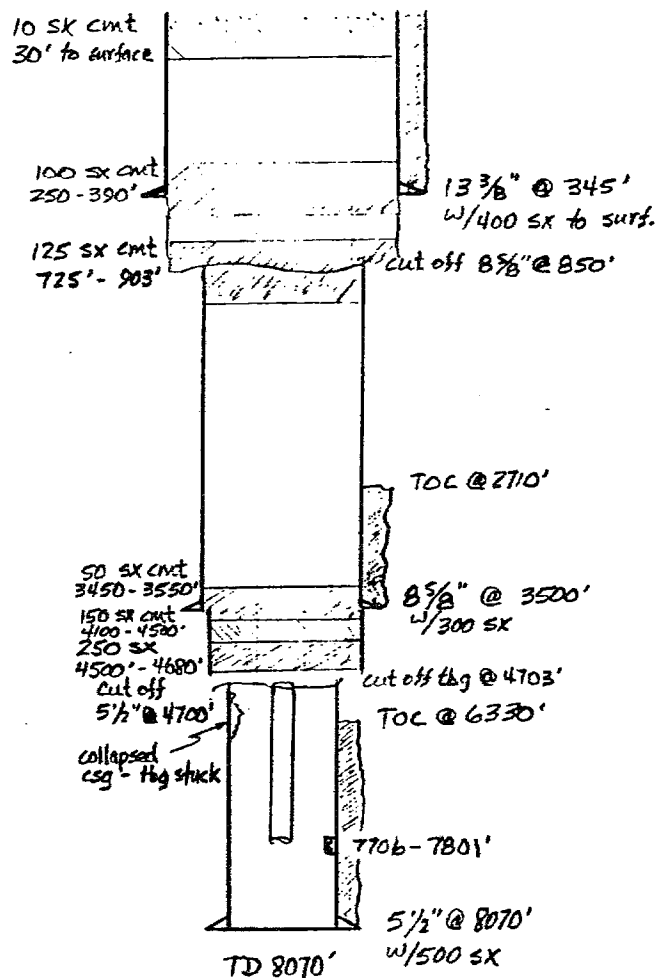
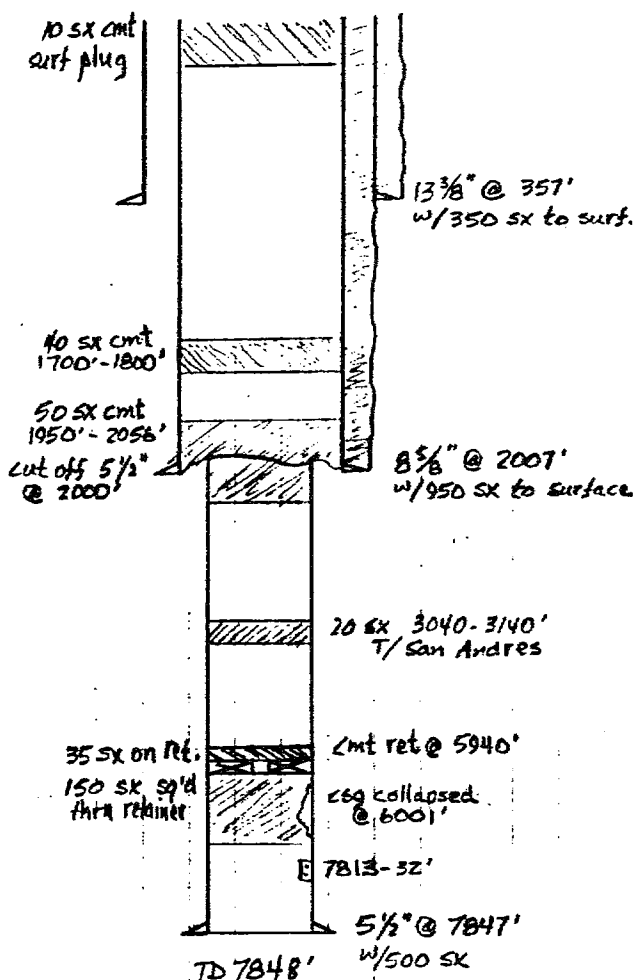

P&A work performed 10/89 and 5-13&14-92
hole circulated w/ 9.5#/gal mud

P&A work performed 7-9-73 to 7-27-73
hole loaded w/mud prior to spotting plugs

CALCULATIONS AND DESIGN DATA		PREPARED BY AFC
SUBJECT	DATE 9-7-93	SHEET 3 OF 3
Wellbore schematics showing all plugging detail		

Goldston Oil Corp. -

Lambirth State A No. 1 — Same Well —



D&A'd 8/51

Phillips Petroleum Co.

Goldston A No. 1

re-entered 8/72

J&A'd 9/72

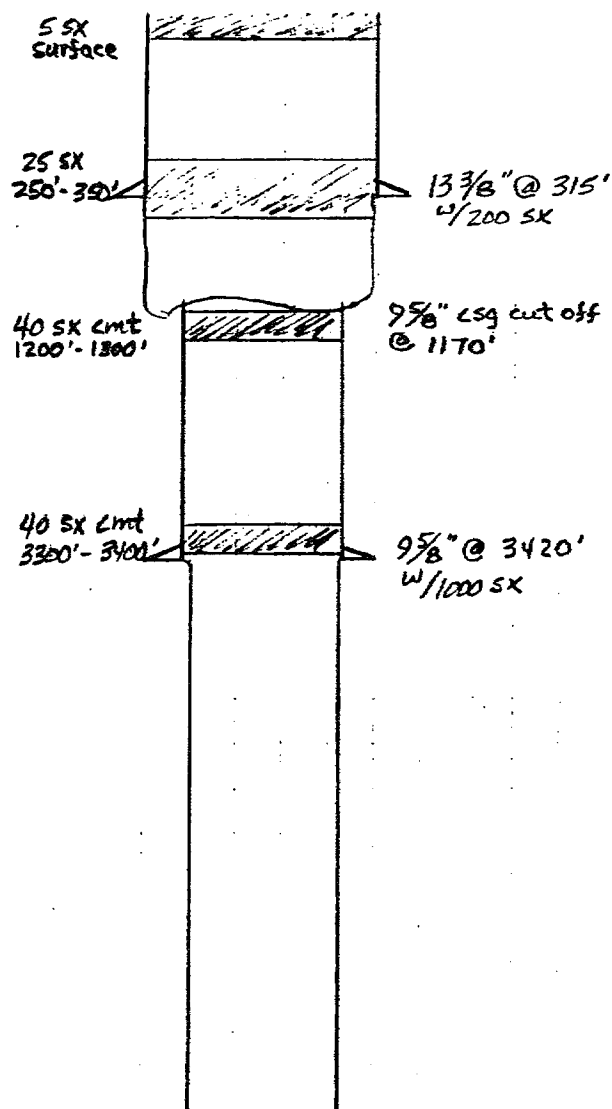

TD 8297'

Work performed 5-28-51 to 8-10-51
Hole left full of heavy mud

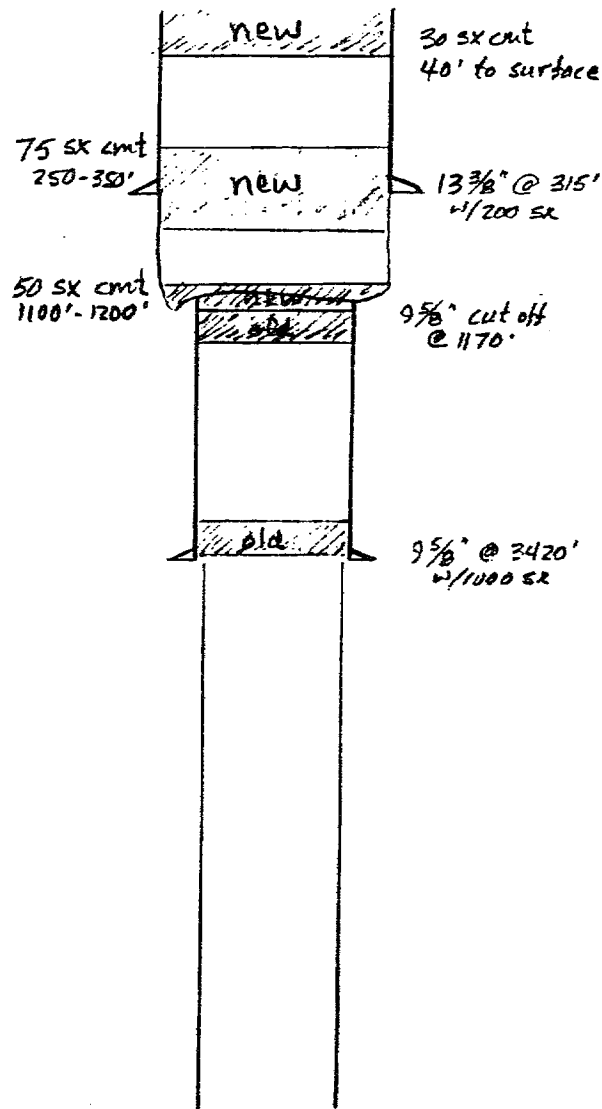

TD 8297'

Attempted to re-enter - could not get below
cut off 9 5/8 inch casing @ 1170'. Hole loaded w/9.8"
mud between plugs

PLUGGING DETAIL

ATTACHMENT NO. 3

PAGE 31 OF 31

11-20-79
11-30-79
12-12-79
1-11-80
1-25-80
2-8-80

[illegible]

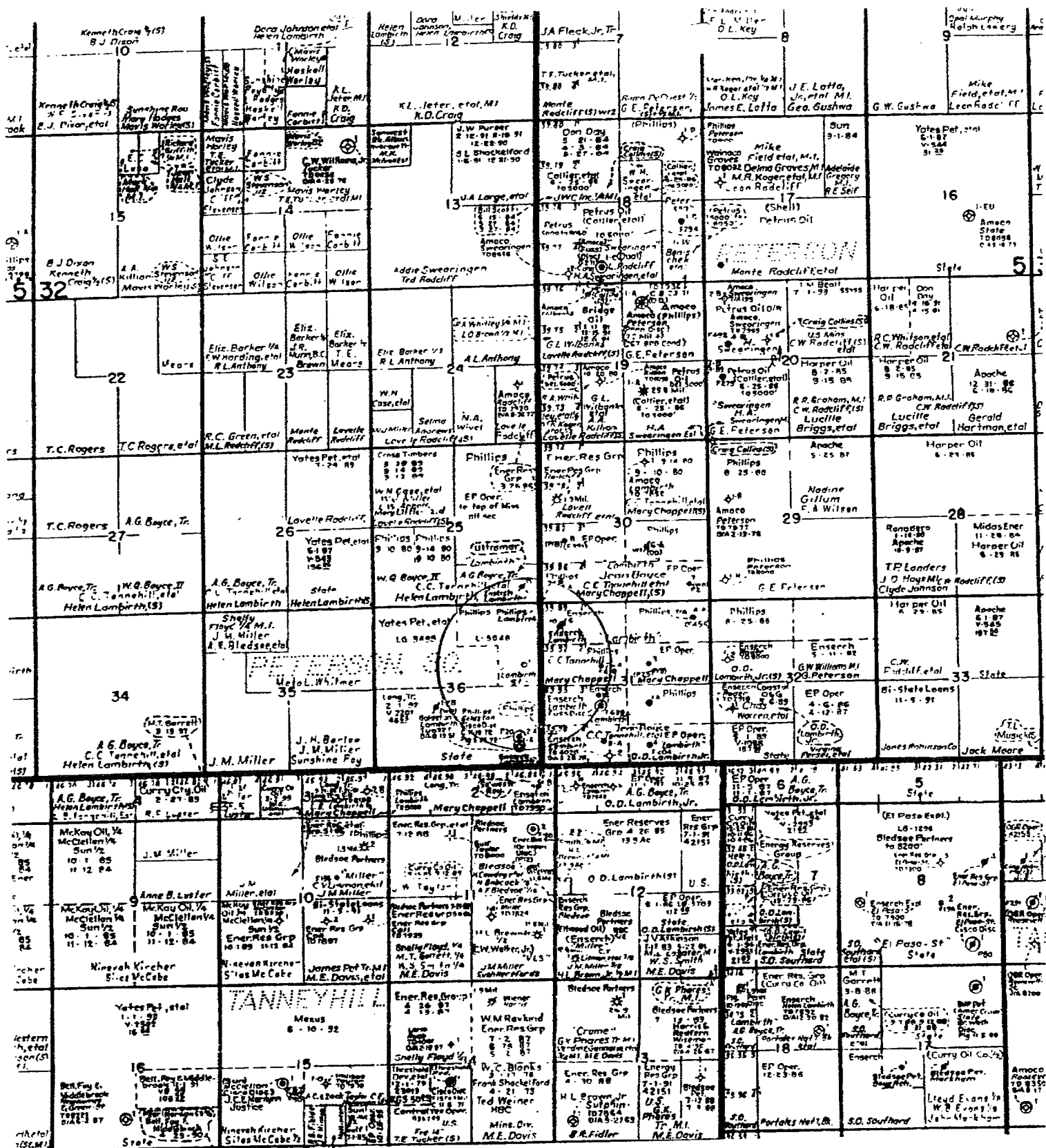

1/2 MILE RADIUS
OF PROPOSED WATER DISPOSAL
OKIE CRUDE COMPANY
LAMBIRTH STATE NO. 1 ATTACHMENT NO. 2

**OKIE CRUDE COMPANY - LAMBIRTH STATE #1
AREA OF REVIEW - 1/2 MILE RADIUS
WELL LIST**

Well Name	Location	Total Depth	Date Drilled	Well Type	Construction
Lambirth #1	1980' FSL & 1980' FWL Sec.31-5S-33E	7992'	6-4-78	Oil	13-3/8" @ 355' w/350 sx 8-5/8" @ 3327' w/300 sx 5-1/2" @ 7961' w/725 sx
Lambirth #6	766' FNL & 766' FWL Sec.31-5S-33E	8000'	3-20-78	Oil	13-3/8" @ 335' w/500 sx 8-5/8" @ 2005' w/700 sx 4-1/2" @ 8000' w/1875 sx
Lambirth #9	560' FSL & 560' FEL Sec.25-5S-32E	7960'	2-14-80	Oil	13-3/8" @ 369' w/350 sx 8-5/8" @ 2067' w/900 sx 5-1/2" @ 7955' w/500 sx
Lambirth #10	810' FNL & 660' FWL Sec.31-5S-33E	7848'	7-19-80	Oil	13-3/8" @ 357' w/350 sx 8-5/8" @ 2007' w/950 sx 5-1/2" @ 7847' w/500 sx
Lambirth #12	2310' FSL & 1854' FWL Sec.31-5S-33E	7750'*	4-13-85	Gas	13-3/8" @ 370' w/375 sx 9-5/8" @ 2005' w/875 sx 5-1/2" @ 7750' w/565 sx
Lambirth #A-2	1980' FNL & 1980' FWL Sec.31-5S-33E	7920'	4-9-79	Oil	13-3/8" @ 400' w/720 sx 8-5/8" @ 3500' w/1375 sx 5-1/2" @ 7920' w/400 sx
Goldston A-1 (Lambirth State #1)	660 FSL & 660' FEL Sec.36-5S-32E	8297'	8-13-51	Dry	13-3/8" @ 315' w/400 sx 8-5/8" @ 3420' w/200 sx
Goldston A-2	960' FSL & 660' FEL Sec.36-5S-32E	8070'	12-27-72	Oil	13-5/8" @ 345' w/300 sx 8-5/8" @ 3500' w/300 sx 5-1/2" @ 8070' w/500 sx

*did not penetrate Fusselman

C:\123radius.wk1

API	Well Name	Operator	Status	Legal	SHL/BHL	TD	Spud	Type	Construction
30-041-20361	PRE-ONGARD WELL #002 (Goldston-A 2)	PRE-ONGARD WELL OPERATOR	Plugged (site released)	P-36-05S-32E	960 FSL & 660 FEL	8070	12/27/1972	Oil	13-5/8" @345' w/300sx 8-5/8" @3500' w/300sx 5-1/2" @8070' w/500sx
30-041-20523	PRE-ONGARD WELL #009 (Lambirth 9)	PRE-ONGARD WELL OPERATOR	Plugged (site released)	P-25-05S-32E	560 FSL & 560 FEL	7960	2/14/1980	Oil	13-3/8" @369' w/350sx 8-5/8" @2067' w/900sx 5-1/2" @7955' w/500sx
30-041-20479	LAMBIRTH #006	ENSERCH EXPLORATION INC.	Plugged (site released)	D-31-05S-33E	766 FNL & 766 FWL	8000	3/20/1978	Oil	13-3/8" @335' w/500sx 8-5/8" @2005' w/700sx 4-1/2" @8000' w/1875sx
30-041-20481	LAMBIRTH A #002	Sabinal Energy Operating, LLC	Active	F-31-05S-33E	1980 FNL & 1980 FWL	7920	3/4/1979	Oil	13-3/8" @400' w/720sx 8-5/8" @3500' w/1375sx 5-1/2" @7920' w/400sx
30-041-20514	LAMBIRTH STATE #001	Sabinal Energy Operating, LLC	Active	H-36-05S-32E	1980 FNL & 510 FEL	7971	11/17/1979	SWD	13-3/8" @358' w/420sx 8-5/8" @3500' w/850sx 5-1/2" @7990' w/400sx
30-041-20536	PRE-ONGARD WELL #010 (Lambirth 10)	PRE-ONGARD WELL OPERATOR	Plugged (site released)	D-31-05S-33E	810 FNL & 660 FWL	7848	7/19/1980	Oil	13-3/8" @357' w/350sx 8-5/8" @2007' w/950sx 5-1/2" @7847' w/500sx
30-041-20783	LAMBIRTH #012	ENERGEN RESOURCES CORPORATION	Plugged (site released)	K-31-05S-33E	2130 FSL & 1854 FWL	7750	2/16/1985	Oil	13-3/8" @370' w/375sx 9-5/8" @2005' w/875sx 5-1/2" @7750' w/565sx

NEW MEXICO OIL CONSERVATION COMMISSION
WELL LOCATION AND ACREAGE DEDICATION PLAT

Form C-102
Supersedes C-128
Effective 1-1-65

All distances must be from the outer boundaries of the Section.

Operator PHILLIPS PETROLEUM Co.			Lease LAMBRITH STATE		Well No. 1
Init Letter H	Section 36	Township 5 South	Range 32 East	County Roosevelt	
Actual Footage Location of Well: 1980 feet from the North line and 510 feet from the East line					
Ground Level Elev. 4381.7	Producing Formation Fusselman	Pool Peterson Fusselman, South		Dedicated Acreage: 80 Acres	

1. Outline the acreage dedicated to the subject well by colored pencil or hatchure marks on the plat below.
2. If more than one lease is dedicated to the well, outline each and identify the ownership thereof (both as to working interest and royalty).
3. If more than one lease of different ownership is dedicated to the well, have the interests of all owners been consolidated by communitization, unitization, force-pooling, etc?

☐ Yes ☐ No If answer is "yes," type of consolidation _____

If answer is "no," list the owners and tract descriptions which have actually been consolidated. (Use reverse side of this form if necessary.) _____

No allowable will be assigned to the well until all interests have been consolidated (by communitization, unitization, forced-pooling, or otherwise) or until a non-standard unit, eliminating such interests, has been approved by the Commission.

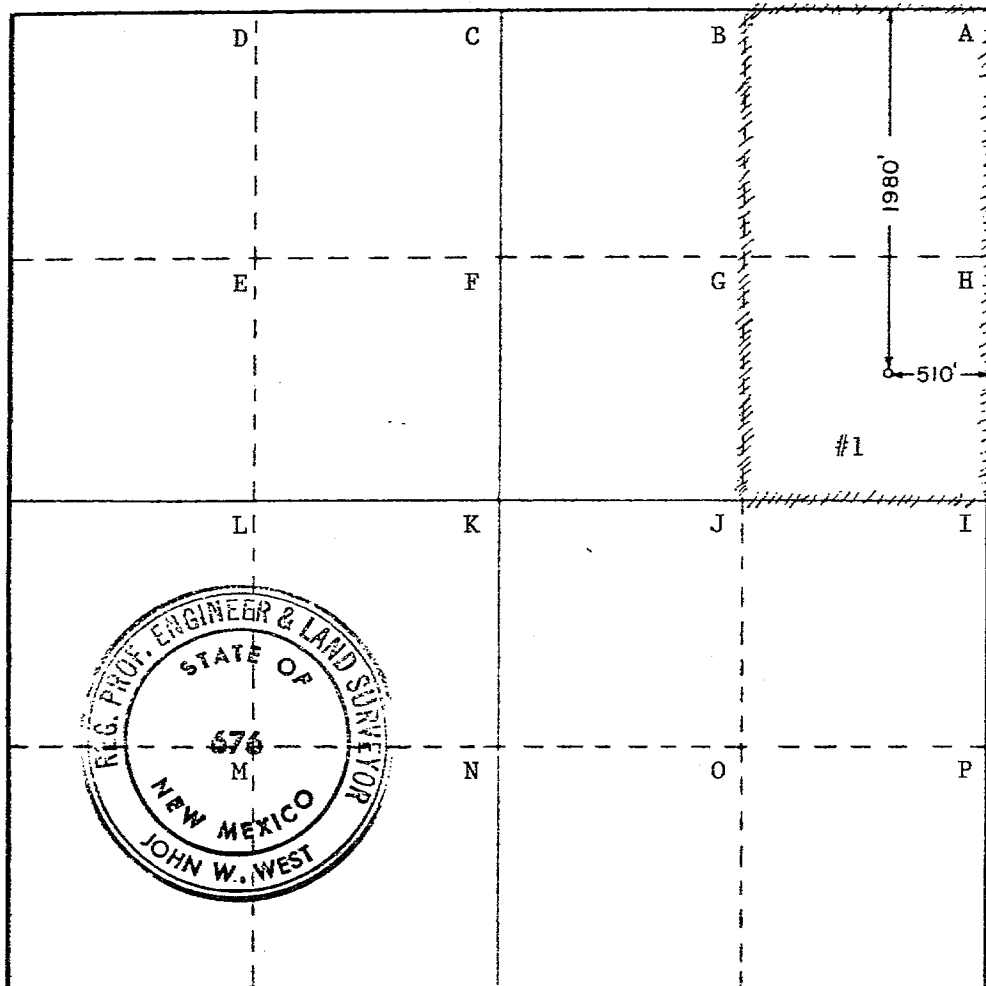

CERTIFICATION

I hereby certify that the information contained herein is true and complete to the best of my knowledge and belief.

[Signature]
Name
W. J. Mueller

Position
Senior Engineering Specialist

Company
Phillips Petroleum Company

Date
October 22, 1979

I hereby certify that the well location shown on this plat was plotted from field notes of actual surveys made by me or under my supervision, and that the same is true and correct to the best of my knowledge and belief.

Date Surveyed
October 17, 1979

Registered Professional Engineer and/or Land Surveyor

[Signature]
Certificate No. **John W. West 676**

Ronald J. Eidson 3239

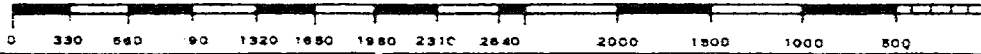

CONTR Rial #7 DENSITY 4400' GL PD 8000' RT

F.R. 11-5-79
(Fusselman)
11-20-79 Drlg 3341' apby
11-30-79 Drlg 6447' lm
12-12-79 TD 7971'; Crc
1-11-80 TD 7971'; PBD 7918'; Flwg
Perf (Fusselman) 7797-7801', 7804-08', 7812-18',
w/2 SPF
Acid (7797-7818') 1500 gals (15%)
Flwd 175 BO + 70 BW in 24 hrs thru 24/64" chk,
TP 70# (7797- 7818')
1-25-80 TD 7971'; PBD 7918'; DOC
Sqzd 7797-7818 w/100 sx
2-8-80 TD 7971'; PBD 7825'; SI WO Eval
Perf (Fusselman) 7865-70' w/4 SPF
Swbd 65 BW w/NS in 5 hrs (7865-70')
PE to 7852
Perf (Fusselman) 7828-33' w/4 SPF
Acid (7828-33') 1000 gals (15%)
Swbd 4 BO + 80 BSW in 5 hrs (7828-33')
Set BP @ 7825' 4-2-36 NM

ROOSEVELT
PHILLIPS PETROLEUM CO. Peterson, S.
1 Lambirth State
Sec 36, T5S, R32E

NM
Page #2

2-28-80 Continuation
Perf (Fusselman) 7796-7806' w/4 SPF
Acid (7796-7806') 500 gals (15%)
Swbd 80 PW w/NS in 4 hrs (7796-7806')
4-7-80 TD 7971'; PED 7825'; Complete
LOG F0881; Foster 1893', Yates 2078', San
Andres 3099', Glorieta 4347', Tubb 5738',
Abo Shale 7484', Brown Dolomite 7046',
Hueco 7112', 3 Brothers 7440', Bough "C"
7590', (11.5) 7682', Fusselman 7795'
4-12-80 COMPLETION ISSUED
5-17-80 RE-ISSUE OF ADD PAGE 2 INFORMATION FORMERLY
INCLUDING GUY HARTMAN, DOYLE, 1 JALMAT FEDERAL
COM., DEW COUNTY, SEC 6, T25S, R37E, TICKET
4-2-36 NM

5-17-80 Continuation
ISSUED 4-12-80 on TICKET ONLY

4-2-36 NM
IC 30-041-70036-79

U.S. Postal Service™
CERTIFIED MAIL® RECEIPT
Domestic Mail Only

For delivery information, visit our website at www.usps.com®.

OFFICIAL USE

Certified Mail Fee
 \$ 3.75
 Extra Services & Fees (check box, add fee as appropriate)
☒ Return Receipt (hardcopy) \$ 3.00
☐ Return Receipt (electronic) \$
☐ Certified Mail Restricted Delivery \$
☐ Adult Signature Required \$
☐ Adult Signature Restricted Delivery \$

Postage
 \$ 00.53
 Total Postage and Fees
 \$ 7.33

Postmark
 Here

1/7/22

Sent To The New Mexico state Land office
 Street and Apt. No., or PO Box No.
 310 Old Santa Fe Trail
 City, State, ZIP+4®
 Santa Fe, NM 87501

PS Form 3800, April 2015 PSN 7530-02-000-9047

See Reverse for Instructions

SENDER: COMPLETE THIS SECTION

- Complete items 1, 2, and 3.
- Print your name and address on the reverse so that we can return the card to you.
- Attach this card to the back of the mailpiece, or on the front if space permits.

1. Article Addressed to:

The New Mexico state Land office
 310 Old Santa Fe Trail,
 Santa Fe, NM 87501



9590 9402 4415 8248 7200 43

2. Article Number (Transfer from service label)

7019 0700 0000 4103 7683

COMPLETE THIS SECTION ON DELIVERY

A. Signature

X

- ☐ Agent
☐ Addressee

B. Received by (Printed Name)

C. Date of Delivery

- D. Is delivery address different from item 1? ☐ Yes
 If YES, enter delivery address below: ☐ No

3. Service Type

- ☐ Adult Signature
☐ Adult Signature Restricted Delivery
☒ Certified Mail®
☐ Certified Mail Restricted Delivery
☐ Collect on Delivery
☐ Collect on Delivery Restricted Delivery
☐ Insured Mail
☐ Insured Mail Restricted Delivery (over \$500)
☐ Priority Mail Express®
☐ Registered Mail™
☐ Registered Mail Restricted Delivery
☐ Return Receipt for Merchandise
☐ Signature Confirmation™
☐ Signature Confirmation Restricted Delivery

PS Form 3811, July 2015 PSN 7530-02-000-9053

Domestic Return Receipt



Sabinal Energy Operating, LLC

VIA USPS

February 16, 2022

NOTICE OF APPLICATION FOR FLUID INJECTION WELL PERMIT

The New Mexico State Land Office
310 Old Santa Fe Trail
Santa Fe, NM 87501

Re: Lambirth State #1 Well
API#: 30-041-20514
Roosevelt County, NM

Sabinal Energy Operating, LLC, located at 1780 Hughes Landing Blvd., Suite 1200, The Woodlands, Texas 77380, (346)-224-9270, is filing Form C-108 (Application for Authorization to Inject) with the New Mexico Oil Conservation Division for administrative approval for its saltwater disposal well Lambirth State #1 (API: 30-041-20514).

The proposed well is located at approximately 1980 feet FNL and 510 feet FEL in Section 36, Township 5S, Range 32E in Roosevelt County, New Mexico. Disposal water will be sourced from area production and will be injected into the Fusselman formation at a depth of 7,796 ft to 7,946 ft below ground level and at an expected maximum injection rate of 2,000 bbls water per day and pressure of 1,500 PSI.

Interested parties must file objections or requests for hearing with the Oil Conservation Division, 1220 South St. Francis Dr., Santa Fe, New Mexico 87505, within 15 days.

In addition, please feel free to contact me at NicoleR@SabinalEnergy.com should you have any general questions or concerns for Sabinal regarding this matter.

Technical questions for Sabinal regarding the Operation may be directed to Coley Jameson at ColeyJ@SabinalEnergy.com.

Sincerely,

Nicole Stone Reeves
Senior Landman

Enclosures

AFFIDAVIT OF LEGAL PUBLICATION

Legal 9432

STATE OF NEW MEXICO
COUNTIES OF CURRY
AND ROOSEVELT:

The undersigned, being dully sworn, says:
That she is a Legal Clerk of
The Eastern New Mexico News
Newspaper of general circulation,
Published in English at Clovis and Portales,
said counties and state, and that the
hereto attached

Lambrith SWD Proclamation (002)
Legal 9432

was published in The Eastern New Mexico News
a daily newspaper duly qualified for that purpose
within the meaning of Chapter 167 of the 1937
Session Laws of the State of New Mexico for
1 Days/weeks on the same days as follows:

First Publication February 13, 2022
Second Publication
Third Publication
Fourth Publication

Sammy Dewby
Legal Clerk

Subscribed and sworn to before me,
February 14, 2022

Alisa Cross
Notary Public

My commission expires on May 3, 2025

Legal 9432
February 13, 2022

LEGAL NOTICE

Sabinal Energy
Operating, LLC, 1780
Hughes Landing Blvd.,
Suite 1200, The
Woodlands, Texas
77380, Attention: Erin
Mazur, (346)-224-9270,
is filing Form C-108
(Application for
Authorization to Inject)
with the New Mexico Oil
Conservation Division for
administrative approval
for its saltwater disposal
well Lambrith State #1
(API: 30-041-20514).
The proposed well is
located at approximately
1980 feet FNL and 510
feet FEL in Section 36,
Township 5S, Range
32E in Roosevelt
County, New Mexico.
Disposal water will be
sourced from area pro-
duction and will be inject-
ed into the Fusselman
formation at a depth of
7,796 ft to 7,946 ft below
ground level and at an
expected maximum
injection rate of 2,000
bbls water per day and
pressure of 1,500 psi.
Interested parties must
file objections or
requests for hearing with
the Oil Conservation
Division, 1220 South St.
Francis Dr., Santa Fe,
New Mexico 87505, with-
in 15 days.

INSTRUCTIONS

This form is to be filed with the appropriate District Office of the Commission not later than 20 days after the completion of any newly drilled or deepened well. It shall be accompanied by one copy of all electrical and radio-activity logs run on the well and a summary of all special tests conducted, including drill stem tests. All depths reported shall be measured depths. In the case of directionally drilled wells, true vertical depths shall also be reported. For multiple completions, Items 30 through 34 shall be reported for each zone. The form is to be filed in quintuplicate except on state land, where six copies are required. See Rule 1105.

INDICATE FORMATION TOPS IN CONFORMANCE WITH GEOGRAPHICAL SECTION OF STATE

Southeastern New Mexico

Northwestern New Mexico

T. Anhy <u>Rustler 1910'</u>	T. Canyon <u>7860'</u>	T. Ojo Alamo	T. Penn. "B"
T. Salt	T. Strawn	T. Kirtland Fruitland	T. Penn. "C"
B. Salt	T. Atoka	T. Pictured Cliffs	T. Penn. "D"
T. Yates <u>2100'</u>	T. Miss	T. Cliff House	T. Leadville
T. 7 Rivers	T. Devonian	T. Menefee	T. Madison
T. Queen	T. Silurian	T. Point Lookout	T. Elbert
T. Grayburg	T. Montoya <u>7898'</u>	T. Mancos	T. McCracken
T. San Andres <u>3135'</u>	T. Simpson <u>8030'</u>	T. Gallup	T. Ignacio Qtzite
T. Glocieta <u>4391'</u>	T. McKee	Base Greenhorn	T. Granite
T. Paddock	T. Ellenburger	T. Dakota	T.
T. Blinney	T. Gr. Wash	T. Morrison	T.
T. Tubb <u>5789'</u>	T. Granite	T. Todillo	T.
T. Drinkard	T. Delaware Sand	T. Entrada	T.
T. Abo <u>6554'</u>	T. Bone Springs	T. Wingate	T.
T. Brown Dolomite <u>7110'</u>	T. Pre-Cambrian <u>8055'</u>	T. Chinte	T.
T. Salt Wash <u>7190'</u>		T. Permian	T.
T. Penn. 3 <u>Brothers 7503'</u>		T. Penn. "A"	T.
T. Cisco (Bough C) <u>7662'</u>			
Cisco <u>7702'</u>			

FORMATION RECORD (Attach additional sheets if necessary)

From	To	Thickness In Feet	Formation	From	To	Thickness In Feet	Formation
0	300	300	Caliche, sand				
300	702	402	Redbeds				
402	1840		Redbeds, anhydrite				
1840	2631		Redbeds, anhydrite, salt				
2631	2756		Anhydrite, salt				
2756	2865		Anhydrite, lime, salt				
2865	2902		Anhydrite, lime				
2902	3190		Lime				
3190	3298		Lime, sand				
3298	4329		Lime				
4329	5674		Lime, sand				
5674	6573		Lime				
6573	7245		Shale				
7245	7612		Shale, lime				
7612	7816		Core				
7816	7958		Shale				
7958	8037		Shale, lime				
8037	8070		Shale, dolomite, sand				
	8070		T.D.				

GOLDSTON A-2

ATTACHMENT NO. 3

PAGE 28 OF 31

NO. OF COPIES RECEIVED	
DISTRIBUTION	
SANTA FE	
FILE	
U.S.G.S.	
LAND OFFICE	
OPERATOR	

NEW MEXICO OIL CONSERVATION COMMISSION
WELL COMPLETION OR RECOMPLETION REPORT AND LOG

API No. 30-041-20514

5a. Indicate Type of Lease State <input checked="" type="checkbox"/> Fee <input type="checkbox"/>
5. State Oil & Gas Lease No. L-5048
7. Unit Agreement Name
8. Name of Lease Name Lambirth-State
9. Well No. 1
10. Field and Pool, or Wildcat Peterson-Fusselman--South
12. County Roosevelt

11. TYPE OF WELL OIL WELL <input checked="" type="checkbox"/> GAS WELL <input type="checkbox"/> DRY <input type="checkbox"/> OTHER <input type="checkbox"/>				
12. TYPE OF COMPLETION NEW WELL <input checked="" type="checkbox"/> WORK OVER <input type="checkbox"/> DEEPEN <input type="checkbox"/> PLUG BACK <input type="checkbox"/> DIFF. RESVR. <input type="checkbox"/> OTHER <input type="checkbox"/>				
1. Name of Operator Phillips Petroleum Company				
3. Address of Operator Room 401, 4001 Penbrook, Odessa, Texas 79762				
4. Location of Well UNIT LETTER <u>H</u> LOCATED <u>1980</u> FEET FROM THE <u>North</u> LINE AND <u>510</u> FEET FROM THE <u>East</u> LINE OF SEC. <u>36</u> TWP. <u>T-5-S</u> RGE. <u>R-32-E</u> NMPM				
15. Date Spudded 11-17-79	16. Date T.D. Reached 12-9-79	17. Date Compl. (Ready to Prod.) 1-2-80	18. Elevations (DF, RKB, RT, GR, etc.) 4400' GR	19. Elev. Casinghead
20. Total Depth 7971'	21. Plug Back T.D. 7918'	22. If Multiple Compl., How Many	23. Intervals Drilled By Rotary	24. Cable Tools
24. Producing Interval(s), of this completion - Top, Bottom, Name Fusselman top 7795', bottom 7971'				25. Was Directional Survey Made No
26. Type Electric and Other Logs Run Schlumberger CBU-DLL-RXO-GR-CAL				27. Was Well Cored No

CASING RECORD (Report all strings set in well)					
CASING SIZE	WEIGHT LB./FT.	DEPTH SET	HOLE SIZE	CEMENTING RECORD	AMOUNT PULLED
13-3/8"	48# H-40	358'	17-1/2" (w/420 sxs Cl H w/2% CaCl. 1/4" (96 sxs to surf.))		Flocele. Circ
8-5/8"	24# K-55	3500'	11" (w/850 sxs Cl H w/30% DD tailed in w/200 sxs (Cl H w/2% CaCl. Circ 160 sxs to pit.))		
5-1/2"	15.5# EL-60	7990'	7-7/8" (w/400 sxs Cl H, 30# DDING RECORD 1/2" Celoflak)		
SIZE	148#	BOTTOM	SACKS CEMENT	SC-1000 SXS SET H w/2% CaCl. SET	PACKER SET
				2-7/8"	7771'

31. Perforation Record (Interval, size and number) Perf'd 5-1/2": 7796-7806'--10', 40 shots	32. ACID, SHOT, FRACTURE, CEMENT SQUEEZE, ETC. DEPTH INTERVAL 7828-33 (w/1000 gals 15% NE HCl acid w/ball sealers. Abnd w/CIBP at 7825'.) 7796-7806 (w/1500 gals 15% NE HCl 7796-7833 (w/15000 gals Injectrol "G", 100 sxs
--	--

33. PRODUCTION (Cl H cmt w/0.5% CFR-2. Pmpd 60 sxs in							
Date First Production 1-5-80	Production Method (blowing, gas lift, pumping - Size and type pump) (formation, reverse 40 sxs) Insert pump 2" x 1-1/4" x 25' Prod.						
Date of Test 3-24-80	Hours Tested 24	Choke Size ---	Prod'n. For Test Period 31	Oil - Bbl. 9	Gas - MCF 0	Water - Bbl. 297	Gas - Oil Ratio
Flow Tubing Press.	Casing Pressure	Calculated 24-Hour Rate	Oil - Bbl.	Gas - MCF	Water - Bbl.	Oil Gravity - API (Corr.) 47.2	

34. Disposition of Gas (Sold, used for fuel, vented, etc.) Vented	Test Witnessed By E. T. Millhollon
--	---------------------------------------

35. List of Attachments Logs furnished direct by Schlumberger
--

36. I hereby certify that the information shown on both sides of this form is true and complete to the best of my knowledge and belief.

SIGNED W. J. Mueller TITLE Sr. Engineering Spec. DATE 3-25-80

LAMBIRTH STATE #1

ATTACHMENT NO. 3

PAGE 2 OF 31

INSTRUCTIONS

This form is to be filed with the appropriate District Office of the Commission not later than 30 days after the completion of any newly-drilled or deepened well. It shall be accompanied by one copy of all electrical and reflectivity logs run on the well and a summary of all special tests conducted, including drill stem tests. All depths reported shall be measured depths. In the case of directionally drilled wells, true vertical depths shall also be reported. For multiple completions, Items 30 through 34 shall be reported for each zone. The form is to be filed in quintuplicate except on state land, where six copies are required. See Rule 1105.

INDICATE FORMATION TOPS IN CONFORMANCE WITH GEOGRAPHICAL SECTION OF STATE

Southeastern New Mexico			Northwestern New Mexico		
Three Bros.					
T. Anhy _____	T. XXXXX 7440'	T. Ojo Alamo _____	T. Penn. "B" _____		
T. Salt _____	T. XXXXX Bough "C" 7590'	T. Kirtland-Fruitland _____	T. Penn. "C" _____		
T. XXXXX Rustler 1898'	T. XXXXX Cisco 7682'	T. Pictured Cliffs _____	T. Penn. "D" _____		
T. Yates 2078'	T. XXXXX Fusselman 7795'	T. Cliff House _____	T. Leadville _____		
T. 7 Rivers _____	T. Devonian _____	T. Menefee _____	T. Madison _____		
T. Queen _____	T. Silurian _____	T. Point Lookout _____	T. Elbert _____		
T. Grayburg _____	T. Montoya _____	T. Mancos _____	T. McCracken _____		
T. San Andres 3099'	T. Simpson _____	T. Gallup _____	T. Ignacio Qtzite _____		
T. Glorieta 4347'	T. McKee _____	T. Base Greenhorn _____	T. Granite _____		
T. Paddock _____	T. Ellenburger _____	T. Dakota _____	T. _____		
T. Blinberry _____	T. Gr. Wash _____	T. Morrison _____	T. _____		
T. Tubb Sand 5738'	T. Granite _____	T. Todilto _____	T. _____		
T. Drinkard _____	T. Delaware Sand _____	T. Entrada _____	T. _____		
T. Abo Shale 6494'	T. Bone Springs _____	T. Wingate _____	T. _____		
T. XXXXX Brown Dolomite	T. 7046'	T. Chinle _____	T. _____		
T. XXXXX Hueco 7125'	T. _____	T. Permian _____	T. _____		
T. XXXXX _____	T. _____	T. Penn. "A" _____	T. _____		
T. Todd Pay Zone 7208'					

OIL OR GAS SANDS OR ZONES

No. 1, from _____ to _____	No. 4, from _____ to _____
No. 2, from _____ to _____	No. 5, from _____ to _____
No. 3, from _____ to _____	No. 6, from _____ to _____

IMPORTANT WATER SANDS

Include data on rate of water inflow and elevation to which water rose in hole.

No. 1, from _____ to _____	feet. _____
No. 2, from _____ to _____	feet. _____
No. 3, from _____ to _____	feet. _____
No. 4, from _____ to _____	feet. _____

FORMATION RECORD (Attach additional sheets if necessary)

From	To	Thickness in Feet	Formation	From	To	Thickness in Feet	Formation
0	358	358	Surface/Rock				
358	1458	1100	Red Bed/Anhy				
1458	3851	2393	Anhy				
3851	5631	1780	Anhy/Salt				
5631	6122	491	Lime/Salt				
6122	6447	325	Lime				
6447	6840	393	Shale				
6840	7200	360	Shale/Lime				
7200	7788	588	Lime				
7788	7971	183	GR/Wash				
	TD						

RECEIVED

MAY 4 1980

OR CONSERVATION DIV.

NO. OF COPIES RECEIVED	
DISTRIBUTION	
SANTA FE	
FILE	
U.S.G.S.	
LAND OFFICE	
OPERATOR	

Form C-105
Revised 1-1-65

NEW MEXICO OIL CONSERVATION COMMISSION WELL COMPLETION OR RECOMPLETION REPORT AND LOG

5a. Indicate Type of Lease
State ☐ Fee ☒

5. State Oil & Gas Lease No.

1a. TYPE OF WELL OIL WELL <input checked="" type="checkbox"/> GAS WELL <input type="checkbox"/> DRY <input type="checkbox"/> OTHER <input type="checkbox"/>						7. Unit Agreement Name	
b. TYPE OF COMPLETION NEW WELL <input checked="" type="checkbox"/> WORK OVER <input type="checkbox"/> DEEPEN <input type="checkbox"/> PLUG BACK <input type="checkbox"/> DIFF. RESVR. <input type="checkbox"/> OTHER <input type="checkbox"/>						8. Farm or Lease Name Lambirth	
2. Name of Operator Enserch Exploration, Inc.						9. Well No. 1	
3. Address of Operator P. O. Box 4815, Midland, Texas 79701						10. Field and Pool, or Wildcat Wildcat	
4. Location of Well UNIT LETTER <u>K</u> LOCATED <u>1980</u> FEET FROM THE <u>South</u> LINE AND <u>1980</u> FEET FROM THE <u>West</u> LINE OF SEC. <u>31</u> TWP. <u>5S</u> RGE. <u>33E</u> NMPM						12. County Roosevelt	
15. Date Spudded 3-31-78		16. Date T.D. Reached 5-16-78		17. Date Compl. (Ready to Prod.) 6-4-78		18. Elevations (DF, RKB, RT, GR, etc.) 4413.8' GR	
19. Elev. Casinghead 4414.8'		20. Total Depth 7992'					
21. Plug Back T.D. 7927'		22. If Multiple Compl., How Many		23. Intervals Drilled By Rotary Tools 0-7992'		24. Was Directional Survey Made No	
24. Producing Interval(s), of this completion - Top, Bottom, Name 7808'-52', Fusselman						25. Was Well Cored No	
26. Type Electric and Other Logs Run CNL-FDC, DLL, BHC Sonic, Dip Meter, CBL/GR						27. Was Well Cored No	
28. CASING RECORD (Report all strings set in well)							
CASING SIZE	WEIGHT LB./FT.	DEPTH SET	HOLE SIZE	CEMENTING RECORD		AMOUNT PULLED	
13-3/8"	48#	356'	17-1/2"	350 sx. Class C (Circ.)		--	
8-5/8"	24# & 32#	3327'	12-1/4"	1950 sx. Lite & C (Circ.)		--	
5-1/2"	15.5#	7959'	7-7/8"	725 sx. Lite & H 50/50 Poz		--	
29. LINER RECORD				30. TUBING RECORD			
SIZE	TOP	BOTTOM	SACKS CEMENT	SCREEN	SIZE	DEPTH SET	PACKER SET
					2-3/8"	7780'	7780'
31. Perforation Record (Interval, size and number) 7808'-52', 14 holes, .46" size				32. ACID, SHOT, FRACTURE, CEMENT SQUEEZE, ETC.			
				DEPTH INTERVAL			
				AMOUNT AND KIND MATERIAL USED			
				7768' (4 holes) Could not break down			
				7870' (4 holes) Squeezed w/150 sx. H & Neat			
				7767' (4 holes) Could not break down			
				7808'-52' (14 holes) 3000 gals. MOD-202			
33. PRODUCTION							
Date First Production 6-4-78		Production Method (Flowing, gas lift, pumping - Size and type pump) Flowing				Well Status (Prod. or Shut-in) Shut-in	
Date of Test 6-4-78	Hours Tested 24	Choke Size 1/4"	Prod'n. For Test Period	Oil - Bbl. 638	Gas - MCF 703	Water - Bbl. - 0 -	Gas - Oil Ratio 1102/1
Flow Tubing Press. 585 psi	Casing Pressure Packer	Calculated 24-Hour Rate	Oil - Bbl. 638	Gas - MCF 703	Water - Bbl. - 0 -	Oil Gravity - API (Corr.) 49.8°	
34. Disposition of Gas (Sold, used for fuel, vented, etc.) Vented during test						Test Witnessed By S. D. Reed	
35. List of Attachments Deviation Record, Logs, Plat, DST Charts							
36. I hereby certify that the information shown on both sides of this form is true and complete to the best of my knowledge and belief.							
SIGNED <u>H. F. Bensie</u>				TITLE <u>Production Superintendent</u>		DATE <u>6-6-78</u>	

LAMBIRTH #1

ATTACHMENT NO. 3

PAGE 4 OF 31

INSTRUCTIONS

This form is to be filed with the appropriate District Office of the Commission not later than 20 days after the completion of any newly-drilled or deepened well. It shall be accompanied by one copy of all electrical and radio-activity logs run on the well and a summary of all special tests conducted, including drill stem tests. All depths reported shall be measured depths. In the case of directionally drilled wells, true vertical depths shall also be reported. For multiple completions, Items 30 through 34 shall be reported for each zone. The form is to be filed in quintuplicate except on state land, where six copies are required. See Rule 1105.

INDICATE FORMATION TOPS IN CONFORMANCE WITH GEOGRAPHICAL SECTION OF STATE

Southeastern New Mexico

Northwestern New Mexico

T. Anhy _____	T. Canyon _____	T. Ojo Alamo _____	T. Penn. "B" _____
T. Salt _____	T. Strawn _____	T. Kirtland-Fruitland _____	T. Penn. "C" _____
B. Salt _____	T. Atoka _____	T. Pictured Cliffs _____	T. Penn. "D" _____
T. Yates _____	T. Miss _____	T. Cliff House _____	T. Leadville _____
T. 7 Rivers _____	T. Devonian _____	T. Menefee _____	T. Madison _____
T. Queen _____	T. Silurian _____ 7750'	T. Point Lookout _____	T. Elbert _____
T. Grayburg _____	T. Fusselman _____ 7800'	T. Mancos _____	T. McCracken _____
T. San Andres _____ 3126'	T. Simpson _____	T. Gallup _____	T. Ignacio Qtzte _____
T. Glorieta _____ 4449'	T. McKee _____	Base Greenhorn _____	T. Granite _____
T. Paddock _____	T. Ellenburger _____	T. Dakota _____	T. _____
T. Blinberry _____	T. Gr. Wash _____	T. Morrison _____	T. _____
T. Tubb _____ 5770'	T. Granite _____ 7926'	T. Todilto _____	T. _____
T. Drinkard _____	T. Delaware Sand _____	T. Entrada _____	T. _____
T. Abo _____ 6530'	T. Bone Springs _____	T. Wingate _____	T. _____
T. Wolfcamp _____ 7154'	T. _____	T. Chinle _____	T. _____
T. Penn. _____ 7580'	T. _____	T. Permian _____	T. _____
T. Cisco (Bough C) _____	T. _____	T. Penn. "A" _____	T. _____

FORMATION RECORD (Attach additional sheets if necessary)

From	To	Thickness in Feet	Formation	From	To	Thickness in Feet	Formation
0'	200'	200'	Tertiary Sandstone				
200'	1800'	1600'	Red Shale				
1800'	3300'	1500'	Red Shale & Anhydrite				
3300'	4390'	1090'	San Andres Dolomite				
4390'	4449'	59'	Salt				
4449'	5500'	1051'	Interbedded Shale & Salt of Glorieta Formation				
5500'	5770'	270'	Interbedded Limestone & Shale of Glorieta Fm.				
5770'	6530'	760'	Shale & Limestone of Tubb Formation				
6530'	7154'	624'	Abo Fm., Red Shale				
7154'	7580'	426'	Limestone & Dolomite of Wolfcampian Age				
7580'	7750'	170'	Pennsylvanian Limestone, Dolomite & Shale				
7750'	7800'	50'	Upper Silurian Dolomite				
7800'	7926'	126'	Fusselman Dolomite				
7926'	7992'	66'	Pink PreCambrian Granite				

NO. OF COPIES RECEIVED	
DISTRIBUTION	
SANTA FE	
FILE	
U.S.G.S.	
LAND OFFICE	
OPERATOR	

NEW MEXICO OIL CONSERVATION COMMISSION

Form C-103
Supersedes Old
C-102 and C-103
Effective 1-1-65

5a. Indicate Type of Lease State <input type="checkbox"/> Fee <input checked="" type="checkbox"/>
5. State Oil & Gas Lease No.
7. Unit Agreement Name
8. Farm or Lease Name Lambirth
9. Well No. 6
10. Field and Pool, or Wildcat South Peterson
12. County Roosevelt

SUNDRY NOTICES AND REPORTS ON WELLS
(DO NOT USE THIS FORM FOR PROPOSALS TO DRILL OR TO DEEPEN OR PLUG BACK TO A DIFFERENT RESERVOIR.
USE "APPLICATION FOR PERMIT" (FORM C-101) FOR SUCH PROPOSALS.)

1. OIL WELL <input type="checkbox"/> GAS WELL <input type="checkbox"/> OTHER - Dry
2. Name of Operator Enserch Exploration, Inc.
3. Address of Operator P. O. Box 4815, Midland, Texas 79704
4. Location of Well UNIT LETTER <u>D</u> <u>766'</u> FEET FROM THE <u>West</u> LINE AND <u>766'</u> FEET FROM THE <u>North</u> LINE, SECTION <u>31</u> TOWNSHIP <u>5S</u> RANGE <u>33E</u> N.M.P.M.
15. Elevation (Show whether DF, RT, GR, etc.) 4382.4' GR

16. Check Appropriate Box To Indicate Nature of Notice, Report or Other Data	
NOTICE OF INTENTION TO:	SUBSEQUENT REPORT OF:
PERFORM REMEDIAL WORK <input type="checkbox"/>	REMEDIAL WORK <input type="checkbox"/>
TEMPORARILY ABANDON <input type="checkbox"/>	COMMENCE DRILLING OPNS. <input type="checkbox"/>
PULL OR ALTER CASING <input type="checkbox"/>	CASING TEST AND CEMENT JOBS <input type="checkbox"/>
OTHER <input type="checkbox"/>	OTHER <input type="checkbox"/>
PLUG AND ABANDON <input type="checkbox"/>	ALTERING CASING <input type="checkbox"/>
CHANGE PLANS <input type="checkbox"/>	PLUG AND ABANDONMENT <input checked="" type="checkbox"/>

17. Describe Proposed or Completed Operations (Clearly state all pertinent details, and give pertinent dates, including estimated date of starting any proposed work) SEE RULE 1103.

Work performed from 4/9/83 to 4/16/83:

Set CIBP at 7600'.
Laid 5 sacks Class H cement from 7590' to 7555'.
Cut off 4-1/2" casing at 2000'.
Laid 60 sacks Class H cement from 2046' to 1860'.
Laid 15 sacks Class H cement from 30' to surface.
Cut off 8-5/8" casinghead, welded on 8-5/8" x 1/2" steel plate.
Installed dry hole marker.

18. I hereby certify that the information above is true and complete to the best of my knowledge and belief.

SIGNED <u>H. F. Burnett</u>	TITLE <u>Prod. Superintendent</u>	DATE <u>5/26/83</u>
APPROVED BY <u>David C. [Signature]</u>	TITLE <u>OIL & GAS INSPECTOR</u>	DATE <u>5/26/83</u>

CONDITIONS OF APPROVAL, IF ANY:

LAMBIRTH #6

ATTACHMENT NO. 3

PAGE 6 OF 31

STATE OF NEW MEXICO
OIL AND MINERALS DEPARTMENTOIL CONSERVATION DIVISION
P. O. BOX 2088
SANTA FE, NEW MEXICO 87501

NO. OF COPIES RECEIVED	
DISTRIBUTION	
SANTA FE	
FILE	
U.S.G.S.	
LAND OFFICE	
OPERATOR	

WELL COMPLETION OR RECOMPLETION REPORT AND LOG

5a. Indicate Type of Lease	
State <input type="checkbox"/>	Fee <input checked="" type="checkbox"/>
5. State Oil & Gas Lease No.	

TYPE OF WELL

OIL WELL ☐GAS WELL ☐DRY ☒OTHER ☐

TYPE OF COMPLETION

NEW WELL ☐WORK OVER ☐OCEPEN ☐PLUG BACK ☒DIFF. RESVR. ☐OTHER ☐

Name of Operator

Enserch Exploration, Inc.

Address of Operator

P. O. Box 4815, Midland, Texas 79704

Location of Well

LETTER D LOCATED 766 FEET FROM THE West LINE AND 766 FEET FROMNorth LINE OF SEC. 31 TWP. 5S RGE. 33E NWPM

3. Date Spudded

2/4/79

16. Date T.D. Reached

2/24/79

17. Date Compl. (Ready to Prod.)

18. Elevations (DF, RKB, RT, GR, etc.)

4382.4' GR

19. Elev. Casinghead

20. Total Depth

8000'

21. Plug Back T.D.

22. If Multiple Compl., How Many

23. Intervals Drilled By

Rotary Tools

Cable Tools

All

24. Producing Interval(s), of this completion — Top, Bottom, Name

25. Was Directional Survey Made

No

26. Type Electric and Other Logs Run

DLL, CNL, GRL, CBL

27. Was Well Cored

No

CASING RECORD (Report all strings set in well)

CASING SIZE	WEIGHT LB./FT.	DEPTH SET	HOLE SIZE	CEMENTING RECORD	AMOUNT PULLED
13-3/8"	48#	335'	17-1/2"	500 sx. (Circ.)	
8-5/8"	24#	2005'	11"	700 sx. (Circ.)	
4-1/2"	11.6#	8000'	7-7/8"	1875 sx.	2011'

LINER RECORD

SIZE	TOP	BOTTOM	SACKS CEMENT	SCREEN	SIZE	DEPTH SET	PACKER SET

31. Perforation Record (Interval, size and number)

7828'-40', .43" size, 10 holes (squeezed)
 7830'-35', .43" size, 6 holes (squeezed)
 7830'-42', .43" size, 20 holes (squeezed)
 7694'-98', .42" size, 5 holes
 7640'-44', .42" size, 4 holes

32. ACID, SHOT, FRACTURE, CEMENT SQUEEZE, ETC.

DEPTH INTERVAL	AMOUNT AND KIND MATERIAL USED
7828'-40'	2000 gals. MOD 202 acid
7830'-35'	500 gals. 15% MSA acid
7830'-42'	350 gals. MOD 101 acid
7694'-98'	1000 gals. MOD 303 acid

PRODUCTION 7640'-44', 250 gals. 15% MCA + 1000 gals. MOD 202

Date First Production

Production Method (Flowing, gas lift, pumping — Size and type pump)

Well Status (Prod. or Shut-in)

Date of Test	Hours Tested	Choke Size	Prod'n. For Test Period	Oil — Bbl.	Gas — MCF	Water — Bbl.	Gas — Oil Ratio
Low Tubing Press.	Casing Pressure	Calculated 24-Hour Rate	Oil — Bbl.	Gas — MCF	Water — Bbl.	Oil Gravity — API (Corr.)	

34. Disposition of Gas (Sold, used for fuel, vented, etc.)

Test Witnessed By

35. List of Attachments

Plat (Logs previously filed)

I hereby certify that the information shown on both sides of this form is true and complete to the best of my knowledge and belief.

SIGNED

H. F. Bennett

TITLE

Prod. Superintendent

DATE 5/26/83

NO. OF COPIES RECEIVED	
DISTRIBUTION	
SANTA FE	
FILE	
U.S.G.S.	
LAND OFFICE	
OPERATOR	

Form C-105
Revised 1-1-65

NEW MEXICO OIL CONSERVATION COMMISSION WELL COMPLETION OR RECOMPLETION REPORT AND LOG

5a. Indicate Type of Lease
State ☐ Fee ☒

5. State Oil & Gas Lease No.

1a. TYPE OF WELL
OIL WELL ☒ GAS WELL ☐ DRY ☐ OTHER ☐

b. TYPE OF COMPLETION
NEW WELL ☒ WORK OVER ☐ DEEPEN ☐ PLUG BACK ☐ DIFF. RESVR. ☐ OTHER ☐

7. Unit Agreement Name

8. Term or Lease Name
Lambirth

9. Well No.
6

10. Field and Pool, or Wildcat
South Peterson Fusselman

2. Name of Operator
Enserch Exploration, Inc.

3. Address of Operator
P. O. Box 4815, Midland, Texas 79701

4. Location of Well

UNIT LETTER D LOCATED 766 FEET FROM THE West LINE AND 766 FEET FROM

THE North LINE OF SEC. 31 TWP. 5S RGE. 33E NMPM

12. County
Roosevelt

15. Date Spudded 2-4-79 16. Date T.D. Reached 2-24-79 17. Date Compl. (Ready to Prod.) 3-20-79 18. Elevations (DF, RKB, RT, GR, etc.) 4381.4' GR 19. Elev. Casinghead 4382.4'

20. Total Depth 8000' 21. Plug Back T.D. 7862' 22. If Multiple Compl., How Many 23. Intervals Drilled By Rotary Tools 0 - 8000' Cable Tools

24. Producing Interval(s), of this completion - Top, Bottom, Name
7830'-35' Fusselman

25. Was Directional Survey Made
No

26. Type Electric and Other Logs Run
CNFD, DL, BHC Sonic, GR

27. Was Well Cored
No

28. CASING RECORD (Report all strings set in well)					
CASING SIZE	WEIGHT LB./FT.	DEPTH SET	HOLE SIZE	CEMENTING RECORD	AMOUNT PULLED
13-3/8"	48#	335'	17-1/2"	500 sx. Class H (Circ.)	--
8-5/8"	24#	2005'	11"	700 sx. Class C (Circ.)	--
4-1/2"	11.6#	8000'	7-7/8"	1875 sx.	

29. LINER RECORD					30. TUBING RECORD		
SIZE	TOP	BOTTOM	SACKS CEMENT	SCREEN	SIZE	DEPTH SET	PACKER SET
					2-3/8"	7778'	7778'

31. Perforation Record (Interval, size and number)
7828'-40', 10 holes, .43" size, squeezed
7872', 4 holes, .43" size, squeezed
7830'-35', 6 holes, .43" size

32. ACID, SHOT, FRACTURE, CEMENT SQUEEZE, ETC.
DEPTH INTERVAL AMOUNT AND KIND MATERIAL USED
7828'-40' (10 holes) 2000 gals. MOD 202
7872' (4 holes) Squeezed w/100 sx. Class H
7830'-35' (6 holes) 250 gals. MSA Acid

33. PRODUCTION
Date First Production 3-10-79 Production Method (Flowing, gas lift, pumping - Size and type pump) Flowing Well Status (Prod. or Shut-in) Producing

Date of Test <u>3-20-79</u>	Hours Tested <u>24</u>	Choke Size <u>3/8"</u>	Prod'n. For Test Period <u> </u>	Oil - Bbl. <u>204</u>	Gas - MCF <u>316</u>	Water - Bbl. <u>65</u>	Gas - Oil Ratio <u>1549/1</u>
Flow Tubing Press. <u>100 psi</u>	Casing Pressure <u>Packer</u>	Calculated 24-Hour Rate <u> </u>	Oil - Bbl. <u>204</u>	Gas - MCF <u>316</u>	Water - Bbl. <u>65</u>	Oil Gravity - API (Corr.) <u>50.1</u>	

34. Disposition of Gas (Sold, used for fuel, vented, etc.)
Vented during test.

Test Witnessed By
B. J. Warren, Jr.

35. List of Attachments
Deviation Record, Logs, Plat

36. I hereby certify that the information shown on both sides of this form is true and complete to the best of my knowledge and belief.

SIGNED H. F. Burnett TITLE Production Superintendent DATE 3-20-79

LAMBIRTH #6

ATTACHMENT NO. 3

PAGE 8 OF 31

INSTRUCTIONS

This form is to be filed with the appropriate District Office of the Commission not later than 20 days after the completion of any newly-drilled or deepened well. It shall be accompanied by one copy of all electrical and radio-activity logs run on the well and a summary of all special tests conducted, including drill stem tests. All depths reported shall be measured depths. In the case of directionally drilled wells, true vertical depths shall also be reported. For multiple completions, Items 30 through 34 shall be reported for each zone. The form is to be filed in quintuplicate except on state land, where six copies are required. See Rule 1105.

INDICATE FORMATION TOPS IN CONFORMANCE WITH GEOGRAPHICAL SECTION OF STATE

Southeastern New Mexico

Northwestern New Mexico

T. Anhy _____	T. Canyon _____	T. Ojo Alamo _____	T. Penn. "B" _____
T. Salt _____	T. Strawn _____	T. Kirtland-Fruitland _____	T. Penn. "C" _____
B. Salt _____	T. Atoka _____	T. Pictured Cliffs _____	T. Penn. "D" _____
T. Yates _____ 2067'	T. Miss _____	T. Cliff House _____	T. Leadville _____
T. 7 Rivers _____	T. Devonian _____	T. Menefee _____	T. Madison _____
T. Queen _____	T. Silurian _____ 7785'	T. Point Lookout _____	T. Elbert _____
T. Grayburg _____	T. Montoya _____	T. Mancos _____	T. McCracken _____
T. San Andres _____ 3090'	T. Simpson _____	T. Gallup _____	T. Ignacio Qtzte _____
T. Glorieta _____ 4412'	T. McKee _____	Base Greenhorn _____	T. Granite _____
T. Paddock _____	T. Ellenburger _____	T. Dakota _____	T. _____
T. Blinberry _____	T. Gr. Wash _____ 7963'	T. Morrison _____	T. _____
T. Tubb _____ 5734'	T. Granite _____	T. Todillo _____	T. _____
T. Drinkard _____	T. Delaware Sand _____	T. Entrada _____	T. _____
T. Abo _____ 6495'	T. Bone Springs _____	T. Wingate _____	T. _____
T. Wolfcamp _____ 7114'	T. _____	T. Chinle _____	T. _____
T. Penn. _____ 7686'	T. _____	T. Permian _____	T. _____
T. Cisco (Bough C) _____	T. _____	T. Penn. "A" _____	T. _____

FORMATION RECORD (Attach additional sheets if necessary)

From	To	Thickness in Feet	Formation	From	To	Thickness in Feet	Formation
2067'	3090'	1023'	Yates				
3090'	4412'	1322'	San Andres				
4412'	5734'	1322'	Glorieta				
5734'	6495'	761'	Tubb				
6495'	7114'	619'	Abo				
7114'	7686'	572'	Wolfcamp				
7686'	7785'	99'	Penn				
7785'	7963'	178'	Silurian				
7963'	TD	37'	Granite Wash				

Submit 3 Copies
to Appropriate
District Office

State of New Mexico
Energy Minerals and Natural Resources Department

Form C-103
Revised 1-1-89

DISTRICT I
P.O. Box 1980, Hobbs, NM 88240

DISTRICT II
P.O. Drawer DD, Artesia, NM 88210

DISTRICT III
1000 Rio Brazos Rd., Aztec, NM 87410

OIL CONSERVATION DIVISION
P.O. Box 2088
Santa Fe, New Mexico 87504-2088

WELL API NO. 30-025-20523
5. Indicate Type of Lease STATE <input type="checkbox"/> FEE <input checked="" type="checkbox"/>
6. State Oil & Gas Lease No.
7. Lease Name or Unit Agreement Name LAMBIRTH
8. Well No. 9
9. Pool name or Wildcat SOUTH PETERSON FUSSELMAN

SUNDRY NOTICES AND REPORTS ON WELLS (DO NOT USE THIS FORM FOR PROPOSALS TO DRILL OR TO DEEPEN OR PLUG BACK TO A DIFFERENT RESERVOIR. USE "APPLICATION FOR PERMIT" (FORM C-101) FOR SUCH PROPOSALS.)	
1. Type of Well: OIL WELL <input checked="" type="checkbox"/> GAS WELL <input type="checkbox"/> OTHER	
2. Name of Operator E.P. OPERATING COMPANY	
3. Address of Operator 6 DESTA DR., SUITE 5250, MIDLAND, TEXAS 79705-5510	
4. Well Location Unit Letter <u>P</u> : <u>560</u> Feet From The <u>SOUTH</u> Line and <u>560</u> Feet From The <u>EAST</u> Line Section <u>25</u> Township <u>5S</u> Range <u>32 E</u> NMPM <u>ROSSEVELT</u> County	
10. Elevation (Show whether DF, RKB, RT, GR, etc.) 4368.4' GR.	

11. Check Appropriate Box to Indicate Nature of Notice, Report, or Other Data	
NOTICE OF INTENTION TO:	SUBSEQUENT REPORT OF:
PERFORM REMEDIAL WORK <input type="checkbox"/>	REMEDIAL WORK <input type="checkbox"/>
TEMPORARILY ABANDON <input type="checkbox"/>	ALTERING CASING <input type="checkbox"/>
PULL OR ALTER CASING <input type="checkbox"/>	COMMENCE DRILLING OPNS. <input type="checkbox"/>
OTHER: <input type="checkbox"/>	PLUG AND ABANDONMENT <input checked="" type="checkbox"/>
	CASING TEST AND CEMENT JOB <input type="checkbox"/>
	OTHER: <input type="checkbox"/>

12. Describe Proposed or Completed Operations (Clearly state all pertinent details, and give pertinent dates, including estimated date of starting any proposed work) SEE RULE 1103.

- (1). 5-11-92 CIRC. HOLE WITH 10# BRINE & 25# SALT GEL PER BBL. FROM 6200'
- (2). 5-11-92 SPOT 20 SXS PLUG FROM 3148'-3048'
- (3). 5-11-92 CUT 5-1/2" CASING @ 2042' LAY DOWN CASING
- (4). 5-12-92 SPOT 60 SXS PLUG @2117' WOC & TAG PLUG @1937
- (5). 5-12-92 SPOT 40 SXS PLUG FROM 1800'-1700'
- (6). 5-12-92 SPOT 10 SXS PLUG @ SURF
- (7). 5-13-92 INSTALL DRY HOLE MARKER

I hereby certify that the information above is true and complete to the best of my knowledge and belief.

SIGNATURE Joe Fields TITLE ACQUISITION MANAGER DATE MAY 15, 1992
TYPE OR PRINT NAME JOEY FIELDS TELEPHONE NO. 683/9722

(This space for State Use)

APPROVED BY Jack Griffin TITLE OIL & GAS INSPECTOR DATE DEC 08 '92
CONDITIONS OF APPROVAL, IF ANY:

LAMBIRTH #9

ATTACHMENT NO. 3

PAGE 10 OF 31

P. 9w N

Submit 3 Copies
to Appropriate
District Office

State of New Mexico
Energy, Minerals and Natural Resources Department

Form C-103
Revised 1-1-89

DISTRICT I
P.O. Box 1980, Hobbs, NM 88240

DISTRICT II
P.O. Drawer DD, Artesia, NM 88210

DISTRICT III
1000 Rio Brazos Rd., Aztec, NM 87410

OIL CONSERVATION DIVISION

P.O. Box 2088
Santa Fe, New Mexico 87504-2088

WELL API NO. 30-025-20523
5. Indicate Type of Lease STATE <input type="checkbox"/> FEE <input checked="" type="checkbox"/>
6. State Oil & Gas Lease No.

SUNDRY NOTICES AND REPORTS ON WELLS (DO NOT USE THIS FORM FOR PROPOSALS TO DRILL OR TO DEEPEN OR PLUG BACK TO A DIFFERENT RESERVOIR. USE "APPLICATION FOR PERMIT" (FORM C-101) FOR SUCH PROPOSALS.)	
1. Type of Well: OIL WELL <input checked="" type="checkbox"/> GAS WELL <input type="checkbox"/> OTHER	7. Lease Name or Unit Agreement Name Lambirth
2. Name of Operator EP Operating Company	8. Well No. 9
3. Address of Operator 6 Desta Drive, Suite 5250, Midland, TX 79705-5510	9. Pool name or Wildcat South Peterson Fusselman
4. Well Location Unit Letter <u>P</u> : <u>560</u> Feet From The <u>South</u> Line and <u>560</u> Feet From The <u>East</u> Line Section <u>25</u> Township <u>5S</u> Range <u>32E</u> NMPM <u>Roosevelt</u> County 10. Elevation (Show whether DF, RKB, RT, GR, etc.) <u>4368.4' GR</u>	

11. Check Appropriate Box to Indicate Nature of Notice, Report, or Other Data	
NOTICE OF INTENTION TO:	SUBSEQUENT REPORT OF:
PERFORM REMEDIAL WORK <input type="checkbox"/>	REMEDIAL WORK <input type="checkbox"/>
TEMPORARILY ABANDON <input type="checkbox"/>	ALTERING CASING <input type="checkbox"/>
PULL OR ALTER CASING <input type="checkbox"/>	COMMENCE DRILLING OPNS. <input type="checkbox"/>
OTHER: <input type="checkbox"/>	PLUG AND ABANDONMENT <input type="checkbox"/>
	CASING TEST AND CEMENT JOB <input type="checkbox"/>
	OTHER: Casing Collapse - Temporary Abandon <input checked="" type="checkbox"/>

12. Describe Proposed or Completed Operations (Clearly state all pertinent details, and give pertinent dates, including estimated date of starting any proposed work) SEE RULE 1103.

Work Performed 10/10/90 through 10/20/90:

During routine operations to change pump on well, the casing was found to be collapsed from 6533'-54'. The tubing was backed off at 6497'. Tubing was jarred for 2 days with no success. Verbal approval was obtained from Conservation Commission to perforate at 6450'. A 5½" cement retainer was set at 6400'. The well was squeezed with 100 sacks Class "C" Neat to 1850# with no bleed off. Stung out of retainer. Circulated hole with 2% KCL water. Well Temporarily Abandoned. Waiting on approval to plug and abandon.

I hereby certify that the information above is true and complete to the best of my knowledge and belief.

SIGNATURE A. D. Kautz TITLE Production Superintendent DATE 10/29/90

TYPE OR PRINT NAME _____ TELEPHONE NO. _____

(This space for State Use)

Orig. Signed by
Paul Kautz
Geologist

APPROVED BY _____ TITLE _____ DATE _____

CONDITIONS OF APPROVAL, IF ANY:

LAMBIRTH #9

ATTACHMENT NO. 3

PAGE 11 OF 31

NOV 01 1990

NO. OF COPIES RECEIVED	
DISTRIBUTION	
SANTA FE	
FILE	
U.S.G.S.	
LAND OFFICE	
OPERATOR	

Form C-105
Revised 1-1-65

NEW MEXICO OIL CONSERVATION COMMISSION WELL COMPLETION OR RECOMPLETION REPORT AND LOG

Indicate Type of Lease
 State ☐ Fee ☒
 Lease No. _____

1a. TYPE OF WELL OIL WELL <input checked="" type="checkbox"/> GAS WELL <input type="checkbox"/> DRY <input type="checkbox"/> OTHER _____					7. Unit Agreement Name	
b. TYPE OF COMPLETION NEW WELL <input checked="" type="checkbox"/> WORK OVER <input type="checkbox"/> DEEPEN <input type="checkbox"/> PLUG BACK <input type="checkbox"/> DIFF. RESVR. <input type="checkbox"/> OTHER _____					8. Name of Lease Name Lambirth	
2. Name of Operator Enserch Exploration, Inc.					9. Well No. 9	
3. Address of Operator P. O. Box 4815, Midland, Texas 79701					10. Field and Pool, or Wildcat S. Peterson-Fusselman	
4. Location of Well UNIT LETTER <u>P</u> LOCATED <u>560</u> FEET FROM THE <u>South</u> LINE AND <u>560</u> FEET FROM THE <u>East</u> LINE OF SEC. <u>25</u> TWP. <u>5S</u> RGE. <u>32E</u> NMPM					12. County Roosevelt	
15. Date Spudded 12/16/79	16. Date T.D. Reached 1/11/80	17. Date Compl. (Ready to Prod.) 2/14/80	18. Elevations (DF, RKB, RT, GR, etc.) 4368.4' GR	19. Elev. Casinghead 4369.4'		
20. Total Depth 7960'	21. Plug Back T.D. 7895'	22. If Multiple Compl., How Many --	23. Intervals Drilled By Rotary Tools All	25. Was Directional Survey Made No		
24. Producing Interval(s), of this completion - Top, Bottom, Name 7824'-38' (15 holes) - Fusselman					27. Was Well Cured No	
26. Type Electric and Other Logs Run DIL, FDC, BHC						
28. CASING RECORD (Report all strings set in well)						
CASING SIZE	WEIGHT LB./FT.	DEPTH SET	HOLE SIZE	CEMENTING RECORD	AMOUNT PULLED	
13-3/8"	48#	369'	17-1/2"	350 sx. (Circulated)		
9-5/8"	36#	2067'	12-1/4"	900 sx. (Circulated)		
5-1/2"	17#	7955'	8-3/4"	500 sx.		
29. LINER RECORD				30. TUBING RECORD		
SIZE	TOP	BOTTOM	SACKS CEMENT	SCREEN	SIZE	DEPTH SET
					2-3/8"	7873'
31. Perforation Record (Interval, size and number) 7824'-38' (15 holes), .43" size				32. ACID, SHOT, FRACTURE, CEMENT SQUEEZE, ETC.		
				DEPTH INTERVAL	AMOUNT AND KIND MATERIAL USED	
				7824'-38'	150 gals. MOD 101, 500 gals. MOD 202	
33. PRODUCTION						
Date First Production 2/14/80		Production Method (Flowing, gas lift, pumping - Size and type pump) Pumping, 2" x 1-1/2" x 26' O'Bannon				Well Status (Prod. or Shut-in) Prod.
Date of Test 2/26/80	Hours Tested 24	Choke Size --	Prod'n. For Test Period --	Oil - Bbl. 32	Gas - MCF 95	Water - Bbl. 2
Flow Tubing Press. 30#	Casing Pressure 30#	Calculated 24-Hour Rate --	Oil - Bbl. 82	Gas - MCF 95	Water - Bbl. 2	Gas - Oil Ratio 1158/1
34. Disposition of Gas (Sold, used for fuel, vented, etc.) Vented during test					Test Witnessed By B. J. Warren, Jr.	
35. List of Attachments Deviation Record, Logs, Plat, DST Chart						
36. I hereby certify that the information shown on both sides of this form is true and complete to the best of my knowledge and belief.						
SIGNED <u>H. F. Burnett</u>			TITLE <u>Prod. Superintendent</u>		DATE <u>2/28/80</u>	

INSTRUCTIONS

This form is to be filed with the appropriate District Office of the Commission not later than 20 days after the completion of any newly-drilled or deepened well. It shall be accompanied by one copy of all electrical and radio-activity logs run on the well and a summary of all special tests conducted, including drill stem tests. All depths reported shall be measured depths. In the case of directionally drilled wells, true vertical depths shall also be reported. For multiple completions, Items 30 through 34 shall be reported for each zone. The form is to be filled in quintuplicate except on state land, where six copies are required. See Rule 1105.

INDICATE FORMATION TOPS IN CONFORMANCE WITH GEOGRAPHICAL SECTION OF STATE

Southeastern New Mexico

T. Anhy _____
T. Salt _____
B. Salt _____
T. Yates 2074'
T. 7 Rivers _____
T. Queen _____
T. Grayburg _____
T. San Andres 3098'
T. Glorieta 4430'
T. Paddock _____
T. Blinbry _____
T. Tubb 5757'
T. Drinkard _____
T. Abo 6508'
T. Wolfcamp 7134'
T. Penn 7562'
T. Cisco (Bough C) 7682'

T. Canyon _____
T. Strawn _____
T. Atoka _____
T. Miss Missing
T. Devonian _____
T. Silurian 7768'
T. Montoya _____
T. Simpson _____
T. McKee _____
T. Ellenburger _____
T. Gr. Wash 7938'
T. Granite _____
T. Delaware Sand _____
T. Bone Springs _____
T. Fusselman 7822'
T. _____
T. _____

Northwestern New Mexico

T. Ojo Alamo _____
T. Kirtland-Fruitland _____
T. Pictured Cliffs _____
T. Cliff House _____
T. Menefee _____
T. Point Lookout _____
T. Mancos _____
T. Gallup _____
Base Greenhorn _____
T. Dakota _____
T. Morrison _____
T. Todilto _____
T. Entrada _____
T. Wingate _____
T. Chinle _____
T. Permian _____
T. Penn. "A" _____

T. Penn. "B" _____
T. Penn. "C" _____
T. Penn. "D" _____
T. Leadville _____
T. Madison _____
T. Elbert _____
T. McCracken _____
T. Ignacio Qtzite _____
T. Granite _____
T. _____
T. _____
T. _____
T. _____
T. _____
T. _____
T. _____

FORMATION RECORD (Attach additional sheets if necessary)

From	To	Thickness in Feet	Formation	From	To	Thickness in Feet	Formation
3098'	4430'	1332'	San Andres				
4430'	5757'	1327'	Glorieta				
5757'	6508'	751'	Tubb				
6508'	7134'	626'	Abo Shale				
7134'	7562'	428'	Wolfcamp				
7562'	7682'	120'	Penn Lime				
7682'	7768'	86'	Cisco				
7768'	7822'	54'	Silurian				
7822'	7938'	116'	Fusselman				
7938'	TD	22'	Granite Wash				

Submit 3 Copies
to Appropriate
District Office

State of New Mexico
Enr Minerals and Natural Resources Department

Form C-103
Revised 1-1-89

DISTRICT I
P.O. Box 1980, Hobbs, NM 88240

DISTRICT II
P.O. Drawer DD, Artesia, NM 88210

DISTRICT III
1000 Rio Brazos Rd., Aztec, NM 87410

OIL CONSERVATION DIVISION
P.O. Box 2088
Santa Fe, New Mexico 87504-2088

WELL API NO. 30-041-20536
5. Indicate Type of Lease STATE <input type="checkbox"/> FEE <input checked="" type="checkbox"/>
6. State Oil & Gas Lease No.
7. Lease Name or Unit Agreement Name LAMBIRTH
8. Well No. 10
9. Pool name or Wildcat SOUTH PETERSON FUSSELMAN

SUNDRY NOTICES AND REPORTS ON WELLS (DO NOT USE THIS FORM FOR PROPOSALS TO DRILL OR TO DEEPEN OR PLUG BACK TO A DIFFERENT RESERVOIR. USE "APPLICATION FOR PERMIT" (FORM C-101) FOR SUCH PROPOSALS.)	
1. Type of Well: OIL WELL <input checked="" type="checkbox"/> GAS WELL <input type="checkbox"/> OTHER	
2. Name of Operator E.P. OPERATING COMPANY	
3. Address of Operator 6 DESTA DR., SUITE 5250, MIDLAND, TEXAS 79705-5510	
4. Well Location Unit Letter <u>D</u> : <u>810</u> Feet From The <u>NORTH</u> Line and <u>660</u> Feet From The <u>WEST</u> Line Section <u>31</u> Township <u>5S</u> Range <u>33E</u> NMPM <u>ROOSEVELT</u> County	
10. Elevation (Show whether DF, RKB, RT, GR, etc.) 4384.4' GR.	

11. Check Appropriate Box to Indicate Nature of Notice, Report, or Other Data	
NOTICE OF INTENTION TO:	SUBSEQUENT REPORT OF:
PERFORM REMEDIAL WORK <input type="checkbox"/>	REMEDIAL WORK <input type="checkbox"/>
TEMPORARILY ABANDON <input type="checkbox"/>	ALTERING CASING <input type="checkbox"/>
PULL OR ALTER CASING <input type="checkbox"/>	COMMENCE DRILLING OPNS. <input type="checkbox"/>
OTHER: <input type="checkbox"/>	PLUG AND ABANDONMENT <input checked="" type="checkbox"/>
	CASING TEST AND CEMENT JOB <input type="checkbox"/>
	OTHER: <input type="checkbox"/>

12. Describe Proposed or Completed Operations (Clearly state all pertinent details, and give pertinent dates, including estimated date of starting any proposed work) SEE RULE 1103.

- (1). 5-13-92 CIRC. HOLE WITH 10# BRINE WITH 25# SALT GEL PER BBL. @5900'
- (2). 5-13-92 SPOT 20 SXS PLUG @ 3140'
- (3). 5-13-92 CUT 5-1/2" CASING @2032' LAY CASING DOWN.
- (4). 5-13-92 SPOT 50 SXS @2082' WOC TAG @1915'
- (5). 5-14-92 SPOT 40 SXS @1800'
- (6). 5-14-92 SPOT 10 SXS SURF PLUG
- (7). 5-14-92 INSTALL DRY HOLE MARKER.

I hereby certify that the information above is true and complete to the best of my knowledge and belief.

SIGNATURE Joe Fields TITLE ACQUISITION MANAGER DATE MAY 15, 1992
TYPE OR PRINT NAME JOEY FIELDS TELEPHONE NO. 683/9722

(This space for State Use)

APPROVED BY Jack Griffin TITLE OIL & GAS INSPECTOR DATE DEC 08 '92
CONDITIONS OF APPROVAL, IF ANY:

LAMBIRTH #10

ATTACHMENT NO. 3

PAGE 14 OF 31

RECEIVED

SEP 1 1964

U.S. DEPARTMENT OF
COMMERCE

STATE OF NEW MEXICO
ENERGY AND MINERALS DEPARTMENT

OIL CONSERVATION DIVISION
P. O. BOX 2088
SANTA FE, NEW MEXICO 87501

NO. OF COPIES RECEIVED	
DISTRIBUTION	
SANTA FE	
FILE	
U.S.G.S.	
LAND OFFICE	
OPERATOR	

WELL COMPLETION OR RECOMPLETION REPORT AND LOG

50. Indicate Type of Lease
State ☐ Fee ☒
51. State Oil & Gas Lease No.

a. TYPE OF WELL

OIL WELL ☒ GAS WELL ☐ DRY ☐ OTHER ☐

b. TYPE OF COMPLETION

NEW WELL ☒ WORK OVER ☐ DEEPEN ☐ PLUG BACK ☐ DIFF. RESVR. ☐ OTHER ☐

c. Name of Operator

Enserch Exploration, Inc.

d. Address of Operator

P. O. Box 4815, Midland, Texas 79704

e. Location of Well

UNIT LETTER D LOCATED 810 FEET FROM THE North LINE AND 660 FEET FROM

West LINE OF SEC. 31 TWP. 5S RGE. 33E 15. Date Spudded 6/6/80 16. Date T.D. Reached 6/24/80 17. Date Compl. (Ready to Prod.) 8/22/80 18. Elevations (DF, RAR, RT, CR, etc.) 4384.4' GR 19. Elev. Casinghead 4385.4'

20. Total Depth 7848'	21. Plug Back T.D. 7843'	22. If Multiple Compl., How Many N/A	23. Intervals Drilled By Rotary Tools All	24. Was Directional Survey Made No
--------------------------	-----------------------------	---	---	---------------------------------------

24. Producing Interval(s), of this completion - Top, Bottom, Name

7813'-32' Fusselman

25. Type Electric and Other Logs Run

DLL/MS, CFDL, CBL/VD

27. Was Well Cored
No

26. CASING RECORD (Report all strings set in well)

CASING SIZE	WEIGHT LB./FT.	DEPTH SET	HOLE SIZE	CEMENTING RECORD	AMOUNT PULLED
13-3/8"	48#	313'	17-1/2"	350 sx. Circulated	
8-5/8"	24#	1963'	12-1/4"	950 sx. Circulated	
5-1/2"	15.5# & 17#	7846'	7-7/8"	500 sx.	

28. LINER RECORD

SIZE	TOP	BOTTOM	SACKS CEMENT	SCREEN	SIZE	DEPTH SET	PACKER SET
					2-3/8"	7842'	--

29. Perforation Record (Interval, size and number)

7813'-32', 9 holes, .40" size

30. ACID, SHOT, FRACTURE, CEMENT SQUEEZE, ETC.

DEPTH INTERVAL	AMOUNT AND KIND MATERIAL USED
7813'-32'	250 gals. 7 1/2% MCA Acid
7825'-32'	4500 gals. Injectrol, 100sx. ceme
7813'-15'	500 gals. MOD 202 Acid
7813'-32'	500 gals. 15% HCL Acid

31. PRODUCTION

32. Date First Production 7-19-80	33. Production Method (Flowing, gas lift, pumping - Size and type pump) Pumping 2" x 1 1/2" x 24' RHBC	34. Well Status (Prod. or Shut-in) Prod.
35. Date of Test 8/25/80	36. Hours Tested 24	37. Choke Size --
38. Flow Tubing Press. --	39. Casing Pressure 30 psi	40. Calculated 24-Hour Rate --
41. Oil - Bbl. 153	42. Gas - MCF 117	43. Water - Bbl. 203
44. Oil Gravity - API (Corr.) 49.2	45. Gas - Oil Ratio 765/1	46. Test Witnessed By L. D. Smith

34. Disposition of Gas (Sold, used for fuel, vented, etc.)

Vented during test.

35. List of Attachments

Deviation Report, Plat, Logs

36. I hereby certify that the information shown on both sides of this form is true and complete to the best of my knowledge and belief.

SIGNED H. F. Burnett

TITLE Prod. Superintendent

DATE 8/27/80

LAMBIRTH #10

ATTACHMENT NO. 3

PAGE 15 OF 31

RECEIVED

SEP 1 1972

21110
OCD 11-11-72

INSTRUCTIONS

This form is to be filled with the appropriate Transfer Office of the Division not later than 20 days after the completion of any newly-filled or deepened well. It shall be accompanied by one copy of all electrical and formation test logs run on the well and a summary of all special tests conducted, including drill stem tests. All depths reported shall be measured separately in the case of directionally drilled wells, true vertical depth shall also be reported. For multiple casing bottoms, from 20 through 24 shall be reported for each zone. The form is to be filled in quadruplicate except on state land, where six copies are required. (See Rule 1105.)

INDICATE FORMATION TOPS IN CONFORMANCE WITH GEOGRAPHICAL SECTION OF STATE

Southeastern New Mexico		Northwestern New Mexico	
T. Anhy	T. Canyon	T. Ojo Alamo	T. Penn. "B"
T. Salt	T. Strawn	T. Kirtland Fruitland	T. Penn. "C"
B. Salt	T. Atoka	T. Fractured Cliffs	T. Penn. "D"
T. Yates	T. Miss	T. Cliff House	T. Leadville
T. 7 Rivers	T. Devonian	T. Hunter	T. Madison
T. Queen	T. Silurian	T. Point Lookout	T. Elbert
T. Grayburg	T. Montoya	T. Mancos	T. McCracken
T. San Andres 3090'	T. Simpson	T. Gallup	T. Ignacio Gato
T. Glorieta 4410'	T. McKee	Base Greenhorn	T. Granite
T. Paddock	T. Ellenburger	T. Dakota	T.
T. Blinberry	T. Gr. Wash	T. Morrison	T.
T. Tubb 5735'	T. Granite	T. Todilto	T.
T. Lrinkard	T. Delaware Sand	T. Entrada	T.
T. Abo 6491'	T. Bone Springs	T. Wingate	T.
T. Wolfcamp 7115'	T. Fusselman 7781'	T. Chinle	T.
T. Penn.	T. 3 Brothers 7438'	T. Permian	T.
T. Cisco (Bough C) 7688'	T.	T. Penn. "A"	T.

OIL OR GAS SANDS OR ZONES

No. 1, from	to	No. 4, from	to
No. 2, from	to	No. 5, from	to
No. 3, from	to	No. 6, from	to

IMPORTANT WATER SANDS

Include data on rate of water inflow and elevation to which water rose in hole.

No. 1, from	to	feet
No. 2, from	to	feet
No. 3, from	to	feet
No. 4, from	to	feet

FORMATION RECORD (Attach additional sheets if necessary)

From	To	Thickness in Feet	Formation	From	To	Thickness in Feet	Formation
3090'	4410'	1320'	San Andres				
4410'	5735'	1325'	Glorieta				
5735'	6491'	756'	Tubb				
6491'	7115'	624'	Abo Shale				
7115'	7438'	323'	Wolfcamp Lime				
7438'	7688'	250'	3 Brothers				
7688'	7781'	93'	Cisco				
7781'	T.D.	67'	Fusselman				

RECEIVED

SEP 11 1964

U.S. DEPT. OF JUSTICE

STATE OF NEW MEXICO

DEVIATION REPORT

Enserch Exploration, Inc.
Drilling Department
1230 Riverbend
Suite 136
Dallas, Texas 75247

Lambirth # 10
Roosevelt County, New Mexico

<u>DEPTH</u>	<u>DEVIATION</u>
361	3/4
943	1
1382	1
1445	1 3/4
1529	1 3/4
1848	3/4
2010	1/2
2747	1/2
3231	1/4
3806	3/4
4340	1
4829	1
5370	1
6102	1
6874	1/2
7135	1/2
7848	1 1/2

REPUBLIC DRILLING & SERVICE, INC.

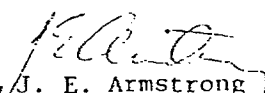
By:  J. E. Armstrong
Vice President - Operations

STATE OF TEXAS I
 I
COUNTY OF HARRIS I

The foregoing instrument was acknowledged before me this 24 day of
July, 19 80, by J. E. Armstrong on behalf of Republic
Drilling & Service, Inc.

My Commission Expires:
6/30/84

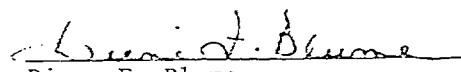
Diane F. Blume
Notary Public in and for
Harris County, Texas

STATE OF NEW MEXICO
OIL AND MINERALS DEPARTMENT

OIL CONSERVATION DIVISION

P. O. BOX 2088

SANTA FE, NEW MEXICO 87501

WELL COMPLETION OR RECOMPLETION REPORT AND LOG

NO. OF COPIES RECEIVED	
DISTRIBUTION	
SANTA FE	
FILE	
U.S.G.S.	
LAND OFFICE	
OPERATOR	

5a. Indicate Type of Lease
State ☐ Fee ☒

5. State Oil & Gas Lease No.

7. Unit Agreement Name

8. Farm or Lease Name

Lambirth

9. Well No.

12

10. Field and Pool, or Wildcat

South Peterson Penn.

12. County

Roosevelt

TYPE OF WELL

OIL WELL ☐

GAS WELL ☒

DRY ☐

OTHER

TYPE OF COMPLETION

NEW WELL ☒

WORK OVER ☐

DEEPEN ☐

PLUG BACK ☐

DIFF. RESVR. ☐

OTHER

Name of Operator

Enserch Exploration, Inc.

Address of Operator

P. O. Box 4815, Midland, Texas 79704

Location of Well

WELL LETTER K LOCATED 2310 FEET FROM THE South LINE AND 1854 FEET FROM

West LINE OF SEC. 31 TWP. 5S RGE. 33E NMPM

15. Date Spudded

2/16/85

16. Date T.D. Reached

3/7/85

17. Date Compl. (Ready to Prod.)

4/13/85

18. Elevations (DF, RKB, RT, GR, etc.)

4410.7' GR

19. Elev. Casinghead

4411.7'

20. Total Depth

7750'

21. Plug Back T.D.

7670'

22. If Multiple Compl., How Many

--

23. Intervals Drilled By

Rotary Tools

All

Cable Tools

24. Producing Interval(s), of this completion — Top, Bottom, Name

7611'-65', Pennsylvanian

25. Was Directional Survey Made

No

26. Type Electric and Other Logs Run

CNL/FDL/GR/Caliper, CBL

27. Was Well Cored

No

CASING RECORD (Report all strings set in well)

CASING SIZE	WEIGHT LB./FT.	DEPTH SET	HOLE SIZE	CEMENTING RECORD	AMOUNT PULLED
13-3/8"	48#	370'	17-1/2"	375 sx. Class C	--
9-5/8"	36#	2005'	12-1/4"	875 sx. Lite & "C"	--
5-1/2"	15.5#	7750'	8-3/4"	565 sx. Lite & "C"	--

LINER RECORD

SIZE	TOP	BOTTOM	SACKS CEMENT	SCREEN

TUBING RECORD

SIZE	DEPTH SET	PACKER SET
2-3/8"	7546'	7547'

28. Perforation Record (Interval, size and number)

7688'-7700', .50" size, 26 holes (Squeezed w/150 sx. Class "H" Neat cement)

7611'-65', .50" size, 50 holes

ACID, SHOT, FRACTURE, CEMENT SQUEEZE, ETC.

DEPTH INTERVAL	AMOUNT AND KIND MATERIAL USED
7688'-7700'	2500 gals. MOD 202 acid, 200 gal. 20% MSA acid
7611'-65'	5000 gals. MOD 202 acid

PRODUCTION

29. Date First Production		30. Production Method (Flowing, gas lift, pumping — Size and type pump)				31. Well Status (Prod. or Shut-in)	
3/30/85		Flowing				Shut-in	
32. Date of Test	Hours Tested	Choke Size	Prod'n. For Test Period	Oil — Bbl.	Gas — MCF	Water — Bbl.	Gas — Oil Ratio
4/13/85	24	24/64"		3	170	58	56,667/1
33. Flow Tubing Press.	Casing Pressure	Calculated 24-Hour Rate	Oil — Bbl.	Gas — MCF	Water — Bbl.	Oil Gravity — API (Corr.)	
85#	Packer		3	170	58	42.4	
34. Disposition of Gas (Sold, used for fuel, vented, etc.)						Test Witnessed By	
Vented during test.						S. C. Hartley	

35. List of Attachments

Inclination Report, Plat and logs

I hereby certify that the information shown on both sides of this form is true and complete to the best of my knowledge and belief.

SIGNED L. F. Lambirth

TITLE Prod. Superintendent

DATE 4/22/85

LAMBIRTH #12

ATTACHMENT NO. 3

PAGE 18 OF 31

NO. OF COPIES RECEIVED	
DISTRIBUTION	
SANTA FE	
FILE	
U.S.G.S.	
LAND OFFICE	
OPERATOR	

NEW MEXICO OIL CONSERVATION COMMISSION
WELL COMPLETION OR RECOMPLETION REPORT AND LOG

API # 30-041-20481

1. Indicate Type of Lease
State <input type="checkbox"/> Fee <input checked="" type="checkbox"/>
2. State Oil & Gas Lease No.

3. Unit Agreement Name
4. Farm or Lease Name
Lambirth-A

5. Well No.
2

10. Field and Feet, or Wildcat
Peterson, Fusselman Sout

11. County
Roosevelt

12. Township
31

13. Range
33-E

14. Elevation (DF, RKB, RT, GR, etc.)
4396.8 GR

15. Elev. Casinghead

16. Date Spudded
3-4-79

17. Date Comp. (Ready to Prod.)
4-9-79

18. Date T.D. Reached
3-30-79

19. Date Completion

20. Total Depth
7920

21. Plug Back T.D.
7877

22. If Multiple Comp., How Many

23. Intervals Cased by
0-7920

24. Producing Interval(s) of this completion - Top, bottom, bottom
Fusselman, Top 7820', Bottom 7877' PBTD

25. Was Directional Survey Made
No

26. Type Electric and Other Logs Run
GR-CL & CBL Western

27. Was Well Cored
Yes

28. Casing Record (Report all strings set in well)

29. Liner Record

30. Tubing Record

31. Perforation Record (Interval, size and number)
4" csg gun 4 SPF 7832'-7838' 6'-24 holes

32. Acid, Shot, Fracture, Cement Squeeze, ETC.

33. Production

34. Disposition of Gas (Sold, used for fuel, vented, etc.)
Sold

35. List of Attachments
Electric logs previously furnished by Log Co. Copy of core analysis attached.

36. I hereby certify that the information shown on both sides of this form is true and complete to the best of my knowledge and belief.
Signed <u>W. J. Mueller</u> Title <u>Senior Engineering Specialist</u> Date <u>4/20/79</u>

LAMBIRTH #A-2

ATTACHMENT NO. 3

PAGE 19 OF 31

INSTRUCTIONS

This form is to be filed with the appropriate District Office of the Commission not later than 30 days after the completion of any newly-drilled or deepened well. It shall be accompanied by one copy of all electrical and resistivity logs run on the well and a summary of all special tests conducted, including drill stem tests. All depths reported shall be measured depths. In the case of directionally drilled wells, true vertical depths shall also be reported. For multiple completions, Items 30 through 34 shall be reported for each zone. The form is to be filed in quadruplicate except on state land, where six copies are required. See Rule 1105.

INDICATE FORMATION TOPS IN CONFORMANCE WITH GEOGRAPHICAL SECTION OF STATE

Southeastern New Mexico

Northwestern New Mexico

T. Andy <u>Bustler</u> <u>1890</u>	T. Canyon _____	T. Ojo Alamo _____	T. Penn. "B" _____
T. Salt _____	T. Strawn _____	T. Kirtland-Fruitland _____	T. Penn. "C" _____
D. Salt _____	T. Atoka _____	T. Pictured Cliffs _____	T. Penn. "D" _____
T. Yates <u>2100</u>	T. Miss _____	T. Cliff House _____	T. Leadville _____
T. 7 Rivers _____	T. Devonian _____	T. Menefee _____	T. Madison _____
T. Queen _____	T. Silurian _____	T. Point Lookout _____	T. Elbert _____
T. Gradyburg _____	T. Montevn _____	T. Mancos _____	T. McCracken _____
T. San Andres <u>3120</u>	T. Simpson _____	T. Gallup _____	T. Ignacio Qtzte _____
T. Glorieta _____	T. McKee _____	Base Greenhorn _____	T. Granite _____
T. Paddock _____	T. Ellenburger _____	T. Dakota _____	T. _____
T. Blinberry _____	T. Gr. Wash <u>7950</u>	T. Morrison _____	T. _____
T. Tubb _____	T. Granite _____	T. Todilto _____	T. _____
T. Drinkard _____	T. Delaware Sand _____	T. Entrada _____	T. _____
T. Abo <u>Shale</u> <u>6500</u>	T. Bone Springs _____	T. Wingate _____	T. _____
T. Wolfcamp <u>Huero</u> <u>7160</u>	T. _____	T. Chinle _____	T. _____
T. <u>Three Brothers</u> <u>7490</u>	T. _____	T. Permian _____	T. _____
T. <u>Cisco</u> <u>7630</u>	T. _____	T. Penn. "A" _____	T. _____
T. <u>Fusselman</u> <u>7820</u>	T. _____		

OIL OR GAS SANDS OR ZONES

No. 1, from 7820 to 7950 No. 4, from _____ to _____
 No. 2, from _____ to _____ No. 5, from _____ to _____
 No. 3, from _____ to _____ No. 6, from _____ to _____

IMPORTANT WATER SANDS APR 23 1979

Include data on rate of water inflow and elevation to which water rose in hole.

OIL CONSERVATION COMM.

No. 1, from none to _____
 No. 2, from _____ to _____
 No. 3, from _____ to _____
 No. 4, from _____ to _____

FORMATION RECORD (Attach additional sheets if necessary)

From	To	Thickness in Feet	Formation	From	To	Thickness in Feet	Formation
0	359	359'	Surface, sand & caliche	* Item 28 continued-- 5-1/2" casing size, 17# K-55 weight lb./ft., 8000' (T.D.) Depth Set, 7-7/8" hole size, Cementing record--100 ex Class H w/30%O.D.. 2% KCl & 1/2# Celloflakes/sx + 1% D-19, followed by 100 ex Class H w/2% KCl & 1% D-19.			
359	1704	1345	Red Bed				
1704	3120	1416	Salt & Anhydrite				
3120	3670	550	Anhydrite				
3670	6681	3011	Lime & Shale				
6681	6802	121	Dolomite				
6802	7109	307	Dolomite & Shale				
7109	7920	811	Dolomite & Shale				

RENEWED

NOV 19 1964

LIBRARY OF THE
CONGRESS

NO. OF COPIES RECEIVED	
DISTRIBUTION	
SANTA FE	
FILE	
U.S.G.S.	
LAND OFFICE	
OPERATOR	

NEW MEXICO OIL CONSERVATION COMMISSION

Form C-103
Supersedes Old
C-102 and C-103
Effective 1-1-65

5a. Indicate Type of Lease
State <input checked="" type="checkbox"/> Fee <input type="checkbox"/>
5. State Oil & Gas Lease No.
K-5732
7. Unit Agreement Name

8. Farm or Lease Name
Goldston-A
9. Well No.
1
10. Field and Pool, or Wildcat
Undesignated
12. County
Roosevelt

SUNDRY NOTICES AND REPORTS ON WELLS (DO NOT USE THIS FORM FOR PROPOSALS TO DRILL OR TO DEEPEN OR PLUG BACK TO A DIFFERENT RESERVOIR. USE "APPLICATION FOR PERMIT -" (FORM C-101) FOR SUCH PROPOSALS.)	
1. OIL WELL <input checked="" type="checkbox"/> GAS WELL <input type="checkbox"/> OTHER <input type="checkbox"/>	2. Name of Operator
Phillips Petroleum Company	3. Address of Operator
Room 711, Phillips Bldg., Odessa, Texas 79761	4. Location of Well
UNIT LETTER P 660 FEET FROM THE south LINE AND 660 FEET FROM	15. Elevation (Show whether DF, RT, GR, etc.)
THE east LINE, SECTION 36 TOWNSHIP 5-S RANGE 32-E NMPM.	4439.6 DF

15. Check Appropriate Box To Indicate Nature of Notice, Report or Other Data	
NOTICE OF INTENTION TO:	SUBSEQUENT REPORT OF:
PERFORM REMEDIAL WORK <input type="checkbox"/>	REMEDIAL WORK <input type="checkbox"/>
TEMPORARILY ABANDON <input type="checkbox"/>	COMMENCE DRILLING OPNS. <input type="checkbox"/>
PULL OR ALTER CASING <input type="checkbox"/>	CASING TEST AND CEMENT JOBS <input type="checkbox"/>
OTHER <input type="checkbox"/>	OTHER <input type="checkbox"/>
PLUG AND ABANDON <input type="checkbox"/>	ALTERING CASING <input type="checkbox"/>
CHANGE PLANS <input type="checkbox"/>	PLUG AND ABANDONMENT <input checked="" type="checkbox"/>

17. Describe Proposed or Completed Operations (Clearly state all pertinent details, and give pertinent dates, including estimated date of starting any proposed work) SEE RULE 1103.

9-18-72: COOH. Laid down DCs and fishing tools. Howco spotted cement plugs thru 4" DP as follows.

50 sx (100') from 1200' - 1100'.

75 sx (100') from 350' - 250'.

30 sx (40') from 40' - 0'.

Hole loaded w/9.8# mud between plugs. Released rig 3 PM, 9-18-72.

Welded on marker. Well P & A.

(This was an unsuccessful re-entry attempt of Goldston Oil Company's Lambirth State #1, originally drilled and abandoned in 1951.)

GOLDSTON A-1

ATTACHMENT NO. 3

PAGE 21 OF 31

18. I hereby certify that the information above is true and complete to the best of my knowledge and belief.

SIGNED W. J. Mueller TITLE Senior Reservoir Engineer DATE 9-19-72

APPROVED BY John W. Ransom TITLE DATE

DUPLICATE
FORM C-105

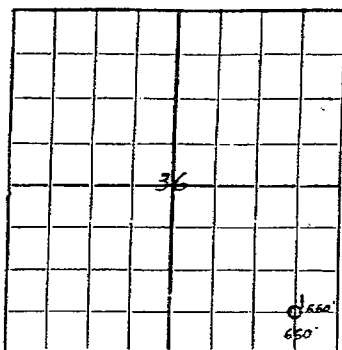

AREA 640 ACRES
LOCATE WELL CORRECTLY

NEW MEXICO OIL CONSERVATION COMMISSION

Santa Fe, New Mexico

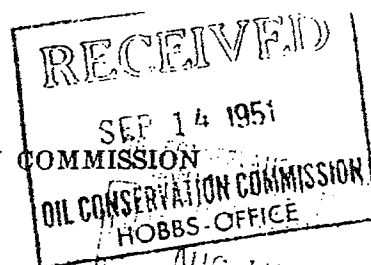

WELL RECORD

Mail to Oil Conservation Commission, Santa Fe, New Mexico, or its proper agent not more than twenty days after completion of well. Follow instructions in the Rules and Regulations of the Commission. Indicate questionable data by following it with (?). SUBMIT IN TRIPPLICATE.

Goldston Oil Corporation **Lambirth - State**
Company or Operator Lease
Well No. 1 in SE Cor. of Sec. 36 T. 5 S.
R. 32 E N. M. P. M. Wildcat Field, Roosevelt County.
Well is 4620 feet south of the North line and 660' feet west of the East line of Section 36
If State land the oil and gas lease is No. B-9244 Assignment No. None
If patented land the owner is -- Address --
If Government land the permittee is -- Address --
The Lessee is Continental Oil Company Address Drawer 1267 Ponca City, Okla.
Drilling commenced 5-28-51 19 19 Drilling was completed 8-10-51 19 19
Name of drilling contractor Bog West Drilling Company Address Ft. Worth, Texas
Elevation above sea level at top of casing 4440' feet.
The information given is to be kept confidential until Not confidential 19 19

OIL SANDS OR ZONES

No. 1, from None to No. 4, from to
No. 2, from to No. 5, from to
No. 3, from to No. 6, from to

IMPORTANT WATER SANDS

Include data on rate of water inflow and elevation to which water rose in hole.

No. 1, from None to feet.
No. 2, from to feet.
No. 3, from to feet.
No. 4, from to feet.

CASING RECORD

SIZE	WEIGHT PER FOOT	THREADS PER INCH	MAKE	AMOUNT	KIND OF SHOE	CUT & FILLED FROM	PERFORATED FROM TO	PURPOSE
13 3/8	48#	8 Rd	Nat'l	200	Baker	-	-	-
9 5/8	36#	8 Rd	Nat'l	1000	Baker	-	-	-

GOLDSTON A-1

ATTACHMENT NO. 3

PAGE 22 OF 31

SIZE OF HOLE	SIZE OF CASING	WHERE SET	J. SACKS OF CEMENT	METHOD USED	MUD GRAVITY	AMOUNT OF MUD USED
12 1/2	9 5/8	3420	1000	Halliburton	9.4#	
17 1/2	13 3/8	317	200	Halliburton	9.4#	

PLUGS AND ADAPTERS

Heaving plug—Material _____ Length None Depth Set _____
 Adapters—Material _____ Size _____

RECORD OF SHOOTING OR CHEMICAL TREATMENT

SIZE	SHELL USED	EXPLOSIVE OR CHEMICAL USED	QUANTITY	DATE	DEPTH SHOT OR TREATED	DEPTH CLEANED OUT
			None			

Results of shooting or chemical treatment _____

RECORD OF DRILL-STEM AND RECORDS

If drill-stem or other special tests or deviation surveys were made, submit report on separate sheet and attach hereto.

TOOLS USED

Rotary tools were used from 7816 feet to 7916 - 280' Mud feet, and from _____ feet to _____ feet.
 Cable tools were used from _____ feet to _____ feet, and from _____ feet to _____ feet.

PRODUCTION

Put to producing _____, 19 _____ None
 The production of the first 24 hours was _____ barrels of fluid of which _____ % was oil; _____ % emulsion; _____ % water; and _____ % sediment. Gravity, Be _____
 If gas well, cu. ft. per 24 hours _____ Gallons gasoline per 1,000 cu. ft. of gas _____
 Rock pressure, lbs. per sq. in. _____

EMPLOYEES

E. Dodson, Supt. Driller T. H. Howard Driller
J. B. Johnson Driller J. E. Spurgin Driller

FORMATION RECORD ON OTHER SIDE

I hereby swear or affirm that the information given herewith is a complete and correct record of the well and all work done on it so far as can be determined from available records.

Subscribed and sworn to before me this 14th
 day of August, 19 51

Louise Worthington
 LOUISE WORTHINGTON
 Notary Public

Notary Public in and for Harris County, Texas
 My Commission expires June 1, 1951

Houston, Texas Aug. 14, 1951
 Place Date

Name S. A. Winkelmann
 Position Petroleum Engr.

Representing Goldston Oil Corporation
 Company or Operator.

Address 202 Oil & Gas Building
Houston, Texas

RECEIVED

NOV 5 1961

OFFICE

FORMATION RECORD

[illegible]

DUPLICATE

NEW MEXICO OIL CONSERVATION COMMISSION
MISCELLANEOUS REPORTS ON WELLS

Form C-103

AUG 17 1951

Submit this report in triplicate to the Oil Conservation Commission District Office within ten days after the work specified is completed. It should be signed and filed as a report on beginning drilling operations, results of shooting well, results of test of casing shut off, result of plugging of well, and other important operations, even though the work was witnessed by an agent of the Commission. See additional instructions in the Rules and Regulations of the Commission.

SEP 14 1951

Indicate nature of report by checking below.

REPORT ON BEGINNING DRILLING OPERATIONS		REPORT ON REPORTING TO OIL CONSERVATION COMMISSION	
REPORT ON RESULT OF SHOOTING OR CHEMICAL TREATMENT OF WELL		REPORT ON PULING OR OTHERWISE ALTERING CASING	X
REPORT ON RESULT OF TEST OF CASING SHUT-OFF		REPORT ON DEEPENING WELL	
REPORT ON RESULT OF PLUGGING OF WELL	X		

August 14, 1951

Houston, Texas

Date

Place

Following is a report on the work done and the results obtained under the heading noted above at the

Goldston Oil Corporation

Lambirth-State

Well No. 1

in the

Company or Operator

Lease

SE Cor.

of Sec. 36

T.

5

S

R.

32 E

N. M. P. M.

Pool

Roosevelt

County.

The dates of this work were as follows: Commenced May 28, 1951 - Completed Aug. 10, 1951

Notice of intention to do the work was (was not) submitted on Form C-102 on _____, 19____, and approval of the proposed plan was (was not) obtained. (Cross out incorrect words.)

DETAILED ACCOUNT OF WORK DONE AND RESULTS OBTAINED

1170' 9 5/8" Casing pulled

Well Cemented with 40 sax from 3400'-3300'

" " " " " 1200'-1300'

" " " 25 " " 350'- 250'

" " " 5 " on top of hole

Hole left full of heavy mud and cellar filled

GOLDSTON A-1

ATTACHMENT NO. 3

PAGE 25 OF 31

Witnessed by S. A. Winkelmann Goldston Oil Corporation Petr. Engr.

Name

Company

Title

APPROVED:

OIL CONSERVATION COMMISSION

Ray Yurkovich
Oil & Gas Inspector

Name

Title

SEP 14 1951

Date

19

I hereby swear or affirm that the information given above is true and correct.

Name S. A. Winkelmann

Position Petroleum Engr.

Representing Goldston Oil Corporation

Address 202 Oil & Gas Building
Houston, Texas

RECEIVED

SEP 1957

U.S. AIR FORCE
OFFICE

NO. OF COPIES RECEIVED		
DISTRIBUTION		
SANTA FE		
FILE		
U.S.G.S.		
LAND OFFICE		
OPERATOR		

NEW MEXICO OIL CONSERVATION COMMISSION

Form C-103
Supersedes Old
C-102 and C-103
Effective 1-1-65

5a. Indicate Type of Lease State <input checked="" type="checkbox"/> Fee <input type="checkbox"/>
5. State Oil & Gas Lease No. K-5732
7. Unit Agreement Name —
8. Firm or Lease Name Goldston-A
9. Well No. 2
10. Field and Pool, or Wildcat South Peterson-Penn
12. County Roosevelt

SUNDRY NOTICES AND REPORTS ON WELLS
(DO NOT USE THIS FORM FOR PROPOSALS TO DRILL OR TO DEEPEN OR PLUG BACK TO A DIFFERENT RESERVOIR. USE "APPLICATION FOR PERMIT -" (FORM C-101) FOR SUCH PROPOSALS.)

1. <input checked="" type="checkbox"/> OIL WELL <input type="checkbox"/> GAS WELL <input type="checkbox"/> OTHER
2. Name of Operator Phillips Petroleum Company
3. Address of Operator Room 711, Phillips Building, Odessa, Texas 79761
4. Location of Well UNIT LETTER P 960 FEET FROM THE south LINE AND 660 FEET FROM east THE 36 LINE, SECTION 5-S TOWNSHIP 32-E RANGE 32-E N.M.P.M.
15. Elevation (Show whether DF, RT, GR, etc.) 4427' Gr., 4439' DF

16. Check Appropriate Box To Indicate Nature of Notice, Report or Other Data

NOTICE OF INTENTION TO:		SUBSEQUENT REPORT OF:	
PERFORM REMEDIAL WORK <input type="checkbox"/>	PLUG AND ABANDON <input type="checkbox"/>	REMEDIAL WORK <input type="checkbox"/>	ALTERING CASING <input type="checkbox"/>
TEMPORARILY ABANDON <input type="checkbox"/>	CHANGE PLANS <input type="checkbox"/>	COMMENCE DRILLING OPHS. <input type="checkbox"/>	PLUG AND ABANDONMENT <input checked="" type="checkbox"/>
PULL OR ALTER CASING <input type="checkbox"/>	OTHER <input type="checkbox"/>	CASING TEST AND CEMENT JOB <input type="checkbox"/>	OTHER <input type="checkbox"/>

17. Describe Proposed or Completed Operations (Clearly state all pertinent details, and give pertinent dates, including estimated date of starting any proposed work) SEE RULE 1103.

- 9-73: MI & RU Baber WS unit. Unable to pump down tbq. Cut tbq at 4703', pulled tbq. Worked 5-1/2" csg, csg parted above collapsed area. Pulled and recovered 4700' of 5-1/2" csg as follows:
2 jts (65') 17#, K-55, ST&C,
32 jts (1000') 15.5#, K-55, ST&C,
114 jts (3635') 14#, K-55, ST&C.
- 10-73: Ran tbq to 4680', mixed 25 sx mud, loaded hole. Spotted 250 sx class H cmt, pulled tbq to 3600'.
- 11-73: Tagged TCC at 4500'. Spotted 150 sx class H cmt f/4500' to 4100', 50 sx class H cmt f/3550-3450', pulled tbq.
- 12-73: Cut off well head. Welded pull npl on 8-5/8" csg. WS unit broke down.
- 13-73-
-24-73: Repaired WS unit.
- 25-73: Worked 8-5/8" csg. Csg stuck at 1300'.
- 26-73: SD, weather.
- 27-73: Cut off 8-5/8" csg at 850'. Pulled and recovered 850' 8-5/8" csg as follows:
2 jts (60') 32#, K-55, ST&C, 24 jts (790') 24#, K-55, ST&C.
spotted 125 sx class H cmt f/903' to 725', 100 sx class H cmt f/390-250', and 10 sx class H cmt f/30' to surface. Installed dry hole marker. Well p & a.

18. I hereby certify that the information above is true and complete to the best of my knowledge and belief.

SIGNED W. J. Mueller TITLE Senior Reservoir Engr. DATE 7-30-73
APPROVED BY John A. Remman DATE DEC

GOLDSTON A-2

ATTACHMENT NO. 3

PAGE 26 OF 31

RECEIVED

SEP 10 1964

LIBRARY

NO. OF COPIES RECEIVED	
DISTRIBUTION	
SANTA FE	
FILE	
U.S.G.S.	
LAND OFFICE	
OPERATOR	

**NEW MEXICO OIL CONSERVATION COMMISSION
WELL COMPLETION OR RECOMPLETION REPORT AND LOG**

Form C-105
Revised 1-1-65

5a. Indicate Type of Lease State <input checked="" type="checkbox"/> Free <input type="checkbox"/>
5. State Oil & Gas Lease No. K-5732
7. Unit Agreement Name —
8. Farm or Lease Name Goldston-A
9. Well No. 2
10. Field and Pool, or Wildcat Unesignated
12. County Roosevelt
15. Date Spudded 10-1-72
16. Date T.D. Reached 10-30-72
17. Date Compl. (Ready to Prod.) 11-17-72
18. Elevations (DF, RKB, RT, GR, etc.) 4427' Gr., 4439' DF
19. Elev. Casinghead —
20. Total Depth 8070'
21. Plug Back T.D. 7830'
22. If Multiple Compl., How Many —
23. Intervals Drilled By Rotary Tools 0-8070
24. Producing Interval(s), of this completion — Top, Bottom, Name Cisco - top 7702' bottom 7830'
25. Was Directional Survey Made No
26. Type Electric and Other Logs Run BHC integrated sonic-gr-caliper, compensated neutron-density, /olog, dual later-
27. Was Well Cored Yes
28. CASING RECORD (Report all strings set in well) Microlaterolog
29. LINER RECORD
30. TUBING RECORD
31. Perforation Record (Interval, size and number) 7706-14' = 8", 16 shots (jet) 7793-7801' = 8", 16 shots (jet) 16", 32 shots
32. ACID, SHOT, FRACTURE, CEMENT SQUEEZE, ETC.
33. PRODUCTION
34. Disposition of Gas (Sold, used for fuel, vented, etc.) Vented
35. List of Attachments Core analysis. Logs previously furnished by Schlumberger.
36. I hereby certify that the information shown on both sides of this form is true and complete to the best of my knowledge and belief.

1a. TYPE OF WELL	
b. TYPE OF COMPLETION	
NEW WELL <input checked="" type="checkbox"/>	WORK OVER <input type="checkbox"/>
DEEPEN <input type="checkbox"/>	PLUG BACK <input type="checkbox"/>
DIFF. RESVR. <input type="checkbox"/>	OTHER <input type="checkbox"/>
2. Name of Operator Phillips Petroleum Company	
3. Address of Operator Room 711, Phillips Building, Odessa, Texas 79761	
4. Location of Well	
UNIT LETTER P	LOCATED 960 FEET FROM THE south LINE AND 660 FEET FROM THE east LINE OF SEC. 36 TWP. 5-S RGE. 32-E NMPM

15. Date Spudded 10-1-72	16. Date T.D. Reached 10-30-72	17. Date Compl. (Ready to Prod.) 11-17-72	18. Elevations (DF, RKB, RT, GR, etc.) 4427' Gr., 4439' DF	19. Elev. Casinghead —
20. Total Depth 8070'	21. Plug Back T.D. 7830'	22. If Multiple Compl., How Many —	23. Intervals Drilled By Rotary Tools 0-8070	Cable Tools —
24. Producing Interval(s), of this completion — Top, Bottom, Name Cisco - top 7702' bottom 7830'				25. Was Directional Survey Made No
26. Type Electric and Other Logs Run BHC integrated sonic-gr-caliper, compensated neutron-density, /olog, dual later-				27. Was Well Cored Yes

CASING SIZE	WEIGHT LB./FT.	DEPTH SET	HOLE SIZE	CEMENTING RECORD	AMOUNT PULLED
13-3/8"	48#	345'	17-1/2"	400 ex Incon SR w/ 2% CaCl₂. Cired.)	—
8-5/8"	24#, 32#	3900'	11"	300 ex Incon SR. Temp sury TOG @ 2710'	—
5-1/2"	14#, 15.5#, 17#	8070'	7-7/8"	500 ex Glass H ent. Temp sury TOG @ 6330'	—

SIZE	TOP	BOTTOM	SACKS CEMENT	SCREEN	SIZE	DEPTH SET	PACKER SET
—	—	—	—	—	2-3/8"	7806'	—

DEPTH INTERVAL	AMOUNT AND KIND MATERIAL USED
7706-14'	1000 gals 20% HCL
" "	2500 gals 20% HCL
7793-7801'	2500 gals 20% CRA

33. PRODUCTION	
Date First Production 11-18-72	Production Method (Flowing, gas lift, pumping — Size and type pump) Insert pump 2" x 1-1/4" x 20'
Well Status (Prod. or Shut-in) Producing	
Date of Test 12-22-72	Hours Tested 24
Choke Size —	Prod'n. For Test Period —
Oil — Bbl. 20	Gas — MCF 12.5
Water — Bbl. 0	Gas — Oil Ratio 625
Flow Tubing Press. —	Casing Pressure —
Calculated 24-Hour Rate —	Oil — Bbl. —
Gas — MCF —	Water — Bbl. —
Oil Gravity — API (Corr.) 42	

34. Disposition of Gas (Sold, used for fuel, vented, etc.) Vented	Test Witnessed By G. W. Hossman
---	---

35. List of Attachments Core analysis. Logs previously furnished by Schlumberger.

36. I hereby certify that the information shown on both sides of this form is true and complete to the best of my knowledge and belief.

SIGNED **W. J. Mueller** TITLE **Senior Reservoir Engineer** DATE **12-28-72**
GOLDSTON A-2 ATTACHMENT NO. 3 PAGE 27 OF 31

RECEIVED

SEP 1 1963

OFFICE

HALLIBURTON SERVICE 3
HOBBS, NEW MEXICO

To Okie Crude Company
415 Mid-Continent Tower
Tulsa Okla. 74103
ATT: Thomas Atkinson

Sample Number 286

This report is the property of Halliburton Company and neither it nor any part thereof nor a copy thereof is to be published or disclosed without first securing the express written approval of laboratory management; it may however, be used in the course of regular business operations by any person or concern and employees thereof receiving such report from Halliburton Company.

Submitted by Doyal Bonds

Date Received 09/03/93

Well No. Lambrith #1 Depth Formation

County Field Source Tank Battery

	Okie Crude Company	E & F Operating	
Resistivity.....	0.0769 @ 75 F	0.0385 @ 75 F	
Specific Gr.....	1.075	1.065	
pH.....	6.7	6.0	
Calcium*.....	6750	4750	
Ca			
Magnesium*.....	nfl	930	
Mg			
Chlorides*.....	52000	45000	
Cl			
Sulfates*.....	1241	1065	
SO ₄			
Bicarbonates*....	555	128	
HCO ₃			
Soluble Iron*....	nfl	50	
Fe			
Sodium Na*	26772	22540	
TDS*	87318	74413	

Remarks:

*Milligrams per liter

Respectfully submitted,

Analyst: JL TUBAK

HALLIBURTON COMPANY

By
CHEMIST

NOTICE

THIS REPORT IS LIMITED TO THE DESCRIBED SAMPLE TESTED. ANY USER OF THIS REPORT AGREES THAT HALLIBURTON SHALL NOT BE LIABLE FOR ANY LOSS OR DAMAGE, WHETHER IT BE TO ACT OR OMISSION, RESULTING FROM SUCH REPORT OR ITS USE.

OKIE CRUDE COMPANY

ATTACHMENT NO. 4