

RECEIVED: <b>06/29/22</b>	REVIEWER: <b>LRL</b>	TYPE: <b>NSL</b>	APP NO:
---------------------------	----------------------	------------------	---------

ABOVE THIS TABLE FOR OCD DIVISION USE ONLY

**NEW MEXICO OIL CONSERVATION DIVISION**  
 - Geological & Engineering Bureau -  
 1220 South St. Francis Drive, Santa Fe, NM 87505

**ADMINISTRATIVE APPLICATION CHECKLIST**

THIS CHECKLIST IS MANDATORY FOR ALL ADMINISTRATIVE APPLICATIONS FOR EXCEPTIONS TO DIVISION RULES AND  
 REGULATIONS WHICH REQUIRE PROCESSING AT THE DIVISION LEVEL IN SANTA FE

**Applicant:** OXY USA INC. (16696) **OGRID Number:** 16696  
**Well Name:** ARKENSTONE 31 FEDERAL COM #010H **API:** 30-015-46323  
**Pool:** PURPLE SAGE WOLFCAMP (GAS)/WC-015 G-08 S233135; WOLFCAMP **Pool Code:** 98220/98236

**SUBMIT ACCURATE AND COMPLETE INFORMATION REQUIRED TO PROCESS THE TYPE OF APPLICATION  
 INDICATED BELOW**

**1) TYPE OF APPLICATION:** Check those which apply for [A]

A. Location – Spacing Unit – Simultaneous Dedication

☒ NSL☐ NSP (PROJECT AREA)☒ NSP (PRORATION UNIT)☐ SD

B. Check one only for [ I ] or [ II ]

[ I ] Commingling – Storage – Measurement

☐ DHC☐ CTB☐ PLC☐ PC☐ OLS☐ OLM

[ II ] Injection – Disposal – Pressure Increase – Enhanced Oil Recovery

☐ WFX☐ PMX☐ SWD☐ IPI☐ EOR☐ PPR**2) NOTIFICATION REQUIRED TO:** Check those which apply.A. ☒ Offset operators or lease holdersB. ☐ Royalty, overriding royalty owners, revenue ownersC. ☐ Application requires published noticeD. ☐ Notification and/or concurrent approval by SLOE. ☒ Notification and/or concurrent approval by BLMF. ☐ Surface ownerG. ☒ For all of the above, proof of notification or publication is attached, and/or,H. ☐ No notice required**FOR OCD ONLY**☐ Notice Complete☐ Application  
Content  
Complete

**3) CERTIFICATION:** I hereby certify that the information submitted with this application for  
 administrative approval is **accurate** and **complete** to the best of my knowledge. I also  
 understand that **no action** will be taken on this application until the required information and  
 notifications are submitted to the Division.

**Note: Statement must be completed by an individual with managerial and/or supervisory capacity.**

LESLIE REEVES

Print or Type Name

6/28/2022

Date

713-497-2492

Phone Number

LESLIE\_REEVES@OXY.COM

e-mail Address

Leslie T. Reeves

Signature



# OXY USA Inc

5 Greenway Plaza, Suite 110  
Houston, TX 77046-0521

June 16, 2022

New Mexico Oil Conservation Division  
1220 South St. Francis Dr.  
Santa Fe, NM 87505

Attention: Leonard Lowe

Re: ***Application for Administrative Approval of Non-Standard Location and Non-Standard Proration  
Arkenstone 31 Federal Com 10H – WC-015 G-08 S233135; Wolfcamp/ Purple Sage Wolfcamp  
Surface – 100' FNL 795' FEL Unit A Sec 31 T23S R31E  
First Take Point – 100' FNL 660' FEL Unit A, Sec 31 T23S R31E  
Last Take Point – 100' FSL 660' FEL Unit P, Sec 7 T24S R31E  
Bottom Hole – 20' FSL 660' FEL Unit P, Sec 7 T24S R31E  
Eddy County, New Mexico***

Dear Mr. Lowe:

OXY USA Inc. respectfully requests administrative approval of a non-standard location on the Arkenstone 31 Federal Com 10H well, API Number-30-015-46323, Property Code 326149. The #10H well is proposed to be completed, partially (Sections 6 & 7) in the Purple Sage Wolfcamp pool, Pool Code 98220, which has special pool rules specifying the completed interval must be located 330 feet from the exterior boundary of the applicable spacing unit. The proposed completed interval is projected as follows:

Surface – 100' FNL 795' FEL Unit A Sec 31 T23S R31E

First Take Point – 100' FNL 660' FEL Unit A, Sec 31 T23S R31E – (WC-015 G-08 S233135; Wolfcamp pool-98236 – Standard Location)

Last Take Point – 100' FSL 660' FEL Unit P, Sec 7 T24S R31E – (Purple Sage Wolfcamp Pool- 98220 – Non-Standard Location)

Bottom Hole – 20' FSL 660' FEL Unit P, Sec 7 T24S R31E

- The adjoining units which the LTP, unorthodox location, encroaches are located to the South in T24S R31E, Section 18 – Units A, B, G and H, which are 100% working interest owned by OXY.

OXY USA Inc. also requests administrative approval of a non-standard proration for the subject well Horizontal Spacing Unit of 480.54-acres. The HSU will include the WC-015 G-08 S233135; Wolfcamp pool in section 31 and the Purple Sage Wolfcamp pool in sections 6 & 7. The larger spacing rules of the two pools is for the purple sage wolfcamp spacing set at 160-acre blocks being the standard. This HSU does not use 160-acre building blocks and only includes tracts in the East ½ of the East ½ of section 31 T23S R31E and sections 6 and 7, T23S R31E. The tracts excluded by creating the NSP, are all 100% OXY owned/operated.

- The excluded tracts in which the NSP is not including: West ½ of the East ½ T23S R31E Section 31, and T24S R31E, Section 6 & 7 – Units B, G, J and O, which are 100% working interest owned by OXY.

Approval of the unorthodox LTP and NSP will allow for efficient spacing of horizontal wells in the wolfcamp formation and thereby prevent waste.

To support this request, the following information has been submitted for your review:

1. C-102 Plat for the proposed well.
2. List of affected offset parties in each adjoining spacing unit in the same pool or formation located closer to the unorthodox well location than the minimum distance prescribed by applicable rule or order, copies of the signed certified return receipts will be furnished upon request.
3. Statement from Oxy Development Area Engineer.

Sincerely,

Leslie Reeves\_Regulatory Manager\_Leslie\_Reeves@oxy.com



**OXY USA Inc**

**5 Greenway Plaza, Suite 110  
Houston, TX 77046-0521**

June 16, 2022

CERTIFIED MAIL – RETURN RECEIPT REQUESTED

Re: *Application for Administrative Approval of Non-Standard Location & Non-Standard Proration  
Arkenstone 31 Federal Com 10H – WC-015 G-08 S233135; Wolfcamp/ Purple Sage Wolfcamp  
Surface – 100' FNL 795' FEL Unit A Sec 31 T23S R31E  
First Take Point – 100' FNL 660' FEL Unit A, Sec 31 T23S R31E  
Last Take Point – 100' FSL 660' FEL Unit P, Sec 7 T24S R31E  
Bottom Hole –20' FSL 660' FEL Unit P, Sec 7 T24S R31E  
Eddy County, New Mexico*

To Whom it May Concern:

Enclosed is a copy of an application, filed with the New Mexico Oil Conservation Division by OXY USA Inc., requesting administrative approval for a non-standard location and non-standard proration unit. As an affected party, notice is being provided to you pursuant to Rule 19.15.4.12(A)(2)(a), 19.15.15.9(A) and 19.15.16.15(B). The well is located as follows:

Surface – 100' FNL 795' FEL Unit A Sec 31 T23S R31E  
First Take Point – 100' FNL 660' FEL Unit A, Sec 31 T23S R31E  
Last Take Point – 100' FSL 660' FEL Unit P, Sec 7 T24S R31E  
Bottom Hole –20' FSL 660' FEL Unit P, Sec 7 T24S R31E

If you object to the well's location, you must notify the Division in writing no later than 20 days from the date the application is received by the NMOCD (1220 South St. Francis Drive, Santa Fe, NM 87505; Attention: Leonard Lowe).

If you need any additional information, you can contact Matt Cole at 713-366-5928 or myself at 713-497-2492.

Thank you,

A handwritten signature in blue ink, appearing to read "Leslie Reeves". The signature is fluid and cursive, with the first name "Leslie" and last name "Reeves" clearly distinguishable.

Leslie Reeves  
Regulatory Manager  
OXY USA Inc.

DISTRICT I  
1625 N. FRENCH DR., HOBBS, NM 88240  
Phone: (575) 393-6161 Fax: (575) 393-0720

DISTRICT II  
811 S. FIRST ST., ARTESIA, NM 88210  
Phone: (575) 746-1283 Fax: (575) 746-9720

DISTRICT III  
1000 RIO BRAZOS RD., AZTEC, NM 87410  
Phone: (505) 334-6178 Fax: (505) 334-6170

DISTRICT IV  
1220 S. ST. FRANCIS DR., SANTA FE, NM 87505  
Phone: (505) 476-3460 Fax: (505) 476-3462

State of New Mexico  
Energy, Minerals & Natural Resources Department  
**OIL CONSERVATION DIVISION**  
1220 SOUTH ST. FRANCIS DR.  
Santa Fe, New Mexico 87505

Form C-102  
Revised August 1, 2011  
Submit one copy to appropriate  
District Office

☒ AMENDED REPORT

**WELL LOCATION AND ACREAGE DEDICATION PLAT**

API Number <b>30-015-46323</b>	Pool Code <b>98236</b>	Pool Name <b>WC-015 G-08 S233135; WOLFCAMP</b>
Property Code <b>326149</b>	Property Name <b>ARKENSTONE 31 FEDERAL COM</b>	Well Number <b>10H</b>
OGRID No. <b>16696</b>	Operator Name <b>OXY USA INC.</b>	Elevation <b>3344.1'</b>

**Surface Location**

UL or lot No.	Section	Township	Range	Lot Idn	Feet from the	North/South line	Feet from the	East/West line	County
A	31	23-S	31-E		100	NORTH	795	EAST	EDDY

**Bottom Hole Location If Different From Surface**

UL or lot No.	Section	Township	Range	Lot Idn	Feet from the	North/South line	Feet from the	East/West line	County
P	7	24 - S	31-E		20	SOUTH	660	EAST	EDDY
Dedicated Acres <b>160</b>	Joint or Infill	Consolidation Code	Order No.						

NO ALLOWABLE WILL BE ASSIGNED TO THIS COMPLETION UNTIL ALL INTERESTS HAVE BEEN CONSOLIDATED  
OR A NON-STANDARD UNIT HAS BEEN APPROVED BY THE DIVISION

<p>NAD 83 NME SURFACE LOCATION Y=461588.9 N X=702805.2 E LAT.=32.267902° N LONG.=103.810928° W</p> <p>NAD83 KOP 50' FNL &amp; 660' FEL Y=461639.5 N X=702939.9 E LAT.=32.268040° N LONG.=103.810492° W</p> <p>NAD83 FTP 100' FNL &amp; 660' FEL Y=461589.5 N X=702940.1 E LAT.=32.267902° N LONG.=103.810492° W</p> <p>NAD83 LTP 100' FSL &amp; 660' FEL Y=445934.0 N X=703006.1 E LAT.=32.224868° N LONG.=103.810525° W</p> <p>NAD 83 NME PROPOSED BOTTOM HOLE LOCATION Y=445854.0 N X=703006.4 E LAT.=32.224648° N LONG.=103.810525° W</p>	<p>LOT 1 41.88 Ac</p> <p>LOT 2 39.62 Ac</p> <p>LOT 3 40.11 Ac</p> <p>LOT 4 42.14 Ac</p> <p>LOT 5 41.97 Ac</p> <p>LOT 6 41.94 Ac</p> <p>LOT 7 41.87 Ac</p> <p>LOT 8 41.82 Ac</p> <p>LOT 9 41.84 Ac</p> <p>LOT 10 41.87 Ac</p> <p>SECTION 31</p> <p>SECTION 6</p> <p>SECTION 7</p> <p>SECTION 8</p> <p>SECTION 9</p> <p>SECTION 10</p> <p>SECTION 11</p> <p>SECTION 12</p> <p>SECTION 13</p> <p>SECTION 14</p> <p>SECTION 15</p> <p>SECTION 16</p> <p>SECTION 17</p> <p>SECTION 18</p> <p>SECTION 19</p> <p>SECTION 20</p> <p>SECTION 21</p> <p>SECTION 22</p> <p>SECTION 23</p> <p>SECTION 24</p> <p>SECTION 25</p> <p>SECTION 26</p> <p>SECTION 27</p> <p>SECTION 28</p> <p>SECTION 29</p> <p>SECTION 30</p> <p>SECTION 31</p> <p>SECTION 32</p> <p>SECTION 33</p> <p>SECTION 34</p> <p>SECTION 35</p> <p>SECTION 36</p> <p>SECTION 37</p> <p>SECTION 38</p> <p>SECTION 39</p> <p>SECTION 40</p> <p>SECTION 41</p> <p>SECTION 42</p> <p>SECTION 43</p> <p>SECTION 44</p> <p>SECTION 45</p> <p>SECTION 46</p> <p>SECTION 47</p> <p>SECTION 48</p> <p>SECTION 49</p> <p>SECTION 50</p> <p>SECTION 51</p> <p>SECTION 52</p> <p>SECTION 53</p> <p>SECTION 54</p> <p>SECTION 55</p> <p>SECTION 56</p> <p>SECTION 57</p> <p>SECTION 58</p> <p>SECTION 59</p> <p>SECTION 60</p> <p>SECTION 61</p> <p>SECTION 62</p> <p>SECTION 63</p> <p>SECTION 64</p> <p>SECTION 65</p> <p>SECTION 66</p> <p>SECTION 67</p> <p>SECTION 68</p> <p>SECTION 69</p> <p>SECTION 70</p> <p>SECTION 71</p> <p>SECTION 72</p> <p>SECTION 73</p> <p>SECTION 74</p> <p>SECTION 75</p> <p>SECTION 76</p> <p>SECTION 77</p> <p>SECTION 78</p> <p>SECTION 79</p> <p>SECTION 80</p> <p>SECTION 81</p> <p>SECTION 82</p> <p>SECTION 83</p> <p>SECTION 84</p> <p>SECTION 85</p> <p>SECTION 86</p> <p>SECTION 87</p> <p>SECTION 88</p> <p>SECTION 89</p> <p>SECTION 90</p> <p>SECTION 91</p> <p>SECTION 92</p> <p>SECTION 93</p> <p>SECTION 94</p> <p>SECTION 95</p> <p>SECTION 96</p> <p>SECTION 97</p> <p>SECTION 98</p> <p>SECTION 99</p> <p>SECTION 100</p> <p>SECTION 101</p> <p>SECTION 102</p> <p>SECTION 103</p> <p>SECTION 104</p> <p>SECTION 105</p> <p>SECTION 106</p> <p>SECTION 107</p> <p>SECTION 108</p> <p>SECTION 109</p> <p>SECTION 110</p> <p>SECTION 111</p> <p>SECTION 112</p> <p>SECTION 113</p> <p>SECTION 114</p> <p>SECTION 115</p> <p>SECTION 116</p> <p>SECTION 117</p> <p>SECTION 118</p> <p>SECTION 119</p> <p>SECTION 120</p> <p>SECTION 121</p> <p>SECTION 122</p> <p>SECTION 123</p> <p>SECTION 124</p> <p>SECTION 125</p> <p>SECTION 126</p> <p>SECTION 127</p> <p>SECTION 128</p> <p>SECTION 129</p> <p>SECTION 130</p> <p>SECTION 131</p> <p>SECTION 132</p> <p>SECTION 133</p> <p>SECTION 134</p> <p>SECTION 135</p> <p>SECTION 136</p> <p>SECTION 137</p> <p>SECTION 138</p> <p>SECTION 139</p> <p>SECTION 140</p> <p>SECTION 141</p> <p>SECTION 142</p> <p>SECTION 143</p> <p>SECTION 144</p> <p>SECTION 145</p> <p>SECTION 146</p> <p>SECTION 147</p> <p>SECTION 148</p> <p>SECTION 149</p> <p>SECTION 150</p> <p>SECTION 151</p> <p>SECTION 152</p> <p>SECTION 153</p> <p>SECTION 154</p> <p>SECTION 155</p> <p>SECTION 156</p> <p>SECTION 157</p> <p>SECTION 158</p> <p>SECTION 159</p> <p>SECTION 160</p> <p>SECTION 161</p> <p>SECTION 162</p> <p>SECTION 163</p> <p>SECTION 164</p> <p>SECTION 165</p> <p>SECTION 166</p> <p>SECTION 167</p> <p>SECTION 168</p> <p>SECTION 169</p> <p>SECTION 170</p> <p>SECTION 171</p> <p>SECTION 172</p> <p>SECTION 173</p> <p>SECTION 174</p> <p>SECTION 175</p> <p>SECTION 176</p> <p>SECTION 177</p> <p>SECTION 178</p> <p>SECTION 179</p> <p>SECTION 180</p> <p>SECTION 181</p> <p>SECTION 182</p> <p>SECTION 183</p> <p>SECTION 184</p> <p>SECTION 185</p> <p>SECTION 186</p> <p>SECTION 187</p> <p>SECTION 188</p> <p>SECTION 189</p> <p>SECTION 190</p> <p>SECTION 191</p> <p>SECTION 192</p> <p>SECTION 193</p> <p>SECTION 194</p> <p>SECTION 195</p> <p>SECTION 196</p> <p>SECTION 197</p> <p>SECTION 198</p> <p>SECTION 199</p> <p>SECTION 200</p> <p>SECTION 201</p> <p>SECTION 202</p> <p>SECTION 203</p> <p>SECTION 204</p> <p>SECTION 205</p> <p>SECTION 206</p> <p>SECTION 207</p> <p>SECTION 208</p> <p>SECTION 209</p> <p>SECTION 210</p> <p>SECTION 211</p> <p>SECTION 212</p> <p>SECTION 213</p> <p>SECTION 214</p> <p>SECTION 215</p> <p>SECTION 216</p> <p>SECTION 217</p> <p>SECTION 218</p> <p>SECTION 219</p> <p>SECTION 220</p> <p>SECTION 221</p> <p>SECTION 222</p> <p>SECTION 223</p> <p>SECTION 224</p> <p>SECTION 225</p> <p>SECTION 226</p> <p>SECTION 227</p> <p>SECTION 228</p> <p>SECTION 229</p> <p>SECTION 230</p> <p>SECTION 231</p> <p>SECTION 232</p> <p>SECTION 233</p> <p>SECTION 234</p> <p>SECTION 235</p> <p>SECTION 236</p> <p>SECTION 237</p> <p>SECTION 238</p> <p>SECTION 239</p> <p>SECTION 240</p> <p>SECTION 241</p> <p>SECTION 242</p> <p>SECTION 243</p> <p>SECTION 244</p> <p>SECTION 245</p> <p>SECTION 246</p> <p>SECTION 247</p> <p>SECTION 248</p> <p>SECTION 249</p> <p>SECTION 250</p> <p>SECTION 251</p> <p>SECTION 252</p> <p>SECTION 253</p> <p>SECTION 254</p> <p>SECTION 255</p> <p>SECTION 256</p> <p>SECTION 257</p> <p>SECTION 258</p> <p>SECTION 259</p> <p>SECTION 260</p> <p>SECTION 261</p> <p>SECTION 262</p> <p>SECTION 263</p> <p>SECTION 264</p> <p>SECTION 265</p> <p>SECTION 266</p> <p>SECTION 267</p> <p>SECTION 268</p> <p>SECTION 269</p> <p>SECTION 270</p> <p>SECTION 271</p> <p>SECTION 272</p> <p>SECTION 273</p> <p>SECTION 274</p> <p>SECTION 275</p> <p>SECTION 276</p> <p>SECTION 277</p> <p>SECTION 278</p> <p>SECTION 279</p> <p>SECTION 280</p> <p>SECTION 281</p> <p>SECTION 282</p> <p>SECTION 283</p> <p>SECTION 284</p> <p>SECTION 285</p> <p>SECTION 286</p> <p>SECTION 287</p> <p>SECTION 288</p> <p>SECTION 289</p> <p>SECTION 290</p> <p>SECTION 291</p> <p>SECTION 292</p> <p>SECTION 293</p> <p>SECTION 294</p> <p>SECTION 295</p> <p>SECTION 296</p> <p>SECTION 297</p> <p>SECTION 298</p> <p>SECTION 299</p> <p>SECTION 300</p> <p>SECTION 301</p> <p>SECTION 302</p> <p>SECTION 303</p> <p>SECTION 304</p> <p>SECTION 305</p> <p>SECTION 306</p> <p>SECTION 307</p> <p>SECTION 308</p> <p>SECTION 309</p> <p>SECTION 310</p> <p>SECTION 311</p> <p>SECTION 312</p> <p>SECTION 313</p> <p>SECTION 314</p> <p>SECTION 315</p> <p>SECTION 316</p> <p>SECTION 317</p> <p>SECTION 318</p> <p>SECTION 319</p> <p>SECTION 320</p> <p>SECTION 321</p> <p>SECTION 322</p> <p>SECTION 323</p> <p>SECTION 324</p> <p>SECTION 325</p> <p>SECTION 326</p> <p>SECTION 327</p> <p>SECTION 328</p> <p>SECTION 329</p> <p>SECTION 330</p> <p>SECTION 331</p> <p>SECTION 332</p> <p>SECTION 333</p> <p>SECTION 334</p> <p>SECTION 335</p> <p>SECTION 336</p> <p>SECTION 337</p> <p>SECTION 338</p> <p>SECTION 339</p> <p>SECTION 340</p> <p>SECTION 341</p> <p>SECTION 342</p> <p>SECTION 343</p> <p>SECTION 344</p> <p>SECTION 345</p> <p>SECTION 346</p> <p>SECTION 347</p> <p>SECTION 348</p> <p>SECTION 349</p> <p>SECTION 350</p> <p>SECTION 351</p> <p>SECTION 352</p> <p>SECTION 353</p> <p>SECTION 354</p> <p>SECTION 355</p> <p>SECTION 356</p> <p>SECTION 357</p> <p>SECTION 358</p> <p>SECTION 359</p> <p>SECTION 360</p> <p>SECTION 361</p> <p>SECTION 362</p> <p>SECTION 363</p> <p>SECTION 364</p> <p>SECTION 365</p> <p>SECTION 366</p> <p>SECTION 367</p> <p>SECTION 368</p> <p>SECTION 369</p> <p>SECTION 370</p> <p>SECTION 371</p> <p>SECTION 372</p> <p>SECTION 373</p> <p>SECTION 374</p> <p>SECTION 375</p> <p>SECTION 376</p> <p>SECTION 377</p> <p>SECTION 378</p> <p>SECTION 379</p> <p>SECTION 380</p> <p>SECTION 381</p> <p>SECTION 382</p> <p>SECTION 383</p> <p>SECTION 384</p> <p>SECTION 385</p> <p>SECTION 386</p> <p>SECTION 387</p> <p>SECTION 388</p> <p>SECTION 389</p> <p>SECTION 390</p> <p>SECTION 391</p> <p>SECTION 392</p> <p>SECTION 393</p> <p>SECTION 394</p> <p>SECTION 395</p> <p>SECTION 396</p> <p>SECTION 397</p> <p>SECTION 398</p> <p>SECTION 399</p> <p>SECTION 400</p> <p>SECTION 401</p> <p>SECTION 402</p> <p>SECTION 403</p> <p>SECTION 404</p> <p>SECTION 405</p> <p>SECTION 406</p> <p>SECTION 407</p> <p>SECTION 408</p> <p>SECTION 409</p> <p>SECTION 410</p> <p>SECTION 411</p> <p>SECTION 412</p> <p>SECTION 413</p> <p>SECTION 414</p> <p>SECTION 415</p> <p>SECTION 416</p> <p>SECTION 417</p> <p>SECTION 418</p> <p>SECTION 419</p> <p>SECTION 420</p> <p>SECTION 421</p> <p>SECTION 422</p> <p>SECTION 423</p> <p>SECTION 424</p> <p>SECTION 425</p> <p>SECTION 426</p> <p>SECTION 427</p> <p>SECTION 428</p> <p>SECTION 429</p> <p>SECTION 430</p> <p>SECTION 431</p> <p>SECTION 432</p> <p>SECTION 433</p> <p>SECTION 434</p> <p>SECTION 435</p> <p>SECTION 436</p> <p>SECTION 437</p> <p>SECTION 438</p> <p>SECTION 439</p> <p>SECTION 440</p> <p>SECTION 441</p> <p>SECTION 442</p> <p>SECTION 443</p> <p>SECTION 444</p> <p>SECTION 445</p> <p>SECTION 446</p> <p>SECTION 447</p> <p>SECTION 448</p> <p>SECTION 449</p> <p>SECTION 450</p> <p>SECTION 451</p> <p>SECTION 452</p> <p>SECTION 453</p> <p>SECTION 454</p> <p>SECTION 455</p> <p>SECTION 456</p> <p>SECTION 457</p> <p>SECTION 458</p> <p>SECTION 459</p> <p>SECTION 460</p> <p>SECTION 461</p> <p>SECTION 462</p> <p>SECTION 463</p> <p>SECTION 464</p> <p>SECTION 465</p> <p>SECTION 466</p> <p>SECTION 467</p> <p>SECTION 468</p> <p>SECTION 469</p> <p>SECTION 470</p> <p>SECTION 471</p> <p>SECTION 472</p> <p>SECTION 473</p> <p>SECTION 474</p> <p>SECTION 475</p> <p>SECTION 476</p> <p>SECTION 477</p> <p>SECTION 478</p> <p>SECTION 479</p> <p>SECTION 480</p> <p>SECTION 481</p> <p>SECTION 482</p> <p>SECTION 483</p> <p>SECTION 484</p> <p>SECTION 485</p> <p>SECTION 486</p> <p>SECTION 487</p> <p>SECTION 488</p> <p>SECTION 489</p> <p>SECTION 490</p> <p>SECTION 491</p> <p>SECTION 492</p> <p>SECTION 493</p> <p>SECTION 494</p> <p>SECTION 495</p> <p>SECTION 496</p> <p>SECTION 497</p> <p>SECTION 498</p> <p>SECTION 499</p> <p>SECTION 500</p> <p>SECTION 501</p> <p>SECTION 502</p> <p>SECTION 503</p> <p>SECTION 504</p> <p>SECTION 505</p> <p>SECTION 506</p> <p>SECTION 507</p> <p>SECTION 508</p> <p>SECTION 509</p> <p>SECTION 510</p> <p>SECTION 511</p> <p>SECTION 512</p> <p>SECTION 513</p> <p>SECTION 514</p> <p>SECTION 515</p> <p>SECTION 516</p> <p>SECTION 517</p> <p>SECTION 518</p> <p>SECTION 519</p> <p>SECTION 520</p> <p>SECTION 521</p> <p>SECTION 522</p> <p>SECTION 523</p> <p>SECTION 524</p> <p>SECTION 525</p> <p>SECTION 526</p> <p>SECTION 527</p> <p>SECTION 528</p> <p>SECTION 529</p> <p>SECTION 530</p> <p>SECTION 531</p> <p>SECTION 532</p> <p>SECTION 533</p> <p>SECTION 534</p> <p>SECTION 535</p> <p>SECTION 536</p> <p>SECTION 537</p> <p>SECTION 538</p> <p>SECTION 539</p> <p>SECTION 540</p> <p>SECTION 541</p> <p>SECTION 542</p> <p>SECTION 543</p> <p>SECTION 544</p> <p>SECTION 545</p> <p>SECTION 546</p> <p>SECTION 547</p> <p>SECTION 548</p> <p>SECTION 549</p> <p>SECTION 550</p> <p>SECTION 551</p> <p>SECTION 552</p> <p>SECTION 553</p> <p>SECTION 554</p> <p>SECTION 555</p> <p>SECTION 556</p> <p>SECTION 557</p> <p>SECTION 558</p> <p>SECTION 559</p> <p>SECTION 560</p> <p>SECTION 561</p> <p>SECTION 562</p> <p>SECTION 563</p> <p>SECTION 564</p> <p>SECTION 565</p> <p>SECTION 566</p> <p>SECTION 567</p> <p>SECTION 568</p> <p>SECTION 569</p> <p>SECTION 570</p> <p>SECTION 571</p> <p>SECTION 572</p> <p>SECTION 573</p> <p>SECTION 574</p> <p>SECTION 575</p> <p>SECTION 576</p> <p>SECTION 577</p> <p>SECTION 578</p> <p>SECTION 579</p> <p>SECTION 580</p> <p>SECTION 581</p> <p>SECTION 582</p> <p>SECTION 583</p> <p>SECTION 584</p> <p>SECTION 585</p> <p>SECTION 586</p> <p>SECTION 587</p> <p>SECTION 588</p> <p>SECTION 589</p> <p>SECTION 590</p> <p>SECTION 591</p> <p>SECTION 592</p> <p>SECTION 593</p> <p>SECTION 594</p> <p>SECTION 595</p> <p>SECTION 596</p> <p>SECTION 597</p> <p>SECTION 598</p> <p>SECTION 599</p> <p>SECTION 600</p> <p>SECTION 601</p> <p>SECTION 602</p> <p>SECTION 603</p> <p>SECTION 604</p> <p>SECTION 605</p> <p>SECTION 606</p> <p>SECTION 607</p> <p>SECTION 608</p> <p>SECTION 609</p> <p>SECTION 610</p> <p>SECTION 611</p> <p>SECTION 612</p> <p>SECTION 613</p> <p>SECTION 614</p> <p>SECTION 615</p> <p>SECTION 616</p> <p>SECTION 617</p> <p>SECTION 618</p> <p>SECTION 619</p> <p>SECTION 620</p> <p>SECTION 621</p> <p>SECTION 622</p> <p>SECTION 623</p> <p>SECTION 624</p> <p>SECTION 625</p> <p>SECTION 626</p> <p>SECTION 627</p> <p>SECTION 628</p> <p>SECTION 629</p> <p>SECTION 630</p> <p>SECTION 631</p> <p>SECTION 632</p> <p>SECTION 633</p> <p>SECTION 634</p> <p>SECTION 635</p> <p>SECTION 636</p> <p>SECTION 637</p> <p>SECTION 638</p> <p>SECTION 639</p> <p>SECTION 640</p> <p>SECTION 641</p> <p>SECTION 642</p> <p>SECTION 643</p> <p>SECTION 644</p> <p>SECTION 645</p> <p>SECTION 646</p> <p>SECTION 647</p> <p>SECTION 648</p> <p>SECTION 649</p> <p>SECTION 650</p> <p>SECTION 651</p> <p>SECTION 652</p> <p>SECTION 653</p> <p>SECTION 654</p> <p>SECTION 655</p> <p>SECTION 656</p> <p>SECTION 657</p> <p>SECTION 658</p> <p>SECTION 659</p> <p>SECTION 660</p> <p>SECTION 661</p> <p>SECTION 662</p> <p>SECTION 663</p> <p>SECTION 664</p> <p>SECTION 665</p> <p>SECTION 666</p> <p>SECTION 667</p> <p>SECTION 668</p> <p>SECTION 669</p> <p>SECTION 670</p> <p>SECTION 671</p> <p>SECTION 672</p> <p>SECTION 673</p> <p>SECTION 674</p> <p>SECTION 675</p> <p>SECTION 676</p> <p>SECTION 677</p> <p>SECTION 678</p> <p>SECTION 679</p> <p>SECTION 680</p> <p>SECTION 681</p> <p>SECTION 682</p> <p>SECTION 683</p> <p>SECTION 684</p> <p>SECTION 685</p> <p>SECTION 686</p> <p>SECTION 687</p> <p>SECTION 688</p> <p>SECTION 689</p> <p>SECTION 690</p> <p>SECTION 691</p> <p>SECTION 692</p> <p>SECTION 693</p> <p>SECTION 694</p> <p>SECTION 695</p> <p>SECTION 696</p> <p>SECTION 697</p> <p>SECTION 698</p> <p>SECTION 699</p> <p>SECTION 700</p> <p>SECTION 701</p> <p>SECTION 702</p> <p>SECTION 703</p> <p>SECTION 704</p> <p>SECTION 705</p> <p>SECTION 706</p> <p>SECTION 707</p> <p>SECTION 708</p> <p>SECTION 709</p> <p>SECTION 710</p> <p>SECTION 711</p> <p>SECTION 712</p> <p>SECTION 713</p> <p>SECTION 714</p> <p>SECTION 715</p> <p>SECTION 716</p> <p>SECTION 717</p> <p>SECTION 718</p> <p>SECTION 719</p> <p>SECTION 720</p> <p>SECTION 721</p> <p>SECTION 722</p> <p>SECTION 723</p> <p>SECTION 724</p> <p>SECTION 725</p> <p>SECTION 726</p> <p>SECTION 727</p> <p>SECTION 728</p> <p>SECTION 729</p> <p>SECTION 730</p> <p>SECTION 731</p> <p>SECTION 732</p> <p>SECTION 733</p> <p>SECTION 734</p> <p>SECTION 735</p> <p>SECTION 736</p> <p>SECTION 737</p> <p>SECTION 738</p> <p>SECTION 739</p> <p>SECTION 740</p> <p>SECTION 741</p> <p>SECTION 742</p> <p>SECTION 743</p> <p>SECTION 744</p> <p>SECTION 745</p> <p>SECTION 746</p> <p>SECTION 747</p> <p>SECTION 748</p> <p>SECTION 749</p> <p>SECTION 750</p> <p>SECTION 751</p> <p>SECTION 752</p> <p>SECTION 753</p> <p>SECTION 754</p> <p>SECTION 755</p> <p>SECTION 756</p> <p>SECTION 757</p> <p>SECTION 758</p> <p>SECTION 759</p> <p>SECTION 760</p> <p>SECTION 761</p> <p>SECTION 762</p> <p>SECTION 763</p> <p>SECTION 764</p> <p>SECTION 765</p> <p>SECTION 766</p> <p>SECTION 767</p> <p>SECTION 768</p> <p>SECTION 769</p> <p>SECTION 770</p> <p>SECTION 771</p> <p>SECTION 772</p> <p>SECTION 773</p> <p>SECTION 774</p> <p>SECTION 775</p> <p>SECTION 776</p> <p>SECTION 777</p> <p>SECTION 778</p> <p>SECTION 779</p> <p>SECTION 780</p> <p>SECTION 781</p> <p>SECTION 782</p> <p>SECTION 783</p> <p>SECTION 784</p> <p>SECTION 785</p> <p>SECTION 786</p> <p>SECTION 787</p> <p>SECTION 788</p> <p>SECTION 789</p> <p>SECTION 790</p> <p>SECTION 791</p> <p>SECTION 792</p> <p>SECTION 793</p> <p>SECTION 794</p> <p>SECTION 795</p> <p>SECTION 796</p> <p>SECTION 797</p> <p>SECTION 798</p> <p>SECTION 799</p> <p>SECTION 800</p> <p>SECTION 801</p> <p>SECTION 802</p> <p>SECTION 803</p> <p>SECTION 804</p> <p>SECTION 805</p> <p>SECTION 806</p> <p>SECTION 807</p> <p>SECTION 808</p> <p>SECTION 809</p> <p>SECTION 810</p> <p>SECTION 811</p> <p>SECTION 812</p> <p>SECTION 813</p> <p>SECTION 814</p> <p>SECTION 815</p> <p>SECTION 816</p> <p>SECTION 817</p> <p>SECTION 818</p> <p>SECTION 819</p> <p>SECTION 820</p> <p>SECTION 821</p> <p>SECTION 822</p> <p>SECTION 823</p> <p>SECTION 824</p> <p>SECTION 825</p> <p>SECTION 826</p> <p>SECTION 827</p> <p>SECTION 828</p> <p>SECTION 829</p> <p>SECTION 830</p> <p>SECTION 831</p> <p>SECTION 832</p> <p>SECTION 833</p> <p>SECTION 834</p> <p>SECTION 835</p> <p>SECTION 836</p> <p>SECTION 837</p> <p>SECTION 838</p> <p>SECTION 839</p> <p>SECTION 840</p> <p>SECTION 841</p> <p>SECTION 842</p> <p>SECTION 843</p> <p>SECTION 844</p> <p>SECTION 845</p> <p>SECTION 846</p> <p>SECTION 847</p> <p>SECTION 848</p> <p>SECTION 849</p> <p>SECTION 850</p> <p>SECTION 851</p> <p>SECTION 852</p> <p>SECTION 853</p> <p>SECTION 854</p> <p>SECTION 855</p> <p>SECTION 856</p> <p>SECTION 857</p> <p>SECTION 858</p> <p>SECTION 859</p> <p>SECTION 860</p> <p>SECTION 861</p> <p>SECTION 862</p> <p>SECTION 863</p> <p>SECTION 864</p> <p>SECTION 865</p> <p>SECTION 866</p> <p>SECTION 867</p> <p>SECTION 868</p> <p>SECTION 869</p> <p>SECTION 870</p> <p>SECTION 871</p> <p>SECTION 872</p> <p>SECTION 873</p> <p>SECTION 874</p> <p>SECTION 875</p> <p>SECTION 876</p> <p>SECTION 877</p> <p>SECTION 878</p> <p>SECTION 879</p> <p>SECTION 880</p> <p>SECTION 881</p> <p>SECTION 882</p> <p>SECTION 883</p> <p>SECTION 884</p> <p>SECTION 885</p> <p>SECTION 886</p> <p>SECTION 887</p> <p>SECTION 888</p> <p>SECTION 889</p> <p>SECTION 890</p> <p>SECTION 891</p> <p>SECTION 892</p> <p>SECTION 893</p> <p>SECTION 894</p> <p>SECTION 895</p> <p>SECTION 896</p> <p>SECTION 897</p> <p>SECTION 898</p> <p>SECTION 899</p> <p>SECTION 900</p> <p>SECTION 901</p> <p>SECTION 902</p> <p>SECTION 903</p> <p>SECTION 904</p> <p>SECTION 905</p> <p>SECTION 906</p> <p>SECTION 907</p> <p>SECTION 908</p> <p>SECTION 909</p> <p>SECTION 910</p> <p>SECTION 911</p> <p>SECTION 912</p> <p>SECTION 913</p> <p>SECTION 914</p> <p>SECTION 915</p> <p>SECTION 916</p> <p>SECTION 917</p> <p>SECTION 918</p> <p>SECTION 919</p> <p>SECTION 920</p> <p>SECTION 921</p> <p>SECTION 922</p> <p>SECTION 923</p> <p>SECTION 924</p> <p>SECTION 925</p> <p>SECTION 926</p> <p>SECTION 927</p> <p>SECTION 928</p> <p>SECTION 929</p> <p>SECTION 930</p> <p>SECTION 931</p> <p>SECTION 932</p> <p>SECTION 933</p> <p>SECTION 934</p> <p>SECTION 935</p> <p>SECTION 936</p> <p>SECTION 937</p> <p>SECTION 938</p> <p>SECTION 939</p> <p>SECTION 940</p> <p>SECTION 941</p> <p>SECTION 942</p> <p>SECTION 943</p> <p>SECTION 944</p> <p>SECTION 945</p> <p>SECTION 946</p> <p>SECTION 947</p> <p>SECTION 948</p> <p>SECTION 949</p> <p>SECTION 950</p> <p>SECTION 951</p> <p>SECTION 952</p> <p>SECTION 953</p> <p>SECTION 954</p> <p>SECTION 955</p> <p>SECTION 956</p> <p>SECTION 957</p> <p>SECTION 958</p> <p>SECTION 959</p> <p>SECTION 960</p> <p>SECTION 961</p> <p>SECTION 962</p> <p>SECTION 963</p> <p>SECTION 964</p> <p>SECTION 965</p> <p>SECTION 966</p> <p>SECTION 967</p> <p>SECTION 968</p> <p>SECTION 969</p> <p>SECTION 970</p> <p>SECTION 971</p> <p>SECTION 972</p> <p>SECTION 973</p> <p>SECTION 974</p> <p>SECTION 975</p> <p>SECTION 976</p> <p>SECTION 977</p> <p>SECTION 978</p> <p>SECTION 979</p> <p>SECTION 980</p> <p>SECTION 981</p> <p>SECTION 982</p> <p>SECTION 983</p> <p>SECTION 984</p> <p>SECTION 985</p> <p>SECTION 986</p> <p>SECTION 987</p> <p>SECTION 988</p> <p>SECTION 989</p> <p>SECTION 990</p> <p>SECTION 991</p> <p>SECTION 992</p> <p>SECTION 993</p> <p>SECTION 994</p> <p>SECTION 995</p> <p>SECTION 996</p> <p>SECTION 997</p> <p>SECTION 998</p> <p>SECTION 999</p> <p>SECTION 1000</p> <p>SECTION 1001</p> <p>SECTION 1002</p> <p>SECTION 1003</p> <p>SECTION 1004</p> <p>SECTION 1005</p> <p>SECTION 1006</p> <p>SECTION 1007</p> <p>SECTION 1008</p> <p>SECTION 1009</p> <p>SECTION 1010</p> <p>SECTION 1011</p> <p>SECTION 1012</p> <p>SECTION 1013</p> <p>SECTION 1014</p> <p>SECTION 1015</p> <p>SECTION 1016</p> <p>SECTION 1017</p> <p>SECTION 1018</p> <p>SECTION 1019</p> <p>SECTION 1020</p> <p>SECTION 1021</p> <p>SECTION 1022</p> <p>SECTION 1023</p> <p>SECTION 1024</p> <p>SECTION 1025</p> <p>SECTION 1026</p> <p>SECTION 1027</p> <p>SECTION 1028</p> <p>SECTION 1029</p> <p>SECTION 1030</p> <p>SECTION 1031</p> <p>SECTION 1032</p> <p>SECTION 1033</p> <p>SECTION 1034</p> <p>SECTION 1035</p> <p>SECTION 1036</p> <p>SECTION 1037</p> <p>SECTION 1038</p> <p>SECTION 1039</p> <p>SECTION 1040</p> <p>SECTION 1041</p> <p>SECTION 10</p>
--	--

DISTRICT I  
1625 N. FRENCH DR., HOBBS, NM 88240  
Phone: (575) 393-6161 Fax: (575) 393-0720

DISTRICT II  
811 S. FIRST ST., ARTESIA, NM 88210  
Phone: (575) 746-1283 Fax: (575) 746-9720

DISTRICT III  
1000 RIO BRAZOS RD., AZTEC, NM 87410  
Phone: (505) 334-6178 Fax: (505) 334-6170

DISTRICT IV  
1220 S. ST. FRANCIS DR., SANTA FE, NM 87505  
Phone: (505) 476-3460 Fax: (505) 476-3462

State of New Mexico  
Energy, Minerals & Natural Resources Department  
**OIL CONSERVATION DIVISION**  
1220 SOUTH ST. FRANCIS DR.  
Santa Fe, New Mexico 87505

Form C-102  
Revised August 1, 2011  
Submit one copy to appropriate  
District Office

☒ AMENDED REPORT

WELL LOCATION AND ACREAGE DEDICATION PLAT

API Number <b>30-015-46323</b>	Pool Code <b>98220</b>	Pool Name <b>PURPLE SAGE WOLFCAMP</b>
Property Code <b>326149</b>	Property Name <b>ARKENSTONE 31 FEDERAL COM</b>	Well Number <b>10H</b>
OGRID No. <b>16696</b>	Operator Name <b>OXY USA INC.</b>	Elevation <b>3344.1'</b>

Surface Location

UL or lot No.	Section	Township	Range	Lot Idn	Feet from the	North/South line	Feet from the	East/West line	County
A	31	23-S	31-E		100	NORTH	795	EAST	EDDY

Bottom Hole Location If Different From Surface

UL or lot No.	Section	Township	Range	Lot Idn	Feet from the	North/South line	Feet from the	East/West line	County
P	7	24-S	31-E		20	SOUTH	660	EAST	EDDY
Dedicated Acres <b>320.54</b>	Joint or Infill	Consolidation Code	Order No.						

NO ALLOWABLE WILL BE ASSIGNED TO THIS COMPLETION UNTIL ALL INTERESTS HAVE BEEN CONSOLIDATED  
OR A NON-STANDARD UNIT HAS BEEN APPROVED BY THE DIVISION

<p>NAD 83 NME SURFACE LOCATION Y=461588.9 N X=702805.2 E LAT.=32.267902° N LONG.=103.810928° W</p> <p>NAD83 KOP 50' FNL &amp; 660' FEL Y=461639.5 N X=702939.9 E LAT.=32.268040° N LONG.=103.810492° W</p> <p>NAD83 FTP 100' FNL &amp; 660' FEL Y=461589.5 N X=702940.1 E LAT.=32.267902° N LONG.=103.810492° W</p>	<p>LOT 1 41.88 Ac</p> <p>LOT 2 39.62 Ac</p> <p>LOT 3 40.11 Ac</p> <p>LOT 4 42.14 Ac</p> <p>LOT 5 41.97 Ac</p> <p>LOT 6 41.94 Ac</p> <p>LOT 7 41.87 Ac</p> <p>LOT 8 41.82 Ac</p> <p>LOT 9 41.84 Ac</p> <p>LOT 10 41.87 Ac</p>	<p>NAD 27 NME SURFACE LOCATION Y=461529.6 N X=661621.7 E LAT.=32.267779° N LONG.=103.810442° W</p> <p>NAD27 KOP 50' FNL &amp; 660' FEL Y=461580.2 N X=661756.4 E LAT.=32.267977° N LONG.=103.810005° W</p> <p>NAD27 FTP 100' FNL &amp; 660' FEL Y=461530.2 N X=661756.6 E LAT.=32.267779° N LONG.=103.810006° W</p>	<p><b>OPERATOR CERTIFICATION</b></p> <p>I hereby certify that the information herein is true and complete to the best of my knowledge and belief, and that this organization either owns a working interest or unleased mineral interest in the land including the proposed bottom hole location or has a right to drill this well at this location pursuant to a contract with an owner of such mineral or working interest, or to a voluntary pooling agreement or a compulsory pooling order heretofore entered by the division.</p> <p><i>Leslie T. Reeves</i> 6/13/2022</p> <p>Signature Date</p> <p><b>LESLIE REEVES</b></p> <p>Printed Name</p> <p><b>LESLIE_REEVES@OXY.COM</b></p> <p>E-mail Address</p>
<p>NAD83 LTP 100' FSL &amp; 660' FEL Y=445934.0 N X=703006.1 E LAT.=32.224868° N LONG.=103.810525° W</p> <p>NAD 83 NME PROPOSED BOTTOM HOLE LOCATION Y=445854.0 N X=703006.4 E LAT.=32.224648° N LONG.=103.810525° W</p>	<p>LOT 1 41.80 Ac</p> <p>LOT 2 41.82 Ac</p> <p>LOT 3 41.84 Ac</p> <p>LOT 4 41.87 Ac</p>	<p>NAD27 LTP 100' FSL &amp; 660' FEL Y=445875.1 N X=661822.0 E LAT.=32.224744° N LONG.=103.810041° W</p> <p>NAD 27 NME PROPOSED BOTTOM HOLE LOCATION Y=445795.1 N X=661822.4 E LAT.=32.224524° N LONG.=103.810041° W</p>	<p><b>SURVEYOR CERTIFICATION</b></p> <p>I hereby certify that the well location shown on this plat was plotted from field notes of actual surveys made by me or under my supervision, and that the same is true and correct to the best of my belief.</p> <p>SEPTEMBER 11, 2018</p> <p>Date of Survey</p> <p>Signature &amp; Seal of Professional Surveyor</p> <p><i>Chad L. Harcrow</i> 6/6/22</p> <p>Certificate No. CHAD HARCROW 17777</p> <p>W.O. # 22-540 DRAWN BY: AH</p>

Intent ☒ As Drilled ☐

API # <b>30-015-46323</b>								
Operator Name: <b>OXY USA Inc.</b>			Property Name: <b>ARKENSTONE 31 FEDERAL COM</b>			Well Number <b>10H</b>		

Kick Off Point (KOP)

UL <b>A</b>	Section <b>31</b>	Township <b>23S</b>	Range <b>31E</b>	Lot	Feet <b>50</b>	From N/S <b>FNL</b>	Feet <b>660</b>	From E/W <b>FEL</b>	County <b>EDDY</b>
Latitude <b>32.268040</b>					Longitude <b>-103.810492</b>				NAD <b>NAD83</b>

First Take Point (FTP)

UL <b>A</b>	Section <b>31</b>	Township <b>23S</b>	Range <b>31E</b>	Lot	Feet <b>100</b>	From N/S <b>FNL</b>	Feet <b>660</b>	From E/W <b>FEL</b>	County <b>EDDY</b>
Latitude <b>32.267902</b>					Longitude <b>-103.810492</b>				NAD <b>NAD83</b>

Last Take Point (LTP)

UL <b>P</b>	Section <b>7</b>	Township <b>24S</b>	Range <b>31E</b>	Lot	Feet <b>100</b>	From N/S <b>FSL</b>	Feet <b>660</b>	From E/W <b>FEL</b>	County <b>EDDY</b>
Latitude <b>32.224868</b>					Longitude <b>-103.810525</b>				NAD <b>NAD83</b>

Is this well the defining well for the Horizontal Spacing Unit? ☒

Is this well an infill well? ☐

If infill is yes please provide API if available, Operator Name and well number for Defining well for Horizontal Spacing Unit.

API #								
Operator Name:			Property Name:			Well Number		

KZ 06/29/2018



OXY USA Inc.  
Arkenstone 31 Federal Com #10H  
Non Standard Location Plat – LTP Only  
Section 31 Township 23 South, Range 31  
East, N.M.P.M.

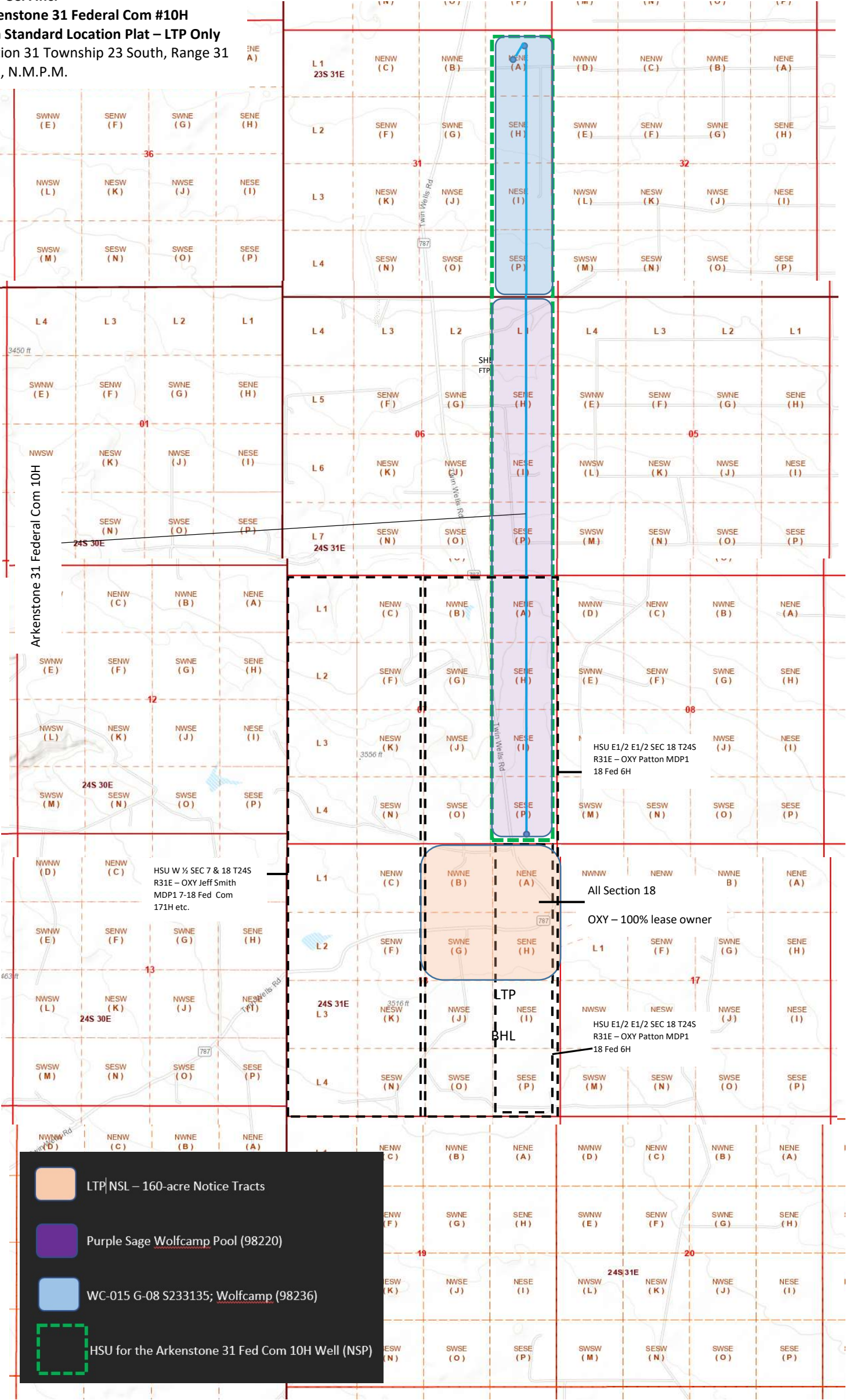



**OXY USA INC.**

A subsidiary of Occidental Petroleum Corporation

5 Greenway Plaza, Suite 110, Houston, Texas 77046  
P.O. Box 4294, Houston, Texas 77210-4294

June 28, 2022

**Re: Arkenstone 31 Federal Com 10H**

**Section 31, T23S R31E, Eddy County**

**Section 6, T24S, R31E, Eddy County**

**Section 7, T24S, R31E, Eddy County**

To Whom It May Concern:

OXY USA INC., OXY Y-1 Company and Occidental Permian Limited Partnership, all subsidiaries of Occidental Petroleum Corporation, are the sole Working Interest Owners of Section 18, T24S, R31E as to depths below the Bone Spring Formation. If you have any questions, please contact me at the number listed below.

Best Regards,

**OXY USA INC.**

A handwritten signature in dark ink, appearing to read "Matt Cole". The signature is fluid and cursive, with the first name "Matt" and last name "Cole" clearly distinguishable.

Matt Cole  
Land Negotiator  
713-366-5928



OXY USA Inc.  
Arkenstone 31 Federal Com #10H  
Non-Standard Proration - Plat  
Section 31 Township 23 South,  
Range 31 East, N.M.P.M.

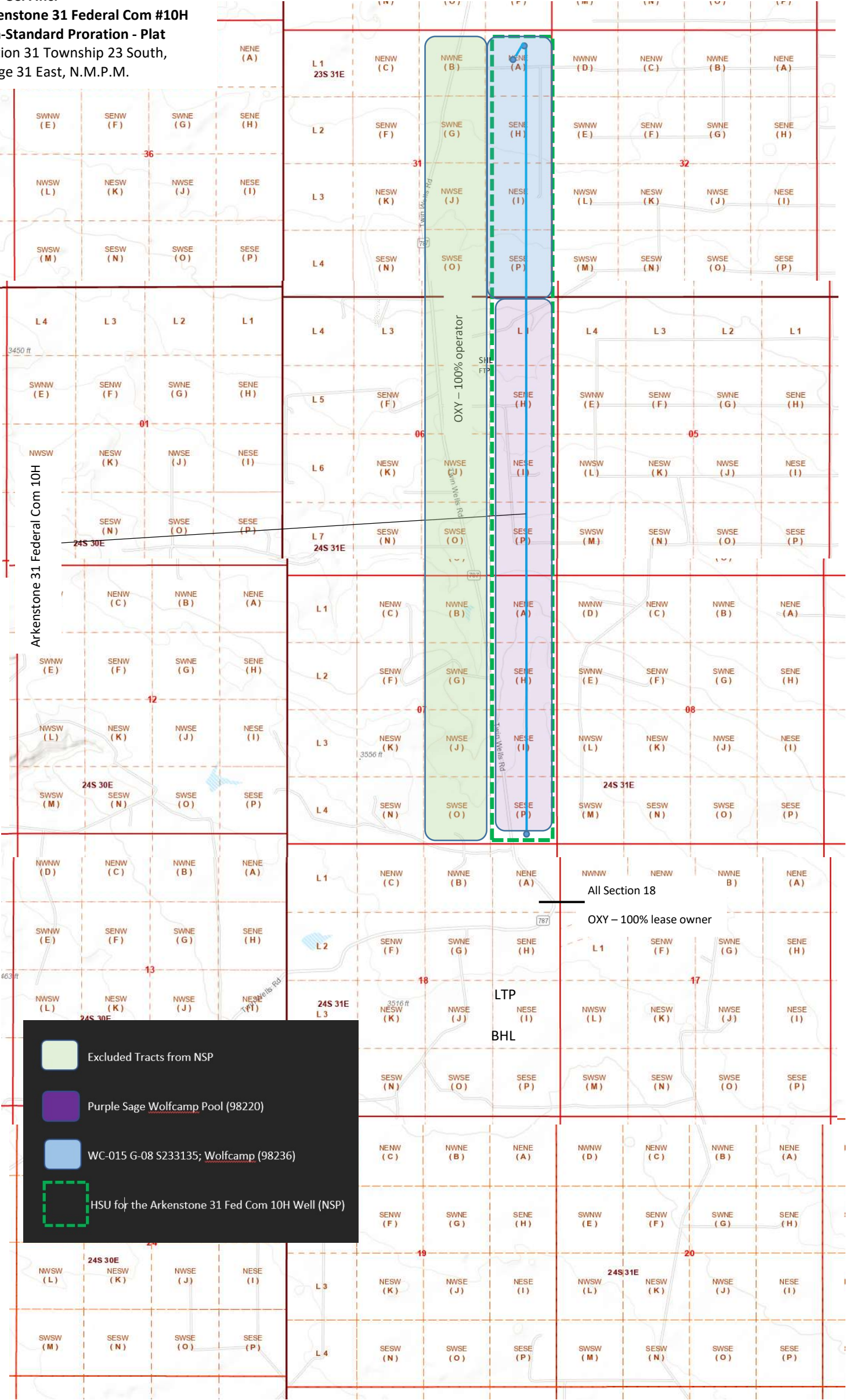



**OXY USA INC.**

A subsidiary of Occidental Petroleum Corporation

5 Greenway Plaza, Suite 110, Houston, Texas 77046  
P.O. Box 4294, Houston, Texas 77210-4294

June 28, 2022

**Re: Arkenstone 31 Federal Com 10H**

**Section 31, T23S R31E, Eddy County**

**Section 6, T24S, R31E, Eddy County**

**Section 7, T24S, R31E, Eddy County**

To Whom It May Concern:

OXY USA INC., OXY Y-1 Company and Occidental Permian Limited Partnership, all subsidiaries of Occidental Petroleum Corporation, are the sole Working Interest Owners in the W/2E/2 of the above described sections as to depths below the Bone Spring Formation. If you have any questions, please contact me at the number listed below.

Best Regards,

**OXY USA INC.**

A handwritten signature in dark ink, appearing to read "Matt Cole". The signature is fluid and cursive, with the first name "Matt" and last name "Cole" clearly distinguishable.

Matt Cole  
Land Negotiator  
713-366-5928



**Occidental Oil and Gas Corporation**  
**ATTN: Pablo Cabal**  
**5 Greenway Plaza, Suite 110**  
**Houston, TX 77046**  
**713-215-7433**  
**pablo\_cabal@oxy.com**

June 28, 2022

Mr. Leonard Lowe  
New Mexico Oil Conservation Division  
1220 South Francis Drive  
Santa Fe, New Mexico 87505

RE: *Application for Nonstandard Location & Nonstandard Proration—Engineering Justification*  
*OXY USA Inc.*  
*Arkenstone 31 Federal Com #10H*  
*T23S R 31E, Section 31 & T24S R31E, Section 6 & 7 – East 1/2 of East 1/2, Eddy County*

Dear Mr. Lowe:

Oxy USA Inc. respectfully seeks approval for a non-standard location, decreasing the last take point for Arkenstone 31 Federal Com 10H in the Wolfcamp formation of the Purple Sage Pool from 330 feet to 100 feet. It is Oxy's responsibility as a prudent operator to maximize lateral length and minimize reserves left in the ground. Decreasing the last take point will increase this well's effective lateral length by 230 feet and increase the estimated ultimate recovery of the well by approximately 1.5%. Any increase in first or last take point would result in untapped reserves left in the reservoir, and waste of a resource that would otherwise go undeveloped.

Sincerely,

A handwritten signature in blue ink, appearing to read "P. Cabal", is placed over a light gray rectangular background.

Pablo Cabal  
Development Engineer

**Application Non-Standard Location - Service List**  
**OXY USA Inc.**  
**Arkenstone 31 Federal Com 10H**

**Online Submission**

New Mexico Oil Conservation Division  
1220 South St. Francis Dr.  
Santa Fe, NM 87505

**Certified Mail #7019 0700 0000 0995 4656**

Bureau of Land Management Carlsbad  
620 E. Greene Street  
Carlsbad, NM 88220-6292

**Offset Tracts Section 18 (T24S-R31E) - Units A, B, G, H,**  
**100% Working Interest Owner**

OXY USA Inc.  
5 Greenway Plaza, Suite 110  
Houston, Texas 77046-0521

**Excluded NSP Tracts Section 31 (T23S-R31E) - Units B, G, J, O,**  
**Section 6 & 7 (T24S-R31E) - Units B, G, J, O,**  
**100% Working Interest Owner**

OXY USA Inc.  
5 Greenway Plaza, Suite 110  
Houston, Texas 77046-0521

Copies of this application were mailed to the following individuals, companies and organizations  
on or before June 29, 2022



---

Leslie Reeves, Regulatory Manager  
OXY USA Inc.