

INITIAL C-141

District I
1625 N. French Dr., Hobbs, NM 88240
District II
1301 W Grand Avenue, Artesia, NM 88210
District III
1000 Rio Brazos Road, Aztec, NM 87410
District IV
1220 S St. Francis Dr., Santa Fe, NM 87505

State of New Mexico
Energy Minerals and Natural Resources

Oil Conservation Division
1220 South St. Francis Dr.
Santa Fe, NM 87505

Form C-141
Revised October 10, 2003

Submit 2 Copies to appropriate
District Office in accordance
with Rule 116 on back
side of form

2009-008

Release Notification and Corrective Action

OPERATOR

☒ Initial Report

☐ Final Report

Name of Company	Southern Union Gas Services, Ltd.	Contact	Tony Savoie
Address	P.O. Box 1226 Jal, N.M. 88252	Telephone No.	505-395-2116
Facility Name	Lea County Field Dept.	Facility Type	Natural Gas Gathering

Surface Owner: Millard Deck	Mineral Owner: State	Lease No.
-----------------------------	----------------------	-----------

LOCATION OF RELEASE ^{NARREY WELL} API # 30-025-39231-00-00

Unit Letter	Section	Township	Range	Feet from the	North/South Line	Feet from the	East/West Line	County
O	15	21S	37E					Lea

Latitude N32 28.326 Longitude W103 9.077

NATURE OF RELEASE

Type of Release : Crude Oil, and Natural Gas	Volume of Release: Greater than 50 MCF gas Greater than 5 bbls crude oil	Volume Recovered NONE
Source of Release : 10" Natural Gas Pipeline	Date and Hour of Occurrence not known	Date and Hour of Discovery 1/7/09 9:07 a.m.
Was Immediate Notice Given? <input type="checkbox"/> Yes <input checked="" type="checkbox"/> No <input type="checkbox"/> Not Required	If YES, To Whom?	
By Whom? Tony Savoie	Date and Hour:	
Was a Watercourse Reached? <input type="checkbox"/> Yes <input checked="" type="checkbox"/> No	If YES, Volume Impacting the Watercourse.	

If a Watercourse was Impacted, Describe Fully.*

Describe Cause of Problem and Remedial Action Taken.*

The 10" Natural gas pipeline developed a leak prior to the discovery date of 2/26/09. The leak area had been excavated and 3 temporary leak clamps had been installed on the pipeline. There were no fluids standing or gas leaking upon discovery. There were 2 areas noted during the discovery that were oil stained. One area measured approximately 10 ft. X 18 ft. and the other measured approximately 40 ft. X 20 ft.

Describe Area Affected and Cleanup Action Taken. Approximately 1340 sq.ft. of pasture land was affected by the leak and temporary repair. Final remediation will follow the NMOCD recommended guidelines for leaks and spills.

I hereby certify that the information given above is true and complete to the best of my knowledge and understand that pursuant to NMOCD rules and regulations all operators are required to report and/or file certain release notifications and perform corrective actions for releases which may endanger public health or the environment. The acceptance of a C-141 report by the NMOCD marked as "Final Report" does not relieve the operator of liability should their operations have failed to adequately investigate and remediate contamination that pose a threat to ground water, surface water, human health or the environment. In addition, NMOCD acceptance of a C-141 report does not relieve the operator of responsibility for compliance with any other federal, state, or local laws and/or regulations.

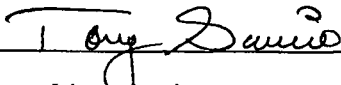
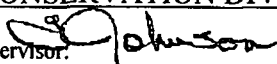
Signature: 		OIL CONSERVATION DIVISION	
Printed Name: John A. Savoie		Approved by District Supervisor: 	
Title: Remediation Supervisor		ENVIRONMENTAL ENGINEER	
E-mail Address: tony.savoie@sug.com		Approval Date: 3.24.09	Expiration Date: 5.24.09
Date: 3/23/09 Phone: 505-395-2116		Conditions of Approval:	Attached <input type="checkbox"/> IRP# 09.5.2165

* Attach Additional Sheets If Necessary

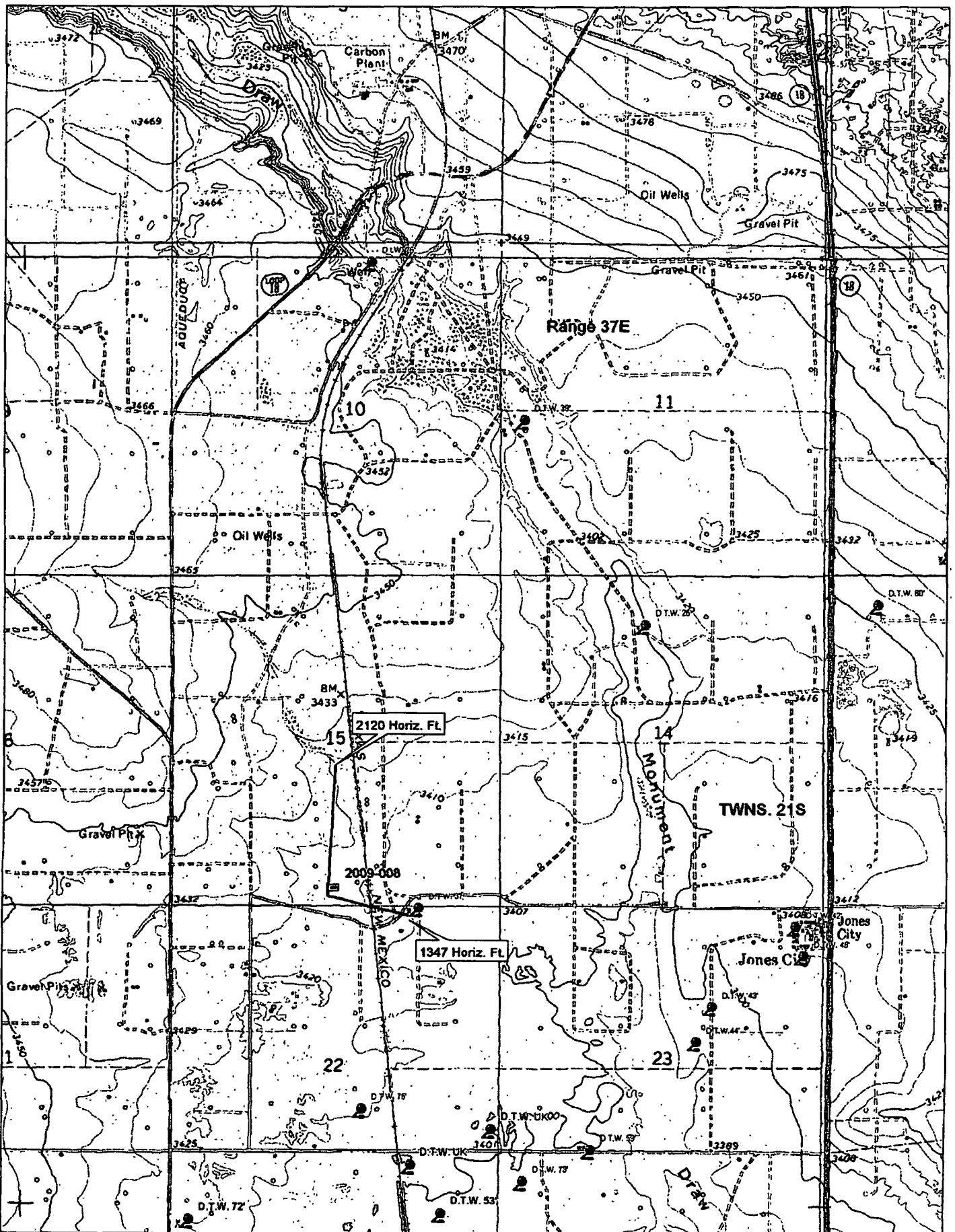

© 2002 DeLorme. 3-D TopoQuads®. Data copyright of content owner.
www.delorme.com

Scale 1 : 25,000
1" = 2080 ft

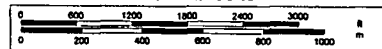

L-5 to MF

Job # 2009-008

Ranking Analysis

NMOCD Standards			Points
Depth to Ground Water	Greater than 100 ft.		0
Depth to Ground Water	Less than 100 ft. but greater than 50 ft.		10
Depth to Ground Water	Less than 50 ft.		20
Well Head Protection	Less than 1000 ft. from a water source, or,	Yes	20
	Less than 200 ft. from private domestic water source	No	0
Distance to Surface water body	Less than 200 Horizontal. ft.		20
Distance to Surface water body	200 to 1000 Horizontal ft.		10
Distance to Surface water body	Greater than 1000 Horizontal ft.		0
Action levels	>19	10-19	0-9
Benzene (mg/kg)	10	10	10
BTEX (mg/kg)	50	50	50
TPH (mg/kg)	100	1000	5000

Site Ranking			Points
Depth to Ground Water	Less than 50 ft.		20
Well Head Protection	1347 Horiz. Ft.		0
Surface Water Body	2120 Horiz. Ft.		0
Total Ranking Score			20

Site Closure Objective	
Benzene (mg/kg)	10
BTEX (mg/kg)	50
TPH (mg/kg)	Delineation 100mg/kg Backfill 100 mg/kg
Chloride (mg/kg)	Delineation 250mg/kg Backfill 500 mg/kg

Remediation Plan:

All affected soil will be excavated and sampled for the presence of Hydrocarbons EPA method (8015M) and Chlorides method 4500-Cl-B or 300 S
Soil with TPH values greater than 100 mg/kg will be transported to the S.U.G.S. Landfarm
Soil with Chloride values greater than 1000 mg/kg will be disposed of in an approved facility
Soil with Chloride value less than 1000 mg/kg but greater than 250 mg/kg will be transported to the S.U.G.S. Landfarm.
Soil samples will be collected from the excavation and analyzed for Hydrocarbons EPA method (8015M) and Chlorides method 4500-Cl-B or 300 S
All samples will be field screened with a "PID" The soil sample with the highest PID reading will be analyzed separately and tested for BTEX.

