

DATE 1/22/02	SUSPENSE 2/11/02	ENGINEER MS	LOGGED IN KW	TYPE NSL	APP NO. 202435151
--------------	------------------	-------------	--------------	----------	-------------------

ABOVE THIS LINE FOR DIVISION USE ONLY

NEW MEXICO OIL CONSERVATION DIVISION
 - Engineering Bureau -
 1220 South St. Francis Drive, Santa Fe, NM 87505

ADMINISTRATIVE APPLICATION CHECKLIST

THIS CHECKLIST IS MANDATORY FOR ALL ADMINISTRATIVE APPLICATIONS FOR EXCEPTIONS TO DIVISION RULES AND REGULATIONS
 WHICH REQUIRE PROCESSING AT THE DIVISION LEVEL IN SANTA FE

Application Acronyms:

[NSP-Non-Standard Location] [NSL-Non-Standard Proration Unit] [SD-Simultaneous Dedication]
 [DHC-Downhole Commingling] [CTB-Lease Commingling] [PLC-Pool/Lease Commingling]
 [PC-Pool Commingling] [OLS-Off-Lease Storage] [OLM-Off-Lease Measurement]
 [WFX-Waterflood Expansion] [PMX-Pressure Maintenance Expansion]
 [SWD-Salt Water Disposal] [IPI-Injection Pressure Increase]
 [EOR-Qualified Enhanced Oil Recovery Certification] [PPR-Positive Production Response]

[1] **TYPE OF APPLICATION** - Check Those Which Apply for [A]

[A] Location - Spacing Unit - Simultaneous Dedication
☒ NSL ☐ NSP ☐ SD

Check One Only for [B] or [C]

[B] Commingling - Storage - Measurement
☐ DHC ☐ CTB ☐ PLC ☐ PC ☐ OLS ☐ OLM

[C] Injection - Disposal - Pressure Increase - Enhanced Oil Recovery
☐ WFX ☐ PMX ☐ SWD ☐ IPI ☐ EOR ☐ PPR

[D] Other: Specify _____

[2] **NOTIFICATION REQUIRED TO:** - Check Those Which Apply, or ☒ Does Not Apply

- [A] ☐ Working, Royalty or Overriding Royalty Interest Owners
- [B] ☐ Offset Operators, Leaseholders or Surface Owner
- [C] ☐ Application if One Which Requires Published Legal Notice
- [D] ☐ Notification and/or Concurrent Approval by BLM or SLO
U.S. Bureau of Land Management - Commissioner of Public Lands, State Land Office
- [E] ☐ For all of the above, Proof of Notification or Publication is Attached, and/or,
- [F] ☐ Waivers are Attached

[3] **SUBMIT ACCURATE AND COMPLETE INFORMATION REQUIRED TO PROCESS THE TYPE OF APPLICATION INDICATED ABOVE.**

[4] **CERTIFICATION:** I hereby certify that the information submitted with this application for administrative approval is **accurate and complete** to the best of my knowledge. I also understand that **no action** will be taken on this application until the required information and notifications are submitted to the Division.

Note: Statement must be completed by an individual with managerial and/or supervisory capacity.

Lee R. White
 Print or Type Name

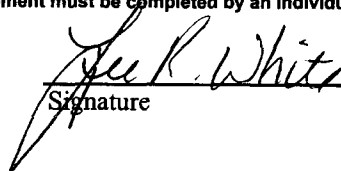
 Signature

Engineering Manager
 Title

01/18/02
 Date

Lee.White@Apachecorp.com
 e-mail Address



January 18, 2002

Attn: Michael E. Stogner
State of New Mexico
Oil Conservation Division
1220 South St. Francis Drive
Santa Fe, New Mexico 87505

Re: **Application for an Unorthodox Oil Well Location**
Proposed Turner No. 19
Paddock Pool (49210)
Section 22, T-21S, R-37E
Lea County, New Mexico

(30-025-34493)

RECEIVED
JAN 22 2002
STATE OF NEW MEXICO
OIL CONSERVATION DIVISION
(Handwritten: ? (show different footage)

Apache Corporation respectfully requests administrative approval of an unorthodox well location for our proposed Turner No. 19 well in the Paddock Pool.

To support this request we submit the following information:

- 1) Apache Corporation is seeking a permit to drill and complete the referenced oil well on our Turner lease which consists of the S/2 of Section 22. The 40-acre proration unit consists of the NW/4 (Unit J) of the SE/4 of Section 22. The desired location is necessary to develop Paddock reserves trapped by a local structural high without drilling a directional well (See attached structural plat). Surface obstructions prevent staking of this well at a standard location.
- 2) The Turner No. 19, as staked, would be located 1065' South & 1450' West of the nearest Turner lease boundaries and 1575' FSL & 1450' FEL of Section 22, Township 21-S, Range 37-E. This location is unorthodox in that Rule 104.C. (1) of the General Rules of the Oil Conservation Division requires wells on 40-acre spacing and proration units be located no closer than 330' to any boundary of such tract nor closer than 330' to the nearest well capable of producing from the same pool. The proposed location is 200' East and 75' South of a standard location and 118' from Apache Corporations' Northeast Drinkard Unit No. 923, which is completed in the deeper Eunice; Blinebry-Tubb-Drinkard, N pool.

- 3) Apache Corporation's entire Turner lease consists of 320-acres.
- 4) NM-OCD Form C-102 for the Turner No. 19.
- 5) Plats of Section 22 with the Turner lease outlined and footages noted.
- 6) No Offset Operator is affected by this request. Encroachment is limited to additional acreage in the Turner and offset Northeast Drinkard leases which are owned and operated by Apache.

If you have any questions or require additional information regarding this application, please contact me at 713-296-6338 or via e-mail at Debra.Anderson@Apachecorp.com. Thank you.

Sincerely,

APACHE CORPORATION



Debra J. Anderson
Sr. Engineering Technician

Attachments

cc: New Mexico Oil Conservation Division
District I
1625 N. French Drive
Hobbs, New Mexico 88240

DISTRICT I
P.O. Box 1980, Hobbs, NM 88241-1980

DISTRICT II
P.O. Drawer DD, Artesia, NM 88211-0719

DISTRICT III
1000 Rio Brazos Rd., Aztec, NM 87410

DISTRICT IV
P.O. BOX 2088, SANTA FE, N.M. 87504-2088

State of New Mexico
Energy, Minerals and Natural Resources Department

OIL CONSERVATION DIVISION

P.O. Box 2088
Santa Fe, New Mexico 87504-2088

Paddock Pool includes the SE 1/4 of Sec. 22
Form C-102
Revised February 10, 1994
Submit to Appropriate District Office
State Lease - 4 Copies
Fee Lease - 3 Copies

WELL LOCATION AND ACREAGE DEDICATION PLAT

☐ AMENDED REPORT

API Number	Pool Code 49210	Pool Name Paddock
Property Code 22880	Property Name TURNER	Well Number 19
OGRID No. 000873	Operator Name APACHE CORPORATION	Elevation 3407'

Surface Location

UL or lot No.	Section	Township	Range	Lot Idn	Feet from the	North/South line	Feet from the	East/West line	County
J	22	21-S	37-E		1575	SOUTH	1450	EAST	LEA

Bottom Hole Location If Different From Surface

UL or lot No.	Section	Township	Range	Lot Idn	Feet from the	North/South line	Feet from the	East/West line	County

Dedicated Acres	Joint or Infill	Consolidation Code	Order No.
40			

NO ALLOWABLE WILL BE ASSIGNED TO THIS COMPLETION UNTIL ALL INTERESTS HAVE BEEN CONSOLIDATED
OR A NON-STANDARD UNIT HAS BEEN APPROVED BY THE DIVISION

	OPERATOR CERTIFICATION I hereby certify the the information contained herein is true and complete to the best of my knowledge and belief. Signature Debra J. Anderson Printed Name Sr. Engineering Technician Title 1/18/02 Date
	SURVEYOR CERTIFICATION I hereby certify that the well location shown on this plat was plotted from field notes of actual surveys made by me or under my supervision, and that the same is true and correct to the best of my belief. DECEMBER 18, 2001 Date Surveyed Signature & Seal of Professional Surveyor Certificate No. RONALD J. EIDSON 3239 GARY EIDSON 12641

SECTION 22, TOWNSHIP 21 SOUTH, RANGE 37 EAST, N.M.P.M.,
LEA COUNTY, NEW MEXICO.

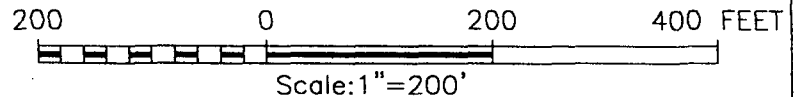
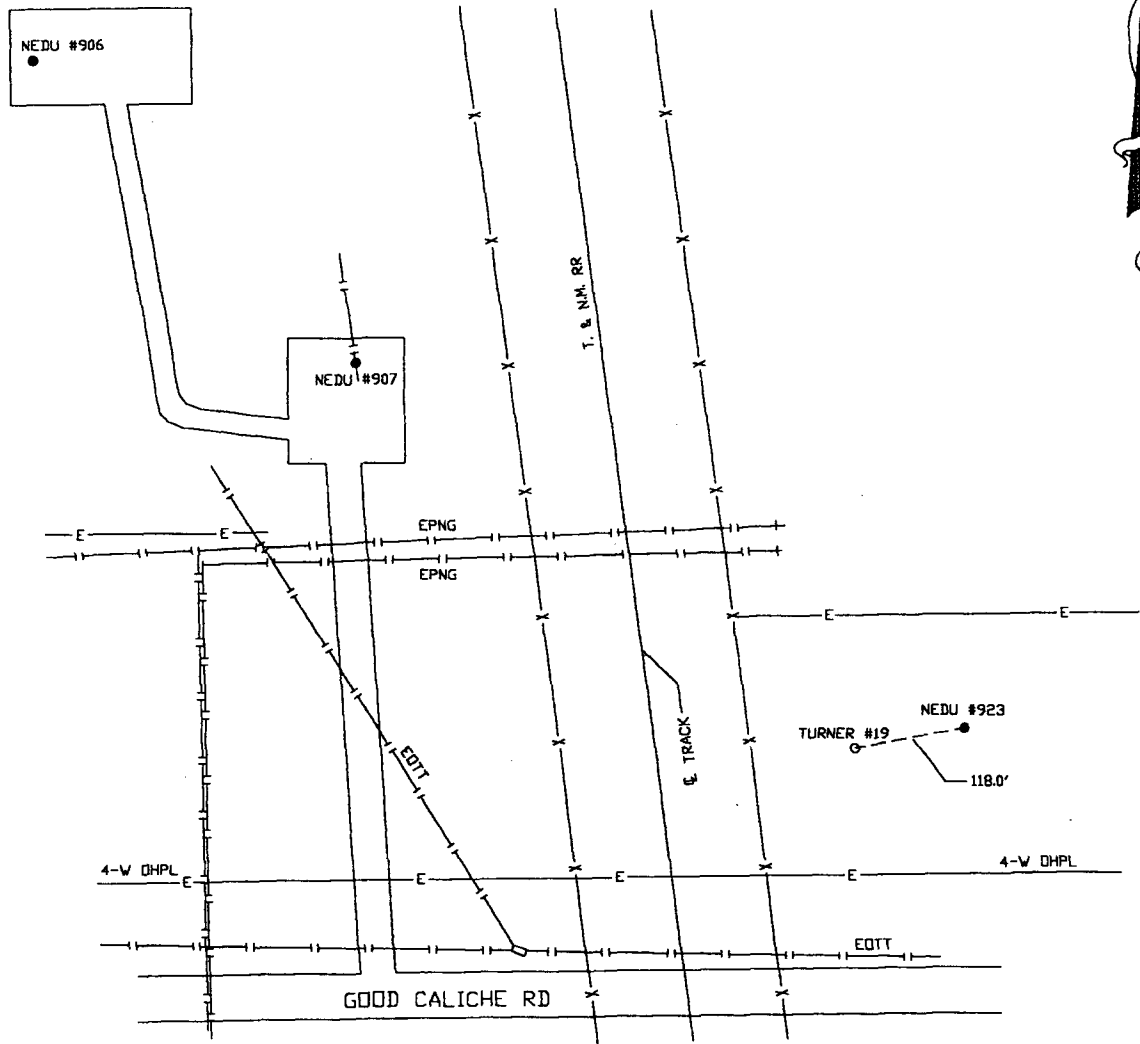

GEOGRAPHIC LOCATION NAD 27

LAT. 32°27'40.88"N
LONG. 103°08'47.60"W

JOHN WEST SURVEYING COMPANY
412 N. DAL PASO - HOBBS, NEW MEXICO - 505-393-3117

APACHE CORPORATION

THE TURNER #19
1575 FEET FROM THE SOUTH LINE AND
1450 FEET FROM EAST LINE OF
SECTION 22, TOWNSHIP 21 SOUTH,
RANGE 37 EAST, N.M.P.M.,
LEA COUNTY, NEW MEXICO

Survey Date: 12/18/01	Sheet 1 of 1 Sheets
W.O. Number: 00-11-1297	Drawn By: L. ANAYA
Date: 01/3/02	

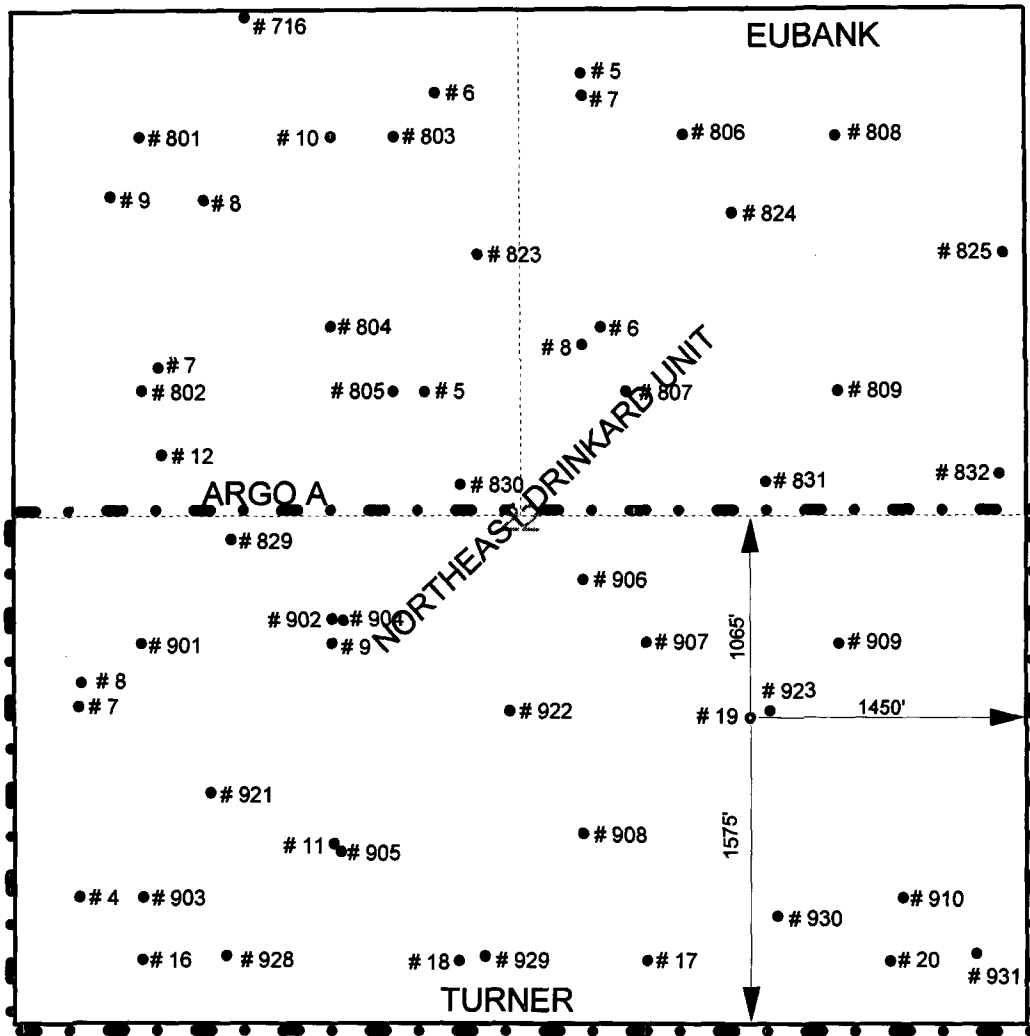

APACHE CORPORATION
 TURNER NO. 19
 1575' FSL & 1450' FEL
 SECTION 22, TOWNSHIP 21S, RANGE 37E
 LEA COUNTY, NEW MEXICO

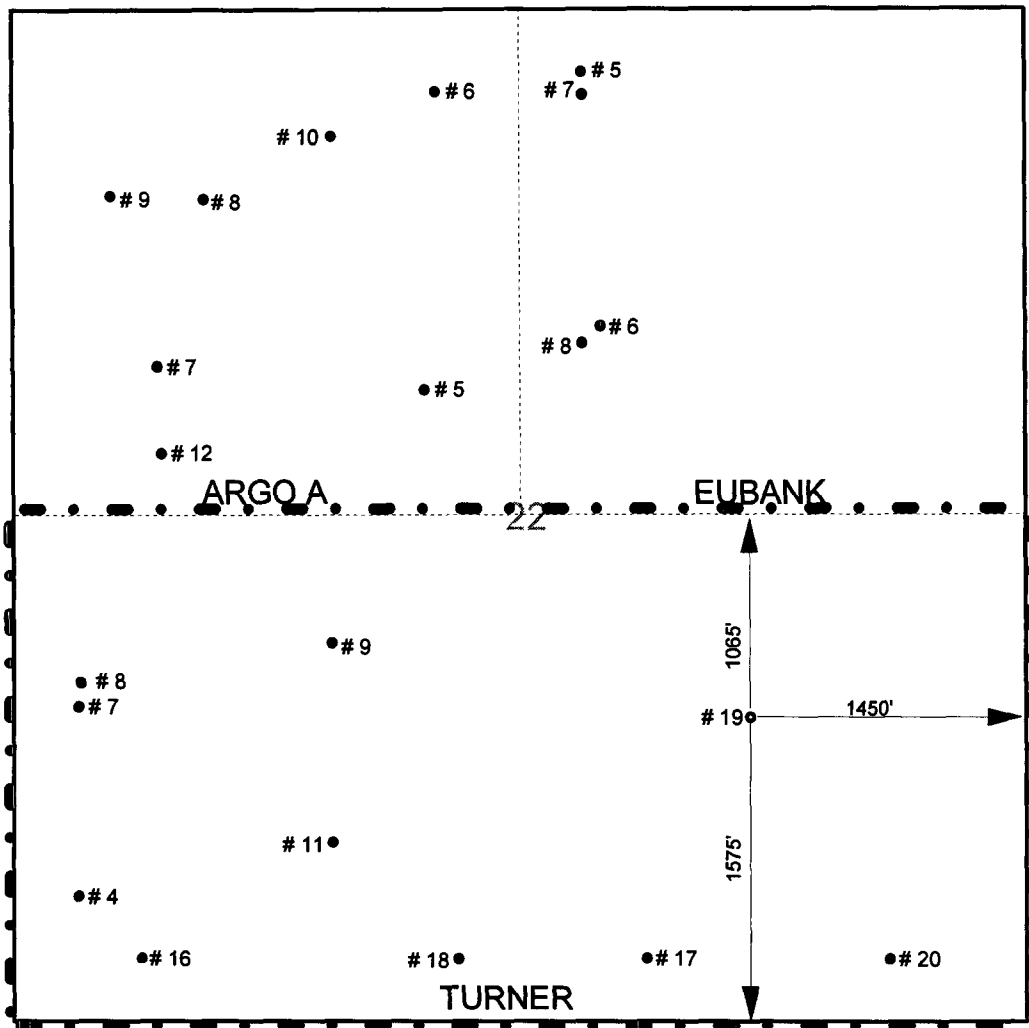

APACHE CORPORATION
TURNER NO. 19
1575' FSL & 1450' FEL
SECTION 22, TOWNSHIP 21S, RANGE 37E
LEA COUNTY, NEW MEXICO

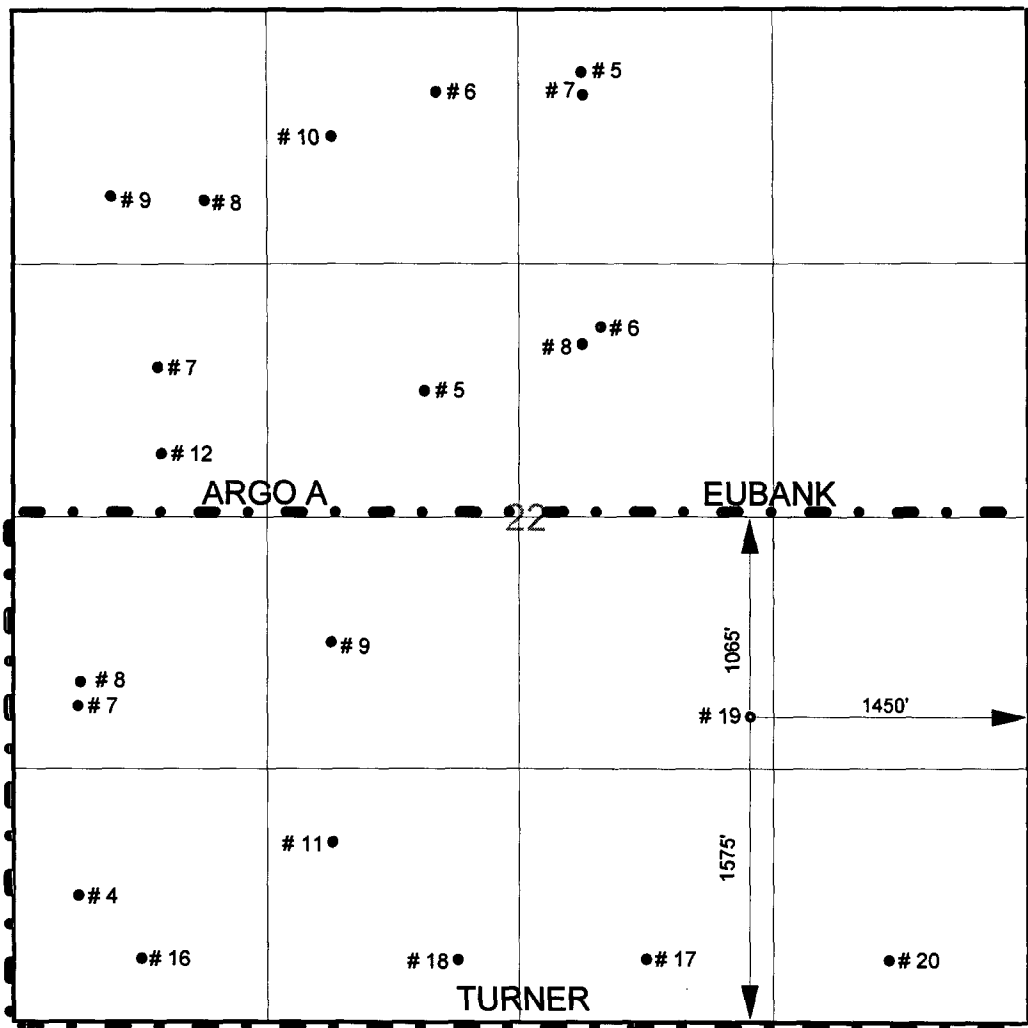

APACHE CORPORATION
TURNER NO. 19
1575' FSL & 1450' FEL
SECTION 22, TOWNSHIP 21S, RANGE 37E
LEA COUNTY, NEW MEXICO