

District I
1625 N. French Dr., Hobbs, NM 88240
District II
1301 W. Grand Avenue, Artesia, NM 88210
District III
1000 Rio Brazos Road, Aztec, NM 87410
District IV
1220 S. St. Francis Dr., Santa Fe, NM 87505

State of New Mexico
Energy Minerals and Natural Resources

Oil Conservation Division
1220 South St. Francis Dr.
Santa Fe, NM 87505

Form C-141
Revised October 10, 2003

Submit 2 Copies to appropriate
District Office in accordance
with Rule 116 on back
side of form

30-015-28736

Release Notification and Corrective Action

nMLB/1135446814		OPERATOR		<input checked="" type="checkbox"/> Initial Report	<input type="checkbox"/> Final Report
Name of Company BOPCO, L.P.		260237	Contact Tony Savoie		
Address 522 W. Mermod, Suite 704 Carlsbad, N.M. 88220		Telephone No. 432-556-8730			
Facility Name Bass 3 Federal Well #4 Spill Site "A"		Facility Type E&P			
Surface Owner Federal		Mineral Owner Federal		Lease No.	

LOCATION OF RELEASE

Unit Letter O	Section 3	Township 22S	Range 28E	Feet from the	North/South Line	Feet from the	East/West Line	County Eddy
------------------	--------------	-----------------	--------------	---------------	------------------	---------------	----------------	----------------

Latitude N 32.416059 Longitude W 104.070738

NATURE OF RELEASE

Type of Release: Produced water and crude oil	Volume of Release: 25 Bbls of Produced water and 5 Bbls of Crude oil	Volume Recovered: none
Source of Release: Above ground 2 7/8" flow line	Date and Hour of Occurrence Unknown	Date and Hour of Discovery 12/13/11 11:36 a.m.
Was Immediate Notice Given? <input checked="" type="checkbox"/> Yes <input type="checkbox"/> No <input type="checkbox"/> Not Required	If YES, To Whom? Mike Bratcher NMOCD and Jim Amos BLM	
By Whom? Tony Savoie	Date and Hour 12/13/11 12:12 p.m.	
Was a Watercourse Reached? <input type="checkbox"/> Yes <input checked="" type="checkbox"/> No	If YES, Volume Impacting the Watercourse.	

If a Watercourse was Impacted, Describe Fully.*	<div style="border: 1px solid black; padding: 5px; text-align: center;">RECEIVED DEC 15 2011 NMOCD ARTESIA</div>
---	--

Describe Cause of Problem and Remedial Action Taken.* The flow line delivering produced fluid from the well to the tank battery developed a leak, the well was shut in and a temporary repair clamp was placed on the affected area. The well will remain shut in until the entire flow line can be replaced with poly pipe.

Describe Area Affected and Cleanup Action Taken.* The released fluid affected an area of approximately 2700 sq. ft of pasture land. All of the fluid had soaked into the ground. The spill is in area previously impacted with produced water and crude oil spills. An air rotary rig has been scheduled for 12/19/11 to determine the vertical and horizontal extent of the release sites.

The Site remediation for the produced water and crude oil spill will follow the NMOCD guidelines for leaks and spills.

I hereby certify that the information given above is true and complete to the best of my knowledge and understand that pursuant to NMOCD rules and regulations all operators are required to report and/or file certain release notifications and perform corrective actions for releases which may endanger public health or the environment. The acceptance of a C-141 report by the NMOCD marked as "Final Report" does not relieve the operator of liability should their operations have failed to adequately investigate and remediate contamination that pose a threat to ground water, surface water, human health or the environment. In addition, NMOCD acceptance of a C-141 report does not relieve the operator of responsibility for compliance with any other federal, state, or local laws and/or regulations.

Signature: <u>Tony Savoie</u>		OIL CONSERVATION DIVISION	
Printed Name: Tony Savoie		Approved by <u>Mike Bratcher</u>	
Title: Waste Mgmt. & Remediation Specialist		Approval Date: <u>DEC 20 2011</u>	Expiration Date:
E-mail Address: TASavoie@BassPet.com		Conditions of Approval:	
Date: 12/15/11 Phone: 432-556-8730		Remediation per OCD Rules & Guidelines. SUBMIT REMEDIATION PROPOSAL NOT LATER THAN:	
		Attached <input type="checkbox"/>	

* Attach Additional Sheets If Necessary

1/20/2012

2RP-980



Scale 1 : 12,800

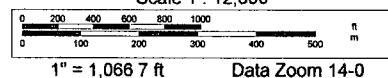

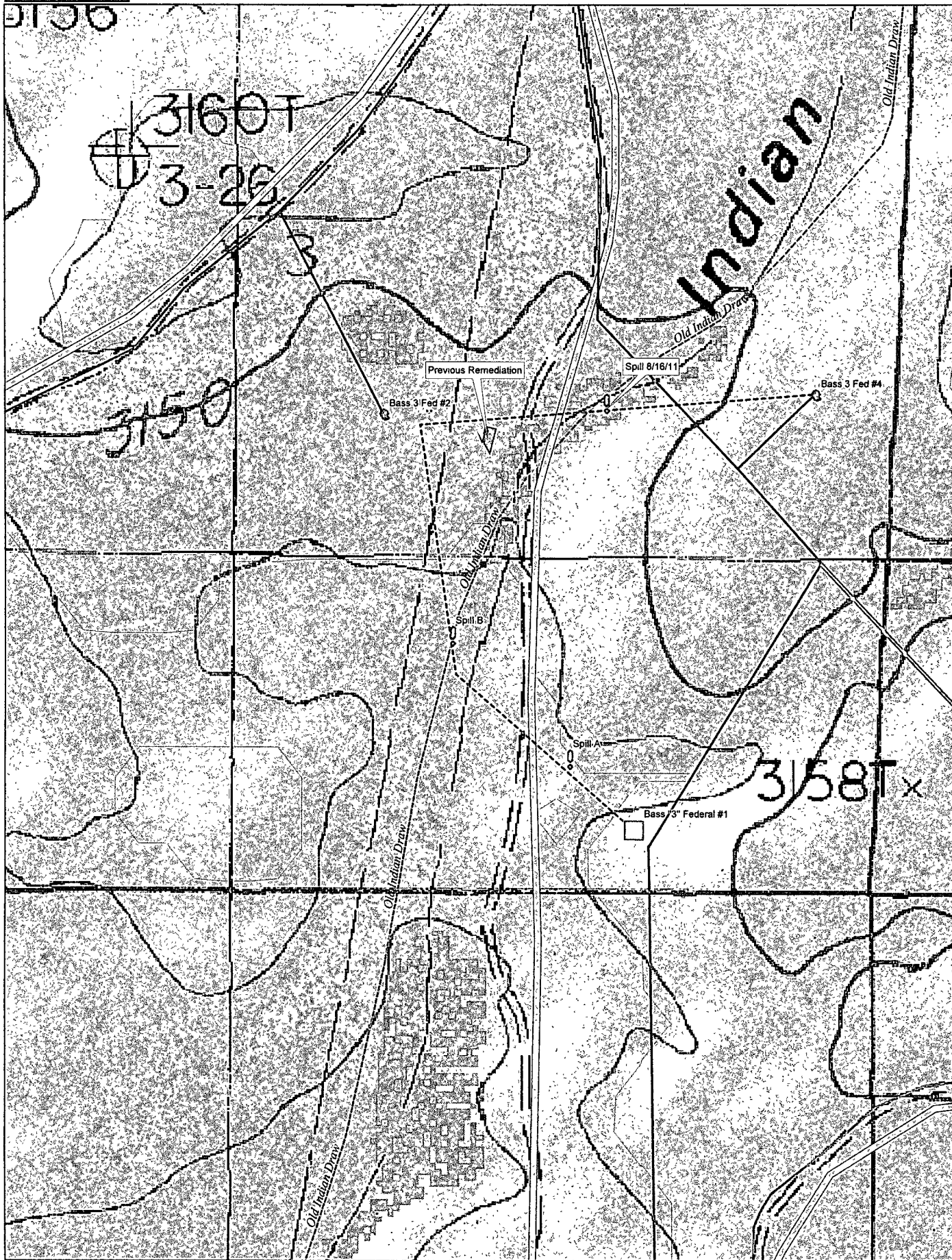

Data use subject to license

© DeLorme. Topo USA® 8

www.delorme.com

