

**Bratcher, Mike, EMNRD**

---

**From:** Vernon Black [vernon@hungry-horse.com]  
**Sent:** Friday, February 17, 2012 10:07 AM  
**To:** Bratcher, Mike, EMNRD  
**Cc:** 'Grajeda De Babb, Patricia'  
**Subject:** DCP's M Exr Line Remediation Soil Analysis  
**Attachments:** H200348 HHE.pdf; DCP M Ext Line Drawing.docx; DCP M-Ext line Lab Results Charted.xlsx

Good Morning Mike,

Please see the attached documentation concerning the remediation at DCP's M Ext Line site. The depth to ground water is 200' based upon the map information. Looks like the chlorides are good to go at all sample points. There was no detectable levels of Benzene at any of the sample points. the only area of concern is the GRO/DRO levels underneath the pipe. They are a bit high. However, there was/is no visual evidence of hydrocarbon staining at the excavation site, so this is most likely aromatic in nature. The excavation has been open and airing out for over a week now, so much of this could have possibly flashed off by now. What are your thoughts and guidance?

Thanks,  
Vernon

## DCP's M-Extension Line Soil Analysis Results

SP1 Road	BTEX	Chlorides	GRO/DRO
3' BGS	<.05ppm	112ppm	<10/117ppm

SP2 Road	BTEX	Chlorides	GRO/DRO
3' BGS	<.05ppm	<16ppm	<10/63.9ppm

SP3 Road	BTEX	Chlorides	GRO/DRO
3' BGS	<.05ppm	32ppm	<10/153ppm

North Wall	BTEX	Chlorides	GRO/DRO
6' BGS	74.08ppm	368ppm	88.5/1490ppm

South Wall	BTEX	Chlorides	GRO/DRO
6' BGS	<.05ppm	80ppm	<10ppm

Beneath Pipe	BTEX	Chlorides	GRO/DRO
6' BGS	3.29ppm	352ppm	1010/6790ppm

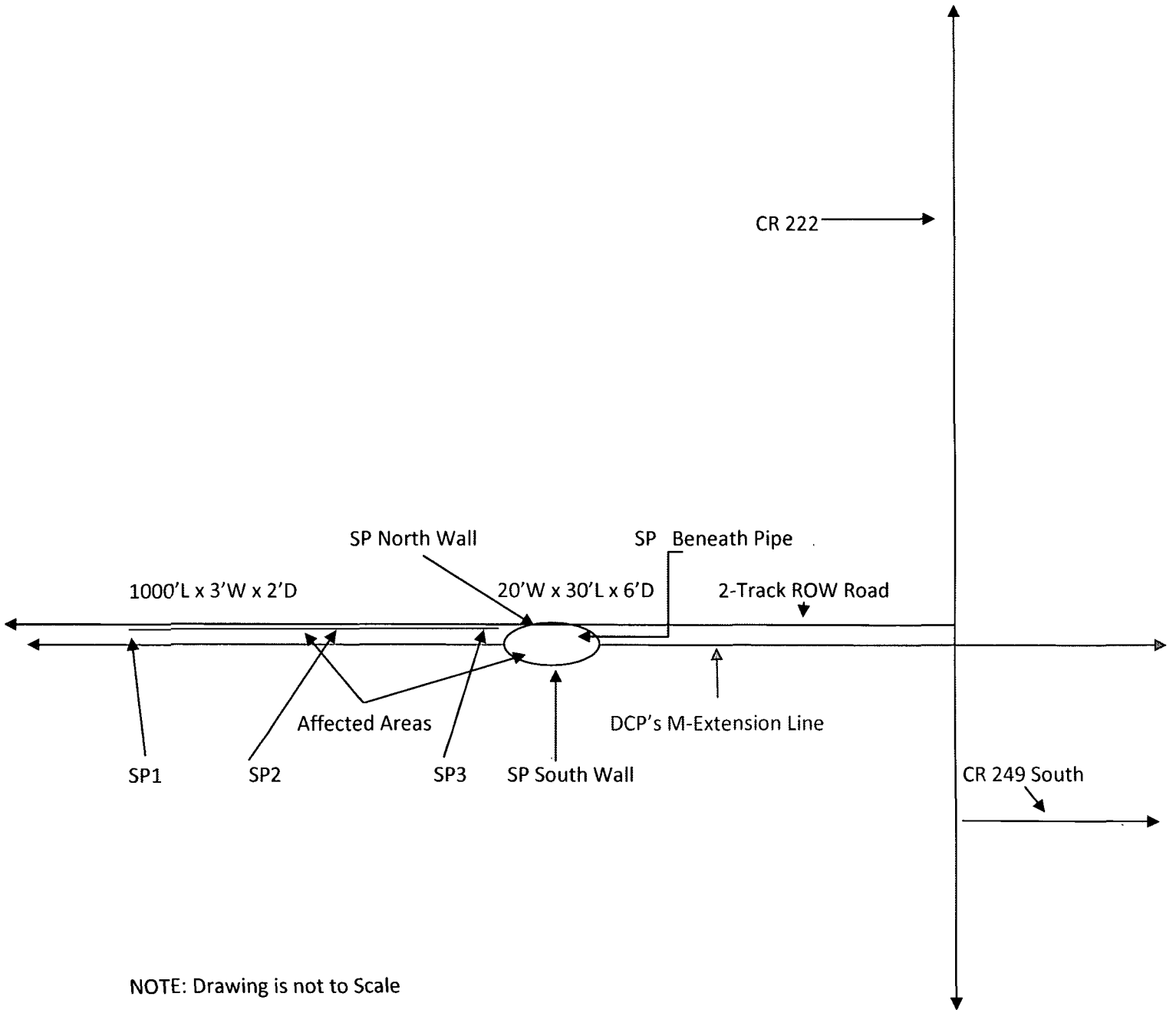



PHONE (575) 393-2326 ° 101 E. MARLAND ° HOBBS, NM 88240

---

February 17, 2012

VERNON BLACK

Hungry Horse Environmental

P.O. Box 1058

Hobbs, NM 88240

RE: M - EXTENSION LINE

Enclosed are the results of analyses for samples received by the laboratory on 02/10/12 12:10.

Cardinal Laboratories is accredited through Texas NELAP under certificate number T104704398-11-3. Accreditation applies to drinking water, non-potable water and solid and chemical materials. All accredited analytes are denoted by an asterisk (\*). For a complete list of accredited analytes and matrices visit the TCEQ website at [www.tceq.texas.gov/field/qa/lab\\_accred\\_certif.html](http://www.tceq.texas.gov/field/qa/lab_accred_certif.html).

Cardinal Laboratories is accredited through the State of Colorado Department of Public Health and Environment for:

Method EPA 552.2	Haloacetic Acids (HAA-5)
Method EPA 524.2	Total Trihalomethanes (TTHM)
Method EPA 524.4	Regulated VOCs (V1, V2, V3)

Accreditation applies to public drinking water matrices.

This report meets NELAP requirements and is made up of a cover page, analytical results, and a copy of the original chain-of-custody. If you have any questions concerning this report, please feel free to contact me.

Sincerely,

Celey D. Keene

Lab Director/Quality Manager

**Analytical Results For:**

Hungry Horse Environmental  
VERNON BLACK  
P.O. Box 1058  
Hobbs NM, 88240  
Fax To: (505) 391-4585

Received: 02/10/2012  
Reported: 02/17/2012  
Project Name: M - EXTENSION LINE  
Project Number: NONE GIVEN  
Project Location: EDDY COUNTY, NM

Sampling Date: 02/10/2012  
Sampling Type: Soil  
Sampling Condition: \*\* (See Notes)  
Sample Received By: Jodi Henson

**Sample ID: SP #1 ROAD 3' BGS (H200348-01)**

BTEX 8021B		mg/kg		Analyzed By: AP					
Analyte	Result	Reporting Limit	Analyzed	Method Blank	BS	% Recovery	True Value QC	RPD	Qualifier
Benzene*	<0.050	0.050	02/16/2012	ND	1.93	96.5	2.00	16.0	
Toluene*	<0.050	0.050	02/16/2012	ND	2.09	105	2.00	15.8	
Ethylbenzene*	<0.050	0.050	02/16/2012	ND	2.15	107	2.00	15.0	
Total Xylenes*	<0.150	0.150	02/16/2012	ND	6.65	111	6.00	15.5	

Surrogate 4-Bromofluorobenzene (PIE) 114 % 64 4-134

Chloride, SM4500Cl-B		mg/kg		Analyzed By: AP					
Analyte	Result	Reporting Limit	Analyzed	Method Blank	BS	% Recovery	True Value QC	RPD	Qualifier
Chloride	112	16.0	02/15/2012	ND	416	104	400	3.92	

TPH 8015M		mg/kg		Analyzed By: MS					
Analyte	Result	Reporting Limit	Analyzed	Method Blank	BS	% Recovery	True Value QC	RPD	Qualifier
GRO C6-C10	<10.0	10.0	02/14/2012	ND	166	83.0	200	4.76	
DRO >C10-C28	117	10.0	02/14/2012	ND	166	83.0	200	5.92	

Surrogate 1-Chlorooctane 98.7 % 55 5-154

Surrogate 1-Chlorooctadecane 97.3 % 57 6-158

Cardinal Laboratories

\*=Accredited Analyte

PLEASE NOTE: Liability and Damages: Cardinal's liability and client's exclusive remedy for any claim arising, whether based in contract or tort, shall be limited to the amount paid by client for analyses. All claims, including those for negligence and any other cause whatsoever shall be deemed waived unless made in writing and received by Cardinal within thirty (30) days after completion of the applicable service. In no event shall Cardinal be liable for incidental or consequential damages, including, without limitation, business interruptions, loss of use, or loss of profits incurred by client, its subsidiaries, affiliates or successors arising out of or related to the performance of the services hereunder by Cardinal, regardless of whether such claim is based upon any of the above stated reasons or otherwise. Results relate only to the samples identified above. This report shall not be reproduced except in full with written approval of Cardinal Laboratories.



Celey D. Keene, Lab Director/Quality Manager

**Analytical Results For:**

 Hungry Horse Environmental  
 VERNON BLACK  
 P.O. Box 1058  
 Hobbs NM, 88240  
 Fax To: (505) 391-4585

 Received: 02/10/2012  
 Reported: 02/17/2012  
 Project Name: M - EXTENSION LINE  
 Project Number: NONE GIVEN  
 Project Location: EDDY COUNTY, NM

 Sampling Date: 02/10/2012  
 Sampling Type: Soil  
 Sampling Condition: \*\* (See Notes)  
 Sample Received By: Jodi Henson

**Sample ID: SP #2 ROAD 3' BGS (H200348-02)**

BTEX-8021B		mg/kg		Analyzed By: AP					
Analyte	Result	Reporting Limit	Analyzed	Method Blank	BS	% Recovery	True Value QC	RPD	Qualifier
Benzene*	<0.050	0.050	02/16/2012	ND	1.93	96.5	2.00	16.0	
Toluene*	<0.050	0.050	02/16/2012	ND	2.09	105	2.00	15.8	
Ethylbenzene*	<0.050	0.050	02/16/2012	ND	2.15	107	2.00	15.0	
Total Xylenes*	<0.150	0.150	02/16/2012	ND	6.65	111	6.00	15.5	

*Suitogate 4-Bromofluorobenzene (PIL) 112 % 64 4-134*

Chloride, SM4500Cl-B		mg/kg		Analyzed By: AP					
Analyte	Result	Reporting Limit	Analyzed	Method Blank	BS	% Recovery	True Value QC	RPD	Qualifier
Chloride	<16.0	16.0	02/15/2012	ND	416	104	400	3.92	

TPH 8015M		mg/kg		Analyzed By: MS					
Analyte	Result	Reporting Limit	Analyzed	Method Blank	BS	% Recovery	True Value QC	RPD	Qualifier
GRO C6-C10	<10.0	10.0	02/14/2012	ND	166	83.0	200	4.76	
DRO >C10-C28	63.9	10.0	02/14/2012	ND	166	83.0	200	5.92	

*Suitogate 1-Chlorooctane 99.7 % 55 5-154*
*Suitogate 1-Chlorooctadecane 102 % 57 6-158*

Cardinal Laboratories

\* = Accredited Analyte

PLEASE NOTE: Liability and Damages. Cardinal's liability and client's exclusive remedy for any claim arising, whether based in contract or tort, shall be limited to the amount paid by client for analyses. All claims, including those for negligence and any other cause whatsoever shall be deemed waived unless made in writing and received by Cardinal within thirty (30) days after completion of the applicable service. In no event shall Cardinal be liable for incidental or consequential damages, including, without limitation, business interruptions, loss of use, or loss of profits incurred by client, its subsidiaries, affiliates or successors arising out of or related to the performance of the services hereunder by Cardinal, regardless of whether such claim is based upon any of the above stated reasons or otherwise. Results relate only to the samples identified above. This report shall not be reproduced except in full with written approval of Cardinal Laboratories.

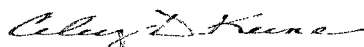

Celey D. Keene, Lab Director/Quality Manager

**Analytical Results For:**

Hungry Horse Environmental  
VERNON BLACK  
P.O. Box 1058  
Hobbs NM, 88240  
Fax To: (505) 391-4585

Received: 02/10/2012  
Reported: 02/17/2012  
Project Name: M - EXTENSION LINE  
Project Number: NONE GIVEN  
Project Location: EDDY COUNTY, NM

Sampling Date: 02/10/2012  
Sampling Type: Soil  
Sampling Condition: \*\* (See Notes)  
Sample Received By: Jodi Henson

**Sample ID: SP #3 ROAD 3' BGS (H200348-03)**

BTX 8021B		mg/kg		Analyzed By: AP					
Analyte	Result	Reporting Limit	Analyzed	Method Blank	BS	% Recovery	True Value QC	RPD	Qualifier
Benzene*	<0.050	0.050	02/16/2012	ND	1.93	96.5	2.00	16.0	
Toluene*	<0.050	0.050	02/16/2012	ND	2.09	105	2.00	15.8	
Ethylbenzene*	<0.050	0.050	02/16/2012	ND	2.15	107	2.00	15.0	
Total Xylenes*	<0.150	0.150	02/16/2012	ND	6.65	111	6.00	15.5	

Surrogate 4-Bromofluorobenzene (PIL) 112 % 64 4-134

Chloride, SM4500Cl-B		mg/kg		Analyzed By: AP					
Analyte	Result	Reporting Limit	Analyzed	Method Blank	BS	% Recovery	True Value QC	RPD	Qualifier
Chloride	32.0	16.0	02/15/2012	ND	416	104	400	3.92	

TPH 8015M		mg/kg		Analyzed By: MS					
Analyte	Result	Reporting Limit	Analyzed	Method Blank	BS	% Recovery	True Value QC	RPD	Qualifier
GRO C6-C10	<10.0	10.0	02/14/2012	ND	166	83.0	200	4.76	
DRO >C10-C28	153	10.0	02/14/2012	ND	166	83.0	200	5.92	

Surrogate 1-Chlorooctane 103 % 55 5-154

Surrogate 1-Chlorooctadecane 104 % 57 6-158

Cardinal Laboratories

\*=Accredited Analyte

PLEASE NOTE: Liability and Damages: Cardinal's liability and client's exclusive remedy for any claim arising, whether based in contract or tort, shall be limited to the amount paid by client for analyses. All claims, including those for negligence and any other cause whatsoever shall be deemed waived unless made in writing and received by Cardinal within thirty (30) days after completion of the applicable service. In no event shall Cardinal be liable for incidental or consequential damages, including, without limitation, business interruptions, loss of use, or loss of profits incurred by client, its subsidiaries, affiliates or successors arising out of or related to the performance of the services hereunder by Cardinal, regardless of whether such claim is based upon any of the above stated reasons or otherwise. Results relate only to the samples identified above. This report shall not be reproduced except in full with written approval of Cardinal Laboratories.

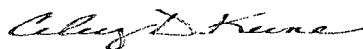

Celey D. Keene, Lab Director/Quality Manager

**Analytical Results For:**

Hungry Horse Environmental  
VERNON BLACK  
P.O. Box 1058  
Hobbs NM, 88240  
Fax To: (505) 391-4585

Received: 02/10/2012  
Reported: 02/17/2012  
Project Name: M - EXTENSION LINE  
Project Number: NONE GIVEN  
Project Location: EDDY COUNTY, NM

Sampling Date: 02/10/2012  
Sampling Type: Soil  
Sampling Condition: \*\* (See Notes)  
Sample Received By: Jodi Henson

**Sample ID: RELEASE POINT N WALL (H200348-04)**

BTEx 8021B		mg/kg	Analyzed By: AP					S-04	
Analyte	Result	Reporting Limit	Analyzed	Method Blank	BS	% Recovery	True Value QC	RPD	Qualifier
Benzene*	<0.500	0.500	02/16/2012	ND	1.93	96.5	2.00	16.0	
Toluene*	7.04	0.500	02/16/2012	ND	2.09	105	2.00	15.8	
Ethylbenzene*	9.14	0.500	02/16/2012	ND	2.15	107	2.00	15.0	
Total Xylenes*	57.9	1.50	02/16/2012	ND	6.65	111	6.00	15.5	

Surrogate 4-Bromofluorobenzene (PIL) 165 % 64 4-134

Chloride, SM4500Cl-B		mg/kg	Analyzed By: AP						
Analyte	Result	Reporting Limit	Analyzed	Method Blank	BS	% Recovery	True Value QC	RPD	Qualifier
Chloride	368	16.0	02/15/2012	ND	416	104	400	3.92	

TPH 8015M		mg/kg	Analyzed By: MS						
Analyte	Result	Reporting Limit	Analyzed	Method Blank	BS	% Recovery	True Value QC	RPD	Qualifier
GRO C6-C10	88.5	10.0	02/14/2012	ND	166	83.0	200	4.76	
DRO >C10-C28	1490	10.0	02/14/2012	ND	166	83.0	200	5.92	

Surrogate 1-Chlorooctane 92.6 % 55 5-154

Surrogate 1-Chlorooctadecane 59.7 % 57 6-158

Cardinal Laboratories

\*=Accredited Analyte

PLEASE NOTE: Liability and Damages: Cardinal's liability and client's exclusive remedy for any claim arising, whether based in contract or tort, shall be limited to the amount paid by client for analyses. All claims, including those for negligence and any other cause whatsoever shall be deemed waived unless made in writing and received by Cardinal within thirty (30) days after completion of the applicable service. In no event shall Cardinal be liable for incidental or consequential damages, including, without limitation, business interruptions, loss of use, or loss of profits incurred by client, its subsidiaries, affiliates or successors arising out of or related to the performance of the services hereunder by Cardinal, regardless of whether such claim is based upon any of the above stated reasons or otherwise. Results relate only to the samples identified above. This report shall not be reproduced except in full with written approval of Cardinal Laboratories.



Celey D. Keene, Lab Director/Quality Manager



**Analytical Results For:**

Hungry Horse Environmental  
VERNON BLACK  
P.O. Box 1058  
Hobbs NM, 88240  
Fax To: (505) 391-4585

Received: 02/10/2012  
Reported: 02/17/2012  
Project Name: M - EXTENSION LINE  
Project Number: NONE GIVEN  
Project Location: EDDY COUNTY, NM

Sampling Date: 02/10/2012  
Sampling Type: Soil  
Sampling Condition: \*\* (See Notes)  
Sample Received By: Jodi Henson

**Sample ID: RELEASE POINT S WALL (H200348-05)**

BTEX 8021B		mg/kg		Analyzed By: AP						
Analyte	Result	Reporting Limit	Analyzed	Method Blank	BS	% Recovery	True Value QC	RPD	Qualifier	
Benzene*	<0.050	0.050	02/16/2012	ND	1.93	96.5	2.00	16.0		
Toluene*	<0.050	0.050	02/16/2012	ND	2.09	105	2.00	15.8		
Ethylbenzene*	<0.050	0.050	02/16/2012	ND	2.15	107	2.00	15.0		
Total Xylenes*	<0.150	0.150	02/16/2012	ND	6.65	111	6.00	15.5		

Surrogate: 4-Bromofluorobenzene (PIL) 114 % 64 4-134

Chloride, SM4500Cl-B		mg/kg		Analyzed By: AP					
Analyte	Result	Reporting Limit	Analyzed	Method Blank	BS	% Recovery	True Value QC	RPD	Qualifier
Chloride	80.0	16.0	02/15/2012	ND	416	104	400	3.92	
TPH 8015M		mg/kg		Analyzed By: MS					

TPH 8015M		mg/kg		Analyzed By: MS						
Analyte	Result	Reporting Limit	Analyzed	Method Blank	BS	% Recovery	True Value QC	RPD	Qualifier	
GRO C6-C10	<10.0	10.0	02/14/2012	ND	190	95.2	200	3.43		
DRO >C10-C28	<10.0	10.0	02/14/2012	ND	181	90.3	200	5.09		

Surrogate 1-Chlorooctane 96.3 % 55 5-154

Surrogate 1-Chlorooctadecane 109 % 57 6-158

Cardinal Laboratories

\*=Accredited Analyte

PLEASE NOTE: Liability and Damages. Cardinal's liability and client's exclusive remedy for any claim arising, whether based in contract or tort, shall be limited to the amount paid by client for analyses. All claims, including those for negligence and any other cause whatsoever shall be deemed waived unless made in writing and received by Cardinal within thirty (30) days after completion of the applicable service. In no event shall Cardinal be liable for incidental or consequential damages, including, without limitation, business interruptions, loss of use, or loss of profits incurred by client, its subsidiaries, affiliates or successors arising out of or related to the performance of the services hereunder by Cardinal, regardless of whether such claim is based upon any of the above stated reasons or otherwise. Results relate only to the samples identified above. This report shall not be reproduced except in full with written approval of Cardinal Laboratories.

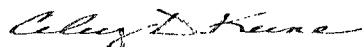

Celey D. Keene, Lab Director/Quality Manager

**Analytical Results For:**

 Hungry Horse Environmental  
 VERNON BLACK  
 P.O. Box 1058  
 Hobbs NM, 88240  
 Fax To: (505) 391-4585

 Received: 02/10/2012  
 Reported: 02/17/2012  
 Project Name: M - EXTENSION LINE  
 Project Number: NONE GIVEN  
 Project Location: EDDY COUNTY, NM

 Sampling Date: 02/10/2012  
 Sampling Type: Soil  
 Sampling Condition: \*\* (See Notes)  
 Sample Received By: Jodi Henson

**Sample ID: RELEASE POINT BENEATH PIPE (H200348-06)**

BTEX 8021B		mg/kg		Analyzed By: AP				S-04	
Analyte	Result	Reporting Limit	Analyzed	Method Blank	BS	% Recovery	True Value QC	RPD	Qualifier
Benzene*	<0.050	0.050	02/16/2012	ND	1.93	96.5	2.00	16.0	
Toluene*	0.335	0.050	02/16/2012	ND	2.09	105	2.00	15.8	
Ethylbenzene*	0.525	0.050	02/16/2012	ND	2.15	107	2.00	15.0	
Total Xylenes*	2.44	0.150	02/16/2012	ND	6.65	111	6.00	15.5	

Surrogate 4-Bromofluorobenzene (PIL) 140 % 64.4-134

Chloride, SM4500Cl-B		mg/kg		Analyzed By: AP					
Analyte	Result	Reporting Limit	Analyzed	Method Blank	BS	% Recovery	True Value QC	RPD	Qualifier
Chloride	352	16.0	02/15/2012	ND	416	104	400	3.92	
TPH 8015M		mg/kg		Analyzed By: MS					
Analyte	Result	Reporting Limit	Analyzed	Method Blank	BS	% Recovery	True Value QC	RPD	Qualifier
GRO C6-C10	1010	50.0	02/15/2012	ND	190	95.2	200	3.43	
DRO >C10-C28	6790	50.0	02/15/2012	ND	181	90.3	200	5.09	

Surrogate 1-Chlorooctane 174 % 55.5-154

Surrogate 1-Chlorooctadecane 87.5 % 57.6-158

Cardinal Laboratories

\* = Accredited Analyte

PLEASE NOTE: Liability and Damages: Cardinal's liability and client's exclusive remedy for any claim arising, whether based in contract or tort, shall be limited to the amount paid by client for analyses. All claims, including those for negligence and any other cause whatsoever shall be deemed waived unless made in writing and received by Cardinal within thirty (30) days after completion of the applicable service. In no event shall Cardinal be liable for incidental or consequential damages, including, without limitation, business interruptions, loss of use, or loss of profits incurred by client, its subsidiaries, affiliates or successors arising out of or related to the performance of the services hereunder by Cardinal, regardless of whether such claim is based upon any of the above stated reasons or otherwise. Results relate only to the samples identified above. This report shall not be reproduced except in full with written approval of Cardinal Laboratories.

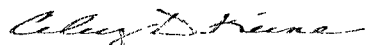

Celey D. Keene, Lab Director/Quality Manager

### Notes and Definitions

- S-04            The surrogate recovery for this sample is outside of established control limits due to a sample matrix effect.
- A-01            1 surrogate failed high due to objective matrix interference.
- ND             Analyte NOT DETECTED at or above the reporting limit
- RPD            Relative Percent Difference
- \*\*             Samples not received at proper temperature of 6°C or below.
- \*\*\*            Insufficient time to reach temperature.
- Chloride by SM4500Cl-B does not require samples be received at or below 6°C  
Samples reported on an as received basis (wet) unless otherwise noted on report

---

Cardinal Laboratories

\*=Accredited Analyte

PLEASE NOTE: Liability and Damages: Cardinal's liability and client's exclusive remedy for any claim arising, whether based in contract or tort, shall be limited to the amount paid by client for analyses. All claims, including those for negligence and any other cause whatsoever shall be deemed waived unless made in writing and received by Cardinal within thirty (30) days after completion of the applicable service. In no event shall Cardinal be liable for incidental or consequential damages, including, without limitation, business interruptions, loss of use, or loss of profits incurred by client, its subsidiaries, affiliates or successors arising out of or related to the performance of the services hereunder by Cardinal, regardless of whether such claim is based upon any of the above stated reasons or otherwise. Results relate only to the samples identified above. This report shall not be reproduced except in full with written approval of Cardinal Laboratories.

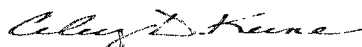

---

Celey D. Keene, Lab Director/Quality Manager



# CHAIN-OF-CUSTODY AND ANALYSIS REQUEST

101 East Marland, Hobbs, NM 88240  
(575) 393-2326 FAX (575) 393-2476

Company Name: <u>Hungry Horse, LLC</u>				<b>BILL TO</b>				<b>ANALYSIS REQUEST</b>															
Project Manager: <u>Vernon K. Black</u>				P.O. #:																			
Address: <u>PO Box 1058</u>				Company:																			
City: <u>Hobbs</u>		State: <u>NM</u>		Zip: <u>88240</u>		Attn:																	
Phone #: <u>575-393-3361</u>		Fax #: <u>575-393-4535</u>		Address:																			
Project #:		Project Owner: <u>(X) Hungry Horse</u>		City:																			
Project Name: <u>117 x 125 ft well</u>		State: _____ Zip: _____		Phone #:																			
Project Location: <u>2.0 mi. S. of Hobbs</u>		Fax #: _____		Sampler Name: <u>Vernon K. Black</u>																			
FOR LAB USE ONLY																							
Lab I.D.		Sample I.D.		MATRIX		PRESERV		SAMPLING															
				(GRAB OR (COMPOUND) (CONTAINERS)		GROUNDWATER WASTEWATER SOIL SOIL SLUDGE OTHER		ACID/BASE: ICE / COOL OTHER		DATE		TIME											
<u>H2D0348</u>										<u>12/10/12</u>		<u>1:15</u>											
<u>1</u>		<u>1st 1/2 inch 3' deep</u>								<u>12/10/12</u>		<u>1:15</u>											
<u>2</u>		<u>1st 1/2 inch 3' deep</u>								<u>12/10/12</u>		<u>1:15</u>											
<u>3</u>		<u>1st 1/2 inch 3' deep</u>								<u>12/10/12</u>		<u>1:15</u>											
<u>4</u>		<u>1st 1/2 inch 3' deep</u>								<u>12/10/12</u>		<u>1:15</u>											
<u>5</u>		<u>1st 1/2 inch 3' deep</u>								<u>12/10/12</u>		<u>1:15</u>											
<u>6</u>		<u>1st 1/2 inch 3' deep</u>								<u>12/10/12</u>		<u>1:15</u>											

PLEASE NOTE: Liability and Damages. Cardinal's liability and clients exclusive remedy for any claim or suit whether based in contract or tort shall be limited to the amount paid by the client for the analyses. All claims, including those for negligence and any other cause whatsoever, shall be deemed waived unless made in writing and received by Cardinal within 30 days after completion of the applicable service. In no event shall Cardinal be liable for incidental or consequential damages, including without limitation business interruptions, loss of use, or loss of profits, incurred by the client as a result of any failure or negligence arising out of or related to the performance of services hereunder by Cardinal. Regardless, no other such claim is based upon any of the above stated terms or conditions.

Relinquished By: _____		Date: _____		Received By: _____		Phone Result: <input type="checkbox"/> Yes <input type="checkbox"/> No		Add'l Phone #: _____	
Time: _____		Time: _____		Time: _____		Fax Result: <input type="checkbox"/> Yes <input type="checkbox"/> No		Add'l Fax #: _____	
Relinquished By: _____		Date: _____		Received By: _____		REMARKS: <u>sample taken &amp; brought directly to lab.</u>			
Time: _____		Time: _____		Time: _____					
Delivered By: (Circle One)		Sample Condition		CHECKED BY:					
Sampler - UPS - Bus - Other: _____		Cool Intact <input type="checkbox"/> Yes <input type="checkbox"/> No		(Initials)					