

MEWBOURNE OIL COMPANY

P.O. BOX 7698
TYLER, TEXAS 75711

903 - 561-2900

FAX 903 - 561-1870

2005 APR 5 AM 10 27

April 4, 2005

UPS NEXT DAY AIR #N455 814 647 5

Mr. William Jones
New Mexico Oil Conservation Division
1220 S. St. Francis Drive
Santa Fe, NM 87505

RE: Form C-107A
Pecos River "9" #1
Sec 9 T22S R27E
Tansill Dam; Atoka, East (Gas) and Carlsbad; Morrow, South (Gas) Pools
Eddy Co., NM

Dear Mr. Jones:

Please find enclosed the following for the application to downhole commingle production from the Atoka and Morrow zones in the referenced well:

Form C-107A
Attachments information
Form C-102 for both zones
Administrative Application Checklist

If you need further information, please call me at (903) 561-2900.

Yours truly,



Janet Burns
Reg. Tech.

cc: NMOCD - Artesia
Hobbs
Midland
Allen Brinson
Wayne Jones
Don Russell

District I
1625 N. French Drive, Hobbs, NM 88240

District II
1301 W. Grand Avenue, Artesia, NM 88210

District III
1000 Rio Brazos Road, Aztec, NM 87410

District IV
1220 S. St. Francis Dr., Santa Fe, NM 87505

State of New Mexico
Energy, Minerals and Natural Resources Department

Form C-107A
Revised June 10, 2003

Oil Conservation Division

1220 South St. Francis Dr.
Santa Fe, New Mexico 87505

APPLICATION TYPE

☒ Single Well

☐ Establish Pre-Approved Pools

EXISTING WELLBORE

☒ Yes ☐ No

APPLICATION FOR DOWNHOLE COMMINGLING

DHC-3431

Mewbourne Oil Company P. O. Box 7698 Tyler, TX 75711
Operator Address

Pecos River "9" #1 I - Sec 9, T22S, R27E Eddy
Lease Well No. Unit Letter-Section-Township-Range County

OGRID No. 14744 Property Code 34150 API No. 30-015-33534 Lease Type: ☐ Federal ☒ State ☐ Fee

DATA ELEMENT	UPPER ZONE	INTERMEDIATE ZONE	LOWER ZONE
Pool Name	OK Tancillo Dam; Atoka, East		Carlsbad; Morrow, South
Pool Code	9532 85900		73960
Top and Bottom of Pay Section (Perforated or Open-Hole Interval)	11,170 - 11,248'		11,398 - 11,656'
Method of Production (Flowing or Artificial Lift)	Flowing		Flowing
Bottomhole Pressure (Note: Pressure data will not be required if the bottom perforation in the lower zone is within 150% of the depth of the top perforation in the upper zone)			
Oil Gravity or Gas BTU (Degree API or Gas BTU)			
Producing, Shut-In or New Zone	Producing		SI below plug
Date and Oil/Gas/Water Rates of Last Production. (Note: For new zones with no production history, applicant shall be required to attach production estimates and supporting data.)	Date: 4/4/05 Rates: 2000 MCF, 0 BO, 10 BW	Date: Rates:	Date: 2/28/05 Rates: 400 MCF, 0 BO, 2 BW
Fixed Allocation Percentage (Note: If allocation is based upon something other than current or past production, supporting data or explanation will be required.)	Oil Gas 0 % 33 %	Oil Gas % %	Oil Gas 0 % 67 %

ADDITIONAL DATA

Are all working, royalty and overriding royalty interests identical in all commingled zones? Yes ☒ No ☐

If not, have all working, royalty and overriding royalty interest owners been notified by certified mail? Yes ☐ No ☐

Are all produced fluids from all commingled zones compatible with each other? Yes ☒ No ☐

Will commingling decrease the value of production? Yes ☐ No ☒

If this well is on, or communitized with, state or federal lands, has either the Commissioner of Public Lands
or the United States Bureau of Land Management been notified in writing of this application? Yes ☐ N/A ☐ No ☐

NMOCD Reference Case No. applicable to this well: _____

Attachments:

- C-102 for each zone to be commingled showing its spacing unit and acreage dedication.
- Production curve for each zone for at least one year. (If not available, attach explanation.)
- For zones with no production history, estimated production rates and supporting data.
- Data to support allocation method or formula.
- Notification list of working, royalty and overriding royalty interests for uncommon interest cases.
- Any additional statements, data or documents required to support commingling.

PRE-APPROVED POOLS

If application is to establish Pre-Approved Pools, the following additional information will be required:

List of other orders approving downhole commingling within the proposed Pre-Approved Pools

List of all operators within the proposed Pre-Approved Pools

Proof that all operators within the proposed Pre-Approved Pools were provided notice of this application.

Bottomhole pressure data.

I hereby certify that the information above is true and complete to the best of my knowledge and belief.

SIGNATURE Janet Burns TITLE Reg. Tech. DATE 4/4/05

TYPE OR PRINT NAME Janet Burns TELEPHONE NO. (903) 561-2900

E-MAIL ADDRESS _____

Attachments to C-107A

Mewbourne Oil Company
Pecos River "9" #1
Unit Letter I, Sec 9 T22S R27E
Tansill Dam; Atoka, East (Gas) and Carlsbad; Morrow, South (Gas) Pools
Eddy Co., NM

C-102 for each zone to be commingled showing its spacing unit and acreage dedication

Production curve is not attached (new well)

Estimated production rates and supporting data

Test Data:

Morrow	2/28/05	400 MCFD, 0 BO, 2 BW: last recorded production
Atoka	4/4/05	200 MCFD, 0 BO, 10 BW: current production

Data to support allocation method or formula

Test as shown above for both zones

Notification list of working, royalty and overriding royalty interests for uncommon interest cases

No uncommon interests.

Any additional statements, data or documents required to support commingling

The well is completed with 4 1/2" OD casing. In order to dually complete the well to recover all economic reserves, the use of small diameter special clearance tubing would be required. Performing a dual completion as described could not be economically justified for a zone with limited deliverability. To produce the Atoka interval (upper zone) up the annulus (4 1/2" - 2 7/8") is not recommended due to liquid loading and insufficient velocity to lift produced fluids with the estimated gas rates listed above. The addition of the Atoka as a commingled zone will prevent waste that would not otherwise be possible due to the increased cost to produce each individual zone. Commingling will prevent early abandonment of each production zone.

DISTRICT II

811 South First, Artesia, NM 88210

DISTRICT III

1000 Rio Brazos Rd., Aztec, NM 87410

DISTRICT IV

2040 South Pacheco, Santa Fe, NM 87505

OIL CONSERVATION DIVISION

P.O. Box 2088

Santa Fe, New Mexico 87504-2088

☐ AMENDED REPORT

WELL LOCATION AND ACREAGE DEDICATION PLAT

API Number 30-015-33534		Pool Code	Pool Name Carlsbad South Morrow	
Property Code 34150	Property Name PECOS RIVER "9"		Well Number 1	
OGRID No. 14744	Operator Name MEWBOURNE OIL COMPANY		Elevation 3077	

Surface Location

UL or lot No.	Section	Township	Range	Lot Idn	Feet from the	North/South line	Feet from the	East/West line	County
1	9	22S	27E		1650	SOUTH	990	EAST	EDDY

Bottom Hole Location If Different From Surface

UL or lot No.	Section	Township	Range	Lot Idn	Feet from the	North/South line	Feet from the	East/West line	County

Dedicated Acres 320	Joint or Infill	Consolidation Code	Order No.
------------------------	-----------------	--------------------	-----------

NO ALLOWABLE WILL BE ASSIGNED TO THIS COMPLETION UNTIL ALL INTERESTS HAVE BEEN CONSOLIDATED
OR A NON-STANDARD UNIT HAS BEEN APPROVED BY THE DIVISION

	OPERATOR CERTIFICATION I hereby certify the the information contained herein is true and complete to the best of my knowledge and belief. <i>F. C. Lathan</i> Signature F. C. Lathan Printed Name Drilling Foreman Title 05/14/2004 Date	
	SURVEYOR CERTIFICATION I hereby certify that the well location shown on this plat was plotted from field notes of actual surveys made by me or under my supervision, and that the same is true and correct to the best of my belief. 5/05/2004 Date Surveyed <i>Michael L. Jones</i> Signature of Professional Surveyor Certificate No. Herschel Jones RLS 3640 PECOS RIVER GENERAL SURVEYING COMPANY	

0 330' 660' 990' 1650' 1980' 2310' 2310' 1980' 1650' 990' 660' 330' 0'

DISTRICT I
 1000 N. French Dr., Hobbs, NM 88240

DISTRICT II
 811 South First, Artesia, NM 88210

DISTRICT III
 10301 Rio Pecos Rd., Artesia, NM 87410

DISTRICT IV
 1000 South Pecos, Santa Fe, NM 87505

State of New Mexico
 Energy, Minerals and Natural Resources Department

Form C-100
 Revised March 17, 1999
 Instructions on back
 Submit to Appropriate District Office
 State Lease - 4 Copies
 Fee Lease - 3 Copies

OIL CONSERVATION DIVISION
 P.O. Box 2088
 Santa Fe, New Mexico 87504-2088

☐ AMENDED REPORT

WELL LOCATION AND ACREAGE DEDICATION PLAT

API Number 30-015-33534	Pool Code	Pool Name Atoka
Property Code 34150	Property Name PECOS RIVER "B"	Well Number 1
OGED No. 14744	Operator Name MEWBOURNE OIL COMPANY	Elevation 3077

Surface Location

UL or lot No.	Section	Township	Range	Lot Idn	Feet from the	North/South line	Feet from the	East/West line	County
1	9	22S	27E		1650	SOUTH	990	EAST	EDDY

Bottom Hole Location if Different From Surface

UL or lot No.	Section	Township	Range	Lot Idn	Feet from the	North/South line	Feet from the	East/West line	County
Dedicated Acres 320		Joint or Infill		Consolidation Code		Order No.			

**NO ALLOWABLE WILL BE ASSIGNED TO THIS COMPLETION UNTIL ALL INTERESTS HAVE BEEN CONSOLIDATED
 OR A NON-STANDARD UNIT HAS BEEN APPROVED BY THE DIVISION**

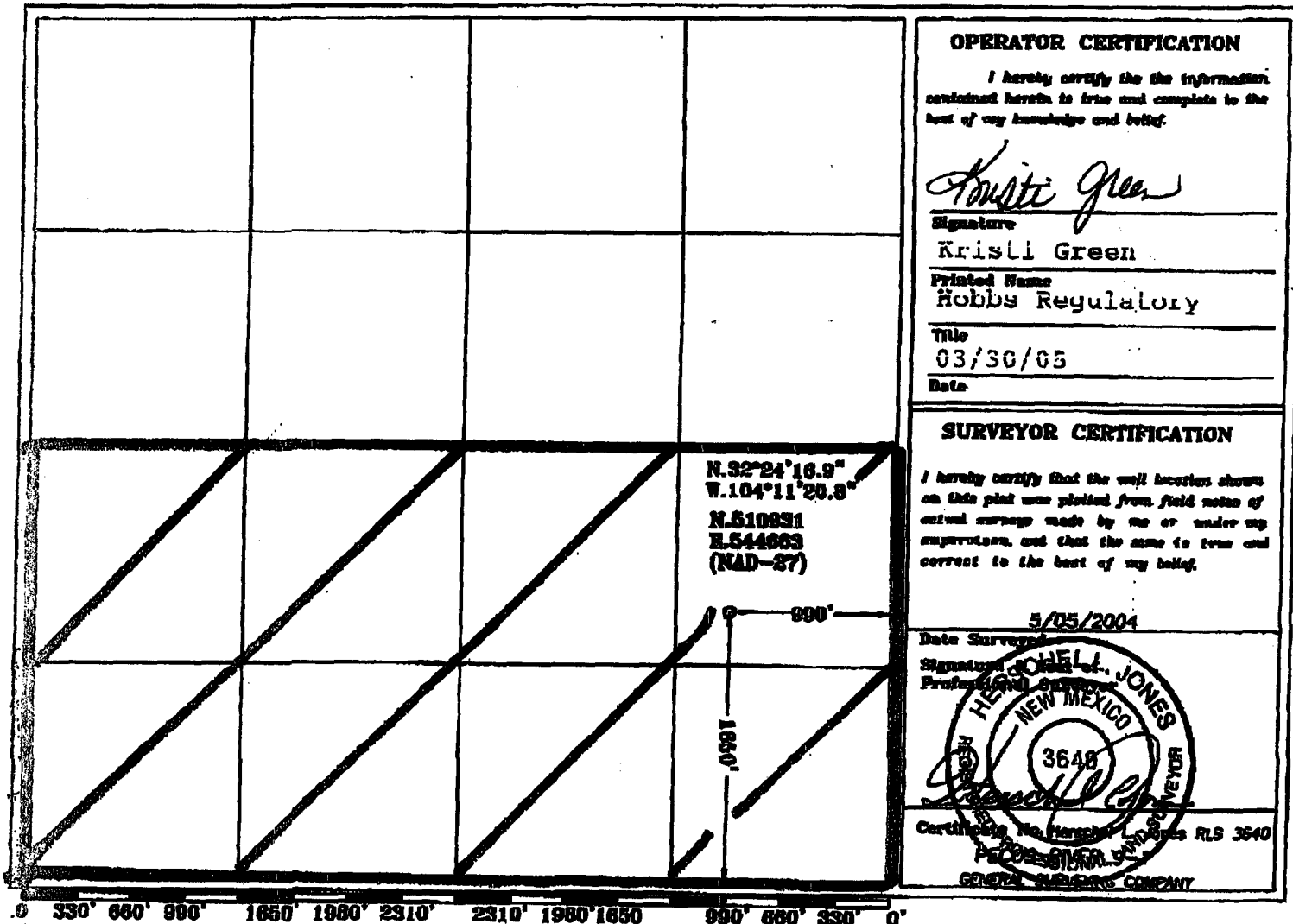

DATE IN <u>4/6/05</u>	SUSPENSE	ENGINEER <u>WVS</u>	LOGGED IN <u>4/6/05</u>	TYPE <u>DHC</u>	APP NO. <u>SEM 0509628719</u>
-----------------------	----------	---------------------	-------------------------	-----------------	-------------------------------

ABOVE THIS LINE FOR DIVISION USE ONLY

NEW MEXICO OIL CONSERVATION DIVISION
- Engineering Bureau -
 1220 South St. Francis Drive, Santa Fe, NM 87505



ADMINISTRATIVE APPLICATION CHECKLIST

THIS CHECKLIST IS MANDATORY FOR ALL ADMINISTRATIVE APPLICATIONS FOR EXCEPTIONS TO DIVISION RULES AND REGULATIONS WHICH REQUIRE PROCESSING AT THE DIVISION LEVEL IN SANTA FE

Application Acronyms:

[NSL-Non-Standard Location] [NSP-Non-Standard Proration Unit] [SD-Simultaneous Dedication]
[DHC-Downhole Commingling] [CTB-Lease Commingling] [PLC-Pool/Lease Commingling]
[PC-Pool Commingling] [OLS - Off-Lease Storage] [OLM-Off-Lease Measurement]
[WFX-Waterflood Expansion] [PMX-Pressure Maintenance Expansion]
[SWD-Salt Water Disposal] [IPI-Injection Pressure Increase]
[EOR-Qualified Enhanced Oil Recovery Certification] [PPR-Positive Production Response]

[1] TYPE OF APPLICATION - Check Those Which Apply for [A]

[A] Location - Spacing Unit - Simultaneous Dedication
☐ NSL ☐ NSP ☐ SD

Check One Only for [B] or [C]

[B] Commingling - Storage - Measurement
☒ DHC ☐ CTB ☐ PLC ☐ PC ☐ OLS ☐ OLM

[C] Injection - Disposal - Pressure Increase - Enhanced Oil Recovery
☐ WFX ☐ PMX ☐ SWD ☐ IPI ☐ EOR ☐ PPR

[D] Other: Specify _____

[2] NOTIFICATION REQUIRED TO: - Check Those Which Apply, or Does Not Apply

- [A]** ☐ Working, Royalty or Overriding Royalty Interest Owners
- [B]** ☐ Offset Operators, Leaseholders or Surface Owner
- [C]** ☐ Application is One Which Requires Published Legal Notice
- [D]** ☐ Notification and/or Concurrent Approval by BLM or SLO
U.S. Bureau of Land Management - Commissioner of Public Lands, State Land Office
- [E]** ☐ For all of the above, Proof of Notification or Publication is Attached, and/or,
- [F]** ☐ Waivers are Attached

[3] SUBMIT ACCURATE AND COMPLETE INFORMATION REQUIRED TO PROCESS THE TYPE OF APPLICATION INDICATED ABOVE.

[4] CERTIFICATION: I hereby certify that the information submitted with this application for administrative approval is accurate and complete to the best of my knowledge. I also understand that no action will be taken on this application until the required information and notifications are submitted to the Division.

Note: Statement must be completed by an individual with managerial and/or supervisory capacity.

Ken M. Calvert
 Print or Type Name

Ken M. Calvert
 Signature

Engineering Manager
 Title

4/4/05
 Date

 e-mail Address