

DATE IN <u>5/25/12</u>	SUSPENSE	ENGINEER <u>DB</u>	LOGGED IN <u>5/25/12</u>	TYPE <u>NSL</u>	APP NO. <u>1214653804</u>
------------------------	----------	--------------------	--------------------------	-----------------	---------------------------

ABOVE THIS LINE FOR DIVISION USE ONLY

## NEW MEXICO OIL CONSERVATION DIVISION

- Engineering Bureau -

1220 South St. Francis Drive, Santa Fe, NM 87505



*Apache*

*0 State #79*

### ADMINISTRATIVE APPLICATION CHECKLIST

*30-015-40312*

THIS CHECKLIST IS MANDATORY FOR ALL ADMINISTRATIVE APPLICATIONS FOR EXCEPTIONS TO DIVISION RULES AND REGULATIONS WHICH REQUIRE PROCESSING AT THE DIVISION LEVEL IN SANTA FE

*6636*

#### Application Acronyms:

**[NSL-Non-Standard Location] [NSP-Non-Standard Proration Unit] [SD-Simultaneous Dedication]**  
**[DHC-Downhole Commingling] [CTB-Lease Commingling] [PLC-Pool/Lease Commingling]**  
**[PC-Pool Commingling] [OLS - Off-Lease Storage] [OLM-Off-Lease Measurement]**  
**[WFX-Waterflood Expansion] [PMX-Pressure Maintenance Expansion]**  
**[SWD-Salt Water Disposal] [IPI-Injection Pressure Increase]**  
**[EOR-Qualified Enhanced Oil Recovery Certification] [PPR-Positive Production Response]**

#### [1] TYPE OF APPLICATION - Check Those Which Apply for [A]

[A] Location - Spacing Unit - Simultaneous Dedication  
☒ NSL ☐ NSP ☐ SD

Check One Only for [B] or [C]

[B] Commingling - Storage - Measurement  
☐ DHC ☐ CTB ☐ PLC ☐ PC ☐ OLS ☐ OLM

[C] Injection - Disposal - Pressure Increase - Enhanced Oil Recovery  
☐ WFX ☐ PMX ☐ SWD ☐ IPI ☐ EOR ☐ PPR

[D] Other: Specify \_\_\_\_\_

*P-26, 17S-28E*

#### [2] NOTIFICATION REQUIRED TO: - Check Those Which Apply, or ☒ Does Not Apply

[A] ☐ Working, Royalty or Overriding Royalty Interest Owners  
 [B] ☐ Offset Operators, Leaseholders or Surface Owner  
 [C] ☐ Application is One Which Requires Published Legal Notice  
 [D] ☐ Notification and/or Concurrent Approval by BLM or SLO  
U.S. Bureau of Land Management - Commissioner of Public Lands, State Land Office  
 [E] ☐ For all of the above, Proof of Notification or Publication is Attached, and/or,  
 [F] ☐ Waivers are Attached

#### [3] SUBMIT ACCURATE AND COMPLETE INFORMATION REQUIRED TO PROCESS THE TYPE OF APPLICATION INDICATED ABOVE.

[4] **CERTIFICATION:** I hereby certify that the information submitted with this application for administrative approval is **accurate** and **complete** to the best of my knowledge. I also understand that **no action** will be taken on this application until the required information and notifications are submitted to the Division.

Note: Statement must be completed by an individual with managerial and/or supervisory capacity.

David Catanach  
Print or Type Name

*David Catanach*  
Signature

Agent for Apache Corporation  
Title

*5/25/12*  
Date

*drcatanach@netscape.com*  
E-Mail Address

May 25, 2012

**Hand Delivered**

New Mexico Oil Conservation Division  
1220 S. St. Francis Drive  
Santa Fe, New Mexico 87505

Attention: Ms. Jami Bailey, CPG  
Division Director

Re: Application for Unorthodox Well Location  
D State Well No. 79  
API No. (30-015-40312)  
170' FSL & 990' FEL (Unit P)  
Section 26, T-17 South, R-28 East, NMPM,  
Eddy County, New Mexico

Dear Ms. Bailey:

Pursuant to Division Rule 19.15.15.13, Apache Corporation ("Apache") respectfully requests administrative approval of an unorthodox oil well location for its proposed D State No. 79. This well will be drilled as a development oil well in the Artesia Glorieta-Yeso Pool (96830).

The proposed D State No. 79 will be dedicated to an existing standard 40-acre oil spacing and proration unit in the Artesia Glorieta-Yeso Pool comprising the SE/4 SE/4 of Section 26. This unit is currently dedicated to Apache's: i) existing D State No. 2 (API No. 30-015-31421) located at a standard well location 990 feet from the South line and 430 feet from the East line; ii) existing D State No. 51 (API No. 30-015-38585) located at a standard well location 900 feet from the South line and 990 feet from the East line; and iii) existing D State No. 59 (API No. 30-015-38470) located at an unorthodox well location 290 feet from the South line and 175 feet from the East line.

The Artesia Glorieta-Yeso Pool is currently governed by Division Rule 19.19.15.9 which requires standard 40-acre oil spacing and proration units with wells to be located no closer than 330 feet to the outer boundary of the spacing unit.

The attached vicinity map shows that the proposed unorthodox well location is necessary in order to maintain a safe distance from an existing pipeline.

The affected offset tracts are the NE/4 NE/4 and NW/4 NE/4 of Section 35, Township 17 South, Range 28 East, NMPM, (see attached plat). These affected offset tracts are operated by Apache in the Artesia Glorieta-Yeso Pool. The working interest

ownership between the drill tract and the affected offset tracts is common. Consequently, notice of this application is not required to any party.

Attached is a Form C-102 showing the proposed well, spacing unit and other existing or proposed wells in the spacing unit, a plat showing the affected offset acreage, and a vicinity map.

In summary, approval of the application will provide Apache Corporation the opportunity to recover additional oil and gas reserves from the Artesia Glorieta-Yeso Pool underlying the SE/4 SE/4 of Section 26 that may otherwise not be recovered by the existing or proposed producing wells, thereby preventing waste, and will not violate correlative rights.

If you should have any questions, please call me at (505) 690-9453.

Sincerely,



David Catanach, Agent  
Apache Corporation  
303 Veterans Airpark Lane  
Suite 3000  
Midland, Texas 79705

Xc: OCD-Artesia

District I  
1625 N. French Dr., Hobbs, NM 88240  
District II  
1301 W. Grand Avenue, Artesia, NM 88210  
District III  
1000 Rio Brazos Rd., Aztec, NM 87410  
District IV  
1220 S. St. Francis Dr., Santa Fe, NM 87505

State of New Mexico  
Energy, Minerals & Natural Resources Department  
**OIL CONSERVATION DIVISION**  
1220 South St. Francis Dr.  
Santa Fe, NM 87505

Form C-102  
Revised July 16, 2010  
Submit one copy to appropriate  
District Office  
☐ AMENDED REPORT

**WELL LOCATION AND ACREAGE DEDICATION PLAT**

API Number <b>30-015-40312</b>		Pool Code <b>96830</b>	Pool Name <b>Artesia Glorieta-Yeso Pool</b>
Property Code <b>308712</b>	Property Name <b>D State</b>		Well Number <b>079</b>
OGRID No. <b>873</b>	Operator Name <b>Apache Corporation</b>		Elevation <b>3676'</b>

**Surface Location**

UL or lot no. <b>P</b>	Section <b>26</b>	Township <b>17 South</b>	Range <b>28 East</b>	Lot Idn	Feet from the <b>170</b>	North/South line <b>South</b>	Feet from the <b>990</b>	East/West line <b>East</b>	County <b>Eddy</b>
---------------------------	----------------------	-----------------------------	-------------------------	---------	-----------------------------	----------------------------------	-----------------------------	-------------------------------	-----------------------

**Bottom Hole Location If Different From Surface**

UL or lot no.	Section	Township	Range	Lot Idn	Feet from the	North/South line	Feet from the	East/West line	County
Dedicated Acres <b>40</b>		Joint or Infill		Consolidate Code		Order No.			

No Allowable will be assigned to this completion until all interests have been consolidated or a non-standard unit has been approved by the Division

				<p align="center"><b>OPERATOR CERTIFICATION</b></p> <p><i>I hereby certify that the information contained herein is true and complete to the best of my knowledge and belief, and that this organization either owns a working interest or unleased mineral interest in the land including the proposed bottomhole location or has a right to drill this well at this location pursuant to a contract with an owner of such a mineral or working interest, or to a voluntary pooling agreement or a compulsory pooling order heretofore entered by the Division.</i></p> <p>Signature _____ Date _____</p> <p>Printed Name _____</p> <p>E-mail Address _____</p>
				<p align="center"><b>SURVEYOR CERTIFICATION</b></p> <p><i>I hereby certify that the well location shown on this plat was plotted from field notes of actual surveys made by me or under my supervision, and that the same is true and correct to the best of my belief.</i></p> <p>Date of Survey _____</p> <p>Signature and Seal of Professional Surveyor: _____</p> <p>Certificate Number _____</p>

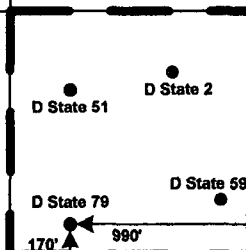

**28 East**

**26**

**25**

**17 South**

**D State 79**



**35**

**36**

Affected Offset Tracts  
Apache-Operator  
(WI ownership  
common w/drill tract)

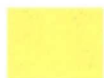

**Affected Offset Acreage**

**Apache Corporation**  
**Application for Non-Standard Well Location**  
**D State No. 79 (API No. 30-015-40312)**

**SECTION 26, TOWNSHIP 17 SOUTH, RANGE 28 EAST, N.M.P.M.,  
EDDY COUNTY, NEW MEXICO.**

**APACHE CORPORATION  
APACHE D STATE #79  
ELEV. - 3676'**

Lat - N 32°47'58.49"  
Long - W 104°08'30.25"  
NMSPCE- N 654673.598  
E 800209.301  
(NAD-83)

Lat - N 32°47'58.08"  
Long - W 104°08'28.41"  
NMSPCE- N 654610.502  
E 559030.199  
(NAD-27)

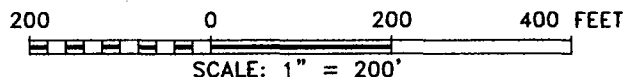
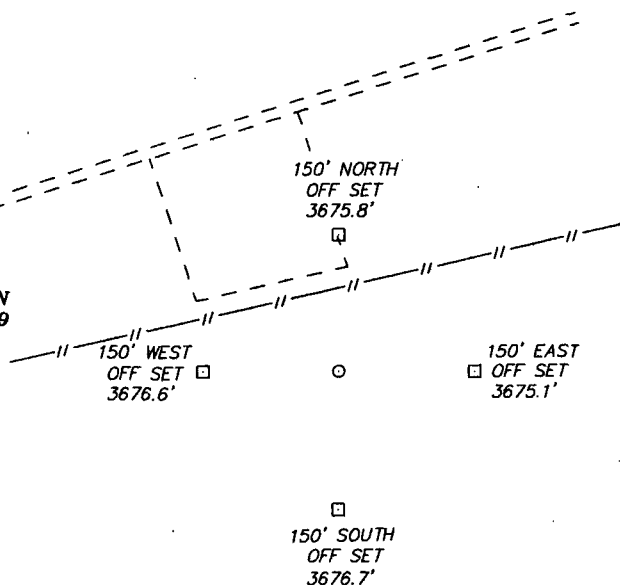

Directions to Location:

FROM MILE MARKER 124 GO WEST 0.7 MILES TO  
LEASE ROAD, GO SOUTH 0.1 MILES TURNING WEST  
0.7 MILES TO PROPOSED LOCATION.

**APACHE CORPORATION**

REF: APACHE D STATE #79 / WELL PAD TOPO

THE APACHE D STATE #79 LOCATED 170'

FROM THE SOUTH LINE AND 990' FROM THE EAST LINE OF

SECTION 26, TOWNSHIP 17 SOUTH, RANGE 28 EAST,

N.M.P.M., EDDY COUNTY, NEW MEXICO.

**BASIN SURVEYS** P.O. BOX 1786-HOBBS, NEW MEXICO

W.O. Number: 26702

Drawn By: J. SMALL

Date: 05-10-2012

Disk: JMS 26702

Survey Date: 05-07-2012

Sheet 1 of 1 Sheets