

DATE IN 5.25.12	SUSPENSE	ENGINEER RE	LOGGED IN 5.25.12	TYPE OLM	APP NO. 1214653372
-----------------	----------	-------------	-------------------	----------	--------------------

ABOVE THIS LINE FOR DIVISION USE ONLY

# NEW MEXICO OIL CONSERVATION DIVISION

- Engineering Bureau -

1220 South St. Francis Drive, Santa Fe, NM 87505



Devon 6137

Softshell 22 Feb #1

## ADMINISTRATIVE APPLICATION CHECKLIST

30-95-39727

THIS CHECKLIST IS MANDATORY FOR ALL ADMINISTRATIVE APPLICATIONS FOR EXCEPTIONS TO DIVISION RULES AND REGULATIONS WHICH REQUIRE PROCESSING AT THE DIVISION LEVEL IN SANTA FE

### Application Acronyms:

[NSL-Non-Standard Location] [NSP-Non-Standard Proration Unit] [SD-Simultaneous Dedication]  
 [DHC-Downhole Commingling] [CTB-Lease Commingling] [PLC-Pool/Lease Commingling]  
 [PC-Pool Commingling] [OLS - Off-Lease Storage] [OLM-Off-Lease Measurement]  
 [WFX-Waterflood Expansion] [PMX-Pressure Maintenance Expansion]  
 [SWD-Salt Water Disposal] [IPI-Injection Pressure Increase]  
 [EOR-Qualified Enhanced Oil Recovery Certification] [PPR-Positive Production Response]

### [1] TYPE OF APPLICATION - Check Those Which Apply for [A]

[A] Location - Spacing Unit - Simultaneous Dedication  
☐ NSL ☐ NSP ☐ SD

Check One Only for [B] or [C]

[B] Commingling - Storage - Measurement  
☐ DHC ☐ CTB ☐ PLC ☐ PC ☐ OLS ☒ OLM

[C] Injection - Disposal - Pressure Increase - Enhanced Oil Recovery  
☐ WFX ☐ PMX ☐ SWD ☐ IPI ☐ EOR ☐ PPR

[D] Other: Specify \_\_\_\_\_

### [2] NOTIFICATION REQUIRED TO: - Check Those Which Apply, or ☐ Does Not Apply

[A] ☒ Working, Royalty or Overriding Royalty Interest Owners

[B] ☐ Offset Operators, Leaseholders or Surface Owner

[C] ☐ Application is One Which Requires Published Legal Notice

[D] ☒ Notification and/or Concurrent Approval by BLM or SLO  
 U.S. Bureau of Land Management - Commissioner of Public Lands, State Land Office

[E] ☐ For all of the above, Proof of Notification or Publication is Attached, and/or,

[F] ☐ Waivers are Attached

### [3] SUBMIT ACCURATE AND COMPLETE INFORMATION REQUIRED TO PROCESS THE TYPE OF APPLICATION INDICATED ABOVE.

[4] **CERTIFICATION:** I hereby certify that the information submitted with this application for administrative approval is **accurate** and **complete** to the best of my knowledge. I also understand that **no action** will be taken on this application until the required information and notifications are submitted to the Division.

Note: Statement must be completed by an individual with managerial and/or supervisory capacity.

Melanie Crawford  
 Print or Type Name

Signature

Melanie Crawford

Regulatory Analyst  
 Title

3-7-12  
 Date

Melanie.Crawford@dmn.com  
 E-mail Address

OLM-63

22-255-31E

2012 MAY 25 AM 14

RECEIVED OOD



Devon Energy Production Company  
20 North Broadway - CT 3.058  
Oklahoma City, Oklahoma 73102-8260  
Phone: (405)-552-5424  
Fax (405)-552-8113  
[Melanie.Crawford@devn.com](mailto:Melanie.Crawford@devn.com)

March 7, 2012

Mr. Richard Ezeanyim  
State of New Mexico  
Oil Conservation Division  
1220 S. St. Francis Drive  
Santa Fe, New Mexico 87505

**Re: Off Gas Lease Measurement, Sales, & Storage  
Softshell 22 Federal 1  
Sec 22-T25S-R31E  
NM - 16131  
API 30-015-39727  
WC; Bone Spring Pool Code: 96053  
Eddy County, New Mexico**

RECEIVED OCD  
2012 MAY 25 A 10:14

Dear Mr. Ezeanyim:

Please find attached the OCD Form C-103, OCD Form C-107B and BLM Form 3160-5 Sundry Notice of Intent to Off Lease Gas Measurement, Sales, & Storage for the aforementioned wells.

The working interest, royalty interest and overriding royalty interest owners are not identical; parties have been notified via certified mail (see attached).

Should you require any additional information or assistance, please do not hesitate to contact me at (405)-552-4524.

Very truly yours,

**DEVON ENERGY PRODUCTION COMPANY, L.P.**

Melanie Crawford  
Regulatory Analyst

Enclosures

District I  
1625 N. French Drive, Hobbs, NM 88240  
District II  
1301 W. Grand Ave, Artesia, NM 88210  
District III  
1000 Rio Brazos Road, Aztec, NM 87410  
District IV  
1220 S. St Francis Dr, Santa Fe, NM  
87505

State of New Mexico  
Energy, Minerals and Natural Resources Department

Form C-107-B  
Revised June 10, 2003

### OIL CONSERVATION DIVISION

1220 S. St Francis Drive  
Santa Fe, New Mexico 87505

Submit the original  
application to the Santa Fe  
office with one copy to the  
appropriate District Office.

#### APPLICATION FOR SURFACE COMMINGLING (DIVERSE OWNERSHIP)

OPERATOR NAME: Devon Energy Production Co., LP

OPERATOR ADDRESS: 20 North Broadway, Oklahoma City, OK 73102

APPLICATION TYPE:

☐ Pool Commingling ☐ Lease Commingling ☐ Pool and Lease Commingling ☒ Off-Lease Storage and Measurement (Only if not Surface Commingled)

LEASE TYPE: ☐ Fee ☐ State ☐ Federal

Is this an Amendment to existing Order? ☐ Yes ☒ No If "Yes", please include the appropriate Order No. \_\_\_\_\_

Have the Bureau of Land Management (BLM) and State Land office (SLO) been notified in writing of the proposed commingling

☒ Yes ☐ No

#### (A) POOL COMMINGLING

Please attach sheets with the following information

(1) Pool Names and Codes	Gravities / BTU of Non-Commingled Production	Calculated Gravities / BTU of Commingled Production		Calculated Value of Commingled Production	Volumes

(2) Are any wells producing at top allowables? ☐ Yes ☐ No

(3) Has all interest owners been notified by certified mail of the proposed commingling? ☐ Yes ☐ No.

(4) Measurement type: ☐ Metering ☐ Other (Specify)

(5) Will commingling decrease the value of production? ☐ Yes ☐ No If "yes", describe why commingling should be approved

#### (B) LEASE COMMINGLING

Please attach sheets with the following information

- (1) Pool Name and Code.
- (2) Is all production from same source of supply? ☐ Yes ☐ No
- (3) Has all interest owners been notified by certified mail of the proposed commingling? ☐ Yes ☐ No
- (4) Measurement type: ☐ Metering ☐ Other (Specify)

#### (C) POOL and LEASE COMMINGLING

Please attach sheets with the following information

- (1) Complete Sections A and E.

#### (D) OFF-LEASE STORAGE and MEASUREMENT

Please attached sheets with the following information

- (1) Is all production from same source of supply? ☒ Yes ☐ No
- (2) Include proof of notice to all interest owners.

#### (E) ADDITIONAL INFORMATION (for all application types)

Please attach sheets with the following information

- (1) A schematic diagram of facility, including legal location.
- (2) A plat with lease boundaries showing all well and facility locations. Include lease numbers if Federal or State lands are involved.
- (3) Lease Names, Lease and Well Numbers, and API Numbers.

I hereby certify that the information above is true and complete to the best of my knowledge and belief.

SIGNATURE: Melanie Crawford TITLE: Regulatory Analyst

DATE: 3-7-12

TYPE OR PRINT NAME: Melanie Crawford TELEPHONE NUMBER: 405-552-4524

E-MAIL ADDRESS: Melanie.Crawford@dvn.com

Submit 3 Copies To Appropriate District Office  
District I  
1625 N. French Dr., Hobbs, NM 88240  
District II  
1301 W. Grand Ave., Artesia, NM 88210  
District III  
1000 Rio Brazos Rd., Aztec, NM 87410  
District IV  
1220 S. St. Francis Dr., Santa Fe, NM 87505

State of New Mexico  
Energy, Minerals and Natural Resources

Form C-103  
May 27, 2004

OIL CONSERVATION DIVISION  
1220 South St. Francis Dr.  
Santa Fe, NM 87505

WELL API NO. 30-015-39727
5. Indicate Type of Lease FED <input checked="" type="checkbox"/> STATE <input type="checkbox"/> FEE <input type="checkbox"/>
6. State Oil & Gas Lease No. NM-16131

SUNDRY NOTICES AND REPORTS ON WELLS (DO NOT USE THIS FORM FOR PROPOSALS TO DRILL OR TO DEEPEN OR PLUG BACK TO A DIFFERENT RESERVOIR. USE "APPLICATION FOR PERMIT" (FORM C-101) FOR SUCH PROPOSALS.)		7. Lease Name or Unit Agreement Name Softshell 22 Federal
1. Type of Well: Oil Well <input checked="" type="checkbox"/> Gas Well <input type="checkbox"/> Other <input type="checkbox"/>		8. Well Number 1
2. Name of Operator Devon Energy Production Company, LP		9. OGRID Number 6137
3. Address of Operator 20 North Broadway Oklahoma City, Oklahoma 73102-8260 (405) 552-4524		10. Pool name or Wildcat WC; Bone Spring
4. Well Location Unit Letter _____: _____ feet from the _____ line and _____ feet from the _____ line Section 22 Township 25S Range 31E NMPM Eddy County New Mexico		
11. Elevation (Show whether DR, RKB, RT, GR, etc.) n/a		
Pit or Below-grade Tank Application <input type="checkbox"/> or Closure <input type="checkbox"/>		
Pit type _____ Depth to Groundwater _____ Distance from nearest fresh water well _____ Distance from nearest surface water _____		
Pit Liner Thickness: _____ mil Below-Grade Tank: Volume _____ bbls; Construction Material _____		

12. Check Appropriate Box to Indicate Nature of Notice, Report or Other Data

NOTICE OF INTENTION TO:

PERFORM REMEDIAL WORK ☐ PLUG AND ABANDON ☐  
TEMPORARILY ABANDON ☐ CHANGE PLANS ☐  
PULL OR ALTER CASING ☐ MULTIPLE COMPL ☐  
OTHER: Off Lease Gas Measurement, Sales, & Storage ☒

SUBSEQUENT REPORT OF:

REMEDIAL WORK ☐ ALTERING CASING ☐  
COMMENCE DRILLING OPNS. ☐ P AND A ☐  
CASING/CEMENT JOB ☐  
OTHER: ☐

13. Describe proposed or completed operations. (Clearly state all pertinent details, and give pertinent dates, including estimated date of starting any proposed work). SEE RULE 1103. For Multiple Completions: Attach wellbore diagram of proposed completion or recompletion.

Devon Energy Production Co., LP respectfully requests to Off Lease Gas Measurement, Sales, & Storage the Softshell 22 Federal 1 well. The gas will flow 1<sup>st</sup> through a separator then through the Softshell Allocation Gas Meter before flowing to the DCP CDP Gas Sales Meter located at the Cotton Draw Booster Station located approximately 2 miles northeast in Sec 12-T25S-31E. No other wells are connected to the gas line and reported gas volumes are the CDP sales meter volumes.

ROW will or has already been obtained.

The working interest, royalty interest and overriding royalty interest owners are not identical; parties have been notified via certified mail (see attached).

\*Production numbers and DCP CDP meter number will be submitted by Sundry once available

I hereby certify that the information above is true and complete to the best of my knowledge and belief. I further certify that any pit or below-grade tank has been/will be constructed or closed according to NMOCD guidelines ☐, a general permit ☐ or an (attached) alternative OCD-approved plan ☐.

SIGNATURE: Melanie Crawford TITLE: Regulatory Analyst DATE: 3-7-12

Type or print name Melanie Crawford E-mail address: Melanie.Crawford@dvn.com Telephone No. (405) 552-4524  
For State Use Only

APPROVED BY: \_\_\_\_\_ TITLE \_\_\_\_\_ DATE \_\_\_\_\_

Conditions of Approval (if any):

Lime Rock Resources  
1111 Bagby Street  
Houston, TX 77002

Certified Mailing  
Number: 7010 1060  
0000 0920 4565

Leo A Riley  
141 S Center Street #200  
Casper, WY 82601

Certified Mailing  
Number: 7010 1060  
0000 0920 4572

ONRR  
Royalty Management Program  
PO Box 25627  
Denver, CO 80225-0627

Certified Mailing  
Number: 7010 1060  
0000 0920 4589



Devon Energy Corporation  
20 North Broadway  
Oklahoma City, OK 73102-8260

405 235 3611 Phone  
www.devonenergy.com

May 23, 2012

**CERTIFIED MAIL**  
**RETURN RECEIPT REQUESTED**

Interest Owners

Re: Request Off Lease Gas Measurement, Sales, & Storage  
Softshell 22 Federal 1  
Sec 22 T25S R31E  
API 30-015-39727  
Pool 96053 WC; Bone Spring  
Eddy County, New Mexico

Gentlemen:

This is to advise you that Devon Energy Production Company, LP, is filing an application with the New Mexico Oil Conservation Division ("NMOCD") seeking approval to permit the off lease gas measurement, sales, & storage for the following lease and pool.

A copy of our application submitted to the Division is attached.

Any objections or requests that a hearing should be held regarding this application must be submitted to the New Mexico Oil Conservation Division Santa Fe office within 20 days from the date of this letter.

Please contact the undersigned at (405) 552-4524 should you have any questions or need anything further.

Sincerely,

Devon Energy Production Company, L.P.

A handwritten signature in black ink that reads "Melanie Crawford". The signature is written in a cursive, flowing style.

Melanie Crawford  
Regulatory Analyst

Enclosure

FORM APPROVED  
OMB NO. 1004-0135  
Expires: July 31, 2010

**SUNDRY NOTICES AND REPORTS ON WELLS**  
Do not use this form for proposals to drill or to re-enter an abandoned well. Use form 3160-3 (APD) for such proposals.

**SUBMIT IN TRIPLICATE - Other instructions on reverse side.**

1. Type of Well <input checked="" type="checkbox"/> Oil Well <input type="checkbox"/> Gas Well <input type="checkbox"/> Other:		8. Well Name and No. SOFTSHELL 22 FEDERAL 1H ✓
2. Name of Operator DEVON ENERGY PRODUCTION CO E		9. API Well No. 30-015-39727
Contact: MELANIE A CRAWFORD Email: melanie.crawford@dvn.com		
3a. Address 20 NORTH BROADWAY OKLAHOMA CITY, OK 73102	3b. Phone No. (include area code) Ph: 405-552-4524	10. Field and Pool, or Exploratory WC; BONE SPRING
4. Location of Well (Footage, Sec., T., R., M., or Survey Description) Sec 22 T25S R31E		11. County or Parish, and State EDDY COUNTY COUNTY, NM

## 12. CHECK APPROPRIATE BOX(ES) TO INDICATE NATURE OF NOTICE, REPORT, OR OTHER DATA

TYPE OF SUBMISSION	TYPE OF ACTION				
<input checked="" type="checkbox"/> Notice of Intent	<input type="checkbox"/> Acidize	<input type="checkbox"/> Deepen	<input type="checkbox"/> Production (Start/Resume)	<input type="checkbox"/> Water Shut-Off	
<input type="checkbox"/> Subsequent Report	<input type="checkbox"/> Alter Casing	<input type="checkbox"/> Fracture Treat	<input type="checkbox"/> Reclamation	<input type="checkbox"/> Well Integrity	
<input type="checkbox"/> Final Abandonment Notice	<input type="checkbox"/> Casing Repair	<input type="checkbox"/> New Construction	<input type="checkbox"/> Recomplete	<input checked="" type="checkbox"/> Other	
	<input type="checkbox"/> Change Plans	<input type="checkbox"/> Plug and Abandon	<input type="checkbox"/> Temporarily Abandon	Off-Lease Measurem t	
	<input type="checkbox"/> Convert to Injection	<input type="checkbox"/> Plug Back	<input type="checkbox"/> Water Disposal		

13. Describe Proposed or Completed Operation (clearly state all pertinent details, including estimated starting date of any proposed work and approximate duration thereof. If the proposal is to deepen directionally or recomplate horizontally, give subsurface locations and measured and true vertical depths of all pertinent markers and zones. Attach the Bond under which the work will be performed or provide the Bond No. on file with BLM/BIA. Required subsequent reports shall be filed within 30 days following completion of the involved operations. If the operation results in a multiple completion or recompletion in a new interval, a Form 3160-4 shall be filed once testing has been completed. Final Abandonment Notices shall be filed only after all requirements, including reclamation, have been completed, and the operator has determined that the site is ready for final inspection.)

Devon Energy Production Co, LP respectfully requests to Off Lease Gas Measurement, Sales, & Storage the Softshell 22 Federal 1H well. The gas will flow 1st through a separator then through the Softshell Allocation Gas Meter before flowing to the DCP CDP Gas Sales Meter located at the Cotton Draw Booster Station located approximately 2 miles northeast in Sec 12-T25S-31E. No other wells are connected to the gas line and reported gas volumes are the CDP sales meter volumes.

**ROW will or has already been obtained.**

The working interest, royalty interest, and overriding royalty interest owners are not identical; parties have been notified via certified mail (see attached).

\*Production numbers and DCP CDP meter number will be submitted by Sundry once available.

SEE ATTACHED FOR

I, <b>MELANIE A CRAWFORD</b> , hereby certify that the foregoing is true and correct. Electronic Submission #133037 verified by the BLM Well Information System For <b>DEVON ENERGY PRODUCTION CO LP</b> , sent to the Carlsbad	
Name (Printed/Typed) <b>MELANIE A CRAWFORD</b>	Title <b>REGULATORY ANALYST</b>
Signature _____ (Electronic Submission)	Date <b>03/14/2012</b>

**THIS SPACE FOR FEDERAL OR STATE OFFICE USE**

Approved By <u>J. R. [Signature]</u>	Title <u>LPE7</u>	Date <u>4/6/12</u>
Conditions of approval, if any, are attached. Approval of this notice does not warrant or certify that the applicant holds legal or equitable title to those rights in the subject lease which would entitle the applicant to conduct operations thereon.	Office <u>CFO</u>	

Title 18 U.S.C. Section 1001 and Title 43 U.S.C. Section 1212, make it a crime for any person knowingly and willfully to make to any department or agency of the United States any false, fictitious or fraudulent statements or representations as to any matter within its jurisdiction.

SEE ATTACHED FOR  
CONDITIONS OF APPROVAL.

72788 0-00

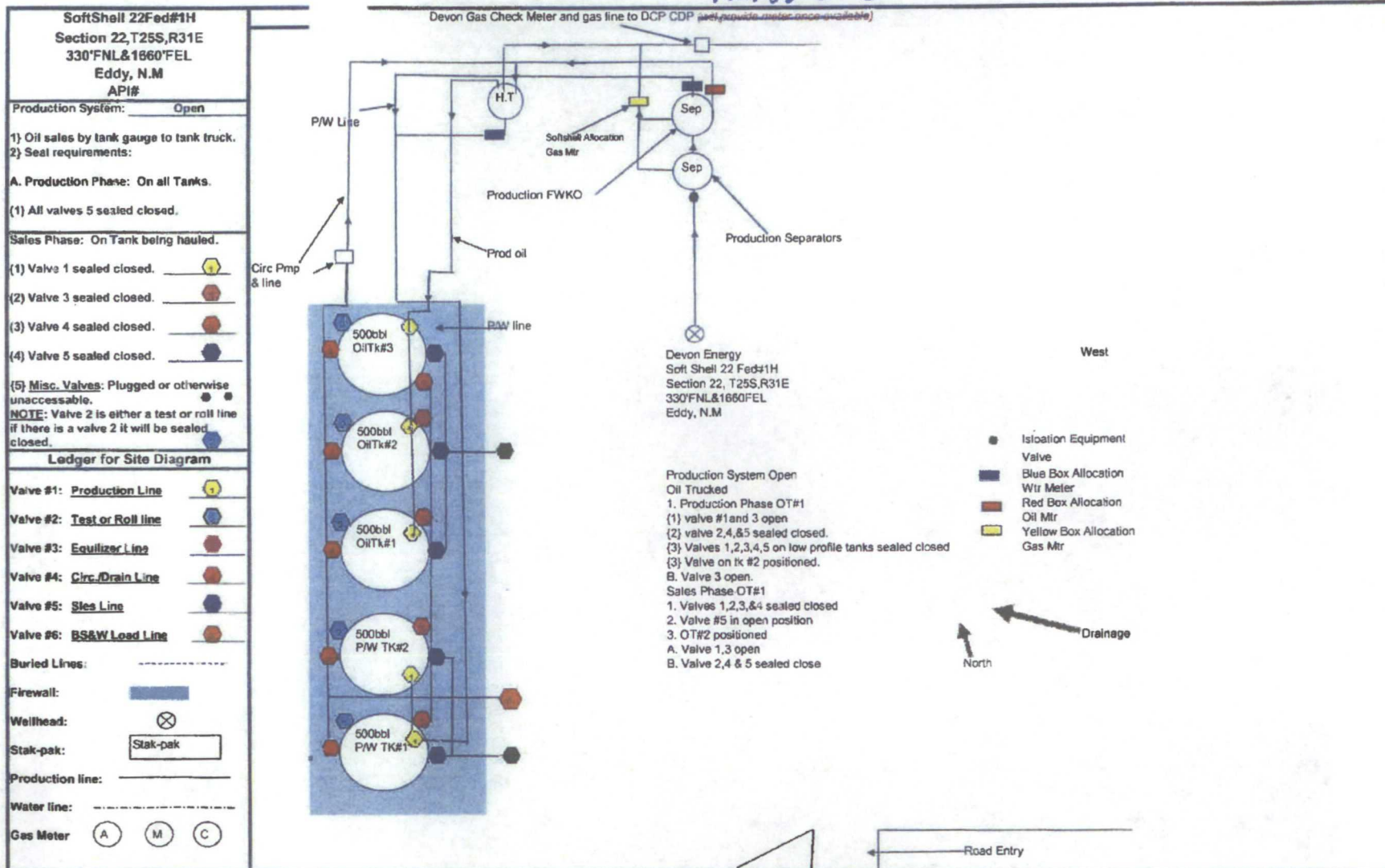

NMNM 120903

016

NMNM 0083082

NMNM 0000503

015

014

NMLC 0061862

NMLC 0061862B NMLC 0070707A

1H-Soitshel 22 Federal

NMLC 0061862A

021

NMNM 016131

022

023

NMLC 0062140

NMLC 0070707A

NMNM 016348

028

NMLC 0062140A

NMNM 125635

027

026

NMLC 0062140

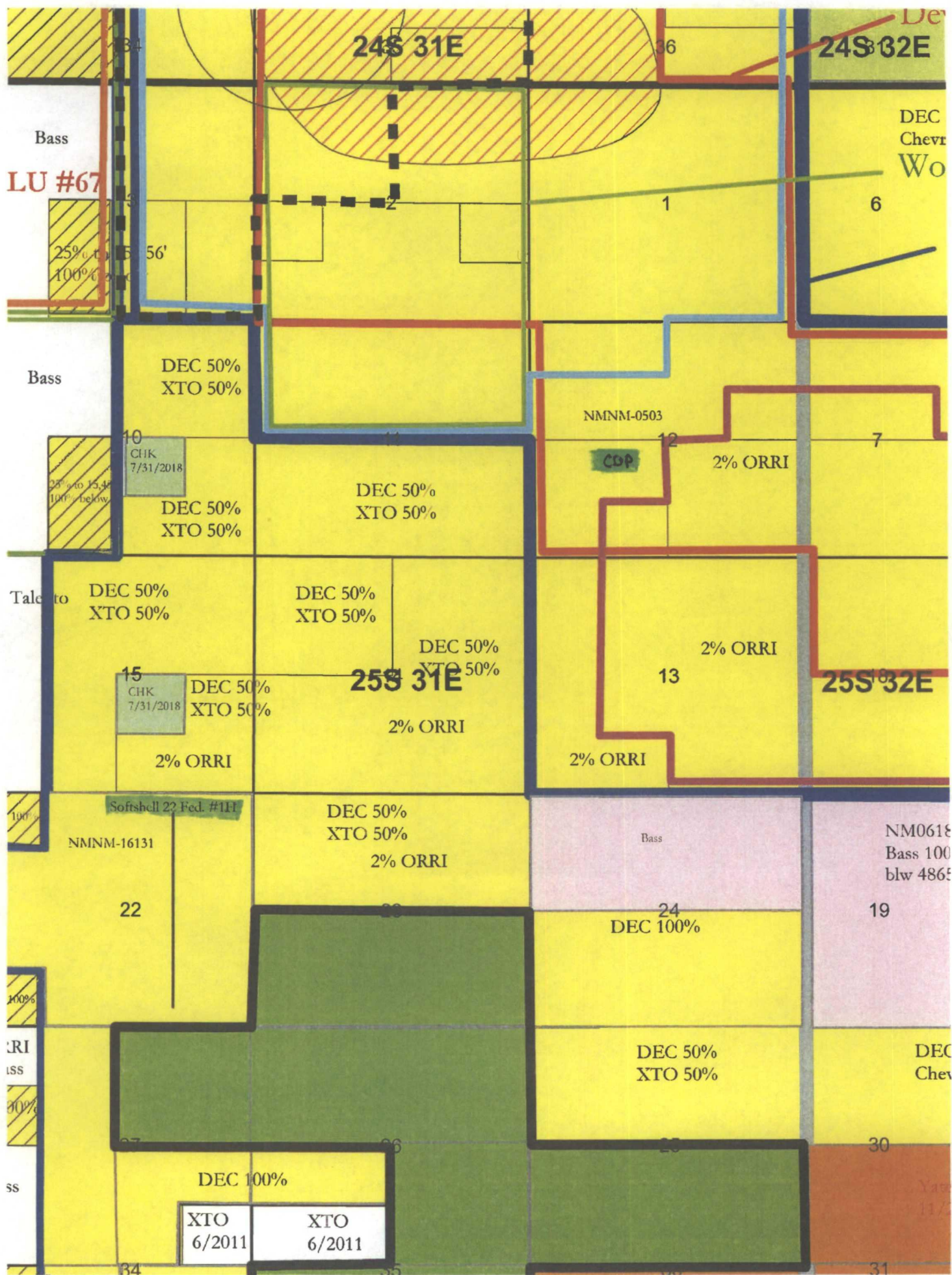

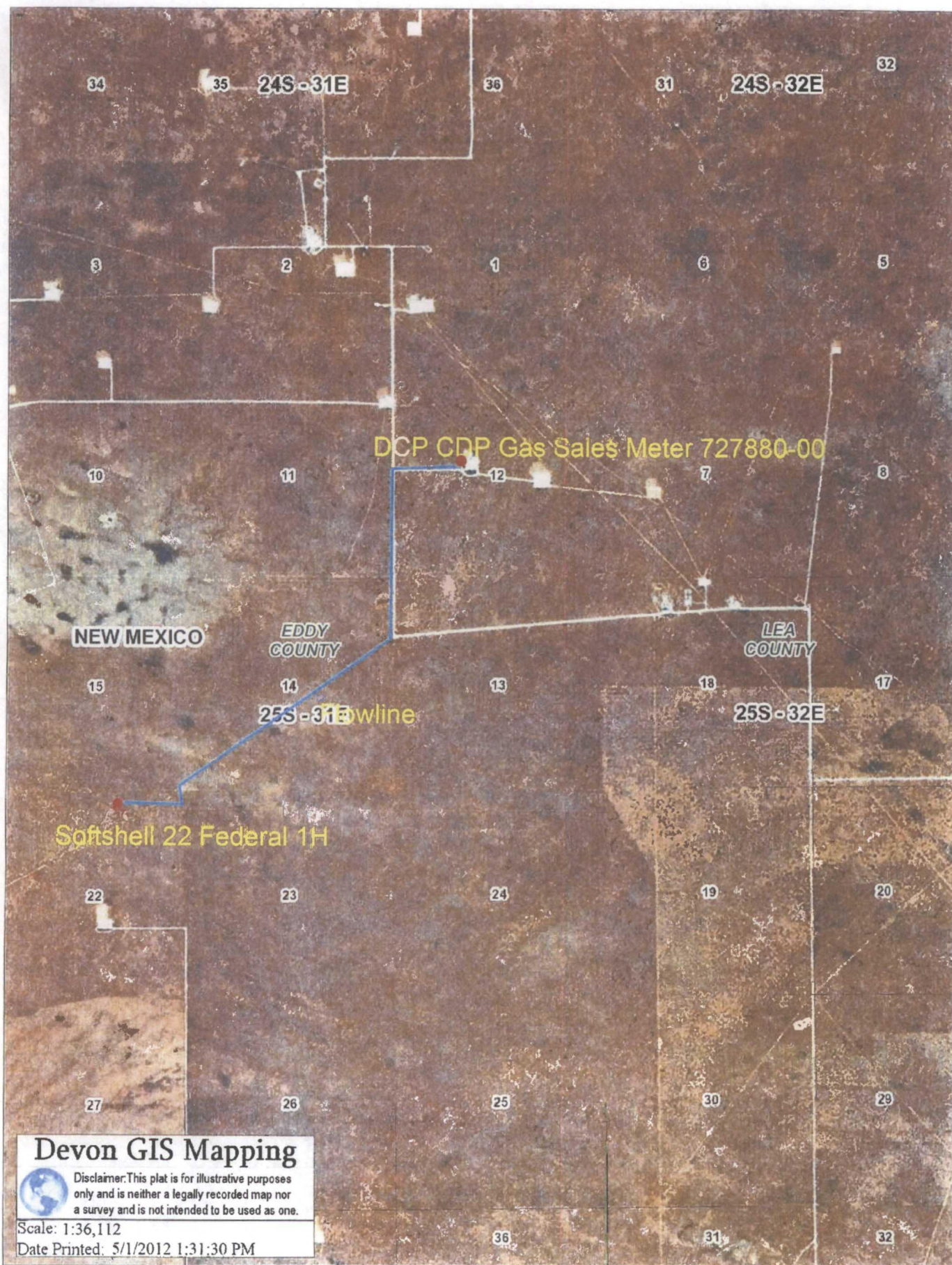

## Devon GIS Mapping



Disclaimer: This plat is for illustrative purposes only and is neither a legally recorded map nor a survey and is not intended to be used as one.

Scale: 1:36,112

Date Printed: 5/1/2012 1:31:30 PM

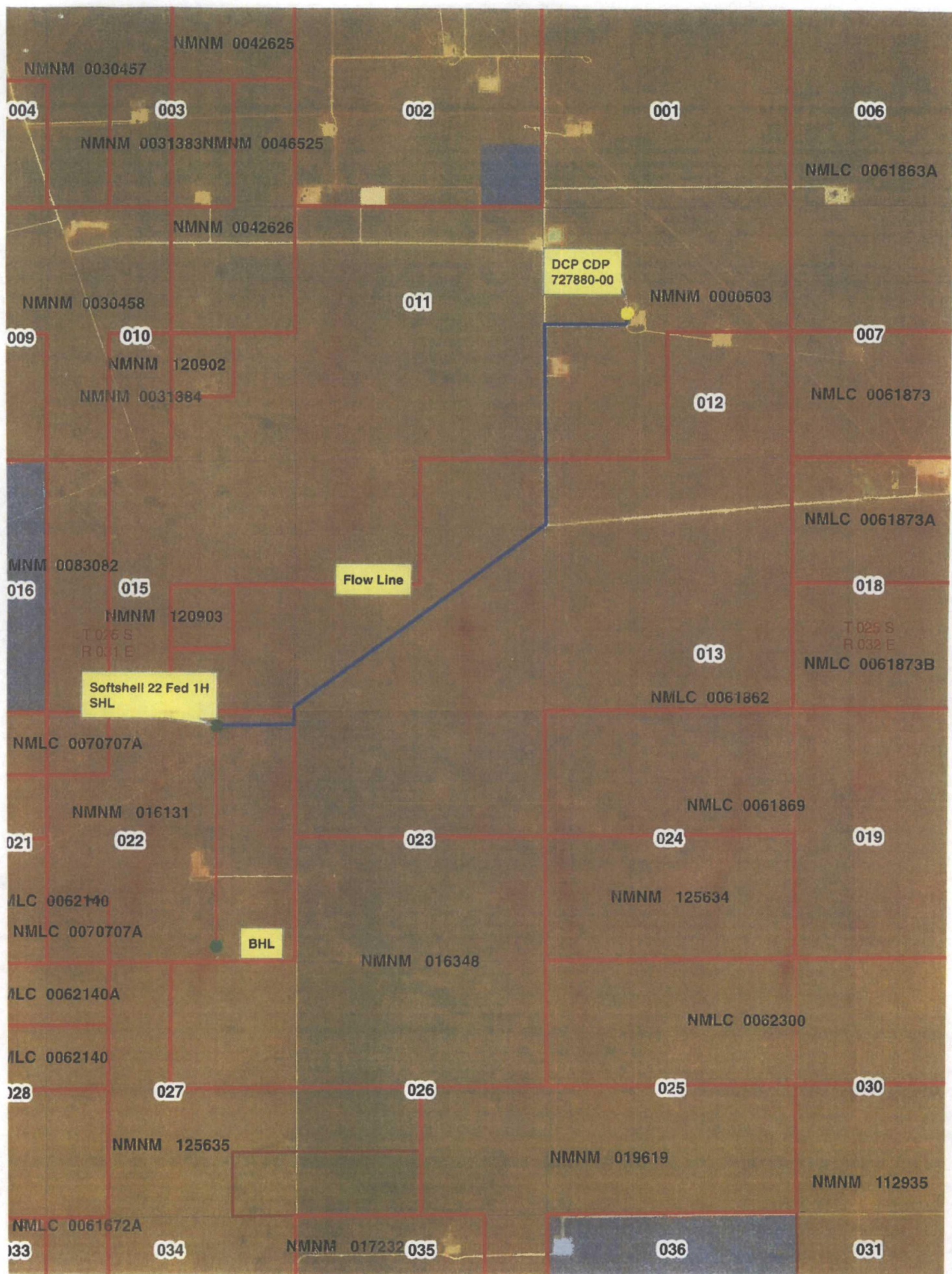

**Bureau of Land Management  
Carlsbad Field Office  
620 East Greene Street  
Carlsbad, New Mexico 88220  
575-234-5972**

**Off-Lease Measurement**

**Conditions of Approval: Devon Energy Production Co.  
Softshell 22 Federal 1H  
NM16131 3001539727**

Approval of off-lease measurement is subject to the following conditions of approval:

1. This agency shall be notified of any change in sales method or location of the Sales point.
2. This agency shall be notified of any spill or discharge as required by NTL-3A. No gas may be vented without proper measurement and prior approval. Any gas vented must be flared.
3. This agency reserves the right to modify or rescind approval whenever it determines continued use of the approved method may adversely affect the surface or subsurface environments.
4. This approval is subject to like approval by the New Mexico Oil Conservation Division.
5. Additional wells and/or leases require additional approvals.
6. This approval does not constitute right-of-way approval for any off-lease activities. Within 30 days, an application for right-of-way approval must be submitted to the Realty Section if not already done.
7. Approval for off-lease measurement from various sources is a privilege which is granted to lessees for the purpose of aiding conservation and extending the economic life of leases. Applicants should be cognizant that failure to operate in accordance with the provisions outlined in the Authorized Officer's conditions of approval and/or subsequent stipulations or modifications will subject such approval to revocation.
8. All above-ground structures not subject to safety requirements shall be painted by the holder to blend with the natural color of the landscape. The paint used shall be color which simulates "standard Environmental Colors" – Shale Green, Munsell Soil Color No. 5Y 4/2.