

509P
4-18-2005

PMESD-509137579



**Southwestern Energy
Production Company**

A subsidiary of Southwestern Energy Company

2350 N. Sam Houston Parkway East
Suite 300
Houston, Texas 77032
(281) 618-4700 FAX: (281) 618-4757

March 22, 2005

Michael E. Stogner
Oil Conservation Division
1220 South St. Francis Drive
Santa Fe, New Mexico 87505

RECEIVED

MAR 23 2005

OIL CONSERVATION
DIVISION

Dear Mr. Stogner:

Pursuant to Division Rule 104.F.(2), Southwestern Energy Production Company applies for approval of an unorthodox oil well location for the following well:

Well: No Bluff State Well No. 6
Location: 1050 feet FNL & 330 feet FWL
Well Unit: NW $\frac{1}{4}$ NW $\frac{1}{4}$ of Section 36, Township 17 South, Range 27 East, N.M.P.M., Eddy County, New Mexico

The well will be drilled to test the Glorieta/Yeso formations (Northeast Red Lake Glorieta-Yeso Pool). The pool is spaced on 40 acres, with wells to be located no closer than 330 feet to a quarter-quarter section line. A form C-102 for the well is attached as Exhibit A.

The location is based on engineering reasons. Applicant has drilled two Glorieta/Yeso wells in the W $\frac{1}{2}$ NW $\frac{1}{4}$ of Section 36 (the No Bluff State Well No. 3, located 2264 feet FNL & 366 feet FWL, and the No Bluff State Well No. 4, located 1765 feet FNL & 330 feet FWL). Based on the evidence presented in Division Case No. 13185, which increased the allowable in the pool, one well will not adequately drain a 40 acre well unit. Therefore, applicant intends to drill three or four wells per well unit. Drilling the well at its proposed location will allow other wells to be located and drilled in such a way as to maximize recovery from the well unit.

Attached as Exhibit B is a land plat. The W $\frac{1}{2}$ NW $\frac{1}{4}$ of Section 36 is covered by State Lease V-5512, which has common interest ownership as to all depths. The proposed well only encroaches on the interior quarter-quarter section line of the lease, and as a result notice of this application was not provided to any offset interest owners.

Please call if you have any questions. I can be reached at 281-618-4749.

Very truly yours,

W. Kurt Butler

W. Kurt Butler
Southwestern Energy Production Co.

WKB/skl

9:10 AM 4-12-2005
Talked w/ Kurt Butler
1) will send geological support info.
2) amended location for a move 50
feet further South
3) topo map showing surface features
that further restrict
location
R-12199 J.M.S.

State of New Mexico

Energy, Minerals and Natural Resources Department

DISTRICT I

1025 N. FRANKLIN DR., ALBUQUERQUE, NM 87102

DISTRICT II

1204 W. GRAND AVENUE, ALBUQUERQUE, NM 87102

DISTRICT III

1000 Rio Grande Rd., Aztec, NM 87410

DISTRICT IV

1025 N. ST. FRANCIS DR., SANTA FE, NM 87505

OIL CONSERVATION DIVISION

1220 SOUTH ST. FRANCIS DR.
Santa Fe, New Mexico 87505

Form C-102

Revised JUNE 10, 2003

Submit to Appropriate District Office

State Lease - 4 Copies

Fee Lease - 3 Copies

WELL LOCATION AND ACREAGE DEDICATION PLAT

☐ AMENDED REPORT

API Number	Pool Code	Pool Name
Property Code	Property Name NO BLUFF STATE COM	Well Number 6
OGRID No.	Operator Name SOUTHWESTERN ENERGY PRODUCTION COMPANY	Elevation 3571'

Surface Location

UL or lot No.	Section	Township	Range	Lot Idn	Feet from the	North/South line	Feet from the	East/West line	County
D	36	17-S	27-E		1050	NORTH	330	WEST	EDDY

Bottom Hole Location If Different From Surface

UL or lot No.	Section	Township	Range	Lot Idn	Feet from the	North/South line	Feet from the	East/West line	County
Dedicated Acres	Joint or Infill	Consolidation Code	Order No.						

NO ALLOWABLE WILL BE ASSIGNED TO THIS COMPLETION UNTIL ALL INTERESTS HAVE BEEN CONSOLIDATED
OR A NON-STANDARD UNIT HAS BEEN APPROVED BY THE DIVISION

	<p>GEODETIC COORDINATES NAD 27 NME</p> <p>Y=652906.8 N X=528916.3 E</p> <p>LAT.=32°47'41.62" N LONG.=104°14'21.23" W</p>		<p>OPERATOR CERTIFICATION</p> <p>I hereby certify the the information contained herein is true and complete to the best of my knowledge and belief.</p> <p>Signature _____</p> <p>Printed Name _____</p> <p>Title _____</p> <p>Date _____</p>
	<p>SURVEYOR CERTIFICATION</p> <p>I hereby certify that the well location shown on this plat was plotted from field notes of actual surveys made by me or under my supervision, and that the same is true and correct to the best of my belief.</p> <p>MARCH 12, 2005</p> <p>Date Surveyed _____</p> <p>Signature of Surveyor _____</p> <p>Professional Surveyor _____</p>		<p>DEL</p> <p>05-11-0394</p> <p>12841</p>
	<p>Barry J. Edson</p> <p>05-11-0394</p> <p>12841</p>		<p>17/05</p>
	<p>Barry J. Edson</p> <p>05-11-0394</p> <p>12841</p>		<p>17/05</p>

T17S - R 27E

S D X RESOURCES INC
Tiger Federal
318710000 4
3,805

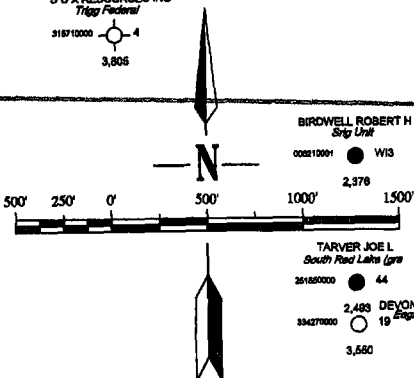

S D X RESOURCES INC
Enron Federal
322820000 8
3,220

MACK ENERGY CORP
Beech Federal
306120000 1
7,244

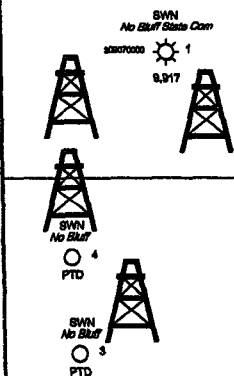

RESER OIL CO
Donahue
008160001 1
2,435

MACK ENERGY CORP
Enron Federal
322820000 5
3,185

MACK ENERGY CORP
Beech Federal
317900000 2
7,800

S D X RESOURCES INC
Enron Federal
322820000 6
3,180

S D X RESOURCES INC
Enron Federal
321900000 3
3,177

MACK ENERGY CORP
Beech Federal
317900000 2
7,800

MARBOS ENERGY CORP
State 25
318270000 1
8,130

MACK ENERGY CORP
Beech Federal
320390000 3
7,861

MARBOS ENERGY CORP
State 25
318640000 2
8,180

S D X RESOURCES INC
Rustler State
318830000 1
3,600

S D X RESOURCES INC
Jeffers 35 State
3186410000 3
3,528

SWESTERN ENERGY PROD
No Bluff 35 State
311230000 2
10,050

35

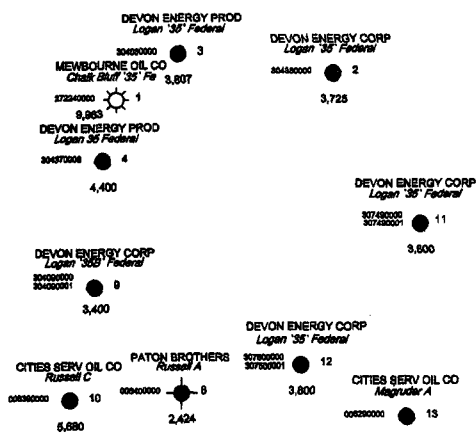

36

BIRDWELL ROBERT H
Strip Unit
005760001 W120
2,578

S & J OPERATING CO
Abo Federal
005760001 1
5,848

PAN AMERICAN
South Red Lake (44, 2,483; 19, 3,560)

S & J OPERATING CO
Dooley State
005760001 3
5,865

YATES MARTIN III
South Red Lake (44, 2,483; 19, 3,560)

YATES MARTIN III
Dooley State
005760001 2
5,970

KERSEY & COMPANY
Ramapo State
005760001 5
5,883

MEWBOURNE OIL CO
Chalk Bluff 35 St
005760001 1
5,795

PAN AMERICAN
State Eb
005760001 1
5,795

BURNHAM OIL CO INC
State A
005760001 1
2,200

GULF OIL CORP
Edley State Not
012810000 1
5,200

YATES MARTIN III
Dooley State
012180000 1
5,925

KERSEY & COMPANY
Ramapo State
005760001 4
6,013

DEVON
Logan 35 State
320110000 3
3,688

CITIES SERV OIL CO
Wright State A
007280000 4
5,881

ATLANTIC RICHFIELD CO
Hudson State A
007280000 1
5,920

MARBOS
Tall State
320000000 2
4,000

SPEIR ARCHIE M
Strip Unit
007410000 1
5,884

MARBOS ENER
Beech State
320000000 1
3,882

ARCO O&G
Empire Abo Unit K
320000000 143
6,108

ATLANTIC REFG CO
State A
007280000 15
6,100

T18S

R 27E

MARBOS ENERGY CORP
Abo Federal
320000000 1
3,881

PAN AMERICAN
Malco Refining-R
007120000 10
5,900

MARBOS ENERGY CORP
Abo Federal
320000000 2
4,160

PAN AMERICAN
Malco Refining-R
007120000 8
5,173

MARBOS ENERGY CORP
Abo Federal
320000000 3
4,125

PAN AMERICAN
Malco Refining-R
007120000 6
6,078

PAN AMERICAN
Malco Refining-R
012180000 11
5,118

MARBOS ENERGY CORP
Abo Federal
320100000 4
4,100

MARBOS ENERGY
Abo Federal
320000000 2
3,881

PAN AMERICAN
Malco Refining-R
007120000 2
5,980

PAN AMERICAN
Malco Refining-R
007120000 4
6,087

ATLANTIC RICHFIELD CO
Empire Abo Unit K
320000000 183
6,210

ATLANTIC RICHFIELD CO
Empire Abo Unit K
320000000 181
6,203

PAN AMERICAN
Malco Refining-R
007120000 5
6,163



SOUTHWESTERN ENERGY PRODUCTION COMPANY

**NO BLUFF PROSPECT
EDDY COUNTY, NEW MEXICO**

LAND MAP

INTERP. BY: CHUCK CORNISH	DATE: 21-MAR-05
DRAFTED BY:	CADFILE: 21/NoBluff.mxd
PROJECTION: New Mexico East	NAD 27