

Re: 10/21/85

By Michael S. Stogner

Houston Division  
Production Operations, United States



**Marathon  
Oil Company**

P.O. Box 2409  
Hobbs, New Mexico 88240  
Telephone 505/393-7106

NSP-1474

Rule 5(C)3. of Order No. R-6012

September 24, 1985

existing well

Oil Conservation Division  
P. O. Box 2088  
Santa Fe, New Mexico 87501  
Attn: Division Director

Re: Non-Standard Gas Proration Unit, Tubb Gas Pool, J. L. Muncy Well No. 1, Lea County, New Mexico. <sup>Oil</sup> Consisting of the E/2 SW/4 and the S/2 SE/4 of 24, 22S, 37E

Dear Sir:

Marathon Oil Company requests administrative approval for a non-standard gas proration unit for the J. L. Muncy Well No. 1. The legal description of this well is as follows:

660' FEL & 660' FSL  
Unit P, Section 24, T22S, R37E  
Lea County, New Mexico

A non-standard gas proration unit consisting of the E/2 SW 1/4 and the S/2 SE 1/4 is requested for this well. Administrative approval is required for this 160 acre unit because it crosses quarter section lines. There is one other Tubb gas well located on this lease. The J. L. Muncy Well No. 6 is one location north of Well No. 1 in Unit I. This is a newly drilled well. Production from Well No. 6 is 1.4 MMCFPD, while Well No. 1 produces 111 MCFPD.

Offset operators have been notified as required by special pool rules for the Tubb Oil and Gas Pool. Copies of the letter and the receipts are enclosed. If any further information is needed, please contact this office. Thank you.

Sincerely,

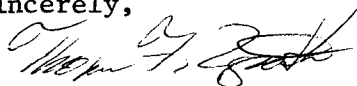
  
Thomas F. Zapatka

cc: W. D. Holmes  
N. R. Daniels  
C. R. Hubacher  
District Oil Conservation Division - Hobbs

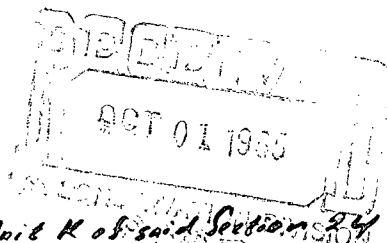

\*  
Remarks: The applicants J.L. Muncy Well No. 2 located in Unit K of said Section 24 is temporarily abandoned in the Tubb Oil & Gas Pool, Division Order No. R-1232 approved a 160-acre non-standard gas proration unit consisting of the S/2 NE/4, NW/4 SE/4, and the NE/4 SW/4 of said Section 24 to be dedicated to the J.L. Muncy Well No. 2 and a 160-acre non-standard gas proration unit consisting of the SE/4 SW/4, S/2 SE/4, and the NE/4 SE/4 of said Section 24 to be dedicated to the J.L. Muncy Well No. 1. <sup>of said Order R-1232</sup> <sup>the subject</sup> Ordering Paragraphs Nos. (3) and (5) are hereby placed in abeyance ~~until~~ until further notice.

## OIL CONSERVATION DIVISION

STATE OF NEW MEXICO  
ENERGY AND MINERALS DEPARTMENTP. O. BOX 2088  
SANTA FE, NEW MEXICO 87501Form C-102  
Revised 10-1-78

All distances must be from the outer boundaries of the Section.

Operator Marathon Oil Company			Lease J. L. Muncy			Well No. 1		
Unit Letter P	Section 24	Township 22S	Range 37E	County Lea				
Actual Footage Location of Well: 660 feet from the East line and 660 feet from the South line								
Ground Level Elev. 3321	Producing Formation Tubb			Pool Tubb Gas			Dedicated Acreage: 160 Acres	

1. Outline the acreage dedicated to the subject well by colored pencil or hatchure marks on the plat below.
2. If more than one lease is dedicated to the well, outline each and identify the ownership thereof (both as to working interest and royalty).
3. If more than one lease of different ownership is dedicated to the well, have the interests of all owners been consolidated by communitization, unitization, force-pooling, etc?

☐ Yes ☐ No If answer is "yes," type of consolidation \_\_\_\_\_

If answer is "no," list the owners and tract descriptions which have actually been consolidated. (Use reverse side of this form if necessary.) \_\_\_\_\_

No allowable will be assigned to the well until all interests have been consolidated (by communitization, unitization, forced-pooling, or otherwise) or until a non-standard unit, eliminating such interests, has been approved by the Division.

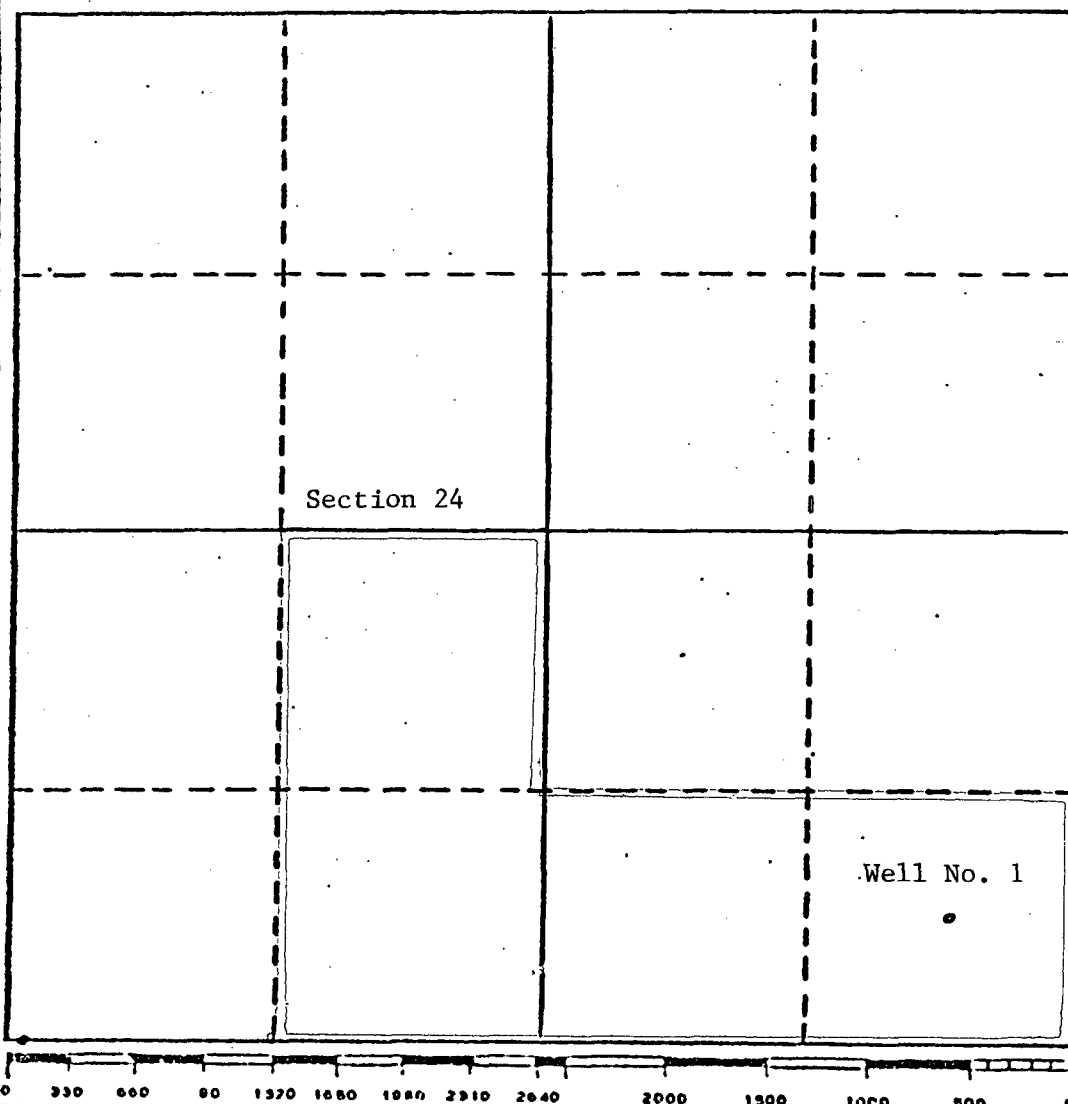

## CERTIFICATION

I hereby certify that the information contained herein is true and complete to the best of my knowledge and belief.

Name

Thomas F. Zapatka/

Position

Production Engineer

Company

Marathon Oil Company

Date

September 25, 1985

I hereby certify that the well location shown on this plat was plotted from field notes of actual surveys made by me or under my supervision, and that the same is true and correct to the best of my knowledge and belief.

Date Surveyed

 Registered Professional Engineer  
and/or Land Surveyor

Certificate No.





P.O. Box 2409  
Hobbs, New Mexico 88240  
Telephone 505/393-7106

September 25, 1985

To: Offset Operators

Re: Non-Standard Gas Proration Unit,  
J. L. Muncy Well No. 1 (Tubb Gas)  
Section 24, T22S, R37E  
Lea County, New Mexico

Dear Sir;

Marathon Oil Company has requested the Oil Conservation Division for administrative approval for a non-standard gas proration unit for the J. L. Muncy Well No. 1. The exact legal description for this well is as follows:

660' FEL & 660' FSL  
Unit P, Section 24, T22S, R37E  
Lea County, New Mexico

The pool rules for the Tubb Oil & Gas Pool require gas wells to be located on a tract consisting of 160 surface acres in the form of a square, which is a quarter section. The proposed acreage dedication is illustrated on the attached Form C-102. This non-standard unit is the result of a newly drilled Tubb completion located just north of Well No. 1. Production from this new well, J. L. Muncy Well No. 6, tested at a rate of 1.4 MMCFPD; Well No. 1 produces 111 MCFPD.

As stated in the Special Pool Rules for the Tubb Oil & Gas Pool, the Division Director may grant approval to this application provided no offset operator has entered an objection within 30 days after receiving the application. If you have any questions regarding this matter, please contact this office. Thank you.

Sincerely,

A handwritten signature in cursive script, appearing to read 'Thomas F. Zapotka'.

Thomas F. Zapotka

TFZ/js

OFFSET OPERATORS

J. L. Muncy Lease  
Lea County, New Mexico

Chevron Oil Company  
P. O. Box 670  
Hobbs, New Mexico 88240

Hanson Operating Company  
P. O. Box 1515  
Roswell, New Mexico 88202-1515

Phillips Petroleum Company  
4001 Penbrook  
Odessa, Texas 79762

John Hendrix  
525 Midland Tower  
Midland, Texas 79701

Crown Central Petroleum  
Building K, Suite 200  
731 West Wadley  
Midland, Texas 79701

Sun Exploration & Production Company  
P. O. Box 1861  
Midland, Texas 79702

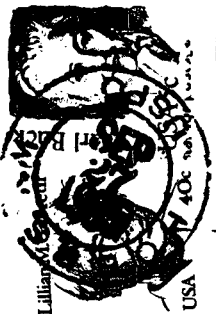

U.S. POSTAL SERVICE  
CERTIFICATE OF MAILING

Received From:

Marathon Oil Co

P.O. Box 2405

Hobbs, New Mexico 88240

One piece of ordinary mail addressed to:

John H. Hester

525 Highland Tower

Highland 72 79701

MAY BE USED FOR DOMESTIC AND INTERNATIONAL MAIL, DOES NOT PROVIDE FOR INSURANCE - POSTMASTER

PS FORM 3817

\*U.S. GOVERNMENT PRINTING OFFICE: 1984 - 756-868



U.S. POSTAL SERVICE  
CERTIFICATE OF MAILING

Received From:

Marathon Oil Company

P.O. Box 2405

Hobbs, New Mexico 88240

One piece of ordinary mail addressed to:

Phillips Pet. Co

4001 Cambridge

Odessa Texas 79762

MAY BE USED FOR DOMESTIC AND INTERNATIONAL MAIL, DOES NOT PROVIDE FOR INSURANCE - POSTMASTER

PS FORM 3817  
MAY 1976

\*U.S. GOVERNMENT PRINTING OFFICE: 1984 - 756-868

U.S. POSTAL SERVICE  
CERTIFICATE OF MAILING

Received From:

Marathon Oil Co

P.O. Box 2405

Hobbs, New Mexico 88240

One piece of ordinary mail addressed to:

Crown Central Petroleum

Bld. K, Suite 200, 731 W. Wally

Highland Texas 79701

MAY BE USED FOR DOMESTIC AND INTERNATIONAL MAIL, DOES NOT PROVIDE FOR INSURANCE - POSTMASTER

PS FORM 3817  
MAY 1976

\*U.S. GOVERNMENT PRINTING OFFICE: 1984 - 756-868

Lillian M. Gilbreth



U.S. POSTAL SERVICE  
CERTIFICATE OF MAILING

Received From:

Marathon Oil Co

P.O. Box 2405

Hobbs, New Mexico 88240

One piece of ordinary mail addressed to:

Sun Exploration & Production Co

P.O. Box 1861

Highland Texas 79702

MAY BE USED FOR DOMESTIC AND INTERNATIONAL MAIL, DOES NOT PROVIDE FOR INSURANCE - POSTMASTER

PS FORM 3817  
MAY 1976

\*U.S. GOVERNMENT PRINTING OFFICE: 1984 - 756-868

Lillian M. Gilbreth



CERTIFICATE OF MAILING

Received From:

Marathon Oil Co

P.O. Box 2405

Hobbs, New Mexico 88240

One piece of ordinary mail addressed to:

Chevron Oil Co

P.O. Box 670

Hobbs, New Mexico 88240

MAY BE USED FOR DOMESTIC AND INTERNATIONAL MAIL, DOES NOT PROVIDE FOR INSURANCE - POSTMASTER

PS FORM 3817  
MAY 1976

\*U.S. GOVERNMENT PRINTING OFFICE: 1984 - 756-868

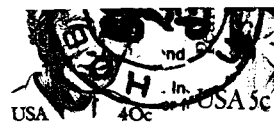

U.S. POSTAL SERVICE  
CERTIFICATE OF MAILING

Received From:

Marathon Oil Company

P.O. Box 2405

Hobbs, New Mexico

One piece of ordinary mail addressed to:

Harrison Operating Co

P.O. Box 1515

Roswell New Mexico 88202

MAY BE USED FOR DOMESTIC AND INTERNATIONAL MAIL, DOES NOT PROVIDE FOR INSURANCE - POSTMASTER

PS FORM 3817  
MAY 1976

\*U.S. GOVERNMENT PRINTING OFFICE: 1984 - 756-868

Lillian M. Gilbreth

