

ABOVE THIS LINE FOR DIVISION USE ONLY

NEW MEXICO OIL CONSERVATION DIVISION

- Engineering Bureau -

1220 South St. Francis Drive, Santa Fe, NM 87505



ADMINISTRATIVE APPLICATION CHECKLIST

THIS CHECKLIST IS MANDATORY FOR ALL ADMINISTRATIVE APPLICATIONS FOR EXCEPTIONS TO DIVISION RULES AND REGULATIONS WHICH REQUIRE PROCESSING AT THE DIVISION LEVEL IN SANTA FE

Application Acronyms:

[NSL-Non-Standard Location] [NSP-Non-Standard Proration Unit] [SD-Simultaneous Dedication]
 [DHC-Downhole Commingling] [CTB-Lease Commingling] [PLC-Pool/Lease Commingling]
 [PC-Pool Commingling] [OLS - Off-Lease Storage] [OLM-Off-Lease Measurement]
 [WFX-Waterflood Expansion] [PMX-Pressure Maintenance Expansion]
 [SWD-Salt Water Disposal] [IPI-Injection Pressure Increase]
 [EOR-Qualified Enhanced Oil Recovery Certification] [PPR-Positive Production Response]

[1] TYPE OF APPLICATION - Check Those Which Apply for [A]

[A] Location - Spacing Unit - Simultaneous Dedication
☐ NSL ☐ NSP ☐ SD

Check One Only for [B] or [C]

[B] Commingling - Storage - Measurement
☒ DHC ☐ CTB ☐ PLC ☐ PC ☐ OLS ☐ OLM

[C] Injection - Disposal - Pressure Increase - Enhanced Oil Recovery
☐ WFX ☐ PMX ☐ SWD ☐ IPI ☐ EOR ☐ PPR

[D] Other: Specify _____

[2] NOTIFICATION REQUIRED TO: - Check Those Which Apply, or ☐ Does Not Apply

- [A] ☐ Working, Royalty or Overriding Royalty Interest Owners
- [B] ☐ Offset Operators, Leaseholders or Surface Owner
- [C] ☐ Application is One Which Requires Published Legal Notice
- [D] ☐ Notification and/or Concurrent Approval by BLM or SLO
 U.S. Bureau of Land Management - Commissioner of Public Lands, State Land Office
- [E] ☐ For all of the above, Proof of Notification or Publication is Attached, and/or,
- [F] ☐ Waivers are Attached

[3] SUBMIT ACCURATE AND COMPLETE INFORMATION REQUIRED TO PROCESS THE TYPE OF APPLICATION INDICATED ABOVE.

[4] CERTIFICATION: I hereby certify that the information submitted with this application for administrative approval is accurate and complete to the best of my knowledge. I also understand that no action will be taken on this application until the required information and notifications are submitted to the Division.

Note: Statement must be completed by an individual with managerial and/or supervisory capacity.

Print or Type Name

Signature

Title

Date

e-mail Address

in 6/2/05 no
Suspense DHC
WTS

MEWBOURNE OIL COMPANY

P.O. BOX 7698
TYLER, TEXAS 75711
903 - 561-2900
FAX 903 - 561-1870

June 1, 2005

UPS NEXT DAY AIR #N455 748 949 1

Mr. William Jones
New Mexico Oil Conservation Division
1220 S. St. Francis Drive
Santa Fe, NM 87505

RE: Form C-107A
Saladar "32" Fee Com #1
Sec 32 T20S R28E
Burton Flat; Atoka West (Gas) and Burton Flat; Morrow (Gas) Pools
Eddy Co., NM

Dear Mr. Jones:

Please find enclosed the following for the application to downhole commingle production from the Atoka and Morrow zones in the referenced well:

Form C-107A
Attachments information
Form C-102 for both zones
Administrative Application Checklist

A copy of Form C-107A is being mailed today to the State Land Office in Santa Fe. If you need further information, please call me at (903) 561-2900.

Yours truly,



Janet Burns
Reg. Tech.

cc: NMOCD - Artesia
State Land Office
Hobbs
Midland
Allen Brinson
Wayne Jones
Don Russell

District I
1625 N. French Drive, Hobbs, NM 88240

District II
1301 W. Grand Avenue, Artesia, NM 88210

District III
1000 Rio Brazos Road, Aztec, NM 87410

District IV
1220 S. St. Francis Dr., Santa Fe, NM 87505

State of New Mexico
Energy, Minerals and Natural Resources Department

Form C-107A
Revised June 10, 2003

Oil Conservation Division

1220 South St. Francis Dr.
Santa Fe, New Mexico 87505

APPLICATION TYPE

☒ Single Well

☐ Establish Pre-Approved Pools

EXISTING WELLBORE

☒ Yes ☐ No

APPLICATION FOR DOWNHOLE COMMINGLING

Mewbourne Oil Company

P. O. Box 7698, Tyler, TX 75711

Operator

Address

Saladar "32" Fee Com #1

O - Sec 32, T20S, R28E

Eddy

Lease

Well No.

Unit Letter-Section-Township-Range

County

OGRID No. 14744 Property Code 34002 API No. 30-015-33416 Lease Type: ☐ Federal ☐ State ☒ Fee

DATA ELEMENT	UPPER ZONE <u>UNDES</u>	INTERMEDIATE ZONE	LOWER ZONE <u>✓</u>
Pool Name	Burton Flat; Atoka, West (Gas)		Burton Flat; Morrow <u>Pro Gas</u>
Pool Code	73260 <u>✓</u>		73280 <u>✓</u>
Top and Bottom of Pay Section (Perforated or Open-Hole Interval)	10,630 - 10,660'		11,176 - 11,326'
Method of Production (Flowing or Artificial Lift)	Flowing		Flowing
Bottomhole Pressure (Note: Pressure data will not be required if the bottom perforation in the lower zone is within 150% of the depth of the top perforation in the upper zone)			
Oil Gravity or Gas BTU (Degree API or Gas BTU)			
Producing, Shut-In or New Zone	New Zone		Producing
Date and Oil/Gas/Water Rates of Last Production. (Note: For new zones with no production history, applicant shall be required to attach production estimates and supporting data.)	Date: Estimated rate: Rates: 500 MCFD, 4 BO, 0 BW	Date: Rates:	Date: 5/15/05 Rates: 100 MCFD, 0 BO, 0 BW
Fixed Allocation Percentage (Note: If allocation is based upon something other than current or past production, supporting data or explanation will be required.)	Oil Gas 100 % 83 %	Oil Gas % %	Oil Gas 0 % 17 %

ADDITIONAL DATA

Are all working, royalty and overriding royalty interests identical in all commingled zones?
If not, have all working, royalty and overriding royalty interest owners been notified by certified mail?

Yes ☒ No ☐
Yes ☐ No ☐

Are all produced fluids from all commingled zones compatible with each other?

Yes ☒ No ☐

Will commingling decrease the value of production?

Yes ☐ No ☒

If this well is on, or communitized with, state or federal lands, has either the Commissioner of Public Lands
or the United States Bureau of Land Management been notified in writing of this application?

Yes ☒ No ☐

NMOCD Reference Case No. applicable to this well: _____

Attachments:

- C-102 for each zone to be commingled showing its spacing unit and acreage dedication.
- Production curve for each zone for at least one year. (If not available, attach explanation.)
- For zones with no production history, estimated production rates and supporting data.
- Data to support allocation method or formula.
- Notification list of working, royalty and overriding royalty interests for uncommon interest cases.
- Any additional statements, data or documents required to support commingling.

PRE-APPROVED POOLS

If application is to establish Pre-Approved Pools, the following additional information will be required:

- List of other orders approving downhole commingling within the proposed Pre-Approved Pools
- List of all operators within the proposed Pre-Approved Pools
- Proof that all operators within the proposed Pre-Approved Pools were provided notice of this application.
- Bottomhole pressure data.

I hereby certify that the information above is true and complete to the best of my knowledge and belief.

SIGNATURE Janet Burns TITLE _____ Reg. Tech. _____ DATE 6/1/05

TYPE OR PRINT NAME _____ Janet Burns _____ TELEPHONE NO. (903) 561-2900

E-MAIL ADDRESS _____

Attachments to C-107A

Mewbourne Oil Company
Saladar "32" Fee Corn #1
Unit Letter O, Sec 32 T20S R28E
Burton Flat; Atoka, West (Gas) and Burton Flat; Morrow (Gas) Pools
Eddy Co., NM

C-102 for each zone to be commingled showing its spacing unit and acreage dedication

Production curve is not attached (new well)

Estimated production rates and supporting data

Test Data:

Morrow	5/15/05	100 MCFD, 0 BO, 0 BW: current production
Atoka		500 MCFD, 4 BO, 0 BW: estimated production

Data to support allocation method or formula

Test as shown above for both zones

Notification list of working, royalty and overriding royalty interests for uncommon interest cases

No uncommon interests.

Any additional statements, data or documents required to support commingling

The well is completed with 5 1/2" OD casing. In order to dually complete the well to recover all economic reserves, the use of small diameter special clearance tubing would be required. Performing a dual completion as described could not be economically justified for a zone with limited deliverability. To produce the Atoka interval (upper zone) up the annulus (5 1/2" - 2 7/8") is not recommended due to liquid loading and insufficient velocity to lift produced fluids with the estimated gas rates listed above. The addition of the Atoka as a commingled zone will prevent waste that would not otherwise be possible due to the increased cost to produce each individual zone. Commingling will prevent early abandonment of each production zone.

Revised March 17, 1999
 Instruction on back
 Submit to Appropriate District Office
 State Lease - 4 Copies
 Fee Lease - 3 Copies

DISTRICT II
611 South First, Artesia, NM 88210

DISTRICT III
1000 Rio Brazos Rd., Aztec, NM 87410

DISTRICT IV
2040 South Pacheco, Santa Fe, NM 87505

OIL CONSERVATION DIVISION

**P.O. Box 2088
Santa Fe, New Mexico 87504-2088**

□ AMENDED REPORT

WELL LOCATION AND ACREAGE DEDICATION PLAT

API Number		Pool Code	Pool Name
			Burton Flat; Morrow
Property Code	Property Name		Well Number
	SALADAR "32" FEE COM		1
OGRID No.	Operator Name		Elevation
14744	MEWBOURNE OIL COMPANY		3198

Surface Location

UL or lot No.	Section	Township	Range	Lot Idn	Feet from the	North/South line	Feet from the	East/West line	County
0	32	20S	28E		660	SOUTH	1650	EAST	EDDY

Bottom Hole Location If Different From Surface

UL or lot No.	Section	Township	Range	Lot Idn	Feet from the	North/South line	Feet from the	East/West line	County
Dedicated Acres	Joint or Infill	Consolidation Code	Order No.						

NO ALLOWABLE WILL BE ASSIGNED TO THIS COMPLETION UNTIL ALL INTERESTS HAVE BEEN CONSOLIDATED
OR A NON-STANDARD UNIT HAS BEEN APPROVED BY THE DIVISION

	<div style="text-align: center; font-weight: bold;">OPERATOR CERTIFICATION</div> <p><i>I hereby certify the the information contained herein is true and complete to the best of my knowledge and belief.</i></p> <div style="border-bottom: 1px solid black; margin-bottom: 5px;"> </div> <p>Signature</p> <p>NM Young</p> <p>Printed Name</p> <p>Hobbs District Manager</p> <p>Title</p> <p>May 11, 2004</p> <p>Date</p>
<div style="text-align: center; font-weight: bold;">SURVEYOR CERTIFICATION</div> <p><i>I hereby certify that the well location shown on this plat was plotted from field notes of actual surveys made by me or under my supervision, and that the same is true and correct to the best of my belief.</i></p> <p style="text-align: right;">4/14/2004</p> <p>Date Surveyed</p> <div style="border-bottom: 1px solid black; margin-bottom: 5px;"> </div> <p>Signature & Seal of Professional Surveyor</p> <div style="text-align: center;"> </div> <p>Certification No. H. H. Jones RLS 3640</p> <p style="text-align: center;">GENERAL SURVEYING COMPANY</p>	

DISTRICT II

811 South First, Artesia, NM 88210

DISTRICT III

1630 Elia Brazos Rd., Aztec, NM 87410

DISTRICT IV

2310 South Pacheco, Santa Fe, NM 87505

OIL CONSERVATION DIVISION

P.O. Box 2088

Santa Fe, New Mexico 87504-2088

☐ AMENDED REPORT**WELL LOCATION AND ACREAGE DEDICATION PLAT**

API Number 30-015-33416	Pool Code	Pool Name Undes Atoka
Property Code	Property Name SALADAR "32" FEE COM	Well Number 1
OCRID No. 14744	Operator Name MEWBORNE OIL COMPANY	Elevation 3198

Surface Location

UL or lot No.	Section	Township	Range	Lot Idn	Feet from the	North/South line	Feet from the	East/West line	County
0	32	20S	28E		660	SOUTH	1650	EAST	EDDY

Bottom Hole Location If Different From Surface

UL or lot No.	Section	Township	Range	Lot Idn	Feet from the	North/South line	Feet from the	East/West line	County

Dedicated Acres	Joint or Infill	Consolidation Code	Order No.
320			

**NO ALLOWABLE WILL BE ASSIGNED TO THIS COMPLETION UNTIL ALL INTERESTS HAVE BEEN CONSOLIDATED
OR A NON-STANDARD UNIT HAS BEEN APPROVED BY THE DIVISION**

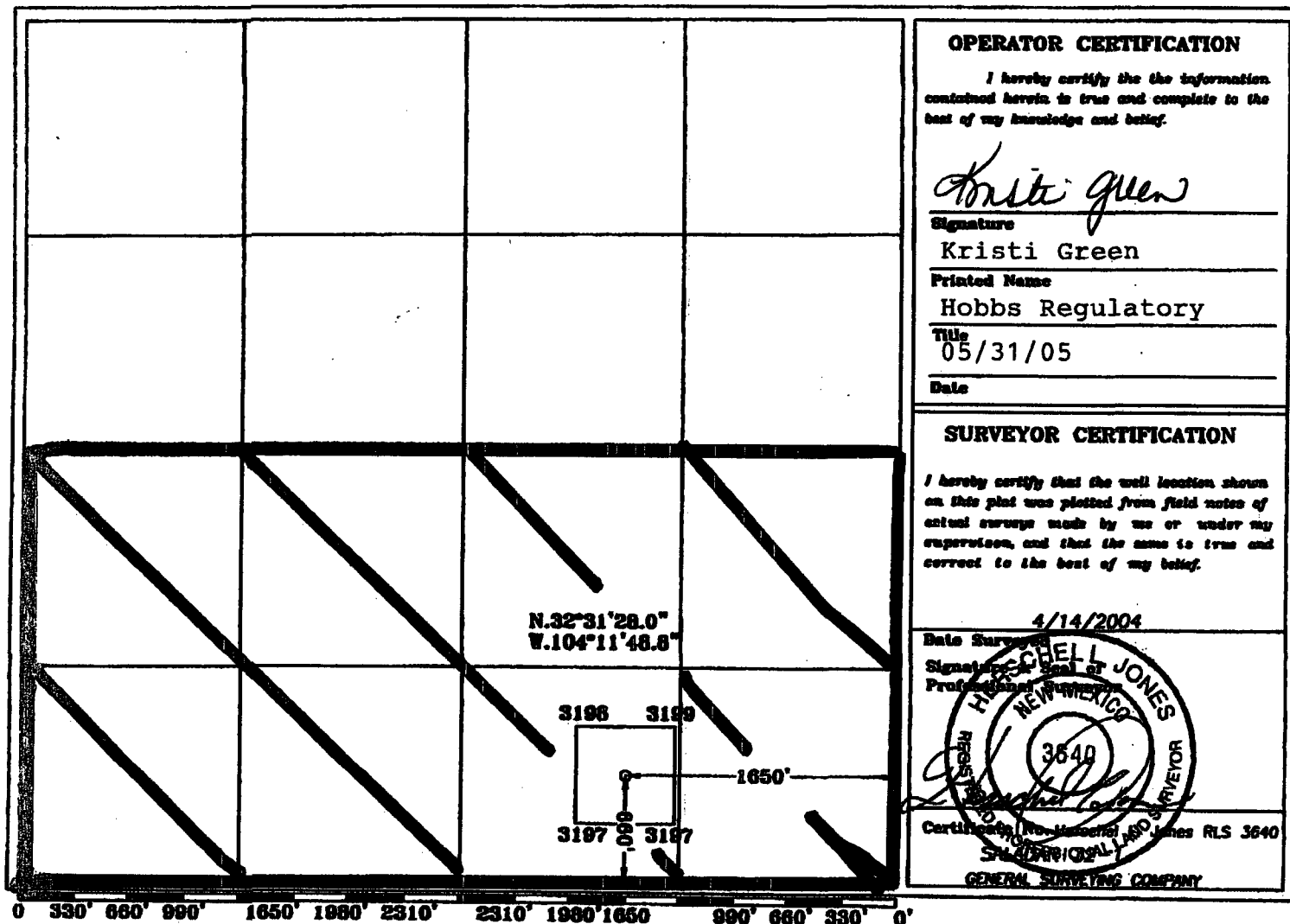
**OPERATOR CERTIFICATION**

I hereby certify the the information contained herein is true and complete to the best of my knowledge and belief.

Kristi Green
Signature

Kristi Green
Printed Name

Hobbs Regulatory
Title

05/31/05
Date

Date

SURVEYOR CERTIFICATION

I hereby certify that the well location shown on this plat was plotted from field notes of actual surveys made by me or under my supervision, and that the same is true and correct to the best of my belief.

4/14/2004
Date Surveyed

Signature and Seal of Professional Surveyor
Professional Surveyor

CHILL JONES
NEW MEXICO
3640
Professional Surveyor

Certification No. 3640
Surveyor Jones RLS 3640
Surveyor Jones

GENERAL SURVEYING COMPANY

DATE IN	SUSPENSE	ENGINEER	LOGGED IN	TYPE	APP NO.
---------	----------	----------	-----------	------	---------

ABOVE THIS LINE FOR DIVISION USE ONLY

NEW MEXICO OIL CONSERVATION DIVISION
- Engineering Bureau -
 1220 South St. Francis Drive, Santa Fe, NM 87505



ADMINISTRATIVE APPLICATION CHECKLIST

THIS CHECKLIST IS MANDATORY FOR ALL ADMINISTRATIVE APPLICATIONS FOR EXCEPTIONS TO DIVISION RULES AND REGULATIONS WHICH REQUIRE PROCESSING AT THE DIVISION LEVEL IN SANTA FE

Application Acronyms:

[NSL-Non-Standard Location] [NSP-Non-Standard Proration Unit] [SD-Simultaneous Dedication]
[DHC-Downhole Commingling] [CTB-Lease Commingling] [PLC-Pool/Lease Commingling]
[PC-Pool Commingling] [OLS - Off-Lease Storage] [OLM-Off-Lease Measurement]
[WFX-Waterflood Expansion] [PMX-Pressure Maintenance Expansion]
[SWD-Salt Water Disposal] [IPI-Injection Pressure Increase]
[EOR-Qualified Enhanced Oil Recovery Certification] [PPR-Positive Production Response]

[1] TYPE OF APPLICATION - Check Those Which Apply for [A]

[A] Location - Spacing Unit - Simultaneous Dedication
☐ NSL ☐ NSP ☐ SD

Check One Only for [B] or [C]

[B] Commingling - Storage - Measurement
☒ DHC ☐ CTB ☐ PLC ☐ PC ☐ OLS ☐ OLM

[C] Injection - Disposal - Pressure Increase - Enhanced Oil Recovery
☐ WFX ☐ PMX ☐ SWD ☐ IPI ☐ EOR ☐ PPR

[D] Other: Specify _____

[2] NOTIFICATION REQUIRED TO: - Check Those Which Apply, or Does Not Apply

- [A]** ☐ Working, Royalty or Overriding Royalty Interest Owners
- [B]** ☐ Offset Operators, Leaseholders or Surface Owner
- [C]** ☐ Application is One Which Requires Published Legal Notice
- [D]** ☒ Notification and/or Concurrent Approval by BLM or SLO
 U.S. Bureau of Land Management - Commissioner of Public Lands, State Land Office
- [E]** ☐ For all of the above, Proof of Notification or Publication is Attached, and/or,
- [F]** ☐ Waivers are Attached

[3] SUBMIT ACCURATE AND COMPLETE INFORMATION REQUIRED TO PROCESS THE TYPE OF APPLICATION INDICATED ABOVE.

[4] CERTIFICATION: I hereby certify that the information submitted with this application for administrative approval is accurate and complete to the best of my knowledge. I also understand that **no action** will be taken on this application until the required information and notifications are submitted to the Division.

Note: Statement must be completed by an individual with managerial and/or supervisory capacity.

Bryan Montgomery
 Print or Type Name

Signature

Manager, Evaluation & 6/1/05
 Title Reservoir Engineering Date

e-mail Address