

DATE IN 7.11.05	SUSPENSE	ENGINEER Jones	LOGGED IN 7.12.05	TYPE DHC	APP NO. 3504
-----------------	----------	----------------	-------------------	----------	--------------

ABOVE THIS LINE FOR DIVISION USE ONLY

NEW MEXICO OIL CONSERVATION DIVISION

- Engineering Bureau -

1220 South St. Francis Drive, Santa Fe, NM 87505



RECEIVED
JUL 11 2005

ADMINISTRATIVE APPLICATION CHECKLIST

THIS CHECKLIST IS MANDATORY FOR ALL ADMINISTRATIVE APPLICATIONS FOR EXCEPTIONS TO DIVISION RULES AND REGULATIONS WHICH REQUIRE PROCESSING AT THE DIVISION LEVEL IN SANTA FE

Application Acronyms:

[NSL-Non-Standard Location] [NSP-Non-Standard Proration Unit] [SD-Simultaneous Dedication]
[DHC-Downhole Commingling] [CTB-Lease Commingling] [PLC-Pool/Lease Commingling]
[PC-Pool Commingling] [OLS - Off-Lease Storage] [OLM-Off-Lease Measurement]
[WFX-Waterflood Expansion] [PMX-Pressure Maintenance Expansion]
[SWD-Salt Water Disposal] [IPI-Injection Pressure Increase]
[EOR-Qualified Enhanced Oil Recovery Certification] [PPR-Positive Production Response]

[1] TYPE OF APPLICATION - Check Those Which Apply for [A]

[A] Location - Spacing Unit - Simultaneous Dedication
 ___ NSL ___ NSP ___ SD

Check One Only for [B] or [C]

[B] Commingling - Storage - Measurement
X DHC ___ CTB ___ PLC ___ PC ___ OLS ___ OLM

[C] Injection - Disposal - Pressure Increase - Enhanced Oil Recovery
 ___ WFX ___ PMX ___ SWD ___ IPI ___ EOR ___ PPR

[D] Other: Specify _____

[2] NOTIFICATION REQUIRED TO: - Check Those Which Apply, or ☐ Does Not Apply

[A] ___ Working, Royalty or Overriding Royalty Interest Owners

[B] ___ Offset Operators, Leaseholders or Surface Owner

[C] ___ Application is One Which Requires Published Legal Notice

[D] ___ Notification and/or Concurrent Approval by BLM or SLO
 U.S. Bureau of Land Management - Commissioner of Public Lands, State Land Office

[E] ___ For all of the above, Proof of Notification or Publication is Attached, and/or,

[F] ___ Waivers are Attached

[3] SUBMIT ACCURATE AND COMPLETE INFORMATION REQUIRED TO PROCESS THE TYPE OF APPLICATION INDICATED ABOVE.

[4] **CERTIFICATION:** I hereby certify that the information submitted with this application for administrative approval is **accurate and complete** to the best of my knowledge. I also understand that **no action** will be taken on this application until the required information and notifications are submitted to the Division.

Note: Statement must be completed by an individual with managerial and/or supervisory capacity.

Robert L. Verquer
Print or Type Name

Robert L. Verquer
Signature

Superintendent
Title

July 4, 2005
Date

e-mail Address

District I
1625 French Drive, Hobbs, NM 88240
District II
1301 W. Grand Avenue, Artesia, NM 88210
District III
1000 Rio Brazos Road, Aztec, NM 87410
District IV
1220 S. St. Francis Dr., Santa Fe, NM 87505

State of New Mexico
Energy, Minerals and Natural Resources Department

Form C-107A
Revised May 15, 2000

Oil Conservation Division
1220 South St. Francis Dr.
Santa Fe, New Mexico 87505

APPLICATION TYPE
Single Well
Establish Pre-Approved Pools
EXISTING WELLBORE
Yes No

APPLICATION FOR DOWNHOLE COMMINGLING

DHC-3504
Operator Caulkins Oil Company Address 1409 W. Aztec, Blvd., Suite B7, Aztec NM 87410
Lease STATE COM Well No. 113-E Unit Letter-Section-Township-Range UNIT P - SEC. 2-26N-6W County Rio Arriba
OGRID No. 003824 Property Code 14243 API No. 30-039-22601 Lease Type: State Fee

DATA ELEMENT	UPPER ZONE	INTERMEDIATE ZONE	LOWER ZONE
Pool Name	Mesa Verde	South Blanco Tocito	Basin Dakota
Pool Code	72319	06460	71599
Top and Bottom of Pay Section (Perforated or Open-Hole Interval)	5547' - 4920'	6923' - 6907'	7620' - 7398'
Method of Production (Flowing or Artificial Lift)	Flowing	Flowing	Flowing
Bottomhole Pressure (Note: Pressure data will not be required if the bottom perforation in the lower zone is within 150% of the depth of the top perforation in the upper zone)			
Oil Gravity or Gas BTU (Degree API or Gas BTU)	1122 BTU	Estimated	1122 BTU
Producing, Shut-In or New Zone	Producing		Producing
Date and Oil/Gas/Water Rates of Last Production. (Note: For new zones with no production history, applicant shall be required to attach production estimates and supporting data.)	Date: 12 month average Rate: Oil .085 Gas 49 Water .42 MCF/D Bbl Bbl	Date: Estimated Rate: Oil 2 Gas .150 Water 0 MCF/D Bbl Bbl	Date: 12 month average Rate: Oil .037 Gas 39 Water .026 MCF/D Bbl Bbl
Fixed Allocation Percentage (Note: If allocation is based upon something other than current or past production, supporting data or explanation will be required.)	Oil 4 % Gas 21 %	Oil 94 % Gas 62 %	Oil 2 % Gas 17 %

ADDITIONAL DATA

Are all working, royalty and overriding royalty interests identical in all commingled zones? Yes X No
If not, have all working, royalty and overriding royalty interest owners been notified by certified mail? Yes No
Are all produced fluids from all commingled zones compatible with each other? Yes X No
Will commingling decrease the value of production? Yes No X
If this well is on, or communitized with, state or federal lands, has either the Commissioner of Public Lands or the United States Bureau of Land Management been notified in writing of this application? Yes No
NMOCD Reference Case No. applicable to this well: DHC-1868-A, DHC-2069-A, DHC-3187, DHC-2248, DHC-2102

- Attachments:
- C-102 for each zone to be commingled showing its spacing unit and acreage dedication.
 - Production curve for each zone for at least one year. (If not available, attach explanation.)
 - For zones with no production history, estimated production rates and supporting data.
 - Data to support allocation method or formula.
 - Notification list of working, royalty and overriding royalty interests for uncommon interest cases.
 - Any additional statements, data or documents required to support commingling.

PRE-APPROVED POOLS

If application is to establish Pre-Approved Pools, the following additional information will be required:

- List of other orders approving downhole commingling within the proposed Pre-Approved Pools
- List of all operators within the proposed Pre-Approved Pools
- Proof that all operators within the proposed Pre-Approved Pools were provided notice of this application.
- Bottomhole pressure data.

I hereby certify that the information above is true and complete to the best of my knowledge and belief.

SIGNATURE Robert L. Verquer TITLE Superintendent DATE June 30, 2005
TYPE OR PRINT NAME Robert L. Verquer TELEPHONE NO. (505) 334-4323

State of New Mexico
Energy, Minerals and Natural Resources Department

OIL CONSERVATION DIVISION

1220 South St. Frances Dr.
Santa Fe, New Mexico 87505

SUNDRY NOTICES AND REPORTS ON WELLS (DO NOT USE THIS FORM FOR PROPOSALS TO DRILL OR TO DEEPEN OR TO PLUG BACK TO A DIFFERENT RESERVOIR. USE "APPLICATION FOR PERMIT" (FORM C-101) FOR SUCH PROPOSALS.)		WELL API NO. 30-039-22601
		5. Indicate Type of Lease STATE <input type="checkbox"/> FEE <input type="checkbox"/> 6. State Oil & Gas Lease No. E29138
1. Type of Well Oil Well <input type="checkbox"/> Gas Well <input type="checkbox"/> Other <input type="checkbox"/>		7. Lease Name or Unit Agreement Name STATE COM
2. Name of Operator Caulkins Oil Company		8. Well No. 113-E
3. Address of Operator 1409 W. Aztec Blvd., Suite B7, Aztec, NM 87410		9. OGRID Number 003824
4. Well Location Unit Letter <u>P</u> : <u>1110'</u> feet from the <u>South</u> line and <u>950'</u> feet from the <u>East</u> line <u>2</u> Section <u>26N</u> Township <u>6W</u> Range <u>NMPM</u> Rio Arriba County		Pool Name or Wildcat DAKOTA, MESA VERDE
		10. Elevation (Show Whether DF,RKB,RT,GR,etc.) 6646 GR
Pit or Below-grade Tank Application <input type="checkbox"/> or Closure <input type="checkbox"/>		
Pit type _____ Depth to Groundwater _____ Distance from nearest fresh water well _____ Distance from nearest surface water _____		
Pit Liner thickness: _____ mil Below-grade Tank: Volume _____ bbls; Construction Material _____		
NOTICE OF INTENTION TO: Perform Remedial Work <input type="checkbox"/> Plug and Abandon <input type="checkbox"/> Temporarily Abandon <input type="checkbox"/> Change Plans <input type="checkbox"/> Pull or Alter Casing <input type="checkbox"/> Multiple Completion <input type="checkbox"/> Other: _____ <input type="checkbox"/>		SUBSEQUENT REPORT OF: Remedial Work <input type="checkbox"/> Altering Casing <input type="checkbox"/> Commence Drilling Opns. <input type="checkbox"/> Plug and Abandonment <input type="checkbox"/> Casing Test and Cement Job <input type="checkbox"/> Other: _____ <input type="checkbox"/>

12. Describe Proposed or Completed Operations

6-29-04 Rig up.
T. O. H. standing back 2 3/8" tubing.
Run wireline set retrievable bridge plug to 7000'.
Run gas spectrum log, 6950' to 6300'.
Perforate Tocito zone, 6923' to 6907', with 4 shots per foot.
T. I. H. with 2 7/8" tubing and full bore packer to approximately 6300'.
Frac Tocito zone with 20,000# 20/40 sand and N₂ foam.

(continued on page 2)

NOTE: This format is in lieu of State Form C-103.

I hereby certify that the information above is true and complete to the best of my knowledge and belief.

SIGNATURE Robert L. Verquer TITLE Superintendent DATE June 30, 2005
ROBERT L. VERQUER Ph. (505) 334-4323

(This space for State Use)

APPROVED BY _____ TITLE _____ DATE _____

CONDITIONS OF APPROVAL, IF ANY:

Caulkins Oil Company
NMOCD C-103 Sundry
State Com 113-E
June 30, 2005
Page 2

Flow back well to clean up and test Tocito.

T. O. H. laying down 2 7/8" tubing with packer.

T. I. H. with 2 3/8" tubing with retrieving head.

T. O. H. with retrievable bridge plug from 7000'.

T. I. H. with 2 3/8" production string.

Clean out to PBTD with air foam unit.

Land tubing on doughnut at approximately 7600'.

Rig down and move.

No new surface will be disturbed, location area will be cleaned up following operations.

Estimated starting date, September 5, 2005

NMOCD C-102 for South Blanco Tocito attached.

All distances must be from the outer boundaries of the Section.

Operator Caulkins Oil Company		Lease State "A"		Well No. 113-E
Unit Letter P	Section 2	Township 26 North	Range 6 West	County Rio Arriba
Actual Footage Location of Well:				
1110 feet from the South line and 950 feet from the East line				
Ground Level Elev. 6646	Producing Formation Mesa Verde - Dakota	Pool Blanco Mesa Verde - Basin Dakota	Dedicated Acreage: 320 MV & Dak. Acres	

1. Outline the acreage dedicated to the subject well by colored pencil or hachure marks on the plat below.
2. If more than one lease is dedicated to the well, outline each and identify the ownership thereof (both as to working interest and royalty).
3. If more than one lease of different ownership is dedicated to the well, have the interests of all owners been consolidated by communitization, unitization, force-pooling, etc?

☒ Yes ☐ No If answer is "yes," type of consolidation Communitization

If answer is "no," list the owners and tract descriptions which have actually been consolidated. (Use reverse side of this form if necessary.)

No allowable will be assigned to the well until all interests have been consolidated (by communitization, unitization, forced-pooling, or otherwise) or until a non-standard unit, eliminating such interests, has been approved by the Division

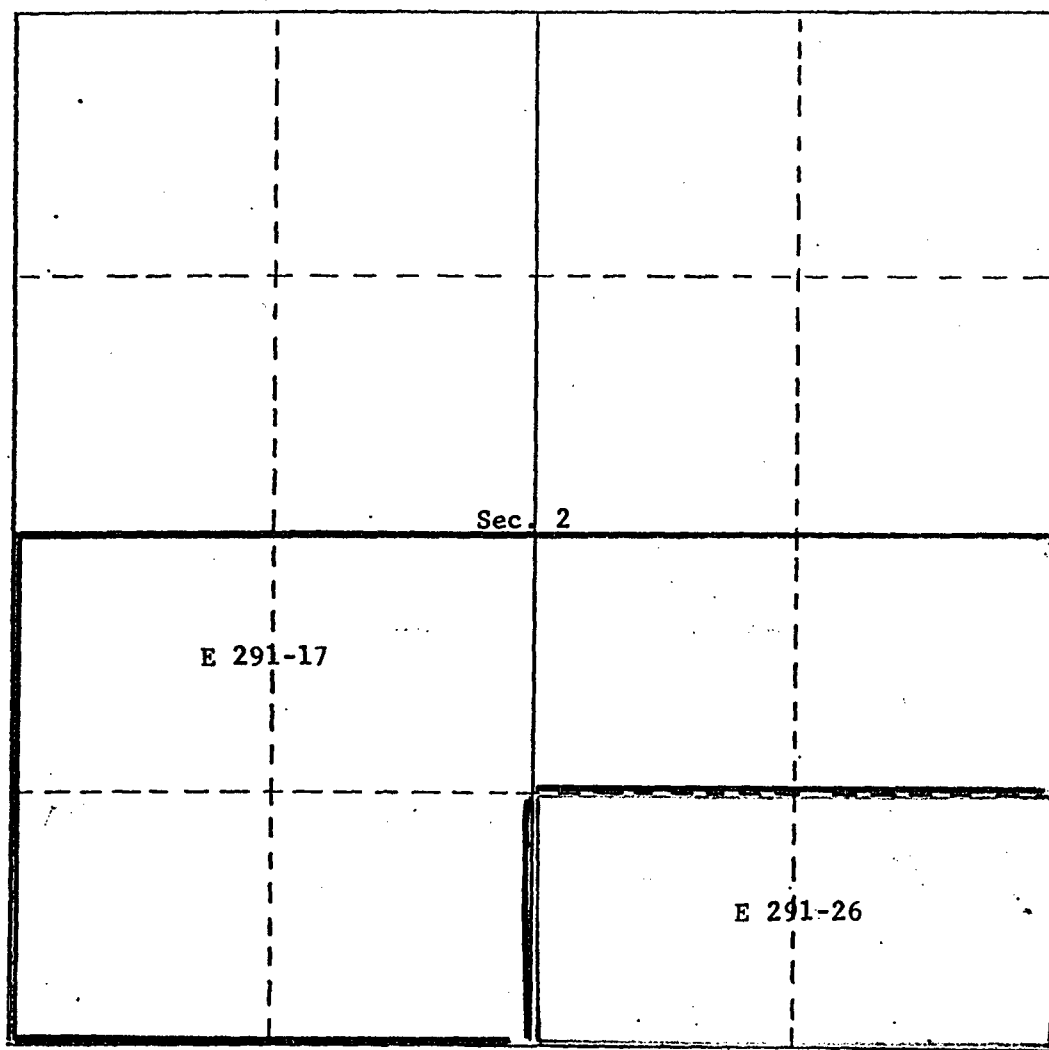

CERTIFICATION

I hereby certify that the information contained herein is true and complete to the best of my knowledge and belief.

Charles E. Verquer
Name

Charles E. Verquer

Position

Superintendent

Company

Caulkins Oil Company

Date

8-29-85

I hereby certify that the well location shown on this plat was plotted from field notes of actual surveys made by me or under my supervision, and that the same is true and correct to the best of my knowledge and belief.

Date Surveyed

6 November, 1980

Registered Professional Engineer
and/or Land Surveyor

C002425

Curtis Stocking

Certificate No.

NMLS 5980

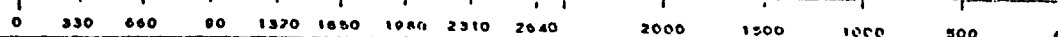

District I

State of New Mexico

Form C-102

PO Box 1980, Hobbs, NM 88241-1980

Energy, Minerals & Natural Resources Department

Revised October 18, 1994

District II

Instructions on back

811 South First, Artesia, NM 88210

OIL CONSERVATION DIVISION

Submit to Appropriate District Office

District III

1220 South St. Francis Drive

State Lease - 4 Copies

1000 Rio Brazos Rd., Aztec, NM 87410

Santa Fe, NM 87504

Fee Lease - 3 Copies

District IV

2040 South Pacheco, Santa Fe, NM 87505



AMENDED REPORT

WELL LOCATION AND ACREAGE DEDICATION PLAT

¹ API Number 30-039-22601		² Pool Code 06460		³ Pool Name SOUTH BLANCO TOCITO	
⁴ Property Code 14243		⁵ Property Name STATE COM			⁶ Well Number 113-E
⁷ OGRID No. 003824		⁸ Operator Name Caulkins Oil Company			⁹ Elevation 6646 GR

¹⁰ Surface Location

UL or lot no.	Section	Township	Range	Lot Idn	Feet from the	North/South line	Feet from the	East/West line	County
P	2	26N	6W		1110'	South	950'	East	Rio Arriba

¹¹ Bottom Hole Location If Different From Surface

UL or lot no.	Section	Township	Range	Lot Idn	Feet from the	North/South line	Feet from the	East/West line	County

¹² Dedicated Acres 80	¹³ Joint or Infill	¹⁴ Consolidation Code	¹⁵ Order No.
--	-------------------------------	----------------------------------	-------------------------

NO ALLOWABLE WILL BE ASSIGNED TO THIS COMPLETION UNTIL ALL INTERESTS HAVE BEEN CONSOLIDATED OR A NON-STANDARD UNIT HAS BEEN APPROVED BY THE DIVISION

¹⁶ 	¹⁷ OPERATOR CERTIFICATION I hereby certify that the information contained herein is true and complete to the best of my knowledge and belief Signature Printed Name Robert L. Verquer Title Superintendent Date June 30, 2005	
	¹⁸ SURVEYOR CERTIFICATION I hereby certify that the well location shown on this plat was plotted from field notes of actual surveys made by me or under my supervision, and that the same is true and correct to the best of my knowledge and belief. Date of Survey Signature and Seal of Professional Surveyor:	
	Certificate Number	

**LAST 12-MONTHS PRODUCTION
FOR
STATE COM 113-E**

DAKOTA

MONTH	GAS	OIL	WATER	DAYS	GAS DPA	OIL DPA
05/04	1121	2	0	31	36	0.065
06/04	1084	2	0	30	36	0.067
07/04	654	2	0	19	34	0.105
08/04	271	1	0	6	45	0.167
09/04	1001	0	0	25	40	0.000
10/04	1213	0	0	30	40	0.000
11/04	1082	0	0	30	36	0.000
12/04	1156	0	0	31	37	0.000
01/05	1237	0	0	31	40	0.000
02/05	996	1	0	28	36	0.036
03/05	330	0	0	9	37	0.000
05/05	1360	0	0	29	47	0.000
	11,505	8	0		39	0.037

MESA VERDE

MONTH	GAS	OIL	WATER	DAYS	GAS DPA	OIL DPA
05/04	1402	4	1	31	45	0.129
06/04	1356	5	1	30	45	0.167
07/04	815	3	0	19	43	0.158
08/04	346	3	0	6	58	0.500
09/04	1266	0	0	25	51	0.000
10/04	1534	0	0	30	51	0.000
11/04	1353	0	0	30	45	0.000
12/04	1452	0	0	31	47	0.000
01/05	1563	1	0	31	50	0.032
02/05	1245	0	0	28	44	0.000
03/05	413	0	0	9	46	0.000
05/05	1742	1	0	29	60	0.034
	14,487	17	2		49	0.085

District I
1625 N. French Drive, Hobbs, NM 88240

District II
1301 W. Grand Avenue, Artesia, NM 88210

District III
1000 Rio Brazos Road, Aztec, NM 87410

District IV
1220 S. St. Francis Dr., Santa Fe, NM 87505

State of New Mexico
Energy, Minerals and Natural Resources Department

Form C-107A
Revised May 15, 2000

Oil Conservation Division
1220 South St. Francis Dr.
Santa Fe, New Mexico 87505

APPLICATION TYPE
____ Single Well
____ Establish Pre-Approved Pools
EXISTING WELLBORE
____ Yes ____ No

APPLICATION FOR DOWNHOLE COMMINGLING

Operator Caulkins Oil Company Address 1409 W. Aztec, Blvd., Suite B7, Aztec NM 87410

Lease STATE COM Well No. 113-E Unit Letter-Section-Township-Range UNIT P - SEC. 2-26N-6W County Rio Arriba

OGRID No. 003824 Property Code 14243 API No. 30-039-22601 Lease Type: Federal X State Fee

DATA ELEMENT	UPPER ZONE	INTERMEDIATE ZONE	LOWER ZONE
Pool Name	Mesa Verde	South Blanco Tocito	Basin Dakota
Pool Code	72319	06460	71599
Top and Bottom of Pay Section (Perforated or Open-Hole Interval)	5547' - 4920'	6923' - 6907'	7620' - 7398'
Method of Production (Flowing or Artificial Lift)	Flowing	Flowing	Flowing
Bottomhole Pressure (Note: Pressure data will not be required if the bottom perforation in the lower zone is within 150% of the depth of the top perforation in the upper zone)			
Oil Gravity or Gas BTU (Degree API or Gas BTU)	1122 BTU	Estimated	1122 BTU
Producing, Shut-In or New Zone	Producing		Producing
Date and Oil/Gas/Water Rates of Last Production. (Note: For new zones with no production history, applicant shall be required to attach production estimates and supporting data.)	Date: 12 month average Rate: Oil Gas Water .085 49 .42 MCF/D Bbl Bbl	Date: Estimated Rate: Oil Gas Water 2 .150 0 MCF/D Bbl Bbl	Date: 12 month average Rate: Oil Gas Water .037 39 .026 MCF/D Bbl Bbl
Fixed Allocation Percentage (Note: If allocation is based upon something other than current or past production, supporting data or explanation will be required.)	Oil Gas 4 % 21 %	Oil Gas 94 % 62 %	Oil Gas 2 % 17 %

ADDITIONAL DATA

Are all working, royalty and overriding royalty interests identical in all commingled zones? Yes X No
If not, have all working, royalty and overriding royalty interest owners been notified by certified mail? Yes No
Are all produced fluids from all commingled zones compatible with each other? Yes X No
Will commingling decrease the value of production? Yes No X
If this well is on, or communitized with, state or federal lands, has either the Commissioner of Public Lands or the United States Bureau of Land Management been notified in writing of this application? Yes No

NMOCD Reference Case No. applicable to this well: DHC-1868-A, DHC-2069-A, DHC-3187, DHC-2248, DHC-2102

Attachments:

- C-102 for each zone to be commingled showing its spacing unit and acreage dedication.
- Production curve for each zone for at least one year. (If not available, attach explanation.)
- For zones with no production history, estimated production rates and supporting data.
- Data to support allocation method or formula.
- Notification list of working, royalty and overriding royalty interests for uncommon interest cases.
- Any additional statements, data or documents required to support commingling.

PRE-APPROVED POOLS

If application is to establish Pre-Approved Pools, the following additional information will be required:

- List of other orders approving downhole commingling within the proposed Pre-Approved Pools
- List of all operators within the proposed Pre-Approved Pools
- Proof that all operators within the proposed Pre-Approved Pools were provided notice of this application.
- Bottomhole pressure data.

I hereby certify that the information above is true and complete to the best of my knowledge and belief.

SIGNATURE Robert L. Verquer TITLE Superintendent DATE June 30, 2005
TYPE OR PRINT NAME Robert L. Verquer TELEPHONE NO. (505) 334-4323

State of New Mexico
Energy, Minerals and Natural Resources Department

OIL CONSERVATION DIVISION

1220 South St. Frances Dr.
Santa Fe, New Mexico 87505

SUNDRY NOTICES AND REPORTS ON WELLS (DO NOT USE THIS FORM FOR PROPOSALS TO DRILL OR TO DEEPEN OR TO PLUG BACK TO A DIFFERENT RESERVOIR. USE "APPLICATION FOR PERMIT" (FORM C-101) FOR SUCH PROPOSALS.)

WELL API NO.

30-039-22601

5. Indicate Type of Lease

STATE ☐ FEE ☐

6. State Oil & Gas Lease No.

E29138

7. Lease Name or Unit Agreement Name

STATE COM

8. Well No.

113-E

9. OGRID Number

003824

Pool Name or Wildcat

DAKOTA, MESA VERDE

1. Type of Well

Oil Well ☐ Gas Well ☐ Other ☐

2. Name of Operator

Caulkins Oil Company

3. Address of Operator

1409 W. Aztec Blvd., Suite B7, Aztec, NM 87410

4. Well Location

Unit Letter P : 1110' feet from the South line and 950' feet from the East line
2 Section 26N Township 6W Range NMPM Rio Arriba County

10. Elevation (Show Whether DF,RKB,RT,GR,etc.)

6646 GR

Pit or Below-grade Tank Application ☐ or Closure ☐

Pit type _____ Depth to Groundwater _____ Distance from nearest fresh water well _____ Distance from nearest surface water _____

Pit Liner thickness: _____ mil Below-grade Tank: Volume _____ bbls; Construction Material _____

NOTICE OF INTENTION TO:

Perform Remedial Work ☐ Plug and Abandon ☐

Temporarily Abandon ☐ Change Plans ☐

Pull or Alter Casing ☐ Multiple Completion ☐

Other: _____ ☐

SUBSEQUENT REPORT OF:

Remedial Work ☐ Altering Casing ☐

Commence Drilling Opns. ☐ Plug and Abandonment ☐

Casing Test and Cement Job ☐

Other: _____ ☐

12. Describe Proposed or Completed Operations

6-29-04 Rig up.

T. O. H. standing back 2 3/8" tubing.

Run wireline set retrievable bridge plug to 7000'.

Run gas spectrum log, 6950' to 6300'.

Perforate Tocito zone, 6923' to 6907', with 4 shots per foot.

T. I. H. with 2 7/8" tubing and full bore packer to approximately 6300'.

Frac Tocito zone with 20,000# 20/40 sand and N₂ foam.

(continued on page 2)

NOTE: This format is in lieu of State Form C-103.

I hereby certify that the information above is true and complete to the best of my knowledge and belief.

SIGNATURE

Robert L. Verquer

ROBERT L. VERQUER

TITLE Superintendent

DATE June 30, 2005

Ph. (505) 334-4323

(This space for State Use)

APPROVED BY _____

TITLE _____

DATE _____

CONDITIONS OF APPROVAL, IF ANY:

Caulkins Oil Company
NMOCD C-103 Sundry
State Com 113-E
June 30, 2005
Page 2

Flow back well to clean up and test Tocito.

T. O. H. laying down 2 7/8" tubing with packer.

T. I. H. with 2 3/8" tubing with retrieving head.

T. O. H. with retrievable bridge plug from 7000'.

T. I. H. with 2 3/8" production string.

Clean out to PBTD with air foam unit.

Land tubing on doughnut at approximately 7600'.

Rig down and move.

No new surface will be disturbed, location area will be cleaned up following operations.

Estimated starting date, September 5, 2005

NMOCD C-102 for South Blanco Tocito attached.

All distances must be from the outer boundaries of the Section.

Operator Caulkins Oil Company			Lease State "A"		Well No. 113-E
Unit Letter P	Section 2	Township 26 North	Range 6 West	County Rio Arriba	
Actual Footage Location of Well: 1110 feet from the South line and 950 feet from the East line					
Ground Level Elev. 6646	Producing Formation Mesa Verde - Dakota		Pool Blanco Mesa Verde - Basin Dakota		Dedicated Acreage: 320 MV & Dak. Acre:

1. Outline the acreage dedicated to the subject well by colored pencil or hachure marks on the plat below.
2. If more than one lease is dedicated to the well, outline each and identify the ownership thereof (both as to working interest and royalty).
3. If more than one lease of different ownership is dedicated to the well, have the interests of all owners been consolidated by communitization, unitization, force-pooling, etc?

☒ Yes ☐ No If answer is "yes," type of consolidation Communitization

If answer is "no," list the owners and tract descriptions which have actually been consolidated. (Use reverse side of this form if necessary.)

No allowable will be assigned to the well until all interests have been consolidated (by communitization, unitization, forced-pooling, or otherwise) or until a non-standard unit, eliminating such interests, has been approved by the Division

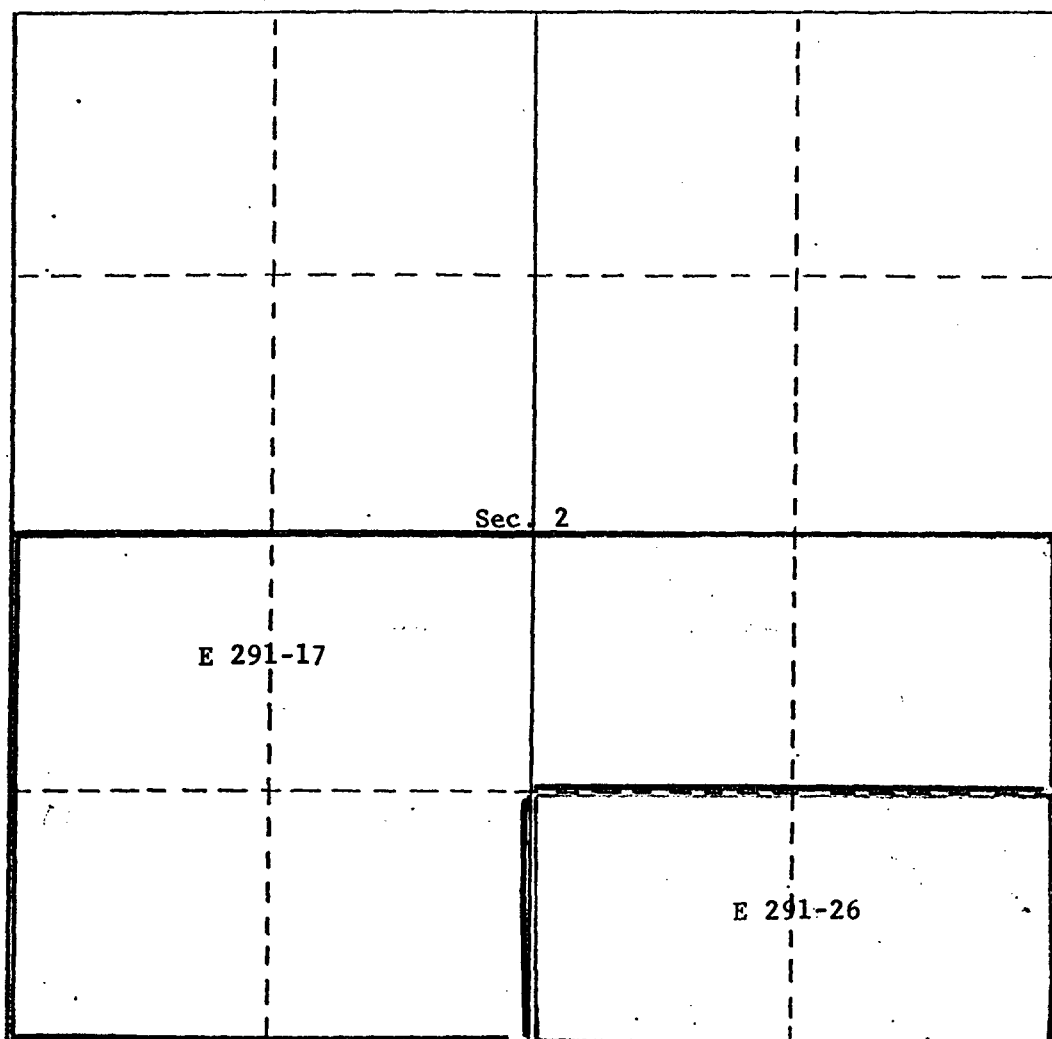

CERTIFICATION

I hereby certify that the information contained herein is true and complete to the best of my knowledge and belief.

Charles E. Verquer
Name

Charles E. Verquer

Position

Superintendent

Company

Caulkins Oil Company

Date

8-29-85

I hereby certify that the well location shown on this plat was plotted from field notes of actual surveys made by me or under my supervision, and that the same is true and correct to the best of my knowledge and belief.

Date Surveyed

6 November, 1980

Registered Professional Engineer and/or Land Surveyor

C002425

Curtis Stocking

Certificate No.

NMLS 5980

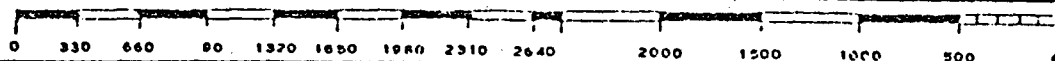

District I

PO Box 1980, Hobbs, NM 88241-1980

District II

811 South First, Artesia, NM 88210

District III

1000 Rio Brazos Rd., Aztec, NM 87410

District IV

2040 South Pacheco, Santa Fe, NM 87505

State of New Mexico

Energy, Minerals & Natural Resources Department

OIL CONSERVATION DIVISION

1220 South St. Francis Drive

Santa Fe, NM 87504

Form C-102

Revised October 18, 1994

Instructions on back

Submit to Appropriate District Office

State Lease - 4 Copies

Fee Lease - 3 Copies



AMENDED REPORT

WELL LOCATION AND ACREAGE DEDICATION PLAT

¹ API Number 30-039-22601	² Pool Code 06460	³ Pool Name SOUTH BLANCO TOCITO
⁴ Property Code 14243	⁵ Property Name STATE COM	⁶ Well Number 113-E
⁷ OGRID No. 003824	⁸ Operator Name Caulkins Oil Company	⁹ Elevation 6646 GR

¹⁰ Surface Location

UL or lot no.	Section	Township	Range	Lot Idn	Feet from the	North/South line	Feet from the	East/West line	County
P	2	26N	6W		1110'	South	950'	East	Rio Arriba

¹¹ Bottom Hole Location If Different From Surface

UL or lot no.	Section	Township	Range	Lot Idn	Feet from the	North/South line	Feet from the	East/West line	County

¹² Dedicated Acres 80	¹³ Joint or Infill	¹⁴ Consolidation Code	¹⁵ Order No.
--	-------------------------------	----------------------------------	-------------------------

NO ALLOWABLE WILL BE ASSIGNED TO THIS COMPLETION UNTIL ALL INTERESTS HAVE BEEN CONSOLIDATED OR A NON-STANDARD UNIT HAS BEEN APPROVED BY THE DIVISION

¹⁶ 	¹⁷ OPERATOR CERTIFICATION I hereby certify that the information contained herein is true and complete to the best of my knowledge and belief Signature Printed Name Robert L. Verquer Title Superintendent Date June 30, 2005	
	¹⁸ SURVEYOR CERTIFICATION I hereby certify that the well location shown on this plat was plotted from field notes of actual surveys made by me or under my supervision, and that the same is true and correct to the best of my knowledge and belief. Date of Survey	
	Signature and Seal of Professional Surveyor:	
	Certificate Number	

**LAST 12-MONTHS PRODUCTION
FOR
STATE COM 113-E**

DAKOTA

MONTH	GAS	OIL	WATER	DAYS	GAS DPA	OIL DPA
05/04	1121	2	0	31	36	0.065
06/04	1084	2	0	30	36	0.067
07/04	654	2	0	19	34	0.105
08/04	271	1	0	6	45	0.167
09/04	1001	0	0	25	40	0.000
10/04	1213	0	0	30	40	0.000
11/04	1082	0	0	30	36	0.000
12/04	1156	0	0	31	37	0.000
01/05	1237	0	0	31	40	0.000
02/05	996	1	0	28	36	0.036
03/05	330	0	0	9	37	0.000
05/05	1360	0	0	29	47	0.000
	11,505	8	0		39	0.037

MESA VERDE

MONTH	GAS	OIL	WATER	DAYS	GAS DPA	OIL DPA
05/04	1402	4	1	31	45	0.129
06/04	1356	5	1	30	45	0.167
07/04	815	3	0	19	43	0.158
08/04	346	3	0	6	58	0.500
09/04	1266	0	0	25	51	0.000
10/04	1534	0	0	30	51	0.000
11/04	1353	0	0	30	45	0.000
12/04	1452	0	0	31	47	0.000
01/05	1563	1	0	31	50	0.032
02/05	1245	0	0	28	44	0.000
03/05	413	0	0	9	46	0.000
05/05	1742	1	0	29	60	0.034
	14,487	17	2		49	0.085

District I
1627 N. French Drive, Hobbs, NM 88240
District II
1301 W. Grand Avenue, Artesia, NM 88210
District III
1000 Rio Brazos Road, Aztec, NM 87410
District IV
1220 S. St. Francis Dr., Santa Fe, NM 87505

State of New Mexico
Energy, Minerals and Natural Resources Department

Form C-107A
Revised May 15, 2000

Oil Conservation Division
1220 South St. Francis Dr.
Santa Fe, New Mexico 87505

APPLICATION TYPE
____ Single Well
____ Establish Pre-Approved Pools
EXISTING WELLBORE
____ Yes ____ No

APPLICATION FOR DOWNHOLE COMMINGLING

Operator Caulkins Oil Company Address 1409 W. Aztec, Blvd., Suite B7, Aztec NM 87410
Lease STATE COM Well No. 113-E Unit Letter-Section-Township-Range UNIT P - SEC. 2-26N-6W County Rio Arriba
OGRID No. 003824 Property Code 14243 API No. 30-039-22601 Lease Type: ____ Federal X State ____ Fee

DATA ELEMENT	UPPER ZONE	INTERMEDIATE ZONE	LOWER ZONE
Pool Name	Mesa Verde	South Blanco Tocito	Basin Dakota
Pool Code	72319	06460	71599
Top and Bottom of Pay Section (Perforated or Open-Hole Interval)	5547' - 4920'	6923' - 6907'	7620' - 7398'
Method of Production (Flowing or Artificial Lift)	Flowing	Flowing	Flowing
Bottomhole Pressure (Note: Pressure data will not be required if the bottom perforation in the lower zone is within 150% of the depth of the top perforation in the upper zone)			
Oil Gravity or Gas BTU (Degree API or Gas BTU)	1122 BTU	Estimated	1122 BTU
Producing, Shut-In or New Zone	Producing		Producing
Date and Oil/Gas/Water Rates of Last Production. (Note: For new zones with no production history, applicant shall be required to attach production estimates and supporting data.)	Date: 12 month average Rate: Oil Gas Water .085 49 .42 MCF/D Bbl Bbl	Date: Estimated Rate: Oil Gas Water 2 .150 0 MCF/D Bbl Bbl	Date: 12 month average Rate: Oil Gas Water .037 39 .026 MCF/D Bbl Bbl
Fixed Allocation Percentage (Note: If allocation is based upon something other than current or past production, supporting data or explanation will be required.)	Oil Gas 4 % 21 %	Oil Gas 94 % 62 %	Oil Gas 2 % 17 %

ADDITIONAL DATA

Are all working, royalty and overriding royalty interests identical in all commingled zones? Yes X No ____
If not, have all working, royalty and overriding royalty interest owners been notified by certified mail? Yes ____ No ____
Are all produced fluids from all commingled zones compatible with each other? Yes X No ____
Will commingling decrease the value of production? Yes ____ No X
If this well is on, or communitized with, state or federal lands, has either the Commissioner of Public Lands or the United States Bureau of Land Management been notified in writing of this application? Yes ____ No ____

NMOCD Reference Case No. applicable to this well: DHC-1868-A, DHC-2069-A, DHC-3187, DHC-2248, DHC-2102

Attachments:

- C-102 for each zone to be commingled showing its spacing unit and acreage dedication.
- Production curve for each zone for at least one year. (If not available, attach explanation.)
- For zones with no production history, estimated production rates and supporting data.
- Data to support allocation method or formula.
- Notification list of working, royalty and overriding royalty interests for uncommon interest cases.
- Any additional statements, data or documents required to support commingling.

PRE-APPROVED POOLS

If application is to establish Pre-Approved Pools, the following additional information will be required:

- List of other orders approving downhole commingling within the proposed Pre-Approved Pools
- List of all operators within the proposed Pre-Approved Pools
- Proof that all operators within the proposed Pre-Approved Pools were provided notice of this application.
- Bottomhole pressure data.

I hereby certify that the information above is true and complete to the best of my knowledge and belief.

SIGNATURE Robert L. Verquer TITLE Superintendent DATE June 30, 2005
TYPE OR PRINT NAME Robert L. Verquer TELEPHONE NO. (505) 334-4323

State of New Mexico
Energy, Minerals and Natural Resources Department

OIL CONSERVATION DIVISION

1220 South St. Frances Dr.
Santa Fe, New Mexico 87505

SUNDRY NOTICES AND REPORTS ON WELLS (DO NOT USE THIS FORM FOR PROPOSALS TO DRILL OR TO DEEPEN OR TO PLUG BACK TO A DIFFERENT RESERVOIR. USE "APPLICATION FOR PERMIT" (FORM C-101) FOR SUCH PROPOSALS.)

WELL API NO.

30-039-22601

5. Indicate Type of Lease

STATE ☐ FEE ☐

6. State Oil & Gas Lease No.

E29138

7. Lease Name or Unit Agreement Name

STATE COM

8. Well No.

113-E

9. OGRID Number

003824

Pool Name or Wildcat

DAKOTA, MESA VERDE

1. Type of Well

Oil Well ☐ Gas Well ☐ Other ☐

2. Name of Operator

Caulkins Oil Company

3. Address of Operator

1409 W. Aztec Blvd., Suite B7, Aztec, NM 87410

4. Well Location

Unit Letter P : 1110' feet from the South line and 950' feet from the East line
2 Section 26N Township 6W Range NMPM Rio Arriba County

10. Elevation (Show Whether DF,RKB,RT,GR,etc.)

6646 GR

Pit or Below-grade Tank Application ☐ or Closure ☐

Pit type _____ Depth to Groundwater _____ Distance from nearest fresh water well _____ Distance from nearest surface water _____

Pit Liner thickness: _____ mil Below-grade Tank: Volume _____ bbls; Construction Material _____

NOTICE OF INTENTION TO:

Perform Remedial Work ☐ Plug and Abandon ☐

Temporarily Abandon ☐ Change Plans ☐

Pull or Alter Casing ☐ Multiple Completion ☐

Other: _____ ☐

SUBSEQUENT REPORT OF:

Remedial Work ☐ Altering Casing ☐

Commence Drilling Opns. ☐ Plug and Abandonment ☐

Casing Test and Cement Job ☐

Other: _____ ☐

12. Describe Proposed or Completed Operations

6-29-04 Rig up.

T. O. H. standing back 2 3/8" tubing.

Run wireline set retrievable bridge plug to 7000'.

Run gas spectrum log, 6950' to 6300'.

Perforate Tocito zone, 6923' to 6907', with 4 shots per foot.

T. I. H. with 2 7/8" tubing and full bore packer to approximately 6300'.

Frac Tocito zone with 20,000# 20/40 sand and N₂ foam.

(continued on page 2)

NOTE: This format is in lieu of State Form C-103.

I hereby certify that the information above is true and complete to the best of my knowledge and belief.

SIGNATURE

Robert L. Verquer

ROBERT L. VERQUER

TITLE Superintendent

DATE June 30, 2005

Ph. (505) 334-4323

(This space for State Use)

APPROVED BY _____

TITLE _____

DATE _____

CONDITIONS OF APPROVAL, IF ANY:

Caulkins Oil Company
NMOCD C-103 Sundry
State Com 113-E
June 30, 2005
Page 2

Flow back well to clean up and test Tocito.

T. O. H. laying down 2 7/8" tubing with packer.

T. I. H. with 2 3/8" tubing with retrieving head.

T. O. H. with retrievable bridge plug from 7000'.

T. I. H. with 2 3/8" production string.

Clean out to PBTD with air foam unit.

Land tubing on doughnut at approximately 7600'.

Rig down and move.

No new surface will be disturbed, location area will be cleaned up following operations.

Estimated starting date, September 5, 2005

NMOCD C-102 for South Blanco Tocito attached.

All distances must be from the outer boundaries of the Section.

Operator Caulkins Oil Company		Lease State "A"		Well No. 113-E	
Unit Letter P	Section 2	Township 26 North	Range 6 West	County Rio Arriba	
Actual Footage Location of Well: 1110 feet from the South line and 950 feet from the East line					
Ground Level Elev. 6646	Producing Formation Mesa Verde - Dakota		Pool Blanco Mesa Verde - Basin Dakota		Dedicated Acreage: 320 MV & Dak. Acre:

1. Outline the acreage dedicated to the subject well by colored pencil or hachure marks on the plat below.
2. If more than one lease is dedicated to the well, outline each and identify the ownership thereof (both as to working interest and royalty).
3. If more than one lease of different ownership is dedicated to the well, have the interests of all owners been consolidated by communitization, unitization, force-pooling, etc?

☒ Yes ☐ No If answer is "yes," type of consolidation Communitization

If answer is "no," list the owners and tract descriptions which have actually been consolidated. (Use reverse side of this form if necessary.)

No allowable will be assigned to the well until all interests have been consolidated (by communitization, unitization, forced-pooling, or otherwise) or until a non-standard unit, eliminating such interests, has been approved by the Division

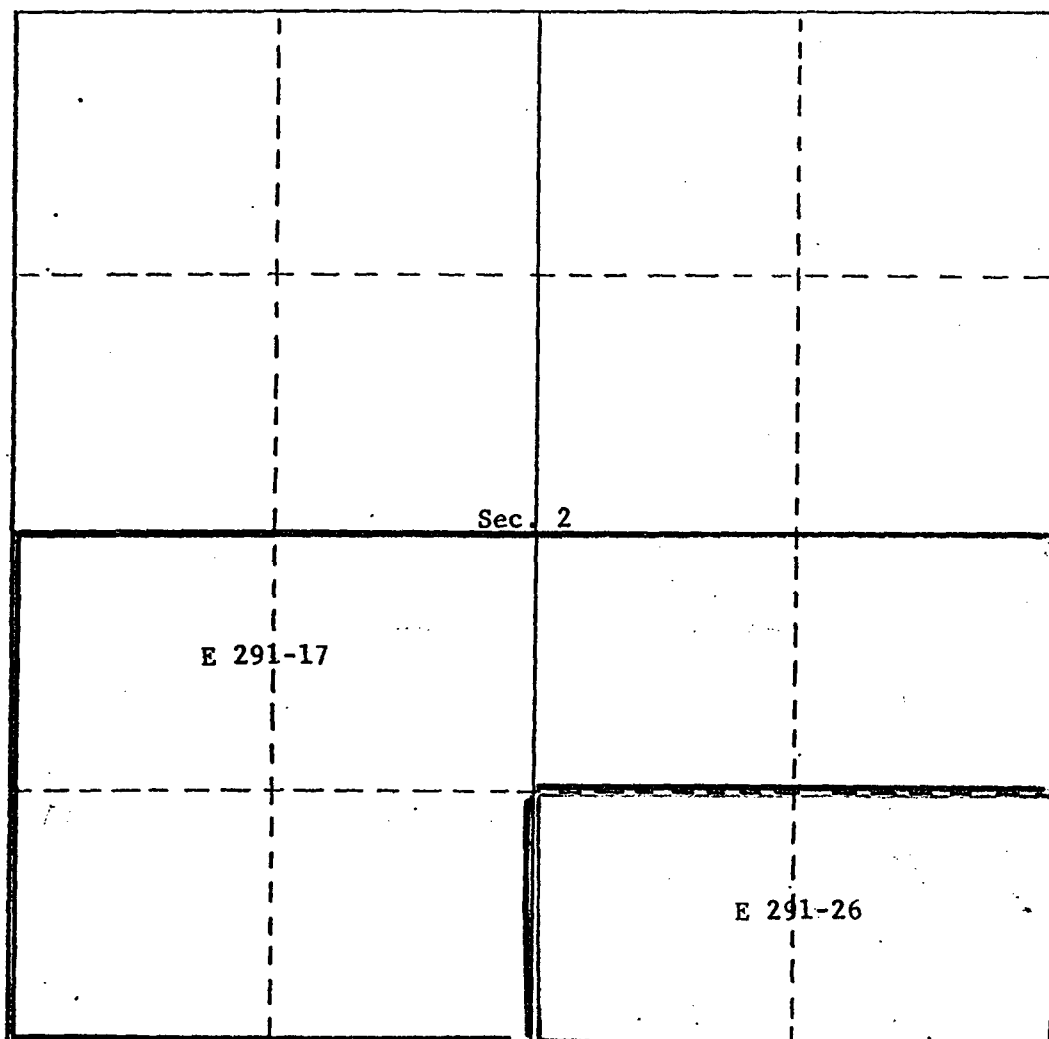

CERTIFICATION

I hereby certify that the information contained herein is true and complete to the best of my knowledge and belief.

Name

Charles E. Verquer

Position

Superintendent

Company

Caulkins Oil Company

Date

8-29-85

I hereby certify that the well location shown on this plot was plotted from field notes of actual surveys made by me or under my supervision, and that the same is true and correct to the best of my knowledge and belief.

Date Surveyed

6 November, 1980Registered Professional Engineer
and/or Land Surveyor**C002425****Curtis Stocking**

Certificate No.

NMLS 5980

0 330 660 990 1320 1650 1980 2310 2640 2000 1500 1000 500 0

District I

State of New Mexico

Form C-102

PO Box 1980, Hobbs, NM 88241-1980

Energy, Minerals & Natural Resources Department

Revised October 18, 1994

District II

Instructions on back

811 South First, Artesia, NM 88210

OIL CONSERVATION DIVISION

Submit to Appropriate District Office

District III

1220 South St. Francis Drive

State Lease - 4 Copies

1000 Rio Brazos Rd., Aztec, NM 87410

Santa Fe, NM 87504

Fee Lease - 3 Copies

District IV

2040 South Pacheco, Santa Fe, NM 87505



AMENDED REPORT

WELL LOCATION AND ACREAGE DEDICATION PLAT

¹ API Number 30-039-22601		² Pool Code 06460		³ Pool Name SOUTH BLANCO TOCITO	
⁴ Property Code 14243		⁵ Property Name STATE COM			⁶ Well Number 113-E
⁷ OGRID No. 003824		⁸ Operator Name Caulkins Oil Company			⁹ Elevation 6646 GR

¹⁰ Surface Location

UL or lot no. P	Section 2	Township 26N	Range 6W	Lot Idn	Feet from the 1110'	North/South line South	Feet from the 950'	East/West line East	County Rio Arriba
---------------------------	---------------------	------------------------	--------------------	---------	-------------------------------	----------------------------------	------------------------------	-------------------------------	-----------------------------

¹¹ Bottom Hole Location If Different From Surface

UL or lot no.	Section	Township	Range	Lot Idn	Feet from the	North/South line	Feet from the	East/West line	County
¹² Dedicated Acres 80		¹³ Joint or Infill		¹⁴ Consolidation Code		¹⁵ Order No.			

NO ALLOWABLE WILL BE ASSIGNED TO THIS COMPLETION UNTIL ALL INTERESTS HAVE BEEN CONSOLIDATED OR A NON-STANDARD UNIT HAS BEEN APPROVED BY THE DIVISION

¹⁶ 	¹⁷ OPERATOR CERTIFICATION I hereby certify that the information contained herein is true and complete to the best of my knowledge and belief Signature Printed Name Robert L. Verquer Title Superintendent Date June 30, 2005			
	¹⁸ SURVEYOR CERTIFICATION I hereby certify that the well location shown on this plat was plotted from field notes of actual surveys made by me or under my supervision, and that the same is true and correct to the best of my knowledge and belief. Date of Survey Signature and Seal of Professional Surveyor:			
	Certificate Number			

**LAST 12-MONTHS PRODUCTION
FOR
STATE COM 113-E**

DAKOTA

MONTH	GAS	OIL	WATER	DAYS	GAS DPA	OIL DPA
05/04	1121	2	0	31	36	0.065
06/04	1084	2	0	30	36	0.067
07/04	654	2	0	19	34	0.105
08/04	271	1	0	6	45	0.167
09/04	1001	0	0	25	40	0.000
10/04	1213	0	0	30	40	0.000
11/04	1082	0	0	30	36	0.000
12/04	1156	0	0	31	37	0.000
01/05	1237	0	0	31	40	0.000
02/05	996	1	0	28	36	0.036
03/05	330	0	0	9	37	0.000
05/05	1360	0	0	29	47	0.000
	11,505	8	0		39	0.037

MESA VERDE

MONTH	GAS	OIL	WATER	DAYS	GAS DPA	OIL DPA
05/04	1402	4	1	31	45	0.129
06/04	1356	5	1	30	45	0.167
07/04	815	3	0	19	43	0.158
08/04	346	3	0	6	58	0.500
09/04	1266	0	0	25	51	0.000
10/04	1534	0	0	30	51	0.000
11/04	1353	0	0	30	45	0.000
12/04	1452	0	0	31	47	0.000
01/05	1563	1	0	31	50	0.032
02/05	1245	0	0	28	44	0.000
03/05	413	0	0	9	46	0.000
05/05	1742	1	0	29	60	0.034
	14,487	17	2		49	0.085