

4.4-95

1116

OIL CONSERVATION DIVISION
RECEIVED

'95 MAR 16 PM 8 52

Southern

Rockies

Business

Unit

March 13, 1995

Mr. William J. LeMay, Director
New Mexico Oil Conservation Division
2040 S. Pacheco Street
P. O. Box 6429
Santa Fe, NM 87504

Application for Exception to Rule 303-A
Downhole Commingling
Schwerdtfeger A 3 Well
815' FWL, 885' FNL, Section 6-T27N-R8W
Blanco Mesaverde and Basin Dakota Pools
San Juan County, New Mexico

Amoco Production Company hereby requests administrative approval to downhole commingle production from the Blanco Mesaverde and Basin Dakota Pools in the Schwerdtfeger A 3 well referenced above. The Schwerdtfeger A 3 well was originally completed in the Dakota formation. We plan to recompleate the well to the Mesaverde with both zones open in the wellbore. The two zones are expected to produce at a total commingled rate of about 500 MCFD. The ownership (WI, RI, ORRI) of these pools is identical in this wellbore. Downhole commingling will offer an economical method of production while protecting against reservoir damage, waste of reserves and violation of correlative rights. Offset operators to this well will receive a copy of this application by certified mail.

The allocation method that we plan to use for this commingled well is as follows. We plan to determine the stabilized rate from the Dakota formation prior to the recompleation of the Mesaverde. After recompleation of the Mesaverde formation, we will allow the production to stabilize to a rate from the Mesaverde and Dakota commingled zones. The allocation percentages would then be fixed at the Dakota stabilized rate as a percentage of the total stabilized rate. Once these rates have been established we will notify your Aztec District.

Should you have questions concerning this matter, please contact me at (303) 830-5344.

Sincerely,

Pamela W. Staley

Enclosures

cc: Wayne Branam
Lara Kwartin

Frank Chavez, Supervisor
Amoco District III
1000 Rio Brazos Road
Aztec, NM 87410

Robert Kent
Bureau of Land Management
435 Montano NE
Albuquerque, NM 87107

LIST OF ADDRESSES FOR INTEREST OWNERS
(Numbers referenced to attached plats)

- 1 Amoco Production Company
- 2 Texaco E&P, Inc.
P.O. box 2100
Denver, CO 80201
- 3 Mobil Production Texas and New Mexico, Inc.
P.O. Box 2080
Dallas, Texas 75221-2080
- 4 Northwest Pipeline Corproation
P.O. Box 58900
Salt Lake, City, UT 84158-0900

SCALE 1 IN. = 2,000 FT. JAN 28, 1995

HORIZONTAL DATUM NAD27

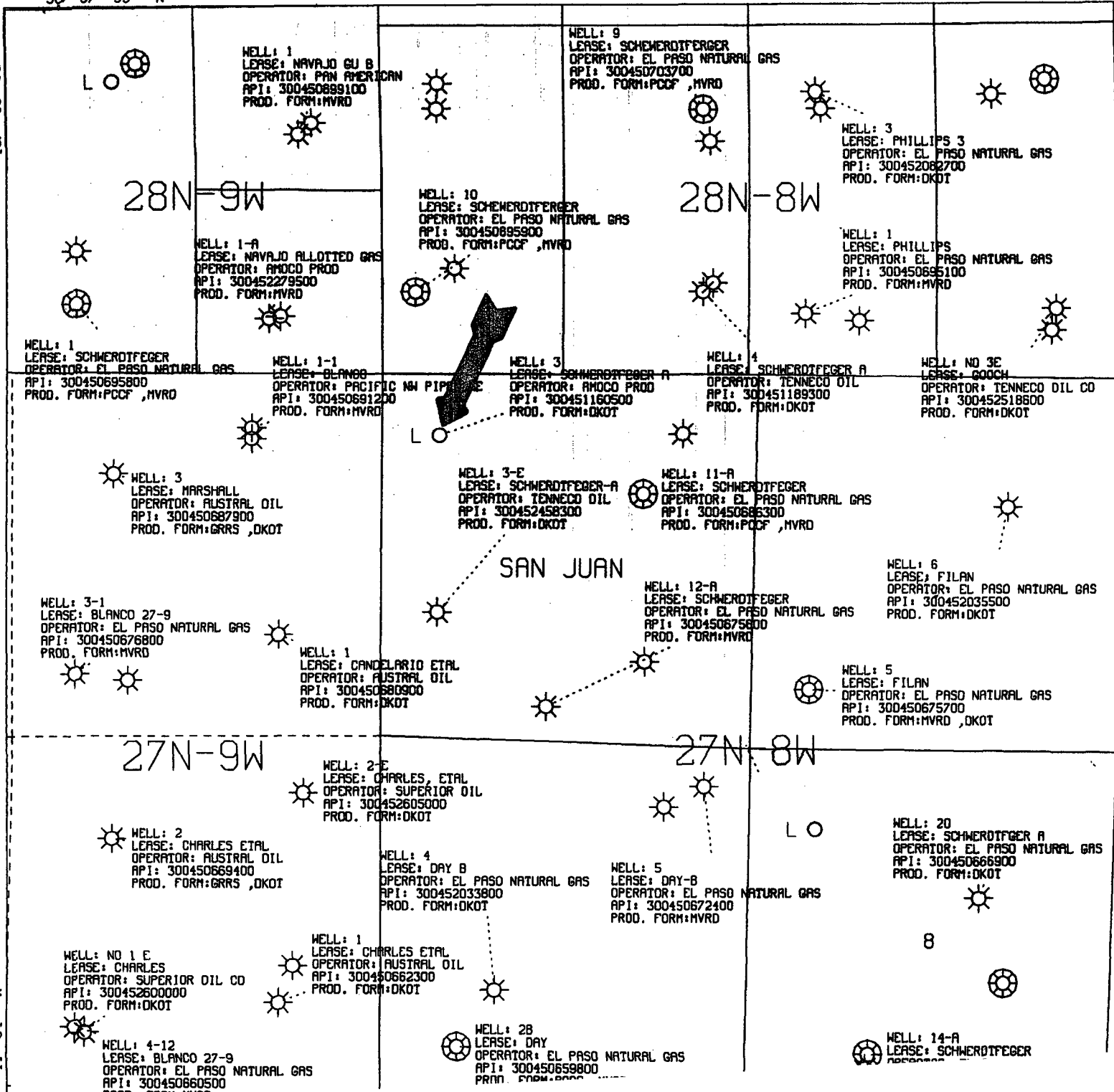

San Juan O.C.
WELL: SCHWERDTFEGER A 003-DK (97892901)
(Downtime excluded)

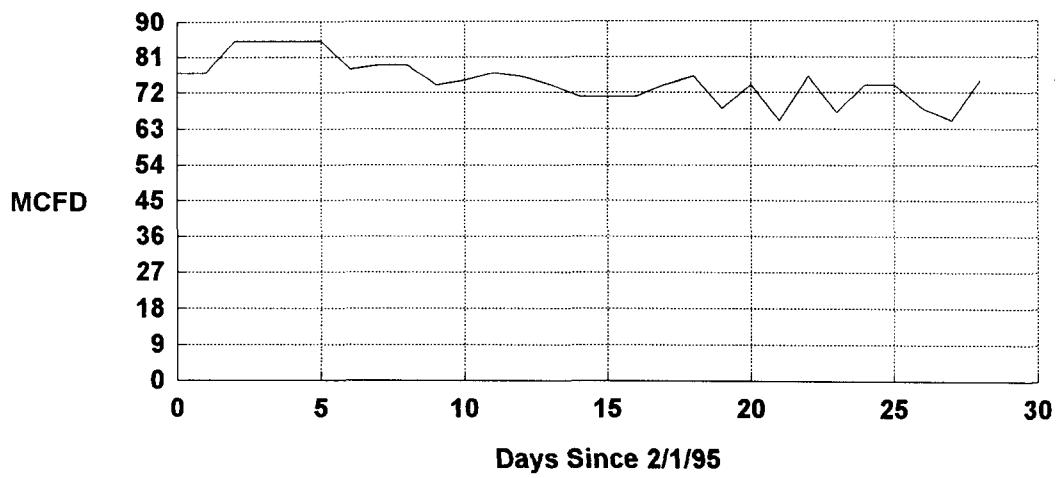

District I
PO Box 1980, Hobbs, NM 88241-1980
District II
PO Drawer DD, Artesia, NM 88211-0719
District III
1000 Rio Brazos Rd., Aztec, NM 87410
District IV
PO Box 2088, Santa Fe, NM 87504-2088

State of New Mexico
Energy, Minerals & Natural Resources Department

OIL CONSERVATION DIVISION
PO Box 2088
Santa Fe, NM 87504-2088

Form C-102
Revised February 21, 1991

Instructions on back
Submit to Appropriate District Office
State Lease - 4 Copies
Fee Lease - 3 Copies

☒ AMENDED REPORT
Number change

WELL LOCATION AND ACREAGE DEDICATION PLAT

1 API Number 30-045-24594		1 Pool Code 72319		1 Pool Name Blanco Mesavende		
1 Property Code 001031		1 Property Name Schwerdtfeger A			1 Well Number old # 6E New # 6M	
1 OGRID No. 000778		1 Operator Name Amoco Production Company			1 Elevation 6134	

10 Surface Location

UL or lot no. D	Section 8	Township 27N	Range 8W	Lot Idn	Feet from the 1120	North/South line FNL	Feet from the 940	East/West line FWL	County SAN JUAN
--------------------	--------------	-----------------	-------------	---------	-----------------------	-------------------------	----------------------	-----------------------	--------------------

11 Bottom Hole Location If Different From Surface

UL or lot no.	Section	Township	Range	Lot Idn	Feet from the	North/South line	Feet from the	East/West line	County
---------------	---------	----------	-------	---------	---------------	------------------	---------------	----------------	--------

12 Dedicated Acres 320	13 Joint or Infill Y	14 Consolidation Code	15 Order No.
---------------------------	-------------------------	-----------------------	--------------

NO ALLOWABLE WILL BE ASSIGNED TO THIS COMPLETION UNTIL ALL INTERESTS HAVE BEEN CONSOLIDATED
OR A NON-STANDARD UNIT HAS BEEN APPROVED BY THE DIVISION

16 420 940					17 OPERATOR CERTIFICATION I hereby certify that the information contained herein is true and complete to the best of my knowledge and belief Signature A. WAYNE BRANAM Printed Name BUSINESS ANALYST Title 02 07 95 Date
					18 SURVEYOR CERTIFICATION I hereby certify that the well location shown on this plat was plotted from field notes of actual surveys made by me or under my supervision, and that the same is true and correct to the best of my belief. 08 08 80 Date of Survey Signature and Seal of Professional Surveyor: ON file 3950 Certificate Number

NEW MEXICO OIL CONSERVATION COMMISSION
WELL LOCATION AND ACREAGE DEDICATION PLAT

Form O-102
Supersedes O-128
Effective 1-1-67

All distances must be from the outer boundaries of the Section.

Operator TENNECO OIL COMPANY		Lease SCHWERTFEGER "A"		Well No. 3
Unit Letter D	Section 6	Township 27 North	Range 8 West	County San Juan
Actual Footage Location of Well: 885 feet from the North line and 815 feet from the West line				
Ground Level Elev. 5902' ungraded	Producing Formation Basin Dakota	Pool Dakota	Dedicated Acreage: 30.68 Acres	

1. Outline the acreage dedicated to the subject well by colored pencil or hatchure marks on the plat below.
2. If more than one lease is dedicated to the well, outline each and identify the ownership thereof (both as to working interest and royalty).
3. If more than one lease of different ownership is dedicated to the well, have the interests of all owners been consolidated by communitization, unitization, force-pooling, etc?

☐ Yes ☐ No If answer is "yes," type of consolidation _____

If answer is "no," list the owners and tract descriptions which have actually been consolidated. (Use reverse side of this form if necessary.) _____

No allowable will be assigned to the well until all interests have been consolidated (by communitization, unitization, forced-pooling, or otherwise) or until a non-standard unit, eliminating such interests, has been approved by the Commission.

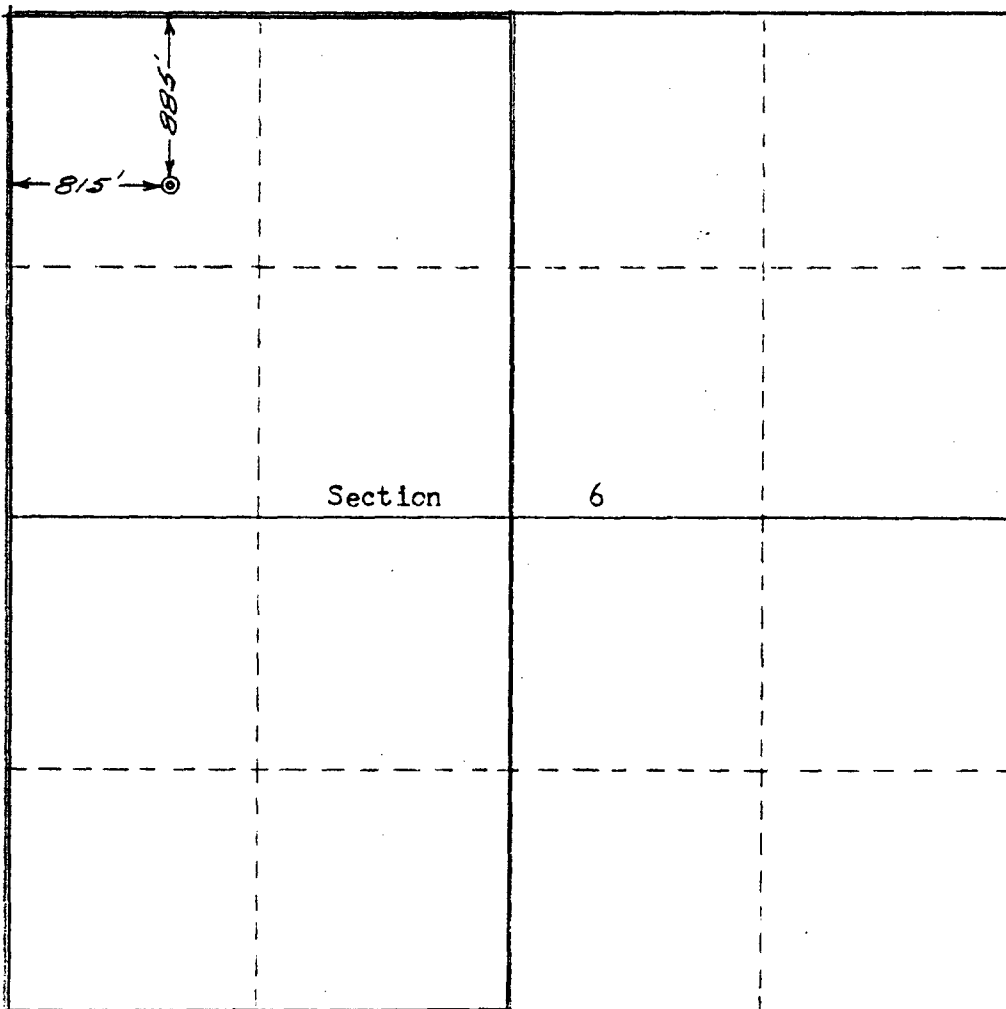

CERTIFICATION

I hereby certify that the information contained herein is true and complete to the best of my knowledge and belief.

Harold C. Nichols

Name **Harold C. Nichols**
Position **Senior Production Clerk**

Company **Tenneco Oil Company**

P. O. Box 1714, Durango, Colorado

Date **October 25, 1965**

I hereby certify that the well location shown on this plat was plotted from field notes of actual surveys made by me or under my supervision, and that the same is true and correct to the best of my knowledge and belief.

Date Surveyed **8 October 1965**

Registered Professional Engineer and/or Land Surveyor

Robert H. Ernst
ROBERT H. ERNST

Certificate No.

N. Mex. PE & LS 2463

Scale: 1" = 400' (0 to 2000 feet)

Amoco Production Company
Offset Operator Plat
Schwerdtfeger LS-12
T27N-R8W, Section 6
2350'FWL & 500'FSL
Blanco Mesaverde Formation

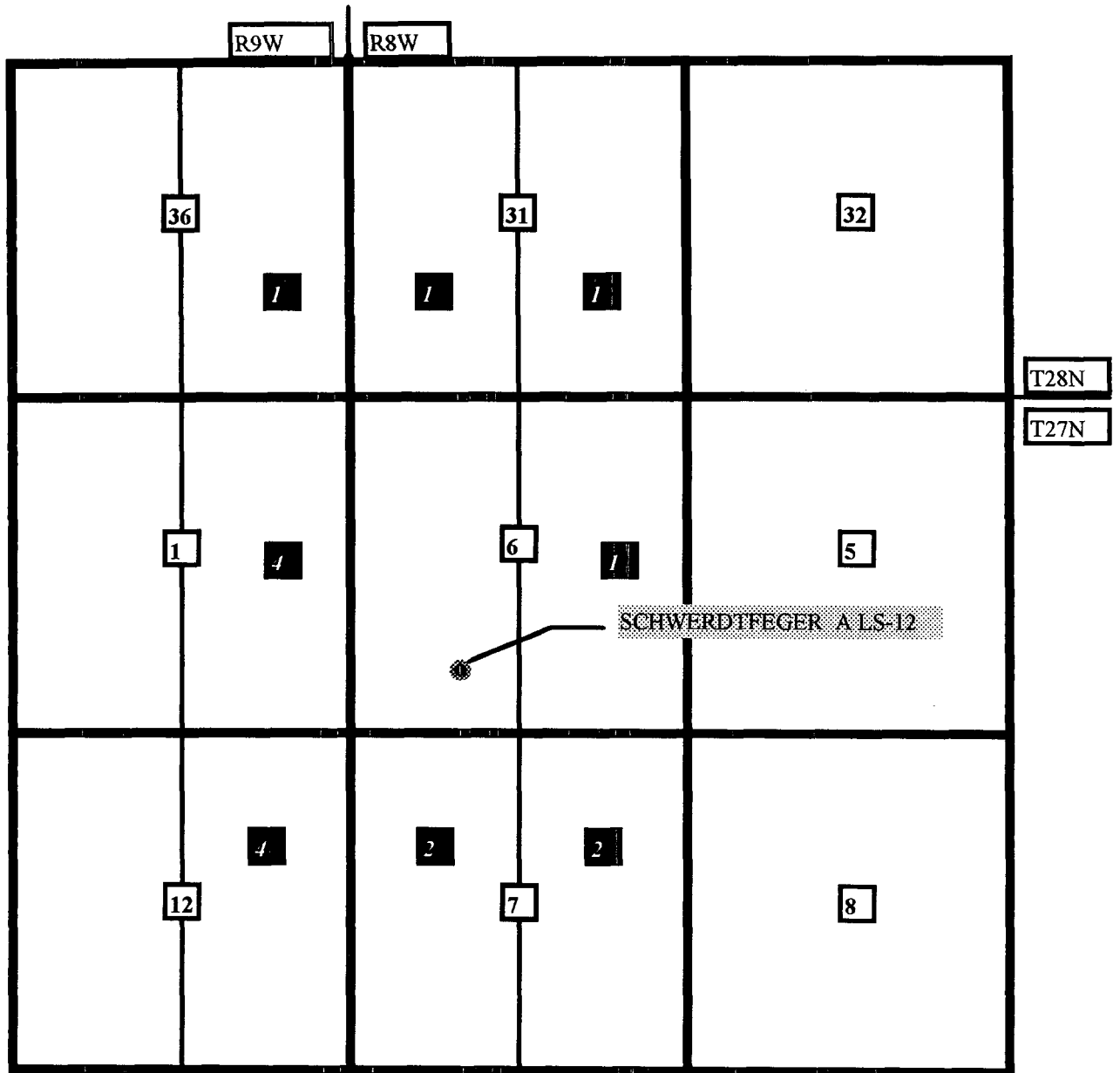

Amoco Production Company
Offset Operator Plat
Schwerdtfeger A-3
T27N-R8W, Section 6
815'FWL & 885'FNL
Dakota Formation

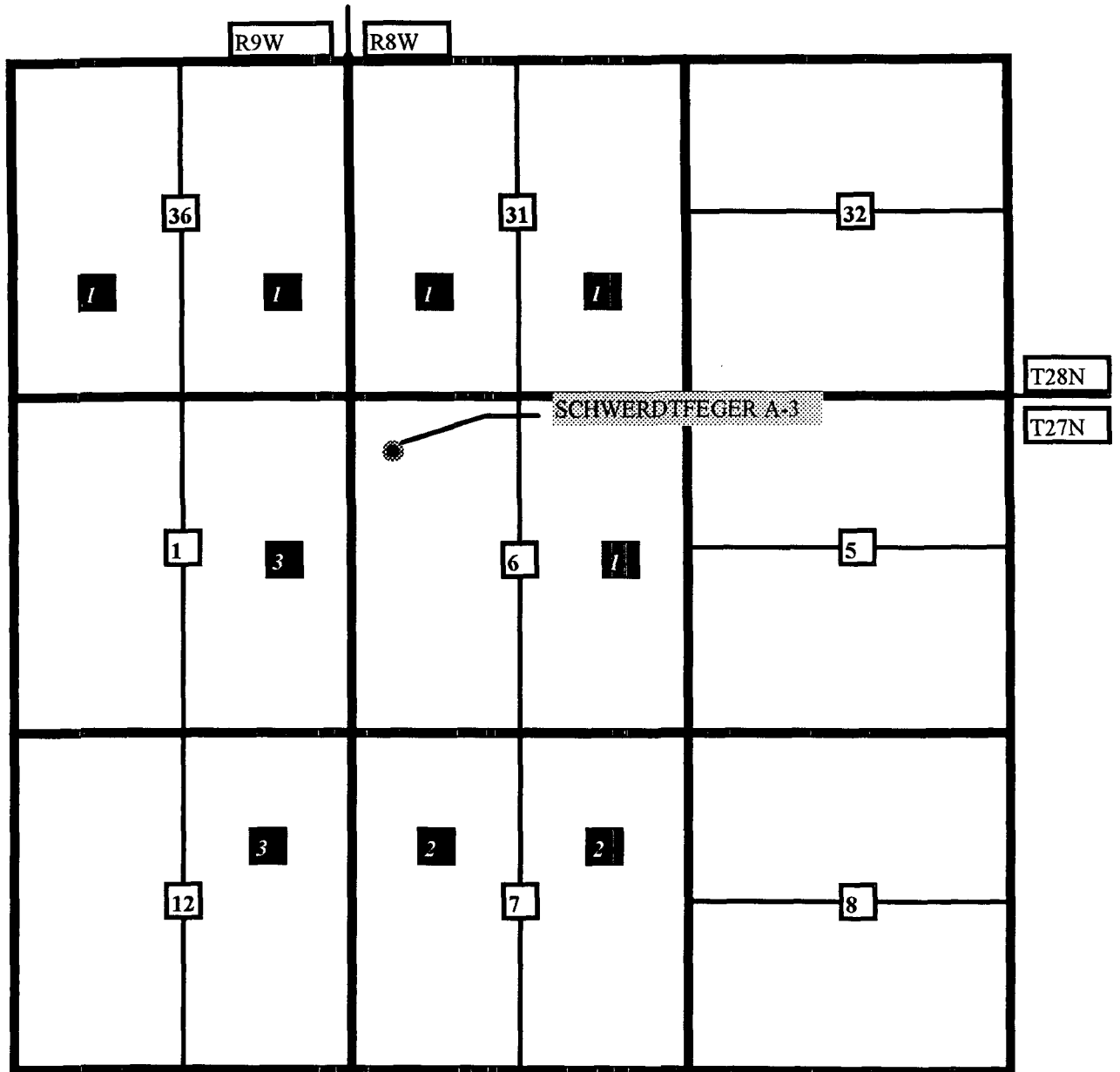

SCHWERDTFEGGER A 3

Operator- AMOCO PRODUCTION CO

Engr: zr4r06

300451160500DK

D062708-003 DK

APC_WI -

0.50000000

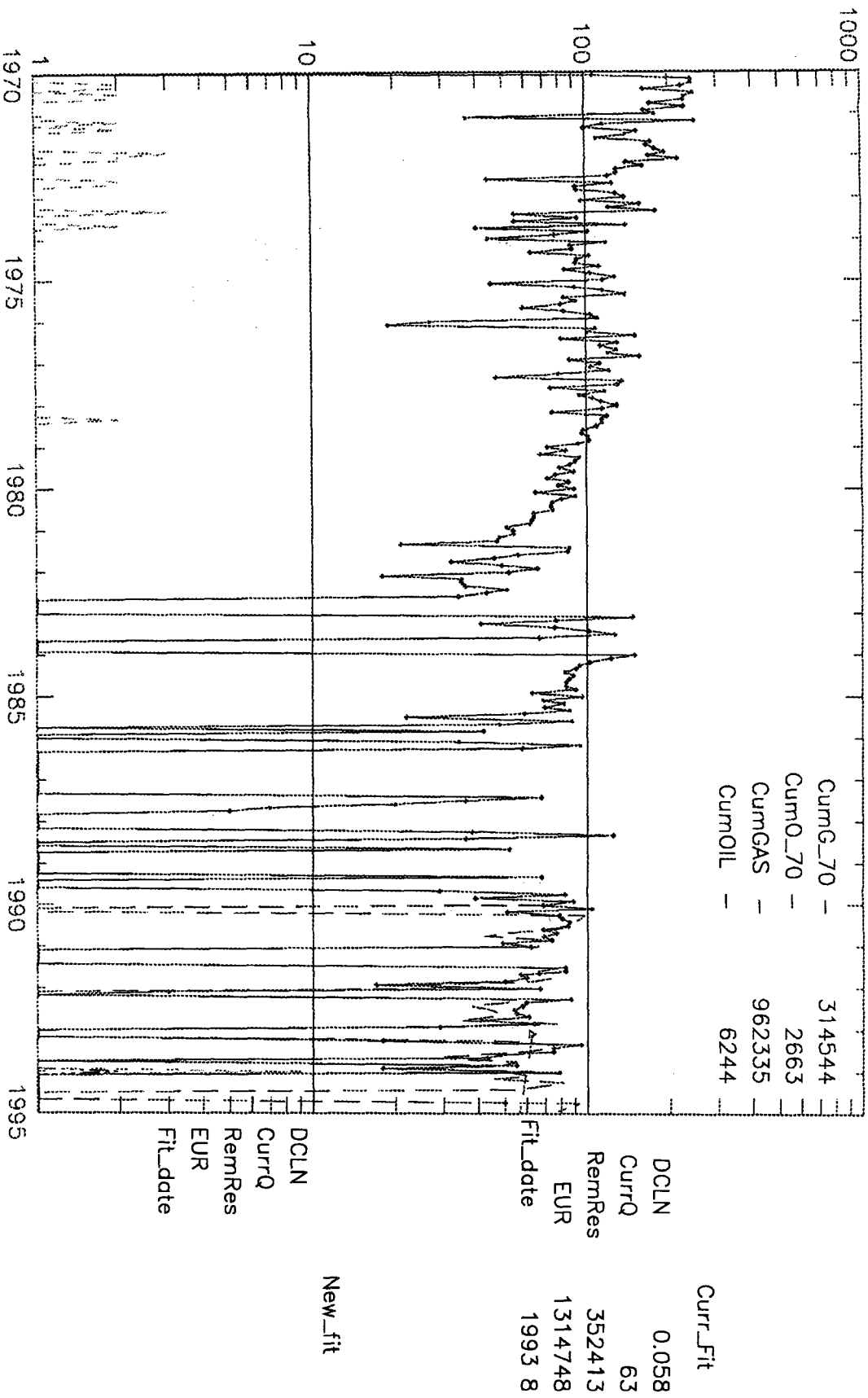

OFFSET WELL PRESSURES AND API GRAVITY INFORMATION

WELLNAME	DK PRESSURE	MV PRESSURE	API GRAVITY
Schwerdtfeger A 3	320 TP	----	51.4
Schwerdtfeger A LS 11	----	267 TP	57.4
Schwerdtfeger A LS 12	----	241 TP	59.7