



DHC 10-4-95
1164

Midland Division
Exploration Production

OIL CONSERVATION DIVISION
RECEIVED

Conoco Inc.
10 Desta Drive, Suite 100W
Midland, TX 79705-4500
(915) 686-5400

05 SEP 15 AM 8 52

September 12, 1995

State of New Mexico
Oil Conservation Division
2040 Pacheco
Santa Fe, New Mexico 87504

**Re: Application to Downhole Commingle
Blinebry and Tubb Production in the
Lockhart B-35 No. 3, 1980' FNL & 660' FEL,
Section 35, R-21S, R-37E, Lea County, New Mexico**

Gentlemen:

Conoco Inc. requests administrative approval to downhole commingle production from the Blinebry and Tubb pools in its Lockhart B-35 No. 3 well to maximize the efficient and effective recovery of reserves from both pools.

This well currently flows 1 BOPD and 37 MCFGPD from the Tubb, but has been shutin in the Blinebry since April, 1993 since the Blinebry will not flow and a dual completion cannot be justified for these very marginal rates.

The following attachments are submitted in support of this application:

1. EXHIBIT A is a plat of Conoco's Lockhart B-35 Lease with the well No. 3 indicated by the arrow and all offset operators shown on the surrounding tracts.
2. EXHIBITS B and C are decline curves for the Blinebry and Tubb completions respectively.
3. EXHIBIT D is a C-116 showing the latest tests for both zones.
4. Estimated bottomhole pressures are 640 psi for the Blinebry and 400 psi for the Tubb.
5. There should be no fluid compatibility problems since the Tubb makes no water and the Blinebry only one barrel per day. Also the gravities of both oils are 35.9° API.
6. Since the oil gravities are identical the value of the commingled fluid will remain the same as the separated pools.

7. Allocation percentages based on the submitted C-116 data are suggested as follows:

	<u>Oil</u>	<u>Gas</u>	<u>Water</u>
Blinebry	25%	41%	100%
Tubb	75%	59%	0%

8. Ownership is common in both pools and correlative rights will not be violated.
9. Offset operators to the east, southeast, and south of this 40-acre spacing unit are:
- Amoco, Cross Timbers, & OXY
10. EXHIBIT E shows copies of the certified mail receipts for the notices of this application that were sent to each of the above operators.

Very truly yours,



Jerry W. Hoover
Sr. Conservation Coordinator

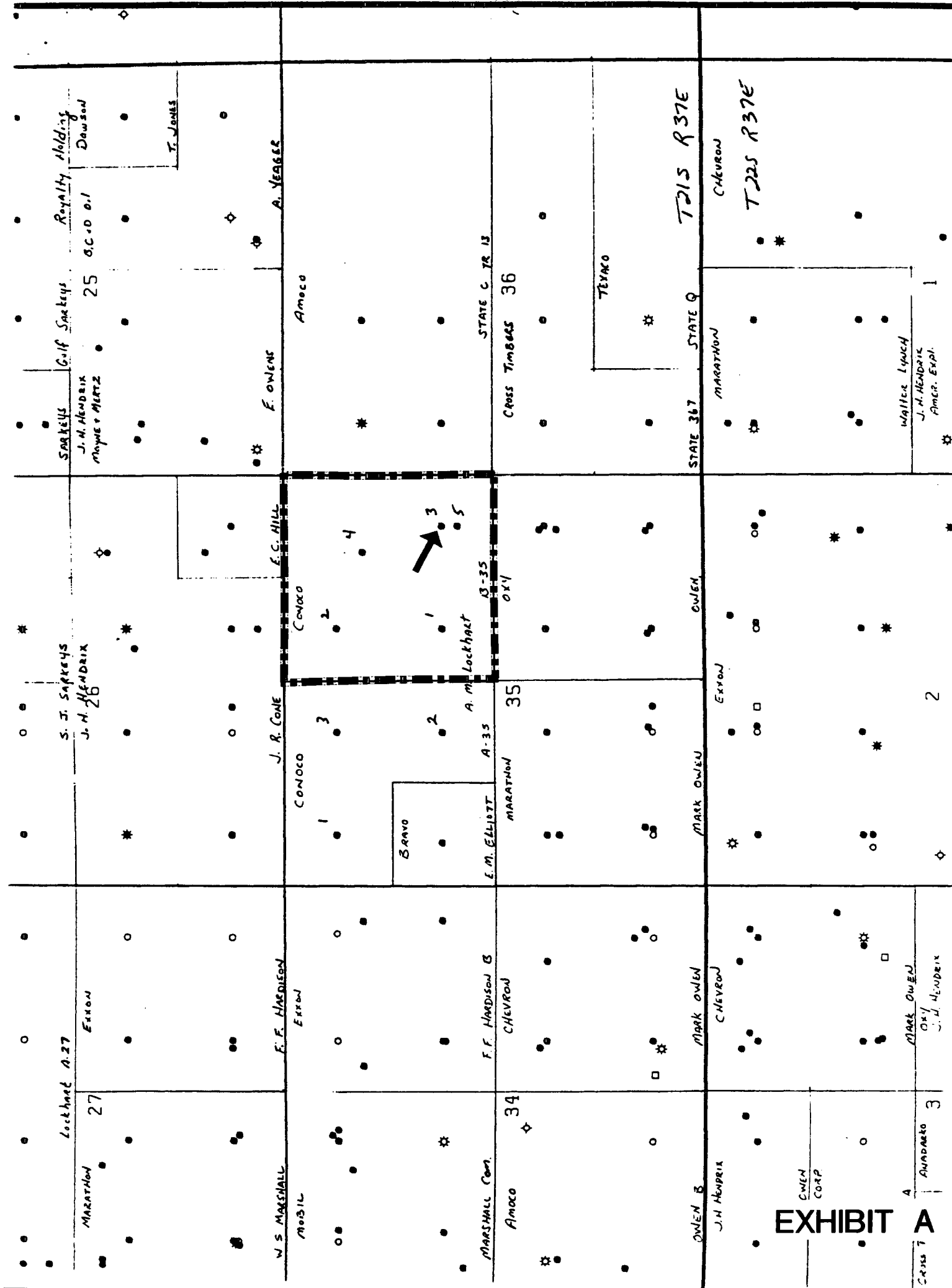

WELL: LOCKHART B 35 NO.3

BLINEBRY

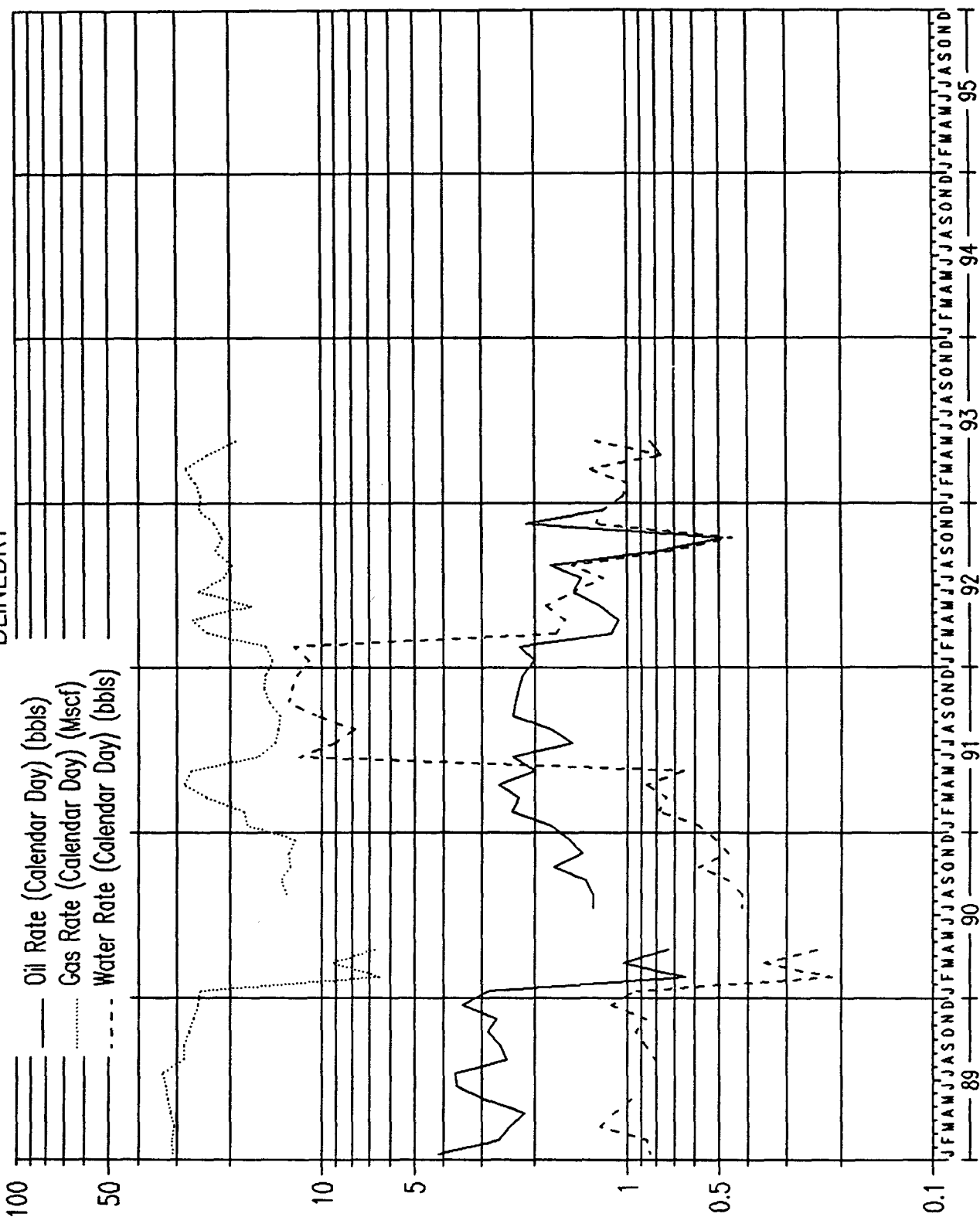

WELL: LOCKHART B 35 3 NO.3

TUBB

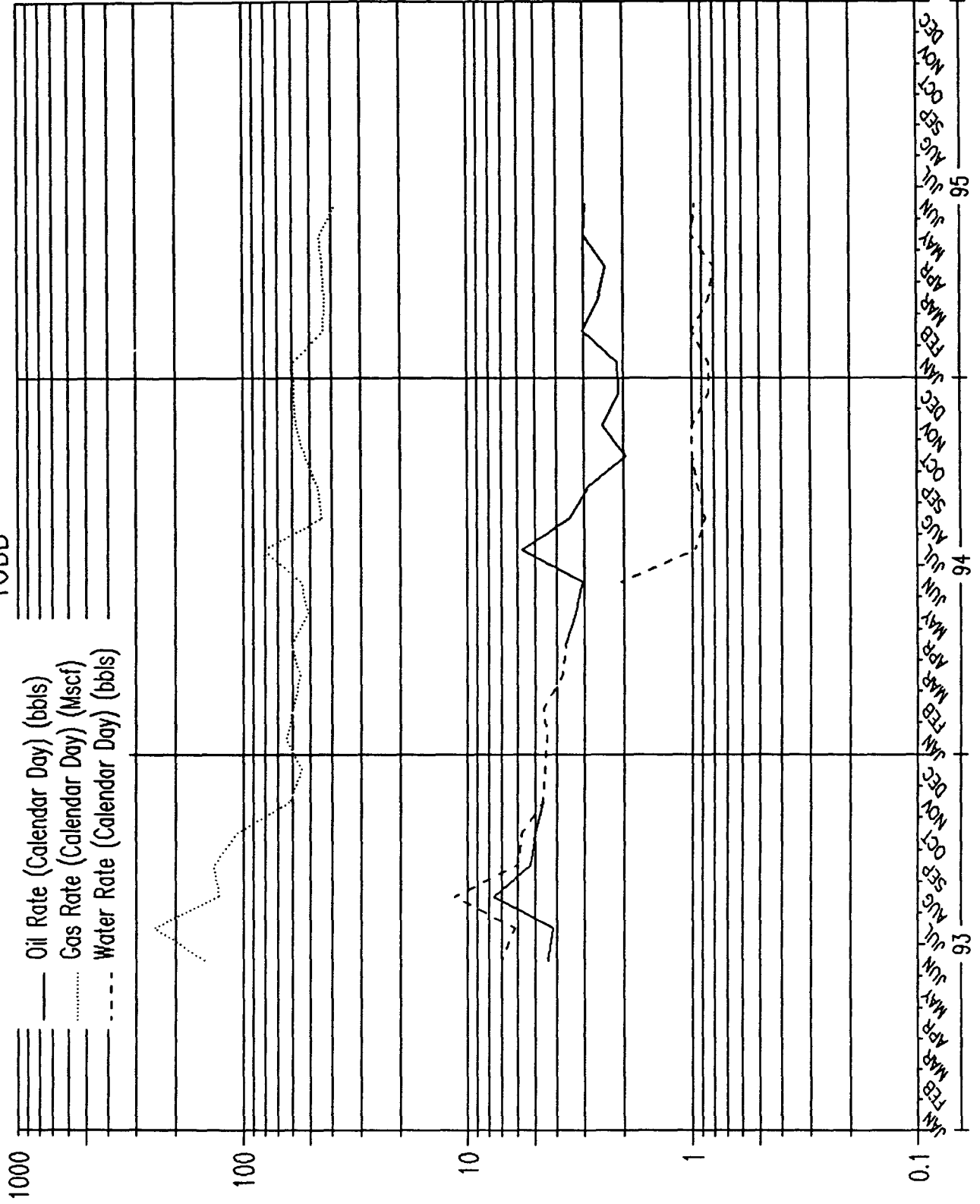

EXHIBIT C

Submit 2 copies to Appropriate District Office.
DISTRICT I
P.O. Box 1980, Hobbs, NM 88240
DISTRICT II
P.O. Drawer DD, Artesia, NM 88210
DISTRICT III
1000 Rio Brazos Rd., Aztec, NM 87410

State of New Mexico
Energy, Minerals and Natural Resources Department

Form C-116
Revised 1/1/89

OIL CONSERVATION DIVISION

P.O. Box 2088
Santa Fe, New Mexico 87504-2088

GAS - OIL RATIO TEST

Operator Conoco Inc.		Pool Tubb Gas		County Lea										
Address 10 Desta Dr., Ste 100W, Midland, Tx 79703		TYPE OF TEST - (X)		Completion <input type="checkbox"/> Scheduled <input type="checkbox"/> Special <input checked="" type="checkbox"/>										
LEASE NAME	WELL NO.	LOCATION			DATE OF TEST	CHOKE SIZE	TBG. PRESS.	DAILY ALLOW-ABLE	LENGTH OF TEST HOURS	PROD. DURING TEST			GAS - OIL RATIO CU FT/888L	
		U	S	T						R	WATER BBL.S.	GRAV. OIL	OIL BBL.S.	GAS MCF.
Lockhart B-35 (Tubb) (Blinebry)	3	H	35	21S	37E	7-18-95	F		24	0	35.9	3	37	12,333
	3	H	35	21S	37E	April '93 last test	S		24	1	35.9	1	26	26,000

Instructions:

During gas-oil ratio test, each well shall be produced at a rate not exceeding the top unit allowable for the pool in which well is located by more than 25 percent. Operator is encouraged to take advantage of this 25 percent tolerance in order that well can be assigned increased allowables when authorized by the Division.

Gas volumes must be reported in MCF measured at a pressure base of 15.025 psia and a temperature of 60° F. Specific gravity base will be 0.60.

Report casing pressure in lieu of tubing pressure for any well producing through casing.

See Rule 301, Rule 1116 & appropriate pool rules.)

I hereby certify that the above information is true and complete to the best of my knowledge and belief.

Signature

Terri Stathem, Sr. O & G. Assistant

Printed name and title

Date 8/15/95 (915) 686-5438

Telephone No.

EXHIBIT D

Z 111 000 217

**Receipt for
Certified Mail**

 No Insurance Coverage Provided
Do not use for International Mail

 Cross Timbers Oil Co.
810 Houston, Ste 2000
Ft. Worth, TX 76102

PS Form 3800, March 1993

Postage	\$
Certified Fee	
Special Delivery Fee	
Restricted Delivery Fee	
Return Receipt Showing to Whom & Date Delivered	
Return Receipt Showing to Whom, Date, and Addressee's Address	
TOTAL Postage & Fees	\$
Postmark or Date 9/12/95	

Z 111 000 216

**Receipt for
Certified Mail**

 No Insurance Coverage Provided
Do not use for International Mail

 Amoco Production Co.
P.O. Box 3092
Houston, Tx 77253

PS Form 3800, March 1993

Postage	\$
Certified Fee	
Special Delivery Fee	
Restricted Delivery Fee	
Return Receipt Showing to Whom & Date Delivered	
Return Receipt Showing to Whom, Date, and Addressee's Address	
TOTAL Postage & Fees	\$
Postmark or Date 9/12/95	

Z 111 000 218

**Receipt for
Certified Mail**

 No Insurance Coverage Provided
Do not use for International Mail

 OXY USA Inc.
P.O. Box 300
Tulsa, OK 74102

PS Form 3800, March 1993

Postage	\$
Certified Fee	
Special Delivery Fee	
Restricted Delivery Fee	
Return Receipt Showing to Whom & Date Delivered	
Return Receipt Showing to Whom, Date, and Addressee's Address	
TOTAL Postage & Fees	\$
Postmark or Date 9/12/95	

EXHIBIT E