

11-5-12	11-26-12	DB	11-5	NSL	1231038506
DATE IN	SUSPENSE	ENGINEER	LOGGED IN	TYPE	APP NO.

ABOVE THIS LINE FOR DIVISION USE ONLY

## NEW MEXICO OIL CONSERVATION DIVISION

- Engineering Bureau -

1220 South St. Francis Drive, Santa Fe, NM 87505



Endurance Resources  
Tuesday Fed #1  
DCCD  
6711

## ADMINISTRATIVE APPLICATION CHECKLIST

THIS CHECKLIST IS MANDATORY FOR ALL ADMINISTRATIVE APPLICATIONS FOR EXCEPTIONS TO DIVISION RULES AND REGULATIONS WHICH REQUIRE PROCESSING AT THE DIVISION LEVEL IN SANTA FE

### Application Acronyms:

[NSL-Non-Standard Location] [NSP-Non-Standard Proration Unit] [SD-Simultaneous Dedication]  
[DHC-Downhole Commingling] [CTB-Lease Commingling] [PLC-Pool/Lease Commingling]  
[PC-Pool Commingling] [OLS - Off-Lease Storage] [OLM-Off-Lease Measurement]  
[WFX-Waterflood Expansion] [PMX-Pressure Maintenance Expansion]  
[SWD-Salt Water Disposal] [IPI-Injection Pressure Increase]  
[EOR-Qualified Enhanced Oil Recovery Certification] [PPR-Positive Production Response]

### [1] TYPE OF APPLICATION - Check Those Which Apply for [A]

- [A] Location - Spacing Unit - Simultaneous Dedication  
☒ NSL ☐ NSP ☐ SD

Check One Only for [B] or [C]

- [B] Commingling - Storage - Measurement  
☐ DHC ☐ CTB ☐ PLC ☐ PC ☐ OLS ☐ OLM

- [C] Injection - Disposal - Pressure Increase - Enhanced Oil Recovery  
☐ WFX ☐ PMX ☐ SWD ☐ IPI ☐ EOR ☐ PPR

- [D] Other: Specify \_\_\_\_\_

### [2] NOTIFICATION REQUIRED TO: - Check Those Which Apply, or ☐ Does Not Apply

- [A] ☐ Working, Royalty or Overriding Royalty Interest Owners  
[B] ☒ Offset Operators, Leaseholders or Surface Owners  
[C] ☐ Application is One Which Requires Published Legal Notice  
[D] ☐ Notification and/or Concurrent Approval by BLM or SLO  
U.S. Bureau of Land Management - Commissioner of Public Lands, State Land Office  
[E] ☒ For all of the above, Proof of Notification or Publication is Attached, and/or,  
[F] ☐ Waivers are Attached

### [3] SUBMIT ACCURATE AND COMPLETE INFORMATION REQUIRED TO PROCESS THE TYPE OF APPLICATION INDICATED ABOVE.

[4] **CERTIFICATION:** I hereby certify that the information submitted with this application for administrative approval is **accurate** and **complete** to the best of my knowledge. I also understand that **no action** will be taken on this application until the required information and notifications are submitted to the Division.

Note: Statement must be completed by an individual with managerial and/or supervisory capacity.

Print or Type Name: RANDALL HARRIS      Signature: [Signature]      Title: Geologist      Date: 10/31/12  
 e-mail Address: rharrism@yahoo.com



11382 Lovington Hwy. ⋈ P.O. Box 1466 ⋈ Artesia, NM 88211-1466 ⋈ Tel: 575-308-0722

October 31, 2012

New Mexico Oil Conservation Division  
1220 South St Francis Dr.  
Santa Fe, NM 87505

RE: Application for a Non-standard Location (NSL)  
Endurance Resources LLC  
Tuesday Federal #1  
30-015-2551

The Tuesday Federal #1 was drilled by Conoco and was completed in the Bone Springs in 1987. Conoco should have filed for a NSL at that time (C-102 attached). The well was sold to Ray Westall Operating in 1988 and then to Endurance Resources in 2008.

Chesapeake is the only offset operator affected and has been notified by certified mail, return receipt requested mail, of this application and a copy of the plat.

  
Randall Harris  
Endurance Resources LLC  
P.O. Box 1466  
Artesia, NM 88211-1466  
575.308.0722

District I  
1625 N. French Dr., Hobbs, NM 88240  
Phone: (575) 393-6161 Fax: (575) 393-0720  
District II  
811 S. First St., Artesia, NM 88210  
Phone: (575) 748-1283 Fax: (575) 748-9720  
District III  
1000 Rio Brazos Road, Aztec, NM 87410  
Phone: (505) 334-6178 Fax: (505) 334-6170  
District IV  
1220 S. St. Francis Dr., Santa Fe, NM 87505  
Phone: (505) 476-3460 Fax: (505) 476-3462

State of New Mexico  
Energy, Minerals & Natural Resources Department  
OIL CONSERVATION DIVISION  
1220 South St. Francis Dr.  
Santa Fe, NM 87505

Form C-102  
Revised August 1, 2011  
Submit one copy to appropriate  
District Office  
☐ AMENDED REPORT

WELL LOCATION AND ACREAGE DEDICATION PLAT

<sup>1</sup> API Number 30-015-25511	<sup>2</sup> Pool Code 306996	<sup>3</sup> Pool Name PARKWAY BONE SPRING
<sup>4</sup> Property Code 011718	<sup>5</sup> Property Name TUESDAY FEDERAL	<sup>6</sup> Well Number 1
<sup>7</sup> OGRID No. 270329	<sup>8</sup> Operator Name ENDURANCE RESOURCES LLC	<sup>9</sup> Elevation 3333.8 6L

<sup>10</sup> Surface Location

UL or lot no.	Section	Township	Range	Lot Idn	Feet from the	North/South line	Feet from the	East/West line	County
	3	20S	29E		1400	NORTH	990	WEST	ROOY

<sup>11</sup> Bottom Hole Location If Different From Surface

UL or lot no.	Section	Township	Range	Lot Idn	Feet from the	North/South line	Feet from the	East/West line	County

<sup>12</sup> Dedicated Acres 40	<sup>13</sup> Joint or Infill	<sup>14</sup> Consolidation Code	<sup>15</sup> Order No.
-------------------------------------	-------------------------------	----------------------------------	-------------------------

No allowable will be assigned to this completion until all interests have been consolidated or a non-standard unit has been approved by the division.

<sup>16</sup> 	<sup>17</sup> OPERATOR CERTIFICATION I hereby certify that the information contained herein is true and complete to the best of my knowledge and belief, and that this organization either owns a working interest or unleased mineral interest in the land including the proposed bottom hole location or has a right to drill this well at this location pursuant to a contract with an owner of such a mineral or working interest, or to a voluntary pooling agreement or a compulsory pooling order heretofore entered by the division.	
	Signature: Date: 10/29/12 Printed Name: RANDALL HARRIS E-mail Address: rharrisnm@yahoo.com	
<sup>18</sup> SURVEYOR CERTIFICATION I hereby certify that the well location shown on this plat was plotted from field notes of actual surveys made by me or under my supervision, and that the same is true and correct to the best of my belief.		
Date of Survey Signature and Seal of Professional Surveyor:		
Certificate Number		

**NEW MEXICO OIL CONSERVATION COMMISSION  
WELL LOCATION AND ACREAGE DEDICATION PLAT**

Form C-102  
Supersedes C-128  
Effective 1-1-65

All distances must be from the outer boundaries of the Section.

Operator <b>Conoco Inc.</b>			Lease <b>Tuesday A Federal</b>		Well No. <b>1</b>
Unit Letter <b>E</b>	Section <b>3</b>	Township <b>20 South</b>	Range <b>29 East</b>	County <b>Eddy</b>	
Actual Footage Location of Well:					
1400 feet from the North line and		990 feet from the West line			
Ground Level Elev. <b>3333.81</b>	Producing Formation <b>Bone Spring</b>	Pool <b>Bone Spring Parkway</b>	Dedicated Acreage: <b>40</b> Acres		

1. Outline the acreage dedicated to the subject well by colored pencil or hachure marks on the plat below.
2. If more than one lease is dedicated to the well, outline each and identify the ownership thereof (both as to working interest and royalty).
3. If more than one lease of different ownership is dedicated to the well, have the interests of all owners been consolidated by communitization, unitization, force-pooling, etc?

☐ Yes ☒ No If answer is "yes," type of consolidation \_\_\_\_\_

If answer is "no," list the owners and tract descriptions which have actually been consolidated. (Use reverse side of this form if necessary.) \_\_\_\_\_

No allowable will be assigned to the well until all interests have been consolidated (by communitization, unitization, forced-pooling, or otherwise) or until a non-standard unit, eliminating such interests, has been approved by the Commission.

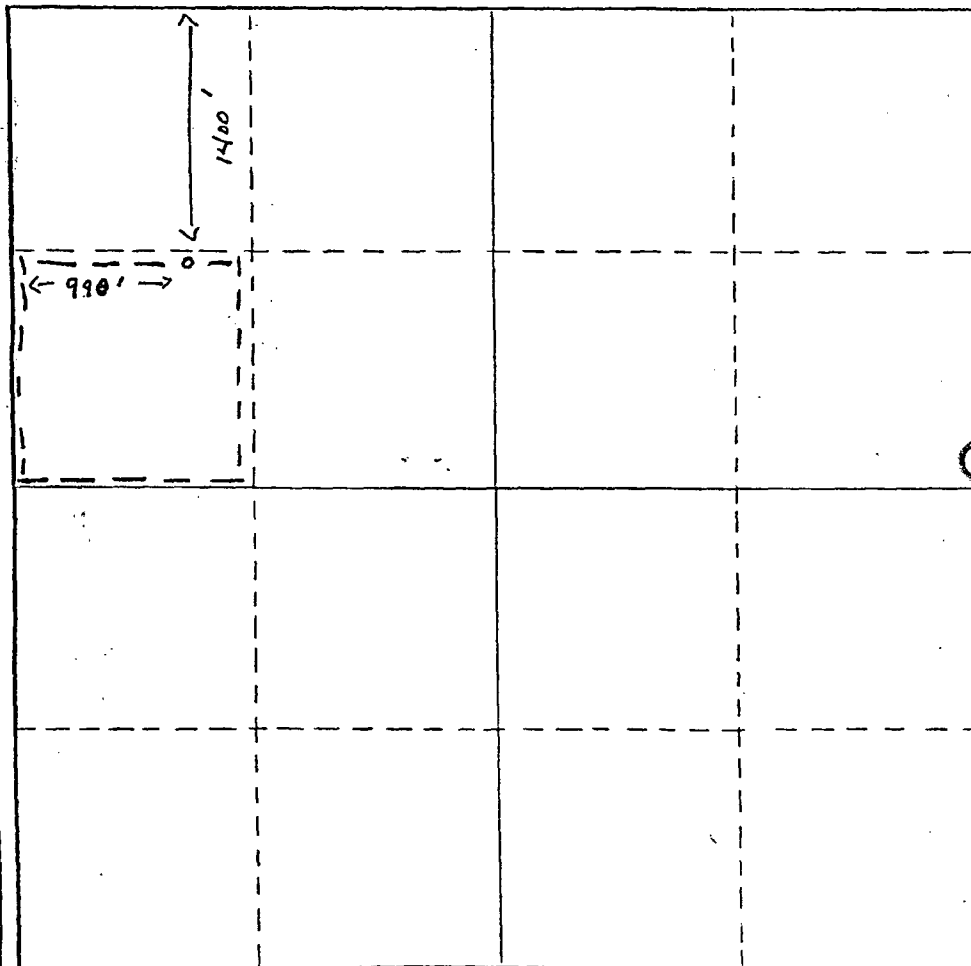

**CERTIFICATION**

I hereby certify that the information contained herein is true and complete to the best of my knowledge and belief.

Name *D.E. Finney*  
Position *D.E. Finney*  
**Administrative Supervisor**  
Company *CONOCO INC.*

Date **12-30-87**

I hereby certify that the well location shown on this plat was plotted from field notes of actual surveys made by me or under my supervision, and that the same is true and correct to the best of my knowledge and belief.

Date Surveyed  
**NOVEMBER 23, 1985**

Registered Professional Engineer  
and/or Land Surveyor

Certificate No. \_\_\_\_\_



11382 Lovington Hwy. ⋈ P.O. Box 1466 ⋈ Artesia, NM 88211-1466 ⋈ Tel: 575-308-0722

October 29, 2012

Chesapeake Operating, Inc.  
P.O. Box 18496  
Oklahoma City, OK 73145

RE: Application for a Non-standard Location (NSL)  
Endurance Resources LLC  
Tuesday Federal #1  
30-015-2551

The Tuesday Federal #1 was drilled by Conoco and was completed in the Bone Springs in 1987. Conoco should have filed for a NSL at that time. The well was sold to Ray Westall Operating and then to Endurance Resources in 2008. The OCD is now requiring an Administrative Application for NSL be filed.

Chesapeake as offset operator is notified by certified mail, return receipt requested mail, of this application and a copy of the plat. If Chesapeake has an objection you must file the objection in writing with the New Mexico Oil and Gas Division within 20 days from the date the Division receives the application.

If you need any additional information concerning this matter please call:

Randall Harris  
Endurance Resources LLC  
575.308.0722

7011 2970 0002 0899 4506

U.S. Postal Service <sup>TM</sup>	
CERTIFIED MAIL <sup>TM</sup> RECEIPT	
(Domestic Mail Only; No Insurance Coverage Provided)	
For delivery information visit our website at <a href="http://www.usps.com">www.usps.com</a> .	
OKLAHOMA CITY OK 73145	
CITY TOTAL USE	
Postage	\$ 0.45
Certified Fee	\$2.95
Return Receipt Fee (Endorsement Required)	\$2.35
Restricted Delivery Fee (Endorsement Required)	\$0.00
Total Postage & Fees	\$ 5.75

0612  
04  
ARTESIA NM  
Postmark Here  
OCT 29 2012  
30/29/2012  
88210

Sent To  
CHESAPEAKE OPERATING, INC.  
Street, Apt. No.,  
or PO Box No. P.O. Box 18496  
City, State, ZIP+4  
OKLAHOMA CITY, OK 73145  
PS Form 3800, August 2006  
See Reverse for Instructions