

ABOVE THIS LINE FOR DIVISION USE ONLY

**NEW MEXICO OIL CONSERVATION DIVISION**  
- Engineering Bureau -  
1220 South St. Francis Drive, Santa Fe, NM 87505



PLU 320 BATT  
PLU Remuda Basin 4 24 30 USA 11

371

**ADMINISTRATIVE APPLICATION CHECKLIST**

THIS CHECKLIST IS MANDATORY FOR ALL ADMINISTRATIVE APPLICATIONS FOR EXCEPTIONS TO DIVISION RULES AND REGULATIONS WHICH REQUIRE PROCESSING AT THE DIVISION LEVEL IN SANTA FE

**Application Acronyms:**

**[NSL-Non-Standard Location] [NSP-Non-Standard Proration Unit] [SD-Simultaneous Dedication]**  
**[DHC-Downhole Commingling] [CTB-Lease Commingling] [PLC-Pool/Lease Commingling]**  
**[PC-Pool Commingling] [OLS - Off-Lease Storage] [OLM-Off-Lease Measurement]**  
**[WFX-Waterflood Expansion] [PMX-Pressure Maintenance Expansion]**  
**[SWD-Salt Water Disposal] [IPI-Injection Pressure Increase]**  
**[EOR-Qualified Enhanced Oil Recovery Certification] [PPR-Positive Production Response]**

**[1] TYPE OF APPLICATION - Check Those Which Apply for [A]**

[A] Location - Spacing Unit - Simultaneous Dedication  
☐ NSL ☐ NSP ☐ SD

Check One Only for [B] or [C]

[B] Commingling - Storage - Measurement  
☐ DHC ☐ CTB ☒ PLC ☐ PC ☐ OLS ☒ OLM

[C] Injection - Disposal - Pressure Increase - Enhanced Oil Recovery  
☐ WFX ☐ PMX ☐ SWD ☐ IPI ☐ EOR ☐ PPR

[D] Other: Specify \_\_\_\_\_

**[2] NOTIFICATION REQUIRED TO: - Check Those Which Apply, or ☐ Does Not Apply**

[A] ☒ Working, Royalty or Overriding Royalty Interest Owners

[B] ☐ Offset Operators, Leaseholders or Surface Owner

[C] ☐ Application is One Which Requires Published Legal Notice

[D] ☒ Notification and/or Concurrent Approval by **BLM** or **SLO**  
U.S. Bureau of Land Management - Commissioner of Public Lands, State Land Office

[E] ☒ For all of the above, Proof of Notification or Publication is Attached, and/or,

[F] ☐ Waivers are Attached

BOPCO, LP  
 30-015-40660  
 PLU Remuda Basin 42430  
 USA #1H

RECEIVED OOD  
 2013 MAR 22 A 11:21

30-015-39731  
 Poker Lake Unit # 318H  
 30-015-39834  
 Poker Lake Unit # 319H  
 30-015-39810  
 Poker Lake Unit # 320H  
 30-015-39835  
 Poker Lake Unit # 332H

**[3] SUBMIT ACCURATE AND COMPLETE INFORMATION REQUIRED TO PROCESS THE TYPE OF APPLICATION INDICATED ABOVE.**

**[4] CERTIFICATION:** I hereby certify that the information submitted with this application for administrative approval is **accurate** and **complete** to the best of my knowledge. I also understand that **no action** will be taken on this application until the required information and notifications are submitted to the Division.

**Note:** Statement must be completed by an individual with managerial and/or supervisory capacity.

Tracie J Cherry  
 Print or Type Name

Signature

Sr. Regulatory Analyst  
 Title

03-20-13  
 Date

tjcherry@basspet.com  
 e-mail Address

**BOPCO, L.P.**

P.O. Box 2760  
Midland, Tx 79702  
(432) 683-2277  
(432) 687-0329 (fax)

RECEIVED OOD

2013 MAR 22 A 11: 21

March 21, 2013

Oil Conservation Division  
1220 S. St Francis  
Santa Fe NM 87505

Re: Poker Lake Unit, 318H  
Poker Lake Unit 319H  
Poker Lake Unit 320H  
Poker Lake Unit 332H  
PLU Remuda Basin 4 24 30 USA 1H  
Various Pools  
Eddy County, NM

Gentlemen:

BOPCO, L.P. respectfully requests permission to surface commingle and off lease measure gas production for the above referenced locations. This request is to add gas production from the PLU Remuda Basin 4 24 30 USA 1H to the system currently in place at the Poker Lake Unit 320H Battery. A list of interest owners notified via certified mail is attached.

Copies of this application and request for approval have also been sent to the Bureau of Land Management and the State Land Office.

If you have any questions or need additional information, please call me at 432/683-2277.

Sincerely,



Tracie J Cherry  
Sr. Regulatory Analyst

Enclosures

District I  
1625 N. French Drive, Hobbs, NM 88240  
District II  
811 S. First St., Artesia, NM 88210  
District III  
1000 Rio Brazos Road, Aztec, NM 87410  
District IV  
1220 S. St Francis Dr, Santa Fe, NM  
87505

State of New Mexico  
Energy, Minerals and Natural Resources Department

Form C-107-B  
Revised August 1, 2011

**OIL CONSERVATION DIVISION**

1220 S. St Francis Drive  
Santa Fe, New Mexico 87505

Submit the original  
application to the Santa Fe  
office with one copy to the  
appropriate District Office.

**APPLICATION FOR SURFACE COMMINGLING (DIVERSE OWNERSHIP)**

OPERATOR NAME: BOPCO, L.P.

OPERATOR ADDRESS: P O Box 2760 Midland, TX 79707

APPLICATION TYPE:

☒ Pool Commingling ☒ Lease Commingling ☐ Pool and Lease Commingling ☐ Off-Lease Storage and Measurement (Only if not Surface Commingling)

LEASE TYPE: ☐ Fee ☐ State ☒ Federal

Is this an Amendment to existing Order? ☐ Yes ☒ No If "Yes", please include the appropriate Order No. \_\_\_\_\_

Have the Bureau of Land Management (BLM) and State Land office (SLO) been notified in writing of the proposed commingling

☒ Yes ☐ No

**(A) POOL COMMINGLING**

Please attach sheets with the following information

(1) Pool Names and Codes	Gravities / BTU of Non-Commingled Production	Calculated Gravities / BTU of Commingled Production		Calculated Value of Commingled Production	Volumes
List attached.					

(2) Are any wells producing at top allowables? ☐ Yes ☒ No

(3) Has all interest owners been notified by certified mail of the proposed commingling? ☒ Yes ☐ No.

(4) Measurement type: ☒ Metering ☐ Other (Specify)

(5) Will commingling decrease the value of production? ☐ Yes ☒ No If "yes", describe why commingling should be approved

**(B) LEASE COMMINGLING**

Please attach sheets with the following information

(1) Pool Name and Code.

(2) Is all production from same source of supply? ☐ Yes ☐ No

(3) Has all interest owners been notified by certified mail of the proposed commingling? ☐ Yes ☐ No

(4) Measurement type: ☐ Metering ☐ Other (Specify)

**(C) POOL and LEASE COMMINGLING**

Please attach sheets with the following information

(1) Complete Sections A and E.

**(D) OFF-LEASE STORAGE and MEASUREMENT**

Please attached sheets with the following information

(1) Is all production from same source of supply? ☐ Yes ☐ No

(2) Include proof of notice to all interest owners.

**(E) ADDITIONAL INFORMATION (for all application types)**

Please attach sheets with the following information

(1) A schematic diagram of facility, including legal location.

(2) A plat with lease boundaries showing all well and facility locations. Include lease numbers if Federal or State lands are involved.

(3) Lease Names, Lease and Well Numbers, and API Numbers.

I hereby certify that the information above is true and complete to the best of my knowledge and belief.

SIGNATURE: Tracie J Cherry

TITLE: Sr. Regulatory Analyst

DATE: 03/20/2013

TYPE OR PRINT NAME Tracie J Cherry

TELEPHONE NO.: (432)683-2277

E-MAIL ADDRESS: tjcherry@basspet.com

# Exhibit A

## APPLICATION FOR LEASE & POOL COMMINGLING, OFF-LEASE MEASUREMENT & SALES APPROVAL

BOPCO L.P. is requesting approval for the above captioned types of commingling & measurement for hydrocarbon gas production from all leases shown:

Lease Name **Poker Lake Unit**  
Property Cd **30642**

Well No.	Unit	API No.	Location	Proration	Pool Name	Pool Code	MCF/D	BTU
318H	30-015-39731	SHL: SENW 4-T24S-R30E BHL: SENE 10-T24S-R30E	*	Poker Lake, NW (Delaware)	96046	1200	1337.8	
319H	30-015-39834	SHL: NESE 4-24s-30E BHL: NESE 10-T24S-R30E	*	Nash Draw, Delaware/BS (Av Sd)	47545	900	1452.7	
320H	30-015-39810	SHL: NESW 9-T24S-R30E BHL: SWSE 10-T24S-R30E	*	Poker Lake, NW (Delaware)	96046	700	1325.8	
332H	30-015-39835	SHL: SWNW 3-T24S-R30E BHL: SWNW 11-T24S-R30E	*	WC Delaware	97821	1200	1369.8	

Lease Name **PLU Remuda Basin 4 24 30**  
Property Cd **39432**

Well No.	API No.	Location	Proration	Pool Name	Pool Code	MCF/D	BTU
1H	30-015-40660	SHL: NENE 4-T24S-R30E BHL: SESE 4-T24S-R30E	*	<del>WC Bone Spring</del>	97798	1000	1175.8

\*Proration unit plats attached

Wildcat G-06 S243026M (BS) *(signature)*

## DISTRICT I

1325 N. French Dr., Hobbs, NM 88240

## DISTRICT II

1301 W. Grand Avenue, Artesia, NM 88210

## DISTRICT III

1000 Rio Brazos Rd., Aztec, NM 87410

## DISTRICT IV

1250 S. St. Francis Dr., Santa Fe, NM 87505

State of New Mexico  
Energy, Minerals and Natural Resources Department

Form C-102

Revised July 18, 2010

Submit one copy to appropriate  
District Office

## OIL CONSERVATION DIVISION

1220 South St. Francis Dr.  
Santa Fe, New Mexico 87505

## WELL LOCATION AND ACREAGE DEDICATION PLAT

☐ AMENDED REPORT

API Number <b>30-015-39835</b>	Pool Code <b>97821</b>	Pool Name <b>WILDCAT; DELAWARE</b>
Property Code <b>306402</b>	Property Name <b>POKER LAKE UNIT</b>	Well Number <b>332H</b>
OGRID No. <b>260737</b>	Operator Name <b>BOPCO, L.P.</b>	Elevation <b>3444'</b>

## Surface Location

UL or lot No.	Section	Township	Range	Lot Idn	Feet from the	North/South line	Feet from the	East/West line	County
E	3	24 S	30 E		1740	NORTH	1075	WEST	EDDY

## Bottom Hole Location If Different From Surface

UL or lot No.	Section	Township	Range	Lot Idn	Feet from the	North/South line	Feet from the	East/West line	County
E	11	24 S	30 E		1600	NORTH	900	WEST	EDDY

Dedicated Acres <b>3600</b>	Joint or Infill	Consolidation Code	Order No.
--------------------------------	-----------------	--------------------	-----------

NO ALLOWABLE WILL BE ASSIGNED TO THIS COMPLETION UNTIL ALL INTERESTS HAVE BEEN CONSOLIDATED  
OR A NON-STANDARD UNIT HAS BEEN APPROVED BY THE DIVISION

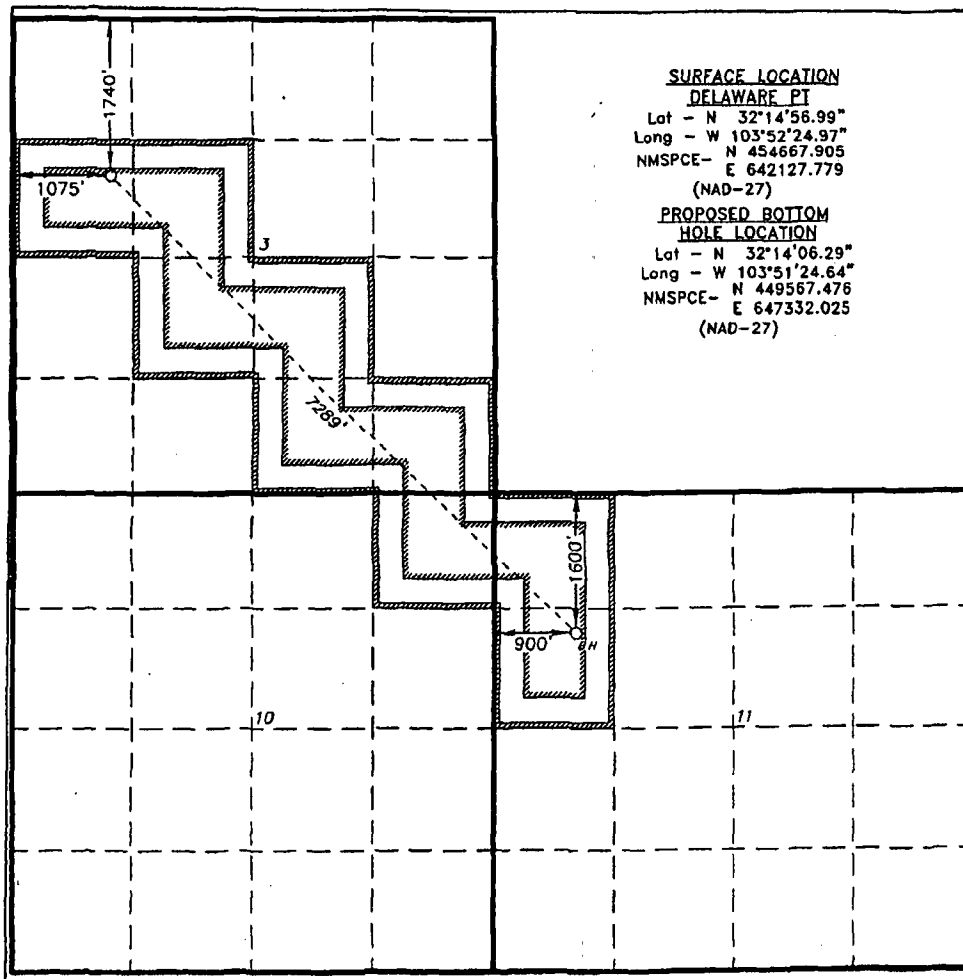

## SURFACE LOCATION

## DELAWARE PI

Lat - N 32°14'56.99"  
Long - W 103°52'24.97"  
NMSPC - N 454667.905  
E 642127.779  
(NAD-27)

PROPOSED BOTTOM  
HOLE LOCATION

Lat - N 32°14'06.29"  
Long - W 103°51'24.64"  
NMSPC - N 449567.476  
E 647332.025  
(NAD-27)

## OPERATOR CERTIFICATION

I hereby certify that the information contained herein is true and complete to the best of my knowledge and belief, and that this organization either owns a working interest or unleased mineral interest in the land including the proposed bottom hole location or has a right to drill this well at this location pursuant to a contract with an owner of such a mineral or working interest, or to a voluntary pooling agreement or a compulsory pooling order heretofore entered by the division.

*Jeremy Braden* 10-27-11  
Signature Date

Printed Name  
Jeremy BradenPrinted Name  
JDBraden@basspet.com

Email Address

## SURVEYOR CERTIFICATION

I hereby certify that the well location shown on this plat was plotted from field notes of actual surveys made by me or under my supervision and that the same is true and correct to the best of my belief.

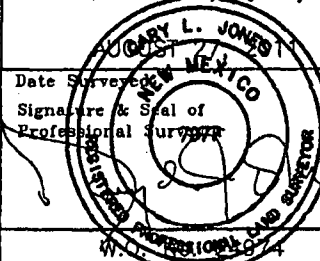

Certificate No. Gary L. Jones 7977

BASIN SURVEYS 24974

30-015-3973

## DISTRICT I

1625 N. French Dr., Hobbs, NM 88240

## DISTRICT II

1301 W. Grand Avenue, Artesia, NM 88210

## DISTRICT III

1000 Rio Brazos Rd., Aztec, NM 87410

## DISTRICT IV

1220 S. St. Francis Dr., Santa Fe, NM 87505

State of New Mexico  
Energy, Minerals and Natural Resources Department

Form C-102

Revised July 16, 2010

Submit one copy to appropriate  
District Office

## OIL CONSERVATION DIVISION

1220 South St. Francis Dr.  
Santa Fe, New Mexico 87505

## WELL LOCATION AND ACREAGE DEDICATION PLAT

☐ AMENDED REPORT

API Number <b>30-015-39731</b>	Pool Code <b>96046</b>	Pool Name <i>per operation 9/16/11</i> <b>Remuda Basin (Delaware) N.W.</b>
Property Code <b>306402</b>	Property Name <b>POKER LAKE UNIT</b>	Well Number <b>318H</b>
GRID No. <b>260737</b>	Operator Name <b>BOPCO, L.P.</b>	Elevation <b>3428'</b>

## Surface Location

UL or lot No.	Section	Township	Range	Lot Idn	Feet from the	North/South line	Feet from the	East/West line	County
H	4	24 S	30 E		2175	NORTH	305	EAST	EDDY

## Bottom Hole Location If Different From Surface

UL or lot No.	Section	Township	Range	Lot Idn	Feet from the	North/South line	Feet from the	East/West line	County
H	10	24 S	30 E		2540	NORTH	85	EAST	EDDY

Dedicated Acres	Joint or Infill	Consolidation Code	Order No.
<b>480</b>			

NO ALLOWABLE WILL BE ASSIGNED TO THIS COMPLETION UNTIL ALL INTERESTS HAVE BEEN CONSOLIDATED  
OR A NON-STANDARD UNIT HAS BEEN APPROVED BY THE DIVISION

	<b>SURFACE LOCATION</b> <b>DELAWARE PT</b> Lat - N 32°14'52.65" Long - W 103°52'41.03" NMSPCE- N 454224.015 E 640750.348 (NAD-27)	<b>OPERATOR CERTIFICATION</b> I hereby certify that the information contained herein is true and complete to the best of my knowledge and belief, and that this organization either owns a working interest or unleased mineral interest in the land including the proposed bottom hole location or has a right to drill this well at this location pursuant to a contract with an owner of such a mineral or working interest, or to a voluntary pooling agreement or a compulsory pooling order heretofore entered by the division. <i>Jeremy Braden 9-9-11</i> Signature _____ Date _____ Printed Name <b>Jeremy Braden</b> Email Address <b>JDBraden@basspet.com</b>
	<b>PROPOSED BOTTOM HOLE LOCATION</b> Lat - N 32°13'56.95" Long - W 103°51'36.12" NMSPCE- N 448619.499 E 646349.986 (NAD-27)	<b>SURVEYOR CERTIFICATION</b> I hereby certify that the well location shown on this plat was plotted from field notes of actual surveys made by me or under my supervision and that the same is true and correct to the best of my belief. AUG 27 2011 Date Surveyed _____ Signature & Seal of Professional Surveyor  W.D. 24975 Certificate No. Gary L. Jones 7977 BASIN SURVEYS 24975

Delaware entry point same as surface.  
 Lat - N 32° 14' 52.65"  
 Long - W 103° 52' 41.03"

RECEIVED

NOV 29 2011

NMOCD ARTESIA

1625 N. French Dr., Hobbs, NM 88240

## DISTRICT II

1301 W. Grand Avenue, Artesia, NM 88210

## DISTRICT III

1000 Rio Brazos Rd., Aztec, NM 87410

## DISTRICT IV

1220 S. St. Francis Dr., Santa Fe, NM 87505

State of New Mexico  
Energy, Minerals and Natural Resources Department

## OIL CONSERVATION DIVISION

1220 South St. Francis Dr.

*Santa Fe, New Mexico*

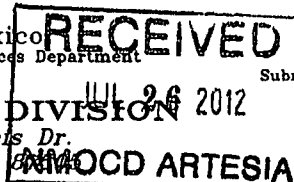

Form C-102

Revised July 18, 2010

Submit one copy to appropriate  
District Office

"as Drilled"

☒ AMENDED REPORT

## WELL LOCATION AND ACREAGE DEDICATION PLAT

API Number 30-015-39834	Pool Code 47545	Pool Name Nash Draw, Delaware/BS (Ava. Sd.)
Property Code 306402	Property Name POKER LAKE UNIT	Well Number 319H
OGRID No. 260737	Operator Name BOPCO, L.P.	Elevation 3425'

### Surface Location

UL or lot No.	Section	Township	Range	Lot Idn	Feet from the	North/South line	Feet from the	East/West line	County
1	4	24 S	30 E		2200	SOUTH	1220	EAST	EDDY

## Bottom Hole Location If Different From Surface

UL or lot No.	Section	Township	Range	Lot Idn	Feet from the	North/South line	Feet from the	East/West line	County
1	10	24 S	30 E		1462	SOUTH	552	EAST	EDDY

Dedicated Acres	Joint or Infill	Consolidation Code	Order No.
360			

NO ALLOWABLE WILL BE ASSIGNED TO THIS COMPLETION UNTIL ALL INTERESTS HAVE BEEN CONSOLIDATED  
OR A NON-STANDARD UNIT HAS BEEN APPROVED BY THE DIVISION

### SURFACE LOCATION DELAWARE PT

Lat - N 32°14'43.54"  
 Long - W 103°52'51.67"  
 NMSPCE- N 453299.812  
 E 639840.893  
 (NAD-27)

### OPERATOR CERTIFICATION

I hereby certify that the information contained herein is true and complete to the best of my knowledge and belief, and that this organization either owns a working interest or unleased mineral interest in the land including the proposed bottom hole location or has a right to drill this well at this location pursuant to a contract with an owner of such a mineral or working interest, or to a voluntary pooling agreement or a compulsory pooling order heretofore entered by the division.

Sandra J. Belt 7-1  
 Signature Date  
Sandra J. Belt  
 Printed Name  
sjbelt@basspet.com  
 Email Address

### SURVEYOR CERTIFICATION

I hereby certify that the well location shown on this plat was plotted from field notes of actual surveys made by me or under my supervision, and that the same is true and correct to the best of my belief.

Date Surveyed: \_\_\_\_\_  
 Signature & Seal of Professional Surveyor: \_\_\_\_\_

Certificate No. Gary L. Jones 7977  
 BASIN SURVEYS 24976

### BOTTOM HOLE LOCATION

Lat - N 32°13'44.35"  
 Long - W 103°51'41.54"  
 NMSPCE- N 447344.39  
 E 645889.85  
 (NAD-27)

DISTRICT I  
1625 N. French Dr., Hobbs, NM 88240

DISTRICT II  
1301 W. Grand Avenue, Artesia, NM 88210

DISTRICT III  
1000 Rio Brazos Rd., Aztec, NM 87410

DISTRICT IV  
1220 S. St. Francis Dr., Santa Fe, NM 87505

State of New Mexico  
Energy, Minerals and Natural Resources Department

OIL CONSERVATION DIVISION  
1220 South St. Francis Dr.  
Santa Fe, New Mexico 87505

RECEIVED

JAN 22 2013

NMOC D ARTESIA

Form C-102  
Revised July 16, 2010

Submit one copy to appropriate  
District Office

WELL LOCATION AND ACREAGE DEDICATION PLAT

☐ AMENDED REPORT

API Number 30-015-39810	Pool Code 47545	Pool Name Nash Draw; Delaware
Property Code 306402	Property Name POKER LAKE UNIT	Well Number 320H
OGRID No. 260737	Operator Name BOPCO, L.P.	Elevation 3364'

Surface Location

UL or lot No. K	Section 4	Township 24 S	Range 30 E	Lot Idn	Feet from the 2590	North/South line SOUTH	Feet from the 1670	East/West line WEST	County EDDY
--------------------	--------------	------------------	---------------	---------	-----------------------	---------------------------	-----------------------	------------------------	----------------

Bottom Hole Location If Different From Surface

UL or lot No. O	Section 10	Township 24 S	Range 30 E	Lot Idn	Feet from the 1148	North/South line SOUTH	Feet from the 2277	East/West line EAST	County EDDY
--------------------	---------------	------------------	---------------	---------	-----------------------	---------------------------	-----------------------	------------------------	----------------

Dedicated Acres 600	Joint or Infill	Consolidation Code	Order No.
------------------------	-----------------	--------------------	-----------

NO ALLOWABLE WILL BE ASSIGNED TO THIS COMPLETION UNTIL ALL INTERESTS HAVE BEEN CONSOLIDATED  
OR A NON-STANDARD UNIT HAS BEEN APPROVED BY THE DIVISION

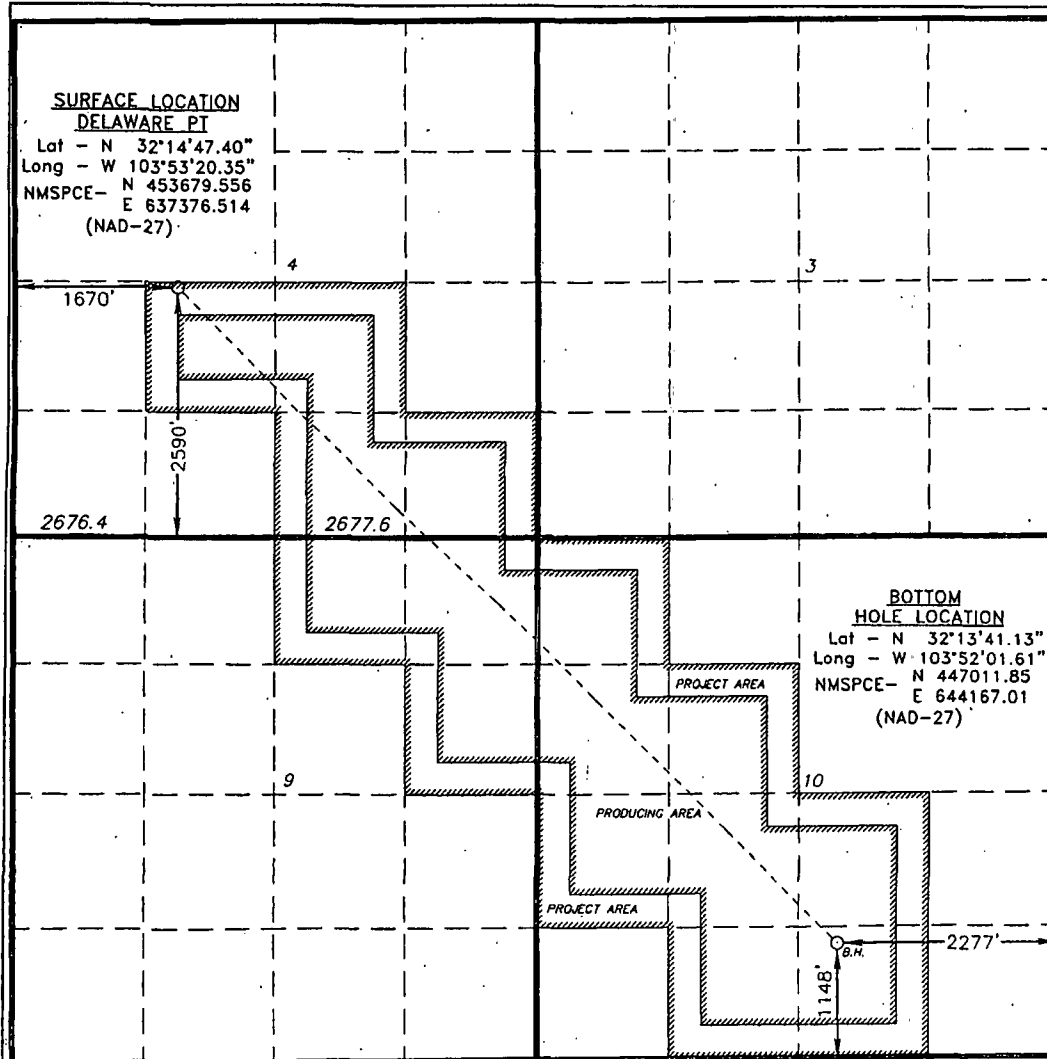

OPERATOR CERTIFICATION

I hereby certify that the information contained herein is true and complete to the best of my knowledge and belief, and that this organization either owns a working interest or unleased mineral interest in the land including the proposed bottom hole location or has a right to drill this well at this location pursuant to a contract with an owner of such a mineral or working interest, or to a voluntary pooling agreement or a compulsory pooling order heretofore entered by the division.

*Jeremy Braden* 12-19-12  
Signature Date

*Jeremy Braden*  
Printed Name

*jbraden@bnpet.com*  
Email Address

SURVEYOR CERTIFICATION

I hereby certify that the well location shown on this plat was plotted from field notes of actual surveys made by me or under my supervision, and that the same is true and correct to the best of my belief.

*GARY L. JONES*  
Date Surveyed  
Signature and Seal of Professional Surveyor

7977  
W.O. No.

Certificate No. Gary L. Jones 7977

BASIN SURVEYS 26661



DISTRICT I  
1625 N. French Dr., Hobbs, NM 88240  
Phone (575) 393-8181 Fax: (575) 393-0720

DISTRICT II  
111 S. First St., Artesia, NM 88210  
Phone (505) 746-1283 Fax: (505) 746-0720

DISTRICT III  
1000 Rio Brazos Rd., Aztec, NM 87410  
Phone (505) 334-8178 Fax: (505) 334-0170

DISTRICT IV  
1220 S. St. Francis Dr., Santa Fe, NM 87505  
Phone (505) 476-3450 Fax: (505) 476-3452

State of New Mexico  
Energy, Minerals and Natural Resources Department

Form C-102  
Revised August 1, 2011

Submit one copy to appropriate  
District Office

OIL CONSERVATION DIVISION  
1220 South St. Francis Dr.  
Santa Fe, New Mexico 87505

WELL LOCATION AND ACREAGE DEDICATION PLAT ☐ AMENDED REPORT

API Number <b>30-05-40660</b>	Pool Code <b>96403</b>	Pool Name <b>WILDCAT; G-06 5243026M; B.S.</b> <b>WILDCAT; BONE SPRING</b>
Property Code <b>39432</b>	Property Name <b>PLU REMUDA BASIN 4 24 30 USA</b>	Well Number <b>1H</b>
OGRID No. <b>147179</b>	Operator Name <b>CHESAPEAKE OPERATING CO.</b>	Elevation <b>3495'</b>

Surface Location

UL or lot No.	Section	Township	Range	Lot Idn	Feet from the	North/South line	Feet from the	East/West line	County
LOT 1	4	24 S	30 E		175	NORTH	1250	EAST	EDDY

Bottom Hole Location If Different From Surface

UL or lot No.	Section	Township	Range	Lot Idn	Feet from the	North/South line	Feet from the	East/West line	County
P	4	24 S	30 E		100	SOUTH	660	EAST	EDDY

Dedicated Acres	Joint or Infill	Consolidation Code	Order No.
160.46			13950 8/24

NO ALLOWABLE WILL BE ASSIGNED TO THIS COMPLETION UNTIL ALL INTERESTS HAVE BEEN CONSOLIDATED  
OR A NON-STANDARD UNIT HAS BEEN APPROVED BY THE DIVISION

LOT 4	LOT 3 <b>SURFACE LOCATION</b> Lat - N 32.253571538° Long - W 103.881603601° NMSPC- E 456276.391 E 680982.201 (NAD-83) Lat - N 32.253448760° Long - W 103.881116280° NMSPC- N 456217.229 E 639798.538 (NAD-27)	LOT 2	LOT 1 1250' 3498.3' 3520.0'
<b>PROJECTED FIRST PERFORATIONS:</b> 330' FNL & 109' FWL		<b>Project Area</b>	<b>Producing Area</b>
		<b>PROPOSED BOTTOM HOLE LOCATION</b> Lat - N 32.239780450° Long - W 103.879673307° NMSPC- N 451261.886 E 681600.121 (NAD-83) Lat - N 32.239657532° Long - W 103.879186602° NMSPC- N 451202.836 E 640416.303 (NAD-27)	100' 660'

**OPERATOR CERTIFICATION**

I hereby certify that the information contained herein is true and complete to the best of my knowledge and belief, and that this organization either owns a working interest or unleased mineral interest in the land including the proposed bottom hole location or has a right to drill this well at this location pursuant to a contract with an owner of such a mineral or working interest, or to a voluntary pooling agreement or a compulsory pooling order heretofore entered by the division.

*Bryan Arrant* 05/21/2012  
Signature Date  
Printed Name Bryan Arrant  
Email Address bryan.arrant@chk.com

**SURVEYOR CERTIFICATION**

I hereby certify that the well location shown on this plat was plotted from field notes of actual surveys made by me or under my supervision, and that the same is true and correct to the best of my belief.

DATE SURVEYED: MARCH 2012  
Signature of Seal of Professional Surveyor 7977  
Certificate No. Gary L. Jones 7977  
BASIN SURVEYS 26322

**Individuals Notified of  
Application to Surface Commingle and Offlease Measure  
Poker Lake Unit Wells 3218H 319H, 320H 332H and  
PLU Remuda Basin 4 24 30 USA 1H**

Patricia C Macpherson  
Patricia C Macpherson Trustee  
2716 Ocean Park Blvd Ste 3080  
Santa Monica CA 90405

Irma Leota Hopp Davis  
P.O. Box 6675  
Lubbock TX 79493-6675

Vergil Wesley Hopp  
P.O. Box 1641  
Arlington TX 76004-1641

Hugh D & Carolyn A Kiddy  
7366 South Platte Canyon Drive  
Littleton CO 80128-6450

Colleen C Webster  
Mars Webster & Patrick Webster Attorney in Fact  
11856 Mississippi Ave  
Los Angeles CA 90025

G Peck & Co  
Colorado State Bank & Trust  
P.O. Box 5945 Attn: P Nemmers  
Denver CO 80217-9977

Hiroko T Parker  
931 Stiles Court  
Vista CA 92083

Scott J Parker  
145 Matisse Circle  
Aliso Viejo CA 92656

Gary L Parker  
1801 Park Street  
Huntington Beach CA 92648

Lynn E Parker  
5186 Tellier Road  
Newark NY 14513

McBride Oil & Gas Corporation  
P.O. Box 1515  
Roswell NM 88202

Ginsberg Properties LLC  
P.O. Box 1473  
Roswell NM 88201

Toby B Graves  
11440 East Desert Troon Lane  
Scottsdale AZ 85255

Leo C & Margaret B Graves  
Rev Living Trust Mary M Graves First Succ Trustee  
7820 S Redland Road  
Coyle OK 73027

Hampton Oil & Gas Inc  
1422 NW Logan  
Lawton OK 73507

Chesapeake  
P.O. Box 960161  
Oklahoma City OK 73196-0161

**BOPCO, L. P.**  
6 DESTA DRIVE, SUITE 3700 (79705)  
P. O. BOX 2760  
MIDLAND, TEXAS 79702

(432) 683-2277

FAX (432) 687-0329

March 21, 2013

RE: Application for Surface  
Commingling and Off Lease  
Sales Measurements

Poker Lake Unit 318H  
Poker Lake Unit 319H  
Poker Lake Unit 320H  
Poker Lake Unit 322H  
PLU Remuda Basin 4 24 30 USA 1H  
Eddy County, New Mexico

Patricia C Macpherson  
Patricia C Macpherson Trustee  
2716 Ocean Park Blvd Ste 3080  
Santa Monica, CA 90405

Gentlemen:

This letter and attached copy of our surface commingling application is to notify you, as interest owner, that BOPCO, L.P. is petitioning the Bureau of Land Management and New Mexico Oil Conservation Division to grant permission to surface commingle and measure off lease sales for the subject wellbores.

If you should have any questions or require additional information please feel free to contact me. Any objections or requests for hearing must be filed with the Oil Conservation Division, 1220 South St Frances Dr., Santa Fe, New Mexico 87505m within 20 days of this letter's date.

Sincerely,

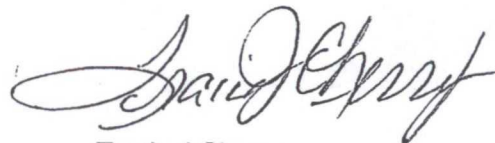

Tracie J Cherry  
Sr Regulatory Analyst

rjt  
Attachments

**BOPCO, L. P.**  
P. O. Box 2760  
Midland, Texas 79702

**CERTIFIED MAIL**

7160 3901 9846 4645 0157  
RETURN RECEIPT REQUESTED

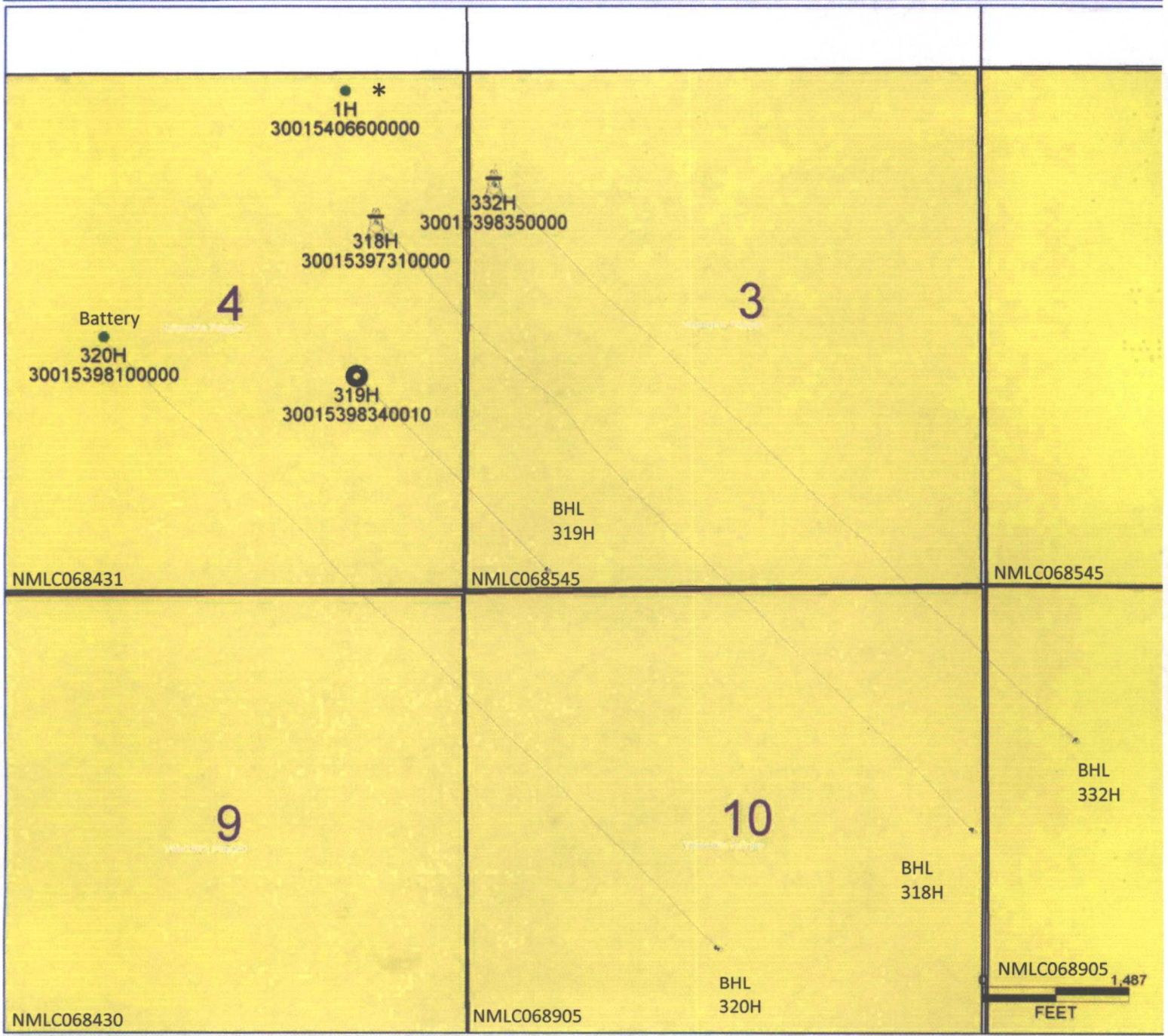

PETRA 3/14/2013 2:23:23 PM

\* PLU Remuda Basin 4 24 30 recently drilled, BHL not shown on this map. BHL in SESE section 4, lease NMLC 068431

BOPCO, LP  
Application for Surface Commingle &  
Off Lease Measurement  
T24S-R30E



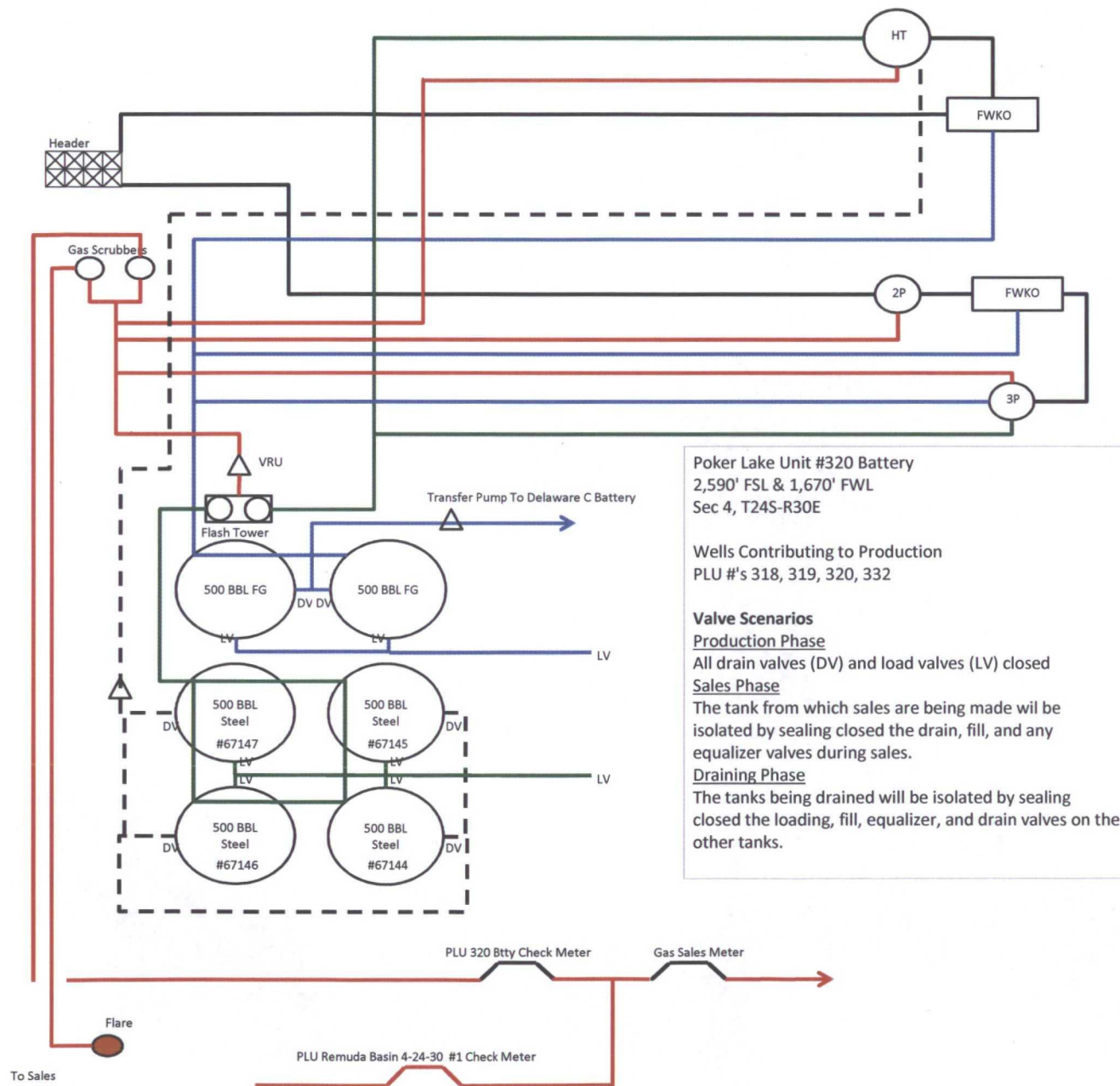

**Brooks, David K., EMNRD**

---

**From:** Brooks, David K., EMNRD  
**Sent:** Friday, April 19, 2013 3:03 PM  
**To:** 'tjcherry@basspet.com'  
**Subject:** Poker Lake Unit ##318H, 319H, 320H and 332H and PLU Remuda Basin 42430 USA #1H  
- Surface Commingle Application

Dear Ms. Cherry

I have some questions concerning the referenced application.

First, at the top of your Form C-107-B, where it asks, "Is this an amendment to existing Order?" you have checked "No." However, your letter says "This request is to add gas production from the PLU Remuda Basin 4 24 30 USA 1H to the system currently in place at the Poker Lake Unit 320H Battery. Please explain. If there is an existing order we are being asked to amend, it would be helpful if you can supply the order number.

Second, in Item (A)(4) of the form C-107-B, we have checked "Measurement type: Metering." Does this mean that the production from each well is metered prior to commingling? If not, how do you propose to allocate production for purposes of proceed payment and production reporting/

Thanks in advance for your assistance.

Sincerely

David K. Brooks  
Legal Examiner

**Brooks, David K., EMNRD**

---

**From:** Cherry, Tracie J. <TJCherry@BassPet.Com>  
**Sent:** Monday, April 22, 2013 1:59 PM  
**To:** Brooks, David K., EMNRD  
**Subject:** RE: Poker Lake Unit ##318H, 319H, 320H and 332H and PLU Remuda Basin 42430 USA #1H - Surface Commingle Application

Mr Brooks:

In gathering the well information to answer your questions, I have learned something about this application after the fact.

This is not an existing order; it will be a new order. I have discovered the wells on the Poker Lake Unit do not have an existing commingle approval in this battery. I was working under the mistaken assumption that, this was taken care of by the "unit" and the only reason commingle approval was needed was to bring the PLU Remuda Basin 4 24 30 gas into the mix. The four existing wells going into the PLU 320 tank battery produce from 3 different pools.

The second question concerning the metering is also incorrect. The Poker Lake Unit wells are combined at the tank battery and flow through a common check meter and then through a common sales meter. The production is allocated back to each well based on well tests. The PLU Remuda Basin 4 24 30 has its own tank battery for oil. Gas goes through a check meter for that well then through the same sales meter with the PLU wells. Gas is also allocated back to this well based on well tests.

I realize there are probably some corrections that need to be made. Please advise as to what they will be and I will handle them as quickly as possible.

Thank you...Tracie Cherry

---

**From:** Brooks, David K., EMNRD [<mailto:david.brooks@state.nm.us>]  
**Sent:** Friday, April 19, 2013 4:03 PM  
**To:** Cherry, Tracie J.  
**Subject:** Poker Lake Unit ##318H, 319H, 320H and 332H and PLU Remuda Basin 42430 USA #1H - Surface Commingle Application

Dear Ms. Cherry

I have some questions concerning the referenced application.

First, at the top of your Form C-107-B, where it asks, "Is this an amendment to existing Order?" you have checked "No." However, your letter says "This request is to add gas production from the PLU Remuda Basin 4 24 30 USA 1H to the system currently in place at the Poker Lake Unit 320H Battery. Please explain. If there is an existing order we are being asked to amend, it would be helpful if you can supply the order number.

Second, in Item (A)(4) of the form C-107-B, we have checked "Measurement type: Metering." Does this mean that the production from each well is metered prior to commingling? If not, how do you propose to allocate production for purposes of proceed payment and production reporting/

Thanks in advance for your assistance.



Sincerely

David K. Brooks  
Legal Examiner

**Brooks, David K., EMNRD**

---

**From:** Brooks, David K., EMNRD  
**Sent:** Tuesday, April 23, 2013 9:01 AM  
**To:** 'Cherry, Tracie J.'  
**Subject:** RE: Poker Lake Unit ##318H, 319H, 320H and 332H and PLU Remuda Basin 42430 USA #1H - Surface Commingle Application

Good morning, Ms. Cherry

Thanks for your response to my previous questions. Now I have two more.

First, the attachment referenced in the form C-107-B, though it states BTU for gas for each of the wells, does not state specific gravity for oil, a datum which the C-107-B calls for. If, as I understand, oil from different pools is to be commingled, we will need this information.

Second, the last sentence of your email states that gas from the Remuda Basin well will "go through a check meter for that well" and be allocated back to the well based on tests. I am wondering why allocation based on tests is necessary if the well has its own gas check meter.

Sincerely

David K. Brooks

---

**From:** Cherry, Tracie J. [<mailto:TJCherry@BassPet.Com>]  
**Sent:** Monday, April 22, 2013 1:59 PM  
**To:** Brooks, David K., EMNRD  
**Subject:** RE: Poker Lake Unit ##318H, 319H, 320H and 332H and PLU Remuda Basin 42430 USA #1H - Surface Commingle Application

Mr Brooks:

In gathering the well information to answer your questions, I have learned something about this application after the fact.

This is not an existing order; it will be a new order. I have discovered the wells on the Poker Lake Unit do not have an existing commingle approval in this battery. I was working under the mistaken assumption that, this was taken care of by the "unit" and the only reason commingle approval was needed was to bring the PLU Remuda Basin 4 24 30 gas into the mix. The four existing wells going into the PLU 320 tank battery produce from 3 different pools.

The second question concerning the metering is also incorrect. The Poker Lake Unit wells are combined at the tank battery and flow through a common check meter and then through a common sales meter. The production is allocated back to each well based on well tests. The PLU Remuda Basin 4 24 30 has its own tank battery for oil. Gas goes through a check meter for that well then through the same sales meter with the PLU wells. Gas is also allocated back to this well based on well tests.

I realize there are probably some corrections that need to be made. Please advise as to what they will be and I will handle them as quickly as possible.

Thank you...Tracie Cherry

---

**From:** Brooks, David K., EMNRD [<mailto:david.brooks@state.nm.us>]

**Sent:** Friday, April 19, 2013 4:03 PM

**To:** Cherry, Tracie J.

**Subject:** Poker Lake Unit ##318H, 319H, 320H and 332H and PLU Remuda Basin 42430 USA #1H - Surface Commingle Application

Dear Ms. Cherry

I have some questions concerning the referenced application.

First, at the top of your Form C-107-B, where it asks, "Is this an amendment to existing Order?" you have checked "No." However, your letter says "This request is to add gas production from the PLU Remuda Basin 4 24 30 USA 1H to the system currently in place at the Poker Lake Unit 320H Battery. Please explain. If there is an existing order we are being asked to amend, it would be helpful if you can supply the order number.

Second, in Item (A)(4) of the form C-107-B, we have checked "Measurement type: Metering." Does this mean that the production from each well is metered prior to commingling? If not, how do you propose to allocate production for purposes of proceed payment and production reporting/

Thanks in advance for your assistance.

Sincerely

David K. Brooks  
Legal Examiner

---

**From:** Cherry, Tracie J. [<mailto:TJCherry@BassPet.Com>]

**Sent:** Monday, April 22, 2013 1:59 PM

**To:** Brooks, David K., EMNRD

**Subject:** RE: Poker Lake Unit ##318H, 319H, 320H and 332H and PLU Remuda Basin 42430 USA #1H - Surface Commingle Application

Mr Brooks:

In gathering the well information to answer your questions, I have learned something about this application after the fact.

This is not an existing order; it will be a new order. I have discovered the wells on the Poker Lake Unit do not have an existing commingle approval in this battery. I was working under the mistaken assumption that, this was taken care of by the "unit" and the only reason commingle approval was needed was to bring the PLU Remuda Basin 4 24 30 gas into the mix. The four existing wells going into the PLU 320 tank battery produce from 3 different pools.

The second question concerning the metering is also incorrect. The Poker Lake Unit wells are combined at the tank battery and flow through a common check meter and then through a common sales meter. The production is allocated back to each well based on well tests. The PLU Remuda Basin 4 24 30 has its own tank battery for oil. Gas goes through a check meter for that well then through the same sales meter with the PLU wells. Gas is also allocated back to this well based on well tests.

I realize there are probably some corrections that need to be made. Please advise as to what they will be and I will handle them as quickly as possible.

Thank you...Tracie Cherry

---

**From:** Brooks, David K., EMNRD [<mailto:david.brooks@state.nm.us>]

**Sent:** Friday, April 19, 2013 4:03 PM

**To:** Cherry, Tracie J.

**Subject:** Poker Lake Unit ##318H, 319H, 320H and 332H and PLU Remuda Basin 42430 USA #1H - Surface Commingle Application

Dear Ms. Cherry

I have some questions concerning the referenced application.

First, at the top of your Form C-107-B, where it asks, "Is this an amendment to existing Order?" you have checked "No." However, your letter says "This request is to add gas production from the PLU Remuda Basin 4 24 30 USA 1H to the system currently in place at the Poker Lake Unit 320H Battery. Please explain. If there is an existing order we are being asked to amend, it would be helpful if you can supply the order number.

Second, in Item (A)(4) of the form C-107-B, we have checked "Measurement type: Metering." Does this mean that the production from each well is metered prior to commingling? If not, how do you propose to allocate production for purposes of proceed payment and production reporting/

Thanks in advance for your assistance.

Sincerely

David K. Brooks  
Legal Examiner

**Brooks, David K., EMNRD**

---

**From:** Cherry, Tracie J. <TJCherry@BassPet.Com>  
**Sent:** Thursday, April 25, 2013 4:08 PM  
**To:** Brooks, David K., EMNRD  
**Subject:** RE: Poker Lake Unit ##318H, 319H, 320H and 332H and PLU Remuda Basin 42430 USA #1H - Surface Commingle Application

Mr. Brooks,

The answer to your first question is as follows:

**Well Number/Gravity**

#318H/38.4

#319/38.3

#320H/38.7

#332/40

Remuda Basin #1H/46

I apologize; I did not realize the form that was created as an attachment omitted that information.

The Remuda Basin will not be allocated based on the check meter, not a well test. I did not proofread my message before sending.

This has definitely been a learning process for me! There is currently another application in the works that will be coming to you next week. Thank you for your patience and assistance.

Have a good evening....Tracie Cherry

---

**From:** Brooks, David K., EMNRD [<mailto:david.brooks@state.nm.us>]

**Sent:** Tuesday, April 23, 2013 10:01 AM

**To:** Cherry, Tracie J.

**Subject:** RE: Poker Lake Unit ##318H, 319H, 320H and 332H and PLU Remuda Basin 42430 USA #1H - Surface Commingle Application

Good morning, Ms. Cherry

Thanks for your response to my previous questions. Now I have two more.

First, the attachment referenced in the form C-107-B, though it states BTU for gas for each of the wells, does not state specific gravity for oil, a datum which the C-107-B calls for. If, as I understand, oil from different pools is to be commingled, we will need this information.

Second, the last sentence of your email states that gas from the Remuda Basin well will "go through a check meter for that well" and be allocated back to the well based on tests. I am wondering why allocation based on tests is necessary if the well has its own gas check meter.

Sincerely

David K. Brooks

## Brooks, David K., EMNRD

---

**From:** Cherry, Tracie J. <TJCherry@BassPet.Com>  
**Sent:** Friday, April 26, 2013 8:47 AM  
**To:** Brooks, David K., EMNRD  
**Subject:** RE: Poker Lake Unit ##318H, 319H, 320H and 332H and PLU Remuda Basin 42430 USA #1H - Surface Commingle Application

The Remuda Basin will be allocated based on the check meter,  a well test.

Sorry.

---

**From:** Brooks, David K., EMNRD [mailto:david.brooks@state.nm.us]  
**Sent:** Friday, April 26, 2013 9:39 AM  
**To:** Cherry, Tracie J.  
**Subject:** RE: Poker Lake Unit ##318H, 319H, 320H and 332H and PLU Remuda Basin 42430 USA #1H - Surface Commingle Application

Good morning, Ms. Cherry

I believe you have too many "nots" in the second sentence in the below message.

Please clarify.

David Brooks

---

**From:** Cherry, Tracie J. [mailto:TJCherry@BassPet.Com]  
**Sent:** Thursday, April 25, 2013 4:08 PM  
**To:** Brooks, David K., EMNRD  
**Subject:** RE: Poker Lake Unit ##318H, 319H, 320H and 332H and PLU Remuda Basin 42430 USA #1H - Surface Commingle Application

Mr. Brooks,

The answer to your first question is as follows:

**Well Number/Gravity**

#318H/38.4



#319/38.3

#320H/38.7

#332/40

Remuda Basin #1H/46

I apologize; I did not realize the form that was created as an attachment omitted that information.

The Remuda Basin will  be allocated based on the check meter,  a well test. I did not proofread my message before sending.

This has definitely been a learning process for me! There is currently another application in the works that will be coming to you next week. Thank you for your patience and assistance.

Have a good evening....Tracie Cherry

---

**From:** Brooks, David K., EMNRD [<mailto:david.brooks@state.nm.us>]  
**Sent:** Tuesday, April 23, 2013 10:01 AM  
**To:** Cherry, Tracie J.  
**Subject:** RE: Poker Lake Unit ##318H, 319H, 320H and 332H and PLU Remuda Basin 42430 USA #1H - Surface Commingle Application

Good morning, Ms. Cherry

Thanks for your response to my previous questions. Now I have two more.

First, the attachment referenced in the form C-107-B, though it states BTU for gas for each of the wells, does not state specific gravity for oil, a datum which the C-107-B calls for. If, as I understand, oil from different pools is to be commingled, we will need this information.

Second, the last sentence of your email states that gas from the Remuda Basin well will "go through a check meter for that well" and be allocated back to the well based on tests. I am wondering why allocation based on tests is necessary if the well has its own gas check meter.

Sincerely

David K. Brooks

---

**From:** Cherry, Tracie J. [<mailto:TJCherry@BassPet.Com>]  
**Sent:** Monday, April 22, 2013 1:59 PM  
**To:** Brooks, David K., EMNRD  
**Subject:** RE: Poker Lake Unit ##318H, 319H, 320H and 332H and PLU Remuda Basin 42430 USA #1H - Surface Commingle Application

Mr Brooks:

In gathering the well information to answer your questions, I have learned something about this application after the fact.

This is not an existing order; it will be a new order. I have discovered the wells on the Poker Lake Unit do not have an existing commingle approval in this battery. I was working under the mistaken assumption that, this was taken care of by the "unit" and the only reason commingle approval was needed was to bring the PLU Remuda Basin 4 24 30 gas into the mix. The four existing wells going into the PLU 320 tank battery produce from 3 different pools.

The second question concerning the metering is also incorrect. The Poker Lake Unit wells are combined at the tank battery and flow through a common check meter and then through a common sales meter. The production is allocated back to each well based on well tests. The PLU Remuda Basin 4 24 30 has its own tank battery for oil. Gas goes through a check meter for that well then through the same sales meter with the PLU wells. Gas is also allocated back to this well based on well tests.

I realize there are probably some corrections that need to be made. Please advise as to what they will be and I will handle them as quickly as possible.

Thank you...Tracie Cherry

---

**From:** Brooks, David K., EMNRD [<mailto:david.brooks@state.nm.us>]  
**Sent:** Friday, April 19, 2013 4:03 PM

**To:** Cherry, Tracie J.

**Subject:** Poker Lake Unit ##318H, 319H, 320H and 332H and PLU Remuda Basin 42430 USA #1H - Surface Commingle Application

Dear Ms. Cherry

I have some questions concerning the referenced application.

First, at the top of your Form C-107-B, where it asks, "Is this an amendment to existing Order?" you have checked "No." However, your letter says "This request is to add gas production from the PLU Remuda Basin 4 24 30 USA 1H to the system currently in place at the Poker Lake Unit 320H Battery. Please explain. If there is an existing order we are being asked to amend, it would be helpful if you can supply the order number.

Second, in Item (A)(4) of the form C-107-B, we have checked "Measurement type: Metering." Does this mean that the production from each well is metered prior to commingling? If not, how do you propose to allocate production for purposes of proceed payment and production reporting/

Thanks in advance for your assistance.

Sincerely

David K. Brooks  
Legal Examiner