



RECEIVED

APR 18 1996

OIL CONSERVATION DIV.  
SANTA FE

Southern

Rockies

Business

Unit

DNC 5.7.96  
1262

April 10, 1996

Mr. William J. LeMay, Director  
New Mexico Oil Conservation Division  
2040 S. Pacheco Street  
P. O. Box 6429  
Santa Fe, NM 87505

**Application for Exception to Rule 303-C - Downhole Commingling**  
**Lackey B LS #8 Well**  
**Unit M Section 20-T28N-R9W**  
**Aztec Pictured Cliffs and Blanco Mesaverde Pools**  
**San Juan County, New Mexico**

Enclosed please find an administrative application form (C-107-A) and attachments for downhole commingling for the captioned well. By copy of this application by certified mail, return receipt requested, Amoco is notifying all offset operators in the formations captioned above as well as all affected interest owners if the ownership of those formations is not common. The Division Director may approve the proposed downhole commingling in the absence of a valid objection from any offset operator or any interest owner in those instances where ownership is not common in the zones to be commingled within 20 days after the receipt of the application if, in his opinion, waste will not result thereby, and correlative rights will not be violated.

Should there be questions concerning this matter, please contact me at (303) 830-5344.

Sincerely,

Pamela W. Staley

Enclosures

cc: Steve Webb  
Gail Jefferson  
Wellfile  
Proration File

Frank Chavez, Supervisor  
NMOCD District III  
1000 Rio Brazos Road  
Aztec, NM 87410

Duane Spencer  
Bureau of Land Management  
1235 La Plata Hwy.  
Farmington, NM 87401

Amoco Production Company		P.O. Box 800 Denver, CO 80201	
Operator	Well No.	Address	County
Lackey B LS	8	M-20-28N-9W	San Juan
Lease		Unit Ltr. - Sec Twp - Rge	

Spacing Unit Lease Types: (check 1 or more)

OGRID NO. 000778 Property Code 000784 API NO. 3004513254 Federal ☒ State (and/or) Fee

The following facts are submitted in support of downhole commingling:	Upper Zone	Intermediate Zone	Lower Zone
1. Pool Name and Pool Code	AZTEC PICTURED CLIFFS 71280		BLANCO MESAVERDE 72319
2. Top and Bottom of Pay Section (Perforations)	2040' - 2082'		4288' - 4424'
3. Type of production (Oil or Gas)	GAS		GAS
4. Method of Production (Flowing or Artificial Lift)	FLOWING		FLOWING
5. Bottomhole Pressure	(Current) 242 PSI	a.	a. 409 PSI
Oil Zones - Artificial Lift: Estimated Current			
Gas & Oil - Flowing: Measured Current	(Original) 1258 PSI	b.	b. 1249 PSI
All Gas Zones: Estimated or Measured Original			
6. Oil Gravity (° API) or Gas BTU Content	1117 BTU		1288 BTU
7. Producing or Shut-In?	PRODUCING		PRODUCING
Production Marginal? (yes or no)	YES		YES
• If Shut-In, give data and oil/gas/water rates of last production	Date: Rates:	Date: Rates:	Date: Rates:
Note: For new zones with no production history, applicant shall be required to attach production estimates and supporting data			
• If Producing, give date and oil/gas/water rates of recent test (within 60 days)	Date: Rates: 3/96 80 MCFD 0 BCPD 0 BWPD	Date: Rates:	Date: Rates: 3/96 30 MCFD 0.77 BCPD 0 BWPD
8. Fixed Percentage Allocation Formula -% for each zone	Oil: 0 % Gas 73 %	Oil: % Gas %	Oil: 100 % Gas 27 %

9. If allocation formula is based upon something other than current or past production, or is based upon some other method, submit attachments with supporting data and/or explaining method and providing rate projections or other required data.
10. Are all working, overriding, and royalty interests identical in all commingled zones? ☒ Yes ☐ No  
If not, have all working, overriding, and royalty interests been notified by certified mail? ☐ Yes ☐ No  
Have all offset operators been given written notice of the proposed downhole commingling? ☒ Yes ☐ No
11. Will cross-flow occur? ☐ Yes ☒ No If yes, are fluids compatible, will the formations not be damaged, will any cross-flowed production be recovered, and will the allocation formula be reliable. ☐ Yes ☐ No (If No, attach explanation)
12. Are all produced fluids from all commingled zones compatible with each other? ☒ Yes ☐ No
13. Will the value of production be decreased by commingling? ☐ Yes ☒ No (If Yes, attach explanation)
14. If this well is on, or communitized with, state or federal lands, either the Commissioner of Public Lands or the United States Bureau of Land Management has been notified in writing of this application. ☒ Yes ☐ No SF-077106
15. NMOCD Reference Cases for Rule 303(D) Exceptions: ORDER NO(S).
16. ATTACHMENTS:
- \* C-102 for each zone to be commingled showing its spacing unit and acreage dedication.
  - \* Production curve for each zone for at least one year. (If not available, attach explanation.)
  - \* For zones with no production history, estimated production rates and supporting data.
  - \* Data to support allocation method or formula.
  - \* Notification list of all offset operators.
  - \* Notification list of working, overriding, and royalty interests for uncommon interest cases.
  - \* Any additional statements, data, or documents required to support commingling.

I hereby certify that the information above is true and complete to the best of my knowledge and belief.

SIGNATURE Pamela W. Staley TITLE REGULATORY AFFAIRS REP DATE 4/11/96

TYPE OR PRINT NAME PAMELA W. STALEY TELEPHONE NO. ( 303 ) 830-5344

NEW MEXICO  
OIL CONSERVATION COMMISSION

Form 1-128

WELL LOCATION AND/OR GAS PRORATION PLAT

DATE **JANUARY 7, 1957**

OPERATOR **EL PASO NATURAL GAS COMPANY** LEASE **LACKEY "B"** **SF 077106**

WELL NO. **8 (PM)** SECTION **20** TOWNSHIP **28 N** RANGE **9 W** NEPM

LOCATED **890** FEET FROM **SOUTH** LINE **990** FEET FROM **WEST** LINE

**SAN JUAN**

COUNTY, NEW MEXICO

G.L. ELEVATION **5861**

**PICTURED CLIFF**

**AZTEC P.C.**

**160 AC. PC**

NAME OF PRODUCING FORMATION **& MESA VERDE** POOL **BLANCO M.V.** DEDICATED ACREAGE **320 AC. MV**  
**(1919 PLAT)**

Note: All distances must be from outer boundaries of section.

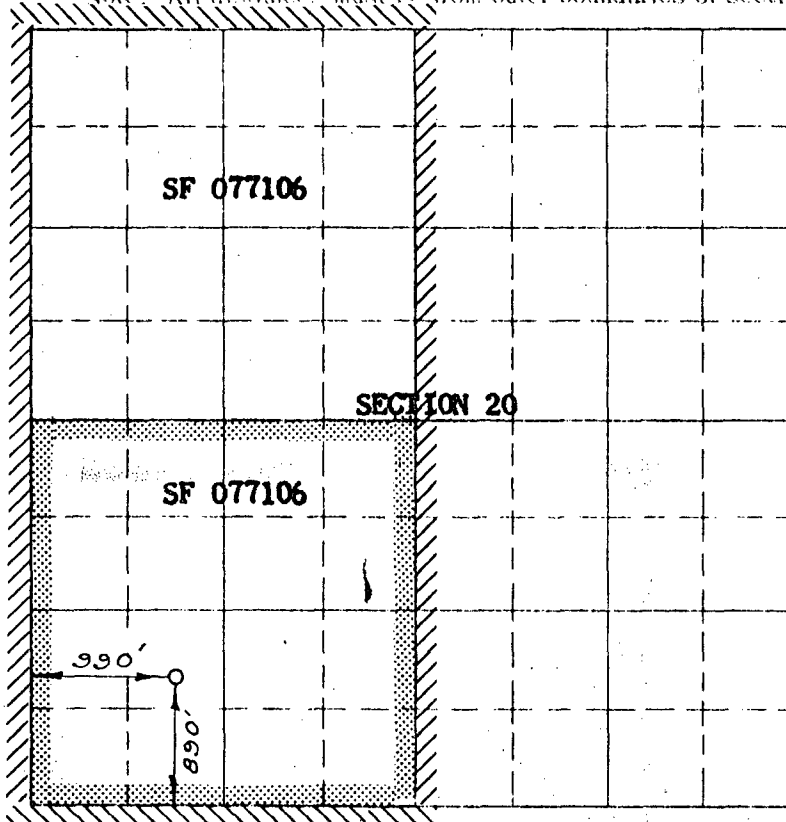

Scale 4 inches equal 1 mile

RECEIVED  
JAN 11 1957  
U. S. GEOLOGICAL SURVEY  
FARMINGTON, NEW MEXICO

NOTE

This section of  
form is to be used  
for gas wells only

This is to certify that the above plat was prepared from  
field notes of actual surveys made by me or under my  
supervision and that the same are true and correct to the  
best of my knowledge and belief.

Date Surveyed **DECEMBER 17, 1956**

*E. O. Walker*  
Registered Professional Engineer and/or Land Surveyor

(Seal)

Farmington, New Mexico

1. Is this well a Dual Comp.  
Yes **X** No
2. If the answer to Question 1  
is yes, are there any other dually  
completed wells within the  
dedicated acreage.  
Yes No **X**

Name **ORIGINAL SIGNED E.S. OBERLY**  
Position **Petroleum Engineer**  
Representing **El Paso Natural Gas Co.**  
Address **Box 997, Farmington, N.M.**

# Dwights

Lease: LACKEY B LS 000008

Retrieval Code: 251,045,28N09W20M00MV

04/09/96

10<sup>3</sup>  
10<sup>3</sup>  
10<sup>3</sup>

10<sup>4</sup>

10<sup>2</sup>  
10<sup>2</sup>  
10<sup>2</sup>

10<sup>3</sup>

10  
10

10<sup>2</sup>

1  
1

10

1970 1972 1974 1976 1978 1980 1982 1984 1986 1988 1990 1992 1994 1996

Oil (bbl/mo)

Water (bbl/mo)

Gas (mcf/mo)

F.P. Date: 06/57

County: SAN JUAN, NM

Field: BLANCO (MESAVARDE) MV

Oil Cum: 14.45 mbbl

Reservoir: MESAVARDE

Gas Cum: 1107 mmcf

Operator: AMOCO PRODUCTION CO

Location: 20M 28N 9W

# Dwights

Lease: LACKEY B LS 000008

Retrieval Code: 251,045,28N09W20M00PC

04/09/96

10<sup>3</sup>  
10<sup>3</sup>

10<sup>4</sup>

10<sup>2</sup>  
10<sup>2</sup>

10<sup>3</sup>

10  
10

10<sup>2</sup>

1  
1

10

1970 1972 1974 1976 1978 1980 1982 1984 1986 1988 1990 1992 1994 1996

Oil (bbl/mo)

F.P. Date: 06/57

County: SAN JUAN, NM

Gas (mcf/mo)

Water (bbl/mo)

Oil Cum: 0 bbl

Field: AZTEC (PICTURED CLIFFS) PC

Gas Cum: 1389 mmcf

Reservoir: PICTURED CLIFFS

Location: 20M 28N 9W

Operator: AMOCO PRODUCTION CO

**OFFSET OPERATORS**  
**Lackey B LS #8**

Meridian Oil, Inc.  
P.O. Box 4289  
Farmington, NM 87499