

INTRODUCTION

This summary is submitted to the New Mexico Oil Conservation Division (OCD) District 1 in Hobbs, New Mexico, on behalf of XTO Energy, Inc. (XTO), a subsidiary of ExxonMobil, for the investigation and closure of an unlined pit (Grimes Pit #3) that was used in conjunction with shallow wells and separation equipment by another operator, Windmill Oil Company, to recover crude oil from shallow groundwater. The pit is located in Unit J (NW/4, SE/4), Section 30, Township 18 South, Range 38 East, in Lea County, New Mexico. The geodetic position is north 32° 43' 04.94" and west 103° 11' 08.95". Figure 1 presents a topographic map. Figure 2 presents an aerial photograph.

BACKGROUND

The U.S. Bureau of Land Management (BLM), as mineral owner, was unable to locate the former operator, believed to be Windmill Oil Company, to restore the area, including plugging wells, removing equipment (i.e., tanks, vessels and piping) and closing the pit. The site reverted back to ExxonMobil as a former oil and gas mineral lessee.

On October 15, 2013, XTO submitted a closure plan meeting the requirements of 19.15.17.13(C) NMAC to the OCD in Santa Fe, New Mexico. The closure plan was approved on October 22, 2013. On December 1, 2013, after providing notification to the landowner, Watson Construction, Inc., under supervision from Larson & Associates, Inc. (LAI) removed BS&W and hydrocarbon contaminated material from the pit. The materials were disposed at Sundance Services located east of Eunice, New Mexico.

On December 2, 2013, LAI personnel collected a 5 part composite sample from the bottom of the pit. The sample was submitted under preservation and chain of custody to Permian Basin Environmental Lab (PBELAB) located in Midland, Texas. The sample was analyzed for benzene, toluene, ethylbenzene, xylenes (BTEX) by method SW-846-8021B, total petroleum hydrocarbons (TPH), including, diesel (DRO), gasoline (GRO) and oil (ORO) range organics, by method SW-846-8015M and chloride by method E300. Table 1 presents the analytical data summary.

On December 18, 2013, the laboratory data summary was transmitted to the OCD in Santa Fe, New Mexico which requested that XTO to notify the OCD District 1 due to TPH exceeding the standard under 19.15.17.13(C).

On December 23, 2013, LAI personnel met with Mr. Geoffrey Leking, OCD District 1, to discuss the sample results and path forward. Mr. Leking requested XTO to submit an initial C-141 (Release Notification and Corrective Action) and delineate the extent of the TPH. On December 31, 2013, XTO submitted the initial C-141. The OCD District 1 assigned the site remediation action project number 1RP-12-13-2999.

approved
Geoffrey Leking
Environmental Specialist
NMOCD-DIST 1
2110114

FEB 10 2014

INVESTIGATION

On January 13 and 14, 2013, Scarborough Drilling, Inc. (Scarborough) used an air rotary rig and jam tube sampler to collect soil samples at 5 locations (3-1 through 3-5) in the bottom and each direction (north, south, east and west) from the center of the pit. A sample was collected about every 5 feet to 30 feet and about every 10 feet to about 50 feet below ground surface (bgs). Groundwater was determined to occur at about 60 feet bgs. The samples were collected in 4 ounce glass jars that were preserved and delivered under chain of custody to Cardinal Laboratory located in Hobbs, New Mexico. The samples were analyzed for TPH, including DRO, GRO and ORO, by method SW-846-8015M. Duplicate samples were collected in 8 ounce glass jars for headspace analysis. The headspace samples were sealed with aluminum foil and warmed on the dashboard of the vehicle before measuring the organic vapor content with a calibrated photoionization detector (PID). The sample from each boring with the highest PID reading over 100 parts per million (ppm) was analyzed for BTEX by method SW-846-8021B. Table 2 presents the laboratory analytical data summary. Appendix B presents the laboratory reports.

Referring to Table 2, benzene and BTEX were below the OCD recommended remediation action level (RRAL) of 10 and 50 milligrams per kilogram (mg/Kg), respectively, in samples from borings 3-1 through 3-5. The TPH was delineated to the vertical and lateral limits of the borings.

REMEDIATION PLAN

XTO proposes to excavate soil to approximately 7 feet bgs. A liner of at least 20 mils will be placed in the bottom of the excavation. The liner will be covered with clean soil and the excavation closed according to the reclamation plan approved by OCD in Santa Fe, on October 22, 2013.

TABLES

Table 1
Initial Soil Sample Analytical Data Summary
XTO Energy, Inc., Grimes Pit #3
Lea County, New Mexico

1RP-12-13-3001

Composite Sample	Sampling Date	Benzene	Toluene	Ethylbenzene	Total Xylenes	Total BTEX	TPH (C6 - C12)	TPH (>C12 - C28)	TPH (>C28 - C35)	TPH (C6 - C35)	Chloride
19.15.17.13(3) Standard		10	0.75	0.75	0.62	50					600
Pit #1	12/10/2013	<0.00109	<0.00217	0.00109	0.00326	38.7	<136	3,850	1,380	5,240	38.7

Table 2
Delineation Sample Analytical Data Summary
XTO Energy, Inc., Grimes Pit #3
Lea County, New Mexico

1RP-12-13-3001

Boring Number	Sample Depth	Sampling Date	Location	PID	Benzene	BTEX	TPH (C6 - C10)	TPH (>C10 - C28)	TPH (>C28 - C35)	TPH (C6- C35)
MOCD RRAL:					10	50				1,000
3-1	10	1/13/2014	Center	326	--	--	27.8	260	73.3	361.1
	15	1/13/2014		515	--	--	151	3,010	678	3,839
	20	1/13/2014		486	--	--	295	5,120	1,050	6,465
	25	1/13/2014		752	0.079	5.41	525	6,150	1,170	7,845
	30	1/13/2014		271	--	--	<50.0	1,220	278	1,498
	40	1/13/2014		645	--	--	208	4,530	861	5,599
	*50	1/13/2014		1035	--	--	4,550	11,600	2,080	18,230
	*60	1/13/2014		202			4,290	10,600	1,750	16,640
3-2	5	1/14/2014	North	248.2	--	--	23.3	383	75.1	481.4
	10	1/14/2014		303	--	--	36.2	476	93.5	605.7
	15	1/14/2014		27.4	--	--	<10.0	99	25.3	124.3
	20	1/14/2014		52.3	--	--	<10.0	103	23.4	126.4
	25	1/14/2014		400	<0.100	7.83	152	1,280	234	1,666
	30	1/14/2014		1038	--	--	68.6	976	196	1,240.6
	40	1/14/2014		296	--	--	<50.0	795	160	955
	50	1/14/2014		316	--	--	75.9	1,280	220	1,500
3-3	5	1/14/2014	East	0.8	--	--	<10.0	<10.0	<10.0	<10.0
	10	1/14/2014		4.3	--	--	<10.0	<10.0	<10.0	<10.0
	15	1/14/2014		9.7	--	--	<10.0	<10.0	<10.0	<10.0
	20	1/14/2014		36	--	--	<10.0	28.9	<10.0	28.9
	25	1/14/2014		515	<0.200	2.95	124	1,220	234	1,578
	30	1/14/2014		172	--	--	50.6	850	165	1,065.6
	40	1/14/2014		99	--	--	66.2	1,390	259	1,715.2
	50	1/14/2014		172	--	--	94.8	1,540	287	1,921.8
3-4	5	1/13/2014	South	9.7	--	--	<10.0	<10.0	<10.0	<10.0

Table 2
Delineation Sample Analytical Data Summary
XTO Energy, Inc., Grimes Pit #3
Lea County, New Mexico

1 RP-12-13-3001

Boring Number	Sample Depth	Sampling Date	Location	PID	Benzene	Total BTEX	TPH (C6 - C10)	TPH (>C10 - C28)	TPH (>C28 - C35)	TPH (C6 - C35)
MOCD RRAL:					10	50				1,000
	10	1/13/2014		2.6	--	--	<10.0	<10.0	<10.0	<10.0
	15	1/13/2014		2.6	--	--	<10.0	10.4	<10.0	10.4
	20	1/13/2014		11.5	--	--	<10.0	62.6	14.7	77.3
	25	1/13/2014		498	<0.050	2.46	107	2,230	412	2,749
	30	1/13/2014		172.5	--	--	<50.0	1,430	292	1,722
	40	1/13/2014		236	--	--	<50.0	1,560	315	1,875
	50	1/13/2014		223.6	--	--	56.9	888	144	1,088.9
3-5	5	1/13/2014	West	798	0.252	4.14	331	3,790	1,170	5,291
	10	1/13/2014		387	--	--	<100	1,860	441	2,301
	15	1/13/2014		23.3	--	--	<10	131	31.2	162.2
	20	1/13/2014		243.8	--	--	41.2	412	78.4	531.6
	25	1/13/2014		312	--	--	232	2,520	505	3,257
	30	1/13/2014		505	--	--	<100	1,510	341	1,850
	40	1/13/2014		188	--	--	<100	861	194	1,055
	50	1/13/2014		117	--	--	142	2,270	425	2,837

Notes: Samples analyzed by Cardinal Laboratories, Inc., Hobbs, New Mexico

Samples analyzed via EPA method SW-8021B (BTEX) and SW-8015M (TPH)

Depth is in feet below ground surface (bgs).

Photionization detector (PID) values are in parts per million (ppm)

Laboratory values are in milligrams per kilogram (mg/Kg) equivalent to parts per million (ppm).

* Sample collected at capillary frindge or groundwater

-- No data available

FIGURES

BSK

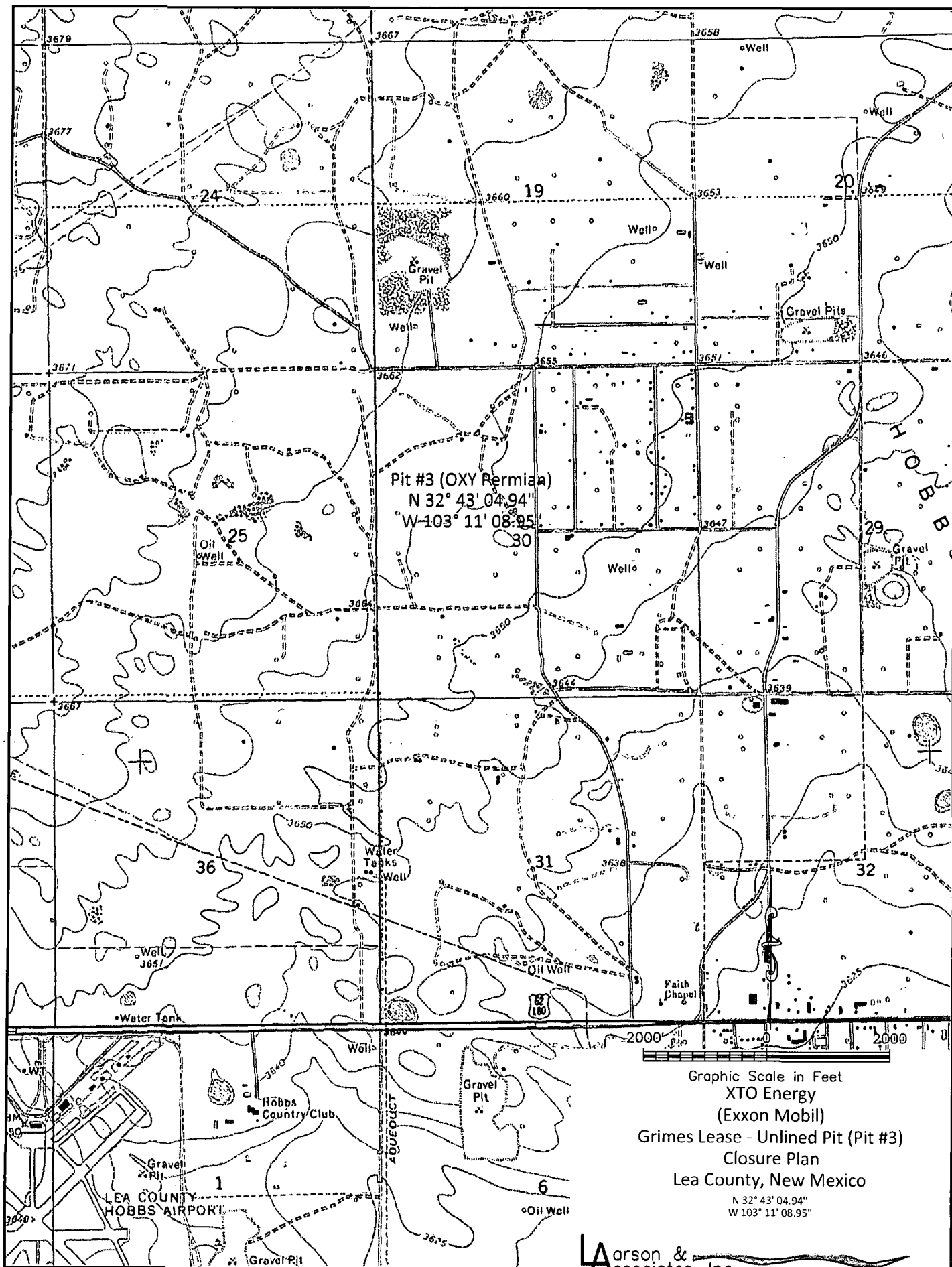

Figure 1 - Topographic Map

BSK

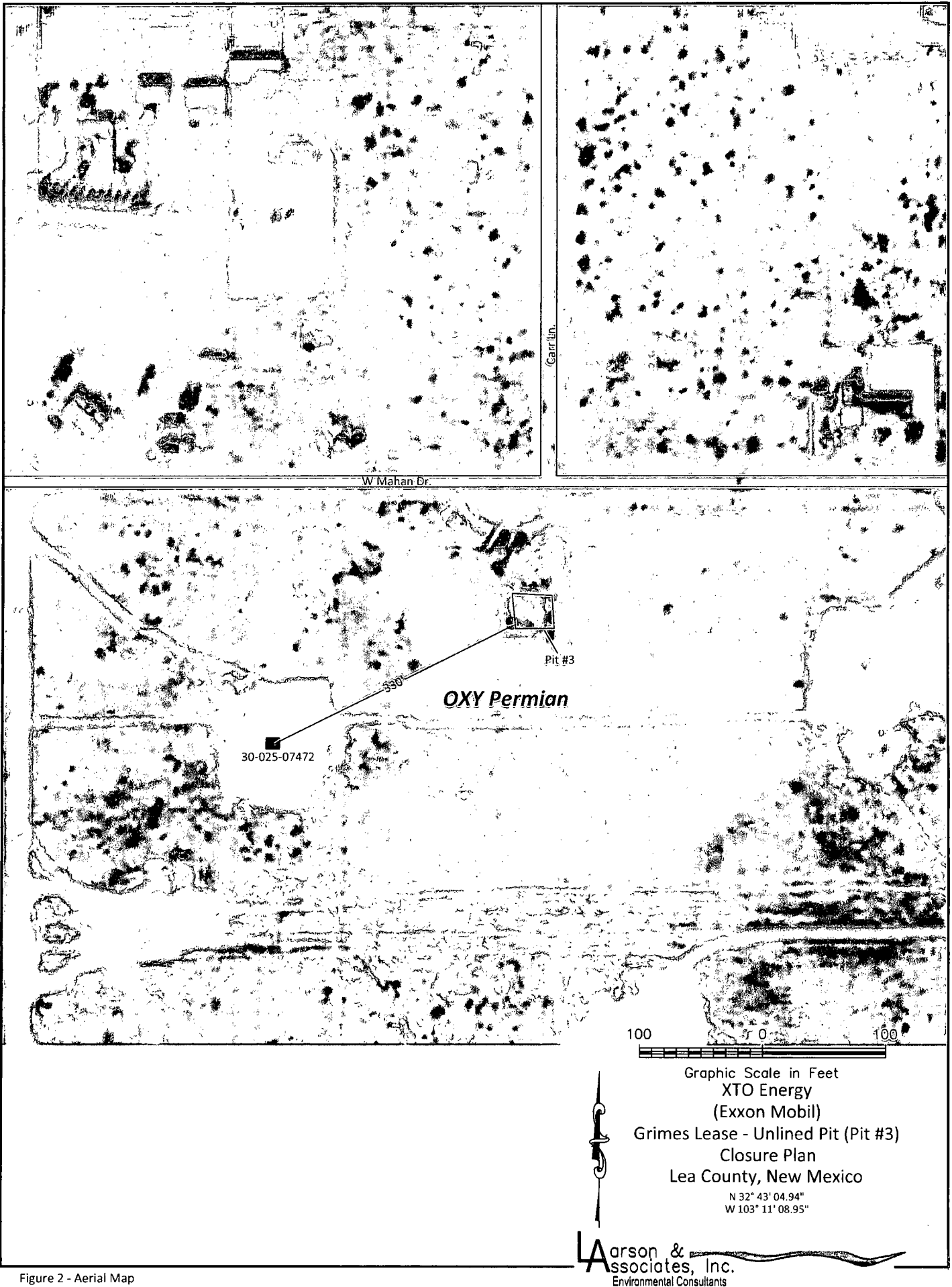

Figure 2 - Aerial Map

BSK

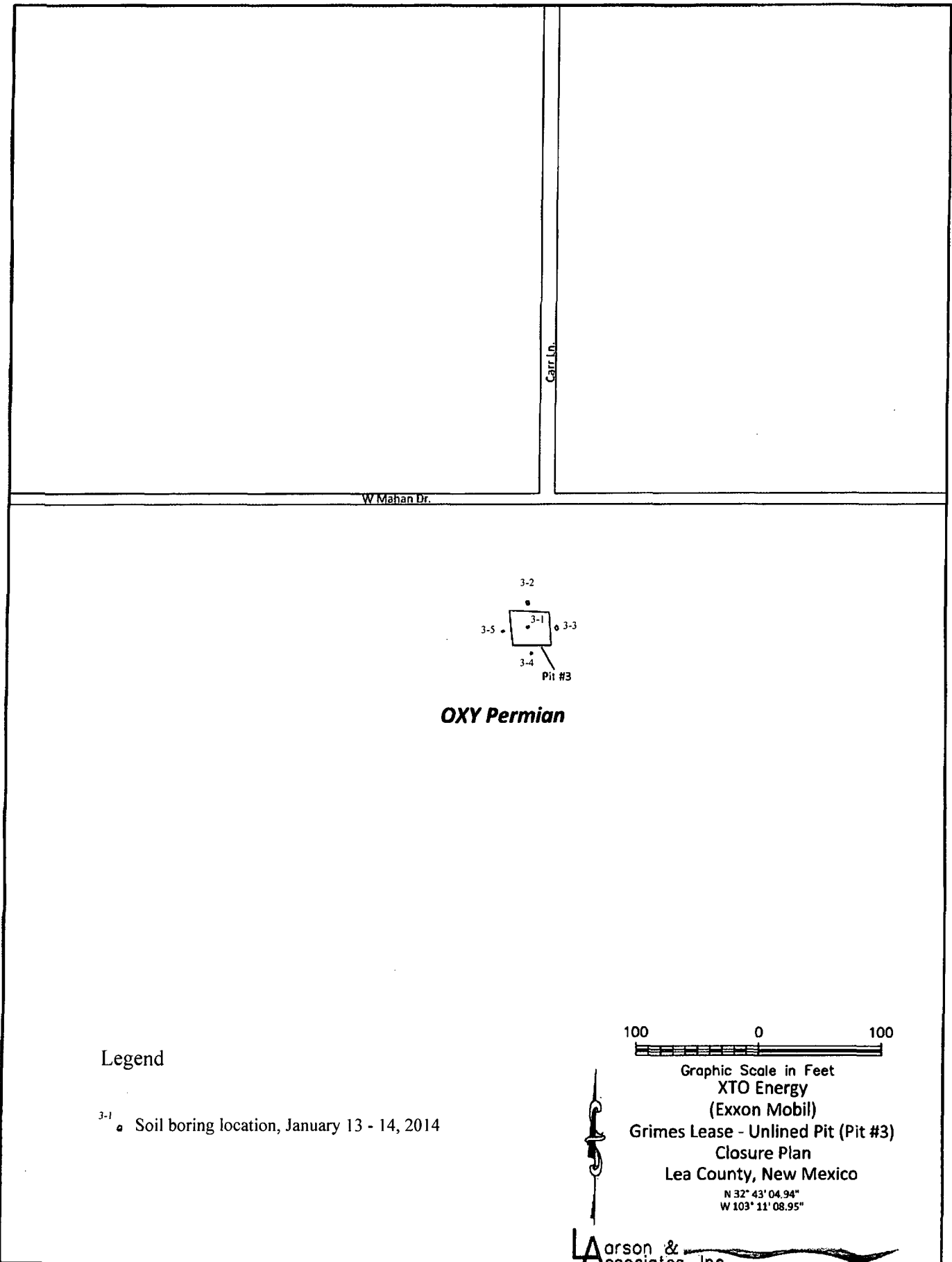

Figure 3 - Site Map

ATTACHMENT A

Photographs

Photo: Pit #3 before excavation
commenced

Direction: South

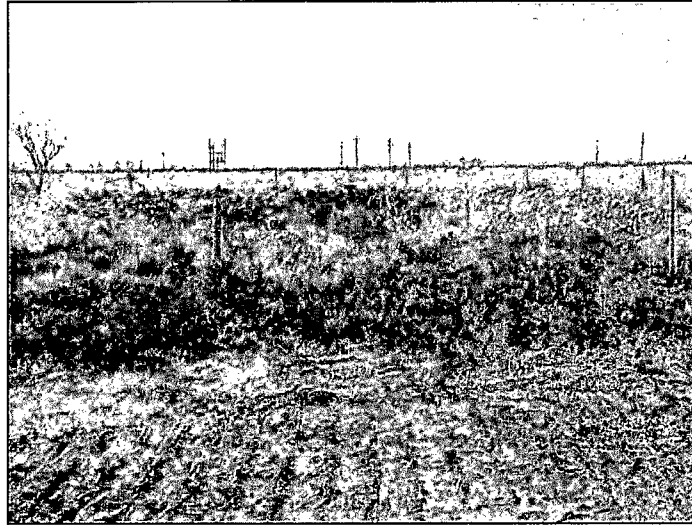

Photo: Pit during excavation

Direction: West



Photo: Excavation limits of pit before
fence was put into place

Direction: Southeast



ATTACHMENT B

Laboratory Reports



PHONE (575) 393-2326 ° 101 E. MARLAND ° HOBBS, NM 88240

January 21, 2014

MARK LARSON

LARSON & ASSOCIATES, INC.

507 N. MARIENFELD, SUITE 200

MIDLAND, TX 79701

RE: GRIMES PIT #3

Enclosed are the results of analyses for samples received by the laboratory on 01/14/14 9:20.

Cardinal Laboratories is accredited through Texas NELAP under certificate number T104704398-13-5. Accreditation applies to drinking water, non-potable water and solid and chemical materials. All accredited analytes are denoted by an asterisk (*). For a complete list of accredited analytes and matrices visit the TCEQ website at www.tceq.texas.gov/field/ga/lab_accred_certif.html.

Cardinal Laboratories is accredited through the State of Colorado Department of Public Health and Environment for:

Method EPA 552.2	Haloacetic Acids (HAA-5)
Method EPA 524.2	Total Trihalomethanes (TTHM)
Method EPA 524.4	Regulated VOCs (V1, V2, V3)

Accreditation applies to public drinking water matrices.

This report meets NELAP requirements and is made up of a cover page, analytical results, and a copy of the original chain-of-custody. If you have any questions concerning this report, please feel free to contact me.

Sincerely,

Celey D. Keene

Lab Director/Quality Manager

Analytical Results For:

LARSON & ASSOCIATES, INC.
MARK LARSON
507 N. MARIENFELD, SUITE 200
MIDLAND TX, 79701
Fax To: ?

Received: 01/14/2014
Reported: 01/21/2014
Project Name: GRIMES PIT #3
Project Number: 12-0148-04
Project Location: LEA COUNTY, NM

Sampling Date: 01/13/2014
Sampling Type: Soil
Sampling Condition: Cool & Intact
Sample Received By: Jodi Henson

Sample ID: 3-1-10' (H400111-01)

TPH 8015M	mg/kg	Analyzed By: ms							
Analyte	Result	Reporting Limit	Analyzed	Method Blank	BS	% Recovery	True Value QC	RPD	Qualifier
GRO C6-C10	27.8	10.0	01/14/2014	ND	209	105	200	6.89	
DRO >C10-C28	260	10.0	01/14/2014	ND	233	116	200	1.72	
EXT DRO >C28-C35	73.3	10.0	01/14/2014	ND					
Surrogate: 1-Chlorooctane	110 %	65.2-140							
Surrogate: 1-Chlorooctadecane	132 %	63.6-154							

Sample ID: 3-1-15' (H400111-02)

TPH 8015M	mg/kg	Analyzed By: ms							S-06
Analyte	Result	Reporting Limit	Analyzed	Method Blank	BS	% Recovery	True Value QC	RPD	Qualifier
GRO C6-C10	151	100	01/14/2014	ND	209	105	200	6.89	
DRO >C10-C28	3010	100	01/14/2014	ND	233	116	200	1.72	
EXT DRO >C28-C35	678	100	01/14/2014	ND					
Surrogate: 1-Chlorooctane	93.3 %	65.2-140							
Surrogate: 1-Chlorooctadecane	175 %	63.6-154							

Cardinal Laboratories

*=Accredited Analyte

PLEASE NOTE: Liability and Damages. Cardinal's liability and client's exclusive remedy for any claim arising, whether based in contract or tort, shall be limited to the amount paid by client for analyses. All claims, including those for negligence and any other cause whatsoever shall be deemed waived unless made in writing and received by Cardinal within thirty (30) days after completion of the applicable service. In no event shall Cardinal be liable for incidental or consequential damages, including, without limitation, business interruptions, loss of use, or loss of profits incurred by client, its subsidiaries, affiliates or successors arising out of or related to the performance of the services hereunder by Cardinal, regardless of whether such claim is based upon any of the above stated reasons or otherwise. Results relate only to the samples identified above. This report shall not be reproduced except in full with written approval of Cardinal Laboratories.



Celey D. Keene, Lab Director/Quality Manager

Analytical Results For:

LARSON & ASSOCIATES, INC.
MARK LARSON
507 N. MARIENFELD, SUITE 200
MIDLAND TX, 79701
Fax To: ?

Received: 01/14/2014
Reported: 01/21/2014
Project Name: GRIMES PIT #3
Project Number: 12-0148-04
Project Location: LEA COUNTY, NM

Sampling Date: 01/13/2014
Sampling Type: Soil
Sampling Condition: Cool & Intact
Sample Received By: Jodi Henson

Sample ID: 3-1-20' (H400111-03)

TPH 8015M	mg/kg	Analyzed By: ms							
Analyte	Result	Reporting Limit	Analyzed	Method Blank	BS	% Recovery	True Value QC	RPD	Qualifier
GRO C6-C10	295	100	01/14/2014	ND	209	105	200	6.89	
DRO >C10-C28	5120	100	01/14/2014	ND	233	116	200	1.72	
EXT DRO >C28-C35	1050	100	01/14/2014	ND					
Surrogate: 1-Chlorooctane	94.2 %	65.2-140							
Surrogate: 1-Chlorooctadecane	149 %	63.6-154							

Cardinal Laboratories

*=Accredited Analyte

PLEASE NOTE: Liability and Damages. Cardinal's liability and client's exclusive remedy for any claim arising, whether based in contract or tort, shall be limited to the amount paid by client for analyses. All claims, including those for negligence and any other cause whatsoever shall be deemed waived unless made in writing and received by Cardinal within thirty (30) days after completion of the applicable service. In no event shall Cardinal be liable for incidental or consequential damages, including, without limitation, business interruptions, loss of use, or loss of profits incurred by client, its subsidiaries, affiliates or successors arising out of or related to the performance of the services hereunder by Cardinal, regardless of whether such claim is based upon any of the above stated reasons or otherwise. Results relate only to the samples identified above. This report shall not be reproduced except in full with written approval of Cardinal Laboratories.



Celey D. Keene, Lab Director/Quality Manager

Analytical Results For:

 LARSON & ASSOCIATES, INC.
 MARK LARSON
 507 N. MARIENFELD, SUITE 200
 MIDLAND TX, 79701
 Fax To: ?

 Received: 01/14/2014
 Reported: 01/21/2014
 Project Name: GRIMES PIT #3
 Project Number: 12-0148-04
 Project Location: LEA COUNTY, NM

 Sampling Date: 01/13/2014
 Sampling Type: Soil
 Sampling Condition: Cool & Intact
 Sample Received By: Jodi Henson

Sample ID: 3-1-25' (H400111-04)

BTX 8021B		mg/kg		Analyzed By: MS				S-04	
Analyte	Result	Reporting Limit	Analyzed	Method Blank	BS	% Recovery	True Value QC	RPD	Qualifier
Benzene*	0.079	0.050	01/15/2014	ND	2.17	108	2.00	1.01	
Toluene*	0.355	0.050	01/15/2014	ND	2.13	106	2.00	0.607	
Ethylbenzene*	2.09	0.050	01/15/2014	ND	2.15	108	2.00	0.331	
Total Xylenes*	2.89	0.150	01/15/2014	ND	6.38	106	6.00	0.537	
Total BTX	5.41	0.300	01/15/2014	ND					

Surrogate: 4-Bromofluorobenzene (PIE) 376 % 89.4-126

TPH 8015M		mg/kg		Analyzed By: ms				S-06	
Analyte	Result	Reporting Limit	Analyzed	Method Blank	BS	% Recovery	True Value QC	RPD	Qualifier
GRO C6-C10	525	100	01/15/2014	ND	199	99.6	200	3.64	
DRO >C10-C28	6150	100	01/15/2014	ND	200	100	200	3.66	
EXT DRO >C28-C35	1170	100	01/15/2014	ND					

Surrogate: 1-Chlorooctane 121 % 65.2-140

Surrogate: 1-Chlorooctadecane 169 % 63.6-154

Cardinal Laboratories

*=Accredited Analyte

PLEASE NOTE: Liability and Damages. Cardinal's liability and client's exclusive remedy for any claim arising, whether based in contract or tort, shall be limited to the amount paid by client for analyses. All claims, including those for negligence and any other cause whatsoever shall be deemed waived unless made in writing and received by Cardinal within thirty (30) days after completion of the applicable service. In no event shall Cardinal be liable for incidental or consequential damages, including, without limitation, business interruptions, loss of use, or loss of profits incurred by client, its subsidiaries, affiliates or successors arising out of or related to the performance of the services hereunder by Cardinal, regardless of whether such claim is based upon any of the above stated reasons or otherwise. Results relate only to the samples identified above. This report shall not be reproduced except in full with written approval of Cardinal Laboratories.



Celey D. Keene, Lab Director/Quality Manager

Analytical Results For:

 LARSON & ASSOCIATES, INC.
 MARK LARSON
 507 N. MARIENFELD, SUITE 200
 MIDLAND TX, 79701
 Fax To: ?

 Received: 01/14/2014
 Reported: 01/21/2014
 Project Name: GRIMES PIT #3
 Project Number: 12-0148-04
 Project Location: LEA COUNTY, NM

 Sampling Date: 01/13/2014
 Sampling Type: Soil
 Sampling Condition: Cool & Intact
 Sample Received By: Jodi Henson

Sample ID: 3-1-30' (H400111-05)

TPH 8015M	mg/kg	Analyzed By: ms					S-06		
Analyte	Result	Reporting Limit	Analyzed	Method Blank	BS	% Recovery	True Value QC	RPD	Qualifier
GRO C6-C10	<50.0	50.0	01/15/2014	ND	199	99.6	200	3.64	
DRO >C10-C28	1220	50.0	01/15/2014	ND	200	100	200	3.66	
EXT DRO >C28-C35	278	50.0	01/15/2014	ND					
<hr/>									
Surrogate: 1-Chlorooctane	94.1 %	65.2-140							
Surrogate: 1-Chlorooctadecane	157 %	63.6-154							

Sample ID: 3-1-40' (H400111-06)

TPH 8015M	mg/kg	Analyzed By: ms							
Analyte	Result	Reporting Limit	Analyzed	Method Blank	BS	% Recovery	True Value QC	RPD	Qualifier
GRO C6-C10	208	100	01/15/2014	ND	199	99.6	200	3.64	
DRO >C10-C28	4530	100	01/15/2014	ND	200	100	200	3.66	
EXT DRO >C28-C35	861	100	01/15/2014	ND					
<hr/>									
Surrogate: 1-Chlorooctane	95.6 %	65.2-140							
Surrogate: 1-Chlorooctadecane	149 %	63.6-154							

Cardinal Laboratories

*=Accredited Analyte

PLEASE NOTE: Liability and Damages. Cardinal's liability and client's exclusive remedy for any claim arising, whether based in contract or tort, shall be limited to the amount paid by client for analyses. All claims, including those for negligence and any other cause whatsoever shall be deemed waived unless made in writing and received by Cardinal within thirty (30) days after completion of the applicable service. In no event shall Cardinal be liable for incidental or consequential damages, including, without limitation, business interruptions, loss of use, or loss of profits incurred by client, its subsidiaries, affiliates or successors arising out of or related to the performance of the services hereunder by Cardinal, regardless of whether such claim is based upon any of the above stated reasons or otherwise. Results relate only to the samples identified above. This report shall not be reproduced except in full with written approval of Cardinal Laboratories.

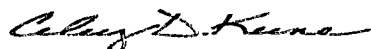

Celey D. Keene, Lab Director/Quality Manager

Analytical Results For:

 LARSON & ASSOCIATES, INC.
 MARK LARSON
 507 N. MARIENFELD, SUITE 200
 MIDLAND TX, 79701
 Fax To: ?

 Received: 01/14/2014
 Reported: 01/21/2014
 Project Name: GRIMES PIT #3
 Project Number: 12-0148-04
 Project Location: LEA COUNTY, NM

 Sampling Date: 01/13/2014
 Sampling Type: Soil
 Sampling Condition: Cool & Intact
 Sample Received By: Jodi Henson

Sample ID: 3-1-50' (H400111-07)

TPH 8015M	mg/kg	Analyzed By: ms						S-06	
Analyte	Result	Reporting Limit	Analyzed	Method Blank	BS	% Recovery	True Value QC	RPD	Qualifier
GRO C6-C10	4550	200	01/15/2014	ND	199	99.6	200	3.64	
DRO >C10-C28	11600	200	01/15/2014	ND	200	100	200	3.66	
EXT DRO >C28-C35	2080	200	01/15/2014	ND					
Surrogate: 1-Chlorooctane	348 %	65.2-140							
Surrogate: 1-Chlorooctadecane	545 %	63.6-154							

Sample ID: 3-1-60' (H400111-08)

TPH 8015M	mg/kg	Analyzed By: ms						S-06	
Analyte	Result	Reporting Limit	Analyzed	Method Blank	BS	% Recovery	True Value QC	RPD	Qualifier
GRO C6-C10	4290	200	01/15/2014	ND	199	99.6	200	3.64	
DRO >C10-C28	10600	200	01/15/2014	ND	200	100	200	3.66	
EXT DRO >C28-C35	1750	200	01/15/2014	ND					
Surrogate: 1-Chlorooctane	218 %	65.2-140							
Surrogate: 1-Chlorooctadecane	250 %	63.6-154							

Cardinal Laboratories

* = Accredited Analyte

PLEASE NOTE: Liability and Damages. Cardinal's liability and client's exclusive remedy for any claim arising, whether based in contract or tort, shall be limited to the amount paid by client for analyses. All claims, including those for negligence and any other cause whatsoever shall be deemed waived unless made in writing and received by Cardinal within thirty (30) days after completion of the applicable service. In no event shall Cardinal be liable for incidental or consequential damages, including, without limitation, business interruptions, loss of use, or loss of profits incurred by client, its subsidiaries, affiliates or successors arising out of or related to the performance of the services hereunder by Cardinal, regardless of whether such claim is based upon any of the above stated reasons or otherwise. Results relate only to the samples identified above. This report shall not be reproduced except in full with written approval of Cardinal Laboratories.



Celey D. Keene, Lab Director/Quality Manager

Analytical Results For:

 LARSON & ASSOCIATES, INC.
 MARK LARSON
 507 N. MARIENFELD, SUITE 200
 MIDLAND TX, 79701
 Fax To: ?

 Received: 01/14/2014
 Reported: 01/21/2014
 Project Name: GRIMES PIT #3
 Project Number: 12-0148-04
 Project Location: LEA COUNTY, NM

 Sampling Date: 01/13/2014
 Sampling Type: Soil
 Sampling Condition: Cool & Intact
 Sample Received By: Jodi Henson

Sample ID: 3-5-5' (H400111-09)

BTEX 8021B		mg/kg		Analyzed By: MS				S-04	
Analyte	Result	Reporting Limit	Analyzed	Method Blank	BS	% Recovery	True Value QC	RPD	Qualifier
Benzene*	0.252	0.200	01/15/2014	ND	2.17	108	2.00	1.01	
Toluene*	0.520	0.200	01/15/2014	ND	2.13	106	2.00	0.607	
Ethylbenzene*	1.27	0.200	01/15/2014	ND	2.15	108	2.00	0.331	
Total Xylenes*	2.10	0.600	01/15/2014	ND	6.38	106	6.00	0.537	
Total BTEX	4.14	1.20	01/15/2014	ND					

Surrogate: 4-Bromofluorobenzene (PIC) 146 % 89.4-126

TPH 8015M		mg/kg		Analyzed By: ms				S-06	
Analyte	Result	Reporting Limit	Analyzed	Method Blank	BS	% Recovery	True Value QC	RPD	Qualifier
GRO C6-C10	331	200	01/15/2014	ND	199	99.6	200	3.64	
DRO >C10-C28	3790	200	01/15/2014	ND	200	100	200	3.66	
EXT DRO >C28-C35	1170	200	01/15/2014	ND					

Surrogate: 1-Chlorooctane 78.4 % 65.2-140

Surrogate: 1-Chlorooctadecane 295 % 63.6-154

Cardinal Laboratories

*=Accredited Analyte

PLEASE NOTE: Liability and Damages. Cardinal's liability and client's exclusive remedy for any claim arising, whether based in contract or tort, shall be limited to the amount paid by client for analyses. All claims, including those for negligence and any other cause whatsoever shall be deemed waived unless made in writing and received by Cardinal within thirty (30) days after completion of the applicable service. In no event shall Cardinal be liable for incidental or consequential damages, including, without limitation, business interruptions, loss of use, or loss of profits incurred by client, its subsidiaries, affiliates or successors arising out of or related to the performance of the services hereunder by Cardinal, regardless of whether such claim is based upon any of the above stated reasons or otherwise. Results relate only to the samples identified above. This report shall not be reproduced except in full with written approval of Cardinal Laboratories.

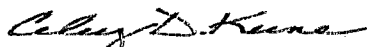

Celey D. Keene, Lab Director/Quality Manager

Analytical Results For:

 LARSON & ASSOCIATES, INC.
 MARK LARSON
 507 N. MARIENFELD, SUITE 200
 MIDLAND TX, 79701
 Fax To: ?

 Received: 01/14/2014
 Reported: 01/21/2014
 Project Name: GRIMES PIT #3
 Project Number: 12-0148-04
 Project Location: LEA COUNTY, NM

 Sampling Date: 01/13/2014
 Sampling Type: Soil
 Sampling Condition: Cool & Intact
 Sample Received By: Jodi Henson

Sample ID: 3-5-10' (H400111-10)

TPH 8015M	mg/kg	Analyzed By: ms					S-06		
Analyte	Result	Reporting Limit	Analyzed	Method Blank	BS	% Recovery	True Value QC	RPD	Qualifier
GRO C6-C10	<100	100	01/15/2014	ND	199	99.6	200	3.64	
DRO >C10-C28	1860	100	01/15/2014	ND	200	100	200	3.66	
EXT DRO >C28-C35	441	100	01/15/2014	ND					

Surrogate: 1-Chlorooctane 84.1 % 65.2-140

Surrogate: 1-Chlorooctadecane 190 % 63.6-154

Sample ID: 3-5-15' (H400111-11)

TPH 8015M	mg/kg	Analyzed By: ms							
Analyte	Result	Reporting Limit	Analyzed	Method Blank	BS	% Recovery	True Value QC	RPD	Qualifier
GRO C6-C10	<10.0	10.0	01/15/2014	ND	199	99.6	200	3.64	
DRO >C10-C28	131	10.0	01/15/2014	ND	200	100	200	3.66	
EXT DRO >C28-C35	31.2	10.0	01/15/2014	ND					

Surrogate: 1-Chlorooctane 110 % 65.2-140

Surrogate: 1-Chlorooctadecane 120 % 63.6-154

Cardinal Laboratories

* = Accredited Analyte

PLEASE NOTE: Liability and Damages. Cardinal's liability and client's exclusive remedy for any claim arising, whether based in contract or tort, shall be limited to the amount paid by client for analyses. All claims, including those for negligence and any other cause whatsoever shall be deemed waived unless made in writing and received by Cardinal within thirty (30) days after completion of the applicable service. In no event shall Cardinal be liable for incidental or consequential damages, including, without limitation, business interruptions, loss of use, or loss of profits incurred by client, its subsidiaries, affiliates or successors arising out of or related to the performance of the services hereunder by Cardinal, regardless of whether such claim is based upon any of the above stated reasons or otherwise. Results relate only to the samples identified above. This report shall not be reproduced except in full with written approval of Cardinal Laboratories.

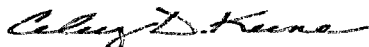

Celey D. Keene, Lab Director/Quality Manager

Analytical Results For:

 LARSON & ASSOCIATES, INC.
 MARK LARSON
 507 N. MARIENFELD, SUITE 200
 MIDLAND TX, 79701
 Fax To: ?

 Received: 01/14/2014
 Reported: 01/21/2014
 Project Name: GRIMES PIT #3
 Project Number: 12-0148-04
 Project Location: LEA COUNTY, NM

 Sampling Date: 01/13/2014
 Sampling Type: Soil
 Sampling Condition: Cool & Intact
 Sample Received By: Jodi Henson

Sample ID: 3-5-20' (H400111-12)

TPH 8015M	mg/kg	Analyzed By: ms							
Analyte	Result	Reporting Limit	Analyzed	Method Blank	BS	% Recovery	True Value QC	RPD	Qualifier
GRO C6-C10	41.2	10.0	01/15/2014	ND	199	99.6	200	3.64	
DRO >C10-C28	412	10.0	01/15/2014	ND	200	100	200	3.66	
EXT DRO >C28-C35	78.4	10.0	01/15/2014	ND					
Surrogate: 1-Chlorooctane	117 %	65.2-140							
Surrogate: 1-Chlorooctadecane	131 %	63.6-154							

Sample ID: 3-5-25' (H400111-13)

TPH 8015M	mg/kg	Analyzed By: ms								S-06
Analyte	Result	Reporting Limit	Analyzed	Method Blank	BS	% Recovery	True Value QC	RPD	Qualifier	
GRO C6-C10	232	100	01/15/2014	ND	199	99.6	200	3.64		
DRO >C10-C28	2520	100	01/15/2014	ND	200	100	200	3.66		
EXT DRO >C28-C35	505	100	01/15/2014	ND						
Surrogate: 1-Chlorooctane	127 %	65.2-140								
Surrogate: 1-Chlorooctadecane	203 %	63.6-154								

Cardinal Laboratories

*=Accredited Analyte

PLEASE NOTE: Liability and Damages. Cardinal's liability and client's exclusive remedy for any claim arising, whether based in contract or tort, shall be limited to the amount paid by client for analyses. All claims, including those for negligence and any other cause whatsoever shall be deemed waived unless made in writing and received by Cardinal within thirty (30) days after completion of the applicable service. In no event shall Cardinal be liable for incidental or consequential damages, including, without limitation, business interruptions, loss of use, or loss of profits incurred by client, its subsidiaries, affiliates or successors arising out of or related to the performance of the services hereunder by Cardinal, regardless of whether such claim is based upon any of the above stated reasons or otherwise. Results relate only to the samples identified above. This report shall not be reproduced except in full with written approval of Cardinal Laboratories.

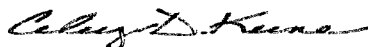

Celey D. Keene, Lab Director/Quality Manager

Analytical Results For:

 LARSON & ASSOCIATES, INC.
 MARK LARSON
 507 N. MARIENFELD, SUITE 200
 MIDLAND TX, 79701
 Fax To: ?

 Received: 01/14/2014
 Reported: 01/21/2014
 Project Name: GRIMES PIT #3
 Project Number: 12-0148-04
 Project Location: LEA COUNTY, NM

 Sampling Date: 01/13/2014
 Sampling Type: Soil
 Sampling Condition: Cool & Intact
 Sample Received By: Jodi Henson

Sample ID: 3-5-30' (H400111-14)

TPH 8015M	mg/kg	Analyzed By: ms					S-06		
Analyte	Result	Reporting Limit	Analyzed	Method Blank	BS	% Recovery	True Value QC	RPD	Qualifier
GRO C6-C10	<100	100	01/15/2014	ND	199	99.6	200	3.64	
DRO >C10-C28	1510	100	01/15/2014	ND	200	100	200	3.66	
EXT DRO >C28-C35	341	100	01/15/2014	ND					
<hr/>									
Surrogate: 1-Chlorooctane	89.5 %	65.2-140							
Surrogate: 1-Chlorooctadecane	176 %	63.6-154							

Sample ID: 3-5-40' (H400111-15)

TPH 8015M	mg/kg	Analyzed By: ms					S-06		
Analyte	Result	Reporting Limit	Analyzed	Method Blank	BS	% Recovery	True Value QC	RPD	Qualifier
GRO C6-C10	<100	100	01/15/2014	ND	199	99.6	200	3.64	
DRO >C10-C28	861	100	01/15/2014	ND	200	100	200	3.66	
EXT DRO >C28-C35	194	100	01/15/2014	ND					
<hr/>									
Surrogate: 1-Chlorooctane	103 %	65.2-140							
Surrogate: 1-Chlorooctadecane	156 %	63.6-154							

Cardinal Laboratories

* = Accredited Analyte

PLEASE NOTE: Liability and Damages. Cardinal's liability and client's exclusive remedy for any claim arising, whether based in contract or tort, shall be limited to the amount paid by client for analyses. All claims, including those for negligence and any other cause whatsoever shall be deemed waived unless made in writing and received by Cardinal within thirty (30) days after completion of the applicable service. In no event shall Cardinal be liable for incidental or consequential damages, including, without limitation, business interruptions, loss of use, or loss of profits incurred by client, its subsidiaries, affiliates or successors arising out of or related to the performance of the services hereunder by Cardinal, regardless of whether such claim is based upon any of the above stated reasons or otherwise. Results relate only to the samples identified above. This report shall not be reproduced except in full with written approval of Cardinal Laboratories.

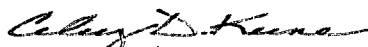

Celey D. Keene, Lab Director/Quality Manager

Analytical Results For:

 LARSON & ASSOCIATES, INC.
 MARK LARSON
 507 N. MARIENFELD, SUITE 200
 MIDLAND TX, 79701
 Fax To: ?

 Received: 01/14/2014
 Reported: 01/21/2014
 Project Name: GRIMES PIT #3
 Project Number: 12-0148-04
 Project Location: LEA COUNTY, NM

 Sampling Date: 01/13/2014
 Sampling Type: Soil
 Sampling Condition: Cool & Intact
 Sample Received By: Jodi Henson

Sample ID: 3-5-50' (H400111-16)

TPH 8015M	mg/kg	Analyzed By: ms						S-06	
Analyte	Result	Reporting Limit	Analyzed	Method Blank	BS	% Recovery	True Value QC	RPD	Qualifier
GRO C6-C10	142	100	01/15/2014	ND	199	99.6	200	3.64	
DRO >C10-C28	2270	100	01/15/2014	ND	200	100	200	3.66	
EXT DRO >C28-C35	425	100	01/15/2014	ND					
<hr/>									
Surrogate: 1-Chlorooctane	110 %	65.2-140							
Surrogate: 1-Chlorooctadecane	193 %	63.6-154							

Sample ID: 3-4-5' (H400111-17)

TPH 8015M	mg/kg	Analyzed By: ms							
Analyte	Result	Reporting Limit	Analyzed	Method Blank	BS	% Recovery	True Value QC	RPD	Qualifier
GRO C6-C10	<10.0	10.0	01/15/2014	ND	199	99.6	200	3.64	
DRO >C10-C28	<10.0	10.0	01/15/2014	ND	200	100	200	3.66	
EXT DRO >C28-C35	<10.0	10.0	01/15/2014	ND					
<hr/>									
Surrogate: 1-Chlorooctane	91.8 %	65.2-140							
Surrogate: 1-Chlorooctadecane	109 %	63.6-154							

Cardinal Laboratories

*=Accredited Analyte

PLEASE NOTE: Liability and Damages. Cardinal's liability and client's exclusive remedy for any claim arising, whether based in contract or tort, shall be limited to the amount paid by client for analyses. All claims, including those for negligence and any other cause whatsoever shall be deemed waived unless made in writing and received by Cardinal within thirty (30) days after completion of the applicable service. In no event shall Cardinal be liable for incidental or consequential damages, including, without limitation, business interruptions, loss of use, or loss of profits incurred by client, its subsidiaries, affiliates or successors arising out of or related to the performance of the services hereunder by Cardinal, regardless of whether such claim is based upon any of the above stated reasons or otherwise. Results relate only to the samples identified above. This report shall not be reproduced except in full with written approval of Cardinal Laboratories.

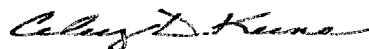

Celey D. Keene, Lab Director/Quality Manager

Analytical Results For:

 LARSON & ASSOCIATES, INC.
 MARK LARSON
 507 N. MARIENFELD, SUITE 200
 MIDLAND TX, 79701
 Fax To: ?

 Received: 01/14/2014
 Reported: 01/21/2014
 Project Name: GRIMES PIT #3
 Project Number: 12-0148-04
 Project Location: LEA COUNTY, NM

 Sampling Date: 01/13/2014
 Sampling Type: Soil
 Sampling Condition: Cool & Intact
 Sample Received By: Jodi Henson

Sample ID: 3-4-10' (H400111-18)

TPH 8015M	mg/kg		Analyzed By: ms						
Analyte	Result	Reporting Limit	Analyzed	Method Blank	BS	% Recovery	True Value QC	RPD	Qualifier
GRO C6-C10	<10.0	10.0	01/15/2014	ND	199	99.6	200	3.64	
DRO >C10-C28	<10.0	10.0	01/15/2014	ND	200	100	200	3.66	
EXT DRO >C28-C35	<10.0	10.0	01/15/2014	ND					
<hr/>									
Surrogate: 1-Chlorooctane	92.0 %	65.2-140							
Surrogate: 1-Chlorooctadecane	109 %	63.6-154							

Sample ID: 3-4-15' (H400111-19)

TPH 8015M	mg/kg		Analyzed By: ms						
Analyte	Result	Reporting Limit	Analyzed	Method Blank	BS	% Recovery	True Value QC	RPD	Qualifier
GRO C6-C10	<10.0	10.0	01/15/2014	ND	199	99.6	200	3.64	
DRO >C10-C28	10.4	10.0	01/15/2014	ND	200	100	200	3.66	
EXT DRO >C28-C35	<10.0	10.0	01/15/2014	ND					
<hr/>									
Surrogate: 1-Chlorooctane	98.6 %	65.2-140							
Surrogate: 1-Chlorooctadecane	113 %	63.6-154							

Cardinal Laboratories

* = Accredited Analyte

PLEASE NOTE: Liability and Damages. Cardinal's liability and client's exclusive remedy for any claim arising, whether based in contract or tort, shall be limited to the amount paid by client for analyses. All claims, including those for negligence and any other cause whatsoever shall be deemed waived unless made in writing and received by Cardinal within thirty (30) days after completion of the applicable service. In no event shall Cardinal be liable for incidental or consequential damages, including, without limitation, business interruptions, loss of use, or loss of profits incurred by client, its subsidiaries, affiliates or successors arising out of or related to the performance of the services hereunder by Cardinal, regardless of whether such claim is based upon any of the above stated reasons or otherwise. Results relate only to the samples identified above. This report shall not be reproduced except in full with written approval of Cardinal Laboratories.

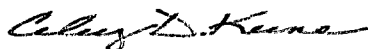

Celey D. Keene, Lab Director/Quality Manager

Analytical Results For:

LARSON & ASSOCIATES, INC.
MARK LARSON
507 N. MARIENFELD, SUITE 200
MIDLAND TX, 79701
Fax To: ? ..

Received: 01/14/2014
Reported: 01/21/2014
Project Name: GRIMES PIT #3
Project Number: 12-0148-04
Project Location: LEA COUNTY, NM

Sampling Date: 01/13/2014
Sampling Type: Soil
Sampling Condition: Cool & Intact
Sample Received By: Jodi Henson

Sample ID: 3-4-20' (H400111-20)

TPH 8015M		mg/kg	Analyzed By: ms						
Analyte	Result	Reporting Limit	Analyzed	Method Blank	BS	% Recovery	True Value QC	RPD	Qualifier
GRO C6-C10	<10.0	10.0	01/15/2014	ND	199	99.6	200	3.64	
DRO >C10-C28	62.6	10.0	01/15/2014	ND	200	100	200	3.66	
EXT DRO >C28-C35	14.7	10.0	01/15/2014	ND					
<hr/>									
Surrogate: 1-Chlorooctane	97.8 %	65.2-140							
Surrogate: 1-Chlorooctadecane	109 %	63.6-154							

Cardinal Laboratories

* = Accredited Analyte

PLEASE NOTE: Liability and Damages. Cardinal's liability and client's exclusive remedy for any claim arising, whether based in contract or tort, shall be limited to the amount paid by client for analyses. All claims, including those for negligence and any other cause whatsoever shall be deemed waived unless made in writing and received by Cardinal within thirty (30) days after completion of the applicable service. In no event shall Cardinal be liable for incidental or consequential damages, including, without limitation, business interruptions, loss of use, or loss of profits incurred by client, its subsidiaries, affiliates or successors arising out of or related to the performance of the services hereunder by Cardinal, regardless of whether such claim is based upon any of the above stated reasons or otherwise. Results relate only to the samples identified above. This report shall not be reproduced except in full with written approval of Cardinal Laboratories.



Celey D. Keene, Lab Director/Quality Manager

Analytical Results For:

 LARSON & ASSOCIATES, INC.
 MARK LARSON
 507 N. MARIENFELD, SUITE 200
 MIDLAND TX, 79701
 Fax To: ?

 Received: 01/14/2014
 Reported: 01/21/2014
 Project Name: GRIMES PIT #3
 Project Number: 12-0148-04
 Project Location: LEA COUNTY, NM

 Sampling Date: 01/13/2014
 Sampling Type: Soil
 Sampling Condition: Cool & Intact
 Sample Received By: Jodi Henson

Sample ID: 3-4-25' (H400111-21)

BTEX 8021B		mg/kg		Analyzed By: MS				S-04	
Analyte	Result	Reporting Limit	Analyzed	Method Blank	BS	% Recovery	True Value QC	RPD	Qualifier
Benzene*	<0.050	0.050	01/15/2014	ND	2.17	108	2.00	1.01	
Toluene*	<0.050	0.050	01/15/2014	ND	2.13	106	2.00	0.607	
Ethylbenzene*	0.429	0.050	01/15/2014	ND	2.15	108	2.00	0.331	
Total Xylenes*	2.03	0.150	01/15/2014	ND	6.38	106	6.00	0.537	
Total BTEX	2.46	0.300	01/15/2014	ND					

Surrogate: 4-Bromofluorobenzene (PIE) 173 % 89.4-126

TPH 8015M		mg/kg		Analyzed By: ms				S-06	
Analyte	Result	Reporting Limit	Analyzed	Method Blank	BS	% Recovery	True Value QC	RPD	Qualifier
GRO C6-C10	107	50.0	01/15/2014	ND	199	99.6	200	3.64	
DRO >C10-C28	2230	50.0	01/15/2014	ND	200	100	200	3.66	
EXT DRO >C28-C35	412	50.0	01/15/2014	ND					

Surrogate: 1-Chlorooctane 136 % 65.2-140

Surrogate: 1-Chlorooctadecane 164 % 63.6-154

Cardinal Laboratories

*=Accredited Analyte

PLEASE NOTE: Liability and Damages. Cardinal's liability and client's exclusive remedy for any claim arising, whether based in contract or tort, shall be limited to the amount paid by client for analyses. All claims, including those for negligence and any other cause whatsoever shall be deemed waived unless made in writing and received by Cardinal within thirty (30) days after completion of the applicable service. In no event shall Cardinal be liable for incidental or consequential damages, including, without limitation, business interruptions, loss of use, or loss of profits incurred by client, its subsidiaries, affiliates or successors arising out of or related to the performance of the services hereunder by Cardinal, regardless of whether such claim is based upon any of the above stated reasons or otherwise. Results relate only to the samples identified above. This report shall not be reproduced except in full with written approval of Cardinal Laboratories.



Celey D. Keene, Lab Director/Quality Manager

Analytical Results For:

 LARSON & ASSOCIATES, INC.
 MARK LARSON
 507 N. MARIENFELD, SUITE 200
 MIDLAND TX, 79701
 Fax To: ?

 Received: 01/14/2014
 Reported: 01/21/2014
 Project Name: GRIMES PIT #3
 Project Number: 12-0148-04
 Project Location: LEA COUNTY, NM

 Sampling Date: 01/13/2014
 Sampling Type: Soil
 Sampling Condition: Cool & Intact
 Sample Received By: Jodi Henson

Sample ID: 3-4-30' (H400111-22)

TPH 8015M	mg/kg		Analyzed By: ms						
Analyte	Result	Reporting Limit	Analyzed	Method Blank	BS	% Recovery	True Value QC	RPD	Qualifier
GRO C6-C10	<50.0	50.0	01/15/2014	ND	199	99.6	200	3.64	
DRO >C10-C28	1430	50.0	01/15/2014	ND	200	100	200	3.66	
EXT DRO >C28-C35	292	50.0	01/15/2014	ND					
<hr/>									
Surrogate: 1-Chlorooctane	98.6 %	65.2-140							
Surrogate: 1-Chlorooctadecane	135 %	63.6-154							

Sample ID: 3-4-40' (H400111-23)

TPH 8015M	mg/kg		Analyzed By: ms					S-06	
Analyte	Result	Reporting Limit	Analyzed	Method Blank	BS	% Recovery	True Value QC	RPD	Qualifier
GRO C6-C10	<50.0	50.0	01/15/2014	ND	199	99.6	200	3.64	
DRO >C10-C28	1560	50.0	01/15/2014	ND	200	100	200	3.66	
EXT DRO >C28-C35	315	50.0	01/15/2014	ND					
Surrogate: 1-Chlorooctane	208 %	65.2-140							
Surrogate: 1-Chlorooctadecane	285 %	63.6-154							

Cardinal Laboratories

*=Accredited Analyte

PLEASE NOTE: Liability and Damages. Cardinal's liability and client's exclusive remedy for any claim arising, whether based in contract or tort, shall be limited to the amount paid by client for analyses. All claims, including those for negligence and any other cause whatsoever shall be deemed waived unless made in writing and received by Cardinal within thirty (30) days after completion of the applicable service. In no event shall Cardinal be liable for incidental or consequential damages, including, without limitation, business interruptions, loss of use, or loss of profits incurred by client, its subsidiaries, affiliates or successors arising out of or related to the performance of the services hereunder by Cardinal, regardless of whether such claim is based upon any of the above stated reasons or otherwise. Results relate only to the samples identified above. This report shall not be reproduced except in full with written approval of Cardinal Laboratories.



Celey D. Keene, Lab Director/Quality Manager

Analytical Results For:

 LARSON & ASSOCIATES, INC.
 MARK LARSON
 507 N. MARIENFELD, SUITE 200
 MIDLAND TX, 79701
 Fax To: ?

 Received: 01/14/2014
 Reported: 01/21/2014
 Project Name: GRIMES PIT #3
 Project Number: 12-0148-04
 Project Location: LEA COUNTY, NM

 Sampling Date: 01/13/2014
 Sampling Type: Soil
 Sampling Condition: Cool & Intact
 Sample Received By: Jodi Henson

Sample ID: 3-4-50' (H400111-24)

TPH 8015M	mg/kg		Analyzed By: ms						
Analyte	Result	Reporting Limit	Analyzed	Method Blank	BS	% Recovery	True Value QC	RPD	Qualifier
GRO C6-C10	56.9	50.0	01/15/2014	ND	173	86.4	200	4.86	
DRO >C10-C28	888	50.0	01/15/2014	ND	174	87.1	200	3.26	
EXT DRO >C28-C35	144	50.0	01/15/2014	ND					
Surrogate: 1-Chlorooctane	73.7 %	65.2-140							
Surrogate: 1-Chlorooctadecane	122 %	63.6-154							

Cardinal Laboratories

* = Accredited Analyte

PLEASE NOTE: Liability and Damages. Cardinal's liability and client's exclusive remedy for any claim arising, whether based in contract or tort, shall be limited to the amount paid by client for analyses. All claims, including those for negligence and any other cause whatsoever shall be deemed waived unless made in writing and received by Cardinal within thirty (30) days after completion of the applicable service. In no event shall Cardinal be liable for incidental or consequential damages, including, without limitation, business interruptions, loss of use, or loss of profits incurred by client, its subsidiaries, affiliates or successors arising out of or related to the performance of the services hereunder by Cardinal, regardless of whether such claim is based upon any of the above stated reasons or otherwise. Results relate only to the samples identified above. This report shall not be reproduced except in full with written approval of Cardinal Laboratories.

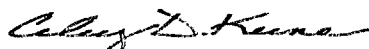

Celey D. Keene, Lab Director/Quality Manager

Notes and Definitions

S-06	The recovery of this surrogate is outside control limits due to sample dilution required from high analyte concentration and/or matrix interference's.
S-04	The surrogate recovery for this sample is outside of established control limits due to a sample matrix effect.
ND	Analyte NOT DETECTED at or above the reporting limit
RPD	Relative Percent Difference
**	Samples not received at proper temperature of 6°C or below.
***	Insufficient time to reach temperature.
-	Chloride by SM4500Cl-B does not require samples be received at or below 6°C Samples reported on an as received basis (wet) unless otherwise noted on report

Cardinal Laboratories

*=Accredited Analyte

PLEASE NOTE: Liability and Damages. Cardinal's liability and client's exclusive remedy for any claim arising, whether based in contract or tort, shall be limited to the amount paid by client for analyses. All claims, including those for negligence and any other cause whatsoever shall be deemed waived unless made in writing and received by Cardinal within thirty (30) days after completion of the applicable service. In no event shall Cardinal be liable for incidental or consequential damages, including, without limitation, business interruptions, loss of use, or loss of profits incurred by client, its subsidiaries, affiliates or successors arising out of or related to the performance of the services hereunder by Cardinal, regardless of whether such claim is based upon any of the above stated reasons or otherwise. Results relate only to the samples identified above. This report shall not be reproduced except in full with written approval of Cardinal Laboratories.

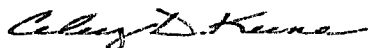

Celey D. Keene, Lab Director/Quality Manager

DATE: 1/14/19 PAGE 1 OF 1
PO #: _____ LAB WORK ORDER #: H400111
PROJECT LOCATION OR NAME: Grimes Pit #3
LAI PROJECT #: 12-0148-04 COLLECTOR: ANJ

[illegible]

TOTAL

☒ HAND DELIVERED

Page 10 of 10

DATE: 1/14/19 PAGE 2 OF 2
PO #: LAB WORK ORDER #: H400111
PROJECT LOCATION OR NAME: Grimes Pit #3
LAI PROJECT #: 12-0148-04 COLLECTOR: ANJ

[illegible][illegible]



PHONE (575) 393-2326 • 101 E. MARLAND • HOBBS, NM 88240

January 21, 2014

MARK LARSON

LARSON & ASSOCIATES, INC.

507 N. MARIENFELD, SUITE 200

MIDLAND, TX 79701

RE: GRIMES PIT #3

Enclosed are the results of analyses for samples received by the laboratory on 01/14/14 12:35.

Cardinal Laboratories is accredited through Texas NELAP under certificate number T104704398-13-5. Accreditation applies to drinking water, non-potable water and solid and chemical materials. All accredited analytes are denoted by an asterisk (*). For a complete list of accredited analytes and matrices visit the TCEQ website at www.tceq.texas.gov/field/ga/lab_accred_certif.html.

Cardinal Laboratories is accredited through the State of Colorado Department of Public Health and Environment for:

Method EPA 552.2	Haloacetic Acids (HAA-5)
Method EPA 524.2	Total Trihalomethanes (TTHM)
Method EPA 524.4	Regulated VOCs (V1, V2, V3)

Accreditation applies to public drinking water matrices.

This report meets NELAP requirements and is made up of a cover page, analytical results, and a copy of the original chain-of-custody. If you have any questions concerning this report, please feel free to contact me.

Sincerely,

A handwritten signature in black ink that reads "Celey D. Keene". The signature is written in a cursive, flowing style.

Celey D. Keene

Lab Director/Quality Manager

Analytical Results For:

 LARSON & ASSOCIATES, INC.
 MARK LARSON
 507 N. MARIENFELD, SUITE 200
 MIDLAND TX, 79701
 Fax To: ?

 Received: 01/14/2014
 Reported: 01/21/2014
 Project Name: GRIMES PIT #3
 Project Number: 12-0148-04
 Project Location: LEA COUNTY, NM

 Sampling Date: 01/14/2014
 Sampling Type: Soil
 Sampling Condition: Cool & Intact
 Sample Received By: Jodi Henson

Sample ID: 3-2-5' (H400114-01)

TPH 8015M	mg/kg	Analyzed By: ms							
Analyte	Result	Reporting Limit	Analyzed	Method Blank	BS	% Recovery	True Value QC	RPD	Qualifier
GRO C6-C10	23.3	10.0	01/15/2014	ND	173	86.4	200	4.86	
DRO >C10-C28	383	10.0	01/15/2014	ND	174	87.1	200	3.26	
EXT DRO >C28-C35	75.1	10.0	01/15/2014	ND					

Surrogate: 1-Chlorooctane 92.4 % 65.2-140

Surrogate: 1-Chlorooctadecane 115 % 63.6-154

Sample ID: 3-2-10' (H400114-02)

TPH 8015M	mg/kg	Analyzed By: ms							
Analyte	Result	Reporting Limit	Analyzed	Method Blank	BS	% Recovery	True Value QC	RPD	Qualifier
GRO C6-C10	36.2	10.0	01/15/2014	ND	173	86.4	200	4.86	
DRO >C10-C28	476	10.0	01/15/2014	ND	174	87.1	200	3.26	
EXT DRO >C28-C35	93.5	10.0	01/15/2014	ND					

Surrogate: 1-Chlorooctane 88.8 % 65.2-140

Surrogate: 1-Chlorooctadecane 111 % 63.6-154

Cardinal Laboratories

* = Accredited Analyte

PLEASE NOTE: Liability and Damages. Cardinal's liability and client's exclusive remedy for any claim arising, whether based in contract or tort, shall be limited to the amount paid by client for analyses. All claims, including those for negligence and any other cause whatsoever shall be deemed waived unless made in writing and received by Cardinal within thirty (30) days after completion of the applicable service. In no event shall Cardinal be liable for incidental or consequential damages, including, without limitation, business interruptions, loss of use, or loss of profits incurred by client, its subsidiaries, affiliates or successors arising out of or related to the performance of the services hereunder by Cardinal, regardless of whether such claim is based upon any of the above stated reasons or otherwise. Results relate only to the samples identified above. This report shall not be reproduced except in full with written approval of Cardinal Laboratories.

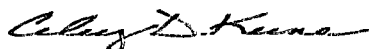

Celey D. Keene, Lab Director/Quality Manager

Analytical Results For:

LARSON & ASSOCIATES, INC.
MARK LARSON
507 N. MARIENFELD, SUITE 200
MIDLAND TX, 79701
Fax To: ?

Received: 01/14/2014
Reported: 01/21/2014
Project Name: GRIMES PIT #3
Project Number: 12-0148-04
Project Location: LEA COUNTY, NM

Sampling Date: 01/14/2014
Sampling Type: Soil
Sampling Condition: Cool & Intact
Sample Received By: Jodi Henson

Sample ID: 3-2-15' (H400114-03)

TPH 8015M	mg/kg	Analyzed By: ms							
Analyte	Result	Reporting Limit	Analyzed	Method Blank	BS	% Recovery	True Value QC	RPD	Qualifier
GRO C6-C10	<10.0	10.0	01/15/2014	ND	173	86.4	200	4.86	
DRO >C10-C28	99.0	10.0	01/15/2014	ND	174	87.1	200	3.26	
EXT DRO >C28-C35	25.3	10.0	01/15/2014	ND					
<hr/>									
Surrogate: 1-Chlorooctane	112 %	65.2-140							
Surrogate: 1-Chlorooctadecane	132 %	63.6-154							

Sample ID: 3-2-20' (H400114-04)

TPH 8015M	mg/kg	Analyzed By: ms							
Analyte	Result	Reporting Limit	Analyzed	Method Blank	BS	% Recovery	True Value QC	RPD	Qualifier
GRO C6-C10	<10.0	10.0	01/15/2014	ND	173	86.4	200	4.86	
DRO >C10-C28	103	10.0	01/15/2014	ND	174	87.1	200	3.26	
EXT DRO >C28-C35	23.4	10.0	01/15/2014	ND					
<hr/>									
Surrogate: 1-Chlorooctane	99.9 %	65.2-140							
Surrogate: 1-Chlorooctadecane	112 %	63.6-154							

Cardinal Laboratories

*=Accredited Analyte

PLEASE NOTE: Liability and Damages. Cardinal's liability and client's exclusive remedy for any claim arising, whether based in contract or tort, shall be limited to the amount paid by client for analyses. All claims, including those for negligence and any other cause whatsoever shall be deemed waived unless made in writing and received by Cardinal within thirty (30) days after completion of the applicable service. In no event shall Cardinal be liable for incidental or consequential damages, including, without limitation, business interruptions, loss of use, or loss of profits incurred by client, its subsidiaries, affiliates or successors arising out of or related to the performance of the services hereunder by Cardinal, regardless of whether such claim is based upon any of the above stated reasons or otherwise. Results relate only to the samples identified above. This report shall not be reproduced except in full with written approval of Cardinal Laboratories.



Celey D. Keene, Lab Director/Quality Manager

Analytical Results For:

LARSON & ASSOCIATES, INC.
MARK LARSON
507 N. MARIENFELD, SUITE 200
MIDLAND TX, 79701
Fax To: ?

Received: 01/14/2014
Reported: 01/21/2014
Project Name: GRIMES PIT #3
Project Number: 12-0148-04
Project Location: LEA COUNTY, NM

Sampling Date: 01/14/2014
Sampling Type: Soil
Sampling Condition: Cool & Intact
Sample Received By: Jodi Henson

Sample ID: 3-2-25' (H400114-05)

BTEX 8021B		mg/kg	Analyzed By: MS				S-04		
Analyte	Result	Reporting Limit	Analyzed	Method Blank	BS	% Recovery	True Value QC	RPD	Qualifier
Benzene*	<0.100	0.100	01/15/2014	ND	2.17	108	2.00	1.01	
Toluene*	0.137	0.100	01/15/2014	ND	2.13	106	2.00	0.607	
Ethylbenzene*	1.34	0.100	01/15/2014	ND	2.15	108	2.00	0.331	
Total Xylenes*	6.36	0.300	01/15/2014	ND	6.38	106	6.00	0.537	
Total BTEX	7.83	0.600	01/15/2014	ND					

Surrogate: 4-Bromofluorobenzene (PIC) 175 % 89.4-126

TPH 8015M		mg/kg	Analyzed By: ms						
Analyte	Result	Reporting Limit	Analyzed	Method Blank	BS	% Recovery	True Value QC	RPD	Qualifier
GRO C6-C10	152	50.0	01/15/2014	ND	173	86.4	200	4.86	
DRO >C10-C28	1280	50.0	01/15/2014	ND	174	87.1	200	3.26	
EXT DRO >C28-C35	234	50.0	01/15/2014	ND					

Surrogate: 1-Chlorooctane 97.2 % 65.2-140

Surrogate: 1-Chlorooctadecane 150 % 63.6-154

Cardinal Laboratories

*=Accredited Analyte

PLEASE NOTE: Liability and Damages. Cardinal's liability and client's exclusive remedy for any claim arising, whether based in contract or tort, shall be limited to the amount paid by client for analyses. All claims, including those for negligence and any other cause whatsoever shall be deemed waived unless made in writing and received by Cardinal within thirty (30) days after completion of the applicable service. In no event shall Cardinal be liable for incidental or consequential damages, including, without limitation, business interruptions, loss of use, or loss of profits incurred by client, its subsidiaries, affiliates or successors arising out of or related to the performance of the services hereunder by Cardinal, regardless of whether such claim is based upon any of the above stated reasons or otherwise. Results relate only to the samples identified above. This report shall not be reproduced except in full with written approval of Cardinal Laboratories.



Celey D. Keene, Lab Director/Quality Manager

Analytical Results For:

LARSON & ASSOCIATES, INC.
MARK LARSON
507 N. MARIENFELD, SUITE 200
MIDLAND TX, 79701
Fax To: ?

Received: 01/14/2014
Reported: 01/21/2014
Project Name: GRIMES PIT #3
Project Number: 12-0148-04
Project Location: LEA COUNTY, NM

Sampling Date: 01/14/2014
Sampling Type: Soil
Sampling Condition: Cool & Intact
Sample Received By: Jodi Henson

Sample ID: 3-2-30' (H400114-06)

TPH 8015M	mg/kg	Analyzed By: ms							
Analyte	Result	Reporting Limit	Analyzed	Method Blank	BS	% Recovery	True Value QC	RPD	Qualifier
GRO C6-C10	68.6	50.0	01/15/2014	ND	173	86.4	200	4.86	
DRO >C10-C28	976	50.0	01/15/2014	ND	174	87.1	200	3.26	
EXT DRO >C28-C35	196	50.0	01/15/2014	ND					
Surrogate: 1-Chlorooctane	116 %	65.2-140							
Surrogate: 1-Chlorooctadecane	146 %	63.6-154							

Sample ID: 3-2-40' (H400114-07)

TPH 8015M	mg/kg	Analyzed By: ms							
Analyte	Result	Reporting Limit	Analyzed	Method Blank	BS	% Recovery	True Value QC	RPD	Qualifier
GRO C6-C10	<50.0	50.0	01/15/2014	ND	173	86.4	200	4.86	
DRO >C10-C28	795	50.0	01/15/2014	ND	174	87.1	200	3.26	
EXT DRO >C28-C35	160	50.0	01/15/2014	ND					
Surrogate: 1-Chlorooctane	81.7 %	65.2-140							
Surrogate: 1-Chlorooctadecane	138 %	63.6-154							

Cardinal Laboratories

*=Accredited Analyte

PLEASE NOTE: Liability and Damages. Cardinal's liability and client's exclusive remedy for any claim arising, whether based in contract or tort, shall be limited to the amount paid by client for analyses. All claims, including those for negligence and any other cause whatsoever shall be deemed waived unless made in writing and received by Cardinal within thirty (30) days after completion of the applicable service. In no event shall Cardinal be liable for incidental or consequential damages, including, without limitation, business interruptions, loss of use, or loss of profits incurred by client, its subsidiaries, affiliates or successors arising out of or related to the performance of the services hereunder by Cardinal, regardless of whether such claim is based upon any of the above stated reasons or otherwise. Results relate only to the samples identified above. This report shall not be reproduced except in full with written approval of Cardinal Laboratories.

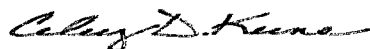

Celey D. Keene, Lab Director/Quality Manager

Analytical Results For:

 LARSON & ASSOCIATES, INC.
 MARK LARSON
 507 N. MARIENFELD, SUITE 200
 MIDLAND TX, 79701
 Fax To: ?

 Received: 01/14/2014
 Reported: 01/21/2014
 Project Name: GRIMES PIT #3
 Project Number: 12-0148-04
 Project Location: LEA COUNTY, NM

 Sampling Date: 01/14/2014
 Sampling Type: Soil
 Sampling Condition: Cool & Intact
 Sample Received By: Jodi Henson

Sample ID: 3-2-50' (H400114-08)

TPH 8015M	mg/kg	Analyzed By: ms					S-06		
Analyte	Result	Reporting Limit	Analyzed	Method Blank	BS	% Recovery	True Value QC	RPD	Qualifier
GRO C6-C10	75.9	50.0	01/15/2014	ND	173	86.4	200	4.86	
DRO >C10-C28	1280	50.0	01/15/2014	ND	174	87.1	200	3.26	
EXT DRO >C28-C35	220	50.0	01/15/2014	ND					
<hr/>									
Surrogate: 1-Chlorooctane	105 %	65.2-140							
Surrogate: 1-Chlorooctadecane	162 %	63.6-154							

Sample ID: 3-3-5' (H400114-09)

TPH 8015M	mg/kg	Analyzed By: ms							
Analyte	Result	Reporting Limit	Analyzed	Method Blank	BS	% Recovery	True Value QC	RPD	Qualifier
GRO C6-C10	<10.0	10.0	01/15/2014	ND	173	86.4	200	4.86	
DRO >C10-C28	<10.0	10.0	01/15/2014	ND	174	87.1	200	3.26	
EXT DRO >C28-C35	<10.0	10.0	01/15/2014	ND					
<hr/>									
Surrogate: 1-Chlorooctane	101 %	65.2-140							
Surrogate: 1-Chlorooctadecane	122 %	63.6-154							

Cardinal Laboratories

*=Accredited Analyte

PLEASE NOTE: Liability and Damages. Cardinal's liability and client's exclusive remedy for any claim arising, whether based in contract or tort, shall be limited to the amount paid by client for analyses. All claims, including those for negligence and any other cause whatsoever shall be deemed waived unless made in writing and received by Cardinal within thirty (30) days after completion of the applicable service. In no event shall Cardinal be liable for incidental or consequential damages, including, without limitation, business interruptions, loss of use, or loss of profits incurred by client, its subsidiaries, affiliates or successors arising out of or related to the performance of the services hereunder by Cardinal, regardless of whether such claim is based upon any of the above stated reasons or otherwise. Results relate only to the samples identified above. This report shall not be reproduced except in full with written approval of Cardinal Laboratories.



Celey D. Keene, Lab Director/Quality Manager

Analytical Results For:

LARSON & ASSOCIATES, INC.
MARK LARSON
507 N. MARIENFELD, SUITE 200
MIDLAND TX, 79701
Fax To: ?

Received: 01/14/2014
Reported: 01/21/2014
Project Name: GRIMES PIT #3
Project Number: 12-0148-04
Project Location: LEA COUNTY, NM

Sampling Date: 01/14/2014
Sampling Type: Soil
Sampling Condition: Cool & Intact
Sample Received By: Jodi Henson

Sample ID: 3-3-10' (H400114-10)

TPH 8015M	mg/kg	Analyzed By: ms							
Analyte	Result	Reporting Limit	Analyzed	Method Blank	BS	% Recovery	True Value QC	RPD	Qualifier
GRO C6-C10	<10.0	10.0	01/15/2014	ND	173	86.4	200	4.86	
DRO >C10-C28	<10.0	10.0	01/15/2014	ND	174	87.1	200	3.26	
EXT DRO >C28-C35	<10.0	10.0	01/15/2014	ND					
<hr/>									
Surrogate: 1-Chlorooctane	73.2 %	65.2-140							
Surrogate: 1-Chlorooctadecane	91.1 %	63.6-154							

Sample ID: 3-3-15' (H400114-11)

TPH 8015M	mg/kg	Analyzed By: ms							
Analyte	Result	Reporting Limit	Analyzed	Method Blank	BS	% Recovery	True Value QC	RPD	Qualifier
GRO C6-C10	<10.0	10.0	01/15/2014	ND	173	86.4	200	4.86	
DRO >C10-C28	<10.0	10.0	01/15/2014	ND	174	87.1	200	3.26	
EXT DRO >C28-C35	<10.0	10.0	01/15/2014	ND					
<hr/>									
Surrogate: 1-Chlorooctane	85.9 %	65.2-140							
Surrogate: 1-Chlorooctadecane	107 %	63.6-154							

Cardinal Laboratories

*=Accredited Analyte

PLEASE NOTE: Liability and Damages. Cardinal's liability and client's exclusive remedy for any claim arising, whether based in contract or tort, shall be limited to the amount paid by client for analyses. All claims, including those for negligence and any other cause whatsoever shall be deemed waived unless made in writing and received by Cardinal within thirty (30) days after completion of the applicable service. In no event shall Cardinal be liable for incidental or consequential damages, including, without limitation, business interruptions, loss of use, or loss of profits incurred by client, its subsidiaries, affiliates or successors arising out of or related to the performance of the services hereunder by Cardinal, regardless of whether such claim is based upon any of the above stated reasons or otherwise. Results relate only to the samples identified above. This report shall not be reproduced except in full with written approval of Cardinal Laboratories.



Celey D. Keene, Lab Director/Quality Manager

Analytical Results For:

LARSON & ASSOCIATES, INC.
MARK LARSON
507 N. MARIENFELD, SUITE 200
MIDLAND TX, 79701
Fax To: ?

Received: 01/14/2014
Reported: 01/21/2014
Project Name: GRIMES PIT #3
Project Number: 12-0148-04
Project Location: LEA COUNTY, NM

Sampling Date: 01/14/2014
Sampling Type: Soil
Sampling Condition: Cool & Intact
Sample Received By: Jodi Henson

Sample ID: 3-3-20' (H400114-12)

TPH 8015M		mg/kg		Analyzed By: ms					
Analyte	Result	Reporting Limit	Analyzed	Method Blank	BS	% Recovery	True Value QC	RPD	Qualifier
GRO C6-C10	<10.0	10.0	01/15/2014	ND	173	86.4	200	4.86	
DRO >C10-C28	28.9	10.0	01/15/2014	ND	174	87.1	200	3.26	
EXT DRO >C28-C35	<10.0	10.0	01/15/2014	ND					
<hr/>									
Surrogate: 1-Chlorooctane	99.1 %	65.2-140							
Surrogate: 1-Chlorooctadecane	108 %	63.6-154							

Cardinal Laboratories

* = Accredited Analyte

PLEASE NOTE: Liability and Damages. Cardinal's liability and client's exclusive remedy for any claim arising, whether based in contract or tort, shall be limited to the amount paid by client for analyses. All claims, including those for negligence and any other cause whatsoever shall be deemed waived unless made in writing and received by Cardinal within thirty (30) days after completion of the applicable service. In no event shall Cardinal be liable for incidental or consequential damages, including, without limitation, business interruptions, loss of use, or loss of profits incurred by client, its subsidiaries, affiliates or successors arising out of or related to the performance of the services hereunder by Cardinal, regardless of whether such claim is based upon any of the above stated reasons or otherwise. Results relate only to the samples identified above. This report shall not be reproduced except in full with written approval of Cardinal Laboratories.

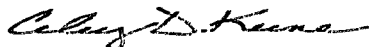

Celey D. Keene, Lab Director/Quality Manager

Analytical Results For:

LARSON & ASSOCIATES, INC.
MARK LARSON
507 N. MARIENFELD, SUITE 200
MIDLAND TX, 79701
Fax To: ?

Received: 01/14/2014
Reported: 01/21/2014
Project Name: GRIMES PIT #3
Project Number: 12-0148-04
Project Location: LEA COUNTY, NM

Sampling Date: 01/14/2014
Sampling Type: Soil
Sampling Condition: Cool & Intact
Sample Received By: Jodi Henson

Sample ID: 3-3-25' (H400114-13)

BTEX 80218		mg/kg	Analyzed By: MS				S-04		
Analyte	Result	Reporting Limit	Analyzed	Method Blank	BS	% Recovery	True Value QC	RPD	Qualifier
Benzene*	<0.200	0.200	01/15/2014	ND	2.17	108	2.00	1.01	
Toluene*	<0.200	0.200	01/15/2014	ND	2.13	106	2.00	0.607	
Ethylbenzene*	1.20	0.200	01/15/2014	ND	2.15	108	2.00	0.331	
Total Xylenes*	1.75	0.600	01/15/2014	ND	6.38	106	6.00	0.537	
Total BTEX	2.95	1.20	01/15/2014	ND					

Surrogate: 4-Bromofluorobenzene (PIL) 173 % 89.4-126

TPH 8015M		mg/kg	Analyzed By: ms				S-06		
Analyte	Result	Reporting Limit	Analyzed	Method Blank	BS	% Recovery	True Value QC	RPD	Qualifier
GRO C6-C10	124	50.0	01/15/2014	ND	173	86.4	200	4.86	
DRO >C10-C28	1220	50.0	01/15/2014	ND	174	87.1	200	3.26	
EXT DRO >C28-C35	234	50.0	01/15/2014	ND					

Surrogate: 1-Chlorooctane 105 % 65.2-140

Surrogate: 1-Chlorooctadecane 162 % 63.6-154

Cardinal Laboratories

*=Accredited Analyte

PLEASE NOTE: Liability and Damages. Cardinal's liability and client's exclusive remedy for any claim arising, whether based in contract or tort, shall be limited to the amount paid by client for analyses. All claims, including those for negligence and any other cause whatsoever shall be deemed waived unless made in writing and received by Cardinal within thirty (30) days after completion of the applicable service. In no event shall Cardinal be liable for incidental or consequential damages, including, without limitation, business interruptions, loss of use, or loss of profits incurred by client, its subsidiaries, affiliates or successors arising out of or related to the performance of the services hereunder by Cardinal, regardless of whether such claim is based upon any of the above stated reasons or otherwise. Results relate only to the samples identified above. This report shall not be reproduced except in full with written approval of Cardinal Laboratories.



Celey D. Keene, Lab Director/Quality Manager

Analytical Results For:

 LARSON & ASSOCIATES, INC.
 MARK LARSON
 507 N. MARIENFELD, SUITE 200
 MIDLAND TX, 79701
 Fax To: ?

 Received: 01/14/2014
 Reported: 01/21/2014
 Project Name: GRIMES PIT #3
 Project Number: 12-0148-04
 Project Location: LEA COUNTY, NM

 Sampling Date: 01/14/2014
 Sampling Type: Soil
 Sampling Condition: Cool & Intact
 Sample Received By: Jodi Henson

Sample ID: 3-3-30' (H400114-14)

TPH 8015M	mg/kg		Analyzed By: ms					S-06	
Analyte	Result	Reporting Limit	Analyzed	Method Blank	BS	% Recovery	True Value QC	RPD	Qualifier
GRO C6-C10	50.6	50.0	01/15/2014	ND	173	86.4	200	4.86	
DRO >C10-C28	850	50.0	01/15/2014	ND	174	87.1	200	3.26	
EXT DRO >C28-C35	165	50.0	01/15/2014	ND					
Surrogate: 1-Chlorooctane	101 %	65.2-140							
Surrogate: 1-Chlorooctadecane	159 %	63.6-154							

Sample ID: 3-3-40' (H400114-15)

TPH 8015M	mg/kg		Analyzed By: ms					S-06	
Analyte	Result	Reporting Limit	Analyzed	Method Blank	BS	% Recovery	True Value QC	RPD	Qualifier
GRO C6-C10	66.2	50.0	01/15/2014	ND	173	86.4	200	4.86	
DRO >C10-C28	1390	50.0	01/15/2014	ND	174	87.1	200	3.26	
EXT DRO >C28-C35	259	50.0	01/15/2014	ND					
Surrogate: 1-Chlorooctane	97.9 %	65.2-140							
Surrogate: 1-Chlorooctadecane	158 %	63.6-154							

Cardinal Laboratories

* = Accredited Analyte

PLEASE NOTE: Liability and Damages. Cardinal's liability and client's exclusive remedy for any claim arising, whether based in contract or tort, shall be limited to the amount paid by client for analyses. All claims, including those for negligence and any other cause whatsoever shall be deemed waived unless made in writing and received by Cardinal within thirty (30) days after completion of the applicable service. In no event shall Cardinal be liable for incidental or consequential damages, including, without limitation, business interruptions, loss of use, or loss of profits incurred by client, its subsidiaries, affiliates or successors arising out of or related to the performance of the services hereunder by Cardinal, regardless of whether such claim is based upon any of the above stated reasons or otherwise. Results relate only to the samples identified above. This report shall not be reproduced except in full with written approval of Cardinal Laboratories.

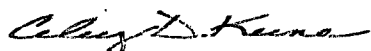

Celey D. Keene, Lab Director/Quality Manager

Analytical Results For:

LARSON & ASSOCIATES, INC.
MARK LARSON
507 N. MARIENFELD, SUITE 200
MIDLAND TX, 79701
Fax To: ?

Received: 01/14/2014
Reported: 01/21/2014
Project Name: GRIMES PIT #3
Project Number: 12-0148-04
Project Location: LEA COUNTY, NM

Sampling Date: 01/14/2014
Sampling Type: Soil
Sampling Condition: Cool & Intact
Sample Received By: Jodi Henson

Sample ID: 3-3-50' (H400114-16)

TPH 8015M	mg/kg	Analyzed By: ms						S-06	
Analyte	Result	Reporting Limit	Analyzed	Method Blank	BS	% Recovery	True Value QC	RPD	Qualifier
GRO C6-C10	94.8	50.0	01/15/2014	ND	173	86.4	200	4.86	
DRO >C10-C28	1540	50.0	01/15/2014	ND	174	87.1	200	3.26	
EXT DRO >C28-C35	287	50.0	01/15/2014	ND					
Surrogate: 1-Chlorooctane	93.5 %	65.2-140							
Surrogate: 1-Chlorooctadecane	155 %	63.6-154							

Cardinal Laboratories

*=Accredited Analyte

PLEASE NOTE: Liability and Damages. Cardinal's liability and client's exclusive remedy for any claim arising, whether based in contract or tort, shall be limited to the amount paid by client for analyses. All claims, including those for negligence and any other cause whatsoever shall be deemed waived unless made in writing and received by Cardinal within thirty (30) days after completion of the applicable service. In no event shall Cardinal be liable for incidental or consequential damages, including, without limitation, business interruptions, loss of use, or loss of profits incurred by client, its subsidiaries, affiliates or successors arising out of or related to the performance of the services hereunder by Cardinal, regardless of whether such claim is based upon any of the above stated reasons or otherwise. Results relate only to the samples identified above. This report shall not be reproduced except in full with written approval of Cardinal Laboratories.



Celey D. Keene, Lab Director/Quality Manager

Notes and Definitions

S-06	The recovery of this surrogate is outside control limits due to sample dilution required from high analyte concentration and/or matrix interference's.
S-04	The surrogate recovery for this sample is outside of established control limits due to a sample matrix effect.
ND	Analyte NOT DETECTED at or above the reporting limit
RPD	Relative Percent Difference
**	Samples not received at proper temperature of 6°C or below.
***	Insufficient time to reach temperature.
-	Chloride by SM4500Cl-B does not require samples be received at or below 6°C Samples reported on an as received basis (wet) unless otherwise noted on report

Cardinal Laboratories

*=Accredited Analyte

PLEASE NOTE: Liability and Damages. Cardinal's liability and client's exclusive remedy for any claim arising, whether based in contract or tort, shall be limited to the amount paid by client for analyses. All claims, including those for negligence and any other cause whatsoever shall be deemed waived unless made in writing and received by Cardinal within thirty (30) days after completion of the applicable service. In no event shall Cardinal be liable for incidental or consequential damages, including, without limitation, business interruptions, loss of use, or loss of profits incurred by client, its subsidiaries, affiliates or successors arising out of or related to the performance of the services hereunder by Cardinal, regardless of whether such claim is based upon any of the above stated reasons or otherwise. Results relate only to the samples identified above. This report shall not be reproduced except in full with written approval of Cardinal Laboratories.

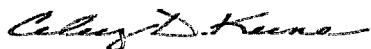

Celey D. Keene, Lab Director/Quality Manager

Page 13 of 14

DATE: 1/14/14 PAGE 1 OF 3
PO #: _____ LAB WORK ORDER #: H400114
PROJECT LOCATION OR NAME: Grines Pit #3
LAI PROJECT #: 12-048-04 COLLECTOR: BNJ

[illegible]

☒ HAND DELIVERED

Page 14 of 14

507 N. Marienfeld, Ste. 200
Midland, TX 79701
432-687-0901

DATE: 1/14/14 PAGE 2 OF 2

PO #: 11 LAB WORK ORDER #: H400114

PROJECT LOCATION OR NAME: Grimes Pit #3

LAI PROJECT #: 12-0149-04 COLLECTOR: AN

Data Reported to:

[illegible]

TOTAL

RELINQUISHED BY: (Signature)

DATE/TIME

RECEIVED BY: (Signature)

RELINQUISHED BY: (Signature)

DATE/TIME

RECEIVED BY: (Signature)

RELINQUISHED BY: (Signature)

DATE/TIME

RECEIVED BY: (Signature)

TURN AROUND TIME

NORMAL ☐

1 DAY ☐2 DAY ☐OTHER ☐

LABORATORY USE ONLY:

RECEIVING TEMP: 3.8°C THERM #: 54

CUSTODY SEALS - ☐ BROKEN ☐ INTACT ☒ NOT USED

CARRIER BILL #

☒ HAND DELIVERED