



DHC 4-29.96

RC'd 4-8-96

Southern

Rockies

Business

Unit

1274

April 2, 1996

Mr. William J. LeMay, Director
New Mexico Oil Conservation Division
2040 S. Pacheco Street
P. O. Box 6429
Santa Fe, NM 87505

Application for Exception to Rule 303-C
Downhole Commingling
Russell A #2A Well
Unit C Section 25-T28N-R8W
Blanco Mesaverde and Otero Chacra Pools
San Juan County, New Mexico

Enclosed please find an administrative application form (C-107-A) and attachments for downhole commingling for the captioned well.

Should you have questions concerning this matter, please contact me at (303) 830-5344.

Sincerely,

Pamela W. Staley

Enclosures

cc: Mark Rothenberg
Patty Haefele
Wellfile
Proration file

Frank Chavez, Supervisor
NMOCD District III
1000 Rio Brazos Road
Aztec, NM 87410

Duane Spencer
Bureau of Land Management
1235 La Plata Hwy.
Farmington, NM 87401

DISTRICT I
P.O. Box 1980, Hobbs NM 88241-1980

State of New Mexico
Energy, Minerals and Natural Resources Department

Form C-107-A
New 3-12-96

DISTRICT II
811 South First St., Artesia, NM 88210-2835

OIL CONSERVATION DIVISION

2040 S. Pacheco
Santa Fe, New Mexico 87505-6429

APPROVAL PROCESS:

☒ Administrative ☐ Hearing

DISTRICT III
1000 Rio Brazos Rd. Aztec, NM 87410-1693

APPLICATION FOR DOWNHOLE COMMINGLING

EXISTING WELLBORE
☒ YES ☐ NO

Amoco Production Company

P.O. Box 800 Denver, CO 80201

Operator
Russell A

2A

Address
C-25-28N-8W

San Juan

Lease

Well No.

Unit Ltr. - Sec Twp - Rge

County

Spacing Unit Lease Types: (check 1 or more)

OGRID NO. 000778 Property Code 000998 API NO. 3004523704 Federal ☒ State ☐ (and/or) Fee ☐

The following facts are submitted in support of downhole commingling:	Upper Zone	Intermediate Zone	Lower Zone
1. Pool Name and Pool Code	OTERO CHACRA 82329		BLANCO MESAVERDE 72319
2. Top and Bottom of Pay Section (Perforations)	3775' - 3785'		4395' - 4918'
3. Type of production (Oil or Gas)	GAS		GAS
4. Method of Production (Flowing or Artificial Lift)	FLOWING		FLOWING
5. Bottomhole Pressure Oil Zones - Artificial Lift: Estimated Current Gas & Oil - Flowing: Measured Current All Gas Zones: Estimated or Measured Original	a. (Current) 595 PSI (EST)	a.	a. 500 PSI
	b. (Original) 1165 PSI	b.	b. 1260 PSI
6. Oil Gravity (° API) or Gas BTU Content	1148 BTU		1289 BTU
7. Producing or Shut-In?	NEW		PRODUCING
Production Marginal? (yes or no)	YES		NO
• If Shut-In, give data and oil/gas/water rates of last production Note: For new zones with no production history, applicant shall be required to attach production estimates and supporting data • If Producing, give date and oil/gas/water rates of recent test (within 60 days)	Date: Rates:	Date: Rates:	Date: Rates:
	(EST) 58 MCFD 0 BCPD 0 BWPD	Date: Rates:	1/95-1/96 79 MCFD 0.83 BCPD 0 BWPD
8. Fixed Percentage Allocation Formula -% for each zone	Oil: 0 % Gas 42 %	Oil: % Gas %	Oil: 100 % Gas 58 %

9. If allocation formula is based upon something other than current or past production, or is based upon some other method, submit attachments with supporting data and/or explaining method and providing rate projections or other required data.

10. Are all working, overriding, and royalty interests identical in all commingled zones? ☒ Yes ☐ No
If not, have all working, overriding, and royalty interests been notified by certified mail? ☐ Yes ☐ No
Have all offset operators been given written notice of the proposed downhole commingling? ☒ Yes ☐ No

11. Will cross-flow occur? ☐ Yes ☒ No If yes, are fluids compatible, will the formations not be damaged, will any cross-flowed production be recovered, and will the allocation formula be reliable. ☐ Yes ☐ No (If No, attach explanation)

12. Are all produced fluids from all commingled zones compatible with each other? ☒ Yes ☐ No

13. Will the value of production be decreased by commingling? ☐ Yes ☒ No (If Yes, attach explanation)

14. If this well is on, or communitized with, state or federal lands, either the Commissioner of Public Lands or the United States Bureau of Land Management has been notified in writing of this application. ☒ Yes ☐ No NM-013860-A

15. NMCD Reference Cases for Rule 303(D) Exceptions: ORDER NO(S) _____

16. ATTACHMENTS:

- * C-102 for each zone to be commingled showing its spacing unit and acreage dedication.
- * Production curve for each zone for at least one year. (If not available, attach explanation.)
- * For zones with no production history, estimated production rates and supporting data.
- * Data to support allocation method or formula.
- * Notification list of all offset operators.
- * Notification list of working, overriding, and royalty interests for uncommon interest cases.
- * Any additional statements, data, or documents required to support commingling.

I hereby certify that the information above is true and complete to the best of my knowledge and belief.

SIGNATURE Pamela W. Staley TITLE REGULATORY AFFAIRS REP DATE 4/2/96

TYPE OR PRINT NAME PAMELA W. STALEY TELEPHONE NO. (303) 830-5344

OIL CONSERVATION DIVISION
2040 South Pacheco
Santa Fe, NM 87505

First, Artesia, NM 88210
District III
1000 Rio Brazos Rd., Aztec, NM 87410
District IV
2040 South Pacheco, Santa Fe, NM 87505

☐ AMENDED REPORT

WELL LOCATION AND ACREAGE DEDICATION PLAT

* API Number 30-045-23704		* Pool Code 82329	* Pool Name Otero Chacra
* Property Code 998	* Property Name Russell A		* Well Number 2A
* OGRID No. 778	* Operator Name Amoco Production Company		* Elevation 6302'

10 Surface Location

UL or lot no.	Section	Township	Range	Lot Idn	Feet from the	North/South line	Feet from the	East/West line	County
C	25	28N	8W		1110	North	1850	West	San Juan

11 Bottom Hole Location If Different From Surface

UL or lot no.	Section	Township	Range	Lot Idn	Feet from the	North/South line	Feet from the	East/West line	County

* Dedicated Acres 160	* Joint or Infill	* Consolidation Code	* Order No.
--------------------------	-------------------	----------------------	-------------

NO ALLOWABLE WILL BE ASSIGNED TO THIS COMPLETION UNTIL ALL INTERESTS HAVE BEEN CONSOLIDATED
OR A NON-STANDARD UNIT HAS BEEN APPROVED BY THE DIVISION

<p>16</p>	<p>17 OPERATOR CERTIFICATION</p> <p>I hereby certify that the information contained herein is true and complete to the best of my knowledge and belief.</p> <p>Signature: <u>Patty Haebele</u> Patty Haebele Staff Assistant</p> <p>Title: _____ Date: <u>2/23/96</u></p>
	<p>18 SURVEYOR CERTIFICATION</p> <p>I hereby certify that the well location shown on this plat was plotted from field notes of actual surveys made by me or under my supervision, and that the same is true and correct to the best of my belief.</p> <p>Date of Survey: <u>8/28/79</u></p> <p>Signature and Seal of Professional Surveyor: _____</p> <p>on file</p> <p>2950 (?) Certificate Number</p>

STATE OF NEW MEXICO
ENERGY AND MINERALS DEPARTMENT

LAND CONSERVATION DIVISION
P. O. BOX 2088
SANTA FE, NEW MEXICO 87501

Form C-102
Revised 10-1-78

All distances must be from the outer boundaries of the Section.

Operator EL PASO NATURAL GAS COMPANY			Lease RUSSELL (NM-013860-A)		Well No. 2A
Unit Letter C	Section 25	Township 28N	Range 8W	County San Juan	
Actual Footage Location of Well: 1110 feet from the North line and 1850 feet from the West line					
Ground Level Elev. 6302	Producing Formation Mesa Verde	Pool Blanco Mesa Verde		Dedicated Acreage: 320.00 Acres	

1. Outline the acreage dedicated to the subject well by colored pencil or hachure marks on the plat below.
2. If more than one lease is dedicated to the well, outline each and identify the ownership thereof (both as to working interest and royalty).
3. If more than one lease of different ownership is dedicated to the well, have the interests of all owners been consolidated by communitization, unitization, force-pooling, etc?

☐ Yes ☐ No If answer is "yes," type of consolidation _____

If answer is "no," list the owners and tract descriptions which have actually been consolidated. (Use reverse side of this form if necessary.) _____

No allowable will be assigned to the well until all interests have been consolidated (by communitization, unitization, forced-pooling, or otherwise) or until a non-standard unit, eliminating such interests, has been approved by the Commission. NOTE: THIS PLAT IS REISSUED TO REFLECT A MOVED LOCATION. 9-5-79

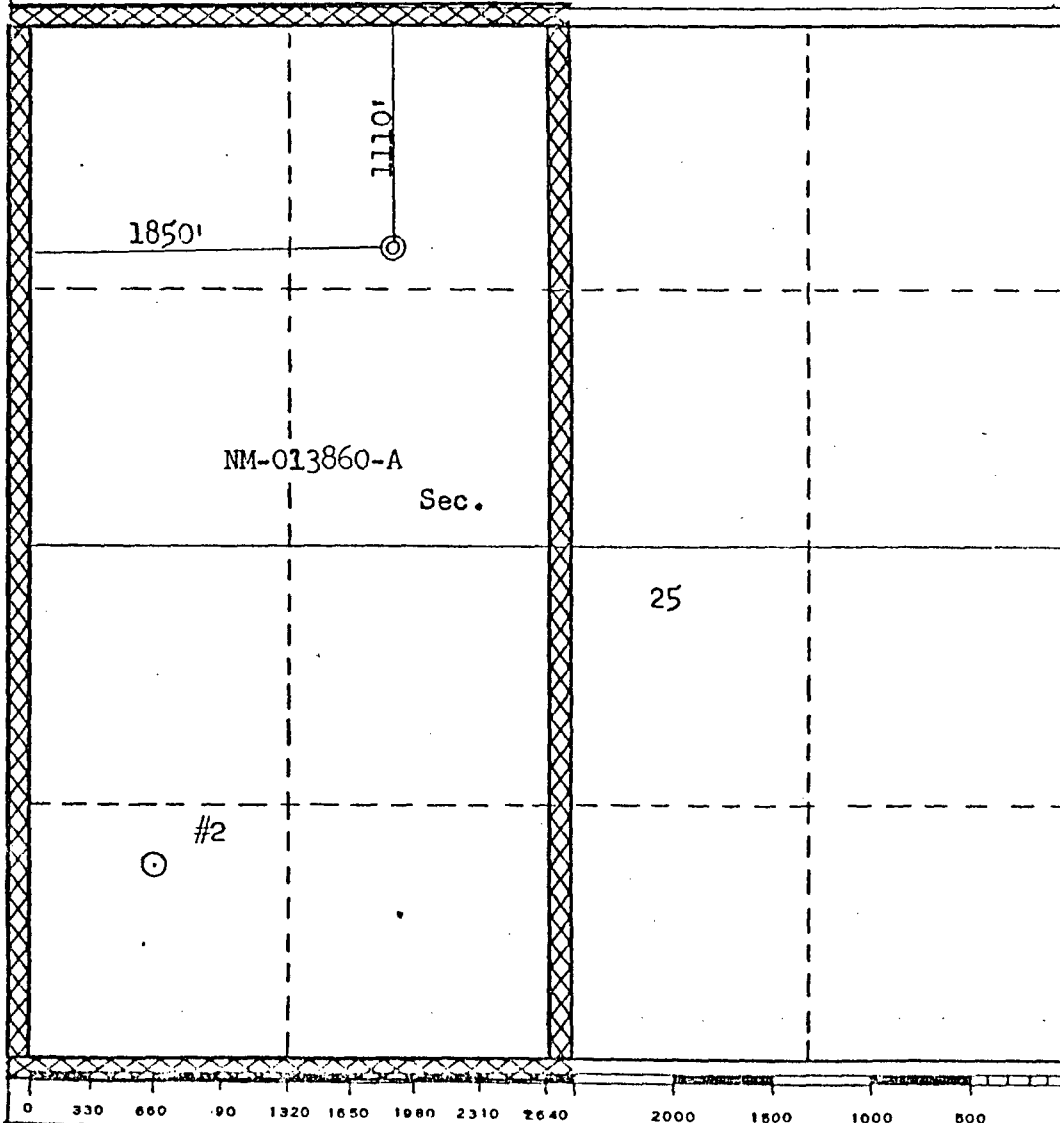

CERTIFICATION

I hereby certify that the information contained herein is true and complete to the best of my knowledge and belief.

D. P. Dices

Name

Drilling Clerk

Position

El Paso Natural Gas Co.

Company

September 18, 1979

Date

I hereby certify that the well location shown on this plat was plotted from field notes of actual surveys made by me or under my supervision, and that the same is true and correct to the best of my knowledge and belief.

Date Surveyed

August 28, 1979

Registered Professional Engineer and/or Land Surveyor

Fred B. Kern Jr.

Certificate No.

3950

Engr: zr06

RUSSELL A 2A (Russell 2A)

Operator- AMOCO PRODUCTION CO

300452370400MV C252808-002AMV

APC_WI - 1.0000000

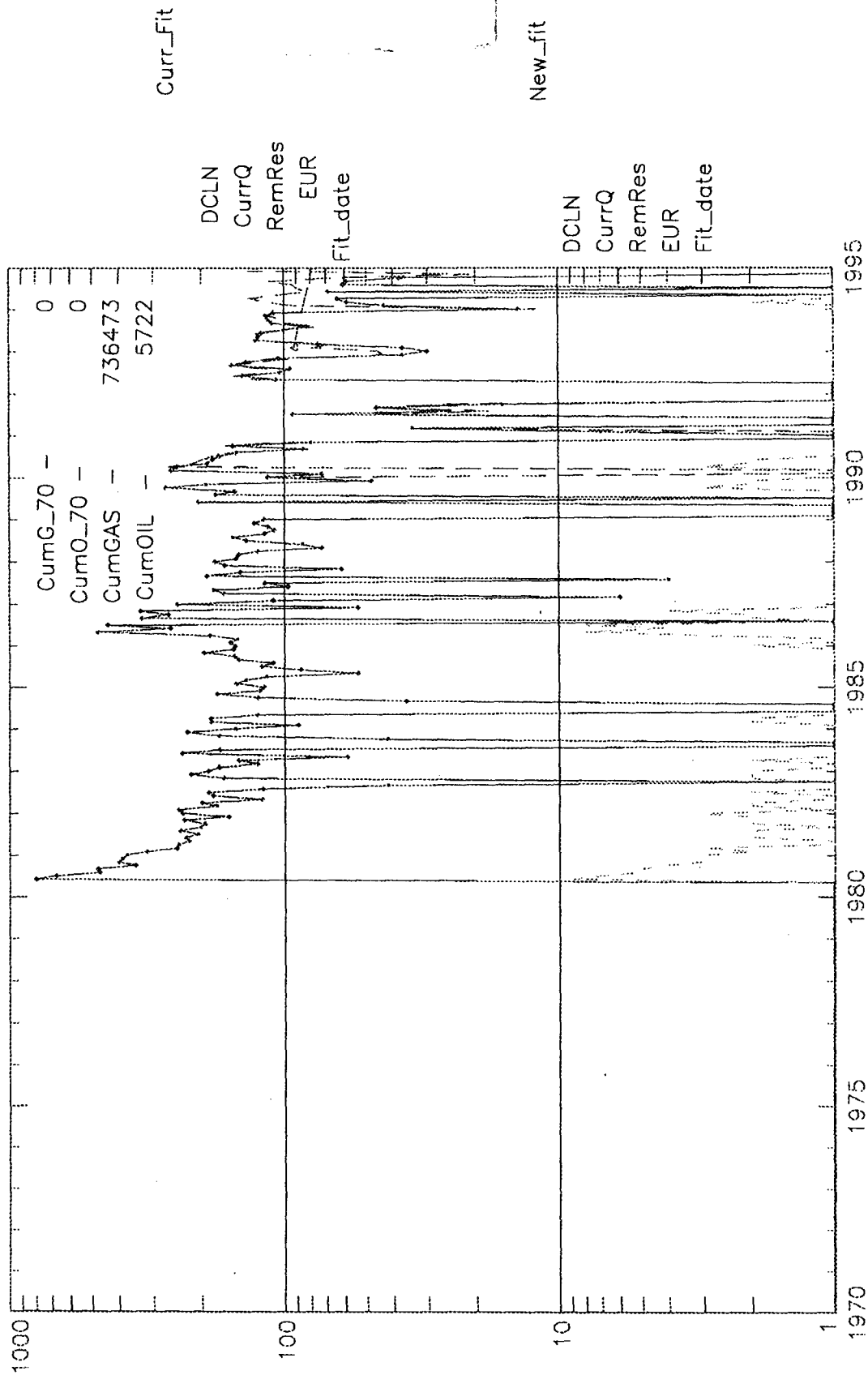

Dwights

1000 Lease: RUSSELL LS 000012

Retrieval Code: 251,045,28N08W24H00C

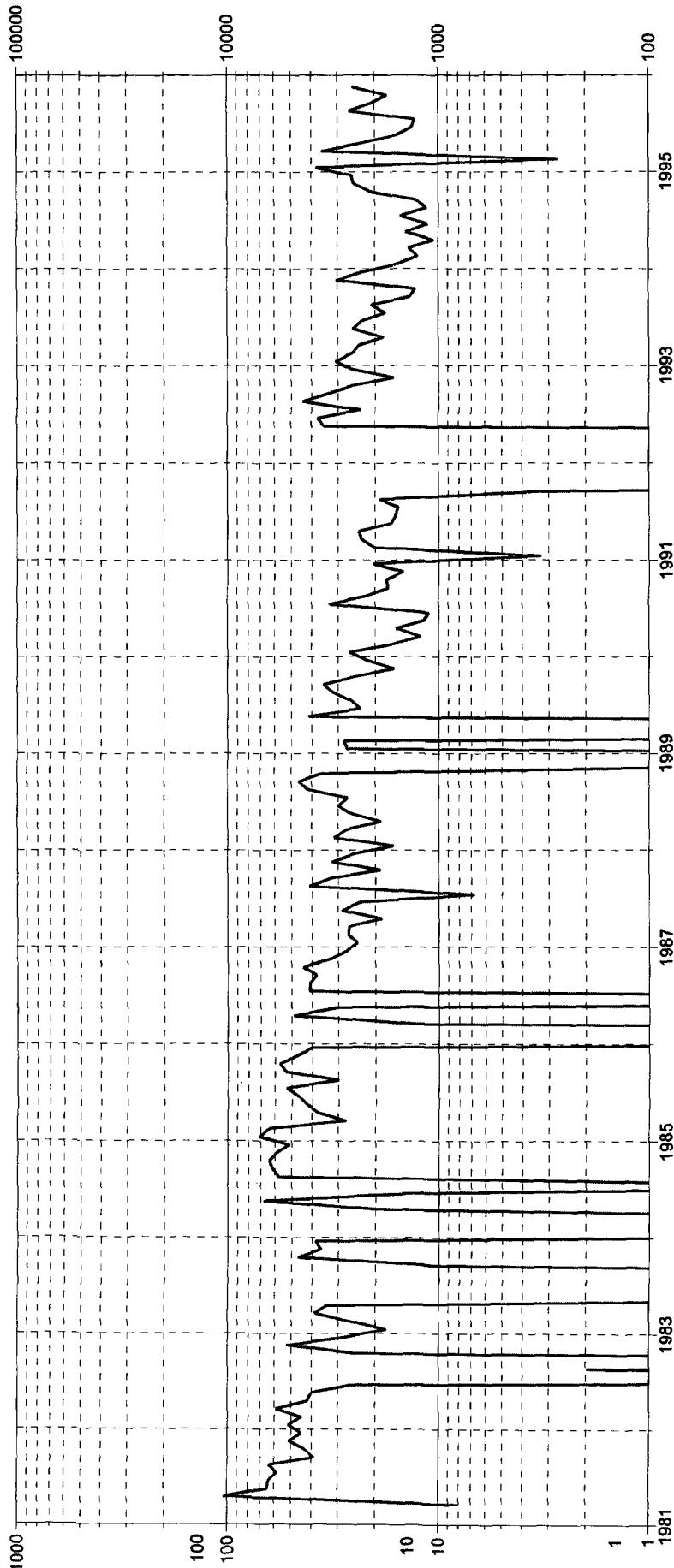

County: SAN JUAN

Field: SAN JUAN (CHACRA) CK

Reservoir: CHACRA

Operator: AMOCO PRODUCTION CO

State: NM

Oil Cum: 0 bbl

Gas Cum: 459772 mcf

Location: 24H 28N 8W

F.P. Date: 03/81

Water (bbl/mo)

Oil (bbl/mo)

Date: 04/03/96

Gas (mcf/mo)

Dwights

1000 Lease: DRYDEN LS 00001A

Retrieval Code: 251,045,28N08W28100C

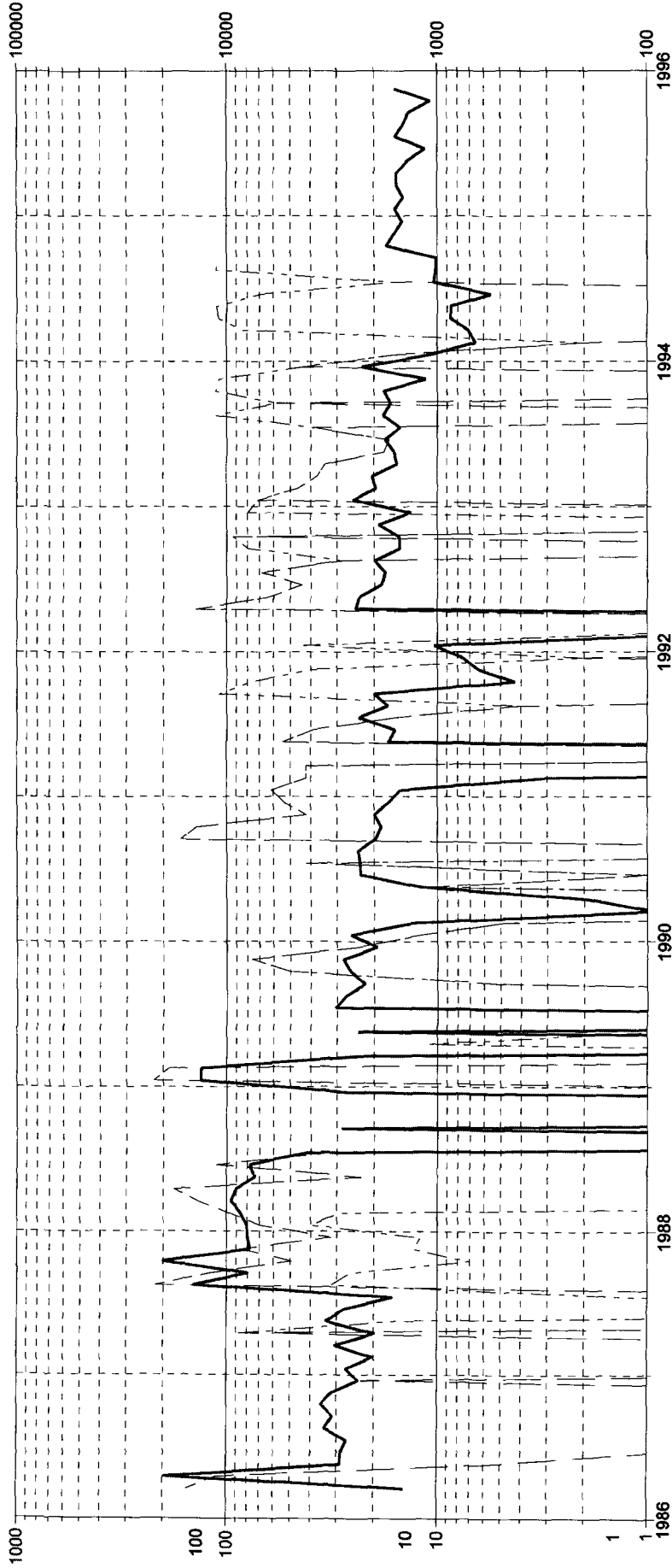

County: SAN JUAN

Field: OTERO (CHACRA) CK

Reservoir: CHACRA

Operator: AMOCO PRODUCTION CO

State: NM

Oil Cum: 3657 bbl

Gas Cum: 327760 mcf

Location: 28N 28W 8W

F.P. Date: 03/86

Water (bbl/mo)

Oil (bbl/mo)

Date: 04/03/96

Gas (mcf/mo)

LIST OF OFFSET OPERATORS
Russell A#2A

Meridian Oil, Inc.
P.O. Box 4289
Farmington, NM 87499