

District I
1625 N. French Dr., Hobbs, NM 88240
District II
811 S. First St., Artesia, NM 88210
District III
1000 Rio Brazos Road, Aztec, NM 87410
District IV
1220 S. St. Francis Dr., Santa Fe, NM 87505

State of New Mexico
Energy Minerals and Natural Resources

Form C-141
Revised August 8, 2011

Oil Conservation Division
1220 South St. Francis Dr.
Santa Fe, NM 87505

Submit 1 Copy to appropriate District Office in
accordance with 19.15.29 NMAC.

Release Notification and Corrective Action

nJMW 1400340759

OPERATOR

☒ Initial Report ☐ Final Report

Name of Company: BOPCO, L.P. <i>260737</i>	Contact: Tony Savoie
Address: 522 W. Mermod, Suite 704 Carlsbad, N.M. 88220	Telephone No. 575-887-7329
Facility Name: PLU-409H Spill location is 2848 ft. S.W. of the PLU-409H	Facility Type: Exploration and Production

Surface Owner: Federal	Mineral Owner: Federal	API No. 30-015-41136
------------------------	------------------------	----------------------

LOCATION OF RELEASE

Unit Letter B	Section 28	Township 24S	Range 31E	Feet from the 263	North/South Line North	Feet from the 2123	East/West Line East	County Eddy
------------------	---------------	-----------------	--------------	----------------------	---------------------------	-----------------------	------------------------	----------------

Latitude N 32.194714 Longitude W 103.780923

NATURE OF RELEASE

Type of Release: Produced water	Volume of Release: 180 bbls	Volume Recovered: 100 bbls
Source of Release: Flange failure on the water transfer pump	Date and Hour of Occurrence: 12/25/13 Time approximately	Date and Hour of Discovery: 12/25/13 at 8:30 a.m.
Was Immediate Notice Given? <input checked="" type="checkbox"/> Yes <input type="checkbox"/> No <input type="checkbox"/> Not Required	If YES, To Whom? NMOCD emergency #104 and BLM	
By Whom? Tony Savoie	Date and Hour: 12/25/13 at 9:20 a.m.	
Was a Watercourse Reached? <input type="checkbox"/> Yes <input type="checkbox"/> No	If YES, Volume Impacting the Watercourse	

RECEIVED

DEC 26 2013

14000 ARTESIA

If a Watercourse was Impacted, Describe Fully.*

Describe Cause of Problem and Remedial Action Taken.* While fracing the PLU-409H an 8" flange broke on the discharge side of the water transfer pump. The pump was shut down and the valve on the discharge of the pump was closed. Vacuum trucks were standing by during the water transfer and were immediately dispatched to the spill location. The lines were switched on the pump and the water transfer continued.

Describe Area Affected and Cleanup Action Taken.* The spill impacted approximately 40,600 sq.ft. of the Buck Jackson caliche road and approximately 8,600 sq.ft. of pasture area at the point of release and where the water ran off the road way and into the pasture. The final remediation will comply with the NMOCD and BLM remediation guidelines.

I hereby certify that the information given above is true and complete to the best of my knowledge and understand that pursuant to NMOCD rules and regulations all operators are required to report and/or file certain release notifications and perform corrective actions for releases which may endanger public health or the environment. The acceptance of a C-141 report by the NMOCD marked as "Final Report" does not relieve the operator of liability should their operations have failed to adequately investigate and remediate contamination that pose a threat to ground water, surface water, human health or the environment. In addition, NMOCD acceptance of a C-141 report does not relieve the operator of responsibility for compliance with any other federal, state, or local laws and/or regulations.

Signature: <i>Tony Savoie</i>	OIL CONSERVATION DIVISION	
Printed Name: Tony Savoie	Approved by Environmental Specialist By <i>Mike Deacon</i>	
Title: Waste Management and Remediation Specialist	Approval Date: JAN 03 2014	Expiration Date:
E-mail Address: <i>tasavoie@basspet.com</i>	Conditions of Approval: Remediation per OCD Rule & Guidelines, & like approval by BLM. SUBMIT REMEDIATION	Attached <input type="checkbox"/>
Date: 12/26/13 Phone: 432-556-8730		

* Attach Additional Sheets If Necessary

PROPOSAL NO LATER THAN:
Feb. 3rd, 2014

2RP-2135

EIGHT POINT DRILLING PROGRAM **BOPCO, L.P.**

NAME OF WELL: Poker Lake Unit 409H

LEGAL DESCRIPTION - SURFACE: 700' FSL, 550' FWL, Section 22, T24S, R31E, Eddy County, NM.
BHL: 1500' FSL, 330' FEL, Section 16, T24S, R31E, Eddy County, New Mexico.

POINT 1: ESTIMATED FORMATION TOPS (See No. 2 Below)

POINT 2: WATER, OIL, GAS AND/OR MINERAL BEARING FORMATIONS

Anticipated Formation Tops: KB 3536' (estimated)
GL 3514'

Formation Description	Est from KB (TVD)	Est (MD)	SUB-SEA TOP	BEARING
T/Fresh Water	400'	400'	+ 3,136'	Fresh Water
T/Rustler	656'	656'	+ 2,880'	Barren
T/Salado	1,017'	1,017'	+ 2,519'	Barren
B\Salt	4,175'	4,175'	- 639'	Barren
T/Lamar	4,395'	4,395'	- 859'	Oil/Gas
T/Ramsey	4,430'	4,430'	- 894'	Oil/Gas
Cherry Canyon	5,321'	5,321'	- 1,785'	Oil/Gas
Brushy Canyon	6,578'	6,578'	- 3,042'	Oil/Gas
KOP	7,621'	7,621'	- 4,085'	Oil/Gas
Lower Brushy Canyon "8A" Sand	8,004'	7,963'	- 4,468'	Oil/Gas
EOC	8,199'	8,570'	- 4,663'	Oil/Gas
Target #1	8,199'	8,570'	- 4,663'	Oil/Gas
TD Horizontal Hole	8,211'	14,205'	- 4,675'	Oil/Gas

POINT 3: CASING PROGRAM

TYPE	INTERVAL MD	HOLE SIZE	PURPOSE	INSTALLATION TYPE
20"	0' - 120'	26"	Conductor	Contractor-Discretion
13-3/8", 48 ppf, H-40, or 54.5#, J-55 8rd, ST&C*	0' - 1,027' <i>See COA</i>	17-1/2"	Surface	New
9-5/8", 40 ppf, N-80, 8rd, LT&C or 9-5/8" 40 ppf, J-55, 8rd, LT&C*	0' - 4,415'	12-1/4"	Intermediate	New
7", 26 ppf, N-80, Buttress or 8rd LTC*	0' - 8,321'	8-3/4"	Production	New

Completion System				
4-1/2", 11.6 ppf, HCP-110 8rd LT&C, BTC	8,271' - 14,205'	6-1/8"	Completion System	New

* Depending on availability.

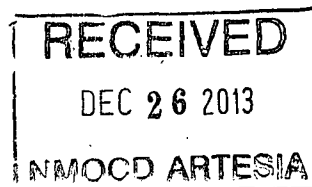

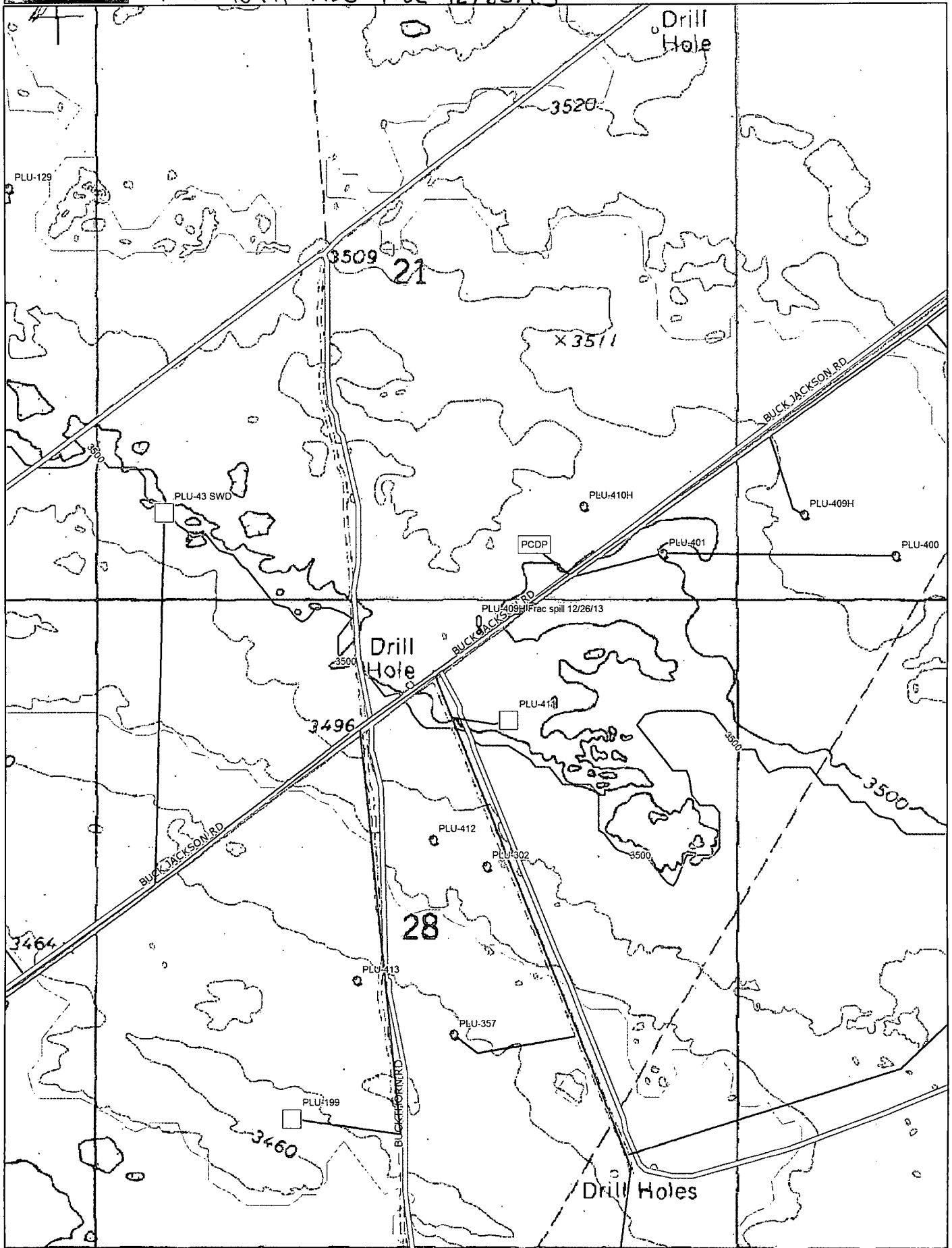

Data use subject to license.

© DeLorme. Topo North America™ 9.

www.delorme.com

UL B
sect 28 -



Scale 1 : 12,800

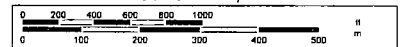

1" = 1,066.7 ft

Data Zoom 14-0

Poker Lake Unit 409H Frac Spill Ranking Analysis

NMOCD Standards			Points
Depth to Ground Water	Greater than 100 ft.		0
Depth to Ground Water	Less than 100 ft. but greater than 50 ft.		10
Depth to Ground Water	Less than 50 ft.		20
Well Head Protection	Less than 1000 ft. from a water source, or,	Yes	20
	Less than 200 ft. from private domestic water source	No	0
Distance to Surface water body	Less than 200 Horizontal. ft.		20
Distance to Surface water body	200 to 1000 Horizontal ft.		10
Distance to Surface water body	Greater than 1000 Horizontal ft.		0
Action levels	>19	10-19	0-9
Benzene (mg/kg)	10	10	10
BTEX (mg/kg)	50	50	50
TPH (mg/kg)	100	1000	5000

Site Ranking		Points
Depth to Ground Water	400 ft.	0
Well Head Protection	1.23 miles	0
Surface Water Body	Greater than 5 miles	0
Total Ranking Score		0

Site Closure Objective	
Benzene (mg/kg)	10
BTEX (mg/kg)	50
TPH (mg/kg)	5000 mg/kg
Chloride (mg/kg)	1000 mg/kg

Remediation Plan:

All of the impacted soil in the pasture area will be excavated and stockpiled on-site pending disposal at an approved disposal facility. Soil samples will be collected from the sidewalls and floors of the excavated area, field screened, properly prepared and delivered to the lab for analysis. Samples will be analyzed for Chlorides method SM4500CL-B, TPH method 8015M, and BTEX method 8021B.

After achieving the closure objective the excavated area will be backfilled with clean soil either purchased or re-claimed from well pad reclamation projects.

The impacted area in the road way will be scraped with a maintainer and surplus soil will be hauled to the approved disposal facility. Clean caliche will be spread back over the area, watered and packed.

Soil samples will be collected at random in the roadway to determine the vertical extent of the chloride impacted area. DFSI will prepare a closure report for BOPCO to submit to the NMOCD.

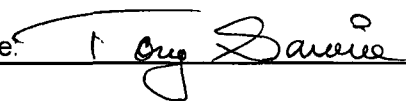
Signature: 

Printed Name: Tony Savoie

Date: 12/26/2013

