

DMC

7/8/96
1326SouthernRockiesBusinessUnit

June 12, 1996

Mr. William J. LeMay, Director
New Mexico Oil Conservation Division
2040 S. Pacheco Street
P. O. Box 6429
Santa Fe, NM 87505

Application for Exception to Rule 303-C - Downhole Commingling
Florance Gas Com E #9A Well
Unit J Section 13-T30N-R9W
Blanco Pictured Cliffs and Blanco Mesaverde Pools
San Juan County, New Mexico

Enclosed please find an administrative application form (C-107-A) and attachments for downhole commingling for the captioned well. By copy of this application by certified mail, return receipt requested, Amoco is notifying all offset operators in the formations captioned above as well as all affected interest owners if the ownership of those formations is not common. The Division Director may approve the proposed downhole commingling in the absence of a valid objection from any offset operator or any interest owner in those instances where ownership is not common in the zones to be commingled within 20 days after the receipt of the application if, in his opinion, waste will not result thereby, and correlative rights will not be violated.

Should there be questions concerning this matter, please contact me at (303) 830-5344.

Sincerely,

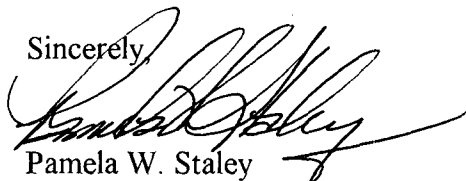
Pamela W. Staley

Enclosures

cc: Hiep Vu
Patty Haefele
Wellfile
Proration File
Frank Chavez, Supervisor
NMOCD District III
1000 Rio Brazos Road
Aztec, NM 87410

Duane Spencer
Bureau of Land Management
1235 La Plata Hwy.
Farmington, NM 87401

DISTRICT I
P.O. Box 1980, Hobbs NM 88241-1980

State of New Mexico
Energy, Minerals and Natural Resources Department

Form C-107-A
New 3-12-96

OIL CONSERVATION DIVISION

APPROVAL PROCESS:

DISTRICT II
811 South First St., Artesia, NM 88210-2835

2040 S. Pacheco
Santa Fe, New Mexico 87505-6429

☒ Administrative ☐ Hearing

DISTRICT III
1000 Rio Brazos Rd. Aztec, NM 87410-1693

EXISTING WELLBORE
☒ YES ☐ NO

APPLICATION FOR DOWNHOLE COMMINGLING

Amoco Production Company	P.O. Box 800	Denver, CO 80201
Operator Florance Gas Com E	Address J-13-30N-9W	County San Juan
Lease	Well No. #9A	Unit Ltr. - Sec Twp - Rge

OGRID NO. 000778 Property Code 000536 API NO. 30-045-21882
Federal ☒ State ☐ (and/or) Fee ☐

The following facts are submitted in support of downhole commingling:	Upper Zone	Intermediate Zone	Lower Zone
1. Pool Name and Pool Code	Blanco Pictured Cliffs 72359		BLANCO MESAVERDE 72319
2. Top and Bottom of Pay Section (Perforations)	2570'-2642'		4229'-5012'
3. Type of production (Oil or Gas)	GAS		GAS
4. Method of Production (Flowing or Artificial Lift)	FLOWING		FLOWING
5. Bottomhole Pressure Oil Zones - Artificial Lift: Gas & Oil - Flowing: All Gas Zones: Estimated Current Measured Current Estimated or Measured Original	a. (Current) 137 PSI b. (Original) 1047 PSI	a. b.	a. 136 PSI b. 1302 PSI
6. Oil Gravity (* API) or Gas BTU Content	1140 BTU		1220 BTU/MMCF 53.8 API
7. Producing or Shut-In?	PRODUCING		PRODUCING
Production Marginal? (yes or no)	YES		NO
• If Shut-In, give data and oil/gas/water rates of last production Note: For new zones with no production history, applicant shall be required to attach production estimates and supporting data	Date: Rates:	Date: Rates:	Date: Rates:
• If Producing, give date and oil/gas/water rates of recent test (within 60 days)	Date: Rates: 04/03/96 54 MCFD 0.38 BWPD	Date: Rates:	Date: Rates: 04/03/96 440 MCFD, 0.33 BWPD 0.68 BCPD
8. Fixed Percentage Allocation Formula -% for each zone	Oil: 0 % Gas 11 %	Oil: % Gas %	Oil: 100 % Gas 89 %

9. If allocation formula is based upon something other than current or past production, or is based upon some other method, submit attachments with supporting data and/or explaining method and providing rate projections or other required data.

10. Are all working, overriding, and royalty interests identical in all commingled zones?
If not, have all working, overriding, and royalty interests been notified by certified mail?
Have all offset operators been given written notice of the proposed downhole commingling?
☒ Yes ☐ No
☐ Yes ☐ No
☒ Yes ☐ No

11. Will cross-flow occur? ☐ Yes ☒ No If yes, are fluids compatible, will the formations not be damaged, will any cross-flowed production be recovered, and will the allocation formula be reliable. ☐ Yes ☐ No (If No, attach explanation)

12. Are all produced fluids from all commingled zones compatible with each other? ☒ Yes ☐ No

13. Will the value of production be decreased by commingling? ☐ Yes ☒ No (If Yes, attach explanation)

14. If this well is on, or communitized with, state or federal lands, either the Commissioner of Public Lands or the United States Bureau of Land Management has been notified in writing of this application. ☒ Yes ☐ No SF-081001 SF-080004

15. NMOCD Reference Cases for Rule 303(D) Exceptions: ORDER NO(S) _____

16. ATTACHMENTS:

- * C-102 for each zone to be commingled showing its spacing unit and acreage dedication.
- * Production curve for each zone for at least one year. (If not available, attach explanation.)
- * For zones with no production history, estimated production rates and supporting data.
- * Data to support allocation method or formula.
- * Notification list of all offset operators.
- * Notification list of working, overriding, and royalty interests for uncommon interest cases.
- * Any additional statements, data, or documents required to support commingling.

I hereby certify that the information above is true and complete to the best of my knowledge and belief.

SIGNATURE Pamela W. Staley TITLE Regulatory Affairs Engineer DATE 6/10/96
TYPE OR PRINT NAME Pamela W. Staley TELEPHONE NO. (303) 830-5344

**NEW MEXICO OIL CONSERVATION COMMISSION
WELL LOCATION AND ACREAGE DEDICATION PLAT**

Form C-102
Superseded C-128
Effective 1-1-61

All distances must be from the outer boundaries of the Section

Operator Tenneco Oil Company				Well No. 9-A	
Tract Corner J	Section 13	Township 30-N	Range 9-W	County San Juan	
Actual Surface Location of Well: <div style="display: flex; justify-content: space-between;"> 1850 feet from the South line and 1650 feet from the East line </div>					
Ground Level Elev. 5812'	Producing Formation Mesa Verde-Pictured Cliffs	Pool Mesa Verde-Pictured Cliffs	Dedicated Acreage SEA/160		Acres

1. Outline the acreage dedicated to the subject well by colored pencil or hatchure marks on the plat below.
2. If more than one lease is dedicated to the well, outline each and identify the ownership thereof (both as to working interest and royalty).
3. If more than one lease of different ownership is dedicated to the well, have the interests of all owners been consolidated by communitization, unitization, force pooling, etc?

One lease
☒ Yes ☐ No If answer is "yes," type of consolidation

If answer is "no," list the owners and tract descriptions which have actually been consolidated. (Use reverse side of this form if necessary.)

No allowable well is assigned to the well until all interests have been consolidated (by communitization, unitization, force pooling, or otherwise) or until a non standard unit, eliminating such interests, has been approved by the Commission.

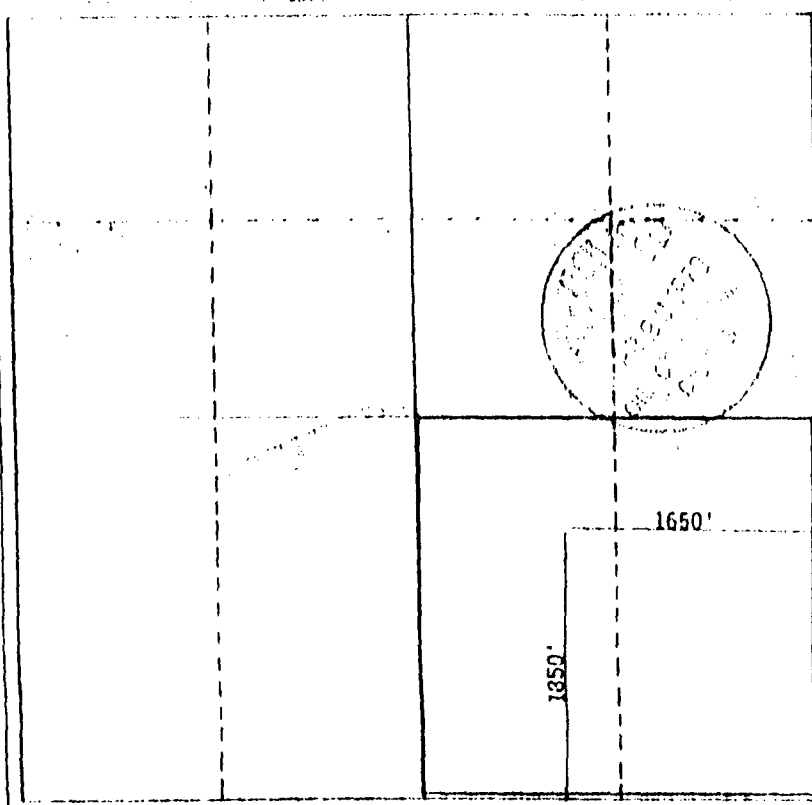

CERTIFICATION

I hereby certify that the information contained herein is true and complete to the best of my knowledge and belief.

Signature *R. C. Jewett*
 Position **Production Analyst**
 Company **Tenneco Oil Company**
 Date **4/16/79**

I hereby certify that the well location shown on this plat was plotted from field notes of actual surveys made by me or under my supervision, and that the same is true and correct to the best of my knowledge and belief.

Letter Forwarded

Registered Professional Engineer
and/or Land Surveyor

Certificate No.

0 300 600 900 1200 1500 1800 2100 2400 2700 3000 3300 3600 3900 4200 4500 4800 5100 5400 5700 6000

Dwights

1000 Lease: FLORANCE GAS COM E 00009A

Retrieval Code: 251,045,30N09W13J00M

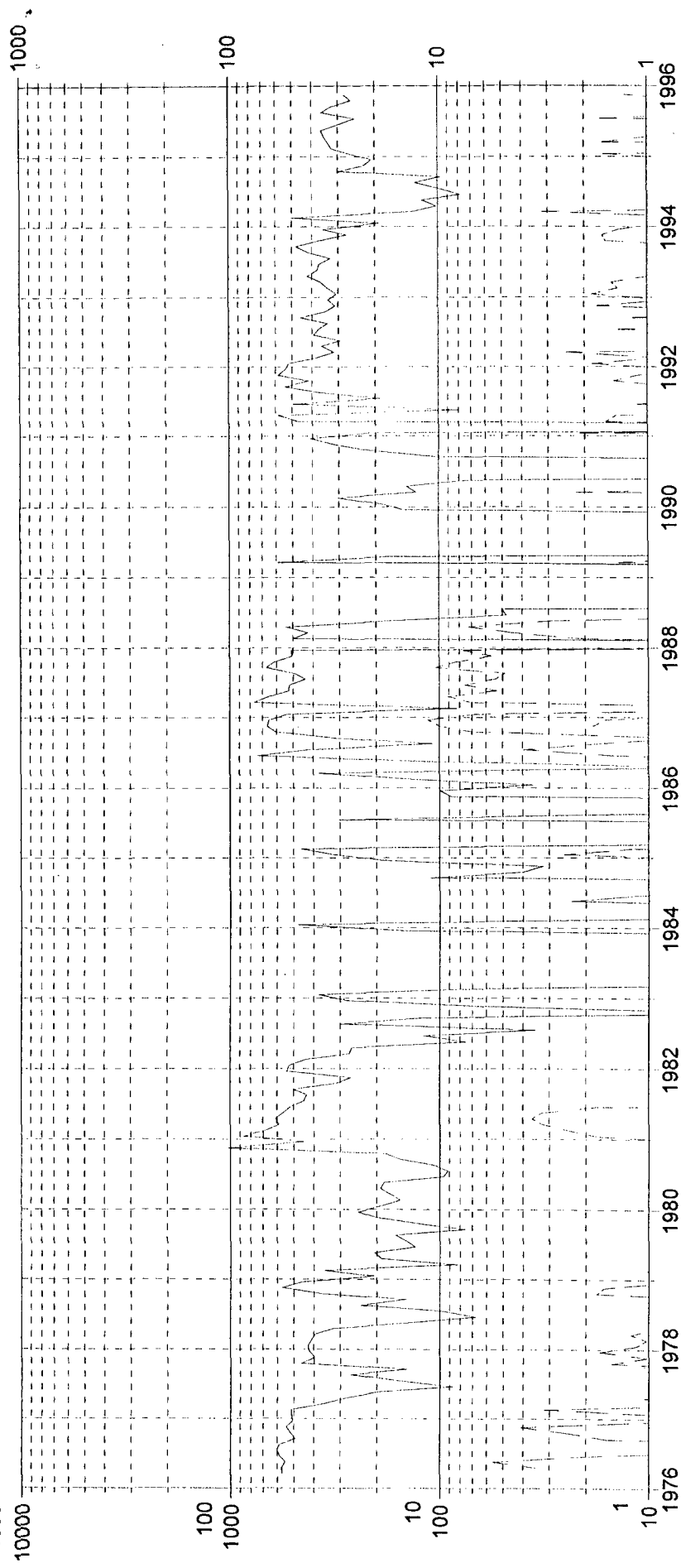

County: SAN JUAN	State: NM	F.P. Date: 03/76	Date: 03/27/96
Field: BLANCO (MESAVERDE) MV	Oil Cum: 8052 bbl		
Reservoir: MESAVERDE	Gas Cum: 1929 mmcf	Water (bbl/day)	---
Operator: AMOCO PRODUCTION CO	Location: 13J 30N 9W	Gas (mcf/day)	---
		Oil (bbl/day)	---

Dwights

1000 Lease: FLORANCE GAS COM E 00009A

Retrieval Code: 251,045,30N09W13J00P

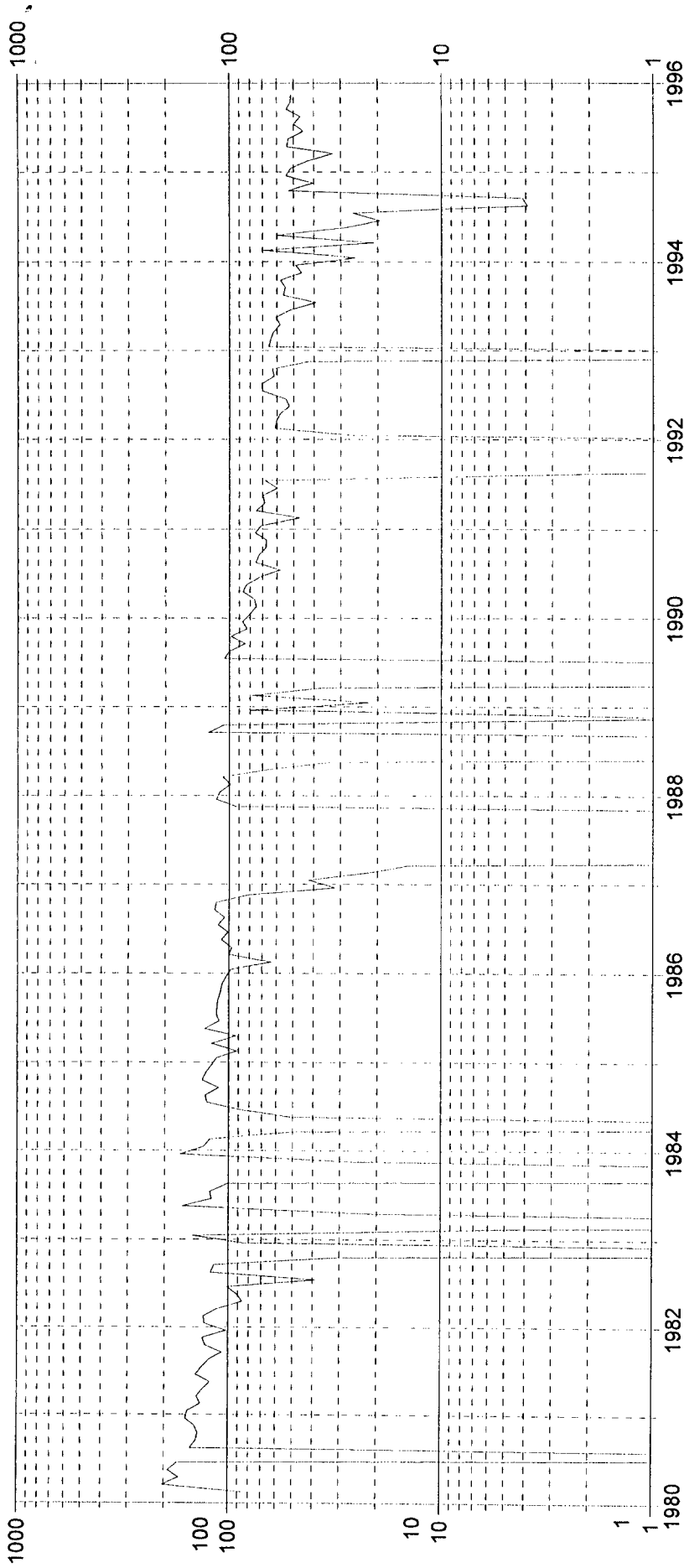

County: SAN JUAN

State: NM

F.P. Date: 02/80

Date: 03/27/96

Field: BLANCO (PICTURED CLIFFS) PC

Oil Cum: 0 bbl

Reservoir: PICTURED CLIFFS

Gas Cum: 423905 mcf

Water (bbl/day)

Operator: AMOCO PRODUCTION CO

Location: 13J 30N 9W

Gas (mcf/day)

Oil (bbl/day)

OFFSET OPERATORS

Meridian Oil, Inc.
P.O. Box 4289
Farmington, NM 87499