



Texaco E & P

205 E. Bender Blvd.  
Hobbs NM 88240  
505 393 7191

July 10, 1996

New Mexico Oil Conservation Commission  
2040 South Pacheco  
Santa Fe, New Mexico 87505  
Attention: Mr. David R. Catanach

Re: Exception to NMOCD Rule 303 (A).  
Application to Downhole Commingle  
Wantz Abo/Drinkard Pool  
Baker "B" #17  
Unit Letter N, Sec. 10, 22S, 37E  
Lea County, New Mexico

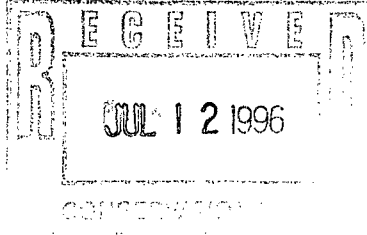

Mr. Catanach,

Texaco Exploration & Production Inc., respectfully requests administrative approval to downhole commingle the Wantz Abo/Drinkard Pool within the subject wellbore. Currently the Wantz Abo is plugback, and we are producing out of the Drinkard Pool. Notification of this application has been sent to the said offset operators and a statement of notification has been included in this application.

The proposed downhole commingling will provide a more economical means of production. It will allow complete development of the productive capacity on the subject lease by allowing both intervals to be artificially lifted simultaneously. This will extend the productive life of both completions, thereby preventing waste.

The subject well meets all of requirements as set forth by Rule 303 (C). The well was completed 1-20-96, so a full year of production data is not available. In addition, it should be noted that all produced fluids have entered a common production facility with no fluid compatibility problems.

It is requested that the allocation of production for each zone be deferred until a stabilized production rate is establish. Production will then be allocated to the Wantz Abo Pool by subtracting the Drinkard stabilized production rate from the total stabilized production rate after downhole commingling the well. If you have any questions concerning this application, please contact Kirk W. Spilman at (505)397-0425.

Yours very truly,

Kirk W. Spilman  
Eunice Area Engineer

attachments

cc: Jerry Sexton/NMOCD/Hobbs

## DISTRICT I

P.O. Box 1980, Hobbs, NM 88240

## DISTRICT II

811 South First St., Artesia, NM 88210

## DISTRICT III

1000 Rio Brazos Rd, Aztec, NM 87410

State of New Mexico  
Energy, Minerals and Natural Resources Department

## OIL CONSERVATION DIVISION

2040 S. Pacheco  
Santa Fe, New Mexico 87505-6429Form C-107-A  
New 3-12-96

APPROVAL PROCESS:

☒ Administrative ☐ Hearing

EXISTING WELLBORE

☒ YES ☐ NO

## APPLICATION FOR DOWNHOLE COMMINGLING

Operator: TEXACO EXPLORATION & PRODUCTION Address: 205 E. BENDER HOBBS, NM 88240

Lease: BAKER 'B' Well No. 17 Unit Ltr. - Sec - Twp - Rge N-10-22S-37E County LEA

OGRID NO. o22351 Property Code 010886 API NO. 30-025-33117 Spacing Unit Lease Types: (check 1 or more) ☒ Federal ☐ State ☐ (and/or) Fee ☒

The following facts are submitted in support of downhole commingling:	Upper Zone	Intermediate Zones	Lower Zone
1. Pool Name and Pool Code	DRINKARD 19190 142/652		WANTZ ABO 62700
2. Top and Bottom of Pay Section (Perforations)	6468-6509		6641-7048
3. Type of production (Oil or Gas)	OIL		OIL
4. Method of Production (Flowing or Artificial Lift)	ARTIFICIAL		ARTIFICIAL
5. Bottomhole Pressure Oil Zones - Artificial Lift: Gas & Oil - Flowing: All Gas Zones: Estimated Current Measured Current Estimated Or Measured Original	a. (Current) 24 hr SI 700 psi b. (Original)	a.  b.	a. 24 hr SI 651 psi b.
6. Oil Gravity (° API) or Gas BTU Content	39.5		39.5
7. Producing or Shut-In?	PRODUCING		SHUT-IN
Production Marginal? (yes or no)	YES		YES
* If Shut-In, give date and oil/gas/water rates of last production Note: For new zones with no production history, applicant shall be required to attach production estimates and supporting data	Date: Rates:	Date: Rates:	Date: 2/19/96 Rates: 16/9/174
* If Producing, give date and oil/gas/water rates of recent test (within 60 days)	Date: 7/8/96 Rates: 11/6/250	Date: Rates:	Date: Rates:
8. Fixed Percentage Allocation Formula - % for each zone	Oil: % Gas: %	Oil: % Gas: %	Oil: % Gas: %

9. If allocation formula is based upon something other than current or past production, or is based upon some other method, submit attachments with supporting data and/or explaining method and providing rate projections or other required data.
10. Are all working, overriding, and royalty interests identical in all commingled zones? ☒ Yes ☐ No  
If not, have all working, overriding, and royalty interests been notified by certified mail? ☐ Yes ☐ No  
Have all offset operators been given written notice of the proposed downhole commingling? ☐ Yes ☐ No
11. Will cross-flow occur? ☐ Yes ☒ No If yes, are fluids compatible, will the formations not be damaged, will any cross-flowed production be recovered, and will the allocation formula be reliable. ☐ Yes ☐ No (If No, attach explanation)
12. Are all produced fluids from all commingled zones compatible with each other? ☒ Yes ☐ No
13. Will the value of production be decreased by commingling? ☐ Yes ☒ No (If Yes, attach explanation)
14. If this well is on, or communitized with, state or federal lands, either the Commissioner of Public Lands or the United States Bureau of Land Management has been notified in writing of this application. ☐ Yes ☐ No
15. NMOCD Reference Cases for Rule 303(C) Exceptions: ORDER NO(S). \_\_\_\_\_
16. ATTACHMENTS:  
\* C-102 for each zone to be commingled showing its spacing unit and acreage dedication.  
\* Production curve for each zone for at least one year. (If not available, attach explanation.)  
\* For zones with no production history, estimated production rates and supporting data.  
\* Data to support allocation method or formula.  
\* Notification list of all offset operators.  
\* Notification list of working, overriding, and royalty interests for uncommon interest cases.  
\* Any additional statements, data, or documents required to support commingling.

I hereby certify that the information above is true and complete to the best of my knowledge and belief.

SIGNATURE Kirk W. Spilman TITLE PETROLEUM ENGINEER DATE 7/10/96TYPE OR PRINT NAME KIRK W. SPILMAN TELEPHONE NO. ( 505 ) 397-0425

# **ATTACHMENTS**

**DISTRICT I**

P.O. Box 1980, Hobbs, NM 88241-1980

**DISTRICT II**

P.O. Box Drawer DD, Artesia, NM 88211-0719

**DISTRICT III**

1000 Rio Brazos Rd., Aztec, NM 87410

**DISTRICT IV**

P.O. Box 2088, Santa Fe, NM 87504-2088

State of New Mexico  
Energy, Minerals and Natural Resources Department**OIL CONSERVATION DIVISION**P.O. Box 2088  
Santa Fe, New Mexico 87504-2088

Form C-102

Revised February 10, 1994

Instructions on back

Submit to Appropriate District Office

State Lease - 4 Copies

Fee Lease - 3 Copies

☐ AMENDED REPORT**WELL LOCATION AND ACREAGE DEDICATION PLAT**

<sup>1</sup> API Number 30-025-33117	<sup>2</sup> Pool Code 62700	<sup>3</sup> Pool Name WANTZ ABO
<sup>4</sup> Property Code 10886	<sup>5</sup> Property Name BAKER 'B'	<sup>6</sup> Well No. 17
<sup>7</sup> OGRID Number 022351	<sup>8</sup> Operator Name TEXACO EXPLORATION & PRODUCTION INC.	<sup>9</sup> Elevation 3409' GR

<sup>10</sup> Surface Location

Ul or lot no. N	Section 10	Township 22-S	Range 37-E	Lot.Idn	Feet From The 400	North/South Line SOUTH	Feet From The 1700	East/West Line WEST	County LEA
--------------------	---------------	------------------	---------------	---------	----------------------	---------------------------	-----------------------	------------------------	---------------

<sup>11</sup> Bottom Hole Location If Different From Surface

Ul or lot no.	Section	Township	Range	Lot.Idn	Feet From The	North/South Line	Feet From The	East/West Line	County
---------------	---------	----------	-------	---------	---------------	------------------	---------------	----------------	--------

<sup>12</sup> Dedicated Acres 40	<sup>13</sup> Joint or Infill No	<sup>14</sup> Consolidation Code	<sup>15</sup> Order No.
-------------------------------------	-------------------------------------	----------------------------------	-------------------------

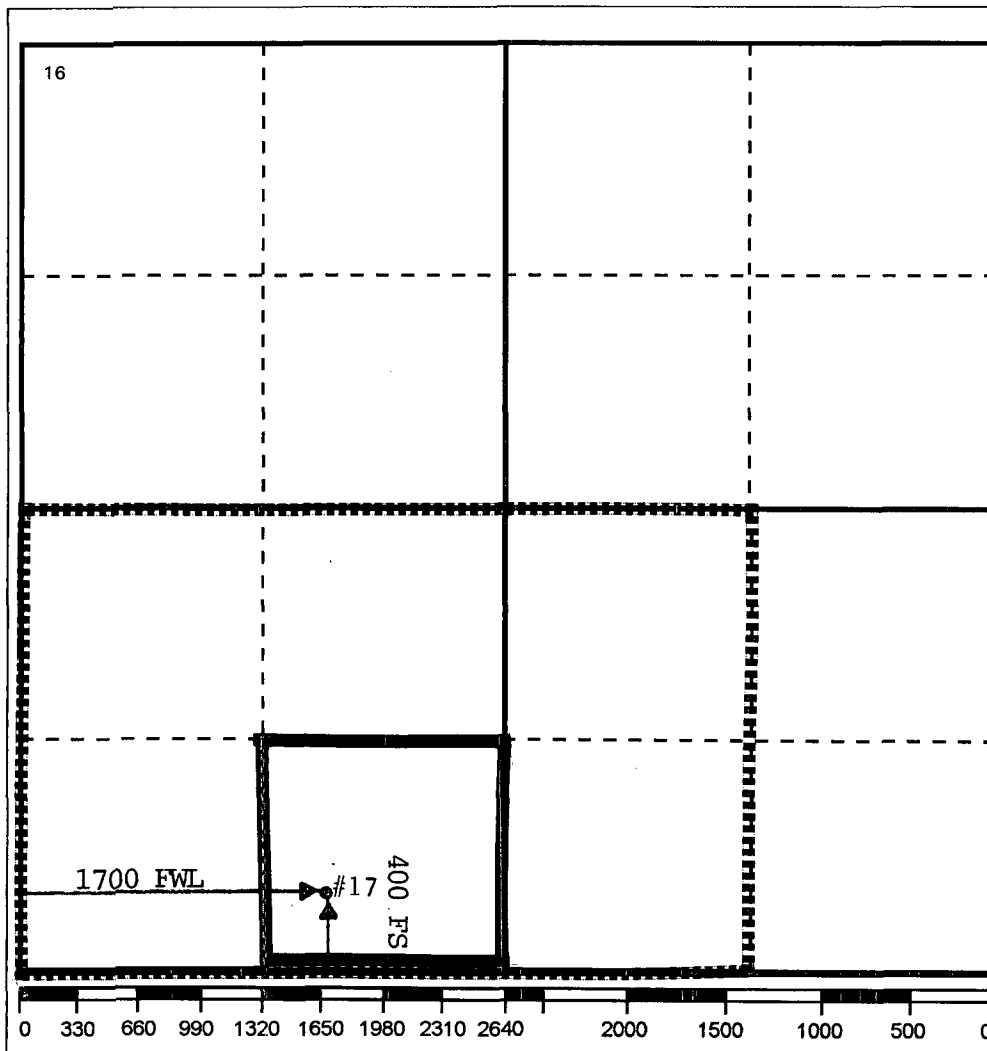
NO ALLOWABLE WILL BE ASSIGNED TO THIS COMPLETION UNTIL ALL INTERESTS HAVE BEEN CONSOLIDATED  
OR A NON-STANDARD UNIT HAS BEEN APPROVED BY THE DIVISION**17 OPERATOR CERTIFICATION**I hereby certify that the information  
contained herein is true and complete to the  
best of my knowledge and belief

Signature

Printed Name

Paula S. Ives

Position

Engineering Assistant

Date

7/10/96

**18 SURVEYOR CERTIFICATION**I hereby certify that the well location shown  
on this plat was plotted from field notes of  
actual surveys made by me or under my  
supervision, and that the same is true and  
correct to the best of my knowledge and  
belief.

Date Surveyed

Signature & Seal of  
Professional Surveyor

Certificate No.

**DISTRICT I**

P.O. Box 1980, Hobbs, NM 88241-1980

**DISTRICT II**

P.O. Box Drawer DD, Artesia, NM 88211-0719

**DISTRICT III**

1000 Rio Brazos Rd., Aztec, NM 87410

**DISTRICT IV**

P.O. Box 2088, Santa Fe, NM 87504-2088

**State of New Mexico**  
**Energy, Minerals and Natural Resources Department**

**OIL CONSERVATION DIVISION**

P.O. Box 2088  
 Santa Fe, New Mexico 87504-2088

Form C-102

Revised February 10, 1994

Instructions on back

Submit to Appropriate District Office

State Lease - 4 Copies

Fee Lease - 3 Copies

☐ AMENDED REPORT**WELL LOCATION AND ACREAGE DEDICATION PLAT**

<sup>1</sup> API Number 30-025-33117	<sup>2</sup> Pool Code 19190	<sup>3</sup> Pool Name DRINKARD
<sup>4</sup> Property Code 10886	<sup>5</sup> Property Name BAKER 'B'	<sup>6</sup> Well No. 17
<sup>7</sup> OGRID Number 022351	<sup>8</sup> Operator Name TEXACO EXPLORATION & PRODUCTION INC.	<sup>9</sup> Elevation 3409' GR

<sup>10</sup> Surface Location

Ul or lot no.	Section	Township	Range	Lot.Idn	Feet From The	North/South Line	Feet From The	East/West Line	County
N	10	22-S	37-E		400	SOUTH	1700	WEST	LEA

<sup>11</sup> Bottom Hole Location If Different From Surface

Ul or lot no.	Section	Township	Range	Lot.Idn	Feet From The	North/South Line	Feet From The	East/West Line	County

<sup>12</sup> Dedicated Acres 40	<sup>13</sup> Joint or Infill No	<sup>14</sup> Consolidation Code	<sup>15</sup> Order No.
-------------------------------------	-------------------------------------	----------------------------------	-------------------------

NO ALLOWABLE WILL BE ASSIGNED TO THIS COMPLETION UNTIL ALL INTERESTS HAVE BEEN CONSOLIDATED  
 OR A NON-STANDARD UNIT HAS BEEN APPROVED BY THE DIVISION

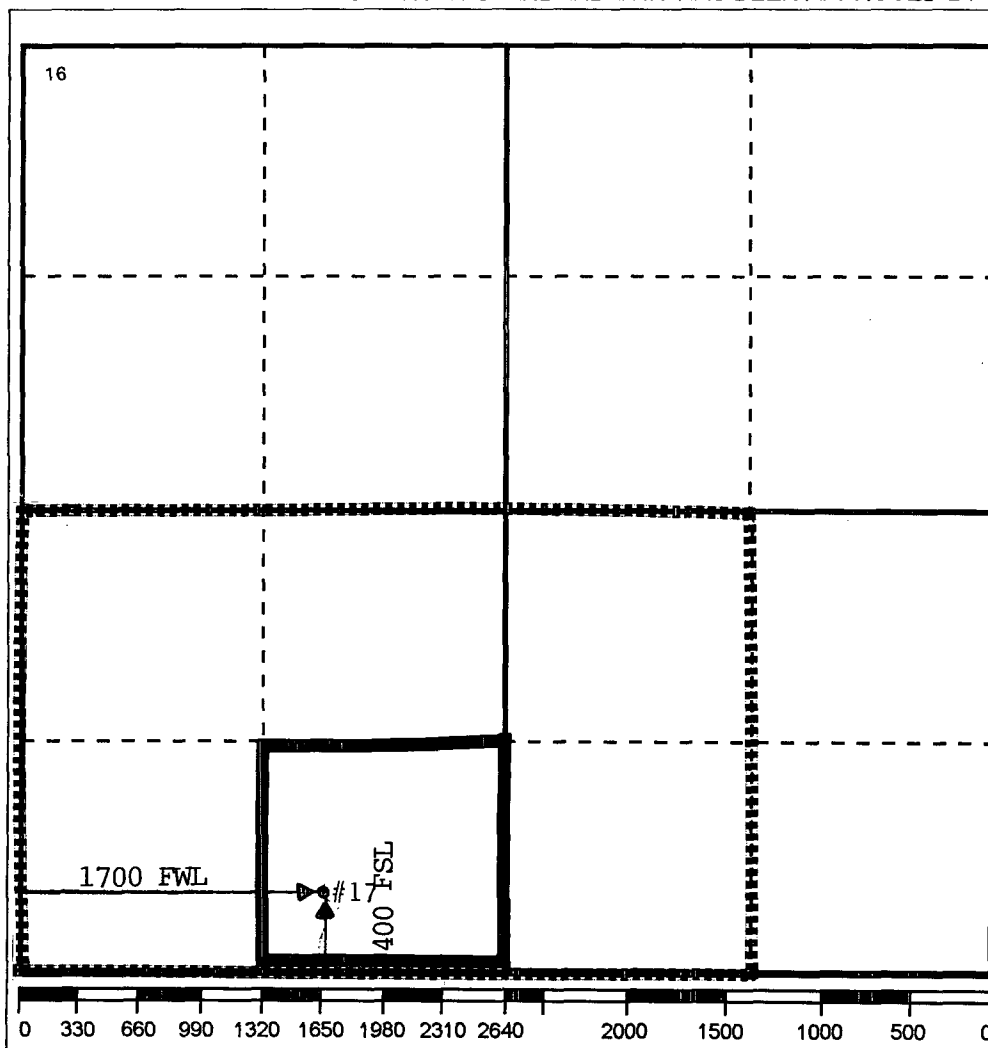
**17 OPERATOR CERTIFICATION**

I hereby certify that the information  
 contained herein is true and complete to the  
 best of my knowledge and belief

Signature

*Paula S. Ives*

Printed Name

Paula S. Ives

Position

Engineering Assistant

Date

7/10/96

**18 SURVEYOR CERTIFICATION**

I hereby certify that the well location shown  
 on this plat was plotted from field notes of  
 actual surveys made by me or under my  
 supervision, and that the same is true and  
 correct to the best of my knowledge and  
 belief.

Date Surveyed

Signature &amp; Seal of

Professional Surveyor

Certificate No.

# BAKER -B- 17 DRINKARD

TEPI NUL

LEASE DATA  
LSE 010886  
FLD 19190  
OPER TEPI  
ZONE NUL  
--  
COUNTY 025  
STATE 30

STATUS 5-96  
CO 1 MBO  
CG 19 MMCF  
CW 3 MBW  
BOPD 3  
BWPD 1  
MCFPD 0  
WELLS 1  
CI 0 MBWI  
BWIPD 0

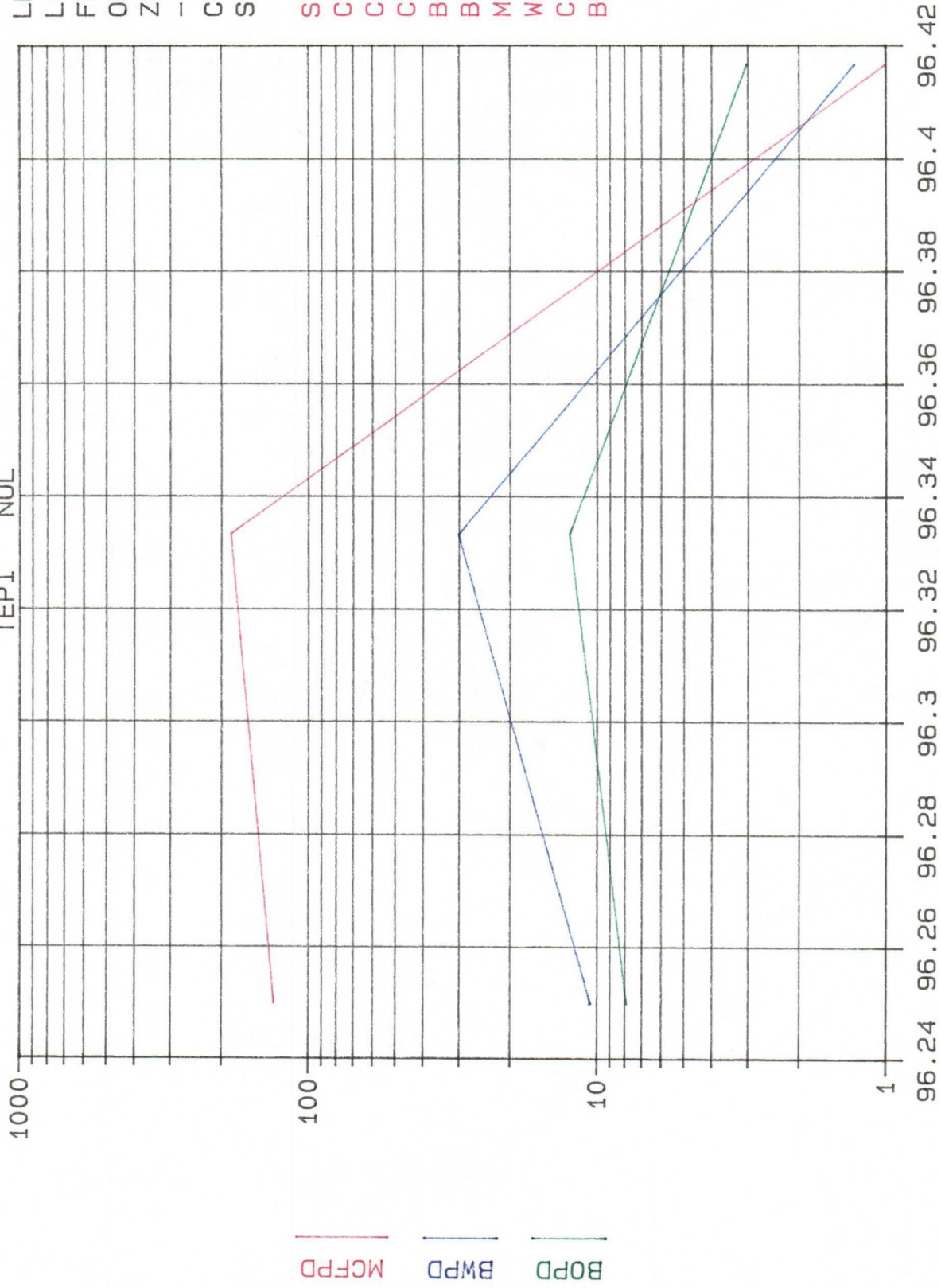

YEARS

# BAKER -B- 17 WANTZ ABO

TEPI NUL

LEASE DATA  
 LSE 010886  
 FLD 62700  
 OPER TEPI  
 ZONE NUL  
 --  
 COUNTY 025  
 STATE 30

STATUS 5-96  
 CO 1 MBO  
 CG 11 MCF  
 CW 1 MBW  
 BOPD 0  
 BWPD 0  
 MCFPD 0  
 WELLS 1  
 CI 0 MBWI  
 BWIPD 0

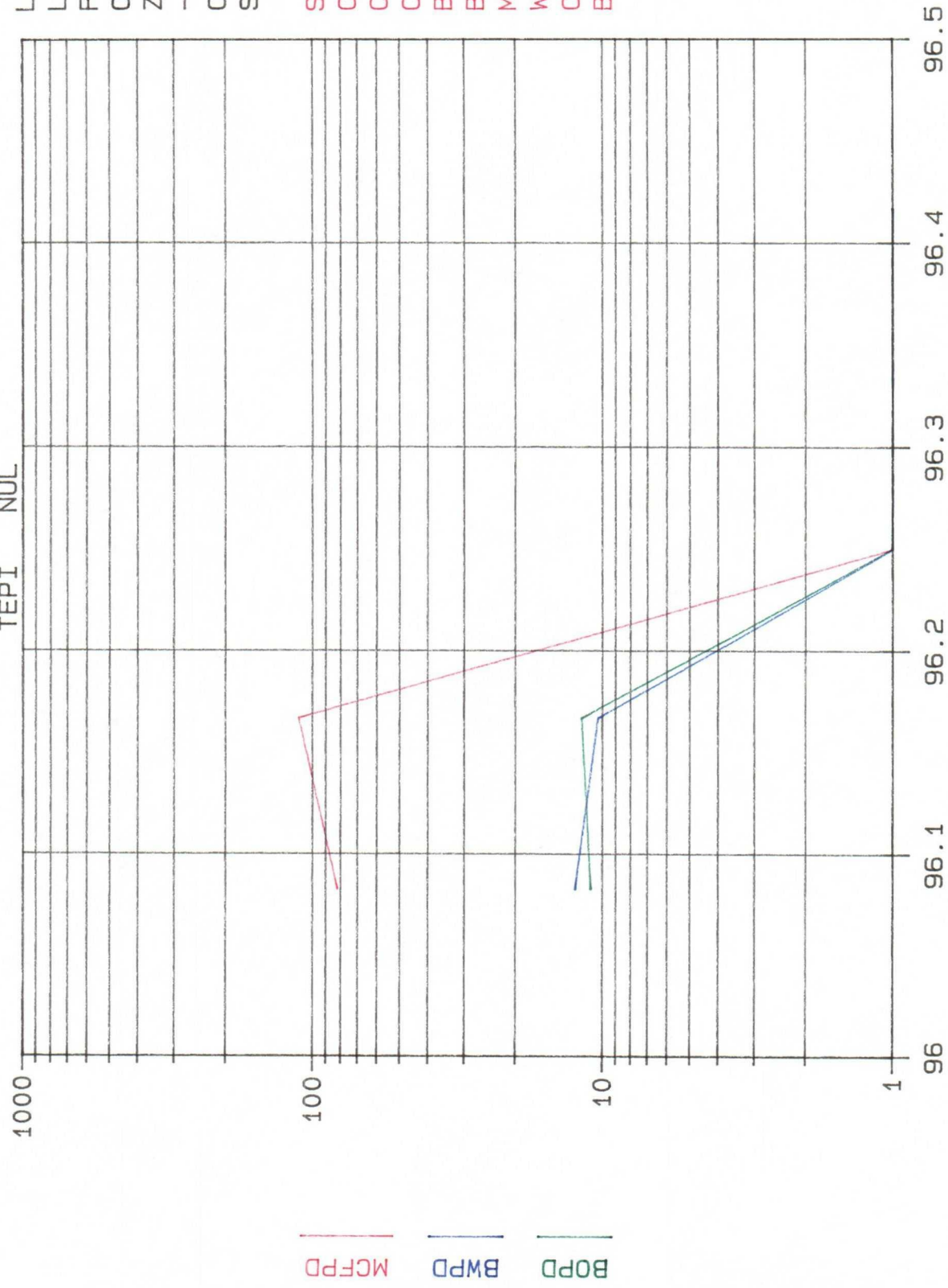

YEARS

Offset Operators and all Lessees of Record  
 Baker "B" #17 Well  
 SE/4 SW/4 of Section 10, T-22-S, R-37-E  
 Drinkard and Wantz Abo Formations  
 Lea County, New Mexico  
 April 12, 1996

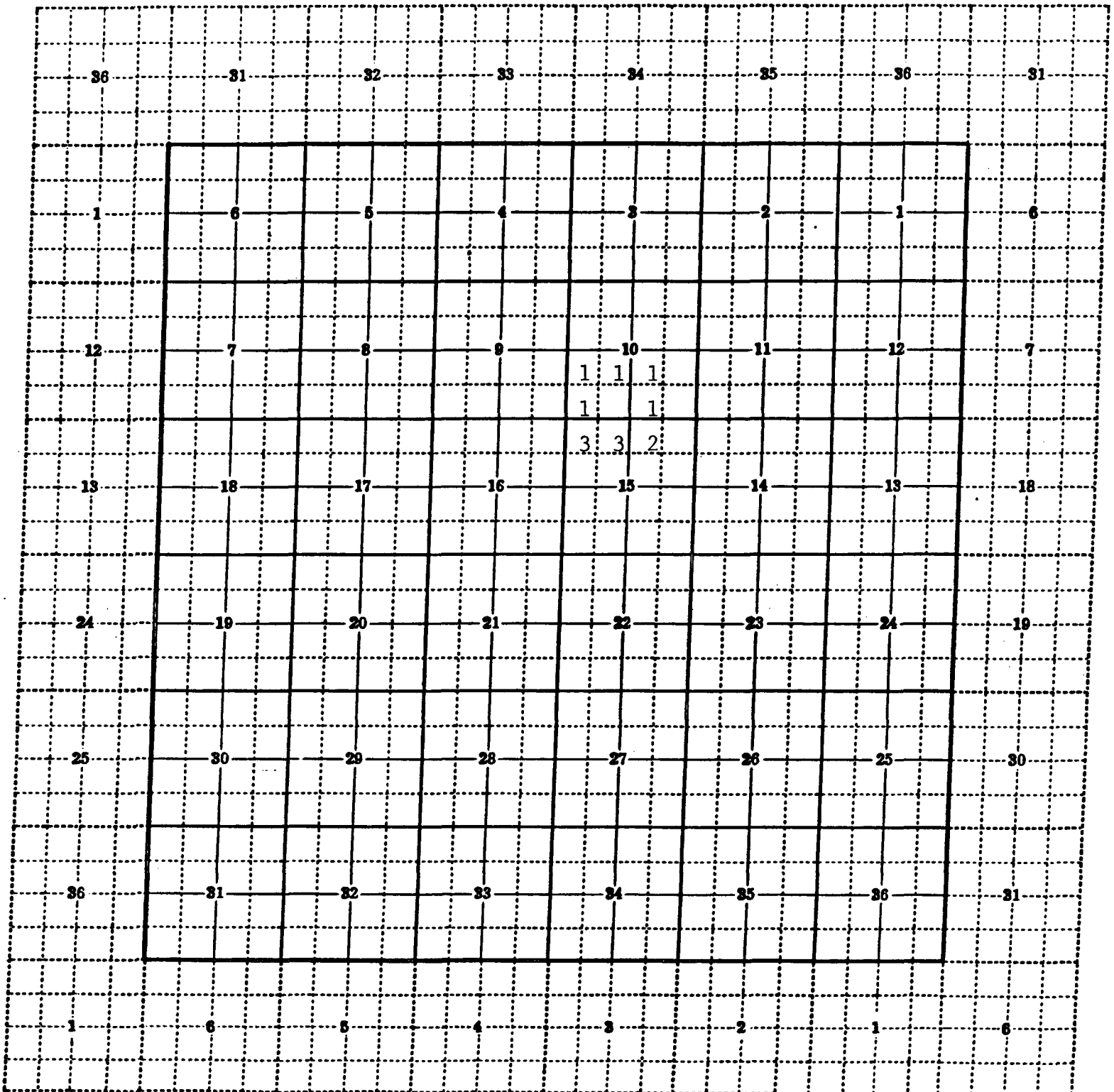



# Offset Operators and all Lessees of Record

Baker "B" #17 Well

SE/4 SW/4 of Section 10, T-22-S, R-37-E

Drinkard and Wantz Abo Formations

Lea County, New Mexico

April 12, 1996

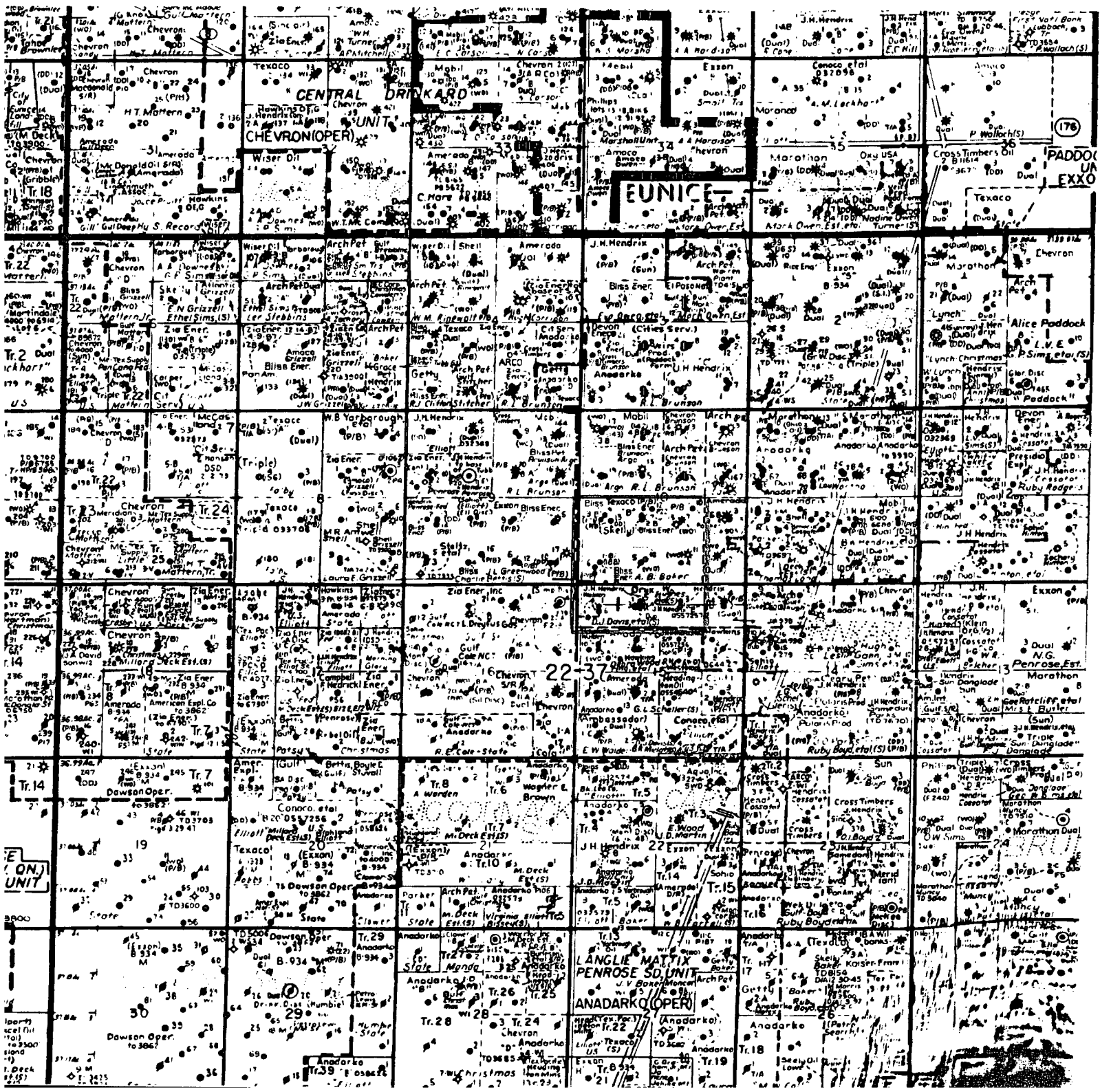

Offset Operators and all Lessees of Record  
Baker "B" #17 Well  
SE/4 SW/4 of Section 10, T-22-S, R-37-E  
Drinkard and Wantz Abo Formations  
Lea County, New Mexico  
April 12, 1996

**Number 1**

---

Texaco Exploration and Production Inc.  
P. O. Box 3109  
Midland, Texas 79702

---

**Number 2**

---

The following well is operated by:

John H. Hendrix Corporation  
110 Marienfeld St.  
Midland, Texas 79701

A) Elliott B-15 Well No. 1  
Unit Letter B, Section 15, (22-37)  
Drinkard Formation

All remaining rights are owned by the following Lessee's of record:

John H. Hendrix Corporation  
110 Marienfeld St.  
Midland, Texas 79701

Michael L. Klein and wife, Jeanne L. Klein  
500 W. Texas Ave., Suite 1230  
Midland, Texas 79701

Ronnie H. Westbrook  
2809 Haynes  
Midland, Texas 79705

Daniel L. Veirs  
110 Marienfeld St.  
Midland, Texas 79701

---

**Number 3**

---

The following well is operated by:

John H. Hendrix Corporation  
110 Marienfeld St.  
Midland, Texas 79701

A) E. W. Walden Well No. 7  
Unit Letter D, Section 15, (22-37)  
Drinkard Formation

All remaining rights are owned by the following Lessee's of record:

John H. Hendrix Corporation  
110 Marienfeld St.  
Midland, Texas 79701

Michael L. Klein and wife, Jeanne L. Klein  
500 W. Texas Ave., Suite 1230  
Midland, Texas 79701

Ronnie H. Westbrook  
2809 Haynes  
Midland, Texas 79705

Daniel L. Veirs  
110 Marienfeld St.  
Midland, Texas 79701

Trusts U/D Donaldson Brown  
% Mercantile Safe Deposit & Trust Company, Trustee  
16 West Madison Street  
Baltimore, Maryland 21201

---



Texaco E & P

205 E. Bender Blvd.  
Hobbs NM 88240  
505 393 7191

**CERTIFIED MAIL**

April 15, 1995

To: John H. Hendrix Corporation  
110 Marienfeld St.  
Midland, TX 79701

Subject: Exception to NMOCD Rule 303 (A).  
Application to Downhole Commingle  
Wantz Abo/Drinkard Pool  
Baker "B" #17  
Unit Letter N, Sec. 10, 22S, 37E  
Lea County, New Mexico

Dear Gentlemen:

Enclosed is a copy of Texaco's application for N.M. O.C.D. administrative approval to downhole commingle the above mentioned pools.

The N.M. O.C.D. regulations require that offset operators be notified before such action can be approved. Questions concerning this matter should be directed to myself at (505) 397-0425.

Sincerely,

Kirk W. Spilman  
Pertroleum Engineer  
Hobbs Operating Unit

Enclosure

## **FORMULA FOR DETERMINING ALLOCATION OF PRODUCTION**

### **OIL**

X = DRINKARD STABILIZED OIL PRODUCTION RATE, BOPD

T = TOTAL COMMINGLED, STABILIZED OIL PRODUCTION RATE, BOPD

WANTZ ABO PROD. = D = (T - X), BOPD

### **GAS**

X = DRINKARD STABILIZED GAS PRODUCTION RATE, MCFPD

T = TOTAL COMMINGLED, STABILIZED GAS PRODUCTION RATE, MCFPD

WANTZ ABO PROD. = D = (T - X), MCFPD

**\*\*ALLOCATION OF PRODUCTION WILL THEN BE BASED ON PERCENTAGE OF TOTAL PRODUCTION**

1383  
Call Kirk Sullivan  
when out  
397-0425



STATE OF NEW MEXICO  
ENERGY, MINERALS AND NATURAL RESOURCES DEPARTMENT

OIL CONSERVATION DIVISION  
HOBBS DISTRICT OFFICE

7/15/96

POST OFFICE BOX 1980  
HOBBS, NEW MEXICO 88241-1980  
(505) 393-6161

GOVERNOR

OIL CONSERVATION DIVISION  
P. O. BOX 2088  
SANTA FE, NEW MEXICO 87501

RE: Proposed:

MC	_____
DHC	_____ <i>X</i> _____
NSL	_____
NSP	_____
SWD	_____
WFX	_____
PMX	_____

Gentlemen:

I have examined the application for the:

<i>Texaco E &amp; P Inc</i>	<i>Baker B</i>	<i>#17-N</i>	<i>10-22s-37e</i>
Operator	Lease & Well No.	Unit	S-T-R

and my recommendations are as follows:

*OK*

\_\_\_\_\_

\_\_\_\_\_

\_\_\_\_\_

\_\_\_\_\_

Yours very truly,

Jerry Sexton  
Supervisor, District 1

/ed