

2/2/2015
 3/10/2015

ABOVE THIS LINE FOR DIVISION USE ONLY

NEW MEXICO OIL CONSERVATION DIVISION
 - Engineering Bureau -
 1220 South St. Francis Drive, Santa Fe, NM 87505



ADMINISTRATIVE APPLICATION CHECKLIST

THIS CHECKLIST IS MANDATORY FOR ALL ADMINISTRATIVE APPLICATIONS FOR EXCEPTIONS TO DIVISION RULES AND REGULATIONS WHICH REQUIRE PROCESSING AT THE DIVISION LEVEL IN SANTA FE

Application Acronyms:

- [NSL-Non-Standard Location] [NSP-Non-Standard Proration Unit] [SD-Simultaneous Dedication]
- [DHC-Downhole Commingling] [CTB-Lease Commingling] [PLC-Pool/Lease Commingling]
- [PC-Pool Commingling] [OLS - Off-Lease Storage] [OLM-Off-Lease Measurement]
- [WFX-Waterflood Expansion] [PMX-Pressure Maintenance Expansion]
- [SWD-Salt Water Disposal] [IPI-Injection Pressure Increase]
- [EOR-Qualified Enhanced Oil Recovery Certification] [PPR-Positive Production Response]

[1] **TYPE OF APPLICATION** - Check Those Which Apply for [A]

- [A] Location - Spacing Unit - Simultaneous Dedication
 NSL NSP SD

- C713 - 746
 - FASKEN OIL & RANCHES, LTD
 151416

Check One Only for [B] or [C]

- [B] Commingling - Storage - Measurement
 DHC CTB PLC PC OLS OLM

- [C] Injection - Disposal - Pressure Increase - Enhanced Oil Recovery
 WFX PMX SWD IPI EOR PPR

[D] Other: Specify _____

RECEIVED OGD
 2015 JUN 20 P 4:02

[2] **NOTIFICATION REQUIRED TO:** - Check Those Which Apply, or Does Not Apply

- [A] Working, Royalty or Overriding Royalty Interest Owners
- [B] Offset Operators, Leaseholders or Surface Owner
- [C] Application is One Which Requires Published Legal Notice
- [D] Notification and/or Concurrent Approval by BLM or SLO
U.S. Bureau of Land Management - Commissioner of Public Lands, State Land Office
- [E] For all of the above, Proof of Notification or Publication is Attached, and/or,
- [F] Waivers are Attached

well
 - Paloma 21 Federal
 Com 14
 30-025-41913
 - Paloma 21 Federal
 Com 24
 30-025-41994
 - Paloma 21 Federal
 Com 34
 30-025-41995
 - Paloma 21 Federal
 Com 34
 30-025-41947
 Pool
 - Lee Bunch Spring
 50444
 3758

[3] **SUBMIT ACCURATE AND COMPLETE INFORMATION REQUIRED TO PROCESS THE TYPE OF APPLICATION INDICATED ABOVE.**

[4] **CERTIFICATION:** I hereby certify that the information submitted with this application for administrative approval is **accurate** and **complete** to the best of my knowledge. I also understand that **no action** will be taken on this application until the required information and notifications are submitted to the Division.

Note: Statement must be completed by an individual with managerial and/or supervisory capacity.

Kim Tyson _____ Regulatory Analyst 1-15-2015
 Print or Type Name Signature Title Date

kimt@forl.com
 e-mail Address

District I
1625 N. French Drive, Hobbs, NM 88240
District II
811 S. First St., Artesia, NM 88210
District III
1000 Rio Brazos Road, Aztec, NM 87410
District IV
1220 S. St Francis Dr, Santa Fe, NM
87505

State of New Mexico
Energy, Minerals and Natural Resources Department

Form C-107-B
Revised August 1, 2011

OIL CONSERVATION DIVISION
1220 S. St Francis Drive
Santa Fe, New Mexico 87505

Submit the original application to the Santa Fe office with one copy to the appropriate District Office.

APPLICATION FOR SURFACE COMMINGLING (DIVERSE OWNERSHIP)

OPERATOR NAME: Fasken Oil and Ranch, Ltd.
OPERATOR ADDRESS: 6101 Holiday Hill Road, Midland, TX 79707
APPLICATION TYPE:

Pool Commingling Lease Commingling Pool and Lease Commingling Off-Lease Storage and Measurement (Only if not Surface Commingled)
LEASE TYPE: Fee State Federal

Is this an Amendment to existing Order? Yes No If "Yes", please include the appropriate Order No. _____
Have the Bureau of Land Management (BLM) and State Land office (SLO) been notified in writing of the proposed commingling
 Yes No

(A) POOL COMMINGLING
Please attach sheets with the following information

(1) Pool Names and Codes	Gravities / BTU of Non-Commingled Production	Calculated Gravities / BTU of Commingled Production		Calculated Value of Commingled Production	Volumes

(2) Are any wells producing at top allowables? Yes No
(3) Has all interest owners been notified by certified mail of the proposed commingling? Yes No.
(4) Measurement type: Metering Other (Specify)
(5) Will commingling decrease the value of production? Yes No If "yes", describe why commingling should be approved

(B) LEASE COMMINGLING
Please attach sheets with the following information

(1) Pool Name and Code. Lea; Bone Spring, South 37580
(2) Is all production from same source of supply? Yes No
(3) Has all interest owners been notified by certified mail of the proposed commingling? Yes No
(4) Measurement type: Metering Other (Specify)

(C) POOL and LEASE COMMINGLING
Please attach sheets with the following information

(1) Complete Sections A and E.

(D) OFF-LEASE STORAGE and MEASUREMENT
Please attached sheets with the following information

(1) Is all production from same source of supply? Yes No
(2) Include proof of notice to all interest owners. See attached certified receipts.

(E) ADDITIONAL INFORMATION (for all application types)
Please attach sheets with the following information

(1) A schematic diagram of facility, including legal location.
(2) A plat with lease boundaries showing all well and facility locations. Include lease numbers if Federal or State lands are involved.
(3) Lease Names, Lease and Well Numbers, and API Numbers.

I hereby certify that the information above is true and complete to the best of my knowledge and belief.

SIGNATURE: Kim Tyson TITLE: Regulatory Analyst DATE: 1-15-2015
TYPE OR PRINT NAME Kim Tyson TELEPHONE NO.: 432-687-1777
E-MAIL ADDRESS: kimt@forl.com

Surface Commingling Application Attachment

Please see attached C-102's for each well.

There is not any production on these wells yet. The Paloma "21" Federal Com Nos. 1H, 3H and 4H have been drilled and are currently waiting on completion. The Paloma "21" Federal Com Nos. 2H is currently drilling.

The Oil, Gas, and Water will all be metered separately.

The Oil will be metered with a Coralis Meter, the Gas will be metered with EFM, and the Water will be metered with a Turbine meter.

All interest owners were sent a copy of this entire Surface Commingling Application which stated that the Oil, Gas, and Water would be metered. They have been notified of the method of allocation production. Please see attached certified receipts.

DISTRICT I
1425 N. FRENCH DR., HOBBS, NM 88240
Phone: (575) 393-6181 Fax: (575) 393-0720

DISTRICT II
811 S. FIRST ST., ARTESIA, NM 88210
Phone: (575) 748-1283 Fax: (575) 748-0720

DISTRICT III
1000 RIO BRAZOS RD., AZTEC, NM 87410
Phone: (505) 334-6178 Fax: (505) 334-6170

DISTRICT IV
1220 S. ST. FRANCIS DR., SANTA FE, NM 87505
Phone: (505) 476-3400 Fax: (505) 476-3462

State of New Mexico
Energy, Minerals & Natural Resources Department
OIL CONSERVATION DIVISION
1220 SOUTH ST. FRANCIS DR.
Santa Fe, New Mexico 87505

Form C-102
Revised August 1, 2011
Submit one copy to appropriate
District Office

AMENDED REPORT

WELL LOCATION AND ACREAGE DEDICATION PLAT

API Number 30-025-41993	Pool Code 37580	Pool Name Lea Bone Spring South
Property Code	Property Name PALOMA 21 FEDERAL COM	Well Number 1H
OGRID No. 151416	Operator Name FASKEN OIL & RANCH	Elevation 3637.4

Surface Location

UL or lot No.	Section	Township	Range	Lot Idn	Feet from the	North/South line	Feet from the	East/West line	County
D	21	20-S	34-E		200	NORTH	675	WEST	LEA

Bottom Hole Location if Different From Surface

UL or lot No.	Section	Township	Range	Lot Idn	Feet from the	North/South line	Feet from the	East/West line	County
E	28	20-S	34-E		2310	NORTH	330	WEST	LEA

Dedicated Acres 2.40	Joint or Infill	Consolidation Code	Order No.
--------------------------------	-----------------	--------------------	-----------

NO ALLOWABLE WILL BE ASSIGNED TO THIS COMPLETION UNTIL ALL INTERESTS HAVE BEEN CONSOLIDATED OR A NON-STANDARD UNIT HAS BEEN APPROVED BY THE DIVISION

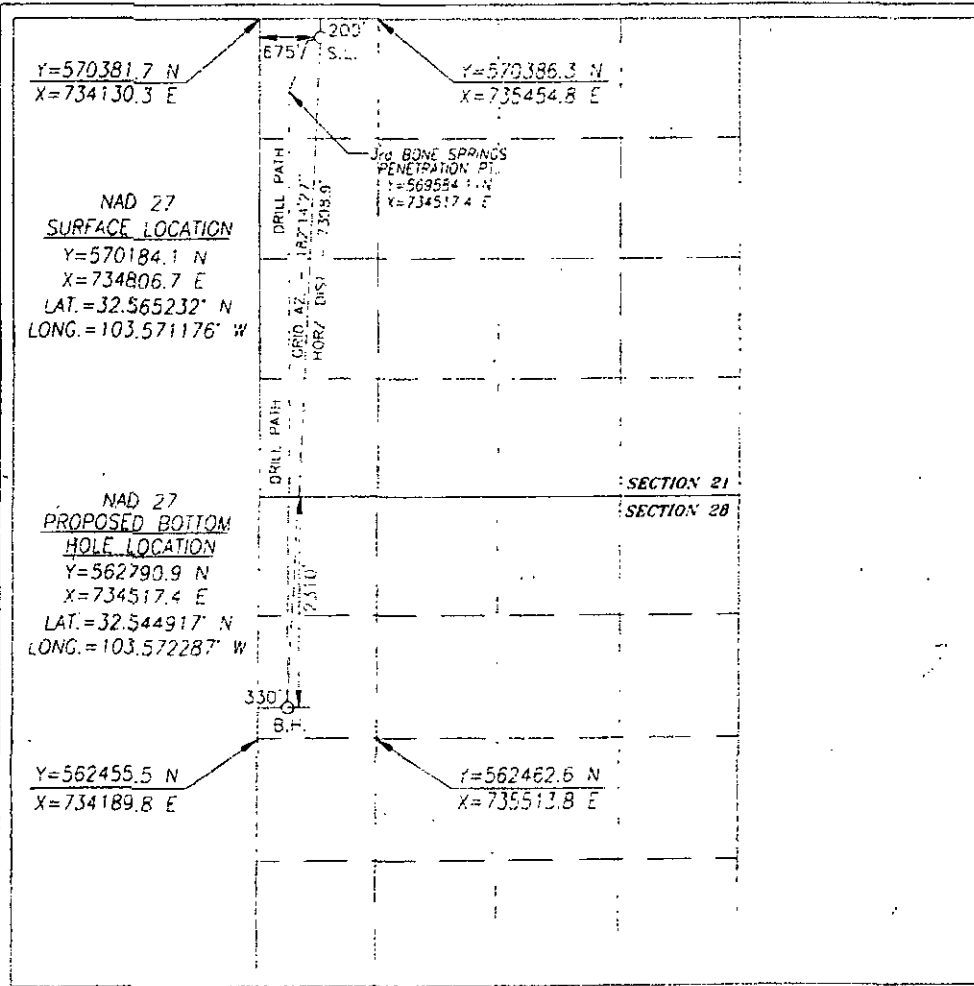

OPERATOR CERTIFICATION
I hereby certify that the information herein is true and complete to the best of my knowledge and belief, and that this organization either owns a working interest or unleased mineral interest in the land including the proposed bottom hole location or has a right to drill this well at this location pursuant to a contract with an owner of such mineral or working interest, or to a voluntary pooling agreement or a compulsory pooling order heretofore entered by the division.
Barry W. Hunt 3/11/14
Signature Date
Barry W. Hunt
Printed Name
E-mail Address

SURVEYOR CERTIFICATION
I hereby certify that the well location shown on this plat was plotted from field notes of actual surveys made by me or under my supervision, and that the same is true and correct to the best of my belief.
JANUARY 24, 2013
Date of Survey
Signature & Seal of Professional Surveyor

CHAD L. HARCROW
NEW MEXICO
LICENSED PROFESSIONAL SURVEYOR
17777
Chad L. Harcrow 3/10/14
Certificate No. CHAD HARCROW 17777
N.M. # 14-30 DRAWN BY: VD

DISTRICT I
1625 N. FRENCH DR., HOBBS, NM 88240
Phone: (575) 393-6161 Fax: (575) 393-0780

DISTRICT II
811 S. FIRST ST., ARTESIA, NM 88210
Phone: (575) 748-1263 Fax: (575) 748-0720

DISTRICT III
1000 RIO BRAZOS RD., AZTEC, NM 87410
Phone: (505) 334-6178 Fax: (505) 334-6170

DISTRICT IV
1220 S. ST. FRANCIS DR., SANTA FE, NM 87505
Phone: (505) 476-3460 Fax: (505) 476-3462

State of New Mexico
Energy, Minerals & Natural Resources Department
OIL CONSERVATION DIVISION
1220 SOUTH ST. FRANCIS DR.
Santa Fe, New Mexico 87505

Form C-102
Revised August 1, 2011
Submit one copy to appropriate
District Office

AMENDED REPORT

WELL LOCATION AND ACREAGE DEDICATION PLAT

API Number 30-025-41994	Pool Code 37580	Pool Name Lea Bone Spring South
Property Code	Property Name PALOMA 21 FEDERAL Com	Well Number 2H
OCRID No. 151416	Operator Name FASKEN OIL & RANCH	Elevation 3638.8

Surface Location

UL or lot No.	Section	Township	Range	Lot Idn	Feet from the	North/South line	Feet from the	East/West line	County
C	21	20-S	34-E		200	NORTH	1650	WEST	LEA

Bottom Hole Location If Different From Surface

UL or lot No.	Section	Township	Range	Lot Idn	Feet from the	North/South line	Feet from the	East/West line	County
F	28	20-S	34-E		2310	NORTH	1870	WEST	LEA

Dedicated Acres 240	Joint or Infill	Consolidation Code	Order No.
-------------------------------	-----------------	--------------------	-----------

NO ALLOWABLE WILL BE ASSIGNED TO THIS COMPLETION UNTIL ALL INTERESTS HAVE BEEN CONSOLIDATED OR A NON-STANDARD UNIT HAS BEEN APPROVED BY THE DIVISION

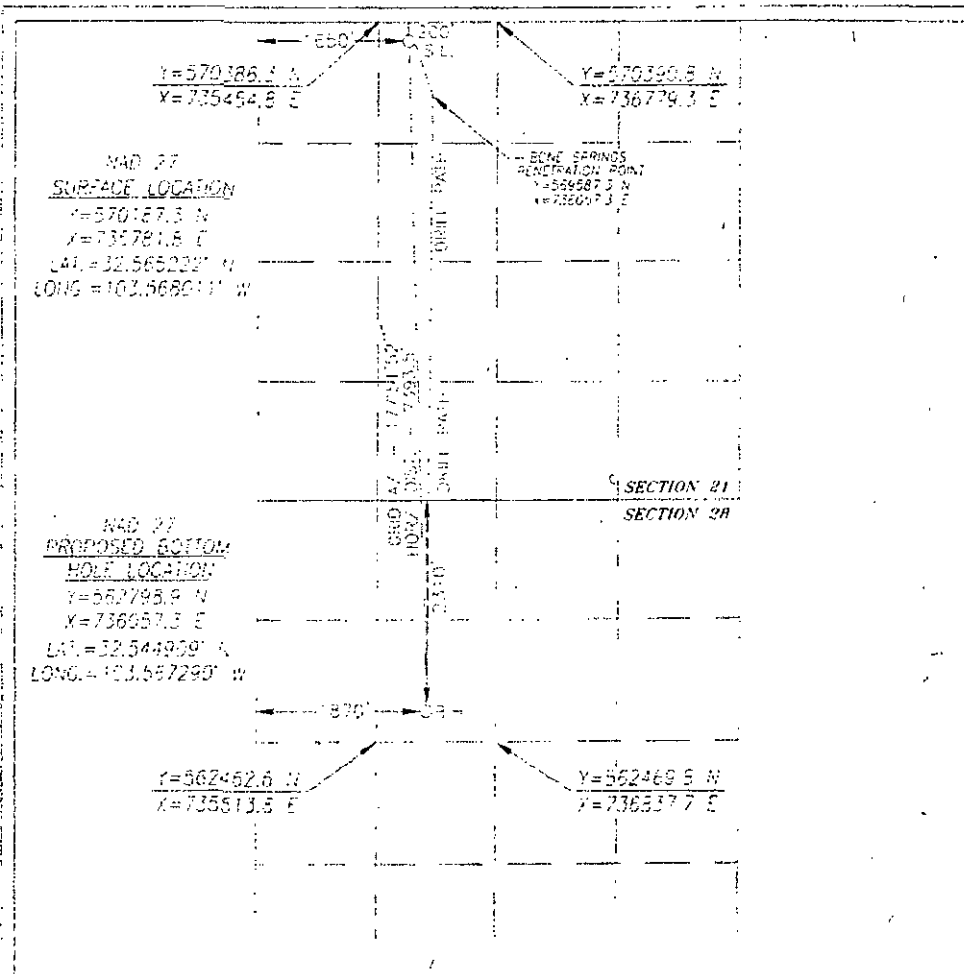

OPERATOR CERTIFICATION
I hereby certify that the information herein is true and complete to the best of my knowledge and belief, and that this organization either owns a working interest or unleased mineral interest in the land including the proposed bottom hole location or has a right to drill this well at this location pursuant to a contract with an owner of such mineral or working interest, or to a voluntary pooling agreement or a compulsory pooling order heretofore entered by the division.

Signature: *Barry W. Hunt* Date: **3/18/14**
Printed Name: **Barry W. Hunt**

SURVEYOR CERTIFICATION
I hereby certify that the well location shown on this plat was plotted from field notes of actual surveys made by me or under my supervision, and that the same is true and correct to the best of my belief.

Date of Survey: **JANUARY 24, 2013**

Signature & Seal of Professional Surveyor

Chad L. Harcrow **3/18/14**
Certificate No. **CHAD HARCROW 17777**

DISTRICT I
1625 N. FRENCH DR., HOHNS, NM 88240
Phone: (575) 383-6161 Fax: (575) 383-0720

DISTRICT II
811 S. FIRST ST., ARTESIA, NM 88210
Phone: (575) 748-1285 Fax: (575) 748-9720

DISTRICT III
1000 RIO BRAZOS RD., AZTEC, NM 87410
Phone: (505) 334-6178 Fax: (505) 334-6178

DISTRICT IV
1820 S. ST. FRANCIS DR., SANTA FE, NM 87505
Phone: (505) 476-3480 Fax: (505) 476-3482

State of New Mexico
Energy, Minerals & Natural Resources Department

OIL CONSERVATION DIVISION
1220 SOUTH ST. FRANCIS DR.
Santa Fe, New Mexico 87505

Form C-102
Revised August 1, 2011
Submit one copy to appropriate
District Office

AMENDED REPORT

WELL LOCATION AND ACREAGE DEDICATION PLAT

API Number 30-025-41945	Pool Code 37580	Pool Name Lea Bone Spring South
Property Code	Property Name PALOMA 21 FEDERAL COM	Well Number 3H
OGRID No. 151416	Operator Name FASKEN OIL & RANCH	Elevation 3641.5

Surface Location

UL or lot No.	Section	Township	Range	Lot Idn	Feet from the	North/South line	Feet from the	East/West line	County
B	21	20-S	34-E		350	NORTH	2200	EAST	LEA

Bottom Hole Location If Different From Surface

UL or lot No.	Section	Township	Range	Lot Idn	Feet from the	North/South line	Feet from the	East/West line	County
G	28	20-S	34-E		2310	NORTH	1870	EAST	LEA

Dedicated Acres 240	Joint or Infill	Consolidation Code	Order No.
-------------------------------	-----------------	--------------------	-----------

NO ALLOWABLE WILL BE ASSIGNED TO THIS COMPLETION UNTIL ALL INTERESTS HAVE BEEN CONSOLIDATED OR A NON-STANDARD UNIT HAS BEEN APPROVED BY THE DIVISION

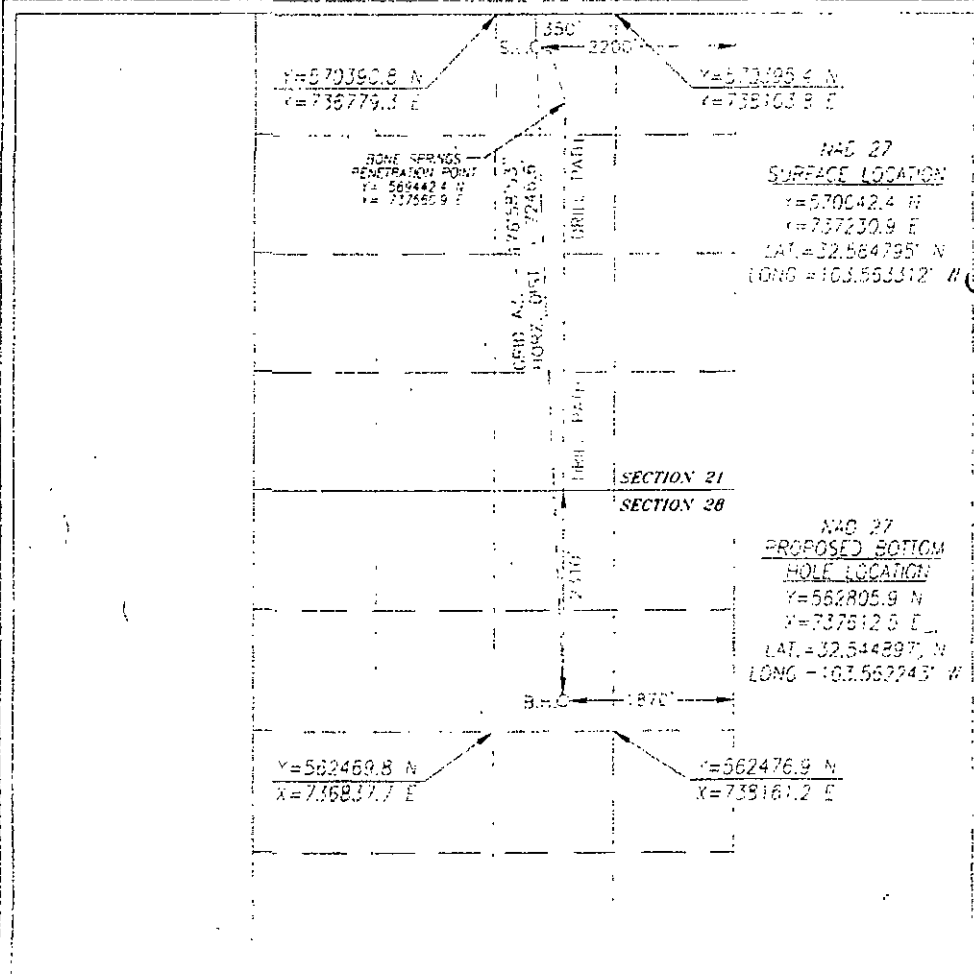

OPERATOR CERTIFICATION
I hereby certify that the information herein is true and complete to the best of my knowledge and belief, and that this organization either owns a working interest or unleased mineral interest in the land including the proposed bottom hole location or has a right to drill this well at this location pursuant to a contract with an owner of such mineral or working interest, or to a voluntary pooling agreement or a compulsory pooling order heretofore entered by the division.

Barry W. Hunt 3/18/14
Signature Date
Barry W. Hunt
Printed Name

E-mail Address

SURVEYOR CERTIFICATION
I hereby certify that the well location shown on this plat was plotted from field notes of actual surveys made by me or under my supervision, and that the same is true and correct to the best of my belief.
JANUARY 24, 2013
Date of Survey

Signature & Seal of Professional Surveyor



Chad L. Harcrow 3/18/14
Certificate No. **CHAD HARCROW 17777**

DISTRICT I
1025 N. FRANCIS DR., ROOM 204, SANTA FE, NM 87500
Phone: (505) 833-6181 Fax: (505) 833-0728

DISTRICT II
511 E. WILSON ST., ALBUQUERQUE, NM 87102
Phone: (505) 743-1283 Fax: (505) 743-0728

DISTRICT III
1000 E. BRAZOS RD., ALBUQUERQUE, NM 87102
Phone: (505) 224-6173 Fax: (505) 224-6170

DISTRICT IV
1225 S. W. BURNHAM BL., SANTA FE, NM 87505
Phone: (505) 476-1400 Fax: (505) 476-6122

State of New Mexico
Energy, Minerals & Natural Resources Department
OIL CONSERVATION DIVISION
1220 SOUTH ST. FRANCIS DR.
Santa Fe, New Mexico 87505

Form C-102
Revised August 1, 2011
Submit one copy to appropriate
District Office

AMENDED REPORT

WELL LOCATION AND ACREAGE DEDICATION PLAT

API Number 30-025-41947	Pool Code 37580	Pool Name Lea; Bone Spring, South
Property Code	Property Name PALOMA 21 FEDERAL COM	Well Number 4H
OGRD No. 151416	Operator Name FASKEN OIL & RANCH	Elevation 3643.1

Surface Location

UL or lot No.	Section	Township	Range	Lot Idn	Feet from the	North/South line	Feet from the	East/West line	County
A	21	20-S	34-E		200	NORTH	185	EAST	LEA

Bottom Hole Location if Different From Surface

UL or lot No.	Section	Township	Range	Lot Idn	Feet from the	North/South line	Feet from the	East/West line	County
H	28	20-S	34-E		2309	NORTH	330	EAST	LEA

Dedicated Acres 240	Joint or Infill	Consolidation Code	Order No.
-------------------------------	-----------------	--------------------	-----------

NO ALLOWABLE WILL BE ASSIGNED TO THIS COMPLETION UNTIL ALL INTERESTS HAVE BEEN CONSOLIDATED
OR A NON-STANDARD UNIT HAS BEEN APPROVED BY THE DIVISION

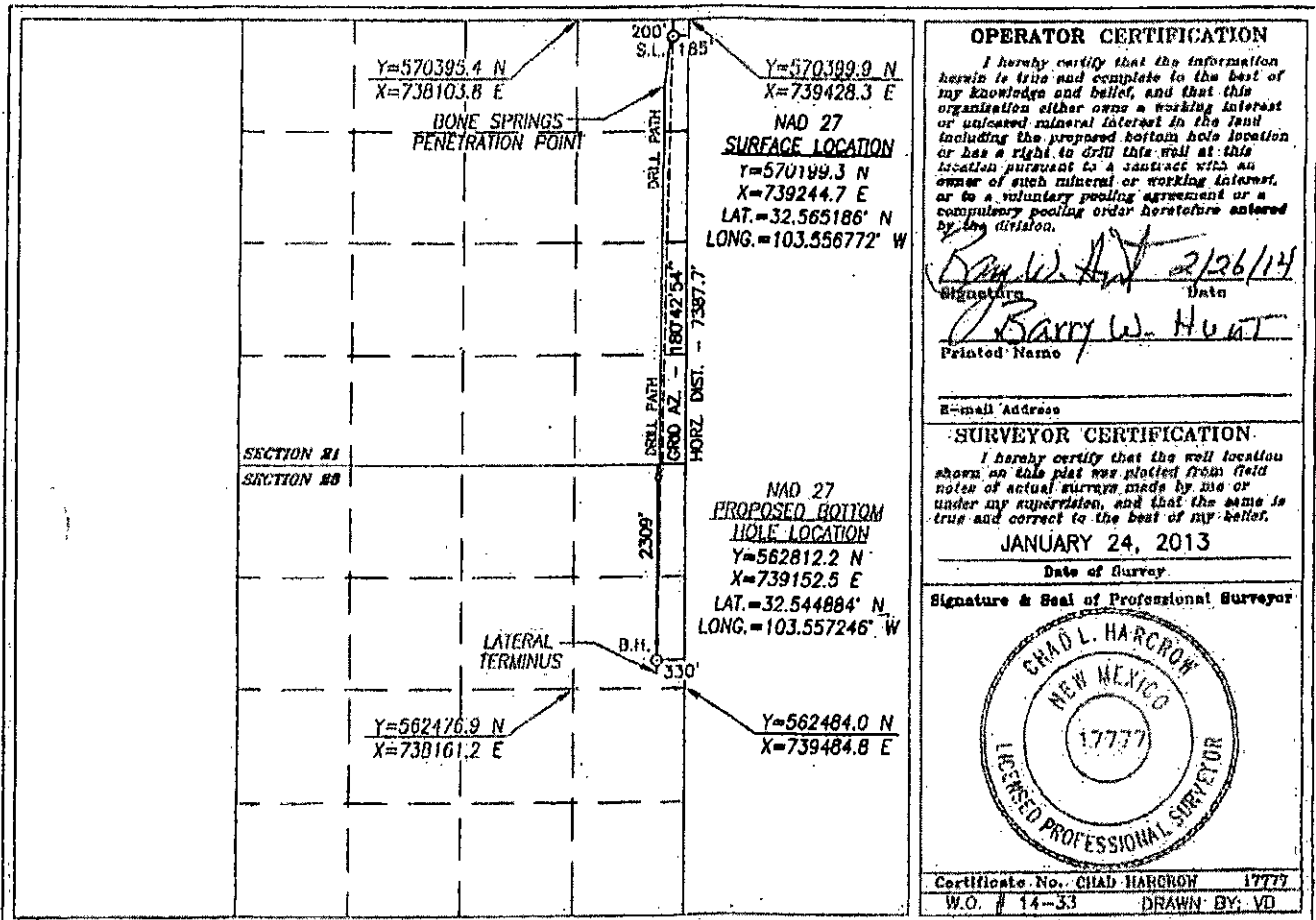

OPERATOR CERTIFICATION
I hereby certify that the information herein is true and complete to the best of my knowledge and belief, and that this organization either owns a working interest or unleased mineral interest in the land including the proposed bottom hole location or has a right to drill this well at this location pursuant to a contract with an owner of such mineral or working interest, or to a voluntary pooling agreement or a compulsory pooling order heretofore entered by the division.
Signature: *Barry W. Hunt* Date: **2/26/14**
Printed Name: **Barry W. Hunt**

SURVEYOR CERTIFICATION
I hereby certify that the well location shown on this plat was plotted from field notes of actual surveys made by me or under my supervision, and that the same is true and correct to the best of my belief.
Date of Survey: **JANUARY 24, 2013**

Signature & Seal of Professional Surveyor
CHAD L. HARGROW
NEW MEXICO
LICENSED PROFESSIONAL SURVEYOR
17777
Certificate No. **CHAD HARGROW 17777**
W.O. # 14-33 DRAWN BY: VD

T-20-S, R-34-E Lea CO NM

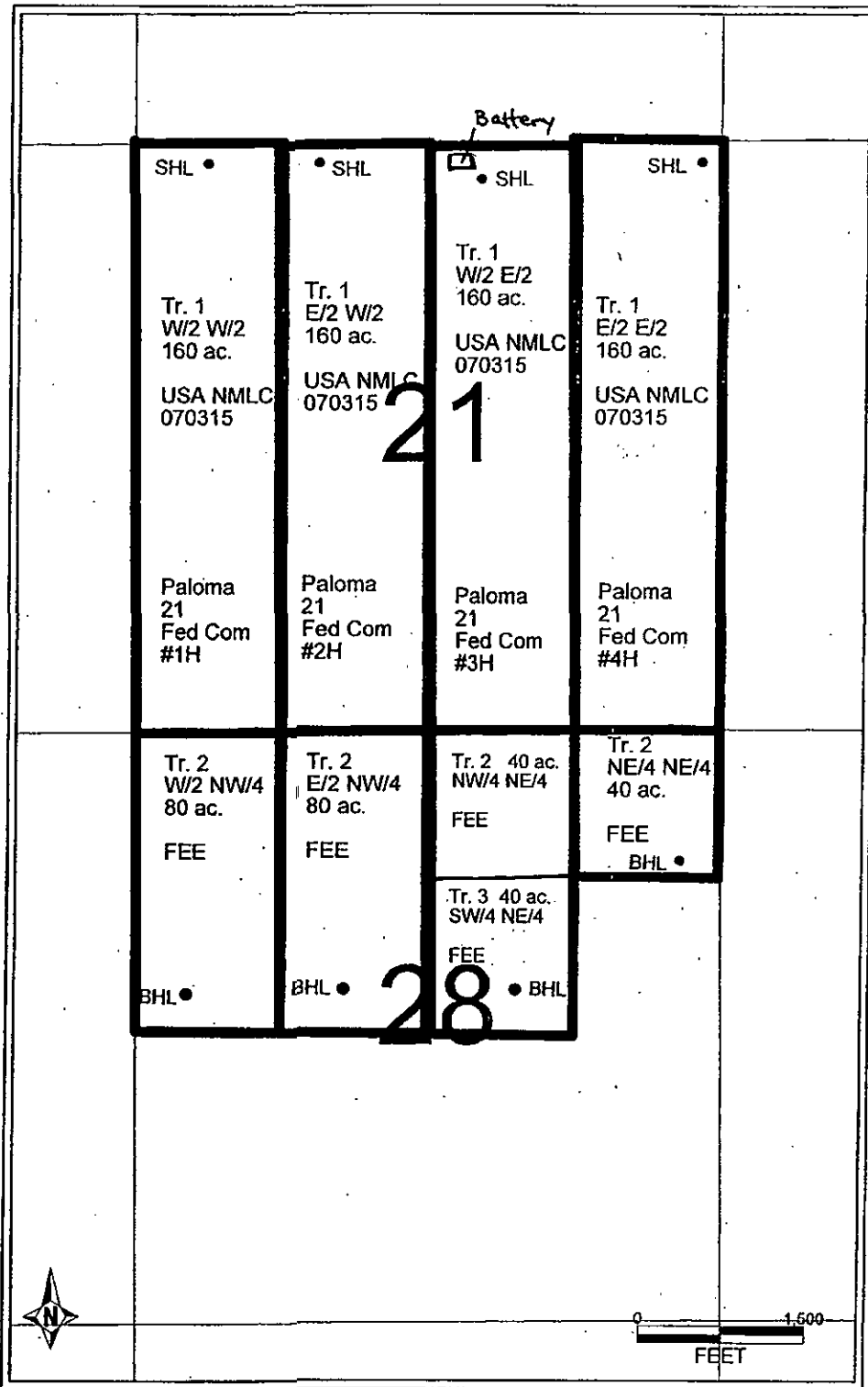

**Well Identification Information
Attachment for Section E3**

Lease

Paloma "21" Federal Com

Well Identification Information

Paloma "21" Federal Com No. 1H

<u>API Number</u>	<u>Lease Number</u>	<u>Unit Letter</u>	<u>Section</u>	<u>Township</u>	<u>Range</u>	<u>County</u>
30-025-41993	LC-070315	D	21	20S	34E	Lea

Footages from lease lines

200' FNL & 675' FWL

Bottom Hole Location

Unit Letter – E, 2310' FNL & 330' FWL, Section 28, T20S, R34E, Lea County

Well Identification Information

Paloma "21" Federal Com No. 2H

<u>API Number</u>	<u>Lease Number</u>	<u>Unit Letter</u>	<u>Section</u>	<u>Township</u>	<u>Range</u>	<u>County</u>
30-025-41994	LC-070315	C	21	20S	34E	Lea

Footages from lease lines

200' FNL & 1650' FWL

Bottom Hole Location

Unit Letter – F, 2310' FNL & 1870' FWL, Section 28, T20S, R34E, Lea County

Well Identification Information

Paloma "21" Federal Com No. 3H

<u>API Number</u>	<u>Lease Number</u>	<u>Unit Letter</u>	<u>Section</u>	<u>Township</u>	<u>Range</u>	<u>County</u>
30-025-41995	LC-070315	B	21	20S	34E	Lea

Footages from lease lines

350' FNL & 2200' FEL

Bottom Hole Location

Unit Letter – G, 2310' FNL & 1870' FEL, Section 28, T20S, R34E, Lea County

Well Identification Information

Paloma "21" Federal Com No. 4H

<u>API Number</u>	<u>Lease Number</u>	<u>Unit Letter</u>	<u>Section</u>	<u>Township</u>	<u>Range</u>	<u>County</u>
30-025-41947	LC-070315	A	21	20S	34E	Lea

Footages from lease lines

200' FNL & 185' FEL

Bottom Hole Location

Unit Letter – H, 2309' FNL & 330' FEL, Section 28, T20S, R34E, Lea County

The battery is located at the Paloma "21" Federal Com No. 3H. Unit Letter B, Section 21, T20S, R34E, Lea County

Fasken Oil and Ranch, Ltd.
Surface Commingle Application for Paloma "21" Federal Com No. 1H,
2H, 3H, & 4H
List of Notified Parties

Crown Oil Partners V, LP
Crump Energy Partners II, LLC
P.O. Box 50820
Midland, TX 79710
Attn: Brian Hall

Featherstone Development Corp.
Prospector LLC
Big Three Energy Group LLC
P.O. Box 429
Roswell, NM 88202
Attn: Olen Featherstone, III

Ross Duncan Properties LLC
P.O. Box 647
Artesia, NM 88211-0647

Brian C. & Katherine A. Reid
2502 Camarie
Midland, TX 79705

Roy G. Barton, Jr.
Roy G. Barton, Trustee of
Roy G. Barton Sr. and Opal Barton Trust
1919 N. Turner Street
Hobbs, NM 88241

MRC Permian
5400 LBJ Freeway, Suite 1500
Dallas, TX 75240

The Blanco Company
P.O. Box 25968
Albuquerque, NM 87125

Eve Levich Bistrin, Trustee of the Eve
Levich Bistrin Trust
c/o Anita Bistrin
2665 Lode St.
Santa Cruz, CA 95062

Henry Thomas Frazor
3610 Colosseum Way
Grand Prairie, TX 75052

Roy B. Frazor aka Bennie Frazor
424 Honolulu Road,
Dexter, NM 88230

Alta Jean Youngblood
424 Honolulu Road
Dexter, NM 88230

Elizabeth Ann Johnson
6800 Cordova Circle.
Las Cruces, NM 88007

Rebecca Lynn Reese
6522 San Blas Place
Albuquerque, NM 87120

Angela Marie Reese
230 Bicentennial Way
Santa Rosa, CA 95403

Laurie Juanita Scott
7219 Dancing Eagle Avenue
Albuquerque, NM 87113

E. L. Latham Company
P.O. Box 1392
Hobbs, NM 88240

Mary Ann Rosenberg Weems
Linda Jena Rosenberg
9317 Ironshore NE
Albuquerque, NM 87111-6435

Williamson Enterprises
P.O. Box 32570
Santa Fe, NM 87594-2570

Donald R. Graham
1500 Ventura Ave.
Midland, TX 79705

Linda Johnson
P.O. Box 3145
McAlester, OK 74501

Margaret Ruth Wilson
1228 Fearnow Avenue
Pueblo, CO 81001

Brenda Jean Gill Sherrill,
Trustee of the William Wayne Gill Family
Trust
Trustee of the William Wayne Gill Survivor
Trust
9804 Uxbridge Avenue
Lubbock, TX 79424

Jason Elkan
7811 E. Rovey Ave.
Scottsdale, AZ 85250

Edward Armstrong Elkan III
P.O. Box 67315
Albuquerque, NM 87114

Clara Irene Elkan Vucetic
7503 Bay Laurel Court
Dublin, CA 94568

Norma J. Chanley
P.O. Box 728
Hobbs, NM 88240

Wells Fargo Bank, N.A.
Agent for Desert Waterfall LLC
Oil, Gas & Mineral Management
P.O. Box 1959
Midland, TX 79702-1959

Wells Fargo Bank, N.A.
Trustee of the Alston Elkan Trust
Oil, Gas & Mineral Management
P.O. Box 1959
Midland, TX 79702-1959

Wells Fargo Bank, N.A.
Trustee of the Adriana Elkan Trust
Oil, Gas & Mineral Management
P.O. Box 1959
Midland, TX 79702-1959

Blind Side, LLC
P.O. Box 429
Roswell, NM 88202

Panhandle Properties, LLC
P.O. Box 647
Artesia, NM 88211

Watts Properties, LLC
P.O. Box 2367
Roswell, NM 88202

Harold Alston Elkan and
Nancy Hastings Elkan
3731 Shade Tree Terrace
Portage, MI 49024-1036

Robert P. Byron and Jeannine Hooper Byron
Trustees of the Robert and Jeannine Byron
Revocable Trust
u/t/a dated June 18, 2003
P.O. Box 1562
Roswell, NM 88202-1562

David J. Sorenson
P.O. Box 1453
Roswell, NM 88202-1453

Christine Ann Elkan
20361 Presley Grove Drive
Porter, TX 77365

Wilma Donohue Moleen Foundation
c/o J. P. Morgan Chase Bank, N.A., Trustee
P.O. Box 2605
Fort Worth, TX 76113
Attn: Buffie Campbell

La Palma Associates, LLC
c/o Crystal Van Lom, DVM.
Amici Pet Hospital of Little Italy
2135 Columbia St.
San Diego, CA 92101

LOSB Inc.
C/O Ken Cambern, President
1900 Evergreen
Pampa, TX 79065

John Thomas
P.O. Box 6881
San Antonio, Texas 78209

Bureau of Land Management
620 E. Greene Street
Carlsbad, NM 88220

7013 1090 0000 5647 6654

U.S. Postal Service™
CERTIFIED MAIL™ RECEIPT
(Domestic Mail Only; No Insurance Coverage Provided)

For delivery information visit our website at www.usps.com

OFFICIAL USE

Postage	\$ 1.61
Certified Fee	3.30
Return Receipt Fee (Endorsement Required)	2.70
Restricted Delivery Fee (Endorsement Required)	
Total Postage & Fees	\$ 7.61

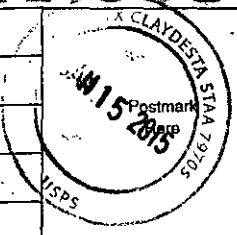

Sent To **Panhandle Properties, LLC**
 Street, Apt. or PO Box I **P.O. Box 647**
 City, State **Artesia, NM 88211**

PS Form 3843

7013 1090 0000 5647 6579

U.S. Postal Service™
CERTIFIED MAIL™ RECEIPT
(Domestic Mail Only; No Insurance Coverage Provided)

For delivery information visit our website at www.usps.com

OFFICIAL USE

Postage	\$ 1.61
Certified Fee	3.30
Return Receipt Fee (Endorsement Required)	2.70
Restricted Delivery Fee (Endorsement Required)	
Total Postage & Fees	\$ 7.61

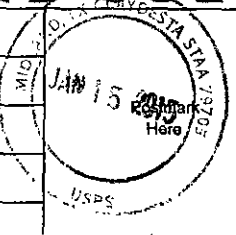

Sent To **LOSB Inc.**
 Street, Apt. or PO Box **C/O Ken Cambern, President**
 City, State **1900 Evergreen**
Pampa, TX 79065

PS Form 3843

7013 1090 0000 5647 6593

U.S. Postal Service™
CERTIFIED MAIL™ RECEIPT
(Domestic Mail Only; No Insurance Coverage Provided)

For delivery information visit our website at www.usps.com

OFFICIAL USE

Postage	\$ 1.61
Certified Fee	3.30
Return Receipt Fee (Endorsement Required)	2.70
Restricted Delivery Fee (Endorsement Required)	
Total Postage & Fees	\$ 7.61

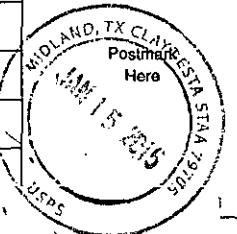

Sent To **Attn: Buffie Campbell**
 Street, Apt. or PO Box **Wilma Donohue Moleen Foundation**
 City, State **c/o J. P. Morgan Chase Bank, N.A.,**
Trustee
P.O. Box 2605
Fort Worth, TX 76113

PS Form 3843

7013 1090 0000 5647 6562

U.S. Postal Service™
CERTIFIED MAIL™ RECEIPT
(Domestic Mail Only; No Insurance Coverage Provided)

For delivery information visit our website at www.usps.com

OFFICIAL USE

Postage	\$ 1.61
Certified Fee	3.30
Return Receipt Fee (Endorsement Required)	2.70
Restricted Delivery Fee (Endorsement Required)	
Total Postage & Fees	\$ 7.61

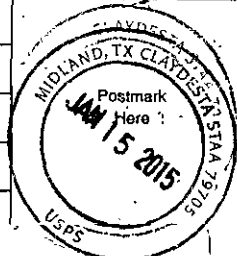

Sent To **John Thomas**
 Street, Apt. or PO Box **P.O. Box 6881**
 City, State **San Antonio, Texas 78209**

PS Form 3843

7013 1090 0000 5647 6609

U.S. Postal Service™
CERTIFIED MAIL™ RECEIPT
(Domestic Mail Only; No Insurance Coverage Provided)

For delivery information visit our website at www.usps.com

OFFICIAL USE

Postage	\$ 1.61
Certified Fee	3.30
Return Receipt Fee (Endorsement Required)	2.70
Restricted Delivery Fee (Endorsement Required)	
Total Postage & Fees	\$ 7.61

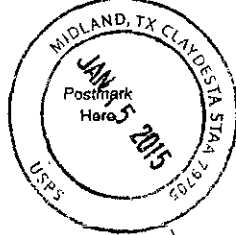

Sent To **Christine Ann Elkan**
 Street, Apt. or PO Box **20361 Presley Grove Drive**
 City, State **Porter, TX 77365**

PS Form 3843

7013 1090 0000 5647 6589

U.S. Postal Service™
CERTIFIED MAIL™ RECEIPT
(Domestic Mail Only; No Insurance Coverage Provided)

For delivery information visit our website at www.usps.com

OFFICIAL USE

Postage	\$ 1.61
Certified Fee	3.30
Return Receipt Fee (Endorsement Required)	2.70
Restricted Delivery Fee (Endorsement Required)	
Total Postage & Fees	\$ 7.61

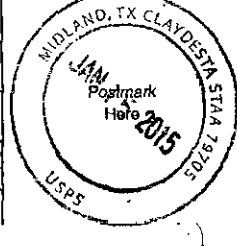

Sent To **La Palma Associates, LLC**
 Street, Apt. or PO Box **c/o Crystal Van Lom, DVM.**
 City, State **Amici Pet Hospital of Little Italy**
2135 Columbia St.
San Diego, CA 92101

PS Form 3843

7013 1090 0000 5647 6629

U.S. Postal Service™
CERTIFIED MAIL™ RECEIPT
(Domestic Mail Only; No Insurance Coverage Provided)

For delivery information visit our website at www.usps.com

OFFICIAL USE

Postage	\$ 1.61
Certified Fee	3.30
Return Receipt Fee (Endorsement Required)	2.70
Restricted Delivery Fee (Endorsement Required)	
Total Postage & Fees	\$ 7.61

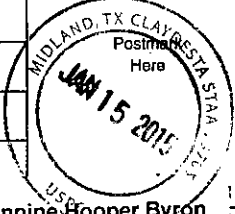

Sent To: Robert P. Byron and Jeannine Hooper Byron
Trustees of the Robert and Jeannine Byron
Revocable Trust
u/t/a dated June 18, 2003
P.O. Box 1562
Roswell, NM 88202-1562

7013 1090 0000 5647 6619

U.S. Postal Service™
CERTIFIED MAIL™ RECEIPT
(Domestic Mail Only; No Insurance Coverage Provided)

For delivery information visit our website at www.usps.com

OFFICIAL USE

Postage	\$ 1.61
Certified Fee	3.30
Return Receipt Fee (Endorsement Required)	2.70
Restricted Delivery Fee (Endorsement Required)	
Total Postage & Fees	\$ 7.61

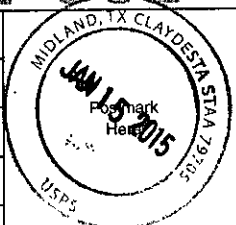

Sent To: David J. Sorenson
P.O. Box 1453
Roswell, NM 88202-1453

7013 1090 0000 5647 6647

U.S. Postal Service™
CERTIFIED MAIL™ RECEIPT
(Domestic Mail Only; No Insurance Coverage Provided)

For delivery information visit our website at www.usps.com

OFFICIAL USE

Postage	\$ 1.61
Certified Fee	3.30
Return Receipt Fee (Endorsement Required)	2.70
Restricted Delivery Fee (Endorsement Required)	
Total Postage & Fees	\$ 7.61

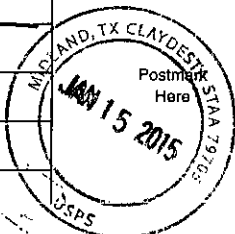

Sent To: Watts Properties, LLC
P.O. Box 2367
Roswell, NM 88202

7013 1090 0000 5647 6630

U.S. Postal Service™
CERTIFIED MAIL™ RECEIPT
(Domestic Mail Only; No Insurance Coverage Provided)

For delivery information visit our website at www.usps.com

OFFICIAL USE

Postage	\$ 1.61
Certified Fee	3.30
Return Receipt Fee (Endorsement Required)	2.70
Restricted Delivery Fee (Endorsement Required)	
Total Postage & Fees	\$ 7.61

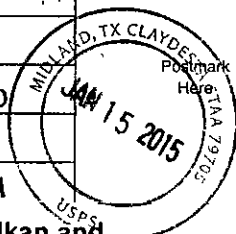

Sent To: Harold Alston Elkan and
Nancy Hastings Elkan
3731 Shade Tree Terrace
Portage, MI 49024-1036

7013 1090 0000 5647 6688

U.S. Postal Service™
CERTIFIED MAIL™ RECEIPT
(Domestic Mail Only; No Insurance Coverage Provided)

For delivery information visit our website at www.usps.com

OFFICIAL USE

Postage	\$ 1.61
Certified Fee	3.30
Return Receipt Fee (Endorsement Required)	2.70
Restricted Delivery Fee (Endorsement Required)	
Total Postage & Fees	\$ 7.61

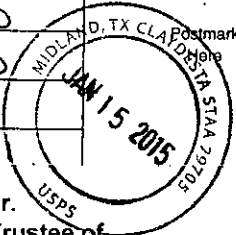

Sent To: Roy G. Barton, Jr.
Roy G. Barton, Trustee of
Roy G. Barton Sr. and Opal Barton Trust
1919 N. Turner Street
Hobbs, NM 88241

7013 1090 0000 5647 6555

U.S. Postal Service™
CERTIFIED MAIL™ RECEIPT
(Domestic Mail Only; No Insurance Coverage Provided)

For delivery information visit our website at www.usps.com

OFFICIAL USE

Postage	\$ 1.61
Certified Fee	3.30
Return Receipt Fee (Endorsement Required)	2.70
Restricted Delivery Fee (Endorsement Required)	
Total Postage & Fees	\$ 7.61

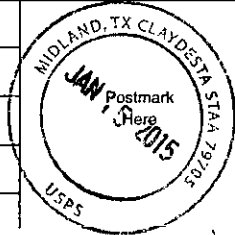

Sent To: Bureau of Land Management
620 E. Greene Street
Carlsbad, NM 88220

7013 1090 0000 5647 6876

U.S. Postal Service™
CERTIFIED MAIL™ RECEIPT
(Domestic Mail Only; No Insurance Coverage Provided)

For delivery information visit our website at www.usps.com

OFFICIAL USE

Postage	\$ 1.61
Certified Fee	3.30
Return Receipt Fee (Endorsement Required)	2.70
Restricted Delivery Fee (Endorsement Required)	
Total Postage & Fees	\$ 7.61

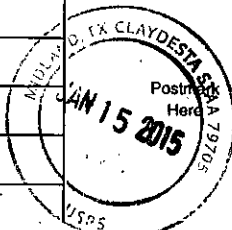

Sent To
The Blanco Company
 P.O. Box 25968
 Albuquerque, NM 87125

PS Form

ctions

7013 1090 0000 5647 6876

U.S. Postal Service™
CERTIFIED MAIL™ RECEIPT
(Domestic Mail Only; No Insurance Coverage Provided)

For delivery information visit our website at www.usps.com

OFFICIAL USE

Postage	\$ 1.61
Certified Fee	3.30
Return Receipt Fee (Endorsement Required)	2.70
Restricted Delivery Fee (Endorsement Required)	
Total Postage & Fees	\$ 7.61

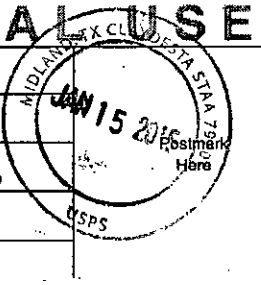

Sent To
MRC Permian
 5400 LBJ Freeway, Suite 1500
 Dallas, TX 75240

PS Form

ctions

7013 1090 0000 5647 6845

U.S. Postal Service™
CERTIFIED MAIL™ RECEIPT
(Domestic Mail Only; No Insurance Coverage Provided)

For delivery information visit our website at www.usps.com

OFFICIAL USE

Postage	\$ 1.61
Certified Fee	3.30
Return Receipt Fee (Endorsement Required)	2.70
Restricted Delivery Fee (Endorsement Required)	
Total Postage & Fees	\$ 7.61

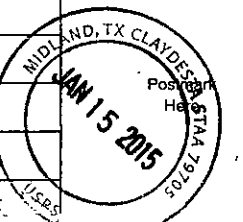

Sent To
Alta Jean Youngblood
 424 Honolulu Road
 Dexter, NM 88230

PS Form

ctions

7013 1090 0000 5647 6845

U.S. Postal Service™
CERTIFIED MAIL™ RECEIPT
(Domestic Mail Only; No Insurance Coverage Provided)

For delivery information visit our website at www.usps.com

OFFICIAL USE

Postage	\$ 1.61
Certified Fee	3.30
Return Receipt Fee (Endorsement Required)	2.70
Restricted Delivery Fee (Endorsement Required)	
Total Postage & Fees	\$ 7.61

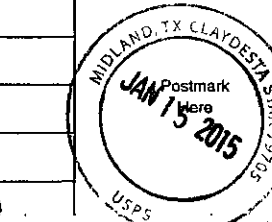

Sent To
Roy B. Frazor aka Bennie Frazor
 424 Honolulu Road,
 Dexter, NM 88230

PS Form

ctions

7013 1090 0000 5647 6821

U.S. Postal Service™
CERTIFIED MAIL™ RECEIPT
(Domestic Mail Only; No Insurance Coverage Provided)

For delivery information visit our website at www.usps.com

OFFICIAL USE

Postage	\$ 1.61
Certified Fee	3.30
Return Receipt Fee (Endorsement Required)	2.70
Restricted Delivery Fee (Endorsement Required)	
Total Postage & Fees	\$ 7.61

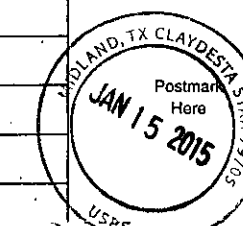

Sent To
Rebecca Lynn Reese
 6522 San Blas Place
 Albuquerque, NM 87120

PS Form

ctions

7013 1090 0000 5647 6821

U.S. Postal Service™
CERTIFIED MAIL™ RECEIPT
(Domestic Mail Only; No Insurance Coverage Provided)

For delivery information visit our website at www.usps.com

OFFICIAL USE

Postage	\$ 1.61
Certified Fee	3.30
Return Receipt Fee (Endorsement Required)	2.70
Restricted Delivery Fee (Endorsement Required)	
Total Postage & Fees	\$ 7.61

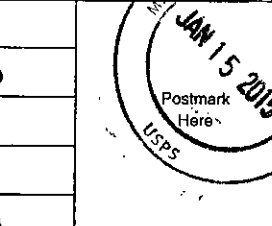

Sent To
Elizabeth Ann Johnson
 6800 Cordova Circle
 Las Cruces, NM 88007

PS Form

ctions

7013 1090 0000 5647 6807

U.S. Postal Service™
CERTIFIED MAIL™ RECEIPT
(Domestic Mail Only; No Insurance Coverage Provided)

For delivery information visit our website at www.usps.com

OFFICIAL USE

Postage	\$ 1.61
Certified Fee	3.30
Return Receipt Fee (Endorsement Required)	2.70
Restricted Delivery Fee (Endorsement Required)	
Total Postage & Fees	\$ 7.61

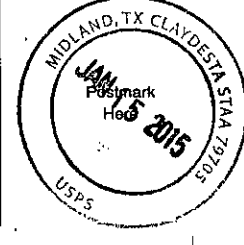

Sent To
Laurie Juanita Scott
 7219 Dancing Eagle Avenue
 Albuquerque, NM 87113

Street, Apt. or PO Box
 City, State

PS Form 3800, April 2008

7013 1090 0000 5647 6814

U.S. Postal Service™
CERTIFIED MAIL™ RECEIPT
(Domestic Mail Only; No Insurance Coverage Provided)

For delivery information visit our website at www.usps.com

OFFICIAL USE

Postage	\$ 1.61
Certified Fee	3.30
Return Receipt Fee (Endorsement Required)	2.70
Restricted Delivery Fee (Endorsement Required)	
Total Postage & Fees	\$ 7.61

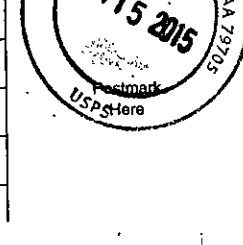

Sent To
Angela Marie Reese
 230 Bicentennial Way
 Santa Rosa, CA 95403

Street, Apt. or PO Box
 City, State

PS Form 3800, April 2008

7013 1090 0000 5647 6824

U.S. Postal Service™
CERTIFIED MAIL™ RECEIPT
(Domestic Mail Only; No Insurance Coverage Provided)

For delivery information visit our website at www.usps.com

OFFICIAL USE

Postage	\$ 1.61
Certified Fee	3.30
Return Receipt Fee (Endorsement Required)	2.70
Restricted Delivery Fee (Endorsement Required)	
Total Postage & Fees	\$ 7.61

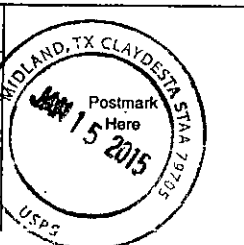

Sent To
Mary Ann Rosenberg Weems
Linda Jena Rosenberg
 9317 Ironshore NE
 Albuquerque, NM 87111-6435

Street, Apt. or PO Box
 City, State

PS Form 3800, April 2008

7013 1090 0000 5647 6791

U.S. Postal Service™
CERTIFIED MAIL™ RECEIPT
(Domestic Mail Only; No Insurance Coverage Provided)

For delivery information visit our website at www.usps.com

OFFICIAL USE

Postage	\$ 1.61
Certified Fee	3.30
Return Receipt Fee (Endorsement Required)	2.70
Restricted Delivery Fee (Endorsement Required)	
Total Postage & Fees	\$ 7.61

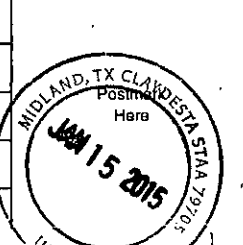

Sent To
E. L. Latham Company
 P.O. Box 1392
 Hobbs, NM 88240

Street, Apt. or PO Box
 City, State

PS Form 3800, April 2008

7013 1090 0000 5647 6760

U.S. Postal Service™
CERTIFIED MAIL™ RECEIPT
(Domestic Mail Only; No Insurance Coverage Provided)

For delivery information visit our website at www.usps.com

OFFICIAL USE

Postage	\$ 1.61
Certified Fee	3.30
Return Receipt Fee (Endorsement Required)	2.70
Restricted Delivery Fee (Endorsement Required)	
Total Postage & Fees	\$ 7.61

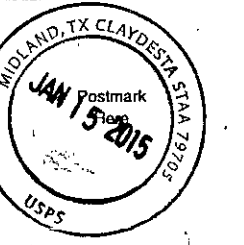

Sent To
Donald R. Graham
 1500 Ventura Ave.
 Midland, TX 79705

Street, Apt. or PO Box
 City, State

PS Form 3800, April 2008

7013 1090 0000 5647 6777

U.S. Postal Service™
CERTIFIED MAIL™ RECEIPT
(Domestic Mail Only; No Insurance Coverage Provided)

For delivery information visit our website at www.usps.com

OFFICIAL USE

Postage	\$ 1.61
Certified Fee	3.30
Return Receipt Fee (Endorsement Required)	2.70
Restricted Delivery Fee (Endorsement Required)	
Total Postage & Fees	\$ 7.61

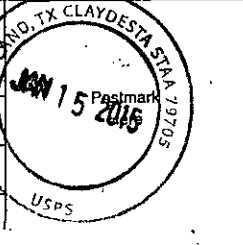

Sent To
Williamson Enterprises
 P.O. Box 32570
 Santa Fe, NM 87594-2570

Street, Apt. or PO Box
 City, State

PS Form 3800, April 2008

U.S. Postal Service™
CERTIFIED MAIL™ RECEIPT
 (Domestic Mail Only; No Insurance Coverage Provided)

For delivery information visit our website at www.usps.com®

OFFICIAL USE

Postage	\$ 1.61
Certified Fee	3.30
Return Receipt Fee (Endorsement Required)	2.70
Restricted Delivery Fee (Endorsement Required)	
Total Postage & Fees	\$ 7.61

MIDLAND, TX CLAYDESTA STA 79705
 JAN 15 2015
 Postmark Here
 USPS

Sent To: Attn: Brian Hall
 Crown Oil Partners V, LP
 Crump Energy Partners II, LLC
 P.O. Box 50820
 Midland, TX 79710

PS Form 3800, October 2010

U.S. Postal Service™
CERTIFIED MAIL™ RECEIPT
 (Domestic Mail Only; No Insurance Coverage Provided)

For delivery information visit our website at www.usps.com®

OFFICIAL USE

Postage	\$ 1.61
Certified Fee	3.30
Return Receipt Fee (Endorsement Required)	2.70
Restricted Delivery Fee (Endorsement Required)	
Total Postage & Fees	\$ 7.61

MIDLAND, TX CLAYDESTA STA 79705
 JAN 15 2015
 Postmark Here
 USPS

Sent To: Linda Johnson
 P.O. Box 3145
 McAlester, OK 74501

PS Form 3800, October 2010

U.S. Postal Service™
CERTIFIED MAIL™ RECEIPT
 (Domestic Mail Only; No Insurance Coverage Provided)

For delivery information visit our website at www.usps.com®

OFFICIAL USE

Postage	\$ 1.61
Certified Fee	3.30
Return Receipt Fee (Endorsement Required)	2.70
Restricted Delivery Fee (Endorsement Required)	
Total Postage & Fees	\$ 7.61

MIDLAND, TX CLAYDESTA STA 79705
 JAN 15 2015
 Postmark Here
 USPS

Sent To: Henry Thomas Frazor
 3610 Colosseum Way
 Grand Prairie, TX 75052

PS Form 3800, October 2010

U.S. Postal Service™
CERTIFIED MAIL™ RECEIPT
 (Domestic Mail Only; No Insurance Coverage Provided)

For delivery information visit our website at www.usps.com®

OFFICIAL USE

Postage	\$ 1.61
Certified Fee	3.30
Return Receipt Fee (Endorsement Required)	2.70
Restricted Delivery Fee (Endorsement Required)	
Total Postage & Fees	\$ 7.61

MIDLAND, TX CLAYDESTA STA 79705
 JAN 15 2015
 Postmark Here
 USPS

Sent To: Attn: Olen Featherstone, III
 Featherstone Development Corp.
 Prospector LLC
 Big Three Energy Group LLC
 P.O. Box 429
 Roswell, NM 88202

PS Form 3800, October 2010

U.S. Postal Service™
CERTIFIED MAIL™ RECEIPT
 (Domestic Mail Only; No Insurance Coverage Provided)

For delivery information visit our website at www.usps.com®

OFFICIAL USE

Postage	\$ 1.61
Certified Fee	3.30
Return Receipt Fee (Endorsement Required)	2.70
Restricted Delivery Fee (Endorsement Required)	
Total Postage & Fees	\$ 7.61

MIDLAND, TX CLAYDESTA STA 79705
 JAN 15 2015
 Postmark Here
 USPS

Sent To: Ross Duncan Properties LLC
 P.O. Box 647
 Artesia, NM 88211-0647

PS Form 3800, October 2010

U.S. Postal Service™
CERTIFIED MAIL™ RECEIPT
 (Domestic Mail Only; No Insurance Coverage Provided)

For delivery information visit our website at www.usps.com®

OFFICIAL USE

Postage	\$ 1.61
Certified Fee	3.30
Return Receipt Fee (Endorsement Required)	2.70
Restricted Delivery Fee (Endorsement Required)	
Total Postage & Fees	\$ 7.61

MIDLAND, TX CLAYDESTA STA 79705
 JAN 15 2015
 Postmark Here
 USPS

Sent To: Eve Levich Bistrin, Trustee of the Eve
 Levich Bistrin Trust
 c/o Anita Bistrin
 2665 Lode St.
 Santa Cruz, CA 95062

PS Form 3800, October 2010

7013 1090 0000 5647 6746

U.S. Postal Service™
CERTIFIED MAIL™ RECEIPT
(Domestic Mail Only; No Insurance Coverage Provided)

For delivery information visit our website at www.usps.com
OFFICIAL USE

Postage	\$ 1.61
Certified Fee	3.30
Return Receipt Fee (Endorsement Required)	2.70
Restricted Delivery Fee (Endorsement Required)	
Total Postage & Fees	\$ 7.61

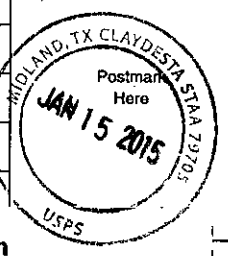

Sent To **Margaret Ruth Wilson**
1228 Fearnow Avenue
Pueblo, CO 81001

7013 1090 0000 5647 6690

U.S. Postal Service™
CERTIFIED MAIL™ RECEIPT
(Domestic Mail Only; No Insurance Coverage Provided)

For delivery information visit our website at www.usps.com
OFFICIAL USE

Postage	\$ 1.61
Certified Fee	3.30
Return Receipt Fee (Endorsement Required)	2.70
Restricted Delivery Fee (Endorsement Required)	
Total Postage & Fees	\$ 7.61

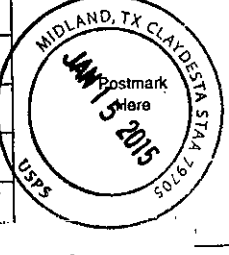

Sent To **Brian C. & Katherine A. Reid**
2502 Camarie
Midland, TX 79705

7013 1090 0000 5647 6722

U.S. Postal Service™
CERTIFIED MAIL™ RECEIPT
(Domestic Mail Only; No Insurance Coverage Provided)

For delivery information visit our website at www.usps.com
OFFICIAL USE

Postage	\$ 1.61
Certified Fee	3.30
Return Receipt Fee (Endorsement Required)	2.70
Restricted Delivery Fee (Endorsement Required)	
Total Postage & Fees	\$ 7.61

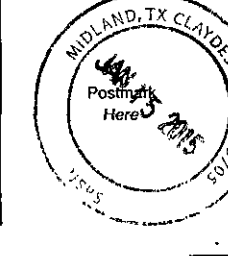

Sent To **Jason Elkan**
7811 E. Rovey Ave.
Scottsdale, AZ 85250

7013 1090 0000 5647 6739

U.S. Postal Service™
CERTIFIED MAIL™ RECEIPT
(Domestic Mail Only; No Insurance Coverage Provided)

For delivery information visit our website at www.usps.com
OFFICIAL USE

Postage	\$ 1.61
Certified Fee	3.30
Return Receipt Fee (Endorsement Required)	2.70
Restricted Delivery Fee (Endorsement Required)	
Total Postage & Fees	\$ 7.61

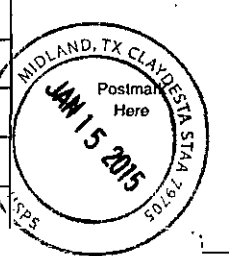

Sent To **Brenda Jean Gill Sherrill,**
Trustee of the William Wayne Gill Family Trust
Trustee of the William Wayne Gill Survivor
Trust
9804 Uxbridge Avenue
Lubbock, TX 79424

7013 1090 0000 5647 6524

U.S. Postal Service™
CERTIFIED MAIL™ RECEIPT
(Domestic Mail Only; No Insurance Coverage Provided)

For delivery information visit our website at www.usps.com
OFFICIAL USE

Postage	\$ 1.61
Certified Fee	3.30
Return Receipt Fee (Endorsement Required)	2.70
Restricted Delivery Fee (Endorsement Required)	
Total Postage & Fees	\$ 7.61

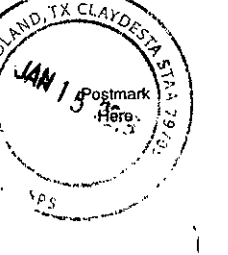

Sent To **Clara Irene Elkan Vucetic**
7503 Bay Laurel Court
Dublin, CA 94568

7013 1090 0000 5647 6715

U.S. Postal Service™
CERTIFIED MAIL™ RECEIPT
(Domestic Mail Only; No Insurance Coverage Provided)

For delivery information visit our website at www.usps.com
OFFICIAL USE

Postage	\$ 1.61
Certified Fee	3.30
Return Receipt Fee (Endorsement Required)	2.70
Restricted Delivery Fee (Endorsement Required)	
Total Postage & Fees	\$ 7.61

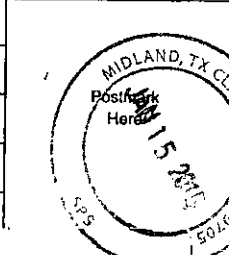

Sent To **Edward Armstrong Elkan III**
P.O. Box 67315
Albuquerque, NM 87114

7013 1090 0000 5647 6692

U.S. Postal Service™
CERTIFIED MAIL™ RECEIPT
 (Domestic Mail Only; No Insurance Coverage Provided)

For delivery information visit our website at www.usps.com

OFFICIAL USE

Postage	\$ 1.61
Certified Fee	3.30
Return Receipt Fee (Endorsement Required)	2.70
Restricted Delivery Fee (Endorsement Required)	
Total Postage & Fees	\$ 7.61

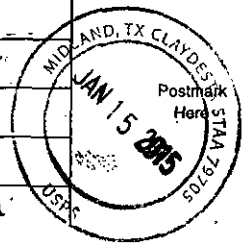

Sent To: **Wells Fargo Bank, N.A.**
 Agent for Desert Waterfall LLC
 Oil, Gas & Mineral Management
 P.O. Box 1959
 Midland, TX 79702-1959

7013 1090 0000 5647 6702

U.S. Postal Service™
CERTIFIED MAIL™ RECEIPT
 (Domestic Mail Only; No Insurance Coverage Provided)

For delivery information visit our website at www.usps.com

OFFICIAL USE

Postage	\$ 1.61
Certified Fee	3.30
Return Receipt Fee (Endorsement Required)	2.70
Restricted Delivery Fee (Endorsement Required)	
Total Postage & Fees	\$ 7.61

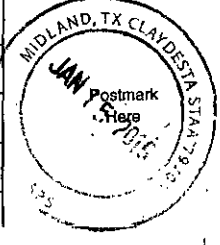

Sent To: **Norma J. Chanley**
 P.O. Box 728
 Hobbs, NM 88240

7013 1090 0000 5647 6678

U.S. Postal Service™
CERTIFIED MAIL™ RECEIPT
 (Domestic Mail Only; No Insurance Coverage Provided)

For delivery information visit our website at www.usps.com

OFFICIAL USE

Postage	\$ 1.61
Certified Fee	3.30
Return Receipt Fee (Endorsement Required)	2.70
Restricted Delivery Fee (Endorsement Required)	
Total Postage & Fees	\$ 7.61



Sent To: **Wells Fargo Bank, N.A.**
 Trustee of the Adriana Elkan Trust
 Oil, Gas & Mineral Management
 P.O. Box 1959
 Midland, TX 79702-1959

7013 1090 0000 5647 6688

U.S. Postal Service™
CERTIFIED MAIL™ RECEIPT
 (Domestic Mail Only; No Insurance Coverage Provided)

For delivery information visit our website at www.usps.com

OFFICIAL USE

Postage	\$ 1.61
Certified Fee	3.30
Return Receipt Fee (Endorsement Required)	2.70
Restricted Delivery Fee (Endorsement Required)	
Total Postage & Fees	\$ 7.61

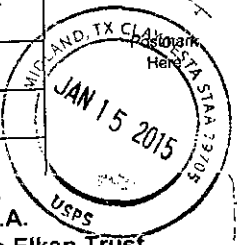

Sent To: **Wells Fargo Bank, N.A.**
 Trustee of the Alston Elkan Trust
 Oil, Gas & Mineral Management
 P.O. Box 1959
 Midland, TX 79702-1959

7013 1090 0000 5647 6661

U.S. Postal Service™
CERTIFIED MAIL™ RECEIPT
 (Domestic Mail Only; No Insurance Coverage Provided)

For delivery information visit our website at www.usps.com

OFFICIAL USE

Postage	\$ 1.61
Certified Fee	3.30
Return Receipt Fee (Endorsement Required)	2.70
Restricted Delivery Fee (Endorsement Required)	
Total Postage & Fees	\$ 7.61

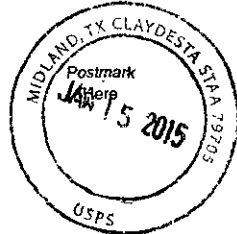

Sent To: **Blind Side, LLC**
 P.O. Box 429
 Roswell, NM 88202

U.S. Postal Service™
CERTIFIED MAIL™ RECEIPT
(Domestic Mail Only, No Insurance Coverage Provided)

For delivery information visit our website at www.usps.com

OFFICIAL USE

7013 1090 0000 5647 6951

Postage	\$ 1.61
Certified Fee	3.30
Return Receipt Fee (Endorsement Required)	2.70
Restricted Delivery Fee (Endorsement Required)	
Total Postage & Fees	\$ 7.61

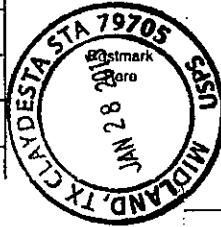

Sent To
Street, A
or PO B
City, Sta

E. L. Latham Company
1320 South University, Suite 820
Fort Worth, TX 76107

PS Form

uctions

7007 2560 0002 4612 4763

U.S. Postal Service
CERTIFIED MAIL RECEIPT
(Domestic Mail Only; No Insurance Coverage Provided)

For delivery information, visit our website at www.usps.com

OFFICIAL USE

Postage	\$ 1.61
Certified Fee	3.30
Return Receipt Fee (Endorsement Required)	2.70
Restricted Delivery Fee (Endorsement Required)	
Total Postage & Fees	\$ 7.61



Sent To	Edward Armstrong Elkan III
Street, A or PO Box	6808 Los Prados Road NW
City, State	Albuquerque, NM 87114
PS Form	actions

7007 2560 0002 4812 4790

U.S. Postal Service TM
CERTIFIED MAIL TM RECEIPT
(Domestic Mail Only; No Insurance Coverage Provided)

For delivery information visit our website at www.usps.com

OFFICIAL USE

Postage	\$ 1.61
Certified Fee	3.30
Return Receipt Fee (Endorsement Required)	2.70
Restricted Delivery Fee (Endorsement Required)	
Total Postage & Fees	\$ 7.61

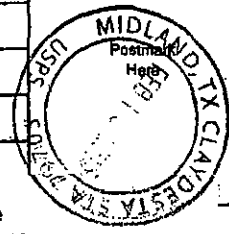

Sent To	Angela Marie Reese
Street, Ap or PO Box	3942 Shelter Glenn Way
City, State	Santa Rosa, CA 95404-7674
PS Form	

McMillan, Michael, EMNRD

From: Kim Tyson <kimt@forl.com>
Sent: Wednesday, March 04, 2015 12:46 PM
To: McMillan, Michael, EMNRD
Subject: RE: Paloma 21 Federal Com surface commingling facility

Michael,

The surface facilities are located at the Paloma "21" Federal Com No. 3H. Unit Letter B, Section 21, T20S, R34E, Lea County.

Kim Tyson

From: McMillan, Michael, EMNRD [<mailto:Michael.McMillan@state.nm.us>]
Sent: Wednesday, March 04, 2015 11:03 AM
To: Kim Tyson
Subject: Paloma 21 Federal Com surface commingling facility

Ms. Tyson:

Where is the surface facility located for the Paloma 21 Federal Com. Relative to the wells? Which well is it closest to? Tomorrow the application can be submitted to the director.

This is the last thing I need to write the letter, so the Director can decide whether to approve your application.

Call me or e-mail me

Thank You

Michael A. McMillan

Engineering and Geological Services Bureau, Oil Conservation Division
1220 South St. Francis Dr., Santa Fe NM 87505
O: 505.476.3448 F. 505.476.3462

--

This message has been scanned for viruses and dangerous content by **Basin Broadband, Inc.**, utilizing DefenderMX technology, and is believed to be clean.

7007 2560 0002 4812 4813

U.S. Postal Service
CERTIFIED MAIL RECEIPT
(Domestic Mail Only; No Insurance Coverage Provided)

For delivery information visit our website at www.usps.com

OFFICIAL USE

Postage	\$ 1.61
Certified Fee	3.30
Return Receipt Fee (Endorsement Required)	2.70
Restricted Delivery Fee (Endorsement Required)	
Total Postage & Fees	\$ 7.61

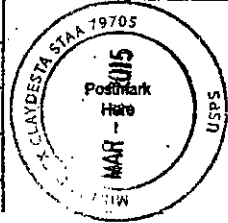

Sent To	Edward Armstrong Elkan III
Street, Apt. or PO Box	9438 NW Harvest Hill Drive
City, State	Portland, OR 97229-8012
PS Form	Instructions