

11/18/2014 DATE IN	SUSPENSE	PRG ENGINEER	11/19/2014 LOGGED IN	SWD TYPE	PMAH/432347407 APP NO.
-----------------------	----------	-----------------	-------------------------	-------------	---------------------------

ABOVE THIS LINE FOR DIVISION USE ONLY

NEW MEXICO OIL CONSERVATION DIVISION

- Engineering Bureau -

1220 South St. Francis Drive, Santa Fe, NM 87505



ADMINISTRATIVE APPLICATION CHECKLIST

THIS CHECKLIST IS MANDATORY FOR ALL ADMINISTRATIVE APPLICATIONS FOR EXCEPTIONS TO DIVISION RULES AND REGULATIONS WHICH REQUIRE PROCESSING AT THE DIVISION LEVEL IN SANTA FE

Application Acronyms:

[NSL-Non-Standard Location] [NSP-Non-Standard Proration Unit] [SD-Simultaneous Dedication]
 [DHC-Downhole Commingling] [CTB-Lease Commingling] [PLC-Pool/Lease Commingling]
 [PC-Pool Commingling] [OLS - Off-Lease Storage] [OLM-Off-Lease Measurement]
 [WFX-Waterflood Expansion] [PMX-Pressure Maintenance Expansion]
 [SWD-Salt Water Disposal] [IPI-Injection Pressure Increase]
 [EOR-Qualified Enhanced Oil Recovery Certification] [PPR-Positive Production Response]

[1] TYPE OF APPLICATION - Check Those Which Apply for [A]

- [A] Location - Spacing Unit - Simultaneous Dedication
☐ NSL ☐ NSP ☐ SD

Check One Only for [B] or [C]

- [B] Commingling - Storage - Measurement
☐ DHC ☐ CTB ☐ PLC ☐ PC ☐ OLS ☐ OLM

- [C] Injection - Disposal - Pressure Increase - Enhanced Oil Recovery
☐ WFX ☐ PMX ☒ SWD ☐ IPI ☐ EOR ☐ PPR

- [D] Other: Specify _____

- SWD
 - Probity SWD, LLC
 296278
 well
 - Kcach #1
 30-025-34565
 Pool
 - SWD, SAN Andres
 9612,

[2] NOTIFICATION REQUIRED TO: - Check Those Which Apply, or Does Not Apply

- [A] ☐ Working, Royalty or Overriding Royalty Interest Owners
 [B] ☒ Offset Operators, Leaseholders or Surface Owner
 [C] ☒ Application is One Which Requires Published Legal Notice
 [D] ☒ Notification and/or Concurrent Approval by BLM or SLO
 U.S. Bureau of Land Management - Commissioner of Public Lands, State Land Office
 [E] ☐ For all of the above, Proof of Notification or Publication is Attached, and/or,
 [F] ☐ Waivers are Attached

[3] SUBMIT ACCURATE AND COMPLETE INFORMATION REQUIRED TO PROCESS THE TYPE OF APPLICATION INDICATED ABOVE.

[4] CERTIFICATION: I hereby certify that the information submitted with this application for administrative approval is accurate and complete to the best of my knowledge. I also understand that no action will be taken on this application until the required information and notifications are submitted to the Division.

Note: Statement must be completed by an individual with managerial and/or supervisory capacity.

Amithy Crawford Regulatory Compliance Dir. 11/19/14
 Print or Type Name Signature Title Date
 acrawford@gmail.com
 e-mail Address
 acrawford@probityenergy.com

APPLICATION FOR AUTHORIZATION TO INJECT

I. PURPOSE: Secondary Recovery Pressure Maintenance X Disposal Storage
Application qualifies for administrative approval? Yes No 2014 NOV 18 P 3:00

II. OPERATOR: Probity SWD, LLC
ADDRESS: PO BOX 7307, midland, TX 79708
CONTACT PARTY: Amithy Crawford Martin Dozier PHONE: 432-570-1122

III. WELL DATA: Complete the data required on the reverse side of this form for each well proposed for injection.
Additional sheets may be attached if necessary.

IV. Is this an expansion of an existing project? Yes X No
If yes, give the Division order number authorizing the project: _____

V. Attach a map that identifies all wells and leases within two miles of any proposed injection well with a one-half mile radius circle drawn around each proposed injection well. This circle identifies the well's area of review.

VI. Attach a tabulation of data on all wells of public record within the area of review which penetrate the proposed injection zone. Such data shall include a description of each well's type, construction, date drilled, location, depth, record of completion, and a schematic of any plugged well illustrating all plugging detail.

VII. Attach data on the proposed operation, including:

1. Proposed average and maximum daily rate and volume of fluids to be injected;
2. Whether the system is open or closed;
3. Proposed average and maximum injection pressure;
4. Sources and an appropriate analysis of injection fluid and compatibility with the receiving formation if other than reinjected produced water; and,
5. If injection is for disposal purposes into a zone not productive of oil or gas at or within one mile of the proposed well, attach a chemical analysis of the disposal zone formation water (may be measured or inferred from existing literature, studies, nearby wells, etc.).

*VIII. Attach appropriate geologic data on the injection zone including appropriate lithologic detail, geologic name, thickness, and depth. Give the geologic name, and depth to bottom of all underground sources of drinking water (aquifers containing waters with total dissolved solids concentrations of 10,000 mg/l or less) overlying the proposed injection zone as well as any such sources known to be immediately underlying the injection interval.

IX. Describe the proposed stimulation program, if any.

*X. Attach appropriate logging and test data on the well. (If well logs have been filed with the Division, they need not be resubmitted).

*XI. Attach a chemical analysis of fresh water from two or more fresh water wells (if available and producing) within one mile of any injection or disposal well showing location of wells and dates samples were taken.

XII. Applicants for disposal wells must make an affirmative statement that they have examined available geologic and engineering data and find no evidence of open faults or any other hydrologic connection between the disposal zone and any underground sources of drinking water.

XIII. Applicants must complete the "Proof of Notice" section on the reverse side of this form.

XIV. Certification: I hereby certify that the information submitted with this application is true and correct to the best of my knowledge and belief.

NAME: Amithy Crawford TITLE: Regulatory Compliance Director

SIGNATURE: Amithy Crawford DATE: 11-10-14

E-MAIL ADDRESS: acrawford@probitenergy.com

* If the information required under Sections VI, VIII, X, and XI above has been previously submitted, it need not be resubmitted.
Please show the date and circumstances of the earlier submittal: _____

III. WELL DATA

A. The following well data must be submitted for each injection well covered by this application. The data must be both in tabular and schematic form and shall include:

- (1) Lease name; Well No.; Location by Section, Township and Range; and footage location within the section.
- (2) Each casing string used with its size, setting depth, sacks of cement used, hole size, top of cement, and how such top was determined.
- (3) A description of the tubing to be used including its size, lining material, and setting depth.
- (4) The name, model, and setting depth of the packer used or a description of any other seal system or assembly used.

Division District Offices have supplies of Well Data Sheets which may be used or which may be used as models for this purpose. Applicants for several identical wells may submit a "typical data sheet" rather than submitting the data for each well.

B. The following must be submitted for each injection well covered by this application. All items must be addressed for the initial well. Responses for additional wells need be shown only when different. Information shown on schematics need not be repeated.

- (1) The name of the injection formation and, if applicable, the field or pool name.
- (2) The injection interval and whether it is perforated or open-hole.
- (3) State if the well was drilled for injection or, if not, the original purpose of the well.
- (4) Give the depths of any other perforated intervals and detail on the sacks of cement or bridge plugs used to seal off such perforations.
- (5) Give the depth to and the name of the next higher and next lower oil or gas zone in the area of the well, if any.

XIV. PROOF OF NOTICE

All applicants must furnish proof that a copy of the application has been furnished, by certified or registered mail, to the owner of the surface of the land on which the well is to be located and to each leasehold operator within one-half mile of the well location.

Where an application is subject to administrative approval, a proof of publication must be submitted. Such proof shall consist of a copy of the legal advertisement which was published in the county in which the well is located. The contents of such advertisement must include:

- (1) The name, address, phone number, and contact party for the applicant;
- (2) The intended purpose of the injection well; with the exact location of single wells or the Section, Township, and Range location of multiple wells;
- (3) The formation name and depth with expected maximum injection rates and pressures; and,
- (4) A notation that interested parties must file objections or requests for hearing with the Oil Conservation Division, 1220 South St. Francis Dr., Santa Fe, New Mexico 87505, within 15 days.

NO ACTION WILL BE TAKEN ON THE APPLICATION UNTIL PROPER PROOF OF NOTICE HAS BEEN SUBMITTED.

NOTICE: Surface owners or offset operators must file any objections or requests for hearing of administrative applications within 15 days from the date this application was mailed to them.



ATTACHMENTS TO APPLICATION C-108

The purpose of this application is to convert the Keach # 1 into a commercial San Andres salt water disposal well.

Keach #1
Unit O, Section 4, T20S, R38E
Lea. County, NM

II. Operator:
Probity SWD, LLC (OGRID #: 296278)
PO BOX 7307, Midland, TX 79708
Contact: Amithy Crawford
432-570-1122

III. Well Data:

- A. See attached Exhibit A (Current P&A Wellbore) & Data sheets
- B. See attached Exhibit A1 (Proposed SWD Wellbore) & Data sheets

IV. No, this is not an expansion of an existing project.

V. 2 mile radius and ½ mile area of review map & table attached. See exhibit B

VI. List of wells and data and wellbore diagrams attached. See Exhibit C.

VII. Probity SWD, LLC plans to re-enter the proposed well. Install anchors and wellhead. Clean out cement plugs down to approximately 5530'. Test casing for leaks. Run in hole and selectively perforate 5 ½" casing from 4400' to 5355', acidize as needed. Go in hole with 2 7/8" coated tubing and packer, and set at approximately 4340' or 100 feet of top of perforations. Load with packer fluid and run MIT as OCD requires and put on injection.

- 1) Plan to inject approximately on average 10,000 bpd (25,000 bpd maximum) of produced water from various sources of production.
- 2) Closed system, commercial.
- 3) Average injection pressure should be approximately 800 psi to ~~1200 psi~~ or whatever limit the NMOCD allows.
- 4) Sources of disposal waters would be produced water from numerous producing intervals of SE New Mexico. See Exhibit D for water analysis.

5) Disposal interval is San Andres 4440'-5355'

VIII. The proposed disposal formation is interbedded shale and limestone. The primary geologic formation is the Lower San Andres from 4440'-5355'. The fresh water formation in the area is the Alluvium which ranges in thickness from 20' to 30'. Underground water sources of drinking water are the Alluvium fill from surface to 350'.

Possible Santa Rosa at 4200' 1300' Ogallala (Red bed targets)

IX. Acid as needed. If needed the disposal interval will be acidized during conversion operations with 15% HCL acid.

X. Log previously submitted to the NMOCD. ✓

XI. Attached. See Exhibit E. ✓

XII. I have examined all available geologic and engineering data and find no evidence of open faults or any other hydrologic connection between the disposal zones and any underground source of drinking water pertaining to this well.

Not qualified - need statement with identified party

XIII. Proof of notice attached. See Exhibit F.

- 1) By certified mail to all leasehold operators within one-half mile) no map
- 2) By certified mail to the surface owner ✓ ? who
- 3) Proof of publishing: Newspaper clipping ✓ ? who

Previous History:

- Producer - in West Nadine, San Andres pool - only well in pool
[R-11304 02-01-2000] SE 1/4 of Sec. 4; no current producers in pool / no adjacent producers in SA except 1/2 mile SE - House; San Andres [SE 1/4 of Sec. 10].
- SWD - 4 applications for this well / 2 approved
SWD-892: 2/14/2003 - Paddock int. [5804' to 6070']
Application 6/25/2003 - cancelled - unknown reason
Application 9/15/2006 - cancelled due to offset plugged well
SWD-1015: 12/20/2005 - Paddock int [5804' to 6070']
- Producer converted to Nadine, Paddock-Blueberry Producer

KEACH #1
UNIT O, SECTION 4, T20S, R38E

467' FSL & 2310 FEL
APL 30-025-34565

AFTER P&A

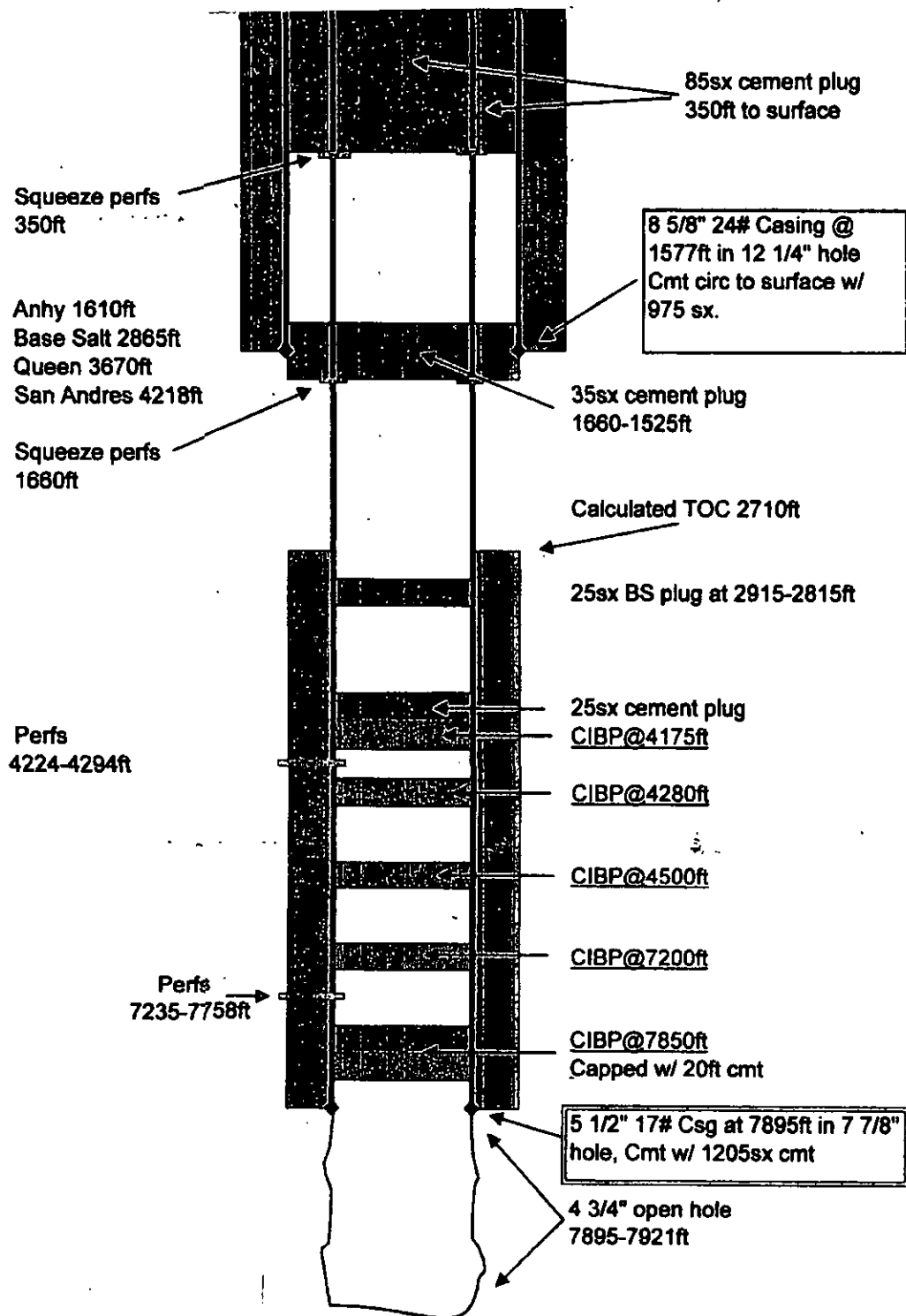

EXHIBIT A

WELL: Keach #1, 467' FSL & 2310' FEL, Unit O, Sec. 4, T20S, R38E, API:30-025-34565

Proposed SWD Wellbore Schematic

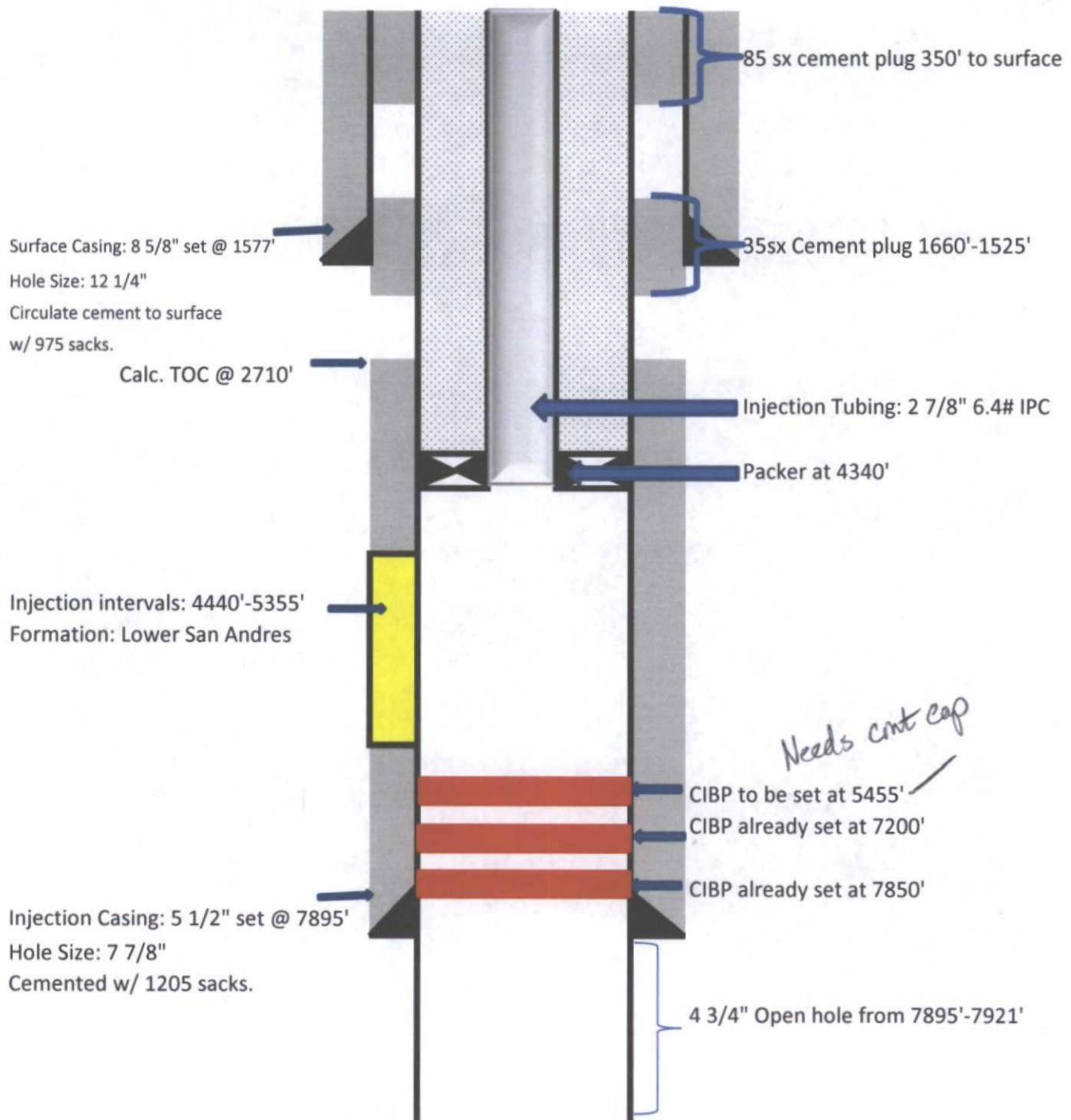

EXHIBIT A1

* Not drawn to scale

INJECTION WELL DATA SHEET

Tubing Size: 2 7/8" Coated tbg Lining Material: N/A
Type of Packer: Baker Lock Set
Packer Setting Depth: 4340'
Other Type of Tubing/Casing Seal (if applicable): N/A

Additional Data

1. Is this a new well drilled for injection? Yes X No
If no, for what purpose was the well originally drilled? well was originally drilled as a producer.
2. Name of the Injection Formation: Lower San Andres
3. Name of Field or Pool (if applicable): _____
4. Has the well ever been perforated in any other zone(s)? List all such perforated intervals and give plugging detail, i.e. sacks of cement or plug(s) used. 4224'-4294'
5884'-6070' & 7235'-7758': CIBPs set @ 4175', 4280', 4500', 7200' & 7850'
5. Give the name and depths of any oil or gas zones underlying or overlying the proposed injection zone in this area: The next higher producing zone is the upper SA @ approx. 4217'. The next lower producing zone is the Floriata @ approx. 5501'

Side 1

INJECTION WELL DATA SHEET

OPERATOR: Probitly SWD, LLC

WELL NAME & NUMBER: Keach #1

WELL LOCATION: 467' FSL 22310' FEL 0 4 20S 38E
FOOTAGE LOCATION UNIT LETTER SECTION TOWNSHIP RANGE

WELLBORE SCHEMATIC

WELL CONSTRUCTION DATA

Surface Casing

Hole Size: 12 1/4" Casing Size: 8 5/8"
Cemented with: 975 sx. or ft³
Top of Cement: Surface Method Determined: Circulate

Intermediate Casing

Hole Size: Casing Size:
Cemented with: sx. or ft³
Top of Cement: Method Determined:

Production Casing

Hole Size: 7 7/8" Casing Size: 5 1/2"
Cemented with: 1205 sx. or ft³
Top of Cement: 2710' Method Determined: Calc.
Total Depth: 7921'

Injection Interval

4440' feet to 5355'

(Perforated or Open Hole; indicate which)

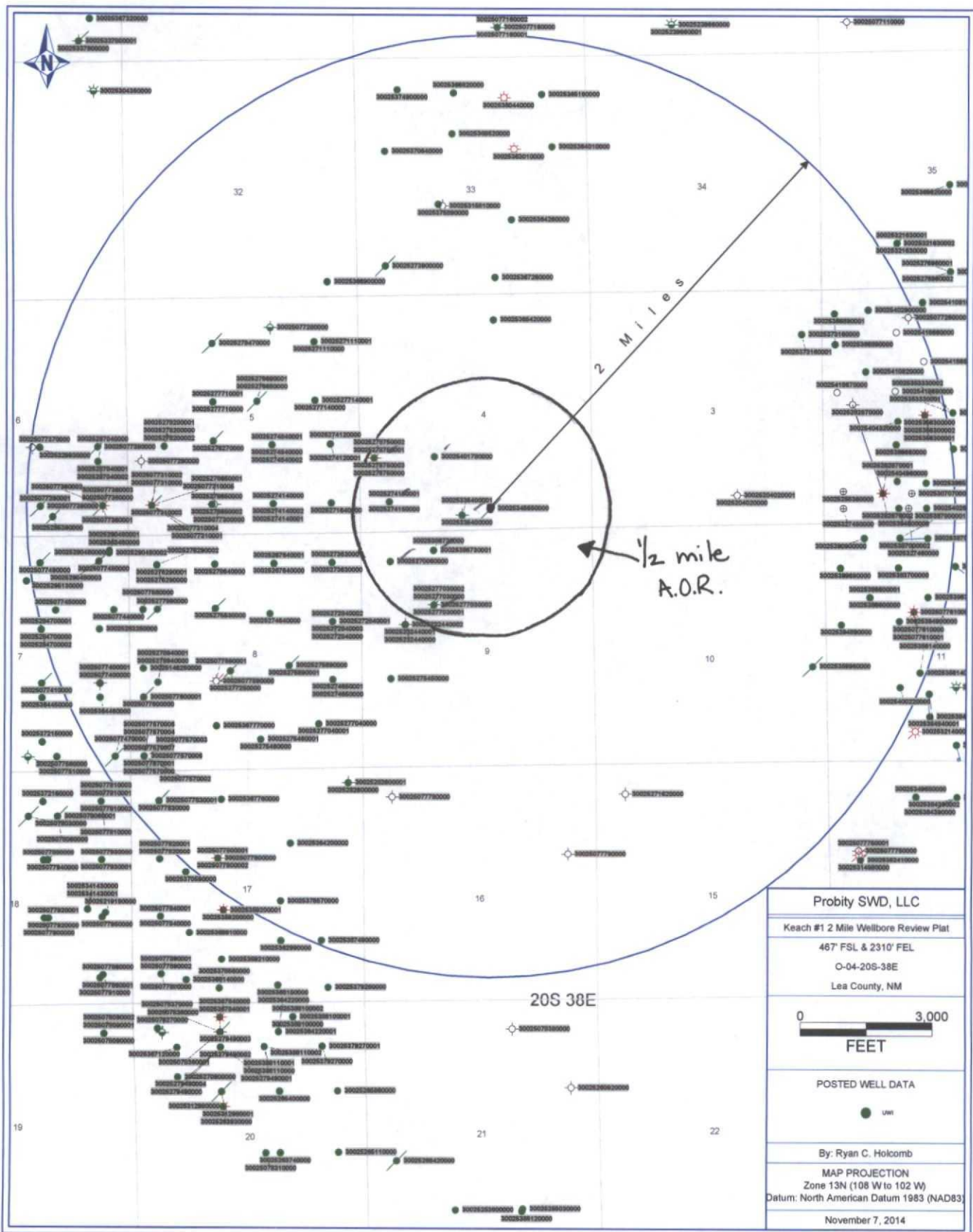

PETRA 11/7/2014 11:36:29 AM

EXHIBIT B

WELLS IN AOR

Well:	Collins Heirs
No.:	#1
Operator:	Primero Operating inc
API:	30-025-40178
Location:	T20S R38E Sec 4, 1650 FSL & 1700 FWL
Land Type:	P
County:	Lea
Status:	Producing

Well:	L&M
No.:	#8
Operator:	Apache Corp
API:	30-025-40262
Location:	T20S R38R SEC2, 330 FSL & 2310 FWL
Land Type:	P
County:	LEA
Status:	Producing

Well:	Lady
No.:	#1
Operator:	Antwell Morris CHEVRON USA
API:	30-025-27875
Location:	T20S R38E SEC 4, 1650 FSL & 330 FWL
Land Type:	P
County:	LEA
Status:	Producing

Well:	Hasket
No.:	#1
Operator:	Tamarack Petr Co Inc
API:	30-025-27415
Location:	T20S R38E SEC 4, 660 FSL & 660 FWL
Land Type:	P
County:	LEA
Status:	Producing

Well:	Roberts
No.:	#1
Operator:	Read & Stevens Inc PRIMERO OPERATING
API:	30-025-38673
Location:	T20S R38E SEC 9, 430 FNL & 1650 FWL
Land Type:	P
County:	LEA
Status:	Producing

EXHIBIT C

Well:	Speight
No.:	#1
Operator:	Tamarack Petr Co Inc
API:	30-025-27006
Location:	T20S R38E SEC 9, 660 FNL & 660 F WL
Land Type:	P
County:	LEA
Status:	Producing

Well:	Kornegay A
No.:	# 1
Operator:	Tamarack Petr Co Inc
API:	30-025-27703
Location:	T20S R38E SEC 9, 1650 FNL & 1650 FWL
Land Type:	P
County:	LEA
Status:	P&A

Well:	Vinson
No.:	#1
Operator:	Amerada Hess Corp <i>Pierce Production</i>
API:	30-025-33540
Location:	T20S R38E SEC 4, 330 FSL & 2310 FWL
Land Type:	P
County:	LEA
Status:	P&A

✓ Re-entry for WC - Abo Pool
Active Producer

3 wells

1 P&A
7 Active

Tamarack Petroleum Co Inc.
Speight #1
API: 3002527006

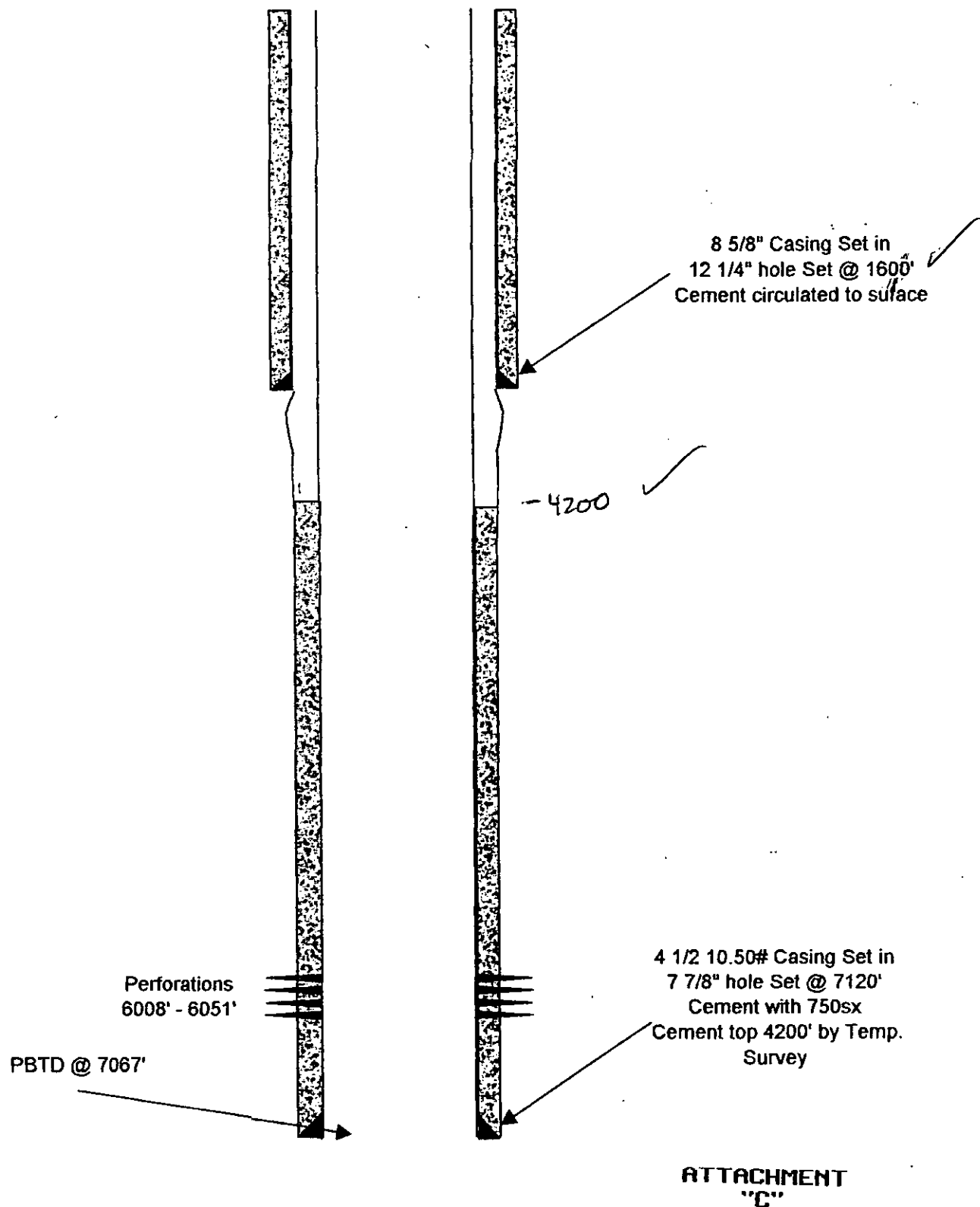

Amerada Hess Corp.

Winson #1

3002533540

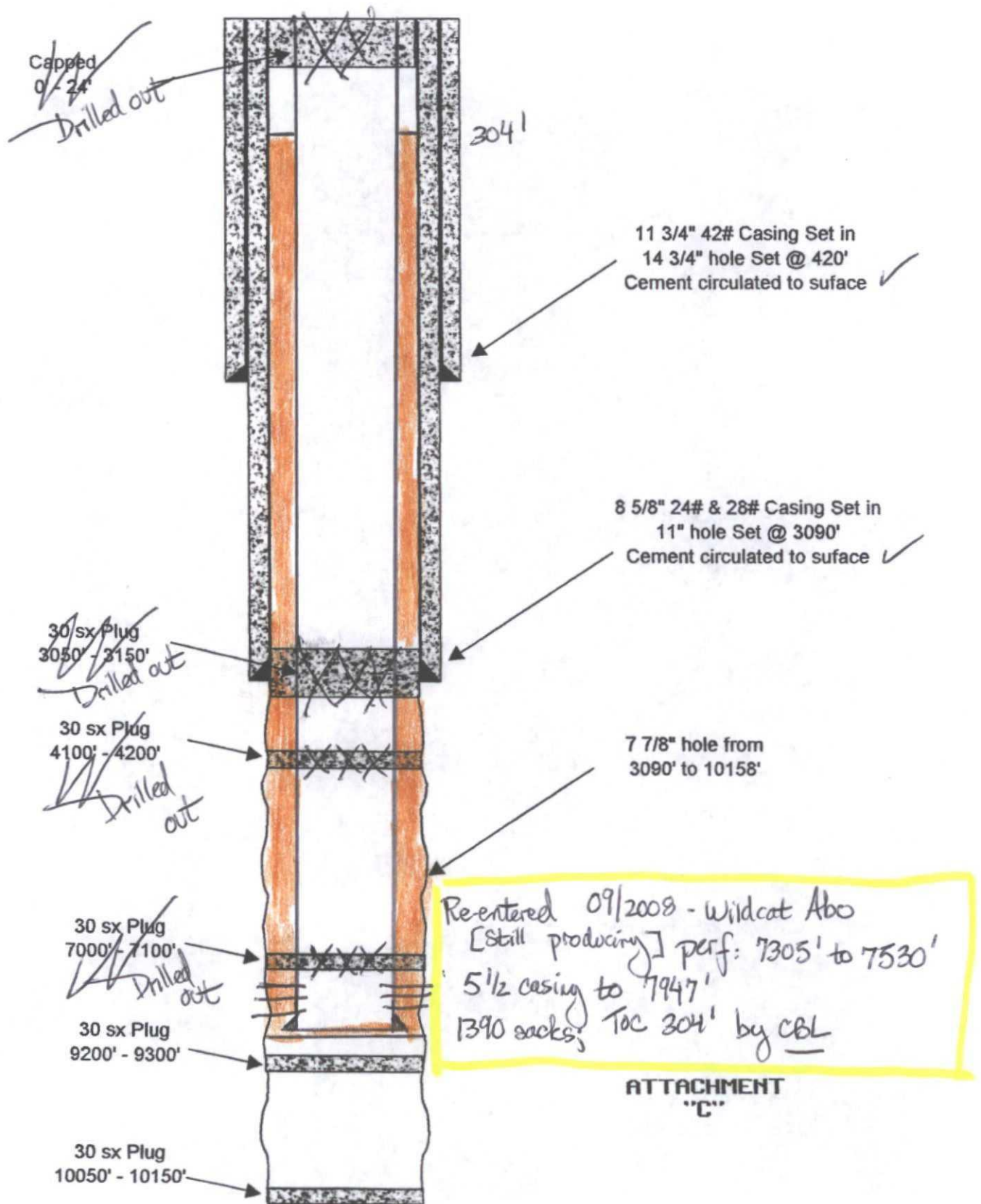

Tamarack Petroleum Co Inc.

Hesket #1

API: 3002527415

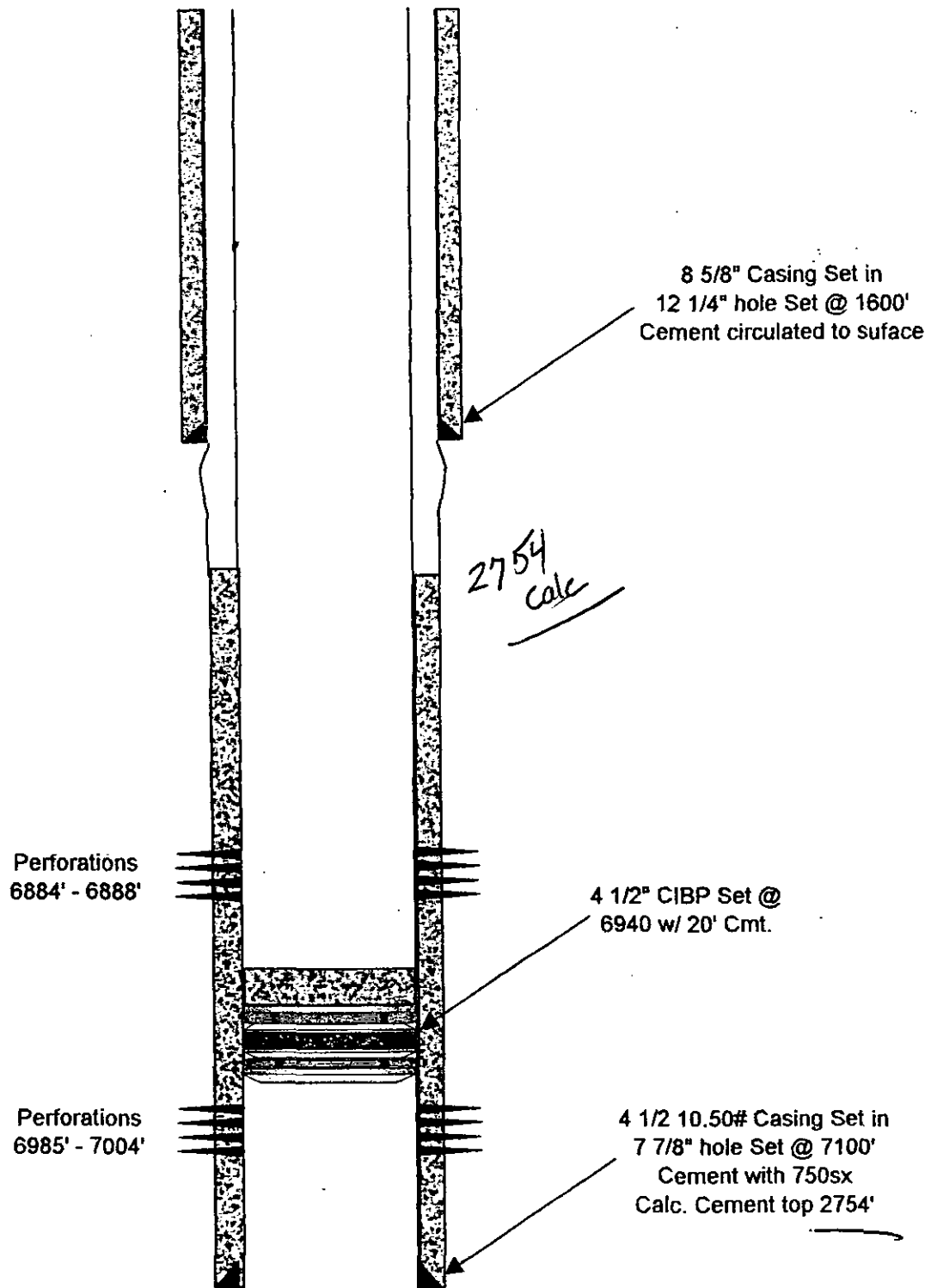

ATTACHMENT
"C"

Tamarack Petroleum Co Inc.
Kornegay A #1
API: 3002527703

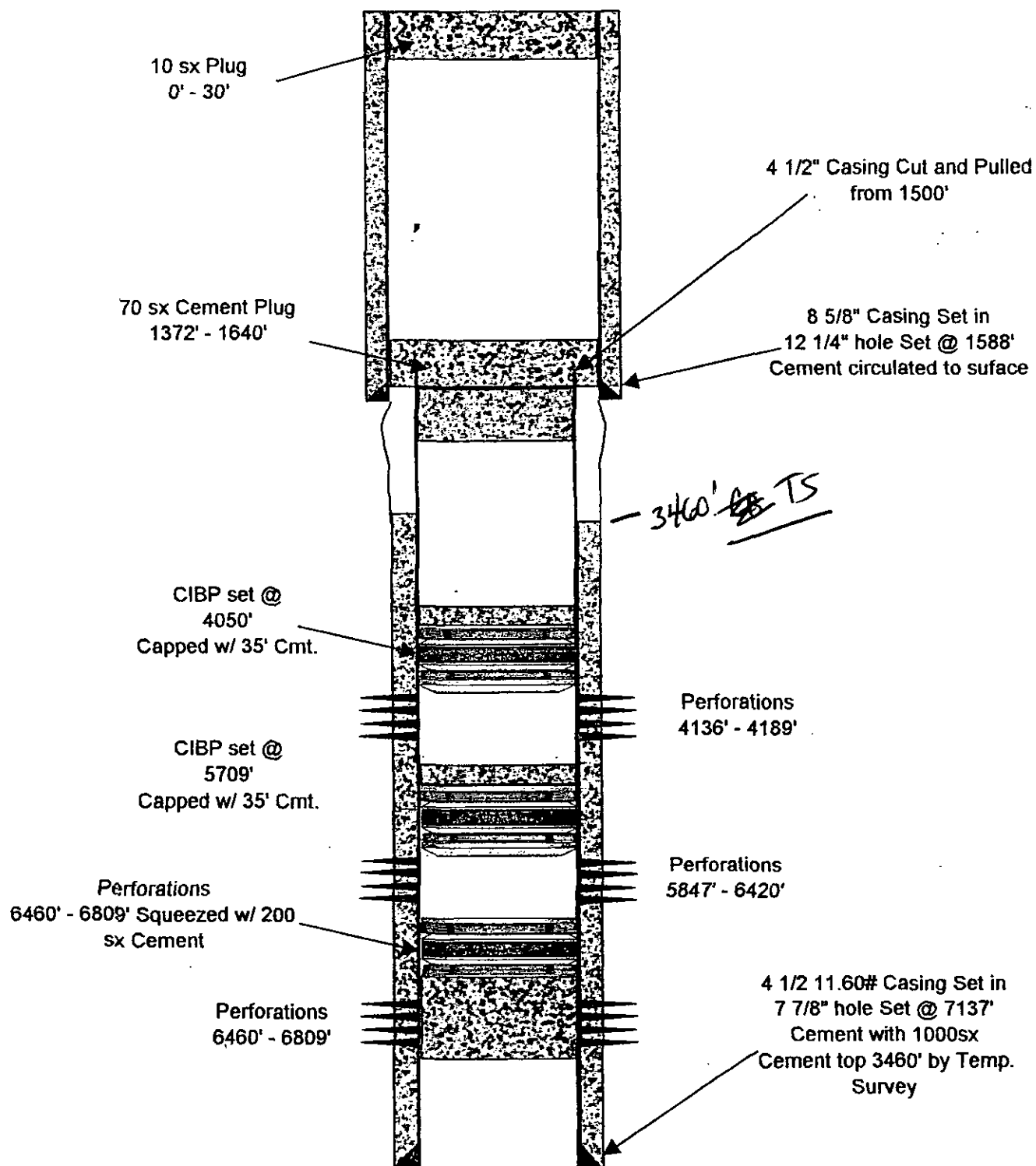

ATTACHMENT
"C"

Primerco Operating, Inc
Collins Heirs # 1
30-025-40178

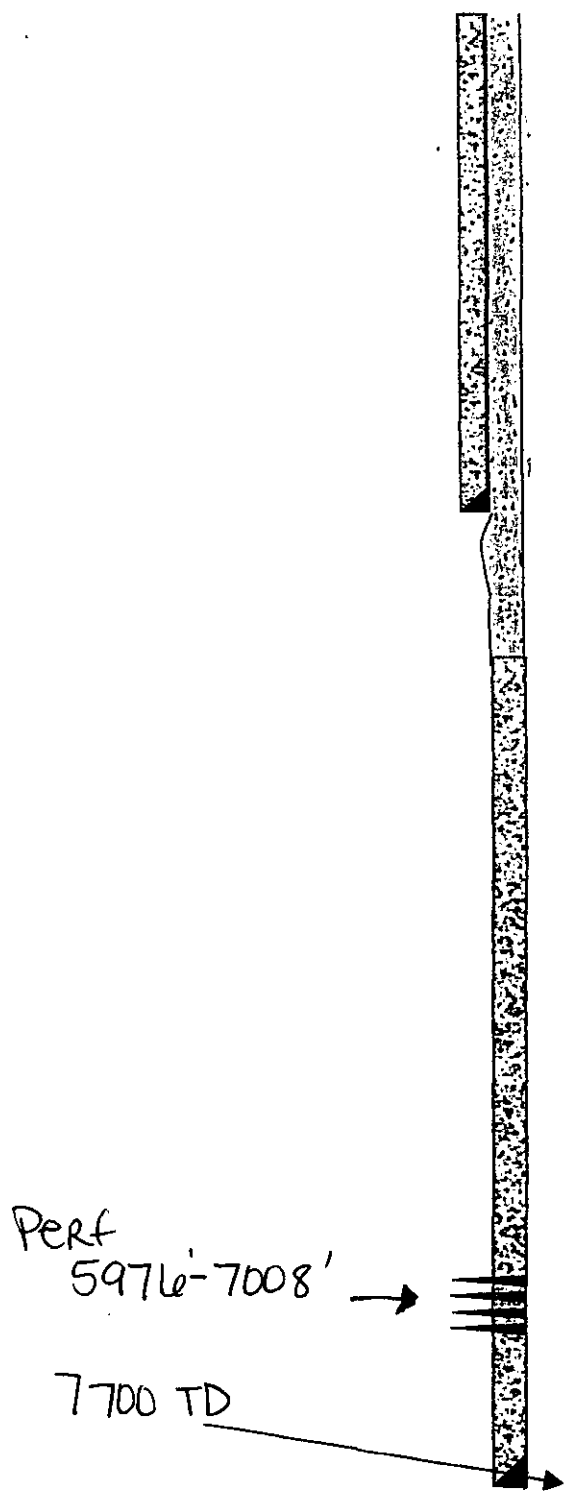

12 1/4" Hole
8 5/8" csg set @ 1568'
Class C cement 733 SKS
Circ to Surface

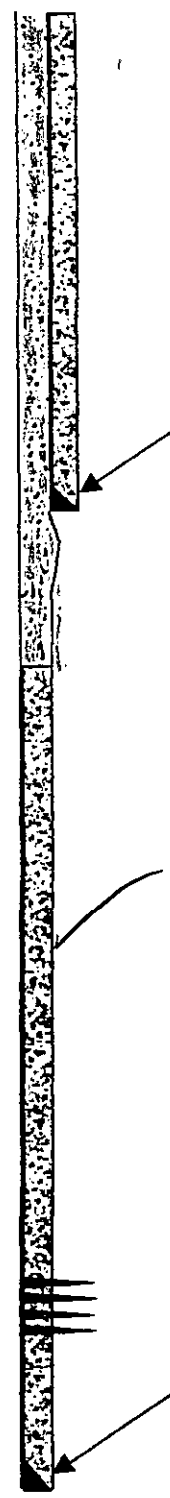

7 7/8" Hole
5 1/2" csg set @ 7689
Class C Cement 520 SKS
Circ to Surface

Apache Corp.

L&M # 8

30-025-40262



12 1/4" Hole

8 5/8" Csg set @ 1610'

Class C Cement: 800 SKS

Circ to surface

Perf:

16104' - 16820'

7357' TD

7 7/8" Hole

5 1/2" csg set @ 7357'

Class C Cement: 1285 SKS

Circ to surface.

Primero Operating
Roberts #1
30-025-38673

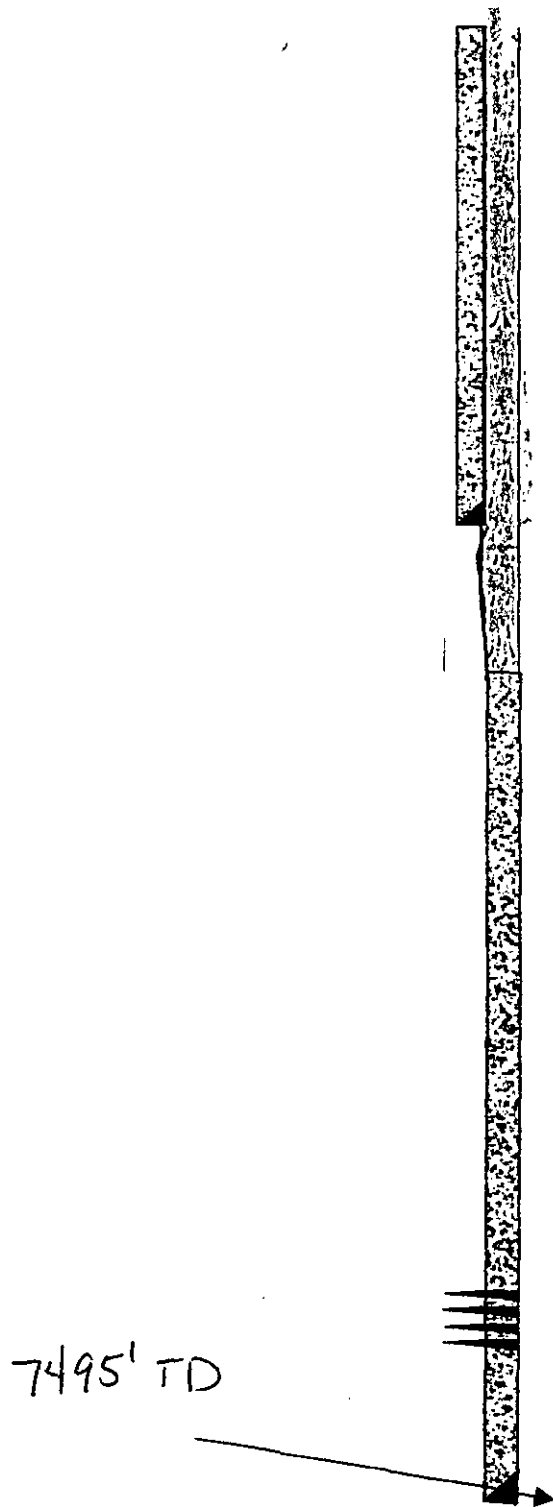

12 1/4" Hole
8 5/8" csg set @ 1548
Class C cement 8158Ks
Circ to surface

7 7/8" Hole
5 1/2" csg set @ 7495'
Class C Cement: 1845 SKS
TOC : surface

Chevron USA

LADY #1

30-025-27875

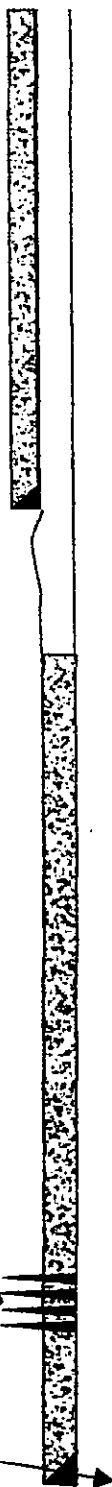

Perf
5930'-6454'

7147' TD



12 1/4" Hole

8 5/8" csg set @ 1500'

Class C cement 800 SKS

Circ to surface

← Top of cement ✓
3400'

TS
//

7 7/8" Hole

5 1/2" csg set @ 7147'

Class C cement 700 SKS

TOC 3400'

EXHIBIT D

Water Sample Analysis

Pool	Location		Range	Chlorides
	Section	Township		
North Justis Montoya	2	25S	37E	45440
North Justis McKee	2	25S	37E	58220
North Justis Fusselman	2	25S	37E	68533
North Justis Ellenburger	2	25S	37E	34151
Fowler Blinebry	22	24S	37E	116085
Skaggs Grayburg	18	20S	38E	84845
Warren McKee	18	20S	38E	85910
Warren Abo	19	20S	39E	91600
DK Drinkard	30	20S	39E	106855
Littman San Andres	8	21S	38E	38695
East Hobbs grayburg	29	18S	39E	6461
Halfway Yates	16	20S	32E	14768
Arkansas Junction San Andres	12	18S	36E	7171
Pearl Queen	28	19S	35E	114310
Midway Abo	17	17S	37E	36494
Lovinton Abo	31	16S	37E	22933
Lovington San Andres	3	16S	37E	4899
Lovington Paddock	31	16S	37E	93720
Mesa Queen	17	16S	32E	172530
Kemnitz Wolfcamp	27	16S	34E	49345
Hume Queen	9	16S	34E	124960
Anderson Ranch Wolfcamp	2	16S	32E	11040
Anderson Ranch Devonian	11	16S	32E	25702
Anderson Ranch Unit	11	16S	32E	23786
Caudill Devonian	9	15S	36E	20874
Townsend Wolfcamp	6	16S	36E	38895
Dean Pemo Penn	5	16S	37E	44730
Dean Devonian	35	15S	36E	19525
South Denton Wolfcamp	26	15S	37E	54315
South Denton Devonian	36	15S	37E	34080
Medicine Rock Devonian	15	15S	38E	39760
Little Lucky Lake Devonian	29	15S	30E	23288
Wantz Abo	26	21S	37E	132770
Crosby Devonian	18	25S	37E	58220
Scarborough Yates Seven Rivers	7	26S	37E	3443(Reef)
Teague Simpson	34	23S	37E	114685
Teague Ellenburger	34	23S	37E	120345
Rhodes Yates 7 Rivers	27	26S	37E	144485
House SA	11	20S	38E	93365
House Drinkard	12	20S	38E	49700
South Leonard Queen	24	26S	37E	115375
Elliot Abo	2	21S	38E	55380
Scharb Bone Springs	5	19S	35E	30601
EK Queen	13	18S	34E	41890
East EK Queen	22	18S	34E	179630
Maljamar Grayburg SA	22	17S	32E	46079
Maljamar Paddock	27	17S	32E	115375
Maljamar Devonian	22	17S	32E	25418

Analytical Results For:

 Eddie Seay Consulting
 601 W. Illinois
 Hobbs NM, 88242

 Project: KEACH SWD
 Project Number: NONE GIVEN
 Project Manager: Eddie Seay
 Fax To: (505) 392-6949

 Reported:
 16-May-13 17:11

KEACH WW #1
H300993-01 (Water)

Analyte	Result	Reporting Limit	Units	Dilution	Batch	Analyst	Analyzed	Method	Notes
---------	--------	-----------------	-------	----------	-------	---------	----------	--------	-------

Cardinal Laboratories
Inorganic Compounds

Alkalinity, Bicarbonate	249	5.00	mg/L	1	3040406	AP	26-Apr-13	310.1	
Alkalinity, Carbonate	ND	0.00	mg/L	1	3040406	AP	26-Apr-13	310.1	
Chloride*	120	4.00	mg/L	1	3042903	DW	29-Apr-13	4500-Cl-B	
Conductivity*	920	1.00	uS/cm	1	3043005	DW	30-Apr-13	120.1	
pH*	7.55	0.100	pH Units	1	3043004	DW	30-Apr-13	150.1	
Sulfate*	155	25.0	mg/L	2.5	3042902	AP	29-Apr-13	375.4	
TDS*	598	5.00	mg/L	1	3043009	CK	01-May-13	160.1	
Alkalinity, Total*	204	4.00	mg/L	1	3040406	AP	26-Apr-13	310.1	

Green Analytical Laboratories
Dissolved Metals by ICP

Calcium*	111	10.0	mg/L	10	B305074	JLM	15-May-13	EPA200.7	
Magnesium*	22.9	10.0	mg/L	10	B305074	JLM	15-May-13	EPA200.7	
Potassium*	ND	10.0	mg/L	10	B305074	JLM	15-May-13	EPA200.7	
Sodium*	58.6	10.0	mg/L	10	B305074	JLM	15-May-13	EPA200.7	

Cardinal Laboratories

* = Accredited Analyte

LARGE NOTE: Liability and Damages: Cardinal's liability and client's exclusive remedy for any claim arising, whether based in contract or tort, shall be limited to the amount paid by client for analysis. All claims, including those for negligence and any other cause whatsoever shall be deemed waived unless made in writing and received by Cardinal within thirty (30) days after completion of the applicable service. In no event shall Cardinal be liable for incidental or consequential damages, including without limitation, business interruptions, loss of use, or loss of profits incurred by client, its subsidiaries, affiliates or successors arising out of or related to the performance of the services hereunder by Cardinal, regardless of whether such claim is based upon any of the above stated reasons or otherwise. Results relate only to the samples identified above. This report shall not be reproduced except in full with written approval of Cardinal Laboratories.



Celey D. Keene, Lab Director/Quality Manager

LEGAL NOTICE

Pursuant to the rules and regulations of the Oil Conservation Division of the State of New Mexico, Probitly SWD, LLC, is filing a C-108, Application for Salt Water Disposal. The well being applied for is the Keach #1, API 30-025-34565, located in Unit O, Section 4, Township 20 South, Range 38 East, 467 FSL & 2310 FEL, Lea County, NM. The injection formation is the lower San Andres from 4440'-5355' below surface. Expected maximum injection rate is ^{25,000}~~10,000~~ bpd and the expected maximum injection pressure of 800 psi or what the OCD allows. Any questions about the application can be directed to Amithy Crawford (432-570-1122) PO BOX 7307, Midland, TX 79707, or any objection or request for hearing must be directed to the Oil Conservation Division, (505)476-3440, 1220 South Saint Francis Drive, Santa Fe NM, 87505, within fifteen (15) days.

LEGAL NOTICE**LEGAL NOTICE**
November 13, 2104

Pursuant to the rules and regulations of the Oil Conservation Division of the State of New Mexico, Probita SWD, LLC, is filing a C-108, Application for Salt Water Disposal. The well being applied for is the Keach #1, API 30-025-34565, located in Unit O, Section 4, Township 20 South, Range 38 East, 467 FSL & 2310 FEL, Lea County, NM. The injection formation is the lower San Andres from 4440'-5355' below surface. Expected maximum injection rate is 25,000 bpd and the expected maximum injection pressure of 800 psi or what the OCD allows. Any questions about the application can be directed to Amithy Crawford (432-579-1122) PO BOX 7307, Midland, TX 79707, or any objection or request for hearing must be directed to the Oil Conservation Division, (505)476-3440, 1220 South Saint Francis Drive, Santa Fe NM, 87505, within fifteen (15) days. #29565

List of required notified:

Surface owner:

Lee Roberts
PO BOX 356 Hobbs, NM 88240

½ mile operators:

Primero Operating, LLC
PO BOX 1433, Roswell NM 88202

Apache Corp
2000 Post Oak BLVD, Suite 100, Houston TX 77056

Chevron USA
PO Box 2100, Houston, TX 77252

Tamarack Pet. Co.
303 W. Wall St. Suite 1901, Midland TX 79701

Amerada Hess Corp
PO BOX 2040, Houston TX, 77252

Pierce Production
1203 7th St., Eunice NM, 88231

7073 1090 0000 5635 9704

U.S. Postal Service™		
CERTIFIED MAIL™ RECEIPT		
(Domestic Mail Only; No Insurance Coverage Provided)		
For delivery information visit our website at www.usps.com		
HOUSTON TX 77252 SPECIAL USE		
Postage	\$ 1.82	0708 GRAVES STA 79708 JUN 13 2014 MIDLAND TX USPS
Certified Fee	\$3.30	
Return Receipt Fee (Endorsement Required)	\$2.70	
Restricted Delivery Fee (Endorsement Required)	\$0.00	
Total Postage & Fees	\$ 7.82	
Sent To Chevron USA		
Street, Apt. No., or PO Box No. PO BOX 2100		
City, State, ZIP+4 HOUSTON TX 77282		
PS Form 3800, August 2006 See Reverse for Instructions		

7013 1090 0000 5635 9711

U.S. Postal ServiceTM
CERTIFIED MAILTM RECEIPT
(Domestic Mail Only; No Insurance Coverage Provided)

For delivery information visit our website at www.usps.com

OFFICIAL USE

Postage	\$ 1.82
Certified Fee	\$ 3.30
Return Receipt Fee (Endorsement Required)	\$ 2.70
Restricted Delivery Fee (Endorsement Required)	\$ 0.00
Total Postage & Fees	\$ 7.82

Sent To: Apache Corp
Street, Apt. No., or PO Box No.: 2000 Post Oak, Suite 100
City, State, ZIP+4: Houston, TX 77056

PS Form 3800, August 2006 See Reverse for Instructions

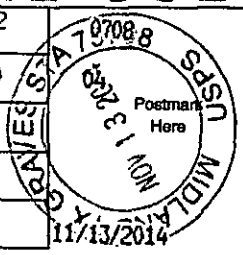

7013 1090 0000 5635 9711

U.S. Postal ServiceTM
CERTIFIED MAILTM RECEIPT
(Domestic Mail Only; No Insurance Coverage Provided)

For delivery information visit our website at www.usps.com

OFFICIAL USE

Postage	\$ 1.82
Certified Fee	\$ 3.30
Return Receipt Fee (Endorsement Required)	\$ 2.70
Restricted Delivery Fee (Endorsement Required)	\$ 0.00
Total Postage & Fees	\$ 7.82

Sent To: Primerco Operating
Street, Apt. No., or PO Box No.: PO Box 1433
City, State, ZIP+4: Roswell, NM 88202

PS Form 3800, August 2006 See Reverse for Instructions

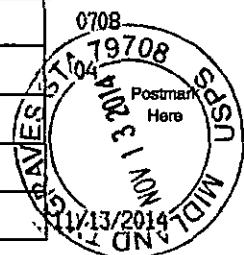

7013 1090 0000 5635 9711

U.S. Postal ServiceTM
CERTIFIED MAILTM RECEIPT
(Domestic Mail Only; No Insurance Coverage Provided)

For delivery information visit our website at www.usps.com

OFFICIAL USE

Postage	\$ 1.82
Certified Fee	\$ 3.30
Return Receipt Fee (Endorsement Required)	\$ 2.70
Restricted Delivery Fee (Endorsement Required)	\$ 0.00
Total Postage & Fees	\$ 7.82

Sent To: Chevron USA
Street, Apt. No., or PO Box No.: PO BOX 2100
City, State, ZIP+4: Houston, TX 77282

PS Form 3800, August 2006 See Reverse for Instructions

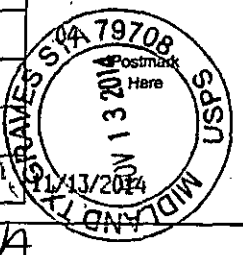

7013 1090 0000 5635 9711

U.S. Postal ServiceTM
CERTIFIED MAILTM RECEIPT
(Domestic Mail Only; No Insurance Coverage Provided)

For delivery information visit our website at www.usps.com

OFFICIAL USE

Postage	\$ 1.82
Certified Fee	\$ 3.30
Return Receipt Fee (Endorsement Required)	\$ 2.70
Restricted Delivery Fee (Endorsement Required)	\$ 0.00
Total Postage & Fees	\$ 7.82

Sent To: Lee Roberts
Street, Apt. No., or PO Box No.: PO BOX 356
City, State, ZIP+4: Hobbs NM 88240

PS Form 3800, August 2006 See Reverse for Instructions

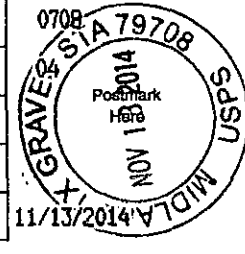

7013 1090 0000 5635 9773

U.S. Postal Service™
CERTIFIED MAIL™ RECEIPT
 (Domestic Mail Only; No Insurance Coverage Provided)
 For delivery information visit our website at www.usps.com

Postage	\$ 1.82
Certified Fee	\$3.30
Return Receipt Fee (Endorsement Required)	\$2.70
Restricted Delivery Fee (Endorsement Required)	\$0.00
Total Postage & Fees	\$ 7.82

Sent To Amerada Hess
 Street, Apt. No., or PO Box No. PO Box 2040
 City, State, ZIP+4 Houston, TX 77252

PS Form 3800, August 2006 See Reverse for Instructions

7013 1090 0000 5635 9766

U.S. Postal Service™
CERTIFIED MAIL™ RECEIPT
 (Domestic Mail Only; No Insurance Coverage Provided)
 For delivery information visit our website at www.usps.com

Postage	\$ 1.82
Certified Fee	\$3.30
Return Receipt Fee (Endorsement Required)	\$2.70
Restricted Delivery Fee (Endorsement Required)	\$0.00
Total Postage & Fees	\$ 7.82

Sent To Tamaraek
 Street, Apt. No., or PO Box No. 303 W. Wall St. Suite 1901
 City, State, ZIP+4 Midland, TX 79701

PS Form 3800, August 2006 See Reverse for Instructions

7013 1090 0000 5635 9759

U.S. Postal Service™
CERTIFIED MAIL™ RECEIPT
 (Domestic Mail Only; No Insurance Coverage Provided)
 For delivery information visit our website at www.usps.com

Postage	\$ 1.82
Certified Fee	\$3.30
Return Receipt Fee (Endorsement Required)	\$2.70
Restricted Delivery Fee (Endorsement Required)	\$0.00
Total Postage & Fees	\$ 7.82

Sent To Pierce Production
 Street, Apt. No., or PO Box No. 203 7th St.
 City, State, ZIP+4 Enice, NM 88231

PS Form 3800, August 2006 See Reverse for Instructions

669E 3699 4938 0002 2000 005C 702

U.S. Postal Service
CERTIFIED MAIL
 (Domestic Mail Only, No Insurance Coverage Provided)

For delivery information visit our website at www.usps.com

RECEIPT

OFFICIAL USE

Postage	\$	1.82
Certified Fee	\$	1.30
Return Receipt Fee (Endorsement Required)	\$	2.70
Restricted Delivery Fee (Endorsement Required)	\$	10.00
Total Postage & Fees	\$	15.82

Sent To: NM State Land Office
 P.O. Box 1148
 Santa Fe, NM 87504

Postmark: NOV 19 2014

PS Form 3800, August 2009

Affidavit of Publication

STATE OF NEW MEXICO
COUNTY OF LEA

I, Todd Bailey, Editor of the Hobbs News-Sun, a newspaper published at Hobbs, New Mexico, solemnly swear that the clipping attached hereto was published in the regular and entire issue of said newspaper, and not a supplement thereof for a period of 1 issue(s).

Beginning with the issue dated
November 13, 2014
and ending with the issue dated
November 13, 2014.

Editor

Sworn and subscribed to before me this
13th day of November 2014.

Business Manager

My commission expires
January 29, 2015
(Seal)

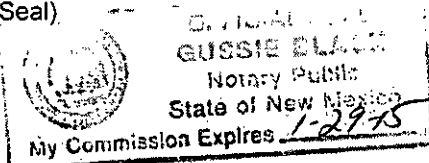

67112254

00147556

AMITHY CRAWFORD
PROBITY SWD, LLC
PO BOX 7307
MIDLAND, TX 79708

This newspaper is duly qualified to publish legal notices or advertisements within the meaning of Section 3, Chapter 167, Laws of 1937 and payment of fees for said

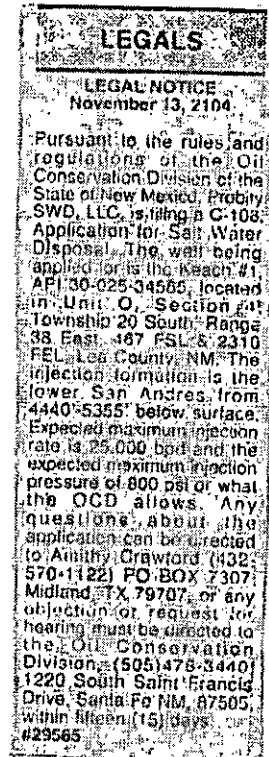



RECEIVED OCD

February 11, 2015

2015 FEB 12 P 1: 22

New Mexico Oil Conservation Division
1220 South St. Francis Drive
Santa Fe, New Mexico 87505

Attn: Mr. Phillip Goetze, Engineer

*Re: Amendment Items to Existing C-108 Application of Probit Operating, LLC to permit
for salt water disposal the Keach No.1 well located in Section 4, Township 20 South, Range
38 East, NMPM, Lea County, New Mexico.*

Dear Mr. Goetze,

I have recently been contacted by Probit Operating, LLC to assist with some of their application efforts for their operations in New Mexico.

Mr. G.A. Baber indicated to me that there were some open items identified by you during a cursory review of the subject C-108 application for SWD.

I have reviewed the file as submitted and worked with Mr. Baber to further research, evaluate and compile or otherwise generate any remaining required documentation.

The attached package is a result of that effort. Please note that 3 water wells were identified within one mile of the proposed well. Samples have been taken and are currently being analyzed – the results will be forwarded to your attention as soon as possible.

I respectfully request that the approval of this salt water disposal well proceed swiftly and if you or your staff requires additional information or has any questions, please do not hesitate to call or email me.

Best regards,

A handwritten signature in black ink, appearing to read 'Ben Stone', is written over a white background.

Ben Stone, Partner
SOS Consulting, LLC
Agent for Probit Operating, LLC

Cc: Application attachment and file

FORM C-108

Amendment Items per OCD Request

1. Geological Affirmation
2. Map of Water Wells within One Mile
3. List of Water Wells – 3 Identified within One Mile
4. Leasehold Map
5. List of Interested Parties – Additional Parties
6. Notice to Interested Parties
7. Proof of Notice – Certified Mail

C-108 ITEM XII – GEOLOGIC AFFIRMATION

We have examined available geologic and engineering data and have found no evidence of open faults or other hydrologic connection between the disposal interval and any underground sources of drinking water.

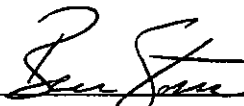

Ben Stone, Partner
SOS Consulting, LLC

Project: Probity Operating, LLC
 Keach Well No.1
 Reviewed 2/11/2015

Keach No.1 SWD – Water Well Spots – 3 within 1 mile

Samples of Nos.02169 & 00438 will be forwarded upon receipt.

(Spots shown are in centered in the closest 2.5 acre Qtr/Qtr/Qtr)

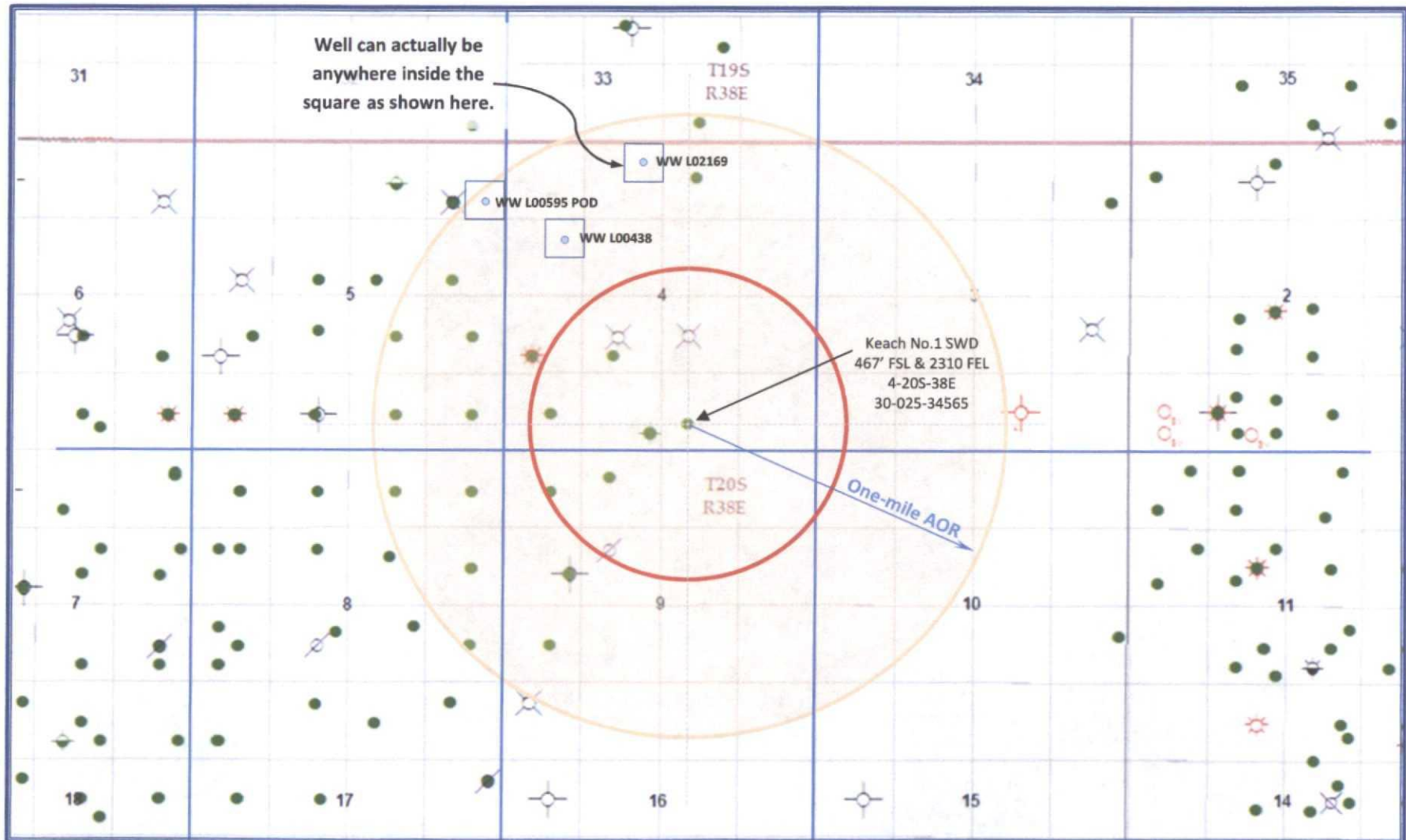

WR File Nbr	Subbasin	Use	Diversion	Owner	County	POD Number	Code	Grant	Source	q64	q16	q4	Sec	Tws	Rng	X	Y	(quarters are 1=NW 2=NE 3=SW 4=SE)
L 00407	L	IRR	240	L.B. TIPPY	LE	L 00407				4	4		03	20S	38E	670773	3607130	*
					LE	L 00407 S			Shallow	2	2	1	03	20S	38E	670781	3606927	*
					LE	L 00407 S2				2	3	1	03	20S	38E	670371	3607323	*
L 00407 A	L	IND	305.35	CONTINENTAL CARBON COMPANY	LE	L 00407 POD4			Shallow	1	2	2	03	20S	38E	670781	3606727	*
					LE	L 00407 POD5			Shallow	2	2	2	03	20S	38E	670581	3606927	*
					LE	L 00407 S	R		Shallow	4	2	2	03	20S	38E	670781	3606927	*
					LE	L 02169 POD2			Shallow		2	4	03	20S	38E	669877	3606815	*
					LE	L 02169 S			Shallow	2	2	1	04	20S	38E	669976	3606914	*
L 00438	L	IRR	703.71	CITY OF EUNICE	LE	L 00438			Shallow	2	3	1	04	20S	38E	671980	3607351	*
					LE	L 00438 S			Shallow	2	2	1	05	20S	38E	671780	3607351	*
L 00595	L	IRR	410.1	S W CATTLE COMPANY	LE	L 00595			Shallow	1	3	1	05	20S	38E	670766	3607733	*
					LE	L 00595 POD3			Shallow	4	2	2	05	20S	38E	670766	3607533	*
					LE	L 00595 S	R		Shallow	4	2	3	05	20S	38E	670766	3607533	*
L 11270	L	DO	0	LEE M. ROBERTS	LE	L 11270				1	2	1	08	20S	38E	675366	3609430	*
L 11713	L	STK	3	MCNEILL RANCH	LE	L 11713 POD1			Shallow	1	3	2	08	20S	38E	672531	3609138	
					LE	L 11713 POD2				3	3	2	08	20S	38E	672548	3608799	
L 12478	L	STK	3	LEE M. ROBERTS	LE	L 12478 POD1			Shallow	2	1	4	08	20S	38E	671378	3608423	
L 13401	L	DO	0	OSWALDO JUAREZ	LE	L 13401 POD1				3	2	4	08	20S	38E	675221	3608637	
L 09503	L	STK	0	RON ELLISON	LE	L 09503			Shallow	4	3	4	10	20S	38E	675215	3606402	*
*UTM location																		
WR File Nbr	Subbasin	Use	Diversion	Owner	County	POD Number	Code	Grant	Source	q64	q16	q4	Sec	Tws	Rng	X	Y	(quarters are 1=NW 2=NE 3=SW 4=SE)
L 00561	L	IRR	127.5	DIXIE H. MAYES	LE	L 00561 POD11			Shallow			4	32	19S	38E	675246	3610730	*
					LE	L 00561 S			Shallow	1	1	34	19S	38E	675340	3611037	*	
L 00561 A	L	IRR	4.47	JOHN T. WILSON	LE	L 00561			Shallow	1	1	34	19S	38E	674130	3610789		
					LE	L 00561 POD10			Shallow	1	1	34	19S	38E	674235	3610918	*	
					LE	L 00561 POD4	R		Shallow	1	1	34	19S	38E	674134	3611017	*	
L 00561 AA	L	AGR	0	H.B. YARBRO	LE	L 00561			Shallow	1	1	34	19S	38E	674130	3610789		
					LE	L 00561 POD4			Shallow	1	1	34	19S	38E	674134	3611017	*	
					LE	L 00561 POD9			Shallow	1	1	34	19S	38E	674536	3610824	*	
L 00561 AB	L	IRR	2.07	SHERMAN SMITH	LE	L 00561	R		Shallow	1	1	34	19S	38E	674130	3610789		
					LE	L 00561 POD4	R		Shallow	1	1	34	19S	38E	674134	3611017	*	
					LE	L 00561 POD8			Shallow	1	1	34	19S	38E	674334	3610817	*	
L 00561 ABA	L	IRR	0	EUGENE WINKER	LE	L 00561 POD8			Shallow	2	1	34	19S	38E	674334	3610817	*	
L 00561 ABB	L	IRR	13.29	JERRY WINKER	LE	L 00561 POD8			Shallow	3	1	34	19S	38E	674334	3610817	*	
L 00561 ABBA	L	IRR	14.7	KEN SCHMITT	LE	L 00561 POD8			Shallow	3	1	34	19S	38E	674334	3610817	*	
L 00561 ABBB	L	IRR	14.82	DONNA WINKER	LE	L 00561 POD8			Shallow	3	1	34	19S	38E	674334	3610817	*	
L 00561 AC	L	IRR	56.94	MICHAELENE THOMPSON	LE	L 00561			Shallow	3	1	34	19S	38E	674130	3610789		
					LE	L 00561 POD10			Shallow	3	1	34	19S	38E	674235	3610918	*	
L 00561 AD	L	IRR	194.1	EUGENE WINKER	LE	L 00561			Shallow	3	1	34	19S	38E	674130	3610789		
					LE	L 00561 POD10			Shallow	3	1	34	19S	38E	674235	3610918	*	
					LE	L 00561 POD8			Shallow	3	1	34	19S	38E	674334	3610817	*	
L 00561 AE	L	IRR	1.41	DAYLN WINKER	LE	L 00561			Shallow	3	1	34	19S	38E	674130	3610789		
					LE	L 00561 POD10			Shallow	3	1	34	19S	38E	674235	3610918	*	
L 00561 AEA	L	IRR	17.7	MICHAELNE THOMPSON	LE	L 00561			Shallow	4	1	34	19S	38E	674130	3610789		

L 00561 AEB	L	IRR 15	EUGENE WINKER	LE	L 00561 POD10	Shallow 4	1	1	34	19S	38E	674235	3610918		
				LE	L 00561	Shallow 4	1	1	34	19S	38E	674130	3610789		
				LE	L 00561 POD10	Shallow 4	1	1	34	19S	38E	674235	3610918		
L 00561 AF	L	IRR 29.4	CHÉSTINA L. BENTLE	LE	L 00561	Shallow 4	1	1	34	19S	38E	674130	3610789		
				LE	L 00561 POD10	Shallow 4	1	1	34	19S	38E	674235	3610918		
L 00561 B	L	IRR 237.93	MCCASLAND LIMITED PARTNERSHIP	LE	L 00561	Shallow 4	1	1	34	19S	38E	674130	3610789		
				LE	L 00561 POD3	Shallow 1	2	1	34	19S	38E	674736	3611024		
				LE	L 00561 POD5	Shallow 1	2	1	34	19S	38E	674938	3610831		
				LE	L 00561 POD6	Shallow 2	2	1	34	19S	38E	674938	3610831		
				LE	L 00561 S	Shallow 2	2	1	34	19S	38E	675340	3611037		
L 00561 C	L	IRR 79.2	MICHAEL RAHE	LE	L 00561 POD7	Shallow 2	2	1	34	19S	38E	675346	3610435		
L 00996	L	DO 3	WILDER PORTER	LE	L 00996 POD1	Shallow 3	2	1	34	19S	38E	674736	3611024		
		M													
L 01034	L	DO 3	LYLE C. STINE	LE	L 01034	Shallow 1	4	1	34	19S	38E	675447	3610536		
		M													
L 01130	L	DO 3	R V JONES	LE	L 01130 POD1	Shallow 1	4	1	34	19S	38E	675447	3610536		
		M													
L 01144	L	DO 3	H E RAMSEY REV	LE	L 01144 POD1	Shallow 3	4	1	34	19S	38E	675540	3610837		
		M													
L 01375	L	STK 3	CHRIS FURNEAUX	LE	L 01375			2	34	19S	38E	672040	3609870		
L 01687	L	DO 3	E L CURRY	LE	L 01687 POD1	Shallow		2	34	19S	38E	674736	3611024		
		M													
L 01783	L	IRR 29.19	H.E. RAMSEY	LE	L 01783	Shallow 3	1	2	34	19S	38E	675540	3611037		
L 02477	L	DO 3	JAMES L BARTON	LE	L 02477	Shallow 3	1	2	34	19S	38E	675546	3610435		
		M													
L 02514	L	DO 3	D J YOUNGBLOOD	LE	L 02514			2	2	34	19S	38E	674536	3611024	
		M													
L 02582	L	DO 3	JAMES L BARTON	LE	L 02582	Shallow		2	2	34	19S	38E	675546	3610435	
		M													
L 02625	L	DO 3	COLLINS WALKER	LE	L 02625	Shallow 1	2	2	34	19S	38E	675346	3610435		
		M													
L 02829	L	DO 3	SHERMAN SMITH	LE	L 02829	Shallow 1	2	2	34	19S	38E	674334	3611017		
		M													
L 02978	L	DO 3	A W BUSCHMAN	LE	L 02978	Shallow 2	2	2	34	19S	38E	674542	3610621		
		M													
L 03325	L	DO 3	FLOYD O HENNINGTON JR	LE	L 03325	Shallow 2	2	2	34	19S	38E	675540	3611037		
		M													
L 03558	L	DO 3	FLOYD O HENNINGTON JR	LE	L 03558	Shallow 2	2	2	34	19S	38E	675540	3611037		
		M													
L 03588	L	DO 3	J O COURSEY	LE	L 03588	Shallow 2	2	2	34	19S	38E	675540	3611037		
		M													
L 03955	L	DO 3	J E BARTON	LE	L 03955	Shallow 2	2	2	34	19S	38E	675540	3611037		
		M													
L 04273	L	IRR 6.6	JAMES L. BARTON	LE	L 04273	Shallow 2	2	2	34	19S	38E	675546	3610435		
L 04678	L	IRR 11.22	D.L. MAYES	LE	L 04678	Shallow 4	2	2	34	19S	38E	675546	3610435		
L 04680	L	DO 0	D.L. MAYES	LE	L 04680		4	2	2	34	19S	38E	675546	3610435	
		M													
L 04970	L	DO 3	JAMES C COONCE	LE	L 04970			2	3	2	34	19S	38E	675441	3610938
		M													
L 05154	L	DO 3	D L MAYERS	LE	L 05154	Shallow		4	2	34	19S	38E	675546	3610435	
		M													
L 05375	L	DO 3	J L BARTON	LE	L 05375	Shallow		4	2	34	19S	38E	675546	3610435	
		M													
L 06310	L	DOL 3	LLOYD W WHITE	LE	L 06310			4	2	34	19S	38E	675441	3610938	
L 07327	L	DO 3	T C HENNINGTON	LE	L 07327	Shallow		4	2	34	19S	38E	675346	3610435	
		M													
L 08612	L	DOL 0	B. L. LILLEY	LE	L 08612	Shallow 3	4	2	34	19S	38E	675447	3610536		
L 08613	L	DOL 3	B. L. LILLEY	LE	L 08613	Shallow 3	4	2	34	19S	38E	675447	3610536		
L 10425	L	MUL 3	CHARLES W. JENNINGS	LE	L 10425	Shallow 3	4	2	34	19S	38E	674542	3610421		
L 10451	L	DO 3	MICHAEL RAHE	LE	L 10451	Shallow 4	4	2	34	19S	38E	675546	3610435		
		M													
L 11014	L	DO 3	BETTY WHITE	LE	L 11014	Shallow 4	4	2	34	19S	38E	675246	3610730		
		M													

L 12343	L	DO M	1	JOSE HERNANDEZ	LE	L 12343 POD1	Shallow	4	4	2	34	19S	38E	674433	3610730
L 12851	L	DO M	1	CHESTINA BENTLE	LE	L 12851 POD1	Shallow	4	4	2	34	19S	38E	674459	3610592
L 13067	L	SAN	1	SCHUBERT CONSTRUCTION	LE	L 13067 POD1	Shallow	4	4	2	34	19S	38E	675159	3610532
L 13144	L	DO M	1	ANDREA CAIRENS	LE	L 13144 POD1	Shallow	4	4	2	34	19S	38E	675486	3611075
L 13183	L	DO M	3	ALBERT C. EWING	LE	L 01442	Shallow	4	4	2	34	19S	38E	675540	3610837
L 13769	L	DO M	1	MANUEL MATA	LE	L 13769 POD1	Artesian	4	4	2	34	19S	38E	674182	3611391

Keach Well No.1 - Leasehold Plat

(Attachment to NMOCD Form C-108, Application for Authority to Inject.)

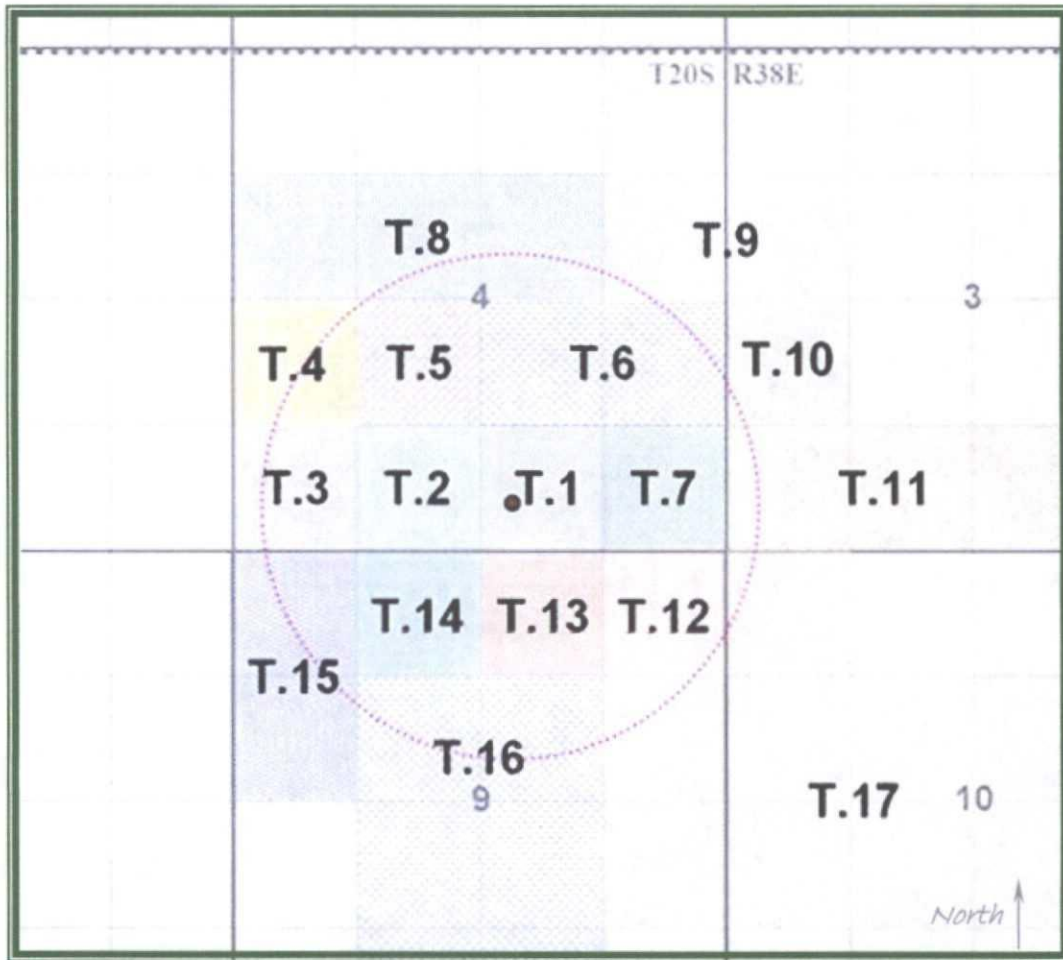

LEGEND

T.1 – Hess Corporation / Roberts	T.10 – / Kaethe Kinimaka, et al
T.2 – JTD Resources, LLC / Roberts	T.11 – ExxonMobil / Roberts
T.3 – Tamarack Petroleum Co. / Roberts	T.12 – / L.M. Roberts
T.4 – Chevron USA, Inc. / McNeil	T.13 – Chevron USA, Inc. / Roberts
T.5 – Primero Operating / Kinimaka	T.14 – JTD Resources, LLC / Roberts
T.6 – Hess Corporation / Kinimaka	T.15 – Tamarack Petroleum Company, Inc. / McCasland
T.7 – Chevron USA, Inc. / Roberts	T.16 – Tamarack Petroleum Company, Inc. / McCasland
T.8 – JTD Resources, LLC	T.17 – / C.S. Eldridge
T.9 – Hess Corporation / Kinimaka	

Note: All tracts identified are Fee Lease / Private Landowner

**C-108 ITEM XIII – PROOF OF NOTIFICATION
INTERESTED PARTIES LIST
Amendment to Original List**

*This listing is only for those additional parties identified during a
secondary review of the application pursuant to
comments by Phillip Goetze in an email on January 8, 2015.*

Additional Notification Sent (All Notified via USPS Certified Mail)

SURFACE OWNER(S)

- 1 C.S. ELDRIDGE
44 Long Branch Ave
Etobicoke, ON M8W3H9.
- 2 KAETHE KINIMAKA
Pineapple Mauka Circle
Ocean View, HI 96737

OFFSET MINERALS LESSEES

- 3 JTD RESOURCES, LLC
415 West Wall Street
Midland, TX 79701
- 4 EXXONMOBIL
503 South Marienfeld Street
Midland, TX 79701

REGULATORY (C-108 Amendment Package)

NEW MEXICO OIL CONSERVATION DIVISION (FedEx'ed original and copy)
1220 S. St. Francis Dr.
Santa Fe, NM 87505

NEW MEXICO OCD DISTRICT 1 OFFICE (FedEx'ed copy)
1625 N. French Drive
Hobbs, New Mexico 88240



February 11, 2015

NOTIFICATION TO INTERESTED PARTIES

Via U.S. Certified Mail

To Whom It May Concern:

Probity Operating, LLC, Midland, Texas, has made application to the New Mexico Oil Conservation Division to convert for salt water disposal its Keach Well No.1. The proposed SWD will be a commercial operation used for disposal of produced water from area operations. As indicated in the notice below, the well is located in Section 4, Township 20 South, Range 38 East in Lea County, New Mexico.

The disposal interval will be through perforations from a maximum top depth of 4440 feet to a maximum bottom depth of 5355 feet in the Lower San Andres formation. Exact intervals will be based on further log analysis.

Following is the legal notice published recently in the Hobbs News-Sun, Hobbs, New Mexico.

LEGAL NOTICE

Pursuant to the rules and regulation of the Oil Conservation Division of the State of New Mexico, Probity SWD, LLC, is filing a C-108, Application for Salt Water Disposal. The well being applied for is the Keach #1, API 30-025-34565, located in Unit O, Section 4, Township 20 South, Range 38 East, 467 FSL & 2310 FED, Lea County, NM. The injection formation is the lower San Andres formation 4440'-5355 below surface. Expected maximum injection rate is 10,000 bpd and the expected maximum injection pressure of 800 psi or what the OCD allows. Any questions about the application can be directed to Amithy Crawford (432)570-1122 PO Box 7307, Midland, TX 79707, or any objection or requires for hearing must be directed to the Oil Conservation Division, (505)476-3440, 1220 South Saint Francis Drive, Santa Fe, NM 87505, within fifteen (15) days.

You have been identified as a party who may be interested as an offset lessee or operator.

You are entitled to a full copy of the application. A full copy in PDF format on a mini-CD will be arriving within a few days of this notice. If you do not receive it, please call or email SOS Consulting, LLC at 903-488-9850, info@sosconsulting.us, and a copy will be expedited to you and may also be sent via email if preferred.

Thank you for your attention in this matter.

Best regards,

A handwritten signature in black ink, appearing to read "Ben Stone". The signature is fluid and cursive, with the first name "Ben" and last name "Stone" clearly distinguishable.

Ben Stone, SOS Consulting, LLC
Agent for Probity Operating, LLC

Cc: Application File

C-108 - Item XIV

Proof of Notice (Certified Mail Receipts)

Registered No.
RE 01675154603

Date Stamp
FEB 11 2015

Reg. Fee
1365

Handling Charge
375

Postage
115

Restricted Delivery
375

Customer Must Declare Full Value \$
0

Domestic Insurance up to \$25,000 is included based upon the declared value. International Indemnity is limited. (See Reverse).

OFFICIAL USE

FROM
SOS CONSULTING, LLC
PO Box 300
COMO, TX 75431

TO
C.S. GORDON
44 LONG BRANCH
ETOBICOKE, ONTARIO M8W3H9

PS Form 3806, Receipt for Registered Mail Copy 1 Customer
May 2007 (7530-02-000-9051) (See Information on Reverse)
For domestic delivery information, visit our website at www.usps.com

U.S. Postal Service™
CERTIFIED MAIL™ RECEIPT
(Domestic Mail Only; No Insurance Coverage Provided)

For delivery information visit our website at www.usps.com

OFFICIAL USE

Postage \$ 49

Certified Fee 330

Return Receipt Fee (Endorsement Required) 270

Restricted Delivery Fee (Endorsement Required)

Total Postage & Fees \$ 649

Sent To
Street, Apt. or PO Box
City, State

Kaethe Kinimaka
Pineapple Mauka Circle
Ocean View, HI 96737

PS Form 3806

U.S. Postal Service™
CERTIFIED MAIL™ RECEIPT
(Domestic Mail Only; No Insurance Coverage Provided)

For delivery information visit our website at www.usps.com

OFFICIAL USE

Postage \$ 49

Certified Fee 330

Return Receipt Fee (Endorsement Required) 270

Restricted Delivery Fee (Endorsement Required)

Total Postage & Fees \$ 649

Sent To
Street, Apt. or PO Box
City, State

JTD RESOURCES, LLC
415 West Wall Street
Midland, TX 79701

PS Form 3806

U.S. Postal Service™
CERTIFIED MAIL™ RECEIPT
(Domestic Mail Only; No Insurance Coverage Provided)

For delivery information visit our website at www.usps.com

OFFICIAL USE

Postage \$ 330

Certified Fee 270

Return Receipt Fee (Endorsement Required) 49

Restricted Delivery Fee (Endorsement Required)

Total Postage & Fees \$ 649

Sent To
Street, Apt. or PO Box
City, State

EXXONMOBIL
503 South Marienfeld Street
Midland, TX 79701

PS Form 3806

February 18, 2015

G A BABER

PROBITY SWD

P. O. BOX 1772

HOBBS, NM 88241

RE: KEACH #1 SWD

Enclosed are the results of analyses for samples received by the laboratory on 02/04/15 13:20.

Cardinal Laboratories is accredited through Texas NELAP under certificate number T104704398-13-5. Accreditation applies to drinking water, non-potable water and solid and chemical materials. All accredited analytes are denoted by an asterisk (*). For a complete list of accredited analytes and matrices visit the TCEQ website at www.tceq.texas.gov/field/qa/lab_accred_certif.html.

Cardinal Laboratories is accredited through the State of Colorado Department of Public Health and Environment for:

Method EPA 552.2	Total Haloacetic Acids (HAA-5)
Method EPA 524.2	Total Trihalomethanes (TTHM)
Method EPA 524.4	Regulated VOCs (V1, V2, V3)

Cardinal Laboratories is accredited through the State of New Mexico Environment Department for:

Method SM 9223-B	Total Coliform and E. coli (Colilert MMO-MUG)
Method EPA 524.2	Regulated VOCs and Total Trihalomethanes (TTHM)
Method EPA 552.2	Total Haloacetic Acids (HAA-5)

Accreditation applies to public drinking water matrices for State of Colorado and New Mexico.

This report meets NELAP requirements and is made up of a cover page, analytical results, and a copy of the original chain-of-custody. If you have any questions concerning this report, please feel free to contact me.

Sincerely,

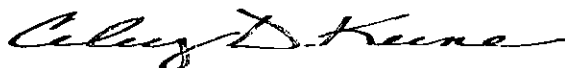

Celey D. Keene

Lab Director/Quality Manager

Analytical Results For:PROBITY SWD
P. O. BOX 1772
HOBBS NM, 88241Project: KEACH #1 SWD
Project Number: NONE GIVEN
Project Manager: G A BABER
Fax To:Reported:
18-Feb-15 16:20

Sample ID	Laboratory ID	Matrix	Date Sampled	Date Received
#1	H500318-01	Water	04-Feb-15 12:45	04-Feb-15 13:20
#2	H500318-02	Water	04-Feb-15 12:45	04-Feb-15 13:20
#3	H500318-03	Water	04-Feb-15 12:45	04-Feb-15 13:20

Cardinal Laboratories

*=Accredited Analyte

PLEASE NOTE: Liability and Damages. Cardinal's liability and client's exclusive remedy for any claim arising, whether based in contract or tort, shall be limited to the amount paid by client for analyses. All claims, including those for negligence or any other cause whatsoever shall be deemed waived unless made in writing and received by Cardinal within thirty (30) days after completion of the applicable service. In no event shall Cardinal be liable for incidental or consequential damage including, without limitation, business interruptions, loss of use, or loss of profits incurred by client, its subsidiaries, affiliates or successors arising out of or related to the performance of the services hereunder by Cardinal, regardless of whether such claim is based upon any of the above stated reasons or otherwise. Results relate only to the samples identified above. This report shall not be reproduced except in full with written approval of Cardinal Laboratories.



Celey D. Keene, Lab Director/Quality Manager

Analytical Results For:PROBITY SWD
P. O. BOX 1772
HOBBS NM, 88241Project: KEACH #1 SWD
Project Number: NONE GIVEN
Project Manager: G A BABER
Fax To:Reported:
18-Feb-15 16:20

#1

H500318-01 (Water)

Analyte	Result	MDL	Reporting Limit	Units	Dilution	Batch	Analyst	Analyzed	Method	Notes
---------	--------	-----	-----------------	-------	----------	-------	---------	----------	--------	-------

Cardinal Laboratories**Inorganic Compounds**

Alkalinity, Bicarbonate	264		5.00	mg/L	1	5020506	AP	06-Feb-15	310.1	
Alkalinity, Carbonate	ND		0.00	mg/L	1	5020506	AP	06-Feb-15	310.1	
Chloride*	72.0		4.00	mg/L	1	5020408	AP	05-Feb-15	4500-Cl-B	
Conductivity*	820		1.00	uS/cm	1	5020605	AP	06-Feb-15	120.1	
pH*	7.62		0.100	pH Units	1	5020603	AP	06-Feb-15	150.1	
Sulfate*	91.0		25.0	mg/L	2.5	5020504	AP	05-Feb-15	375.4	
TDS*	492		5.00	mg/L	1	5012305	AP	05-Feb-15	160.1	
Alkalinity, Total*	216		4.00	mg/L	1	5020506	AP	06-Feb-15	310.1	

Green Analytical Laboratories**Total Recoverable Metals by ICP (E200.7)**

Calcium*	73.1		0.020	mg/L	1	B502076	JGS	09-Feb-15	EPA200.7	
Magnesium*	16.8		0.100	mg/L	1	B502076	JGS	09-Feb-15	EPA200.7	
Potassium*	3.69		1.00	mg/L	1	B502076	JGS	09-Feb-15	EPA200.7	
Sodium*	72.7		0.250	mg/L	1	B502076	JGS	09-Feb-15	EPA200.7	

Cardinal Laboratories

*=Accredited Analyte

PLEASE NOTE: Liability and Damages. Cardinal's liability and client's exclusive remedy for any claim arising, whether based in contract or tort, shall be limited to the amount paid by client for analyses. All claims, including those for negligence or any other cause whatsoever shall be deemed waived unless made in writing and received by Cardinal within thirty (30) days after completion of the applicable service. In no event shall Cardinal be liable for incidental or consequential damage including, without limitation, business interruptions, loss of use, or loss of profits incurred by client, its subsidiaries, affiliates or successors arising out of or related to the performance of the services hereunder by Cardinal, regardless of whether such claim is based upon any of the above stated reasons or otherwise. Results relate only to the samples identified above. This report shall not be reproduced except in full with written approval of Cardinal Laboratories.



Celey D. Keene, Lab Director/Quality Manager

Analytical Results For:

 PROBITY SWD
 P. O. BOX 1772
 HOBBS NM, 88241

 Project: KEACH #1 SWD
 Project Number: NONE GIVEN
 Project Manager: G A BABER
 Fax To:

 Reported:
 18-Feb-15 16:20

 #2
 H500318-02 (Water)

Analyte	Result	MDL	Reporting Limit	Units	Dilution	Batch	Analyst	Analyzed	Method	Notes
---------	--------	-----	-----------------	-------	----------	-------	---------	----------	--------	-------

Cardinal Laboratories
Inorganic Compounds

Alkalinity, Bicarbonate	303		5.00	mg/L	1	5020506	AP	06-Feb-15	310.1	
Alkalinity, Carbonate	ND		0.00	mg/L	1	5020506	AP	06-Feb-15	310.1	
Chloride*	56.0		4.00	mg/L	1	5020408	AP	05-Feb-15	4500-Cl-B	
Conductivity*	788		1.00	uS/cm	1	5020605	AP	06-Feb-15	120.1	
pH*	7.52		0.100	pH Units	1	5020603	AP	06-Feb-15	150.1	
Sulfate*	72.0		25.0	mg/L	2.5	5020504	AP	05-Feb-15	375.4	
TDS*	502		5.00	mg/L	1	5012305	AP	05-Feb-15	160.1	
Alkalinity, Total*	248		4.00	mg/L	1	5020506	AP	06-Feb-15	310.1	

Green Analytical Laboratories
Total Recoverable Metals by ICP (E200.7)

Calcium*	72.2		0.020	mg/L	1	B502076	JGS	09-Feb-15	EPA200.7	
Magnesium*	21.9		0.100	mg/L	1	B502076	JGS	09-Feb-15	EPA200.7	
Potassium*	3.67		1.00	mg/L	1	B502076	JGS	09-Feb-15	EPA200.7	
Sodium*	59.4		0.250	mg/L	1	B502076	JGS	09-Feb-15	EPA200.7	

Cardinal Laboratories

* = Accredited Analyte

PLEASE NOTE: Liability and Damages. Cardinal's liability and client's exclusive remedy for any claim arising, whether based in contract or tort, shall be limited to the amount paid by client for analyses. All claims, including those for negligence or any other cause whatsoever shall be deemed waived unless made in writing and received by Cardinal within thirty (30) days after completion of the applicable service. In no event shall Cardinal be liable for incidental or consequential damage including, without limitation, business interruptions, loss of use, or loss of profits incurred by client, its subsidiaries, affiliates or successors arising out of or related to the performance of the services hereunder by Cardinal, regardless of whether such claim is based upon any of the above stated reasons or otherwise. Results relate only to the samples identified above. This report shall not be reproduced except in full with written approval of Cardinal Laboratories.



Celey D. Keene, Lab Director/Quality Manager

Analytical Results For:

 PROBITY SWD
 P. O. BOX 1772
 HOBBS NM, 88241

 Project: KEACH #1 SWD
 Project Number: NONE GIVEN
 Project Manager: G A BABER
 Fax To:

 Reported:
 18-Feb-15 16:20

#3

11500318-03 (Water)

Analyte	Result	MDL	Reporting Limit	Units	Dilution	Batch	Analyst	Analyzed	Method	Notes
---------	--------	-----	-----------------	-------	----------	-------	---------	----------	--------	-------

Cardinal Laboratories
Inorganic Compounds

Alkalinity, Bicarbonate	224		5.00	mg/L	1	5020506	AP	06-Feb-15	310.1	
Alkalinity, Carbonate	ND		0.00	mg/L	1	5020506	AP	06-Feb-15	310.1	
Chloride*	68.0		4.00	mg/L	1	5020408	AP	05-Feb-15	4500-Cl-B	
Conductivity*	689		1.00	uS/cm	1	5020605	AP	06-Feb-15	120.1	
pH*	7.85		0.100	pH Units	1	5020603	AP	06-Feb-15	150.1	
Sulfate*	70.4		10.0	mg/L	1	5020504	AP	05-Feb-15	375.4	
TDS*	436		5.00	mg/L	1	5012305	AP	05-Feb-15	160.1	
Alkalinity, Total*	184		4.00	mg/L	1	5020506	AP	06-Feb-15	310.1	

Green Analytical Laboratories
Total Recoverable Metals by ICP (E200.7)

Calcium*	71.5		0.020	mg/L	1	B502076	JGS	09-Feb-15	EPA200.7	
Magnesium*	12.2		0.100	mg/L	1	B502076	JGS	09-Feb-15	EPA200.7	
Potassium*	2.86		1.00	mg/L	1	B502076	JGS	09-Feb-15	EPA200.7	
Sodium*	48.0		0.250	mg/L	1	B502076	JGS	09-Feb-15	EPA200.7	

Cardinal Laboratories

* = Accredited Analyte

PLEASE NOTE: Liability and Damages. Cardinal's liability and client's exclusive remedy for any claim arising, whether based in contract or tort, shall be limited to the amount paid by client for analyses. All claims, including those for negligence or any other cause whatsoever shall be deemed waived unless made in writing and received by Cardinal within thirty (30) days after completion of the applicable service. In no event shall Cardinal be liable for incidental or consequential damage including, without limitation, business interruptions, loss of use, or loss of profits incurred by client, its subsidiaries, affiliates or successors arising out of or related to the performance of the services hereunder by Cardinal, regardless of whether such claim is based upon any of the above stated reasons or otherwise. Results relate only to the samples identified above. This report shall not be reproduced except in full with written approval of Cardinal Laboratories.

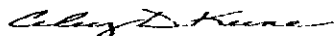

Celey D. Keene, Lab Director/Quality Manager

Analytical Results For:

 PROBITY SWD
 P. O. BOX 1772
 HOBBS NM, 88241

 Project: KEACH #1 SWD
 Project Number: NONE GIVEN
 Project Manager: G A BABER
 Fax To:

 Reported:
 18-Feb-15 16:20

Inorganic Compounds - Quality Control
Cardinal Laboratories

Analyte	Result	Reporting Limit	Units	Spike Level	Source Result	%REC	%REC Limits	RPD	RPD Limit	Notes
Batch 5012305 - Filtration										
Blank (5012305-BLK1)				Prepared & Analyzed: 23-Jan-15						
TDS	ND	5.00	mg/L							
LCS (5012305-BS1)				Prepared & Analyzed: 23-Jan-15						
TDS	514	5.00	mg/L	527		97.5	80-120			
Duplicate (5012305-DUP1)				Source: H500220-04 Prepared & Analyzed: 23-Jan-15						
TDS	572	5.00	mg/L		584			2.08	20	
Batch 5020408 - General Prep - Wet Chem										
Blank (5020408-BLK1)				Prepared & Analyzed: 04-Feb-15						
Chloride	ND	4.00	mg/L							
LCS (5020408-BS1)				Prepared & Analyzed: 04-Feb-15						
Chloride	104	4.00	mg/L	100		104	80-120			
LCS Dup (5020408-BSD1)				Prepared & Analyzed: 04-Feb-15						
Chloride	100	4.00	mg/L	100		100	80-120	3.92	20	
Batch 5020504 - General Prep - Wet Chem										
Blank (5020504-BLK1)				Prepared & Analyzed: 05-Feb-15						
Sulfate	ND	10.0	mg/L							
LCS (5020504-BS1)				Prepared & Analyzed: 05-Feb-15						
Sulfate	21.4	10.0	mg/L	20.0		107	80-120			

Cardinal Laboratories

* = Accredited Analyte

PLEASE NOTE: Liability and Damages. Cardinal's liability and client's exclusive remedy for any claim arising, whether based in contract or tort, shall be limited to the amount paid by client for analyses. All claims, including those for negligence or any other cause whatsoever shall be deemed waived unless made in writing and received by Cardinal within thirty (30) days after completion of the applicable service. In no event shall Cardinal be liable for incidental or consequential damage including, without limitation, business interruptions, loss of use, or loss of profits incurred by client, its subsidiaries, affiliates or successors arising out of or related to the performance of the services hereunder by Cardinal, regardless of whether such claim is based upon any of the above stated reasons or otherwise. Results relate only to the samples identified above. This report shall not be reproduced except in full with written approval of Cardinal Laboratories.

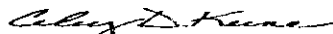

Celey D. Keene, Lab Director/Quality Manager

Analytical Results For:

PROBITY SWD
P. O. BOX 1772
HOBBS NM, 88241

Project: KEACH #1 SWD
Project Number: NONE GIVEN
Project Manager: G A BABER
Fax To:

Reported:
18-Feb-15 16:20

Inorganic Compounds - Quality Control
Cardinal Laboratories

Analyte	Result	Reporting Limit	Units	Spike Level	Source Result	%REC	%REC Limits	RPD	RPD Limit	Notes
---------	--------	-----------------	-------	-------------	---------------	------	-------------	-----	-----------	-------

Batch 5020504 - General Prep - Wet Chem
LCS Dup (5020504-BSD1)

Prepared & Analyzed: 05-Feb-15

Sulfate	21.2	10.0	mg/L	20.0		106	80-120	0.939	20	
---------	------	------	------	------	--	-----	--------	-------	----	--

Batch 5020506 - General Prep - Wet Chem
Blank (5020506-BLK1)

Prepared: 05-Feb-15 Analyzed: 06-Feb-15

Alkalinity, Carbonate	ND	0.00	mg/L							
Alkalinity, Bicarbonate	ND	5.00	mg/L							
Alkalinity, Total	ND	4.00	mg/L							

LCS (5020506-BS1)

Prepared: 05-Feb-15 Analyzed: 06-Feb-15

Alkalinity, Carbonate	ND	0.00	mg/L				80-120			
Alkalinity, Bicarbonate	127	5.00	mg/L				80-120			
Alkalinity, Total	104	4.00	mg/L	100		104	80-120			

LCS Dup (5020506-BSD1)

Prepared: 05-Feb-15 Analyzed: 06-Feb-15

Alkalinity, Carbonate	ND	0.00	mg/L				80-120		20	
Alkalinity, Bicarbonate	127	5.00	mg/L				80-120	0.00	20	
Alkalinity, Total	104	4.00	mg/L	100		104	80-120	0.00	20	

Batch 5020603 - General Prep - Wet Chem
LCS (5020603-BS1)

Prepared & Analyzed: 06-Feb-15

pH	7.08		pH Units	7.00		101	90-110			
----	------	--	----------	------	--	-----	--------	--	--	--

Duplicate (5020603-DUP1)

Source: H500306-01

Prepared & Analyzed: 06-Feb-15

pH	7.14	0.100	pH Units	7.14				0.00	20	
----	------	-------	----------	------	--	--	--	------	----	--

Cardinal Laboratories

*=Accredited Analyte

PLEASE NOTE: Liability and damages. Cardinal's liability and client's exclusive remedy for any claim arising, whether based in contract or tort, shall be limited to the amount paid by client for analyses. All claims, including those for negligence or any other cause whatsoever, shall be deemed waived unless made in writing and received by Cardinal within thirty (30) days after completion of the applicable service. In no event shall Cardinal be liable for incidental or consequential damage including, without limitation, business interruptions, loss of use, or loss of profits incurred by client, its subsidiaries, affiliates or successors arising out of or related to the performance of the services hereunder by Cardinal, regardless of whether such claim is based upon any of the above stated reasons or otherwise. Results relate only to the samples identified above. This report shall not be reproduced except in full with written approval of Cardinal Laboratories.



Caley D. Keene, Lab Director/Quality Manager

Analytical Results For:PROBITY SWD
P. O. BOX 1772
HOBBS NM, 88241Project: KEACH #1 SWD
Project Number: NONE GIVEN
Project Manager: G A BABER
Fax To:Reported:
18-Feb-15 16:20**Inorganic Compounds - Quality Control****Cardinal Laboratories**

Analyte	Result	Reporting Limit	Units	Spike Level	Source Result	%REC	%REC Limits	RPD	RPD Limit	Notes
---------	--------	--------------------	-------	----------------	------------------	------	----------------	-----	--------------	-------

Batch 5020605 - General Prep - Wet Chem**LCS (5020605-BS1)**

Prepared & Analyzed: 06-Feb-15

Conductivity	507		uS/cm	500		101	80-120			
--------------	-----	--	-------	-----	--	-----	--------	--	--	--

Duplicate (5020605-DUP1)

Source: II500306-01

Prepared & Analyzed: 06-Feb-15

Conductivity	2340	1.00	uS/cm		2350			0.256	20	
--------------	------	------	-------	--	------	--	--	-------	----	--

Cardinal Laboratories

* = Accredited Analyte

PLEASE NOTE: Liability and Damages. Cardinal's liability and client's exclusive remedy for any claim arising, whether based in contract or tort, shall be limited to the amount paid by client for analyses. All claims, including those for negligence or any other cause whatsoever shall be deemed waived unless made in writing and received by Cardinal within thirty (30) days after completion of the applicable service. In no event shall Cardinal be liable for incidental or consequential damage including, without limitation, business interruptions, loss of use, or loss of profits incurred by client, its subsidiaries, affiliates or successors arising out of or related to the performance of the services hereunder by Cardinal, regardless of whether such claim is based upon any of the above stated reasons or otherwise. Results relate only to the samples identified above. This report shall not be reproduced except in full with written approval of Cardinal Laboratories.



Celey D. Keene, Lab Director/Quality Manager

Analytical Results For:

PROBITY SWD
P. O. BOX 1772
HOBBS NM, 88241

Project: KEACH #1 SWD
Project Number: NONE GIVEN
Project Manager: G A BABER
Fax To:

Reported:
18-Feb-15 16:20

Total Recoverable Metals by ICP (E200.7) - Quality Control

Green Analytical Laboratories

Analyte	Result	Reporting Limit	Units	Spike Level	Source Result	%REC	%REC Limits	RPD	RPD Limit	Notes
---------	--------	-----------------	-------	-------------	---------------	------	-------------	-----	-----------	-------

Batch B502076 - Total Recoverable, Direct Analysis E200.7/E200.8

Blank (B502076-BLK1)

Prepared & Analyzed: 09-Feb-15

Magnesium	ND	0.100	mg/L							
Calcium	ND	0.020	mg/L							
Sodium	ND	0.250	mg/L							
Potassium	ND	1.00	mg/L							

LCS (B502076-BS1)

Prepared & Analyzed: 09-Feb-15

Magnesium	24.8	0.100	mg/L	25.0		99.3	85-115			
Potassium	10.4	1.00	mg/L	10.0		104	85-115			
Sodium	8.29	0.250	mg/L	8.10		102	85-115			
Calcium	4.63	0.020	mg/L	5.00		92.6	85-115			

LCS Dup (B502076-BSD1)

Prepared & Analyzed: 09-Feb-15

Potassium	10.4	1.00	mg/L	10.0		104	85-115	0.593	20	
Magnesium	24.8	0.100	mg/L	25.0		99.4	85-115	0.0949	20	
Calcium	4.64	0.020	mg/L	5.00		92.8	85-115	0.260	20	
Sodium	8.23	0.250	mg/L	8.10		102	85-115	0.648	20	

Cardinal Laboratories

*=Accredited Analyte

PLEASE NOTE: Liability and Damages. Cardinal's liability and client's exclusive remedy for any claim arising, whether based in contract or tort, shall be limited to the amount paid by client for analyses. All claims, including those for negligence or any other cause whatsoever shall be deemed waived unless made in writing and received by Cardinal within thirty (30) days after completion of the applicable service. In no event shall Cardinal be liable for incidental or consequential damage including, without limitation, business interruptions, loss of use, or loss of profits incurred by client, its subsidiaries, affiliates or successors arising out of or related to the performance of the services hereunder by Cardinal, regardless of whether such claim is based upon any of the above stated reasons or otherwise. Results relate only to the samples identified above. This report shall not be reproduced except in full with written approval of Cardinal Laboratories.

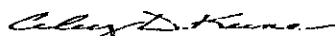

Celey D. Keene, Lab Director/Quality Manager

Notes and Definitions

ND	Analyte NOT DETECTED at or above the reporting limit
RPD	Relative Percent Difference
**	Samples not received at proper temperature of 6°C or below.
***	Insufficient time to reach temperature.
-	Chloride by SM4500Cl-B does not require samples be received at or below 6°C Samples reported on an as received basis (wet) unless otherwise noted on report

Cardinal Laboratories

*=Accredited Analyte

PLEASE NOTE: Liability and Damages. Cardinal's liability and client's exclusive remedy for any claim arising, whether based in contract or tort, shall be limited to the amount paid by client for analyses. All claims, including those for negligence or any other cause whatsoever shall be deemed waived unless made in writing and received by Cardinal within thirty (30) days after completion of the applicable service. In no event shall Cardinal be liable for incidental or consequential damage including, without limitation, business interruptions, loss of use, or loss of profits incurred by client, its subsidiaries, affiliates or successors arising out of or related to the performance of the services hereunder by Cardinal, regardless of whether such claim is based upon any of the above stated reasons or otherwise. Results relate only to the samples identified above. This report shall not be reproduced except in full with written approval of Cardinal Laboratories.



Celey D. Keene, Lab Director/Quality Manager



Page 11 of 11

[illegible]

† Cardinal cannot accept verbal changes. Please fax written changes to (575) 393-2326



C-108 Review Checklist: Received 4/19/14 Add. Request from Rep Reply Date: 02/12/15 Suspended: _____ (Ver 15)

ORDER TYPE: WFX / PMX / SWD Number: 1543 Order Date: 04/02/15 Legacy Permits/Orders: 2 SWD orders + 2 SWD Appl.

Well No. 1 Well Name(s): Keach

API: 30-0 25-34565 Spud Date: _____ New or Old: _____ (UIC Class II Primacy 03/07/1982)

Footages 467 F8L / 2310 FEL Lot - or Unit 0 Sec 4 Tsp 20S Rge 38E County Lea

General Location: ~6 miles S of Hobbs / west of SR 18 Pool: SWD: Paddock Pool No.: 96121

BLM 100K Map: Hobbs Operator: Probity SWD LLC Nadine: San Andres, SE - former producer OGRID: _____ Contact: Earl Stone

COMPLIANCE RULE 5.9: Total Wells: 1 Inactive: 0 Fincl Assur: Yes Compl. Order? No IS 5.9 OK? Yes Date: 04/02/15

WELL FILE REVIEWED ☒ Current Status: P&A; prior SWD well in Paddock; Producer from San Andres

WELL DIAGRAMS: NEW: Proposed ☐ or RE-ENTER: Before Conv. ☒ After Conv. ☒ Logs in Imaging: _____

Planned Rehab Work to Well: Drill out plugs to proposed casing depth / (new perf); CIBP; perf; run tubing

Well Construction Details		Sizes (in) Borehole / Pipe	Setting Depths (ft)	Cement Sx or Cf	Cement Top and Determination Method
Planned <input type="checkbox"/> or Existing <input checked="" type="checkbox"/> Surface		12 1/4 / 8 5/8	0 to 1577	475	Ar. to surface
Planned <input type="checkbox"/> or Existing <input checked="" type="checkbox"/> Interm/Prod		7 7/8 / 5 1/2	0 to 7895	1205	2710' / calc.
Planned <input type="checkbox"/> or Existing <input type="checkbox"/> Interm/Prod		---	---	---	---
Planned <input type="checkbox"/> or Existing <input type="checkbox"/> Prod/Liner		---	---	---	---
Planned <input type="checkbox"/> or Existing <input type="checkbox"/> Liner		---	---	---	---
Planned <input checked="" type="checkbox"/> or Existing <input type="checkbox"/> OH (PERF)		7 7/8 / 5 1/2	4440' to 5355'	Inj Length 915	

Injection Lithostratigraphic Units	Depths (ft)	Injection or Confining Units	Tops
Adjacent Unit: Litho. Struc. Por.			
Confining Unit: <u>Litho.</u> Struc. <u>Por.</u>	1366	Grauburg	4074
Proposed Inj Interval TOP:	4440	San Andres Fm	4218
Proposed Inj Interval BOTTOM:	5355		
Confining Unit: <u>Litho.</u> Struc. <u>Por.</u>	5531	Glorietta	5531
Adjacent Unit: Litho. Struc. Por.		Blinberry	5992

Completion/Operation Details:	
Drilled TD	7921 P&A
NEW TD	7921-NEW P&A
NEW Open Hole	or NEW Perfs
Tubing Size	2 7/8 in. Inter Coated? <u>Yes</u>
Proposed Packer Depth	4340 ft
Min. Packer Depth	4340 (100-ft limit)
Proposed Max. Surface Press.	800-1200 psi
Admin. Inj. Press.	880 (0.2 psi per ft)

AOR: Hydrologic and Geologic Information

POTASH: R-111-P No Noticed? NA BLM Sec Ord No WIPP No Noticed? NA Salt/Salado T: _____ B: _____ NW: Cliff House fm _____

FRESH WATER: Aquifer 1 Ogallala 2 Santa Rosa Max Depth 0-150' @ <150' HYDRO AFFIRM STATEMENT By Qualified Person ☒

NMOSE Basin: Lea CAPITAN REEF: thru ☐ adj ☐ NAD ☒ No. Wells within 1-Mile Radius? 3 FW Analysis ☒

Disposal Fluid: Formation Source(s) San Andres Analysis? Historical On Lease ☐ Operator Only ☐ or Commercial ☒

Disposal Int: Inject Rate (Avg/Max BWPD): 10000/25000 Protectable Waters? No Source: Analysis System: Closed ☒ or Open ☐

HC Potential: Producing Interval? No Formerly Producing? Yes Method: Logs/DS/P&A/Other _____ 2-Mile Radius Pool Map ☒

AOR Wells: 1/2-M Radius Map? Yes Well List? Yes Total No. Wells Penetrating Interval: 8 Horizontals? No

Penetrating Wells: No. Active Wells 7 Num Repairs? 0 on which well(s)? _____ Diagrams? Yes

Penetrating Wells: No. P&A Wells 1 Num Repairs? 0 on which well(s)? _____ Diagrams? Yes

NOTICE: Newspaper Date 11/13/2014 Mineral Owner Private Surface Owner Private N. Date 02/11/2015

RULE 26.7(A): Identified Tracts? Yes Affected Persons: 8 parties Eldridge & Kinimaka N. Date 02/11/2015

Order Conditions: Issues: Cont during P&A/perfs/calc. TOC 4/13/14

Add Order Cond: CBL for 5 1/2-in. casing; cont rep on CIBP

Production Info on San Andres

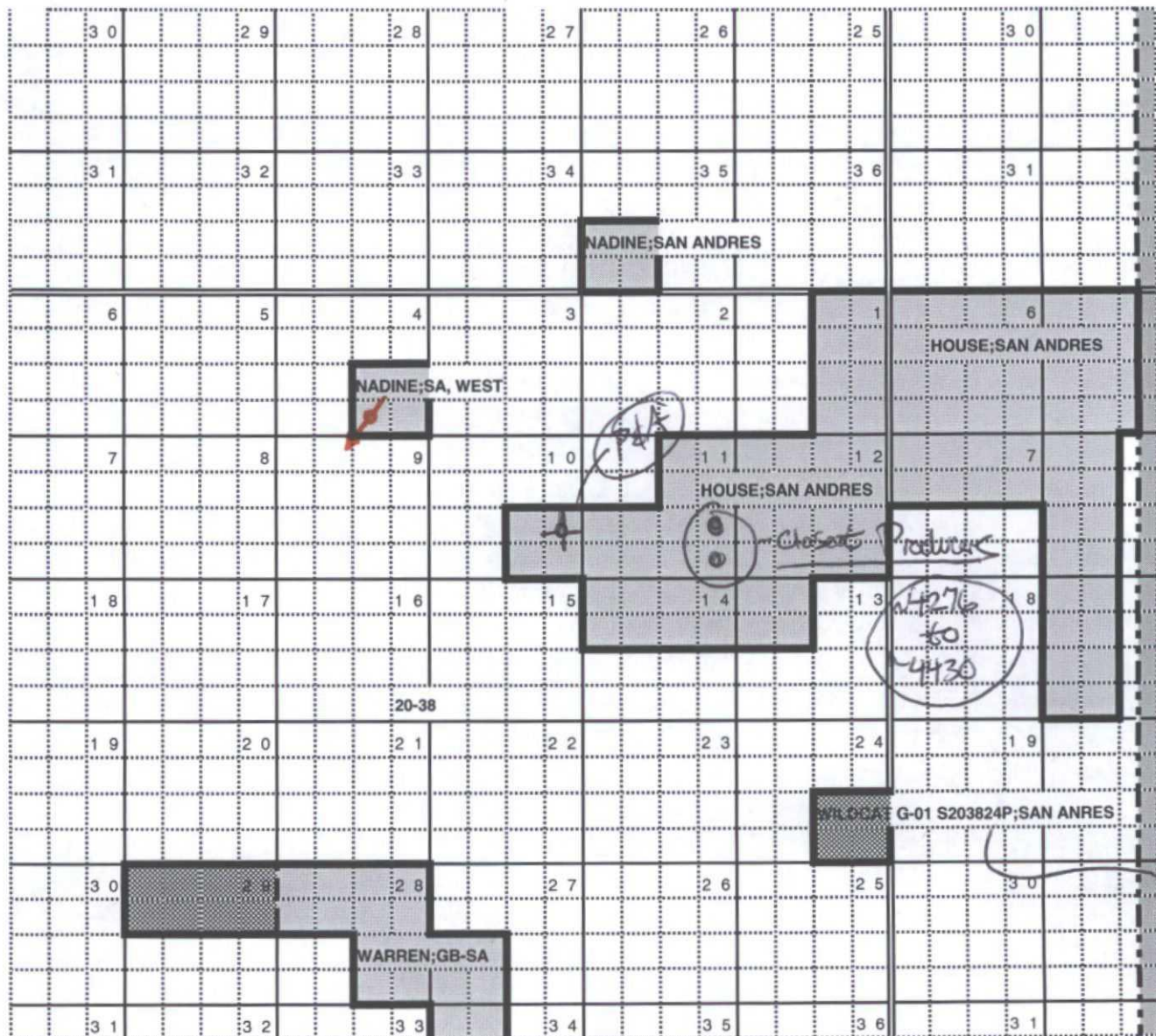

Nadine; SA, West: R-11304 01/12/2000
Keach #1 is discovery/pool has no other producers well