

District I
1625 N. French Dr., Hobbs, NM 88240
District II
811 S. First St., Artesia, NM 88210
District III
1000 Rio Brazos Road, Aztec, NM 87410
District IV
1220 S. St. Francis Dr., Santa Fe, NM 87505

State of New Mexico
Energy Minerals and Natural Resources
Oil Conservation Division
1220 South St. Francis Dr.
Santa Fe, NM 87505

NM OIL CONSERVATION

ARTESIA DISTRICT

Form C-141

MAR 25 2015 Revised August 8, 2011

Submit 1 Copy to appropriate District Office in accordance with 19.15.29 NMAC.

RECEIVED

Release Notification and Corrective Action

NAB1510631004

OPERATOR

☒ Initial Report ☐ Final Report

Name of Company: BOPCO, L.P. <i>260737</i>	Contact: Tony Savoie
Address: 522 W. Mermod, Suite 704 Carlsbad, N.M. 88220	Telephone No. 575-887-7329
Facility Name: PLU-85	Facility Type: Exploration and Production

Surface Owner: Federal	Mineral Owner: Federal	API No. 30-015-27911
------------------------	------------------------	----------------------

LOCATION OF RELEASE

Unit Letter H	Section 25	Township 24S	Range 30E	Feet from the 1930	North/South Line North	Feet from the 710	East/West Line East	County Eddy
------------------	---------------	-----------------	--------------	-----------------------	---------------------------	----------------------	------------------------	----------------

Latitude N 32.190801 Longitude W 103.827930

NATURE OF RELEASE

Type of Release: Crude oil and produced water	Volume of Release: 1 Bbl oil and 7 Bbls produced water	Volume Recovered: less than 1/2 bbl oil and 4 bbls produced water
Source of Release: High pressure hose	Date and Hour of Occurrence: 3/23/15 time unknown	Date and Hour of Discovery: 3/23/15 at approximately 2:30 p.m.
Was Immediate Notice Given? <input type="checkbox"/> Yes <input type="checkbox"/> No <input checked="" type="checkbox"/> Not Required	If YES, To Whom?	
By Whom?	Date and Hour	
Was a Watercourse Reached? <input type="checkbox"/> Yes <input checked="" type="checkbox"/> No	If YES, Volume Impacting the Watercourse.	

If a Watercourse was Impacted, Describe Fully.*

Describe Cause of Problem and Remedial Action Taken.*

A 1/4" hose to the high pressure kill switch ruptured. The valve was shut and the hose was replaced.

Describe Area Affected and Cleanup Action Taken.*

The spill impacted approximately 1525 sq.ft. of caliche well pad. The free standing fluid was recovered with a vacuum truck. The stained area was left as pending the final remediation.

I hereby certify that the information given above is true and complete to the best of my knowledge and understand that pursuant to NMOCD rules and regulations all operators are required to report and/or file certain release notifications and perform corrective actions for releases which may endanger public health or the environment. The acceptance of a C-141 report by the NMOCD marked as "Final Report" does not relieve the operator of liability should their operations have failed to adequately investigate and remediate contamination that pose a threat to ground water, surface water, human health or the environment. In addition, NMOCD acceptance of a C-141 report does not relieve the operator of responsibility for compliance with any other federal, state, or local laws and/or regulations.

Signature: <i>Tony Savoie</i>	OIL CONSERVATION DIVISION	
Printed Name: Tony Savoie	Signed By <i>M. L. Brannon</i> Approved by Environmental Specialist	
Title: Waste Management and Remediation Specialist	Approval Date: <i>4/16/15</i>	Expiration Date: <i>N/A</i>
E-mail Address: <i>tasavoie@basspet.com</i>	Conditions of Approval: Remediation per O.C.D. Rules & Guidelines SUBMIT REMEDIATION PROPOSAL NO	
Date: <i>3/25/15</i> Phone: 432-556-8730	Attached <input type="checkbox"/>	

* Attach Additional Sheets If Necessary

LATER THAN: *5/16/15*

2RP-2952

FIELD SPILL REPORT

Distribution List: CJ Barry, TA Savoie, B. Biehl, RL Gawlik, JR Smitherman, SF Johnson, FD Schoch, G Fletcher, C Giese, J Fuqua, A Ruth, A Thompson, B Blevins, K Bright

DATE: March 23, 2015

LOCATION OF SPILL SITE: PLU 085 (API 30-015-27911)

UL H-25-24S-30E 1930 FNL & 710 FEL Eddy Co.

GPS COORDINATES (Lat & Long): 32.190801, -103.827930

ESTIMATED VOLUMES (Oil & Water Separately):

*If BBLs Recovered are not available at time of Initial Report: Send in Follow-up report when numbers are known

Volume spilled:			*BBLs Recovered	Net Spilled			*BBLs Recovered	Net Spilled
		BBLs Spilled				BBLs Spilled		
On ground /or earth berm -	Oil:	1	0.5	0.5	Water:	7	4	3
Contained in impervious liner -	Oil:			0	Water:			0
Total:	Oil:	1	0.5	0.5	Water:	7	4	3

DESCRIPTION (What happened?):

High Pressure hose on the kill switch ruptured due to weathering of hose.

SPILL RESPONSE (How was the spill cleaned up?):

Site was reviewed on 3/23/15. Vacuum truck was able to recover 0.5 bbl of crude oil and approximately 4 bbls of produced water. Hose to be replaced.

PICTURE ATTACHMENT:

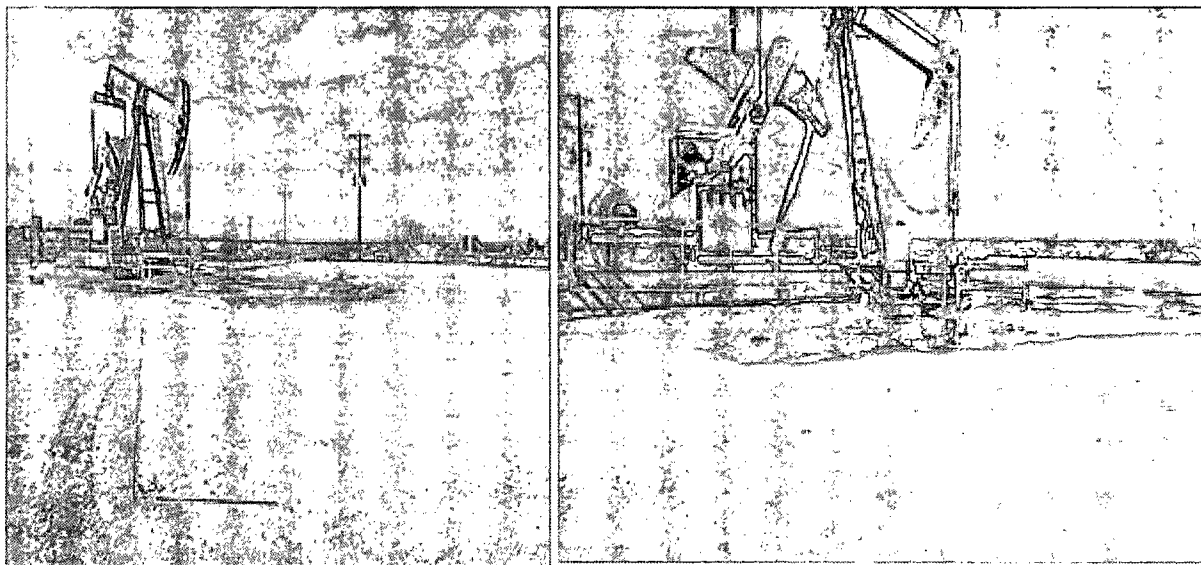

3.23.15 EHS

A. Ruth

FLU #085

HP hose on the kill switch ruptured due to weathering. Was recovered 1/2 bbl oil and 4 bbls PLW. Detected 1525 # of pad. HP hose will be replaced with SS tubing.

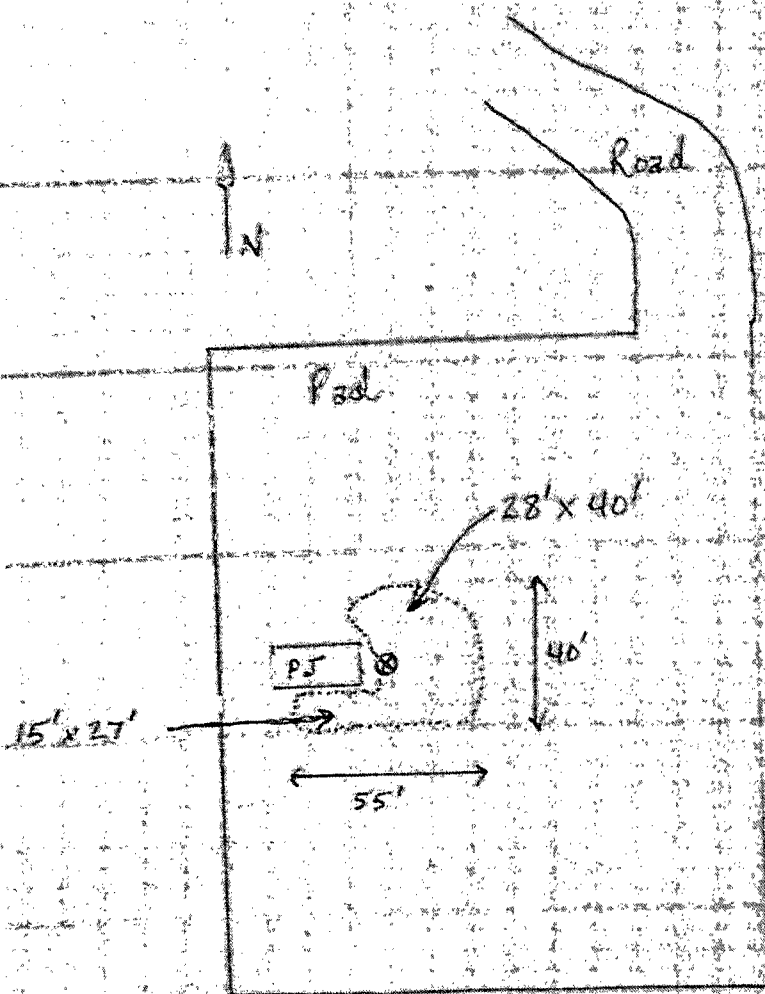

N 32.190801°
W 103.827930°

Oil

$$28' \times 40' \times \frac{1}{4}'' = \boxed{0.21 \text{ bbls}}$$

PLW

$$28' \times 40' \times \frac{3}{4}'' = 2.49$$

$$15' \times 27' \times 1'' = 0.30$$

$$\boxed{2.79 \text{ bbls}}$$