

## Bratcher, Mike, EMNRD

---

**From:** Michael Stubblefield [mstubblefield@talonlpe.com]  
**Sent:** Friday, September 23, 2011 9:07 AM  
**To:** Bratcher, Mike, EMNRD  
**Cc:** gnewton@pvtnetworks.net  
**Subject:** FW: ARTESIA UNIT NO 32  
**Attachments:** H102002 TALON.pdf; diagram for Artesia Unit No. 32.pdf

Mike,

Talon/LPE is sending you the analytical results for the soil samples collected on 9/14/2011 from the excavated area at the Quantum Resources Management Artesia Unit No. 32 release. Please review the analytical results, I will be over to your office to discuss further steps to taken for the remediation at the Artesia Unit No. 32 release site.

Mike Stubblefield  
Talon/LPE Project Manager

---

**From:** Celey Keene [<mailto:celey.keene@cardinallabsnm.com>]  
**Sent:** Thursday, September 22, 2011 2:14 PM  
**To:** Michael Stubblefield  
**Cc:** David Adkins  
**Subject:** ARTESIA UNIT NO 32

THANK YOU,

**Celey Keene**  
**Lab Director**  
**Cardinal Laboratories**  
101 East Marland  
Hobbs, NM 88240  
T: (575) 393-2326  
F: (575) 393-2476  
e-mail: [celey.keene@cardinallabsnm.com](mailto:celey.keene@cardinallabsnm.com)



Drawn By: TJS

Scale: 1" = 150'

Date: 06/30/2011

Artesia Unit No. 32  
Quantum Resources Management, LLC  
Eddy County, New Mexico  
Attachment I - Site Plan w/Sample Locations

Scale in Feet  
0 75 150



Legend  
- Sample Location  
- Impacted Area

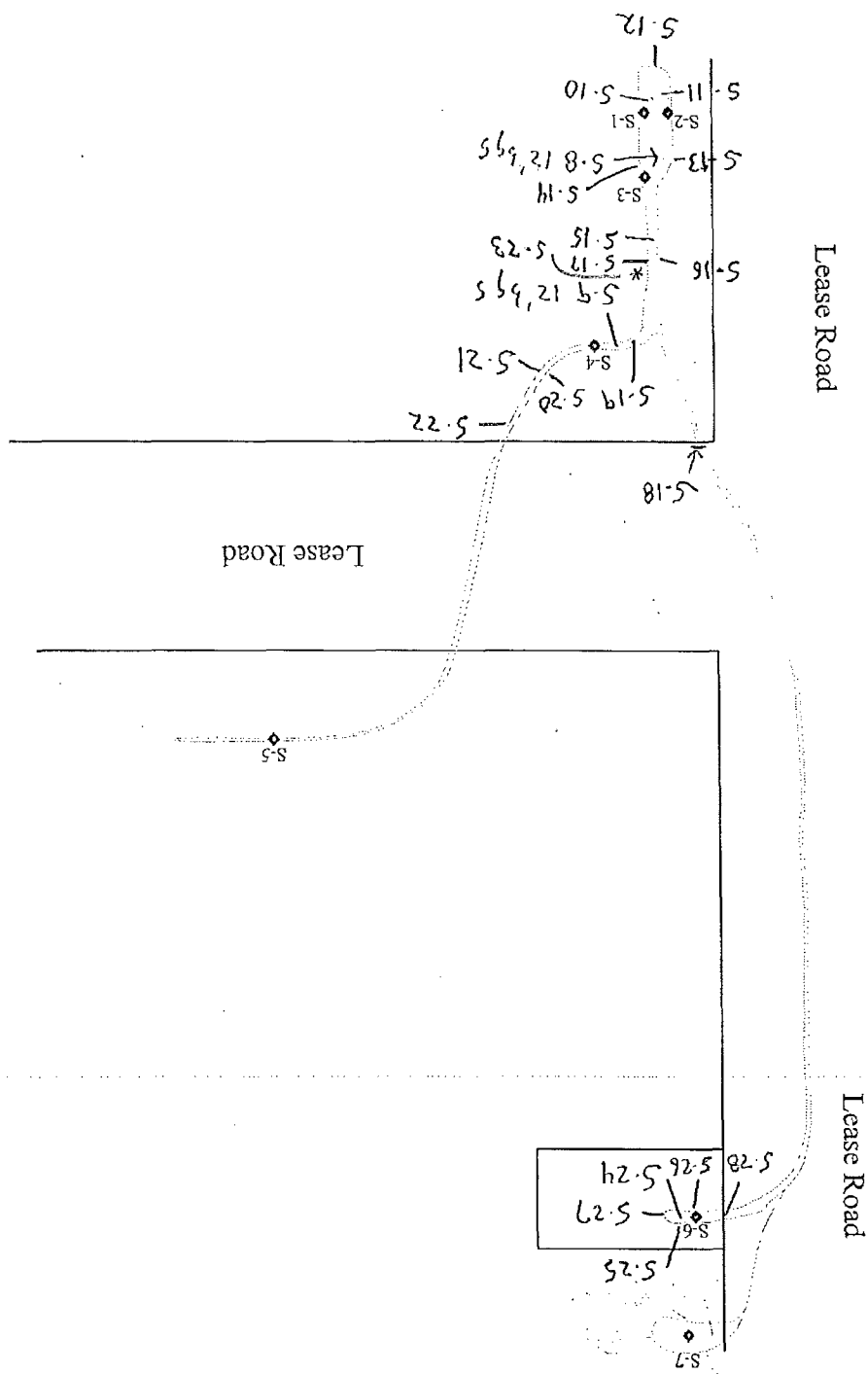



PHONE (575) 393-2326 ° 101 E. MARLAND ° HOBBS, NM 88240

---

September 22, 2011

MIKE STUBBLEFIELD

TALON LPE

408 W. TEXAS AVE.

ARTESIA, NM 88210

RE: ARTESIA UNIT #32

Enclosed are the results of analyses for samples received by the laboratory on 09/20/11 15:12.

Cardinal Laboratories is accredited through Texas NELAP for:

Method SW-846 8021	Benzene, Toluene, Ethyl Benzene, and Total Xylenes
Method SW-846 8260	Benzene, Toluene, Ethyl Benzene, and Total Xylenes
Method TX 1005	Total Petroleum Hydrocarbons

Certificate number T104704398-08-TX. Accreditation applies to solid and chemical materials and non-potable water matrices.

Cardinal Laboratories is accredited through the State of Colorado Department of Public Health and Environment for:

Method EPA 552.2	Haloacetic Acids (HAA-5)
Method EPA 524.2	Total Trihalomethanes (TTHM)
Method EPA 524.4	Regulated VOCs (V2, V3)

Accreditation applies to public drinking water matrices.

This report meets NELAP requirements and is made up of a cover page, analytical results, and a copy of the original chain-of-custody. If you have any questions concerning this report, please feel free to contact me.

Sincerely,

Celey D. Keene

Lab Director/Quality Manager

**Analytical Results For:**

 TALON LPE  
 MIKE STUBBLEFIELD  
 408 W. TEXAS AVE.  
 ARTESIA NM, 88210  
 Fax To: (575) 745-8905

 Received: 09/20/2011  
 Reported: 09/22/2011  
 Project Name: ARTESIA UNIT #32  
 Project Number: 701407.009.01  
 Project Location: SEC. 36-T17S.R28E

 Sampling Date: 09/14/2011  
 Sampling Type: Soil  
 Sampling Condition: \*\* (See Notes)  
 Sample Received By: Jodi Henson

**Sample ID: S-8 12' BGS (H102002-01)**

Chloride, SM4500Cl-B		mg/kg		Analyzed By: HM					
Analyte	Result	Reporting Limit	Analyzed	Method Blank	BS	% Recovery	True Value QC	RPD	Qualifier
Chloride	240	16.0	09/21/2011	ND	416	104	400	3.77	

**Sample ID: S-9 12' BGS (H102002-02)**

Chloride, SM4500Cl-B		mg/kg		Analyzed By: HM						
Analyte	Result	Reporting Limit	Analyzed	Method Blank	BS	% Recovery	True Value QC	RPD	Qualifier	
Chloride	368	16.0	09/21/2011	ND	416	104	400	3.77		

**Sample ID: S-10 BTTM EXC 5' BGS (H102002-03)**

Chloride, SM4500Cl-B		mg/kg		Analyzed By: HM					
Analyte	Result	Reporting Limit	Analyzed	Method Blank	BS	% Recovery	True Value QC	RPD	Qualifier
Chloride	7360	16.0	09/21/2011	ND	416	104	400	3.77	

**Sample ID: S-11 BTTM EXC 3' BGS (H102002-04)**

Chloride, SM4500Cl-B		mg/kg		Analyzed By: HM						
Analyte	Result	Reporting Limit	Analyzed	Method Blank	BS	% Recovery	True Value QC	RPD	Qualifier	
Chloride	32.0	16.0	09/21/2011	ND	416	104	400	3.77		

Cardinal Laboratories

\*=Accredited Analyte

PLEASE NOTE: Liability and Damages. Cardinal's liability and client's exclusive remedy for any claim arising, whether based in contract or tort, shall be limited to the amount paid by client for analyses. All claims, including those for negligence and any other cause whatsoever shall be deemed waived unless made in writing and received by Cardinal within thirty (30) days after completion of the applicable service. In no event shall Cardinal be liable for incidental or consequential damages, including, without limitation, business interruptions, loss of use, or loss of profits incurred by client, its subsidiaries, affiliates or successors arising out of or related to the performance of the services hereunder by Cardinal, regardless of whether such claim is based upon any of the above stated reasons or otherwise. Results relate only to the samples identified above. This report shall not be reproduced except in full with written approval of Cardinal Laboratories.

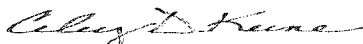

Celestine D. Keene, Lab Director/Quality Manager

**Analytical Results For:**

TALON LPE  
MIKE STUBBLEFIELD  
408 W. TEXAS AVE.  
ARTESIA NM, 88210  
Fax To: (575) 745-8905

Received: 09/20/2011  
Reported: 09/22/2011  
Project Name: ARTESIA UNIT #32  
Project Number: 701407.009.01  
Project Location: SEC. 36-T17S.R28E

Sampling Date: 09/14/2011  
Sampling Type: Soil  
Sampling Condition: \*\* (See Notes)  
Sample Received By: Jodi Henson

**Sample ID: S-12 SOUTHSIDE WALL (H102002-05)**

Chloride, SM4500Cl-B		mg/kg		Analyzed By: HM					
Analyte	Result	Reporting Limit	Analyzed	Method Blank	BS	% Recovery	True Value QC	RPD	Qualifier
Chloride	224	16.0	09/21/2011	ND	416	104	400	3.77	

**Sample ID: S-13 WESTSIDE WALL (H102002-06)**

Chloride, SM4500Cl-B		mg/kg		Analyzed By: HM						
Analyte	Result	Reporting Limit	Analyzed	Method Blank	BS	% Recovery	True Value QC	RPD	Qualifier	
Chloride	64.0	16.0	09/21/2011	ND	416	104	400	3.77		

**Sample ID: S-14 EASTSIDE WALL (H102002-07)**

Chloride, SM4500Cl-B		mg/kg		Analyzed By: HM						
Analyte	Result	Reporting Limit	Analyzed	Method Blank	BS	% Recovery	True Value QC	RPD	Qualifier	
Chloride	64.0	16.0	09/21/2011	ND	416	104	400	3.77		

**Sample ID: S-15 BTM EXC 3' BGS (H102002-08)**

Chloride, SM4500Cl-B		mg/kg		Analyzed By: HM					
Analyte	Result	Reporting Limit	Analyzed	Method Blank	BS	% Recovery	True Value QC	RPD	Qualifier
Chloride	1600	16.0	09/21/2011	ND	416	104	400	3.77	

**Sample ID: S-16 WESTSIDE WALL (H102002-09)**

Chloride, SM4500Cl-B		mg/kg		Analyzed By: HM						
Analyte	Result	Reporting Limit	Analyzed	Method Blank	BS	% Recovery	True Value QC	RPD	Qualifier	
Chloride	144	16.0	09/21/2011	ND	416	104	400	7.41		

Cardinal Laboratories

\*=Accredited Analyte

PLEASE NOTE: Liability and Damages. Cardinal's liability and client's exclusive remedy for any claim arising, whether based in contract or tort, shall be limited to the amount paid by client for analyses. All claims, including those for negligence and any other cause whatsoever shall be deemed waived unless made in writing and received by Cardinal within thirty (30) days after completion of the applicable service. In no event shall Cardinal be liable for incidental or consequential damages, including, without limitation, business interruptions, loss of use, or loss of profits incurred by client, its subsidiaries, affiliates or successors arising out of or related to the performance of the services hereunder by Cardinal, regardless of whether such claim is based upon any of the above stated reasons or otherwise. Results relate only to the samples identified above. This report shall not be reproduced except in full with written approval of Cardinal Laboratories.

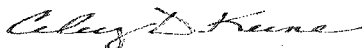

Celey D. Keene, Lab Director/Quality Manager

**Analytical Results For:**

TALON LPE  
MIKE STUBBLEFIELD  
408 W. TEXAS AVE.  
ARTESIA NM, 88210  
Fax To: (575) 745-8905

Received: 09/20/2011  
Reported: 09/22/2011  
Project Name: ARTESIA UNIT #32  
Project Number: 701407.009.01  
Project Location: SEC. 36-T17S.R28E

Sampling Date: 09/14/2011  
Sampling Type: Soil  
Sampling Condition: \*\* (See Notes)  
Sample Received By: Jodi Henson

**Sample ID: S-17 EASTSIDE WALL (H102002-10)**

Chloride, SM4500Cl-B		mg/kg		Analyzed By: HM						
Analyte	Result	Reporting Limit	Analyzed	Method Blank	BS	% Recovery	True Value QC	RPD	Qualifier	
Chloride	3400	16.0	09/21/2011	ND	416	104	400	7.41		

**Sample ID: S-18 NORTHSIDE WALL (H102002-11)**

Chloride, SM4500Cl-B		mg/kg	Analyzed By: HM							
Analyte	Result	Reporting Limit	Analyzed	Method Blank	BS	% Recovery	True Value QC	RPD	Qualifier	
Chloride	2600	16.0	09/21/2011	ND	416	104	400	7.41		

**Sample ID: S-19 BTM EXC 4' BGS (H102002-12)**

Chloride, SM4500Cl-B		mg/kg		Analyzed By: HM						
Analyte	Result	Reporting Limit	Analyzed	Method Blank	BS	% Recovery	True Value QC	RPD	Qualifier	
Chloride	3240	16.0	09/21/2011	ND	416	104	400	7.41		

**Sample ID: S-20 NORTHSIDE WALL (H102002-13)**

Chloride, SM4500Cl-B		mg/kg		Analyzed By: HM						
Analyte	Result	Reporting Limit	Analyzed	Method Blank	BS	% Recovery	True Value QC	RPD	Qualifier	
Chloride	1460	16.0	09/21/2011	ND	416	104	400	7.41		

**Sample ID: S-21 SOUTHSIDE WALL (H102002-14)**

Chloride, SM4500Cl-B		mg/kg		Analyzed By: HM					
Analyte	Result	Reporting Limit	Analyzed	Method Blank	BS	% Recovery	True Value QC	RPD	Qualifier
Chloride	1230	16.0	09/21/2011	ND	416	104	400	7.41	

Cardinal Laboratories

\*=Accredited Analyte

PLEASE NOTE: Liability and Damages. Cardinal's liability and client's exclusive remedy for any claim arising, whether based in contract or tort, shall be limited to the amount paid by client for analyses. All claims, including those for negligence and any other cause whatsoever shall be deemed waived unless made in writing and received by Cardinal within thirty (30) days after completion of the applicable service. In no event shall Cardinal be liable for incidental or consequential damages, including, without limitation, business interruptions, loss of use, or loss of profits incurred by client, its subsidiaries, affiliates or successors arising out of or related to the performance of the services hereunder by Cardinal, regardless of whether such claim is based upon any of the above stated reasons or otherwise. Results relate only to the samples identified above. This report shall not be reproduced except in full with written approval of Cardinal Laboratories.

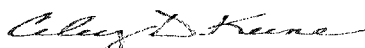

Celey D. Keene, Lab Director/Quality Manager

**Analytical Results For:**

 TALON LPE  
 MIKE STUBBLEFIELD  
 408 W. TEXAS AVE.  
 ARTESIA NM, 88210  
 Fax To: (575) 745-8905

 Received: 09/20/2011  
 Reported: 09/22/2011  
 Project Name: ARTESIA UNIT #32  
 Project Number: 701407.009.01  
 Project Location: SEC. 36-T17S.R28E

 Sampling Date: 09/14/2011  
 Sampling Type: Soil  
 Sampling Condition: \*\* (See Notes)  
 Sample Received By: Jodi Henson

**Sample ID: S-22 EASTSIDE WALL (H102002-15)**

Chloride, SM4500Cl-B		mg/kg	Analyzed By: HM						
Analyte	Result	Reporting Limit	Analyzed	Method Blank	BS	% Recovery	True Value QC	RPD	Qualifier
Chloride	176	16.0	09/21/2011	ND	416	104	400	7.41	

**Sample ID: S-23 EAST OF FLOWLINE (H102002-16)**

Chloride, SM4500Cl-B		mg/kg		Analyzed By: HM						
Analyte	Result	Reporting Limit	Analyzed	Method Blank	BS	% Recovery	True Value QC	RPD	Qualifier	
Chloride	432	16.0	09/21/2011	ND	416	104	400	7.41		

**Sample ID: S-24 BTM EXC 3' BGS (H102002-17)**

Chloride, SM4500Cl-B		mg/kg	Analyzed By: HM						
Analyte	Result	Reporting Limit	Analyzed	Method Blank	BS	% Recovery	True Value QC	RPD	Qualifier
Chloride	3520	16.0	09/21/2011	ND	416	104	400	7.41	

**Sample ID: S-25 NORTHSIDE WALL (H102002-18)**

Chloride, SM4500Cl-B		mg/kg	Analyzed By: HM							
Analyte	Result	Reporting Limit	Analyzed	Method Blank	BS	% Recovery	True Value QC	RPD	Qualifier	
Chloride	1120	16.0	09/21/2011	ND	416	104	400	7.41		

**Sample ID: S-26 SOUTHSIDE WALL (H102002-19)**

Chloride, SM4500Cl-B		mg/kg		Analyzed By: HM						
Analyte	Result	Reporting Limit	Analyzed	Method Blank	BS	% Recovery	True Value QC	RPD	Qualifier	
Chloride	16.0	16.0	09/21/2011	ND	416	104	400	7.41		

Cardinal Laboratories

\*=Accredited Analyte

PLEASE NOTE: Liability and Damages. Cardinal's liability and client's exclusive remedy for any claim arising, whether based in contract or tort, shall be limited to the amount paid by client for analyses. All claims, including those for negligence and any other cause whatsoever shall be deemed waived unless made in writing and received by Cardinal within thirty (30) days after completion of the applicable service. In no event shall Cardinal be liable for incidental or consequential damages, including, without limitation, business interruptions, loss of use, or loss of profits incurred by client, its subsidiaries, affiliates or successors arising out of or related to the performance of the services hereunder by Cardinal, regardless of whether such claim is based upon any of the above stated reasons or otherwise. Results relate only to the samples identified above. This report shall not be reproduced except in full with written approval of Cardinal Laboratories.

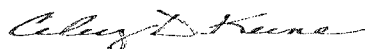

Celey D. Keene, Lab Director/Quality Manager

**Analytical Results For:**

TALON LPE  
MIKE STUBBLEFIELD  
408 W. TEXAS AVE.  
ARTESIA NM, 88210  
Fax To: (575) 745-8905

Received: 09/20/2011  
Reported: 09/22/2011  
Project Name: ARTESIA UNIT #32  
Project Number: 701407.009.01  
Project Location: SEC. 36-T17S.R28E

Sampling Date: 09/14/2011  
Sampling Type: Soil  
Sampling Condition: \*\* (See Notes)  
Sample Received By: Jodi Henson

**Sample ID: S-27 EASTSIDE WALL (H102002-20)****Chloride, SM4500Cl-B****mg/kg****Analyzed By: HM**

Analyte	Result	Reporting Limit	Analyzed	Method Blank	BS	% Recovery	True Value QC	RPD	Qualifier
Chloride	16.0	16.0	09/21/2011	ND	416	104	400	7.41	

Cardinal Laboratories

\*=Accredited Analyte

PLEASE NOTE: Liability and Damages. Cardinal's liability and client's exclusive remedy for any claim arising, whether based in contract or tort, shall be limited to the amount paid by client for analyses. All claims, including those for negligence and any other cause whatsoever shall be deemed waived unless made in writing and received by Cardinal within thirty (30) days after completion of the applicable service. In no event shall Cardinal be liable for incidental or consequential damages, including, without limitation, business interruptions, loss of use, or loss of profits incurred by client, its subsidiaries, affiliates or successors arising out of or related to the performance of the services hereunder by Cardinal, regardless of whether such claim is based upon any of the above stated reasons or otherwise. Results relate only to the samples identified above. This report shall not be reproduced except in full with written approval of Cardinal Laboratories.

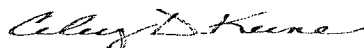

Celey D. Keene, Lab Director/Quality Manager



**Notes and Definitions**

ND	Analyte NOT DETECTED at or above the reporting limit
RPD	Relative Percent Difference
**	Samples not received at proper temperature of 6°C or below.
***	Insufficient time to reach temperature.
-	Chloride by SM4500Cl-B does not require samples be received at or below 6°C Samples reported on an as received basis (wet) unless otherwise noted on report

---

Cardinal Laboratories

\*=Accredited Analyte

PLEASE NOTE: Liability and Damages. Cardinal's liability and client's exclusive remedy for any claim arising, whether based in contract or tort, shall be limited to the amount paid by client for analyses. All claims, including those for negligence and any other cause whatsoever shall be deemed waived unless made in writing and received by Cardinal within thirty (30) days after completion of the applicable service. In no event shall Cardinal be liable for incidental or consequential damages, including, without limitation, business interruptions, loss of use, or loss of profits incurred by client, its subsidiaries, affiliates or successors arising out of or related to the performance of the services hereunder by Cardinal, regardless of whether such claim is based upon any of the above stated reasons or otherwise. Results relate only to the samples identified above. This report shall not be reproduced except in full with written approval of Cardinal Laboratories.

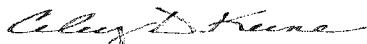

---

Celey D. Keene, Lab Director/Quality Manager

# Cardinal Laboratories

## CHAIN-OF-CUSTODY AND ANALYSIS REQUEST

101 East Marland, Hobbs, NM 88240  
(575) 393-2326 FAX (575) 393-2476

1-3

Company Name: <u>Talon/LPE</u>				P.O. #:				ANALYSIS REQUEST															
Project Manager: <u>Mike Stubblefield</u>				Company: <u>Talon/LPE</u>																			
Address: <u>408 West Texas Ave</u>				Attn:																			
City: <u>Artesia</u> State: <u>N.M.</u> Zip: <u>8</u>				Address:																			
Phone #: <u>575-441-7254</u> Fax #:				City:																			
Project #: <u>701407.004.01</u> Project Owner: <u>Quantum Res.</u>				State:																			
Project Name: <u>Artesia Oils No. 32</u>				Zip:																			
Project Location: <u>Sec. 36 TNS-R28E</u>				Phone #:																			
Sampler Name: <u>Mike Stubblefield</u>				Fax #:																			
FOR LAB USE ONLY																							
Lab I.D.		Sample I.D.		GRAB OR (COMP.)		CONTAINERS		MATRIX		PRESERV.		SAMPLING		Total Chlorides									
H102002																							
1 5' 8" 12' by 5		G																					
2 5' 9" 12' by 5		G																					
3 5' 10" bottom excavation 5' by 5		G																					
4 5' 11" bottom excavation 3' by 5		G																					
5 5' 12" southside wall		G																					
6 5' 13" west side wall		G																					
7 5' 14" eastside wall		G																					
8 5' 15" bottom excavation 3' by 5		G																					
9 5' 16" westside wall		G																					
10 5' 17" eastside wall		G																					

PLEASE NOTE: Liability and Damages. Cardinal's liability and client's exclusion remedy for any claim arising whether based in contract or tort, shall be limited to the amount paid by the client for the analysis. All claims including those for negligence and any other cause whatsoever shall be deemed waived unless made in writing and received by Cardinal within 30 days after completion of the applicable service. In no event shall Cardinal be liable for incidental or consequential damages, including without limitation, business interruptions, loss of use, or loss of profits incurred by client, its subsidiaries, affiliates or successors arising out of or related to the performance of services hereunder by Cardinal, regardless of whether such claim is based upon any of the above stated reasons or otherwise.

Relinquished By:	Date:	Received By:	Phone Result:	Yes	No	Add'l Phone #:
<u>Mike Stubblefield</u>	<u>9/20/2011</u>	<u>John Hinson</u>	Fax Result:	Yes	No	Add'l Fax #:
Relinquished By:	Date:	Received By:	REMARKS:			

Delivered By: (Circle One)	Sample Condition	CHECKED BY:
Sampler - UPS - Bus - Other	Cool Intact	(Initials)
	Yes <input checked="" type="checkbox"/> No <input type="checkbox"/>	<u>JH</u>



## CHAIN-OF-CUSTODY AND ANALYSIS REQUEST

101 East Marland, Hobbs, NM 88240

(575) 393-2326 FAX (575) 393-2476

2-3

Company Name:						BILL TO								ANALYSIS REQUEST																											
Project Manager:						P.O. #:																																			
Address:						Company:																																			
City:						Attn:																																			
Phone #:						Address:																																			
Project #:						City:																																			
Project Name:						State:						Zip:																													
Project Location:						Phone #:																																			
Sampler Name:						Fax #:																																			
FOR LAB USE ONLY																																									
Lab I.D.		Sample I.D.				GRAB OR (COMP.)		# CONTAINERS		GROUNDWATER		WASTEWATER		SOIL		OIL		SLUDGE		OTHER :		ACID/BASE		ICE / COOL		OTHER :		DATE		TIME											
HIDZ002																																									
11 S-19 northside wall						G																						9/14/2011		2:35P											
12 S-19 bottom excavation 7' bgs						G																						9/13/2011		3:14P											
13 S-20 northside wall						G																						9/14/2011		3:19P											
14 S-21 southside wall						G																						9/14/2011		3:21P											
15 S-22 eastside wall						G																						9/14/2011		3:36P											
16 S-23 east of flame line						G																						9/14/2011		3:40P											
17 S-24 bottom excavation 3' bgs						G																						9/14/2011		3:49P											
18 S-25 northside wall						G																						9/14/2011		3:51P											
19 S-26 southside wall						G																						9/14/2011		3:54P											
20 S-27 eastside wall						G																						9/14/2011		3:59P											

**PLEASE NOTE:** Liability and Damages. Cardinal's liability and client's exclusive remedy for any claim arising whether based in contract or tort, shall be limited to the amount paid by the client for the analyses. All claims, including those for negligence and any other cause whatsoever shall be deemed waived unless made in writing and received by Cardinal within 30 days after completion of the applicable service. In no event shall Cardinal be liable for incidental or consequential damages, including without limitation, business interruptions, loss of use, or loss of profits incurred by client, its subsidiaries, affiliates or successors arising out of or related to the performance of services hereunder by Cardinal, regardless of whether such claim is based upon any of the above stated reasons or otherwise.

Relinquished By:		Date:	Received By:	Phone Result:		<input type="checkbox"/> Yes	<input type="checkbox"/> No	Add'l Phone #:
<i>Mick Stappell</i>		9/20/2011	<i>Jodi Hunsen</i>	Fax Result:		<input type="checkbox"/> Yes	<input type="checkbox"/> No	Add'l Fax #:
Time:				REMARKS:				
3:12PM								
Relinquished By:		Date:	Received By:					
Time:								

**Delivered By: (Circle One)**

Sampler - UPS - Bus - Other: Other

*13C*

**Sample Condition**

Cool Intact

☒ Yes ☐ No    ☐ Yes ☐ No

**CHECKED BY:**

(Initials)

*[Signature]*

† Cardinal cannot accept verbal changes. Please fax written changes to 505-393-2476