



Texaco E & P

205 E. Bender Blvd.

Hobbs NM 88240

505 393 7191

DHC

5/13/97

148.2

VERBA ON
5-3097
BS

April 21, 1997

NMOCD

2040 South Pacheco

Santa Fe, New Mexico 87505

Attn: Mr. Ben Stone

Subject: Application to DHC C. H. Weir "A" #12, G-12-20-37, in the Skaggs Drinkard (63800) and Weir Blinebry, East (63800) Pools.

Dear Mr. Stone:

Texaco Exploration and Production, Inc. respectfully requests administrative approval to downhole commingle the C. H. Weir "A" #12 in the Skaggs Drinkard and Weir Blinebry, East Pools. Notification of this application has been sent to offset operators and a statement of notification has been included in this package.

This well was recently recompleted in the Weir Blinebry, East pool and is currently being produced by rod-pumping. Prior to the recompletion, the Skaggs Drinkard was being produced by plunger lift. Currently, the Skaggs Drinkard is plugged back. In order to commingle, the bridge plug will be drilled out and both zones will be simultaneously rod-pumped.

A full year of production data is not available for the Blinebry due to the recency of the completion. The allocation factors were determined by recent tests from both zones.

This well will meet all of the requirements set forth by Rule 303(C). The allocation factor will be determined in the following manner:

$$\% \text{ BLINEBRY} = \frac{\text{STABILIZED BLINEBRY PRODUCTION}}{\text{BLINEBRY} + \text{DRINKARD STABILIZED PRODUCTION}}$$

$$\% \text{ DRINKARD} = 100\% - \% \text{ BLINEBRY PRODUCTION}$$

If you have any questions concerning this application, please contact Britton M. McQuien at (505) 397-0427.

Sincerely,

Britton M. McQuien

Britton M. McQuien

Production Engineer

Texaco Exploration and Production, Inc.

cc: Mr. J. T. Sexton

EXHIBIT "B" - CASE NO. 11353, ORDER NO. R-10470-A

DISTRICT I

P.O. Box 1980, Hobbs, NM 88240

DISTRICT II

811 South First St., Artesia, NM 88210

DISTRICT III

1000 Rio Brazos Rd. Aztec, NM 87410

State of New Mexico
Energy, Minerals and Natural Resources Department

OIL CONSERVATION DIVISION

2040 S. Pacheco
Santa Fe, New Mexico 87505-6429Form C-107-A
New 3-12-96

APPROVAL PROCESS:

☐ Administrative ☐ Hearing

EXISTING WELLBORE

☐ YES ☐ NO

APPLICATION FOR DOWNHOLE COMMINGLING

Operator Texaco Exploration & Producing Inc. Address 205 East Bender Hobbs, New Mexico 88240

Lease C. H. Weir "A" Well No. 12 Unit Ltr. - Sec - Tws - Rge G-12-20S-37E County Lea

OGRID NO. 022351 Property Code 011130 API NO. 30-025-27398 Spacing Unit Lease Types: (check 1 or more)
Federal State X Fee

The following facts are submitted in support of downhole commingling:	Lower Zone	Intermediate Zone	Upper Zone
1. Pool Name and Pool Code	Skaggs Drinkard 57000		Weir Blinbry, East 63800
2. Top And Bottom of Pay Section (Perforations)	6587'-6894'		5752'-5930'
3. Type of production (Oil or Gas)	oil		oil
4. Method of Production (Flowing or Artificial Lift)	plunger lift		pumping
5. Bottomhole Pressure Oil Zones - Artificial Lift: Estimated Current	(Current) a. 700 psi	a.	a. 1035 psi
Gas & Oil - Flowing: Measured Current All Gas Zones: Estimated Or Measured Original	(Original) b.	b.	b.
6. Oil Gravity (* API) or Gas BTU Content	38		39
7. Producing or Shut-In? Production Marginal? (yes or no)	shut-in yes		Producing Yes
* If Shut-In, give date and oil/gas/ water rates of last production Note: For new zones with no production history, applicant shall be required to attach production estimates and supporting data	Date: 2/24/97 Rates: 10/200/0		
* If Producing, give date and oil/gas/ water rates of recent test (within 60 days)	Date: Rates:		3/11/97 44/209/0
8. Fixed Percentage Allocation Formula -% for each zone	Oil: 18.5% Gas: 49%	Oil: % Gas: %	Oil: 81.5% Gas: 51%

9. If allocation Formula is based upon something other than current or past production, or is based upon some other method, submit attachments with supporting data and/or explaining method and providing rate projections or other required data.
10. Are all working, overriding, and royalty interests identical in all commingled zones? ☒ Yes ☐ No
If not, have all working, overriding, and royalty interests been notified by certified mail? ☐ Yes ☐ No
Have all offset operators been given written notice of the proposed downhole commingling? ☒ Yes ☐ No
11. Will cross-flow occur? ☐ Yes ☒ No If yes, are fluids compatible, will the Formations not be damaged, will any cross-flowed production be recovered, and will the allocation formula be reliable. ☐ Yes ☐ No (If No, attach explanation)
12. Are all produced fluids from all commingled zones compatible with other? ☒ Yes ☐ No
13. Will the value of production be decreased by commingling? ☐ Yes ☒ No (If Yes, attach explanation)
14. If this well is on, or communitized with, state or federal lands, either the Commissioner of Public Land or the United States Bureau of Land Management has been notified in writing of this application. ☒ Yes ☐ No
15. NMOCD Reference Cases for Rule 303(C) Exceptions: ORDER NO(S) _____
16. ATTACHMENTS:

- * C-102 for each zone to be commingled showing its spacing unit and acreage deication.
- * Production curve for each zone for at lease one year. (If not available, attach explanation.)
- * For zones with no production history, estimated production rates and supporting data.
- * Notification list of all offset operators.
- * Notification list of working, overriding, and royalty interests for uncommon interest cases.
- * Any additional statements, data or documents required to support commingling.

I hereby certify that the information above is true and complete to the best of my knowledge and belief

SIGNATURE Britton M. McQuien TITLE Engineer DATE 4-21-97TYPE OR PRINT NAME Britton M. McQuien TELEPHONE NO. (505) 397-0427

WEIR, C. H. -A- 12 SKAGGS DRINKARD

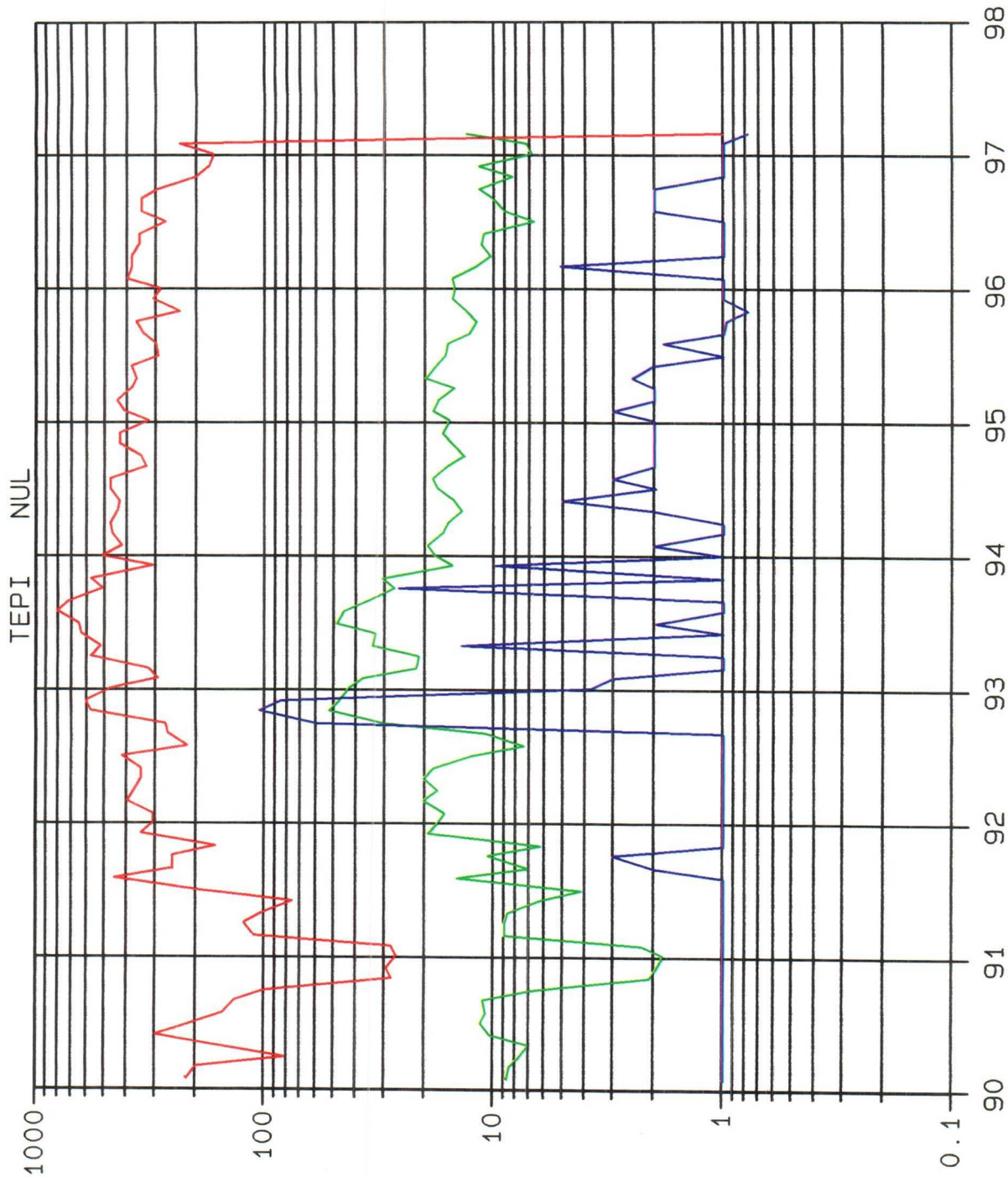

LEASE DATA
LSE 011130
FLD 57000
OPER TEPI
ZONE NUL
--
COUNTY 025
STATE 30
30025273980001
STATUS 2-97
CO 42 MBO
CG 852 MCMF
CW 11 MBW
BOPD 13
BWPD 1
MCFPD 0
WELLS 1
CI 0 MBWI
BWIPD 0

DISTRICT I

P.O. Box 1980, Hobbs, NM 88241-1980

DISTRICT II

P.O. Box Drawer DD, Artesia, NM 88211-0719

DISTRICT III

1000 Rio Brazos Rd., Aztec, NM 87410

DISTRICT IV

P.O. Box 2088, Santa Fe, NM 87504-2088

State of New Mexico

Energy, Minerals and Natural Resources Department

Form C-102

Revised February 10, 1994

Instructions on back

Submit to Appropriate District Office

State Lease - 4 Copies

Fee Lease - 3 Copies

☐ AMENDED REPORT

OIL CONSERVATION DIVISION

P.O. Box 2088

Santa Fe, New Mexico 87504-2088

WELL LOCATION AND ACREAGE DEDICATION PLAT

¹ API Number 3002527398	² Pool Code 63800	³ Pool Name WEIR BLINEBRY, EAST
⁴ Property Code 011130	⁵ Property Name WEIR, C. H. -A-	⁶ Well No. 12
⁷ OGRID Number 022351	⁸ Operator Name TEXACO EXPLORATION & PRODUCTION INC.	⁹ Elevation 3559' GR

¹⁰ Surface Location

UI or lot no.	Section	Township	Range	Lot.Idn	Feet From The	North/South Line	Feet From The	East/West Line	County
G	12	20S	37E		2307'	NORTH	2307'	EAST	LEA

¹¹ Bottom Hole Location If Different From Surface

UI or lot no.	Section	Township	Range	Lot.Idn	Feet From The	North/South Line	Feet From The	East/West Line	County

¹² Dedicated Acres 40	¹³ Joint or Infill No	¹⁴ Consolidation Code	¹⁵ Order No.
-------------------------------------	-------------------------------------	----------------------------------	-------------------------

NO ALLOWABLE WILL BE ASSIGNED TO THIS COMPLETION UNTIL ALL INTERESTS HAVE BEEN CONSOLIDATED
OR A NON-STANDARD UNIT HAS BEEN APPROVED BY THE DIVISION

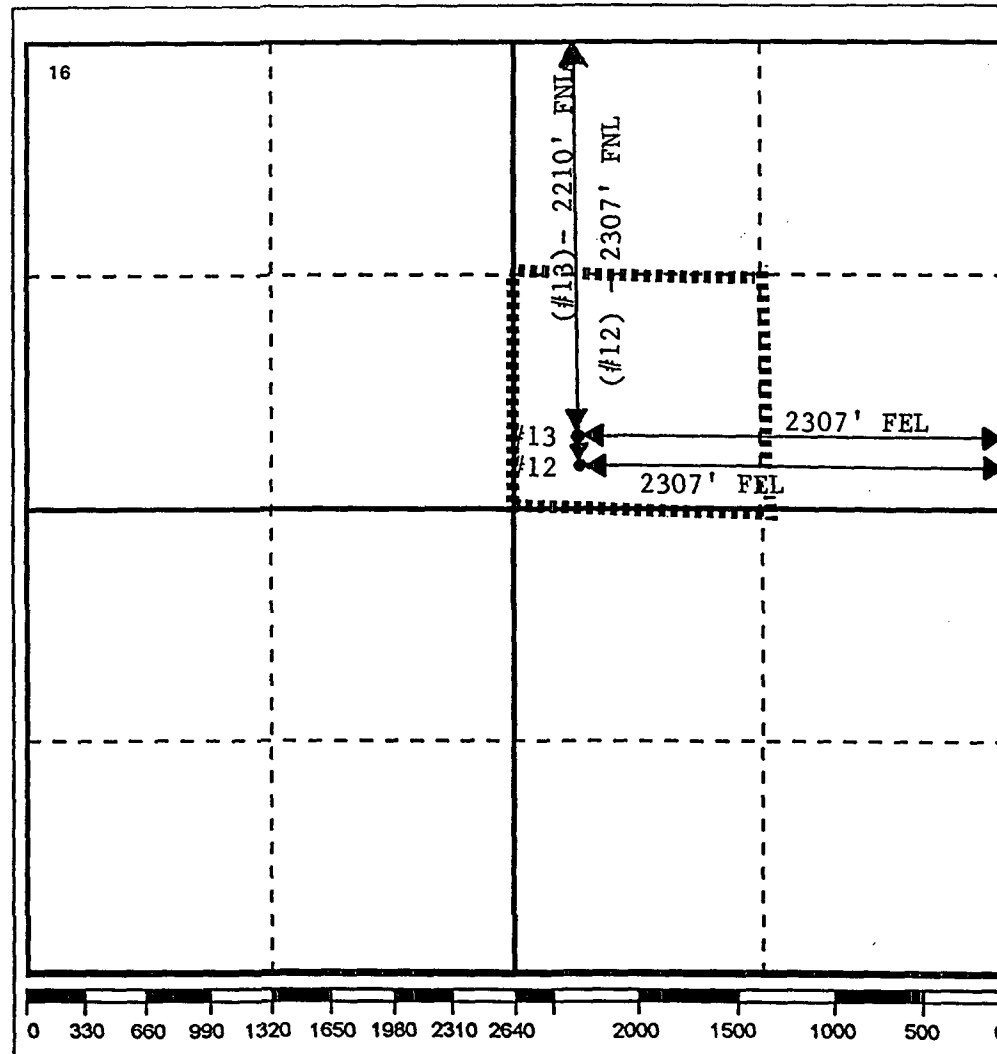

17 OPERATOR CERTIFICATION

I hereby certify that the information contained herein is true and complete to the best of my knowledge and belief

Signature

Printed Name

V. Greg Maes

Position

Engineering Assistant

Date

2/10/97

18 SURVEYOR CERTIFICATION

I hereby certify that the well location shown on this plat was plotted from field notes of actual surveys made by me or under my supervision, and that the same is true and correct to the best of my knowledge and belief.

Date Surveyed

Signature & Seal of
Professional Surveyor

Certificate No.

P.O. Box 1980, Hobbs, NM 88241-1980

DISTRICT II

P.O. Box Drawer DD, Artesia, NM 88211-0719

DISTRICT III

1000 Rio Brazos Rd., Aztec, NM 87410

DISTRICT IV

P.O. Box 2088, Santa Fe, NM 87504-2088

State of New Mexico

Energy, Minerals and Natural Resources Department

Form C-102

Revised February 10, 1994

Instructions on back

Submit to Appropriate District Office

State Lease - 4 Copies

Fee Lease - 3 Copies

☐ AMENDED REPORT

OIL CONSERVATION DIVISION

P.O. Box 2088

Santa Fe, New Mexico 87504-2088

WELL LOCATION AND ACREAGE DEDICATION PLAT

¹ API Number 3002527398	² Pool Code 57000	³ Pool Name SKAGGS DRINKARD
⁴ Property Code 011130	⁵ Property Name WEIR, C. H. -A-	⁶ Well No. 12
⁷ OGRID Number 022351	⁸ Operator Name TEXACO EXPLORATION & PRODUCTION INC.	⁹ Elevation 3559'-GR

¹⁰ Surface Location

Ul or lot no.	Section	Township	Range	Lot.Idn	Feet From The	North/South Line	Feet From The	East/West Line	County
G	12	20S	37E		2307'	NORTH	2307'	EAST	LEA

¹¹ Bottom Hole Location If Different From Surface

Ul or lot no.	Section	Township	Range	Lot.Idn	Feet From The	North/South Line	Feet From The	East/West Line	County
---------------	---------	----------	-------	---------	---------------	------------------	---------------	----------------	--------

¹² Dedicated Acres 40	¹³ Joint or Infill No	¹⁴ Consolidation Code	¹⁵ Order No.
-------------------------------------	-------------------------------------	----------------------------------	-------------------------

NO ALLOWABLE WILL BE ASSIGNED TO THIS COMPLETION UNTIL ALL INTERESTS HAVE BEEN CONSOLIDATED
OR A NON-STANDARD UNIT HAS BEEN APPROVED BY THE DIVISION

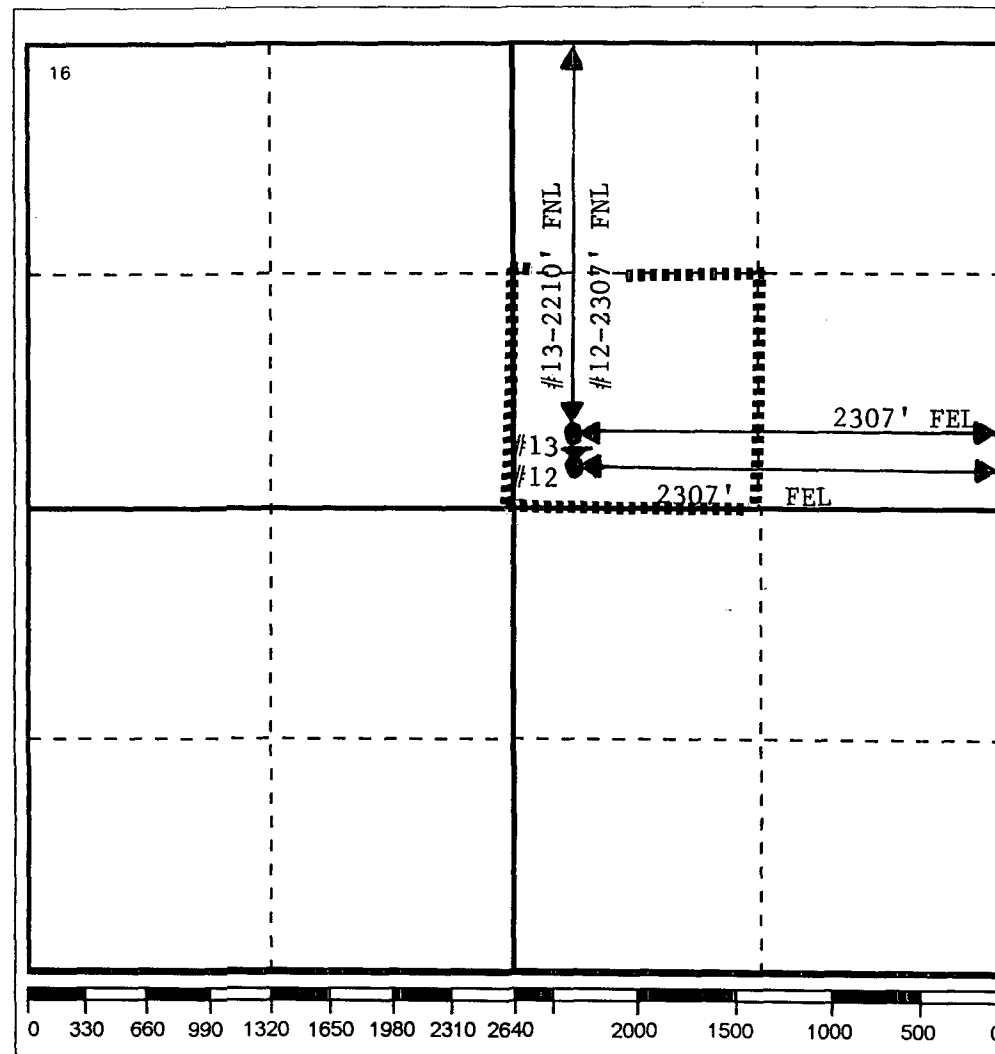

17 OPERATOR CERTIFICATION

I hereby certify that the information
contained herein is true and complete to the
best of my knowledge and belief

Signature

Printed Name

V. Greg Maes

Position

Engineering Assistant

Date _____

4/21/97

18 SURVEYOR CERTIFICATION

I hereby certify that the well location shown on this plat was plotted from field notes of actual surveys made by me or under my supervision, and that the same is true and correct to the best of my knowledge and belief.

Date Surveyed

Signature & Seal of
Professional Surveyor

Certificate No.

Offset Operators and all Lessees of Record
C. H. Weir "A" No. 12 Well
SW/4 NE/4 of Section 12, T-20-S, R-37-E
Weir Blinbry, East and Skaggs Drinkard Formations
Lea County, New Mexico
April 16, 1997

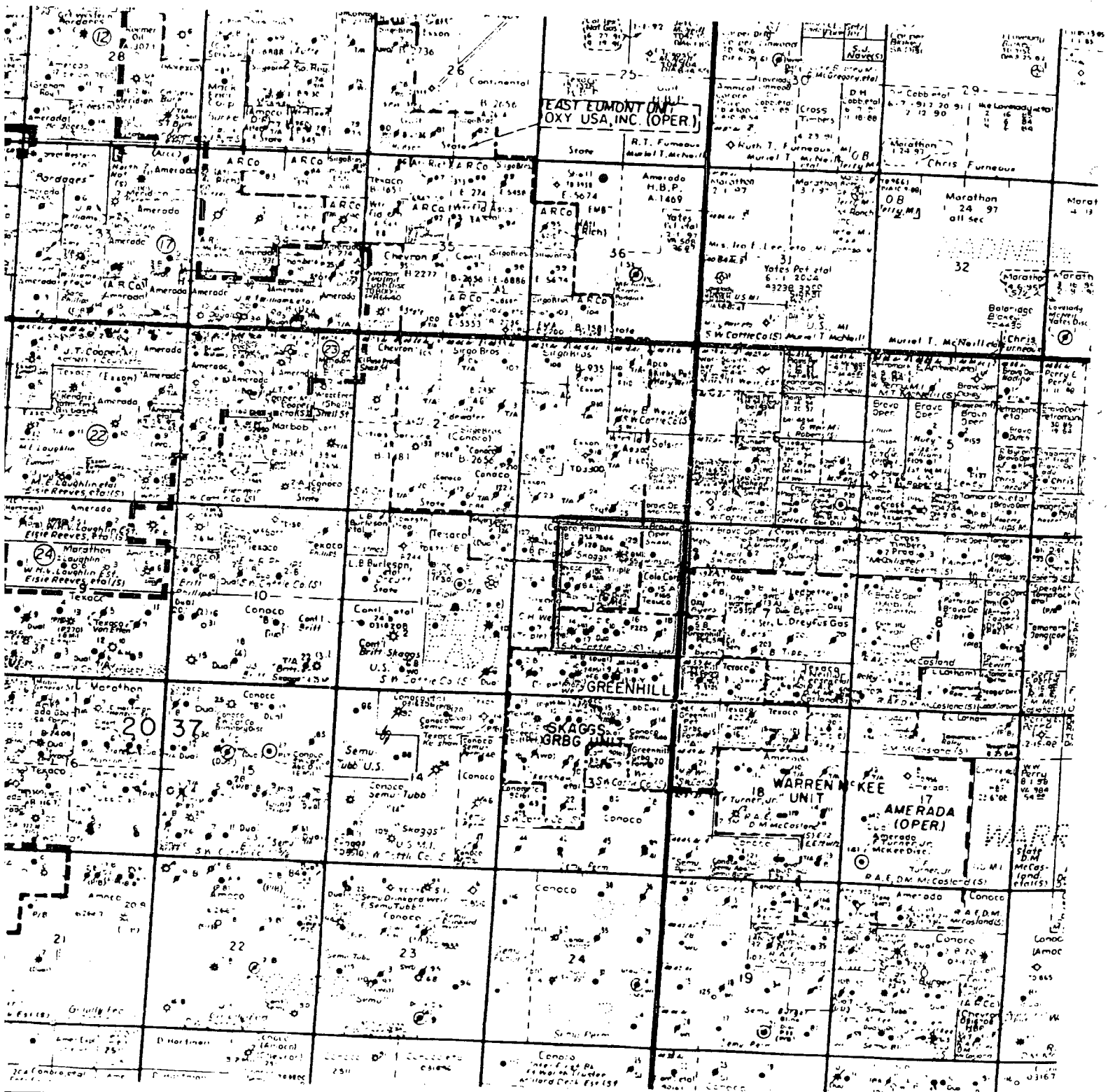

Offset Operators and all Lessees of Record
 C. H. Weir "A" No. 12 Well
 SW/4 NE/4 of Section 12, T-20-S, R-37-E
 Weir Blinebry, East and Skaggs Drinkard Formations
 Lea County, New Mexico
 April 16, 1997

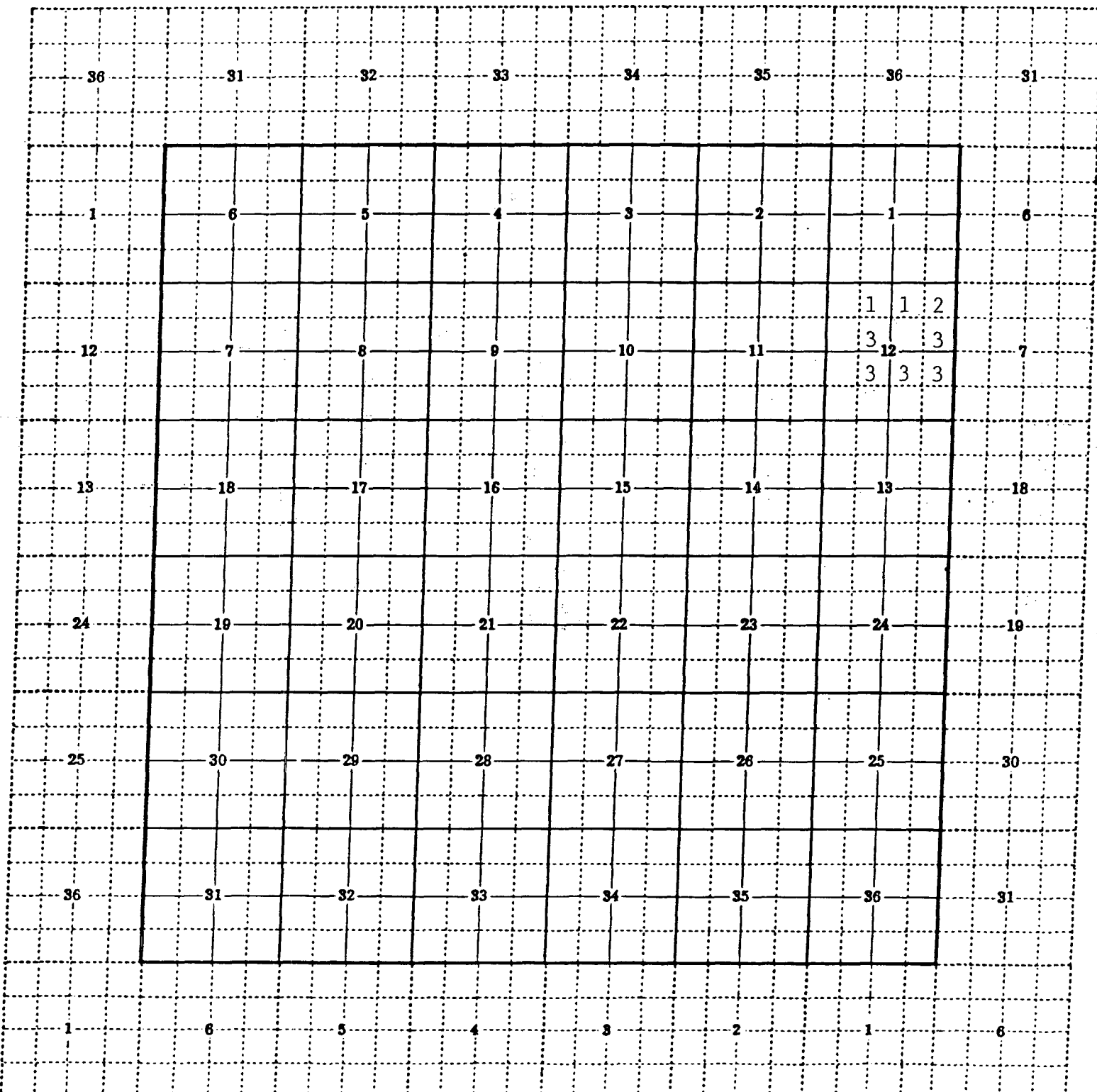

Offset Operators and all Lessees of Record
C. H. Weir "A" No. 12 Well
SW/4 NE/4 of Section 12, T-20-S, R-37-E
Weir Blinebry, East and Skaggs Drinkard Formations
Lea County, New Mexico
April 16, 1997

Number 1

Conoco Inc.
10 Desta Drive, Suite 100-W
Midland, Texas 79705

Number 2

Cross Timbers Operating Company
3000 N. Garfield, Suite 175
Midland, Texas 79705

Number 3

Texaco Exploration and Production Inc.
P. O. Box 3109
Midland, Texas 79702

Is your RETURN ADDRESS completed on the reverse side?

SENDER: <ul style="list-style-type: none">■ Complete items 1 and/or 2 for additional services.■ Complete items 3, 4a, and 4b.■ Print your name and address on the reverse of this form so that we can return this card to you.■ Attach this form to the front of the mailpiece, or on the back if space does not permit.■ Write "Return Receipt Requested" on the mailpiece below the article number.■ The Return Receipt will show to whom the article was delivered and the date delivered.		I also wish to receive the following services (for an extra fee): 1. <input type="checkbox"/> Addressee's Address 2. <input type="checkbox"/> Restricted Delivery Consult postmaster for fee.	
3. Article Addressed to: Conoco Inc. 10 Desta Drive, Suite 100W Midland, Texas 79705		4a. Article Number P 442 355 602	
		4b. Service Type <input type="checkbox"/> Registered <input checked="" type="checkbox"/> Certified <input type="checkbox"/> Express Mail <input type="checkbox"/> Insured <input type="checkbox"/> Return Receipt for Merchandise <input type="checkbox"/> COD	
		7. Date of Delivery	
5. Received By: (Print Name)		8. Addressee's Address (Only if requested and fee is paid)	
6. Signature: (Addressee or Agent) X			

Thank you for using Return Receipt Service.

PS Form 3811, December 1994

Domestic Return Receipt

Is your RETURN ADDRESS completed on the reverse side?

SENDER: <ul style="list-style-type: none">■ Complete items 1 and/or 2 for additional services.■ Complete items 3, 4a, and 4b.■ Print your name and address on the reverse of this form so that we can return this card to you.■ Attach this form to the front of the mailpiece, or on the back if space does not permit.■ Write "Return Receipt Requested" on the mailpiece below the article number.■ The Return Receipt will show to whom the article was delivered and the date delivered.		I also wish to receive the following services (for an extra fee): 1. <input type="checkbox"/> Addressee's Address 2. <input type="checkbox"/> Restricted Delivery Consult postmaster for fee.	
3. Article Addressed to: Cross Timbers Operating Company 3000 N. Garfield, Suite 175 Midland, Texas 79705		4a. Article Number P 442 355 601	
		4b. Service Type <input type="checkbox"/> Registered <input checked="" type="checkbox"/> Certified <input type="checkbox"/> Express Mail <input type="checkbox"/> Insured <input type="checkbox"/> Return Receipt for Merchandise <input type="checkbox"/> COD	
		7. Date of Delivery	
5. Received By: (Print Name)		8. Addressee's Address (Only if requested and fee is paid)	
6. Signature: (Addressee or Agent) X			

Thank you for using Return Receipt Service.

PS Form 3811, December 1994

Domestic Return Receipt

DHC-1482



STATE OF NEW MEXICO
ENERGY, MINERALS AND NATURAL RESOURCES DEPARTMENT

OIL CONSERVATION DIVISION
HOBBS DISTRICT OFFICE

4/28/97

GOVERNOR

POST OFFICE BOX 1980
HOBBS, NEW MEXICO 88241-1980
(505) 393-6161

OIL CONSERVATION DIVISION
P. O. BOX 2088
SANTA FE, NEW MEXICO 87501

RE: Proposed:

MC _____
DHC X _____
NSL _____
NSP _____
SWD _____
WFX _____
PMX _____

Gentlemen:

I have examined the application for the:

Texaco E&P Inc CH Weir A # 12-6 12-203-37e
Operator Lease & Well No. Unit S-T-R

and my recommendations are as follows:

OK

Yours very truly,

Jerry Sexton
Supervisor, District 1

/ed